

MERIDIAN STREET

84-B-2

PEAKS ISLAND

MI-10288
HEATH & WATSON
1955



CITY OF PORTLAND

JOSEPH E. GRAY, JR.
DIRECTOR OF PLANNING
AND URBAN DEVELOPMENT

Date: September 27, 1983

Lare Huber & Lois Tiedeken
84-B-2 Merriden Street
Peaks Island, Me'ne 04108

Subject: Alterations, no permit

Dear Sir:

A recent inspection at the above named address of which you are listed the present owner, showed that alterations have been completed, or are in the process of being completed, that require building permits from the City of Portland as defined in the 1981 BOCA Building Code and/or Portland Municipal Code.

It is therefore necessary for you to come to City Hall, 389 Congress Street, Room 317, to file an application for these required permits. This must be done within five (5) days of receipt of this letter. Failure to abide by this request could result in court action and a fine of up to \$50 to \$1,000 per day for each day this violation exists.

I look forward to your cooperation.

Yours truly,

P. Samuel Hoffses
Chief of Inspection Services

Code Enforcement Officer -



APARTMENT HOUSE BOARD

APPLICATION FOR PERMIT

PERMIT ISSUED

Class of Building or Type of Structure Third Class

Portland, Maine, July 27, 1939 JUL 29 1939

To the INSPECTOR OF BUILDINGS, PORTLAND, ME.

The undersigned hereby applies for a permit to erect alter install the following building structure equipment in accordance with the Laws of the State of Maine, the Building Code of the City of Portland, plans and specifications, if any, submitted herewith and the following specifications:

Location Meridian Street, Peaks Island Within Fire Limits? no Dist. No. _____

Owner's or Lessee's name and address Fred L. Hansen, Meridian St. Peaks Telephone _____

Contractor's name and address George H. Weaver, Island Ave. Peaks Telephone 200

Architect _____ Plans filed no No. of sheets _____

Proposed use of building Cottage No. families _____

Other buildings on same lot _____

Estimated cost \$ 210. Fee \$ 15.

Description of Present Building to be Altered.

Material wood No. stories 1 1/2 Heat _____ Style of roof pitch Roofing wood

Last use Cottage No. families _____

General Description of New Work

To remove gable roof with asphalt roofing Class C
To cut in three new small windows for ventilation of second floor attic

CERTIFICATE OF OCCUPANCY REQUIREMENT IS WAIVED

It is understood that this permit does not include installation of heating apparatus which is to be taken out separately by and in the name of the heating contractor.

Details of New Work

Size, front _____ depth _____ No. stories _____ Height average _____ to top of plate

To be erected on solid or filled land? _____ earth or rock? _____

Material of foundation _____ Thickness, top _____ bottom _____ cellar _____

Material of underpinning _____ Height _____ Thickness _____

Kind of Roof _____ Rise per foot _____ Roof covering Asphalt roofing Class C Inc. Lb.

No. of chimneys _____ Material of chimneys _____ of lining _____

Kind of heat _____ Type of fuel _____ Is gas fitting involved? _____

Framing Lumber—Kind _____ Dressed or Full Size? _____

Corner posts _____ Sills _____ Girt or ledger board? _____ Size _____

Material columns under girders _____ Size _____ Max. on centers _____

Studs (outside walls and carrying partitions) 2x4-16" O. C. Girders 6x8 or larger. Bridging in every floor and flat roof span over 8 feet. Sills and corner posts all one piece in cross section.

Joists and rafters: 1st floor _____, 2nd _____, 3rd _____, roof _____

On centers: 1st floor _____, 2nd _____, 3rd _____, roof _____

Maximum span: 1st floor _____, 2nd _____, 3rd _____, roof _____

If one story building with masonry walls, thickness of walls? _____ height? _____

If a Garage

No. cars now accommodated on same lot _____ to be accommodated _____

Total number commercial cars to be accommodated _____

Will automobile repairing be done other than minor repairs to cars habitually stored in the proposed building? _____

Miscellaneous

Will above work require removal or disturbing of any shade tree on a public street? no

Will there be in charge of the above work a person competent to see that the State and City requirements pertaining thereto are observed? yes

Fred L. Hansen

Signature of owner

L. S. Weaver

INSPECTION COPY

Permit No. 39/1124

Location: Meridian St. Pecks

Owner: Fred L. Hansen

Date of permit: 7/29/39.

Notif. closing-in

Inspn. closing-in

Final Notif.

Final Inspn. 9/12/39 1276

Cert. of Occupancy issued 11/30/39

NOTES

~~Notes section crossed out with a large X.~~

No.	City	County	State	Year	Permit	Inspector	Remarks
1							
2							
3							
4							
5							
6							
7							
8							
9							
10							
11							
12							
13							
14							
15							
16							
17							
18							
19							
20							
21							
22							
23							
24							
25							
26							
27							
28							
29							
30							
31							
32							
33							
34							
35							
36							
37							
38							
39							
40							
41							
42							
43							
44							
45							
46							
47							
48							
49							
50							
51							
52							
53							
54							
55							
56							
57							
58							
59							
60							
61							
62							
63							
64							
65							
66							
67							
68							
69							
70							
71							
72							
73							
74							
75							
76							
77							
78							
79							
80							
81							
82							
83							
84							
85							
86							
87							
88							
89							
90							
91							
92							
93							
94							
95							
96							
97							
98							
99							
100							

84-B-2 MERIDIAN ST., PEAKS ISL.

1





CITY OF PORTLAND

JOSEPH E. GRAY, JR.
DIRECTOR OF PLANNING
AND URBAN DEVELOPMENT

Date: September 27, 1983

Lare Huber & Lois Tiedeken
84-B-2 Merriden Street
Peaks Island, Maine 04108

OK
BY *Admitts*
DATE *9-30-83*

Subject: Alterations, no permit

Dear Sir:

A recent inspection at the above named address of which you are listed the present owner, showed that alterations have been completed, or are in the process of being completed, that require building permits from the City of Portland as defined in the 1981 BOCA Building Code and/or Portland Municipal Code.

It is therefore necessary for you to come to City Hall, 389 Congress Street, Room 317, to file an application for these required permits. This must be done within five (5) days of receipt of this letter. Failure to abide by this request could result in court action and a fine of up to \$50 to \$1,000 per day for each day this violation exists.

I look forward to your cooperation.

Yours truly,

P. Samuel Hoffses
Chief of Inspection Services

Arthur Admitts
Code Enforcement Officer -

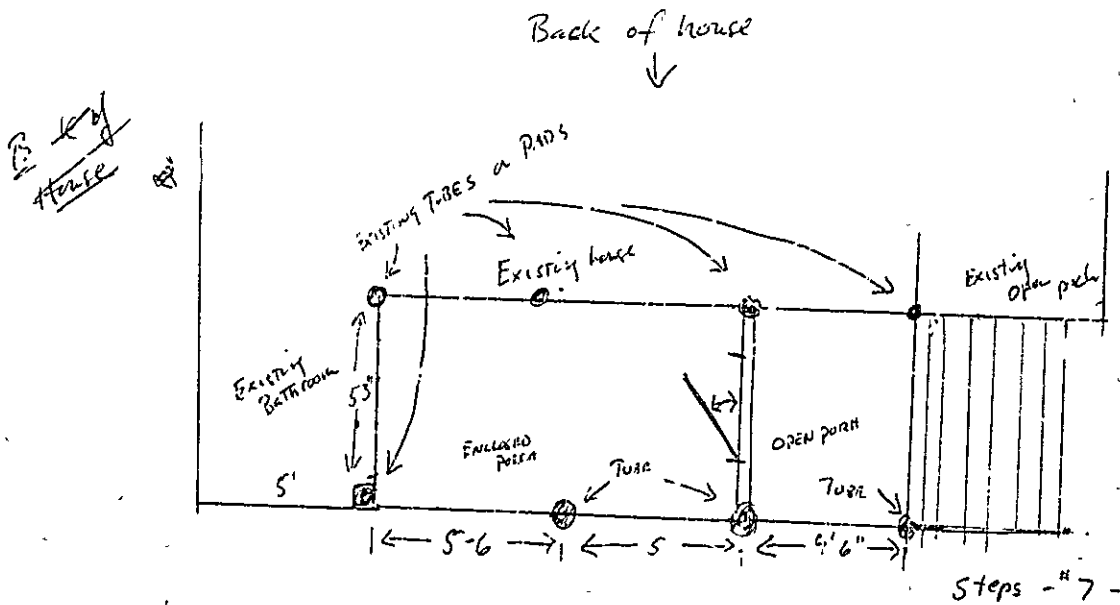

Sono tubes - 8" - Set on ledge, with lags in ledge
diameter

Floor frames 16" OC - 2x6

Wall frames 24" OC - 2x6

Roof frames 16" OC - 2x6

New roof incorporates old roof over Bathroom

Existing open porch enclosed, existing ~~part~~ open porch lengthened across back of house (4'6")

New steps



Chart. 84 B-2

TK

LEAKE HOUSE, 1000 LEAKE STREET, DEARFIELD, MAINE

APPLICATION FOR PERMIT

B.O.C.A. USE GROUP
 B.O.C.A. TYPE OF CONSTRUCTION **001029**
 ZONING LOCATION PORTLAND, MAINE Sept. 27, 1983

PERMIT ISSUED
OCT 6 1983

To the CHIEF OF BUILDING & INSPECTION SERVICES, PORTLAND, MAINE

The undersigned hereby applies for a permit to erect, alter, repair, demolish, move or install the following building, structure, equipment or change use in accordance with the Laws of the State of Maine, the Portland B.O.C.A. Building Code and Zoning Ordinance of the City of Portland with plans and specifications, if any, submitted herewith and the following specifications:

LOCATION **84-B-2 Meridian Street, Peaks Island**
 1. Owner's name and address **Lara Huber - same**
 2. Lessee's name and address
 3. Contractor's name and address **Owner**

Fire District #1 #2
 Telephone **766-2006**
 Telephone
 Telephone

Proposed use of building **dwelling with porch enclosure**
 Last use
 Material No. stories Heat Style of roof Roofing

Other buildings on same lot
 Estimated contractual cost \$ **900**

FIELD INSPECTOR—Mr.
 @ 775-5451
 Appeal Fees \$
 Base Fee **15.00**
 Late Fee
 TOTAL \$ **15.00**

To enclose **5' 3" x 10' 6" porch as per plans.**
1 sheet of plans.
 said permit - **04108**
 Stamp of Special Conditions

NOTE TO APPLICANT: Separate permits are required by the installers and subcontractors of heating, plumbing, electrical and mechanicals.

DETAILS OF NEW WORK

Is any plumbing involved in this work? **no** Is any electrical work involved in this work? **no**
 Is connection to be made to public sewer? If not, what is proposed for sewer?
 Has septic tank notice been sent? Form notice sent?
 Lot average grade to top of plate Height average grade to highest point of roof
 Slope front depth No. stories Solid or filled land? earth or rock?
 Material of foundation Thickness, top bottom cellar
 Pitch of roof Rise per foot Roof covering
 Material of chimneys of lining Kind of heat fuel
 Framing Lumber—Kind Dressed or full size? Corner posts Sills
 Size Girders Columns under girders Size Max. on centers
 Studs for side walls and carrying partitions) 2x4-16" O. C. Bridging in every floor and flat roof span over 8 feet.
 Joists and rafters: 1st floor 2nd 3rd roof
 On centers: 1st floor 2nd 3rd roof
 Maximum span: 1st floor 2nd 3rd roof
 In one story building with masonry walls, thickness of walls? height?

IF A GARAGE

No. cars now accommodated on same lot to be accommodated number commercial cars to be accommodated
 Will automobile repairing be done other than minor repairs to cars habitually stored in the proposed building?

APPROVALS BY DATE
 BUILDING INSPECTION—PLAN EXAMINER
 ZONING:
 BUILDING CODE:
 Fire Dept.:
 Health Dept.:
 Others:

MISCELLANEOUS
 Will work require disturbing of any tree on a public street? **no**
 Will there be in charge of the above work a person competent to see that the State and City requirements pertaining thereto are observed?

Signature of Applicant *Lara Huber* Phone # **same**
 Type Name of above **Lara Huber**
 I 2 3 4

Other
 and Address

FIELD INSPECTOR'S COPY APPLICANT'S COPY OFFICE FILE COPY
Mr. Addato

NOTES

10-20-83 - Work all complete
as per plans OK. aa

Permit No. 83/1029

Location

81 B-2 Milwaukee

Owner

Paul J. Miller

Date of permit

9-27-83

Approved

10-6-83

Dwelling

Deck

Garage

Alteration

Large section of the form is crossed out with a large 'X'.

B

APPLICATION FOR PERMIT

PERMIT ISSUED

B.O.C.A. USE GROUP

B.O.C.A. TYPE OF CONSTRUCTION

1029

6

ZONING LOCATION

PORTLAND, MAINE

Sept. 27, 1993

CITY OF PORTLAND

To the CHIEF OF BUILDING & INSPECTION SERVICES, PORTLAND, MAINE

The undersigned hereby applies for a permit to erect, alter, repair, demolish, move or install the following building, structure, equipment or change use in accordance with the Law of the State of Maine, the Portland B.O.C.A. Building Code and Zoning Ordinance of the City of Portland with plans and specifications, if any, submitted herewith and the following specifications:

LOCATION 84-B-2 Markham Street, Peaks Island

- 1. Owner's name and address Lars Huber - same
2. Lessee's name and address
3. Contractor's name and address Owner

Proposed use of building dwelling with porch enclosure
Last use
Material No. stories Heat Style of roof Roofing
Other buildings on same lot
Estimated contractual cost \$ 960

FIELD INSPECTOR-Mr. @ 775-5451

Appeal Fees \$
Base Fee 15.00
Late Fee
TOTAL \$ 15.00

To enclose 5' 3" x 10' 3" porch as per plans. 1 sheet of plans.

send permit - 04108

Stamp of Special Conditions

NOTE TO APPLICANT: Separate permits are required by the installers and subcontractors heating, plumbing, electrical and mechanicals.

DETAILS OF NEW WORK

Is any plumbing involved in this work? Is any electrical work involved in this work?
Is connection to be made to public sewer? If not, what is proposed for sewage?
Has septic tank notice been sent? Form notice sent?
Height average grade to top of plate Height average grade to highest point of roof?
Size, front depth No. stories solid or filled lava? earth or rock?
Material of foundation Thickness, top bottom cellar
Kind of roof Rise per foot Roof covering
No. of chimneys Material of chimneys of lining Kind of heat fuel
Framing Lumber - Kind Dressed or full size? Corner posts Sills
Size Girder Columns under girders Size Max. on centers
Studs (outside walls and carrying partitions) 2x4-16" O. C. Bridging in every floor and flat roof span over 8 feet.
Joists and rafter 1st floor 2nd 3rd roof
On centers: 1st floor 2nd 3rd roof
Maximum span: 1st floor 2nd 3rd roof
If one story building with masonry walls, thickness of walls? height?

IF A GARAGE

No. cars now accommodated on same lot to be accommodated number commercial cars to be accommodated
Will automobile repairing be done other than minor repairs to cars habitually stored in the proposed building?

APPROVALS BY: DATE
BUILDING INSPECTION-PLAN EXAMINER
ZONING
BUILDING CODE:
Fire Dept.:
Health Dept.:
Others:

MISCELLANEOUS
Will work require disturbing of any tree on a public street?
Will there be in charge of the above work person competent to see that the State and City requirements pertaining thereto are observed?

Signature of Applicant Lars Huber Phone # same
Type Name of above

Other and Address

FIELD INSPECTOR'S COPY APPLICANT'S COPY OFFICE FILE COPY



001597

PERMIT ISSUED
NOV 4 1986
City Of Portland

FILL IN AND SIGN WITH INK

APPLICATION FOR PERMIT FOR
HEATING, COOKING OR POWER EQUIPMENT

Portland, Maine, November 3, 1986

To the INSPECTOR OF BUILDINGS, PORTLAND, ME.

The undersigned hereby applies for a permit to install the following heating, cooking or power equipment in accordance with the Laws of Maine, the Building Code of the City of Portland, and the following specifications:

Location Peaks Island B4-B-2 Use of Building Resident No. Stories 2 No. Building Existing Y
Name and address of owner of appliance Lara Hubor Same
Installer's name and address Charles DeRocher Upper A St., Peaks Island Telephone 756-2535

General Description of Work

To install Hot Water Heating System

IF HEATER, OR POWER BOILER

Location of appliance Any burnable material in floor surface or beneath?
If so, how protected? Kind of fuel?
Minimum distance to burnable material, from top of appliance or casing top of furnace
From top of smoke pipe From front of appliance From sides or back of appliance
Size of chimney flue Other connections to same flue
If gas fired, how vented? Rated maximum demand per hour
Will sufficient fresh air be supplied to the appliance to insure proper and safe combustion?

IF OIL BURNER

Name and type of burner Utica Labeled by underwriters' laboratories? Yes
Will operator be always in attendance? no Does oil supply line feed from top or bottom of tank? bottom
Type of floor beneath burner concrete slab Size of vent pipe 1 1/4 inch
Location of oil storage basement Number and capacity of tanks 1 275 Gallons
Low water shut off Yes Make Safeguard No.
Will all tanks be more than five feet from any flame? Yes How many tanks enclosed? one
Total capacity of any existing storage tanks for furnace burner n/a

IF COOKING APPLIANCE

Location of appliance Any burnable material in floor surface or beneath?
If so, how protected? Height of legs, if any
Skirting at bottom of appliance? Distance to combustible material from top of appliance?
From front of appliance From sides and back From top of smoke pipe
Size of chimney flue Other connections to same flue
Is hood to be provided? If so, how vented? Forced or gravity?
If gas fired, how vented? Rated maximum demand per hour

MISCELLANEOUS EQUIPMENT OR SPECIAL INFORMATION

Amount of fee enclosed 12.00 Estimated cost \$3800

INSPECTION FILE APPLICANT'S COPY ASSESSOR'S COPY

Will there be in charge of the above work a person who will see that the State and City requirements pertaining thereto are observed? Yes

Signature of Installer Charles DeRocher

34-B 2 PIER STREET PEAKS ISLAND



APPLICATION FOR PERMIT
DEPARTMENT OF BUILDING INSPECTIONS SERVICES
ELECTRICAL INSTALLATIONS

Date Oct. 25, 1982
 Receipt and Permit number A79836

To the CHIEF ELECTRICAL INSPECTOR, Portland, Maine:

The undersigned hereby applies for a permit to make electrical installations in accordance with the laws of Maine, the Portland Electrical Ordinance, the National Electrical Code and the following specifications:

LOCATION OF WORK: 84-B-2 Peaks Island - Murriner Street
 OWNER'S NAME: Lares Huber ADDRESS: same

OUTLETS:	Receptacles <u>X</u>	Switches _____	Plugmold _____	ft. TOTAL <u>1-30</u>	<u>3.00</u>	
FIXTURES. (number of)	In:andescent <u>X</u>	Flourescent _____	(not strip) TOTAL <u>1-10</u>		<u>3.00</u>	
	Strip Flourescent _____	ft.				<u>3.00</u>	
SERVICES:	Overhead <u>X</u>	Underground _____	Temporary _____	TOTAL amperes <u>200</u>	<u>3.00</u>	
METERS. (number of)							
MOTORS: (number of)							
	Fractional _____						
	1 HP or over _____						
RESIDENTIAL HEATING:	Oil or Gas (number of units) _____						
	Electric (number of rooms) <u>2</u>					<u>2.00</u>	
COMMERCIAL OR INDUSTRIAL HEATING:	Oil or Gas (by a main boiler) _____						
	Oil or Gas (by separate units) _____						
	Electric Under 20 kws _____	Over 20 kws _____					
APPLIANCES: (number of)	Ranges _____	Water Heaters _____					
	Cook Top ^s _____	Disposals _____					
	Wall C vents _____	Dishwashers _____					
	Dryers _____	Compactors _____					
	Fans _____	Others (denote) _____					
	TOTAL _____						
MISCELLANEOUS: (number of)	Branch Panels _____						
	Transformers _____						
	Air Conditioners Central Unit _____						
	Separate Units (windows) _____						
	Signs 20 sq. ft. and under _____						
	Over 20 sq. ft. _____						
	Swimming Pools Above Ground _____						
	In Ground _____						
	Fire/Burglar Alarms Residential _____						
	Commercial _____						
	Heavy Duty Outlets, 220 Volt (such as welders) 30 amps and under _____						
	over 30 amps _____						
	Circus, Fairs, etc. _____						
	Alterations to wires _____						
	Repairs after fire _____						
	Emergency Lights, battery _____						
	Emergency Generators _____						
	FOR ADDITIONAL WORK NOT ON ORIGINAL PERMIT INSTALLATION FEE DUE:						
	FOR REMOVAL OF A "STOP ORDER" (304-16.b) DOUBLE FEE DUE:						
	TOTAL AMOUNT DUE:					<u>11.00</u>	

INSPECTION: Will be ready on _____, 19__; or Will Call X
 CONTRACTOR'S NAME: James Cairns
 ADDRESS: 160 W. Pleasant St., Wstbrk.
 TEL.: 854-2047
 MASTER LICENSE NO.: 4227 SIGNATURE OF CONTRACTOR: _____
 LIMITED LICENSE NO.: _____

INSPECTOR'S COPY -- WHITE
 OFFICE COPY -- CANARY
 CONTRACTOR'S COPY -- GREEN

ELECTRICAL INSTALLATIONS -

Permit Number 79836

Location 84-B-2 Quarrist St, Pooko Island

Owner L. Haber

Rate of Permit 10-25-82

Final Inspection 7-26-83

By Inspector Libby

Permit Application Register Page No. 131

INSPECTIONS: Service ✓ by Libby
Service called in 10-27-82
Closing-in _____ by _____

PROGRESS INSPECTIONS: 7-26-83 / _____
_____ / _____
_____ / _____
_____ / _____
_____ / _____

CODE
COMPLIANCE
COMPLETED
DATE 7-26-83

DATE

REMARKS:

Robert A. Tind