

ECHO POINT

1950
ECHO POINT
1950

ECHO POINT - GREAT DIAMOND ISL.
827-A-4

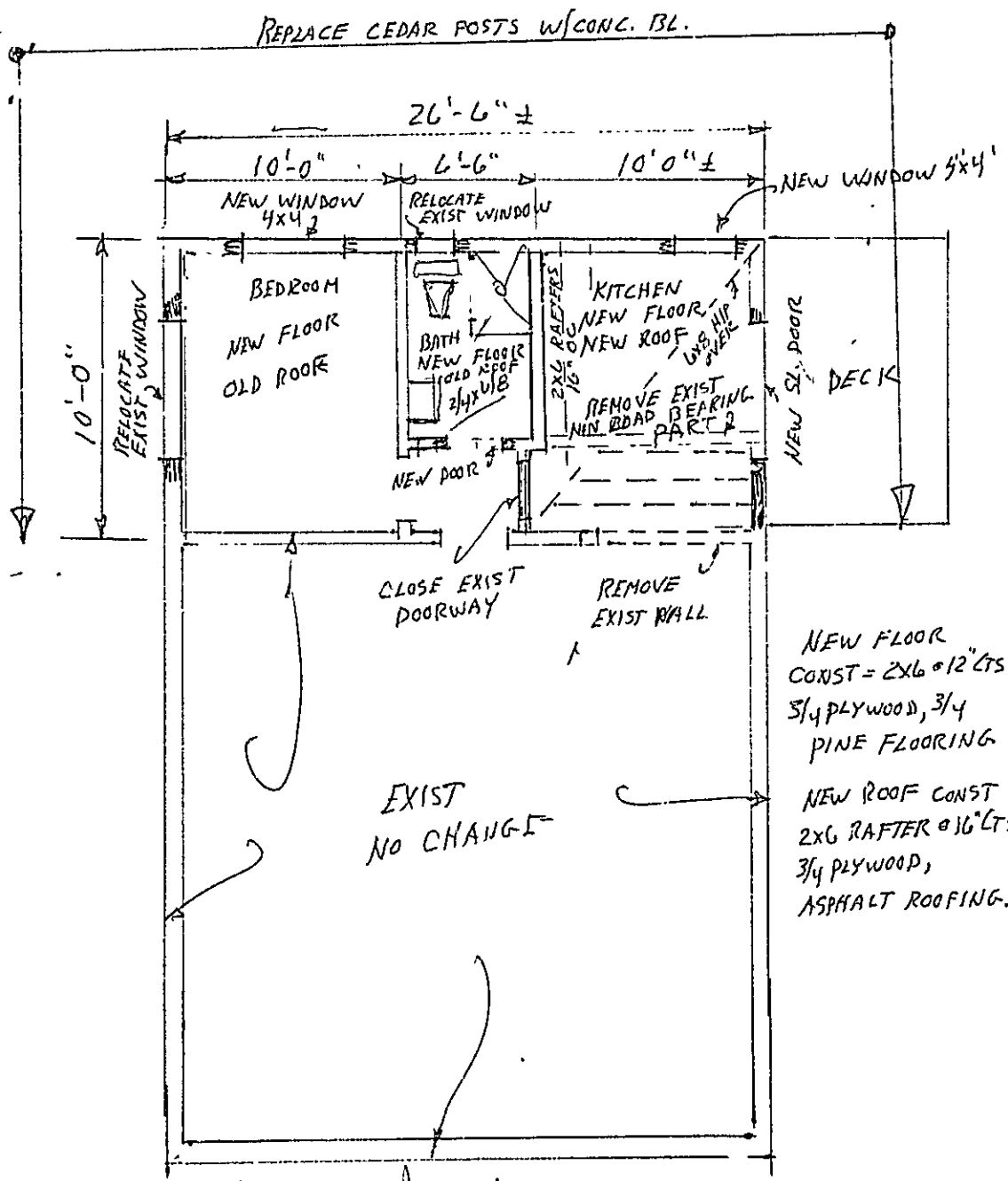

83-CA-4
 End City Point
 Great Diamond Del.

RECEIVED
 JUL - 8 1980
 DEPT. OF BLDG. INSP.
 CITY OF PORTLAND

APPLICATION FOR PERMIT TO INSTALL PLUMBING

NO. OF BUILDING _____ Apt. or Unit No. _____

Type of Building Residence ;one family ;multiple ;No. Families _____

Commercial use: (specify) _____

Owner of Building: _____

Owner's Address _____

New	Replac- ment	PROPOSED INSTALLATIONS	NO.
		Sinks	
		Lavatories	
		Toilets	
		Bath Tubs	
		Showers	
		Drains	
		Hot Water Tanks	
		Tankless Water Heaters	
		Garbage Grinders	
		Septic Tank	
		House Sewer	
		Other Fixtures:	

The above plumbing will be installed to meet requirements of the State Plumbing Code and Municipal Ordinances.

Permit Number: _____ Signed: _____

Issued: _____ Address _____

_____ Date _____

THIS IS NOT A PERMIT. No work to be started until permit is issued.

CS 314



APPLICATION FOR PERMIT

PERMIT ISSUED

B.O.C.A. USE GROUP 00 495

B.O.C.A. TYPE OF CONSTRUCTION

JUL 8 1980

ZONING LOCATION PORTLAND, MAINE, July 8, 1980

CITY of PORTLAND

To the DIRECTOR OF BUILDING & INSPECTION SERVICES, PORTLAND, MAINE

The undersigned hereby applies for a permit to erect, alter, repair, demolish, move or install the following building, structure, equipment or change use in accordance with the Laws of the State of Maine, the Portland B.O.C.A. Building Code and Zoning Ordinance of the City of Portland with plans and specifications, if any, submitted herewith and the following specifications:

LOCATION 83-C-A-4 End Echo Point, Great Diamond Island Fire District #1 [], #2 []
1. Owner's name and address Earle D. Reed, 1183 Shore Road, Cape Telephone 799-0668...
2. Lessee's name and address Eliz Telephone
3. Contractor's name and address 04107 Telephone
4. Architect Specifications Plans No. of sheets
Proposed use of building summer cottage No. families
Last use same No. families
Material No. stories Heat Style of roof Roofing
Other buildings on same lot
Estimated contractual cost \$ 2,000 Fee \$ 10.00

FIELD INSPECTOR—Mr.

GENERAL DESCRIPTION

This application is for: @ 775-5451
Dwelling Ext. 234
Garage
Masonry Bldg.
Metal Bldg.
Alterations
Demolitions
Change of Use
Other

To make alterations and repairs to dwelling as per plans. 1 sheet of plans.

Stamp of Special Conditions

NOTE TO APPLICANT: Separate permits are required by the installers and subcontractors of heating, plumbing, electrical and mechanicals.

PERMIT IS TO BE ISSUED TO box 2 [] 3 [] 4 []
Other:

DETAILS OF NEW WORK

Is any plumbing involved in this work? Is any electrical work involved in this work?
Is connection to be made to public sewer? If not, what is proposed for sewage?
Has septic tank notice been sent? Form notice sent?
Height average grade to top of plate Height average grade to highest point of roof
Size, front depth No. stories solid or filled land? earth or rock?
Material of foundation Thickness, top bottom cellar
Kind of roof Rise per foot Roof covering
No. of chimneys Material of chimneys of lining Kind of heat fuel
Framing Lumber—Kind Dressed or full size? Corner posts Sills
Size Girder Columns under girders Size Max. on centers
Studs (outside walls and carrying partitions) 2x4-16" O. C. Bridging in every floor and flat roof span over 8 feet.
Joists and rafters: 1st floor 2nd 3rd roof
On centers: 1st floor 2nd 3rd roof
Maximum span: 1st floor 2nd 3rd roof
If one story building with masonry wall thickness of walls? height?

IF A GARAGE

No. cars now accommodated on same lot, to be accommodated number commercial cars to be accommodated
Will automobile repairing be done other than minor repairs to cars habitually stored in the proposed building?

APPROVALS BY: DATE
BUILDING INSPECTION—PLAN EXAMINER
ZONING:
BUILDING CODE:
Fire Dept.:
Health Dept.:
Others:

MISCELLANEOUS
Will work require disturbing of any tree on a public street?
Will there be in charge of the above work a person competent to see that the State and City requirements pertaining thereto are observed?

Signature of Applicant Earle D. Reed Phone # same
Type Name of above Earle D. Reed 1 [] 2 [] 3 [] 4 []
Other and Address

FIELD INSPECTOR'S COPY

NOTES

8-3-83 Complete *aa*
when permit received

Permit No. 80/493

Location 83-14-V Road

Owner

Land Grid

Date of permit

9-6-86

Approved

9-9-80

Alfred Remond 1911

CITY OF PORTLAND, MAINE

Application for Permit to Install Wires

Permit No. 308
 Issued 5/3/77
5/3 .. 1977

Portland, Maine

07 B3CA-12
 B3CA-4
 4/27/77
 18

To the City Electrician, Portland, Maine:

The undersigned hereby applies for a permit to install wires for the purpose of conducting electric current, in accordance with the laws of Maine, the Electrical Ordinance of the City of Portland, and the following specifications:

(This form must be completely filled out - Minimum Fee, \$1.00)

Owner's Name and Address Earle Reed Tel. 799-2287
 Contractor's Name and Address Oliver P. Lubke Tel. 799-2587
 Location Great Diamond Island Use of Building store
 Number of Families 1 Apartments Stores Number of Stories
 Description of Wiring: New Work Additions Alterations

Pipe Cable Metal Molding BX Cable Plug Molding (No. of feet)
 No. Light Outlets Plugs Light Circuits Plug Circuits

FIXTURES: No. Fluor. or Strip Lighting (No. feet)
 SERVICE: Pipe Cable Underground No. of Wires 3 Size 2/2-1/5
 METERS: Relocated 100A Added Total No. Meters

MOTORS: Number Phase H. P. Amps Volts Starter
 HEATING UNITS: Domestic (Oil) No. Motors Phase H.P.
 Commercial (Oil) No. Motors Phase H.P.
 Electric Heat (No. of Rooms)

APPLIANCES: No. Ranges Watts Brand Feeds (Size and No.)
 Elec. Heaters Watts Extra Cabinets or Panels
 Miscellaneous Watts

Transformers Air Conditioners (No. Units) Sign (No. Units)
 Will commence 19 77 Ready to cover in 5/4 1977
 Amount of fee \$ Signed Oliver P. Lubke #9995

DO NOT WRITE BELOW THIS LINE

SERVICE	METER	GROUND
VISITS: 1	2	3
7	8	9
	10	11
		12

REMARKS:

DONE

INSPECTED BY Herbert (OVER)



GENERAL RESIDENCE ZONE PERMIT IS
APPLICATION FOR PERMIT Permit No. 162

Class of Building or Type of Structure Third Class Oct 7 1932

To the INSPECTOR OF BUILDINGS, PORTLAND, ME.

Portland, Maine, October 7, 1932.

The undersigned hereby applies for a permit to erect alter install the following building structure equipment in accordance with the Laws of the State of Maine, the Building Code of the City of Portland, plans and specifications, if any, submitted herewith and the following specifications:

Location Bay Avenue, Crest Diamond Island Ward _____ Within Fire Limits? No Dist. No. _____
 Owner's or Lessee's name and address Joseph Whitney, 22 Clifford Street Telephone _____
 Contractor's name and address J. E. Kennedy, 98 Fiske Street Telephone F 7100
 Architect's name and address _____
 Proposed use of building Cottage No. families 1
 Other buildings on same lot Storage Shed
 Plans filed as part of this application? _____ No. of sheets _____
 Estimated cost \$ 1800 Fee \$ 1.00

Description of Present Building to be Altered

Material Wood No. stories 2 Heat _____ Style of roof Pitch Roofing Asphalt shingles
 Last use Cottage No. families _____

General Description of New Work

To enclose and build roof over existing side platform about 8' x 8' to include this space in living room by removing outside wall of cottage. 4 x 8 header supporting 2nd story wall on 8' span. To extend existing dormer window on side of building about 5' to make window for bathroom. To erect 10' dormer on other side of roof to make sleeping porch. To enclose portion of first story porch about 4 x 6 to make toilet room, porch existing with roof over previous to Dec. 8, 1926. At least 15' to lot line from portion of platform to be enclosed.

It is understood that this permit does not include installation of heating apparatus which is to be taken care of by the heating contractor. CERTIFICATE OF OCCUPANCY REQUIREMENT IS WAIVED, name of _____

Details of New Work

Size, front _____ depth _____ No. stories _____ Height average grade to top of place _____
 To be erected on solid or filled land? _____ Height average grade to highest point of roof _____
 Material of foundation _____ Thickness, top _____ earth or rock? _____ bottom _____
 Material of underpinning _____ Add. _____ Height _____ Thickness _____
 Kind of Roof Shed Shed Rise per foot 6" 8" Roof covering Asphalt roofing Clg "C"
 No. of chimneys _____ Material of chimneys _____ of lining _____
 Kind of heat _____ Type of fuel _____ Is gas fitting involved? _____
 Corner posts _____ Sills _____ Girt or ledger board? _____ Size _____
 Material columns under girders _____ Size _____ Max. on centers _____
 Studs (outside walls and carrying partitions) 2x4-16" O. C. Girders 6x8 or larger. Bridging in every floor and flat roof span over 8 feet. Sills and corner posts all one piece in cross section.
 Joists and rafters: 1st floor _____, 2nd _____, 3rd _____, roof 2 x 4 2 x 6
 On centers: 1st floor _____, 2nd _____, 3rd _____, roof 20" 20"
 Maximum span: 1st floor _____, 2nd _____, 3rd _____, roof 8' 7'
 If one story building with masonry walls, thickness of walls? _____ height? _____
 If a Garage _____
 No. cars now accommodated on same lot _____ to be accommodated _____
 Total number commercial cars to be accommodated _____
 Will automobile repairing be done other than minor repairs to cars habitually stored in the proposed building? _____

Miscellaneous

Will above work require removal or disturbing of any shade tree on a public street? _____
 Will there be in charge of the above work a person competent to see that the State and City requirements pertaining thereto are observed? Yes

Signature of owner _____

By Joseph Whitney

J. E. Kennedy

INSPECTION COPY.

8530A

9 of 9
Ward 2 Permit No. 32/1654
Location Echo Point Pt. Diamond
Owner Joseph Whitney
Date of permit 10/7/32

Notif. closing-in _____
Inspn. closing-in 83
Final Notif. A
Final Inspn. 11/9/32 4
Cert. of Occupancy issued None

NOTES

83 - ch. 1A

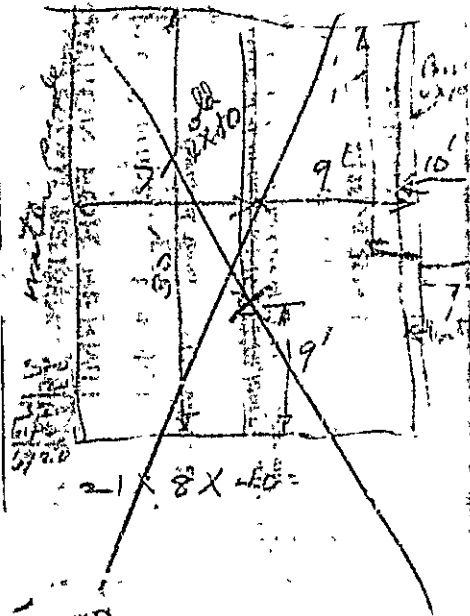

SOED

Pottage



Storage Shed

9 ft

21 ft

Approximate lot line
being sea wall

14 ft



GENERAL RESIDENCE ZONE
APPLICATION FOR PERMIT

PERMIT ISSUED
Permit No. 1653
7 1932

Class of Building or Type of Structure Third Class

Portland, Maine, October 7, 1932

To the INSPECTOR OF BUILDINGS, PORTLAND, ME.

The undersigned hereby applies for a permit to erect alter install the following building structure equipment in accordance with the Laws of the State of Maine, the Building Code of the City of Portland, plans and specifications, if any, submitted herewith and the following specification Island

Location Bay Point, Great Diamond Island Ward 2 Within Fire Limits? NO Dist. No. _____

Owner's or Lessee's name and address Jose Whitney, 25 Gifford Street Telephone _____

Contractor's name and address J. H. Kennedy, 98 Preble St. Telephone 7104

Architect's name and address _____

Proposed use of building Storage shed, tools, etc. (private) No. families _____

Other buildings on same lot _____

Plans filed as part of this application? yes No of sheets 1

Estimated cost \$ 150. Fee \$.75

Description of Present Building to be Altered

Material wood No. stories 1 Heat _____ Style of roof pitch Roofing W.

Last use Storage shed, tools, etc. No. families _____

General Description of New Work

To complete existing one story frame shed app 10' x 10'
To retaild shed, one story 8' x 11'

CERTIFICATE OF OCCUPANCY
REQUIREMENT IS WAIVED.
NOTIFICATION BEFORE LA
OR CLOSING-IN IS WAIN.

It is understood that this permit does not include installation of heating apparatus which is to be taken out separately and the name of the heating contractor.

Details of New Work

Size, front 8' depth 11' No. stories 1 Height average grade to top of plate _____

To be erected on solid or well land? solid Height average grade to highest point of roof 12'

Material of foundation concrete posts earth or rock? rock not over 20'

Material of underpinning _____ Thickness, top _____ bottom _____

Material of underpinning _____ Height _____ Thickness _____

Kind of Roof pitch Rise per foot 0" Kind of covering Asphalt shingles Class C Ind. Lab.

No. of chimneys no Material of chimneys _____ of lining _____

Kind of heat no Type of fuel _____ Is gas fitting involved? _____

Corner posts 4x4 Sills 4x8 Girt or ledger board? _____ Size _____

Material columns under girders _____ Size _____ Max. on centers _____

Studs (outside walls and carrying partitions) 2x4-16" O. C. Girders 6x8 or larger. Bridging in every floor and flat roof

span over 8 feet. Sills and corner posts one piece in cross section

Joists and rafters: 1st floor 2x8 2nd _____ 3rd _____ roof 2x4

On centers: 1st floor 16" 2nd _____ 3rd _____ roof 8'

Maximum span: 1st floor 8' 2nd _____ 3rd _____ roof _____

If one story building with masonry walls, thickness of walls? _____ height? _____

If a Garage

cars now accommodated on same lot _____ to be accommodated _____

number commercial cars to be accommodated _____

automobile repairing be done other than minor repairs to cars habitually stored in the proposed building? _____

Miscellaneous

Will above work require removal or disturbing of any shade tree on a public street? no

Will there be in charge of the above work a person competent to see that the State and City requirements pertaining thereto

be observed? yes

Signature of owner Joseph Whitney

INSPECTION COPY

Permit No. 32/1653

Location John Point, A. Denmark

Owner Joseph Whitney

Date of permit 10/17/32

Notif. Closing-in _____

Int. _____

Final Notif. _____

Final Insyn. 10/17/32

Cert. of Occupancy issued. None

NOTES

830
4
4

