

- CRESCENT AVE. - GREAT DIAMOND ISL
83A-E-12

ford
No. 753½
U.S.A.

Recd.

Date Issued **June 28, 1974**
Portland Plumbing Inspector

By ~~HOFFSES, P.~~
HOFFSES, P.

Date **9-21-74**
By *[Signature]*

App. Final Insp.

- Type of Bldg.
- Commercial
 - Residential
 - Single
 - Multi Family
 - New Construction
 - Remodeling

PERMIT TO INSTALL PLUMBING
03A-E-12 Crescent Ave.

PERMIT NUMBER **3735**

Address **Grt. Diamond Is.**

Installation For **1 fm**

Owner of Bldg **Miss Eunice Baker**

Owner's Address **same**

Date **6-28-74**

Plumber: **Emil Iverson**

NEW REPL **Scarboro, Me.**

NEW	REPL		NO	FEE
		SINKS		
		LAVATORIES		
		TOILETS		
		BATH TUBS		
		SHOWERS		
		DRAINS FLOOR SURFACE		
		HOT WATER TANKS		
		TANKLESS WATER HEATERS		
		GARBAGE DISPOS LS		
		SEPTIC TANKS	1	2.00
		HOUSE SEWERS		
		ROOF LEADERS		
		AUTOMATIC WASHERS		
		DISHWASHERS		
		OTHER		
		Base Fee		3.00
		TOTAL	1	5.00

Building and Inspection Services Dept.: Plumbing Inspection.

83 A-E-12 CRESCENT AVENUE, GREAT DIAMOND ISLAND

1

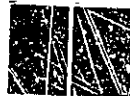



APPLICATION FOR PERMIT
DEPARTMENT OF BUILDING INSPECTIONS SERVICES
ELECTRICAL INSTALLATIONS

Date Oct. 2, 19 81
 Receipt and Permit number A-73225

To the CHIEF ELECTRICAL INSPECTOR, Portland, Maine:

The undersigned hereby applies for a permit to make electrical installations in accordance with the laws of Maine, the Portland Electrical Ordinance, the National Electrical Code and the following specifications:

LOCATION OF WORK: 83-A-E 12 Crescent Ave. Great Diamond
 OWNER'S NAME: Margery Foster & Helen Davis ADDRESS: same

OUTLETS:	FEES
Receptacles _____ Switches _____ Plugmold _____ ft. TOTAL _____	
FIXTURES: (number of)	
Incandescent _____ Fluorescent _____ (not strip) TOTAL _____	
Strip Fluorescent _____ ft. _____	
SERVICES:	
Overhead <u>xx</u> Underground _____ Temporary _____ TOTAL amperes <u>200</u>	3.00
METERS: (number of) <u>1</u>	.50
MOTORS: (number of)	
Fractional _____	
1 HP or over _____	
RESIDENTIAL HEATING:	
Oil or Gas (number of units) _____	
Electric (number of rooms) _____	
COMMERCIAL OR INDUSTRIAL HEATING:	
Oil or Gas (by a main boiler) _____	
Oil or Gas (by separate units) _____	
Electric Under 20 kws _____ Over 20 kws _____	
APPLIANCES: (number of)	
Ranges _____	Water Heaters _____
Cook Tops _____	Disposals _____
Wall Ovens _____	Dishwashers _____
Dryers _____	Compactors _____
Fans _____	Others (denote) _____
TOTAL _____	
MISCELLANEOUS: (number of)	
Branch Panels _____	
Transformers _____	
Air Conditioners Central Unit _____	
Separate Units (windows) _____	
Signs 20 sq. ft. and under _____	
Over 20 sq. ft. _____	
Swimming Pools Above Ground _____	
In Ground _____	
Fire/Burglar Alarms Residential _____	
Commercial _____	
Heavy Duty Outlets, 220 Volt (such as welders) 30 amps and under _____	
over 30 amps _____	
Circus, Fairs, etc. _____	
Alterations to wires _____	
Repairs after fire _____	
Emergency Lights, battery _____	
Emergency Generators _____	

FOR ADDITIONAL WORK NOT ON ORIGINAL PERMIT	INSTALLATION FEE DUF:
FOR REMOVAL OF A "STOP ORDER" (304-16 b)	DOUBLE FEE DUE:
	TOTAL AMOUNT DUE: <u>3.50</u>

This is an exception to rules because of unusual circumstances

INSPECTION: Will be ready on ready, 19 81; or Will Call _____

CONTRACTOR'S NAME: Owners

ADDRESS: same

TEL.: 766-2426

MASTER LICENSE NO.: _____ SIGNATURE OF CONTRACTOR: M Foster

LIMITED LICENSE NO.: _____

INSPECTOR'S COPY — WHITE
 OFFICE COPY — CANARY
 CONTRACTOR'S COPY — GREEN

R & H

ELECTRICAL INSTALLATIONS—

Permit Number 73225

Location B3-A-E-12 Precast for Great Diamond and Steel

Owner Am. Photo

Date of Permit 10-2-81

Final Inspection _____

By Inspector _____

Permit Application Register Page No. 100

INSPECTIONS: Service _____ by _____

Service called in _____

Closing-in _____ by _____

PROGRESS INSPECTIONS: _____ / _____ / _____

CODE
COMPLIANCE
COMPLETED
DATE 10/2/81

DATE:

REMARKS:

Five cart and 2 white houses and
1 Red house
turn left
pass assoc. house
to wooden board walk.

5-1-82 Done by H. Pappice this date.

Great Diamond

913247

Permit # _____ City of Portland BUILDING PERMIT APPLICATION Fee _____ Zone _____ Map # _____ Lot# _____

Please fill out any part which applies to job. Proper plans must accompany form.

Owner: Marjorie Foster Phone # _____
 Address: Croissant Ave. Helen Davis Great Grandchild
 LOCATION OF CONSTRUCTION _____
 Contractor: Steve Berube Sub: _____ Lots 12, 14
 Address: _____ Phone # _____
 Est. Construction Cost: 2300 Proposed Use: 1-fam unshed
 Past use: 1-fam
 # of Existing Res. Units _____ # of New Res. Units _____
 Building Dimensions: L _____ W _____ Total Sq. Ft. _____
 # Stories: _____ # Bedrooms _____ Lot Size: _____
 Is Proposed Use: Seasonal _____ Cor. to aluminum _____ Conversion _____
 Explain Conversion: Construct shed - 10' x 12'
83A-E-4, 12

For Official Use Only

Date: 11/29/91 Submittal # _____
 Inside Fire Limit _____
 Block Code _____
 Estimated Cost: _____
 City of Portland Public
PERMIT ISSUED
NOV 25 1991
CITY OF PORTLAND

Foundation:

- Type of Soil: _____
- Set Backs: Front _____ Rear _____ Side(s) _____
- Footings Size: _____
- Foundation Size: _____
- Other: _____

Floor:

- Sills Size: _____ Sills must be anchored
- Girder Size: _____
- Lally Column Spacing: _____ Size: _____
- Joists Size: _____ Spacing 16" O.C.
- Bridging Type: _____ Size: _____
- Floor Sheathing Type: _____ Size: _____
- Other Material: _____

Exterior Walls:

- Studding Size _____ Spacing _____
- No. windows _____
- No. Doors _____
- Header Sizes _____ Span(s) _____
- Bracing: Yes _____ No _____
- Corner Post Size _____
- Insulation Type _____ Size _____
- Sheathing Type _____ Size _____
- Siding Type _____ Weather Exposure _____
- Minor Materials _____
- Metal Materials _____

Interior Walls:

- Studding Size _____ Spacing _____
- Header Sizes _____ Span(s) _____
- Wall Covering Type _____
- Fire Wall if required _____
- Other Materials _____

Ceiling:

- Ceiling Joists Size: _____ Spacing _____
- Ceiling Strapping Size _____ Spacing _____
- Type Ceilings: _____
- Insulation Type _____ Size _____
- Ceiling Height: _____

Roof:

- Truss or Rafter Size _____ Span _____
- Sheathing Type _____ Size _____
- Roof Covering Type _____

Chimneys:

Type: _____ Number of Fire Places _____

Heating:

Type of Heat: _____

Electrical:

Service Entrance Size: _____ Breaker/Generator Required Yes _____ No _____

Plumbing:

- Approval of soil test if required Yes _____ No _____
- No. of Tubs or Showers _____
- No. of Flushes _____
- No. of Lavatories _____
- No. of Other Fixtures _____

Swimming Pools:

- Type: _____
- Pool Size: _____ x _____ Square Footage _____
- Must conform to National Electrical Code and State Law

Permit Received By Louise E. G. se

Signature of Applicant William E. Weber Date _____

CEO's Designation William E. Weber

CONTINUED TO REVERSE SIDE

White Tax Assessor

Ivory Tag - CEO

16 MA. ROWE

PERMIT ISSUED WITH REQUIREMENTS

PERMIT ISSUED WITH REQUIREMENTS

PLOT PLAN

N



FEES (Breakdown From Front)

Base Fee \$ _____
 Subdivision Fee \$ _____
 Site Plan Review Fee \$ _____
 Other Fees \$ _____
 (If plain) _____
 Lab. Fee \$ _____

Type

Inspection Record

Date

Type	Inspection Record	Date
OK		

OK
6/30/91

COMMENTS

CERTIFICATION

I hereby certify that I am the owner of record of the named property, or that the proposed work is authorized by the owner of record and that I have been authorized by the owner to make this application as his authorized agent and I agree to conform to all applicable laws of this jurisdiction. In addition, if a permit for work described in this application is issued, I certify that the code official or the code official's authorized representative shall have the authority to enter areas covered by such permit at any reasonable hour to enforce the provisions of the code(s) applicable to such permit.

William J. White
 SIGNATURE OF APPLICANT

C/DI
 ADDRESS

760-5061
 PHONE NO.

RESPONSIBLE PERSON IN CHARGE OF WORK, TITLE

PHONE NO.

BUILDING PERMIT REPORT

E

ADDRESS: Crescent Ave Great Diamond Is DATE: 22/Nov/91

REASON FOR PERMIT: To Construct a 10x12' Const.
Shed

BUILDING OWNER: Foster - Davis

CONTRACTOR: Steven Berube

PERMIT APPLICANT: " " "

APPROVED: *1*2

CONDITION OF APPROVAL:

- ~~1.)~~ Before concrete for foundation is placed, approvals from Public Works and Inspection Services must be obtained.
- 2.) Precaution must be taken to protect concrete from freezing.
- 3.) All vertical openings shall be enclosed with construction having a fire rating of at least one(1) hour, including fire doors with self-closers.
- 4.) Each apartment shall have access to two(2) separate, remote and approved means of egress. A single exit is acceptable when it exits directly from the apartment to the building exterior with no communications to other apartment units.
- 5.) The boiler shall be protected by enclosing with one(1) hour fire rated construction including fire doors and ceiling, or by providing automatic extinguishment. Sprinkler piping serving not more than six sprinklers may be connected to a domestic water supply system having a capacity sufficient to provide 0.15 gallons per minute, per square foot of floor throughout the entire area. An INDICATING shut-off valve shall be installed in an accessible location between the sprinkler and the connection to the domestic water supply. Minimum pipe size shall be 3/4 inch copper or 1 inch steel. Maximum coverage area of a residential sprinkler is 144 square feet per sprinkler.
- 6.) Every sleeping room below the fourth story in buildings of Use Groups R and I-1 shall have at least one operable window or exterior door approved for emergency egress or rescue. The units must be operable from the inside opening without the use of separate tools. Where windows are provided as a means of egress or rescue, they shall have a sill height not more than 44 inches (1118 mm) above the floor. All egress or rescue windows from sleeping rooms must have minimum net clear openings of 5.7 square feet (0.53m²). The minimum net clear opening height dimension shall be 24 inches (610 mm). The minimum net clear opening width dimension shall be 20 inches (508 mm).
- 7.) All single and multiple-station smoke detectors shall be of an approved type and shall be installed in accordance with the provisions of the building code (BOCA National Building Code 1990, and N.F.P.A. 74).

Great Diamond Is.
Specimen (F)
lat. 10° 15' N
70' from High Water
(no longer in use)



222
Darker

Johnston/
residence
man/day

RECEIVED
NOV 20 1931
OFFICE OF BUILDING
CITY OF PORTLAND

1120000 - Great Dining Island.

116' of center of ends

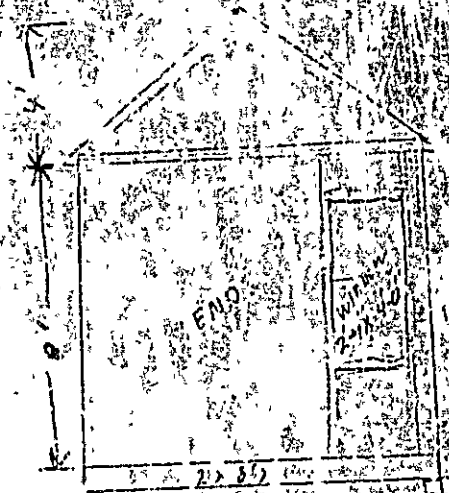
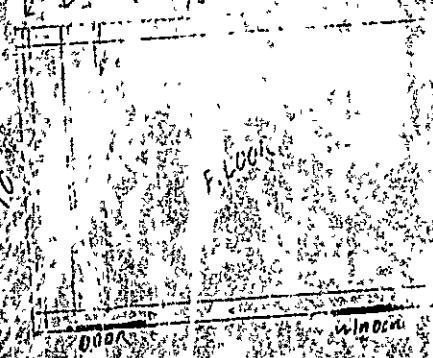

4x6 Headers FOR
DOORS & WINDOWS
SHEATHING - 6' x 6'
SHOULDER
ROOF T16 12' @ Asphalt shingles

FLAT ROOF
LEVEL