

Coroga Minaboard and Fire Guard Lay-in Ceilings

ARCHITECTURAL CEILINGS FROM ARMSTRONG

Armstrong
CEILING
SYSTEMS

ARMSTRONG WORLD INDUSTRIES, INC.
LANCASTER, PA. 17604



Underwriters Laboratories Inc.®
CLASSIFIED

R3407-TYPE XLD

ACOUSTICAL MATERIAL
CONTENTS NOT OVER 100 SQ. FT. (FORM B) Issue No. BP-5824
SURFACE BURNING CHARACTERISTICS*



FLAME SPREAD 25
SMOKE DEVELOPED 10

*ALSO CLASSIFIED AS TO SURFACE BURNING CHARACTERISTICS IN
ACCORDANCE WITH THE STANDARD CANULC-S102M

LAS910 PL Rev. 0594

Printed in United States of America

Cozy Harbor

MISO

MAN-MADE MINERAL FIBER CEILING PANELS
THIS PRODUCT CONTAINS FIBERS AND FORMALDEHYDE. POSSIBLE CANCER AND RESPIRATORY TRACT HAZARDS CAN CAUSE TEMPORARY RESPIRATORY, SKIN AND EYE IRRITATION.

Precautionary Measures Install in well-ventilated areas and avoid breathing dust. If high dust level are anticipated during installation such as with the use of power tools, use appropriate NIOSH designated dust respirator. All power cutting tools must be equipped with dust collectors. Avoid contact with skin or eyes. Wear long-sleeve, loose fitting clothing, gloves and eye protection.

First Aid Measures If contact occurs flush eyes and skin irritation with plenty of water for at least 15 minutes and remove contaminated clothing. After installing material, wash with warm water and mild soap. Wash work clothes separately from other clothing. Rinse sweater thoroughly.

Refer to Armstrong MSDS (which includes information on established occupational exposure limits) which are available from Armstrong or your employer.

Made in the United States by Armstrong World Industries, Inc., Lancaster, Pennsylvania 17604.

CEILING PANELS MADE OF ARTIFICIAL MINERAL FIBERS
CE PRODUIT CONTIENE FIBRES MINÉRALES SYNTHÉTIQUES ET DU FORMALDÉHYDE. IL PEUT PRÉSENTER DES RISQUES DE CANCER ET DES RISQUES POUR LES VOIES RESPIRATOIRES. IL PEUT PROVOQUER DE IRRITATIONS TEMPORAIRES DE LA PEAU, DES YEUX OU DES VOIES RESPIRATOIRES.

Précautions de prévention Installer en s'assurant que le site est bien ventilé et éviter de respirer la poussière. Si l'on prévoit pénétrer une grande quantité de poussières, comme lors de l'utilisation d'outils électriques, il faut porter l'appareil respiratoire (approuvé par la NIOSH) approprié. Tous les outils électriques de coupe doivent être munis de dépoussiéurs. Éviter le contact avec la peau ou les yeux. Porter des vêtements amples, confortables et à manches longues, des gants et une protection oculaire adéquate.

Premiers soins En cas de contact avec les yeux ou la peau, rincer à grande eau pendant au moins 15 minutes et retirer les vêtements contaminés. Se laver les mains avec de l'eau chaude et un savon doux après avoir installé du matériel. Laver des vêtements de travail séparément des autres. Bien rincer la lessive.

Prise de se référer à la Fiche signalétique de Armstrong (cette fiche des informations sur les limites d'exposition au travail) disponible chez Armstrong ou auprès de votre employeur.

Fait aux États-Unis d'Amérique par Les Industries Mondiales Armstrong Inc., Lancaster, Pennsylvanie 17604.

PANELES PARA CIelos RASOS DE LANA MINERAL ARTIFICIAL
ESTE PRODUCTO CONTIENE FIBRAS MINERALES ARTIFICIALES Y FORMALDEHIDO. PUEDE PROVOCAR CANCER Y PRESENTAR RIESGOS PARA EL SISTEMA RESPIRATORIO; PUEDE PROVOCAR IRRITACION TEMPORARIA DEL SISTEMA RESPIRATORIO, LA PIEL Y LOS OJOS.

Medidas de precaucion Instalar en zonas bien ventiladas y evitar respirar el polvo. Si se prevé que durante la instalacion se generaran altas concentraciones de polvo, tales como con el uso de herramientas electricas, utilice respiradores de polvo apropiados aprobados por NIOSH. Todos las herramientas electricas de corte del en estar equipadas con recolectoras de polvo. Evite el contacto con la piel y los ojos. Utilice vestimenta cómoda, con mangas y largas, guantes y protección de los ojos. Medidas de primeros auxilios Si se produce un contacto con el material, enjuague los ojos y la piel irritada con el agua durante por lo menos 15 minutos, y quite la vestimenta contaminada. Después de instalar el material, lávese con agua tibia y jabón suave. Lave la vestimenta de trabajo separada de otra vestimenta. Enjuague el lavavestidos minuciosamente. Consulte las MSDS-pláticas de datos de seguridad de los materiales de Armstrong, (que incluyen información relacionada con los límites de exposición laboral establecidos) y están disponibles a través de Armstrong o de su empleador.

Fabricados en los Estados Unidos por Armstrong World Industries, Inc., Lancaster, Pennsylvania 17604.

Do not wear or install under conditions where relative humidity exceeds 70%. (Except R190 and R1100). No porter el poseer le produit aux endroits où l'humidité relative dépasse 70%. (Except R190 and R1100).
Class A per ASTM E 1264. Clase A selon la et ASTM E 1264. Clase A por la ASTM E 1264.

LA-25647-7957

City of Portland, Maine - Building or Use Permit Application 389 Congress Street, 04101, Tel: (207) 874-8703, FAX: 874-8716

Location of Construction: 75 St John St		Owner: WRDK Int Liability Co.	Phone:	Permit No: 60594
Owner Address:	Lessee/Buyer's Name: Cozy Harbor Seafood	Address:	Phone:	Business Name:
Contractor Name: Eastern Security Systems	Address: 665 Congress St Portland, ME	Phone: 04102	772-1171	
Past Use: Cozy/Seafood	Proposed Use: Same	COST OF WORK: \$ 500	PERMIT FEE: \$ 25.00	
Proposed Project Description: Hook-up Transmitter to Relay		FIRE DEPT. <input checked="" type="checkbox"/> Approved <input type="checkbox"/> Denied	INSPECTION: Use Group: Type:	
		Signature: <i>[Signature]</i>	Signature: <i>[Signature]</i>	
		PEDESTRIAN ACTIVITIES DISTRICT (P.A.D.) Action: <input type="checkbox"/> Approved <input type="checkbox"/> Approved with Conditions <input type="checkbox"/> Denied	Zoning Approval: OK 5/24/96 Special Zone or Reviews: <input type="checkbox"/> Shoreland <input type="checkbox"/> Wetland <input type="checkbox"/> Flood Zone <input type="checkbox"/> Subdivision <input type="checkbox"/> Site Plan <input type="checkbox"/> major <input type="checkbox"/> minor <input type="checkbox"/> mm <input type="checkbox"/>	
Permit Taken By: Mary Gresik	Date Applied For: 21 June 1996	Zone: CBL: 070-B-001		

PERMIT ISSUED

JUN 25 1996

CITY OF PORTLAND

- This permit application doesn't preclude the Applicant(s) from meeting applicable State and Federal rules.
- Building permits do not include plumbing, septic or electrical work.
- Building permits are void if work is not started within six (6) months of the date of issuance. False information may invalidate a building permit and stop all work.

- Zoning Appeal**
- Variance
 - Miscellaneous
 - Conditional Use
 - Interpretation
 - Approved
 - Denied
- Historic Preservation**
- Not in District or Landmark
 - Does Not Require Review
 - Requires Review

CERTIFICATION

I hereby certify that I am the owner of record of the named property, or that the proposed work is authorized by the owner of record and that I have been authorized by the owner to make this application as his authorized agent and I agree to conform to all applicable laws of this jurisdiction. In addition, if a permit for work described in the application issued, I certify that the code official's authorized representative shall have the authority to enter all areas covered by such permit at any reasonable hour to enforce the provisions of the code(s) applicable to such permit

 SIGNATURE OF APPLICANT **Ron Jespersen** ADDRESS: _____ DATE: **21 June 1996** PHONE: _____

RESPONSIBLE PERSON IN CHARGE OF WORK, TITLE _____ PHONE: _____

White-Permit Desk Green-Assessor's Canary-D.P.W. Pink-Public File Ivory Card-Inspector

Action:
 Approved
 Approved with Conditions
 Denied

Date: 6/21/96

[Signature]

CEO DISTRICT **3**

COMMENTS

See Attached Photos - Job Log

	Type	Inspection Record	Date
Foundation:	_____	_____	_____
Framing:	_____	_____	_____
Plumbing:	_____	_____	_____
Final:	_____	_____	_____
Other:	_____	_____	_____

Cozy Harbor
75 St John St

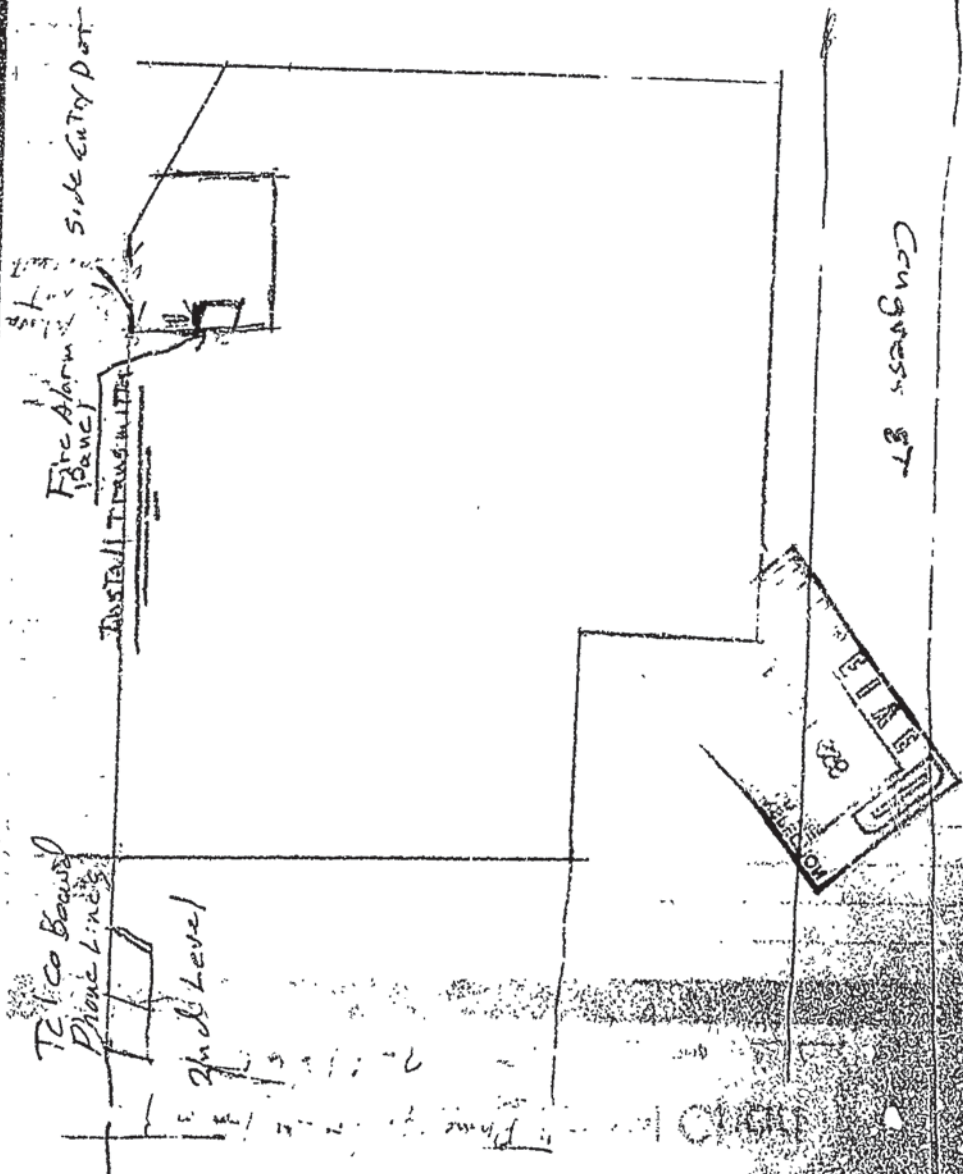

Cozy Harbor Seafood Facsimile Transmission

total pages sent 14

To: Mr. SIMPSON
FROM: Building Inspection
Tel: 74-8716

John Simpson - Cozy Harbor Seafood

TELEPHONE: 4-6595

FAX NUMBER: 89-1560

Mr. Simpson are the test results
you requested. If you have any
questions or comments please call.

(If you receive this fax in error, please contact sender.)



Cozy Harbor Seafood, Inc.
P.O. Box 389, Portland, ME 04112, (207) 667-6595

8748716 P.01

TO

06-20-1996 03:55AM FROM COZY-HARBOR

8748716 P.02

TO

06-20-1996 03:55AM FROM COZY-HARBOR

R. W. ...
...
...inford.

LETTER OF TRANSMITTAL

Date: 02-May-96 Project No.: 235-212
Attention: Mr. John Norton

Co: ...
110 Dartmouth St
South Portland, ME 0

In-Place Density Testing
Cozy Harbor Seafood Renovations
South Portland, Maine

Summary of attached In-Place Density Test Results:

Date(s) Performed: April 29, 1996	Test (s) Performed
	In-Place Density Testing - Nuclear Method ASTM D2922
	<input checked="" type="radio"/> Meets Specification
	<input type="radio"/> Selected Tests Do Not Meet Specification - Noted with an *
Note: Materials descriptions and maximum laboratory dry density values were transmitted under separate cover and are referenced in the attached summaries by the material number.	

Remarks:

Copy To: _____ Signed: 

If enclosures are not as noted, kindly notify us at once.

R. W. C. Associates, Inc.
P.O. Box 1730
Sanford, Va. 24073

LETTER OF TRANSMITTAL

(202) 224-8000
Fax: (202) 224-8002

Date:	02-May-96	Project No.:	235-212
Attention:	Mr. John Norton		
Re:	Concrete Testing		

Cozy Harbor School
110 Dartmouth St.
So. Portland, Me. 04107

We are sending you attached concrete cylinder test results:

Cylinder No. (s)	Age (Days)
15648	7
15652	7
15656	7

Remarks:

Copy To:

Signed: Melody Roy

If enclosures are not as noted, kindly notify us at once.

8748716 P.03

TO

FROM: COZY HARBOR

06-20-1998 10:00AM

CONCRETE TEST/PLACEMENT REPORT

Project Name: Cozy Harbor Seafood
 Project No: 23-212
 Weather Conditions: Partly cloudy, cool
 Method of Placement: Pump
 Admixtures: ---
 Placement Location: Sub Placement #2; Between C&F, 4&10 Lines
 Test Cylinder Location: Between 4&5, C&D Lines

Date Cylinders Cast: 24-Apr-96
 Concrete Supplier: F.R. Carroll
 General Contractor: Brown Const.
 Design Strength: 3,000 psi
 Max Agg. Size: 1 1/2"

5x12 Cylinders	4	Cast by	Scott L. Harmon	Time	
Load No.	3/14	Slump (in)	4 1/4	Batched @	7:10
Truck No.	1118	Air (°F)	53	Arrived @	7:50
Truck No.		Concrete (°F)	62	Total Time	70 min
Cubic Yds.	13	Air Content (%)	---		

Specimen Storage: Field cure for 1 Jay

Lab No.	Cast Date	Age (Days)	Area (in ²)	Load (lbs)	Compressive Strength (psi)	Break type
15648	01-May-96	7	28.37	104,500	3680	4 ✓
15649	22-May-96	28	28.37			
15650	22-May-96	28	28.37			
15651	HOLD	HOLD	28.37			

Types of Breaks



Cone
1



Cone & Split
2



Cone & Shear
3



Shear
4



Columnar
5

Load	Ticket Number	Truck Number	Cubic Yds	Slump (Inches)	Air Temp (°F)	Conc Temp (°F)	(%) Air Content	Time (min.)
1/14	1118	1	10	5	53	63	---	70
2/14	1117	6	10	5	53	63	---	80
4/14	1120	5	10	4 1/4	55	62	---	60
5/14	1121	9	10	4 1/2	55	62	---	50

Remarks:

Checked by:

cc:

R. W. GILLESPIE & ASSOCIATES, INC.

P. O. Box 1730 Sanford, Maine 04073 (207) 324-8008

CONCRETE TEST/PLACEMENT REPORT

Project Name: Cozy Harbor Seafood
 Project No: 235-212
 Weather Conditions: Partly to mostly cloudy, cool
 Method of Placement: Pump
 Admixtures: --
 Placement Location: Slab Placement #2; Between C&F, 4&10 Lines
 Test Cylinder Location: Between 6&7, D&E Lines

Date Cylinders Cast: 24-Apr-96
 Concrete Supplier: F.R. Carroll
 General Contractor: Brown Const.
 Design Strength: 3,000 psi
 Max Agg. Size: 1 1/2"

6x12 Cylinders	4	Cast by	Scott L. Harmon	Time	
Load No.	6/14	Slump (in)	4 1/4	Batched @	9:12
Ticket No.	1122	Air (°F)	61	Arrived @	8:45
Truck No.	14	Concrete (°F)	62	Total Time	60 min
Cubic Yds.	10	Air Content (%)	--		

Specimen Storage: Field cure for 1 day

Lab No.	Test Date	Avg Dia (in)	Area (in ²)	Age (Days)	Load (lbs)	Compressive Strength (psi)	Break type
15652	01-May-96	6.01	28.37	7	116,500	4110	4 ✓
15653	22-May-96	6.01	28.37	28			
15654	22-May-96	6.01	28.37	28			
15655	HOLD	6.01	28.37	HOLD			

Types of Breaks

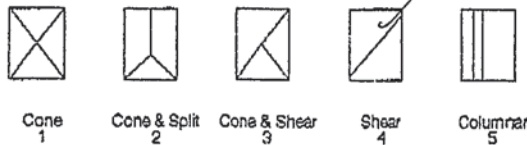

Load	Ticket Number	Truck Number	Cubic Yds	Slump (inches)	Air Temp (°F)	Cone Temp (°F)	(%) Air Content	Time (min.)
7/14	1123	7	9	5	61	62	--	60
8/14	1124	1	10	4 1/4	58	62	--	55
9/14	1126	2	10	4 1/4	58	62	--	60
10/14	1126	11	8	4 1/4	58	62	--	60
11/14	1129	3	10	5	58	62	--	60

Remarks:

Checked by:

cc:

CONCRETE TEST/PLACEMENT REPORT

Project Name: Cozy Harbor Seafood
 Project No: 235-212
 Weather Conditions: Mostly cloudy, cool
 Method of Placement: Pump
 Admixtures: --
 Placement Location: Lab Placement #2; Between C&F, 4&10 Lines
 Test Cylinder Location: Between 9&10, E&F Lines

Date Cylinders Cast: 24-Apr-96
 Concrete Supplier: F.R. Carroll
 General Contractor: Brown Const.
 Design Strength: 3,000 psi
 Max Agg. Size: 1 1/2"

6x12 Cylinders	4	Cast by	Scott L. Harmon	Time	
Lead No.	12/14	Slump (in)	4 1/4		
Ticket No.	1131	Air (°F)	60		
Truck No.	9	Concrete (°F)	62		
Cubic Yds.	10	Air Content (%)	--		
				Batched @	9:50
				Arrived @	10:25
				Total Time	90 min

Specimen Storage: Field cure for 1 day

Lab No.	Test Date	Avg Dia (in)	Area (in ²)	Age (Days)	Load (lbs)	Compressive Strength (psi)	Break type
15656	01-May-96	6.01	28.37	7	114,500	4035	4
15657	22-May-96	6.01	28.37	28			
15658	22-May-96	6.01	28.37	28			
15659	HOLD	6.01	28.37	HOLD			

Types of Breaks

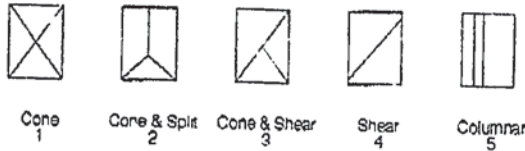

Lead	Ticket Number	Truck Number	Cubic Yds	Slump (inches)	Air Temp (°F)	Core Temp (°F)	(%) Air Content	Time (min.)
13/14	1135	4	10	4 1/4	61	62	--	85
14/14	1139	13	11	4 1/2	65	62	--	--

Remarks:

Checked by:

cc:

R. W. Gillespie & Associates, Inc.
P.O. Box 1730
Sanford, Maine 04073

LETTER OF TRANSMITTAL

(207)324-8008
Fax (207)324-8042

Date:	09-May-96	Project No.:	235-212
Attention:	Mr. John Norton		
Re:	Concrete Testing		

Cozy Harbor Seafood

110 Dartmouth Street

So. Portland, ME 04106

We are sending you attached concrete cylinder test results.

Cylinder No. (s)	Age (Days)
15720	7
15724	7
15728	7

Remarks:

Copy To:

Signed: Melody Roy

If enclosures are not as noted, kindly notify us at once.

8748716 P.07

TO

05-20-1996 10:02 AM FROM COZY HARBOR

R. W. GILLESPIE & ASSOCIATES, INC.
 P. O. Box 1730 Sanford, Maine 04073 (207) 324-8008

CONCRETE TEST/PLACEMENT REPORT

Project Name: Cozy Harbor Seafood
 Project No: 235-212
 Weather Conditions: Partly cloudy, cool
 Method of Placement: Pump with Boom
 Admixtures: --
 Placement Location: A-B; 1-9
 Test Cylinder Location: A1-B1

Date Cylinders Cast: 01-May-96
 Concrete Supplier: F.R. Carroll
 General Contractor: Brown Const.
 Design Strength: 3,000 psi
 Max Agg. Size: 1½"

6x12 Cylinders	4	Cast by	Jeffrey A. Hallett	Time	
Load No.	1/13	Slump (in)	4½	Batched @	6:20
Ticket No.	1244	Air (°F)	50	Arrived @	7:00
Truck No.	6	Concrete (°F)	58	Total Time	80 min
Cubic Yds.	10	Air Content (%)	--		

Specimen Storage: Field cure for 1 day

Lab No.	Test Date	Avg Dia (in)	Area (in ²)	Age (Days)	Load (lbs)	Compressive Strength (psi)	Break type
15720	08-May-96	6.01	28.37	7	100,000	3520	S
15721	20-May-96	6.01	28.37	28			
15722	29-May-96	6.01	28.37	HOLD			
15723	HOLD	6.01	28.37	HOLD			

Types of Breaks



Load	Ticket Number	Truck Number	Cubic Yds	Slump (inches)	Air Temp (°F)	Conc Temp (°F)	(%) Air Content	Time (min.)
					50	--	--	55
2/13	1245	14	10	--	50	--	--	65
3/13	1246	5	10	4½*	51	57	--	55
4/13	1247	10	10	4¼	53	57	--	55
5/13	1248	1	10	2½	53	57	--	55

Remarks: * Visual

Checked by: K

cc:

R. W. GILLESPIE & ASSOCIATES, INC.

P. O. Box 1730 Sanford, Maine 04073 (207) 324-8008

CONCRETE TEST/PLACEMENT REPORT

Project Name: Cozy Harbor Seafood
 Project No: 235-212
 Weather Conditions: Clear, warm
 Method of Placement: Pump with Boom
 Admixtures: --
 Placement Location: A-B; 1-9
 Test Cylinder Location: A4-B4

Date Cylinders Cast: 01-May-96
 Concrete Supplier: F.R. Carroll
 General Contractor: Brown Const.
 Design Strength: 3,000 psi
 Max Agg. Size: 1 1/2"

6x12 Cylinders	4	Cast by	Jeffrey A. Hallett	Time		
Load No.	6/13	Slump (in)	4 1/2		Batched @	7:55
Ticket No.	1249	Air (°F)	57		Arrived @	8:30
Truck No.	3	Concrete (°F)	58		Total Time	80 min
Cubic Yds.	10	Air Content (%)	--			

Specimen Storage: Field cure for 1 day

Lab No.	Test Date	Avg Dia (in)	Area (in ²)	Age (Days)	Load (lbs)	Compressive Strength (psi)	Break type
15724	08-May-96	6.01	28.37	7	110,000	3880	4
15725	29-May-96	6.01	28.37	28			
15726	29-May-96	6.01	28.37	23			
15727	HOLD	6.01	28.37	HOLD			

Types of Breaks

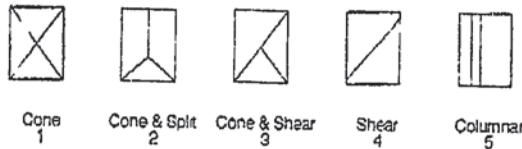

Load	Ticket Number	Truck Number	Cubic Yds	Slump (Inches)	Air Temp (°F)	Cons Temp (°F)	(%) Air Content	Time (min.)
7/13	1250	2	10	4 1/2 *	57	58	--	80
8/13	1252	11	8	5	57	58	--	65
9/13	1253	8	10.5	4	53	60	--	70
10/13	1254	14	10.5	3 1/4	53	59	--	55

Remarks: * Visual

Checked by:

cc:

CONCRETE TEST/PLACEMENT REPORT

Project Name: Cozy Harbor Seafood
Project No: 235-212
Weather Conditions: Clear, sunny
Method of Placement: Pump with Boom
Admixtures: --
Placement Location: A-B; 1-9
Test Cylinder Location: B8.5 (freezer wall, cooler side of wall)

Date Cylinders Cast: 01-May-96
Concrete Supplier: F.R. Carroll
General Contractor: Brown Const.
Design Strength: 3,000 psi
Max Agg. Size: 1½"

6x12 Cylinders	4	Cast by	Jeffrey A. Hallatt	Time		
Load No.	11/13	Slump (in)	5½		Bathed @	9:30
Ticket No.	1257	Air (°F)	53		Arrived @	10:10
Truck No.	5	Concrete (°F)	60		Total Time	50 min
Cubic Yds.	10½	Air Content (%)	--			

Specimen Storage: Field cure for 1 day

Lab No.	Test Date	Avg Dia (in)	Area (in ²)	Age (Days)	Load (lbs)	Compressive Strength (psi)	Break type
15728	08-May-96	6.01	28.37	7	102,500	3610	4
15720	29-May-96	6.01	28.37	28			
15730	29-May-96	6.01	28.37	28			
15731	HOLD	6.01	28.37	HOLD			

Types of Breaks

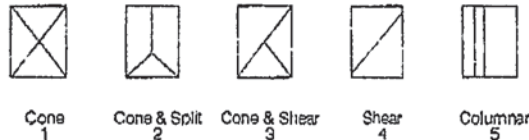

Cone 1 Cone & Split 2 Cone & Shear 3 Shear 4 Columnar 5

Load	Ticket Number	Truck Number	Cubic Yds	Slump (inches)	Air Temp (°F)	Conc Temp (°F)	(%) Air Content	Time (min.)
12/13	1259	10	10½	4½ *	50	--	--	70
13/13	1251	1	10	4 *	60	57	--	55

Remarks: * Visual

Checked by:

cc:

R. W. Gillespie & Associates, Inc.
P.O. Box 1730
Sanford, Maine 04073

LETTER OF TRANSMITTAL

(207)324-8008
Fax (207)324-8042

Date:	10-May-96	Project No.:	235-212
Attention:	Mr. John Norton		
Re:	Concrete Testing		

Cozy Harbor Seafood
110 Dartmouth Street
So. Portland, ME 04106

We are sending you attached concrete cylinder test results.	
Cylinder No. (s)	Age (Days)
15536	28
15537	28
15540	28
15541	28

Remarks:

Copy To:

Signed: Melody Roy

If enclosures are not as noted, kindly notify us at once.

8749716 P. 11

TO

FROM COZY HARBOR 05-20-1996 10:05AM

R. W. GILLESPIE & ASSOCIATES, INC.
 P. O. Box 1730 Sanford, Maine 04073 (207) 324-8008

Page 1 of 2

CONCRETE TEST/PLACEMENT REPORT

Project Name:	Cozy Harbor Seafood	Date Cylinders Cast:	12-Apr-96
Project No:	235-212	Concrete Supplier:	F.R. Carroll
Weather Conditions:	Mostly cloudy, cool	General Contractor:	Brown Const.
Method of Placement:	Pump	Design Strength:	3,000 psi
Admixtures:	--	Max Agg. Size:	1/2"
Placement Location:	Slab #1 (F to K, 4 to 7 plus F to G, 7 to 9 lines)		
Test Cylinder Location:	Between F and G, 4 and 5 lines		

6x12 Cylinders	4	Cast by	Scott L. Harmon	Time		
Load No.	2/9	Slump (in)	--		Batched @	7:10
Ticket No.	10566	Air (%)	47		Arrived @	7:45
Truck No.	10	Concrete (%)	--		Total Time	70 min
Cubic Yds.	10	Air Content (%)	--			

Specimen Storage: Field cure for 3 days

Lab No.	Test Date	Avg Dia (in)	Area (in ²)	Age (Days)	Load (lbs)	Compressive Strength (psi)	Break type
15535	19-Apr-96	6.01	28.27	7	102,000	3595	4
15536	10-May-96	6.01	28.37	28	126,000	4440	4
15537	10-May-96	6.01	28.37	28	127,000	4480	4
15538	HOLD	6.01	28.37	HOLD			

Types of Breaks

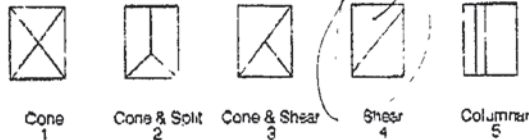

Load	Ticket Number	Truck Number	Cubic Yds	Slump (inches)	Air Temp (°F)	Conc Temp (°F)	(%) Air Content	Time (min.)
1/9	10585	4	10	5	47	63	--	95
3/9	10568	13	10	5	47	60	--	65
4/9	10591	5	10	4 1/2	48	60	--	65
5/9	10592	14	10	4 1/4	50	61	--	60
6/9	10595	4	10	4 1/4	50	60	--	60

Remarks:

Checked by:

cc:

R. W. GILLESPIE & ASSOCIATES, INC.
P. O. Box 1730 Sanford, Maine 04073 (207) 324-0008

CONCRETE TEST/PLACEMENT REPORT

Project Name: Cozy Harbor Seafood
Project No: 235-212
Weather Conditions: Mostly cloudy, cool
Method of Placement: Pump
Admixtures: --
Placement Location: Slab #1 (F to K, 4 to 7 plus F to G, 7 to 9 lines)
Test Cylinder Location: Between F.5 and G.5, 4.7 and 7 lines

Date Cylinders Cast: 12-Apr-96
Concrete Supplier: F.R. Carroll
General Contractor: Brown Const.
Design Strength: 3,000 psi
Max Agg. Size: 1 1/2"

6x12 Cylinders	4	Cast by	Scott L. Harmon	Time	
Load No.	7/9	Slump (in)	4 1/4		
Ticket No.	10596	Air (°F)	51		
Truck No.	2	Concrete (°F)	59		
Cubic Yds.	10	Air Content (%)	--		
				Batched @	9:10
				Arrived @	9:50
				Total Time	70 min

Specimen Storage: Field cure for 3 days

Lab No.	Test Date	Avg Dia (in)	Area (in ²)	Age (Days)	Load (lbs)	Compressive Strength (psi)	Break type:
15539	19-Apr-96	6.01	28.37	7	96,000	3380	4
15540	10-May-96	6.01	28.37	28	126,500	4460	4
15341	10-May-96	6.01	28.37	28	121,500	4280	3
15542	HOLD	6.01	28.37	HOLD			

Types of Breaks



Cone
1



Cone & Split
2



Cone & Shear
3



Shear
4



Columnar
5

Load	Ticket Number	Truck Number	Cubic Yds	Slump (inches)	Air Temp (°F)	Ccno Temp (°F)	(%) Air Content	Time (min.)
8/9	10597	10	8	4 1/4	51	59	--	70
9/9	10599	11	8 1/2	--	51	59	--	80

Remarks:

Checked by:

cc:

SUMMARY OF IN-PLACE DENSITY TESTS
COZY HARBOR SEAFOODS
SOUTH PORTLAND, MAINE
PROJECT NO. 235-212

Date: April 29, 1996

Test No.	Location	Elevation	Dry Density (pcf)	Water Content (%)	Percent of Max. (%)
1	4.5/A.5	FG Slab Base	124.8	6.8	96.7
2	5/A.8	1-G Slab Base	127.3	5.4	98.5
3	4/A.7	FG Slab Base	123.1	5.3	95.3
4	6.5/B	FG Slab Base	130.1	5.6	100+
5	8.2/A.6	FG Slab Base	122.9	5.5	95.2
6	6.2/A.1	FG Slab Base	123.6	3.8	95.7

Remarks: FG = Finish Grade

8748716 P. 12

TO

05-20-1996 10:07AM FROM COZY HARBOR

Seafood Processing Facility
 Cozy Harbor Seafood
 Portland, Maine
 LEA Project No. 88018.00

ADDENDUM NO. 1

ITEM NO.	DWG NO./ SPEC SECTION	CHANGE
1.	Add Alt.#5	Change to read as follows: "Electrical Contractor shall provide material and labor for connection to Owner's process equipment. Include circuit breakers in each power panelboard PF1 thru PF4 as needed and connections and drops from same to each piece of Owner furnished equipment."
2.	SC-4	Omit the following sentence: "The Contractor shall make such arrangements with his employees as not to conflict with the wage and hour laws of the State and the United States of America."
3.	SC-8	Change Paragraph 1.21, D.: Testing shall be paid for by the Owner, per Section 03350, Paragraph 1.08, unless such specified testing fails, in which case the cost of retesting will be at the Contractor's expense.
4.	Dwg S-3	Omit reference to piles in general notes #1. None are required.
5.	Dwg S-3	Change Section 5: The vapor barrier under the freezer slab is to be 50 mil thickness, not 10.
6.	Dwg S-1	Clarification: Welded wire fabric in new slab to be 6x6 W4.0 x W4.0.
7.	Dwg S-1 <i>done</i>	Clarification: Saw cut control joints for new concrete slab are located at high points of finished floor as shown on Drawing A-1.
8.	Dwg S-1	- Change: Tank Pad will be rotated 90° on site. Section A-A should show a thickened slab measuring 39' total depth, with reinforcing stopping 3' max from bottom of the haunch.
9.	Dwg S-4	Change General Notes to reference the BOCA National Building Code 1993 and the City of Portland Design shall be for a snow load of 50 psf.
10.	Dwg A-1 Sect 09705	New resinous flooring shall be located only on existing concrete slab in Production Room 112 from column line K/4 thru 8 around Break Room to line of floor drains along column lines 4 thru 9 midway between E and F (see expansion joint on S-1). The same system will be located in the Rooms 109 and 110. The intent of the resinous flooring is to provide a finished floor slope to drains of 1/8"/ft. Fill material may be equal to Master Builders EMACO T430 rapid setting mortar with a minimum 8-hour cure. The resinous flooring system may cure within 72 hours.
11.	Dwg A-1	- Clarification: The Loading Dock (Room 113) slab will be removed and replaced with new slab, sloping to drains. New masonry openings at Loading Dock Area include a 12' wide x 8' high M.O. at door 121 and for the 8'x8' M.O.'s at new doors 118 and 119. This involves demo of existing windows and one overhead door at these areas.
12.	Dwg A-1	- Add: Twenty-Eight (28) steel pipe bollards at door and material lift locations.
13.	Dwg A-1	Change: Former overhead door in Fish Processing area west wall shall be a new 12' wide x 10' hi Thermacore 501 sectional door. A new 6'x20' lintel will be required at this door head. <i>detail</i>
14.	Dwg A-1	Change: Stair No.4 on west wall of Fish Processing 118 will be relocated to north wall. <i>- site plan?</i>
15.	Dwg A-1	Add: 2'-8" x 7'-0" wood door from Open Office Area to Storage Room 108.
16.	Dwg A-2	Change: South walls of Open Office 102 and Office 111 will include 1 1/2" rigid insulation installed in 1 1/2" Z-furring in lieu of the 7/8" hat furring.
17.	Dwg A-2	Clarification: Counter in Break Room is by Owner.
18.	Dwg A-4	Clarification: All references to glass block are to be the Lexan block windows (Sect.04300, 2.04). <i>MAC-15916?</i>

Addendum No. 1
 February 14, 1988

Seafood Processing Facility
Cozy Harbor Seafood
Portland, Maine
LEA Project No. 86018.00

ITEM NO.	DWG NO./ SPEC SECTION	CHANGE
19.	Dwg A-2	Clarification: Window W-3 is to be 1/4" clear float glass, ASTM C1036, Class 1, in painted hollow metal frame 5'-4" wide x 4'-0" high with center mullion. Exterior windows should be equal to Kawneer 631RT-SH, thermal single-hung, AAMA C50, clear anodized aluminum frames, with 1" insulated glass. Windows should include screens and transom frames to receive 3" thick Lexan block windows.
20.	Dwg A-6	Add: The following rooms shall receive vinyl composition tile (VCT) flooring and vinyl wall base: Rooms 101 thru 108 and 111. VCT shall be equal to Armstrong Imperial Texture Excelon 12"x12"x1/8" thick. Tile will be selected on at least two colors. Cove base will be equal to Armstrong 4" high x 1/8" thick, top set coved and toeless, preformed external corners, color to be selected by the Architect.
21.	Spec 09900	Change Par. 3.05 A, Exterior Concrete Block to: 1. One coat Tnemec 151 Elasto-Grip, 4 mil DFT. 2. One coat Tnemec 156 Enviro-Crete, 9-10 mil DFT. Change Par. 3.08 A.3. to add: Two colors will be selected for each wall as horizontal bands.
22.	Dwg A-6	Clarification: Frames for double-acting doors shall be hollow metal 16-gauge without rebate and shall have 5/16" steel full height backup plate inserted into opening and grouted into the slab or otherwise equally anchored to the slab.
23.	Dwg A-3	Clarification: Section reference 6/A-5 should read, "1/A-5."
24.	Spec 09511	Clarification: Use Sanigrid by Kemlite or equal type grid system in the process areas (Rooms 109, 110, 112, 118). Use Alumax or equal type grid system in the office/ employee areas.
25.	Electrical	Relocate panelboards PP1, PP2, PP3, and PP4 from first floor process areas to mezzanine level east wall at column line 8.
26.	Electrical	Relocate main switchboard and panelboard PPA from mezzanine level west wall column line 1 to mezzanine level east wall column line 5.
27.	Electrical	Panelboard PPA in Break Room shall now be called panelboard LPA.
28.	Electrical	Relocate ice machine auger and ice machine from mezzanine level east wall column line 7 to same level west wall column line 7. <i>- drain & air gap</i>
*29.	Electrical	Utility Company pad-mounted transformer and associated pull box and conduit run up building shall be relocated to column line 4. Extend PVC run underground to new location, coordinating with plumbing contractor's invertis.
30.	Electrical	Relocate (3) duplex receptacles for vending machines located in Break Room from north wall to east wall.
31.	Electrical	Install (1) duplex receptacle in Break Room at column line 8/H 18" above finished floor on circuit number RPA-28.
32.	Electrical	Replace (2) duplex receptacles in Break Room for microwaves with (2) double duplex receptacles. Circuit numbers shall be RPA-7,9 and RPA-24,28. These receptacles shall be mounted 42" AFF.
33.	Electrical	Relocate duplex receptacle circuit #23 on north wall of Open Office from 18" AFF to 42" AFF and change to GFI protection, located towards end of counter.
34.	Electrical	Install (1) duplex receptacle with GFI protection on the north wall of the Open Office at column line 9/H mounted 42" AFF, located towards opposite end of counter from receptacle mentioned above. Circuit number shall be RPA-31.
35.	Electrical	Relocate existing Quonset structure panelboard from column line A/1 to north wall of Quonset.
36.	Electrical	Lighting Fixture type "G" shall be 150W metal halide.

Addendum No. 1
February 14, 1998

Brown CONSTRUCTION

TO: CITY OF PORTLAND CODE ENFORCEMENT ATTN: AMY SIMPSON

FROM: TOM ANUSZEWSKI DATE: 6-13-96

SUBJECT: COZY HARBOR SEAFOOD, 75 ST. JOHN ST.

TOTAL PAGES INCLUDING THIS SHEET: 3 JOB# _____

FAX MESSAGE:

Amy,
As requested via Ed Gabel, attached
is the Sprinkler System Material & Test
Certificate.

If any additional information is required,
or if you have any questions, please
give me a call.

Tom



CONTRACTOR'S MATERIAL & TEST CERTIFICATE FOR ABOVEGROUND PIPING

PROCEDURE

2-231

Upon completion of work, inspection and tests shall be made by the contractor's representative and witnessed by an owner's representative. All defects shall be corrected and system left in service before contractor's personnel finally leaves the job.

A certificate shall be filled out and signed by both representatives. Copies shall be prepared for approving authorities, owners and contractor. It is understood the owner's representative's signature in no way prejudices any claim against contractor for faulty material, poor workmanship, or failure to comply with approving authority's requirements or local ordinance.

PROPERTY NAME

COZY HARBOR SEAFOOD

DATE

6-10-96

PROPERTY ADDRESS

ST. JOHN STREET PORTLAND

PLANS

ACCEPTED BY APPROVING AUTHORITY(S) NAMES

STATE FIRE MARSHAL'S OFFICE

ADDRESS

397 WATER ST. GARDNER, MAINE 04345

INSTALLATION CONFORMS TO ACCEPTED PLANS

EQUIPMENT USED IS APPROVED

IF NO, EXPLAIN DEVIATIONS

YES NO

YES NO

INSTRUCTIONS

HAS PERSON IN CHARGE OF FIRE EQUIPMENT BEEN INSTRUCTED AS TO LOCATION OF CONTROL VALVES AND CARE AND MAINTENANCE OF THIS NEW EQUIPMENT IF NO, EXPLAIN

YES NO

HAVE COPIES OF APPROPRIATE INSTRUCTIONS AND CARE AND MAINTENANCE CHARTS AND NFPA 13A BEEN LEFT ON PREMISES IF NO, EXPLAIN

YES NO

LOCATION OF SYSTEM

SUPPLIES BLOCS.

ENTIRE BLDG

SPRINKLERS

MAKE	MODEL	YEAR OF MANUFACTURE	ORIFICE SIZE	QUANTITY	TEMPERATURE RATING
CENTRAL	"GB" UPR	1996	1/2"	108	200°
CENTRAL	"GB" PWD	1996	1/2"	131	155°
CENTRAL	"A" (S)	1996	1/2"	24	165°

PIPE AND FITTINGS

PIPE CONFORMS TO NFPA STANDARD
FITTINGS CONFORM TO NFPA STANDARD

YES NO
 YES NO

ALARM VALVE OR FLOW INDICATOR

ALARM DEVICE

TYPE	MAKE	MODEL	MAXIMUM TIME TO OPERATE	M.N.
CENTRAL ALARM CHECK	CENTRAL	"G"		

DRY PIPE OPERATING TEST

MAKE		MODEL		SERIAL NO.		MAKE		MODEL		SERIAL NO.	
CENTRAL		AG									
TIME TO TRIP THRU TEST PIPE		WATER PRESSURE		AIR PRESSURE		TRIP POINT AIR PRESSURE		TIME WATER REACHED TEST OUTLET		TIME TO OPERATE	
MIN.	SEC.	PSI	PSI	PSI	PSI	MIN.	SEC.	MIN.	SEC.	MIN.	SEC.
Without Q.O.D.											
With Q.O.D.											

IF NO, EXPLAIN

DELUGE & PREACTION VALVES	OPERATION					
	PIPING SUPERVISED		PNEUMATIC <input checked="" type="checkbox"/> ELECTRIC <input type="checkbox"/> HYDRAULIC <input type="checkbox"/>		DETECTING MEDIA SUPERVISED	
	<input type="checkbox"/> YES <input type="checkbox"/> NO		<input type="checkbox"/> YES <input type="checkbox"/> NO		<input type="checkbox"/> YES <input type="checkbox"/> NO	
TEST DESCRIPTION	IS THERE AN ACCESSIBLE FACILITY IN EACH CIRCUIT FOR TESTING					
	<input type="checkbox"/> YES <input type="checkbox"/> NO		IF NO, EXPLAIN			
	MAKE	MODEL	DOES EACH CIRCUIT OPERATE SUPERVISION LOSS ALARM		DOES EACH CIRCUIT OPERATE VALVE RELEASE	
TESTS	ALL PIPING HYDROSTATICALLY TESTED AT		200 PSI FOR		2 HRS	
	DRY PIPING PNEUMATICALLY TESTED		<input checked="" type="checkbox"/> YES <input type="checkbox"/> NO		IF NO, STATE REASON	
	EQUIPMENT OPERATES PROPERLY		<input checked="" type="checkbox"/> YES <input type="checkbox"/> NO			
BLANK TESTING GASKETS	DRAIN TEST	READING OF GAGE LOCATED NEAR WATER SUPPLY TEST PIPE		RESIDUAL PRESSURE WITH VALVE IN TEST PIPE OPEN W/OUT		
		STATIC PRESSURE		70 PSI		
		Underground mains and lead in connections to system are flushed before connection made to sprinkler piping.		78 PSI		
WELDING	VERIFIED BY COPY OF THE U FORM NO. 85B		<input checked="" type="checkbox"/> YES <input type="checkbox"/> NO		OTHER EXPLAIN	
	FLUSHED BY INSTALLER OF UNDERGROUND SPRINKLER PIPING		<input type="checkbox"/> YES <input type="checkbox"/> NO		EXISTING	
	NUMBER USED	LOCATIONS				NUMBER REMOVED
HYDRAULIC DATA NAMEPLATE	NAMEPLATE PROVIDED		IF NO, EXPLAIN			
	<input checked="" type="checkbox"/> YES <input type="checkbox"/> NO					
	DATE LEFT IN SERVICE WITH ALL CONTROL VALVES OPEN					
SIGNATURES	NAME OF SPRINKLER CONTRACTOR					
	EASTERN FIRE PROTECTION CO.					
	FOR PROPERTY OWNER (SIGNED)		TESTS WITNESSED BY		DATE	
X Ed Salvo		Seymour		6/13/96		
FOR SPRINKLER CONTRACTOR (SIGNED)		TITLE		DATE		
X [Signature]		Foreman		6/13/96		
ADDITIONAL EXPLANATION AND NOTES						

Brown CONSTRUCTION

FAX

Date June 27, 1996

Number of pages including cover sheet 2

TO: Amy Simpson
Codes Enforcement
City of Portland
Portland, ME

Phone 207-874-8300, X-0708
Fax Phone 207-874-8716

CC: John Norton, Cozy Harbor
Seafood

FROM: Tom Anuszewski, PE
Brown Construction, Inc.
253 Warren Avenue
PO Box 1217
Portland, ME 04104

Phone 207-797-6152

Fax Phone 207-797-2948

Urgent For your review Reply ASAP Please Comment

Message:

**RE: Cozy Harbor Seafood
St. John Street**

Attached for your information and files is a copy of Coastal Equipment Corporation letter of this date, concerning confirmation of load test and lifting and lowering speeds of the Vertical Reciprocating Conveyor located at this project.

If you require any additional information about this piece of equipment or have any questions, please give me a call.

Thanks.

Tom

COASTAL EQUIPMENT CORPORATION

P.O. Box 1118 • Portland, Maine 04104 • Phone: 207-775-1100 • Fax 207-775-1139

06/27/96

Tom Anuszewski
Brown Construction
253 Warren Ave.
Portland, ME 04101

RE: Cozy Harbor Seafood

Dear Tom:

This letter is to confirm that a load of 6000 LBS was put on the Pflow Vertical Reciprocating Conveyor (VCR) and conveyed to the second level and returned to the floor several times. The load was also raised to the second floor and allowed to remain on the platform overnight. The conveyor showed no signs of deflection when inspected and was lowered to the floor.

The average lifting speed is 24.95 FPM
The average lowering speed is 25.023 FPM

Sincerely,



Mark Goldstein
President

MATERIAL HANDLING EQUIPMENT
ENGINEERING, FABRICATION, INSTALLATION

Brown CONSTRUCTION

FAX

Date June 27, 1996

Number of pages including cover sheet 2

TO: Amy Simpson
Codes Enforcement
City of Portland
Portland, ME

FROM: Tom Anuszewski, PE
Brown Construction, Inc.
253 Warren Avenue
PO Box 1217
Portland, ME 04104

Phone 207-874-8300, X-8708

Fax Phone 207-874-8716

Phone 207-797-6152

CC: John Norton, Cozy Harbor
Seafood

Fax Phone 207-797-2948

Urgent For your review Reply ASAP Please Comment

Message:

RE: Cozy Harbor Seafood
St. John Street

Attached for your information and files is a copy of Coastal Equipment Corporation letter of this date, concerning confirmation of load test and lifting and lowering speeds of the Vertical Reciprocating Conveyor located at this project.

If you require any additional information about this piece of equipment or have any questions, please give me a call.

Thanks.

Tom

06/27/96 15:39

3 207 737 2948

Brown Const

02

COASTAL EQUIPMENT CORPORATION

J. Box 111B • Portland, Maine 04104 • Phone: 207-775-1103 • Fax 207-775-1139

06/27/96

Tom Anuszewski
Brown Construction
253 Warren Ave.
Portland, ME 04101

RE: Cozy Harbor Seafood

Dear Tom:

This letter is to confirm that a load of 6000 LBS was put on the Pflow Vertical Reciprocating Conveyor (VCR) and conveyed to the second level and returned to the floor several times. The load was also raised to the second floor and allowed to remain on the platform overnight. The conveyor showed no signs of deflection when inspected and was lowered to the floor.

The average lifting speed is 24.95 FPM

The average lowering speed is 25.023 FPM

Sincerely,



Mark Goldstein
President

MATERIAL HANDLING EQUIPMENT
ENGINEERING, FABRICATION, INSTALLATION



CITY OF PORTLAND, MAINE
Department of Building Inspection

Certificate of Occupancy

LOCATION 75 St John St

Issued to Cozy Harbor Seafood

Date of Issue 21 June 1996

This is to certify that the building, premises, or part thereof, at the above location, built — altered — changed as to use under Building Permit No. 960189, has had final inspection, has been found to conform substantially to requirements of Zoning Ordinance and Building Code of the City, and is hereby approved for occupancy or use, limited or otherwise, as indicated below.

PORTION OF BUILDING OR PREMISES

APPROVED OCCUPANCY

Entire

Fish Processing

Limiting Conditions:

This certificate supersedes
certificate issued

Approved:

6/29/96 *[Signature]*
(bze) Inspector

[Signature]
Inspector of Buildings

[Handwritten initials]

Notice: This certificate identifies lawful use of building or premises, and ought to be transferred from owner to owner when property changes hands. Copy will be furnished to owner or lessee for one dollar.

Amy

6/26

11:15

Ed

Brown Const.

773-5952 OK stop by
from Tom - Spruce

Cozy Harbor

pre C of O insap

Vicki

Brown CONSTRUCTION

THOMAS J. ANUSZEWSKI, PE
Project Manager
207-797-6152

253 Warren Ave., P.O. Box 1217, Portland, Maine 04104

COZY HARBOR SEAFOOD
75 St. John Street, Portland, ME

FACTORS & MAJOR SUPPLIERS

SITE WORK

White Brothers, Inc.
95 Warren Ave.
Westbrook, ME 04092
(207)854-9173
Contact: Mike White

LANDSCAPING

Sabra Property Care, Inc.
4 Philips Street
Cumberland, ME 04021
(207)874-4774
Contact: Peter Monro

CONCRETE FINISHING

Quality Concrete Flooring, Inc.
RR#1, Box 319A
New Gloucester, ME 04062
(207)926-3531
Contact: Don Leavitt

REINFORCING STEEL

MacFarlane Steel Corporation
P.O. Box 142
Fryeburg, ME 04037
(207)935-3531
Contact: Pat Maillot

STRUCTURAL & MISC. STEEL

Dinsmore Steel Erecting, Inc.
45 Grand Street
South Portland, ME 04106
(207)799-1495
Contact: Frank Dinsmore

FENCING

Main Line Fence Co., Inc.
P.O. Box 27A
Cumberland, ME 04021
(207)829-5549
Contact: Brett Asherman

CONCRETE SUPPLIER

F. R. Carroll, Inc.
P.O. Box 9
Limerick, ME 04048
(207)793-8615
Contact: Mike Carroll

STAMPED CONCRETE

SIDEWALKS

Preble Concrete
26 N. Raymond Road
Gray, ME
(207)657-4239
Contact: Jeff Preble

MASONRY

Ben & Andy Libby
P.O. Box 22
Bar Mills, ME 04004
(207)929-4343
Contact: Andy Libby

ROOFING

SMR, Inc.
P.O. Box 10308
Portland, ME 04104
(207)883-1247
Contact: Steve McBrady

Brown Construction, Inc.

253 Warren Ave. / P. O. Box 1217 / Portland, ME 04104 / FAX 207-797-2948

207-797-6152



**ALUMINUM, STORE FRONT,
GLASS & GLAZING**

Cumberland County Glass
88 Second Street
South Portland, ME 04106
(207)767-7550
Contact: Ken Bouchard

**STEEL DOORS, FRAMES &
HARDWARE**

HCI/Craftsmen
P.O. Box 2532
161 John Roberts Road
South Portland, ME 04116-2532
(207)775-3191
Contact: Charles Tartre

VCT FLOORING

Paul G. White Tile Co., Inc.
50 Allen Ave.
Portland, ME 04103
(207)797-4657
Contact: Richard Gadbois

PAINTING

Theodore Logan & Son, Inc.
P.O. Box 1629
Portland, ME 04104
(207)774-6321
Contact: John Logan

MATERIAL LIFT

Coastal Equipment Corporation
P.O. Box 118
142 Presumpscot Street
Portland, ME 04104
(207)775-1100
Contact: Mark Goldstein

PLUMBING & HVAC

James J. Kelley Associates, Inc.
P.O. Box 1310
Westbrook, ME 04098-1310
(207)854-1167
Contact: Larry Guidi

**OVERHEAD DOORS &
TRAFFIC DOORS**

Overhead Door Company of Portland,
533 Riverside Industrial Parkway
Portland, ME 04103
(207)797-6734
Contact: Mike True

DRYWALL

Dirigo Drywall Associates, Inc.
225 Riverside Street
Portland, ME 04103
(207)773-3741
Contact: Larry Dahms

SUSPENDED CEILING

Landry & Sons Acoustics, Inc.
P.O. Box 976
Lewiston, ME 04243
(207)783-1269
Contact: Gerry Landry

**TOILET PARTITIONS &
ACCESSORIES**

HCI/Craftsmen
P.O. Box 2532
161 John Roberts Road
South Portland, ME 04116-2532
(207)775-3191
Contact: Charles Tartre

SPRINKLER SYSTEMS

Eastern Fire Protection
P.O. Box 1390
Auburn, ME 04210
(207)784-1507
Contact: Bub Beauchesne

ELECTRICAL

Eastern Electrical Corp.
P.O. Box 346
Portland, ME 04112
(207)772-6762
Contact: Dave Bradbury

BROWN CONSTRUCTION INC.
GENERAL CONTRACTORS

P. O. BOX 1217
PORTLAND, MAINE 04104

TRANSMITTAL LETTER

TO: INSPECTOR SERVICES
CITY OF PORTLAND
389 CONGRESS ST.
PORTLAND, ME. 04101

CONTRACT COZY HARBOR SENFORD
75 ST. JOHN STREET

DATE 5-17-96

REPLY TO: TOM ANUSZEWSKI

GENTLEMEN: P. SPAN'S HOFFSES, CHIEF

WE ARE SENDING YOU: HEREWITH UNDER SEPARATE COVER

SHOP DRAWINGS COLOR SAMPLES SPECIFICATIONS PLANS

NO. OF COPIES	DRWG. NOS.	DATE	DESCRIPTION
1	-	-	LIST OF CONTRACTORS + MAJOR SUPPLIERS

SENT TO YOU FOR THE FOLLOWING: APPROVAL FILE OR DISTRIBUTION
 APPROVED FINAL APPROVAL INFORMATION
 APPROVED AS NOTED REVISE RESUBMIT COPIES

NOTES: RE: BUILDING PERMIT # 960189, ISSUED 3-22-96.
ATTACHED LIST OF CONTRACTORS IS SUBMITTED AS
REQUIRED BY LETTER OF 3-21-96, ISSUED WITH PERMIT.
IF THERE ARE ANY QUESTIONS, PLEASE GIVE ME A CALL.

SENT BY
 MESSENGER
 MAIL

C. C. TO
JOHN NORTON
COZY HARBOR SENFORD

Very truly yours,
 THANKS,
 BROWN CONSTRUCTION INC.
 Per [Signature]

(Gen'l)

Brown Const.

* Office 797 6152

* Jobst 773 5952

Plumbing

Kelly Assoc.

Mark Golden

Dirtwork

White Bros.

Electrical

Eastern Elec.

Sprinklers

Planning & Urban Development



rec'd 3/1/96

Joseph E. Gray Jr.
Director

CITY OF PORTLAND

February 28, 1996

John Norton
Cozy Harbor
P.O. Box 389
Portland, ME 04112

RE: Cozy Harbor Revisions

Dear Mr. Norton:

This letter is to confirm the revision to the approved site plan of the Cozy Harbor project located on St. John Street. The approved revision includes relocation of catchbasin #1, pavement treatment, and relocation of entries. The revised plan has been reviewed and approved by the project review staff including representatives of the Planning, Public Works, Building Inspections, Fire and Parks Departments.

If you have any questions regarding the revision please contact the planning staff at 874-8300, extension 8720.

Sincerely,

A handwritten signature in dark ink, appearing to read "Joseph E. Gray, Jr.", written over a printed name and title.

Joseph E. Gray, Jr.
Director of Planning and Urban Development

cc: Alexander Jaegerman, Chief Planner
Sarah Hopkins, Senior Planner
✓ P. Samuel Hoffses, Chief of Building Inspections
Jeff Tarling, City Arborist
Lt. Gaylen McDougall, Fire Prevention
Natalie Burns, Associate Corporation Counsel
Mary Gresik, Building Permit Secretary
James Seymour, Acting Development Review Coordinator
Kathleen Brown, Assistant Director of Economic Development
Approval Letter File

CITY OF PORTLAND, MAINE
PLANNING BOARD

Kenneth M. Cole III, C.
Cyrus Hagge, Vice Chair
Joseph F. DeCoursey
John H. Carroll
Donna Williams
Jaimy Caron
Kevin McQuinn

November 15, 1995

John Norton
Cozy Harbor Seafood
P.O. Box 389
Portland, ME 04112

RE: 75 St. John Street

Dear Mr. Norton:

On November 14, 1995, the Portland Planning Board voted unanimously (6-0; DeCoursey absent) to deny your request for a waiver of the installation of sidewalk and the resetting of curb around the bullnose between St. John and Valley streets.

The Board also voted (5-1; William; opposed; DeCoursey absent) to approve the site plan for the renovation of and addition to 75 St. John Street. The approval was granted for the project with the following conditions:

- i. That the applicant revise the site plan to indicate the installation of granite curbing along St. John street and Valley Streets instead of concrete curbing.
- ii. That a sidewalk be installed and existing curb be reset around the "bullnose" within 36 months of site plan approval.
- iii. That the applicant submit a revised lighting plan showing "cut-off" lighting fixtures on the building and in the parking area prior to issuance of a building permit.
- iv. That the conditions included in a memo from the City Engineer dated November 14, 1995 be included as part of the approval.

The approval is based on the submitted site plan and the findings related to the site plan review standards as contained in Planning Report #57 -95, which is attached.

Please note the following provisions and requirements for all site plan approval:

1. A performance guarantee covering the site improvements as well as an inspection fee payment of 1.7% of the guarantee amount and 7 final sets of plans must be submitted to and approved by the Planning Division and Public Works prior to the release of the building permit. If you need to make any modifications to the approved site plan, you must submit a revised site plan for staff review and approval.

2. The site plan approval will be deemed to have expired unless work in the development has commenced within one (1) year of the approval or within a time period agreed upon in writing by the city and the applicant. Requests to extend approvals must be received before the expiration date.
3. A defect guarantee, consisting of 10% of the performance guarantee, must be posted before the performance guarantee will be released.
4. Prior to construction, a preconstruction meeting shall be held at the project site with the contractor, development review coordinator, Public Works, representative and owner to review the construction schedule and critical aspects of the site work. At that time, the site/building contractor shall provide three (3) copies of a detailed be the contractor's responsibility to arrange a mutually agreeable time for the preconstruction meeting.
5. If work will occur within the public right-of-way such as utilities, curb, sidewalk and driveway construction, a street opening permit(s) is required for your site. Please contact Carl Poliskey at 874-8300, ext. 8828. (only excavators licensed by the city of Portland are eligible.)

If there are any questions, please contact the Planning Staff.

Sincerely,

Kenneth M. Cole III, Chair
Portland Planning Board

cc: Joseph E. Gray, Jr., Director of Planning and Urban Development
Alexander Jaegerman, Chief Planner
Sarah Hopkins, Senior Planner
P. Samuel Hoffses, Chief of Building Inspections
Marge Schmuckal, Zoning Administrator
George Flaherty, Director of Environmental/Intergovernmental Services
Kathi Staples PE, City Engineer
James Seymour, Acting Development Review Coordinator
Mary Conroy, Principal Traffic Engineer
Jeff Tarling, City Arborist
Natalie Burns, Associate Corporation Counsel
Lt. Gaylen McDougall, Fire Prevention
Mary Gresik, Building Permit Secretary
Kathleen Brown, Assistant Director of Economic Development
Approval Letter File

Project Name: Cozy Harbor
 Project Address: 75 St. John St.

Inspection Date	Type of Inspection	Remarks - prints - page #
3.21.96	Progress Plumbing & general	Have installed 12" sewer pipe @ CB#3 Backfilled - Have not capped anything yet. Saw cutting for 4" x 6" FD rains @ Bathroom area. Have also installed 6" and 8" Domestic and Waste (Process) lines @ St. John St. side.
3.25.96	Need Amendment to Site Plan	Need to submit amendment to Site Plan - re: stair and service location change on St. John Street side.
3.27.96	PLUMBING TEST FDI @ W SANITARY	OK.
3.28.96	PLUMBING TEST OK	
4.3.96	PLUMBING TEST - OK TO BACKFILL W/ SAND TANKS AND GOING TO POUR SLABS ON NEXT WEEK. HAVE RAISED THE ELEV. 140" OF SUMP PIT #1 AND DROPPED THE ELEVATION OF SUMP PIT #2 BY 210" USED 3,000 PSI MIX AND #4 REBAR. HAVE REBAR CONC. AROUND COLUMNS. OK TO BACKFILL.	SEE PG P-1 FOR SUMP ELEV.
4.9.96	TEST LINES OK TO BACKFILL. HAVE REQUESTED D.M.C. DO AN INSPECTION PRIOR TO THEM BACKFILLING CONDUIT IN TRENCH. 4x4x6 W/M IN PLACE TO POUR SLABS @ COLUMN LINE - 6" @ W-11.5 10" @ DRAINS. BLOCKING IN OLD OPENINGS.	12" Conduit 12" Waste
4.17.96	Plumbing Inspection of Floor drains in the fish processing area. Also contractor has installed all 4" perforated pipe and gravel @ freezer area. Sump drains installed plan also.	

PLUMBING APPLICATION

Department of Human Services
Division of Health Engineering
(207) 283-3826

PROPERTY ADDRESS

Town Or Plantation: **PORTLAND**

Street Subdivision Lot #: **75-~~4~~ ST. JOHN STREET**

PROPERTY OWNERS NAME

COZY HARBOR SEAFOOD

Last: _____ First: _____

Applicant Name: **JAMES J KELLEY ASSOC., INC.**

Mailing Address of Owner/Applicant (if Different): **P.O. BOX 1310 WESTBROOK, ME 04098-1310**

PORTLAND PERMIT # 5695 STATE COPY

Date Permit Issued: **3, 19, 96** \$ **304** Double Fee Charged

255 _____ L.P.I. # **0124**

Local Plumbing Inspector Signature

Owner/Applicant Statement

I certify that the information submitted is correct to the best of my knowledge and understand that any falsification is reason for the Local Plumbing Inspector to deny a Permit.

James J. Kelley **03-18-96**

Signature of Owner/Applicant Date

Caution: Inspection Required

I have inspected the installation authorized above and found it to be in compliance with the Maine Plumbing Rules.

_____ Date Approved

Local Plumbing Inspector Signature

PERMIT INFORMATION

This Application is for	Type Of Structure To Be Served:	Plumbing To Be Installed By:
1. <input checked="" type="checkbox"/> NEW PLUMBING 2. <input type="checkbox"/> RELOCATED PLUMBING	1. <input type="checkbox"/> SINGLE FAMILY DWELLING 2. <input type="checkbox"/> MODULAR OR MOBILE HOME 3. <input type="checkbox"/> MULTIPLE FAMILY DWELLING 4. <input checked="" type="checkbox"/> OTHER — SPECIFY <u>MANUFACTURER/DISTRIBUTOR</u>	1. <input checked="" type="checkbox"/> MASTER PLUMBER 2. <input type="checkbox"/> OIL BURNERMAN 3. <input type="checkbox"/> MFG'D. HOUSING DEALER / MECHANIC 4. <input type="checkbox"/> PUBLIC UTILITY EMPLOYEE 5. <input type="checkbox"/> PROPERTY OWNER
		LICENSE # C09Q009024

Hook-Up & Piping Relocation Maximum of 1 Hook-Up	Column 2		Column 1	
	Number	Type of Fixture	Number	Type of Fixture
HOOK-UP: to public sewer in those cases where the connection is not regulated and inspected by the local Sanitary District. OR HOOK-UP: to an existing subsurface wastewater disposal system.	12	Hosebibb / Sillcock		Bathtub (and Shower)
	43	Floor Drain		Shower (Separate)
PIPING RELOCATION: of sanitary lines, drains, and piping without new fixtures.	1	Urinal	4	Sink
		Drinking Fountain	4	Wash Basin
Number of Hook-Ups & Relocations	3	Indirect Waste	5	Water Closet (Toilet)
		Water Treatment Softener, Filter, etc.		Clothes Washer
Hook-Up & Relocation Fee		Grease / Oil Separator		Dish Washer
		Dental Cuspidor		Garbage Disposal
OR TRANSFER FEE \$6.00		Bidet	1	Laundry Tub
	1	Other: <u>TRENCH DRAIN</u>	1	Water Heater
	60	Fixtures (Subtotal) Column 2	15	Fixtures (Subtotal) Column 1
			60	Fixtures (Subtotal) Column 2
			75	Total Fixtures
			\$ 300	Fixture Fee
			\$	Transfer Fee
			\$ 4.00	Hook-Up & Relocation Fee
			\$ 304	Permit Fee (Total)

SEE PERMIT FEE SCHEDULE FOR CALCULATING FEE

SECTION 15430
PLUMBING SPECIALTIES

PART 1 GENERAL

1.01 SECTION INCLUDES

- A. Floor drains, Hub drains, and Trench drains.
- B. Cleanouts.
- C. Washdown Hose bibbs.
- D. Backflow preventers.

1.02 PRODUCTS FURNISHED BUT NOT INSTALLED UNDER THIS SECTION

- A. Toilet room accessories.

1.03 PRODUCTS INSTALLED BUT NOT FURNISHED UNDER THIS SECTION

- A. Section 01010 - Summary of Work: Owner furnished kitchen equipment.

1.04 RELATED SECTIONS

- A. Section 15410 - Plumbing Piping.
- B. Section 15440 - Plumbing Fixtures.
- C. Section 15450 - Plumbing Equipment.

1.05 REFERENCES

- A. ANSI/ASSE 1011 - Hose Connection Vacuum Breakers.
- B. ANSI/ASSE 1012 - Backflow Preventers with Immediate Atmospheric Vent.
- C. ANSI/ASSE 1013 - Backflow Preventers, Reduced Pressure Principle.
- D. ANSI A112.21.1 - Floor Drains.
- E. AWWA C506 - Backflow Prevention Devices - Reduced Pressure Principle and Double Check Valve Types.

1.06 SUBMITTALS

- A. Submit under provisions of Division 1.

- B. Shop Drawings: Indicate dimensions, weights, and placement of openings and holes.
- C. Product Data: Provide component sizes, rough-in requirements, service sizes, and finishes.
- D. Manufacturer's Installation Instructions: Indicate assembly and support requirements.
- E. Approved applications and permits for cross connection control and backflow devices.

1.07 PROJECT RECORD DOCUMENTS

- A. Submit under provisions of Division 1.
- B. Record actual locations of equipment, cleanouts, and backflow preventers.

1.08 OPERATION AND MAINTENANCE DATA

- A. Submit under provisions of Division 1.
- B. Maintenance Data: Include installation instructions, spare parts lists, exploded assembly views.

1.09 DELIVERY, STORAGE, AND HANDLING

- A. Deliver, store, protect and handle products to site under provisions of Division 1.
- B. Accept specialties on site in original factory packaging. Inspect for damage.

1.10 EXTRA MATERIALS

- A. Furnish under provisions of Division 1.
- B. Provide two sets of loose keys for wall hydrants and hose end vacuum breakers.

PART 2 PRODUCTS

2.01 FLOOR DRAINS

- A. FD-1: Cast-iron rectangular floor drain with double drainage flange, bottom outlet inside caulk connection, 12-7/8" top, heavy-duty hinged grate, removable sediment bucket. With 4-1/4" diameter holes drilled in bottom of bucket.
Size: 6" → 4" ④
Josam No. 36620
Smith No. 2473
Wade No. W-1740
Or approved equal.

- B. FD-2: Cast-iron floor drain complete with bottom outlet inside caulk connection, 7" round top, and adjustable polished nikaloy strainer and funnel.
Size: ~~4"~~ 3" ^(3")
Josam No. 30000-E2
Smith No. 3510-F-11
Wade No. 1100-EF
Or approved equal.
- C. HD: Cast-iron body and flashing flange with nickel bronze strainer. Provide J.R. Smith 3580 funnel. Model J.R. Smith 2010-A, or approved equal.
Size: 4".

2.02 TRENCH DRAINS

- A. Cast iron multiple section drain with inside caulk outlet, flange and special duty (over 10,000 lbs.) ductile iron loose set grates. 24 foot total drain length. Pitch drain to 6" train outlet. Provide (12) 2 foot sections of total trench length. Model 2920 manufactured by WADE (or approved equal).

2.03 CLEANOUTS

- A. Interior Finished Floor Areas: Lacquered cast iron, two piece body with double drainage flange, weep holes, reversible clamping collar, and adjustable nickel-bronze strainer, round with flush cover in service areas and round with depressed cover to accept floor finish in finished floor areas; Model 4020 for tile floor areas. Model 4100 for areas subject to for truck and dolly traffic. Approved for substitutions.

2.04 WASHDOWN HOSE BIBBS

- A. Interior: Chrome plated brass with integral mounting flange, replaceable hexagonal disc, hose thread spout, chrome plated where exposed with handwheel integral vacuum breaker in conformance with ANSI/ASSE 1011; Model 952 manufactured by Chicago Faucet Co.

2.05 BACKFLOW PREVENTERS

- A. Reduced Pressure Backflow Preventers: ANSI/ASSE 1013 and AWWA C506; bronze body with bronze and plastic internal parts and stainless steel springs; two independently operating, spring loaded check valves; diaphragm type differential pressure relief valve located between check valves; third check valve which opens under back pressure in case of diaphragm failure; non-threaded vent outlet; assembled with two gate valves, strainer, and four test cocks; Model 825 as manufactured by FEBCO.

PART 3 EXECUTION

3.01 PREPARATION

- A. Coordinate cutting and forming of floor construction to receive drains to required invert elevations.

3.02 INSTALLATION

- A. Install in accordance with manufacturer's instructions.
- B. Extend cleanouts to finished floor or wall surface. Lubricate threaded cleanout plugs with mixture of graphite and linseed oil. Ensure clearance at cleanout for rodding of drainage system.
- C. Cross Connection Protection
 - 1. Backflow preventer type, application and installation shall comply with state requirements.
 - 2. Mount backflow preventers horizontally at heights and with clearances as required by State regulations.
 - a. Reduced pressure backflow preventers shall be installed between 36" to 48" above the floor with a minimum of 6" clear space all around.
 - 3. All backflow devices use for fire protection service shall also be UL/FM approved.
 - 4. Provide indirect waste piping with funnel to receive discharge from reduced pressure backflow preventer atmospheric vents and spill through air gap into floor drain.

END OF SECTION

Tom Anuszewski

Copy Harbor

3/21/96

Preliminary Spec. Review Notes

- * Fire extinguisher w/in 10' of welding and patching 20 lb. ABC.
- * Fire hose ^{@ supply} pressure, size and material as req'd or accepted by M.C.
- * Ground Fault protected.

Domestic Waste Water Line 8"

Process Waste }
Domestic Waste } 8"

White Box certified w/city?

Street Open Permit - all work in row.

Sealed Drain Permit - plugging of ^{device and} storm drain ^{service}

Floor Drains 4" & 6" ^{FD-2 FD-1}

24'-0" trough

Holding - Distribution Boxes

3/21/96 4" and 8" DW and 12" RCP class IV @
store drain CB3, plumbed. Not capped
existing yet. Backfilled w/ material.
Saw cutting floor to accommodate new 6"
and 4" floor drains in bathrooms.

Plumbing - Kelly Associates
Electrical - Eastern Electric
Roofing - ?
Asphalt - White Bros.

5/25/96 4" trunk turn - 3" FD

6/12/96: Preliminary C of I Inspection

- 1.) Fire Penetrations Mark-out ✓
- 2.) ANSI CERTIFICATION of GLASS WINDOW
- 3.) Fire Rated Ceiling Tiles ✓
- 4.) KEWT ASSOC. → Boiler Installation (Future)
- 5.) Handrail @ EXTERIOR ROOF STEPS ✓
- 6.) ALL TEST REPORTS: STEEL - WELDER'S CERT.
CONC. - REP. BATCH
SIUS - WHATEVER

? 7.) JIM SLYNNER WAS ON SITE - HAS HIS ISSUES?

- 8.) Lt. Mac needs proper reports/ACCEPTANCE
- 9.) Master box Tie in - not yet. Phone lines
- 10.) VERTICAL LIFT TEST REPORT ✓



Jim / Tie in

c TH 430

KNOX BOX

6/19/96 Final: Cof O Inspection

Signage Permit?

Met Sami A. Mordene - Seafood
Inspection Officer - he's very
confident that Cozy Harker
has a good operation of
all penetrations etc.

The balance of items to be submitted:

1.) All test reports : still cert.
: Core. (representatives)
: pits

2.) H. Mac : Tie in
: Knox box

3.) Vertical ~~Conveyer~~ ~~Conveyer~~
Load Test

COMMENTS

6/9/96

Checked framing Metal studs
OK to close in walls
Starting to insulate 5/8" fire rated
Sheetrock being installed.

6/11/96 Did Plumbing Inspection

6/19/96 Shetrock installed, now installing lights &
shelving, heating system being installed

6/26/96 Did final inspection everything ~~OK~~
Complete

Type	Inspection Record	Date
Foundation:	_____	_____
Framing:	_____	_____
Plumbing:	_____	_____
Final:	_____	_____
Other:	_____	_____

City of Portland, Maine - Building or Use Permit Application 389 Congress Street, 04101, Tel: (207) 874-8703, FAX: 874-8716

Location of Construction: 75 St John St		Owner: W N K D Ltm Labty Co	Phone:	Permit No: 960189
Address: lessee:	Leasee/Buyer's Name: Cozy Harbor,	Address: 253 Warren Ave- P1ld ME 04103	Phone: * 797-6152	Business Name:
Contractor Name: Brown Construction Inc	Proposed Use: fish processing	COST OF WORK: \$ 859,400	HERMIT FEE: \$ 4315	PERMIT ISSUED Permit Issued: MAR 22 1996 CITY OF PORTLAND
Past Use: wholesale/warehouse	FIRE DEPT. <input checked="" type="checkbox"/> Approved <input type="checkbox"/> Denied	INSPECTION: Use Group: 47 Type: 37	Signature: <i>[Signature]</i>	
Proposed Project Description: change/use with interior/exterior renovations of existing structure		Signature: <i>[Signature]</i>	Signature: <i>[Signature]</i>	Zoning: DCBL: Zoning Approval: <i>Processing</i> Special Zone or Reviews: <input type="checkbox"/> Shoreland <input type="checkbox"/> Wetland <input type="checkbox"/> Flood Zone <input type="checkbox"/> Subdivision <input type="checkbox"/> Site Plan <input type="checkbox"/> major <input type="checkbox"/> minor <input type="checkbox"/> mm <input type="checkbox"/>
Permit Taken By: L Chase	Date Applied For: 3/4/96	Signature: _____ Date: _____		PEDESTRIAN ACTIVITIES DISTRICT (P.A.D.) Action: <input type="checkbox"/> Approved <input type="checkbox"/> Approved with Conditions <input type="checkbox"/> Denied

- This permit application doesn't preclude the Applicant(s) from meeting applicable State and Federal rules. * (??site plan for addition??) *
- Building permits do not include plumbing, septic or electrical work.
- Building permits are void if work is not started within six (6) months of the date of issuance. False information may invalidate a building permit and stop all work.

(dumpster permit : 30 cy .. # ~~00116~~ - \$300)
 # 30-2509

PERMIT ISSUED WITH LETTER
call Jan 97-61
PERMIT ISSUED WITH LETTER

CERTIFICATION

I hereby certify that I am the owner of record of the named property, or that the proposed work is authorized by the owner of record and that I have been authorized by the owner to make this application as his authorized agent and I agree to conform to all applicable laws of this jurisdiction. In addition, if a permit for work described in the application issued, I certify that the code official's authorized representative shall have the authority to enter all areas covered by such permit at any reasonable hour to enforce the provisions of the code(s) applicable to such permit

14 March 1996

Edward Ghel
 SIGNATURE OF APPLICANT ADDRESS: _____ DATE: 3-4-96 PHONE: _____

RESPONSIBLE PERSON IN CHARGE OF WORK, TITLE PHONE: _____

White-Permit Desk Green-Assessor's Canary-D.P.W. Pink-Public File Ivory Card-Inspector

Zoning Appeal

- Variance
- Miscellaneous
- Conditional Use
- Interpretation
- Approved
- Denied

Historic Preservation

- Not in District or Landmark
- Does Not Require Review
- Requires Review

Action:

- Approved
- Approved with Conditions
- Denied

Date: 3/4/96
[Signature]

CEO DISTRICT **3**
A. Simpson