

1041-1043 CONGRESS STREET

STANLEY

100 cut # 020R - 100 cut # 0202R - 100 cut # 0203R - 100 cut # 0205R



APPLICATION FOR PERMIT  
DEPARTMENT OF BUILDING INSPECTIONS SERVICES  
ELECTRICAL INSTALLATIONS

Date Feb. 26, 19 80  
Receipt and Permit number A 45571

To the CHIEF ELECTRICAL INSPECTOR, Portland, Maine:

The undersigned hereby applies for a permit to make electrical installations in accordance with the laws of Maine, the Portland Electrical Ordinance, the National Electrical Code and the following specifications:

LOCATION OF WORK: 1043 Congress Street

OWNER'S NAME: Amelia A. Hamlin ADDRESS: lives there

		FEES
OUTLETS:		
Receptacles	Switches Plugmold	ft. TOTAL
FIXTURES: (number of)		
Incandescent	Flourescent (not strip) TOTAL	
Strip Flourescent	ft.	
SERVICES:		
Overhead	Underground Temporary	TOTAL amperes
METERS (number of)		
MOTORS (number of)		
Fractional		
1 HP or over		
RESIDENTIAL HEATING:		
Oil or Gas (number of units)	<u>XX</u>	3.00
Electric (number of rooms)		
COMMERCIAL OR INDUSTRIAL HEATING:		
Oil or Gas (by a main boiler)	<u>XXX</u>	<u>3.00</u>
Oil or Gas (by separate units)		
Electric Under 20 kws	Over 20 kws	
APPLIANCES (number of)		
Ranges	Water Heaters	
Cook Tops	Disposals	
Wall Ovens	Dishwashers	
Dryers	Compactors	
Fans	Others (denote)	
TOTAL		
MISCELLANEOUS: (number of)		
Branch Panels		
Transformers		
Air Conditioners Central Unit		
Separate Units (windows)		
Signs 20 sq. ft. and under		
Over 20 sq. ft.		
Swimming Pools Above Ground		
In Ground		
Fire/Burglar Alarms Residential		
Commercial		
Heavy Duty Outlets, 220 Volt (such as welders) 30 amps and under		
over 30 amps		
Circus, Fairs, etc.		
Alterations to wires		
Repairs after fire		
Emergency Lights, battery		
Emergency Generators		
FOR ADDITIONAL WORK NOT ON ORIGINAL PERMIT		INSTALLATION FEE DUE:
FOR REMOVAL OF A "STOP ORDER" (304-16.b)		DOUBLE FEE DUE:
		TOTAL AMOUNT DUE: 3.00

INSPECTION:

Will be ready on \_\_\_\_\_, 19\_\_\_\_; or Will Call 3-3-80

CONTRACTOR'S NAME: Ballard Oil & Equip

ADDRESS: 135 Marginal Way

TEL.: \_\_\_\_\_

MASTER LICENSE NO.: 1850

LIMITED LICENSE NO.: \_\_\_\_\_

SIGNATURE OF CONTRACTOR:

*Ballard Oil & Equip Co*  
*Jack H. Boyer*  
*Telephone # 1850*

INSPECTOR'S COPY — WHITE

OFFICE COPY — CANARY

CONTRACTOR'S COPY — GREEN

## —SNOBBERIES—

11

01/11/2020

ALL SPECIES

Case of Permit - 2-26-80

Small Inspection *W. G. C.*

Sy Inspector

**Permit Application No.**

1

\_\_\_\_\_

[illegible]

\_\_\_\_\_

2

77

1-7

10

22

15

2  
-5  
10

3

**g-i**

los  
ET

SP

S I

RI  
5  
π

RC

.

FE

7.

100



FILL IN AND SIGN WITH INK

00 114 PERMIT ISSUED  
FEB 26 1980  
CITY of PORTLAND

APPLICATION FOR PERMIT FOR  
HEATING, COOKING OR POWER EQUIPMENT

Portland, Maine,

Feb. 26, 1980

To the INSPECTOR OF BUILDINGS, PORTLAND, ME.

The undersigned hereby applies for a permit to install the following heating, cooking or power equipment in accordance with the Laws of Maine, the Building Code of the City of Portland, and the following specifications:

Location 1043 Congress St. Use of Building Dwelling - 1 family Stories 2 New Building Existing "  
Name and address of owner of appliance Amelia A. Hamlin  
Installer's name and address Ballard OIL & Equip-135 Margianl Way Telephone 772-1991

General Description of Work

To install Boiler & Burner - Replacement

IF HEATER, OR POWER BOILER

Location of appliance basement Any burnable material in floor surface or beneath? no  
If so, how protected? Kind of fuel? # 2 fuel oil  
Minimum distance to burnable material, from top of appliance or casing top of furnace 3 ft. all around  
From top of smoke pipe From front of appliance From sides or back of appliance  
Size of chimney flue 8 x 10 Other connections to same flue no  
If gas fired, how vented? Rated maximum demand per hour  
Will sufficient fresh air be supplied to the appliance to insure proper and safe combustion? yes

IF OIL BURNER

Name and type of burner Texaco Ignitor - gun Labelled by underwriters' laboratories? yes  
Will operator be always in attendance? no Does oil supply line feed from top or bottom of tank? bottom  
Type of floor beneath burner concrete Size of vent pipe 1 1/2  
Location of oil storage basement Number and capacity of tanks 1-275 gal.  
Low water shut off yes Make McDonald Miller No. 67  
Will all tanks be more than five feet from any flame? yes How many tanks enclosed? no  
Total capacity of any existing storage tanks for furnace burners 275 gal.

II COOKING APPLIANCE

Location of appliance Any burnable material in floor surface or beneath?  
If so, how protected? Height of Legs, if any  
Skirting at bottom of appliance? Distance to combustible material from top of appliance?  
From front of appliance From sides and back From top of smokepipe  
Size of chimney flue Other connections to same flue  
Is hood to be provided? If so, how vented? Forced or gravity?  
If gas fired, how vented? Rated maximum demand per hour

MISCELLANEOUS EQUIPMENT OR SPECIAL INFORMATION

Amount of fee enclosed: cost of work 300.00 5.50  
5.00  
10.50

APPROVED:

Will there be in charge of the above work a person competent to see that the State and City requirements pertaining thereto are observed?

CS 300

FILE COPY

Signature of Installer

*John J. [Signature]*



# CITY OF PORTLAND, MAINE Application for Permit to Install Wires

Permit No. *54-182*  
Issued *11/17*  
Portland, Maine *11/17*, 19*70*

To the City Electrician, Portland, Maine:

The undersigned hereby applies for a permit to install wires for the purpose of conducting electric current, in accordance with the laws of Maine, the Electrical Ordinance of the City of Portland, and the following specifications:

(This form must be completely filled out — Minimum Fee \$1.00)

Owner's Name and Address *Basil Hamer* Tel. *772-5788*  
Contractor's Name and Address *Basil Hamer* Tel. *772-5788*  
Location *1093 Congress St* Use of Building *dwelling*  
Number of Families *2* Apartments Stores Number of Stories  
Description of Wiring: New Work Additions Alterations *1*  
*Change service to 3 wire 10-220*  
Pipe Cable Metal Molding BX Cable Plug Molding (No. of feet)  
No. Light Outlets Plugs Light Circuits Plug Circuits  
FIXTURES: No. Fluor. or Strip Lighting (No. feet)  
SERVICE: Pipe Cable Underground No. of Wires Size  
METERS: Relocated Added Total No. Meters  
MOTORS: Number Phase H. P. Amps Volts Starter  
HEATING UNITS: Domestic (Oil) No. Motors Phase H. P.  
Commercial (Oil) No. Motors Phase H. P.  
Electric Heat (No. of Rooms)  
APPLIANCES: No. Ranges *1* Watts *750* Brand Feeds (Size and No.)  
Elec. Heaters Watts  
Miscellaneous Watts Extra Cabinets or Panels  
Transformers Air Conditioners (No. Units) Signs (No. Units)  
Will commence 19 Ready to cover in 19 Inspection 19  
Amount of Fee \$ *3.50*

Signed *Basil Hamer*

DO NOT WRITE BELOW THIS LINE

SERVICE	<input checked="" type="checkbox"/>	METER		GROUND	<input checked="" type="checkbox"/>
VISITS: 1	2	3	4	5	6
7	8	9	10	11	12

REMARKS:

INSPECTED BY

*76 H. H.*

(OVER)

LOCATION Cong. ST 1043  
 INS' ON DATE 12/2/70  
 WORK COMPLETED 12/2/70  
 TOTAL NO. INSPECTIONS  
 REMARKS:

# FEES FOR WIRING PERMITS EFFECTIVE JULY 31, 1963

WIRING	\$ 2.00
1 to 30 Outlets	3.00
31 to 60 Outlets	.05
Over 60 Outlets, each Outlet	
(Each twelve feet or fraction thereof of fluorescent lighting or	
any type of plug molding will be classed as one outlet).	
SERVICES	2.00
Single Phase	4.00
Three Phase	
MOTORS	3.00
Not exceeding 50 H.P.	4.00
Over 50 H.P.	
HEATING UNITS	2.00
Domestic (Oil)	4.00
Commercial (Oil)	.75
Electric Heat (Each Room)	
APPLIANCES	
Ranges, Cooking Tops, Ovens, Water Heaters, Disposals, Built-in	
Dishwashers, Dryers, and any permanent built-in appliance — each	
unit	
MISCELLANEOUS	1.00
Temporary Service Single Phase	2.00
Temporary Service Three Phase	10.00
Circuses, Carnival, etc.	1.00
Meters, relocate	1.00
Distribution Cabinet or Panel, per unit	2.00
Transformers, per unit	2.00
Air Conditioners, per unit	2.00
Signs, per unit	
ADDITIONS	1.00
5 Outlets, or less	
Over 5 Outlets, Regular Wiring Rates	

Date  
Issued **Jan 20, 1970**  
Portland Plumbing Inspector  
By **ERNOLD R. GOODWIN**

App. First Insp.

Date

By

App. First Insp.

Date

By

Type of Bldg.

- ☐ Commercial  
☐ Residential  
☐ Single  
☒ Multi Family  
☐ New Construction  
☐ Renodeling

PERMIT TO INSTALL PLUMBING

Address **1043 Congress St. (2nd fl)** PERMIT NUMBER **1047**

Issued For **dwelling**

Owner's Bldg **William Conlin**

Owner's Address **same**

Plumber **Ralph Blake** Date **1/20/70**

NEW REPL NO. FEE

SINKS

LAVATORIES

1 TOILETS 1

BATH TUBS

SHOWERS

DRAINS FLOOR SURFACE

HOT WATER TANKS

TANKLESS WATER HEATERS

GARBAGE DISPOSALS

SEPTIC TANKS

HOUSE SEWERS

ROOF LEADERS

AUTOMATIC WASHERS

DISHWASHERS

OTHER

TOTAL 1 2.00

Building and Inspection Services Dept.: Plumbing Inspection

# PERMIT TO INSTALL PLUMBING

Date Issued 7/24/67  
 PORTLAND PLUMBING INSPECTOR

By J. P. Welch  
 APPROVED FIRST INSPECTION

Date 7-25-67  
 By [Signature]  
 APPROVED FINAL INSPECTION

Date 7-25-67

By JOSEPH P. WELCH

- TYPE OF BUILDING  
☐ COMMERCIAL  
☐ RESIDENTIAL  
☐ SINGLE  
☐ MULTI FAMILY  
☐ NEW CONSTRUCTION  
☐ REMODELING

Address 1043 Congress Street  
 Installation For. Wesley Galbraith  
 Owner of Bldg. Wesley Galbraith  
 Owner's Address. 1043 Congress Street  
 Plumber: Eastern Oil Company

10442  
 PERMIT NUMBER

NEW	REPL	PROPOSED INSTALLATIONS	NUMBER	FEE
		SINKS		
		LAVATORIES		
		TOILETS		
		BATH TUBS		
		SHOWERS		
		DRAINS		
		HOT WATER TANKS		
		TANKLESS WATER HEATERS		
		GARBAGE GRINDERS		
		SEPTIC TANKS		
		HOUSE SEWERS		
		ROOF LEADERS (Conn to house drain)		
1			1	\$ 2.00

PORTLAND HEALTH DEPT. PLUMBING INSPECTION TOTAL ▶ \$ 2.00



12-53 ☐ PORTLAND

PLUMBING INSPECTION	Total	1.00
---------------------	-------	------

PORTLAND HEALTH DEPT.

PLUMBING INSPECTION

Total	1.00
-------	------



FILL IN AND SIGN WITH INK

APPLICATION FOR PERMIT FOR  
HEATING, COOKING OR POWER EQUIPMENT

Portland, Maine, July 15, 1961

PERMIT ISSUED

JUL 14 1961

CITY of PORTLAND

To the INSPECTOR OF BUILDINGS, PORTLAND, ME.

The undersigned hereby applies for a permit to install the following heating, cooking or power equipment in accordance with the Laws of Maine, the Building Code of the City of Portland, and the following specifications:

Location 1043 Congress Street Use of Building 2-family dwg. No. Stories 2 New Building Existing "  
Name and address of owner of appliance Wesley Galkraith, 1043 Congress St.  
Installer's name and address Eastern Oil & Equip. Co., 27 Portland St. Telephone

General Description of Work

To install oil-fired steam boiler and oil burner (replacement)

IF HEATER, OR POWER BOILER

Location of appliance basement Any burnable material in floor surface or beneath? no  
If so, how protected? Kind of fuel? oil  
Minimum distance to burnable material, from top of appliance or casing top of furnace 3'  
From top of smoke pipe 3' From front of appliance 4' From sides or back of appliance 3'  
Size of chimney flue 8x10 Other connections to same flue ~~gas fired water heat~~  
If gas fired, how vented? Rated maximum demand per hour  
Will sufficient fresh air be supplied to the appliance to insure proper and safe combustion? yes

IF OIL BURNER

Name and type of burner Richmond Labelled by underwriters' laboratories? yes  
Will operator be always in attendance? Does oil supply line feed from top or bottom of tank? bottom  
Type of floor beneath burner concrete Size of vent pipe 6x existing  
Location of oil storage basement Number and capacity of tanks existing  
Low water shut off yes Make McDonnell-Killer No. 69  
Will all tanks be more than five feet from any flame? How many tanks enclosed?  
Total capacity of any existing storage tanks for furnace burners none

IF COOKING APPLIANCE

Location of appliance Any burnable material in floor surface or beneath?  
If so, how protected? Height of Legs, if any  
Skirting at bottom of appliance? Distance to combustible material from top of appliance?  
From front of appliance From sides and back From top of smokepipe  
Size of chimney flue Other connections to same flue  
Is hood to be provided? If so, how vented? Forced or gravity?  
If gas fired, how vented? Rated maximum demand per hour

MISCELLANEOUS EQUIPMENT OR SPECIAL INFORMATION

Amount of fee enclosed? 2.00 (\$2.00 for one heater, etc., 50 cents additional for each additional heater, etc., in same building at same time.)

APPROVED

7/13/61

Will there be in charge of the above work a person competent to see that the State and City requirements pertaining thereto are observed? yes

Eastern Oil & Equip. Co.

Signature of Installer By: 3. F. F. F.

CS 300

INSPECTION COPY

7.24

Permit No. 601/839  
 Location 104.2 Congress St.  
 Owner Wm. R. D. Smith  
 Date of permit 1/14/61  
 Approved 1/14/61, R. J. D.

NOTES

1	Fire Dept.	
2	Post Office	
3	Kind of Work	5/16/61
4	Barriers, Safety & Signage	
5	Name of Level	
6	Stack Control	
7	Edge of Work Area	
8	Stack Control	
9	Trailing Safety Protection	
10	Valve and Control	
11	Exhaust System	
12	Tank & Support	
13	Tank & Support	
14	Oil Gauge	
15	Oil Gauge	
16	Oil Gauge	

REPRODUCTION OF PERMIT IN 2-1-61



FILL IN COMPLETELY AND SIGN WITH INK

# APPLICATION FOR PERMIT FOR HEATING, COOKING OR POWER EQUIPMENT

PERMIT ISSUED

Permit No. 1740

August 27, 1942

To the INSPECTOR OF BUILDINGS, PORTLAND, ME.

The undersigned hereby applies for a permit to install the following heating, cooking or power equipment in accordance with the Laws of Maine, the Building Code of the City of Portland, and the following specifications:

Location 1674 Congress Street Use of Building dwelling house No. Stories 2 2nd Building  
Name and address of owner of appliance Leslie J. Colburn, 1674 Congress St. Existing "  
Installer's name and address Harris Oil Co., 17 Main St., So. Portland Telephone 2-1514

## General Description of Work

To install two oil furnace equipments, in connection with steam heat (2) DIFF. ST. C. 1674

IF HEATER, POWER BOILER OR COOKING DEVICE  
Is appliance or source of heat to be in cellar? yes If not, which story \_\_\_\_\_  
Material of supports of appliance (concrete floor or what kind) concrete Kind of Fuel oil  
Minimum distance to wood or combustible material, from top of appliance or casing top of furnace, \_\_\_\_\_  
from top of smoke pipe \_\_\_\_\_ from front of appliance \_\_\_\_\_ from sides or back of appliance \_\_\_\_\_  
Size of chimney flue \_\_\_\_\_ Other connections to same flue \_\_\_\_\_

## IF OIL BURNER

Name and type of burner Paraffin Heat Labeled and approved by Underwriters' Laboratories? yes  
Will operator be always in attendance? \_\_\_\_\_ Type of oil feed (gravity or pressure) gravity  
Location oil storage basement No. and capacity of tanks 1 275 gallons for each  
Will all tanks be more than 5 feet from any flange? yes How many tanks fireproofed? \_\_\_\_\_  
Amount of fee enclosed? 1.50 (\$1.00 for one heater, etc., 50 cents additional for each additional heater, etc., in same building at same time.)

INSPECTION COPY

Signature of Installer Harris Oil Co.

Permit No. 40/1223  
Location 1043 Angers St.  
Owner W. H. Galbraith  
Date of Permit 8/27/40

Post Card sent

Notif. for insp. None

Approval 3/8/41. C. H.

Oil Burner Check List (date) 3/8/41.

- |  |   |                                     |
|--|---|-------------------------------------|
| 1. Kind of heat                                  | <u>Steam</u>                                      |                                     |
| 2. Label   | <u>538332</u>                                     |                                     |
| 3. Anti-siphon                                   |   | <input checked="" type="checkbox"/> |
| 4. Oil storage                                   |   | <input checked="" type="checkbox"/> |
| 5. Tank distance                                 |   | <input checked="" type="checkbox"/> |
| 6. Vent Pipe                                     |   | <input checked="" type="checkbox"/> |
| 7. Fill Pipe                                     |   | <input checked="" type="checkbox"/> |
| 8. Gauge   |   | <input checked="" type="checkbox"/> |
| 9. Rigidity                                      |   | <input checked="" type="checkbox"/> |
| 10. Feed safety                                  |   | <input checked="" type="checkbox"/> |
| 11. Pipe sizes and material                      |   | <input checked="" type="checkbox"/> |
| 12. Control valve                                |   | <input checked="" type="checkbox"/> |
| 13. Ash pit vent                                 |   | <input checked="" type="checkbox"/> |
| 14. Temp. or pressure safety                     |   | <input checked="" type="checkbox"/> |
| 15. Instruction card                             | <u>Transcript to Stat (Sent Wm. H. Galbraith)</u> | <input checked="" type="checkbox"/> |
| 16. <u>Transcript to Stat in envelope (Sent)</u> |   | <input checked="" type="checkbox"/> |

NOTES

4/23/41. Perone ins. C. H.





# APPLICATION FOR PERMIT PERMIT ISSUED 0519

Class of Building or Type of Structure Third Class

Portland, Maine, May 10, 1940 MAY 10 1940

To the INSPECTOR OF BUILDINGS, PORTLAND, ME.

The undersigned hereby applies for a permit to ~~erect~~ alter ~~install~~ the following building ~~structure~~ ~~equipment~~ in accordance with the Laws of the State of Maine, the Building Code of the City of Portland, plans and specifications, if any, submitted herewith and the following specifications:

Location 1043 Congress Street Within Fire Limits? no Dist. No. \_\_\_\_\_  
Owner's or lessee's name and address W. H. Galbraith, 1043 Congress St. Telephone 2-8972  
Contractor's name and address Owner Telephone \_\_\_\_\_  
Architect \_\_\_\_\_ Plans filed no No. of sheets \_\_\_\_\_  
Proposed use of building \_\_\_\_\_ No. families \_\_\_\_\_  
Other buildings on same lot dwelling - garage applied for  
Estimated cost \$ \_\_\_\_\_ Fee \$ .50

## Description of Present Building to be Altered

Material wood No. stories 1 Heat \_\_\_\_\_ Style of roof \_\_\_\_\_ Roofing \_\_\_\_\_  
Last use Storage Shed No. families \_\_\_\_\_

## General Description of New Work

To demolish existing shed 10'x 22' to sewer connection

It is understood that this permit does not include installation of heating apparatus which is to be taken out separately by and in the name of the heating contractor.

## Details of New Work

Is any plumbing work involved in this work? \_\_\_\_\_  
Is any electrical work involved in this work? \_\_\_\_\_ Height average grade to top of plate \_\_\_\_\_  
Size, front \_\_\_\_\_ depth \_\_\_\_\_ No. stories \_\_\_\_\_ Height average grade to highest point of roof \_\_\_\_\_  
To be erected on solid or filled land? \_\_\_\_\_ earth or rock? \_\_\_\_\_  
Material of foundation \_\_\_\_\_ Thickness, top \_\_\_\_\_ bottom \_\_\_\_\_ cellar \_\_\_\_\_  
Material of underpinning \_\_\_\_\_ Height \_\_\_\_\_ Thickness \_\_\_\_\_  
Kind of Roof \_\_\_\_\_ Rise per foot \_\_\_\_\_ Roof covering \_\_\_\_\_  
No. of chimneys \_\_\_\_\_ Material of chimneys \_\_\_\_\_ of lining \_\_\_\_\_  
Kind of heat \_\_\_\_\_ Type of fuel \_\_\_\_\_ Is gas fitting involved? \_\_\_\_\_  
Framing Lumber—Kind \_\_\_\_\_ Dressed or Full Size? \_\_\_\_\_  
Corner posts \_\_\_\_\_ Sills \_\_\_\_\_ Girt or ledger board? \_\_\_\_\_ Size \_\_\_\_\_  
Material columns under girders \_\_\_\_\_ Size \_\_\_\_\_ Max. on centers \_\_\_\_\_  
Studs (outside walls and carrying partitions) 2x4-16" O. C. Girders 6x8 or larger. Bridging in every floor and flat roof span over 8 feet. Sills and corner posts all one piece in cross section.  
Joists and rafters: 1st floor \_\_\_\_\_, 2nd \_\_\_\_\_, 3rd \_\_\_\_\_, roof \_\_\_\_\_  
On centers: 1st floor \_\_\_\_\_, 2nd \_\_\_\_\_, 3rd \_\_\_\_\_, roof \_\_\_\_\_  
Maximum span: 1st floor \_\_\_\_\_, 2nd \_\_\_\_\_, 3rd \_\_\_\_\_, roof \_\_\_\_\_  
If one story building with masonry walls, thickness of walls? \_\_\_\_\_ height? \_\_\_\_\_

## If a Garage

No. cars now accommodated on same lot \_\_\_\_\_, to be accommodated \_\_\_\_\_  
Total number commercial cars to be accommodated \_\_\_\_\_  
Will automobile repairing be done other than minor repairs to cars habitually stored in the proposed building? \_\_\_\_\_

## Miscellaneous

Will above work require removal or disturbing of any shade tree on a public street? no  
Will there be in charge of the above work a person competent to see that the State and City requirements pertaining thereto are observed? yes

Signature of owner W. H. Galbraith

INSTRUCTION COPY

Permit No. 40/519

Location 1043 Congress St.

Owner W. H. Gallia H.

Date of permit 5/10/40

Notif. closing

Inspn. closing-in

Final Notif.

Final Inspn. 10/29/40

Cert. of Occupancy issued None

NOTES

9/11/40 - New garage  
completed but old  
building not yet  
demolished - OK

10/29/40 - Work completed -  
O.G.S.

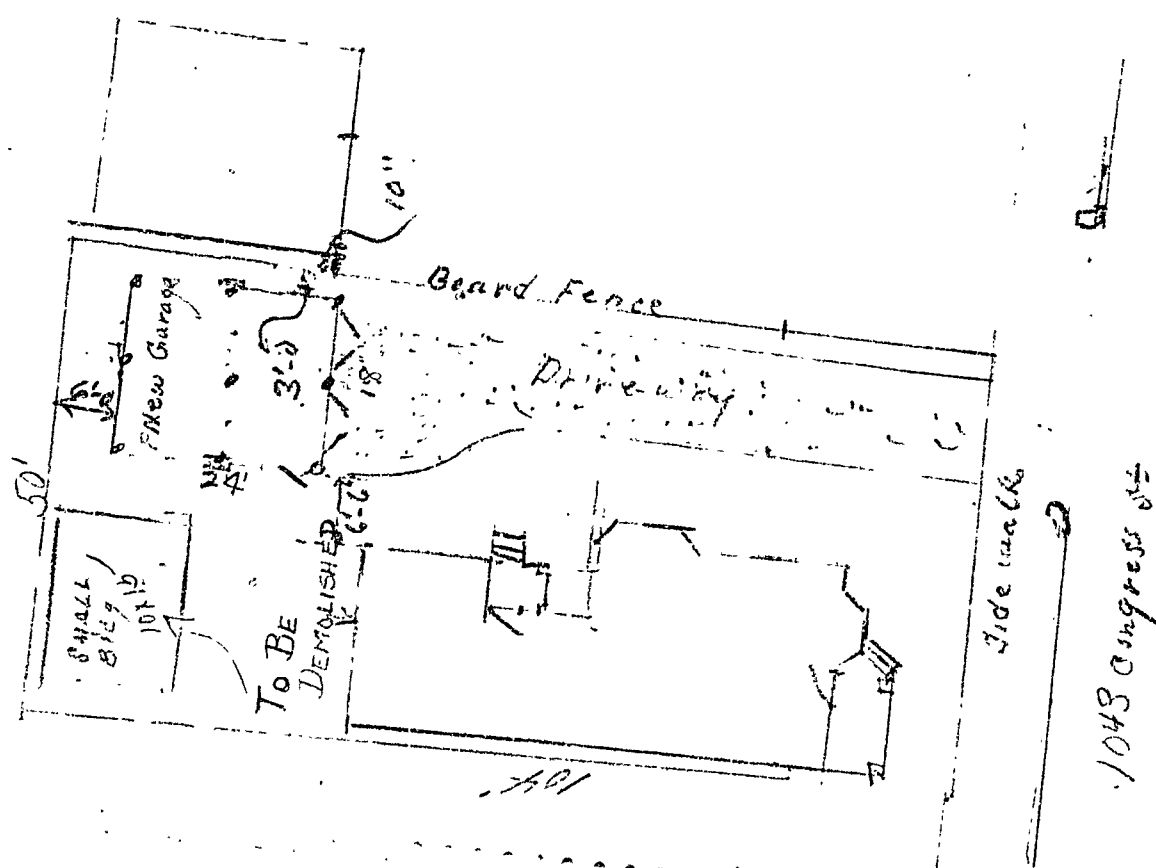

STATEMENT ACCOMPANYING APPLICATION FOR BUILDING PERMIT

for 2-car garage  
at 1043 Congress Street Date 5/7/40

1. In whose name is the title of the property now recorded? W. H. Galbraith
2. Are the boundaries of the property in the vicinity of the proposed work shown clearly on the ground, and how? stakes
3. Is the outline of the proposed work now staked out upon the ground? yes If not, will you notify the Inspection Office when the work is staked out and before any of the work is commenced?
4. What is to be maximum projection or overhang of eaves or drip? 8 x 12
5. Do you assume full responsibility for the correctness of the location plan or statement of location filed with this application, and does it show the complete outline of the proposed work on the ground, including bay windows, porches and other projections? yes
6. Do you assume full responsibility for the correctness of all statements in the application concerning the sizes, design and use of the proposed building? yes
7. Do you understand that in case changes are proposed in the location of the work or in any of the details specified in the application that a revised plan and application must be submitted to this office before the changes are made? yes

W. H. Galbraith



# APPLICATION FOR PERMIT

Class of Building or Type of Structure Third Class

Permit No. 101

**PERMIT ISSUED**

To the INSPECTOR OF BUILDINGS, PORTLAND, ME.

Portland, Maine, May 7, 1940

MAY 10 1940

The undersigned hereby applies for a permit to erect ~~when install~~ the following building ~~structure~~ equipment in accordance with the Laws of the State of Maine, the Building Code of the City of Portland, plans and specifications, if any, submitted herewith and the following specifications:

Location 1043 Congress Street  
Owner's or Lessee's name and address W. H. Galbraith, 1043 Congress St. Within Fire Limits? no Dist. No.       
Contractor's name and address Owner Telephone 2-8972  
Architect      Telephone       
Proposed use of building 2 car garage Plans filed yes No. of sheets 1  
Other buildings on same lot 2 family dwelling, shed No. families       
Estimated cost \$ 240. Fee \$ .75  
Description of Present Building to be Altered  
Material      No. stories      Heat      Style of roof      Roofing       
Last use      No. families     

## General Description of New Work

To erect two car frame garage ~~18' x 24'~~ 18' x 24'

It is understood that this permit does not include installation of heating apparatus which is to be taken out separately by and in the name of the heating contractor.

## Details of New Work

Is any plumbing work involved in this work?       
Is any electrical work involved in this work?       
Size, front 18' depth 24' No. stories 1 Height average grade to top of plate 9'  
To be erected on solid or filled land? solid Height average grade to highest point of roof 15'  
Material of foundation concrete piers Thickness, top      bottom      cellar       
Material of underpinning      Height      Thickness       
Kind of Roof pitch Rise per foot of 8" Roof covering Asphalt roofing Class C Und. Lbr.  
No. of chimneys no Material of chimneys      of lining       
Kind of heat no Type of fuel      Is gas fitting involved?       
Framing Lumber—Kind hemlock Dressed or Full Size? dressed full size  
Corner posts 4x4 Sills 4x6 Girt or ledger board?      Size       
Material columns under girders      Size      Max. on centers       
Studs (outside walls and carrying partitions) 2x4-16" O. C. Girders 6x8 or larger. Bridging in every floor and flat roof span over 8 feet. Sills and corner posts all one piece in cross section.  
Joists and rafters: 1st floor 2x6 plank, 2nd     , 3rd     , roof 2x4  
On centers: 1st floor 2x6 plank, 2nd     , 3rd     , roof 2x4  
Maximum span: 1st floor 12', 2nd     , 3rd     , roof       
If one story building with masonry walls, thickness of walls 6x8 thru center full size, 9' span height?     

## If a Garage

No. cars now accommodated on same lot none, to be accommodated 2  
Total number commercial cars to be accommodated none  
Will automobile repairing be done other than minor repairs to cars habitually stored in the proposed building? no

## Miscellaneous

Will above work require removal or disturbing of any shade tree on a public street? no  
Will there be in charge of the above work a person competent to see that the State and City requirements pertaining thereto are observed? yes

INSTRUCTION COPY

Signature of owner

W. H. Galbraith

550



Permit No. 40/518  
Location 1043 Congress Street  
Owner W. H. Galbraith  
Date of permit 5/10/40  
Notif. closing-in  
Inspn. closing-in  
Final Notif.  
Final Inspn. 7/11/40  
Cert. of Occupancy issued

NOTES

5/17/40 - 1st floor  
5/17/40 - 2nd floor  
5/24/40 - 3rd floor  
7/1/40 - frame  
7/11/40 - 1st floor  
8/6/40 - 2nd floor  
8/20/40 - 3rd floor  
9/14 - 1st floor completed



## APPLICATION FOR PERMIT

Class of Building or Type of Structure 3rd

Portland, Maine, 1044 Oct 25 1927

PERMIT ISSUED  
Permit No. 5103

OCT 25 1927

To the INSPECTOR OF BUILDINGS, PORTLAND, ME.

The undersigned hereby applies for a permit to ~~erect~~ alter ~~install~~ the following building ~~structure~~ in accordance with the Laws of the State of Maine, the Building Code of the City of Portland, plans and specifications, if any, submitted herewith and the following specifications:

Location 1039 Congress St. 1041-1043 Ward 7 Within Fire Limits? no Dist. No. \_\_\_\_\_  
Owner's or Lessee's name and address Wesley R. Galbraith 18 Huntress St. Telephone F641  
Contractor's name and address Owner Telephone \_\_\_\_\_  
Architect's name and address \_\_\_\_\_  
Proposed use of building Dwelling House No. families 2  
Other buildings on same lot \_\_\_\_\_

### Description of Present Building to be Altered

Material wood No. stories 2 1/2 Heat \_\_\_\_\_ Style of roof \_\_\_\_\_ Roofing \_\_\_\_\_  
Last use Dwelling House No. families 2

### General Description of New Work

Cut in 1 Window in rear 1st floor in pantry

CERTIFICATE OF OCCUPANCY  
REQUIREMENT IS WAIVED  
NOTED BY  
AS CLERK OF THE CITY

### Details of New Work

Size, front \_\_\_\_\_ depth \_\_\_\_\_ No. stories \_\_\_\_\_ Height average grade to highest point of roof \_\_\_\_\_  
To be erected on solid or filled land? \_\_\_\_\_ earth or rock? \_\_\_\_\_  
Material of foundation \_\_\_\_\_ Thickness, top \_\_\_\_\_ bottom \_\_\_\_\_  
Material of underpinning \_\_\_\_\_ Height \_\_\_\_\_ Thickness \_\_\_\_\_  
Kind of roof \_\_\_\_\_ Roof covering \_\_\_\_\_  
No. of chimneys \_\_\_\_\_ Material of chimneys \_\_\_\_\_ of lining \_\_\_\_\_  
Kind of heat \_\_\_\_\_ Type of fuel \_\_\_\_\_ Distance, heater to chimney \_\_\_\_\_  
If oil burner, name and model \_\_\_\_\_  
Capacity and location of oil tanks \_\_\_\_\_  
Is gas fitting involved? \_\_\_\_\_ Size of service \_\_\_\_\_  
Corner posts \_\_\_\_\_ Sills \_\_\_\_\_ Girt or ledger board? \_\_\_\_\_ Size \_\_\_\_\_  
Material columns under girders \_\_\_\_\_ Size \_\_\_\_\_ Max. on centers \_\_\_\_\_  
Studs (outside walls and carrying partitions) 2x4 16" O. C. Girders 6x8 or larger. Bridging in every floor and flat roof span over 8 feet. Sills and corner posts all one piece in cross section.  
Joists and rafters: 1st floor \_\_\_\_\_, 2nd \_\_\_\_\_, 3rd \_\_\_\_\_, roof \_\_\_\_\_  
On centers: 1st floor \_\_\_\_\_, 2nd \_\_\_\_\_, 3rd \_\_\_\_\_, roof \_\_\_\_\_  
Maximum span: 1st floor \_\_\_\_\_, 2nd \_\_\_\_\_, 3rd \_\_\_\_\_, roof \_\_\_\_\_  
If one story building with masonry walls, thickness of walls? \_\_\_\_\_ height? \_\_\_\_\_

### If a Garage

No. cars now accommodated on same lot \_\_\_\_\_, to be accommodated \_\_\_\_\_  
Total number commercial cars to be accommodated \_\_\_\_\_  
Will automobile repairing be done other than minor repairs to cars habitually stored in the proposed building? \_\_\_\_\_

### Miscellaneous

Will above work require removal or disturbing of any shade tree on a public street? no  
Plans filed as part of this application? no No. sheets \_\_\_\_\_  
Estimated cost \$ 16 Fee \$ .25  
Will there be in charge of the above work a person competent to see that the State and City requirements pertaining thereto are observed? yes

INSPECTION COPY

Signature of owner \_\_\_\_\_

5104

Ward 10th Permit No. 27103  
Location 1037 Custer St.  
Owner Wesley H. Gallbreith  
Date of permit Oct 27/37  
Cost of work in       
Inspection by       
Final No.       
Final Insp.       
Cert. of Occupancy issued     

NOTES

*[The following section contains a large, faint, and mostly illegible handwritten note or sketch, possibly a floor plan, which has been crossed out with a large 'X'. The text is too faded to transcribe accurately.]*