

BURNHAM STREET



INQUIRY BLANK

ZONE "I"

FIRE DIST. 211

CITY OF FORTLAND, MAINE  
DEPARTMENT OF BUILDING INSPECTION

Verbal  
By Telephone

Date 11/29/47

LOCATION 19 Burnham St. OWNER Michael Morris

MADE BY Benson Norton TEL. 2-2544

ADDRESS 150 Fenway St.

PRESENT USE OF BUILDING Warehouse

CLASS OF CONSTRUCTION frame NO. OF STORIES 1

REMARKS: Last use warehouse

INQUIRY: Could this bldg. be used for warehouse  
and carpenter shop with porches?

ANSWER: zone OK. Did not want to give him  
OK use of power saw. Would have  
given answer P.H.

Told him about question of noise  
of saw but that it may be a somewhat  
difficultly. Also of requirements  
of Bldg Code as to heat.

DATE OF REPLY 11/29/47 REPLY BY [Signature]

BI '76

STATEMENT ACCOMPANYING APPLICATION FOR BUILDING PERMIT

for Storage shed  
at Easterly End of Birmham St.

Date 9/26/30

1. In whose name is the title of the property now recorded? .....
2. Are the boundaries of the property in the vicinity of the proposed work shown clearly on the ground, and how? Stakes .....
3. Is the outline of the proposed work now staked out upon the ground? yes If not, will you notify the Inspection Office when the work is staked out and before any of the work is commenced? .....
4. What is to be maximum projection or overhang of eaves or drip? 8" .....
5. Do you assume full responsibility for the correctness of the location plan or statement of location filed with this application, and does it show the complete outline of the proposed work on the ground, including bay windows, porches and other projections? yes .....
6. Do you assume full responsibility for the correctness of all statements in the application concerning the sizes, design and use of the proposed building? yes .....
7. Do you understand that in case changes are proposed in the location of the work or in any of the details specified in the application that a revised plan and application must be submitted to this office before the changes are made? yes .....

M E Reddaway Co  
By J. J. Foggy



PERMIT  
SEP 28 1930

# APPLICATION FOR PERMIT

Class of Building or Type of Structure Third Class

Portland, Maine, September 26, 1930

To the INSPECTOR OF BUILDINGS, PORTLAND, ME.

The undersigned hereby applies for a permit to erect alter ~~to~~ the following building structure equipment in accordance with the Laws of the State of Maine, the Building Code of the City of Portland, plans and specifications, if any, submitted herewith and the following specifications:

Location Easterly End of Barnham Street Ward 7 Within Fire Limits?  Dist. No. \_\_\_\_\_

Owner's or Lessee's name and address H. E. Hedlon Co., 60 Union Telephone 1730

Contractor's name and address \_\_\_\_\_ Telephone \_\_\_\_\_

Architect's name and address \_\_\_\_\_

Proposed use of building Storage of contractor's equipment No. families \_\_\_\_\_

Other buildings on same lot none

Plans filed as part of this application?  No. of sheets 1

Estimated cost \$ 500. Fee \$ .75

### Description of Present Building to be Altered

Material \_\_\_\_\_ No. stories \_\_\_\_\_ Heat \_\_\_\_\_ Style of roof \_\_\_\_\_ Roofing \_\_\_\_\_

Last use \_\_\_\_\_ No. families \_\_\_\_\_

### General Description of New Work

To erect one story frame building 28' x 60'

It is understood that this permit does include installation of heating apparatus which is to be taken out separately by and in the name of the heating contractor.

### Details of New Work

Size, front 60' depth 22' No. stories 1 Height average grade to top of plate \_\_\_\_\_  
Height average grade to highest point of roof 22'

To be erected on solid or filled land? solid earth or rock? earth

Material of foundation wood posts on stone Thickness, top \_\_\_\_\_ bottom \_\_\_\_\_

Material of underpinning \_\_\_\_\_ Height \_\_\_\_\_ Thickness \_\_\_\_\_

Kind of Roof pitch Rise per foot 6" Roof covering Asphalt roofing Class 0 Und. Lab.

No. of chimneys no Material of chimneys \_\_\_\_\_ of lining \_\_\_\_\_

Kind of heat no Type of fuel \_\_\_\_\_ Is gas fitting involved? \_\_\_\_\_

Corner posts no Sills 8x8 Girt or ledger board? \_\_\_\_\_ Size \_\_\_\_\_

Material columns under girders \_\_\_\_\_ Size \_\_\_\_\_ Max. on centers \_\_\_\_\_

Studs (outside walls and carrying partitions) 2x4-16" O.C. Girders 6x8 or larger. Bridging in every floor and flat roof span over 8 feet. Sills and corner posts all one piece in cross section.

Joists and rafters: 1st floor 2x10 - various, 2nd \_\_\_\_\_, 3rd \_\_\_\_\_, roof 2x6

On centers: 1st floor 14", 2nd \_\_\_\_\_, 3rd \_\_\_\_\_, roof 19" 24"

Maximum span: 1st floor 11', 2nd \_\_\_\_\_, 3rd \_\_\_\_\_, roof \_\_\_\_\_

If one story building with masonry walls, thickness of walls? \_\_\_\_\_ height? \_\_\_\_\_

### If a Garage

No. cars now accommodated on same lot \_\_\_\_\_, to be accommodated \_\_\_\_\_

Total number commercial cars to be accommodated \_\_\_\_\_

Will automobile repairing be done other than minor repairs to cars habitually stored in the proposed building? \_\_\_\_\_

### Miscellaneous

Will above work require removal or disturbing of any shade tree on a public street? no

Will there be in charge of the above work a person competent to see that the State and City requirements pertaining thereto are observed? yes

H. E. Hedlon Co.

Signature of owner By \_\_\_\_\_

*J. Hedlon*

INSPECTION COPY

3/5/93

War No. 7 Permit No. 30/2153  
 Location Local Bazaar  
 Owner P. E. Redford  
 Date of permit 7/30/30  
 Notif. closi \_\_\_\_\_  
 Inspn closing-in \_\_\_\_\_  
 Final Notif. \_\_\_\_\_  
 Inspn \_\_\_\_\_  
 Cert. of Occupancy issued \_\_\_\_\_

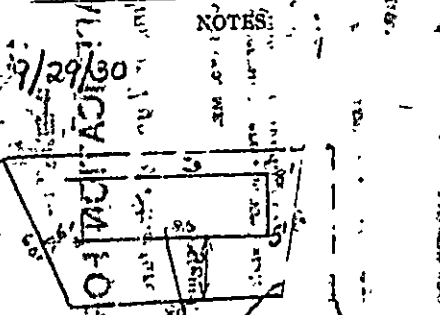

Location: No regards lot  
 lines was placed as near  
 as I can check at present  
 of as shown on plat plan  
 submitted. Required dis-  
 tances have been noticed  
 all sides. However  
 has been  
 as will be  
 in turn  
 of rain

It is about 30' square  
 by 12' wide, lying on  
 top of ground. This  
 structure is a local  
 building, the lot  
 having been used as  
 a dump for ashes &  
 rubbish. There are  
 are odd sizes about 12'  
 o.c. ranging from  
 2x12, 6x6, up to 3x12  
 & 4x12 - A.J.  
 10/6/30 - It is a  
 structure, etc. It  
 sets on top of floor  
 of which is made of  
 of which is down to  
 This is one hand  
 number as per day  
 no through wall  
 result A.J.  
 10/15/30 - Meeting on  
 held. Only 1/2 allows  
 as noted from permit  
 A.J.

