



APPLICATION FOR PERMIT

PREPARED BY

Class of Building or Type of Structure Garage

Portland, Maine, April 27 1927 APR 30 1927

To the INSPECTOR OF BUILDINGS, PORTLAND, ME.

The undersigned hereby applies for a permit to alter the following building structure garage in accordance with the laws of the State of Maine, the Building Code of the City of Portland, plans and specifications, if any, submitted herewith and the following specifications:

Location 1130 Congress St., 421157-115, Congress 21, 1927 Ward 6 Within Fire Limits? no Dist. No. ---

Owner's or owner's name and address Edward C. Carter 1130 Congress St. Telephone 7 8807

Contractor's name and address --- Telephone ---

Architect's name and address ---

Proposed use of building Private Garage 1 Car No. families ---

Other buildings on same lot Dwelling House

Description of Present Building to be Altered

Material wood No. stories 1 Heat no Style of roof Pitch Roofing asphalt shingles

Last use Private Garage 1 Car No. families ---

General Description of New Work

Build addition 6'-0" x 18'-0" to present garage

CERTIFICATE OF COMPLETION
REQUIREMENT IS WAIVED
FOR CITY

Details of New Work

Size, front 6 depth 10 No. stories 1 Height average grade to highest point of roof 11'

To be erected on solid or filled land? solid earth or rock? ---

Material of foundation Concrete Thickness, top --- bottom ---

Material of underpinning --- Height --- Thickness ---

Kind of roof Pitch Roof covering asphalt shingles

No. of chimneys none Material of chimneys --- of lining ---

Kind of heat none Type of fuel --- Distance, heater to chimney ---

If oil burner, name and model ---

Capacity and location of oil tanks ---

Is gas fitting involved? no Size of service ---

Corner post 4x4 Sill 2x4 Girt or ledger board? --- Size ---

Material columns under girders --- Size --- Max. on center ---

Studs (outside walls and carrying partitions) 2x4-16" O.C. Girders 6x8 or larger. Bridging in every floor and flat roof span over 8 feet. Sills and corner posts all one piece in each section.

Joists and rafters: 1st floor ceasing 2nd --- 3rd --- roof 2x8

On centers: 1st floor --- 2nd --- 3rd --- roof 24"

Maximum span: 1st floor --- 2nd --- 3rd --- roof ---

If one story building with masonry walls, thickness of walls? --- height? ---

If a Garage: No. cars now accommodated on same lot 1 to be accommodated 1

Total number commercial cars to be accommodated no

Will automobile repairing be done other than minor repairs to cars usually stored in the proposed building? no

Miscellaneous

Will above work require removal or disturbing of any shade tree on a public street? no

Plans filed as part of this application? yes No sheets 1

Estimated cost \$ 100.00 Fee \$ 1.00

Will there be in charge of the above work a person competent to see that State and City requirements pertaining thereto are observed? yes

APPROVED COPY Signature of owner

Oliver J. Saubert

3413

Ward 8 Permit No. 523 H
Area 1130
Owner Edw. C. Barte
Date of permit 4/20/27
Notif. closing-1.
In. u. closing-in
Final Notif. 5/23/27
Final Inspn.
Cert. of Occupancy Issued

NOTES

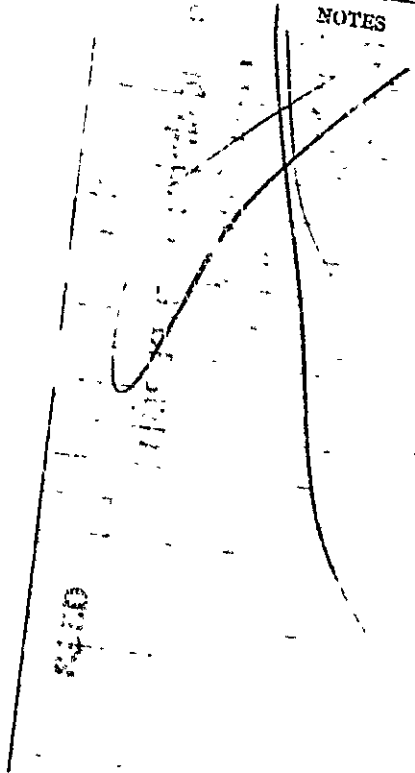

No.	Date	Inspector	Remarks
1			
2			
3			
4			
5			
6			
7			
8			
9			
10			
11			
12			
13			
14			
15			
16			
17			
18			
19			
20			
21			
22			
23			
24			
25			
26			
27			
28			
29			
30			
31			
32			
33			
34			
35			
36			
37			
38			
39			
40			
41			
42			
43			
44			
45			
46			
47			
48			
49			
50			



Location, Ownership and detail must be correct, complete and legible.
 Responsible for compliance with the law, whether you know the requirements or not.
 Separate application required for every building.
 Plans must be filed with this application.

Application for Permit for Alterations, etc.

READ this Application and Get All Questions Settled BEFORE Commencing Work.

Portland, Me., June 2/25 19

To the Failure To Do So
 Inspector of Buildings:
 PENALTY!

The undersigned applies for a permit to alter the following described building:--

Descrip-
 tion of
 Present
 Bldg.

Location 1120 Congress Street (No 1154-1156 Congress Street) in fire-limits? no
 Name of Owner or Lessee, Margaret E Carter Address 1120 Congress St
 " " Contractor, E C Carter
 " " Architect,
 Material of Building is wood Style of Roof, pitch Material of Roofing, asphalt
 Size of Building is feet long; feet wide. No. of Stories,
 Cellar Wall is constructed of is inches wide on bottom and batters to inches on top.
 Underpinning is is inches thick; is feet in height.
 Height of Building Wall, if Brick; 1st, 2d, 3d, 4th, 5th,
 What was Building last used for? dwelling No. of Families? 1
 What will Building now be used for? dwelling 2 families

PERMIT MUST BE OBTAINED BEFORE BEGINNING WORK

Detail of Proposed Work

Build second story piazza over 1st story piazza, change stairway,
put in bath, out in window
all to comply with the building ordinance

Estimated Cost \$ 500.

If Extended On Any Side

Size of Extension, No. of feet long?; No. of feet wide?; No. of feet high above sidewalk?
 No. of Stories high?; Style of Roof?; Material of Roofing?
 Of what material will the Extension be built? Foundation?
 If of Brick, what will be the thickness of External Walls? inches; and Party Walls inches.
 How will the extension be occupied? How connected with Main Building?

When Moved, Raised or Built Upon

No. of Stories in height when Moved, Raised, or Built upon? Proposed Foundations?
 No. of feet high from level of ground to highest part of Roof to be?
 How many feet will the External Walls be increased in height? Party Walls

If Any Portion of the External or Party Walls Are Removed

Will an opening be made in the Party or External Walls? in Story.
 Size of the opening? How protected?
 How will the remaining portion of the wall be supported?

Signature of Owner or
 Authorized Representative

Margaret E Carter
 Address 1120 Congress St.



Location, Ownership and detail must be correct, complete and legible.

Separate application required for every building.

Plans must be filed with this application.

Application for Permit for Alterations, etc.

READ!
Get All Questions Settled
BEFORE Commencing Work.
Portland, Me., April 6, 1926 19
Failure to do so
May Prohibit
PERMITIVE!

To the INSPECTOR OF BUILDINGS:

The undersigned applies for a permit to alter the following described building:—

Description of Present Bldg.

Location 1130 Congress Street (see 1154-1156 Congress Street) Ward 7 in fire-limits? no.....

Name of Owner or Lessee, Margaret E Carter Address 15 Van St.....

“ “ Contractor, E C Carter “ “ “ “ “ “

“ “ Architect, “ “ “ “ “ “

Material of Building is wood Style of Roof, pitch Material of Roofing, asphalt.....

Size of Building is feet long; feet wide. No. of Stories,

Cellar Wall is constructed of is inches wide on bottom and batters to inches on top.

Underpinning is is inches thick; is feet in height.

Height of Building Wall, if Brick; 1st, 2d, 3d, 4th, 5th,

What was Building last used for? dwelling No. of Families? 1.....

What will Building now be used for? dwelling 1 family.....

Detail of Proposed Work

Raise the roof of the building about three feet so as to make flat roof, put in partition all to comply with the building ordinance

Estimated Cost \$ 250.

If Extended On Any Side

Size of Extension, No. of feet long?.....; No. of feet wide?.....; No. of feet high above sidewalk?.....

No. of Stories high?....., Style of Roof?.....; Material of Roofing?.....

Of what material will the Extension be built?..... Foundation?.....

If of Brick, what will be the thickness of External Walls?..... inches; and Party Walls inches.

How will the extension be occupied?..... How connected with Main Building?.....

When Moved, Raised or Built Upon

No. of Stories in height when Moved, Raised, or Built upon?..... Proposed Foundations?.....

No. of feet high from level of ground to highest part of Roof to be?.....

How many feet will the External Walls be increased in height?..... Party Walls.....

If Any Portion of the External or Party Walls Are Removed

Will an opening be made in the Party or External Walls?..... in Story.

Size of the opening?..... How protected?.....

How will the remaining portion of the wall be supported?.....

Signature of Owner or Authorized Representative Margaret E. Carter ?
Address 15 Van St E. C. Carter

PERMIT MUST BE OBTAINED BEFORE BEGINNING WORK



Location, ownership, and detail must be correct, complete and legible. Separate application required for every building.

APPLICATION FOR PERMIT TO BUILD A PRIVATE GARAGE

Portland, Me., December 12, 1923 19

TO THE
INSPECTOR OF BUILDINGS

The undersigned hereby applies for a permit to build, according to the following Specifications:-

Location 1130 Congress Street ^(See A 57-1156 Congress Street) Fire Districts no Ward 8
Name of owner is? J G Gilbert Address 1130 Congress Street
Name of mechanic is? W D Floyd Address 87 Concord Street
Proposes occupancy of building (purpose)? Private garage for one

cars only, and no space to be l.t.

Not nearer than two feet from any lot line, will not obstruct windows of adjoining property.

A Pyrene fire extinguisher to be kept in garage.

Size of building, No. of feet front? 12ft; No. of feet rear? 12ft; No. of feet deep? 18ft

No. of stories? 1

No. of feet in height from the mean grade of street to the highest part of the roof? 12ft

Floor to be? concrete

Will the roof be flat, pitch, mansard, or hip? pitch Material of roofing? asphalt

Will there be a chimney? no Will the flues be lined? _____ No stoves to be used.

Will the building conform to the requirements of the law? yes

Will the building be as good in appearance as other surrounding buildings? yes

Have you or any person acting for you previously applied for a permit to build a private garage? no

If so, state the particulars _____

Estimated Cost,
\$ 100.

Signature of owner or authorized representative,

W D Floyd

Address, 87 Concord St

1130 Congress St.

No. 5611

APPLICATION FOR
PRIVATE GARAGE

LOCATION

No. 1130 Congress

1154 - 1156

WARD 8

PERMIT GRANTED

Dec 12, 1923

102

1154-1156 CONGRESS STREET

SHAW-WALKER

Full cut # 920R - Half cut # 920-11 - Third cut # 920R - Full cut # 920R



FILL IN AND SIGN WITH INK

APPLICATION FOR PERMIT FOR HEATING, COOKING OR POWER EQUIPMENT

Portland, Maine June 16 1950

PERM. ISSUED 00952 JUN 17 1950

To the INSPECTOR OF BUILDINGS, PORTLAND, MAINE

The undersigned hereby applies for a permit to install the following heating, cooking or power equipment in accordance with the Laws of Maine, the Building Code of the City of Portland, and the following specifications:

Location 1158 Congress Use of Building Dwelling No. Stories 2 1/2 New Building Existing " Name and address of owner of appliance Edw C Carter Installer's name and address PORTLAND LEHIGH FUEL CO. INC. Telephone 25871

General Description of Work

To install 2 oil burners gravity fed, existing steam

IF HEATER, OR POWER BOILER

Location of appliance or source of heat Basement Type of floor beneath appliance concrete If wood, how protected? Kind of fuel oil Minimum distance to wood or combustible material, from top of appliance or casing top of furnace registers From top of smoke pipe 15" From front of appliance over 4' From sides or back of appliance over 3' Size of chimney flue 14x10 Other connections to same flue 3 run water If gas fired, how vented? Rated maximum demand per hour

IF OIL BURNER

Name and type of burner Mastercraft Labeled by underwriter's laboratories? yes Will operator be always in attendance? Does oil supply line feed from top or bottom of tank? bottom Type of floor beneath burner concrete Location of oil storage Basement Number and capacity of tanks no - 2 separate for 2 furnaces Will all tanks be more than five feet from any flame? yes How many tanks fire proofed? Total capacity of any existing storage tanks for furnace burners now 2 - 275 gal

IF COOKING APPLIANCE

Location of appliance Kind of fuel Type of floor beneath appliance If wood, how protected? Minimum distance to wood or combustible material from top of appliance From front of appliance From sides and back From top of smokepipe Size of chimney flue Other connections to same flue Is hood to be provided? If so, how vented? If gas fired, how vented? Rated maximum demand per hour

MISCELLANEOUS EQUIPMENT OR SPECIAL INFORMATION

Amount of fee enclosed? 2.50 (\$3.00 for one heater, etc., 50 cents additional for each additional heater, etc., in same building at same time.)

APPROVED

Signature and date: J. B. 6.16.50

Will there be in charge of the above work a person competent to see that the State and City requirements pertaining thereto are observed? yes

PORTLAND LEHIGH FUEL CO. INC.

Signature of Installer

Signature of Installer

INSPECTION COPY

Permit No. 50/952 7-10-50

Location 7156 Congress St.

Owner Edward C. Carter

Date of permit 6/19/50

Approved _____

NOTES

- 1. Fill Pipe
- 2. Vent Pipe
- 3. Kind of Heat
- 4. Dipper Capacity & Support
- 5. Name & Label
- 6. Stack Control
- 7. High Limit Control
- 8. Relief Control
- 9. Pipe or Protection
- 10. Valves in Line
- 11. Capacity of Tank
- 12. Tank Capacity & Support
- 13. Tank Placement
- 14. Oil Gauge
- 15. Instruction Card

7/15/50 Water Home
i/r/g

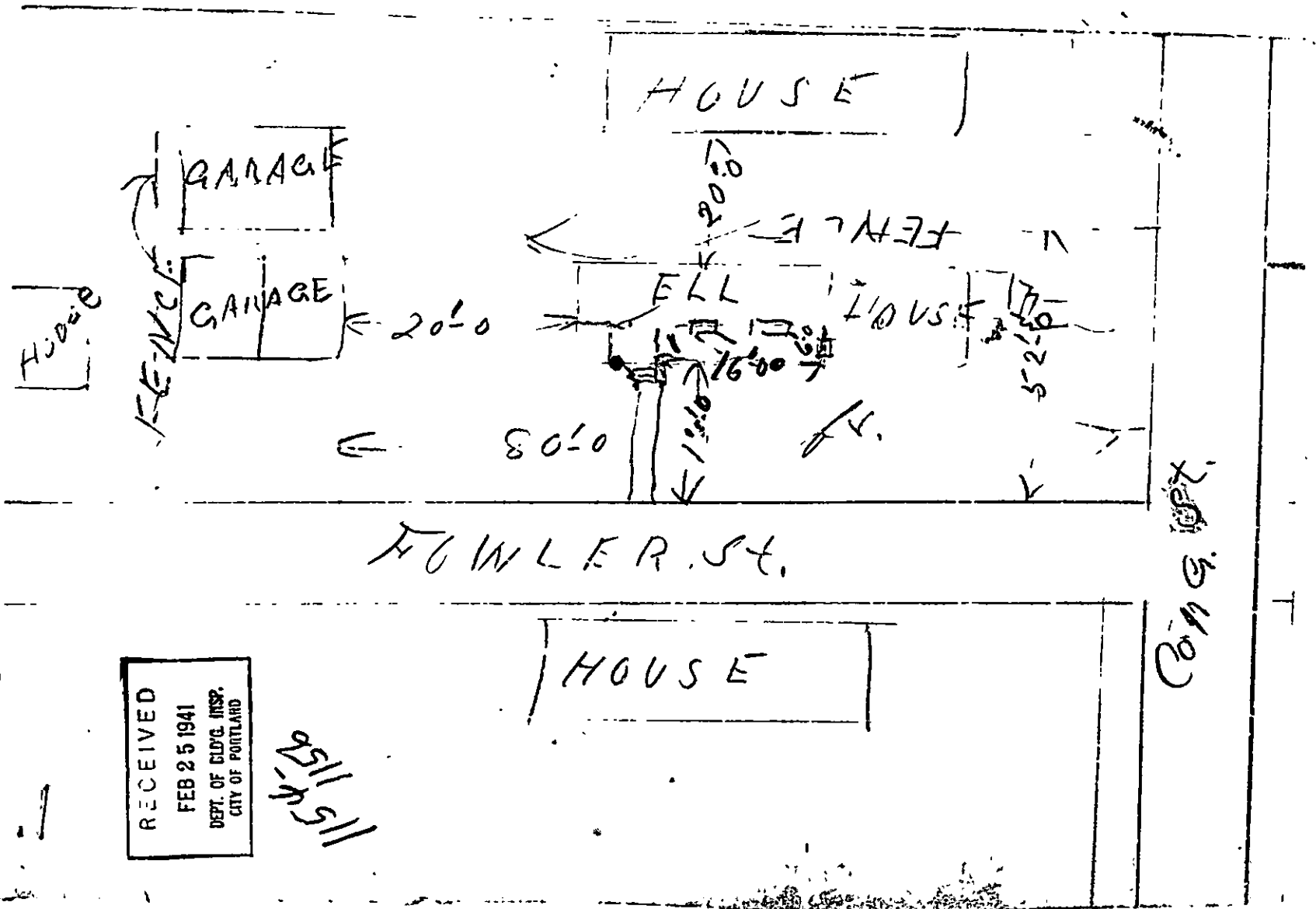

RECEIVED
 FEB 25 1941
 DEPT. OF CLYD. INSP.
 CITY OF PORTLAND

115
 115
 115

Comp. G. Opt.



APPLICATION FOR PERMIT

PERMIT ISSUED

Class of Building or Type of Structure Third Class

Portland, Maine, February 25, 1943 FEB 25 1943

To the INSPECTOR OF BUILDINGS, PORTLAND, ME.

The undersigned hereby applies for a permit to ~~erect~~ alter install the following building structure equipment in accordance with the Laws of the State of Maine, the Building Code of the City of Portland, plans and specifications, if any, submitted herewith and the following specifications:

Location 1156 Congress Street Within Fire Limits? no Dist. No.
Corner Fowler Street
Owner's or lessee's name and address Mrs. Edward C. Carter 1156 Congress St. Telephone 2-4379
Contractor's name and address Owner Telephone
Architect Plans filed yes No. of sheets 1
Proposed use of building Dwelling house No. families 2
Other buildings on same lot garage
Estimated cost \$ 50. Fee \$ 50

Description of Present Building to be Altered

Material wood No. stories 2 Heat Style of roof Roofing
Last use Dwelling house No. families 2

General Description of New Work

To glass in ^{portion of} first floor of existing two story rear piazza 6' x 16'
To change window to door to lead into same

It is understood that this permit does not include installation of heating apparatus which is to be taken out separately by and in the name of the heating contractor.

Details of New Work

CERTIFICATE OF OCCUPANCY
PERMIT IS WAIVED

Is any plumbing work involved in this work?
Is any electrical work involved in this work? Height average grade to top of plate
Size, front depth No. stories Height average grade to highest point of roof
To be erected on solid or filled land? earth or rock?
Material of foundation Thickness, top bottom cellar
Material of underpinning Height Thickness
Kind of roof Rise per foot Roof covering
No. of chimneys Material of chimneys of lining
Kind of heat Type of fuel Is gas fitting involved?
Framing lumber—Kind Dressed or full size?
Corner posts Sills Girt or ledger board? Size
Material columns under girders Size Max. on centers
Studs (outside walls and carrying partitions) 2x4-16" O. C. Girders 6x8 or larger. Bridging in every floor and flat roof span over 8 feet. Sills and corner posts all one piece in cross section.
Joists and rafters: 1st floor , 2nd , 3rd , roof
On centers: 1st floor , 2nd , 3rd , roof
Maximum span: 1st floor , 2nd , 3rd , roof

If one story building with masonry walls, thickness of walls? height?

If a Garage

No. cars now accommodated on same lot , to be accommodated
Total number commercial cars to be accommodated
Will automobile repairing be done other than minor repairs to cars habitually stored in the proposed building?

Miscellaneous

Will above work require removal or disturbing of any shade tree on a public street? no
Will there be in charge of the above work a person competent to see that the State and City requirements pertaining thereto are observed? yes

Signature of owner Edward C. Carter

INSPECTION COPY

Permit No. 41/228

Location: 156 Congress St.

Owner: R. C. Carter

Date of permit: 2/25/41

Notif. closing-in

Inspn. closing-in

Final Notif.

Final Inspn. 3/11/41

Cert. of Occupancy issued None

NOTES

3/11/41 - Work well
along - aj

~~FOR
REPAIR~~