

1044-1046 CONGRESS STREET



Full cut #020R - Half cut #0202R - Third cut #0203R - Fifth cut #0205R

CITY OF PORTLAND, MAINE

Application for Permit to Install Wires

Permit No. 541326
 Issued 11/1/68
 Portland, Maine November 7, 1968

To the City Electrician, Portland, Maine:

The undersigned hereby applies for a permit to install wires for the purpose of conducting electric current, in accordance with the laws of Maine, the Electrical Ordinance of the City of Portland, and the following specifications:

(This form must be completely filled out — Minimum Fee, \$1.00)

Owner's Name and Address Frank Bryant Tel. _____
 Contractor's Name and Address Carl Maxwell Tel. 781-2946
 Location 1046 Congress St. Use of Building Res.
 Number of Families 2 Apartments _____ Stores _____ Number of Stories _____
 Description of Wiring: New Work _____ Additions _____ Alterations _____
Remove 1-60A & replace with 2/3 & 1/5 = 1-60A on second floor
 Pipe _____ Cable ☒ Metal Molding _____ BX Cable _____ Plug Molding (No. of feet) _____
 No. Light Outlets _____ Plugs _____ Light Circuits _____ Plug Circuits _____
 FIXTURES: No. _____ Light Switches _____ Fluor. or Strip Lighting (No. feet) _____
 SERVICE: Pipe _____ Cable _____ Underground _____ No. of Wires _____ Size _____
 METERS: Relocated _____ Added _____ Total No. Meters _____
 MOTORS: Number _____ Phase _____ H. P. _____ Amps _____ Volts _____ Starter _____
 HEATING UNITS: Domestic (Oil) _____ No. Motors _____ Phase _____ H.P. _____
 Commercial (Oil) _____ No. Motors _____ Phase _____ H.P. _____
 Electric Heat (No. of Rooms) _____
 APPLIANCES: No. Ranges _____ Watts _____ Brand Feeds (Size and No.) _____
 Elec. Heaters dryer in m. floor Watts _____
 Miscellaneous _____ Watts _____ Extra Cabinets or Panels _____
 Transformers _____ Air Conditioners (No. Units) _____ Signs (No. Units) _____
 Will commence _____ 19 _____ Ready to cover in OK _____ 19 _____ Inspection _____ 19 _____
 Amount of Fee \$ 2.50

Signed Carl Maxwell

DO NOT WRITE BELOW THIS LINE

SERVICE ✓ METER ✓ GROUND _____
 VISITS: 1 11/13/68 2 _____ 3 _____ 4 _____ 5 _____ 6 _____
 7 _____ 8 _____ 9 _____ 10 _____ 11 _____ 12 _____

REMARKS:

INSPECTED BY [Signature] (OVER)

LOCATION 1046 Gwynn St
 INSPECTION DATE 11/13/68
 WORK COMPLETED 11/13/68
 TOTAL NO. INSPECTIONS 2
 REMARKS:

FEES FOR WIRING PERMITS EFFECTIVE JULY 31, 1963

WIRING	
1 to 30 Outlets	(including switches) \$ 2.00
31 to 60 Outlets	(including switches) 3.00
Over 60 Outlets, each Outlet	(including switches) .05
(Each twelve feet or fraction thereof of fluorescent lighting or any type of plug molding will be classed as one outlet).	
SERVICES	
Single Phase	
Three Phase	2.00
MOTORS	
Not exceeding 50 H.P.	4.00
Over 50 H.P.	3.00
HEATING UNITS	
Domestic (Oil)	4.00
Commercial (Oil)	2.00
Electric Heat (Each Room)	.75
APPLIANCES	
Ranges, Cooking Tops, Ovens, Water Heaters, Disposals, Dishwashers, etc. — Each Unit	1.50
TEMPORARY WORK (Limited to 6 months from date of permit)	
Service, Single Phase	1.00
Service, Three Phase	2.00
Wiring, 1-50 Outlets	1.00
Wiring, each additional outlet over 50	.02
Circuses, Carnivals, Fairs, etc.	10.00
MISCELLANEOUS	
Distribution Cabinet or Panel, per unit	1.00
Transformers, per unit	2.00
Air Conditioners, per unit	2.00
Signs, per unit	2.00
ADDITIONS	
5 Outlets, or less	
Over 5 Outlets, Regular Wiring Rates	1.00

PERMIT TO INSTALL PLUMBING

14782

PERMIT NUMBER

Date issued 1/1/65
 PORTLAND PLUMBING
 INSPECTOR

Address 116 Commercial Street
 Installation For: Plumbing

Owner of Bldg. Same

Owner's Address: Same

Plumber: Edison T. T. T. Date: 1/1/65

By J.P. Welch

APPROVED FIRST INSPECTION

Date 1/13/65

By J.P. Welch

APPROVED FINAL INSPECTION

Date 1/13/65

By JOSEPH P. WELCH

CHIEF PLUMBING INSPECTOR

TYPE OF BUILDING

☐ RESIDENTIAL

☐ SINGLE

☐ MULTI FAMILY

☐ NEW CONSTRUCTION

☐ REMODELING

NEW	REPL	PROPOSED INSTALLATIONS	NUMBER	FEE
		SINKS		
		LABORATORIES		
		TOILETS		
		BATH TUBS		
		SHOWERS		
		DRAINS		
	1	HOT WATER TANKS Electric	1	
		TANKLESS WATER HEATERS		
		GARBAGE GRINDERS		
		SEPTIC TANKS		
		HOUSE SEWERS		
		ROOF LEADERS (Conn. to house drain)		

PORTLAND HEALTH DEPT. PLUMBING INSPECTION

TOTAL ▶ \$2.00

3



FILL IN AND SIGN WITH INK

APPLICATION FOR PERMIT FOR
HEATING, COOKING OR POWER EQUIPMENT

Portland, Maine, August 31, 1949

PERMIT ISSUED

SEP 2 1949

CITY OF PORTLAND

To the INSPECTOR OF BUILDINGS, PORTLAND, MAINE

The undersigned hereby applies for a permit to install the following heating, cooking or power equipment in accordance with the Laws of Maine, the Building Code of the City of Portland, and the following specifications

Location 1046 Congress St. Use of Building Dwelling No. Stories 2 ~~New Building~~
Name and address of owner of appliance Frank W. Briant, 1046 Congress St. Existing "
Installer's name and address Ballard Oil Equipment Co., 135 Main St., Portland, Me. Telephone 2-1991

General Description of Work

To install One Fully Automatic Oil Burner in Steam Boiler

RECEIVED

SEP 1 1949

DEPT OF BLD'G. INSP.
CITY OF PORTLAND

IF HEATER, OR POWER BOILER

Location of appliance or source of heat _____ Type of floor beneath appliance _____
If wood, how protected? _____ Kind of fuel _____
Minimum distance to wood or combustible material from top of appliance or casing top of furnace _____
From top of smoke pipe _____ From front of appliance _____ From sides or back of appliance _____
Size of chimney flue _____ Other connections to same flue _____
If gas fired, how vented? _____ Rated maximum demand per hour _____

IF OIL BURNER

Name and type of burner Esso, ECH Labelled by underwriter's laboratories? Yes
Will operator be always in attendance? no Does oil supply line feed from top or bottom of tank? Bottom
Type of floor beneath burner Cement
Location of oil storage Basement Number and capacity of tanks 1 - 275
If two 275-gallon tanks, will three-way valve be provided? _____
Will all tanks be more than five feet from any flame? yes How many tanks fire proofed? none
Total capacity of any existing storage tanks for furnace burners none

IF COOKING APPLIANCE

Location of appliance _____ Kind of fuel _____ Type of floor beneath appliance _____
If wood, how protected? _____
Minimum distance to wood or combustible material from top of appliance _____
From front of appliance _____ From sides and back _____ From top of smokepipe _____
Size of chimney flue _____ Other connections to same flue _____
Is hood to be provided? _____ If so, how vented? _____
If gas fired, how vented? _____ Rated maximum demand per hour _____

MISCELLANEOUS EQUIPMENT OR SPECIAL INFORMATION

Amount of fee enclosed? \$2.00 (\$1.00 for one heater, etc., 50 cents additional for each additional heater, etc., in same building at same time.)

APPROVED:

OK-9/1/49-AGJ

Will there be in charge of the above work a person competent to see that the State and City requirements pertaining thereto are observed? yes

Ballard Oil & Equipment Co.

Signature of Installer

INSPECTION COPY

Permit No. 49/1401 7/15
 Location 1046 Congress St
 Owner Frank W. Bryant
 Date of permit 9/2/49
 Approved 9/11/49 15/10/49
 NOTES

- 1 Fill Pipe ☒
 - 2 Vent Pipe ☒
 - 3 Running Water ☒
 - 4 Drain & Sewer Support ☒
 - 5 Name & Label ☒
 - 6 Signs & Labels ☒
 - 7 Hot Water Control ☒
 - 8 Remote Control ☒
 - 9 Piping & Connections ☒
 - 10 Valves in Supply Line ☒
 - 11 Capacity of Tanks ☒
 - 12 Tank Room & Support ☒
 - 13 Tank Distance ☒
 - 14 Oil Gauge ☒
 - 15 Instruction Card ☒
 - 16 ☒
- Oil Filter



FILL IN AND SIGN WITH INK

APPLICATION FOR PERMIT FOR
HEATING, COOKING OR POWER EQUIPMENT

Portland, Maine, January 16, 1948

PERMIT ISSUED
00067

JAN 17 1948

CITY OF PORTLAND

To the INSPECTOR OF BUILDINGS, PORTLAND, MAINE

The undersigned hereby applies for a permit to install the following heating, cooking or power equipment in accordance with the Laws of Maine, the Building Code of the City of Portland, and the following specifications:

Location 1046 Congress Street Use of Building Dwelling No. Stories New Building Existing "
Name and address of owner of appliance Herbert F. Bryant, 1036 Congress St.
Installer's name and address Fred Butterfield, 43 Granite St. Telephone 4-3164

General Description of Work

To install circulated hot water heating boiler and oil burning unit in place of stove
heat for second floor

IF HEATER, OR POWER BOILER

Location of appliance or source of heat basement Type of floor beneath appliance concrete
If wood, how protected? Kind of fuel oil
Minimum distance to wood or combustible material, from top of appliance or casing top of furnace 3'
From top of smoke pipe 12" shield From front of appliance over 4' From sides or back of appliance over 3'
Size of chimney flue 8x12 Other connections to same flue stove
If gas fired, how vented? Rated maximum demand per hour

IF OIL BURNER

Name and type of burner Crane Labelled by underwriter's laboratories? yes
Will operator be always in attendance? Does oil supply line feed from top or bottom of tank? bottom
Type of floor beneath burner concrete
Location of oil storage basement Number and capacity of tanks 1-275 gal.
If two 275-gallon tanks, will three-way valve be provided?
Will all tanks be more than five feet from any flame? yes How many tanks fire proofed?
Total capacity of any existing storage tanks for furnace burners none

IF COOKING APPLIANCE

Location of appliance Kind of fuel Type of floor beneath appliance
If wood, how protected?
Minimum distance to wood or combustible material from top of appliance
From front of appliance From sides and back From top of smoke pipe
Size of chimney flue Other connections to same flue
Is hood to be provided? If so, how vented?
If gas fired, how vented? Rated maximum demand per hour

MISCELLANEOUS EQUIPMENT OR SPECIAL INFORMATION

Permit Issued with Letter (c) (extra 2902-12-1)

Amount of fee enclosed? 1.00 (\$1.00 for one heater, etc., 50 cents additional for each additional heater, etc., same building at same time.)

APPROVED:

OK 1-16-48 RMB

Will there be in charge of the above work a person competent to see that the State and City requirements pertaining thereto are observed? yes

INSPECTION COPY

Signature of Installer

Fred Z Butterfield

CHIEF OF POLICE DEPT.

Permit No. 48/67
 Location 1046 Congress St
 Owner Herbert J. Bryant
 Date of permit 1/17/48
 Approved E. J. R. R. M.

NOTES

- 1 Fill Pipe
- 2 Vent Pipe
- 3 Fuel Line
- 4 Exhaust Pipe
- 5 Water Pipe
- 6 Sewer Pipe
- 7 Gas Control
- 8 Gas Control
- 9 Piping Support & Protection
- 10 Valves in Supply Line
- 11 Cartridge of Tank
- 12 Fuel Filter & Supply
- 13 Tank Vent
- 14 Oil Gauge
- 15 Instruction Card
- 16

2-48 Section of floor
 first embedded

in chimney, also
 flooring & floor
 against feet side
 wall - 2x4 floor
 supporting base. Draft
 1/2" at base
 installed later.
 3-48 Section of floor
 first - 1st embedded
 in chimney, clams
 chimney was
 repaired & sealed
 1/2" gap filling
 against chimney
 (R.M.)



APPLICATION FOR PERMIT

Permit No. 10526

Class of Building or Type of Structure Third Class

To the INSPECTOR OF BUILDINGS, PORTLAND, ME.

Portland, Maine, April 7, 1930

The undersigned hereby applies for a permit to erect alter install the following building structure equipment in accordance with the Laws of the State of Maine, the Building Code of the City of Portland, plans and specifications, if any, submitted herewith and the following specifications:

Location 1042 Congress Street (See 1044 Congress Street) Ward 7 Within Fire Limits? No Dist. No. 61
Owner's or Lessee's name and address Herbert F. Bryant, 1042 Congress St. Telephone F 4451 R
Contractor's name and address W. H. Bell, 15 Hanover St. Telephone _____
Architect's name and address N. E. Keaton Co Telephone _____
Proposed use of building dwelling house
Other buildings on same lot _____ No. families 2

Description of Present Building to be Altered

Material wood No. stories 2 1/2 Heat _____ Style of roof _____ Roofing _____
Last use dwelling house No. families 2

General Description of New Work

To erect two story open front piazza 4' x 23' long, 5'9" wide at one end and 6' at other end
To remove existing one story bay window on front of dwelling and replace with one window
(This is to provide means of entrance to dwelling, as street grade has been changed
and former steps to front door cannot be used, he wishes to build this piazza with
steps at one end for entrance)

in front wall of building.

To cut in new entrance door onto piazza on second floor

On account of closeness to street Details of New Work: one corner of this piazza will be located 2'4" from the street line and the opening of the door will be 4'0" wide. The piazza will be 4'0" deep. The height average grade to highest point of roof _____

To be erected on solid or fill? solid earth or rock? earth

Material of foundation brick & mortar Thickness, top _____ bottom 4/8" to 1 1/2"

Material of underpinning _____ Height _____ Thickness 2" to 4"

Kind of roof flat 1" to foot Roof covering Asphalt roofing Class 2 Und. Lab.

No. of chimneys _____ Material of chimneys _____ of lining _____

Kind of heat _____ Type of fuel _____ Distance, heater to chimney _____

If oil burner, name and model _____

Capacity and location of oil tanks _____

Is gas fitting involved? _____ Size of service _____

Corner posts 4x6 Sills 4x6 Girt or ledger board? _____ Size _____

Material columns under girders _____ Size _____ Max. on centers _____

Studs (outside walls and carrying partitions) 2x-16" O. C. Girders 6x8 or larger. Bridging in every floor and flat roof span over 8 feet. Sills and corner posts all one piece in cross section.

Joists and rafters: 1st floor 2x6, 2nd 2x6, 3rd _____, roof 2x6

On centers: 1st floor 18", 2nd 18", 3rd _____, roof 18"

Maximum span: 1st floor 11', 2nd 11', 3rd _____, roof 2-4'

If one story building with masonry walls, thickness of walls? _____ height? _____

If a Garage

No. cars now accommodated on same lot _____, to be accommodated _____

Total number commercial cars to be accommodated _____

Will automobile repairing be done other than minor repairs to cars habitually stored in the proposed building? _____

Miscellaneous

Will above work require removal or disturbing of any shade tree on a public street? no

Plans filed as part of this application? yes No. sheets 1

Estimated cost \$ 275. Fee \$.75

Will there be in charge of the above work a person competent to see that the State and City requirements pertaining thereto are observed? yes

INSPECTION COPY

Signature of owner Herbert F. Bryant
Oliver T. Sanborn

CHIEF OF FIRE DEPT.

1422 A

Permit No. 38/526
Location 1042 Congress St.
OK Herbert H. Bryant
Date of permit 4/10/30
Name crossing-in
In
Final Notif.
In
Cert. of Occupancy issued

NOTES

4/15/30 - No work started
A.C.S.
4/22/30 - Same - A.C.S.
4/29/30 - Same - A.C.S.
5/7/30 - Permit signed
work on - A.C.S.
5/14/30 - Work on - A.C.S.
A.C.S.

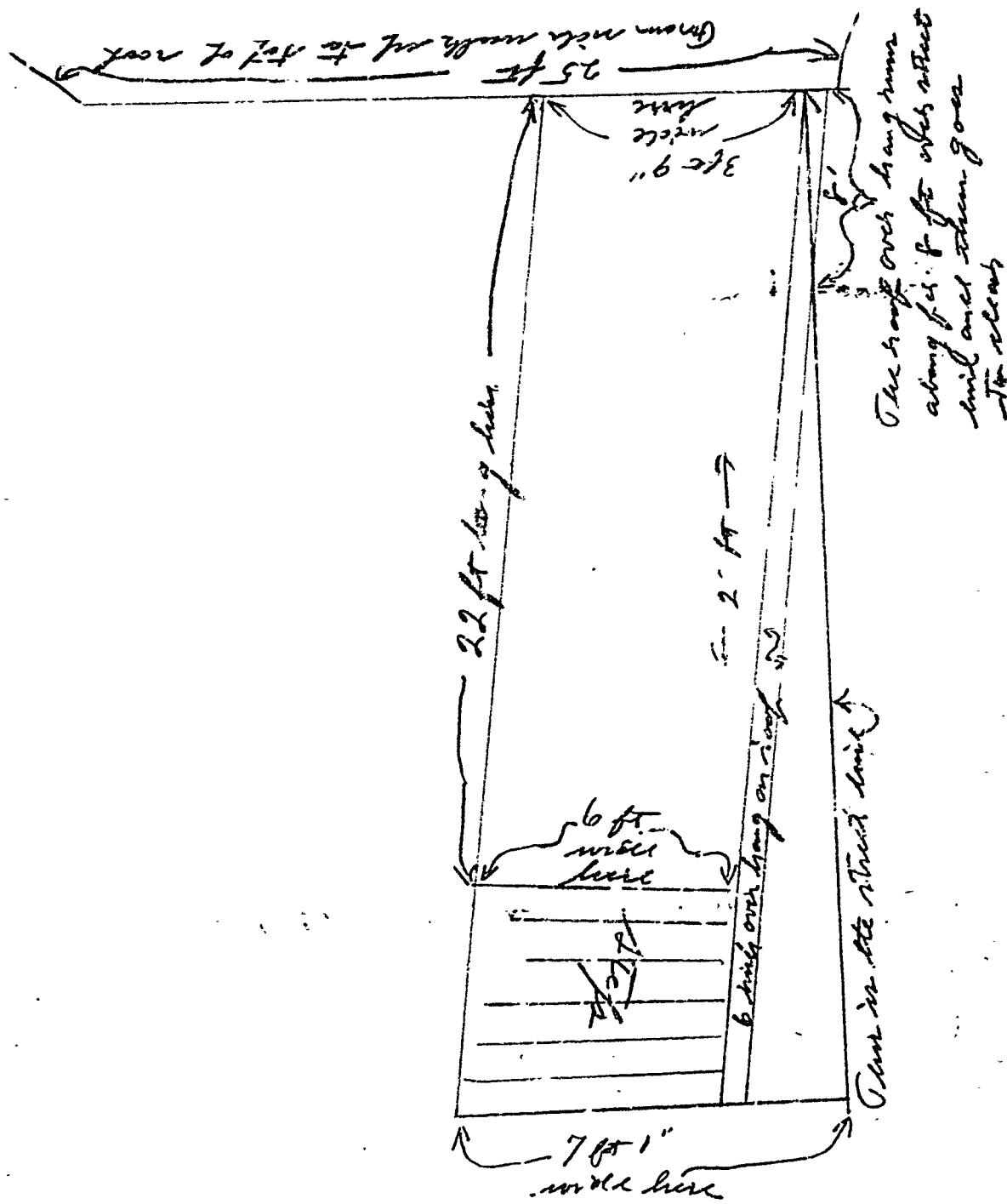

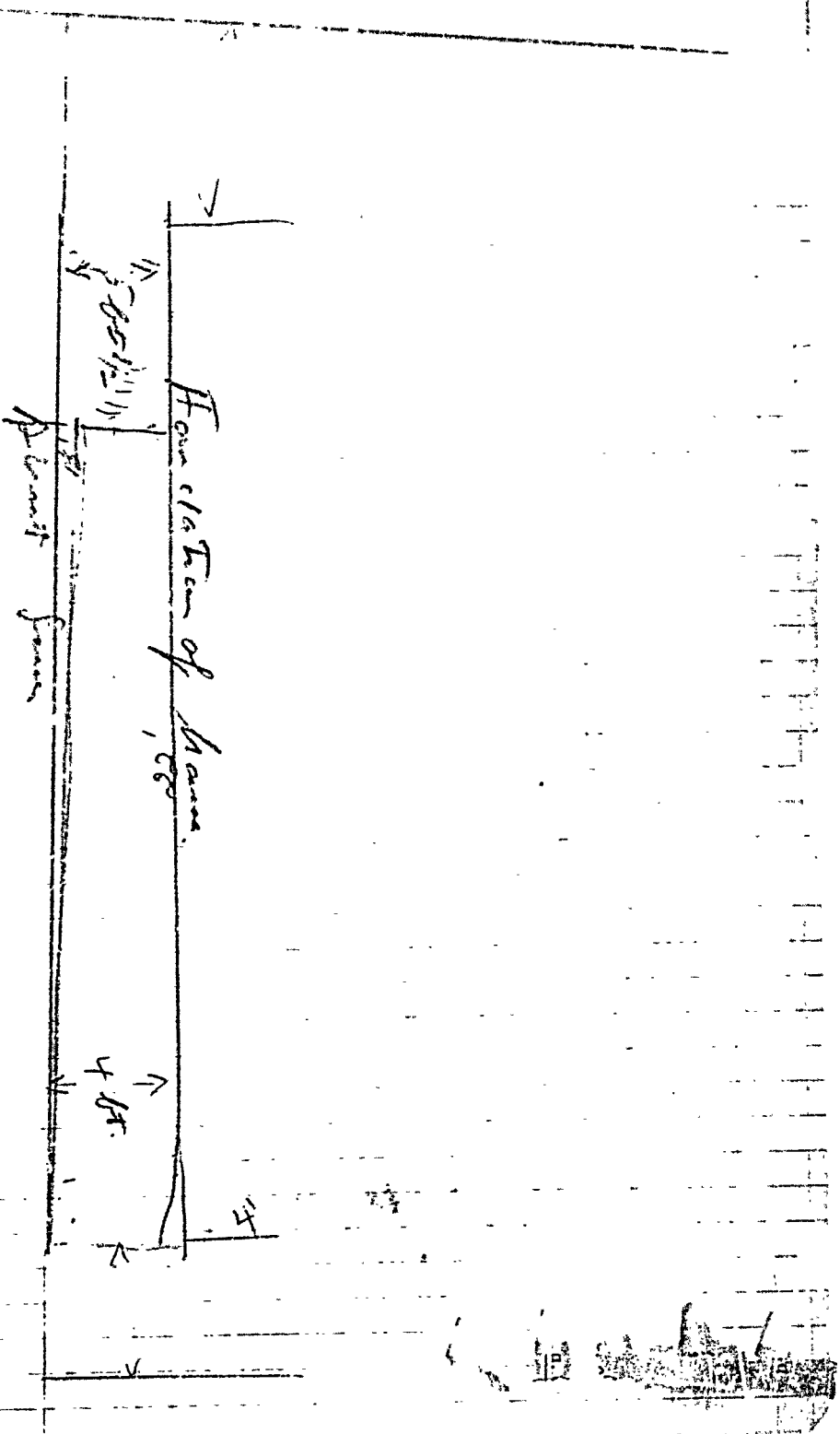

1042 Congress St.

RECEIVED
JAN 10 1964

AP 1046 Congress Street-I

January 16, 1946

Mr. Herbert F. Bryant
1036 Congress Street
Mr. Fred Butterfield
43 Granite Street

Subject: Installation of circulating hot water heating system and oil burning equipment in place of stove heat at 1046 Congress Street

Gentlemen:

Now that a circulating hot water heating system is to be installed in the cellar and connected to the existing chimney, it may be necessary that the owner make the following improvements in the cellar:

Provide a cast iron clean-out door and frame at the bottom of the chimney flue, if none exists, and see to it that the flue to which the heater is connected is thoroughly cleaned out.

Repair any joints of the brick masonry of the chimney in the basement so that they will be permanently sound.

Provide a firestop of non-burnable material around the first floor framing at the chimney. If any of this wooden framing of the first floor is closer than one inch to the outside wall of the chimney, it should be adjusted without doing damage to the strength of the floor and work above which the framing supports, so that there will be no woodwork closer than one inch to the outside walls of the chimney as seen in the cellar. Then this space between the chimney wall and the wooden framing of the first floor is to be closed underneath by non-burnable material. The usual way of doing this is to tack strips of sheet metal on the underside of the framing around the chimney of such a width and in such a way that this metal will project from the wooden framing out as tightly as possible against the masonry of the chimney (do not fasten metal to chimney), all around, thus should a fire take place in the cellar, no fire would be less likely to be drawn up into the building through the vertical opening between the framing of the building and the chimney.

Very truly yours,

Inspector of Buildings

RMT/J



Location, ownership, and detail must be correct, complete and legible. Separate application required for every building.

APPLICATION FOR PERMIT TO BUILD A PRIVATE GARAGE

To THE
INSPECTOR OF BUILDINGS

Portland, Me., June 5/24 19

The undersigned hereby applies for a permit to build, according to the following Specifications:—

Location 1042 Congress Street (1042-1046 Congress Street)
Name of owner is? Herbert Bryant Fire Districts no Ward 7
Name of mechanic is? owner Address 1042 Congress St
Proposes occupancy of building (purpose)? Address
cars only, and no space to be let. Private garage for two
Not nearer than two feet from any lot line, will not obstruct windows of adjoining property.
A Pyrene fire extinguisher to be kept in garage.
Size of building, No. of feet front? 18ft; No. of feet rear? 18ft; No. of feet deep? 20ft
No. of stories? 1
No. of feet in height from the mean grade of street to the highest part of the roof? 12ft
Floor to be? cinder
Will the roof be flat, pitch, mansard, or hip? pitch Material of roofing? asphalt
Will there be a chimney? no Will the flues be lined? No stoves to be used.
Will the building conform to the requirements of the law? yes
Will the building be as good in appearance as other surrounding buildings? yes
Have you or any person acting for you previously applied for a permit to build a private garage? no
If so, state the particulars
.....
.....
.....

Estimated Cost,

\$ 200.

Signature of owner or authorized representative,

Address,

Herbert G Bryant
1042 Congress St.



Location, Ownership and detail must be correct, complete and legible.
Separate application required for every building.
Plans must be filed with this application.

Application for Permit for Alterations, etc.

To the

Portland, August 10, 1922

192

INSPECTOR OF BUILDINGS:

The undersigned applies for a permit to alter the following described building:—

Location **1042 Congress Street** Ward, **10th** in fire-limits? **no**
Name of Owner or Lessee, **Herbert F Bryant** Address **12 Frederic Street**
" " Contractor, **Ira Dresser** **1296 Congress Street**
" " Architect,

Descrip-
tion of
Present
Bldg.

Material of Building is **wood** Style of Roof, **flat** Material of Roofing, **tar & gravel**
Size of Building is **20ft** feet long; **20ft** feet wide No. of Stories, **2**
Cellar Wall is constructed of **posts** is inches wide on bottom and batters to inches on top.
Underpinning is inches thick; is feet in height.
Height of Building **20ft** Wall, if Brick; 1st, 2d, 3d, 4th, 5th.
What was Building last used for? **dwelling** No. of Families? **2**
What will Building now be used for? **same**

DETAIL OF PROPOSED WORK

**Move building on same lot about 7 feet, put in concrete foundation, interior changes
all to comply with the building ordinance**

Estimated Cost \$600.

IF EXTENDED ON ANY SIDE

Size of Extension, No. of feet long? ; No. of feet wide? ; No. of feet high above sidewalk?
No. of Stories high? ; Style of Roof? ; Material of Roofing?
Of what material will the Extension be built? Foundation?
If of Brick, what will be the thickness of External Walls? inches; and Party Walls inches.
How will the extension be occupied? How connected with Main Building?

WHEN MOVED, RAISED OR BUILT UPON

No. of Stories in height when Moved, Raised, or Built upon? Proposed Foundations
No. of feet high from level of ground to highest part of Roof to be?
How many feet will the External Walls be increased in height? Party Walls

IF ANY PORTION OF THE EXTERNAL OR PARTY WALLS ARE REMOVED

Will an opening be made in the Party or External Walls? in Story.
Size of the opening? How protected?
How will the remaining portion of the wall be supported?

Signature of Owner or
Authorized Representative
Address

Herbert F Bryant
11 Ocean St

PERMIT MUST BE OBTAINED BEFORE BEGINNING WORK