

Cortega Minaboard and Fire Guard Lay-in Ceilings

ARCHITECTURAL CEILINGS FROM ARMSTRONG

Armstrong
CEILING
SYSTEMS

ARMSTRONG WORLD INDUSTRIES, INC.
LANCASTER, PA. 17604

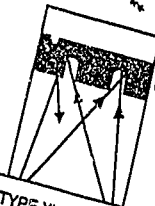

Underwriters Laboratories Inc.®
CLASSIFIED

R3407-TYPE XLD

ACOUSTICAL MATERIAL
CONTENTS NOT OVER 100 SQ. FT. (FORM B)

Issue No. BP-5024

SURFACE BURNING CHARACTERISTICS*

FLAME SPREAD 25
SMOKE DEVELOPED 10

*ALSO CLASSIFIED AS TO SURFACE BURNING CHARACTERISTICS IN
ACCORDANCE WITH THE STANDARD CANULC-S102M

LA5910 RL Rev. 0594

Printed in United States of America

2505

Precautionary Measures Install in well-ventilated areas and avoid breathing dust. If high dust level are anticipated during installation such as with the use of power tools, use appropriate NIOSH designated dust respirator. All power cutting tools must be equipped with dust collectors. Avoid contact with skin or eyes. Wear long-sleeved, loose fitting clothing, gloves and eye protection. If contact occurs flush eyes with water for at least 15 minutes.

Made in the United States by Armstrong World Industries, Inc., Lancaster, Pennsylvania 17604.

Not to be installed under conditions where relative humidity exceeds 70%. (Except RH90 and RH100). No gas vapor or poses
Clase A per ASTM R 1264. Clase A selon la ASTM E 1264. Clasa A pentru EN 1264.

Measures de prévention Installer un assuranceur que le site est bien ventilé et éviter de respirer la poussière. Si l'on prévoit générer une grande quantité de poussières, comme lors de l'utilisation d'outils électriques, il faut porter l'appareil respiratoire (approuvé par la NIOSH) approprié. Tous les outils électriques de coupe doivent être munis de dépoussiérisateurs. Éviter le contact avec la peau ou les yeux. Porter des vêtements amples, confortables et à manches longues, des gants et une protection adéquate.

Fait aux États-Unis d'Amérique par Les Industries Mondiales
Armstrong Inc., Lancaster, Pennsylvania 17604.

[illegible]

Medidas de primeros auxilios: Si se produce un contacto con el material, enjuague los ojos y la piel irritada con agua abundante. En caso de inhalación, quite la vestimenta según durante por lo menos 10 minutos. Lleve consigo una mascarilla para protección respiratoria. Evite la ingestión continuada. Después de instalar el material, lávelo cuidadosamente con agua y jabón nuevo. Lave las vestimentas de trabajo separadas de otras vestimentas. Enjuague el lavaplatos minuciosamente.

Consulte las MSDS-pláticas de datos de seguridad de los materiales de Armstrong, que incluyen información relacionada con los riesgos de exposición laboral establecidos y están disponibles en exposición laboral o de su empleador.

Fabricados en los Estados Unidos por Armstrong World Industries, Inc., Lancaster, Pennsylvania 17604.

Fabricados en los Estados Unidos por Armstrong World Industries, Inc., Lancaster, Pennsylvania 17604.

LA-265M7-3263

City of Portland, Maine - Building or Use Permit Application 389 Congress Street, 04101, Tel: (207) 874-8703, FAX: 874-8716

Location of Construction: 75' to John St		Owner: WARD Int Liability Co.		Phone:		Permit No. 60594	
Owner Address:		Lessee/Buyer's Name: Cozy Harbor Seafood		Phone:		Business Name:	
Contractor Name: Eastern Security Systems		Address: 665 Congress St Portland, ME		Phone: 04102 772-1171		<div style="border: 2px solid black; padding: 5px; text-align: center;"> PERMIT ISSUED Permit Issued: <div style="border: 1px solid black; padding: 5px; margin: 5px 0;"> JUN 25 1996 </div> CITY OF PORTLAND </div>	
Past Use: Cozy/Seafood		Proposed Use: Same		COST OF WORK: \$ 550		PERMIT FEE: \$ 25.00	
Proposed Project Description: Hook-up Transmitter to Relay		FIRE DEPT. <input checked="" type="checkbox"/> Approved <input type="checkbox"/> Denied		INSPECTION: Use Group: Type:		Zone: CBL: 070-B-002	
		Signature: <i>[Signature]</i>		Signature: <i>[Signature]</i>		Zoning Approval: OK 5/24/96	
		PEDESTRIAN ACTIVITIES DISTRICT (P.A.D.) Action: <input type="checkbox"/> Approved <input type="checkbox"/> Approved with Conditions <input type="checkbox"/> Denied		Special Zone or Reviews: <input type="checkbox"/> Shoreland <input type="checkbox"/> Wetland <input type="checkbox"/> Flood Zone <input type="checkbox"/> Subdivision <input type="checkbox"/> Site Plan <input checked="" type="checkbox"/> major <input type="checkbox"/> minor <input type="checkbox"/> mm <input type="checkbox"/>			
Permit Taken By: Mary Grosik		Date Applied For: 21 June 1996					

1. This permit application doesn't preclude the Applicant(s) from meeting applicable State and Federal rules.
2. Building permits do not include plumbing, septic or electrical work.
3. Building permits are void if work is not started within six (6) months of the date of issuance. False information may invalidate a building permit and stop all work.

CERTIFICATION

I hereby certify that I am the owner of record of the named property, or that the proposed work is authorized by the owner of record and that I have been authorized by the owner to make this application as his authorized agent and I agree to conform to all applicable laws of this jurisdiction. In addition, if a permit for work described in the application issued, I certify that the code official's authorized representative shall have the authority to enter all areas covered by such permit at any reasonable hour to enforce the provisions of the code(s) applicable to such permit

SIGNATURE OF APPLICANT **Ron Jespersen** ADDRESS: DATE: **21 June 1996** PHONE:

RESPONSIBLE PERSON IN CHARGE OF WORK, TITLE PHONE:

White-Permit Desk Green-Assessor's Canary-D.P.W. Pink-Public File Ivory Card-Inspector

Zoning Appeal

- ☐ Variance
- ☐ Miscellaneous
- ☐ Conditional Use
- ☐ Interpretation
- ☐ Approved
- ☐ Denied

Historic Preservation

- ☒ Not in District or Landmark
- ☒ Does Not Require Review
- ☐ Requires Review

Action:

- ☐ Approved
- ☐ Approved with Conditions
- ☐ Denied

Date: **6/1/96**

CEO DISTRICT

3

COMMENTS

See Attached Sheets - Job Log

Type		Inspection Record	Date
Foundation:	_____	_____	_____
Framing:	_____	_____	_____
Plumbing:	_____	_____	_____
Final:	_____	_____	_____
Other:	_____	_____	_____

Cozy Harbor
75 St John St

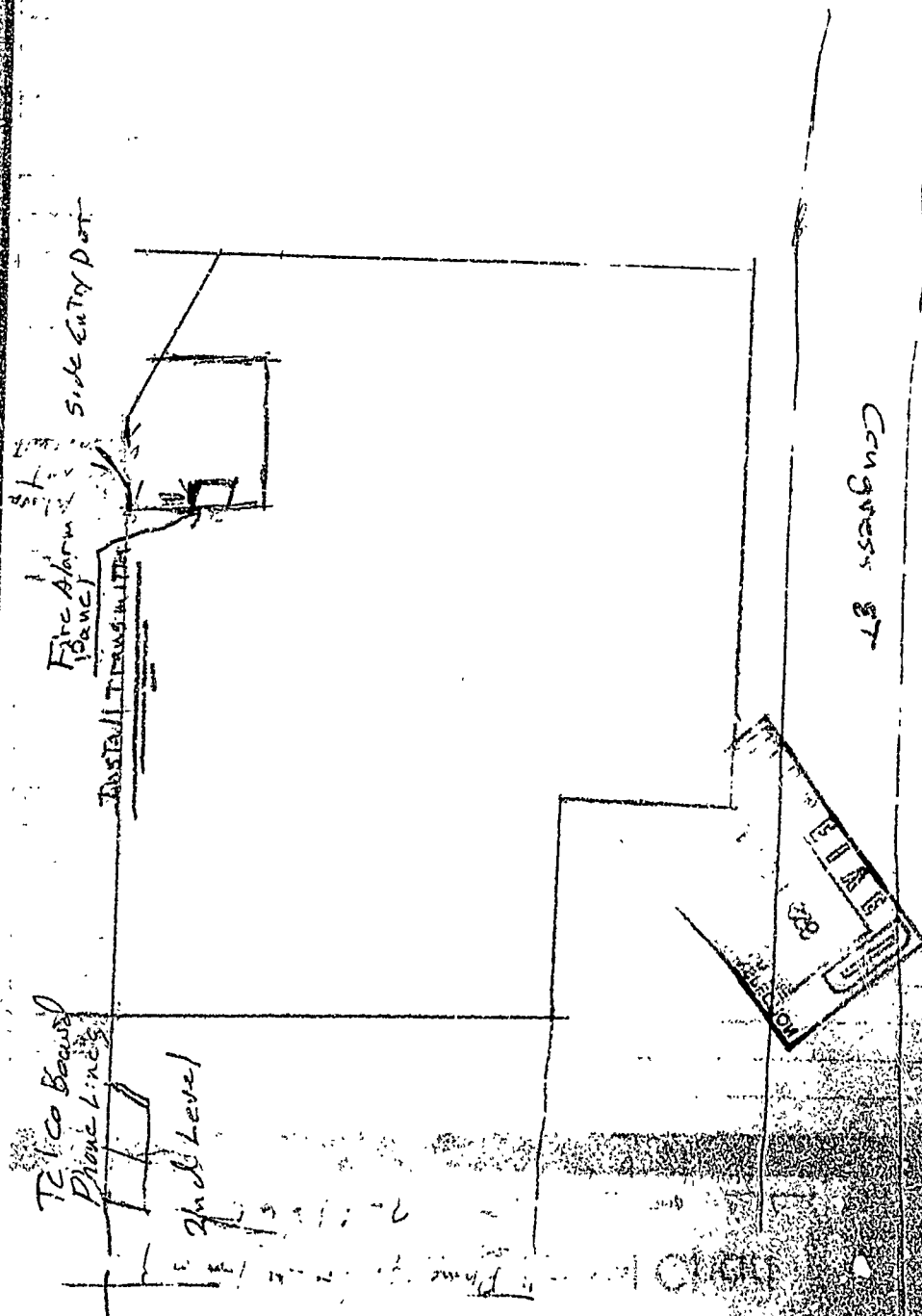

Cozy Harbor Seafood Facsimile Transmission

total pages sent 14

To: Mr. Simpson
From: Building Inspection
Tel: 74-8716

John Simpson - Cozy Harbor Seafood

SEN: 0112 J-6595

NUM: 89-1550

Mr. Simpson are the test results
you requested. If you have any
questions or comments please call!

(If you receive this fax in error, please contact sender.)



Cozy Harbor Seafood, Inc.
P.O. Box 389, Portland, ME 04112, (207) 799-6595

8748716 P.01

TO

06-20-1996 03:55AM FROM: COZY-HARBOR

8748716 P.02

TO

1. 7. 11.

inford.

LETTER OF TRANSMITTAL

02-May-96

230-212

Attention:

Mr. John Norton

Co-

110 Dartmouth St.

South Africa MF 0

**In-Place Density Testing
Cozy Harbor Seafood Renovations
South Portland, Maine**

attached to the attached In-
 nsity Test Results:

Date(s) Performed: April 29, 1996

Test (s) Performed

In-Place Density Testing -- Nuclear Method ASTM D2922

☒ Meets Specification

○ Selected Tests Do Not Meet Specification – Noted with an *

Note: Materials descriptions and maximum laboratory dry density values were transmittted under separate cover and are referenced in the attached summaries by the material number.

Remarks:

Copy To:

Signed:

If enclosures are not as noted, kindly notify us at once

8748716 P.02

01

06-20-1936 09:59AM 2 FROM: COZY HARBOR

R. W. Edwards Associates, Inc.
P.O. Box 1730
San Francisco, Ca 94073

LETTER OF TRANSMITTAL

(200-124-800)
Fax: (415) 734-8112

Date:	02-May-96	Project No.:	235-212
Attention:	Mr. John Norton		
Re:	Concrete Testing		

Cozy Harbor School

110 Dartmouth St.

San Francisco, Ca 94102

We are sending you attached concrete cylinder test results:

Cylinder No. (s)	Age (Days)
15648	7
15652	7
15656	7

Remarks:

Copy To:

Signed: Melody Roy

If enclosures are not as noted, kindly notify us at once.

8748716 P.03

TO

05:20:1596 FROM: COZY HARBOR

R. W. GILLESPIE & ASSOCIATES, INC.
P. O. Box 1730 Sanford, Maine 04073 (207) 324-8008

Page 1 of 3

CONCRETE TEST/PLACEMENT REPORT

Project Name: Cozy Harbor Seafood
Project No.: 28-212
Weather Conditions: Partly cloudy, cool
Method of Placement: Pump
Admixtures: --
Placement Location: Lab Placement #2; Between C&F, 4&10 Lines
Test Cylinder Location: Between 4&5, C&D Lines

Date Cylinders Cast: 24-Apr-96
Concrete Supplier: F.R. Carroll
General Contractor: Brown Const.
Design Strength: 3,000 psi
Max Agg. Size: 1½"

6x12 Cylinders	4	Cast by	Scott L. Harmon	Time	
Load No.	3/14	Slump (in)	4½	Batched @	7:10
Test	1118	Air (°F)	53	Arrived @	7:50
Truck No.		Concrete (°F)	62	Total Time	70 min
Cubic Yds.	10	Air Content (%)	--		

Specimen Storage: Field cure for 1 day

Lab No.	Test Date	Test Dia (in)	Area (in²)	Age (Days)	Load (lbs)	Compressive Strength (psi)	Break type
15648	01-May-96	6.01	28.37	7	104,500	3680	4 ✓
15649	22-May-96	6.01	28.37	28			
15650	22-May-96	6.01	28.37	28			
15651	HOLD	6.01	28.37	HOLD			

Types of Breaks



Cone
1



Cone & Split
2



Cone & Shear
3



Shear
4



Columnar
5

Load	Ticket Number	Truck Number	Cubic Yds	Slump (Inches)	Air Temp (°F)	Cone Temp (°F)	(%) Air Content	Time (min.)
1/14	1118	1	10	5	53	63	--	70
2/14	1117	6	10	5	53	63	--	80
4/14	1120	5	10	4¾	55	62	--	60
5/14	1121	9	10	4½	55	62	--	50

Remarks:

Checked by:

cc:

R. W. GILLESPIE & ASSOCIATES, INC.

P. O. Box 1730 Sanford, Maine 04073 (207) 324-8008

Page 2 of 3

CONCRETE TEST/PLACEMENT REPORT

Project Name: Cozy Harbor Seafood
 Project No: 235-212
 Weather Conditions: Partly to mostly cloudy, cool
 Method of Placement: Pump
 Admixtures: --
 Placement Location: Slab Placement #2; Between C&F, 4&10 Lines
 Test Cylinder Location: Between 6&7, D&E Lines

Date Cylinders Cast: 24-Apr-96
 Concrete Supplier: F.R. Carroll
 General Contractor: Brown Const.
 Design Strength: 3,000 psi
 Max Agg. Size: 1 1/2"

6x12 Cylinders	4	Cast by	Scott L. Harmon	Time	
Load No.	6/14	Slump (in)	4 1/4	Bathed @	9:12
Ticket No.	1122	Air (°F)	61	Arrived @	8:45
Truck No.	14	Concrete (°F)	62	Total Time	60 min
Cubic Yds.	10	Air Content (%)	--		

Specimen Storage: Field cure for 1 day

Lab No.	Test Date	Avg Dia (in)	Area (in ²)	Age (Days)	Load (lbs)	Compressive Strength (psi)	Break type
15652	01-May-96	6.01	28.37	7	116,500	4110	4 ✓
15653	22-May-96	6.01	28.37	28			
15654	22-May-96	6.01	28.37	28			
15655	HOLD	6.01	28.37	HOLD			

Types of Breaks



Cone
1



Cone & Split
2



Cone & Shear
3



Shear
4



Columnar
5

Load	Ticket Number	Truck Number	Cubic Yds	Slump (inches)	Air Temp (°F)	Cone Temp (°F)	(%) Air Content	Time (min.)
7/14	1123	7	9	5	61	62	--	60
8/14	1124	1	10	4 1/4	58	62	--	55
9/14	1126	2	10	4 1/4	58	62	--	60
10/14	1126	11	8	4 1/4	58	62	--	60
11/14	1129	3	10	5	58	62	--	60

Remarks:

Checked by: 

cc:

R. W. GILLESPIE & ASSOCIATES, INC.
P. O. Box 1730 Sanford, Maine 04073 (207) 324-8008

Page 3 of 3

CONCRETE TEST/PLACEMENT REPORT

Project Name: Cozy Harbor Seafood
Project No: 235-212
Weather Conditions: Mostly cloudy, cool
Method of Placement: Pump
Admixtures: --
Placement Location: Lab Placement #2: Between C&F, 4&10 Lines
Test Cylinder Location: Between 9&10, E&F Lines

Date Cylinders Cast: 24-Apr-96
Concrete Supplier: F.R. Carroll
General Contractor: Brown Const.
Design Strength: 3,000 psi
Max Agg. Size: 1½"

6x12 Cylinders	4	Cast by	Scott L. Harmon	Time
Load No.	12/14	Slump (in)	4½	
Ticket No.	1131	Air (°F)	60	
Truck No.	9	Concrete (°F)	62	
Cubic Yds.	10	Air Content (%)	--	
				Batched @ 9:50
				Arrived @ 10:25
				Total Time 90 min

Specimen Storage: Field cure for 1 day

Lab No.	Test Date	Avg Dia (in)	Area (in ²)	Age (Days)	Load (lbs)	Compressive Strength (psi)	Break type
15656	01-May-96	6.01	28.37	7	114,500	4035	4
15657	22-May-96	6.01	28.37	28			
15658	22-May-96	6.01	28.37	28			
15659	HOLD	6.01	28.37	HOLD			

Types of Breaks



Cone
1



Cone & Split
2



Cone & Shear
3



Shear
4



Columnar
5

Load	Ticket Number	Truck Number	Cubic Yds	Slump (inches)	Air Temp (°F)	Cone Temp (°F)	(%) Air Content	Time (min.)
13/14	1135	4	10	4½	61	62	--	85
14/14	1139	13	11	4½	65	62	--	--

Remarks:

cc:

Checked by:

R. W. Gillespie & Associates, Inc.
P.O. Box 1730
Sanford, Maine 04073

(207)324-8008
Fax (207)324-8042

LETTER OF TRANSMITTAL

Cozy Harbor Seafood
110 Dartmouth Street
So. Portland, ME 04106

Date:	09-May-96	Project No.	235-212
Attention:	Mr. John Norton		
Re:	Concrete Testing		

We are sending you attached concrete cylinder test results.

Cylinder No. (s)	Age (Days)
15720	7
15724	7
15728	7

Remarks:

Copy To:

Signed: Melody Roy

If enclosures are not as noted, kindly notify us at once.

8748716 P. 07

TO

05-22-1996 10:02AM FROM COZY HARBOR

R. W. GILLESPIE & ASSOCIATES, INC.
P. O. Box 1730 Sanford, Maine 04073 (207) 324-8008

Page 1 of 3

CONCRETE TEST/PLACEMENT REPORT

Project Name: Cozy Harbor Seafood
Project No: 235-212
Weather Conditions: Partly cloudy, cool
Method of Placement: Pump with Boom
Admixtures: --
Placement Location: A-B; 1-9
Test Cylinder Location: A1-B1

Date Cylinders Cast: 01-May-96
Concrete Supplier: F.R. Carroll
General Contractor: Brown Const.
Design Strength: 3,000 psi
Max Agg. Size: 1½"

6x12 Cylinders	4	Cast by	Jeffrey A. Hallett	Time Batched @ 6:20 Arrived @ 7:00 Total Time 80 min
Load No.	1/13	Slump (in)	4½	
Ticket No.	1244	Air (°F)	50	
Truck No.	6	Concrete (°F)	58	
Cubic Yds.	10	Air Content (%)	--	

Specimen Storage: Field cure for 1 day

Lab No.	Test Date	Avg Dia. (in)	Area (in ²)	Age (Days)	Load (lbs)	Compressive Strength (psi)	Break type
15720	08-May-96	8.01	28.37	7	100,000	5520	S
15721	13-May-96	8.01	28.37	21			
15722	29-May-96	8.01	28.37	28			
15723	HOLD	8.01	28.37	HOLD			

Types of Breaks



Cone
1



Cone & Split
2



Cone & Shear
3



Shear
4



Columnar
5

Load	Ticket Number	Truck Number	Cubic Yds	Slump (inches)	Air Temp (°F)	Conc Temp (°F)	(%) Air Content	Time (min.)
2/13	1245	14	10	--	50	--	--	55
3/13	1246	5	10	4½ *	51	--	--	65
4/13	1247	10	10	4¼	53	57	--	55
5/13	1248	1	10	2½	53	57	--	55

Remarks: * Visual

Checked by: K

cc:

R. W. GILLESPIE & ASSOCIATES, INC.
P. O. Box 1730 Sanford, Maine 04073 (207) 324-8008

Page 2 of 3

CONCRETE TEST/PLACEMENT REPORT

Project Name: Cozy Harbor Seafood
Project No: 235-212
Weather Conditions: Clear, warm
Method of Placement: Pump with Boom
Admixtures: --
Placement Location: A-B; 1--9
Test Cylinder Location: A4-B4

Date Cylinders Cast: 01-May-96
Concrete Supplier: F.R. Carroll
General Contractor: Brown Const.
Design Strength: 3,000 psi
Max Agg. Size: 1 1/2"

6x12 Cylinders	4	Cast by	Jeffrey A. Hallett	Time	
Load No.	5/13	Slump (in)	4 1/2		
Ticket No.	1249	Air (°F)	57		Settled @ 7:55
Truck No.	3	Concrete (°F)	58		Arrived @ 8:30
Cubic Yds.	10	Air Content (%)	--		Total Time 80 min

Specimen Storage: Field cure for 1 day

Lab No.	Test Date	Avg Dia (in)	Area (in ²)	Age (Days)	Load (lbs)	Compressive Strength (psi)	Break type
15724	08-May-96	6.01	28.37	7	110,000	3880	4
15725	29-May-96	6.01	28.37	28			
15726	29-May-96	6.01	28.37	23			
15727	HOLD	6.01	28.37	HOLD			

Types of Breaks



Cone
1



Cone & Split
2



Cone & Shear
3



Shear
4



Columnar
5

Load	Ticket Number	Truck Number	Cubic Yds	Slump (inches)	Air Temp (°F)	Conc Temp (°F)	(%) Air Content	Time (min.)
7/13	1250	2	10	4 1/2 *	57	58	--	80
8/13	1252	11	8	5	57	58	--	65
9/13	1253	8	10.5	4	53	60	--	70
10/13	1254	14	10.5	3 1/2	53	59	--	55

Remarks: * Visual

Checked by: (Signature)

cc:

R. W. GILLESPIE & ASSOCIATES, INC.

P. O. Box 1730 Sanford, Maine 04073 (207) 324-8008

Page 3 of 3

CONCRETE TEST/PLACEMENT REPORT

Project Name: Cozy Harbor Seafood
Project No: 235-212
Weather Conditions: Clear, sunny
Method of Placement: Pump with Boom
Admixtures: --

Date Cylinders Cast: 01-May-96
Concrete Supplier: F.R. Carroll
General Contractor: Brown Const.
Design Strength: 3,000 psi
Max Agg. Size: 1½"

Placement Location: A-B; 1-9
Test Cylinder Location: B8.5 (freezer wall, cooler side of wall)

6x12 Cylinders	4	Cast by	Jeffrey A. Hallatt	Time	
Load No.	11/13	Slump (in)	5½		Bathed @ 9:30
Ticket No.	1257	Air (°F)	53		Arrived @ 10:10
Truck No.	5	Concrete (°F)	60		Total Time 50 min
Cubic Yds.	10½	Air Content (%)	--		

Specimen Storage: Field cure for 1 day

Lab No.	Test Date	Avg Dia (in)	Area (in ²)	Age (Days)	Load (lbs)	Compressive Strength (psi)	Break type
15728	08-May-96	6.01	28.37	7	102,500	3610	4
15729	29-May-96	6.01	28.37	28			
15730	29-May-96	6.01	28.37	28			
15731	HOLD	6.01	28.37	HOLD			

Types of Breaks



Cone
1



Cone & Split
2



Cone & Shear
3



Shear
4



Columnar
5

Load	Ticket Number	Truck Number	Cubic Yds	Slump (inches)	Air Temp (°F)	Conc Temp (°F)	(%) Air Content	Time (min.)
12/13	1259	10	10½	4½ *	53	--	--	70
13/13	1231	1	10	4 *	60	57	--	65

Remarks: * Visual

Checked by:

cc:

R. W. Gillespie & Associates, Inc.
P.O. Box 1730
Sanford, Maine 04073

LETTER OF TRANSMITTAL

(207)324-8008
Fax (207)324-8042

Date:	10-May-96	Project No.:	235-212
Attention: Mr. John Norton			
Re: Concrete Testing			

Cozy Harbor Seafood

110 Dartmouth Street

So. Portland, ME 04106

We are sending you attached concrete cylinder test results.

Cylinder No. (s)

Age (Days)

15536
15537
15540
15541

28
28
28
28

Remarks:

Copy To:

Signed: Melody Roy

If enclosures are not as noted, kindly notify us at once.

0749716 P.11

TO

05-20-1996 10:05AM FROM COZY HARBOR

R. W. GILLESPIE & ASSOCIATES, INC.

P. O. Box 1730 Sanford, Maine 04073 (207) 324-8008

Page 1 of 2

CONCRETE TEST/PLACEMENT REPORT

Project Name: Cozy Harbor Seafood

Project No: 235-212

Weather Conditions: Mostly cloudy, cool

Method of Placement: Pump

Admixtures: --

Placement Location: Slab #1 (F to K, 4 to 7 plus F to G, 7 to 9 lines)

Test Cylinder Location: Between F and G, 4 and 5 lines

Date Cylinders Cast: 12-Apr-96

Concrete Supplier: F.R. Carroll

General Contractor: Brown Const.

Design Strength: 3,000 psi

Max Agg. Size: 1/2"

6x12 Cylinders	4	Cast by	Scott L. Harmon	Time	
Load No.	2/9	Slump (in)	--	Batched @	7:10
Ticket No.	10566	Air (°F)	47	Arrived @	7:45
Truck No.	10	Concrete (°F)	--	Total Time	70 min
Cubic Yds.	10	Air Content (%)	--		

Specimen Storage: Field cure for 3 days

Lab No.	Test Date	Avg Dia (in)	Area (in ²)	Age (Days)	Load (lbs)	Compressive Strength (psi)	Break type
15535	19-Apr-96	6.01	28.27	7	102,000	3595	4
15536	10-May-96	6.01	28.37	28	126,000	4440	4
15537	10-May-96	6.01	28.37	28	127,000	4480	4
15538	HOLD	6.01	28.37	HOLD			

Types of Breaks



Cone
1



Cone & Split
2



Cone & Shear
3



Shear
4



Columnar
5

Load	Ticket Number	Truck Number	Cubic Yds	Slump (inches)	Air Temp (°F)	Conc Temp (°F)	(%) Air Content	Time (min)
1/9	10585	4	10	5	47	63	--	95
3/9	10588	13	10	5	47	60	--	65
4/9	10591	5	10	4 1/2	48	60	--	65
5/9	10592	14	10	4 1/4	50	61	--	60
6/9	10595	4	10	4 1/4	50	60	--	60

Remarks:

Checked by:

cc:

R. W. GILLESPIE & ASSOCIATES, INC.

P. O. Box 1730 Sanford, Maine 04073 (207) 324-0008

Page 2 of 2

CONCRETE TEST/PLACEMENT REPORT

Project Name:	Cozy Harbor Seafood	Date Cylinders Cast:	12-Apr-96
Project No:	235-212	Concrete Supplier:	F.R. Carroll
Weather Conditions:	Mostly cloudy, cool	General Contractor:	Brown Const.
Method of Placement:	Pump	Design Strength:	3,000 psi
Admixtures:	--	Max Agg. Size:	1 1/2"
Placement Location:	Slab #1 (F to K, 4 to 7 plus F to G, 7 to 9 lines)		
Test Cylinder Location:	Between F.5 and G.5, 4.7 and 7 lines		

6x12 Cylinders	4	Cast by	Scott L. Harmon	Time	
Load No.	7/9	Slump (in)	4 1/4		
Ticket No.	10596	Air (°F)	51		Batched @ 9:10
Truck No.	2	Concrete (°F)	59		Arrived @ 9:50
Cubic Yds.	10	Air Content (%)	--		Total Time 70 min

Specimen Storage: Field cure for 3 days

Lab No.	Test Date	Avg Dia (in)	Area (in ²)	Age (Days)	Load (lbs)	Compressive Strength (psi)	Break type:
15539	19-Apr-96	6.01	28.37	7	96,000	3380	4
15540	10-May-96	6.01	28.37	28	126,500	4460	4
15341	10-May-96	6.01	28.37	28	121,500	4280	3
15542	HOLD	6.01	28.37	HOLD			

Types of Breaks



Cone
1



Cone & Split
2



Cone & Shear
3



Shear
4



Columnar
5

Load	Ticket Number	Truck Number	Cubic Yds	Slump (inches)	Air Temp (°F)	Concrete Temp (°F)	(%) Air Content	Time (min.)
8/9	10597	10	8	4 1/4	51	59	--	70
9/9	10599	11	8 1/2	--	51	59	--	80

Remarks:

Checked by: [Signature]

cc:

SUMMARY OF IN-PLACE DENSITY TESTS
COZY HARBOR SEAFOODS
SOUTH PORTLAND, MAINE
PROJECT NO. 235-212

Date: April 29, 1996

Test No.	Location	Elevation	Dry Density (pcf)	Water Content (%)	Percent of Max. (%)
1	4.5/A.5	FG Slab Base	124.8	6.8	96.7
2	5/A.8	FG Slab Base	127.3	5.4	98.5
3	4/A.7	FG Slab Base	123.1	5.3	95.3
4	6.5/B	FG Slab Base	130.1	5.6	100+
5	8.2/A.6	FG Slab Base	122.9	5.5	95.2
6	6.2/A.1	FG Slab Base	123.6	3.8	95.7

Remarks: FG = Finish Grade

8748716 P-13

05-20-1996 10:07AM FROM COZY HARBOR

Seafood Processing Facility
Cozy Harbor Seafood
Portland, Maine
LEA Project No. 90010.00

ADDENDUM NO. 1

ITEM NO.	DWG NO./ SPEC SECTION	CHANGE
1.	Add Alt.#5	Change to read as follows: "Electrical Contractor shall provide material and labor for connection to Owner's process equipment. Include circuit breakers in each power panelboard PF1 thru PF4 as needed and connections and drops from same to each piece of Owner furnished equipment."
2.	SC-4	Omit the following sentence: "The Contractor shall make such arrangements with his employees as not to conflict with the wage and hour laws of the State and the United States of America."
3.	SC-8	Change Paragraph 1.21, D.: Testing shall be paid for by the Owner, per Section 03350, Paragraph 1.08, unless such specified testing fails, in which case the cost of retesting will be at the Contractor's expense.
4.	Dwg S-3	Omit reference to piles in general notes #1. None are required.
5.	Dwg S-3	Change Section 5: The vapor barrier under the freezer slab is to be 60 mil thickness, not 10.
6.	Dwg S-1	Clarification: Welded wire fabric in new slab to be 6x6 W4.0 x W4.0.
7.	Dwg S-1 <i>done</i>	Clarification: Saw cut control joints for new concrete slab are located at high points of finished floor as shown on Drawing A-1.
8.	Dwg S-1	- Change: Tank Pad will be rotated 90° on site. Section A-A should show a thickened slab measuring 39' total depth, with reinforcing stopping 3" max from bottom of the haunch.
9.	Dwg S-4	Change General Notes to reference the BOCA National Building Code 1993 and the City of Portland Design shall be for a snow load of 50 psf.
10.	Dwg A-1 Sect 09705	New resinous flooring shall be located only on existing concrete slab in Production Room 112 from column line K/4 thru 8 around Break Room to line of floor drains along column lines 4 thru 8 midway between E and F (see expansion joint on S-1). The same system will be located in the Rooms 109 and 110. The intent of the resinous flooring is to provide a finished floor slope to drains of 1/8"/ft. Fill material may be equal to Master Builders EMACO T430 rapid setting mortar with a minimum 8-hour cure. The resinous flooring system may cure within 72 hours.
11.	Dwg A-1	- Clarification: The Loading Dock (Room 113) slab will be removed and replaced with new slab, sloping to drains. New masonry openings at Loading Dock Area include a 12' wide x 8' high M.O. at door 121 and for the 8'x8' M.O.'s at new doors 118 and 119. This involves demo of existing windows and one overhead door at these areas.
12.	Dwg A-1	- Add: Twenty-Eight (28) steel pipe bollards at door and material lift locations.
13.	Dwg A-1	✓ Change: Former overhead door in Fish Processing area west wall shall be a new 12' wide x 10' hi Thermacore 501 sectional door. A new C 9x20 lintel will be required at this door head <i>detail</i>
14.	Dwg A-1	Change: Stair No.4 on west wall of Fish Processing 118 will be relocated to north wall. <i>- site plan?</i>
15.	Dwg A-1	Add: 2'-8" x 7'-0" wood door from Open Office Area to Storage Room 108.
16.	Dwg A-2	Change: South walls of Open Office 102 and Office 111 will include 1 1/2" rigid insulation installed in 1 1/2" Z-furring in lieu of the 7/8" hat furring.
17.	Dwg A-2	Clarification: Counter in Break Room is by Owner.
18.	Dwg A-4	Clarification: All references to glass block are to be the Lexan block windows (Sect.04300, 2.04)

MAC-15916?

Addendum No. 1
February 14, 1998

Seafood Processing Facility
Cozy Harbor Seafood
Portland, Maine
LEA Project No. 98018.00

ITEM NO.	DWG NO./ SPEC SECTION	CHANGE
19.	Dwg A-2	Clarification: Window W-3 is to be 1/4" clear float glass, ASTM C1036, Class 1, in painted hollow metal frame 6'-4" wide x 4'-0" high with center mullion. Exterior windows should be equal to Kawneer 831HT-SH, thermal single-hung, AAMA C60, clear anodized aluminum frames, with 1" insulated glass. Windows should include screens and transom frames to receive 3" thick Lexan block windows.
20.	Dwg A-6	Add: The following rooms shall receive vinyl composition tile (VCT) flooring and vinyl wall base: Rooms 101 thru 108 and 111. VCT shall be equal to Armstrong Imperial Texture Excelon 12"x12"x1/8" thick. Tile will be selected on at least two colors. Cove base will be equal to Armstrong 4" high x 1/8" thick, top set coved and toeless, pre molded external corners, color to be selected by the Architect.
21.	Spec 09900	Change Par. 3.05 A, Exterior Concrete Block to: 1. One coat Tnemec 151 Elasto-Grip, 4 mil DFT. 2. One coat Tnemec 158 Enviro-Crete, 9-10 mil DFT. Change Par. 3.06 A.3. to add: Two colors will be selected for each wall as horizontal bands.
22.	Dwg A-6	Clarification: Frames for double-acting doors shall be hollow metal 16-gauge without rebate and shall have 5/16" steel full height backup plate inserted into opening and grouted into the slab or otherwise equally anchored to the slab.
23.	Dwg A-3	Clarification: Section reference 6/A-5 should read, "1/A-5."
24.	Spec 09511	Clarification: Use Sanigrid by Kemlite or equal type grid system in the process areas (Rooms 109, 110, 112, 116). Use Alumax or equal type grid system in the office/ employee areas.
25.	Electrical	Relocate panelboards PP1, PP2, PP3, and PP4 from first floor process areas to mezzanine level east wall at column line 8.
26.	Electrical	Relocate main switchboard and panelboard PPA from mezzanine level west wall column line 1 to mezzanine level east wall column line 5.
27.	Electrical	Panelboard PPA in Break Room shall now be called panelboard IPA.
28.	Electrical	Relocate ice machine auger and ice machine from mezzanine level east wall column line 7 to same level west wall column line 7. <i>- drawn & air gap</i>
29.	Electrical	Utility Company pad-mounted transformer and associated pull box and conduit run up building shall be relocated to column line 4. Extend PVC run underground to new location, coordinating with plumbing contractor's invert.
30.	Electrical	Relocate (3) duplex receptacles for vending machines located in Break Room from north wall to east wall.
31.	Electrical	Install (1) duplex receptacle in Break Room at column line 8/H 18" above finished floor on circuit number RPA-28.
32.	Electrical	Replace (2) duplex receptacles in Break Room for microwaves with (2) double duplex receptacles. Circuit numbers shall be RPA-7,9 and RPA-24,28. These receptacles shall be mounted 42" AFF.
33.	Electrical	Relocate duplex receptacle circuit #23 on north wall of Open Office from 18" AFF to 42" AFF and change to GFI protection, located towards end of counter.
34.	Electrical	Install (1) duplex receptacle with GFI protection on the north wall of the Open Office at column line 9/H mounted 42" AFF, located towards opposite end of counter from receptacle mentioned above. Circuit number shall be RPA-31.
35.	Electrical	Relocate existing Quonset structure panelboard from column line A/1 to north wall of Quonset.
36.	Electrical	Lighting Fixture type "G" shall be 150W metal halide.

Addendum No. 1
February 14, 1998

Brown CONSTRUCTION

TO: CITY OF PORTLAND CODE ENFORCEMENT ATTN: AMY SIMPSON

FROM: TOM ANUSZEWSKI DATE: 6-13-96

SUBJECT: CORZY HARBOR SEAFOOD, 75 ST. JOHN ST.

TOTAL PAGES INCLUDING THIS SHEET: 3 JOB#

FAX MESSAGE:

Any,
As requested via Ed Gabel, attached
is the SPRINKLER SYSTEM MATERIAL & TEST
Certificate.

If any additional information is required,
or if you have any questions, please
give me a call.

Tom

Brown Construction, Inc.

253 Warren Ave. / P. O. Box 1217 / Portland, ME 04104 / FAX 207-797-2948

207-797-6152



CONTRACTOR'S MATERIAL & TEST CERTIFICATE FOR ABOVEGROUND PIPING

PROCEDURE

2-231

Upon completion of work, inspection and tests shall be made by the contractor's representative and witnessed by an owner's representative. All defects shall be corrected and system left in service before contractor's personnel finally leave the job.

A certificate shall be filled out and signed by both representatives. Copies shall be prepared for approving authorities, owners and contractor. It is understood the owner's representative's signature in no way prejudices any claim against contractor for faulty material, poor workmanship, or failure to comply with approving authority's requirements or local ordinances.

PROPERTY NAME

COZY HARBOR SEAFOOD

DATE

6-10-96

PROPERTY ADDRESS

ST. JOHN STREET PORTLAND

ACCEPTED BY APPROVING AUTHORITY(S) NAMES

STATE FIRE MARSHALL'S OFFICE

ADDRESS

397 WATERST. GARDNER, MAINE 04345

PLANS

INSTALLATION CONFORMS TO ACCEPTED PLANS

EQUIPMENT USED IS APPROVED

IF NO, EXPLAIN DEVIATIONS

☒ YES ☐ NO☒ YES ☐ NO

INSTRUCTIONS

HAS PERSON IN CHARGE OF FIRE EQUIPMENT BEEN INSTRUCTED AS TO LOCATION OF CONTROL VALVES AND CARE AND MAINTENANCE OF THIS NEW EQUIPMENT

☒ YES ☐ NO

HAVE COPIES OF APPROPRIATE INSTRUCTIONS AND CARE AND MAINTENANCE CHARTS AND NFPA 13A BEEN LEFT ON PREMISES

☒ YES ☐ NO

LOCATION OF SYSTEM

SUPPLIES BLDG.

ENTIRE BLDG.

SPRINKLERS

MAKE	MODEL	YEAR OF MANUFACTURE	ORIFICE SIZE	QUANTITY	TEMPERATURE RATING
CENTRAL	"GB" UPR	1996	1/2"	108	200°
CENTRAL	"GB" PEND	1996	1/2"	131	155°
CENTRAL	"A" (4)	1996	1/2"	24	165°

PIPE AND FITTINGS

PIPE CONFORMS TO NFPA STANDARD

FITTINGS CONFORM TO NFPA STANDARD

☒ YES ☐ NO☒ YES ☐ NO

ALARM VALVE OR FLOW INDICATOR

ALARM DEVICE

TYPE	MAKE	MODEL	MAXIMUM TIME TO OPERATE
CENTRAL ALARM CHECK	CENTRAL	"G"	19

DRY VALVE

MAKE	MODEL	SERIAL NO.	MAKE	MODEL	SERIAL NO.
CENTRAL	AG				

TIME TO TRIP THRU TEST PIPE	WATER PRESSURE	AIR PRESSURE	TRIP POINT AIR PRESSURE	TIME WATER REACHED TEST OUTLET	TIME WATER REACHED OPERATING POINT
MIN. SEC.	PSI	PSI	PSI	MIN. SEC.	MIN. SEC.
Without O.O.D.					
With O.O.D.					

IF NO, EXPLAIN

DELUGE & PREACTION VALVES	OPERATION		<input checked="" type="checkbox"/> PNEUMATIC <input type="checkbox"/> ELECTRIC <input type="checkbox"/> HYDRAULIC	
	PIPING SUPERVISED		<input checked="" type="checkbox"/> YES <input type="checkbox"/> NO	
	DOES VALVE OPERATE FROM THE MANUAL TRIP AND/OR REMOTE CONTROL STATIONS		<input checked="" type="checkbox"/> YES <input type="checkbox"/> NO	
	IS THERE AN ACCESSIBLE FACILITY IN EACH CIRCUIT FOR TESTING		<input checked="" type="checkbox"/> YES <input type="checkbox"/> NO	
TEST DESCRIPTION	MAKE	MODEL	DOES EACH CIRCUIT OPERATE SUPERVISION LOSS ALARM	DOES EACH CIRCUIT OPERATE VALVE RELEASE
			<input checked="" type="checkbox"/> YES <input type="checkbox"/> NO	<input checked="" type="checkbox"/> YES <input type="checkbox"/> NO
			MAXIMUM TIME TO OPERATE RELEASE	
			MIN. SEC.	
<p>HYDROSTATIC: Hydrostatic tests shall be made at not less than 200 psi (13.6 bars) for two hours or 50 psi (3.4 bars) above static pressure in excess of 150 psi (10.2 bars) for two hours. Differential dry-pipe valve clappers shall be left open during test to prevent damage.</p> <p>FLUSHING: Flow the required rate until water is clear as indicated by no convection of foreign material in burlap bags at outlets such as hydrants and blow-offs. Flush at flows not less than 400 GPM (1514 L/min) for 4-inch pipe, 600 GPM (2271 L/min) for 5-inch pipe, 750 GPM (2839 L/min) for 6-inch pipe, 1000 GPM (3785 L/min) for 8-inch pipe, 1500 GPM (5678 L/min) for 10-inch pipe and 2000 GPM (7570 L/min) for 12-inch pipe. When supply cannot produce stipulated flow rates, obtain maximum available.</p> <p>PNEUMATIC: Establish 40 psi (2.7 bars) air pressure and measure drop which shall not exceed 1 1/2 psi (0.1 bars) in 24 hours. Test pressure tanks at normal water level and air pressure and measure air pressure drop which shall not exceed 1 1/2 psi (0.1 bars) in 24 hours.</p>				
TESTS	ALL PIPING HYDROSTATICALLY TESTED AT <u>200</u> PSI FOR <u>2</u> HRS		IF NO, STATE REASON	
	DRY PIPING PNEUMATICALLY TESTED		<input checked="" type="checkbox"/> YES <input type="checkbox"/> NO	
	EQUIPMENT OPERATES PROPERLY		<input checked="" type="checkbox"/> YES <input type="checkbox"/> NO	
	DRAIN TEST	READING OF GAGE LOCATED NEAR WATER SUPPLY TEST PIPE	RESIDUAL PRESSURE WITH VALVE IN TEST PIPE OPEN W/OUT	
BLANK TESTING GASKETS	STATIC PRESSURE <u>90</u> PSI		<u>78</u> PSI	
	Underground mains and lead in connections to system shall be flushed before connection made to sprinkler piping.			
	VERIFIED BY COPY OF THE U FORM NO. 808		<input checked="" type="checkbox"/> YES <input type="checkbox"/> NO	
	FLUSHED BY INSTALLER OF UNDERGROUND SPRINKLER PIPING		<input type="checkbox"/> YES <input type="checkbox"/> NO	
NUMBER USED <u>0</u>		LOCATIONS <u>EXISTING</u>		NUMBER REMOVED
WELDING	WELDED PIPING <input type="checkbox"/> YES <input checked="" type="checkbox"/> NO		IF YES	
	DO YOU CERTIFY AS THE SPRINKLER CONTRACTOR THAT ALL WELDING PROCEDURES COMPLY WITH THE REQUIREMENTS OF AT LEAST AWS D10.9, LEVEL AR-3		<input checked="" type="checkbox"/> YES <input type="checkbox"/> NO	
	DO YOU CERTIFY THAT THE WELDING WAS PERFORMED BY WELDERS QUALIFIED IN COMPLIANCE WITH THE REQUIREMENTS OF AT LEAST AWS D10.9, LEVEL AR-3		<input checked="" type="checkbox"/> YES <input type="checkbox"/> NO	
	DO YOU CERTIFY THAT WELDING WAS CARRIED OUT IN COMPLIANCE WITH A DOCUMENTED QUALITY CONTROL PROCEDURE TO INSURE THAT ALL DISC. ARE RETRIEVED, THAT OPENINGS IN PIPING ARE SMOOTH, THAT SLAG AND OTHER WELDING RESIDUE ARE REMOVED, AND THAT THE INTERNAL DIAMETERS OF PIPING ARE NOT PENETRATED		<input checked="" type="checkbox"/> YES <input type="checkbox"/> NO	
HYDRAULIC DATA NAMEPLATE	NAMEPLATE PROVIDED <input checked="" type="checkbox"/> YES <input type="checkbox"/> NO		IF NO, EXPLAIN	
REMARKS	DATE LEFT IN SERVICE WITH ALL CONTROL VALVES OPEN			
SIGNATURES	NAME OF SPRINKLER CONTRACTOR			
	<u>EASTERN FIRE PROTECTION CO.</u>			
	FOR PROPERTY OWNER (SIGNED)		TESTS WITNESSED BY	
	FOR SPRINKLER CONTRACTOR (SIGNED)		DATE	
ADDITIONAL EXPLANATION AND NOTES				

Brown CONSTRUCTION

FAX

Date June 27, 1996

Number of pages including cover sheet 2

TO: Amy Simpson
Codes Enforcement
City of Portland
Portland, ME

Phone 207-874-8300, X-0708

Fax Phone 207-874-8716

CC: John Norton, Cozy Harbor
Seafood

FROM: Tom Anuszewski, PE
Brown Construction, Inc.
253 Warren Avenue
PO Box 1217
Portland, ME 04104

Phone 207-797-6152

Fax Phone 207-797-2948

☐ Urgent ☐ For your review ☐ Reply ASAP ☐ Please Comment

Message:

**RE: Cozy Harbor Seafood
St. John Street**

Attached for your information and files is a copy of Coastal Equipment Corporation letter of this date, concerning confirmation of load test and lifting and lowering speeds of the Vertical Reciprocating Conveyor located at this project.

If you require any additional information about this piece of equipment or have any questions, please give me a call.

Thanks.

Tom

COASTAL EQUIPMENT CORPORATION

P.O. Box 1118 • Portland, Maine 04104 • Phone: 207-775-1100 • Fax 207-775-1139

06/27/96

Tom Anuszewski
Brown Construction
253 Warren Ave.
Portland, ME 04101

RE: Cozy Harbor Seafood

Dear Tom:

This letter is to confirm that a load of 6000 LBS was put on the Pflow Vertical Reciprocating Conveyor (VCR) and conveyed to the second level and returned to the floor several times. The load was also raised to the second floor and allowed to remain on the platform overnight. The conveyor showed no signs of deflection when inspected and was lowered to the floor.

The average lifting speed is 24.95 FPM

The average lowering speed is 25.023 FPM

Sincerely,

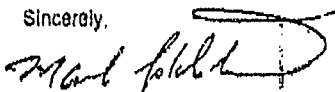

Mark Goldstein
President

MATERIAL HANDLING EQUIPMENT
ENGINEERING, FABRICATION, INSTALLATION

Brown CONSTRUCTION

FAX

Date June 27, 1996

Number of pages including cover sheet 2

TO: Amy Simpson
Codes Enforcement
City of Portland
Portland, ME

Phone 207-874-8300, X-8708

Fax Phone 207-874-8716

CC: John Norton, Cozy Harbor
Seafood

FROM: Tom Anuszewski, PE
Brown Construction, Inc.
253 Warren Avenue
PO Box 1217
Portland, ME 04104

Phone 207-797-6152

Fax Phone 207-797-2948

☐ Urgent ☐ For your review ☐ Reply ASAP ☐ Please Comment

Message:

RE: Cozy Harbor Seafood
St. John Street

Attached for your information and files is a copy of Coastal Equipment Corporation letter of this date, concerning confirmation of load test and lifting and lowering speeds of the Vertical Reciprocating Conveyor located at this project.

If you require any additional information about this piece of equipment or have any questions, please give me a call.

Thanks.

Tau

COASTAL EQUIPMENT CORPORATION

J. Box 1118 • Portland, Maine 04104 • Phone: 207-775-1103 • Fax 207-775-1139

06/27/96

Tom Anuszewski
Brown Construction
253 Warren Ave.
Portland, ME 04101

RE: Cozy Harbor Seafood

Dear Tom:

This letter is to confirm that a load of 6000 LBS was put on the Pflow Vertical Reciprocating Conveyor (VCR) and conveyed to the second level and returned to the floor several times. The load was also raised to the second floor and allowed to remain on the platform overnight. The conveyor showed no signs of deflection when inspected and was lowered to the floor.

The average lifting speed is 24.95 FPM

The average lowering speed is 25.023 FPM

Sincerely,



Mark Goldstein
President

MATERIAL HANDLING EQUIPMENT
ENGINEERING, FABRICATION, INSTALLATION



CITY OF PORTLAND, MAINE
Department of Building Inspection

Certificate of Occupancy

LOCATION

75 St John St

Issued to Cozy harbor Seafood

Date of Issue 21 June 1996

This is to certify that the building, premises, or part thereof, at the above location, built — altered — changed as to use under Building Permit No. 960189, has had final inspection, has been found to conform substantially to requirements of Zoning Ordinance and Building Code of the City, and is hereby approved for occupancy or use, limited or otherwise, as indicated below.

PORTION OF BUILDING OR PREMISES

APPROVED OCCUPANCY

Entire

Fish Processing

Limiting Conditions:

This certificate supersedes
certificate issued

Approved:

6/24/96 *William P. O'Neil*
(Date) Inspector

[Signature]
Inspector of Buildings

Notice: This certificate identifies lawful use of building or premises, and ought to be transferred from owner to owner when property changes hands. Copy will be furnished to owner or lessee for one dollar.

Amey

6/26

11:15

Ed

Brown Const.

773-5952 OK stop by
from 7am-3pm

Cozy Harbor

pre C of O insp

Vicki

Brown CONSTRUCTION

THOMAS J. ANUSZEWSKI, PE
Project Manager
207-797-6152

253 Warren Ave., P.O. Box 1217, Portland, Maine 04104

COZY HARBOR SEAFOOD
75 St. John Street, Portland, ME

FACTORS & MAJOR SUPPLIERS

SITE WORK

White Brothers, Inc.
95 Warren Ave.
Westbrook, ME 04092
(207)854-9173
Contact: Mike White

LANDSCAPING

Sabra Property Care, Inc.
4 Philips Street
Cumberland, ME 04021
(207)874-4774
Contact: Peter Monro

CONCRETE FINISHING

Quality Concrete Flooring, Inc.
RR#1, Box 319A
New Gloucester, ME 04062
(207)926-3531
Contact: Don Leavitt

REINFORCING STEEL

MacFarlane Steel Corporation
P.O. Box 142
Fryeburg, ME 04037
(207)935-3531
Contact: Pat Maillot

STRUCTURAL & MISC. STEEL

Dinsmore Steel Erecting, Inc.
45 Grand Street
South Portland, ME 04106
(207)799-1495
Contact: Frank Dinsmore

FENCING

Main Line Fence Co., Inc.
P.O. Box 27A
Cumberland, ME 04021
(207)829-5549
Contact: Brett Asherman

CONCRETE SUPPLIER

F. R. Carroll, Inc.
P.O. Box 9
Limerick, ME 04048
(207)793-8615
Contact: Mike Carroll

STAMPED CONCRETE

SIDEWALKS

Preble Concrete
26 N. Raymond Road
Gray, ME
(207)657-4239
Contact: Jeff Preble

MASONRY

Ben & Andy Libby
P.O. Box 22
Bar Mills, ME 04004
(207)929-4343
Contact: Andy Libby

ROOFING

SMR, Inc.
P.O. Box 10308
Portland, ME 04104
(207)883-1247
Contact: Steve McBrady

Brown Construction, Inc.

253 Warren Ave. / P. O. Box 1217 / Portland, ME 04104 / FAX 207-797-2948

207-797-6152



**ALUMINUM, STORE FRONT,
GLASS & GLAZING**

Cumberland County Glass
88 Second Street
South Portland, ME 04106
(207)767-7550
Contact: Ken Bouchard

**STEEL DOORS, FRAMES &
HARDWARE**

HCI/Craftsmen
P.O. Box 2532
161 John Roberts Road
South Portland, ME 04116-2532
(207)775-3191
Contact: Charles Tartre

VCT FLOORING

Paul G. White Tile Co., Inc.
50 Allen Ave.
Portland, ME 04103
(207)797-4657
Contact: Richard Gadbois

PAINTING

Theodore Logan & Son, Inc.
P.O. Box 1629
Portland, ME 04104
(207)774-6321
Contact: John Logan

MATERIAL LIFT

Coastal Equipment Corporation
P.O. Box 118
142 Presumpscot Street
Portland, ME 04104
(207)775-1100
Contact: Mark Goldstein

PLUMBING & HVAC

James J. Kelley Associates, Inc.
P.O. Box 1310
Westbrook, ME 04098-1310
(207)854-1167
Contact: Larry Guidi

**OVERHEAD DOORS &
TRAFFIC DOORS**

Overhead Door Company of Portland,
533 Riverside Industrial Parkway
Portland, ME 04103
(207)797-6734
Contact: Mike True

DRYWALL

Dirigo Drywall Associates, Inc.
225 Riverside Street
Portland, ME 04103
(207)773-3741
Contact: Larry Dahms

SUSPENDED CEILING

Landry & Sons Acoustics, Inc.
P.O. Box 976
Lewiston, ME 04243
(207)783-1269
Contact: Gerry Landry

**TOILET PARTITIONS &
ACCESSORIES**

HCI/Craftsmen
P.O. Box 2532
161 John Roberts Road
South Portland, ME 04116-2532
(207)775-3191
Contact: Charles Tartre

SPRINKLER SYSTEMS

Eastern Fire Protection
P.O. Box 1390
Auburn, ME 04210
(207)784-1507
Contact: Bub Beauchesne

ELECTRICAL

Eastern Electrical Corp.
P.O. Box 346
Portland, ME 04112
(207)772-6762
Contact: Dave Bradbury

BROWN CONSTRUCTION INC.

GENERAL CONTRACTORS

P. O. BOX 1217

PORTLAND, MAINE 04104

TRANSMITTAL LETTER

TO: INSPECTOR'S SERVICES
CITY OF PORTLAND
389 CONGRESS ST.
PORTLAND, ME. 04101

CONTRACT CORRY HARBOR SEN FORD
75 ST. JOHN STREET
DATE 5-17-96
REPLY TO: TOM ANUSZEWSKI

GENTLEMEN: P. SPAN'S - HOFFSES, GIER

WE ARE SENDING YOU: HEREWITH ☒

UNDER SEPARATE COVER ☐

SHOP DRAWINGS ☐

COLOR SAMPLES ☐

SPECIFICATIONS

PLANS ☐[illegible]

SENT TO YOU FOR THE FOLLOWING:

☐ APPROVAL

☐ FILE OR DISTRIBUTION☐ APPROVED

☐ FINAL APPROVAL

☐ INFORMATION

☐ APPROVED AS NOTED☐ REVISE☐ RESUBMIT _____ COPIES

NOTES:

NOTES: RE: BUILDING PERMIT # 960189, ISSUED 3-22-96.

Attached List of Contractors is submitted as

REQUIRED BY LETOK OF 3-21-96, ISSUED WITH PERMIT

IF THERE ARE ANY QUESTIONS, PLEASE GIVE ME A CALL

SENT BY

C. C. TO

Very truly yours,

☐ MESSENGER

JOHN NORTON,
Cozy Harp & Sinfonia

~~BROWN CONSTRUCTION INC~~

MAIL

Pe

Gen'l

Brown Const.

* office 797 6152

* JOBSITE 775 5952

Plumbing

Kelly Assoc.

Mark Golden

Dirtwork

White Bros.

Electrical

Eastern Elec.

Sprinklers

Planning & Urban Development



rec'd 3/4/96

Joseph E. Gray Jr.
Director

CITY OF PORTLAND

February 28, 1996

John Norton
Cozy Harbor
P.O. Box 389
Portland, ME 04112

RE: Cozy Harbor Revisions

Dear Mr. Norton:

This letter is to confirm the revision to the approved site plan of the Cozy Harbor project located on St. John Street. The approved revision includes relocation of catchbasin #1, pavement treatment, and relocation of entries. The revised plan has been reviewed and approved by the project review staff including representatives of the Planning, Public Works, Building Inspections, Fire and Parks Departments.

If you have any questions regarding the revision please contact the planning staff at 874-8300, extension 8720.

Sincerely,

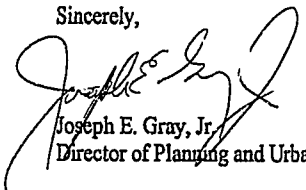
Joseph E. Gray, Jr.
Director of Planning and Urban Development

cc: Alexander Jaegerman, Chief Planner
Sarah Hopkins, Senior Planner
✓ P. Samuel Hoffses, Chief of Building Inspections
Jeff Tarling, City Arborist
Lt. Gaylen McDougall, Fire Prevention
Natalie Burns, Associate Corporation Counsel
Mary Gresik, Building Permit Secretary
James Seymour, Acting Development Review Coordinator
Kathleen Brown, Assistant Director of Economic Development
Approval Letter File

CITY OF PORTLAND, MAINE
PLANNING BOARD

Kenneth M. Cole III, C
Cyrus Hagge, Vice Chair
Joseph R. DeCoursey
John H. Carroll
Donna Williams
Jaimy Caron
Kevin McQuinn

November 15, 1995

John Norton
Cozy Harbor Seafood
P.O. Box 389
Portland, ME 04112

RE: 75 St. John Street

Dear Mr. Norton:

On November 14, 1995, the Portland Planning Board voted unanimously (6-0; DeCoursey absent) to deny your request for a waiver of the installation of sidewalk and the resetting of curb around the bullnose between St. John and Valley streets.

The Board also voted (5-1; William opposed; DeCoursey absent) to approve the site plan for the renovation of and addition to 75 St. John Street. The approval was granted for the project with the following conditions:

- i. That the applicant revise the site plan to indicate the installation of granite curbing along St. John Street and Valley Streets instead of concrete curbing.
- ii. That a sidewalk be installed and existing curb be reset around the "bullnose" within 36 months of site plan approval.
- iii. That the applicant submit a revised lighting plan showing "cut-off" lighting fixtures on the building and in the parking area prior to issuance of a building permit.
- iv. That the conditions included in a memo from the City Engineer dated November 14, 1995 be included as part of the approval.

The approval is based on the submitted site plan and the findings related to the site plan review standards as contained in Planning Report #57 -95, which is attached.

Please note the following provisions and requirements for all site plan approval:

1. A performance guarantee covering the site improvements as well as an inspection fee payment of 1.7% of the guarantee amount and 7 final sets of plans must be submitted to and approved by the Planning Division and Public Works prior to the release of the building permit. If you need to make any modifications to the approved site plan, you must submit a revised site plan for staff review and approval.

2. The site plan approval will be deemed to have expired unless work in the development has commenced within one (1) year of the approval or within a time period agreed upon in writing by the City and the applicant. Requests to extend approvals must be received before the expiration date.
3. A defect guarantee, consisting of 10% of the performance guarantee, must be posted before the performance guarantee will be released.
4. Prior to construction, a preconstruction meeting shall be held at the project site with the contractor, development review coordinator, Public Works, representative and owner to review the construction schedule and critical aspects of the site work. At that time, the site/building contractor shall provide three (3) copies of a detailed be the contractor's responsibility to arrange a mutually agreeable time for the preconstruction meeting.
5. If work will occur within the public right-of-way such as utilities, curb, sidewalk and driveway construction, a street opening permit(s) is required for your site. Please contact Carol Poliskey at 874-8300, ext. 8828. (only excavators licensed by the City of Portland are eligible.)

If there are any questions, please contact the Planning Staff.

Sincerely,



Kenneth M. Cole III, Chair
Portland Planning Board

cc: Joseph E. Gray, Jr., Director of Planning and Urban Development
Alexander Jaegerman, Chief Planner
Sarah Hopkins, Senior Planner
P. Samuel Hoffses, Chief of Building Inspections
Marge Schmuckal, Zoning Administrator
George Flaherty, Director of Environmental/Intergovernmental Services
Kathi Staples PE, City Engineer
James Seymour, Acting Development Review Coordinator
Mary Conroy, Principal Traffic Engineer
Jeff Tarling, City Arborist
Natalie Burns, Associate Corporation Counsel
Lt. Gaylen McDougall, Fire Prevention
Mary Gresik, Building Permit Secretary
Kathleen Brown, Assistant Director of Economic Development
Approval Letter File

Project Name: Cozy Harbor
 Project Address: 75 St. John St.

Page 1A
 Supplemental Sheet

Inspection Date	Type of Inspection	Remarks - prints - page #
3.21.96	Progress Plumbing & general	Have installed 12" sewer pipe @ CB#3 Backfilled - Have not capped anything yet. Saw cutting for 4" & 6" FD rains @ Bathroom area. Have also installed 6" and 8" Domestic and Waste (Process) lines @ St. John St. side.
3.25.96	Need Amendment to Site Plan	Need to submit amendment to Site Plan - re: stair and service location change on St. John Street side.
3.27.96	PUMPING TEST FDI & WATER SANITARY	OK.
3.28.96	PUMPING TEST OK	
4.3.96	PUMPING TEST - OK TO BACKFILL W/ SAND TAMING AND GOING TO POOR SLAB ON NEXT WEEK. HAVE RAISED THE ELEV. 140" OF SUMP PIT #1 AND DROPPED THE ELEVATION OF SUMP PIT #2 BY 210" USED 3,000 PSI MIX AND #4 REBAR. HAVE FURRED CONC. AROUND COLUMNS. OK TO BACKFILL.	SEE PG P-1 FOR SUMP ELEV.
4.9.96	TEST LINES OK TO BACKFILL. HAVE REQUESTED D.M.C. DO AN INSPECTION PRIOR TO THEM BACKFILLING CONDUIT IN TRENCH. 4x4x10 W/M IN PLACE TO POUR 4x8x8 @ COLUMN LINE - 6" @ W-11.5 10" @ DRAINS. BLOCKING IN OLD OPENINGS.	12" Conduit 12" Waste
4.17.96	Plumbing Inspection of Floor drains in the fish processing area. Also contractor has installed all 4" perforated pipe and gravel @ freezer area. Sump drains installed properly also.	

Project Name:

Project Address: 75 St John Street

Page 1A
Supplemental Sheet

Inspection Date	Type of Inspection	Remarks— prints— page#
4/23/96	White Bros. doing sewer connection to St. John Street. Sewer main is 10" Ø Ø still, White Bros. & City Sewer Dept. don't want to core a 8" Ø hole in pipe, so they have checked w/ Engineer and decided to go w/ a 12" Ø pipe instead (out of bkg.) Have Requested information from Engineer re the impact it would have, he says 12" will be adequate. But still need to see it on paper.	

PLUMBING APPLICATION

Department of Human Services
Division of Health Engineering
(207) 283-3826

PROPERTY ADDRESS	
Town Or Plantation	PORTLAND
Street Subdivision Lot #	75- 4 ST. JOHN STREET
PROPERTY OWNERS NAME	
COZY HARBOR SEAFOOD	
Last:	First:
Applicant Name:	JAMES J KELLEY ASSOC., INC.
Mailing Address of Owner/Applicant (If Different)	P.O. BOX 1310 WESTBROOK, ME 04098-1310

PORTLAND	PERMIT # 5695	STATE COPY
Date Permit Issued: 3, 19, 96	\$ 304	<input type="checkbox"/> Double Fee Charged
255	L.P.I. # 0124	
Local Plumbing Inspector Signature		

Owner/Applicant Statement

I certify that the information submitted is correct to the best of my knowledge and understand that any falsification is reason for the Local Plumbing Inspector to Deny a Permit.

James J. Kelley 03-18-96
Signature of Owner/Applicant Date

Caution: Inspection Required

I have inspected the installation authorized above and found it to be in compliance with the Maine Plumbing Rules.

Local Plumbing Inspector Signature _____ Date Approved _____

PERMIT INFORMATION		
This Application is for 1. <input checked="" type="checkbox"/> NEW PLUMBING 2. <input type="checkbox"/> RELOCATED PLUMBING	Type Of Structure To Be Served: 1. <input type="checkbox"/> SINGLE FAMILY DWELLING 2. <input type="checkbox"/> MODULAR OR MOBILE HOME 3. <input type="checkbox"/> MULTIPLE FAMILY DWELLING 4. <input checked="" type="checkbox"/> OTHER — SPECIFY <u>MANUFACTURER/DISTRIBUTOR</u>	Plumbing To Be Installed By: 1. <input checked="" type="checkbox"/> MASTER PLUMBER 2. <input type="checkbox"/> OIL BURNERMAN 3. <input type="checkbox"/> MFG'D. HOUSING DEALER / MECHANIC 4. <input type="checkbox"/> PUBLIC UTILITY EMPLOYEE 5. <input type="checkbox"/> PROPERTY OWNER LICENSE # <u>CQ9Q009024</u>

Hook-Up & Piping Relocation Maximum of 1 Hook-Up		Column 2 Number Type of Fixture	Column 1 Number Type of Fixture
OR <input type="checkbox"/> HOOK-UP: to public sewer in those cases where the connection is not regulated and inspected by the local Sanitary District. <input checked="" type="checkbox"/> HOOK-UP: to an existing subsurface wastewater disposal system. <input type="checkbox"/> PIPING RELOCATION: of sanitary lines, drains, and piping without new fixtures. <input type="checkbox"/> Number of Hook-Ups & Relocations \$ 4. Hook-Up & Relocation Fee	12	Hosebibb / Silcock	
	43	Floor Drain	
OR TRANSFER FEE \$6.00	1	Urinal	4
		Drinking Fountain	4
	3	Indirect Waste	5
		Water Treatment Softener, Filter, etc.	
		Grease / Oil Separator	
		Dental Cuspidor	
		Bidet	1
	1	Other: <u>TRENCH DRAIN</u>	1
	60	Fixtures (Subtotal) Column 2	15
			60
			75
			\$ 300
			\$ 4.00
			\$ 304

SEE PERMIT FEE SCHEDULE FOR CALCULATING FEE

Page 1 of 1
HHE-211 Rev 7/93

STATE COPY

SECTION 15430

PLUMBING SPECIALTIES

PART 1 GENERAL

1.01 SECTION INCLUDES

- A. Floor drains, Hub drains, and Trench drains.
- B. Cleanouts.
- C. Washdown Hose bibbs.
- D. Backflow preventers.

1.02 PRODUCTS FURNISHED BUT NOT INSTALLED UNDER THIS SECTION

- A. Toilet room accessories.

1.03 PRODUCTS INSTALLED BUT NOT FURNISHED UNDER THIS SECTION

- A. Section 01010 - Summary of Work: Owner furnished kitchen equipment.

1.04 RELATED SECTIONS

- A. Section 15410 - Plumbing Piping.
- B. Section 15440 - Plumbing Fixtures.
- C. Section 15450 - Plumbing Equipment.

1.05 REFERENCES

- A. ANSI/ASSE 1011 - Hose Connection Vacuum Breakers.
- B. ANSI/ASSE 1012 - Backflow Preventers with Immediate Atmospheric Vent.
- C. ANSI/ASSE 1013 - Backflow Preventers, Reduced Pressure Principle.
- D. ANSI A112.21.1 - Floor Drains.
- E. AWWA C506 - Backflow Prevention Devices - Reduced Pressure Principle and Double Check Valve Types.

1.06 SUBMITTALS

- A. Submit under provisions of Division 1.

- B. Shop Drawings: Indicate dimensions, weights, and placement of openings and holes.
- C. Product Data: Provide component sizes, rough-in requirements, service sizes, and finishes.
- D. Manufacturer's Installation Instructions: Indicate assembly and support requirements.
- E. Approved applications and permits for cross connection control and backflow devices.

1.07 PROJECT RECORD DOCUMENTS

- A. Submit under provisions of Division 1.
- B. Record actual locations of equipment, cleanouts, and backflow preventers.

1.08 OPERATION AND MAINTENANCE DATA

- A. Submit under provisions of Division 1.
- B. Maintenance Data: Include installation instructions, spare parts lists, exploded assembly views.

1.09 DELIVERY, STORAGE, AND HANDLING

- A. Deliver, store, protect and handle products to site under provisions of Division 1.
- B. Accept specialties on site in original factory packaging. Inspect for damage.

1.10 EXTRA MATERIALS

- A. Furnish under provisions of Division 1.
- B. Provide two sets of loose keys for wall hydrants and hose end vacuum breakers.

PART 2 PRODUCTS

2.01 FLOOR DRAINS

- A. FD-1: Cast-iron rectangular floor drain with double drainage flange, bottom outlet inside caulk connection, 12-7/8" top, heavy-duty hinged grate, removable sediment bucket. With 4-1/4" diameter holes drilled in bottom of bucket.
Size: 6" → 4" ④
Josam No. 36620
Smith No. 2473
Wade No. W-1740
Or approved equal.

- B. FD-2: Cast-iron floor drain complete with bottom outlet inside caulk connection, 7" round top, and adjustable polished nikaloy strainer and funnel.
Size: ~~4"~~ 3" (39)
Josam No. 30000-E2
Smith No. 3510-F-11
Wade No. 1100-EF
Or approved equal.
- C. HD: Cast-iron body and flashing flange with nickel bronze strainer. Provide J.R. Smith 3580 funnel. Model J.R. Smith 2010-A, or approved equal.
Size: 4".

2.02 TRENCH DRAINS

- A. Cast iron multiple section drain with inside caulk outlet, flange and special duty (over 10,000 lbs.) ductile iron loose set grates. 24 foot total drain length. Pitch drain to 6" train outlet. Provide (12) 2 foot sections of total trench length. Model 2920 manufactured by WADE (or approved equal).

2.03 CLEANOUTS

- A. Interior Finished Floor Areas: Lacquered cast iron, two piece body with double drainage flange, weep holes, reversible clamping collar, and adjustable nickel-bronze strainer, round with flush cover in service areas and round with depressed cover to accept floor finish in finished floor areas; Model 4020 for tile floor areas. Model 4100 for areas subject to for truck and dolly traffic. Approved for substitutions.

2.04 WASHDOWN HOSE BIBBS

- A. Interior: Chrome plated brass with integral mounting flange, replaceable hexagonal disc, hose thread spout, chrome plated where exposed with handwheel integral vacuum breaker in conformance with ANSI/ASSE 1011; Model 952 manufactured by Chicago Faucet Co.

2.05 BACKFLOW PREVENTERS

- A. Reduced Pressure Backflow Preventers: ANSI/ASSE 1013 and AWWA C506; bronze body with bronze and plastic internal parts and stainless steel springs; two independently operating, spring loaded check valves; diaphragm type differential pressure relief valve located between check valves; third check valve which opens under back pressure in case of diaphragm failure; non-threaded vent outlet; assembled with two gate valves, strainer, and four test cocks; Model 825 as manufactured by FEBCO.

PART 3 EXECUTION

3.01 PREPARATION

- A. Coordinate cutting and forming of floor construction to receive drains to required invert elevations.

3.02 INSTALLATION

- A. Install in accordance with manufacturer's instructions.
- B. Extend cleanouts to finished floor or wall surface. Lubricate threaded cleanout plugs with mixture of graphite and linseed oil. Ensure clearance at cleanout for rodding of drainage system.
- C. Cross Connection Protection
 - 1. Backflow preventer type, application and installation shall comply with state requirements.
 - 2. Mount backflow preventers horizontally at heights and with clearances as required by State regulations.
 - a. Reduced pressure backflow preventers shall be installed between 36" to 48" above the floor with a minimum of 6" clear space all around.
 - 3. All backflow devices use for fire protection service shall also be UL/FM approved.
 - 4. Provide indirect waste piping with funnel to receive discharge from reduced pressure backflow preventer atmospheric vents and spill through air gap into floor drain.

END OF SECTION

TOM ANUSZKOWSKI

Copy Harbor

3/21/96

Preliminary Spec. Review Notes

- * Fire extinguisher w/in 10' of welding and patching 20 lb. ABC.
- * Fire hose ^{to supply} pressure, size and material as req'd or accepted by MHC.
- * Ground Fault protected.

Domestic Waste Water Line 8"

Process Waste }
Domestic Waste } 8"

White Bros. certified w/city?

Street Opening Permit - all work in LOS.

Sealed Drain Permit - plugging of ^{sewer and} storm drain ^{service}

FD-2 FD-1

Floor Drains 4" & 6"

24'-0" trough

Holding - Distribution Box(es)

3/21/94 4" and 8" DW and 12" RCP class IV @
storm drain CB3, plumbed. Not capped
existing yet. Backfilled w/ material.
Saw cutting floor to accommodate new 6"
and 4" floor drains in bathrooms.

Plumbing - Kelly Associates
Electrical - Eastern Electric
Paving - ?
~~Grading~~ - White Bros.

3/25/94 4" trunk turn - 3" FD

6/12/96: Preliminary C of I Inspection

- 1.) Fire Penetrations thru out ✓
- 2.) ANSI CERTIFICATION on GLASS WINDOW
- 3.) Fire Rated Ceiling Tiles ✓

gym
tables

- 4.) KENT ASSOC. → Boiler Installation (Exterior)
- 5.) Handrail @ EXTERIOR REAR STEPS ✓

~~6.) ALL TEST REPORTS: STEEL - WELDER'S CERT.
CONC. - REP. BATCH
STLS - WHATEVER~~

7.) JIM SLYNNER WAS ON SITE - HAS HIS ISSUES?

8.) Lt. Mac needs proper reports/acceptance

9.) Master box Tie in - not yet. Phone lines

10.) VERTICAL LIFT TEST REPORT ✱



Jim / Tie in

TH 430

KNOX BOX

6/19/96 Final: C of O Inspection

Signage Permit?

Met Sami A. Mordene - Seafood
Inspection Officer - he's very
confident that Cozy Harker
has a good operation.
All penetrations ok.

The balance of items to be submitted:

1.) All test reports : still Cert.
: Core. (representatives)
: pits

2.) H. Mac : Tie in
: Knox box

3.) Vertical ~~Concrete~~ ~~Concrete~~ ~~Concrete~~
Load Test

COMMENTS

6/9/96

Checked framing Metal Studs
OK to Close in walls
Starting to insulate 5" pressed
Sheetrock being installed.

6/11/96

Did Plumbing Inspection

6/19/96 Shetrock installed, now installing lights &
Shelving, heating system being installed

6/26/96

Did final inspection everything OK
Complete

Inspection Record

Type	Date
Foundation:	
Framing:	
Plumbing:	
Final:	
Other:	

City of Portland, Maine – Building or Use Permit Application 389 Congress Street, 04101, Tel: (207) 874-8703, FAX: 874-8716

Location of Construction: 85 St James St		Owner: Arnold Goodman		Phone:		Permit No: 960334
Owner Address:		Leasee/Buyer's Name: Wm Goodman & Sons		Phone:		<div style="border: 2px solid black; padding: 5px; text-align: center;"> PERMIT ISSUED MAY - 2 1996 CITY OF PORTLAND </div>
Contractor Name: Dahlgren Construction		Address: 20 U.S. Rt 1 Yarmouth, ME		Phone: 04096 846-3505		
Past Use: Warehouse		Proposed Use: Warehouse/Distribution		COST OF WORK: \$ 40,000.00 PERMIT FEE: \$ 225.00		
Proposed Project Description: Change Use/Make Interior Renovations]		FIRE DEPT. <input checked="" type="checkbox"/> Approved <input type="checkbox"/> Denied Signature: <i>MAN</i> PEDESTRIAN ACTIVITIES DISTRICT (P.U.D.) Action: Approved Approved with Conditions: Denied Signature: _____ Date: _____		INSPECTION: Use Group: _____ Type: _____ Signature: _____ Zoning Appeal: <input type="checkbox"/> Variance <input type="checkbox"/> Miscellaneous <input type="checkbox"/> Conditional Use <input type="checkbox"/> Interpretation <input type="checkbox"/> Approved <input type="checkbox"/> Denied		
Permit Taken By: Mary Gresik		Date Applied For: 26 April 1996		Zoning Approval: <i>of us 5/1/96</i> Special Zone or Reviews: <input type="checkbox"/> Shoreland <i>not considered</i> <input type="checkbox"/> Wetland <i>change of use</i> <input type="checkbox"/> Flood Zone <input type="checkbox"/> Subdivision <input type="checkbox"/> Site Plan <input type="checkbox"/> major <input type="checkbox"/> minor <input type="checkbox"/> mm <input type="checkbox"/>		Historic Preservation <input type="checkbox"/> Not in District or Landmark <input checked="" type="checkbox"/> Does Not Require Review <input type="checkbox"/> Requires Review

1. This permit application doesn't preclude the Applicant(s) from meeting applicable State and Federal rules.
2. Building permits do not include plumbing, septic or electrical work.
3. Building permits are void if work is not started within six (6) months of the date of issuance. False information may invalidate a building permit and stop all work..

No dumpsters to be on site in connection w/building permit

**PERMIT ISSUED
WITH LETTER**

CERTIFICATION

I hereby certify that I am the owner of record of the named property, or that the proposed work is authorized by the owner of record and that I have been authorized by the owner to make this application as his authorized agent and I agree to conform to all applicable laws of this jurisdiction. In addition, if a permit for work described in the application issued, I certify that the code official's authorized representative shall have the authority to enter all areas covered by such permit at any reasonable hour to enforce the provisions of the code(s) applicable to such permit

<i>Steve Dunn</i>		26 April 1996	
SIGNATURE OF APPLICANT	Steve Dunn	ADDRESS:	PHONE:
<i>Dahlgren Construction, Inc.</i>			
RESPONSIBLE PERSON IN CHARGE OF WORK, TITLE		PHONE:	

CEO DISTRICT

5

White-Permit Desk Green-Assessor's Canary-D.P.W. Pink-Public File Ivory Card-Inspector

ELECTRICAL PERMIT

City of Portland, Me.



To the Chief Electrical Inspector, Portland, Maine:

The undersigned hereby applies for a permit to make electrical installations in accordance with the laws of Maine, the City of Portland Electrical Ordinance, National Electrical code and the following specification:

Date 29 May 1996Permit # 3122LOCATION: PS 75 St James StOWNER Goodman ADDRESS _____

							TOTAL EACH FEE		
OUTLETS									
	Receptacles		Switches		Smoke Detector		16	.20	3.20
FIXTURES	(number of)								
	incandescent		fluorescent				80	.20	16.00
	fluorescent strip							.20	
SERVICES									
	Overhead				TTL AMPSTO	800		15.00	
	Underground					800		15.00	
TEMPORARY SERV.									
	Overhead				AMPS OVER	800		25.00	
	Underground					800		25.00	
METERS	(number of)						1	1.00	
MOTORS	(number of)							2.00	
RESID/COM	Electric units							1.00	
HEATING	oil/gas units							5.00	
APPLIANCES	Ranges		Cook Tops		Wall Ovens			2.00	
	Water heaters		Fans		Dryers			2.00	
Disposals	Dishwasher		Compactors		Others (denote)		1	2.00	
MISC. (number of)	Air Cond/win							3.00	
	Air Cond/cent							10.00	
	Signs							5.00	
	Pools							10.00	
	Alarms/res							5.00	
	Alarms/com							15.00	
	Heavy Duty							2.00	
	Outlets								
	Circus/Camv							25.00	
	Alterations							5.00	
	Fire Repairs							15.00	
	E Lights							1.00	
	E Generators							20.00	
	Panels						1	4.00	4.00
TRANSFORMER	0-25 Kva							5.00	
	25-200 Kva							8.00	
	Over 200 Kva							10.00	
TOTAL AMOUNT DUE									
MINIMUM FEE/COMMERCIAL 35.00							25.00		25.00

INSPECTION: Will be ready _____ or will call XXXXCONTRACTORS NAME Falmouth Electric Wayne MillikenADDRESS 446 Riverside Industrial ParkwayTELEPHONE Portland, ME 04103 797-6174MASTER LICENSE No. 3122

LIMITED LICENSE No. _____

SIGNATURE OF CONTRACTOR

Wayne Milliken

3/22

25 St. James St.

Godman & Linn

0129146

9/28/96

trial

Closing-in 6/6/96 by W. J. [unclear]

6/3/96 (Pledge-in)
6/24/96 (Cura IK - Thru)
6/27/96 (Final)
6/28/96 (Final)

DATE:	REMARKS:
6/5/96	Romex metal stud walls (no good) FMT on service outside (no good) } REOTAG
6/6/96	OK FOR Romex in metal studs but 2 (not in future) metallic shielding requires metallic systems
6/24/96	NOT READY FOR FINAL
6/27/96	FINAL (NOT READY)



FILL IN AND SIGN WITH 960577

APPLICATION FOR PERMIT FOR
HEATING, COOKING OR POWER EQUIPMENT

Portland, Maine,

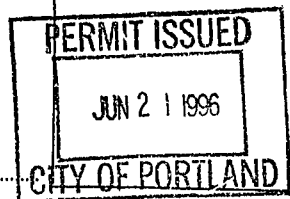

To the INSPECTOR OF BUILDINGS, PORTLAND, ME. 14 June 1996

The undersigned hereby applies for a permit to install the following heating, cooking or power equipment in accordance with the Laws of Maine, the Building Code of the City of Portland, and the following specifications:

Location 85 St James St Use of Building Big "A" No. Stories New Building
Name and address of owner of appliance William Goodman & Sons Existing "
Installer's name and address C.D. Aceto P.O. Box 754 Portland, ME 04104 Telephone 775-2402

General Description of Work

To install Force Hot Air Oil Fired Heating System

IF HEATER, OR POWER BOILER

Location of appliance 1st fl Any burnable material in floor surface or beneath? NO
If so, how protected? Kind of fuel? #2 Oil
Minimum distance to burnable material, from top of appliance casing top of furnace 20'
From top of smoke pipe 5' From front of appliance 20' From sides or back of appliance 20'
Size of chimney flue 1 - 6" Other connections to same flue no 1 - 185,000
If gas fired, how vented? Rated maximum demand per hour 1 - 140,000
Will sufficient fresh air be supplied to the appliance to insure proper and safe combustion? yes

IF OIL BURNER

Name and type of burner Beckett Labelled by underwriters' laboratories? yes
Will operator be always in attendance? NO Does oil supply line feed from top or bottom of tank? Bottom
Type of floor beneath burner Concrete Size of vent pipe 1 1/2 "
Location of oil storage 1st floor Number and capacity of tanks 2-330
Low water shut off n/a Make No.
Will all tanks be more than five feet from any flame? yes How many tanks enclosed? none
Total capacity of any existing storage tanks for furnace burners none

IF COOKING APPLIANCE

Location of appliance Any burnable material in floor surface or beneath?
If so, how protected? Height of Legs, if any
Skirting at bottom of appliance? Distance to combustible material from top of appliance?
From front of appliance From sides and back From top of smokepipe
Size of chimney flue Other connections to same flue
Is hood to be provided? If so, how vented? Forced or gravity?
If gas fired, how vented? Rated maximum demand per hour

MISCELLANEOUS EQUIPMENT OR SPECIAL INFORMATION

Charles D. Aceto Master Oil & Solid Fuel #1380
Cost of Work? 4,500.00 45.00 Permit Fee
Amount of fee enclosed?

APPROVED:

Will there be in charge of the work a person competent to see that the State and City requirements are observed?

CS 300

INSPECTION FILE SIGNATURE OF INSTALLER APPLICANT'S ASSESSOR'S COPY

City of Portland, Maine – Building or Use Permit Application 389 Congress Street, 04101, Tel: (207) 874-8703, FAX: 874-8716

Location of Construction: 75 St James St		Owner: Alside		Phone: 04105 781-5405		Permit No: 960086
Owner Address:		Leasee/Buyer's Name:		Business Name:		PERMIT ISSUED Permit issued: FEB 15 1996 CITY OF PORTLAND
Contractor Name: Quality Designs		Address: 17 Kelley Rd Falmouth, ME		Phone: 04105 781-5405		
Past Use: Wholesale		Proposed Use: Same w/int reno		COST OF WORK: \$ 4,000.00 FIRE DEPT. <input checked="" type="checkbox"/> Approved <input type="checkbox"/> Denied INSPECTION: Use Group: SI Type: 2B Signature: <i>[Signature]</i> Signature: <i>[Signature]</i> PEDESTRIAN ACTIVITIES DISTRICT <input checked="" type="checkbox"/> D.D. Action: Approved <input type="checkbox"/> Approved with Conditions: <input type="checkbox"/> Denied <input type="checkbox"/> Signature: _____ Date: _____		
Proposed Project Description: make Interior Renovations						Zoning Approval: <i>[Signature]</i> 2/12/96 Special Zoning or Reviews: <input type="checkbox"/> Shoreland <input type="checkbox"/> Wetland <input type="checkbox"/> Flood Zone <input type="checkbox"/> Subdivision <input type="checkbox"/> Site Plan mod. <input type="checkbox"/> minor <input type="checkbox"/> mm <input type="checkbox"/>
Permit Taken By: Mary Gresik		Date Applied For: 08 February 1996				Zoning Appeal: <input type="checkbox"/> Variance <input type="checkbox"/> Miscellaneous <input type="checkbox"/> Conditional Use <input type="checkbox"/> Interpretation <input type="checkbox"/> Approved <input type="checkbox"/> Denied Historic Preservation: <input checked="" type="checkbox"/> Not in District or Landmark <input type="checkbox"/> Does Not Require Review <input type="checkbox"/> Requires Review Action: <input type="checkbox"/> Approved <input type="checkbox"/> Approved with Conditions <input type="checkbox"/> Denied Date: <i>2/8/96</i> <i>[Signature]</i> CEO DISTRICT <i>[Signature]</i>

1. This permit application doesn't preclude the Applicant(s) from meeting applicable State and Federal rules.
2. Building permits do not include plumbing, septic or electrical work.
3. Building permits are void if work is not started within six (6) months of the date of issuance. False information may invalidate a building permit and stop all work..

CERTIFICATION

I hereby certify that I am the owner of record of the named property, or that the proposed work is authorized by the owner of record and that I have been authorized by the owner to make this application as his authorized agent and I agree to conform to all applicable laws of this jurisdiction. In addition, if a permit for work described in the application issued, I certify that the code official's authorized representative shall have the authority to enter all areas covered by such permit at any reasonable hour to enforce the provisions of the code(s) applicable to such permit

SIGNATURE OF APPLICANT *Terry Horr*

ADDRESS:

DATE: 08 February 1996

PHONE: 781-5405

RESPONSIBLE PERSON IN CHARGE OF WORK, TITLE

PHONE: 781-5405

White-Permit Desk Green-Assessor's Canary-D.R.W. Pink-Public File Ivory Card-Inspector

City of Portland, Maine - Building or Use Permit Application 389 Congress Street, 04101, Tel: (207) 874-8703, FAX: 874-8716

Location of Construction: 75 St John St		Owner: W N K D Ltm Lablty Co		Phone:		Permit No: 960189	
Work Address: Lessee:		Lease/Buyer's Name: Cozy Harbor,		Phone:		Business Name:	
Contractor Name: Brown Construction Inc		Address: 253 Warren Ave- Portland ME 04103		Phone: 797-6152		- call for plan	
Past Use: wholesale/warehouse		Proposed Use: fish processing		COST OF WORK: \$ 859,400		HERMIT FEE: \$ 4315	
Proposed Project Description: change/use with interior/exterior renovations of existing structure		FIRE DEPT. <input checked="" type="checkbox"/> Approved <input type="checkbox"/> Denied		INSPECTION: Use Group: <i>F</i> Type: <i>7A</i>		PERMIT ISSUED MAR 22 1996 CITY OF PORTLAND Zone: <i>OCBL</i> Zoning Approval: <i>Processing</i> Special Zone or Reviews: <input type="checkbox"/> Shoreland <input type="checkbox"/> Wetland <input type="checkbox"/> Flood Zone <input type="checkbox"/> Subdivision <input type="checkbox"/> Site Plan <input checked="" type="checkbox"/> major <input type="checkbox"/> minor <input type="checkbox"/> mm <input type="checkbox"/>	
		Signature: <i>[Signature]</i>		Signature: <i>[Signature]</i>			
		PEDESTRIAN ACTIVITIES DISTRICT (P.A.D.) Action: <input checked="" type="checkbox"/> Approved <input type="checkbox"/> Approved with Conditions <input type="checkbox"/> Denied					
Permit Taken By: <i>L Chase</i>		Date Applied For: <i>3/4/96</i>		Signature:		Date:	

1. This permit application doesn't preclude the Applicant(s) from meeting applicable State and Federal rules. *(??site plan for addition??)*
2. Building permits do not include plumbing, septic or electrical work.
3. Building permits are void if work is not started within six (6) months of the date of issuance. False information may invalidate a building permit and stop all work..

(dumpster permit : 30 cy .. ~~# 00116~~ - \$300)
30.. 2509

**PERMIT ISSUED
WITH LETTER**

**PERMIT ISSUED
WITH LETTER**

CERTIFICATION

I hereby certify that I am the owner of record of the named property, or that the proposed work is authorized by the owner of record and that I have been authorized by the owner to make this application as his authorized agent and I agree to conform to all applicable laws of this jurisdiction. In addition, if a permit for work described in the application issued, I certify that the code official's authorized representative shall have the authority to enter all areas covered by such permit at any reasonable hour to enforce the provisions of the code(s) applicable to such permit

14 March 1996

SIGNATURE OF APPLICANT

ADDRESS:

DATE: *3-4-96*

PHONE:

RESPONSIBLE PERSON IN CHARGE OF WORK, TITLE

PHONE:

White-Permit Desk Green-Assessor's Canary-D.P.W. Pink-Public File Ivory Card-Inspector

CEO DISTRICT

3

A. Simpson

City of Portland, Maine – Building or Use Permit Application 389 Congress Street, 04101, Tel: (207) 874-8703, FAX: 374-87

Location of Construction: 75 St James St		Owner:		Phone:		Permit No: 9600	
Owner Address:		Leasee/Buyer's Name: Alside		Phone:		Business Name:	
Contractor Name: Quality Design		Address: 17 Kelley Rd Falmouth, ME		Phone: 04105 781-5405		Permit Issued: FEB 15 1996	
Past Use: FREE Wholesale		Proposed Use: Same w/int reno		COST OF WORK: \$ 4,000.00		PERMIT FEE: \$ 40.00	
Proposed Project Description: make Interior Renovations		FIRE DEPT. <input type="checkbox"/> Approved <input type="checkbox"/> Denied		INSPECTION: Use Group: 1 Type: B		CITY OF PORTLAND	
		Signature: <i>[Signature]</i>		Signature: <i>[Signature]</i>		Zone: E-2 CBL:	
Permit Taken By: Mary Giesik		Date Applied For: 08 February 1996		PEDESTRIAN ACTIVITIES DISTRICT (P.U.D.)		Zoning Approval: <i>[Signature]</i> 2/12/96	
		Action: <input type="checkbox"/> Approved <input type="checkbox"/> Approved with Conditions <input type="checkbox"/> Denied		Signature: _____ Date: _____		<input type="checkbox"/> Special Zone or Review <input type="checkbox"/> Shoreland <input type="checkbox"/> Wetland <input type="checkbox"/> Flood Zone <input type="checkbox"/> Subdivision <input type="checkbox"/> Site Plan <input type="checkbox"/> major <input type="checkbox"/> minor <input type="checkbox"/> no	

1. This permit application doesn't preclude the Applicant(s) from meeting applicable State and Federal rules.
2. Building permits do not include plumbing, septic or electrical work.
3. Building permits are void if work is not started within six (6) months of the date of issuance. False information may invalidate a building permit and stop all work..

Zoning Appeal

☐ Variance
☐ Miscellaneous
☐ Conditional Use
☐ Interpretation
☐ Approved
☐ Denied

Historic Preservation

☐ Not in District or Landmark
☐ Does Not Require Review
☐ Requires Review

Action:

☐ Approved
☐ Approved with Conditions
☐ Denied

Date: *[Signature]* **2/12/96**

CERTIFICATION

I hereby certify that I am the owner of record of the named property, or that the proposed work is authorized by the owner of record and that I have been authorized by the owner to make this application as his authorized agent and I agree to conform to all applicable laws of this jurisdiction. In addition, if a permit for work described in the application issued, I certify that the code official's authorized representative shall have the authority to enter all areas covered by such permit at any reasonable hour to enforce the provisions of the code(s) applicable to such permit

SIGNATURE OF APPLICANT Terry Horr		ADDRESS:		DATE: 08 February 1996		PHONE:	
RESPONSIBLE PERSON IN CHARGE OF WORK, TITLE						PHONE:	

White-Permit Desk Green-Assessor's Canary-D.P.W. Pink-Public File Ivory Card-Inspector

CEO DISTRICT **5**

COMMENTS

3/6/96 Inspected walls installed
 checked new door shut off
 OK everything OK *OK moving*

Inspection Record

Type	Date
Foundation: _____	_____
Framing: _____	_____
Plumbing: _____	_____
Final: _____	_____
Other: _____	_____

OFFICE

Copy Room

← ADD DOOR

MENS Room

LADIES
Room

Catalog Room

Close 2
Doorways

OFFICE

SALES
DECK

Submitted By

Quality Design

13 Kelly Rd

Falmouth, ME 04105

781-5405

Alside Supply
75 St James St
Portland, ME

1 SQUARE = 1 sq Ft

= HALF WALL

= WALLS REMOVED



CITY OF PORTLAND, MAINE
Department of Building Inspection

Certificate of Occupancy

LOCATION 85 St James St

Issued to Arnold Goodman

Date of Issue 02 July 1996

This is to certify that the building, premises, or part thereof, at the above location, built — altered — changed is to use under Building Permit No. 960334, has had final inspection, has been found to conform substantially to requirements of Zoning Ordinance and Building Code of the City, and is hereby approved for occupancy or use, limited or otherwise, as indicated below.

PORTION OF BUILDING OR PREMISES

APPROVED OCCUPANCY

Entire

Warehouse/Distribution

Limiting Conditions:

This certificate supersedes
certificate issued

Approved:

7/2/96

(Date)

Inspector

Inspector of Buildings

Notice: This certificate identifies lawful use of building or premises, and ought to be transferred from owner to owner when property changes hands. Copy will be furnished to owner or lessee for one dollar.

City of Portland, Maine - Building or Use Permit Application 389 Congress Street, 04101, Tel: (207) 874-8703, FAX: 874-8716

Location of Construction: 85 St James St		Owner: Arnold Goodman		Phone:		Permit No: 960334
Owner Address:		Leasee/Buyer's Name: Mr Goodman & Sons		Phone:		
Contractor Name: Dahlgren Construction		Address: 20 U.S. Rt 1 Yarmouth, ME		Phone: 04096 846-3506		PERMIT ISSUED MAY - 2 1996 CITY OF PORTLAND
Past Use: Warehouse		Proposed Use: Warehouse/Distribution		COST OF WORK: \$ 20,000.00 PERMIT FEE: \$ 225.00		
Proposed Project Description: Change Use/Make Interior Renovations		FIRE DEPT. <input checked="" type="checkbox"/> Approved <input type="checkbox"/> Denied INSPECTION: Use Group: Type:		Signature: <i>[Signature]</i> Signature: _____ PEDESTRIAN ACTIVITIES DISTRICT (P.U.D.) Action: Approved <input type="checkbox"/> Approved with Conditions: <input type="checkbox"/> Denied <input type="checkbox"/> Signature: _____ Date: _____		Zone: CBL F-2 Zoning Approval: <i>[Signature]</i> 5/1/96 Special Zone or Reviews: <input type="checkbox"/> Shoreland <i>[Signature]</i> <input type="checkbox"/> Wetland <i>[Signature]</i> <input type="checkbox"/> Flood Zone <i>[Signature]</i> <input type="checkbox"/> Subdivision <input type="checkbox"/> Site Plan <input type="checkbox"/> major <input type="checkbox"/> minor <input type="checkbox"/> mm <input type="checkbox"/>
Permit Taken By: Mary Cresik		Date Applied For: 26 April 1996				

1. This permit application doesn't preclude the Applicant(s) from meeting applicable State and Federal rules.
2. Building permits do not include plumbing, septic or electrical work.
3. Building permits are void if work is not started within six (6) months of the date of issuance. False information may invalidate a building permit and stop all work..

No dumpsters to be on site in connection w/building permit

**PERMIT ISSUED
WITH LETTER**

CERTIFICATION

I hereby certify that I am the owner of record of the named property, or that the proposed work is authorized by the owner of record and that I have been authorized by the owner to make this application as his authorized agent and I agree to conform to all applicable laws of this jurisdiction. In addition, if a permit for work described in the application issued, I certify that the code official's authorized representative shall have the authority to enter all areas covered by such permit at any reasonable hour to enforce the provisions of the code(s) applicable to such permit

SIGNATURE OF APPLICANT <i>[Signature]</i> Steve Dunn		ADDRESS:		DATE: 26 April 1996		PHONE:	
RESPONSIBLE PERSON IN CHARGE OF WORK, TITLE <i>[Signature]</i> Dahlgren Construction, Inc.						PHONE:	

Zoning Appeal

☐ Variance
☐ Miscellaneous
☐ Conditional Use
☐ Interpretation
☐ Approved
☐ Denied

Historic Preservation

☐ Not in District or Landmark
☒ Does Not Require Review
☐ Requires Review

Action:

☐ Approved
☐ Approved with Conditions
☐ Denied

Date: *[Signature]* 4/29/96

CEO DISTRICT **5**

White-Permit Desk Green-Assessor's Canary-D.P.W. Pink-Public File Ivory Card-Inspector

Inspection Services
P. Samuel Hoffses
Chief



Planning and Urban Development
Joseph E. Gray Jr.
Director

CITY OF PORTLAND

May 3, 1996

Dahlgren Construction
20 U. S. Route 1
Yarmouth, Maine 04096

RE: 85 St. James Street
Portland, Maine

Dear Sir,

Your application to change use/make interior renovations has been reviewed and a permit is herewith issued subject to the requirements listed below. This permit does not excuse the applicant from meeting applicable State and Federal laws.

No Certificate of Occupancy will be issued until all requirements of this letter are met.

Building and Fire Code Requirements

1. The sprinkler system shall be maintained to NFPA 13 Standards.
2. A fire alarm system shall be installed in accordance with Section 7.6 of NFPA 101.
3. A fire alarm acceptance report shall be submitted to the Portland Fire Department.
4. All exit signs, lights and means of egress lighting shall be done in accordance with Chapter 10, Section and Subsections 1023. and 1024. of the City's Building Code. (The BOCA National Building Code/1993)
5. A portable fire extinguisher shall be located as per NFPA 10. They shall bear the label of an approved agency and be of an approved type.
6. Every building or structure used for storage and every section thereof considered separate shall have at least two (2) separate means of egress remotely located from each other as practicable.

If you have any questions regarding these requirements, please do not hesitate to contact this office.

Sincerely,

P. Samuel Hoffses
Chief, Code Enforcement Division

cc: Lt. McDougall, PFD