

11-15 THOMAS STREET



#9202H #9203H #9204H



FILL IN AND SIGN WITH INK 0 0565

APPLICATION FOR PERMIT FOR HEATING, COOKING OR POWER EQUIPMENT

PERMIT ISSUED

JUN 29 1978

Portland, Maine, June 29, 1978

CITY of PORTLAND

To the INSPECTOR OF BUILDINGS, PORTLAND, ME.

The undersigned hereby applies for a permit to install the following heating, cooking or power equipment in accordance with the Laws of Maine, the Building Code of the City of Portland, and the following specifications:

Location 15 Thomas St. Use of Building single family No. Stories 3 New Building Existing "
Name and address of owner of appliance Richard Balsor - same -> 871-2343
Installer's name and address Gray Oil Co.-396 Commercial St. Telephone 772-2861

General Description of Work

To install boiler & Burner - forced hot water - replacement

IF HEATER, OR POWER BOILER

Location of appliance basement Any burnable material in floor surface or beneath? no
If so, how protected? Kind of fuel? # 2 fuel oil
Minimum distance to burnable material, from top of appliance or casing top of furnace 18 in plus all around
From top of smoke pipe From front of appliance From sides or back of appliance
Size of chimney flue 10 x 12 Other connections to same flue none
If gas fired, how vented? Rated maximum demand per hour
Will sufficient fresh air be supplied to the appliance to insure proper and safe combustion? yes

IF OIL BURNER

Name and type of burner Tegaco - gun Labelled by underwriters' laboratories? yes
Will operator be always in attendance none Does oil supply line feed from top or bottom of tank? bottom
Type of floor beneath burner concrete Size of vent pipe 1 1/2
Location of oil storage basement Number and capacity of tanks 1 -275 gal.
Low water shut off yes Make McDonald Miller No. 901
Will all tanks be more than five feet from any flame? yes How many tanks enclosed? none
Total capacity of any existing storage tanks for furnace burners 275 gal.

IF COOKING APPLIANCE

Location of appliance Any burnable material in floor surface or beneath?
If so, how protected? Height of Legs, if any
Skirting at bottom of appliance? Distance to combustible material from top of appliance?
From front of appliance From sides and back From top of smokepipe
Size of chimney flue Other connections to same flue
Is hood to be provided? If so, how vented? Forced or gravity?
If gas fired, how vented? Rated maximum demand per hour

MISCELLANEOUS EQUIPMENT OR SPECIAL INFORMATION

Amount of fee enclosed? 5.00

APPROVED:

OK EJ 6/28/78

Will there be in charge of the above work a person competent to see that the State and City requirements pertaining thereto are observed?

CR 300

INSPECTION COPY

Signature of Installer

Handwritten signature of installer

NOTES

7-26-78 hot water base P. skin on
 gauge & heating it up - Super kind
 of base - will fall over oil - will
 correct the situation
 7-28-78 spoke to office & may well
 correct the situation
 8-23-78 must have satisfied owner -

- 1/2 FILL PIPE hold him to call in 2 weeks
- 1/4 VENT PIPE if not found - no work up
- Kind of fuel
- Burner & idity & support
- Name of burner
- Remote Control
- Protection
- Name
- Support
- Instruction Card
- Adequate ventilation
- Smoke, fire to combustible
- Thermal Control switch

Permit No. 98 / 19565
 Location [unclear]
 Owner [unclear] 871-2343
 Date of permit 6-29-78
 Approved 6-29-78

[Large handwritten X mark across the bottom left section of the page]



APPLICATION FOR PERMIT

DEPARTMENT OF BUILDING INSPECTIONS SERVICES

ELECTRICAL INSTALLATIONS

01/28/78

Date June 29, 19 78
 Receipt and Permit number A 12657

To the CHIEF ELECTRICAL INSPECTOR, Portland, Maine:
 The undersigned hereby applies for a permit to make electrical installations in accordance with the laws of Maine, the Portland Electrical Ordinance, the National Electrical Code and the following specifications:

LOCATION OF WORK: 15 Thomas St.
 OWNER'S NAME: Richard Balser ADDRESS: same

OUTLETS: (number of)

Lights	_____	
Receptacles	_____	
Switches	_____	
Plugmold	_____ (numbe. of feet)	
TOTAL	_____	FEES

FIXTURES: (number of)

Incandescent	_____	
Fluorescent	_____ (Do not include strip fluorescent)	
TOTAL	_____	
Strip Fluorescent, in feet	_____	

SERVICES:

Permanent, total amperes	_____	
Temporary	_____	

METERS: (number of) _____

MOTORS: (number of)

Fractional	_____	
1 HP or over	_____	

RESIDENTIAL HEATING:

Oil or Gas (number of units)	<u>xx</u>	
Electric (number of rooms)	_____	3.00

COMMERCIAL OR INDUSTRIAL HEATING:

Oil or Gas (by a main boiler)	_____	
Oil or Gas (by separate units)	_____	
Electric (total number of kws)	_____	

APPLIANCES: (number of)

Ranges	_____	Water Heaters	_____
Cook Tops	_____	Disposals	_____
Wall Ovens	_____	Dishwashers	_____
Dryers	_____	Compactors	_____
Fans	_____	Others (acnote)	_____
TOTAL	_____		

MISCELLANEOUS: (number of)

Branch Panels	_____	
Transformers	_____	
Air Conditioners	_____	
Signs	_____	
Fire/Burglar Alarms	_____	
Circus, Fairs, etc.	_____	
Alterations to wires	_____	
Repairs after fire	_____	
Heavy Duty, 220v outlets	_____	
Emergency Lights, battery	_____	
Emergency Generators	_____	

FOR ADDITIONAL WORK NOT ON ORIGINAL PERMIT	INSTALLATION FEE DUE:	_____
FOR REMOVAL OF A "STOP ORDER" (304-16.b)	DOUBLE FEE DUE:	_____
FOR PERFORMING WORK WITHOUT A PERMIT (304-9)	TOTAL AMOUNT DUE:	3.00

INSPECTION: Will be ready on 7-7-78, 19__; or Will Call _____

CONTRACTOR'S NAME: Gray Oil Co.
 ADDRESS: 396 Commerical St.
 TEL.: 772-2861

MASTER LICENSE NO.: on file
 LIMITED LICENSE NO.: _____
 SIGNATURE OF CONTRACTOR: *[Signature]*

INSPECTOR'S COPY

ELECTRICAL INSTALLATIONS —

Permit Number 12657

Location 15 Thomas St.

Owner Richard Galles

Date of Permit 6-29-78

Final Inspection 7-18-78

By Inspector Hesslein

Permit Application Register Page No. 143

INSPECTIONS: Service _____ by _____

Service called in: _____

Closing-in _____ by _____

PROGRESS INSPECTIONS: 7-7-78, none done

7-12-78, not done

7-18-78, / / /

**CODE
COMPLIANCE
COMPLETED
DATE _____**

DATE:	REMARKS:
	OK

on file
737-2803
CSC Building 5F
New York, NY
6-7-78

PERMIT TO INSTALL PLUMBING

Address 15 Tacoma St. PERMIT NUMBER 1607

Installation For one family

Owner of Bldg Richard Balsor

Owner's Address same

Plumber Ray 011-396 Commercial St. Date 6-29-78

Date Issued 6-29-78
 Portland Plumbing Inspector
 By ERNOLD R GOODWIN

App. First Insp. 0 1978
 Date
 By

App. Final Insp.
 Date
 By

- Type of Bldg. 1-1978
- Commercial
 - Residential
 - Single
 - Multi Family
 - New Construction
 - Remodeling

		SINKS		
		LAVATORIES		
		TOILETS		
		BATH TUBS		
		SHOWERS		
		DRAINS FLOOR SURFACE		
		HOT WATER TANKS		
		TANKLESS WATER HEATERS	1	2.00
		GARBAGE DISPOSALS		
		SEPTIC TANKS		
		HOUSE SEWERS		
		ROOF LEADERS		
		AUTOMATIC WASHERS		
		DISHWASHERS		
		OTHER	base fee	3.00
TOTAL				5.00

Building and Inspection Services Dept.: Plumbing Inspection

PERMIT TO INSTALL PLUMBING

Date Issued **11-12-71**
 Portland Plumbing Inspector

By **ERNOLD R. GOLDWIN**
 App. First Insp.

Date **NOV 22 1971**
 By **ERNOLD R. GOLDWIN**
 AFA Final Insp.

- Type of bldg.
- Commercial
 - Residential
 - Single
 - Multi Family
 - New Construction
 - Remodeling

Address **15 Thomas St.** PERMIT NUM **30**
 Installation For

Owner of Bldg **A. Falser**
 Owner's Address **3200**

Plumber **George Frederick** Date **11-12-71**
Old Mack Rd. Scarborough

NEW	RE	NO	FEE
	1	SINKS	
	1	LAVATORIES	2.00
		TOILETS	2.00
		BATH TUBS	
		SHOWERS	
		DRAINS FLOOR SURFACE	
		HOT WATER TANKS	
		TANKLESS WATER HEATERS	
	1	GARBAGE DISPOSALS	2.00
		SEPTIC TANKS	
		HOUSE SEWERS	
		ROOF LEADERS	
	1	AUTOMATIC WASHERS	2.00
		DISHWASHERS	
		OTHER	
TOTAL			4 0.00

Building and Inspection Services Dept: Plumbing Inspection

2768

CITY OF PORTLAND, MAINE Application for Permit to Install Wires

Permit No. 55460
Issued 11-5-71
1971

Portland, Maine

To the City Electrician, Portland, Maine

The undersigned hereby applies for a permit to install wires for the purpose of conducting electric current, in accordance with the laws of Maine, the Electrical Ordinance of the City of Portland, and the following specifications:

(This form must be completely filled out — Minimum Fee, \$1.00)

Owner's Name and Address Dick Bolser Tel.
Contractor's Name and Address Donald Spinney Tel. 799 6128
Location 15 Thomas St Use of Building

Number of Families 1 Apartments Stores Number of Stories ..
Description of Wiring: New Work Additions Alteration

Pipe Cable Metal Molding BX Cable Plug Molding (No. of feet)
No. Light Outlets Plugs 10 Light Circuits Plug Circuits

FIXTURES: No Fluor. or Strip Lighting (No. feet)

SERVICE: Pipe Cable Underground No. of Wires Size ..

METERS: Relocated ✓ Added Total No Meters 1

MOTORS: Number Phase H. P. Amps Volts Starter none

HEATING UNITS: Domestic (Oil) No. Motors Phase H.P.

Commercial (Oil) No. Motors Phase H.P.

Electric Heat (No. of Rooms)

APPLIANCE: No. Ranges Watts Brand Feeds (Size and No.)

Elec. Heaters Watts

Miscellaneous Watts

Extra Cabinets or Panels

Transformers Air Conditioners (No. Units) Signs (No. Units)

Will commence 4:00 19 Ready to cover in 19 Inspection 19

Amount of Fee \$ 4.00

Signed Ronald Spinney

DO NOT WRITE BELOW THIS LINE

SERVICE	METER				GROUND	
VISITS: 1	2	3	4	5	6	
.. 7	8	9	10	11	12	

REMARKS:

INSPECTED BY [Signature]
(OVER)

LOCATION *Thomas ST 15*
 INSPECTION DATE *12/6/71*
 WORK COMPLETED *12/6/71*
 TOTAL NO. INSPECTIONS *1*
 REMARKS:

FEE S FOR WIRING PERMITS EFFECTIVE JULY 31, 1963

WIRING	
1 to 30 Outlets	\$ 2.00
31 to 60 Outlets	3.00
Over 60 Outlets, each Outlet	.05
(Each twelve feet or fraction thereof of fluorescent lighting or any type of plug molding will be classed as one outlet).	
SERVICES	
Single Phase	2.00
Three Phase	4.00
MOTORS	
Not exceeding 50 H.P.	3.00
Over 50 H.P.	4.00
HEATING UNITS	
Domestic (Oil)	2.00
Commercial (Oil)	4.00
Electric Heat (Each Room)	.75
APPLIANCES	
Ranges, Cooking Tops, Ovens, Water Heaters, Disposals, Built-in Dishwashers, Dryers, and any permanent built-in appliance — each unit	1.50
MISCELLANEOUS	
Temporary Service, Single Phase	1.00
Temporary Service, Three Phase	2.00
Circuses, Carnivals, Fairs, etc	10.00
Meters, relocate	1.00
Distribution Cabinet or Panel, per unit	1.50
Transformers, per unit	2.00

CITY OF PORTLAND
HEALTH DEPARTMENT
HOUSING DIVISION



Loc. 15 Thomas Street
Loc w/1 S
Bldg * Fire * Elec * Other *
Issued March 13, 1969
Expires April 13, 1969

Mr. Frank G. Adams, Jr.
15 Thomas Street
Portland, Maine 04102

Dear Sir:

On February 13, 1969

an examination was made of the premises located

at 15 Thomas Street, Portland, Maine

Non-compliance with the ordinances relating to housing conditions was found as detailed below.

In accordance with the provisions of the above ordinance, you are hereby ordered to correct these defects according to specifications within the time limits allowed. Failure to comply with this notice will necessitate legal action.

Some repairs or improvements required will necessitate permits which are to be obtained from the Building Inspector, Health, Fire or other City Departments. These must be obtained before the work is started.

If any additional information is desired, visit or telephone the Housing Supervisor at this Office, Tel. 774-8221, extension 220. Kindly notify this office as soon as all corrections have been completed.

Very truly yours,
Health Director

By _____
Housing Supervisor

VIOLATIONS & SPECIFICATIONS

Responsibility of Owner or Agent

** Responsibility of Occupant

STRUCTURAL

Repair and put in good order all deteriorated and hazardous parts of the structure as follows:

1. Determine the reason and remedy the condition which causes the railing on the rear porch to be loose.
2. Have the outside front steps painted.
3. Have the foundation pointed on all sides.
4. Have the bricks pointed on all sides of the structure.
5. Determine the reason and remedy the condition which causes the paint on the trim to be chipped.
6. Repair or replace the loose, worn, deteriorated parts of the bulkhead door and frame.
7. Repair or replace the worn and deteriorated gutter on the front of the structure.
8. Repair or replace the loose, worn and deteriorated downspouts on all sides of the structure.
9. Repair or replace the loose, cracked and sagging plaster on the ceiling in the third floor hall.
10. Determine the reason and remedy the condition which causes the windows to be loose in the kitchen, den and right rear bedroom on the second floor.
11. Repair the old window sashes or install new window sashes in the den so that they may be properly opened and closed.
12. Repair or replace the loose, cracked and remaining plaster on the bathroom ceiling on the second floor.

HEATING

- a. Install a safety valve for the furnace.

PLUMBING

Check and have repaired all defective plumbing and plumbing fixtures throughout the structure.

- a. Repair or replace the defective hot water tank.
- b. Correct the condition of the fixture that causes a cross connection at the bathtub.

ELECTRICAL

Check and have repaired all defective electric wiring and electrical equipment throughout the structure.

- a. Install a main shut-off switch for the electrical system.

5-6-58

61-C-2

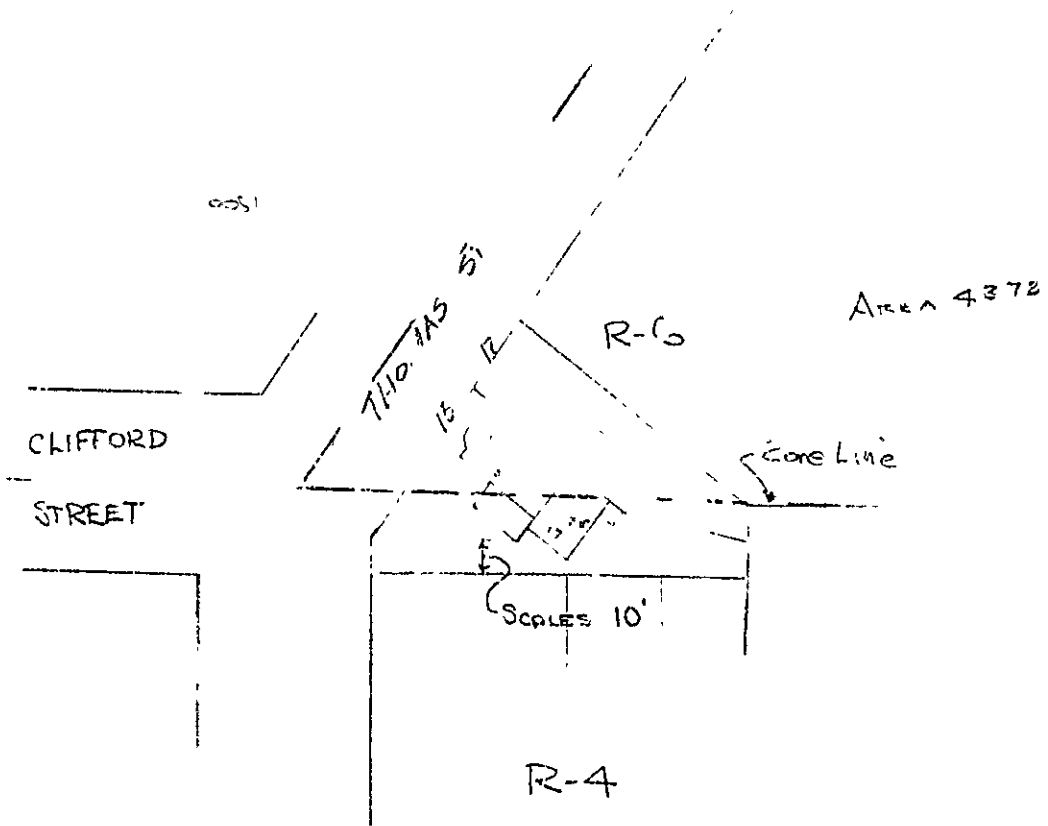

Addition - 15 Thomas Street - Martin (F. Inc)

5-7-58

1. Zoning: OK R-4 + R-6

2. Use OK

3. Construction Details & Design

Existing

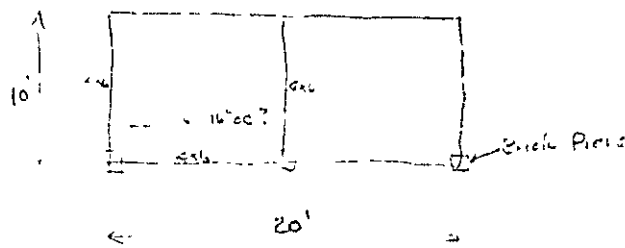

4x6 plate 3 span

$$3 \times 5 \times 30 = 1200$$

$$1752 \text{ Allow OK}$$

Post 600 + 300 = 900

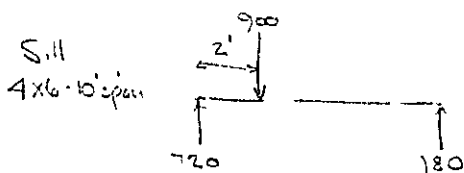

$$M_{o2} = 720 (2) (12) = 17280$$

$$S_{req} \frac{M}{f} = \frac{17280}{1100} = 15.70 \text{ OK}$$

$$S = 19.12$$

$$\begin{array}{r} 1440 \\ 12 \\ \hline 2880 \\ 1920 \\ \hline 17280 \end{array}$$



APPLICATION FOR PERMIT

Class of Building or Type of Structure 2nd class

Portland, Maine, May 5, 1958

PERMIT ISSUED

00513

MAY 7 1958

CITY of PORTLAND

To the INSPECTOR OF BUILDINGS, PORTLAND, MAINE

The undersigned hereby applies for a permit to erect alter-repair demolish install the following building structure equipment in accordance with the Laws of the State of Maine, the Building Code and Zoning Ordinance of the City of Portland, plans and specifications, if any, submitted herewith and the following specifications:

Location 15 Thomas St. Within Fire Limits? yes Dist. No. 3

Owner's name and address Mrs. Ernest Files, 15 Thomas St. Telephone

Lessee's name and address Telephone

Contractor's name and address Thomas W. Martin Sr., RFD 1-Box 296 Cape Eliz., Me. Telephone 4-5715

Architect Specifications Plans yes No of sheets 1

Proposed use of building Dwelling No families 1

Last use " No families 1

Material brick No stories 2 Heat Style of roof pitch Roofing

Other building on same lot

Estimated cost \$ 900.00 Fee \$ 4.00

General Description of New Work

To construct roof over existing frame platform. 10' x 20' (and screen-in same.) on side of dwelling.

It is understood that this permit does not include installation of heating apparatus which is to be taken out separately by and in the name of the heating contractor. **PERMIT TO BE ISSUED TO** contractor

Details of New Work

Is any plumbing involved in this work? Is any electrical work involved in this work?

Is connection to be made to public sewer? If not, what is proposed for: sewage?

Has septic tank notice been sent? Form notice sent?

Height average grade to top of plate 11' Height average grade to highest point of roof 14'

Size, front depth No. stories solid or filled land? earth or rock?

Material of foundation Thickness, top bottom cellar

Material of underpinning Height Thickness

Kind of roof pitch Rise per foot 4" Roof covering Asphalt Class C Und. Tab.

No. of chimneys Material of chimneys of lining Kind of heat fuel

Framing Lumber—Kind pine Dressed or full size? dressed Corner posts 4x4 Sills 4x6 plate

Size Girder Columns under girders Size Max on centers sill is existing

Kind and thickness of outside sheathing of exterior walls?

Studs (outside walls and carrying partitions) 2x4-16" O. C. Bridging in every floor and flat roof span over 8 feet

Joists and rafters	1st floor	, 2nd	, 3rd	, roof	2x6
On centers:	1st floor	, 2nd	, 3rd	, roof	10'
Maximum span:	1st floor	, 2nd	3rd	, roof	11'

If one story building with masonry walls, thickness of walls? height?

If a Garage

No. cars now accommodated on same lot , to be accommodated number commercial cars to be accommodated

Will automobile repairing be done other than minor repairs to cars habitually stored in the proposed building?

APPROVED:

Miscellaneous

Will work require disturbing any tree on a public street? no

Will there be in charge of the above work a person competent to see that the State and City requirements pertaining thereto are observed? yes

Mrs. Ernest Files
Thomas W. Martin Sr.

INSPECTION COPY

Signature of owner

by:

Thomas W. Martin Sr.
T.M.

NOTES

5-16-58 Not started *AD*

5-29-58 Completed

except nouds bridging & nails under platform

Yes *AD*

Yes

Yes

pitch

1.00

to construct roof over existing frame platform 10' x 20' and screen in same.

6-4-58 Completed *AD*

~~contractor~~

~~pitch~~

~~pitch~~

~~pitch~~

~~pitch~~

~~pitch~~

~~pitch~~

~~pitch~~

~~pitch~~

~~pitch~~

~~pitch~~

~~pitch~~

~~pitch~~

~~pitch~~

~~pitch~~

~~pitch~~

Permit No. 58/573
 Location 11 Thomas St.
 Owner The Shuckles
 Date of permit 7/1/58
 Notif. closing-in
 Inspn. closing-in
 Final Notif.
 Final Inspn.
 Cert. of Occupancy Issued
 Staking Out Notice
 Form Check Notice

6-4-58 5-27

brick 3

200.00

to construct roof over existing frame platform 10' x 20' and screen in same.

pitch 4"

pitch

pitch

pitch

pitch

pitch

pitch

pitch

pitch

pitch

all is existing

Yes

Yes

Yes

Yes

Yes

Yes

Yes

Yes

Yes

Yes

Yes

Yes

Yes

Yes

Yes

Yes

Yes

Yes

Yes

Yes

Yes

Yes



FILE IN AND SIGN WITH IT

APPLICATION FOR PERMIT FOR HEATING, COOKING OR POWER EQUIPMENT

Portland, Maine,

PERMIT ISSUED 00915 MAY 6 1947

To the INSPECTOR OF BUILDINGS, PORTLAND, MAINE

317-03

The undersigned hereby applies for a permit to install the following heating, cooking or power equipment in accordance with the Laws of Maine, the Building Code of the City of Portland, and the following specifications.

Location 15 Thomas St. Use of Building Remelling No Stories 2 New Building Existing "
Name and address of owner of appliance W. F. Filer 15 Thomas St.
Installer's name and address Belland Oil & Equipment -135 Marginal Way Telephone 2-1991

General Description of Work

To install Fully automatic oil burner for heating system heat

IF HEATER, OR POWER BOILER

Location of appliance or source of heat Type of floor beneath appliance
If wood, how protected? Kind of fuel
Minimum distance to wood or combustible material from top of appliance or casing top of furnace
From top of smoke pipe. From front of appliance From sides or back of appliance
Size of chimney flue Other connections to same flue
If gas fired, how vented? Rated maximum demand per hour

IF OIL BURNER

Name and type of burner F.C.-1 - Case Labelled by underwriter's laboratories? yes
Will operator be always in attendance? no Does oil supply line feed from top or bottom of tank? top
Type of floor beneath burner Cement
Location of oil storage outside in ground Number and capacity of tanks 1 - 1000 gals
(If two 275-gallon tanks, will three-way valve be provided?
If all tanks be more than five feet from any flame? yes How many tanks fire proofed? all
Total capacity of any existing storage tanks for furnace burners none

IF COOKING APPLIANCE

Location of appliance Kind of fuel Type of floor beneath appliance
If wood, how protected?
Minimum distance to wood or combustible material from top of appliance
From front of appliance From sides and back From top of smokepipe
Size of chimney flue Other connections to same flue
Is hood to be provided? If so, how vented?
If gas fired, how vented? Rated maximum demand per hour

MISCELLANEOUS EQUIPMENT OR SPECIAL INFORMATION

Amount of fee enclosed? 1.00 (\$1.00 for one heater, etc., 50 cents additional for each additional heater, etc., in same building at same time.)

APPROVED:

Handwritten signature and initials

Will there be in charge of the above work a person competent to see that the State and City requirements pertaining thereto are observed? yes

INSPECTION COPY

Signature of Installer

Handwritten signature of installer

Permit No. 47/915

Location 75 Thomas St

Owner Dr. E. M. Files

Date of permit 5/6/47

Approved _____

NOTES

- 1 Fill Pipe _____
- 2 Vent Pipe _____
- 3 Kind of Heat _____
- 4 Over Bimby Supports _____
- 5 Name & Label _____
- 6 Stack Control _____
- 7 High Limit Control _____
- 8 Remote Control _____
- 9 Firing Support & Provision _____
- 10 Fuel Supply Line _____
- 11 _____
- 12 _____
- 13 _____
- 14 _____
- 15 _____
- 16 _____
- 17 _____
- 18 _____



FILL IN COMPLETELY AND SIGN WITH INK

PERMIT ISSUED

APPLICATION FOR PERMIT FOR HEATING, COOKING OR POWER EQUIPMENT

11-13

Portland, Maine, August 26, 1937

To the INSPECTOR OF BUILDINGS, PORTLAND, ME.

The undersigned hereby applies for a permit to install the following heating, cooking or power equipment in accordance with the Laws of Maine, the Building Code of the City of Portland, and the following specifications:

Location 15 Thomas Street Use of Building dwelling house
Name and address of owner Dr. E. W. Files, 15 Thomas Street
Contractor's name and address Portland Gas Light Co., 5 Temple Street Telephone 2-5821

General Description of Work

To install gas fired steam boiler in place of existing oil burner in boiler

NOTICE: NO OPERATION BEFORE LATHING OR CLOSING IN IS WAIVED.

IF HEATER, POWER BOILER OR COOKING DEVICE

Is heater or source of heat to be in cellar? yes If not, which story Kind of Fuel concrete
Material of supports of heater or equipment (concrete floor or what kind) concrete
Minimum distance to wood or combustible material, from top of boiler or casing top of furnace, 4'
from top of smoke pipe 2' from front of heater over 4' from sides or back of heater over 5'
Size of chimney flue 8x12 Other connections to same flue from gas water heater

CERTIFICATE OF OCCUPANCY CURRENT IS WAIVED

IF OIL BURNER

Name and type of burner E-Line Labeled and approved by Underwriters' Laboratories? yes
Will operator be always in attendance? Type of oil feed (gravity or pressure)
Location oil storage No. and capacity of tanks
Will all tanks be more than seven feet from any flame? How many tanks fireproofed?

Amount of fee enclosed? 1.00 (\$1.00 for one heater, etc., 50 cents for each additional heater, etc., in same building at same time.)

INSPECTION COPY

Signature of contractor

50818

Ward 7 Permit No. 35/1327

Location 15 Thomas St.

Owner Dr. E. W. Files

Date of permit 8/26/35

Post Card sent 8/26/35

Notif. for insp. None

Approval Tag issued 9/14/35, OK

Oil-Burner Check-List (date) Gas fired

1. Kind of heat Steam Boiler
2. Label
3. Anti-siphon
4. Oil storage
5. Tank distance
6. Vent pipe
7. Fill pipe
8. Gauge
9. Rigidly
10. Feed safety
11. Pipe sizes and material
12. Control valve
13. Ash pit vent
14. Temp. or pressure safety
15. Instruction card
- 16.

NOTES



FILL IN COMPLETELY AND SIGN WITH INK

Permit No. _____

APPLICATION FOR PERMIT FOR HEATING, COOKING OR POWER EQUIPMENT

To the INSPECTOR OF BUILDINGS, Portland, Me. Portland, Maine, January 13, 1950
The undersigned hereby applies for a permit to install the following heating, cooking or power equipment in accordance with the laws of Maine, the Building Code of the City of Portland, and the following specifications:

Location 15 Thomas Street Use of Building Residence

Name and address of owner Dr. F. W. Miles

Contractor's name and address Ballard Oil & Equipment Co., 124 High St., Portland, Me. Telephone 76223

General Description of Work

To install oil burner
IF HEATER, POWER BOILER OR COOKING DEVICE

*P.C. sent
1/14/50*

Is heater or source of heat to be in cellar? Yes If not, which story _____ Kind of Fuel Oil

Material of supports of heater or equipment (concrete floor or what kind) Concrete

Minimum distance to wood or combustible material, from top of boiler or casing top of furnace,
from top of smoke pipe _____, from front of heater _____, from sides or back of heater _____

IF OIL BURNER

Name and type of burner quiet Ballard Jr. Approved by Underwriters' Laboratories? No.

Location oil storage tank already installed No. and capacity of tanks _____

Will all tanks be more than seven feet from any flame? Yes How many tanks fireproofed? _____

Amount of fee enclosed? 27.00 (\$1.00 for one heater, etc. 50 cents additional for each additional heater, etc.)

Signature of contractor [Signature] BALLARD OIL & EQUIPMENT CO. OF MAINE TREASURER



APPLICATION FOR PERMIT

Permit No. _____

Class of Building or Type of Structure _____

Portland, Maine, January 14, 1930

JAN 14 1930

To the INSPECTOR OF BUILDINGS, PORTLAND, ME.

The undersigned hereby applies for a permit to erect ~~or~~ install the following building structure equipment in accordance with the Laws of the State of Maine, the Building Code of the City of Portland, plans and specifications, if any, submitted herewith and the following specifications:

Location 15 Thomas Street Ward 7 Within Fire Limits? Yes Dist. No. 3
 Owner's or Lessee's name and address Dr. E. W. Fileo, 15 Thomas St. Telephone _____
 Contractor's name and address Ballard Oil & Equipment Co. 124 High Street Telephone 6223
 Architect's name and address _____ Telephone _____
 Proposed use of building dwelling house No. families _____
 Other buildings on same lot _____

Description of Present Building to be Altered

Material _____ No. stories _____ Heat _____ Style of roof _____ Roofing _____
 Last use _____ No. families _____

General Description of New Work

To install Oil Burner

NOTIFICATION BEFORE LATHING
OR CLOSING-IN IS WAIVED.
CERTIFICATE OF OCCUPANCY
REQUIREMENT IS WAIVED.

Details of New Work

Size, front _____ depth _____ No. stories _____ Height average grade to highest point of roof _____
 To be erected on solid or filled land? _____ earth or rock? _____
 Material of foundation _____ Thickness, top _____ bottom _____
 Material of underpinning _____ Height _____ Thickness _____
 Kind of roof _____ Roof covering _____
 No. of chimneys _____ Material of chimneys _____ of lining _____
 Kind of heat _____ Type of fuel oil Distance, heater to chimney _____
 If oil burner, name and model Quiet Ballard, Jr.
 Capacity and location of oil tanks no change
 Is gas fitting involved? _____ Size of service _____
 Corner posts _____ Sills _____ Cirt or ledger board? _____ Size _____
 Material columns under girders _____ Size _____ Max. on centers _____
 Studs (side walls and carrying partitions) 2x1-16" O. C. Girders 6x8 or larger. Bridging in every floor and flat roof span over 6 feet. Sills and corner posts all one piece in cross section.
 Joists and rafters: 1st floor _____, 2nd _____, 3rd _____, roof _____
 On centers: 1st floor _____, 2nd _____, 3rd _____, roof _____
 Maximum span: 1st floor _____, 2nd _____, 3rd _____, roof _____
 If one story building with masonry walls, thickness of walls? _____ height? _____

If a Garage

No. cars now accommodated on same lot _____, to be accommodated _____
 Total number commercial cars to be accommodated _____
 Will automobile repairing be done other than minor repairs to cars habitually stored in the proposed building? _____

Miscellaneous

Will above work require removal or disturbing of any shade tree on a public street? no
 Plans filed as part of this application? _____ No. sheets 1
 Estimated cost \$ _____ Fee \$ 1.00
 Will there be in charge of the above work a person competent to see that the State and City requirements pertaining thereto are observed? yes

INSPECTION COPY

Signature of owner _____

937A

Ward 7 Permit No. 30/47

Loc. 15 Thomas St.

Owner Dr. E. W. Files

Date of permit 1/14/30

Inspr. closing-in

Inspn. closing-in

Final Inspn. 1/24/30

Cert. of Occupancy issued

NOTES

1/20/30 - Installation
OK - A.J.S.

