

178-180 STATE STREET

SHAW-WALKER

Full cut # 820R - Half cut # 8202R - Third cut # 8203R - Fifth cut # 8205R

PERMIT TO INSTALL PLUMBING

11211

PERMIT NUMBER

Date Issued
PORTLAND PLUMBING INSPECTOR

Address **180 State Street**
 Installation For: **Dr. Albert Moulton Sr.**
 Owner of Bldg. **Dr. Albert Moulton Sr.**
 Owner's Address **180 State Street**
 Plumber: **Portland Gas Light Company** Date: **3-9-62**

By **J. P. Welch**
 APPROVED FIRST INSPECTION
 Date **3-14-62**
 By **[Signature]**
 APPROVED FINAL INSPECTION
 Date **3-14-62**
 By **ROSEPH P. WELCH**

- TYPE OF BUILDING
 COMMERCIAL
 RESIDENTIAL
 SINGLE
 MULTI FAMILY
 NEW CONSTRUCTION
 REMODELING

NEW	REPL.	PROPOSED INSTALLATIONS	NUMBER	FEE
		SINKS		
		LAVATORIES		
		TOILETS		
		BATH TUBS		
		SHOWERS		
		DRAINS		
		HOT WATER TANKS	1	\$2.00
		TANKLESS WATER HEATERS		
		GARBAGE GRINDERS		
		SEPTIC TANKS		
		HOUSE SEWERS		
		ROOF LEADERS (Conn. to house drain)		

PORTLAND HEALTH DEPT. PLUMBING INSPECTION **TOTAL \$2.00**



FILL IN COMPLETELY AND SIGN WITH INK

PERMIT ISSUED

Permit No. 1770

OCT 16 1936

APPLICATION FOR PERMIT FOR HEATING, COOKING OR POWER EQUIPMENT

178-180

To the INSPECTOR OF BUILDINGS, PORTLAND, ME.

Portland, Maine, October 16, 1936

The undersigned hereby applies for a permit to install the following heating, cooking or power equipment in accordance with the Laws of Maine, the Building Code of the City of Portland, and the following specifications:

Location 180 State Street Use of Building dwelling house
Name and address of owner W. B. Aoulton, 180 State Street Ward 6
Contractor's name and address Portland Gas Light Co., 5 Temple St. 2-3321

General Description of Work

To install Gas Burner in existing hot water heating system

MODIFICATION BEFORE LATHING OR CLOSING-IN IS WAIVED

CERTIFICATE OF OCCUPANCY REQUIREMENT IS WAIVED

IF HEATER, POWER BOILER OR COOKING DE ICE

Is heater or source of heat to be in cellar? yes If not, which story Kind of Fuel gas
Material of supports of heater or equipment (concrete floor or what kind) concrete
Minimum distance to wood or combustible material, from top of boiler or casing top of furnace
from top of smoke pipe from front of heater from sides or back of heater
Size of chimney fl Other connections to same flue

IF OIL BURNER

Name and type of burner Janitrol Labeled and approved by Underwriters' Laboratories? yes
Will operator be always in attendance? Type of oil feed (gravity or pressure)
Location oil storage No. and capacity of tanks
Will all tanks be more than seven feet from any flame? How many tanks fireproofed?

Amount of fee enclosed? 1.00 (\$1.00 for one heater, etc., 50 cents additional for each additional heater, etc., in same building at same time.)

INSPECTION COPY

Signature of contractor Portland Gas Light Co.

Signature of Carl M. Morgan

8244-P

Ward 6 Permit No. 36/1770

Location 180 State St.

Owner W. B. Mullin

Date of permit 10/16/36

Post Card sent 10/16/36

Notif. for insp. None

Approval Tag issued 1/20/37. O.P.

Oil-Burner Check List (date)

1. Kind of heat Gas burner for hot water
2. Label
3. Anti-siphon
4. Oil storage
5. Tank distance
6. Vent pipe
7. Fill pipe
8. Gauge
9. Rigidity
10. Feed safety
11. Pipe sizes and material
12. Control valve
13. Ash pit vent
14. Temp. or pressure safety
15. Instruction card
- 16.

NOTES

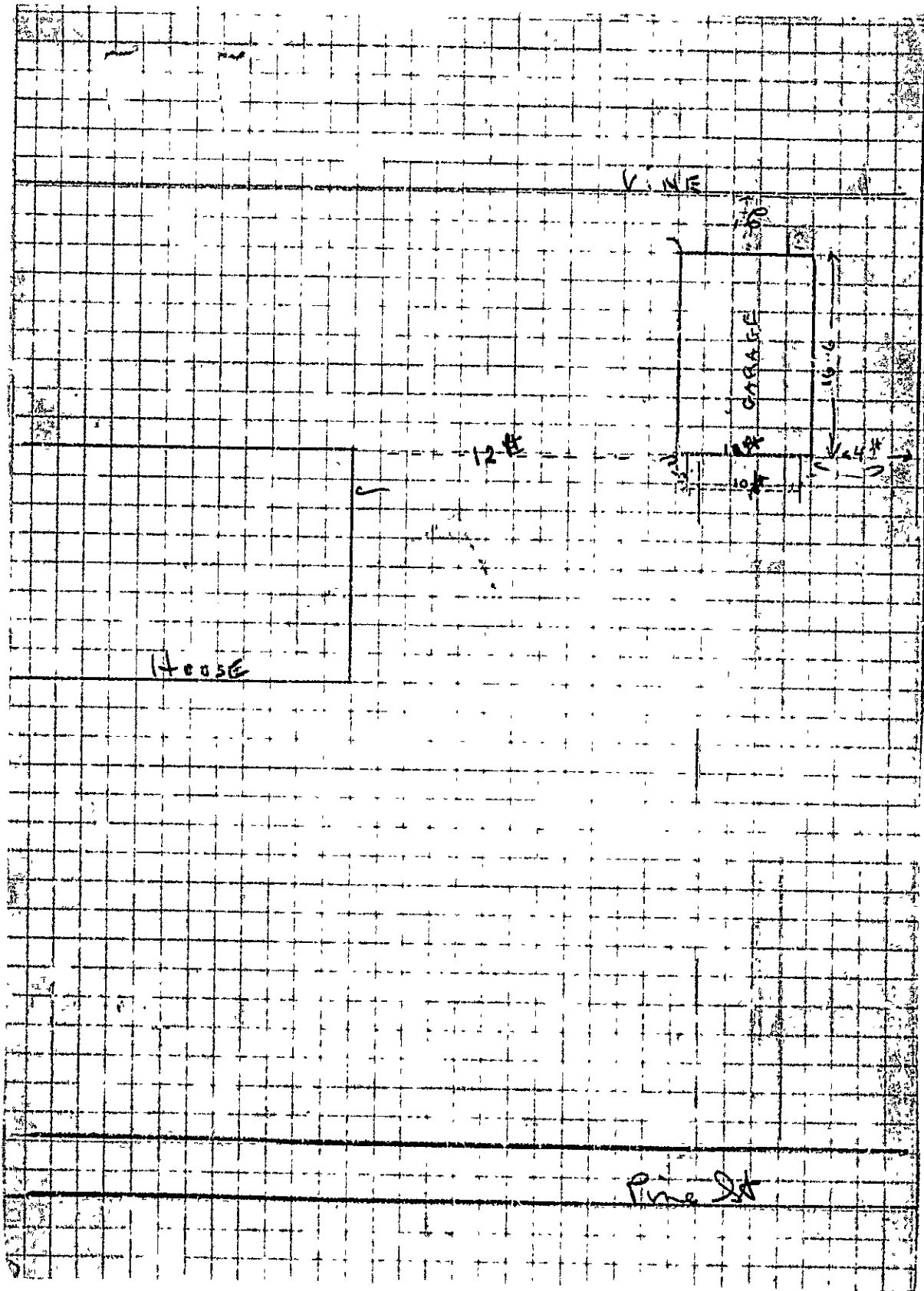

Pine St

L

STATEMENT ACCOMPANYING APPLICATION FOR BUILDING PERMIT

for addition to one car garage
at 180 State Street

Date 4/25/58

1. In whose name in the title of the property now recorded? W P Moulton
2. Are the boundaries of the property in the vicinity of the proposed work shown clearly on the ground, and how? Back Wall
3. Is the outline of the proposed work now staked out upon the ground? If not, will you notify the Inspection Office when the work is staked out and before any of the work is commenced?
4. What is to be maximum projection or overhang of eaves or drip?
5. Do you assume full responsibility for the correctness of the location plan or statement of location filed with this application, and does it show the complete outline of the proposed work on the ground, including bay windows, porches, and other projections? Yes
6. Do you assume full responsibility for the correctness of all statements in the application concerning the sizes, design and use of the proposed building? Yes
7. Do you understand that in case changes are proposed in the location of the work or in any of the details specified in the application that a revised plan and application must be submitted to this office before the changes are made? Yes

W P Moulton



GENERAL BUSINESS ZONE
APPLICATION FOR PERMIT

Permit No. H-155011
0499
APR 27 1928

Class of Building or Type of Structure Third Class

Portland, Maine, April 26, 1928

To the INSPECTOR OF BUILDINGS, PORTLAND, ME.

The undersigned hereby applies for a permit to erect alter install the following building structure or equipment in accordance with the Laws of the State of Maine, the Building Code of the City of Portland, plans and specifications, if any, submitted herewith and the following specifications:

Location 180 State Street Ward 6 Within Fire Limits? yes Dist. No. 3
Owner's or Lessee's name and address Dr. E. B. Moulton, 180 State Street, Telephone _____
Contractor's name and address H. A. Gladenberg, 169 Clark St., Telephone 3-4161
Architect's name and address _____
Proposed use of building 1 car garage No. families _____
Other buildings on same lot 1 family dwelling house
Plans filed as part of this application? yes No. of sheets 1
Estimated cost \$ 50. Fee \$.50

Description of Present Building to be Altered

Material wood No. stories 1 Heat no Style of roof pitch Roofing Asphalt
Last use 1 car garage No. families _____

General Description of New Work

To erect one story frame addition 18' x 8' 10'

It is understood that this permit does not include installation of heating apparatus which is to be taken out separately by and in the name of the heating contractor.

Details of New Work

Size, front _____ depth _____ No. stories 1 Height average grade to top of plate _____
To be erected on solid or filled land? solid earth or rock? earth
Material of foundation concrete Thickness, top _____ bottom _____
Material of underpinning _____ Height _____ Thickness _____
Kind of Roof flat Rise per foot 8" Roof covering Asphalt roofing Class 0 Und. Lab.
No. of chimneys 0 Material of chimneys _____ of lining _____
Kind of heat _____ Type of fuel _____ Is gas fitting involved? _____
Corner posts 4x4 Sills 2x4 Girt or ledger board? _____ Size _____
Material columns under girders _____ Size _____ Max. on centers _____
Studs (out side walls and carrying partitions) 2x4-16" O. C. Girders 4x8 or large _____ Bridging in every floor and flat roof span over 8 feet. Sills and corner posts all one piece in cross section.
Joists and rafters: 1st floor _____, 2nd _____, 3rd _____, roof 8x6
On centers: 1st floor _____, 2nd _____, 3rd _____, roof 16"
Maximum span: 1st floor _____, 2nd _____, 3rd _____, roof 18"
If one story building with masonry walls, thickness of walls? _____ height? _____

If a Garage

No. cars now accommodated on same lot 1, to be accommodated 1
Total number commercial cars to be accommodated none
Will automobile repairing be done other than minor repairs to cars habitually stored in the proposed building? no

Miscellaneous

Will above work require removal or disturbing of any shade tree on a public street? no
Will there be in charge of the above work a person competent to see that the State and City requirements pertaining thereto are observed? yes

Signature of owner Dr. E. B. Moulton
H. A. Gladenberg
INSPECTION COPY James V. [unclear]

Ward 6 Permit No 36/498

Location 180 State St.

Own Dr. W. B. Murtha

Date of permit 4/27/36

Notif. closing-in _____

Insp 7-in

Final Notif _____

Final Inspn 5/7/36

Cert. of Occupancy issued None

NOTES
5/7/36 - Work done.
A.J.S.

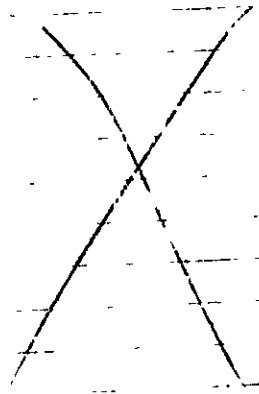



Location, Ownership and detail must be correct, complete and legible.

YOU Separate application required for every building.

responsibility for compliance must be filed with this application.

the law, who is responsible for the requirement, or not

Application for Permit for Alterations, etc.

is Application and
All Questions Settled
Commencing Work.

December 7/25
Portland, Me., 19

To the
INSPECTOR OF BUILDINGS:
May Prove

The undersigned applies for a permit to alter the following described building:—

Description of Present Bldg.

Location 180 State Street Ward 6 in fire limits? Yes

Name of Owner or Lessee, Dr. W B Moulton Address 180 State St

" " Contractor, Hayden & Dingwell " 169 Clark St

" " Architect, "

Material of Building is brick Style of Roof, pitch Material of Roofing, slate

Size of Building is feet long; feet wide. No. of Stories,

Cellar Wall is constructed of is inches wide on bottom and batters to inches on top.

Underpinning is is inches thick; is feet in height.

Height of Building Wall, if Brick: 1st, 2d, 3d, 4th, 5th,

What was Building last used for? dwelling No. of Families? 1

What will Building now be used for? dwelling 1 family

Detail of Proposed Work

Put in partitions to make bathroom

all to comply with the building ordinance

.....

.....

..... Estimated Cost \$ 40.

If Extended On Any Side

Size of Extension, No. of feet long?; No. of feet wide?; No. of feet high above sidewalk?

No. of Stories high?; Style of Roof?; Material of Roofing?

Of what material will the Extension be built? Foundation?

If of Brick, what will be the thickness of External Walls? inches; and Party Walls inches.

How will the extension be occupied? How connected with Main Building?

When Moved, Raised or Built Upon

No. of Stories in height when Moved, Raised, or Built upon? Proposed Foundations?

No. of feet high from level of ground to highest part of Roof to be?

How many feet will the External Walls be increased in height? Party Walls

.....

.....

If Any Portion of the External or Party Walls Are Removed

Will an opening be made in the Party or External Walls? in Story.

Size of the opening? How protected?

How will the remaining portion of the wall be supported?

Signature of Owner or Authorized Representative Dr. W. B. Moulton
Mr. Edward T. Hayden

Address

PERMIT MUST BE OBTAINED BEFORE BEGINNING WORK



Location, Ownership and detail must be correct, complete and legible.
 Separate application required for every building.
 Plans must be filed with this application.

Application for Permit for Alterations, etc.

To the
 INSPECTOR OF BUILDINGS: Portland, November tenth, 1915

The undersigned applies for a permit to alter the following described building: -

Location, 180 State St. Ward, 5 In fire-limits? Yes
 Name of Owner or Lessee, Dr. W. B. Houlton Address, Do.
 " " Contractor, Jayden & D. Inguwell " 469 Clark St.
 " " Architect, _____ " _____
 Material of Building is Brick Style of Roof, flat Material of Roofing Gravel
 Size of Building is _____ feet long; _____ feet wide. No. of Stories, 2 1/2
 Cellar Wall is constructed of stone is _____ inches wide on bottom and batters to _____ inches on top.
 Underpinning is brick is _____ inches thick; is _____ feet in height.
 Height of Building, _____ Wall, if Brick; 1st, _____ 2d, _____ 3d, _____ 4th, _____ 5th, _____
 What was Building last used for? dwellling No. of Families: one
 Building to be occupied for _____ Estimated Cost, \$ 100.

Descrip-
 tion of
 Present
 Bldg.

PERMIT MUST BE OBTAINED BEFORE BEGINNING WORK

DETAIL OF PROPOSED WORK

Build addition

IF EXTENDED ON ANY SIDE

Size of Extension, No. of feet long? 11; No. of feet wide? 34; No. of feet high above sidewalk? 15
 No. of Stories high? one Style of Roof? flat; Material of Roofing? Gravel
 Of what material will the Extension be built? brick Foundation? concrete, brick
 If of Brick, what will be the thickness of External Walls? 9 inches; and Party Walls _____ inches.
 How will the Extension be occupied? office How connected with Main Building? _____

WHEN MOVED, RAISED OR BUILT UPON

No. of Stories in height when Moved, Raised or Built upon? _____ Proposed Foundations? _____
 No. of feet high from level of ground to highest part of Roof to be? _____
 How many feet will the External Walls be increased in height? _____ Party Walls _____

IF ANY PORTION OF THE EXTERNAL OR PARTY WALLS ARE REMOVED

Will an opening be made in the Party or External Walls? _____ in _____ Story.
 Size of the opening? _____ How protected? _____
 How will the remaining portion of the wall be supported? _____

Signature of _____
 Authorized Representative

Jayden I. Inguwell

Address _____

Y 180 State St.
176

FINAL REPORT

192

Has the work been completed in accordance with
this application and plans filed and approved?

Law been violated? ..Doc. No. of 191

Nature of violation? ..

PERMIT GRANTED

11-10-1915

Permit filled out by ..

Permit number ..

Location 180 State

Violation removed, when? 191

Estimated cost of alterations etc., \$

Inspector of Buildings.



City of Portland.

3424

OFFICE OF INSPECTOR OF BUILDINGS

.....191'

To the Inspector of Buildings of the City of Portland:

The undersigned respectfully makes application for a permit to erect enlarge a building on.....
.....street, at number.....to be.....
.....stories high..... feet long.....
feet wide; also an addition to be..... stories high.....
feet long..... feet wide, and to be used as a.....

CELLAR WALL—To be constructed of..... to be..... inches wide on bottom and
batter to..... inches on top.

UNDERPINNING—To be..... Height of underpinning from top of cellar wall to bottom of
sill.....ft. inches to be..... inches in thickness.

EXTERIOR WALLS—To be constructed of..... If of Brick, Stone, etc. Total length of wall
.....ft. inches. Thickness of 1st..... 2d..... 3d..... 4th.....
5th..... 6th..... story walls. f of reinforced concrete state mix and reinforcing system
to be used.

If wood construction, sills to be..... Girders

Posts..... Girts..... Studs..... to be spaced.....

This building will be used for the purposes of..... (If for apartments,

tenements, or other family uses state number of families accommodated and number on each floor.
If for manufacturing or mercantile purpose: state character of business and amount of estimated
weight to be carried by the floor.)

Number of families on floor.....

Total number of families.....

Manufacturing (state character).....

Estimated load on floors per sq. ft.

Mercantile business (state character and load per sq. ft.).....

If building is used for tenement house or family use and more than one family, the following provisions
of the Building Laws regarding dividing partitions shall be adhered to (Quote Law re. this).

FIRESTOPS—All bearing and center partitions will have firestops cut in tight on top of each partition cap
and between each set of floor timbers. Where ledger boards are used there shall be firestops cut in
tight against bottom of ledger boards, of same size as wall studs. Also wherever the Inspector of
Buildings may consider necessary.

STAIRWAYS—No. in building..... location..... to be enclosed
with..... walls to be lathed with..... lathing.

ROOF—To be constructed of..... Rafters to be..... inches to be spaced.....
..... inches on centers. Roof to be covered with.....

Gutters to be made of..... Cornices to be made of.....

Bay windows to be made of..... to be covered with.....

Dormer Windows to be made of..... to be covered.....
Chimneys, Smoke flues to be lined with..... and provided with a 10 inch outside collar and an
inside collar to go to the inside of the flue.

Estimated Cost of Building.....

INSPECTION—The Inspector of Buildings is to be notified when building is ready for lathing and at least
24 hours before the lathing is begun.

The Builder is..... Address.....

The Architect is..... Address.....

The Owner is..... Address.....

No Deviation will be made from the above application without written permission from the Inspector of
Buildings.

The above petition was granted the..... day of..... 191'

(Applicant to sign here

M. E. Ordman Co.
P. C. D.

180 State St.
178-

AUG. '11

OFFICE OF THE DIRECTOR OF PUBLIC HEALTH



Handwritten initials

FILL IN AND SIGN WITH INK

APPLICATION FOR PERMIT FOR HEATING, COOKING OR POWER EQUIPMENT

01081

Portland, Maine, August 30, 1984

PERMIT ISSUED

SEP 4 1984

CITY of PORTLAND

To the INSPECTOR OF BUILDINGS, PORTLAND, ME.

The undersigned hereby applies for a permit to install the following heating, cooking or power equipment in accordance with the Laws of Maine, the Building Code of the City of Portland, and the following specifications:

Location 180 State Street... Use of Building Apt. Hse. No. Stories 4 New Building Existing "X"
Name and address of owner of appliance Ebenezer Seavey House - same 04103
Installer's name and address Rudi The Plumber - 1231 Forest Ave., Port. Telephone 797-8311

General Description of Work

To install Gas Hot Water Boiler/with Burner

IF HEATER, OR POWER BOILER

Location of appliance cellar Any burnable material in floor surface or beneath? NO
If so, how protected? Kind of fuel? gas
Minimum distance to burnable material, from top of appliance or casing top of furnace At least 3' all around
From top of smoke pipe From front of appliance From sides or back of appliance
Size of chimney flue 12" x 12" Other connections to same flue yes, another gas boiler existing
If gas fired, how vented? thru chimney Rated maximum demand per hour 150,000 Btu's
Will sufficient fresh air be supplied to the appliance to insure proper and safe combustion? yes

IF OIL BURNER

Name and type of burner Atmospheric Gas Bu. 2 Labeled by underwriters' laboratories? yes
Will operator be always in attendance? NO Does oil supply line feed from top or bottom of tank?
Type of floor beneath burner concrete Size of vent pipe 6"
Location of oil storage Number and capacity of tanks
Low water shut off Make No.
Will all tanks be more than five feet from any flame? How many tanks enclosed?
Total capacity of any existing storage tanks for furnace burners

IF COOKING APPLIANCE

Location of appliance Any burnable material in floor surface or beneath?
If so, how protected? Height of Legs, if any
Skirting at bottom of appliance? Distance to combustible material from top of appliance?
From front of appliance From sides and back From top of smokepipe
Size of chimney flue Other connections to same flue
Is hood to be provided? If so, how vented? Forced or gravity?
If gas fired, how vented? Rated maximum demand per hour

MISCELLANEOUS EQUIPMENT OR SPECIAL INFORMATION

Blank lines for miscellaneous information

Amount of fee enclosed? \$15.00

APPROVED: [Signature line]

Will there be in charge of the above work a person competent to see that the State and City requirements pertaining thereto are observed? yes

Signature of Installer: Rudi Caparita

CS 300

FILE COPY

Signature of Installer

#1076

Est. Cost: \$1,500.00

Handwritten number 5



Handwritten initials

FILL IN AND SIGN WITH INK

APPLICATION FOR PERMIT FOR HEATING, COOKING OR POWER EQUIPMENT

01081

Portland, Maine, ... August 30, 1984

PERMIT ISSUED

SEP 4 1984

CITY of PORTLAND

To the INSPECTOR OF BUILDINGS, PORTLAND, ME.

The undersigned hereby applies for a permit to install the following heating, cooking or power equipment in accordance with the Laws of Maine, the Building Code of the City of Portland, and the following specifications:

Location 120 State Street... Use of Building Apt. Hse. No. Stories 4 New Building Existing X
Name and address of owner of appliance ... Seavey House - same ... 04103
Installer's name and address ... Rudi The Plumber - 1231 Forest Ave., Port. Telephone 797-8311

General Description of Work

To install Gas Hot Water Boiler/with Burner

IF HEATER, OR POWER BOILER

Location of appliance cellar Any burnable material in floor surface or beneath? no
If so, how protected? Kind of fuel? gas
Minimum distance to burnable material, from top of appliance or casing top of furnace At least 3' all around
From top of smoke pipe From front of appliance From sides or back of appliance
Size of chimney flue 10 1/2 x 8 x 12 Other connections to same flue yes, another gas boiler existing
If gas fired, how vented? thru chimney Rated maximum demand per hour 150,000 BTU'S
Will sufficient fresh air be supplied to the appliance to insure proper and safe combustion? yes

IF OIL BURNER

Name and type of burner Atmospheric Gas Burner Labeled by underwriters' laboratories? yes
Will operator be always in attendance? no Does oil supply line feed from top or bottom of tank?
Type of floor beneath burner concrete Size of vent pipe 6"
Location of oil storage Number and capacity of tanks
Low water shut off Make No.
Will all tanks be more than five feet from any flame? How many tanks enclosed?
Total capacity of any existing storage tanks for furnace burners

IF COOKING APPLIANCE

Location of appliance Any burnable material in floor surface or beneath?
If so, how protected? Height of Legs, if any
Skirting at bottom of appliance? Distance to combustible material from top of appliance?
From front of appliance From sides and back From top of smokepipe
Size of chimney flue Other connections to same flue
Is hood to be provided? If so, how vented? Forced or gravity?
If gas fired, how vented? Rated maximum demand per hour

MISCELLANEOUS EQUIPMENT OR SPECIAL INFORMATION

Amount of fee enclosed \$15.00

APPROVED: [Signature]

Will there be in charge of the above work a person competent to see that the State and City requirements pertaining thereto are observed? yes

Signature of Installer

Rudi Caparita

51076

CS 300

FILE COPY

Est. Cost: \$1,500.00

Handwritten number 5

APPLICATION FOR PERMIT

PERMIT ISSUED

F.O.C.A. USE GROUP
B.O.C.A. TYPE OF CONSTRUCTION 0 189
ZONING LOCATION R-6 PORTLAND, MAINE

MAR 12 1985

CITY OF PORTLAND
L 10839

To the CHIEF OF BUILDING & INSPECTION SERVICES, PORTLAND, MAINE

The undersigned hereby applies for a permit to erect, alter, repair, demolish, move or install the following building, structure, equipment or change use in accordance with the Laws of the State of Maine, the Portland B.O.C.A. Building Code and Zoning Ordinance of the City of Portland with plans and specifications, if any, submitted herewith and the following specifications.

LOCATION 180 State Street - Apt. #2 Fire District #1 [] #2 []
1. Owner's name and address Ward Parter c/a 15 Pine St., Portland Telephone 774-3880
2. Lessee's name and address Herbert R. Sears Telephone 774-1658
3. Contractor's name and address Ross Construction Telephone 772-5367
126 Neal Street
Proposed use of building Home Occupation No. of sheets
Last use Residential No. families
Material No stories Heat Style of roof Roofing
Other buildings on same lot
Estimated contractual cost \$
FIELD INSPECTOR - Mr. @ 775-5451
Appraisal Fees \$
Base Fee \$ 25.00
Late Fee
TOTAL \$ 25.00

Change of use from dwelling to dwelling with
2-room dwelling occupation
B.R.S.H.M.P.E.
No change

Stamp of Special Conditions

NOTE TO APPLICANT: Separate permits are required by the installers and subcontractors of heating, plumbing, electrical and mechanicals.

DETAILS OF NEW WORK

Is any plumbing involved in this work? Is any electrical work involved in this work?
Is plumbing to be made to public sewer? If no., what is proposed for sewage?
Has septic tank notice been sent? Form notice sent?
Height average grade to top of plate Height average grade to highest point of roof
Size, front depth No. stories solid or filled land? earth or rock?
Material of foundation Thickness, top bottom cellar
Kind of roof Rise per foot Roof covering
No. of chimneys Material of chimneys of lining Kind of heat fuel
Framing Lumber - Kind Dressed or full size? Corner posts Sills
Size Girder Columns under girders Size Max. on centers
Studs (outside walls and carrying partitions) 2x4-16" O. C. Bridging in every floor and flat roof span over 8 feet.
Joists and rafters: 1st floor, 2nd, 3rd, roof
On centers: 1st floor, 2nd, 3rd, roof
Maximum span: 1st floor, 2nd, 3rd, roof
If one story building with masonry walls, thickness of walls? height?

IF A GARAGE

No. cars now accommodated on same lot, to be accommodated, number commercial cars to be accommodated
Will automobile repairing be done other than minor repairs to cars habitually stored in the proposed building?

APPROVALS BY: DATE
BUILDING INSPECTION - PLAN EXAMINER
ZONING: M.A.L. 3/11/85
BUILDING CODE:
Fire Dept.:
Health Dept.:
Others:

MISCELLANEOUS
Will work require disturbing of any tree on a public street?
Will there be in charge of the above work a person competent to see that the State and City requirements pertaining thereto are observed?

Signature of Applicant Herbert R. Sears Phone # 774-1658
Type Name of above Herbert R. Sears 1 [] 2 [] 3 [] 4 []
Other and Address

FIELD INSPECTOR'S COPY APPLICANT'S COPY OFFICE FILE COPY

5 MR. Leary

NOTES

4-24-88 This is OK for covering

~~XXXXXX~~

Permit No.

85/189

Location

150 S. 1st St. Apt # 2

Owner

Frank Carter

Date of permit

Approved

3-12-88

Dwelling

Change of use

Garage

Alteration

Large empty lined area for notes or drawings, divided into two columns by a vertical line.



APPLICATION FOR PERMIT
DEPARTMENT OF BUILDING INSPECTIONS SERVICES
ELECTRICAL INSTALLATIONS

Date October 4, 19 84
 Receipt and Permit number 05498

To the CHIEF ELECTRICAL INSPECTOR, Portland, Maine

The undersigned hereby applies for a permit to make electrical installations in accordance with the laws of Maine, the Portland Electrical Ordinance the National Electrical Code and the following specifications:

LOCATION OF WORK 180 State Street

OWNER'S NAME Ward Porter ADDRESS 2100 Sandburge Rd., Dunn-Loring Virginia

OUTLETS	Receptacles	Switches	Plugmold	_____ ft	TOTAL <u>15</u>	<u>3.00</u>
FIXTURES (number of)	Incandescent	Flourescent	(not strip)	TOTAL <u>1-10</u>		<u>3.00</u>
	Strip Flourescent	_____ ft				
SERVICES	Overhead	Underground	Temporary	TOTAL amperes <u>200</u>		<u>3.00</u>
METERS (number of)	<u>2</u>					<u>1.00</u>
MOTORS (number of)	Fractional					
	1 HP or over					
RESIDENTIAL HEATING	Oil or Gas (number of units)					
	Electric (number of rooms) <u>2</u>					<u>2.00</u>
COMMERCIAL OR INDUSTRIAL HEATING	Oil or Gas (by a main boiler)					
	Oil or Gas (by separate units)					
	Electric Under 20 kws	Over 20 kws				
APPLIANCES: (number of)	Ranges	<u>1</u>	Water Heaters			
	Cook Tops		Disposals	<u>1</u>		
	Wall Ovens		Dishwashers	<u>1</u>		
	Dryers		Compactors			
	Fans	<u>3</u>	Others (denote)			
	TOTAL <u>6</u>					<u>9.00</u>
MISCELLANEOUS: (number of)	Branch Panels					
	Transformers					
	Air Conditioners Central Unit					
	Separate Units (windows,					
	Signs 20 sq. ft. and under					
	Over 20 sq. ft.					
	Swimming Pools Above Ground					
	In Ground					
	Fire/Burglar Alarms Residential					
	Commercial					
	Heavy Duty Outlets, 220 Volt (such as welders)	30 amps and under				
		over 30 amps				
	Circus, Fairs, etc.					
	Alterations to wires					
	Repairs after fire					
	Emergency Lights, battery					
	Emergency Generators					
FOR ADDITIONAL WORK NOT ON ORIGINAL PERMIT				INSTALLATION FEE DUE:		
FOR REMOVAL OF A "STOP ORDER" (304-16.b)				DOUBLE FEE DUE:		
				TOTAL AMOUNT DUE:		<u>21.00</u>

INSPECTION:

Will be ready on _____, 19 __; or Will Call x

CONTRACTOR'S NAME: Heritage Electric
 ADDRESS: Route 302, N. Windham, ME 04062
 TEL.: 892-4756
 MASTER LICENSE NO.: 00726
 LIMITED LICENSE NO.: _____

SIGNATURE OF CONTRACTOR
Paul M. Donald

INSPECTOR'S COPY -- WHITE
 OFFICE COPY -- CANARY
 CONTRACTOR'S COPY -- GREEN



APPLICATION FOR PERMIT
DEPARTMENT OF BUILDING INSPECTIONS SERVICES
ELECTRICAL INSTALLATIONS

Date August 30, 1984
 Receipt and Permit number 05303

To the CHIEF ELECTRICAL INSPECTOR, Portland, Maine:

The undersigned hereby applies for a permit to make electrical installations in accordance with the laws of Maine, the Portland Electrical Ordinance, the National Electrical Code and the following specification:

LOCATION OF WORK: 180 State Street
 OWNER'S NAME: Ebenezer Seavey House ADDRESS: same

301-114403
 68130000
 PERMITS

OUTLETS:
 Receptacles _____ Switches _____ Plugmold _____ ft. TOTAL _____
 FIXTURES: (number of)
 Incandescent _____ Fluorescent _____ (not strip) TOTAL _____
 Strip Fluorescent _____ ft. _____

SERVICES:
 Overhead _____ Underground _____ Temporary _____ TOTAL amperes _____

METERS: (number of) _____

MOTORS: (number of)
 Fractional _____
 1 HP or over _____

RESIDENTIAL HEATING:
 Oil or Gas (number of units) _____
 Electric (number of rooms) _____

COMMERCIAL OR INDUSTRIAL HEATING:
 Oil or Gas (by a main boiler) x .. 5.00
 Oil or Gas (by separate units) _____
 Electric Under 20 kws _____ Over 20 kws _____

APPLIANCES: (number of)
 Ranges _____ Water Heaters _____
 Cook Tops _____ Disposals _____
 Wall Ovens _____ Dishwashers _____
 Dryers _____ Compactors _____
 Fans _____ Others (denote) _____
 TOTAL _____

MISCELLANEOUS: (number of)
 Branch Panels _____
 Transformers _____
 Air Conditioners Central Unit _____
 Separate Units (windows) _____
 Signs 20 sq. ft. and under _____
 Over 20 sq. ft. _____
 Swimming Pools Above Ground _____
 In Ground _____
 Fire/Burglar Alarms Residential _____
 Commercial _____
 Heavy Duty Outlets, 220 Volt (such as welders) 30 amps and under _____
 over 30 amps _____
 Circus, Fairs, etc. _____
 Alterations to wires _____
 Repairs after fire _____
 Emergency Lights, battery _____
 Emergency Generators _____

INSTALLATION FEE DUE: _____
 FOR ADDITIONAL WORK NOT ON ORIGINAL PERMIT DOUBLE FEE DUE: _____
 FOR REMOVAL OF A "STOP ORDER" (304-16.b)
 TOTAL AMOUNT DUE: 5.00

INSPECTION:
 Will be ready on _____, 19__ ; or Will Call _____
 CONTRACTOR'S NAME: Rudi The Plumber
 ADDRESS: 1231 Forest Avenue
 TEL.: _____
 MASTER LICENSE NO.: _____ SIGNATURE OF CONTRACTOR: Rudi The Plumber
 LIMITED LICENSE NO.: 1076

INSPECTOR'S COPY — WHITE
 OFFICE COPY — CANARY
 CONTRACTOR'S COPY — GREEN

