

ADDITION TO BOLL A MEAS. OF 500' LIT. TOTAL
SCALE 1/8" = 1'

8x8 ft. - 14 ft. x 14 ft. - 14 ft. x 14 ft.
4x12 - 30' - 14 ft. x 14 ft.
14 ft. x 14 ft.

The main structure is a 14 ft. x 14 ft. square
The main structure is a 14 ft. x 14 ft. square
The main structure is a 14 ft. x 14 ft. square
The main structure is a 14 ft. x 14 ft. square

1619 x 1-1/2 = 8750 ft. x 14 ft. x 14 ft.

Use 4x8 ft. x 14 ft. x 14 ft. x 14 ft. x 14 ft.
Use 4x8 ft. x 14 ft. x 14 ft. x 14 ft. x 14 ft.

8x8 ft. x 14 ft. x 14 ft. x 14 ft. x 14 ft.
8x8 ft. x 14 ft. x 14 ft. x 14 ft. x 14 ft.

43/591-T
Amendment #1

August 28, 1943

C. DiBiase & Co.
22 Monument Square
Portland, Maine

Subject: Amendment to building permit covering
change or construction, requiring complete
plans and engineering design for steel work
on reinforced concrete slab.

Gentlemen:

You or the owner must procure an architectural plan showing complete details of this proposed addition to the boiler room, including plan (looking-down-on-top view) and sufficient cross sections to fully explain the proposal and a design plan for the reinforced concrete wall by an experienced designer who is competent to work out the loads and the strength of materials, proper location of reinforcing rods in the slab, proper bending; to take care of diagonal shear etc., and that designer's personal signature on a statement of design attached to the plan as called for by Section 104-b-3 of the Building Code; these plans to be filed as blueprints with all of the information on them printed from the original.

Such requirement of plan is a matter of law, and it will be appreciated if you will lose your own time and ours by trying some other way than the obvious way of supplying this information.

It is important to show on the plan the height of the proposed addition above the finished surface of the ground around it and the depth below that surface also, so that it may be determined how much earth the proposed walls will have to retain; also to show clearly a small plat plan which will indicate whether or not the slab over the top will be required to sustain more than ordinary roof loads,--perhaps the load of motor trucks or storage.

Very truly yours,

Inspector of Buildings

WMO/S

CC: Lafayette Hotel Co.
638 Congress Street

Rept. 2375D-I

June , 1945

C. H. Hesse, P. C.,
22 Monument Square,
Portland, Maine

Subject: Application for building permit
to cover construction of addition to
boiler room at 4 feet by 15 feet for
the Lafayette Hotel at 633 Congress St.

Gentlemen:

The sketch which you have filed with the application to illustrate the work is not nearly complete enough to prove compliance with the Building Code, and in some particulars it is evident that the proposed construction work does not satisfy Building Code requirements.

It will be necessary for you to have a detailed construction plan to a definite scale filed with the application for the permit in the shape of a blueprint with all of the information on it printed from the original. This plan should show all details sufficiently complete so that the addition may be built from it without other information, including a cross section through the building showing the floor, the details of foundation, the details and thickness of the super structure, walls, the arrangement of the cornice, framing of the roof, etc., etc. There should also be shown the thickness of all walls, the depth of the foundation wall below the grade and the height of the brick walls above grade. Show also the required anchors from masonry wall to roof joists and whether or not there will be any windows or doors in the addition. If there are to be windows or doors on the long side of the addition it appears likely that Section 402-a-5 of the Building Code will require that they be standard fire windows or fire doors since the location is within the limits of Fire District No. 1 and such new windows or doors would probably be closer than 50 feet to similar openings in the first story stores of the part of the hotel facing on Congress Street.

This plan ought to be made by a man thoroughly accustomed to making plans and sufficiently acquainted with the Building Code to examine the Code and make the plans to comply with it so that there will be no delay when the new plan is filed.

It appears that you had intended to continue to use the 8x8 wooden beam on a span of 14 foot six inches to support part of the load of the addition as well as a large portion of the existing roof. This 8x8 is already showing signs of distress and figures out to be about half strong enough to take the theoretical roof load from the existing roof and from the proposed new roof. Your designer should be able to design wooden beams applying the usual rules based upon the estimated load to be carried and the theoretical strength of the structural member.

Our inspector discovered another 8x8 wooden beam on the same span very similar to the beam intended to carry part of the new roof load. In all probability this 8x8 is severely overloaded also. Your designer should look into this matter and if the beam is found to be overloaded strengthening of it should be designed and shown upon the new plan filed here.

Very truly yours,

RMH/H

CC: Lafayette Hotel Co.
633 Congress Street

Inspector of Buildings



APPLICATION FOR PERMIT

PERMIT ISSUED
Permit No. 1594

Class of Building or Type of Structure SAFETY CLASS

JUN 22 1913

Portland, Maine, June 16, 1913

To the INSPECTOR OF BUILDINGS, PORTLAND, ME.

The undersigned hereby applies for a permit to erect alter install the following building structure-equipment in accordance with the Laws of the State of Maine, the Building Code of the City of Portland, plans and specifications, if any, submitted herewith and the following specifications:

Location 625 Congress Street Within Fire Limits? yes Dist. No. 1
Owner's or lessee's name and address Lafayette Hotel Co., Inc. 625 Congress St. Telephone 21023
Contractor's name and address C. L. Bissell Co., 22 Monument Square Telephone 21023
Architect _____ Plans filed yes No. of sheets 1
Proposed use of building Hotel and stores No. families _____
Other buildings on same lot _____
Estimated cost \$ 500. Fee \$ 1.00

Description of Present Building to be Altered

Material brick No. stories 7-1 Heat steam Style of roof _____ Roofing _____
Last use Hotel and stores No. families _____

General Description of New Work

To build one story brick addition 4' x 13' on northwesterly side of one story boiler room removing 13' section of existing wall of boiler room

INSPECTION NOT COMPLETED

It is understood that this permit does not include installation of heating apparatus which is to be taken out separately by and in the name of the heating contractor.

Details of New Work

Is any plumbing work involved in this work? _____
Is any electrical work involved in this work? _____ Height average grade to top of plate _____
Size, front _____ depth _____ No. stories _____ Height average grade to highest point of roof _____
To be erected on solid or filled land? solid earth or rock? earth
Material of foundation concrete or stone Thickness, top 12" bottom 12" cellar yes
Material of masonry _____ Height _____ Thickness _____
Kind of roof flat Rise per foot 1" Roof covering tar and gravel / ply
No. of chimneys _____ Material of chimneys _____ of lining _____
Kind of heat _____ Type of fuel _____ Is gas fitting involved? _____
Framing lumber—Kind spruce Dressed or full size? dressed
Corner posts _____ Sills _____ Girt or ledger board? _____ Size _____
Material columns under girders _____ Size _____ Max. on centers _____
Studs (outside walls and carrying partitions) 2x4-16" O. C. Girders 6x8 or larger. Bridging in every floor and flat roof span over 8 feet. Sills and corner posts all one piece in cross section.
Joists and rafters: 1st floor _____, 2nd _____, 3rd _____, roof 2x8
On centers: 1st floor _____, 2nd _____, 3rd _____, roof 2'
Maximum span: 1st floor _____, 2nd _____, 3rd _____, roof 9'
If one story building with masonry walls, thickness of walls? 8" height? 7'

If a Garage

No. cars now accommodated on same lot _____, to be accommodated _____
Total number commercial cars to be accommodated _____
Will automobile repairing be done other than minor repairs to cars habitually stored in the proposed building? _____

Miscellaneous

Will above work require removal or disturbing of any shade tree on a public street? no
Will there be in charge of the above work a person competent to see that the State and City requirements pertaining thereto are observed? yes
Signature of owner Lafayette Hotel Co. Camille B. Bissell

INSPECTION COPY

Permit No. 43/591
Location 638 Congress St.
Owner Lafayette Hotel Co.
Date of permit 6/22/43.
Notif. closing-in
Inspn. closing-in
Final Notif.
Final Inspn.
Cert. of Occupancy issued
4/1/42
4/1/49

NOTES

6/23/43 - Letter
for closing permit
is in
8/20/43 - Letter to
Arch. Board re: permit
for local and District
re: middle story
higher than other walls
constructed at 12th



APPLICATION FOR PERMIT Class of Building or Type of Structure Second Class

Permit No. 6965

To the INSPECTOR OF BUILDINGS, PORTLAND, ME.

Portland, Maine, April 15, 1943

The undersigned hereby applies for a permit to erect alter install the following building structure-equipment in accordance with the Laws of the State of Maine, the Building Code of the City of Portland, plans and specifications, if any, submitted herewith and the following specifications:

Location 638 Congress Street Within Fire Limits? yes Dist. No. 1
Owner's or-Lesser's name and address Lafayette Hotel Corp., 638 Congress St. Telephone _____
Contractor's name and address C. H. Galley & Son, 17 Irving St. Telephone 2-5606
Architect _____ Plans filed yes No. of sheets 1
Proposed use of building hotel and stores No. families _____
Other buildings on same lot _____
Estimated cost \$ 500. Fee \$ 1.00

Description of Present Building to be Altered

Memorandum from Department of Building Inspection, Portland, Maine

638 Congress St.-----Addition for Coal bin for Lafayette Hotel by C. H. Galley & Sons, Builders-----4/16/43

To Owner and Builder:

No information has been required as to the strength of this concrete slab and steel on which bin is to rest for the reason that it is reported to have been used as driveway for heavy trucks for years, and it is assumed that those loads would be heavier than any which would come on them under new arrangement.
Anchors from roof joists to masonry walls should be provided as required by Section 311-c-3.2-(c) of Building Code.

CC Lafayette Hotel Corp.,
638 Congress St.

(Signed) Warren McDonald
Inspector of Buildings

the heating contractor.

Details of New Work

Is any plumbing work involved in this work? _____
Is any electrical work involved in this work? _____ Height average grade to top of plate _____
Size, front _____ depth _____ No. stories _____ Height average grade to highest point of roof _____
To be erected on solid or filled land? _____ earth or rock? _____
Material of foundation _____ Thickness, top _____ bottom _____ cellar _____
Material of underpinning _____ Height _____ Thickness _____
Kind of roof _____ Rise per foot _____ Roof covering _____
No. of chimneys _____ Material of chimneys _____ of lining _____
Kind of heat _____ Type of fuel _____ Is gas fitting involved? _____
Framing lumber--Kind _____ Dressed or full size? _____
Corner posts _____ Sills _____ Girt or ledger board? _____ Size _____
Material columns under girders _____ Size _____ Max. on centers _____
Studs (outside walls and carrying partitions) 2x4-16" O. C. Girders 6x8 or larger. Bridging in every floor and flat roof span over 8 feet. Sills and corner posts all one piece in cross section.
Joists and rafters: 1st floor _____, 2nd _____, 3rd _____, roof _____
On centers: 1st floor _____, 2nd _____, 3rd _____, roof _____
Maximum span: 1st floor _____, 2nd _____, 3rd _____, roof _____
If one story building with masonry walls, thickness of walls? _____ 8" - 12" height? 6'

If a Garage

No. cars now accommodated on same lot _____, to be accommodated _____
Total number commercial cars to be accommodated _____
Will automobile repairing be done other than minor repairs to cars habitually stored in _____ closed _____

Miscellaneous

Will above work require removal or disturbing of any shade tree on a public street? _____
Will there be in charge of the above work a person competent to see that the State and C. _____ as pertaining thereto are observed? yes

INSPECTION COPY

Signature of owner By C. H. Galley & Son
4 C. H. Galley & Son

Lafayette Hotel Corp.

3-16-43



APPLICATION FOR PERMIT

Class of Building or Type of Structure Second Class

Portland, Maine, April 15, 1942

PERMIT NO. 0225

Permit No. 0225

Last use Hotel and stores No. families 3

General Description of New Work

To build brick coal bin 10' x 17' over existing concrete vault of oil storage as per plan
To cut in new opening 3' x 12' to boiler room

It is understood that this permit does not include installation of heating apparatus which is to be taken out separately by and in the name of the heating contractor.

Details of New Work

Is any plumbing work involved in this work? _____
Is any electrical work involved in this work? _____ Height average grade to top of plate _____
Size, front _____ depth _____ No. stories _____ Height average grade to highest point of roof _____
To be erected on solid or filled land? _____ earth or rock? _____
Material of foundation _____ Thickness, top _____ bottom _____ cellar _____
Material of underpinning _____ Height _____ Thickness _____
Kind of roof _____ Rise per foot _____ Roof covering _____
No. of chimneys _____ Material of chimneys _____ of lining _____
Kind of heat _____ Type of fuel _____ Is gas fitting involved? _____
Framing lumber—Kind _____ Dressed or full size? _____
Corner posts _____ Sills _____ Girt or ledger board? _____ Size _____
Material columns under girders _____ Size _____ Max. on centers _____
Studs (outside walls and carrying partitions) 2x4-16" O. C. Girders 6x8 or larger. Bridging on every floor and flat roof span over 8 feet. Sills and corner posts all one piece in cross section.
Joists and rafters: 1st floor _____, 2nd _____, 3rd _____, roof _____
On centers: 1st floor _____, 2nd _____, 3rd _____, roof _____
Maximum span: 1st floor _____, 2nd _____, 3rd _____, roof _____
If one story building with masonry walls, thickness of walls? _____ R² = 12" height? 6'

If a Garage

No. cars now accommodated on same lot _____, to be accommodated _____
Total number commercial cars to be accommodated _____
Will automobile repairing be done other than minor repairs to cars habitually stored in the proposed building? _____

Miscellaneous

Will above work require removal or disturbing of any shade tree on a public street? no
Will there be in charge of the above work a person competent to see that the State and City requirements pertaining thereto are observed? yes
Signature of owner Py Lafayette Hotel Corp.
44 Clifford St. Bailey.

INSPECTION COPY

3365D

Permit No 4125
Location 638 Congress St.
Owner Lafayette Hotel Corp
Date of permit 4/16/43
Notif. closing-in _____
Inspn. closing-in _____
Final Notif. _____
Final Insp 5/1/43
Cert. of Occupancy issued Mar 1

NOTES

5/1/43 - 3152 - 1 - 1
posted - 29K

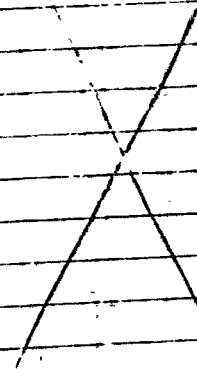

Approved by M. O.
10/17/42

, that the above permit intended to include the erection of
a parquee for the W. L. Atkins Company over the public sidewalk at 650 Congress
street, attached to property owned by the Dev. of James Cunningham, be
approved, such approval of the Municipal Officers being required by Section 102-
c-4.1 of the Building Code as a structure projecting over the public sidewalk,
before the permit is issued.



APPLICATION FOR PERMIT

Class of Building or Type of Structure 1st Second

PERMIT ISSUED

Permit No. 908

AUG 18 1942

Portland, Maine, August 13, 1942

To the INSPECTOR OF BUILDINGS, PORTLAND, ME.

The undersigned hereby applies for a permit to erect alter install the following building structure equipment in accordance with the Laws of the State of Maine, the Building Code of the City of Portland, plans and specifications, if any, submitted herewith and the following specifications:

Location 150 Congress Street Within Fire Limits? Yes Dist. No. 1
Owner's or Lessee's name and address Owner - Twin Lakes Bldg Co, 124 Forest Avenue Telephone
Contractor's name and address Clayton S. Clark, 46 Portland Street Telephone 2-2168
Architect Hillier & Bass Plans filed yes No. of sheets 1
Proposed use of building Stores and hotel No. families
Other buildings on same lot none
Estimated cost \$ 1400 Fee \$ 3.00

Description of Present Building to be Altered

Material brick No. stories 5 Heat Style of roof flat Roofing
Last use stores and hotel No. families

General Description of New Work

To provide new store front and entrance as per plans at the above location.
No structural changes

Approved by Municipal Officers 8/17/42

It is understood that this permit does not include installation of heating apparatus which is to be taken out separately by and in the name of the heating contractor.

Details of New Work

Is any plumbing work involved in this work? no
Is any electrical work involved in this work? yes Height average grade to top of plate
Size, front depth No. stories Height average grade to highest point of roof
To be erected on filled land? earth or rock?
Material of foundation Thickness, top bottom cellar
Material of underpinning Height Thickness
Kind of roof Rise per foot Roof covering
No. of chimneys Material of chimneys of lining
Kind of heat Type of fuel Is gas fitting involved?
Framing lumber—Kind Dressed or full size?
Corner posts Sills Girt or ledger board? Size
Material columns under girders Size Max. on centers
Studs (outside walls and carrying partitions) 2x4-16" O. C. Girders 6x8 or larger. Bridging in every floor and flat roof span over 8 feet. Sills and corner posts all one piece in cross section.
Joists and rafters: 1st floor , 2nd , 3rd , roof
On centers: 1st floor , 2nd , 3rd , roof
Maximum span: 1st floor , 2nd , 3rd , roof

If one story building with masonry walls, thickness of walls? height?

If a Garage

No. cars now accommodated on same lot , to be accommodated
Total number commercial cars to be accommodated
Will automobile repairing be done other than minor repairs to cars habitually stored in the proposed building?

Miscellaneous

Will above work require removal or disturbing of any shade tree on a public street?
Will there be in charge of the above work a person competent to see that the State and City requirements pertaining thereto are observed? yes

INSPECTION COPY

Signature of owner F. L. Watkins Company
By Georgina M. Clark
By Clayton S. Clark

Permit No. 42/908 P
Location 650 Congress St.
S. H. Watkins Co
Corner Cunningham Heir
Date of permit 8/18/42
Notif. closing-in _____
Inspn. closing-in _____
Final Notif. _____
Final Inspn. 10/30/42
Cert. of Occupancy issued None

NOTES

2/5/42 - 11 in. dia. hole
7/2 - 1 in. dia. hole
10/9/42 - 2 in. dia. hole
10/30/42 - same - 2 in. dia.

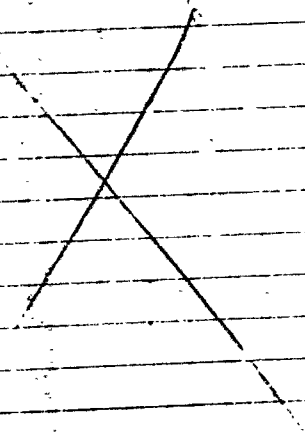



APPLICATION FOR PERMIT

Class of Building or Type of Structure Second Class

Permit No. 1111

Portland, Maine, November 25, 1941

To the INSPECTOR OF BUILDINGS, PORTLAND, ME.

The undersigned hereby applies for a permit to erect alter install the following building structure equipment in accordance with the Laws of the State of Maine the Building Code of the City of Portland, plans and specifications, if any, submitted herewith and the following specifications:

Location 515 Congress Street Within Fire Limits? Yes Dist. No. 1
Owner's or lessee's name and address James Cunningham Dev: 5555, 638 Congress St. Telephone 3-0246
Contractor's name and address F. W. Cunningham & Sons, 181 State Street Telephone 3-0246
Architect _____ Plans filed Yes No. of sheets 1
Proposed use of building Hotel and stores No. families _____
Older buildings on same lot _____
Estimated cost \$ 250. Fee \$ 1.00

Description of Present Building to be Altered

Material brick No. stories 6-1 Heat _____ style of roof _____ Roofing _____
Last use Hotel & Stores No. families _____

General Description of New Work

To Repair after Fire -

To cut floor joists out of boiler setting and support as per plan

It is understood that this permit does not include installation of heating apparatus which is to be taken out separately by and in the name of the heating contractor.

Details of New Work

Is any plumbing work involved in this work? _____
Is any electrical work involved in this work? _____ Height average grade to top of plate _____
Size, front _____ depth _____ No. stories _____ Height average grade to highest point of roof _____
To be erected on solid or filled land? _____ ea. or rock? _____
Material of foundation _____ Thickness, top _____ bottom _____ cellar _____
Material of underpinning _____ Height _____ Thickness _____
Kind of roof _____ Rise per foot _____ Roof covering _____
No. of chimneys _____ Material of chimneys _____ of lining _____
Kind of heat _____ Type of fuel _____ Is gas fitting involved? _____
Framing lumber—Kind _____ Dressed or full size? _____
Corner posts _____ Sills _____ Girt or ledger board? _____ Size _____
Material columns under girders _____ Size _____ Max. on centers _____
Studs (outside walls and carrying partitions) 2x4-16" O. C. Girders 6x8 or larger. Bridging in every floor and flat roof span over 8 feet. Sills and corner posts all one piece in cross section.
Joists and rafters: 1st floor _____ 2nd _____ 3rd _____ roof _____
On centers: 1st floor _____ 2nd _____ 3rd _____ roof _____
Maximum span: 1st floor _____ 2nd _____ 3rd _____ roof _____
If one story building with masonry walls, thickness of walls? _____ height? _____

If a Garage

No. cars now accommodated on same lot _____ to be accommodated _____
Total number commercial cars to be accommodated _____
Will automobile repairing be done other than minor repairs to cars habitually stored in the proposed building? _____

Miscellaneous

Will above work require removal or disturbing of any shade tree on a public street? no
Will there be in charge of the above work a person competent to see that the State and City requirements pertaining thereto are observed yes
By James Cunningham Devisees
Signature of owner By F. W. Cunningham & Sons

INSPECTION COPY

Permit No. 41/1846

Location 638 Congress St.

Owner James Cunningham

Date of permit 11/25/41

Notif. closing-in

Inspn. closing-in

Final Notif.

Final Inspn. 12/31/41. C.L.C.

Cert. of Occupancy issued March

Comp C-41-122

NOTES

11/28/41. Work out site. C.L.C.

12/1/41. same. C.L.C.

12/10/41. same. C.L.C.

12/15/41. same. C.L.C.

12/29/41. Work almost done. C.L.C.

12/31/41. Work completed, as
near as can be seen ends
of floor joists have been
cut back from boiler
brickwork. C.L.C.

C-41-122-I

11/13/41-H

November 4, 1941

James C. Maher, Mgr.
Lafayette Hotel
638 Congress Street,
Portland, Maine

Dear Mr. Maher:

As the result of a minor fire in or around the boiler room of the Lafayette Hotel, an inspector from this office finds that the first floor joists are built into the back brick wall of the boiler setting.

I am aware of the fact that your engineer thinks that the fire started from accumulation of dirt and dust rather than contact of this woodwork with the boiler setting. Irrespective of how the fire started this situation from many experiences in the field of fire prevention, is not a good one and not safe.

Will you be kind enough to consider this letter as an order, given in accordance with my duty as authorized and directed by Sections 28, 29, 30 and 32 of Chapter 35, Revised Statutes of Maine, copy attached hereto, to proceed and accomplish the removal of this woodwork from the bricking up of the boiler setting and the proper support of the floor joists according to Building Code standards not later than November 18, 1941?

Presumably some type of auxiliary beam or girder with posts will probably be necessary to support these joists. A permit from this department is required before the work is commenced and with the application for the permit it is necessary to file a plan to a definite scale, made by some person familiar with the methods of figuring loads and stresses in building material, the plan to be either in duplicate or a blueprint on which all of the information has been printed from the original, so that the owner and builder may have the same information that has been filed here.

Very truly yours,

WHD/H

Inspector of Buildings

(C) GENERAL BUSINESS ZONE
Complaint No. C-41-122

Location 638-652 Congress St.

Date Received 10/1/41

Date Disposed of 11/25/41

Alt. 41/1046 NOTES

11/1/41. This complaint is the result of a fire. The first floor joists are let into the back brick wall of this boiler about 2". This condition has existed since the Hotel was built and according to the owner here, the fire started from accumulation of dirt and dust, rather than contact of wood against the boiler. Condition is not good and I believe can be greatly improved without much trouble. There is a 6" T. & G. beam about 30" from the boiler for supports a safe over this area. I believe a steel beam spanning the full width of the boiler (abt 14') could be put close enough

to back of boiler so these joists could be cut away

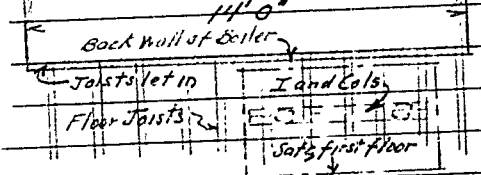

PLAN

10/4/41 - Better - wood

11/14/41. Nothing has been done



GENERAL BUSINESS ZONING PERMIT ISSUED
APPLICATION FOR PERMIT Permit No. 920

Class of Building or Type of Structure Refrigeration JUN 21 1938

Portland, Maine, June 20, 1938

To the INSPECTOR OF BUILDINGS, PORTLAND, ME.

The undersigned hereby applies for a permit to ~~erect~~ install the following ~~building structure~~ equipment in accordance with the Laws of the State of Maine, the Building Code of the City of Portland, plans and specifications, if any, submitted herewith and the following specifications:

Location 638 Congress Street Within Fire Limits? yes Dist. No. _____
Owner's or Lessee's name and address Lafayette Hotel, 638 Congress St. Telephone _____
Contractor's name and address The Boyd Corp. 176 Middle Street Telephone Y-0274
Architect _____ Plans filed yes No. of sheets _____
Proposed use of building Hotel and stores No. families _____
Other buildings on same lot _____
Estimated cost \$ 200. Fee \$.75

Description of Present Building to be Altered

Material brick No. stories _____ Heat _____ Style of roof _____ Roofing _____
Last use Hotel and stores No. families _____

General Description of New Work

To install ~~refrigeration~~ Cooling system for cocktail bar and lounge, 1st floor
(compressor in basement)

It is understood that this permit does not include installation of heating apparatus which is to be taken out separately by and in the name of the heating contractor.

Details of New Work

Height average grade to top of plate _____
Size, front _____ depth _____ No. stories _____ Height average grade to highest point of roof _____
To be erected on solid or filled land? _____ earth or rock? _____
Material of foundation _____ Thickness, top _____ bottom _____ cellar _____
Material of underpinning _____ Height _____ Thickness _____
Kind of Roof _____ Rise per foot _____ Roof covering _____
No. of chimneys _____ Material of chimneys _____ of lining _____
Kind of heat _____ Type of fuel _____ Is gas fitting involved? _____
Framing Lumber—Kind _____ Dressed or Full Size? _____
Corner posts _____ Sills _____ Girt or ledger board? _____ Size _____
Material columns under girders _____ Size _____ Max. on centers _____
Studs (outside walls and carrying partitions) 2x4-16" O. C. Girders 6x8 or larger. Bridging in every floor and flat roof span over 8 feet. Sills and corner posts all one piece in cross section.

Joists and rafters: 1st floor _____, 2nd _____, 3rd _____, roof _____
On centers: 1st floor _____, 2nd _____, 3rd _____, roof _____
Maximum span: 1st floor _____, 2nd _____, 3rd _____, roof _____

If one story building with masonry walls, thickness of walls? _____ height? _____

If a Garage

No. cars now accommodated on same lot _____, to be accommodated _____
Total number commercial cars to be accommodated _____
Will automobile repairing be done other than minor repairs to cars habitually stored in the proposed building? _____

Miscellaneous

Will above work require removal or disturbing of any shade tree on a public street? no
Will there be in charge of the above work a person competent to see that the State and City requirements pertaining thereto are observed? yes

By Lafayette Hotel
Signature of owner J. S. Boyd
INSPECTION COPY By J. S. Boyd

CITY OF PORTLAND

Permit No. 38/920
Location 628 Congress St.
Owner Lafayette Hotel
Date of permit 6/21/38
Notif. closing-in
Inspn. closing-in
Final Notif.
Final Inspn. 7/2/38. 006.
Cert. of Occupancy issued None

NOTES

To Congress ST ← PARK ST

CURB

Proposed
stand

Room
PIAZZA

A. J. Kind Company,
Builders —

Permit to build frame on
Park St side of Lafayette Hotel —

Expense \$105.⁰⁰/₁₀₀

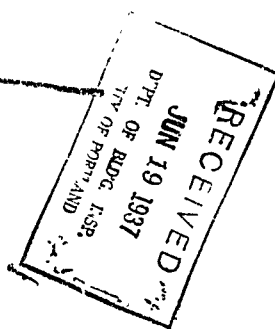



100 GENERAL BUSINESS ZONE
APPLICATION FOR PERMIT

Class of Building or Type of Structure Third Class

Portland, Maine, June 10, 1937

7899
JUN 11 1937

To the INSPECTOR OF BUILDINGS, PORTLAND, ME.

The undersigned hereby applies for a permit to erect, alter, install the following building, structure, equipment, or in accordance with the Laws of the State of Maine, the Building Code of the City of Portland, plans and specifications, if any, submitted herewith and the following specifications:

Location 828 Congress Street Ward 6 Within Fire Limits? yes Dist. No. 1
Owner's or Lessee's name and address Park St. Side of Bldg. Yankee Division Veteran Assoc. Telephone 4-2024
Contractor's name and address Owen P. Benton, 17 Hill St. Telephone 2-2725
Architect _____ Plans filed _____ No. of sheets _____
Proposed use of building Temporary Stand No. families _____
Other buildings on same lot _____
Estimated cost \$ _____ Fee \$.25

Description of Present Building to be Altered

Material _____ No. stories _____ Heat _____ Style of roof _____ Roofing _____
Last use _____ No. families _____

General Description of New Work

To erect temporary stands for convention purposes in location shown on sketch. The stand will be removed on or before July 5th, 1937

It is understood that this permit does not include installation of heating apparatus which is to be taken out separately by contract in the name of the heating contractor.

Details of New Work

Size, front _____ depth _____ No. stories _____ Height average grade to top of plate _____
To be erected on solid or filled land? _____ earth or rock? _____
Material of foundation _____ Thickness, top _____ bottom _____
Material of underpinning _____ Height _____ Thickness _____
Kind of Roof _____ Rise per foot _____ Roof covering _____
No. of chimneys _____ Material of chimneys _____ of lining _____
Kind of heat _____ Type of fuel _____ Is gas fitting involved? _____
Corner posts _____ Sills _____ Girt or ledger board? _____ Size _____
Material columns under girders _____ Size _____ Max. on centers _____
Studs (outside walls and carrying partitions) 2x4-16" O. C. Girders 6x8 or larger. Bridging in every floor and flat roof span over 8 feet. Sills and corner posts all one piece in cross section.
Joists and rafters: 1st floor _____, 2nd _____, 3rd _____, roof _____
On centers: 1st floor _____, 2nd _____, 3rd _____, roof _____
Maximum span: 1st floor _____, 2nd _____, 3rd _____, roof _____
If one story building with masonry walls, thickness of walls? _____ height? _____

If a Garage

No. cars now accommodated on same lot _____, to be accommodated _____
Total number commercial cars to be accommodated _____
Will automobile repairing be done other than minor repairs to cars habitually stored in the proposed building? _____

Miscellaneous

Will above work require removal or disturbing of any shade tree on a public street? no
Will there be in charge of the above work a person competent to see that the State and City requirements pertaining thereto are observed? yes
Signature of owner Owen P. Benton Yankee Division, Veteran Association

INSPECTION COPY

Ward 6 Permit No. 37/899
Location 638 Congress St.
Owner Yankee Division
Veteran Clinic
Date of permit 6/19/37.
Notif. closing-in _____
Inspn. closing-in _____
Final Notif. None
Final Inspn. 6/28/37. C.H.
Cert. of Occupancy issued None

NOTES

Portland, Maine
Jan. 6, 1941.

I hereby give my full consent to the erecting of
a sign for the Kalamazoo Stove Co. on the Lafayette
Hotel Building. I understand fully the conditions
of the erection and they are satisfactory to me.

(Signed)

The Lafayette
by J. Mahan, mgt.



(C) GENERAL BUSINESS ZONE

PERMIT ISSUED
0001

APPLICATION FOR PERMIT TO ERECT
SIGN OVER PUBLIC SIDEWALK OR STREET

Permit No. JAN-10-1941

Portland, Maine, January 15, 1941 19

To the INSPECTOR OF BUILDINGS, PORTLAND, ME.

The undersigned hereby applies for a permit to erect the following described sign extending over a public sidewalk or street in accordance with the Building Code of the City of Portland, and the following specifications:

Location 611 Congress Street Within Fire Limits? yes Dist. No. 1
Owner of building to which sign is to be attached Leffette Hotel
Name and address of owner of sign Re. Mazzio Stove & Furnace Co.
Contractor's name and address Robert G. Cousens, 243A Middle St. Telephone 8-8839
When does contractor's bond expire? January 1942

Information Concerning Building

No. stories 7 Material of wall to which sign is to be attached brick
from 19 Free St. Details of Sign and Connections
Electric? yes Vertical dimension after erection 26" Horizontal 6'
Weight 160 lbs., Will there be any hollow spaces? yes Any rigid frame? yes
Material of frame angle iron No. advertising faces 2, material galv iron
No. rigid connections 4 Are they fastened directly to frame of sign? yes
No. through bolts 1, Size 3/8", Location, top or bottom top
No. guys 2, material angle iron, Size 1 1/2 x 3/16
Minimum clear height above sidewalk or street 17'
Maximum projection into street 6'

Fee \$ 1.00

INSPECTION COPY

Signature of contractor

R. G. Cousens

8-7180

Permit No. 41/61
Location 644 Congress St.
Owner Kalamazoo Store & Furniture Co.
Date of permit 1/16/41
Sign Contractor
Final Insp. 1/23/41 O.R.

NOTES

Shop - 1/21/41
Through Bolt - 1/23/41
Distance above sidewalk - 1/23/41
Document Under side - 1/23/41

OR
BETWEEN
STREET

31

OWNERS LATE 1911 HOTEL
6 STORIES. BRICK
BARTLETT RALPH 642 CONGRESS ST

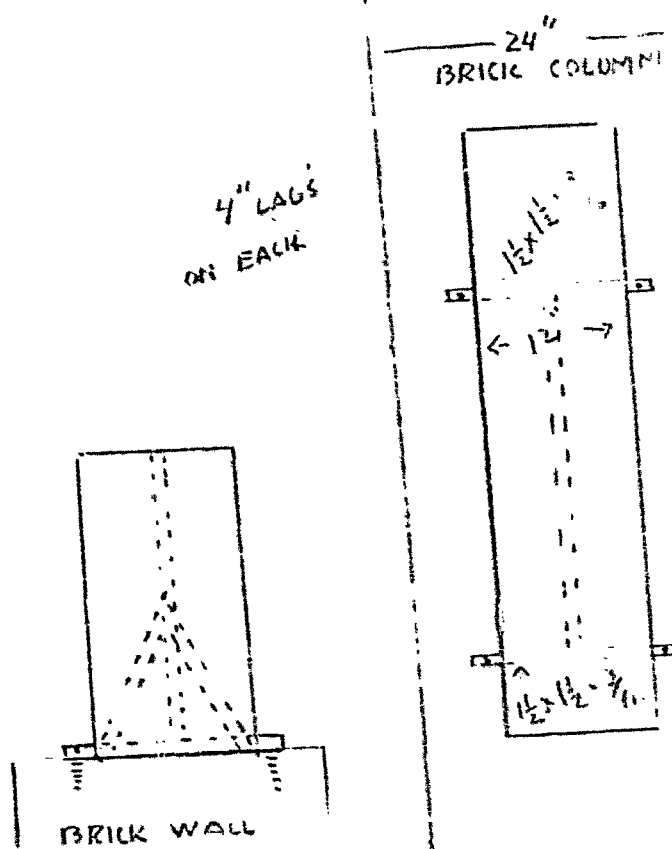

WEIGHT 80 lbs.

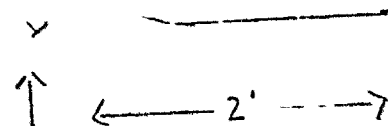
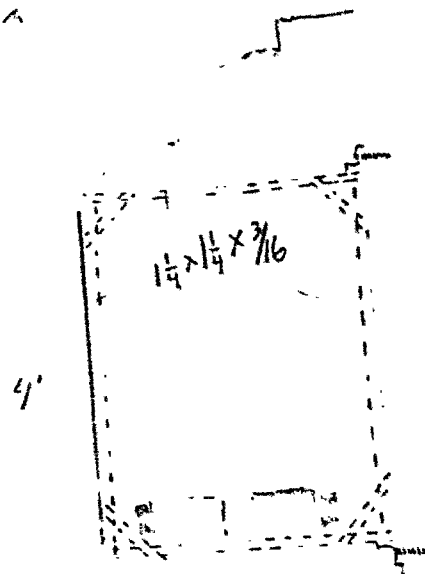

8'6" from Sidewalk
LINE

JAN 28-36
FILED FOR PERMIT



GENERAL BUSINESS ZONE

PERMIT ISSUED
Permit No. 0068

APPLICATION FOR PERMIT TO ERECT SIGN
OVER PUBLIC SIDEWALK OR STREET

Portland, Maine, Jan. 23, 1938

To the INSPECTOR OF BUILDINGS, PORTLAND, ME.

The undersigned hereby applies for a permit to erect the following described sign extending over a public sidewalk or street in accordance with the Building Code of the City of Portland, and the following specifications:

Location 642 Congress St Ward _____ Within Fire Limits? _____ Dist. No. _____
Owner of building to which sign is to be attached Lafayette Hotel
Name and address of owner of sign Bartlett Radio Co., 642 Congress St
Contractor's name and address THE KIMBALL SYSTEM OF PORTLAND Telephone 2-5047
When does contractor's bond expire? Jan. 24, 1937

Information Concerning Building

No. stories 6 Material of wall to which sign is to be attached bricks

Details of Sign and Connections

Electric? yes Vertical dimension after erection 4' Horizontal 1'
Weight 80 lbs. lbs., Will there be any hollow spaces? yes Any rigid frame? yes
Material of frame 1 1/2 x 1 1/2 x 3/16 Angle iron advertising faces 2 material 24 ga. Galv. metal
No. rigid connections four Are they fastened directly to frame of sign? yes
No. through bolts none Size _____ Location, top or bottom _____
No. guys 4 material band iron, inside of sign Size 1 1/2 x 3/16
Minimum clear height above sidewalk or street 8' 6"
Maximum projection into street 2'

CERTIFICATE OF OCCUPA
REQUIREMENT IS WAIVED

Oliver T. Dubois

CHIEF OF FIRE DEPT.
INSPECTION COPY

Signature of contractor

THE KIMBALL SYSTEM OF PORTLAND

Howard J. Curry

Fee \$ 1.00

6113 B

Ward 6 Permit No. 34/68

Loc 642 Congress St.

Owner Battlett Radio Co

Date of permit 1/29/36

Sign Contractor

Final Inspn. 3/9/36. V.C.B.

NOTES

Sticker
Elect. ltrg. Has art. in d
or shop in sp.
Shop 1/31/36.
Sign file plan made 2/7/36.
Ornament underside - No 19/36.
Distance above sidewalk - ✓

2/19/36. Sign not to be
erected for a while
C.B.B.



GENERAL BUSINESS ZONE

PERMIT ISSUED

APPLICATION FOR PERMIT TO ERECT SIGN
OVER PUBLIC SIDEWALK OR STREET

JAN 18 1936

Portland, Maine, January 15, 1936

To the INSPECTOR OF BUILDINGS, PORTLAND, ME.

The undersigned hereby applies for a permit to erect the following described sign extending over a public sidewalk or street in accordance with the Building Code of the City of Portland, and the following specifications:

Location 650 Congress Street Ward 6 Within Fire Limits? yes Dist. No. 1
Owner of building to which sign is to be attached Helen C. Donahue, et al
Name and address of owner of sign Ford Cleansers, 850 Congress St.
Contractor's name and address Creeden of Portland, 273 Middle St. Telephone 2-124242
When does contractor's bond expire? August, 1936

Information Concerning Building

No. stories 6 Material of wall to which sign is to be attached brick

Details of Sign and Connections

Electric? yes Vertical dimension after erection 3' Horizontal 5'
Weight 150 lbs. Will there be any hollow spaces? yes Any rigid frame? yes
Material of frame angle iron No. advertising faces 2 material galv. iron
No. rigid connections 4 Are they fastened directly to frame of sign? yes
No. through bolts 1 Size 5/8" Location, top or bottom top
No. guys 1 material iron Size 3/4"
Minimum clear height above sidewalk or street 15'
Minimum projection into street 8'

Creeden of Portland

Fee \$ 1.00

CHIEF OF FIRE DEPT. Signature of contractor

INSPECTION COPY

By

John Creeden

Ward 6 Permit No. 36/34

Location 650 Centre St

Owner Ford Cleaners

Date of permit 1/16/36

Sign Contractor

File No. 1/20/36 008

NOTES original sign

Sticker

Elect. Inspr.

1/17/36

Shop Inspr.

Sign file plan made

1/20/36

Clearance above sidewalk

Ornament underside of

1/17/36. This is the same sign as erected under permit 34/90 by Mr Middlebrook. Mr Cruden is using the same fastenings. Mr Middlebrook said his fastenings bolt in and on original permit this is shown the uplift. Mr Cruden put in a transverse corner braces and reinforced part of the face, this extra weight would be offset by old lettering and will be removed. C.B.



APPLICATION FOR PERMIT

Class of Building or Type of Structure Refrigeration

Permit No. 2014
NOV 21 1935

Portland, Maine, November 21, 1935

To the INSPECTOR OF BUILDINGS, PORTLAND, ME.

The undersigned hereby applies for a permit to erect ~~alter~~ install the following building ~~structure~~ equipment in accordance with the Laws of the State of Maine, the Building Code of the City of Portland, plans and specifications, if any, submitted herewith and the following specifications:

Location 651 Congress Street Ward 6 Within Fire Limits? yes Dist. No. 1
Owner's or lessee's name and address Marie Saunders Store, 651 Congress St. Telephone _____
Contractor's name and address Ballard Oil & Equipment Co., 124 High St. Telephone 2-1991
Architect's name and address _____
Proposed use of building Hotel and stores No. families _____
Other buildings on same lot _____
Plans filed as part of this application? yes with Fire Dept No. of sheets _____
Estimated cost \$ approx 1,000. Fee \$ approx 1.00

Description of Present Building to be Altered

Material _____ No. stories _____ Heat _____ Style of roof _____ Roofing _____
Last use Hotel and stores No. families _____

General Description of New Work

To install refrigeration equipment (compressor in basement)

It is understood that this permit does not include installation of heating apparatus which is to be taken out separately by and in the name of the heating contractor.

Details of New Work

Size, front _____ depth _____ No. stories _____ Height average grade to top of plate _____
To be erected on solid or filled land? _____ Height average grade to highest point of roof _____
Material of foundation _____ Thickness, top _____ bottom _____
Material of underpinning _____ Height _____ Thickness _____
Kind of Roof _____ Rise per foot _____ Roof covering _____
No. of chimneys _____ Material of chimneys _____ of lining _____
Kind of heat _____ Type of fuel _____ Is gas fitting involved? _____
Corner posts _____ Sills _____ Girt or ledger board? _____ Size _____
Material columns under girders _____ Size _____ Max. on centers _____
Studs (outside walls and carrying partitions) 2x4-16" O. C. Girders 6x8 or larger. Bridging in every floor and flat roof span over 8 feet. Sills and corner posts all one piece in cross section.
Joists and rafters: 1st floor _____, 2nd _____, 3rd _____, roof _____
On centers: 1st floor _____, 2nd _____, 3rd _____, roof _____
Maximum span: 1st floor _____, 2nd _____, 3rd _____, roof _____
If one story building with masonry walls, thickness of walls? _____ height? _____

If a Garage

No. cars now accommodated on same lot _____, to be accommodated _____
Total number commercial cars to be accommodated _____
Will automobile repairing be done other than minor repairs to cars habitually stored in the proposed building? _____

Miscellaneous

Will above work require removal or disturbing of any shade tree on a public street? no
Will there be in charge of the above work a person competent to see that the State and City requirements pertaining thereto are observed? yes

Signature of owner Marie Saunders Store
By Ballard Oil & Equipment Co.
By E. P. Anderson Treasurer.

Ward 6 Permit No. 35/2014
Location 652 Congress St.
Owner Marie Saunders Street
Date of permit 11/21/85.
Notif. closing-in _____
Inspn. closing-in _____
Final Notif. _____
Final Inspn. _____
Cert. of Occupancy issued None

NOTES

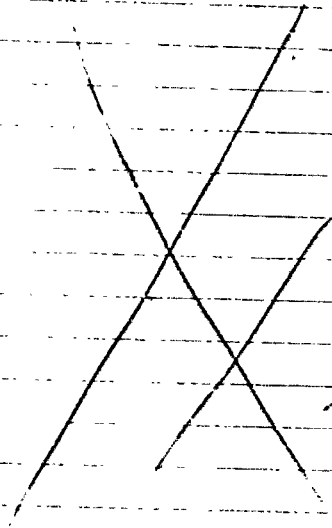



(7) GENERAL BUSINESS ZONE

PERMIT JED
Permit No. 1969

APPLICATION FOR PERMIT TO ERECT SIGN OVER PUBLIC SIDEWALK OR STREET

Portland, Maine, November 15, 1935.

To the INSPECTOR OF BUILDINGS, PORTLAND, ME.

The undersigned hereby applies for a permit to erect the following described sign extending over a public sidewalk or street in accordance with the Building Code of the City of Portland, and the following specifications:

Location 642 Congress Street Ward 6 Within Fire Limits? yes Dist. No. 1
Owner of building to which sign is to be attached Lafayette Hotel Co.
Name and address of owner of sign Bartlett Radio Co. 842 Congress St.
Contractor's name and address Kimball System of Portland, 51 Cross St. Telephone 2-5947
When does contractor's bond expire? January 1936

Information Concerning Building

No. stories 6 Material of wall to which sign is to be attached brick
Sign to be moved from 650 Congress Street

CERTIFICATE OF OCCUPANCY
REQUIREMENT IS WAIVED

Details of Sign and Connections
Electric? yes Vertical dimension after erection 27" Horizontal 11"
Weight 100 lbs. Will there be any hollow spaces? yes Any rigid frame? yes
Material of frame exp. galv. iron No. advertising faces 1 material metal
No. rigid connections 5 Are they fastened directly to frame of sign? yes
No. through bolts 3 Size 1/2" Location, top or bottom bottom
No. guys none material --- Size ---
Minimum clear height above sidewalk or street 15'
Maximum projection into street 10"

Oliver T. Lumbow

Signature of contractor

Robert C. Kimball
Kimball System of Portland

INSPECTION COPY

Fee \$ 1.00

Ward 6 Permit No. 35/1969
Loc 642 Congress St.
Owner Bartlett Radio Co.
Date of permit 11/13/35
Sign Contractor _____
Final Inspn. 12/7/35

NOTES
~~Sketch made~~
~~Plot map~~ None
~~Shop~~ 12/1/35
~~Spotted on sign map~~
~~Sign file plan made~~ 12/1/35



APPLICATION FOR PERMIT

Class of Building or Type of Structure Second Class

Portland, Maine, October 17, 1935

To the INSPECTOR OF BUILDINGS, PORTLAND, ME.

The undersigned hereby applies for a permit to erect alter install the following building structure eq accordance with the Laws of the State of Maine, the Building Code of the City of Portland, plans and specif any, submitted herewith and the following specifications:

Location 842 Congress Street Ward 6 Within Fire Limits? yes Dist. No. _____
Owner's or Lessee's name and address Bartlett Radio Co., 842 Congress St. Telephone _____
Contractor's name and address Harry L. Peterson, 956 Washington Ave. Telephone 3-35
Architect's name and address _____
Proposed use of building Hotel, stores No. families _____
Other buildings on same lot _____
Plans filed as part of this application? no No. of sheets _____
Estimated cost \$ 200. Fee \$ 75

Description of Present Building to be Altered

Material brick No. stories 6 Heat _____ Style of roof _____ Roofing _____
Last use Hotel, stores No. families _____

General Description New Work

To change existing 8' street entrance door to store to recessed entrance (4') with 5' door
(Floor area of store app. 18' x 25')

It is understood that this permit does not include installation of heating apparatus which is to be taken out separately by and is the name of the heating contractor.

Details of New Work

Size, front _____ depth _____ No. stories _____ Height average grade to top of plate _____
To be erected on solid or filled land? _____ Height average grade to highest point of roof _____
Material of foundation _____ Thickness, top _____ bottom _____
Material of underpinning _____ Height _____ Thickness _____
Kind of Roof _____ Rise per foot _____ Roof covering _____
No. of chimneys _____ Material of chimneys _____ Lining _____
Kind of heat _____ Type of fuel _____ Is gas fitting involved? _____
Corner posts _____ Sills _____ Girt or ledger board? _____ Size _____
Material columns under girders _____ Size _____ Max. on centers _____
Studs (outside walls and carrying partitions) 2x4-16" O. C. Girders 6x8 or larger. Bridging in every floor and flat roof span over 8 feet. Sills and corner posts all one piece in cross section.
Joists and rafters: 1st floor _____, 2nd _____, 3rd _____, roof _____
On centers: 1st floor _____, 2nd _____, 3rd _____, roof _____
Maximum span: 1st floor _____, 2nd _____, 3rd _____, roof _____
If one story building with masonry walls, thickness of walls? _____ height? _____

If a Garage

No. cars now accommodated on same lot _____ to be accommodated _____
Total number commercial cars to be accommodated _____
Will automobile repairing be done other than minor repairs to cars habitually stored in the proposed building? _____

Miscellaneous

Will above work require removal or disturbing of any shade tree on a public street? no
Will there be in charge of the above work a person competent to see that the State and City requirements pertaining to are observed? yes
Bartlett Radio Co.

Signature of owner

By

Harry L. Peterson

INSPECTION COPY

Ward 6 Permit No. 35/1779
Location 642 Cuyam St.
Owner Bailett Radio Co.
Date of permit 10/17/35.
Notif. closing-in.
Inspn. closing-in.
Final Notif.
Final Inspn. 11/1/35
Cert. of Occupancy issued None

NOTES

10/22/35 - Work started
D. B. S.
11/1/35 - Work done O.S.

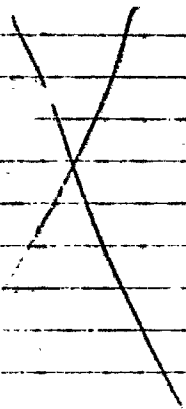

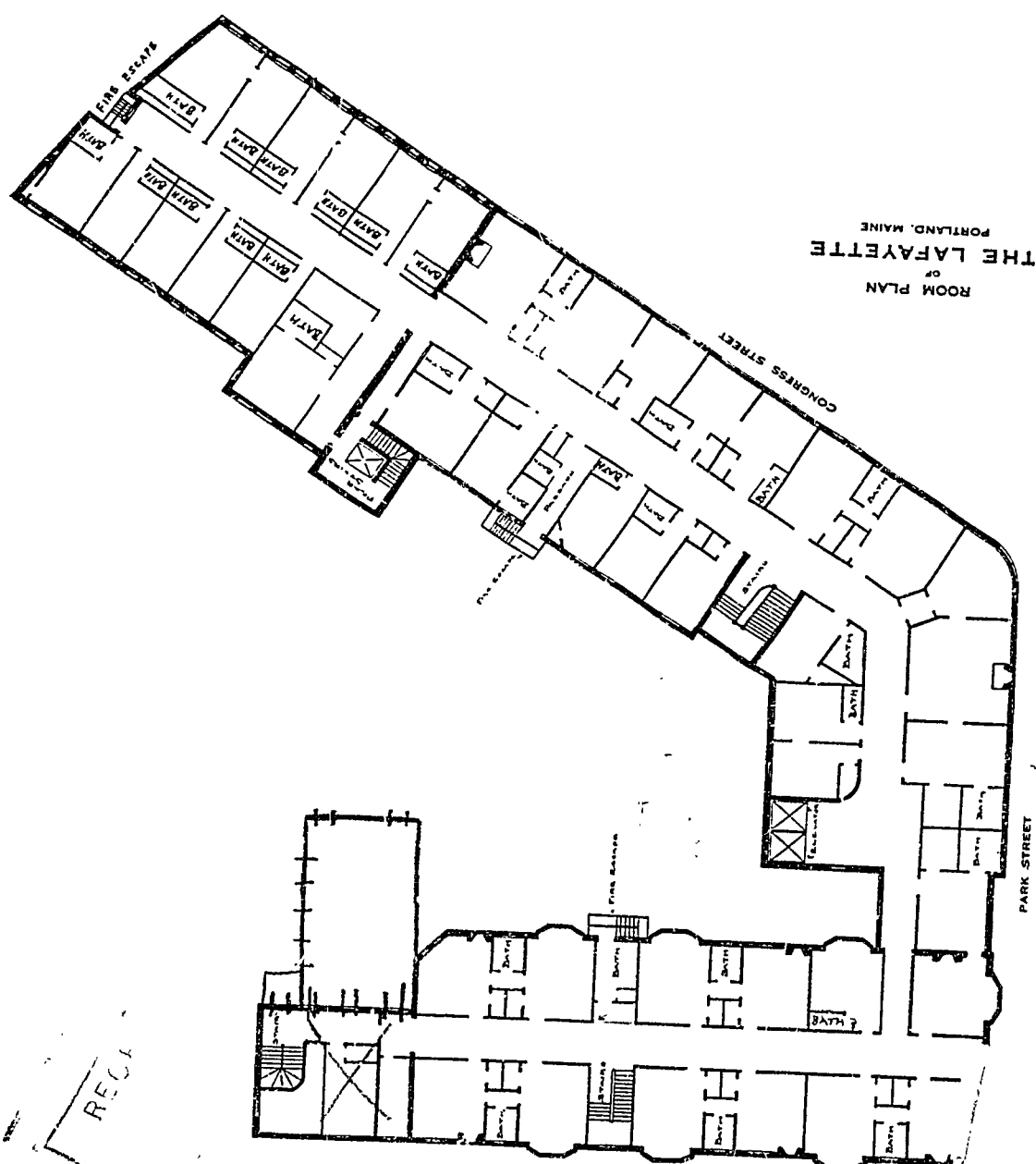

RECL



(G) GENERAL BUSINESS ZONE
APPLICATION FOR PERMIT

PERMIT No. 1
0161
FEB 12 1935

Class of Building or Type of Structure Second Class

Portland, Maine, February 12, 1935

To the INSPECTOR OF BUILDINGS, PORTLAND, ME.

The undersigned hereby applies for a permit to ~~erect~~ alter ~~install~~ the following building structure equipment in accordance with the Laws of the State of Maine, the Building Code of the City of Portland, plans and specifications, if any, submitted herewith and the following specifications:

Location 638-652 Congress Street Ward 8 Within Fire Limits? yes Dist. No. 1
Owner's or Lessee's name and address Devisees of James Cunningham Telephone _____
Contractor's name and address F. K. Cunningham & Sons, 181 State St. Telephone 4-1895
Architect's name and address _____
Proposed use of building Hotel and stores No. families _____
Other buildings on same lot _____
Plans filed as part of this application? yes No. of sheets 1
Estimated cost \$ 100. Fee \$.50

Description of Present Building to be Altered

Material brick No. stories 7-1 Heat _____ Style of roof _____ Roofing _____
Last use Hotel and stores No. families _____

General Description of New Work

To remove non-bearing partitions, first floor, as indicated in red on plan, space to be used for private dining rooms

CERTIFICATE OF OCCUPANCY
REQUIREMENT IS WAIVED

It is understood that this permit does not include installation of heating apparatus which is to be taken out separately by and in the name of the heating contractor.

Details of New Work

Size, front _____ depth _____ No. stories _____ Height average grade to top of plate _____
To be erected on solid or filled land? _____ earth or rock? _____
Material of foundation _____ Thickness, top _____ bottom _____
Material of underpinning _____ Height _____ Thickness _____
Kind of Roof _____ Rise per foot _____ Roof covering _____
No. of chimneys _____ Material of chimneys _____ of lining _____
Kind of heat _____ Type of fuel _____ Is gas fitting involved? _____
Corner posts _____ Sills _____ Girt or ledger board? _____ Size _____
Material columns under girders _____ Size _____ Max. on centers _____
Studs (outside walls and carrying partitions) 2x4-16" O. C. Girders 6x8 or larger. Bridging in every floor and flat span over 8 feet. Sills and corner posts all one piece in cross section.
Joists and rafters: 1st floor _____, 2nd _____, 3rd _____, roof _____
On centers: 1st floor _____, 2nd _____, 3rd _____, roof _____
Maximum span: 1st floor _____, 2nd _____, 3rd _____, roof _____
If one story building with masonry walls, thickness of walls? _____ height? _____

If a Garage

No. cars now accommodated on same lot _____, to be accommodated _____
Total number commercial cars to be accommodated _____
Will automobile repairing be done other than minor repairs to cars habitually stored in the proposed building? _____

Miscellaneous

Will above work require removal or disturbing of any shade tree on a public street? no
Will there be in charge of the above work a person competent to see that the State and City requirements pertaining thereto are observed? yes
By Devisees of James Cunningham
F. K. Cunningham & Sons

INSPECTION COPY

Signature of owner

By

Arthur J. Cunningham

Ward 6 Permit No. 35/164
Location 638-652 Congress St.
Owner Mr. James Cunningham
Date of permit 2/12/35
Not closing-in
Inspn. closing-in
Final Notif.
Final Inspn. 2/13/35
Cert. of Occupancy issued None

NOTES
2/13/35 - Work done
before permit was
applied for - A.G.S.

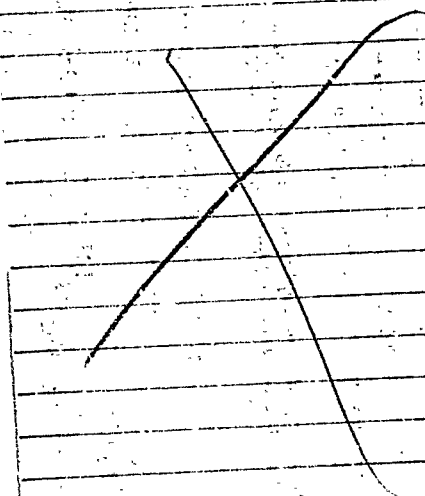

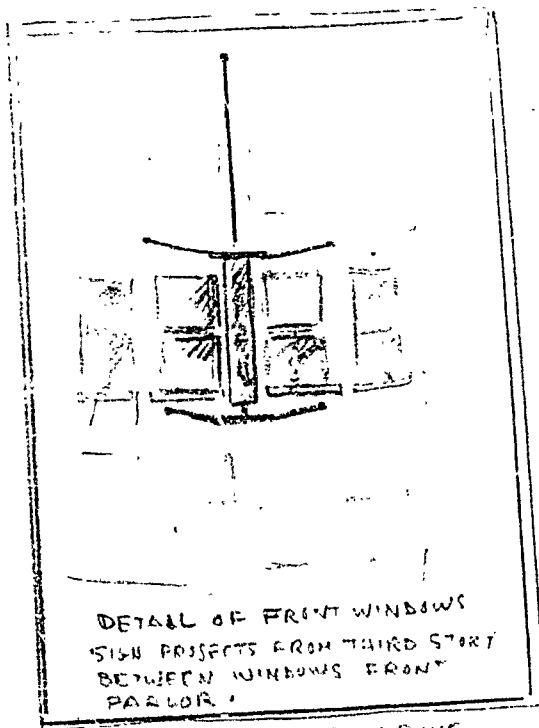

GUYS AND BRACES ABOVE
AND BELOW 2 MIDDLE WINDOWS
4 WINDOWS IN ROOM

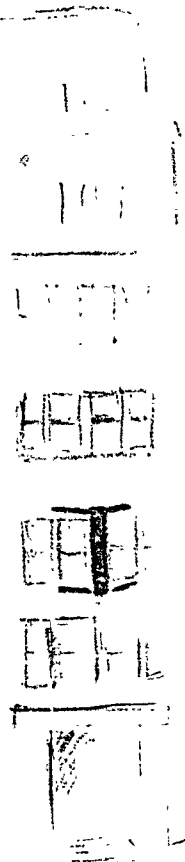

CONGRESS

PARK

LOCATION OF SIGN ON
BUILDING
LAFAYETTE HOTEL

SHEET (2)

(THE KIMBALL SYSTEM)

Sign at Lafayette Hotel by Kimball, 11/9/5

Weight -

$$\text{Steel metal } 8 \times 2 + 26 / 5 = 126 \text{ \#}$$

$$2 \times 2 \times 4 \text{ LS} - 33 \times 3.19 = 105$$

$$2 \times 2 \times 1/16 \text{ LS} - 12 \times 2.44 = 30 \text{ \#}$$

$$6 \text{ transformers} = 120 \text{ \#}$$

$$\text{misc} = 25 \text{ \#}$$

$$406 \text{ \# py 500 \#}$$

$$500 \times 3 \times 12 = 18,000$$

$$\frac{18,000}{18,000} = 1.0$$

$$3 \times 0.25 = 0.75 \text{ considering up lift gny}$$

and base traces this is OK.

Wind

$$8 \times 6 \times 10 = 480$$

$$480 \times 3 \times 12 = 17,280$$

$$\frac{17,280}{17,280} = 0.96 \text{ reg. S.}$$

$$3 \times 0.25 = 0.75 \text{ act S for angles}$$

necessary to change gny

$$5.0 \times 150 \times 12 = 750$$

$$\frac{0.1258}{0.75} = 0.041$$

$$\text{OK. } \frac{18,000}{3}$$



(G) GENERAL BUSINESS

PERMIT ISSUED

Permit No. 1865

APPLICATION FOR PERMIT TO ERECT SIGN OVER PUBLIC SIDEWALK OR STREET

To the INSPECTOR OF BUILDINGS, PORTLAND, ME.

Portland, Maine, October 24 1934

The undersigned hereby applies for a permit to erect the following described sign extending over a public sidewalk or street in accordance with the Building Code of the City of Portland, and the following specifications:

Location 338 Congress Street Ward C Within Fire Limits? Yes Dist. No. 1

Owner of building to which sign is to be attached Lafayette Hotel

Name and address of owner of sign Lafayette Hotel, 650 Congress Street

Contractor's name and address Kimball System, 51 Cross Street Telephone 2-5047

When does contractor's bond expire? January 1, 1935

Information Concerning Building

CERTIFICATE OF OCCUPANCY
REQUIREMENT IS WAIVED.

No. stories 7 Material of wall to which sign is to be attached brick

Details of Sign and Connections

Electric? yes Vertical dimension after erection 6' Horizontal 7'10"

Weight 500 lbs., Will there be any hollow spaces? yes Any rigid frame? yes

Material of frame 2x2x1/4" Angle iron No. advertising faces 2 material 240. Galv. metal

No. rigid connections 3 Are they fastened directly to frame of sign? yes

No. through bolts 1 Size 1/2" Location, top or bottom top

No. guys 5 material 2 Rigid 12x12x3/16 -- 3 3/8" Cable Size

Minimum clear height above sidewalk or street 21'

Maximum projection into street 3'

NOV 28

Wm. G. Sanborn

Signature of contractor The Kimball System of Portland

Fee \$ 1.00

INSPECTION COPY

2-11-35 OF FIRE DEPT.

R. F. Carlucci

35023

Permit No. 34/1865

638 Canyon St.

On Lafayette Hotel

Date of permit 11/9/34

Signature tractor

Final Inspn. 2/25/35 C.C.B.

NOTES

11/9/34 - Shop OK. wires
Electrical OK

2/23/35: Clerk said
through bolts used
but could not be
seen now as they
are covered.

CITY OF PORTLAND, MAINE
ELEVATOR INSPECTION

Bldg. No. 44 Block B Sheet 2 of 3

Location of Bldg. 638 CONG. ST.

Owner JAMES CUNNINGHAM DENISSE

Occupant LAFFAYETTE HOTEL

Inspection by A. K. BITH Date 3-12-34

Formal Complaint No. _____ Date _____

Letter sent without complaint _____

Building Data

Mat'l outside walls BRICK Int. Frame STEEL

No. stories 7 Style of Roof FLAT

No. elev. in bldg., Passenger 2 Freight 1

Location of Elevator on Street Floor

ELEVATOR

Shown Below

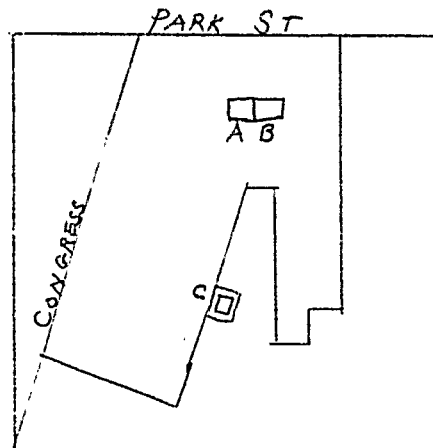

St. Ave.

This report for 1 identical elevators

Elev. Man'f'r. PAYNE

Use of elev., Pass. ☒ Frt. ☐ Comb'n. ☐ (check which)

No. stops 7 Bmt. 1, 2, 3, 4, 5, 6, 7, 8, 9, 10, 11, 12

Shaftway

Open? ☒ Hatch doors, Auto. ☐ Non-auto ☐

Gates, Auto. ☐ Semi-auto. ☐ Hand ☒

Enclosed? ☒ Mat'l. of enclosure MASONRY

Fire Doors ☒ Normally closed ☒ open ☐

Are enclosure doors interlocked? ☐

Height enclosure, full story ☒ what ht. ☐

Elevator Machinery

Type of Power ELEC.

Type of Machine WORM-GEARED TRACTAN

Location of Machine PENTHOUSE

Material of Supports STEEL of Guides STEEL

Material of cables STEEL

No. cables, hoisting 4 counterweight 4

Type of brakes ELEC.

Has elev. following safeties: Governor ☒

Car Safety ☒ Elect. Brakes ☒ Auto. Terminal Stops top & bottom ☒ Slack Cable

Stops ☒ Safety Floor Stops ☒

Remarks: (note defects, if any) _____

Elevator Car

Platform Dimensions 6'x6' Capacity 2500

Mat'l. of Encl. STEEL No. sides encl. 3

Height of enclosure ☒ No. entrances 1

Type of gates or doors HAND

Are they interlocked? ☐

Have they auto-closing device? ☐

Type operation, Push-Button ☐ Operator HAND

Any emergency exit? ☒

Remarks: (note defects, if any) _____

CITY OF PORTLAND, MAINE
ELEVATOR INSPECTION

Bldg. No. 44 Block B Sheet 1 of 2
Location of Bldg. 638 CONG. ST
Owner JAMES CUNNINGHAM DEBISORS
Occupant LAFFAYETTE HOTEL
Inspection by A. KEITH Date 9-12-34
Formal Complaint No. _____ Date _____
Letter sent without complaint _____

Building Data

Mat'l outside walls BRICK Int. Frame STEEL
No. stories 7 Style of Roof FLAT
No. elev. in bldg. Passenger 2 Freight 1

Location of Elevator on Street Floor

ELEVATOR Shown Below
C PARK ST

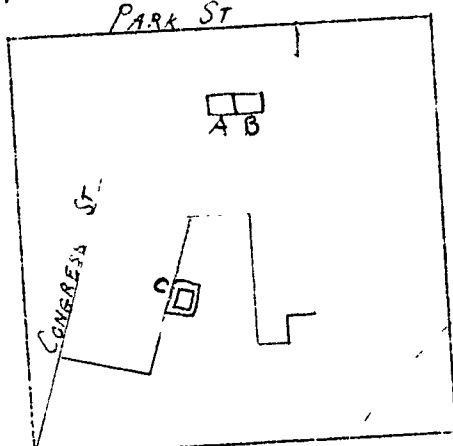

St. Ave.

This report for 1 identical elevators

Elev. No. PAYNE (check)
Use of elev., Pass. — Frt. ✓ Comb'n. — which)
No. stops 7 ~~Bottom, 1, 2, 3, 4, 5, 6, 7, 8, 9, 10, 11, 12~~

Shaftway

Open? ✓ Hatch doors, Autc. — Non-auto —
Gates, auto. — Semi-auto. — Hand ✓
Enclosed? ✓ Mat'l. of enclosure STEEL WRE
Fire Doors — Normally closed — open —
Are enclosure doors interlocked? ✓
Height enclosure, full story ✓ what ht. —

Elevator Machinery

Type of Power ELEC
Type of Machine WORM-GEARED
Location of Machine PENTHOUSE
Material of Supports STEEL Guides STEEL
Material of cables STEEL
No. cables, consisting 2 counterweight 2
Type of brakes ELEC
Has elev. following safeties: Governor —
Car Safety ✓; Elect. Brakes ✓; Autc. Per-
minal Stops top & bottom ✓; Slack Cable
Stops ✓; Safety Floor Stops ✓
Remarks: (note defects, if any) _____

Elevator Car

Platform Dimensions 5' x 6' Capacity —
Mat'l. of Encl. STEEL No. sides encl. 3
Height of enclosure ✓ No. entrances 1
Type of gates or doors HAND
Are they interlocked? ✓
Have they auto-closing device? —
Type operation, Push-Button ✓ Operator —
Any emergency exit? ✓
Remarks: (note defects, if any) _____

General Remarks:

CITY OF PORTLAND, MAINE
ELEVATOR INSPECTION

Bldg. No. 44 Block B Sheet 1 of 3

Location of Bldg. 638 CONG. ST.

Owner JAMES CUNNINGHAM DEBLESAS

Occupant LAFFAYETTE HOTEL

Inspection by A. KEITH Date 3-12-34

Formal Complaint No. _____ Date _____

Letter sent without complaint _____

Building Data

Mat'l outside walls BRICK Int. Frame STEEL

No. stories 7 Style of Roof FLAT

No. elev. in bldg., Passenger 2 Freight 1

Location of Elevator on Street Floor

ELEVATOR

Shown Below

PARK ST

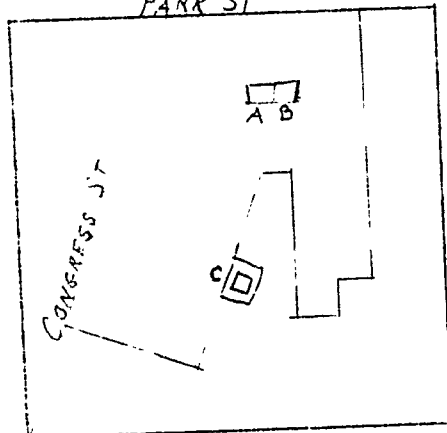

St. Ave.

This report for 1 identical elevators

Elev. Man'f'r. PAYNE (check)

Use of elev., Pass. — Frt. — Comb'n. ✓ which

No. stops 8 Bsat. 1, 2, 3, 4, 5, 6, 7, 8, 9, 10, 11, 12

Shaftway

Open? ✓ Hatch doors, Autc. — Non-autc. —

Gates, auto. — Semi-auto. — Hand ✓

Enclosed? ✓ Mat'l. of enclosure MASONRY

Fire Doors ✓ Normally closed ✓ open —

Are enclosure doors interlocked? —

Height enclosure, full story ✓ what ht. —

Elevator Machinery

Type of Power ELEC.

Type of Machine WORM-GEARED TRACTION

Location of Machine PENTHOUSE

Material of Supports STEEL of Guides STEEL

Material of cables STEEL

No. cables, hoisting 4 counterweight 4

Type of brakes ELEC.

Has elev. following safeties: Governor ✓

Car Safety ✓; Elect. Brakes ✓; Autc. Per-

sonal stops top & bottom ✓; Slack Cable

Stops ✓; Safety Floor Stops ✓

Remarks: (note defects, if any) _____

Elevator Car

Platform Dimensions 6' X 6' Capacity 2500

Mat'l. of Encl. STEEL No. sides encl. 2

Height of enclosure ✓ No. entrances 2

Type of gates or doors HAND

Are they interlocked? —

Have they auto-closing device? —

Type operation, Push-Button — Operator HAND

Any emergency exit? ✓

Remarks: (note defects, if any) _____

General Remarks: _____



(G) GENERAL BUSINESS ZONE **PERMIT ISSUED**
APPLICATION FOR PERMIT 1878

Class of Building or Type of Structure Refrigeration DEC 10 1933

Portland, Maine, December 18, 1933

To the INSPECTOR OF BUILDINGS, PORTLAND, ME.

The undersigned hereby applies for a permit to erect ~~alter~~ install the following building structure equipment in accordance with the Laws of the State of Maine, the Building Code of the City of Portland, plans and specifications, if any, submitted herewith and the following specifications:

Location 852A Congress Street Ward 6 Within Fire Limits? yes Dist. No. 1
Owner's or lessee's name and address Marie Saunders Candy Kitchen 852A Congress St. Telephone _____
Contractor's name and address Frigidaire Sales Corp. of N. E. 188 State St. Telephone 3-5607
Architect's name and address _____
Proposed use of building Hotel and stores No. families _____
Other buildings on same lot _____
Plans filed as part of this application? yes No. of sheets 1
Estimated cost \$ 300. Fee \$.75

Description of Present Building to be Altered

Material brick No. stories _____ Heat _____ Style of roof _____ Roofing _____
Last use Hotel and stores No. families _____

General Description of New Work

To install refrigeration system

NOTIFICATION BEFORE LATHING
OR CLOSING-IN IS WAIVED

CERTIFICATE OF OCCUPANCY
REQUIREMENT IS WAIVED

It is understood that this permit does not include installation of heating apparatus which is to be taken out separately by and in the name of the heating contractor.

Details of New Work

Height average grade to top of plate _____
Size, front _____ depth _____ No. stories _____ Height average grade to highest point of roof _____
To be erected on solid or filled land? _____ earth or rock? _____
Material of foundation _____ Thickness, top _____ bottom _____
Material of underpinning _____ Height _____ Thickness _____
Kind of Roof _____ Rise per foot _____ Roof covering _____
No. of chimneys _____ Material of chimneys _____ of lining _____
Kind of heat _____ Type of fuel _____ Is gas fitting involved? _____
Corner posts _____ Sills _____ Girt or ledger board? _____ Size _____
Material columns under girders _____ Size _____ Max. on centers _____
Studs (outside walls and carrying partitions) 2x4-16" O. C. Girders 6x8 or larger. Bridging in every floor and flat roof span over 8 feet. Sills and corner posts all one piece in cross section.
Joists and rafters: 1st floor _____, 2nd _____, 3rd _____, roof _____
On centers: 1st floor _____, 2nd _____, 3rd _____, roof _____
Maximum span: 1st floor _____, 2nd _____, 3rd _____, roof _____
If one story building with masonry walls, thickness of walls? _____ height? _____

If a Garage

No. cars now accommodated on same lot _____, to be accommodated _____
Total number commercial cars to be accommodated _____
Will automobile repairing be done other than minor repairs to cars habitually stored in the proposed building? _____

Miscellaneous

Will above work require removal or disturbing of any shade tree on a public street? no
Will there be in charge of the above work a person competent to see that the State and City requirements pertaining thereto are observed? yes
By Marie Saunders Candy Kitchen
By Frigidaire Sales Corp. of N.E.

INSPECTION COPY Oliver T. Sanborn By B. Baldwin
CHIEF OF FIRE DEPT.

12303

Ward 6 Permit No. 33/1878
Location 652A Congress St.
Owner Maia Saunders Candy
Date of permit 12/19/33
Notif. closing-in _____
Inspn. closing-in _____
Final Notif. _____
Final Inspn. 12/19/33
Cert. of Occupancy issued None

NOTES
12/19/33 - P17 - agl

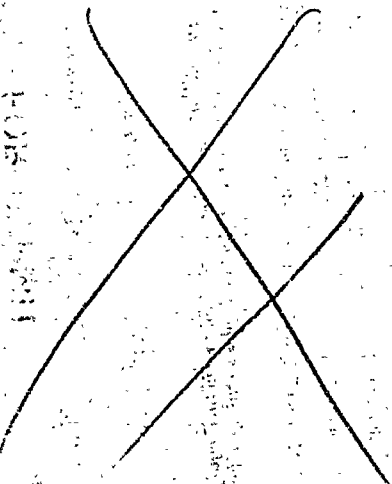



(7) GENERAL BUSINESS PERMIT ISSUED
APPLICATION FOR PERMIT

Class of Building or Type of Structure Second Class

Portland, Maine, June 27, 1933

To the INSPECTOR OF BUILDINGS, PORTLAND, ME.

The undersigned hereby applies for a permit to ~~erect~~ install the following building structure equipment in accordance with the Laws of the State of Maine, the Building Code of the City of Portland, plans and specifications, if any, submitted herewith and the following specifications:

Location 638 Congress Street Ward 6 Within Fire Limits? yes Dist. No. 1
Owner's or Lessee's name and address Lafayette Hotel, 638 Congress St. Telephone 3-5607
Contractor's name and address Frigidaire Sales Corp. of N.E. 188 State St. Telephone 3-5607
Architect's name and address _____ No. families _____
Proposed use of building Hotel and stores
Other buildings on same lot _____ No. of sheets _____
Plans filed as part of this application? _____ Fee \$.75
Estimated cost \$ 400.

Description of Present Building to be Altered

Material brick No. stories 7 Heat _____ Style of roof _____ Roofing _____
Last use Hotel and stores No. families _____

General Description of New Work

To install refrigeration equipment in one story wing

NOTIFICATION BEFORE LATHING
OR CLASING-IN IS WAIVED.
CERTIFICATE OF OCCUPANCY
REQUIREMENT IS WAIVED.

It is understood that this permit does not include installation of heating apparatus which is to be taken care of separately by and in the name of the heating contractor.

Details of New Work

Size, front _____ depth _____ No. stories _____ Height average grade to top of plate _____
To be erected on solid or filled land? _____ earth or rock? _____
Material of foundation _____ Thickness, top _____ bottom _____
Material of underpinning _____ Height _____ Thickness _____
Kind of Roof _____ Rise per foot _____ Roof covering _____ of lining _____
No. of chimneys _____ Material of chimneys _____ Is gas fitting involved? _____
Kind of heat _____ Type of fuel _____ Size _____
Corner posts _____ Sills _____ Girt or ledger board? _____
Material columns under girders _____ Size _____ Max. on centers _____
Studs (outside walls and carrying partitions) 2x4-16" O. C. Girders 6x8 or larger. Bridging in every floor and flat roof span over 8 feet. Sills and corner posts all one piece in cross section.
Joists and rafters: 1st floor _____, 2nd _____, 3rd _____, roof _____
On centers: 1st floor _____, 2nd _____, 3rd _____, roof _____
Maximum span: 1st floor _____, 2nd _____, 3rd _____, height? _____
If one story building with masonry walls, thickness of walls? _____

If a Garage

No. cars now accommodated on same lot _____, to be accommodated _____
Total number commercial cars to be accommodated _____
Will automobile repairing be done other than minor repairs to cars habitually stored in the proposed building? _____

Miscellaneous

Will above work require removal or disturbing of any shrub or tree on a public street? no
Will there be in charge of the above work a person competent to see that the State and City requirements pertaining thereto are observed? yes

INSPECTION COPY

Oliver T. Sanborn

CHIEF OF FIRE DEPT.

Signature of owner

By

Lafayette Hotel
By Frigidaire Sales Corp. of N.E.

W.B. Baldwin

712

Ward 6 Permit No. 33/844
Location 638 Congress St.
Owner Lafayette Hotel
Date of permit 6/29/33
Notif. closing-in _____
Inspn. closing-in _____
Final Notif. _____
Final Inspn. 9/12/33
Cert. of Occupancy issued None

NOTES
9/12/33-P.I.T.-A.g.

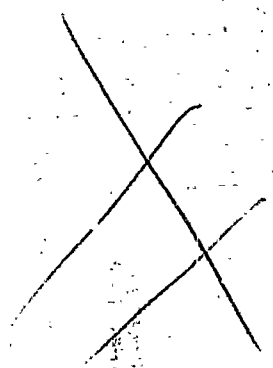

RECEIVED
SEP 14 1933
CITY OF BOSTON

TELEPHONE CONNECTION

THOROUGHNESS AND PROMPTNESS ON ALL WORK

A. J. Bird Company

WOOD - STEEL - CEMENT

Contractors and Builders

52A PORTLAND STREET
PORTLAND, MAINE

GENERAL BUSINESS ZONE

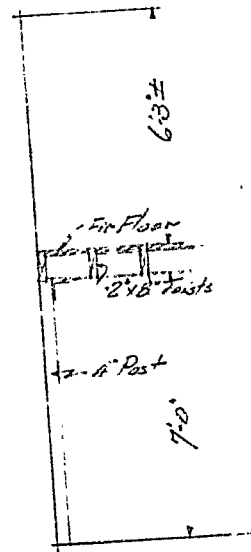
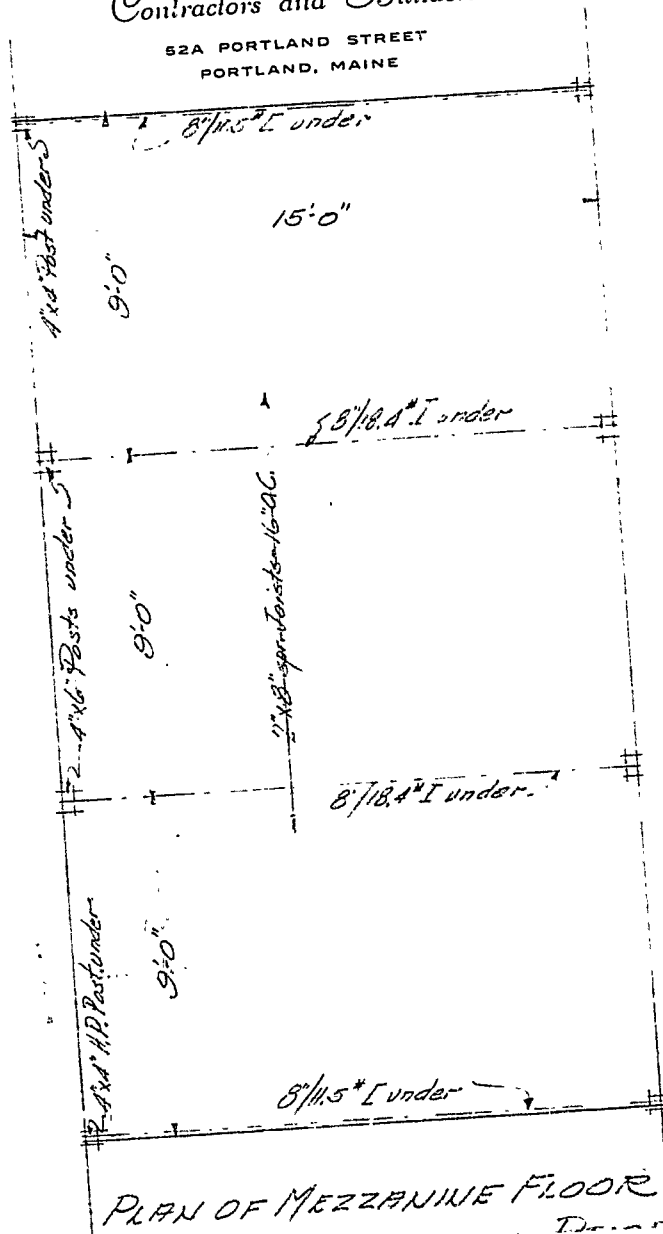

SECTION

PLAN OF MEZZANINE FLOOR

DETAILED SECTION



PERMIT ISSUED
APPLICATION FOR PERMIT

Class of Building or Type of Structure Second Class MAY 29 1933
Portland, Maine, May 29, 1933

To the INSPECTOR OF BUILDINGS, PORTLAND, ME.

The undersigned hereby applies for a permit to erect alter install the following building structure equipment in accordance with the Laws of the State of Maine, the Building Code of the City of Portland, plans and specifications, if any, submitted herewith and the following specifications:

Location 652 Congress Street Ward 6 Within Fire Limits? yes Dist. No. 1
Owner's or Lessee's name and address E. E. Blanchard Electric Co. Telephone F 5230
Contractor's name and address A. J. Bird Co., 524 Portland Street Telephone F 5230
Architect's name and address _____ No. families _____
Proposed use of building Hotel and stores
Other buildings on same lot _____
Plans filed as part of this application? yes No. of sheets 1
Estimated cost \$ 150. Fee \$.75

Description of Present Building to be Altered

Material brick No. stories 7 Heat _____ Style of roof _____ Roofing _____
Last use Hotel and stores No. families _____

General Description of New Work

To construct mezzanine floor 15' x 27 in store as per plan

CERTIFICATE OF OCCUPANCY
REQUIREMENT IS WAIVED.

It is understood that this permit does not include installation of heating apparatus which is to be taken out separately by and in the name of the heating contractor.

Details of New Work

Size, front _____ depth _____ No. stories _____ Height average grade to top of plate _____
To be erected on solid or filled land? _____ earth or rock? _____
Material of foundation _____ Thickness, top _____ bottom _____
Material of underpinning _____ Height _____ Thickness _____
Kind of Roof _____ Rise per foot _____ Roof covering _____ of lining _____
No. of chimneys _____ Material of chimneys _____ Is gas fitting involved? _____
Kind of heat _____ Type of fuel _____ Size _____
Corner posts _____ Sills _____ Girt or ledger board? _____
Material columns under girders _____ Size _____ Max. on centers _____
Studs (outside walls and carrying partitions) 2x4-16" O. C. Girders 6x8 or larger. Bridging in every floor and flat roof span over 8 feet. Sills and corner posts all one piece in cross section.
Joists and rafters: 1st floor _____, 2nd _____, 3rd _____, roof _____
On centers: 1st floor _____, 2nd _____, 3rd _____, roof _____
Maximum span: 1st floor _____, 2nd _____, 3rd _____, height? _____
If one story building with masonry walls, thickness of walls? _____

If a Garage

No. cars now accommodated on same lot _____, to be accommodated _____
Total number commercial cars to be accommodated _____
Will automobile repairing be done other than minor repairs to cars habitually stored in the proposed building? _____

Miscellaneous

Will above work require removal or disturbing of any shade tree on a public street? no
Will there be in charge of the above work a person competent to see that the State and City requirements pertaining thereto are observed? yes
By A. J. Bird Co.
Signature of owner A. J. Bird

INSPECTION COPY

9885A

Ward ³ 6 Permit No. 33/643
Local 6522 Congress St
Owner H. N. Blanchard Elec.
Date of permit 5/29/33
Notif. closing-in _____
Inspn Aug-33 _____
Final Notif. _____
Final Inspn. 6/3/33 _____
Cert. of Occupancy issued None

NOTES
6/3/33 - Work com-
pleted - A. J. S.

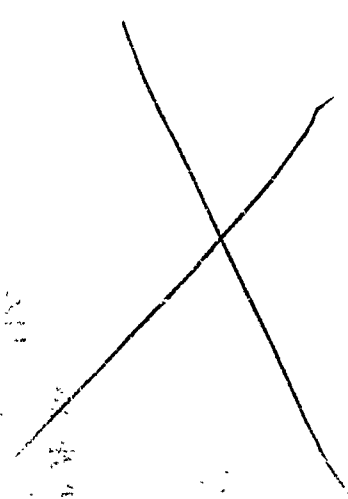



APPLICATION FOR PERMIT

Permit No. 1129
AUG 9 1932Class of Building or Type of Structure RefrigerationPortland, Maine, July 27, 1932

To the INSPECTOR OF BUILDINGS, PORTLAND, ME.

The undersigned hereby applies for a permit to ~~erect~~ install the following ~~building structure~~ equipment in accordance with the Laws of the State of Maine, the Building Code of the City of Portland, plans and specifications, if any, submitted herewith and the following specifications:

Location 628 Congress Street Ward 6 Within Fire Limits? yes Dist. No. 1Owner's or Lessee's name and address Lafayette Hotel Telephone _____Contractor's name and address Frigidaire Sales Corp. of N.E. 186 State St. Telephone F 4498

Architect's name and address _____

Proposed use of building Hotel and stores No. families _____

Other buildings on same lot _____

Plans filed as part of this application? yes No. of sheets 1Estimated cost \$ 1800 Fee \$ 2.75

Description of Present Building to be Altered

Material _____ No. stories _____ Heat _____ Style of roof _____ Roofing _____

Last use _____ No. families _____

General Description of New Work

To install refrigeration equipment

NOTIFICATION BEFORE LATHING
OR CLOSING-IN IS WAIVED.
CERTIFICATE OF OCCUPANCY
REQUIREMENT IS WAIVED.

It is understood that this permit does not include installation of heating apparatus which is to be taken out separately by and in the name of the heating contractor.

Details of New Work

Size, front _____ depth _____ No. stories _____ Height average grade to top of plate _____
Height average grade to highest point of roof _____

To be erected on solid or filled land? _____ earth or rock? _____

Material of foundation _____ Thickness, top _____ bottom _____

Material of underpinning _____ Height _____ Thickness _____

Kind of Roof _____ Rise per foot _____ Roof covering _____

No. of chimneys _____ Material of chimneys _____ of lining _____

Kind of heat _____ Type of fuel _____ Is gas fitting involved? _____

Corner posts _____ Sills _____ Girt or ledger board? _____ Size _____

Material columns under girders _____ Size _____ Max. on centers _____

Studs (outside walls and carrying partitions) 2x4-16" O. C. Girders 6x8 or larger. Bridging in every floor and flat roof span over 8 feet. Sills and corner posts all one piece in cross section.

Joists and rafters: 1st floor _____, 2nd _____, 3rd _____, roof _____

On centers: 1st floor _____, 2nd _____, 3rd _____, roof _____

Maximum span: 1st floor _____, 2nd _____, 3rd _____, roof _____

If one story building with masonry walls, thickness of walls? _____ height? _____

If a Garage

No. cars now accommodated on same lot _____, to be accommodated _____

Total number commercial cars to be accommodated _____

Will automobile repairing be done other than minor repairs to cars habitually stored in the proposed building? _____

Miscellaneous

Will above work require removal or disturbing of any shade tree on a public street? no

Will there be in charge of the above work a person competent to see that the State and City requirements pertaining thereto are observed? yes

APPROVED

INSPECTION COPY

Signature of owner

By Lafayette Hotel
Frigidaire Sales Corp. of N. E.

By

W B Baldwin

7909A

3) GENERAL ELEVATION



Side Elev.

640 Congress St.

Front Elev

8 ft

BARBER SHOP

Side wall

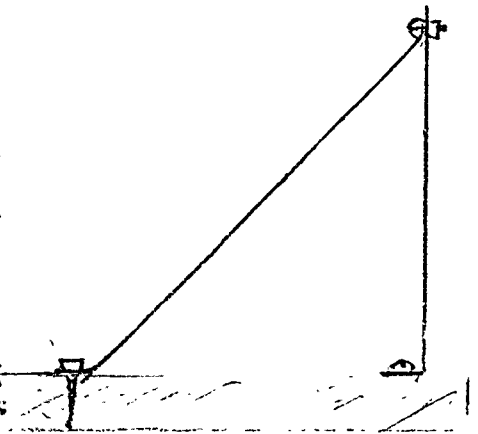

Vertical 24"
Horizontal 15" weight 6 lbs.

owner of sign Hortense J. Adams
Building Lafayette Hotel

(G) GENERAL BUSINESS ZONE PERMIT ISSUED
Permit No. 0784



APPLICATION FOR PERMIT TO ERECT SIGN OVER PUBLIC SIDEWALK OR STREET

Portland, Maine, June 8, 1935 19

To the INSPECTOR OF BUILDINGS, PORTLAND, ME.

The undersigned hereby applies for a permit to erect the following described sign extending over a public sidewalk or street in accordance with the Building Code of the City of Portland, and the following specifications:

Location 640 Congress St. Ward 3 Within Fire Limits? yes Dist. No. 1
Owner of building to which sign is to be attached Lafayette Hotel 640 Congress St.
Name and address of owner of sign Hortense L. Adams 641 Congress St. Telephone 8833
Contractor's name and address Flynn The Painter 245 Middle St.
When does contractor's bond expire? May 1938

Information Concerning Building

No. stories 8 Material of wall to which sign is to be attached brick

Details of Sign and Connections

Electric? no Vertical dimension after erection 24" Horizontal 16"
Weight 8 lbs., Will there be any hollow spaces? no Any rigid frame? yes
Material of frame galvanized iron No. advertising faces 2, material iron
No. rigid connections 2 Are they fastened directly to frame of sign? yes
No. through bolts no, Size ---, Location, top or bottom ---
No. guys 1, material iron, Size 1/8th"
Minimum clear height above sidewalk or street 8'
Maximum projection into street ---

CERTIFICATE OF OCCUPANCY
REQUIREMENT IS WAIVED

APPROVED

Signature of contractor

Flynn The Painter
E. J. Peewee

INSPECTION COPY

Oliver L. Sanderson

CHIEF OF FIRE DEPT.

Ward 6 Permit No. 32/7.84
Location: 640 Chicago St
Owner: Hartness J Adams
Date of permit 6/7/32
Sign Contractor W. J. Adams
Final Inspn: 6/16/32

~~OVER PUBLIC SIDEWALK OR STREET
APPLICATION FOR PERMIT TO ERECT SIGN~~

NOTES

~~1. The applicant must obtain a copy of the City of Chicago's Ordinance No. 478, which relates to the erection of signs on public property.~~

Instructions Concerning Erection

Details of Sign and Connections

Location of Sign

Height of Sign

Width of Sign

Color of Sign

Material of Sign

Foundation of Sign

Lighting of Sign

Signage

Signage

Signage

Signage

Signage

Signage

Signage



(C) GENERAL BUSINESS ZONE

PERMIT 0822

APPLICATION FOR PERMIT

JUN 14 1922

Class of Building or Type of Structure Second Class

Portland, Maine. June 14, 1922

To the INSPECTOR OF BUILDINGS, PORTLAND, ME.

The undersigned hereby applies for a permit to ~~erect~~ alter install the following building structure equipment in accordance with the Laws of the State of Maine, the Building Code of the City of Portland, plans and specifications, if any, submitted herewith and the following specifications:

Location 628 Congress Street Ward 6 Within Fire Limits? yes Dist. No. 1
Owner's or Lessee's name and address Lafayette Hotel, 628 Congress St. Telephone 5280
Contractor's name and address F. H. Cunningham & Sons, 181 State St Telephone F 6180
Architect's name and address _____
Proposed use of building Hotel and stores No. families _____
Other buildings on same lot _____
Plans filed as part of this application? yes No. of sheets 1
Estimated cost \$ 500. Fee \$.75

Description of Present Building to be Altered

Material brick No. stories 6 Heat _____ Style of roof _____ Roofing _____
Last use Hotel and stores No. families _____

General Description of New Work

To erect one story metal addition 10'6" x 15' on rear of building for refrigerator
(angle iron frame)
To cut in new door between main building and new addition

It is understood that this permit does not include installation of heating apparatus which is to be taken out separately by and in the name of the heating contractor.

Details of New Work

Height average grade to top of plate _____
Size, front _____ depth _____ No. stories _____ Height average grade to highest point of roof 14'
To be erected on solid or filled land? solid earth or rock? earth
Material of foundation concrete wall Thickness, top _____ bottom _____
Material of underpinning _____ Height _____ Thickness _____
Kind of Roof flat Rise per foot 2" 1 1/2" Roof covering metal
No. of chimneys no Material of chimneys _____ of lining _____
Kind of heat _____ Type of fuel _____ Is gas fitting involved? _____
Corner posts _____ Sills _____ Girt or ledger board? _____ Size _____
Material columns under girders _____ Size _____ Max. on centers _____
Studs (outside walls and carrying partitions) 2x4-16" O. C. Girders 6x8 or larger. Bridging in every floor and flat roof span over 8 feet. Sills and corner posts all one piece in cross section.
Joists and rafters: 1st floor concrete, 2nd _____, 3rd _____, roof metal
On centers: 1st floor _____, 2nd _____, 3rd _____, roof _____
Maximum span: 1st floor _____, 2nd _____, 3rd _____, roof _____
If one story building with masonry walls, thickness of walls? _____ height? _____

If a Garage

No. cars now accommodated on same lot _____, to be accommodated _____
Total number commercial cars to be accommodated _____
Will automobile repairing be done other than minor repairs to cars habitually stored in the proposed building? _____

Miscellaneous

Will above work require removal or disturbing of any shade tree on a public street? no
Will there be in charge of the above work a person competent to see that the State and City requirements pertaining thereto are observed? yes

Lafayette Hotel
By F. H. Cunningham & SonsSignature of owner F. H. Cunningham

INSPECTION COPY

Ward 6 Permit No. 32/822

Location 638 Congress St.

0 Lafayette Hotel

Date of permit 6/14/32

Notif. closing-in

In ng-in

Final Notif.

Final Inspn. 6/30/32

Cert. of Occupancy issued None

NOTES

6/22/32 - Metal Build-
ing not yet up
6/30/32 - Work on
metal housing
nearly complete



(3) GENERAL BUSINESS ZONE

APPLICATION FOR PERMIT

PERMIT ISSUED

0816

JUN 14 1932

Class of Building or Type of Structure Second Class

Portland, Maine, June 14, 1932

To the INSPECTOR OF BUILDINGS, PORTLAND, ME.

The undersigned hereby applies for a permit to ~~erect~~ alter install the following building structure equipment in accordance with the Laws of the State of Maine, the Building Code of the City of Portland, plans and specifications, if any, submitted herewith and the following specifications:

Location 638 Congress Street Ward 6 Within Fire Limits? yes Dist. No. 1
Owner's or Lessee's name and address Lafayette Hotel, 638 Congress St. Telephone _____
Contractor's name and address F. W. Cunningham & Sons, 181 State Street Telephone F 5380
Architect's name and address _____
Proposed use of building Hotel and stores No. families _____
Other buildings on same lot _____
Plans filed as part of this application? no No. of sheets _____
Estimated cost \$ 450. Fee \$.75

Description of Present Building to be Altered

Material brick No. stories 6 Heat _____ Style of roof _____ Roofing _____
Last use Hotel and stores No. families _____

General Description of New Work

To provide metal lath and plaster front for elevator enclosure, first floor, with hollow metal doors

CERTIFICATE OF OCCUPANCY
REQUIREMENT IS WAIVED

It is understood that this permit does not include installation of heating apparatus which is to be taken out separately by and in the name of the heating contractor.

Details of New Work

Size, front _____ depth _____ No. stories _____ Height average grade to top of plate _____
To be erected on solid or filled land? _____ Height average grade to highest point of roof _____
Material of foundation _____ Thickness, top _____ bottom _____
Material of underpinning _____ Height _____ Thickness _____
Kind of Roof _____ Rise per foot _____ Roof covering _____
No. of chimneys _____ Material of chimneys _____ of lining _____
Kind of heat _____ Type of fuel _____ Is gas fitting involved? _____
Corner posts _____ Sills _____ Dirt or ledger board? _____ Size _____
Material columns under girders _____ Size _____ Max. on centers _____
Studs (outside walls and carrying partition) 2x4 16" O. C. Girders 6x8 or larger. Bridging in every floor and flat roof span over 8 feet. Sills and corner posts all one piece in cross section.
Joists and rafters: 1st floor _____, 2nd _____, 3rd _____, roof _____
On centers: 1st floor _____, 2nd _____, 3rd _____, roof _____
Maximum span: 1st floor _____, 2nd _____, 3rd _____, roof _____
If one story building with masonry walls, thickness of walls? _____ height? _____

If a Garage

No. cars now accommodated on same lot _____, to be accommodated _____
Total number commercial cars to be accommodated _____
Will automobile repairing be done other than minor repairs to cars habitually stored in the proposed building? _____

Miscellaneous

Will above work require removal or disturbing of any shade tree on a public street? no
Will there be in charge of the above work a person competent to see that the State and City requirements pertaining thereto are observed? yes

INSPECTION COPY

Signature of owner By F. W. Cunningham & Sons

By J. J. Connolly

7626A