

33-17 PLEASANT STREET

19

SHAW-WALBER

Full cut # 920R - Half cut # 9202R - Third cut # 9203R - Fifth cut # 9205R

PERMIT TO INSTALL PLUMBING

PERMIT NUMBER **2019**

Date Issued **1-15-80**
 Portland Plumbing Inspector

By **ERNOLD RSGOODWIN**

App. First Insp.
 Date
 By

App. Final Insp.
 Date

By

Type of Bldg.

- Commercial
- Residential
- Single
- Multi Family
- New Construction
- Remodeling

Address **15 Pleasant Street**
 Installation For: **Multiple**
 Owner of Bldg: **F. T. Brown**
 Owner's Address: **same**
 Plumber: **Rouben Katz - 173 Neal St.**
 Date: **1-15-80**

NEW	REPL		NO.	FEE
	2	SINKS		
	x	LAVATORIES	2	4.00
	x	TOILETS	2	4.00
	x	BATH TUBS	2	4.00
		SHOWERS	2	4.00
		DRAINS FLOOR SURFACE		
		HOT WATER TANKS		
		TANKLESS WATER HEATERS		
		GARBAGE DISPOSALS		
		SEPTIC TANKS		
		HOUSE SEWERS		
		ROOF LEADERS		
		AUTOMATIC WASHERS		
		DISHWASHERS		
		OTHER		
			300	
			19.00	
			TOTAL 8	16.00

Building and Inspection Services Dept.; Plumbing Inspection



APPLICATION FOR PERMIT

DEPARTMENT OF BUILDING INSPECTIONS SERVICES

ELECTRICAL INSTALLATIONS

Date Sept. 8, 19 80
 Receipt and Permit number A 51675

To the CHIEF ELECTRICAL INSPECTOR, Portland, Maine:

The undersigned hereby applies for a permit to make electrical installations in accordance with the laws of Maine, the Portland Electrical Ordinance, the National Electrical Code and the following specifications:

LOCATION OF WORK: 15B Pleasant St.
 OWNER'S NAME: Edward Brown ADDRESS: same

OUTLETS: FEES

Receptacles _____ Switches _____ Plugmold _____ ft. TOTAL _____

FIXTURES: (number of)

Incandescent _____ Flourescent _____ (not strip) TOTAL _____

Strip Flourescent _____ ft. _____

SERVICES:

Overhead _____ Underground _____ Temporary _____ TOTAL amperes _____

METERS: (number of) _____

MOTORS: (number of)

Fractional _____

1 HP or over _____

RESIDENTIAL HEATING:

Oil or Gas (number of units) _____

Electric (number of rooms) _____

COMMERCIAL OR INDUSTRIAL HEATING:

Oil or Gas (by a main boiler) X 3.00

Oil or Gas (by separate units) _____

Electric Under 20 kws _____ Over 20 kws _____

APPLIANCES: (number of)

Ranges _____ Water Heaters _____

Cook Tops _____ Disposals _____

Wall Ovens _____ Dishwashers _____

Dryers _____ Compactors _____

Fans _____ Others (denote) _____

TOTAL _____

MISCELLANEOUS: (number of)

Branch Panels _____

Transformers _____

Air Conditioners Central Unit _____

Separate Units (windows) _____

Signs 20 sq. ft. and under _____

Over 20 sq. ft. _____

Swimming Pools Above Ground _____

In Ground _____

Fire/Burglar Alarms Residential _____

Commercial _____

Heavy Duty Outlets, 220 Volt (such as welders) 30 amps and under _____

over 30 amps _____

Circus, Fairs, etc. _____

Alterations to wires _____

Repairs after fire _____

Emergency Lights, battery _____

Emergency Generators _____

INSTALLATION FEE DUE: _____

FOR ADDITIONAL WORK NOT ON ORIGINAL PERMIT DOUBLE FEE DUE: _____

FOR REMOVAL OF A "STOP ORDER" (304-16.b) _____

TOTAL AMOUNT DUE: 3.00

INSPECTION:

Will be ready on ready, 19 80; or Will Call _____

CONTRACTOR'S NAME: Jims Plumbing & Heating

ADDRESS: 179 Marrett St. Westbrook

TEL.: _____

MASTER LICENSE NO.: 1458 SIGNATURE OF CONTRACTOR: _____

LIMITED LICENSE NO.: _____

INSPECTOR'S COPY — WHITE

OFFICE COPY — CANARY

CONTRACTOR'S COPY — GREEN



FILL IN AND SIGN WITH INK

00 714

PERMIT ISSUED

APPLICATION FOR PERMIT FOR HEATING, COOKING OR POWER EQUIPMENT

SEP 9 1980

Portland, Maine, Sept. 8, 1980

CITY of PORTLAND

To the INSPECTOR OF BUILDINGS, PORTLAND, ME.

The undersigned hereby applies for a permit to install the following heating, cooking or power equipment in accordance with the Laws of Maine, the Building Code of the City of Portland, and the following specifications:

Location **15 B. Pleasant St.** Use of Building **multi family** No. Stories **3** New Building Existing "
 Name and address of owner of appliance **Edward Brown - same**
 Installer's name and address **Jims Plumbing & Heating - 179 Marrett St. Westbrook** Telephone
 General Description of Work
 To install **gas conversion burner - replacing oil**

IF HEATER, OR POWER BOILER

Location of appliance **basement** Any burnable material in floor surface or beneath? **no**
 If so, how protected? Kind of fuel? **gas**
 Minimum distance to burnable material, from top of appliance or casing top of furnace
 From top of smoke pipe From front of appliance From sides or back of appliance
 Size of chimney flue Other connections to same flue
 If gas fired, how vented? **thur chimney** Rated maximum demand per hour **380,000 BTUS PER HOUR**
 Will sufficient fresh air be supplied to the appliance to insure proper and safe combustion?

IF OIL BURNER

Name and type of burner Labelled by underwriters' laboratories?
 Will operator be always in attendance? Does oil supply line feed from top or bottom of tank?
 Type of floor beneath burner Size of vent pipe
 Location of oil storage Number and capacity of tanks
 Low water shut off Make No.
 Will all tanks be more than five feet from any flame? How many tanks enclosed?
 Total capacity of any existing storage tanks for furnace burners

IF COOKING APPLIANCE

Location of appliance Any burnable material in floor surface or beneath?
 If so, how protected? Height of Legs, if any
 Skirting at bottom of appliance? Distance to combustible material from top of appliance?
 From front of appliance From sides and back From top of smokepipe
 Size of chimney flue Other connections to same flue
 Is hood to be provided? If so, how vented? Forced or gravity?
 If gas fired, how vented? Rated maximum demand per hour

MISCELLANEOUS EQUIPMENT OR SPECIAL INFORMATION

Amount of fee enclosed? **5.00**
cost of work 550 5.50

APPROVED:

10.50

Will there be in charge of the above work a person competent to see that the State and City requirements pertaining thereto are observed?

Signature of Installer

2ND ENTRANCE

1513 PLEASANT ST.

AREA 15 X 15 FT. AREA APPROXIMATELY

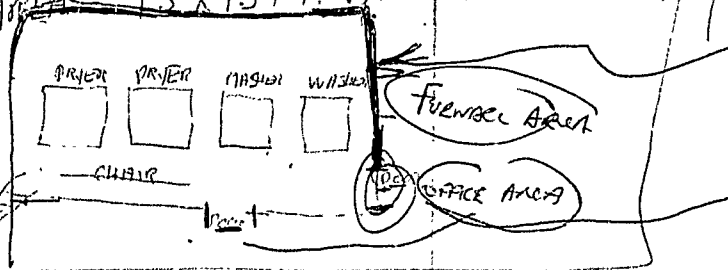

4 1/2" Fire Code
Street code ON BOTH SIDES

1-HR rated door
w/ self-closing device

CEILING

FOR USE MOSTLY FOR TENANTS
THERE ARE 6 CELLARS IN BUILDING

Basement Area

* DOOR AT TOP OF STAIRS RATED
1-HR DOOR

John Flaherty MS 72
next door

RECEIVED
 JUL 29 1980
 DEPT. OF BLDG. INSP.
 CITY OF PORTLAND



APPLICATION FOR PERMIT

PERMIT ISSUED

B.O.C.A. USE GROUP

B.O.C.A. TYPE OF CONSTRUCTION 00 562

JUL 30 1980

ZONING LOCATION PORTLAND, MAINE, July 29, 1980

CITY OF PORTLAND

To the DIRECTOR OF BUILDING & INSPECTION SERVICES, PORTLAND, MAINE

The undersigned hereby applies for a permit to erect, alter, repair, demolish, move or install the following building, structure, equipment or change use in accordance with the Laws of the State of Maine, the Portland B.O.C.A. Building Code and Zoning Ordinance of the City of Portland with plans and specifications, if any, submitted herewith and the following specifications:

LOCATION 15-17 Pleasant Street ... 04101

1. Owner's name and address ... Edward T. Brown - same Apt. 19A ... Fire District #1 , #2 Telephone 773-5191

2. Lessee's name and address Telephone

3. Contractor's name and address ... Ray Moulton - Cape Elizabeth ... Telephone

4. Architect Specifications Plans No. of sheets

Proposed use of building ... apt. bldg. - tenant laundermat No. families

Material No. stories Heat Style of roof Roofing

Other buildings on same lot

Estimated contractual cost \$ Fee \$ 15.00

FIELD INSPECTOR—Mr. GENERAL DESCRIPTION

This application is for: @ 775-5451
Dwelling Ext. 234

To change use from multi family to multi family with laundermat in basement, to be used for tenants of dwelling only as per plans. ^{Stamp of Special Conditions} ~~Sheet~~ of plans. 1 sheet

PERMIT ISSUED WITH LETTER

Masonry Bldg.
Metal Bldg.
Alterations
Demolitions
Change of Use
Other

NOTE TO APPLICANT: Separate permits are required by the installers and subcontractors of heating, plumbing, electrical and mechanicals.

PERMIT IS TO BE ISSUED TO 1 2 3 4

Other:

DETAILS OF NEW WORK

Is any plumbing involved in this work? Is any electrical work involved in this work?

Is connection to be made to public sewer? If not, what is proposed for sewage?

Has septic tank notice been sent? Form notice sent?

Height average grade to top of plate Height average grade to highest point of roof

Size, front depth No. stories solid or filled land? earth or rock?

Material of foundation Thickness, top bottom cellar

Kind of roof Rise per foot Roof covering

No. of chimneys Material of chimneys of lining Kind of heat fuel

Framing Lumber—Kind Dressed or full size? Corner posts Sills

Size Girder Columns under girders Size Max. on centers

Studs (outside walls and carrying partitions) 2x4-16" O. C. Bridging in every floor and flat roof span over 8 feet.

Joists and rafters: 1st floor, 2nd, 3rd, roof

On centers: 1st floor, 2nd, 3rd, roof

Maximum span: 1st floor, 2nd, 3rd, roof

If one story building with masonry walls, thickness of walls? height?

IF A GARAGE

No. cars now accommodated on same lot, to be accommodated ... number commercial cars to be accommodated ... Will automobile repairing be done other than minor repairs to cars habitually stored in the proposed building?

APPROVALS BY: DATE

BUILDING INSPECTION—PLAN EXAMINER

ZONING:

BUILDING CODE:

Fire Dept.:

Health Dept.:

Others:

MISCELLANEOUS

Will work require disturbing of any tree on a public street? ..

Will there be in charge of the above work a person competent to see that the State and City requirements pertaining thereto are observed?

Signature of Applicant *Edward T. Brown* Phone # ... same

Type Name of above ... Edward T. Brown ... 1 2 3 4

Other and Address

FIELD INSPECTOR'S COPY

NOTES

8-19-80 Contractor notified me that work has been completed - went to address & couldn't get in - Mr Brown not around.

Still trying to get into basement area - ~~OO~~

2-17-81 Still can't gain access to basement area -

3-11-81 Couldn't get in - called owner for apt tomorrow -

3-13-81 Has 1 hr door labels

At top of stairs -> New layer of Sheet rock on wall - Smoke Detector installed - Furnace room locked but appears has fire doors - NEEDS a closer going to be installed

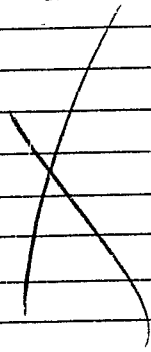

Permit No. 801563
Location 1517 O'Leary St.
Owner Edward J. Brown
Date of permit 9-29-80
Approved 7-31-80 Building Dept



APPLICATION FOR PERMIT

B.O.C.A. USE GROUP

B.O.C.A. TYPE OF CONSTRUCTION

ZONING LOCATION _____ PORTLAND, MAINE, March 12, 1979

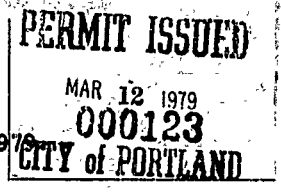

To the DIRECTOR OF BUILDING & INSPECTION SERVICES, PORTLAND, MAINE

The undersigned hereby applies for a permit to erect, alter, repair, demolish, move or install the following building, structure, equipment or change use in accordance with the Laws of the State of Maine, the Portland B.O.C.A. Building Code and Zoning Ordinance of the City of Portland with plans and specifications, if any, submitted herewith and the following specifications:

LOCATION **15-19 Pleasant Street**

1. Owner's name and address **Edward T. Brown - same** Fire District #1 , #2
 Telephone ... **773-5191**

2. Lessee's name and address _____ Telephone ... _____

3. Contractor's name and address **Waning & Son, Inc. - 185 Warren Ave. Westport ME 04082** Telephone ... **854-9338**

4. Architect _____ Specifications _____ Plans _____ No. of sheets _____

Proposed use of building **multi family** No. families _____

Last use **same** No. families _____

Material _____ No. stories _____ Heat _____ Style of roof _____ Roofing _____

Other buildings on same lot _____

Estimated contractual cost \$ **5,000** Fee \$ **20.00**

FIELD INSPECTOR—Mr.

GENERAL DESCRIPTION

This application is for: @ 775-5451
 Dwelling Ext. 234
 Garage
 Masonry Bldg.
 Metal Bldg.
 Alterations
 Demolitions
 Change of Use
 Other **repairs to roof after fire**

Repairs after fire to roof with 2 x 8 timbers, roof to be same as type before fire, flat tar & gravel.
 Stamp of Special Conditions

NOTE TO APPLICANT: Separate permits are required by the installers and subcontractors of heating, plumbing, electrical and mechanicals.

PERMIT IS TO BE ISSUED TO 1 2 3 4

Other:

DETAILS OF NEW WORK

Is any plumbing involved in this work? Is any electrical work involved in this work?

Is connection to be made to public sewer? If not, what is proposed for sewage?

Has septic tank notice been sent? Form notice sent?

Height average grade to top of plate Height average grade to highest point of roof

Size, front depth No. stories solid or filled land? earth or rock?

Material of foundation Thickness, top bottom cellar

Kind of roof Rise per foot Roof covering

No. of chimneys Material of chimneys of lining Kind of heat fuel

Framing Lumber—Kind Dressed or full size? Corner posts Sills

Size Girder Columns under girders Size Max. on centers

Studs (outside walls and carrying partitions) 2x4-16" O. C. Bridging in every floor and flat roof span over 8 feet.

Joists and rafters: 1st floor, 2nd, 3rd, roof

On centers: 1st floor, 2nd, 3rd, roof

Maximum span: 1st floor, 2nd, 3rd, roof

If one story building with masonry walls, thickness of walls? height?

IF A GARAGE

No. cars now accommodated on same lot, to be accommodated ... number commercial cars to be accommodated ...

Will automobile repairing be done other than minor repairs to cars habitually stored in the proposed building?

APPROVALS BY: DATE

BUILDING INSPECTION—PLAN EXAMINER

ZONING:

BUILDING CODE:

Fire Dept.:

Health Dept.:

Others:

MISCELLANEOUS

Will work require disturbing of any tree on a public street? ..

Will there be in charge of the above work a person competent to see that the State and City requirements pertaining thereto are observed?

Signature of Applicant *Charles Spaulding* Phone # **same**

Type Name of above **Waning & Son, Inc.** 1 2 3 4

Other and Address

NOTES

3/22/79 started work
6/17/79 completed

Permit No. 79/123

Location 1519 Pleasant St

Owner Edward T. Brown

Date of permit 3-12-79

Approved

Approved after five
working days of
notification

Large blank lined area for notes, with a large handwritten 'X' or scribble across the middle.



CITY OF PORTLAND, MAINE
Department of Building Inspection

Certificate of Occupancy

LOCATION

15-17 Pleasant Street

Issued to

Edward T. Brown

Date of Issue

April 10, 1980

This is to certify that the building, premises, or part thereof, at the above location, built—altered—changed as to use under Building Permt No. 79/1107, has had final inspection, has been found to conform substantially to requirements of Zoning Ordinance and Building Code of the City, and is hereby approved for occupancy or use, limited or otherwise, as indicated below.

PORTION OF BUILDING OR PREMISES

APPROVED OCCUPANCY

Entire

Apartment Building

Limiting Conditions:

This certificate supersedes
certificate issued

Approved:

4-10-80

(Date)

Inspector

Notice: This certificate identifies lawful use of building or premises, and ought to be transferred from owner to owner when property changes hands. Copy will be furnished to owner or lessee for one dollar.



APPLICATION FOR PERMIT

B.O.C.A. USE GROUP
 B.O.C.A. TYPE OF CONSTRUCTION
 ZONING LOCATION PORTLAND, MAINE, 12-14-79

PERMIT ISSUED
 DEC 14 1979
CITY OF PORTLAND

DIRECTOR OF BUILDING & INSPECTION SERVICES, PORTLAND, MAINE

The undersigned hereby applies for a permit to erect, alter, repair, demolish, move or install the following building, structure, equipment or change use in accordance with the Laws of the State of Maine, the Portland B.O.C.A. Building Code and Zoning Ordinance of the City of Portland with plans and specifications, if any, submitted herewith and the following specifications:

LOCATION .. 15-17 Pleasant St., 04101 Fire District #1 , #2
 1. Owner's name and address Edward T. Brown - same Apt. 19A Telephone 773-5191
 2. Contractor's name and address E. J. Monte - 42 Anson, Port., Me. Telephone 773-6672
 3. Architect Specifications Plans No. of sheets
 Proposed use of building .. apartment bldg. No. families
 Last use .. same No. families
 Material No. stories Heat Style of roof Roofing
 Other buildings on same lot
 Estimated contractual cost \$... 40,000... .. Fee \$.. 181.00

FIELD INSPECTOR—Mr. GENERAL DESCRIPTION
 This application is for: @ 775-5451 Repairs after fire to original condition.
 Dwelling Ext. 234
 Garage
 Masonry Bldg.
 Metal Bldg.
 Alterations
 Demolitions
 Change of Use
 Other

Stamp of Special Conditions

NOTE TO APPLICANT: Separate permits are required by the installers and subcontractors of heating, plumbing, electrical and mechanicals.

PERMIT IS TO BE ISSUED TO 1 2 3 4
 Other:

DETAILS OF NEW WORK

Is any plumbing involved in this work? Is any electrical work involved in this work?
 Is connection to be made to public sewer? If not, what is proposed for sewage?
 Has septic tank notice been sent? Form notice sent?
 Height average grade to top of plate Height average grade to highest point of roof
 Size, front depth No. stories solid or filled land? earth or rock?
 Material of foundation Thickness, top bottom cellar
 Kind of roof Rise per foot Roof covering
 No. of chimneys Material of chimneys of lining Kind of heat fuel
 Framing Lumber—Kind Dressed or full size? Corner posts Sills
 Size Girder Columns under girders Size Max. on centers
 Studs (outside walls and carrying partitions) 2x4-16" O. C. Bridging in every floor and flat roof span over 8 feet.
 Joists and rafters: 1st floor, 2nd, 3rd, roof
 On centers: 1st floor, 2nd, 3rd, roof
 Maximum span: 1st floor, 2nd, 3rd, roof
 If one story building with masonry walls, thickness of walls? height?

IF A GARAGE

No. cars now accommodated on same lot, to be accommodated ... number commercial cars to be accommodated ...
 Will automobile repairing be done other than minor repairs to cars habitually stored in the proposed building?

APPROVALS BY: DATE
 BUILDING INSPECTION—PLAN EXAMINER
 ZONING:
 BUILDING CODE:
 Fire Dept.:
 Health Dept.:
 Others:

MISCELLANEOUS
 Will work require disturbing of any tree on a public street? ..
 Will there be in charge of the above work a person competent to see that the State and City requirements pertaining thereto are observed?

Signature of Applicant *Edward T. Brown* Phone # 77-3519
 Type Name of above Edward T. Brown 1 2 3 4
 Other
 and Address

INSPECTOR'S COPY

NOTES

12-14-79 work already started - had him
 coming in for permit - will put fire
 doors on to hall & will install smoke
 detectors
 2-11-80 doors on Apts - still has
 smoke detectors on order - readings
 going up on stairs -
 4-10-80 smoke detectors in - readings
 on - dec. sp. gaurak - lumber gaurak
 fire alarm installed - tssub. C.O.

Permit No. 79/1107
 Location 15-17 Leonard St.
 Owner Edward J. Gamm
 Date of permit 12-14-79
 Approved 12-14-79

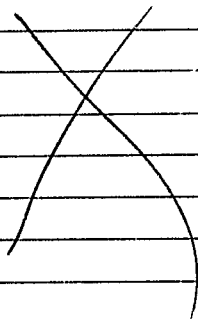



APPLICATION FOR PERMIT

PERMIT ISSUED

APR 2 1980

B.O.C.A. USE GROUP

B.O.C.A. TYPE OF CONSTRUCTION 00 152

ZONING LOCATION _____ PORTLAND, MAINE, April 1, 1980

CITY OF PORTLAND

To the DIRECTOR OF BUILDING & INSPECTION SERVICES, PORTLAND, MAINE

The undersigned hereby applies for a permit to erect, alter, repair, demolish, move or install the following building, structure, equipment or change use in accordance with the Laws of the State of Maine, the Portland B.O.C.A. Building Code and Zoning Ordinance of the City of Portland with plans and specifications, if any, submitted herewith and the following specifications:

LOCATION 15-19 Pleasant St. Fire District #1 , #2

1. Owner's name and address Edward T. Brown Telephone

2. Lessee's name and address Telephone

3. Contractor's name and address Wm. Lazarovich 268 Spring St. Telephone 774-3257

4. Architect Specifications Plans No. of sheets

Proposed use of building 13 apts. No. families

Last use No. families

Material No. stories Heat Style of roof Roofing

Other buildings on same lot

Estimated contractual cost \$ 900 Fee \$ 5.50

FIELD INSPECTOR—Mr. GENERAL DESCRIPTION

This application is for: @ 775-5451 To install a manual fire alarm system

Dwelling Ext. 234 5 horns and 5 pull boxes, and 13 unit

Garage smoke alarms

Masonry Bldg.

Metal Bldg. Stamp of Special Conditions

Alterations

Demolitions

Change of Use

Other

NOTE TO APPLICANT: Separate permits are required by the installers and subcontractors of heating, plumbing, electrical and mechanicals.

PERMIT IS TO BE ISSUED TO 1 2 3 4

Other:

DETAILS OF NEW WORK

Is any plumbing involved in this work? Is any electrical work involved in this work?

Is connection to be made to public sewer? If not, what is proposed for sewage?

Has septic tank notice been sent? Form notice sent?

Height average grade to top of plate Height average grade to highest point of roof

Size, front depth No. stories solid or filled land? earth or rock?

Material of foundation Thickness, top bottom cellar

Kind of roof Rise per foot Roof covering

No. of chimneys Material of chimneys of lining Kind of heat fuel

Framing Lumber—Kind Dressed or full size? Corner posts Sills

Size Girder Columns under girders Size Max. on centers

Studs (outside walls and carrying partitions) 2x4-16" O. C. Bridging in every floor and flat roof span over 8 feet.

Joists and rafters: 1st floor, 2nd, 3rd, roof

On centers: 1st floor, 2nd, 3rd, roof

Maximum span: 1st floor, 2nd, 3rd, roof

If one story building with masonry walls, thickness of walls? height?

IF A GARAGE

No. cars now accommodated on same lot . . . , to be accommodated . . . number commercial cars to be accommodated . . .

Will automobile repairing be done other than minor repairs to cars habitually stored in the proposed building?

APPROVALS BY: DATE

BUILDING INSPECTION—PLAN EXAMINER

ZONING:

BUILDING CODE:

Fire Dept.: James P. [Signature]

Health Dept.:

Others:

MISCELLANEOUS

Will work require disturbing of any tree on a public street? . . .

Will there be in charge of the above work a person competent to see that the State and City requirements pertaining thereto are observed? yes

Signature of Applicant W. Lazarovich Phone # 774-3257

Type Name of above Wm Lazarovich 1 2 3 4

Other and Address

FIELD INSPECTOR'S COPY

NOTES

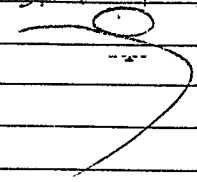
4-10-80 installed - H. Collins notified
of msp - 

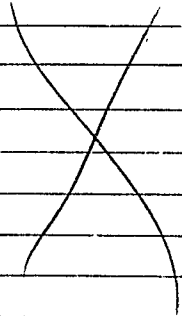

Permit No. 80/152

Location 15-19 

Owner  ST. MARY'S

Date of permit 7-1-80 Fire Alarm System

Approved 7-2-81 

PERMIT TO INSTALL PLUMBING

PERMIT NUMBER **1142**

Date Issued **FEB 18, 1970**
Portland Plumbing Inspector
 By **ERNOLD R. GOODWIN**

Address		Installation From 17 Pleasant St.	
Owner of Bldg. 17 Pleasant St.		Owner's Address 17 Pleasant St.	
Plumber: Ernie		Date: 2/20/70	
NEW	REPL	Routen Kats	NO. 2/20/70
		SINKS	
		LAVATORIES	
		TOILETS	
		BATH TUBS	
		SHOWERS	
		DRAINS FLOOR SURFACE	
		HOT WATER TANKS	
		TANKLESS WATER HEATERS	
		GARBAGE DISPOSALS	
		SEPTIC TANKS	
		HOUSE SEWERS	
		ROOF LEADERS	
		AUTOMATIC WASHERS	
		DISHWASHERS	
		OTHER	
		TOTAL	2

App. First Insp.
FEB 27 1970
 Date
 By **ERNOLD R. GOODWIN**
CHIEF PLUMBING INSPECTOR
 App. Final Insp.

Date **FEB 27 1970**
 By **ERNOLD R. GOODWIN**
CHIEF PLUMBING INSPECTOR

- Type of Bldg.
- Commercial
 - Residential
 - Single
 - Multi Family
 - New Construction
 - Remodeling

Building and Inspection Services Dept.; Plumbing Inspection

4520

CITY OF PORTLAND, MAINE

Application for Permit to Install Wires

Permit No. 58029
 Issued 7/29/69
 Portland, Maine July 30, 1969

To the City Electrician, Portland, Maine:

The undersigned hereby applies for a permit to install wires for the purpose of conducting electric current, in accordance with the laws of Maine, the Electrical Ordinance of the City of Portland, and the following specifications:

(This form must be completely filled out — Minimum Fee, \$1.00)

Owner's Name and Address F. T. Brown 17 Pleasant Tel.

Contractor's Name and Address Fidelity Electric Co Tel.

Location 17 Pleasant St. Use of Building

Number of Families Apartments Stores Number of Stories

Description of Wiring: New Work Additions Alterations

Pipe Cable Metal Molding BX Cable Plug Molding (No. of feet)

No. Light Outlets Plugs Light Circuits Plug Circuits

FIXTURES: No. Floor, or Strip Lighting (No. feet)

SERVICE: Pipe Cable Underground No. of Wires Size

METERS: Relocated 6 Added Total No. Meters

MOTORS: Number Phase H. P. Amps Volts Starter

HEATING UNITS: Domestic (Oil) No. Motors Phase H.P.
 Commercial (Oil) No. Motors Phase H.P.
 Electric Heat (No. of Rooms)

APPLIANCES: No. Ranges Watts Brand Feeds (Size and No.)

Elec. Heaters Watts

Miscellaneous Watts Extra Cabinets or Panels

Transformers Air Conditioners (No. Units) Signs (No. Units)

Will commence 19..... Ready to cover in 19..... Inspection 19.....

Amount of Fee \$ 2.00

Signed V. Lopez

DO NOT WRITE BELOW THIS LINE

SERVICE METER GROUND

VISITS: 1 2 3 4 5 6

7 8 9 10 11 12

REMARKS:

INSPECTED BY J. W. Huber
 (OVER)

LOCATION Pleasant ^{ST.} ~~St.~~ 17

INSPECTION DATE 8/14/69

WORK COMPLETED 8/14/69

TOTAL NO. INSPECTIONS 1

REMARKS:

FEEES FOR WIRING PERMITS EFFECTIVE JULY 31, 1963

WIRING

1 to 30 Outlets \$ 2.00
 31 to 60 Outlets 3.00
 Over 60 Outlets, each Outlet05
 (Each twelve feet or fraction thereof of fluorescent lighting or
 any type of plug molding will be classed as one outlet).

SERVICES

Single Phase 2.00
 Three Phase 4.00

MOTORS

Not exceeding 50 H.P. 3.00
 Over 50 H.P. 4.00

HEATING UNITS

Domestic (Oil) 2.00
 Commercial (Oil) 4.00
 Electric Heat (Each Room)75

APPLIANCES

Ranges, Cooking Tops, Ovens, Water Heaters, Disposals, Built-in
 Dishwashers, Dryers, and any permanent built-in appliance — each
 unit 1.50

MISCELLANEOUS

Temporary Service, Single Phase 1.00
 Temporary Service, Three Phase 2.00
 Circuses, Carnivals, Fairs, etc. 10.00
 Meters, re-late 1.00
 Distribution Cabinet or Panel, per unit 1.00
 Transformers, per unit 2.00
 Air Conditioners, per unit 2.00
 Signs, per unit 2.00

ADDITIONS

PERMIT TO INSTALL PLUMBING

State
 Issued **3/10/69**
 Portland Plumbing Inspector
 By **ERNOLD R. GOODWIN**

PERMIT NUMBER **131**

Address **15 Pleasant Street**
 Installation For: **Dwelling**
 Owner of Bldg: **Ted Brown**
 Owner's Address: **15 Pleasant Street**
 Plumber: **Neuben Katz**

Date: **3/10/69**
 NO **1** FEE

App. First Insp.
 Date **MAR 11 1969**
 By **ERNOLD R. GOODWIN**

App. Final Insp.
 Date **MAR 11 1969**
 By **ERNOLD R. GOODWIN**
 Type of Bldg.

- Commercial
- Residential
- Single
- Multi Family
- New Construction
- Remodeling

NEW	REPL		NO	FEE
		SINKS		
		LAVATORIES		
		TOILETS		
	1	BATH TUBS		
		SHOWERS	1	2.00
		DRAINS FLOOR SURFACE		
		HOT WATER TANKS		
		TANKLESS WATER HEATERS		
		GARBAGE DISPOSALS		
		SEPTIC TANKS		
		HOUSE SEWERS		
		ROOF LEADERS		
		AUTOMATIC WASHERS		
		DISHWASHERS		
		OTHER		
TOTAL			1	2.00

Building and Inspection Services Dept., Plumbing Inspection.

CITY OF PORTLAND, MAINE

Application for Permit to Install Wires

Permit No. 57572
 Issued 2/17/69
 Portland, Maine Feb. 17, 1969

To the City Electrician, Portland, Maine:

The undersigned hereby applies for a permit to install wires for the purpose of conducting electric current, in accordance with the laws of Maine, the Electrical Ordinance of the City of Portland, and the following specifications:

(This form must be completely filled out — Minimum Fee, \$1.00)

Owner's Name and Address E. T. Brown Tel.
 Contractor's Name and Address Fidelity Electric Tel.
 Location 15 B. Pleasant St. Use of Building
 Number of Families Apartments Stores Number of Stories
 Description of Wiring: New Work Additions Alterations

Pipe Cable Metal Molding BX Cable Plug Molding (No. of feet)
 No. Light Outlets 9 Plugs 10 Light Circuits 2 Plug Circuits 2

FIXTURES: No. Fluor. or Strip Lighting (No. feet)

SERVICE: Pipe Cable Underground No. of Wires Size

METERS: Relocated Added Total No. Meters

MOTORS: Number Phase H. P. Amps Volts Starter

HEATING UNITS: Domestic (Oil) No. Motors Phase H.P.

Commercial (Oil) No. Motors Phase H.P.

Electric Heat (No. of Rooms)

APPLIANCES: No. Ranges Watts Brand Feeds (Size and No.)

Elec. Heaters Watts

Miscellaneous Watts Extra Cabinets or Panels

Transformers Air Conditioners (No. Units) Signs (No. Units)

Will commence 19... Ready to cover in 19... Inspection 19...

Amount of Fee \$ 2.00

Signed W. Fitzgerald

DO NOT WRITE BELOW THIS LINE

SERVICE METER GROUND

VISITS: 1 2 3 4 5 6

7 8 9 10 11 12

REMARKS:

INSPECTED BY J. W. [Signature]
 (OVER)

LOCATION Pleasant St. 15
 INSPECTION DATE 2/28/69
 WORK COMPLETED 2/28/69
 TOTAL NO. INSPECTIONS 1
 REMARKS:

FEES FOR WIRING PERMITS EFFECTIVE JULY 31, 1963

WIRING

1 to 30 Outlets \$ 2.00
 \$1 to 60 Outlets 5.00
 Over 60 Outlets, each Outlet05
 (Each twelve feet or fraction thereof of fluorescent lighting or
 any type of plug molding will be classed as one outlet).

SERVICES

Single Phase 2.00
 Three Phase 4.00

MOTORS

Not exceeding 50 H.P. 3.00
 Over 50 H.P. 4.00

HEATING UNITS

Domestic (Oil) 2.00
 Commercial (Oil) 4.00
 Electric Heat (Each Room)75

APPLIANCES

Ranges, Cooking Tops, Ovens, Water Heaters, Disposals, Built-in
 Dishwashers, Dryers, and any permanent built-in appliance - each
 unit 1.50

MISCELLANEOUS

Temporary Service, Single Phase 1.00
 Temporary Service, Three Phase 2.00
 Circuses, Carnivals, Fairs, etc. * 10.00
 Meters, relocate 1.00
 Distribution Cabinet or Panel, per unit 7.00



1-2 INDUSTRIAL ZONE

APPLICATION FOR PERMIT

Class of Building or Type of Structure Second Class

Portland, Maine, Feb. 17, 1969

PERMIT ISSUED
114
FEB 17 1969
CITY of PORTLAND

To the INSPECTOR OF BUILDINGS, PORTLAND, MAINE

The undersigned hereby applies for a permit to erect alter repair demolish install the following building structure equipment in accordance with the Laws of the State of Maine, the Building Code and Zoning Ordinance of the City of Portland, plans and specifications, if any, submitted herewith and the following specifications:

Location 15B Pleasant Street Within Fire Limits? _____ Dist. No. _____
 Owner's name and address Edward T. Brown, 19 Pleasant St. Telephone _____
 Lessee's name and address _____ Telephone _____
 Contractor's name and address Ernest Monte, 43 Anson Rd. Telephone _____
 Architect _____ Specifications _____ Plans _____ No. of sheets _____
 Proposed use of building Tenement No. families 13
 Last use _____ " _____ No. families 13
 Material brick No. stories 3 Heat _____ Style of roof _____ Roofing _____
 Other buildings on same lot _____
 Estimated cost \$ 2000. Fee \$ 7.00

General Description of New Work

To Repair after Fire to former condition.
 No structural damage
 Replacing windows, two suspended ceilings, etc.

It is understood that this permit does not include installation of heating apparatus which is to be taken out separately by and in the name of the heating contractor. **PERMIT TO BE ISSUED TO** owner

Details of New Work

Is any plumbing involved in this work? _____ Is any electrical work involved in this work? _____
 Is connection to be made to public sewer? _____ If not, what is proposed for sewage? _____
 Has septic tank notice been sent? _____ Form notice sent? _____
 Height average grade to top of plate _____ Height average grade to highest point of roof _____
 Size, front _____ depth _____ No. stories _____ solid or filled land? _____ earth or rock? _____
 Material of foundation _____ Thickness, top _____ bottom _____ cellar _____
 Kind of roof _____ Rise per foot _____ Roof covering _____
 No. of chimneys _____ Material of chimneys _____ of lining _____ Kind of heat _____ fuel _____
 Framing Lumber—Kind _____; Dressed or full size? _____ Corner posts _____ Sills _____
 Size Girder _____ Columns under girders _____ Size _____ Max. on centers _____
 Studs (outside walls and carrying partitions) 2x4-16" O. C. Bridging in every floor and flat roof span over 8 feet.
 Joists and rafters: 1st floor _____, 2nd _____, 3rd _____, roof _____
 On centers: 1st floor _____, 2nd _____, 3rd _____, roof _____
 Maximum span: 1st floor _____, 2nd _____, 3rd _____, roof _____
 If one story building with masonry walls, thickness of walls? _____ height? _____

If a Garage

No. cars now accommodated on same lot _____, to be accommodated _____ number commercial cars to be accommodated _____
 Will automobile repairing be done other than minor repairs to cars habitually stored in the proposed building? _____

APPROVED:

2/17/69 rms ✓

Miscellaneous

Will work require disturbing of any tree on a public street? no
 Will there be in charge of the above work a person competent to see that the State and City requirements pertaining thereto are observed? yes

Edward T. Brown

PK

Permit No.

69/194

Location

153 Laurent St.

Owner

Blaise J. Brune

Date of permit

7/17/69

Notif. closing-in

Inspn. closing-in

Final Notif.

Final Inspn.

Cart. of Occupancy issued

Staking Out Notice

Form Check Notice

NOTES

2-24-69 Completed

EW

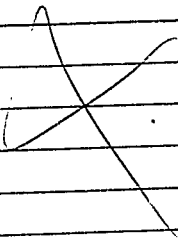

CITY OF PORTLAND, MAINE

Application for Permit to Install Wires

Permit No. 56853
 Issued 5/22/68
 Portland, Maine May 22, 1968

To the City Electrician, Portland, Maine:

The undersigned hereby applies for a permit to install wires for the purpose of conducting electric current, in accordance with the laws of Maine, the Electrical Ordinance of the City of Portland, and the following specifications:

(This form must be completely filled out — Minimum Fee, \$1.00)

Owner's Name and Address E. T. Brown Pleasant St. Tel.

Contractor's Name and Address Fidelity Electric Tel.

Location 17-19 Pleasant Use of Building

Number of Families Apartments Stores Number of Stories

Description of Wiring: New Work Additions Alterations

Pipe Cable ~~✓~~ Metal Molding BX Cable Plug Molding (No. of feet)

No. Light Outlets Plugs Light Circuits Plug Circuits

FIXTURES: No. Fluor. or Strip Lighting (No. feet)

SERVICE: Pipe Cable Underground No. of Wires Size

METERS: Relocated 5 Added Total No. Meters

MOTORS: Number Phase H. P. Amps Volts Starter

HEATING UNITS: Domestic (Oil) No. Motors Phase H.P.

Commercial (Oil) No. Motors Phase H.P.

Electric Heat (No. of Rooms)

APPLIANCES: No. Ranges Watts Brand Feeds (Size and No.)

Elec. Heaters Watts

Miscellaneous Watts Extra Cabinets or Panels

Transformers Air Conditioners (No. Units) Signs (No. Units)

Will commence 19..... Ready to cover in 19..... Inspection 19.....

Amount of Fee \$ 2.00

Signed H. Lazarus

DO NOT WRITE BELOW THIS LINE

SERVICE METER GROUND

VISITS: 1 2 3 4 5 6

7 8 9 10 11 12

REMARKS:

INSPECTED BY F. W. Heaton
 (OVER)

LOCATION *Pleasant ST 17-19*
 INSPECTION DATE *5/18/68*
 WORK COMPLETED *5/28/68*
 TOTAL NO. INSPECTIONS *1*
 REMARKS:

FEES FOR WIRING PERMITS EFFECTIVE JULY 31, 1963

WIRING

1 to 30 Outlets \$ 2.00
 31 to 60 Outlets 3.00
 Over 60 Outlets, each Outlet05
 (Each twelve feet or fraction thereof of fluorescent lighting or any type of plug molding will be classed as one outlet).

SERVICES

Single Phase 2.00
 Three Phase 4.00

MOTORS

Not exceeding 50 H.P. 3.00
 Over 50 H.P. 4.00

HEATING UNITS

Domestic (Oil) 2.00
 Commercial (Oil) 4.00
 Electric Heat (Each Room)75

APPLIANCES

Ranges, Cooking Tops, Ovens, Water Heaters, Disposals, Built-in Dishwashers, Dryers, and any permanent built-in appliance — each unit 1.50

MISCELLANEOUS

Temporary Service, Single Phase 1.00
 Temporary Service, Three Phase 2.00
 Circuses, Carnivals, Fairs, etc. 10.00
 Meters, relocate 1.00
 Distribution Cabinet or Panel, per unit 1.00
 Transformers, per unit 2.00

WRITTEN CONSENT AND AGREEMENT RELATING TO A CERTAIN SIGN PROPOSED
TO BE ERECTED PROJECTING OVER A PUBLIC SIDEWALK FROM THE PREMISES
AT 17 Pleasant St IN PORTLAND, MAINE

Edward T. Brown being the owner of the
premises at 17 Pleasant St in Portland, Maine hereby gives
consent to the erection of a certain sign owned by Edward T. Brown
projecting over the public sidewalk from said premises as described in
application to the Inspector of Buildings of Portland, Maine for a permit
to cover erection of said sign;

And in consideration of the issuance of said permit _____
Edward T. Brown, owner of said premises, in event said sign
shall cease to serve the purpose for which it was erected or shall become
dangerous and in event the owner of said sign shall fail to remove said sign
or make it permanently safe in case the sign still serves the purpose for
which it was erected, hereby agrees for himself or itself, for his heirs, its
successors, and his or its assigns, to completely remove said sign within ten
days of notice from said Inspector of Buildings that said sign is in such
condition and of order from him to remove it.

In Witness whereof the owner of said premises has signed this
consent and agreement this 26th day of January 1968.

J. L. Coyne
Witness

Edward T. Brown
Owner

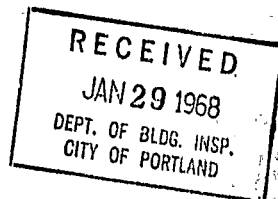

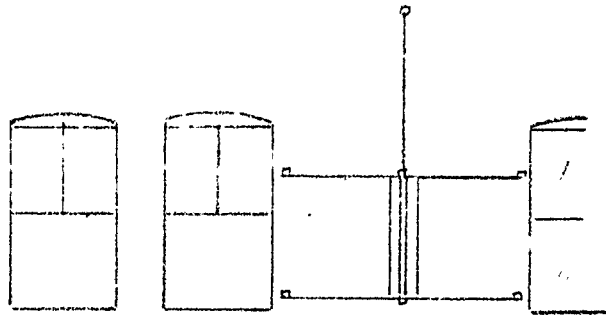

3 STORY BRICK

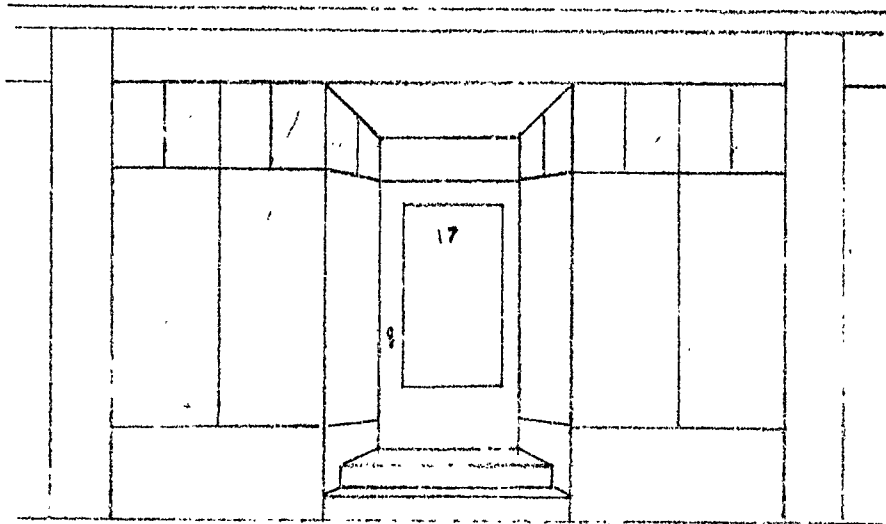

SCALE 1/4" = 1'-0"

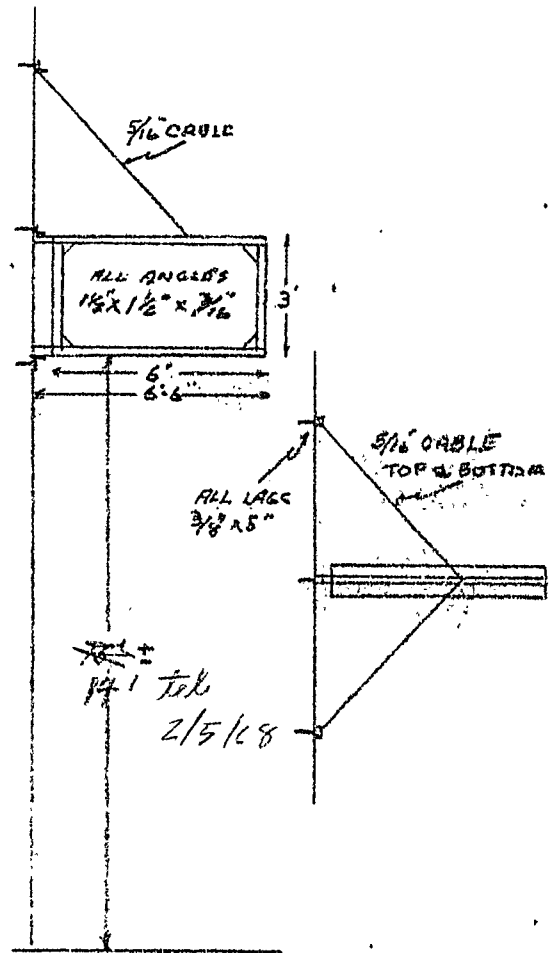

SIGN FOR E. T. BROWN, INC.
17 PLEASANT ST.

ESTD. W. 35" - 18 SQ. FT. PLASTIC EN. SIDE
NON-ELECTRIC

1/29/68

COYNE SIGNS
CORPORATION



I-2B
18 square ft. Plexiglass-Und. Label: 6

APPLICATION FOR PERMIT TO ERECT SIGN OVER PUBLIC SIDEWALK OR STREET

PERMIT ISSUED
JAN 30 1968
CITY OF PORTLAND

Portland, Maine, January 29 1968, 19

To the INSPECTOR OF BUILDINGS, PORTLAND, ME.

The undersigned hereby applies for a permit to erect the following described sign extending over a public sidewalk or street in accordance with the Building Code of the City of Portland, and the following specifications:

Location 17 Pleasant St. Within Fire Limits? _____ Dist. No. _____
Owner of building to which sign is to be attached. Edward C Brown, 17 Pleasant St.
Name and address of owner of sign " "
Contractor's name and address Boyer Sign Company 195 St. John St. Telephone 772-4144
When does contractor's bond expire? Dec. 31, 1968

Information Concerning Building no lighting

No. stories 3 Material of wall to which sign is to be attached brick

Details of Sign and Connections

Building owner's consent and agreement filed with application yes

Electric? yes Vertical dimension after erection 3' Horizontal 6'

Weight 85 lbs., Will there be any hollow spaces? yes Any rigid frame? yes

Material of frame angle iron No. advertising faces 2 material plastic

No. rigid connections 2 Are they fastened directly to frame of sign? yes

No. through bolts 7 Size _____ Location, top or bottom _____

No. guys 5 material cable Size 5/16

Minimum clear height above sidewalk or street 15'

Maximum projection into street 686"

Fee \$ 2.00

Signature of contractor by:

INSPECTION COPY

J. E. Mc

3/13

Permit No. 68/88

Location 17 Pleasant St

Owner Edward C. Brown

Date of permit 4/5/68

Sign Contractor

Final Inspn.

NOTES

2/13/68 - stop insp.
made iff

3/17/68 - work done
E.S.S.

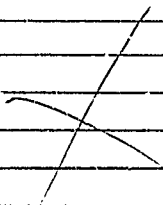

CITY OF PORTLAND, MAINE

Application for Permit to Install Wires

Permit No. 45506

Issued 1/27/67

Portland, Maine 1 - 27 - 1967

To the City Electrician, Portland, Maine:

The undersigned hereby applies for a permit to install wires for the purpose of conducting electric current, in accordance with the laws of Maine, the Electrical Ordinance of the City of Portland, and the following specifications:

(This form must be completely filled out — Minimum Fee, \$1.00)

Owner's Name and Address E. T. Brown Tel.

Contractor's Name and Address 19 Pleasant St. E. T. Brown Electric Tel. 778-2119

Location 19 Pleasant St. Use of Building Apartment

Number of Families Apartments Stores Number of Stories

Description of Wiring: New Work Additions Alterations

Pipe Cable Metal Molding BX Cable Plug Molding (No. of feet)

No. Light Outlets Plugs 28 Light Circuits Plug Circuits 2

FIXTURES: No. 6 Light Switches 12 Fluor. or Strip Lighting (No. feet)

SERVICE: Pipe Cable Underground No. of Wires Size

METERS: Relocated Added Total No. Meters

MOTORS: Number Phase H. P. Amps Volts Starter

HEATING UNITS: Domestic (Oil) No. Motors Phase H.P.

Commercial (Oil) No. Motors Phase H.P.

Electric Heat (No. of Rooms)

APPLIANCES: No. Ranges Watts Brand Feeds: (Size and No.)

Elec. Heaters Watts

Miscellaneous Watts Extra Cabinets or Panels

Transformers Air Conditioners (No. Units) Signs (No. Units)

Will commence 19 Ready to cover in 19 Inspection 1-30-1967

Amount of Fee \$.. 2.00

Signed H. V. Richardson

Masters # 2187

DO NOT WRITE BELOW THIS LINE

SERVICE METER GROUND

VISITS: 1 2 3 4 5 6

..... 7 8 9 10 11 12

REMARKS:

INSPECTED BY [Signature]
(OVER)

LOCATION Pleasant St 19
 INSPECTION DATE 2/9/67
 WORK COMPLETED 2/9/67
 TOTAL NO. INSPECTIONS 1
 REMARKS:

FEES FOR WIRING PERMITS EFFECTIVE JULY 31, 1963.

WIRING
 1 to 30 Outlets (including switches) \$ 2.00
 31 to 60 Outlets (including switches) 3.00
 Over 60 Outlets, each Outlet (including switches) .02
 (Each twelve feet or fraction thereof of fluorescent lighting or any type of plug molding will be classed as one outlet.)

SERVICES
 Single Phase 2.00
 Three Phase 4.00

MOTORS
 Not exceeding 5/8 H.P. 3.00
 Over 50 H.P. 7.00

HEATING UNITS
 Domestic (Oil) 2.00
 Commercial (Oil) 4.00
 Electric Heat (Each Room) 7.50

APPLIANCES
 Ranges, Cooking Tops, Ovens, Water Heaters, Disposals Dish washers, etc. — Each Unit 1.50

TEMPORARY WORK (limited to 6 months frontdate of permit)
 Service, Single Phase 4.00
 Service, Three Phase 2.00
 Wiring, 1-50 Outlets 1.00

Wiring, each additional outlet over 5002
 Circuits, Carnivals, Fairs, etc. 10.00

MISCELLANEOUS

Done

PERMIT TO INSTALL PLUMBING

PERMIT NUMBER **16513**

Date Issued **8/22/66**

Portland Plumbing Inspector
By **ERNOLD R. GOODWIN**

App. First Insp.
Date **9/6/66**
By *[Signature]*

App. Final Insp.
Date **SEP 8 1966**
By **ERNOLD R. GOODWIN**
CHIEF TYPE OF BLDG. INSPECTOR

- Commercial
- Residential
- Single
- Multi Family
- New Construction
- Remodeling

Address **17 Pleasant Street**
 Installation For: **Dwelling**
 Owner of Bldg.: **E. T. Brown**
 Owner's Address: **17 Pleasant Street**
 Plumber: **Paul Iverson** Date: **8/22/66**

NEW	REPL.		NO.	FEE
		SINKS		
✓	1	LAVATORIES	1	2.00
✓	1	TOILETS	1	2.00
		BATH TUBS		
✓	1	SHOWERS	1	2.00
		DRAINS FLOOR SURFACE		
		HOT WATER TANKS		
		TANKLESS WATER HEATERS		
		GARBAGE DISPOSALS		
		SEPTIC TANKS		
		HOUSE SEWERS		
		ROOF LEADERS		
		AUTOMATIC WASHERS		
		DISHWASHERS		
		OTHER		

TOTAL **3** **6.00**

Building and Inspection Services Dept. Plumbing Inspection

- COMMERCIAL
- RESIDENTIAL
- SINGLE
- MULTI FAMILY
- NEW CONSTRUCTION
- REMODELING

		HOUSE SEWERS		
		ROOF LEADERS (Conn. to house drain)		

PORTLAND HEALTH DEPT. PLUMBING INSPECTION TOTAL ▶ \$13.00

- RESIDENTIAL
- SINGLE
- MULTI FAMILY
- NEW CONSTRUCTION
- REMODELING

PORTLAND HEALTH DEPT. PLUMBING INSPECTION TOTAL ▶ \$ 2.00

- REMODELING

PORTLAND HEALTH DEPT. PLUMBING INSPECTION TOTAL ▶ \$22.00

- REMODELING

PORTLAND HEALTH DEPT. PLUMBING INSPECTION TOTAL ▶ \$10.60

- REMODELING

PORTLAND HEALTH DEPT. PLUMBING INSPECTION TOTAL ▶ **44.60**

- REMODELING

PORTLAND HEALTH DEPT. PLUMBING INSPECTION TOTAL ▶ **716.00**

- REMODELING

PORTLAND HEALTH DEPT. PLUMBING INSPECTION TOTAL

PERMIT TO INSTALL PLUMBING

1141 North 4th St

14805

PERMIT NUMBER

By: J.P. Welch
 PORTLAND PLUMBING INSPECTOR

Address: 17
 Installation For: T. Brown Inc
 Owner of Bldg: Same
 Owner's Address: Same
 Plumber: Emil Iverson Date: 1/17/65

APPROVED FIRST INSPECTION

NEW	REPL	PROPOSED INSTALLATIONS	NUMBER	FEE
✓	2	SINKS	2	1.00
✓	2	LAVATORIES	2	4.00
✓	2	TOILETS	2	2.60
✓	2	BATH TUBS	2	1.20
✓	2	SHOWERS	2	1.20
		DRAINS		
		HOT WATER TANKS		
		TANKLESS WATER HEATERS		
	2	GARBAGE GRINDERS	2	1.20
		SEPTIC TANKS		
		HOUSE SEWERS		
		ROOF LEADERS (Conn. to house drain)		

APPROVED FINAL INSPECTION

JOSEPH P. WELCH
 CHIEF PLUMBING INSPECTOR

- TYPE OF BUILDING
- COMMERCIAL
 - RESIDENTIAL
 - SINGLE
 - MULTI FAMILY
 - NEW CONSTRUCTION
 - REMODELING

PORTLAND HEALTH DEPT. PLUMBING INSPECTION

TOTAL ▶ \$13.00

- RESIDENTIAL
- SINGLE
 - MULTI FAMILY
 - NEW CONSTRUCTION
 - REMODELING

PORTLAND HEALTH DEPT. PLUMBING INSPECTION

TOTAL ▶ \$ 2.00

- REMODELING

PORTLAND HEALTH DEPT. PLUMBING INSPECTION

TOTAL ▶ \$22.00

- REMODELING

PORTLAND HEALTH DEPT. PLUMBING INSPECTION

TOTAL ▶ \$10.60

- REMODELING

PORTLAND HEALTH DEPT.

PLUMBING INSPECTION

Total 4 9.00

- REMODELING

PORTLAND HEALTH DEPT.

PLUMBING INSPECTION

Total 1 11.00

PERMIT TO INSTALL PLUMBING

E. T. Brown

14100

PERMIT NUMBER

Date Issued 6-9-64
PORTLAND PLUMBING INSPECTOR

Address 15B Pleasant Street

Installation for: E. T. Brown

Owner of Bldg. E. T. Brown

Owner's Address: Same

Plumber: Portland Gas Light Company Date: 6-9-64

By J. P. Welch

APPROVED FIRST INSPECTION

Date 6-18-64

By J. P. Welch

APPROVED FINAL INSPECTION

Date 6-18-64

By JOSEPH P. WELCH

CHIEF PLUMBING INSPECTOR

- By
- TYPE OF BUILDING
 - COMMERCIAL
 - RESIDENTIAL
 - SINGLE
 - MULTI FAMILY
 - NEW CONSTRUCTION
 - REMODELING

NEW	REPL	PROPOSED INSTALLATIONS	NUMBER	FEE
		SINKS		
		LAVATORIES		
		TOILETS		
		BATH TUBS		
		SHOWERS		
		DRAINS		
		HOT WATER TANKS	1	\$ 2.00
		TANKLESS WATER HEATERS		
		GARBAGE GRINDERS		
		SEPTIC TANKS		
		HOUSE SEWERS		
		ROOF LEADERS (Conn. to house drain)		

PORTLAND HEALTH DEPT. PLUMBING INSPECTION

TOTAL ▶ \$ 2.00

REMODELING

PORTLAND HEALTH DEPT. PLUMBING INSPECTION

TOTAL ▶ \$22.00

REMODELING

PORTLAND HEALTH DEPT. PLUMBING INSPECTION

TOTAL ▶ \$10.60

REMODELING

PORTLAND HEALTH DEPT.

PLUMBING INSPECTION

Total 47.60

REMODELING

PORTLAND HEALTH DEPT.

PLUMBING INSPECTION

Total 186.00

506 (12-58)

PERMIT TO INSTALL PLUMBING

Building & Code

13062

PERMIT NUMBER

Date: 7-26-63

Issued: PORTLAND PLUMBING INSPECTOR

By: J. P. Welch

Address: 15 C & D Pleasant Street

Installation for: E. T. Brown

Owner of Bldg. E. T. Brown

Owner's Address: 15 Pleasant Street

Plumber: Philip Iourin

Date: 7-26-63

APPROVED FIRST INSPECTION

Date: Aug 1, 1963

By: Welch

APPROVED FINAL INSPECTION

Date: Dec 16, 1963

By: JOSEPH E. WELCH

- TYPE OF BUILDING
- COMMERCIAL
 - RESIDENTIAL
 - SINGLE
 - MULTI FAMILY
 - NEW CONSTRUCTION
 - REMODELING

NEW	REP'L	PROPOSED INSTALLATIONS	NUMBER	FEE
✓	✓	SINKS	5	\$10.00
5	✓	LAVATORIES	5	3.00
✓	✓	TOILETS	5	3.00
4	✓	BATH TUBS	4	2.40
1		SHOWERS	1	.60
		DRAINS		
5	✓	HOT WATER TANKS	5	3.00
		TANKLESS WATER HEATERS		
		GARBAGE GRINDERS		
		SEPTIC TANKS		
		HOUSE SEWERS		
		ROOF LEADERS (Conn. to house drain)		

PORTLAND HEALTH DEPT. PLUMBING INSPECTION

TOTAL ▶ \$22.00

REMODELING

PORTLAND HEALTH DEPT. PLUMBING INSPECTION

TOTAL ▶ \$10.60

REMODELING

SM 12-53 PORTLAND HEALTH DEPT.

PLUMBING INSPECTION

Total

REMODELING

SM 12-53 PORTLAND HEALTH DEPT.

PLUMBING INSPECTION

Total

49.00

116.00

3

PERMIT TO INSTALL PLUMBING

12646

PERMIT NUMBER

Date Issued 4-4-63
 PORTLAND PLUMBING INSPECTOR

Address 15B Pleasant Street
 Installation For: E. T. Brown
 Owner of Bldg. E. T. Brown
 Owner's Address: 101 Dartmouth Street
 Plumber: Philip Lovato Date: 4-1-63

By J. P. Welch
 APPROVED FIRST INSPECTION

Date Klein

By Apr. 5 63
 APPROVED FINAL INSPECTION

Date

By **JOSEPH P. WELCH**
 TYPE OF BUILDING
 COMMERCIAL
 RESIDENTIAL
 SINGLE
 MULTI FAMILY
 NEW CONSTRUCTION
 REMODELING

NEW	REPL	PROPOSED INSTALLATIONS	NUMBER	FEE
	2	✓ SINKS	2	\$ 4.00
1		✓ LAVATORIES	1	2.00
	1	✓ TOILETS	1	2.00
1		✓ BATH TUBS	1	2.00
		SHOWERS		
		DRAINS		
1		HOT WATER TANKS	1	.60
		TANKLESS WATER HEATERS		
		GARBAGE GRINDERS		
		SEPTIC TANKS		
		HOUSE SEWERS		
		ROOF LEADERS (Conn. to house drain)		

PORTLAND HEALTH DEPT. PLUMBING INSPECTION TOTAL ▶ \$10.60

REMODELING
 5M 12-53 PORTLAND HEALTH DEPT. PLUMBING INSPECTION Total 49.00

REMODELING
 5M 12-53 PORTLAND HEALTH DEPT. PLUMBING INSPECTION Total 116.00

PERMIT NUMBER **2495**

Date Issued **10/3/57**

PORTLAND PLUMBING INSPECTOR

By **J. Phalick**

APPROVED FIRST INSPECTION

Date **9/18/57**

By **L.B.B.**

APPROVED FINAL INSPECTION

Date **10/21/57**

By **L.B.B.**

TYPE OF BUILDING

- COMMERCIAL
- RESIDENTIAL
- SINGLE
- MULTI FAMILY
- NEW CONSTRUCTION
- REMODELING

PERMIT TO INSTALL PLUMBING

Address: **15 Pleasant St. R**

Installation For:

Owner of Bldg.: **C. Brown**

Owner's Address: **Same**

Plumber **P.R. Mullin** Date **10/3/57**

NEW	REP'L	PROPOSED INSTALLATIONS	NO.	FEE
	1	SINKS	1	1.00
	1	LAVATORIES	1	1.00
	1	TOILETS	1	1.00
	1	BATH TUBS	1	1.00
		SHOWERS	1	1.00
		DRAINS		
		HOT WATER TANKS	3	
		TANKLESS WATER HEATERS		
		GARBAGE GRINDERS		
		SEPTIC TANKS		
		HOUSE SEWERS		
		ROOF LEADERS (conn. to house drain)		

SM 12-53 PORTLAND HEALTH DEPT.

REMODELING

PLUMBING INSPECTION

Total **4.00**

SM 12-53 PORTLAND HEALTH DEPT.

PLUMBING INSPECTION

Total **1.00**

PERMIT
NUMBER

Date
Issued

PORTLAND PLUMBING
INSPECTOR

By

APPROVED FIRST INSPECTION

Date

By

APPROVED FINAL INSPECTION

Date

By

- TYPE OF BUILDING
- COMMERCIAL
 - RESIDENTIAL
 - SINGLE
 - MULTI-FAMILY
 - NEW CONSTRUCTION
 - REMODELING

SM 12-53

PERMIT TO INSTALL PLUMBING

Address: 15 Cleavant Street

Installation For:

Owner of Bldg: Stanley Brown

Owner's Address: 101 Dartmouth St

Plumber: Philip Lennie Date: 8/17/55

NEW	REP'L	PROPOSED INSTALLATIONS	NUMBER	FEE
	1	SINKS	1	1.00
		LAVATORIES		
		TOILETS		
		BATH TUBS		
		SHOWERS		
		DRAINS		
		HOT WATER TANKS		
		TANKLESS WATER HEATERS	3	
		GARBAGE GRINDERS		
		SEPTIC TANKS		
		HOUSE SEWERS		
		ROOF LEADERS (conn. to house drain)		

PORTLAND HEALTH DEPT.

PLUMBING INSPECTION

Total

1.00

CITY OF PORTLAND, MAINE

Application for Permit to Install Wires

Permit No. 53739
 Issued 3/19/65

Portland, Maine March 19, 19 65

To the City Electrician, Portland, Maine:

The undersigned hereby applies for a permit to install wires for the purpose of conducting electric current, in accordance with the laws of Maine, the Electrical Ordinance of the City of Portland, and the following specifications:

(This form must be completely filled out — Minimum Fee, \$1.00)

Owner's Name and Address F. T. Brown Tel. _____
 Contractor's Name and Address Fidelity Electric Tel. _____
 Location 157 Pleasant St. Use of Building _____
 Number of Families _____ Apartments _____ Stores _____ Number of Stories _____
 Description of Wiring: New Work _____ Additions Alterations _____

Pipe _____ Cable Metal Molding _____ BX Cable _____ Plug Molding (No. of feet) _____

No. Light Outlets 8 Plugs 2 Light Circuits _____ Plug Circuits 2

FIXTURES: No. _____ Light Switches 15 Fluor. or Strip Lighting (No. feet) _____

SERVICE: Pipe _____ Cable _____ Underground _____ No. of Wires _____ Size _____

METERS: Relocated _____ Added _____ Total No. Meters _____

MOTORS: Number _____ Phase _____ H. P. _____ Amps _____ Volts _____ Starter _____

HEATING UNITS: Domestic (Oil) _____ No. Motors _____ Phase _____ H.P. _____

Commercial (Oil) _____ No. Motors _____ Phase _____ H.P. _____

Electric Heat (No. of Rooms) _____

APPLIANCES: No. Ranges _____ Watts _____ Brand Feeds (Size and No.) _____

Elec. Heaters _____ Watts _____

Miscellaneous _____ Watts _____ Extra Cabinets or Panels _____

Transformers _____ Air Conditioners (No. Units) _____ Signs (No. Units) _____

Will commence _____ 19 _____ Ready to cover in _____ 19 _____ Inspection will call 19 _____

Amount of Fee \$ 2.00

Signed N. T. [Signature]

DO NOT WRITE BELOW THIS LINE

SERVICE _____ METER _____ GROUND _____

VISITS: 1 _____ 2 _____ 3 _____ 4 _____ 5 _____ 6 _____

7 _____ 8 _____ 9 _____ 10 _____ 11 _____ 12 _____

REMARKS:

4/2/65
4/15/65

INSPECTED BY [Signature]
(OVER)

LOCATION Present St. 15A
 INSPECTION DATE 4/16/65
 WORK COMPLETED 4/16/65
 TOTAL NO. INSPECTIONS 3

REMARKS:

FEEES FOR WIRING PERMITS EFFECTIVE JULY 31, 1963

WIRING
 1 to 30 Outlets (including switches) \$ 2.00
 31 to 60 Outlets (including switches) 3.00
 Over 60 Outlets, each Outlet (including switches)05
 (Each twelve feet or fraction thereof of fluorescent lighting or any type of plug moulding will be classed as one outlet).

SERVICES
 Single Phase 2.00
 Three Phase 4.00

MOTORS
 Not exceeding 50 H.P. 3.00
 Over 50 H.P. 4.00

HEATING UNITS
 Domestic (Oil) 2.00
 Commercial (Oil) 4.00
 Electric Heat (Each Room)75

APPLIANCES
 Ranges, Cooking Tops, Ovens, Water Heaters, Disposals, Dishwashers, etc. — Each Unit 1.50

TEMPORARY WORK (Limited to 6 months from date of permit)
 Service, Single Phase 1.00
 Service, Three Phase 2.00
 Wiring, 1-50 Outlets 1.00
 Wiring, each additional outlet over 5002
 Circuses, Carnivals, Fairs, etc. 10.00

MISCELLANEOUS
 Distribution Cabinet or Panel, per unit 1.00
 Transformers, per unit 2.00
 Air Conditioners, per unit 2.00
 Signs, per unit 2.00

ADDITIONS



FILL IN AND SIGN WITH INK

APPLICATION FOR PERMIT FOR HEATING, COOKING OR POWER EQUIPMENT

Portland, Maine, March 1, 1965

PERMIT ISSUED
00186
MAR 2 1965
CITY OF PORTLAND

To the INSPECTOR OF BUILDINGS, PORTLAND, ME.

The undersigned hereby applies for a permit to install the following heating, cooking or power equipment in accordance with the Laws of Maine, the Building Code of the City of Portland, and the following specifications:

Location 15 Pleasant St. Use of Building (3) apt. 9 No. Stories 3 ~~New Building~~ Existing "
Name and address of owner of appliance E. T. Brown Co., 17 Pleasant St. Telephone 772-8304
Installer's name and address Harris Oil Co., 202 Commercial St. Telephone

General Description of Work

To install oil burning equipment ~~comprising~~ and oil-fired boiler in circulating hot water heating system (in place of gas heat) to heat second and third floors.

IF HEATER, OR POWER BOILER

Location of appliance basement Any burnable material in floor surface or beneath? no
If so, how protected? Kind of fuel? oil
Minimum distance to burnable material, from top of appliance or casing top of furnace 2 1/2
From top of smoke pipe 2! From front of appliance over 4! From sides or back of appliance over 4!
Size of chimney flue 12x14 Other connections to same flue no
If gas fired, how vented? Rated maximum demand per hour
Will sufficient fresh air be supplied to the appliance to insure proper and safe combustion? yes

IF OIL BURNER

Name and type of burner Eastern oil-gun type Labeled by underwriters' laboratories?
Will operator be always in attendance? Does oil supply line feed from top or bottom of tank?
Type of floor beneath burner cement Size of vent pipe 1 1/2
Location of oil storage basement Number and capacity of tanks 1 - 275 gal.
Low water shut off Make No.
Will all tanks be more than five feet from any flame? yes How many tanks enclosed?
Total capacity of any existing storage tanks for furnace burners

IF COOKING APPLIANCE

Location of appliance Any burnable material in floor surface or beneath?
If so, how protected? Height of Legs, if any
Skirting at bottom of appliance? Distance to combustible material from top of appliance?
From front of appliance From sides and back From top of smokepipe
Size of chimney flue Other connections to same flue
Is hood to be provided? If so, how vented? Forced or gravity?
If gas fired, how vented? Rated maximum demand per hour

MISCELLANEOUS EQUIPMENT OR SPECIAL INFORMATION

Amount of fee enclosed? 2.00 (\$2.00 for one heater, etc., \$1.00 additional for each additional heater, etc., in same building at same time.)

APPROVED:

O.N. - 3/2/65 - agj

Will there be in charge of the above work a person competent to see that the State and City requirements pertaining thereto are observed? yes

E. T. Brown Co.
Harris Oil Co.

By: *[Signature]*

Signature of Installer

CS 300

INSPECTION COPY

[Handwritten mark]

NOTES

Permit No. 671886
 Location 151 Leonard Street
 Owner E. J. Raymond, Inc.
 Date of permit 3/21/68
 Approved _____

1	Fill (ft)	
2	Vent (ft)	
3	Kind of Work	
4	Fluor. (ft) by 2 Supports	
5	Name of Work	
6	Base	
7	Height	
8	Remarks	
9	Notes	
10	Notes	
11	Notes	
12	Notes	
13	Notes	
14	Notes	
15	Notes	
16	Notes	
17	Notes	
18	Notes	
19	Notes	
20	Notes	

3-9-68 In rear abutting
 bldg. collar etc.

Large ruled area for notes, containing a large handwritten 'X' in the upper left quadrant.



APPLICATION FOR PERMIT

Class of Building or Type of Structure Second Class
Portland, Maine, July 11, 1963

PERMIT ISSUED
007531
JUL 11 1963
CITY of PORTLAND

To the INSPECTOR OF BUILDINGS, PORTLAND, MAINE

The undersigned hereby applies for a permit to erect alter repair demolish install the following building structure equipment in accordance with the Laws of the State of Maine, the Building Code and Zoning Ordinance of the City of Portland, plans and specifications, if any, submitted herewith and the following specifications:

Location 13-17 Pleasant Street Within Fire Limits? _____ Dist. No. _____
 Owner's name and address Edward T. Brown, 101 Dartmouth St. Telephone _____
 Lessee's name and address _____ Telephone _____
 Contractor's name and address Donald Bragdon, 257 Ocean St., 3rd, Portland Telephone _____
 Architect _____ Specifications _____ Plans _____ No. of sheets _____
 Proposed use of building Store and apts. No. families 13
 Last use _____ " _____ No. families 13
 Material brick No. stories 2 Heat _____ Style of roof _____ Roofing _____
 Other buildings on same lot _____
 Estimated cost \$ 2000. Fee \$ 6.00

General Description of New Work

To tear out closets and provide new bathrooms - 2x4 studs, 16" O.C., sheetrock
 2 on 1st floor all bathrooms vented through roof
 3 on 2nd floor
 3 on 3rd floor

38-15-23

It is understood that this permit does not include installation of heating apparatus which is to be taken out separately by and in the name of the heating contractor. **PERMIT TO BE ISSUED TO** owner

Details of New Work

Is any plumbing involved in this work? yes Is any electrical work involved in this work? yes
 Is connection to be made to public sewer? _____ If not, what is proposed for sewage? _____
 Has septic tank notice been sent? _____ Form notice sent? _____
 Height average grade to top of plate _____ Height average grade to highest point of roof _____
 Size, front _____ depth _____ No. stories _____ solid or filled land? _____ earth or rock? _____
 Material of foundation _____ Thickness, top _____ bottom _____ cellar _____
 Kind of roof _____ Rise per foot _____ Roof covering _____
 No. of chimneys _____ Material of chimneys _____ of lining _____ Kind of heat _____ fuel _____
 Framing Lumber—Kind _____ Dressed or full size? _____ Corner posts _____ Sills _____
 Size Girder _____ Columns under girders _____ Size _____ Max. on centers _____
 Studs (outside walls and carrying partitions) 2x4-16" O. C. Bridging in every floor and flat roof span over 8 feet.
 Joists and rafters: 1st floor _____, 2nd _____, 3rd _____, roof _____
 On centers: 1st floor _____, 2nd _____, 3rd _____, roof _____
 Maximum span: 1st floor _____, 2nd _____, 3rd _____, roof _____
 If one story building with masonry walls, thickness of walls? _____ height? _____

If a Garage

No. cars now accommodated on same lot _____, to be accommodated _____ number commercial cars to be accommodated _____
 Will automobile repairing be done other than minor repairs to cars habitually stored in the proposed building? _____

APPROVED:

E. E. M.

Miscellaneous

Will work require disturbing of any tree on a public street? no
 Will there be in charge of the above work a person competent to see that the State and City requirements pertaining thereto are observed? yes

Signature of owner Edward T. Brown

NOTES

7-16-63 Work started
on removing partitions

1-13-64 Completed

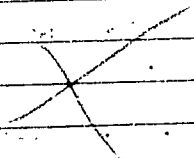

Work in progress

7-1

Permit No. 63 191

Location 15-1-10 Pleasant Hill

Owner Edward J. Brown

Date of permit 7/11/63

Notif. closing-in

Inspn. closing-in

Final Notif.

Final Inspn.

Cert. of Occupancy issued

Sinking Out-Notice

Form Check-Notice



FILL IN AND SIGN IN INK

APPLICATION FOR PERMIT FOR HEATING, COOKING OR POWER EQUIPMENT

Portland, Maine, October 23, 1962

PERMIT ISSUED
06394
OCT 23 1962
CITY OF PORTLAND

To the INSPECTOR OF BUILDINGS, PORTLAND, ME.

The undersigned hereby applies for a permit to install the following heating, cooking or power equipment in accordance with the Laws of Maine, the Building Code of the City of Portland, and the following specifications:

Location 14 Pleasant St. Use of Building Store & Apt's. No. Stories 3 New Building Existing "

Name and address of owner of appliance Edward F. Brown, 101 Dartmouth St.

Installer's name and address Eastern Oil & Equipment Co. 27 Portland St. Telephone 3-6495

General Description of Work

To install forced warm air heating system and oil burning equipment in place of space heat.
for store only - first floor.

IF HEATER, OR POWER BOILER

Location of appliance Basement Any burnable material in floor surface or beneath? none

If so, how protected? Kind of fuel? oil

Minimum distance to burnable material, from top of appliance or casing top of furnace 4"

From top of smoke pipe 3' From front of appliance over 4' From sides or back of appliance over 3'

Size of chimney flue 10x10 Other connections to same flue none

Is gas fired, how vented? Rated maximum demand per hour

Will sufficient fresh air be supplied to the appliance to insure proper and safe combustion? yes

IF OIL BURNER

Name and type of burner Hallmark-gunitype Labeled by underwriters' laboratories? yes

Will operator be always in attendance? Does oil supply line feed from top or bottom of tank? bottom

Type of floor beneath burner concrete Size of vent pipe 1 1/2"

Location of oil storage basement Number and capacity of tanks 275 gal.

Low water shut off Make No.

Will all tanks be more than five feet from any flame? yes How many tanks enclosed?

Total capacity of any existing storage tanks for furnace burners

IF COOKING APPLIANCE

Location of appliance Any burnable material in floor surface or beneath?

If so, how protected? Height of Legs, if any

Skirting at bottom of appliance? Distance to combustible material from top of appliance?

From front of appliance From sides and back From top of smokepipe

Size of chimney flue Other connections to same flue

Is hood to be provided? If so, how vented? Forced or gravity?

If gas fired, how vented? Rated maximum demand per hour

MISCELLANEOUS EQUIPMENT OR SPECIAL INFORMATION

.....
.....
.....

Amount of fee enclosed? 2.00 (\$2.00 for one heater, etc., \$1.00 additional for each additional heater, etc., in same building at same time.)

APPROVED: [Signature]

Will there be in charge of the above work a person competent to see that the State and City requirements pertaining hereto are observed? yes
Eastern Oil & Equipment Company

Signature of Installer [Signature]



(G) GENERAL BUSINESS ZONING

APPLICATION FOR PERMIT

Class of Building or Type of Structure Second Class
Portland, Maine, Jan. 10, 1957

PERMIT ISSUED
00045
JAN 15 1957
CITY OF PORTLAND

To the INSPECTOR OF BUILDINGS, PORTLAND, MAINE

The undersigned hereby applies for a permit to ~~erect~~ ~~alter~~ ~~repair~~ ~~rebuild~~ ~~or~~ ~~add~~ the following building ~~structure~~ ~~equipment~~ in accordance with the Laws of the State of Maine, the Building Code and Zoning Ordinance of the City of Portland, plans and specifications, if any, submitted herewith and the following specifications:

Location 15 Pleasant St. Within Fire Limits? Yes Dist. No. _____
Owner's name and address Edward T. Brown, 101 Dartmouth St. Telephone 3-5191
Lessee's name and address _____ Telephone _____
Contractor's name and address Ernest C. Densmore, 28 Inverness St. Telephone 2-0881
Architect _____ Specifications _____ Plans no No. of sheets _____
Proposed use of building stores and apartments No. families 13
Last use _____ " " _____ No. families 13
Material brick No. stories 3 Heat _____ Style of roof _____ Roofing _____
Other buildings on same lot _____
Estimated cost \$ 100. Fee \$ 50.

General Description of New Work

To close up door on right hand side of building. 2x4 studs, 16" on centers, covered with sheetrock on inside and ~~boards on the outside~~. 8" of brickwork on outside.

CERTIFICATE OF OCCUPANCY
REQUIREMENT IS WAIVED

It is understood that this permit does not include installation of heating apparatus which is to be taken out separately by and in the name of the heating contractor. **PERMIT TO BE ISSUED TO** owner, 17 Pleasant St.

Details of New Work

Is any plumbing involved in this work? _____ Is any electrical work involved in this work? _____
Is connection to be made to public sewer? _____ If not, what is proposed for sewage? _____
Has septic tank notice been sent? _____ Form notice sent? _____
Height average grade to top of plate _____ Height average grade to highest point of roof _____
Size, front _____ depth _____ No. stories _____ solid or filled land? _____ earth or rock? _____
Material of foundation _____ Thickness, top _____ bottom _____ cellar _____
Material of underpinning _____ Height _____ Thickness _____
Kind of roof _____ Rise per foot _____ Roof covering _____
No. of chimneys _____ Material of chimneys _____ of lining _____ Kind of heat _____ fuel _____
Framing lumber—Kind _____ Dressed or full size? _____
Corner posts _____ Sills _____ Girt or ledger board? _____ Size _____
Girders _____ Size _____ Columns under girders _____ Size _____ Max. on centers _____
Studs (outside walls and carrying partitions) 2x4-16" O. C. Bridging in every floor and flat roof span over 8 feet.
Joists and rafters: 1st floor _____, 2nd _____, 3rd _____, roof _____
On centers: 1st floor _____, 2nd _____, 3rd _____, roof _____
Maximum span: 1st floor _____, 2nd _____, 3rd _____, roof _____
If one story building with masonry walls, thickness of walls? _____ height? _____

If a Garage

No. cars now accommodated on same lot _____, to be accommodated _____ number commercial cars to be accommodated _____
Will automobile repairing be done other than minor repairs to cars habitually stored in the proposed building? _____

APPROVED:

O.N-1/15/57-ags

Miscellaneous

Will work require disturbing of any tree on a public street? no
Will there be in charge of the above work a person competent to see that the State and City requirements pertaining thereto are observed? yes

Signature of owner

Edward T. Brown

INSPECTION COPY

NOTES

1/23/57 - Don needs to be
broken up - Allen

2/6/57 - Same - Allen

3/6/57 - Same - Allen

3/17/57 - Roe at work by
a car - road

4/15/57 - says he will have
at first by May 1st. Did
him what would be a - Allen

5/9/57 - left word fr. Mr.
Brown to call me - Allen

5/10/57 - Mr. Brown called.

He says he has a summer job
is going to do the job but
that it has been hard to
get him to start. He can
save quite a little money if
he can get the man's
desk job. This is a small
job so I wish you would
not see anything for a
month or so but that the
date of May 1st would
still stand - Allen

5/20/57 - Opening still with
closed in - Allen

6/21/57 - Job done - Allen

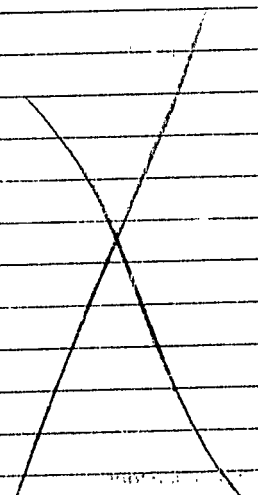

Handwritten notes in the top right corner, including the number '28' and some illegible scribbles.

Permit No.	57/4-5
Location	15 Cleveland St
Owner	Charles J. Brown
Date of permit	1/5/57
Notif. closing-in	
Inspn. closing-in	
Final Notif.	
Final Inspn.	
Cert. of Occupancy issued	
Staking Out Notice	
Form Check Notice	



APPLICATION FOR PERMIT

Class of Building or Type of Structure

Portland, Maine, Jan. 27, 1955

PERMIT ISSUED

001422
JAN 27 1955

CITY of PORTLAND

To the INSPECTOR OF BUILDINGS, PORTLAND, MAINE

The undersigned hereby applies for a permit to erect ~~at the proposed location~~ ^{at the proposed location} install the following building ~~erect~~ ^{erect} equipment in accordance with the Laws of the State of Maine, the Building Code and Zoning Ordinance of the City of Portland, plans and specifications, if any, submitted herewith and the following specifications:

Location 13-19 Pleasant St. Within Fire Limits? yes Dist. No.

Owner's name and address Arthur A. Fink, 67 Union St. Telephone

Lessee's name and address Telephone

Contractor's name and address Megquier & Jones Co., 33 Pearl St. Telephone 3-6471

Architect Specifications Plans yes No. of sheets 1

Proposed use of building Apartment house No. families

Last use " " No. families

Material second brick No. stories 3 Heat Style of roof Roofing

Other buildings on same lot

Estimated cost \$ 180. Fee \$ 2.00

General Description of New Work

To provide three ladders on existing fire escapes as per plan.

Order 6/28/54

It is understood that this permit does not include installation of heating apparatus which is to be taken out separately by and in the name of the heating contractor. **PERMIT TO BE ISSUED TO** Megquier & Jones Co. ^{Rec'd from Fire Dept. 1/28/55}

Details of New Work

Is any plumbing involved in this work? Is any electrical work involved in this work?

Is connection to be made to public sewer? If not, what is proposed for sewage?

Has septic tank notice been sent? Form notice sent?

Height average grade to top of plate Height average grade to highest point of roof

Size, front depth No. stories solid or filled land? earth or rock?

Material of foundation Thickness, top bottom cellar

Material of underpinning Height Thickness

Kind of roof Rise per foot Roof covering

No. of chimneys Material of chimneys of lining Kind of heat fuel

Framing lumber—Kind Dressed or full size?

Corner posts Sills Girt or ledger board? Size

Girders Size Columns under girders Size Max. on centers

Studs (outside walls and carrying partitions) 2x4-16" O. C. Bridging in every floor and flat roof span over 8 feet.

Joists and rafters: 1st floor 2nd 3rd roof

On centers: 1st floor 2nd 3rd roof

Maximum span: 1st floor 2nd 3rd roof

If one story building with masonry walls, thickness of walls? height?

If a Garage

No. cars now accommodated on same lot to be accommodated number commercial cars to be accommodated

Will automobile repairing be done other than minor repairs to cars habitually stored in the proposed building?

APPROVED:

01/13/55 - AOS

 CHIEF OF FIRE DEPT.

Miscellaneous

Will work require disturbing of any tree on a public street? no

Will there be in charge of the above work a person competent to see that the State and City requirements pertaining thereto are observed? yes

Arthur A. Fink
 Megquier & Jones Co.

Signature of owner by: A. Fink

28-10

(10) GENERAL BUSINESS ZONE



APPLICATION FOR PERMIT

PERMIT ISSUED
00239
MAR 3 1950
CITY OF PORTLAND

Class of Building or Type of Structure Second Class
Portland, Maine, March 1, 1950

To the INSPECTOR OF BUILDINGS, PORTLAND, MAINE

The undersigned hereby applies for a permit to erect ~~to repair~~ ~~demolish~~ ~~construct~~ the following building structure ~~and~~ equipment in accordance with the Laws of the State of Maine, the Building Code and Zoning Ordinance of the City of Portland, plans and specifications, if any, submitted herewith and the following specifications:

Location Rear 15 Pleasant Street Within Fire Limits? YES Dist. No.
Owner's name and address Estate of Myrtle Myers Telephone.....
Mrs. Katherine Polan, 14 Sheridan St.
Lessee's name and address Telephone.....
Contractor's name and address Simonds Construction Co., 12 Monument Sq. Telephone.....
Architect Specifications..... Plans NO No. of sheets
Proposed use of building Emergency Tenement No. families
Last use " No. families
Material brick No. stories 3 Heat Style of roof Roofing
Other buildings on same lot
Estimated cost \$ 400. Fee \$ 2.00

General Description of New Work

To Repair after Fire to former condition. No alterations
(~~2nd floor rear~~) (1st floor rear) kitchen & closets

CERTIFICATE OF OCCUPANCY
REQUIREMENTS

It is understood that this permit does not include installation of heating apparatus which is to be taken out separately by and in the name of the heating contractor. **PERMIT TO BE ISSUED TO** Simonds Construction Co.

Details of New Work

Is any plumbing involved in this work? Is any electrical work involved in this work?
Height average grade to top of plate Height average grade to highest point of roof.....
Size, front..... depth No. stories solid or filled land?..... earth or rock?
Material of foundation Thickness, top bottom..... cellar
Material of underpinning Height Thickness
Kind of roof Rise per foot Roof covering
No. of chimneys Material of chimneys..... of lining Kind of heat fuel
Framing lumber—Kind..... Dressed or full size?
Corner posts Sills..... Girt or ledger board? Size
Girders..... Size Columns under girders..... Size Max. on centers
Studs (outside walls and carrying partitions) 2x4-16" O. C. Bridging in every floor and flat roof span over 8 feet.
Joists and rafters: 1st floor....., 2nd....., 3rd roof
On centers: 1st floor....., 2nd....., 3rd roof
Maximum span: 1st floor....., 2nd....., 3rd roof
If one story building with masonry walls, thickness of walls?..... height?.....

If a Garage

No. cars now accommodated on same lot....., to be accommodated..... number commercial cars to be accommodated.....
Will automobile repairing be done other than minor repairs to cars habitually stored in the proposed building?.....

Miscellaneous

Will work require disturbing of any tree on a public street?.....no.....
Will there be in charge of the above work a person competent to see that the State and City requirements pertaining thereto are observed?.....yes.....

Estate of Myrtle Myers
Simonds Construction Co. Inc.

APPROVED:
3-2-50

Signature of owner By: John H. Simonds

PH

NOTES

3-2-50. Fire escape (to test etc) ceiling
joists and wall furring removed.

P.S.S.

3/13/50 - No objection in
inspection given. All
placed in final placement

P.S.S.

Permit No: 50/239

3/9

Location: 15th & Madison St

Owner: Estate of Myrtle Myers

Date of permit: 3/3/50

156

Notif. closing-in

Inspn. closing-in

Final Certif.

Final Inspn.

Cert. of Occupancy Issued

3/13/50

Worm

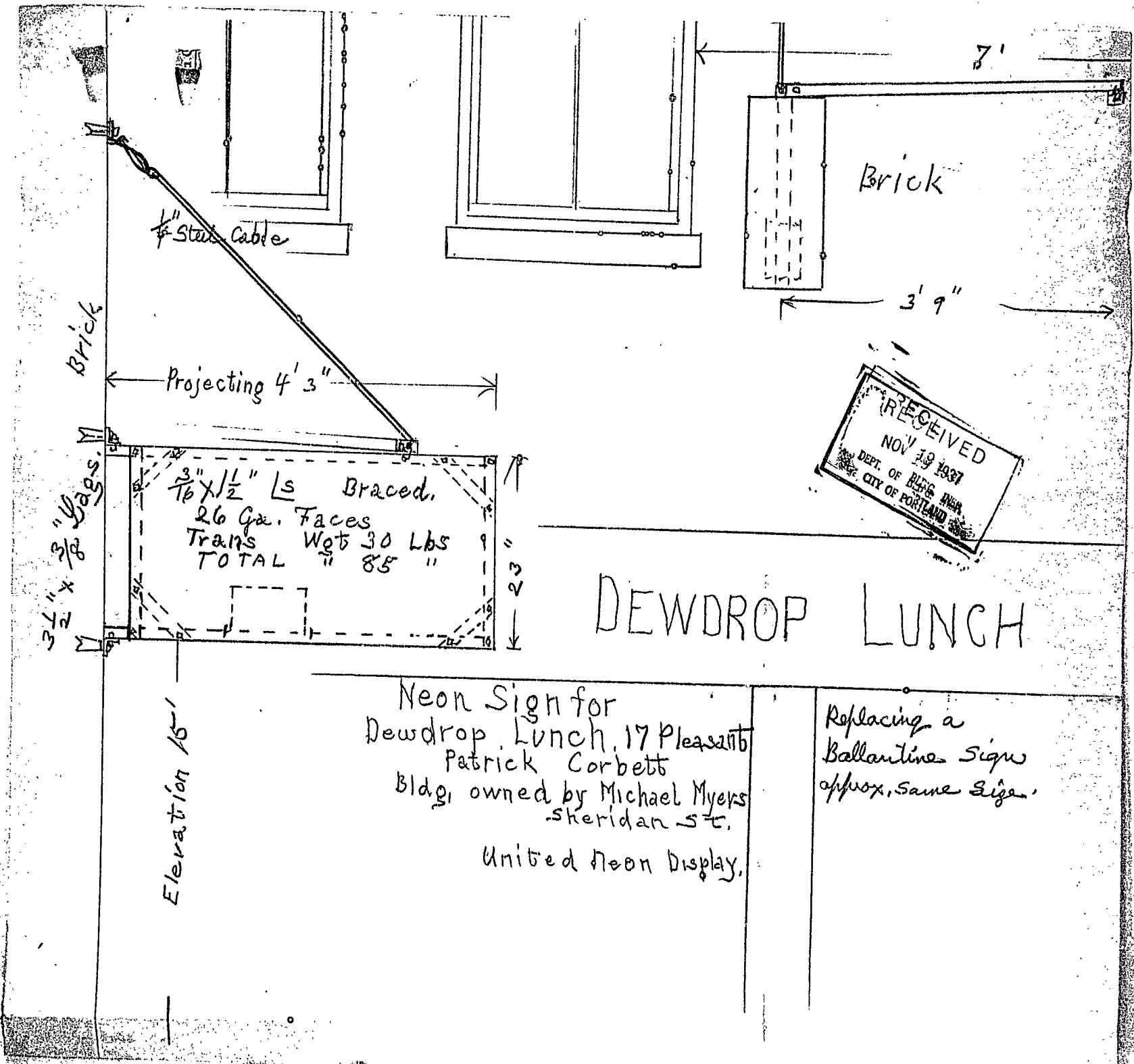

1/4" steel cable

Brick

Projecting 4' 3"

Brick

3' 9"

7'

RECEIVED
 NOV 19 1937
 DEPT. OF PUBLIC WORKS
 CITY OF PORTLAND

3/16 x 1/2" Ls Braced,
 26 Gage Faces
 Trans Wgt 30 Lbs
 TOTAL " 85 "

3 1/2" x 3/8" Wags.

DEWDROP LUNCH

Elevation 16'-

Neon Sign for
 Dewdrop Lunch, 17 Pleasant
 Patrick Corbett
 Bldg, owned by Michael Myers
 Sheridan St.

United Neon Display.

Replacing a
 Ballantine Sign
 approx. same size.

RECEIVED
NOV 10 1937
DEPT. OF BLD'G. INSP.
CITY OF PORTLAND



Brick

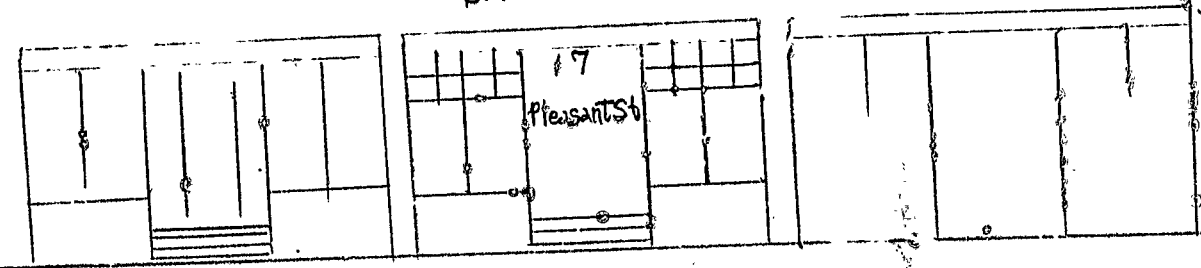

17
Pleasant St

2
EXITS

2
EXITS



APPLICATION FOR PERMIT TO ERECT SIGN OVER PUBLIC SIDEWALK OR STREET

NOV 19 1937

To the INSPECTOR OF BUILDINGS, PORTLAND, ME.

Portland, Maine, November 19, 1937

The undersigned hereby applies for a permit to erect the following described sign extending over a public sidewalk or street in accordance with the Building Code of the City of Portland, and the following specifications:

Location 17 Pleasant Street Ward 4 Within Fire Limits? yes Dist. No. 1

Owner of building to which sign is to be attached M. Myers

Name and address of owner of sign Dew Drop Lunch, 17 Pleasant St.

Contractor's name and address United Neon Display, 27 Monument Square Telephone 2-0695

When does contractor's bond expire? October 1938

Information Concerning Building

No. stories 3 Material of wall to which sign is to be attached brick

CERTIFICATE OF OCCUPANCY
REQUIREMENT IS WAIVED

Details of Sign and Connections

Electric? yes Vertical dimension after erection 23" Horizontal 4'3"

Weight 85 lbs., Will there be any hollow spaces? yes Any rigid frame? yes

Material of frame angle iron No. advertising faces 2, material metal

No. rigid connections 4 Are they fastened directly to frame of sign? yes

No. through bolts none, Size _____, Location, top or bottom _____

No. guys 2, material angle iron - cable, Size 1 1/2 x 1/2 x 3/16 - 1/2"

Minimum clear height above sidewalk or street 14'

Maximum projection into street 4'3"

Oliver D. ...

United Neon Display

Fee \$ 1.00

Signature of contractor By M. Pasquale

CHIEF OF PERM. DEPT.
INSPECTION COPY