



FILL IN AND SIGN WITH INK

001123

PERMIT ISSUED

APPLICATION FOR PERMIT FOR HEATING, COOKING OR POWER EQUIPMENT

OCT 22 1981

Portland, Maine, Oct. 21, 1981

CITY OF PORTLAND

To the INSPECTOR OF BUILDINGS, PORTLAND, ME.

The undersigned hereby applies for a permit to install the following heating, cooking or power equipment in accordance with the Laws of Maine, Building Code of the City of Portland, and the following specifications:

Location 17 Portland St Use of Building multi family No. Stories 3 New Building Existing X
Name and address of owner Alan B. Rich - same
Installer's name and address Alan B. Rich Plumbing & Heating - same Telephone 773-2260

General Description of Work

To install gas conversion burner - replacing oil

IF HEATER, OR POWER BOILER

Location of appliance Any burnable material in floor surface or beneath?
If so, how protected? Kind of fuel? gas
Minimum distance to burnable material, from top of appliance or casing top of furnace
From top of smoke pipe From front of appliance From sides or back of appliance
Size of chimney flue Other connections to same flue
If gas fired, how vented? thru chimney Rated maximum demand per hour 400,000 BTU
Will sufficient fresh air be supplied to the appliance to insure proper and safe combustion? Yes Per hour

Mr. Bartlett

IF OIL BURNER

Name and type of burner Economite Labelled by underwriters' laboratories? AGA Label
Will operator be always in attendance? Does oil supply line feed from top or bottom of tank?
Type of floor beneath burner Size of vent pipe
Location of oil storage Number and capacity of tanks
Low water shut off Make No.
Will all tanks be more than five feet from any flame? How many tanks enclosed?
Total capacity of any existing storage tanks for furnace burners

IF COOKING APPLIANCE

Location of appliance Any burnable material in floor surface or beneath?
If so, how protected? Height of Legs, if any
Skirting at bottom of appliance? Distance to combustible material from top of appliance?
From front of appliance From sides and back From top of smokepipe
Size of chimney flue Other connections to same flue
Is hood to be provided? If so, how vented? Forced or gravity?
If gas fired, how vented? Rated maximum demand per hour

MISCELLANEOUS EQUIPMENT OR SPECIAL INFORMATION

Amount of fee enclosed? 15.00

APPROVED:

[Signature]

Will there be in charge of the above work a person competent to see that the State and City requirements pertaining thereto are observed?

Alan B. Rich Plbg & Htg Inc.
By Alan B. Rich

Signature of Installer

CS 308

INSPECTION COPY

5

(COPY)

CITY OF PORTLAND, MAINE
Department of Building Inspection



Certificate of Occupancy

LOCATION 17 Portland Street

Issued to **Michael Schwartz**

Date of Issue **August 11, 1976**

This is to certify that the building, premises, or part thereof, at the above location, built—altered—changed as to use under Building Permit No. **76/716**, has had final inspection, has been found to conform substantially to requirements of Zoning Ordinance and Building Code of the City, and is hereby approved for occupancy or use, limited or otherwise, as indicated below.

PORTION OF BUILDING OR PREMISES

1st floor

APPROVED OCCUPANCY

secondhand store & antiques

Limiting Conditions: **none**

This certificate supersedes
certificate issued

Approved:

8-11-76
(Date)

Mary Schmuckel
Inspector

[Signature]
Inspector of Buildings

Note: This certificate identifies lawful use of building or premises, and ought to be transferred from owner to owner when property changes hands. Copy will be furnished to owner or lessee for one dollar.



APPLICATION FOR PERMIT

PERMIT ISSUED
AUG 11 1976
0716
CITY of PORTLAND

B.O.C.A. USE GROUP
B.O.C.A. TYPE OF CONSTRUCTION
ZONING LOCATION B-3 PORTLAND, MAINE, Aug. 9, 1976

To the DIRECTOR OF BUILDING & INSPECTION SERVICES, PORTLAND, MAINE

The undersigned hereby applies for a permit to erect, alter, repair, demolish, move or install the following building, structure, equipment or change use in accordance with the Laws of the State of Maine, the Portland B.O.C.A. Building Code and Zoning Ordinance of the City of Portland with plans and specifications, if any, submitted herewith and the following specifications:

LOCATION 17 Portland St. Fire District #1 [], #2 []
1. Owner's name and address Leo Schwartz 6 Front St. Telephone
2. Lessee's name and address Oldies & Goodies 17 Portland St. Telephone none
3. Contractor's name and address Telephone
4. Architect Specifications Plans No. of sheets
Proposed use of building second hand store & antiques No. families
Last use service bldg. No. families
Material No. stories Heat Style of roof Roofing
Other buildings on same lot
Estimated contractual cost \$ Feo \$ 5.00

FIELD INSPECTOR—Mr. Marge GENERAL DESCRIPTION

This application is for: @ 775-5451 To change use from service bldg. to second
Dwelling Ext. 234 hand store & antiques
Garage
Masonry Bldg.
Metal Bldg. Stamp of Special Conditions
Alterations
Demolitions
Change of Use
Other

NOTE TO APPLICANT: Separate permits are required by the installers and subcontractors of heating, plumbing, electrical and mechanicals.

PERMIT IS TO BE ISSUED TO 1 [] 2 [x] 3 [] 4 []
Other:

DETAILS OF NEW WORK

Is any plumbing involved in this work? Is any electrical work involved in this work?
Is connection to be made to public sewer? If not, what is proposed for sewage?
Has septic tank notice been sent? Form notice sent?
Height average grade to top of plate Height average grade to highest point of roof
Size, front depth No. stories solid or filled land? earth or rock?
Material of foundation Thickness, top bottom cellar
Kind of roof Rise per foot Roof covering
No. of chimneys Material of chimneys of lining Kind of heat fuel
Framing Lumber—Kind Dressed or full size? Corner posts Sills
Size Girder Column under girders Size Max. on centers
Studs (outside walls and carrying partitions) 2x4-16" O. C. Bridging in every floor and flat roof span over 8 feet.
Joists and rafters: 1st floor 2nd 3rd roof
On centers: 1st floor 2nd 3rd roof
Maximum span: 1st floor 2nd 3rd roof
If one story building with masonry walls, thickness of walls? height?

IF A GARAGE

No. cars now accommodated on same lot . . . , to be accommodated . . . number commercial cars to be accommodated . . .
Will automobile repairing be done other than minor repairs to cars habitually stored in the proposed building?

APPROVALS BY: DATE
BUILDING INSPECTION—PLAN EXAMINER
ZONING: O.R. M. 8/7/76
BUILDING CODE: O.R. C.A. 8/10/76
Fire Dept.:
Health Dept.:
Others:

MISCELLANEOUS
Will work require disturbing of any tree on a public street?
Will there be in charge of the above work a person competent to see that the State and City requirements pertaining thereto are observed? Yes

Signature of Applicant Michael Schwartz Phone #
Type Name of above Michael Schwartz 1 [] 2 [] 3 [] 4 []

FIELD INSPECTOR'S COPY Other and Address

Date Issued **October 13, 1969**
 Portland Plumbing Inspector

By **ERNOLD R. GOODWIN**
 App. First Insp.

Date
 By **ERNOLD R. GOODWIN**
 App. Final Insp.

Date
 By **ERNOLD R. GOODWIN**
 Type of Bldg.

- Commercial
- Residential
- Single
- Multi Family
- New Construction
- Remodeling

PERMIT TO INSTALL PLUMBING

PERMIT NUMBER **794**

Address		27 Portland St.	
Installation of or dwelling			
Owner of Bldg. Dirigo Realty			
Owner's Address. 27 Portland St.			
Plumber Franklin Binks		Date. 10/13/69	
NEW	REPL		
		SINKS	
		LAVATORIES	
		TOILETS	
		BATH TUBS	
		SHOWERS	
		DRAINS	FLOOR SURFACE
		HOT WATER TANKS	
		TANKLESS WATER HEATERS	
		GARBAGE DISPOSALS	
		SEPTIC TANKS	
		HOUSE SEWERS	
		ROOF LEADERS	
		AUTOMATIC WASHERS	
		DISHWASHERS	
		OTHER	
	1	Hot. Feed	1
		TOTAL	2.00

Building and Inspection Services Dept.; Plumbing Inspection



B3 BUSINESS ZONE

APPLICATION FOR PERMIT

Class of Building or Type of Structure Second Class

Portland, Maine, September 15, 1964

RECEIVED
011/15
1964
CITY OF PORTLAND

To the INSPECTOR OF BUILDINGS, PORTLAND, MAINE

The undersigned hereby applies for a permit to erect alter repair demolish install the following building structure equipment in accordance with the Laws of the State of Maine, the Building Code and Zoning Ordinance of the City of Portland, plans and specifications, if any, submitted herewith and the following specifications:

Location 25 Portland Street Within Fire Limits? _____ Dist. No. _____
 Owner's name and address Easternoil & Equip. Co., 27 Portland St. Telephone _____
 Lessee's name and address _____ Telephone _____
 Contractor's name and address BREGGY Construction Co., 10 Fleetwood St. Telephone 712-1269
 Architect _____ Specifications _____ Plans no. _____ No. of sheets _____
 Proposed use of building Office, dwelling and barber shop No. families _____
 Last use _____ " _____ No. families _____
 Material masonry _____ No. stories 3 Heat _____ Style of roof _____ Roofing _____
 Other buildings on same lot _____
 Estimated cost \$ 200. Fee \$ 3.00

General Description of New Work

To change size of existing front window removing old frame and providing new metal frame and brickwork (window to be smaller in size)
 To change out existing wooden front steps to brick -

Permit issued with Memo

It is understood that this permit does not include installation of heating apparatus which is to be taken out separately by and in the name of the heating contractor. **PERMIT TO BE ISSUED TO** Breggy Construction Co.

Details of New Work

Is any plumbing involved in this work? _____ Is any electrical work involved in this work? _____
 Is connection to be made to public sewer? _____ If not, what is proposed for sewage? _____
 Has septic tank notice been sent? _____ Form notice sent? _____
 Height average grade to top of plate _____ Height average grade to highest point of roof _____
 Size, front _____ depth _____ No. stories _____ solid or filled land? _____ earth or rock? _____
 Material of foundation _____ Thickness, top _____ bottom _____ cellar _____
 Kind of roof _____ Rise per foot _____ Roof covering _____
 No. of chimneys _____ Material of chimneys _____ of lining _____ Kind of heat _____ fuel _____
 Framing Lumber—Kind _____ Dressed or full size? _____ Corner posts _____ Sills _____
 Size Girder _____ Columns under girders _____ Size _____ Max. on centers _____
 Studs (outside walls and carrying partitions) 2x4-16" O. C. Bridging in every floor and flat roof span over 8 feet.
 Joists and rafters: 1st floor _____, 2nd _____, 3rd _____, roof _____
 On centers: 1st floor _____, 2nd _____, 3rd _____, roof _____
 Maximum span: 1st floor _____, 2nd _____, 3rd _____, roof _____
 If one story building with masonry walls, thickness of walls? _____ height? _____

If a Garage

No. cars now accommodated on same lot _____, to be accommodated _____ number commercial cars to be accommodated _____
 Will automobile repairing be done other than minor repairs to cars habitually stored in the proposed building? _____

APPROVED:

J. E. McNeil / memo

Miscellaneous

Will work require disturbing of any tree on a public street? no
 Will there be in-charge of the above work a person competent to see that the State and City requirements pertaining thereto are observed? yes

Easternoil & Equip. Co.
Breggy Construction Co.

CS 301

INSPECTION COPY

Signature of owner

BY:

Breggy Construction Co.
Edward Breggy

NOTES

9-30-64 Completed *SH*
@ 17 Portland St. *SH*

X

Permit No.

64-1171

Location

25 Portland St.

Owner

Edwards & Sons, Inc.

Date of permit

9/17/64

Notif. closing-in

Inspn. closing-in

Final Notif.

Final Inspn.

Certe. of Occupancy/issued

Staking Out Notice

Form Check Notice

10-1



B2 FIRE CLASS ZONE

APPLICATION FOR PERMIT

Class of Building or Type of Structure

Fire Class

2nd

Portland, Maine,

October 24, 1960

PERMIT ISSUE

OCT 25 1960

CITY OF PORTLAND

To the INSPECTOR OF BUILDINGS, PORTLAND, MAINE

The undersigned hereby applies for a permit to erect alter repair demolish install the following building structure equipment in accordance with the Laws of the State of Maine, the Building Code and Zoning Ordinance of the City of Portland, plans and specifications, if any, submitted herewith and the following specifications:

Location 21-27 Portland St. Within Fire Limits? _____ Dist. No. _____

Owner's name and address Easternoil & Equipment Co., 27 Portland St. Telephone _____

Lessee's name and address _____ Telephone _____

Contractor's name and address owners Telephone 2-6495

Architect _____ Specifications _____ Plans yes No. of sheets 1

Proposed use of building Offices & tenement No. families 13

Last use _____ " " No. families 13

Material masonry No. stories 3 Heat _____ Style of roof _____ Roofing _____

Other buildings on same lot _____

Estimated cost \$ 1500.00 Fee \$ 5.00

General Description of New Work

To extend from (2) existing offices to (3) offices on first floor with (formerly tailor) alteration, such as covering walls and ceiling with pine panelling, only. ^{shop}

It is understood that this permit does not include installation of heating apparatus which is to be taken out separately by and in the name of the heating contractor. PERMIT TO BE ISSUED TO owners

Details of New Work

Is any plumbing involved in this work? _____ Is any electrical work involved in this work? _____

Is connection to be made to public sewer? _____ If not, what is proposed for sewage? _____

Has septic tank notice been sent? _____ Form notice sent? _____

Height average grade to top of plate _____ Height average grade to highest point of roof _____

Size, front _____ depth _____ No. stories _____ solid or filled land? _____ earth or rock? _____

Material of foundation _____ Thickness, top _____ bottom _____ cellar _____

Kind of roof _____ Rise per foot _____ Roof covering _____

No. of chimneys _____ Material of chimneys _____ of lining _____ Kind of heat _____ fuel _____

Framing Lumber—Kind _____ Dressed or full size? _____ Corner posts _____ Sills _____

Size Girder _____ Columns under girders _____ Size _____ Max. on centers _____

Studs (outside walls and carrying partitions) 2x4-16" O. C. Bridging in every floor and flat roof span over 8 feet.

Joists and rafters: 1st floor _____, 2nd _____, 3rd _____, roof _____

On centers: 1st floor _____, 2nd _____, 3rd _____, roof _____

Maximum span: 1st floor _____, 2nd _____, 3rd _____, roof _____

If one story building with masonry walls, thickness of walls? _____ height? _____

If a Garage

No. cars now accommodated on same lot _____, to be accommodated _____ number commercial cars to be accommodated _____

Will automobile repairing be done other than minor repairs to cars habitually stored in the proposed building? _____

APPROVED:

O.R. - 10/25/60 - [Signature]

Miscellaneous

Will work require disturbing of any trees on a public street? no

Will there be in charge of the above work a person competent to see that the State and City requirements pertaining thereto are observed? yes

Easternoil & Equipment Company

CS 301

INSPECTION COPY

Signature of owner

by: Bernard F. Felton

FM

Permit No. 601/1637
Location: 81-27 103rd Ave W
Owner: Edmund J. & Betty A.
Date of permit: 1/25/64
Notif. closing-in _____
Inspn. closing-in _____
Final Notif. _____
Final Inspn. _____
Cert. of Occupancy issued _____
Sinking Out Notice _____
Form Check Notice _____

NOTES

12/8/64: work done. All in

Large ruled area for notes, mostly blank with a large diagonal scribble.



IN BUSINESS ZONE

APPLICATION FOR PERMIT

Class of Building or Type of Structure 2nd Class
Portland, Maine, February 10, 1958

PERMIT ISSUED
00135

FEB 11 1958

CITY OF PORTLAND

To the INSPECTOR OF BUILDINGS, PORTLAND, MAINE

The undersigned hereby applies for a permit to erect alter repair demolish install the following building structure equipment in accordance with the Laws of the State of Maine, the Building Code and Zoning Ordinance of the City of Portland, plans and specifications, if any, submitted herewith and the following specifications:

Location 25-27 Portland Street Within Fire Limits? yes Dist. No. 1B
 Owner's name and address Easternoil & Equip. Co., 25 Portland St. Telephone 3-6495
 Lessee's name and address _____ Telephone _____
 Contractor's name and address George Stanford, Scarborough, Maine Telephone _____
 Architect _____ Specifications _____ Plans yes No. of sheets 2
 Proposed use of building Offices and tenement No. families 13
 Last use _____ " " No. families 13
 Material MASONRY No stories 3 Heat _____ Style of roof _____ Roofing _____
 Other building on same lot _____
 Estimated cost \$ 4,500. Fee \$ 5.00.

General Description of New Work:

To change existing windows and make interior alterations as per plans.
First floor only.

Permit issued with letter

It is understood that this permit does not include installation of heating apparatus which is to be taken out separately by and in the name of the heating contractor. **PERMIT TO BE ISSUED TO owners**

Details of New Work

Is any plumbing involved in this work? _____ Is any electrical work involved in this work? _____
 Is connection to be made to public sewer? _____ If not, what is proposed for sewage? _____
 Has septic tank notice been sent? _____ Form notice sent? _____
 Height average grade to top of plate _____ Height average grade to highest point of roof _____
 Size, front _____ depth _____ No. stories _____ solid or filled land? _____ earth or rock? _____
 Material of foundation _____ Thickness, top _____ bottom _____ cellar _____
 Material of underpinning _____ Height _____ Thickness _____
 Kind of roof _____ Rise per foot _____ Roof covering _____
 No. of chimneys _____ Material of chimneys _____ of lining _____ Kind of heat _____ fuel _____
 Framing Lumber—Kind _____ Dressed or full size? _____ Corner posts _____ Sills _____
 Size Girder _____ Columns under girders _____ Size _____ Max. on centers _____
 Kind and thickness of outside sheathing of exterior walls? _____
 Studs (outside walls and carrying partitions) 2x4-16" O. C. Bridging in every floor and flat roof span over 2 feet.
 Joists and rafters: 1st floor _____, 2nd _____, 3rd _____, roof _____
 On centers: 1st floor _____, 2nd _____, 3rd _____, roof _____
 Maximum span: 1st floor _____, 2nd _____, 3rd _____, roof _____
 If one story building with masonry walls, thickness of walls? _____ height? _____

If a Garage

No. cars now accommodated on same lot _____, to be accommodated _____ number commercial cars to be accommodated _____
Will automobile repairing be done other than minor repairs to cars habitually stored in the proposed building? _____

APPROVED:

with letter by AJJ

Miscellaneous

Will work require disturbing of any tree on a public street? no
Will there be in charge of the above work a person competent to see that the State and City requirements pertaining thereto are observed? yes

Easternoil & Equipment Co.

INSPECTION COPY

Signature of owner BY: *John A. Capriano*

John A. Capriano

PH

NOTES

2/26/58 - *Work started* - *Allen*

2/28/58 - *left G T to place* - *Allen*

3/12/58 - *Work done* - *Allen*

Unit No. *58/134*

Location *2537 Portland St*

Owner *Ed Bernard of Portland Co*

Date of permit *2/11/58*

Notif. closing-in *2/28/58 - 9:30AM*

Insprn. closing-in *2/28/58*

Final Notif.

Final Insprn.

Cert. of Occupancy issued

Staking Out Notice

Form Check Notice

[Large section of the page is crossed out with a large 'X' mark.]

142

143

144

145

146

147

148

149

150

151

152



FILL IN AND SIGN WITH INK

APPLICATION FOR PERMIT FOR HEATING, COOKING OR POWER EQUIPMENT

PERMIT ISSUED 00183 FEB 16 1956 CITY OF PORTLAND

Portland, Maine, Feb. 16, 1956

To the INSPECTOR OF BUILDINGS, PORTLAND, ME.

The undersigned hereby applies for a permit to install the following heating, cooking or power equipment in accordance with the Laws of Maine, the Building Code of the City of Portland, and the following specifications:

Location 27 Portland St. Use of Building apartment house & No. Stories 3 New Building Existing Name and address of owner of appliance John E. Cispriano, 27 Portland St., Cape Elizabeth, Maine 27 Portland St., Telephone 3-6425 Installer's name and address Eastern Oil & Equipment Co., 27 Portland St., Telephone 3-6425

General Description of Work

To install forced hotwater heating system and oil burning equipment in place of stove heat in second and third floors

IF HEATER, OR POWER BOILER

Location of appliance basement Any burnable material in floor surface or beneath? no If so, how protected? Kind of fuel? oil Minimum distance to burnable material, from top of appliance or casing top of furnace over 2' From top of smoke pipe over 18" From front of appliance over 4' From sides or back of appliance over 3' Size of chimney flue 18" Other connections to same flue gas-fired boiler in connection with pressing machine If gas fired, how vented? Rated maximum demand per hour Will sufficient fresh air be supplied to the appliance to insure proper and safe combustion? yes

IF OIL BURNER

Permit Issued with Letter (Form Letter)

Name and type of burner Eastern oil Labeled by underwriters' laboratories? yes Will operator be always in attendance? Does oil supply line feed from top or bottom of tank? bottom Type of floor beneath burner concrete Size of vent pipe 1 1/2" Location of oil storage basement Number and capacity of tanks 1-275 gal. Low water shut off Make No. Will all tanks be more than 6 feet from any flame? yes How many tanks enclosed? Total capacity of any existing storage tanks for furnace burners none

IF COOKING APPLIANCE

Location of appliance Any burnable material in floor surface or beneath? If so, how protected? Height of Legs, if any Skirting at bottom of appliance? Distance to combustible material from top of appliance? From front of appliance From sides and back From top of smokepipe Size of chimney flue Other connections to same flue Is hood to be provided? If so, how vented? Forced or gravity? If gas fired, how vented? Rated maximum demand per hour

MISCELLANEOUS EQUIPMENT OR SPECIAL INFORMATION

Existing gas boiler has device which will automatically shut off all gas supply in case pilot flame is extinguished

Issued under allowance of Section 25j of Code - without enclosure

7/6/56

Amount of fee enclosed? 2.00 (\$9.00 for one heater, etc., 50 cents additional for each additional heater, etc., in same building at same time.)

APPROVED [Signature] FEB 16 1956

Will there be in charge of the above work a person competent to see that the State and City requirements pertaining thereto are observed? YES

Easternoil & Equipment Co.

City of Portland Printing Co.

INSPECTION COPY

Signature of Installer: [Signature]

33 L-1

NOTES

SURVEY

1924 ASSESSORS - 12 Tenants - 26 Rooms

7 Baths - Stone Heat

1955 - 2nd floor - 8 Rooms

3rd - 6 Rooms

9 Bathrooms -

9 Hot sinks

1 Toilet Room

2 water closets

- 1 Fill Pipe
- 2 Vent Pipe
- 3 Kind of Heat
- 4 Barometric Rigidity & Support
- 5 Name & Label
- 6 Stack Control
- 7 High Limit Control
- 8 Remote Control
- 9 Piping Support & Protection
- 10 Valves in Supply Line
- 11 Capacity of Tanks
- 12 Tank Rigidity & Supports
- 13 Tank Distance
- 14 Off-charge
- 15 Instruction Card
- 16 Low Water Shut off

2-2356. Furnace
 set up. (Drs. Tallen
 (LW/UN) says no tank water
 supply ~~is~~ ^{is} furnished
 in furnished with
 set of March

4-10-56. Work being done
 in open time. Should
 be finished by the
 last of April

Permit No. 56/183
 Location 27 West Highland
 Owner John W. Chapman
 Date of permit 3/16/56
 Approved S. S. C. [Signature]

2-2356-4-B30
 C-1



FILL IN AND SIGN WITH INK

APPLICATION FOR PERMIT FOR HEATING, COOKING OR POWER EQUIPMENT

Portland, Maine, Dec. 17, 1954

PERMIT ISSUED

022 1954

CITY of PORTLAND

To the INSPECTOR OF BUILDINGS, PORTLAND, MAINE

The undersigned hereby applies for a permit to install the following heating, cooking or power equipment in accordance with the Laws of Maine, the Building Code of the City of Portland, and the following specifications:

Location 23 Portland St. Use of Building tailor shop and apartments No. Stories 3 New Building Existing
Name and address of owner of appliance Peter Thoma, 75 Pitt St.
Installer's name and address Easternoil, 27 Portland St. Telephone 3-6495

General Description of Work

To install oil burning equipment in connection with existing gravity warm air heating system (conversion)

IF HEATER, OR POWER BOILER

Location of appliance Any burnable material in floor surface or beneath?
If so, how protected? Kind of fuel?
Minimum distance to burnable material, from top of appliance or casing top of furnace
From top of smoke pipe From front of appliance From sides or back of appliance
Size of chimney flue Other connections to same flue
If gas fired, how vented? Rated maximum demand per hour
Will sufficient fresh air be supplied to the appliance to insure proper and safe combustion?

IF OIL BURNER

Name and type of burner Easternoil Model A Labeled by underwriter's laboratories? yes
Will operator be always in attendance? Does oil supply line feed from top or bottom of tank? bottom
Type of floor beneath burner concrete Size of vent pipe 1"
Location of oil storage basement Number and capacity of tanks 1-275 gal.
Low water shut off Make No.
Will all tanks be more than five feet from any flame? yes How many tanks enclosed?
Total capacity of any existing storage tanks for furnace burners none

IF COOKING APPLIANCE

Location of appliance Any burnable material in floor surface or beneath?
If so, how protected? Height of Legs, if any
Skirting at bottom of appliance? Distance to combustible material from top of appliance?
From front of appliance From sides and back From top of smokepipe
Size of chimney flue Other connections to same flue
Is hood to be provided? If so, how vented? Forced or gravity?
If gas fired, how vented? Rated maximum demand per hour

MISCELLANEOUS EQUIPMENT OR SPECIAL INFORMATION

Amount of fee enclosed? 2.00 (\$2.00 for one heater, etc., 50 cents additional for each additional heater, etc., in same building at same time.)

APPROVED

Handwritten signature and date: OK 12.17.54

Will there be in charge of the above work a person competent to see that the State and City requirements pertaining thereto are observed? yes

Easternoil

Signature of Installer by:

Handwritten signature: John F. Keenan

INSPECTION COPY

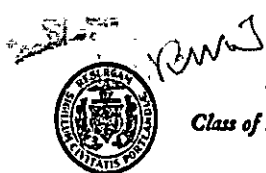

(G) GENERAL BUSINESS ZONE

APPLICATION FOR PERMIT

Class of Building or Type of Structure Third Class
Portland, Maine, August 26, 1949

PERMIT ISSUED
01396
SEP 2 1949
CITY of PORTLAND

To the INSPECTOR OF BUILDINGS, PORTLAND, MAINE

The undersigned hereby applies for a permit to erect alter repair demolish install the following building structure equipment in accordance with the Laws of the State of Maine, the Building Code and Zoning Ordinance of the City of Portland, plans and specifications, if any, submitted herewith and the following specifications:

Location 17-27 Portland Street Withir Fire Limits? Yes Dist. No. 1B
 Owner's name and address Peter Thins, 76 Pitt Street Telephone _____
 Lessee's name and address _____ Telephone _____
 Contractor's name and address Simonds Const. Co., Inc., 12 Monument Sq. Telephone 3-5125
 Architect _____ Specifications _____ Plans Yes No. of sheets 1
 Proposed use of building Stores & Apartments No. families 8
 Last use " " No. families 3
 Material frame _____ No. stories 3 Heat _____ Style of roof _____ Roofing _____
 Other buildings on same lot _____
 Estimated cost \$ 100. Fee \$.50

General Description of New Work

To cut in new door 2' 8" x 6' 8" second floor from kitchen to rear hall & stairs.
To close transom over door between front and rear stair hall on third floor.

Exam in 15 Dept. 8/31/49
~~Wood from Fire Dept.~~
CERTIFICATE OF OCCUPANCY
REQUIREMENT IS WAIVED

It is understood that this permit does not include installation of heating apparatus which is to be taken out separately by and in the name of the heating contractor. PERMIT TO BE ISSUED TO Simonds Const. Co., Inc.

Details of New Work

Is any plumbing involved in this work? _____ Is any electrical work involved in this work? _____
 Height average grade to top of plate _____ Height average grade to highest point of roof _____
 Size, front _____ depth _____ No. stories _____ solid or filled land? _____ earth or rock? _____
 Material of foundation _____ Thickness, top _____ bottom _____ cellar _____
 Material of underpinning _____ Height _____ Thickness _____
 Kind of roof _____ Rise per foot _____ Roof covering _____
 No. of chimneys _____ Material of chimneys _____ of lining _____ Kind of heat _____ fuel _____
 Framing lumber—Kind _____ Dressed or full size? _____
 Corner posts _____ Sills _____ Girt or ledger board? _____ Size _____
 Girders _____ Size _____ Columns under girders _____ Size _____ Max. on centers _____
 Studs (outside walls and carrying partitions) 2x4-16" O. C. Bridging in every floor and flat roof span over 8 feet.
 Joists and rafters. 1st floor _____, 2nd _____, 3rd _____, roof _____
 On centers: 1st floor _____, 2nd _____, 3rd _____, roof _____
 Maximum span: 1st floor _____, 2nd _____, 3rd _____, roof _____
 If one story building with masonry walls, thickness of walls? _____ height? _____

If a Garage

No. cars now accommodated on same lot _____, to be accommodated _____ number commercial cars to be accommodated _____
Will automobile repairing be done other than minor repairs to cars habitually stored in the proposed building? _____

APPROVED:
[Signature]
CITY OF PORTLAND

Miscellaneous

Will work require disturbing of any tree on a public street? No
Will there be in charge of the above work a person competent to see that the State and City requirements pertaining thereto are observed? Yes

Peter Thins
Simonds Construction Company, Inc. [Signature]
Signature of owner by [Signature] Engineer

INSPECTION COPY

APPLICATION FOR PERMIT



Class of Building or Type of Structure Installation

Portland, Maine, April 13, 1949

PERMIT ISSUED

00534

APR 26 1949

CITY of PORTLAND

To the INSPECTOR OF BUILDINGS, PORTLAND, MAINE

The undersigned hereby applies for a permit to erect also to install the following equipment in accordance with the Laws of the State of Maine, the Building Code and Zoning Ordinance of the City of Portland, plans and specifications, if any, submitted herewith and the following specifications:

Location 17-23 Portland Street Within Fire Limits? yes Dist. No.
Owner's name and address Peter Thims, 76 Pitt Street Telephone 30056
Lessee's name and address Telephone
Contractor's name and address Gill Fire Service Co., 310 Commercial St. Telephone 4-0721
Architect Specifications Plans No. of sheets
Proposed use of building Tailor shop and apartments No. families
Last use " " " No. families
Material brick No. stories 3 Heat Style of roof Roofing
Other buildings on same lot
Estimated cost \$ Fee \$ 1.00

General Description of New Work

To install automatic fire alarm using Protectowire lines of fire-detecting wire (made by the Protectowire Company) not more than 15' apart nor more than 7' 6" from any wall or partition extending to ceiling, to cover entire basement or cellar and sub-cellar, if any, all public and stair halls, all closets off halls or under stairs, all hazardous rooms and attached garage, if any, tailor shop at #21--gongs of such tone, strength of signal, number and location as to arouse all persons for whose protection intended--current by dry batteries of capacity to ring all gongs simultaneously at full signal strength, to operate system for at least one year, installed in substantial cabinet of no less than 1/4 gauge steel or well-seasoned wood at least 3/4" thick with hinged door and catch and located not less than 6" nor more than 6' above floor in dry, clean place where temperature will not go below 40 degrees F. nor above 100 degrees--test button rigidly fastened in place, conveniently located to permit and capable of testing entire system frequently. Alarm silencing switch, if provided, will be so arranged that alarm will sound if switch is thrown to "silent" position when alarm is not sounding. Installer will fasten to control box full instructions as to operation and testing of system and where and how to secure service if system gets out of order.

is understood that this permit does not include installation of heating apparatus which is to be taken out separately by and in the name of the heating contractor. PERMIT TO BE ISSUED TO Gill Fire Service Co. 4/26/49 Detection to cover all stores and shops in first story. Memo Sent to Fire Chief

4/8/49
Rec'd from Fire Dept. 4/21/49

Details of New Work

Is any plumbing involved in this work? Is any electrical work involved in this work?
Height average grade to top of plate Height average grade to highest point of roof
Size, front depth No. stories solid or filled land? earth or rock?
Material of foundation Thickness, top bottom cellar
Material of underpinning Height Thickness
Kind of roof Rise per foot Roof cover.
No. of chimneys Material of chimneys of lining Kind of heat fuel
Framing lumber--Kind Dressed or full size?
Corner posts Sills Girt or ledger board? Size
Girders Size Columns under girders Size Max. on centers
Studs (outside walls and carrying partitions) 2x4-16" O. C. Bridging in every floor and flat roof span over 8 feet.
Joists and rafters: 1st floor, 2nd, 3rd, roof
On centers: 1st floor, 2nd, 3rd, roof
Maximum span: 1st floor, 2nd, 3rd, roof
If one story building with masonry walls, thickness of walls? height?

If a Garage

No. cars now accommodated on same lot, to be accommodated number commercial cars to be accommodated
Will automobile repairing be done other than minor repairs to cars habitually stored in the proposed building?

APPROVED:

OK. 4-13-49. [Signature]

Miscellaneous

Will work require disturbing of any tree on a public street? no
Will there be in charge of the above work a person competent to see that the State and City requirements pertaining thereto are observed? yes

Peter Thims
Gill Fire Service Co.

Signature of owner by Francis J. Gill

INSPECTION COPY

NOTES

5/18/49 Ready for
~~inspection. I & Mr. Hill present.~~
~~Make minor work as requested.~~
~~Def. as let him handle it.~~

Permit No. 49/534
Location 233 Highland St.
Owner Peter J. Higgins
Date of permit 4/26/49
Notif. closing-in
Inspn. closing-in
Final Notif.
Final Inspn. 5-19-49. P.M.
Cert. of Occupancy issued

all work done

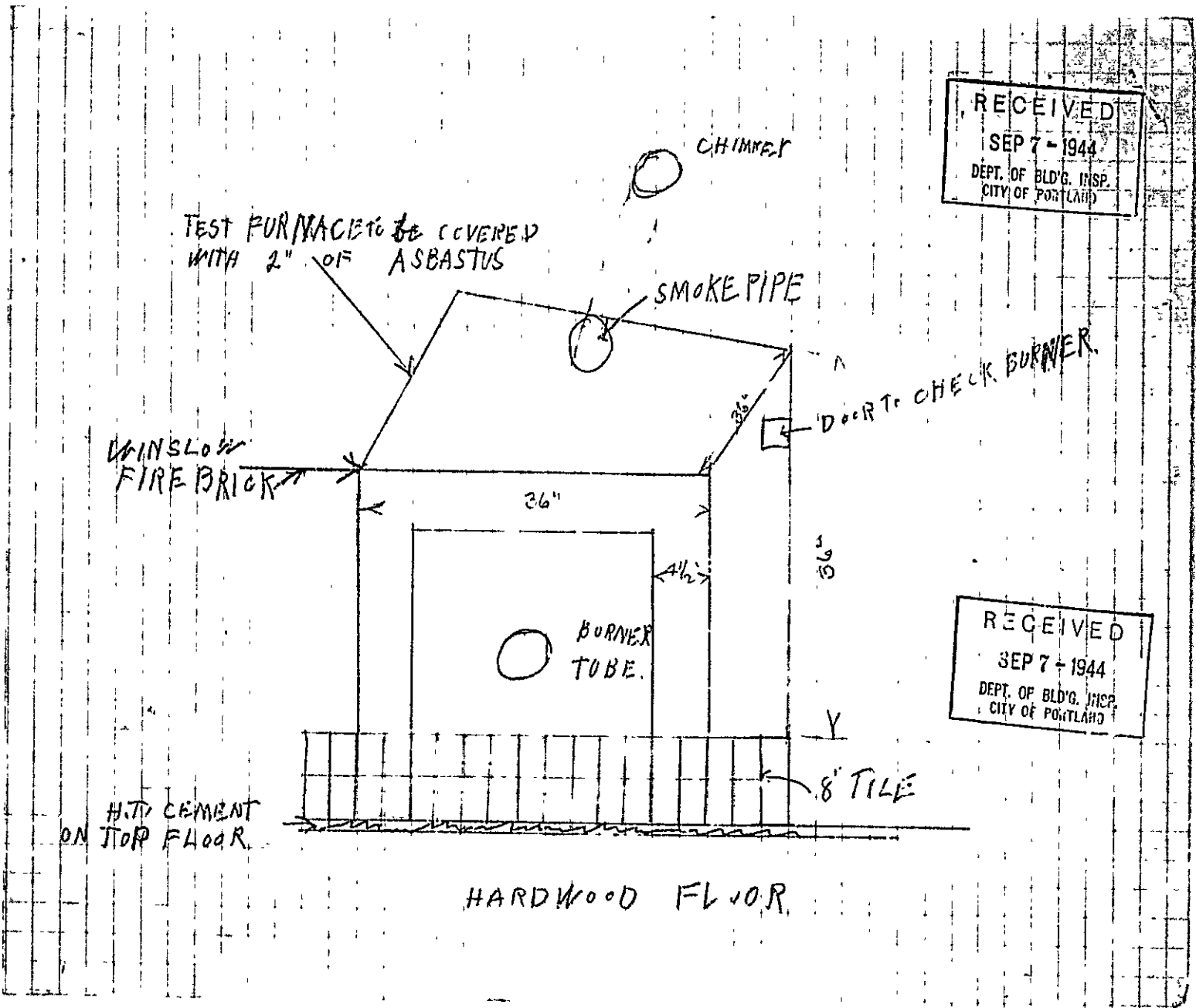

RECEIVED
 SEP 7 - 1944
 DEPT. OF BLD'G. INSP.
 CITY OF PORTLAND

RECEIVED
 SEP 7 - 1944
 DEPT. OF BLD'G. INSP.
 CITY OF PORTLAND

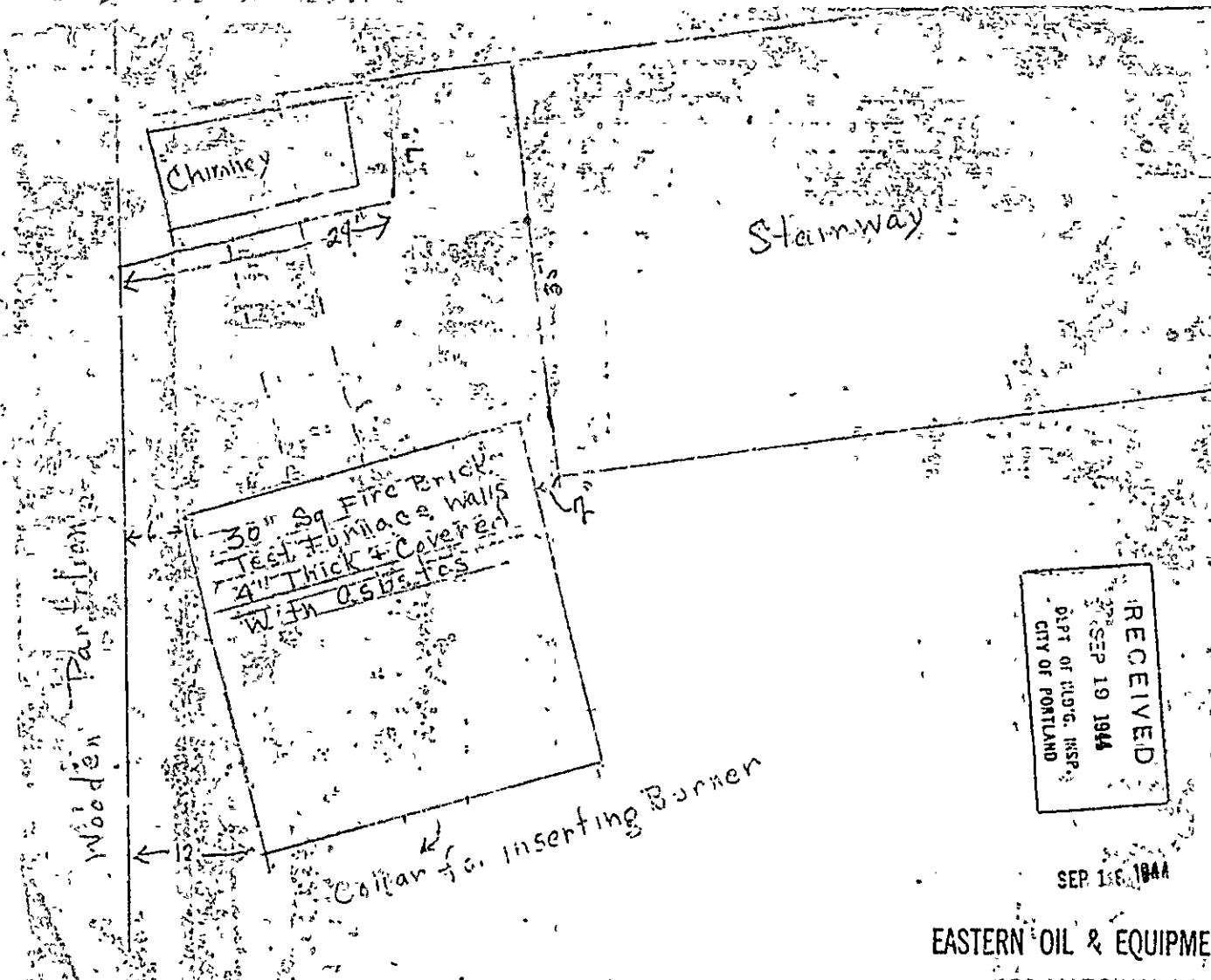

Test furnace is composed of 4" fire brick, mounted on 8" hollow
 tile blocks and covered with 2" Asbestos cement boiler
 covering. Burners are run about 10 minutes and a man
 is always in attendance.

RECEIVED
 SEP 19 1944
 DEPT. OF BLDG. INSP.
 CITY OF PORTLAND

SEP 16 1944

EASTERN OIL & EQUIPMENT CO.
 133 MARGINAL WAY
 PORTLAND, MAINE

Permit No. 44/934

Location 27 Portland St.

Owner Eastern Oil & Equip Co.

Date of Permit 9/21/44

Post Card sent

Notif. for insp. 1-5-49 P.M.

Approval Tag Issued NOT COMPLETED

Oil Burner Check List (date)

- 1. Kind of heat
- 2. Label
- 3. Anti-siphon
- 4. Oil storage
- 5. Tank Distance
- 6. Vent Pipe
- 7. Fill Pipe
- 8. Gauge
- 9. Rigidity
- 10. Feed safet,
- 11. Pipe sizes and material
- 12. Control valve
- 13. Ash pit vent
- 14. Temp. or pressure safety
- 15. Instruction card
- 16.

NOTES

9/21/44 this burner is practically
 built to the size (8") from
 the kind of material used in the

and connected to the
 main of water and
 with each burner will
 have its own safety

1-5-49. Times of
 additional inspections
 P.M.

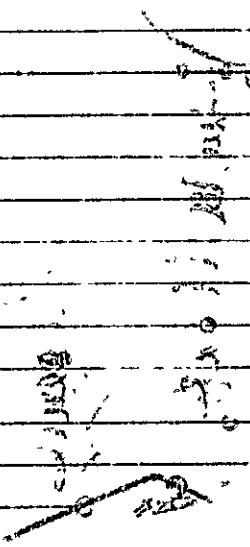



FILL IN COMPLETELY AND SIGN WITH INK

PERMIT ISSUED

Permit No. 1152
NOV 16 1943

APPLICATION FOR PERMIT FOR HEATING, COOKING OR POWER EQUIPMENT

Portland, Maine, Oct. 11, 1943

To the INSPECTOR OF BUILDINGS, PORTLAND, ME.

The undersigned hereby applies for a permit to install the following heating, cooking or power equipment in accordance with the Laws of Maine, the Building Code of the City of Portland, and the following specifications:

Location 27 Portland St Use of Building Store No. Stories Existing
Name and address of owner of appliance Eastern Oil & Equipment Co.,
Installer's name and address Same Telephone 3-6495

General Description of Work

To install Eastern Oil Burner With 275 Gallon Tank

IF HEATER, POWER BOILER OR COOKING DEVICE

Is appliance or source of heat to be in cellar? Yes If not, which story _____ Kind of Fuel _____
Material of supports of appliance (concrete floor or what kind) Concrete Floor
Minimum distance to wood or combustible material, from top of appliance or casing top of furnace, _____
from top of smoke pipe _____ from front of appliance _____ from sides or back of appliance _____
Size of chimney flue _____ Other connections to same flue _____

IF OIL BURNER

Name and type of burner Eastern Oil Labeled and approved by Underwriters' Laboratories? Yes
Will operator be always in attendance? _____ Type of oil feed (gravity or pressure) Gravity
Location oil storage Basement No. and capacity of tanks 1 275 gal
Will all tanks be more than seven feet from any flame? Yes How many tanks fireproofed? _____

Amount of fee enclosed? _____ (\$1.00 for one heater, etc., 50 cents additional for each additional heater, etc., in same building at same time.)

ASSESSOR'S COPY

Signature of Installer

John W. West

NOTIFICATION BY UNDERWRITERS' LABORATORIES OR CLOSING IS WAIVED

Permit No. 431161

Location 27 Portland St.

Owner Eastern Pk Equip Co.

Date of Permit 11/16/43.

Post Card sent

Notif. for insp.

Approval Fee issued 4.25/45 Pinc

Warm Air Heater 43/104

Oil Burner Check List (date)

1. Kind of heat
2. Label
3. Anti-siphon
4. Oil storage
5. Tank Distance
6. Vent Pipe
7. Fill Pipe
8. Gauge
9. Rigidity
10. Feed safety
11. Pipe sizes and material
12. Control valve
13. Ash pit vent
14. Temp. or pressure safety
15. Instruction card
- 16.

NOTES

11/22/43 installation
 completed.
 1/26/45 C. Brown, and

asbestos, had been
 put around registers
 and around pipe
 to immediate station
 even up. T. J. Duf



FILL IN COMPLETELY AND SIGN WITH INK

Permit No. 0-24

AUG 16 1943

APPLICATION FOR PERMIT FOR HEATING, COOKING OR POWER EQUIPMENT

To the INSPECTOR OF BUILDINGS, PORTLAND, ME.

Portland, Maine.

The undersigned hereby applies for a permit to install the following heating, cooking or power equipment in accordance with the Laws of Maine, the Building Code of the City of Portland, and the following specifications:

Location 27 Portland St. Use of Building Store No. Stories 2 New Building Existing

Name and address of owner of appliance Peter W. T. Thomas

Installer's name and address Portland Stove Foundry Co Telephone 33864

General Description of Work

Memorandum from Department of Building Inspection, Portland, Maine

27 Portland Street - Installation of warm air furnace and heating system for Peter W. Thomas by Portland Stove Foundry Company - - 8/16/43
To Owner and Installer:

Application gives this chimney as having an 8x8 flue and says that there is a stove connection beside the proposed heater connection. The Building Code forbids any other connection to a flue to which a heater is connected unless approved by the Inspector. I have talked with Mr. Thomas who is in considerable doubt as to whether or not there is actually any other connection to this flue than the proposed connection of the furnace. At any rate, I am approving the situation, even if there is another connection, but with the understanding that the owner takes full responsibility for the result and should inadequate draft occur or any condition developing toward fire hazard, the owner will immediately make them good. If there is not a cast iron clean-out door and frame at the bottom flue, then one should be installed and the flue thoroughly cleaned out.

(Signed) Warren McDonald
Inspector of Buildings

Amount of fee enclosed? (\$1.00 for one heater, etc., 50 cents additional for each additional heater, etc., in same building at same time.)

INSPECTION COPY

Signature of Installer Portland Stove Foundry Co

Per W. K. Thomas



FILL IN COMPLETELY AND SIGN WITH INK

Permit No. 1094

AUG 18 1943

APPLICATION FOR PERMIT FOR HEATING, COOKING OR POWER EQUIPMENT

Portland, Maine, _____

To the INSPECTOR OF BUILDINGS, PORTLAND, ME.

The undersigned hereby applies for a permit to install the following heating, cooking or power equipment in accordance with the Laws of Maine, the Building Code of the City of Portland, and the following specifications:

Location 27 Portland St. Use of Building Store No. Stories 2 New Building Existing "

Name and address of owner of appliance Peter M. P. Pinnis

Installer's name and address Portland Store Fidelity Co Telephone 33864

General Description of Work

install Coal burning Warm Air System

IF HEATER, POWER BOILER OR COOKING DEVICE

Is appliance or source of heat to be in cellar? yes If not, which story _____ Kind of Fuel Coal

Material of supports of appliance (concrete floor or what kind) concrete

Minimum distance to wood or combustible material, from top of appliance or casing top of furnace, 1-9"

from top of smoke pipe 10" shield provided from front of appliance 4 ft from sides or back of appliance 3 ft

Size of chimney flue 8 x 8 Other connections to same flue one on second floor

IF OIL BURNER INSPECTION NOT COMPLETE

Name and type of burner _____ Labeled and approved by Underwriters' Laboratories? _____

Will operator be always in attendance? _____ Type of oil feed (gravity or pressure) _____

Location oil storage _____ No. and capacity of tanks _____

Will all tanks be more than seven feet from any flame? _____ How many tanks fireproofed? _____

Amount of fee enclosed? _____ (\$1.00 for one heater, etc., 50 cents additional for each additional heater, etc., in same building at same time.)

Signature of Installer P. M. Pinnis

INSPECTION COPY

Permit No. 43) 784
 Location 27 Portland St.
 Owner Peter N. Thims
 Date of Permit 8/16/43
 Post Card sent
 Notification NOT COMPLETE

Approval Tag issued 1-5-49 RW
 Oil Burner Check List (date) 1-5-49 RW

1. Kind of heat
2. Label
3. Anti-siphon
4. Oil storage
5. Tank distance
6. Vent Pipe
7. Fill Pipe
8. Gauge
9. Rigidity
10. Feed safety
11. Pipe sizes and material
12. Control valve
13. Ash pit vent
14. Temp. or pressure safety
15. Instruction card
- 16.

NOTES

8/26/43 could not get in
 11/13/43. This installation
 has not been inspected
 over

whether has it been in
 use yet. The situation
 is not good. The chimney
 has a run of about 25'
 and then has to go up
 an offset false due to
 the chimney being
 corbelled out & above the
 foundation. The separate
 boxes should be covered
 with 14" asbestos where
 against the flooring. A
 shield should be provided
 where chimney is 10"
 below a window. The
 inspector will take
 these matters up with
 Mr. Thims

There is a chimney
 much closer to this heater
 but it stops at the first floor.
 I understand Eastern will
 say you had told Mr. Thims
 that due to conditions, it
 would be difficult to carry
 it down. etc

1-5-49 lack of thorough
 factory inspection
 RW



FILL IN COMPLETELY AND SIGN WITH INK

PERMIT ISSUED

Permit No. 1045

APPLICATION FOR PERMIT FOR HEATING, COOKING OR POWER EQUIPMENT

To the INSPECTOR OF BUILDINGS, PORTLAND, ME.

Portland, Maine, October 15, 1943

The undersigned hereby applies for a permit to install the following heating, cooking or power equipment in accordance with the Laws of Maine, the Building Code of the City of Portland, and the following specifications:

Location 21 Portland Street Use of Building Tailor Shop No. Stories 3 New-Dwelling Existing "
Name and address of owner of appliance S. Fineberg, 21 Portland Street
Installer's name and address J. E. Coughlin, 28 Gilman Street Telephone 2-2941

General Description of Work

To install gas fired boiler for pressing machine - Burner has device for automatically shutting off gas supply in case automatic heat control demands heat and the supp' of gas fails to ignite

IF HEATER, POWER BOILER OR COOKING DEVICE

O.K. 10/16/43. J.E.C.

Is appliance or source of heat to be in cellar? 1st If not, which story Kind of Fuel gas

Material of supports of appliance (concrete floor or what kind) wood 6" above floor hollow tile will be provided

Minimum distance to wood or combustible material, from top of appliance or casing top of furnace, 9'

from top of smoke pipe 7' from front of appliance 10' from sides or back of appliance 2'

Size of chimney flue 12x14 Other connections to same flue possibly two stoves insulated jacket

IF OIL BURNER

Name and type of burner Labeled and approved by Underwriters Laboratories

Will operator be always in attendance? Type of oil feed (gravity or pressure)

Location oil storage No. and capacity of tanks

Will all tanks be more than seven feet from any flame? How many tanks fireproofed?

Amount of fee enclosed? 1.00 (\$1.00 for one heater, etc., 50 cents additional for each additional heater, etc., in same building at same time.)

INSPECTION COPY

Signature of Installer J. E. Coughlin

3936D

Permit No. 43/1045

Location 21 Portland St.

Owner S. Fineberg

Date of Permit 10/16/48

Post Card sent _____

Notif. for insp. _____

Approval Exp. issued 12-21-44 Print

Oil Burner Check List (date) _____

1. Kind of heat _____
2. Label _____
3. Anti-siphon _____
4. Oil storage _____
5. Tank Distance _____
6. Vent Pipe _____
7. Fill Pipe _____
8. Gauge _____
9. Rigidity _____
10. Feed safety _____
11. Pipe sizes and material _____
12. Control valve _____
13. Ash pit vent _____
14. Temp. or pressure safety _____
15. Instruction card _____
16. _____

NOTES

CHANGE NUMBER THREE

RECEIVED
JUL 13 1943
DEPT. OF BLDG. INSP.
CITY OF PORTLAND

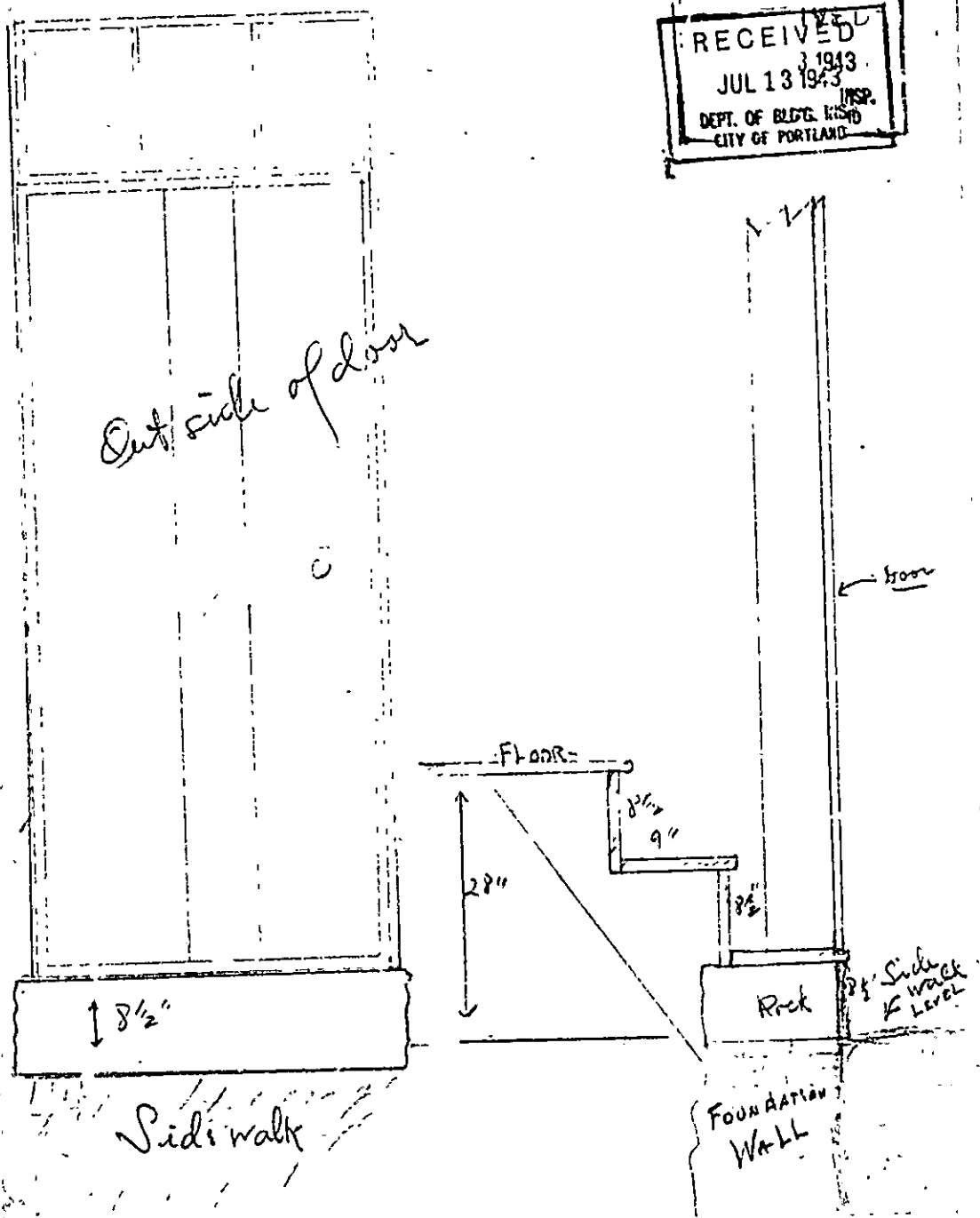



GENERAL BUSINESS ZONE
APPLICATION FOR PERMIT

Class of Building or Type of Structure Second Class Permit No. _____

Portland, Maine, June 22, 1943

To the INSPECTOR OF BUILDINGS, PORTLAND, ME.

The undersigned hereby applies for a permit to erect alter install the following, building structure equipment in accordance with the laws of the State of Maine, the Building Code of the City of Portland, plans and specifications, if any, submitted herewith and the following specifications:

Location 27 Portland Street Within Fire Limits? yes Dist No. 1

Owner's or Lessee's name and address W. D. N. Thins, 7 1/2 Pitt Street Telephone _____

Contractor's name and address Jehovah Witnesses, 27 Portland St. Telephone _____

Architect _____ Plans filed yes No. of sheets 2

Proposed use of building 1st floor Assembly Hall and Tenement and Stores No. families _____

Other buildings on same lot _____

Estimated cost \$ _____ Fee \$.50

Description of Present Building to be Altered

Material brick No. stories 3 Heat _____ Style of roof _____ Roofing _____

Last use Tire Repair Shop, tenement and stores No. families _____

General Description of New Work

To Obtain Use of first floor from tire repair shop to Minor Assembly Hall, as per plans

This hall to accommodate approximately 50 persons.

It is understood that this permit does not include installation of heating apparatus which is to be taken out separately by and in the name of the heating contractor.

Details of New Work

Is any plumbing work involved in this work? _____

Is any electrical work involved in this work? _____ Height average grade to top of plate _____

Size, front _____ depth _____ No. stories _____ Height average grade to highest point of roof _____

To be erected on solid or filled land? _____ earth or rock? _____

Material of foundation _____ Thickness, top _____ bottom _____ cellar _____

Material of underpinning _____ Height _____ Thickness _____

Kind of roof _____ Rise per foot _____ Roof covering _____

No. of chimneys _____ Material of chimneys _____ of lining _____

Kind of heat _____ Type of fuel _____ Is gas fitting involved? _____

Framing lumber—Kind _____ Dressed or full size? _____

Corner posts _____ Sills _____ Girt or ledger board? _____ Size _____

Material columns under girders _____ Size _____ Max. on centers _____

Studs (outside walls and carrying partitions) 2x4-16" O. C. Girders 6x8 or larger. Bridging in every floor and flat roof span over 8 feet. Sills and corner posts all one piece in cross section.

Joists and rafters: 1st floor _____, 2nd _____, 3rd _____, roof _____

On centers: 1st floor _____, 2nd _____, 3rd _____, roof _____

Maximum span: 1st floor _____, 2nd _____, 3rd _____, roof _____

If one story building with masonry walls, thickness of walls? _____ height? _____

If a Garage

No. cars now accommodated on same lot _____, to be accommodated _____

Total number commercial cars to be accommodated _____

Will automobile repairing be done other than minor repairs to cars habitually stored in the proposed building? _____

Miscellaneous

Will above work require removal or disturbing of any shade tree on a public street? yes

Will there be in charge of the above work a person competent to see that the State and City requirements pertaining thereto are observed? yes

Signature of owner by: P. N. Thins
Jehovah Witnesses

INSPECTION COPY

3462 PH

Permit No 43/

Location 27 Portland Street

Owner P. H. Thoms

Date of permit 6/ 143

Notif. closing-in

Insp. closing-in

Final Notif.

Final Inspn.

Cert. of Occupancy issued

NOTES

7/7/43 - met Mr. Gorch at this location. He has been advised that removal of door between rooms as small one is to be used for office; would accept limit of 10 ft on 50' on large room thus allowing front door to rest door to swing in & tell the problem of getting exit door down to grade of sidewalk - work.

Present: 11/10 - 2 + 27 1/2
Showing time 20 - 30
Pratt 54 4 20 - 5 1/2

What size in column?
H-94

RECEIVED
JUN 14 1943
DEPT. OF BLDG. INSP.
CITY OF PORTLAND

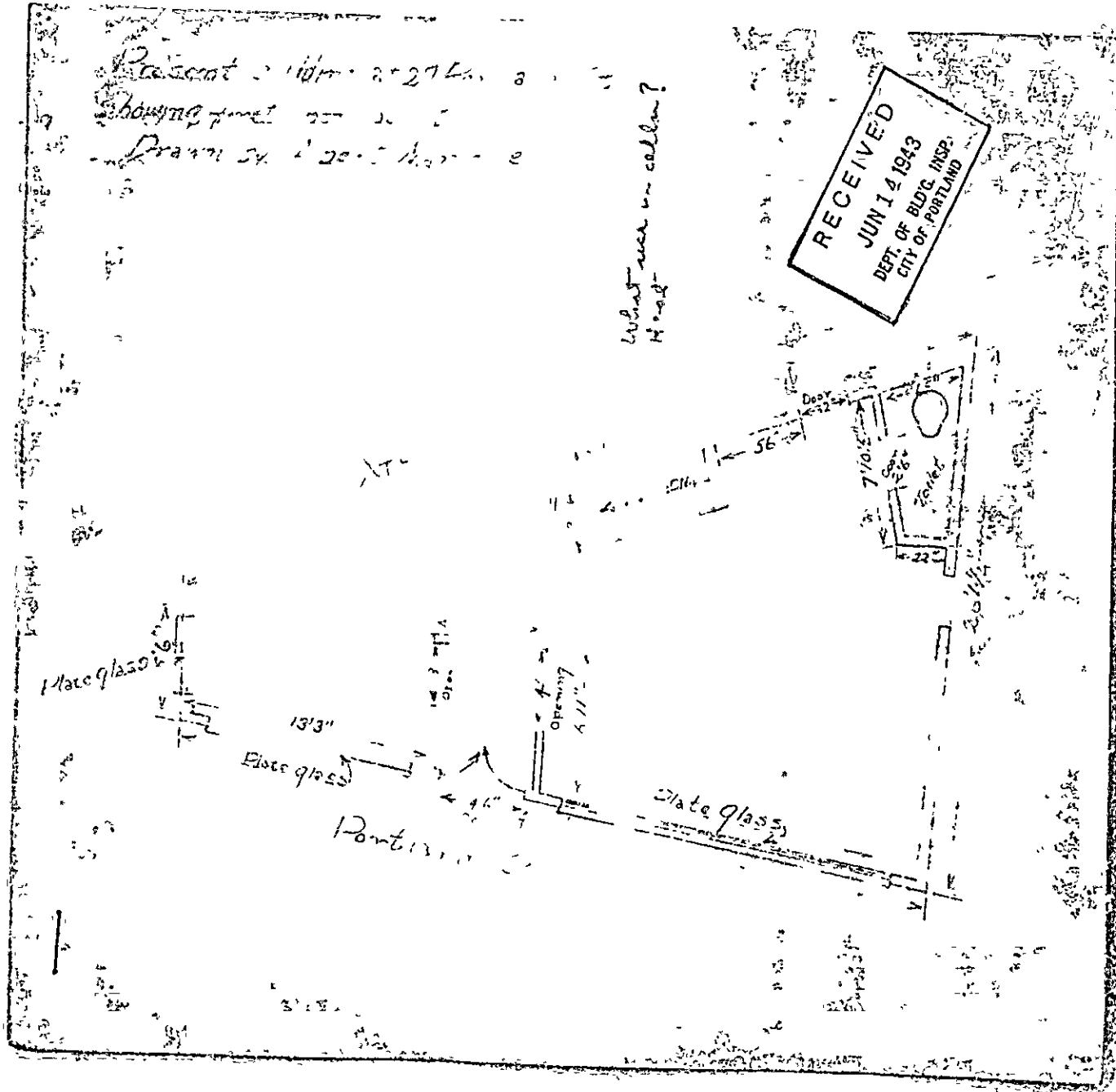

Present building at 27 - Wetland St.
Showing of Sill Construction
Designed by Albert Marcell

RECEIVED
JUN 14 1943
DEPT. OF BLDG. INSP.
CITY OF PORTLAND

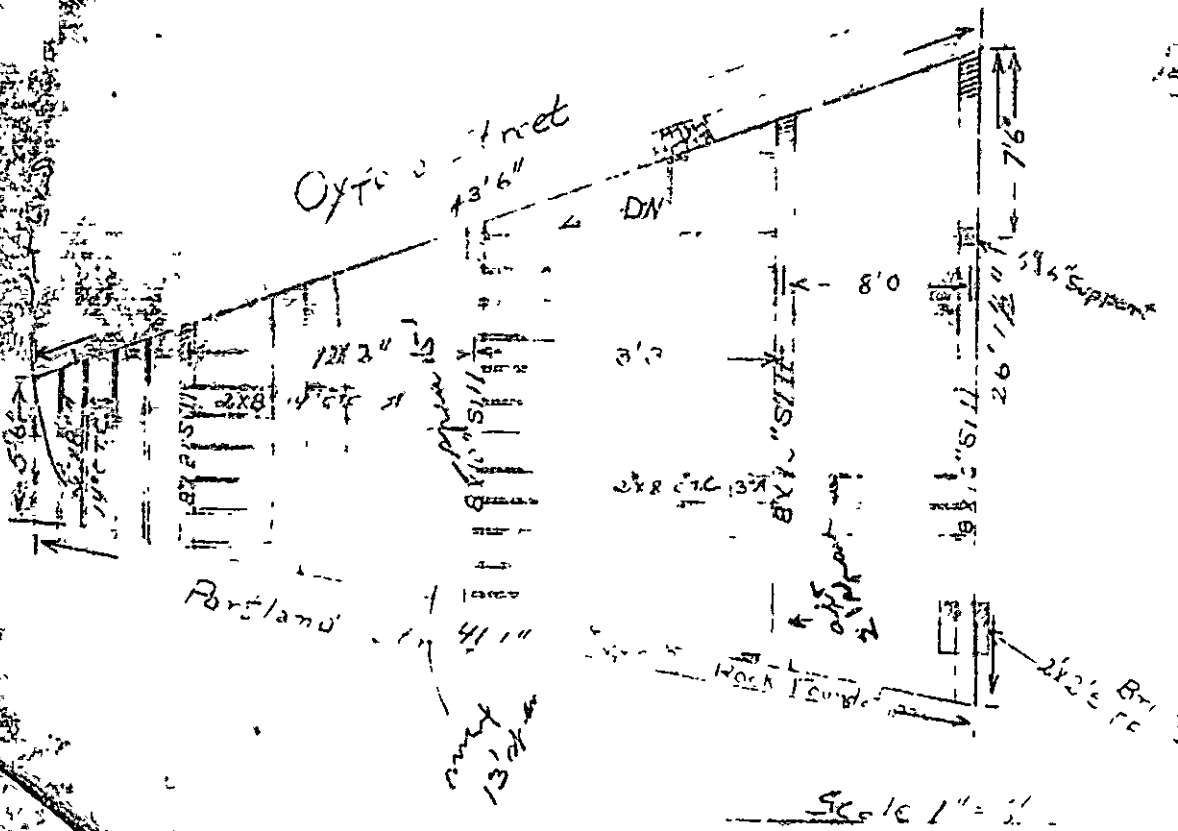



APPLICATION FOR PERMIT PERMIT ISSUED

Class of Building or Type of Structure _____

2157

DEC 14 1938

Portland, Maine, December 16, 1938

To the INSPECTOR OF BUILDINGS, PORTLAND, ME.

The undersigned hereby applies for a permit to erect alter install the following building structure equipment, in accordance with the Laws of the State of Maine, the Building Code of the City of Portland, plans and specifications, if any, submitted herewith and the following specifications:

Location 260 Oxford Street Within Fire Limits? Yes Dist. No. 1
 Owner's or Lessee's name and address John Donnelly & Sons, 73 Main St., So. Portland Telephone 2-2709
 Contractor's name and address _____ Telephone _____
 Architect _____ Plans filed _____ No. of sheets _____
 Proposed use of building _____ No. families _____
 Other buildings on same lot _____
 Estimated cost \$ _____ Fee \$ 1.25
Description of Present Building to be Altered
 Material _____ No. stories _____ Heat _____ Style of roof _____ Roofing _____
 Last use _____ No. families _____

General Description of New Work

To remove 12' x 25 wall panel

Owner of property Alice M. McAlpine

It is understood that this permit does not include installation of heating apparatus which is to be taken out separately by and in the name of the heating contractor.

Details of New Work

Height average grade to top of plate _____

Size, front _____ depth _____ No. stories _____ Height average grade to highest point of roof _____

To be erected on solid or firm land? _____ earth or rock? _____

Material of foundation _____ Thickness, top _____ bottom _____ cellar _____

Material of underpinning _____ Height _____ Thickness _____

Kind of Roof _____ Rise per foot _____ Roof covering _____

No. of chimneys _____ Material of chimneys _____ of lining _____

Kind of heat _____ Type of fuel _____ Is gas fitting involved? _____

Framing Lumber—Kind _____ Dressed or Full Size? _____

Corner posts _____ Sills _____ Girt or ledger board? _____ Size _____

Material columns under girders _____ Size _____ Max. on centers _____

Studs (outside walls and carrying partitions) 2x4-16" O. C. Girders 6x8 or larger. Bridging in every floor and flat roof span over 8 feet. Sills and corner posts all one piece in cross section.

Joists and rafters: 1st floor _____, 2nd _____, 3rd _____, roof _____

On centers: 1st floor _____, 2nd _____, 3rd _____, roof _____

Maximum span: 1st floor _____, 2nd _____, 3rd _____, roof _____

If one story building with masonry walls, thickness of walls? _____ height? _____

If a Garage

No. cars now accommodated on same lot _____, to be accommodated _____

Total number commercial cars to be accommodated _____

Will automobile repairing be done other than minor repairs to cars habitually stored in the proposed building? _____

Miscellaneous

Will above work require removal or disturbing of any shade tree on a public street? No

Will there be in charge of the above work a person competent to see that the State and City requirements pertaining thereto are observed? Yes

John Donnelly & Sons

Signature of owner J. A. Donnelly

INSPECTION COPY

2157



PERMIT ISSUED

APPLICATION FOR PERMIT TO REPAIR BUILDING 1727

Second Class Building

OCT 12 1938

Portland, Maine, October 12, 1938

To the INSPECTOR OF BUILDINGS, PORTLAND, ME.

The undersigned hereby applies for a permit to repair the following described building in accordance with the Laws of Maine, the Building Code of the City of Portland, and the following specifications:

Location 27 Portland Street Ward 4 Within fire limits? yes Dist. No. 1
Owner's name and address Portland Savings Bank, 485 Congress St. Telephone
Contractor's name and address A. E. Vickerson, Cape Cottage Telephone 2-7809
Use of building Tire Repair
No. stories 8 Height ft., Gross area sq. ft., Style of roof
Type of present roof covering

General Description of New Work

To Repair after Fire to former condition. No alterations
(Cause - overheated stove, 1st floor)

CERTIFICATE OF COMPLIANCE
REQUIREMENT IS WANTED

If Roof Covering is to be Repaired or Renewed

When last repaired? Area then repaired sq. ft.
Are repairs or renewal due to damage by fire? yes If so, what area damaged? sq. ft.
Area of roof to be repaired now? sq. ft.
Type of roofing to be used No. plies
Trade name and grade of roof covering to be used
Estimated cost \$ 290. Portland Savings Bank Fee \$.75

INSPECTION COPY

Signature of owner By

A. E. Vickerson

1727

Ward 4 Permit No. 36/1727.1
Location 27 Portland St.
Owner Portland Savings Bank
Date of permit 10/12/36.
Notif. closing-in
Inspn. closing-in
Final Notif. None
Final Inspn. 10/21/36. O.K.
Cert. of Occupancy issued None

NOTES

On his report as given as
defective chimney
10/13/36, chimney starts
at street floor and is
built in outside wall.
Has opening at bottom
for cleanout door -
being now against
chimney it to be re-
moved and studded
around studs to be 1"
from chimney. Collar
12" dia to be used
where smoke pipe
enters chimney. O.K.
10/21/36. This work about
done. Chimney left for
access to cleanout door.
O.K.



Application for Permit for Alterations and Miscellaneous Structures

CLASS OF BUILDING OR TYPE OF STRUCTURE 1st

To the INSPECTOR OF BUILDINGS, PORTLAND, ME July 12, 1926 19

The undersigned hereby applies for a permit to alter the following described building according to the following specifications, the Laws of the State of Maine, and the Building Ordinances of the City of Portland:

Location 27 Portland Street Ward 4 Within Fire Limits? no

Owner's name and address? William Bronner, 20 Exchange Street

Contractor's name and address? Charles B. Hovatt & Son, 193 Exchange Street

Architect's name and address? _____

Last use of building? vulcanizing shop No. Families? _____

Proposed use of building? vulcanizing shop No. Families? _____

Description of Present Building

Material brick No. of Stories 2 Style of Roof flat Roofing T & G

General Description of New Work

Cut in doorway in outside wall in place of window

NOTIFICATION
before
LATHING OR CL
is
WAIVED

Size of New Framing Members

Corner posts? _____ Sills? _____ Rafters or roof beams? _____ on center? _____

Material and size of columns under girders? _____ on center? _____

Ledger board used? _____ Size? _____ Studs (outside walls and carrying partitions) 2 x 4 16" O. C.

Girders 6" x 8" or larger. Bridging in every floor and flat roof span over 8 feet. Sills and corner posts will be all one piece in cross section.

Floor timbers: 1st floor _____, 2nd _____, 3rd _____, 4th _____

On centers: 1st floor _____, 2nd _____, 3rd _____, 4th _____

Span: 1st floor _____, 2nd _____, 3rd _____, 4th _____

If 1st or 2nd Class Construction

External walls } thickness { 1st story _____, 2nd story _____
Party walls } 1st story _____, 2nd story _____

Other Details New Construction

To be erected on solid or filled land? _____ earth or rock? _____

Material of foundation? _____ Thickness, top? _____ bottom? _____

Material of underpinning? _____ over 4 ft. high? _____ thickness? _____

Kind of roof (pitch, hip, etc.)? _____ Kind of roofing? _____

No. of new chimneys? _____ Material of chimneys? _____ of lining? _____

If a Private Garage

No. cars now accommodated on lot? _____ Total number to be accommodated? _____

Other buildings on same lot? _____

Distance from nearest present building to proposed garage? _____

All parts of garage, including eaves, will be at least 2 ft. from all lot lines.

Garage will be at least _____ feet from nearest windows of adjoining property.

Miscellaneous

Will the above construction require the removal or disturbing of any shade tree on the public street? no

Plans filed as part of this application? no No. sheets? _____

Estimated total cost \$ 50. Fee? .50

Signature of owner or authorized representative? _____

4 #26/689

27 Portland Street
William Dussac

July 12/1926. X

AMC $\frac{12}{30}$
 $\frac{26}{26}$

W. H. P.
P. M. C.
P. M. C.



Location, Ownership and detail must be correct, complete and legible.
 Separate application required for every building.
 Plans must be filed with this application.

Application for Permit for Alterations, etc.

Portland, June 27th, 12. 191

To the
 INSPECTOR OF BUILDINGS:

The undersigned applies for a permit to alter the following-described building:—

Location, Portland 17-19-21 Wd. 4
 Name of owner is? X. Geo. E. Macgowan Address, Eastern Prom 176
 Name of mechanic is? L. E. Strout
 Name of architect is? _____
 Material of building is? Brick Style of roof? Flat Material of roofing? Tar p
 Size of building, feet front? _____ ; feet rear? _____ ; feet deep? _____ ; No. of stories? _____
 Size of L, feet long? _____ ; feet wide? _____ ; feet high? _____ ; No. of storeis? _____ ; roof? _____
 No. of feet in height from sidewalk to highest point of roof? _____ Material of foundation? _____
 Thickness of external walls? _____ Party walls? _____ Distance from line of street? _____ Width of street? _____
 What was the building last used for? _____ How many families? _____ Number of stores? _____
 Nature of egress? _____
 Building to be occupied for _____ Size of lot front? _____ ; rear? _____ ; deep? 5500
 after alteration. Estimated cost? _____

PERMIT MUST BE OBTAINED BEFORE BEGINNING WORK.

DETAIL OF PROPOSED WORK.

To add one story to part of building and to re-build that part that is now wood in brick; to make general alterations and repairs.

IF EXTENDED ON ANY SIDE.

Size of extension, No. of feet long? _____ ; No. of feet wide? _____ ; No. of feet high above sidewalk? _____
 No. of stories high? _____ ; style of roof? _____ ; material of roofing? _____
 Of what material will the extension be built? _____ Foundation? _____
 If of brick, what will be the thickness of external walls? _____ inches; and party walls _____ inches.
 How will the extension be occupied? _____ How connected with main building? _____
 Distance from lot lines.— Front? _____ ; side? _____ ; side? _____ ; rear? _____

WHEN MOVED, RAISED OR BUILT UPON.

Number of stories in height when moved, raised or built upon? _____ Proposed foundations? _____
 Number of feet high from level of ground to highest part of roof to be? _____
 Distance back from line of street? _____ Distances from lot lines when moved? _____
 Distance from next buildings when moved? _____ ; front? _____ ; side? _____ ; side? _____ ; rear? _____
 How many feet will the external walls be increased in height? _____ Party walls? _____

IF ANY PORTION OF THE EXTERNAL OR PARTY WALLS ARE REMOVED.

Will an opening be made in the party or external walls? _____ in _____ story.
 Size of the opening? _____ How protected? _____
 How will the remaining portion of the wall be supported? _____

Signature of owner or
 authorized representative,

Address,



17-21 Portland St.

17-27

FINAL REPORT.

191 .

Has the work been completed in accordance with this application and plans filed and approved?

Law been violated? . Doc. No. of 191 .

Nature of violation?

PERMIT GRANTED.

6-27-1912

Permit filled out by J. L. C.

Permit number 3930 A.

Location Portland St.

Violation removed when? 191 .

Estimated cost of alterations, etc., \$.

Inspector of Buildings.



OFFICE HOURS
10 TO 12 M
4 TO 5 P. M.

City of Portland.

OFFICE OF INSPECTOR OF BUILDINGS

3574

To the Inspector of Buildings of the City of Portland: 191

The undersigned respectfully makes application for a permit to erect enlarge a building on..... street, at number..... to be..... stories high..... feet long; 2.17 feet wide; also an addition to be..... stories high, feet long..... feet wide, and to be used as a.....

CELLAR WALL To be constructed of..... to be..... inches wide on bottom and batter to..... inches on top.

UNDERPINNING—To be..... Height of underpinning from top of cellar wall to bottom of sill.....ft.....inches to be..... inches in thickness.

EXTERIOR WALLS—To be constructed of..... If of Brick, Stone, etc. Total length of wall.....ft.....inches. Thickness of 1st..... 2d..... 3d..... 4th..... 5th..... 6th..... story walls. If of reinforced concrete state mix and reinforcing system to be used.

If wood construction, sills to be..... Girders..... Posts..... Girts..... Studs..... to be spaced..... This building will be used for the purposes of..... (If for apartments, tenements, or other family uses state number of families accommodated and number on each floor. If for manufacturing or mercantile purposes state character of business and amount of estimated weight to be carried by the floor.) Number of families on floor..... Total number of families..... Manufacturing (state character)..... Estimated load on floors per sq. ft..... Mercantile business (state character and load per sq. ft.).....

If building is used for tenement house or family use and more than one family, the following provisions or the Building Laws regarding dividing partitions shall be adhered to (Quote Law re. this).

FIRESTOPS—All bearing and center partitions will have firestops cut in tight on top of each partition cap and between each set of floor timbers. Where ledger boards are used there shall be firestops cut in tight against bottom of ledger boards, of same size as wall studs. Also wherever the Inspector of Buildings may consider necessary.

STAIRWAYS—No. in building..... location..... to be enclosed with..... walls to be lathed with..... lathing.

ROOF—To be constructed of..... Rafters to be..... inches to be spaced..... inches on centers. Roof to be covered with.....

Gutters to be made of..... Cornices to be made of..... Bay windows to be made of..... to be covered with..... Dormer Windows to be made of..... to be covered..... Chimneys, Smoke flues to be lined with..... and provided with a 10 inch outside collar and an inside collar to go to the inside of the flue.....

Estimated Cost of Building

INSPECTION—The Inspector of Buildings is to be notified when building is ready for lathing and at least 24 hours before the lathing is begun.

The Builder is..... Address.....

The Architect is..... Address.....

The Owner is..... Address.....

No Deviation will be made from the above application without written permission from the Inspector of Buildings.

The above petition was granted the..... day of..... 191

(Applicant to sign here

3514

NO. ~~H-9-H~~

11-9-11

1929

LOCATION

25 Portland St.

J. P. Gaster

Remarks

Info 11-13-11

11-17-11

11-21-11

11-29-11

12-7-11

DATE OF FINAL INSPECTION 12/7/12



APPLICATION FOR PERMIT
DEPARTMENT OF BUILDING INSPECTIONS SERVICES
ELECTRICAL INSTALLATIONS

Date 4/4/85, 19__
 Receipt and Permit number 01677

To the CHIEF ELECTRICAL INSPECTOR, Portland, Maine:

The undersigned hereby applies for a permit to make electrical installations in accordance with the laws of Maine, the Portland Electrical Ordinance, the National Electrical Code and the following specifications:

LOCATION OF WORK: 17 Portland Street - Work on Oxford St. Side
 OWNER'S NAME: Bill Harris ADDRESS: same

OUTLETS:
 Receptacles _____ Switches _____ Plugmold _____ ft. TOTAL 1-30
 FIXTURES: (number of)
 Incandescent 2 Fluorescent 4 (not strip) TOTAL 6
 Strip Fluorescent _____ ft. _____

FEES	
✓	13.00
✓	3.00

SERVICES:
 Overhead x Underground _____ Temporary _____ TOTAL amperes 100
 METERS: (number of) 1 _____ TOTAL 3.00
 MOTORS: (number of) _____ TOTAL .50
 Fractional _____
 1 HP or over _____

RESIDENTIAL HEATING:
 Oil or Gas (number of units) _____
 Electric (number of rooms) _____

COMMERCIAL OR INDUSTRIAL HEATING:
 Oil or Gas (by a main boiler) _____
 Oil or Gas (by separate units) _____
 Electric Under 20 kws _____ Over 20 kws _____

APPLIANCES: (number of)
 Ranges _____ Water Heaters _____
 Cook Tops _____ Disposals _____
 Wall Ovens _____ Dishwashers _____
 Dryers _____ Compactors _____
 Fans _____ Others (denote) _____
 TOTAL _____

MISCELLANEOUS: (number of)
 Branch Panels 1 _____
 Transformers _____
 Air Conditioners Central Unit _____
 Separate Units (windows) _____
 Signs 20 sq. ft. and under _____
 Over 20 sq. ft. _____
 Swimming Pools Above Ground _____
 In Ground _____
 Fire/Burglar Alarms Residential _____
 Commercial _____
 Heavy Duty Outlets, 220 Volt (such as welders) 30 amps and under _____
 over 30 amps _____
 Circus, Fairs, etc. _____
 Alterations to wires _____
 Repairs after fire _____
 Emergency Lights, battery _____
 Emergency Generators _____

FOR ADDITIONAL WORK NOT ON ORIGINAL PERMIT INSTALLATION FEE DUE: _____
 FOR REMOVAL OF A "STOP ORDER" (304-16.b) DOUBLE FEE DUE: _____
 TOTAL AMOUNT DUE: 10.50

INSPECTION:
 Will be ready on 4/4, 19__; or Will Call _____
 CONTRACTOR'S NAME: John Perry
 ADDRESS: 381 Danforth Street
 TEL.: _____
 MASTER LICENSE NO.: 3695 SIGNATURE OF CONTRACTOR: _____
 LIMITED LICENSE NO.: _____

INSPECTOR'S COPY — WHITE
 OFFICE COPY — CANARY
 CONTRACTOR'S COPY — GREEN



APPLICATION FOR PERMIT
DEPARTMENT OF BUILDING INSPECTIONS SERVICES
ELECTRICAL INSTALLATIONS

Date August 8 19 88
 Receipt and Permit number 79024

To the CHIEF ELECTRICAL INSPECTOR, Portland, Maine:

The undersigned hereby applies for a permit to make electrical installations in accordance with the laws of Maine, the Portland Electrical Ordinance, the National Electrical Code and the following specifications:

LOCATION OF WORK: 17 Portland, Street
 OWNER'S NAME: Bill Dowd ADDRESS: Same

	FEES
OUTLETS:	
Receptacles _____ Switches _____ Plugmold _____ ft. TOTAL <u>30</u>	3.00
FIXTURES: (number of)	
Incandescent <u>10</u> Fluorescent _____ (not strip) TOTAL <u>10</u>	3.00
Strip Fluorescent _____ ft.	
SERVICES:	
Overhead <u>X</u> Underground _____ Temporary _____ TOTAL amperes <u>200</u> ..	3.00
METERS: (number of) <u>13</u>	6.50
MOTORS: (number of)	
Fractional	
1 HP or over	
RESIDENTIAL HEATING:	
Oil or Gas (number of units)	
Electric (number of rooms)	
COMMERCIAL OR INDUSTRIAL HEATING:	
Oil or Gas (by a main boiler)	
Oil or Gas (by separate units)	
Electric Under 20 kws _____ Over 20 kws _____	
APPLIANCES: (number of)	
Ranges _____ <u>2</u> _____ Water Heaters _____	
Cook Tops _____ Disposals _____	
Wall Ovens _____ Dishwashers _____	
Dryers _____ Compactors _____	
Fans _____ Others (denote) _____	
TOTAL	3.00
MISCELLANEOUS: (number of)	
Branch Panels <u>4</u>	4.00
Transformers	
Air Conditioners Central Unit _____	
Separate Units (windows) _____	
Signs 20 sq. ft. and under _____	
Over 20 sq. ft. _____	
Swimming Pools Above Ground _____	
In Ground _____	
Fire/Burglar Alarms Residential _____	
Commercial _____	
Heavy Duty Outlets, 220 Volt (such as welders) 30 amps and under _____	
over 30 amps _____	
Circus, Fairs, etc.	
Alterations to wires	
Repairs after fire	
Emergency Lights, battery	
Emergency Generator	
FOR ADDITIONAL WORK NOT ON ORIGINAL PERMIT	INSTALLATION FEE DUE:
FOR REMOVAL OF A "STOP ORDER" (304-16.b)	DOUBLE FEE DUE:
	TOTAL AMOUNT DUE: 22.50

INSPECTION:

Will be ready on _____, 19__; or Will Call X

CONTRACTOR'S NAME: Richard L. Hannan

ADDRESS: 51 Lawn Ave. So. Portland, Maine 04106

TEL: 767-2471

MASTER LICENSE NO.: 2885 SIGNATURE OF CONTRACTOR: Richard L. Hannan

LIMITED LICENSE NO.: _____

INSPECTOR'S COPY — WHITE

OFFICE COPY — CANARY

ELECTRICAL INSTALLATIONS

Permit Number 298477

Location 1700 Parkview Blvd

Owner Blackburn Island

Date of Permit 8/11/88

Final Inspection [Signature]

By Inspector [Signature]

Permit Application Register Page No. 42

INSPECTIONS. Service 2-200 by [Signature]

Service called in 10/27/88

Closing-in 8/11/88 by [Signature]

PROGRESS INSPECTIONS: _____

DATE:	REMARKS:
8/11/88	Insulate Grounded Conductor needed for the Wires on 2nd & 3rd floors
	Grounded & Ungrounded conductors are reversed in the front panel on the 2nd & 3rd floors