

424-426 FORE STREET

SHAW-WALKER



CITY OF PORTLAND, MAINE
Department of Building Inspection

Certificate of Occupancy

LOCATION Rear 426 Fore Street

Issued to Robert Peverada

Date of Issue June 26, 1978

This is to certify that the building, premises, or part thereof, at the above location, built—altered—changed as to use under Building Permit No 78/42, has had final inspection, has been found to conform substantially to requirements of Zoning Ordinance and Building Code of the City, and is hereby approved for occupancy or use, limited or otherwise, as indicated below.

PORTION OF BUILDING OR PREMISES

APPROVED OCCUPANCY

1st FLOOR

Food Service

Limiting Conditions:

This certificate supersedes
certificate issued

Approved:

6-26-78
(Date)

Inspector

Mary Schmitt
[Signature]
Inspector of Buildings

Notice: This certificate identifies lawful use of building or premises, and ought to be transferred from owner to owner when property changes hands. Copy will be furnished to owner or lease for one dollar.



APPLICATION FOR PERMIT

PERMIT ISSUED

B.O.C.A. USE GROUP

0042

JAN 13 1978

B.O.C.A. TYPE OF CONSTRUCTION

ZONING LOCATION 13-3

PORTLAND, MAINE, 1-18-78

CITY OF PORTLAND

To the DIRECTOR OF BUILDING & INSPECTION SERVICES, PORTLAND, MAINE

The undersigned hereby applies for a permit to erect, alter, repair, demolish, move or install the following building, structure, equipment or change use in accordance with the Laws of the State of Maine, the Portland B O C A Building Code and Zoning Ordinance of the City of Portland with plans and specifications, if any, submitted herewith and the following specifications:

LOCATION R 426 Fore St.

1 Owner's name and address Robert Feverada- Fire District #1 [] #2 [] Telephone 773 1911
2 Lessee's name and address Telephone
3 Contractor's name and address Whalen Guimond-79 Sherwood St. Telephone 773-1915
4 Architect Specifications Plans No of sheets
Proposed use of building Food service No families
Last use Storage area No families
Material No stories Heat Style of roof Roofing
Other buildings on same
Estimated contractual cost \$ Fee \$ 5.00

FIELD INSPECTOR—Mr

GENERAL DESCRIPTION

This application is for @ 775-5451 Ext 234 To Change the Use from storage area to food service. Without alterations.
Dwelling
Garage
Masonry Bldg.
Metal Bldg.
Alterations
Demolitions
Change of Use
Other

Stamp of Special Conditions

NOTE TO APPLICANT Separate permits are required by the installers and subcontractors of heating, plumbing, electrical and mechanics

PERMIT IS TO BE ISSUED TO 1 [x] 2 [] 3 [] 4 []

Other:

DETAILS OF NEW WORK

Is any plumbing involved in this work? Is any electrical work involved in this work?
Is connection to be made to public sewer? If not, what is proposed for sewage?
Has septic tank notice been sent? Form notice sent?
Height average grade to top of plate Height average grade to highest point of roof
Size, front depth No stories solid or filled land/ earth or rock?
Material of foundation Thickness, top bottom cellar
Kind of roof Rise per foot Roof covering
No. of chimneys Material of chimneys of lining Kind of fuel fuel
Planing Lumber—Kind Dressed or full size? Corner posts Sills
Size Girder Columns under girder Size Max on centers
Studs (outside walls and carrying partitions) 2x4-16" O. C. Bridging in every floor and flat roof span over 8 feet
Joists and rafters 1st floor 2nd 3rd roof
On ceiling 1st floor 2nd 3rd roof
Material 1st floor 2nd 3rd roof
if with masonry walls, thickness of walls? height?

IF A GARAGE

No. of automobiles on same lot to be accommodated number commercial cars to be accommodated
Will automobile repair be done other than minor repairs to cars habitually stored in the proposed building?

APPROVALS BY

DATE

MISCELLANEOUS

BUILDING INSPECTION—PLAN EXAMINER

Will work require disturbing of any tree on a public street?

ZONING O.R. 1/18/78

BUILDING CODE O.R. 1/18/78

Will there be in charge of the above work a person competent

Fire Dept.

to see that the State and City requirements pertaining thereto

Health Dept.

are observed?

Others:

Signature of Applicant Whalen Guimond Phone # 773-1915

Type Name of above Whalen Guimond 1 [x] 2 [] 3 [] 4 []

Other and Address

FIELD INSPECTOR'S COPY

NOTES

1-23-78 cant locate where this is going - NO one working on this activity - find out what the snow isn't plowed out completely
 2-15-78 Same -
 3-16-78 Same
 5-12-78 Started work - working on floors now - no equipment installed -
 6-5-78 most of work done - lot of finish work to do -
 6-26-78 Compl. work - the Dept. did the fire safety between floors -
 issue -

Permit No. 98/10124
 Location 126 St. St.
 Owner [Signature]
 Date of permit 1-18-78
 Approved 1-19-78 Food Service

year

A large section of the page is a grid of horizontal lines, likely for additional notes or a schedule. A large 'X' is drawn across the left side of this grid, extending from the middle of the page down to the bottom.

X

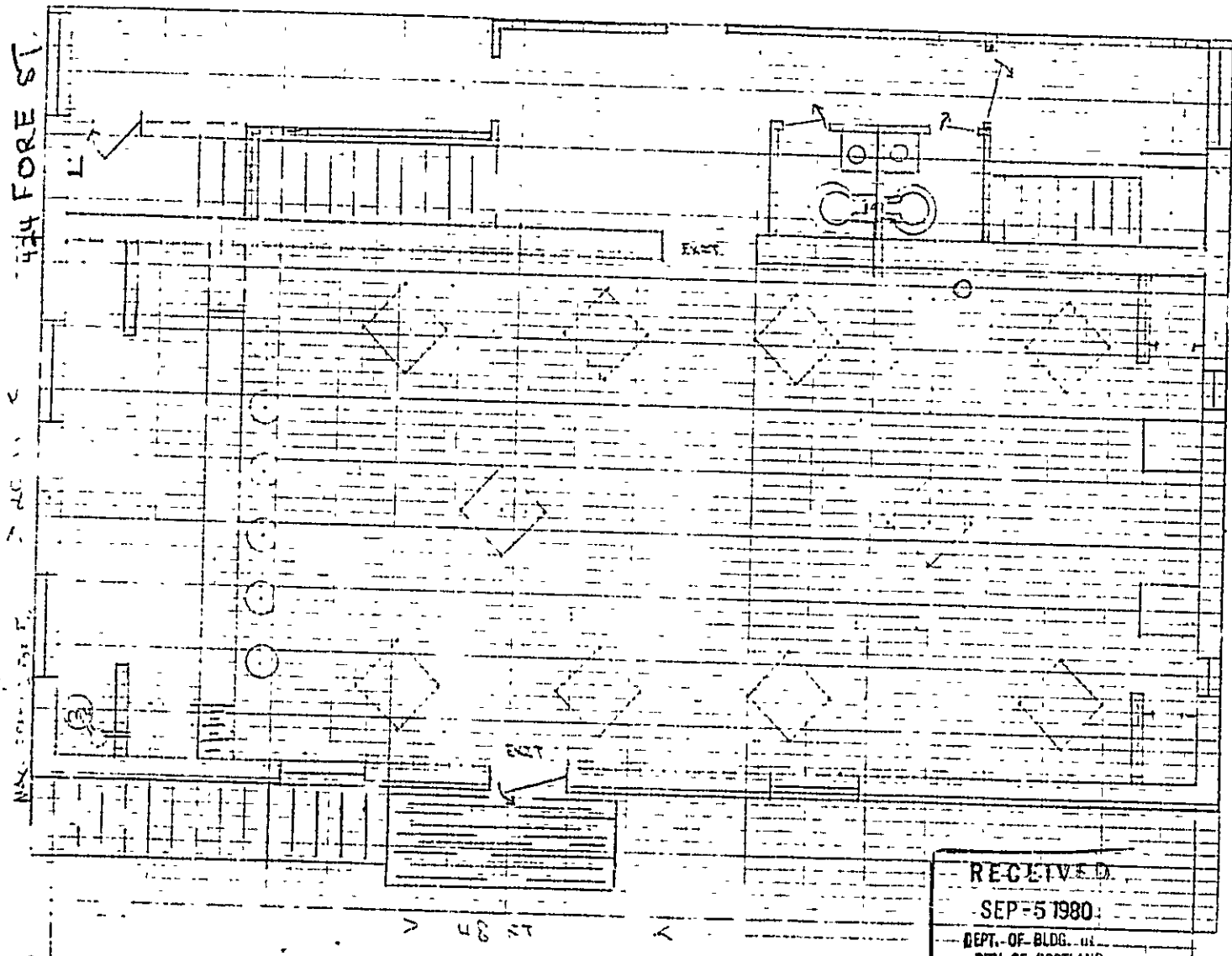

RECEIVED
 SEP-5 1980
 DEPT. OF BLDG. OF
 CITY OF PORTLAND

SCALE = 3.5 FT PER [Symbol]

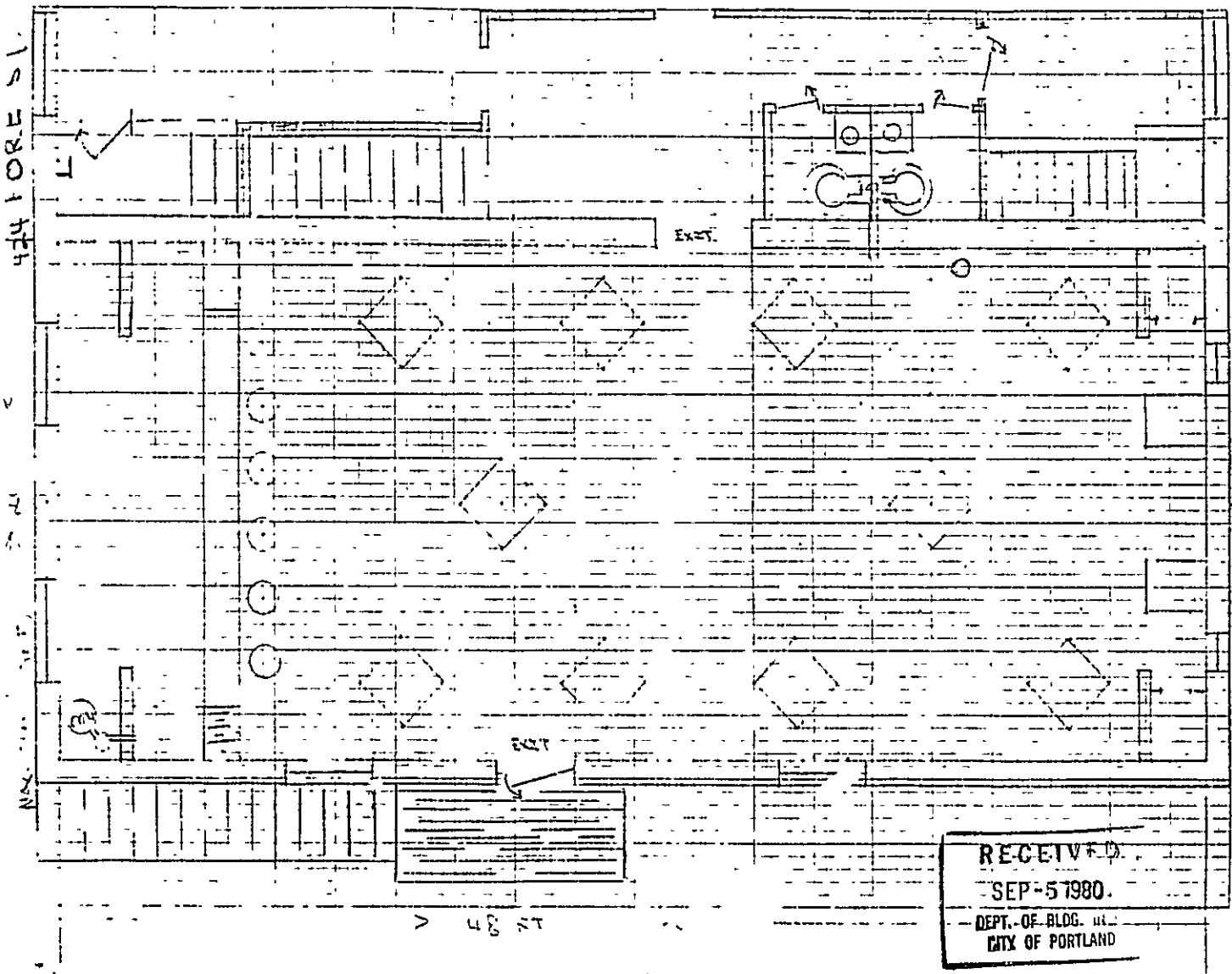

SCALE = 1/8" = 1'-0" PER SQUARE

RECEIVED
 SEP-5 1980
 DEPT. OF BLDG. ...
 CITY OF PORTLAND



CITY OF PORTLAND

JOSEPH E. McDONOUGH
FIRE CHIEF

March 12, 1980

Mr. Lou Chaisson
424 Fore St.
Portland, Maine

Mr. Chaisson:

You have requested a waiver from Section 8-1.6 of the 101 Life Safety Code which would grant you permission to place a public assemblage occupancy on the second floor of 424 Fore St.

Chief McDonough and myself have reviewed your request and have agreed to grant you this waiver based on the following:

The occupancy load shall not exceed fifty persons, there will be no cooking facilities and two remote and separate enclosed exits leading directly to the outside shall be provided. An automatic fire and smoke alarm system shall be installed on this floor and all floors below.

Be advised that permission must be given from the State Fire Marshall's office and the City Building Inspection Dept.

If this office can assist you in any way, feel free to call.

Sincerely,

James P. Collins
Lt. James Collins
Fire Prevention Bureau

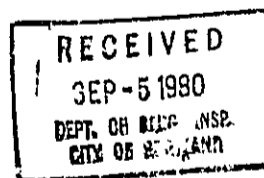



APPLICATION FOR PERMIT

B.O.C.A. USE GROUP

B.O.C.A. TYPE OF CONSTRUCTION

ZONING LOCATION _____ PORTLAND, MAINE, Sept. 5, 1980

PERMIT ISSUED

SEP 11 1980

00 730

CITY LAND

To the DIRECTOR OF BUILDING & INSPECTION SERVICES, PORTLAND, MAINE

The undersigned hereby applies for a permit to erect, alter, repair, demolish, move or install the following building, structure, equipment or change use in accordance with the Laws of the State of Maine, the Portland B.O.C.A. Building Code and Zoning Ordinance of the City of Portland with plans and specifications, if any, submitted herewith and the following specifications:

LOCATION 424 Fore St. - 2nd floor Fire District #1 #2

1 Owner's name and address Robert Cravada Telephone

2 Lessee's name and address Louis Chiasson 104 Candlewyck Terrace Telephone 774-7231

3 Contractor's name and address Telephone

4 Architect Specifications Plans No. of sheets

Proposed use of building meeting room No families

Last use No. families

Material No. stories Heat Style of roof Roofing

Other buildings on same lot

Estimated contractual cost \$ 5,000 Fee \$ 23.50

FIELD INSPECTOR—Mr. GENERAL DESCRIPTION

This application is for: @ 775-5451 ~~XXXXXXXXXXXXXXXXXXXX~~

Dwelling Ext 234 To convert a vacant area into a meeting room, will build a stairway to ground as per plan

Garage Occupancy shall not exceed 50 persons

Masonry Bldg. Stamp of Special Conditions

Metal Bldg

itions

itions

Change of Use

Other

NOTE TO APPLICANT Separate permits are required by the installers and subcontractors of heating, plumbing, electrical and mechanicals.

PERMIT IS TO BE ISSUED TO 1 2 3 4 Other

DETAILS OF NEW WORK

Is any plumbing involved in this work? Is any electrical work involved in this work?

Is connection to be made to public sewer? If not, what is proposed for sewage?

Has septic tank notice been sent? Form notice sent?

Height average grade to top of plate Height average grade to highest point of roof

Size, front depth No. stories solid or filled land? earth or rock?

Material of foundation Thickness, top bottom cellar

Kind of roof Rise per foot Roof covering

No. of chimneys Material of chimneys of lining Kind of heat fuel

Framing Lumber—Kind Dressed or full size? Corner posts Sills

Size Girder Columns under girders Size Max. on centers

Studs (outside walls and carrying partitions) 2x4-16" O.C. Bridging in every floor and flat roof span over 8 feet

Joists and rafters: 1st floor 2nd 3rd roof

On centers: 1st floor 2nd 3rd roof

Maximum span: 1st floor 2nd 3rd roof

If one story building with masonry walls, thickness of walls? height?

IF A GARAGE

No. cars now accommodated on same lot to be accommodated number commercial cars to be accommodated

Will automobile repairing be done other than minor repairs to cars habitually stored in the proposed building?

APPROVALS BY: DATE MISCELLANEOUS

BUILDING INSPECTION—PLAN EXAMINER Will work require disturbing of any tree on a public street?

ZONING

BUILDING CODE *James P. Collins* Will there be in charge of the above work a person competent to see that the State and City requirements pertaining thereto are observed? *Yes*

Fire Dept:

Health Dept:





Others:

Signature of Applicant *Louis Chiasson* Phone #774-7231

Type Name of above Louis Chiasson 1 2 3 4

FIELD INSPECTOR'S COPY and Address

NOTES

inspected prior to this Application -
 owner to call for inspection start
 on stairway - 
 1-16-80 cant get in - looks like no
 one working - no stairway on outside
 yet - 
 3-10-81 same - cant get in - 
 9-8-81 same - by rights
 permit is required by 
 cross off 

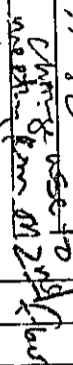
Permit No. 80/ ~~730~~ 730 # 2
 Location 424 Ave St
 Owner Robert Gonzalez
 Date of permit 9-11-80
 Approved 
 Change use to
 use from 012 to 014

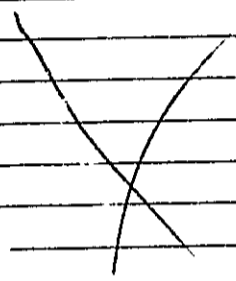



APPLICATION FOR PERMIT
 DEPARTMENT OF BUILDING INSPECTION SERVICES
 ELECTRICAL INSTALLATION

Date Sept. 2, 1981, 19
 Receipt # Permit number A73104

To the CHIEF ELECTRICAL INSPECTOR Portland, Maine
 The undersigned hereby applies for a permit to make electrical installations in accordance with the laws of
 Maine, the Portland Electrical Ordinance, the National Electrical Code and the following specifications:
 LOCATION OF WORK: 429 Fore St.
 OWNER'S NAME: Robert Pervada ADDRESS _____ FEES _____

OUTLETS: Receptacles _____ Switches _____ Plugmold _____ ft. TOTAL _____

FIXTURES (number of): Incandescent _____ Fluorescent _____ (not strip) TOTAL _____
 Strip Fluorescent _____ ft. _____

SERVICES: Overhead _____ Underground _____ Temporary _____ TOTAL amperes 400 6.00
3.00

METERS: (number of) 6

MOTORS: (number of) Fractional _____ 1 HP or over _____

RESIDENTIAL HEATING: Oil or Gas (number of units) _____ Electric (number of rooms) _____

COMMERCIAL OR INDUSTRIAL HEATING: Oil or Gas (by a main boiler) _____ Oil or Gas (by separate units) _____ Electric Under 20 kws _____ Over 20 kws _____

APPLIANCES: (number of) Ranges _____ Cook Tops _____ Wall Ovens _____ Dryers _____ Fans _____ Water Heaters _____ Disposals _____ Dishwashers _____ Compactors _____ Others (denote) _____

TOTAL _____

MISCELLANEOUS (number of): Branch Panels _____ Transformers _____ Air Conditioners Central Unit _____ Separate Units (windows) _____ Signs 20 sq ft. and under _____ Over 20 sq. ft. _____ Swimming Pools Above Ground _____ In Ground _____ Fire/Burglar Alarms Residential _____ Commercial _____ Heavy Duty Outlets. 20 Volt (such as welders) 30 amps and under _____ over 30 amps _____ Circus, Fairs, etc. _____ Alterations to wires _____ Repairs after fire _____ Emergency Lights, battery _____ Emergency Generators _____

INSTALLATION FEE DUE: 9.00
 FOR ADDITIONAL WORK NOT ON ORIGINAL PERMIT DOUBLE FEE DUE: _____
 FOR REMOVAL OF A "STOP ORDER" (304-16 b) _____
 TOTAL AMOUNT DUE: 9.00

INSPECTION: Will be ready on _____, 19____; or Will Call yes
 CONTRACTOR'S NAME: Chris DeSimon
 ADDRESS: Orchard Rd. Cumberland
 TEL.: 829-3123
 MASTER LICENSE NO.: 5115 02999 SIGNATURE OF CONTRACTOR: Chris DeSimon
 LIMITED LICENSE NO.: _____

INSPECTOR'S COPY — WHITE
 OFFICE COPY — CANARY
 CONTRACTOR'S COPY — GREEN

CITY OF PORTLAND, MAINE
Application for Permit to Install Wire.

Permit No. 2162
 Issued Sept. 4, 1974

Portland, Maine Sept.

To the City Electrician, Portland, Maine:

The undersigned hereby applies for a permit to install wires for the purpose of conducting electric current, in accordance with the laws of Maine, the Electrical Ordinance of the City of Portland, and the following specifications:

(This form must be completely filled out with Minimum Fee, \$1.00)

Owner's Name and Address Eric Mung... Tel. 774-3813
 Contractor's Name and Address John Cavallaro Tel. 774-3813
 Location 424 - Crest St. Use of Building Gift Shop.
 Number of Families _____ Apartments _____ Stores _____ Number of Stories _____
 Description of Wiring: New Work _____ Additions _____ Alterations _____

Pipe _____ Cable _____ Metal Molding _____ BX Cable _____ Plug Molding (No. of feet) _____
 No. Light Outlets _____ Plugs _____ Light Circuits _____ Plug Circuits _____
 FIXTURES: No. 49 Fluor. or Strip Lighting (No. feet) _____
 SERVICE: Pipe 400 amp Cable _____ Underground _____ No. of Wires _____ Size _____
 METERS: Relocated _____ Added _____ Total No. Meters _____
 MOTORS: Number _____ Phase _____ H. P. _____ Amps _____ Volts _____ Starter _____
 HEATING UNITS: Domestic (Oil) _____ No Motors _____ Phase _____ H.P. _____
 Commercial (Oil) _____ No Motors _____ Phase _____ H.P. _____
 Electric Heat (No. of Rooms) 22 kw.
 APPLIANCES: No. Ranges _____ Watts _____ Brand Feds (Size and No.) _____
 Elec. Heaters _____ Watts _____
 Miscellaneous _____ Watts _____
 Transformers _____ Air Conditioners (No. Units) _____ Extra Cabinets or Panels _____
 Will commence _____ 19 _____ Ready to cover in _____ 19 _____ Signs (No. Units) _____
 Amount of Fee \$ 6.50 _____ 19 _____ Inspection _____ 19 _____

Signed John Cavallaro

DO NOT WRITE BELOW THIS LINE

SERVICE	METER	GROUND
VISIT: 1 <u>9-20-74</u> 2 <u>11-25-74</u>	4	5
7	8	9
REMARKS:	10	11
		12

*Permit for outlets?
 Service called*

INSPECTED BY Libby

(OVER)

MARGE:

MR. CHIASSON WOULD LIKE YOU TO CALL
HIM IN REGARD TO SOME WORK HE IS DOING
ON FORE STREET

799-8111 EXT 244
HE IS THERE EXCEPT 12 to 1 and
UNTILL 4 .P.M.

HE SAID THE WORK IS NEAR THE AVA
MARIA SHOP ON FORE ST.

H. 7-10-80
10:55



CITY OF PORTLAND, MAINE
DEPARTMENT OF BUILDING INSPECTION
COMPLAINT

Location: 426 Fore St.

INSPECTION COPY
COMPLAINT NO. 80/57

cd July 8, 1980

Location 426 Fore floor 1 Use of Building 1
Owner's name and address Terada - 424 Fore St. Telephone 773-1911
Tenant's name and address _____ Telephone _____
Complainant's name and address Exchange St. Association Telephone _____

Description:

Making renovations and changing to all night club without permits

NOTES: 7-9-80 Couldn't get in - No one working - left word at Auto Mart - will call tomorrow morning -
7-10-80 Talked to owner - only cleaned up on 2nd floor - fixed the windows - best water going in on that floor -
7-10-80 A MR. CHASSAN called in pm & SAID he was going to be doing work at this place - will meet there tomorrow -
7-11-80 Met MR. CHASSAN & determined what he was proposing - No structural work done yet - just sand blasting - already spoke to fire dept about a renovation of the sprinkler system - will be up for a permit -

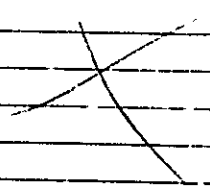



APPLICATION FOR PERMIT
 DEPARTMENT OF BUILDING INSPECTIONS SERVICES
 ELECTRICAL INSTALLATIONS

Date April 27, 1988
 Receipt and Permit number A 10636

To the CHIEF ELECTRICAL INSPECTOR, Portland, Maine:
 The undersigned hereby applies for a permit to make electrical installations in accordance with the laws of Maine;
 the Portland Electrical Ordinance, the National Electrical Code and the following specifications:

LOCATION OF WORK: 126 Fore St. - Rear of bldg.
 OWNER'S NAME: Robert Peverada ADDRESS: Thomas St.

OUTLETS: (number of)			
Lights	<u>1-30</u>		
Receptacles	_____		
Switches	_____		
Plugmold	_____ (number of feet)		
TOTAL	_____		3.00
FIXTURES: (number of)			
Incandescent	<u>1-10</u>		
Fluorescent	_____ (Do not include strip fluorescent)		
TOTAL	_____		
Strip Fluorescent, in feet	_____		3.00
SERVICES:			
Permanent, total amperes	<u>200</u>		
Temporary	_____		3.00
METERS: (number of)	<u>1</u>		.50
MOTORS: (number of)			
Fractional	<u>3</u>		
1 HP or over	_____		1.50
RESIDENTIAL HEATING:			
Oil or Gas (number of units)	_____		
Electric (number of rooms)	_____		
COMMERCIAL OR INDUSTRIAL HEATING:			
Oil or Gas (by a main boiler)	<u>X</u>		
Oil or Gas (by separate units)	_____		5.00
Electric (total number of kws)	_____		
APPLIANCES: (number of)			
Ranges	<u>X</u>	Water Heaters	_____
Cook Tops	_____	Disposals	_____
Wall Ovens	_____	Dishwashers	_____
Dryers	_____	Compactors	_____
Fans	_____	Others (denote pizza oven)	<u>X</u>
TOTAL	_____		3.00
MISCELLANEOUS: (number of)			
Branch Panels	_____		
Transformers	_____		
Air Conditioners	_____		
Signs	_____		
Fire/Burglar Alarms	_____		
Circus, Fairs, etc.	_____		
Alterations to wires	_____		
Repairs after fire	_____		
Heavy Duty, 220v outlets	<u>3</u>		
Emergency Lights, battery	_____		1.00
Emergency Generators	_____		

FOR ADDITIONAL WORK NOT ON ORIGINAL PERMIT INSTALLATION FEE DUE: _____
 FOR REMOVAL OF A "STOP ORDER" (304-16.b) DOUBLE FEE DUE: _____
 FOR PERFORMING WORK WITHOUT A PERMIT (304-9) TOTAL AMOUNT DUE: 20.00

INSPECTION:
 Will be ready on _____, 19____; or Will Call XX

CONTRACTOR'S NAME: Anthony Ferrante
 ADDRESS: Cottage Rd, So. Windham
 TEL.: 892-2178

MASTER LICENSE NO.: 4-15
 LIMITED LICENSE NO.: _____
 SIGNATURE OF CONTRACTOR: Anthony Ferrante - w.f.

INSPECTOR'S COPY



APPLICATION FOR PERMIT
DEPARTMENT OF BUILDING INSPECTIONS SERVICES
ELECTRICAL INSTALLATIONS

Date May 5, 19 78
 Receipt and Permit number A 10664

To the CHIEF ELECTRICAL INSPECTOR, Portland, Maine:
 The undersigned hereby applies for a permit to make electrical installations in accordance with the laws of Maine, the Portland Electrical Ordinance, the National Electrical Code and the following specifications:

LOCATION OF WORK: 426 Fore St.
 OWNER'S NAME: Robert Peverada ADDRESS: same

OUTLETS: (number of)

Lights	_____	FEES
Receptacles	_____	
Switches	_____	
Plugmold	_____ (number of feet)	
TOTAL	_____	

FIXTURES: (number of)

Incandescent	_____	
Fluorescent	_____ (Do not include strip fluorescent)	
TOTAL	_____	
Strip Fluorescent, in feet	_____	

SERVICES:

Permanent, total amperes	_____	
Temporary	_____	

METERS: (number of) _____

MOTORS: (number of)

Fractional	_____	
1 HP or over	_____	

RESIDENTIAL HEATING:

Oil or Gas (number of units)	_____	
Electric (number of rooms)	_____	

COMMERCIAL OR INDUSTRIAL HEATING:

Oil or Gas (by a main boiler) <u>✓</u>	_____	<u>5.00</u>
Oil or Gas (by separate units)	_____	
Electric (total number of kws)	_____	

APPLIANCES: (number of)

Ranges	_____	Water Heaters	_____
Cook Tops	_____	Disposals	_____
Wall Ovens	_____	Dishwashers	_____
Dryers	_____	Compactors	_____
Fans	_____	Others (denote)	_____
TOTAL	_____		

MISCELLANEOUS: (number of)

Branch Panels	_____	
Transformers	_____	
Air Conditioners	_____	
Signs	_____	
Fire/Burglar Alarms	_____	
Circuits, Fairs, etc.	_____	
Alterations to wires	_____	
Repairs after fire	_____	
Heavy Duty, 220v outlets	_____	
Emergency Lights, battery	_____	
Emergency Generators	_____	

	INSTALLATION FEE DUE:	_____
FOR ADDITIONAL WORK NOT ON ORIGINAL PERMIT	DOUBLE FEE DUE:	_____
FOR REMOVAL OF A "STOP ORDER" (304-16.b)		_____
FOR PERFORMING WORK WITHOUT A PERMIT (304-9)		_____
	TOTAL AMOUNT DUE:	<u>5.00</u>

INSPECTION:
 Will be ready on _____, 19____; or Will Call _____

CONTRACTOR'S NAME: Richard A Profenno
 ADDRESS: 58 Christy Road
 TEL.: 797-4953

MASTER LICENSE NO.: 3599 SIGNATURE OF CONTRACTOR: Richard A Profenno
 LIMITED LICENSE NO.: _____

INSPECTOR'S COPY

PERMIT TO INSTALL PLUMBING

PERMIT NUMBER 1522

Date Issued **5-5-78**
 Portland Plumbing Inspector
 By ERNOLD R. GOODWIN

Add **426 Fore Street**
 District **Commercial**
 Owner's Name **Robert Peverada**
 Owner's Address **same**
 Plumber's Name **Richard A. Profenno** Date **5-5-78**
 Plumber's Address **50 Christy Rd.**

App. First Insp.
 Date **MAY 23 1978**
 By

App. Final Insp.
 Date **MAY 8 1978**
 By

- Type of Bldg.
- Commercial
 - Residential
 - Single
 - Multi Family
 - New Construction
 - Remodeling

PLUMBING		
REPAIRS		
REPLACEMENT		
INSTALLATION		
ADJUSTMENT		
TESTING		
INSPECTION		
REVISIONS		
FINAL		
TOTAL	1	2.00
BASE FEE		3.00
TOTAL		5.00

Building and Inspection Services Dept., Plumbing Inspection

CERTIFICATE OF APPROVAL

FOR INTERNAL PLUMBING FOR THE TOWN/CITY OF Portland

OWNER Robert J. P. ...

Cert. of App. Number
№ 13213

ADDRESS 421 ..., MAINE

Date C O A Issued

MAY 8 1978
Month Day Year

Plumbing Installed by Edward ...

Date Inspected

MAY 8 1978
Month Day Year

5-2-78
Date Permit Issued

THE INTERNAL PLUMBING INSTALLED PURSUANT TO THE ABOVE CERTIFICATE OF APPROVAL NUMBER HAS BEEN TESTED IN MY PRESENCE, FOUND TO BE FREE FROM LEAKS, AND WAS INSTALLED IN COMPLIANCE WITH THE MUNICIPAL AND STATE PLUMBING REGULATIONS.

Signature of LPI _____

State Office Use Only
Date Received

ORIGINAL—To be sent to Department of Human Services
Division of Health Engineering 221 State Street Augusta, Maine 04333

INTERNAL PLUMBING PERMIT FOR THE TOWN/CITY OF Portland

Town/City Code 05170 License Number 1723 Date Issued 5 1 78 PERMIT NUMBER **№ 13213 IP**

Address of where Plumbing is done

1577 ROSE STREET

- 1 Owner
- 2 Licensed Master Plumber
- 3 Licensed Oil Burnerman
- 4 Employees of Public Utilities

Code Issued To

Name of Owner

LEVY, RALPH

Type of Construction
Plumbing to Serve

- 1 New
- 2 Remodeling
- 3 Addition
- 4 Remodeling & Addition
- 5 Replacement of Hot Water Heater
- 6 Hook up of Mobile Home
- 7 Minor Change
- 8 Oil or (Specify)

SCHEDULE OF "FEES"
(See Sect. 1.12 of the Part I Code)

1-10 Fixtures	\$2.00 each
11-20 Fixtures	\$1.00 each
21 Fixtures on up	\$.50 each
Hook-ups	\$2.00 each

Note: Hotwater Heater (tank or tankless) is considered a fixture!

Fixture	#	Fixture	#	Fixture	#
Sinks	1	Showers		Hot Water Heaters	
Toilets	1	Urinals		Floor Drains	1
Bathtubs		Clothes Washers		Other	
Lavatories	2	Dish Washers		Hook ups	

Quantity	Fee
Fixtures ...	17.00
Hook ups ...	

Administrative fee 3.00

Total or Double Fee 20.00

STATE OFFICE USE ONLY

Date Received _____
Receipt Number _____
Money Received \$ _____
Administrative Code

Signature of LPI _____

HHE-211 Rev 877

This "Internal Plumbing Permit" is invalid if work is not commenced within six(6) months from date of issuance. Upon completion of work a "Certificate of Approval" must be obtained.
Original—To be sent to: Department of Human Services, Division of Health Engineering 221 State Street, Augusta, Maine 04333



FILL IN AND SIGN WITH INK

0336

APPLICATION FOR PERMIT FOR HEATING, COOKING OR POWER EQUIPMENT

PERMIT ISSUED

MAY 5 1978

Portland, Maine, May 5, 1978

CITY OF PORTLAND

To the INSPECTOR OF BUILDINGS, PORTLAND, ME.

The undersigned hereby applies for a permit to install the following heating, cooking or power equipment in accordance with the Laws of Maine, the Building Code of the City of Portland, and the following specifications:

Location 426 Fore Street Use of Building No. Stories New Building Existing
Name and address of owner of appliance Robert Reverada - same
Installer's name and address Richard A. Profenno - 58 Christy Rd. Telephone 797-4953

General Description of Work

To install Boiler & Burner Unit - new

IF HEATER, OR POWER BOILER

Location of appliance basement Any burnable material in floor surface or beneath? yes
If so, how protected? by setting burner on air space Kind of fuel? # 2 fuel oil
Minimum distance to burnable material, from top of appliance or casing top of furnace 6 ft.
From top of smoke pipe 2 ft. From front of appliance From sides or back of appliance
Size of chimney flue 8 x 10 Other connections to same flue none
If gas fired, how vented? Rated maximum demand per hour
Will sufficient fresh air be supplied to the appliance to insure proper and safe combustion? yes

IF OIL BURNER

Name and type of burner Texaco - gun Labelled by underwriters' laboratories? yes
Will operator be always in attendance? no Does oil supply line feed from top or bottom of tank? bottom
Type of floor beneath burner see above Size of vent pipe 1 1/4
Location of oil storage basement Number and capacity of tanks 1-275 gal.
Low water shut off yes Make McDonald Miller No
Will all tanks be more than five feet from any flame? yes How many tanks enclosed? none
Total capacity of any existing storage tanks for furnace burners 275 gal.

IF COOKING APPLIANCE

Location of appliance Any burnable material in floor surface or beneath?
If so, how protected? Height of Legs, if any
Skirting at bottom of appliance? Distance to combustible material from top of appliance?
From front of appliance From sides and back From top of smokepipe
Size of chimney flue Other connections to same flue
Is hood to be provided? If so, how vented? Forced or gravity?
If gas fired, how vented? Rated maximum demand per hour

MISCELLANEOUS EQUIPMENT OR SPECIAL INFORMATION

Amount of fee enclosed? 15.00

APPROVED:

O.K. E.B. 5/5/78

Will there be in charge of the above work a person competent to see that the State and City requirements pertaining thereto are observed?

CS 300

Signature of Installer

Richard A. Profenno 3599

INSPECTION COPY

NOTES

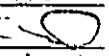
5-12-78 Couldn't get in to check (went to
The main area of Food Section) - 
8-22-78 Saw board on before I did connect
on bldg permit permit - installed
The emergency switch at top of stairs

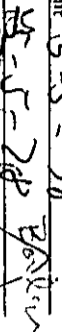
Permit No. 98 / 1336
Location V216
Owner 
Date of permit 5-5-78
Approved 

Two columns of horizontal lines for notes or drawings. The left column contains a large hand-drawn 'X' mark.



APPLICATION FOR PERMIT
DEPARTMENT OF BUILDING INSPECTIONS SERVICES
ELECTRICAL INSTALLATIONS

Date 12-1, 1978
 Receipt and Permit number 215899

To the CHIEF ELECTRICAL INSPECTOR, Portland, Maine:

The undersigned hereby applies for a permit to make electrical installations in accordance with the laws of Maine, the Portland Electrical Ordinance, the National Electrical Code and the following specifications:

LOCATION OF WORK: 424 Fore Street
 OWNER'S NAME: Ave Maria Gift Shop ADDRESS: same

	FEES
OUTLETS: Receptacles _____ Switches _____ Plugmold _____ ft. TOTAL _____	
FIXTURES: (number of) double flood light- outside _____	
Incandescent <u>X</u> Fluorescent _____ (not strip) TOTAL _____	3.00
Strip Fluorescent _____ ft. _____	
SERVICES: Overhead _____ Underground _____ Temporary _____ TOTAL amperes _____	
METERS (number of) _____	
MOTORS: (number of) Fractional _____ 1 HP or over _____	
RESIDENTIAL HEATING: Oil or Gas (number of units) _____ Electric (number of rooms) _____	
COMMERCIAL OR INDUSTRIAL HEATING: Oil or Gas (by a main boiler) _____ Oil or Gas (by separate units) _____ Electric Under 20 kws _____ Over 20 kws _____	
APPLIANCES: (number of)	
Ranges _____ Water Heaters _____	
Cook Tops _____ Disposals _____	
Wall Ovens _____ Dishwashers _____	
Dryers _____ Compactors _____	
Fans _____ Others (denote) _____	
TOTAL _____	
MISCELLANEOUS: (number of)	
Branch Panels _____	
Transformers _____	
Air Conditioners Central Unit _____	
Separate Units (windows) _____	
Signs 20 sq. ft. and under _____	
Over 20 sq. ft. _____	
Swimming Pools Above Ground _____	
In Ground _____	
Fire/Burglar Alarms Residential _____	
Commercial _____	
Heavy Duty Outlets, 220 Volt (such as welders) 30 amps and under _____	
over 30 amps _____	
Circus, Fairs, etc. _____	
Alterations to wires _____	
Repairs after fire _____	
Emergency Lights, battery _____	
Emergency Generators _____	
INSTALLATION FEE DUE: _____	
FOR ADDITIONAL WORK NOT ON ORIGINAL PERMIT DOUBLE FEE DUE: _____	
FOR REMOVAL OF A "STOP ORDER" (304-16.b)	
TOTAL AMOUNT DUE: _____	3.00

INSPECTION:
 Will be ready on _____, 19__; or Will Call X
 CONTRACTOR'S NAME: Thomas Carll
 ADDRESS: Mountain View Road, Gray, Me.
 TEL: 428-3820
 MASTER LICENSE NO.: 3335 SIGNATURE OF CONTRACTOR: Thomas Carll
 LIMITED LICENSE NO.: _____

INSPECTOR'S COPY — WHITE
 OFFICE COPY — CANARY
 CONTRACTOR'S COPY — GREEN

(COPY)

CITY OF PORTLAND, MAINE
Department of Building Inspection



Certificate of Occupancy

LOCATION 424-426 Fore St

Date of Issue November 18, 1974

Issued to **Ava Maria Gift Shop**

This is to certify that the Building, premises, or part thereof, at the above location, built—altered—changed as to use under Building Permit No. **74/808**, has had final inspection, has been found to conform substantially to requirements of Zoning Ordinance and Building Code of the City, and is hereby approved for occupancy or use, limited or otherwise, as indicated below

PORTION OF BUILDING OR PREMISES

APPROVED OCCUPANCY

gift shop - retail

first floor

Limiting Conditions

none

This certificate supersedes certificate issued

Approved

11-18-74
(Date)

M. L. ...
Inspector

[Signature]
Inspector of Buildings

Notice: This certificate identifies lawful use of building or premises and ought to be transferred from owner to owner when property changes hands. Copy will be furnished to owner or lessee for one dollar.

... and ought to be transferred from ...
... will be furnished to owner or lessee for one dollar.



APPLICATION FOR PERMIT

PERMIT ISSUED

B.O.C.A. USE GROUP 0808
B.O.C.A. TYPE OF CONSTRUCTION

AUG 29 1974

ZONING LOCATION PORTLAND, MAINE, August 22, 1974

CITY of PORTLAND

To the DIRECTOR OF BUILDING & INSPECTION SERVICES, PORTLAND, MAINE

The undersigned hereby applies for a permit to erect, alter, repair, demolish, move or install the following building, structure, equipment or change use in accordance with the Laws of the State of Maine, the Portland B.O.C.A. Building Code and Zoning Ordinance of the City of Portland with plans and specifications, if any, submitted herewith and the following specifications:

- LOCATION 424/Fore St Fire District #1 - #2
- 1. Owner's name and address Ave Maria Gift Shop, same Telephone
- 2. Lessee's name and address Telephone
- 3. Contractor's name and address Lydon Const Co, 95 Lyden Lane, Cape Elizabeth Telephone 799-3596
- 4. Architect Specifications Plans No. of sheets
- Proposed use of building Gift shop - retail No. families
- Last use storage & warehouse No. families
- Material No. stories Heat Style of roof Roofing
- Other buildings on same lot 3, Fee \$ 12.00
- Estimated contractual cost \$ 25,000.00

FIELD INSPECTOR—Mr. Gattwright GENERAL DESCRIPTION

This application is for: @ 775-5451 change of use as above with alterations per plan.
 Dwelling Ext. 234
 Garage
 Masonry Bldg. Stamp of Special Conditions
 Metal Bldg.
 Other

NOTE TO APPLICANT: Separate permits are required by the installers and subcontractors of heating, plumbing, electrical and mechanical.

PERMIT IS TO BE ISSUED TO 1 2 3 4

Other:

DETAILS OF NEW WORK

- Is any plumbing involved in this work? YES
- Is any electrical work involved in this work? YES
- Is connection to be made to public sewer? If not, what is proposed for sewage?
- Has septic tank notice been sent? Form notice sent?
- Height average grade to top of plate Height average grade to highest point of roof
- Size, front depth No. stories solid or filled land? earth or rock?
- Material of foundation Thickness, top bottom cellar
- Kind of roof Rise per foot Roof covering
- No. of chimneys Material of chimneys of lining Kind of heat fuel
- Framing Lumber—Kind Dressed or full size? Corner posts Sills
- Size Girder Colu under girders Size Max. on centers
- Studs (outside walls and carrying partitions) 2x4-16" O. C. Bridging in every floor and flat roof span over 8 feet.
- Joists and rafters: 1st floor 2nd 3rd roof
- On centers: 1st floor 2nd 3rd roof
- Maximum span: 1st floor 2nd 3rd roof
- If one story building with masonry walls, thickness of walls? height?

IF A GARAGE

No. cars now accommodated on same lot, to be accommodated ... number commercial cars to be accommodated ...
 Will automobile repairing be done other than minor repairs to cars habitually stored in the proposed building?

APPROVALS BY: DATE MISCELLANEOUS

BUILDING INSPECTION—PLAN EXAMINER Will work require disturbing of any tree on a public street? ..

ZONING: D. W. 8/22/74 - R. M. Will there be in charge of the above work a person competent to see that the State and City requirements pertaining thereto are observed? Yes

BUILDING CODE:
 Fire Dept.:
 Health Dept.:
 Others:

Signature of Applicant Lawrence Lydon Phone #
 Type Name of above
 1 2 3 4

REC'D. 8/25/74
 FIELD INSPECTOR'S COPY
 RETURNED 8/27/74
 BY

PERMIT TIMING

NOTES

MAINTENANCE TO YETS

8-30-74 left side finishing off
to move in

Right side steel beams need
1/4" plate to hold brick wall 18" thick
RW

9-6-74 Moving in left side RW

10-1-74 Steel beam in OK.
Doors on RW

10-31-74 Finishing RW

11-18-74 Done RW

C. of O

Approved

Date of permit 8/29/74

Owner One Main City Shop

Location 421-436 Pine St

Permit No. 741808

Melham

PERMIT TIMING



APPLICATION FOR PERMIT

B.O.C.A. USE GROUP

B.O.C.A. TYPE OF CONSTRUCTION

ZONING LOCATION B-3 PORTLAND, MAINE, . . .7-21-78....

To the DIRECTOR OF BUILDING & INSPECTION SERVICES, PORTLAND, MAINE

The undersigned hereby applies for a permit to erect, alter, repair, demolish, move or install the following building, structure, equipment or change use in accordance with the Laws of the State of Maine, the Portland B.O.C.A. Building Code and Zoning Ordinance of the City of Portland with plans and specifications, if any, submitted herewith and the following specifications:

LOCATION 426 Fore St. Fire District #1 , #2

1. Owner's name and address Robert Peverada-XXXXXXXXXXXX same Telephone

2. Lessee's name and address Whalen Guimond-79 Sherwood St. Telephone 773-1915

3. Contractor's name and address Robert M. Jackman-Cross St., Port., Me Telephone

4. Architect Specifications Plans No. of sheets

Proposed use of building sandwich shop No. families

Last use storage bldg. No. families

Material No. stories Heat Style of roof Roofing

Other buildings on same lot

Estimated contractual cost \$ Fee \$ 5.75

FIELD INSPECTOR—Mr. GENERAL DESCRIPTION

This application is for: @ 775-5451
 Dwelling Ext. 234 **To erect sign, 2x3, attached to building, as per plan.**
 Garage
 Masonry Bldg. **Send permit to Mr. Guimond** Stamp of Special Conditions
 Metal Bldg.
 Alterations
 Demolitions
 Change of Use
 Other

NOTE TO APPLICANT. Separate permits are required by the installers and subcontractors of heating, plumbing, electrical and mechanicals.

PERMIT IS TO BE ISSUED TO 1 2 3 4

Other:

DETAILS OF NEW WORK

Is any plumbing involved in this work? Is any electrical work involved in this work?

Is connection to be made to public sewer? If not, what is proposed for sewage?

Has septic tank notice been sent? Form notice sent?

Height average grade to top of plate Height average grade to highest point of roof

Size from depth No. stories solid or filled land? earth or rock?

Material of foundation Thickness, top bottom cellar

Kind of roof Rise per foot Roof covering

No. of chimneys Material of chimneys of lining Kind of heat fuel

Framing Lumber—Kind Dressed or full size? Corner posts Sills

Size Girder Columns under girders Size Max. on centers

Studs (outside walls and carrying partitions) 2x4-16" O. C. Bridging in every floor and flat roof span over 8 feet.

Joists and rafters: 1st floor 2nd 3rd roof

On centers: 1st floor 2nd 3rd roof

Maximum span. 1st floor 2nd 3rd roof

If one story building with masonry walls, thickness of walls? height?

IF A GARAGE

No. cars now accommodated on same lot . . . , to be accommodated . . . number commercial cars to be accommodated . . .

Will automobile repairing be done other than minor repairs to car habitually stored in the proposed building?

APPROVALS BY: DATE

BUILDING INSPECTION—PLAN EXAMINER

ZONING: DR. M.G. 4/24/78

BUILDING CODE:

Fire Dept.:

Health Dept.:

Others:

MISCELLANEOUS

Will work require disturbing of any tree on a public street?

Will there be in charge of the above work a person competent to see that the State and City requirements pertaining thereto are observed?

Signature of Applicant Whalen Guimond Phone #

Type Name of above Whalen Guimond 1 2 3 4

Other and Address

FIELD INSPECTOR'S COPY

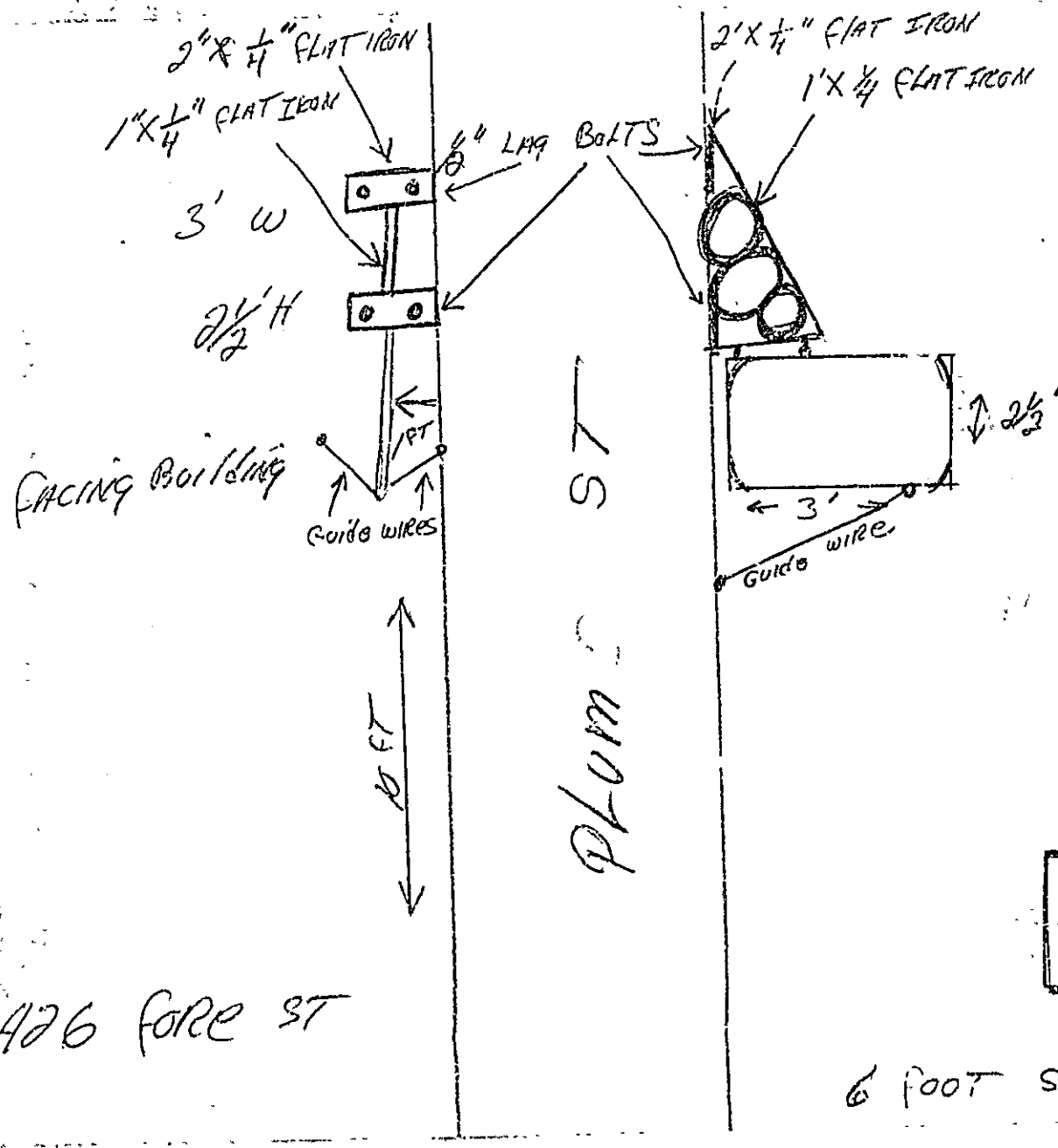

426 Fore ST

Plum
ST

RECEIVED
JUL 21 1978
DEPT. OF BLDG. INSP.
CITY OF PORTLAND

6 FOOT SIDEWALK



APPLICATION FOR PERMIT
DEPARTMENT OF BUILDING INSPECTIONS SERVICES
ELECTRICAL INSTALLATIONS

Date Jan. 28, 19 81
 Receipt and Permit number A 66806

To the CHIEF ELECTRICAL INSPECTOR, Portland, Maine:

The undersigned hereby applies for a permit to make electrical installations in accordance with the laws of Maine, the Portland Electrical Ordinance, the National Electrical Code and the following specifications:

LOCATION OF WORK: 424 Forest Avenue
 OWNER'S NAME: Brunswick Savings Bank ADDRESS: same

FEES

OUTLETS.	Receptacles _____	Switches _____	Plugmold _____	ft TOTAL _____	_____
FIXTURES: (number of)	Incandescent _____	Flourescent _____	(not strip) TOTAL _____	_____	_____
	Strip Flourescent _____	ft. _____	_____	_____	_____
SERVICES:	Overhead _____	Underground _____	Temporary _____	TOTAL amperes _____	_____
METERS: (number of)	_____	_____	_____	_____	_____
MOTORS: (number of)	Fractional _____	_____	_____	_____	_____
	1 HP or over _____	_____	_____	_____	_____
RESIDENTIAL HEATING:	Oil or Gas (number of units) _____	_____	_____	_____	_____
	Electric (number of rooms) _____	_____	_____	_____	_____
COMMERCIAL OR INDUSTRIAL HEATING:	Oil or Gas (by a main boiler) _____	_____	_____	_____	_____
	Oil or Gas (by separate units) _____	_____	_____	_____	_____
	Electric Under 20 kws _____	Over 20 kws _____	_____	_____	_____
APPLIANCES. (number of)	Ranges _____	Water Heaters _____	_____	_____	_____
	Cook Tops _____	Disposals _____	_____	_____	_____
	Wall Ovens _____	Dishwashers _____	_____	_____	_____
	Dryers _____	Compactors _____	_____	_____	_____
	Fans _____	Others (denote) _____	_____	_____	_____
	TOTAL _____	_____	_____	_____	_____
MISCELLANEOUS: (number of)	Branch Panels _____	_____	_____	_____	_____
	Transformers _____	_____	_____	_____	_____
	Air Conditioners Central Unit _____	_____	_____	_____	_____
	Separate Units (windows) _____	_____	_____	_____	_____
	Signs 20 sq. ft. and under _____	_____	_____	_____	_____
	Over 20 sq. ft. _____	_____	_____	_____	_____
	Swimming Pools Above Ground _____	_____	_____	_____	_____
	In Ground _____	_____	_____	_____	_____
	Fire/Burglar Alarms Residential _____	_____	_____	_____	_____
	Commercial 5.00 _____	_____	_____	_____	5.00
	Heavy Duty Outlets, 220 Volt (such as welder) \ 30 amps and under _____	_____	_____	_____	_____
	over 30 amps _____	_____	_____	_____	_____
	Circus, Fairs, etc. _____	_____	_____	_____	_____
	Alterations to wires _____	_____	_____	_____	_____
	Repairs after fire _____	_____	_____	_____	_____
	Emergency Lights, battery _____	_____	_____	_____	_____
	Emergency Generators _____	_____	_____	_____	_____
	INSTALLATION FEE DUE. _____	_____	_____	_____	_____
	FOR ADDITIONAL WORK NOT ON ORIGINAL PERMIT DOUBLE FEE DUE: _____	_____	_____	_____	_____
	FOR REMOVAL OF A "STOP ORDER" (304-16 b) _____	_____	_____	_____	_____
	TOTAL AMOUNT DUE: _____	_____	_____	_____	5.00

INSPECTION:
 Will be ready on _____, 19__; or Will Call ~~xxx~~
 CONTRACTOR'S NAME: Eastern Securities
 ADDRESS: 112 Middle St.
 TEL.: 774-5819
 MASTER LICENSE NO.: 412 SIGNATURE OF CONTRACTOR: [Signature]
 LIMITED LICENSE NO.: _____

INSPECTOR'S COPY — WHITE
 OFFICE COPY — CANARY
 CONTRACTOR'S COPY — GREEN



APPLICATION FOR PERMIT TO ERECT
SIGN OVER PUBLIC SIDEWALK OR STREET

PERMIT ISSUED

SEP 24 1974

Portland, Maine, September 20, 1974

CITY OF PORTLAND

To the INSPECTOR OF BUILDINGS, PORTLAND, ME

The undersigned hereby applies for a permit to erect the following described sign extending over a public sidewalk or street in accordance with the Building Code of the City of Portland, and the following specifications

Location ~~424 Fore St~~ 424 Fore St Within Fire Limits? Dist. No. 1
 Owner of building to which sign is to be attached Robert Paverada, same
 Name and address of owner of sign Ave Maria Gift Shop
 Contractor's name and address Coyne Sign Co, 66 Cove Telephone 774-4430
 When does contractor's bond expire? 31 Dec 74

Information Concerning Building

No stories 3 Material of wall to which sign is to be attached brick

Details of Sign and Connections

Building owner's consent and agreement filed with application
 Electric? Vertical dimension after erection 4' Horizontal 5'
 Weight 85 lbs. Will there be any hollow spaces? Any rigid frame?
 Material of frame angle iron No. advertising faces 2 material plastic
 No. rigid connections two Are they fastened directly to frame of sign?
 No. through bolts none Size 3/16" Location, top or bottom
 No. guys four material wire Size 5/16"
 Minimum clear height above sidewalk or street 10'
 Maximum projection into street 5.16" Fee \$ 7.00

Signature of contractor Joseph Coyne

Joseph Coyne

INSPECTION COPY

207116 D/C M.C.W. 9/23/74

Permit No. 74/899
Location 424 Fore St
Owner Peverside
Date of permit 9/24/74
Sign Contractor _____
Final Inspn. _____

NOTES

9-26-74 Completed

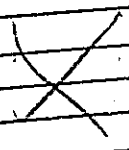

WRITTEN CONSENT AND AGREEMENT RELATING TO A CERTAIN SIGN PROPOSED
TO BE ERECTED PROJECTING OVER A PUBLIC SIDEWALK FROM THE
PREMISES AT 424 Fore St IN PORTLAND, MAINE

Robert Peperada being the owner of the
premises at 474 Fore St in Portland, Maine hereby
gives consent to the erection of a certain sign owned by
_____ projecting over the public sidewalk
from said premises as described in application to the Inspector
of Buildings of Portland, Maine for a permit to cover erection
of said sign;

And in consideration of the issuance of said permit
Robert Peperada, owner of said premises,
in event said sign shall cease to serve the purpose for which
it was erected or shall become dangerous and in event the owner
of said sign shall fail to remove said sign or make it permanently
safe in case the sign still serves the purpose for which it was
erected, hereby agrees for himself or itself, for his heirs,
its successors, and his or its assigns, to completely remove
said sign within ten days of notice from said Inspector of
Buildings that said sign is in such condition and of order from
him to remove it.

In Witness whereof, the owner of said premises has signed
this consent and agreement this twentieth
day of September 1974.

J. J. Coyne
Witness

Robert Peperada
Owner

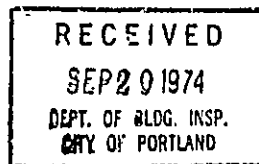

CITY OF PORTLAND, MAINE
ELEVATOR INSPECTION

Bldg. No. 46 Block 6 Sheet 1-25 of

Location of Bldg. 424 1/2 Ave. St

Owner Thomas Elizabeth W. Person

Occupant Z Box & Tins

Inspection by W. P. Hill Date 2-7-34

Formal Complaint No. Date

Letter sent without complaint

Building Data

Mat'l outside walls Brick Int. Frame wood

No. stories 3 Style of Roof Pitch

No. elev. in bldg: Passenger Freight 1

Location of Elevator on Street Floor
Shown Below

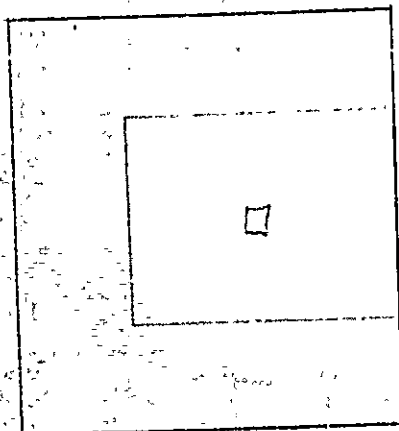

 St. Ave.

This report for 1 identical elevators

Elev. Man'f'r (check)

Use of elev. Pass. Frt. Comb'n. which

No. stops 4 Bsm't. 1, 2, 3, 4, 5, 6, 7, 8, 9, 10, 11, 12

Shaftway

Open! Hatch doors Auto. Non-auto 1

Gates, auto. Semi-auto. Hand

Enclosed! Mat'l. of enclosure

Fire Doors Normally closed open

Are enclosure doors interlocked!

Height enclosure, full story what ht.

Elevator Machinery

Type of Power Hand

Type of Machine Hand w/ 4

Location of Machine Attic

Material of Supports wood of Guides

Material of cables

No. cables, hoisting counterweight

Type of brakes

Has elev. following safeties: Governor

Car Safety ; Elect. Brakes ; Auto. Ter-

minial Stops top & bottom ; Slack Cable

Stops ; Safety Floor Stops

Remarks: (note defects, if any)

Elevator Car

Platform Dimensions Capacity

Mat'l. of Encl. No. sides encl.

Height of enclosure No. entrances

Type of gates or doors

Are they interlocked!

Have they auto-closing device!

Type operation, Push-Button Operator

Any emergency exit!

Remarks: (note defects, if any)

General Remarks: Hand rop. hook
with rop. & hook

CITY OF PORTLAND, MAINE
ELEVATOR INSPECTION

Bldg. No. 42 Block 2 Sheet 1-25 of

Location of Bldg. 426 Fore St.

Owner Thomas Elizabeth W. Dun

Occupant Satin's Place P. Co. Inc.

Inspection by H. B. ... Date 7-34

Formal Complaint No. Date

Letter sent without complaint

Building Data
Mat'l outside walls Brick Int. Frame Wood

No. stories 3 Style of Roof Palms

No. elev. in bldg. Passenger 1 Freight 1

Location of Elevator on Street Floor
Shown Below

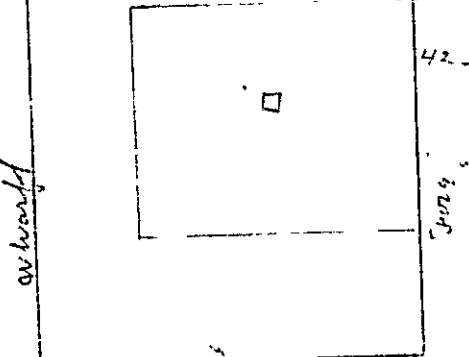

 St. Ave.

This report for 1 identical elevators

Elev. Man'f'r. (check)

Use of elev. Pass Frt. Comb'n. which

No. stops 4 Bsm't. 1, 2, 3, 4, 5, 6, 7, 8, 9, 10, 11, 12

Shaftway

Open! Hatch doors Auto. Non-auto

Gates, auto. Semi-auto. Hand

Enclosed! Mat'l. of enclosure

Fire Doors Normally closed open

Are enclosure doors interlocked!

Height enclosure, full story what ht.

Elevator Machinery

Type of Power Hand

Type of Machine Handover Hoist

Location of Machine Attic

Material of Supports Wood of Guides

Material of cables Rope

No. cables, hoisting counterweight

Type of brakes

Has elev. following safeties: Governor

Car Safety ; Elect. Brakes ; Auto. Terminal Stops top & bottom ; Slack Cable

Stops ; Safety Floor Stops

Remarks: (note defects, if any)

Elevator Car

Platform Dimensions Capacity

Mat'l. of Encl. No. sides encl.

Height of enclosure No. entrances

Type of gates or doors

Are they interlocked!

Have they auto-closing device?

Type operation, Push-Button Operator

Any emergency exit!

Remarks: (note defects, if any)

General Remarks:

Hatch doors 8 floors

closed by hand

of

62

APPLICATION FOR PERMIT

PERMIT ISSUED
MAR 15 1984
CITY OF PORTLAND

B.G.C.A. USE GROUP
B.O.C.A. TYPE OF CONSTRUCTION 206
ZONING LOCATION PORTLAND, MAINE

March 7, 1984

To the CHIEF OF BUILDING & INSPECTION SERVICES, PORTLAND, MAINE

The undersigned hereby applies for a permit to erect, alter, repair, demolish, move or install the following building, structure, equipment or change use in accordance with the Laws of the State of Maine, the Portland B.O.C.A. Building Code and Zoning Ordinance of the City of Portland with plans and specifications, if any, submitted herewith and the following specifications:

LOCATION 424 Fore Street - 2nd floor - south side of bldg. Fire District #1 #2
1. Owner's name and address Eric Cianchette Telephone
2. Licensee's name and address Hill & Associates - 386 Fore Street Telephone
3. Contractor's name and address Sherwood Hamill - 2 Atlantic St. Telephone 761-0552

Propose use of building offices No. of sheets
Last use vacant No. families
Material No. stories Left Style of roof Roofing
Other buildings on same lot
Estimated contractual cost \$ 5,000

FIELD INSPECTOR - Mr. @ 775-5451

Appeal Fees \$
Base Fee \$ 35.00
Late Fee \$ 25.00
TOTAL \$ 60.00

Change of use from vacant to offices
To make alterations to vacant space to be used for offices, no structural changes.
2 sheets of plans.
Send permit to 383 Fore St. - C// Sherwood Hamill

Stamp of Special Conditions

NOTE TO APPLICANT: Separate permits are required by the installers and subcontractors of heating, plumbing, electrical and mechanicals.

DETAILS OF NEW WORK

Is any plumbing involved in this work? **Yes** If any electrical work involved in this work? **Yes**
Is connection to be made to public sewer? If not, what is proposed for sewage?
Has septic tank notice been sent? Form notice sent?
Height average grade to top of plate Height average grade to highest point of roof
Size, front depth No. stories solid or filled land? earth or rock?
Material of foundation Thickness, top bottom center
Kind of roof Rise per foot Roof covering
No. of chimneys Material of chimneys of lining Kind of heat fuel
Framing Lumber—Kind Dressing or full size? Corner posts Sills
Size Girder Columns under girders Size Max on centers
Studs (outside walls and carrying partitions) 2x4-16" O. C. Bridging in every 1100' and flat roof span over 8 feet
Joists and rafters: 1st floor 2nd 3rd roof
On centers: 1st floor 2nd 3rd roof
Maximum span: 1st floor 2nd 3rd roof
If one story building with masonry walls, thickness of walls? height?

IF A GARAGE

No. cars now accommodated on same lot to be accommodated number commercial cars to be accommodated
Will automobile repairing be done other than minor repairs to cars habitually stored in the proposed building?

APPROVALS BY: DATE
BUILDING INSPECTION—PLAN EXAMINER
ZONING
BUILDING CODE:
Fire Dept.:
Health Dept.:
Others:

MISCELLANEOUS
Will work require cutting of any tree on a public street? **no**
Will there be in charge of the above work a person competent to see that the State and City requirements pertaining thereto are observed? **BB**

Signature of Applicant Phone # 888
Type Name of above Sherwood Hamill for Hill & Associates
Other
and Address

10

FIELD INSPECTOR'S COPY APPLICANT'S COPY OFFICE FILE COPY

424-426 FORE ST.

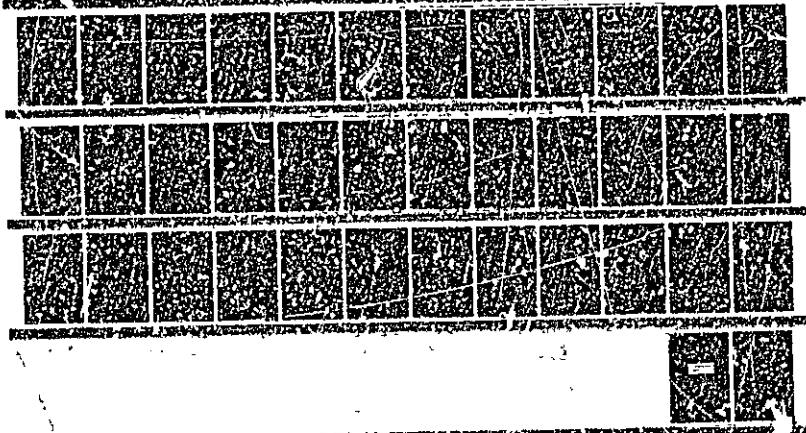



APPLICATION FOR PERMIT
DEPARTMENT OF BUILDING INSPECTIONS SERVICES
ELECTRICAL INSTALLATIONS

Date March 15, 1984
 Receipt and Permit number B19986

To the CHIEF ELECTRICAL INSPECTOR, Portland, Maine:

The undersigned hereby applies for a permit to make electrical installations in accordance with the laws of Maine, the Portland Electrical Ordinance, the National Electrical Code and the following specifications:

LOCATION OF WORK: 242 Fore Street - 2nd Floor Right
 OWNER'S NAME: Steven Blatt Architect ADDRESS: same

OUTLETS:
 Receptacles _____ Switches _____ Plugmold _____ ft. TOTAL 1-30 _____
 FIXTURES: (number of)
 Incandescent x Fluorescent _____ (not strip) TOTAL 1-10 _____ 3.00
 Strip Fluorescent _____ ft. _____

SERVICES:
 Overhead _____ Underground _____ Temporary _____ TOTAL amperes _____

METERS: (number of) _____

MOTORS: (number of)
 Fractional _____
 1 HP or over _____

RESIDENTIAL HEATING:
 Oil or Gas (number of units) _____
 Electric (number of rooms) _____

COMMERCIAL OR INDUSTRIAL HEATING:
 Oil or Gas (by a main boiler) _____
 Oil or Gas (by separate units) _____
 Electric Under 20 kws x Over 20 kws _____ 5.00

APPLIANCES: (number of)
 Ranges _____ Water Heaters _____
 Cook Tops _____ Disposals _____
 Wall Ovens _____ Dishwashers _____
 Dryers _____ Compactors _____
 Fans _____ Oth: (denote) _____
 TOTAL _____

MISCELLANEOUS: (number of)
 Branch Panels _____
 Transformers _____
 Air Conditioners Central Unit _____
 Separate Units (windows) _____
 Signs 20 sq. ft. and under _____
 Over 20 sq. ft. _____
 Swimming Pools Above Ground _____
 In Ground _____
 Fire/burglar Alarms Residential _____
 Commercial _____
 Heavy Duty Outlets, 220 Volt (such as welders) 30 amps and under _____
 over 30 amps _____
 Circus, Fairs, etc. _____
 Alterations to wires _____
 Repairs after fire _____
 Emergency Lights, battery _____
 Emergency Generators _____

FOR ADDITIONAL WORK NOT ON ORIGINAL PERMIT DOUBLE FEE DUE: _____
 FOR REMOVAL OF A "STOP ORDER" (304-16.b) _____
 TOTAL AMOUNT DUE: 11.00

INSPECTION

Will be ready on March 15, 1984; or Will Call _____

CONTRACTOR'S NAME: John Perly

ADDRESS: 381 Danforth St.

TEL.: 773-5824

MASTER LICENSE NO.: 3695 SIGNATURE OF CONTRACTOR: _____

LIMITED LICENSE NO.: _____

INSPECTOR'S COPY - WHITE

OFFICE COPY - CANARY

CONTRACTOR'S COPY - GREEN

510

PERMIT ISSUED

MAY 22 1984



APPLICATION FOR PERMIT TO ERECT SIGN OVER PUBLIC SIDEWALK OR STREET

CITY OF PORTLAND

To the INSPECTOR OF BUILDINGS, PORTLAND, ME.

Portland, Maine, May 15 19 84

The undersigned hereby applies for a permit to erect the following described sign extending over a public sidewalk or street in accordance with the Building Code of the City of Portland, and the following specifications:

Location 424 Fore Street Within Fire Limits? Dist. No.

Owner of building to which sign is to be attached Eric Clanchette - same

Name and address of owner of sign The Steamer Trunk - same

Contractor's name and address The Sign Center - 171 Walton St. Telephone 797-7448

When does contractor's bond expire? Dec. , 1984

Information Concerning Building

No. stories 3 Material of wall to which sign is to be attached brick

Details of Sign and Connections

Building owner's consent and agreement filed with application yes

Electric? no Vertical dimension after erection 4' Horizontal 3'

Weight 50 lbs. Will there be any hollow spaces? yes Any rigid frame? yes

Material of frame steel No. advertising faces 2 material 2" pine

No. rigid connections yes - 2 5 Are they fastened directly to frame of sign? yes

No. through bolts 3 Size 2 1/2 x 3/8 Location, top or bottom both

No. guys 2 material 3/16 steel Size 3/16

Minimum clear height above sidewalk or street 10'

Maximum projection into street 42"

Signature of contractor Eric Clanchette Fee \$27.40

FILE COPY

THE SIGN CENTER



CITY OF PORTLAND, MAINE
Department of Building Inspection

Certificate of Occupancy

Issued to: Matthew John Inc.

LOCATION 426 Fore Street

Date of Issue May 20, 1987

This is to certify that the building, premises, or part thereof, at the above location, built—altered—changed as to use under Building Permit No. 27/285, has had final inspection, has been found to conform substantially to requirements of Zoning Ordinance and Building Code of the City, and is hereby approved for occupancy or use, limited or otherwise, as indicated below.

PORTION OF BUILDING OR PREMISES

APPROVED OCCUPANCY

1st Floor

Hair Salon

Limiting Conditions:

This certificate supersedes
certificate issued

Approved:

5/20/87

Arthur P. ...
Inspector

James P. ...
Director of Buildings

Notice: This certificate identifies lawful use of building or premises, and ought to be transferred from owner to owner when property changes hands. Copy will be furnished to owner or lessee for use of title.



4 Moulton Street, Portland, Maine 04101

April 15, 1987

Matthew Crawford
Matthew John Inc.
426 Fore Street
Portland, Maine 04101

Dear Matt:

Gendron Commercial Brokers and Landmarks Inc. have approved the design for your signs which will be located at 426 Fore Street (see enclosed scale rendering.) We feel the size, location and color selections are fine.

Sincerely,

GENDRON COMMERCIAL BROKERS, INC.

A handwritten signature in cursive script, appearing to read "Lydia R. Colen", with a horizontal line extending to the right.

Lydia R. Colen
Property Management

LRC:dr
Encl.

RECEIVED

APR 16 1987

DEPT OF BUILDING INSPECTIONS
CITY OF PORTLAND

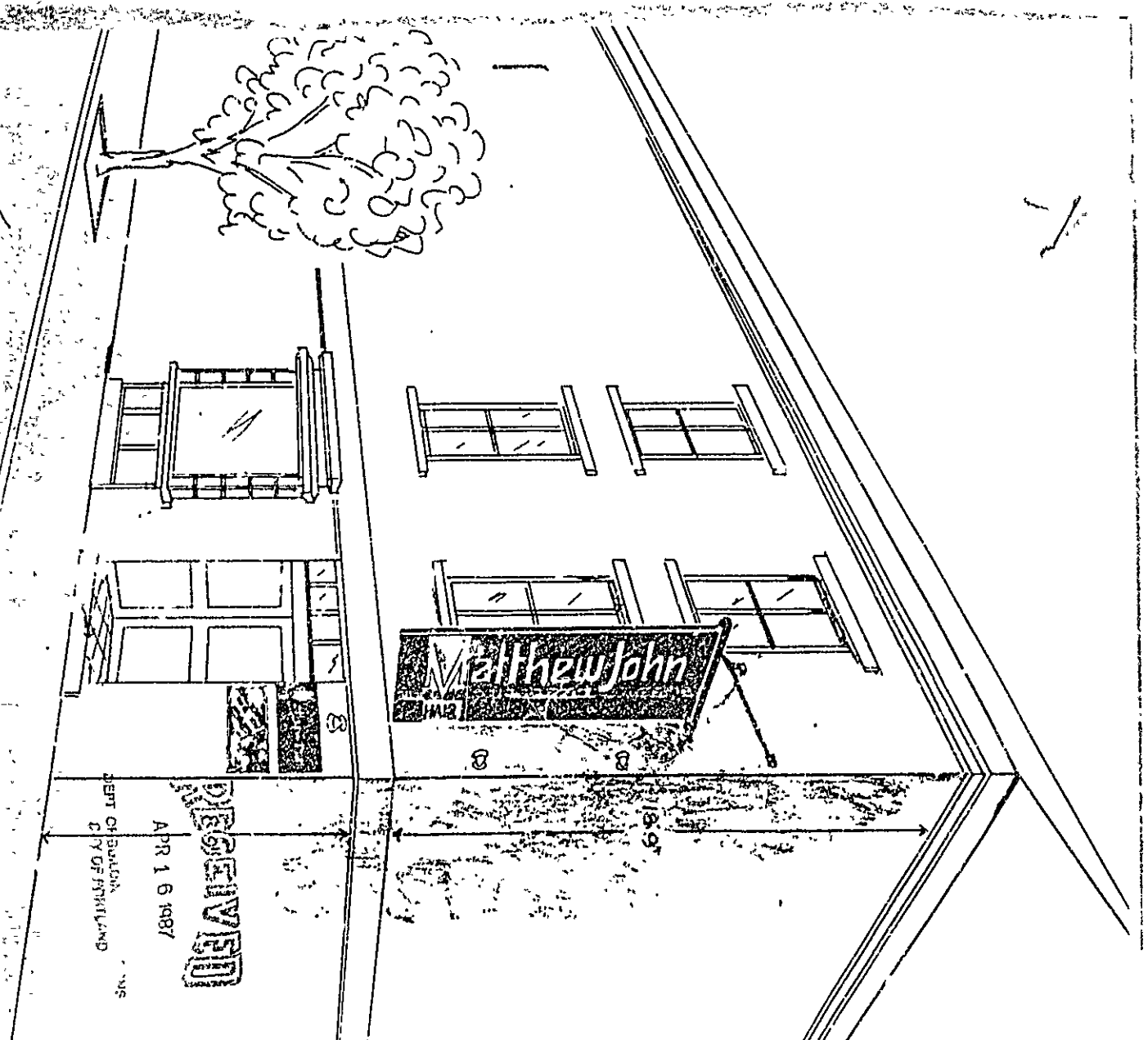

DEPT. OF BUILDING
CITY OF HAWAII

APR 16 1987

RECEIVED

Matthew John

April 16, 1987

PERMIT # BUILDING PERMIT APPLICATION Portland Previous permit #
APPLICANT FILL OUT I - VIII AND DETAILS OF WORK ON REVERSE
Please insert N/A (not applicable) for any item not pertaining to your request

I. GENERAL INFORMATION

Location/address of construction 426 Fore St
Owner or lessee's name Local Brokers - Gendron Tel 775-1811
Address 4 Mount St
Lessee - Matthew Johnson - same H 773-0783
Contractor's name _____ Tel _____
Address Fickett & Welch - Portsmouth, N. H.

Subcontractors _____
II. NEW SUBDIVISION OR EXISTING LOT REFERENCE
Name _____
Lot _____
Block _____
Bk. & pg. Reg./ deeds _____
Date recorded _____

III. PROPOSED USE: beauty salon & gift shop - 328 CODE forward If other, explain _____ Seasonal _____ Condominium _____ Apartment _____

IV. PAST USE: same
V. OWNERSHIP: _____ PUBLIC (Federal/ State/ local government) inc _____ PRIVATE (individual/cc/p/nonprofit)

VI. DESCRIPTION OF WORK:
send permit to 305 Commercial St. Apt # 312 04101
To erect 3 signs on front of building, 1 10' x 2' 9" 2 smaller 3' x 1 1/2'
as per plans. consent form included in permit

VII. BUILDING DIMENSIONS: length _____ width _____ square footage _____ height _____ # stories _____

VIII. EST. CONSTRUCTION COST: _____ IX. ACRES OF LAND: _____ BUILDING _____

X. RESIDENTIAL BUILDINGS ONLY: BEDROOMS
* NEW DWELLING UNITS WITH: 1 BDRM 2 BDRMS 3 BDRMS
* EXISTING DWELLING UNITS WITH: _____
XI. RESIDENTIAL UNITS
* NEW DWELLINGS _____
* EXISTING DWELLINGS _____
NET RESIDENTIAL UNITS _____

XII. SIGNATURE OF APPLICANT: _____ DATE: 4-16-87

XIII. ZONING: DISTRICT 2 STREET FRONTAGE _____
SETBACKS front _____ side _____
ZONING BOARD APPROVAL no yes (date) _____
PLANNING BOARD APPROVAL no yes (date) _____
XIV. OFFICE USE: TAX MAP # _____
LOT # _____
VALUE/STRUCTURE _____
PERMIT EXPIRATION _____

XV. CONDITIONAL USE: variance _____ site plan _____ subdivision _____ shore and floodplain mgmt _____
special exception _____ other _____ (explain) _____

XVI. SIGNATURE OF FIELD INSPECTOR (CEO) _____ DATE _____

XVII. FEES:
base fee _____
subdivision fee _____
site plan review fee _____
other fees _____
late fee _____
TOTAL 30.00
XVIII. SPACE FOR FIGURING /ADDITIONAL COMMENTS:
OK, M.S. Turner April 16, 1987

1 WATER SUPPLY <input type="checkbox"/> public <input type="checkbox"/> private	8 CHIMNEY # flues _____ material _____	FLOT PLAN/DETAILS OF WORK ON REVERSE White - Municipal Office Yellow - CUO Pink - Tax Assessor Blue - Utility
2 SEWER <input type="checkbox"/> public <input type="checkbox"/> private type	9 FRAMING floor joists _____ size _____ max. or centers _____	
3 HEAT type _____ fuel _____	ceiling joists _____	
4 FOUNDATION type _____ thickness _____ footing _____	rafters _____	
5 ROOF type _____ pitch _____ covering _____ load _____	studs _____	
6 PLUMBING # tubs _____ # showers _____ # lavatories _____ # laundry tubs _____ # flushes _____ # other _____	wall studs _____	
7 RINKLER SYSTEM <input type="checkbox"/> yes <input type="checkbox"/> no	10 If 1-story building w/ masonry walls wall thickness _____ height _____	
7 ELECTRICAL service entrance size _____ # smoke detectors _____	11 BEDROOM WINDOWS height _____ width _____ sill height _____ eg. ess window? <input type="checkbox"/> yes <input type="checkbox"/> no	
NUMBER OF OFF-STREET PARKING SPACES enclosed _____ outdoors _____		

110 MB RW

WATER TREATMENT PLANT
MIDLAND DISTRICT WATERWORKS
No. 100 of 1911
Date 1/18/81

W. C. Taylor
S. J.

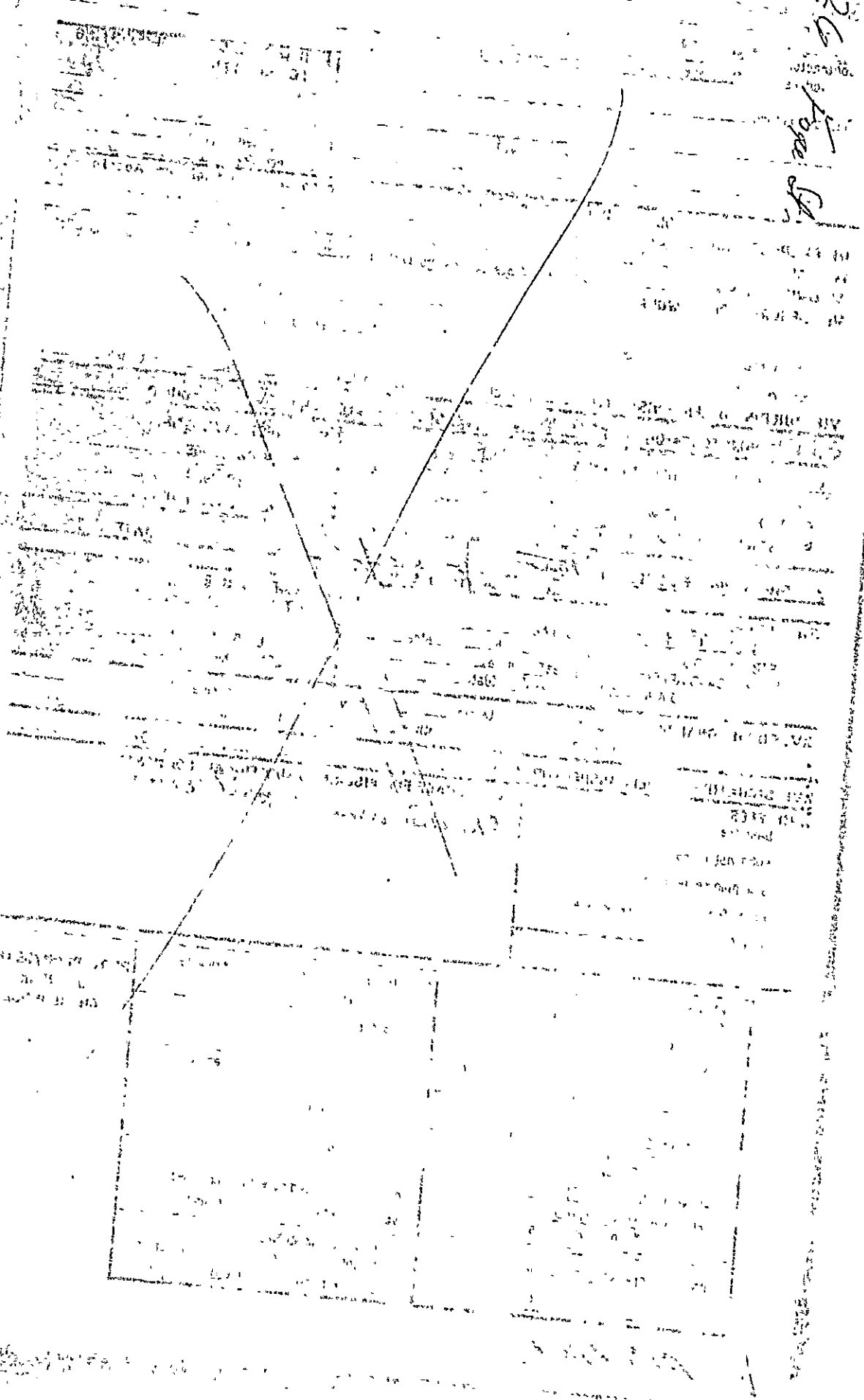

940075

Permit # _____ City of Portland BUILDING PERMIT APPLICATION Fee \$115.00 Zone _____ Map # _____ Lot # _____
Please fill out any part which applies to job. Proper plans must accompany form.

Owner: Tim Soley Phone # 775-7062
 Address: 111 Commercial St. Portland, ME 04101
 LOCATION OF CONSTRUCTION: 426 Fore St.
 Contractor: Matthew J. Crawford Sub: _____
 Address: 426 Fore St. Portland 04101 Phone # 772-5243
 Est. Construction Cost: _____,000 Proposed Use: hair salon
 Past Use: hair salon
 # of Existing Res. Units _____ # of New Res Units _____
 Building Dimensions L _____ W _____ Total Sq Ft _____
 # Stories: _____ # Bedrooms _____ Lot Size _____
 Is Proposed Use: Seasonal _____ Condominium _____ Conversion _____
 Explain Conversion: to make interior and exterior renovations as per plans (2 sets)

For Official Use Only
 Date: Jan. 28, 1994 Subdivision: _____
 Inside Fire Limit: _____ Name: EGH-21004
 Bldg Code: _____ Lot: _____
 Time Limit: _____ Ownership: _____ Public _____ Private _____
 Estimated Cost: 19,000

Zoning: _____
 Street Frontage Provided: _____
 Provided Setbacks Front _____ Back _____ Side _____ Side _____
 Required: _____
 Zoning Board Approval: Yes _____ No _____ Date: _____
 Planning Board Approval: Yes _____ No _____ Date: _____
 Conditional Use _____ Variance _____ Site Plan _____ Subdivision _____
 Shoresland Zoning Yes _____ No _____ Floodplain Yes _____ No _____
 Special Exception _____
 Other (Explain): WDA 2-1-94

Foundation: Not enough debris to warrant a dumpster
 1. Type of Soil _____
 2. Set Backs - Front _____ Rear _____ Side(s) _____
 3. Footings Size _____
 4. Foundation Size _____
 5. Other _____

Floor:
 1. Sill's Size _____ Sills must be anchored.
 2. Girder Size _____
 3. Lally Column Spacing _____ Size _____
 4. Joists Size _____ Spacing 16" O C
 5. Bridging Type _____ Size _____
 6. Floor Sheathing Type _____ Size _____
 7. Other Material _____

Exterior Walls:
 1. Studding Size _____ Spacing _____
 2. No. windows _____
 3. No. Doors _____
 4. Header Sizes _____ Span(s) _____
 5. Bracing Yes _____ No _____
 6. Corner Posts Size _____
 7. Insulation Type _____ Size _____
 8. Sheathing Type _____ Size _____
 9. Siding Type _____ Weather Exposure _____
 10. Masonry Materials _____
 11. Metal Materials _____

Interior Walls:
 1. Studding Size _____ Spacing _____
 2. Header Sizes _____ Spacing _____
 3. Wall Covering Type _____
 4. Fire Wall if required _____
 5. Other Materials _____

Ceiling:
 1. Ceiling Joists Size _____
 2. Ceiling Strapping Size _____ Spacing _____ Not in District or Landmark
 3. Type Ceilings _____ Does not require review
 4. Insulation Type _____ Size _____ requires review
 5. Ceiling Height _____

Roof:
 1. Truss or Rafter Size _____ Span _____ Action _____ Approved _____
 2. Sheathing Type _____ Size _____ Approved with Conditions _____
 3. P. of Covering Type _____ Denied _____

Chimneys:
 Type _____ Number of Fire Places _____ Date _____
 Signature _____

Heating:
 Type of Heat _____

Electrical:
 Service Entrance Size _____ Smoke Detector Required Yes _____ No _____

Plumbing:
 1. Approval of soil test if required Yes _____ No _____
 2. No. of Tubs or Showers _____
 3. No. of Flushes _____
 4. No. of Lavatories _____
 5. No. of other Fixtures _____

Swimming Pools:
 1. Type _____
 2. Pool Size _____ Square Footage _____
 3. Must conform to National Electrical Code and State Law

Received By: Matthew J. Crawford
 Signature of Applicant: Matthew John Crawford Date: 1/28/94

CEO's District: 2

CONTINUED TO REVERSE SIDE
 Ivory Tag - CEO [2] Ms. M. A. 15-17

PERMIT ISSUED WITH LETTER

White - Tax Assessor

PLUMBING APPLICATION

Department of Human Services
Division of Health Engineering
(207) 289-3626

PROPERTY ADDRESS

Town Or Plantation: Portland

Street Subdivision Lot #: 145 Fair St

PROPERTY OWNERS NAME

Last: Parsons First: Michael

Applica Name: Local Plumber # 117

Mailing Address of Owner/Applicant (if Different): 251 Union St Portland ME 04102

PORTLAND 3719 TOWN COPY

Date Permit Issued: 11/12/89 Fee: \$121.00

Local Plumbing Inspector Signature: _____ L.P.I. # 117

Owner/Applicant Statement

I certify that the information submitted is correct to the best of my knowledge and understand that any falsification is reason for the Local Plumbing Inspector to deny a Permit.

Signature of Owner/Applicant: _____ Date: 11/12/89

Caution: Inspection Required

I have inspected the installation authorized above and found it to be in compliance with the Maine Plumbing Rules.

Local Plumbing Inspector Signature: _____ Date Approved: JAN 12 1990

PERMIT INFORMATION

This Application is for: **1. NEW PLUMBING**

Type Of Structure To Be Served: **3. MULTIPLE FAMILY DWELLING**

Plumbing To Be Installed By: **1. MASTER PLUMBER**

NOV 4 1989

LICENSE # 117

Hook-Up & Piping Relocation Maximum of 1 Hook-Up	Number	Column 2 Type of Fixture	Number	Column 1 Type of Fixture
HOOK-UP: to public sewer in those cases where the connection is not regulated and inspected by the local Sanitary District		Hosebibb / Silcock		Bathub (and Shower)
	<u>2</u>	Floor Drain		Shower (Separate)
OR		Urinal		Sink
		Drinking Fountain		Wash Basin
HOOK-UP, to an existing subsurface wastewater disposal system.		Indirect Waste		Water Closet (Toilet)
		Water Treatment Softener Filter, etc		Clothes Washer
PIPING RELOCATION, of sanitary lines, drains, and piping without new fixtures		Grease/Oil Separator	<u>1</u>	Dish Washer
		Dental Cuspidor		Garbage Disposal
		Bidet		Laundry Tub
Number of Hook Ups & Relocations		Other: _____	<u>1</u>	Water Heater
Hook-Up & Relocation Fee		Fixtures (Subtotal) Column 2	<u>4</u>	Fixtures (Subtotal) Column 1
			<u>3</u>	Fixtures (Subtotal) Column 2
			<u>7</u>	Total Fixtures
			\$	Fixture Fee
			\$	Hook-Up & Relocation Fee
			\$ <u>31.</u>	Permit Fee (Total)

SEE PERMIT FEE SCHEDULE FOR CALCULATING FEE

* Mail to: Jack Solby, 1000 Commercial St., Portland, Me. 04101.

PERMIT # 171 CITY OF Portland BUILDING PERMIT APPLICATION MAP # _____ LOT# _____

Please fill out any part which applies to job. Proper plans must accompany any form.

Owner: John Cudron and Company 775-1211
Address: Houlton Street Ptd.

LOCATION OF CONSTRUCTION 424 Fore St. 2nd

CONTRACTOR: Gypsy, Inc. SUBCONTRACTORS: 778-871-8271

ADDRESS: 424 Fore Street Ptd. No. 04101

Est. Construction Cost: _____ Type of Use: business

Past Use: _____

Building Dimensions: L _____ W _____ Sq Ft _____ # Stories _____ Lot Size _____

Is Proposed Use: _____ Seasonal _____ Condominium _____ Apartment _____

Conversion - Explain, erect one hanging sign as per plan

COMPLETE ONLY IF THE NUMBER OF UNITS WILL CHANGE erect one

Residential Buildings Only: _____

Of Dwelling Units _____ # Of New Dwelling Units building as p

Foundation:
1. Type of Soil: _____
2. Set Backs - Front _____ Rear _____ Side(s) _____
3. Footings Size: _____
4. Foundation Size: _____
5. Other: _____

Floor:
1. Sills Size: _____ Sill must be anchored.
2. Girder Size: _____
3. Lally Column Spacing: _____ Size: _____
4. Joists Size: _____ Spacing 16" O.C.
5. Bridging Type _____ Size: _____
6. Floor Sheathing Type _____ Size: _____
7. Other Material: _____

Exterior Walls:
1. Studding Size _____ Spacing _____
2. No. windows _____
3. No. Doors _____
4. Header Sizes _____ Span(s) _____
5. Bracing: Yes _____ No _____
6. Corner Posts Size _____
7. Insulation Type _____ Size _____
8. Sheathing Type _____ Size _____
9. Siding Type _____ Weather Exposure _____
10. Masonry Materials _____
11. Metal Materials _____

Interior Walls:
1. Studding Size _____ Spacing _____
2. Header Sizes _____ Span(s) _____
3. Wall Covering Type _____
4. Fire Wall if required _____
5. Other Materials _____

For Official Use Only
Date: March 21, 1989 Subdivision: _____
Inside Fire Lines _____ Name: _____
Bldg Code _____ Lot: _____
Time Limit _____ Block: _____
Estimated Cost _____ Permit Expiration: 03-21-89
Value _____ Ownership: _____
Fee: 25.00 + 4.50 City of Portland

Ceiling: 22.5 ft.
1. Ceiling Joists Size: _____
2. Ceiling Strapping Size _____ Spacing _____
3. Type Ceiling: _____
4. Insulation Type _____ Size _____
5. Ceiling Height: _____

Roof:
1. Truss or Rafter Size _____ Span _____
2. Sheathing Type _____ Size _____
3. Roof Covering Type _____
4. Other: _____

Stoves:
Type: _____ Number of Fire Places _____
Type of Heat: _____
Service Entrance Size _____ Smoke Detector Required Yes _____ No _____

Plumbing:
1. Approval of soil test if required Yes _____ No _____
2. No. of Toilets _____ Showers _____
3. No. of Sinks _____
4. No. of Lavatories _____
5. No. of Other Fixtures _____

Swimming Pools:
1. Type: _____
2. Pool Size: _____ Square Footage _____
3. Must conform to National Electrical Code and State Law.

Zoning: District D-3 Street Frontage Req. _____ Provided _____
Required Setbacks: Front _____ Back _____ Side _____ Side _____

Review Required:
Zoning Board Approval: Yes _____ No _____ Date: _____
Planning Board Approval: Yes _____ No _____ Date: _____
Conditional Use: _____ Variance _____ Site Plan _____ Subdivision _____
Shore and Floodplain Mgmt. _____ Special Exception _____
Other (Explain): _____
Date Approved: 3-21-89

Permit Issued By: Deborah Good

Signature of Applicant: _____ Date: _____

Signature of CEO: _____ Date: _____

Inspection Dates: _____

PLOT PLAN



FFES (Breakdown From Front)

Base Fee \$ _____

Subdivision Fee \$ _____

Site Plan Review Fee \$ _____

Other Fees \$ _____

(Explain) _____

Late Fee \$ _____

Type	Inspection Record	Date
_____	_____	____/____/____
_____	_____	____/____/____
_____	_____	____/____/____
_____	_____	____/____/____

OWNER'S 3/26/89 am - No sign as yet -
 I instructed the contractor to take out a permit for the
 front porch, windows & doors.

3/26/89
 Proceed as per plan

Signature of Applicant _____

Date _____

WORKSHEET TO ERECT SIGN OVER PUBLIC SIDEWALK - THIS IS NOT A PERMIT!

To the INSPECTOR OF BUILDINGS, PORTLAND, ME. Portland, Maine, 3/16 1989
The undersigned hereby applies for a permit to erect the following described sign extending over a public sidewalk or street in accordance with the Building Code of the City of Portland, and the following specifications:
24" FAÇADE ST. Within Fire Limits? _____ Dist No. _____
which sign is to be attached JOHN GENDRON
of owner of sign GYPSY KING
of name and address JACK SOLEY Telephone 871-8291
does contractor's bond expire? _____

Information Concerning Building

No. stories 3 Material of wall to which sign is to be attached MASONRY

Details of Sign and Connections

Building owner's consent and agreement filed with application _____
Electric? NO Vertical dimension after erection _____ Horizontal _____
Weight _____ lbs. Will there be any hollow _____ Any rigid frame? _____
Material of frame WOOD (2x3 PLYWOOD) No. advertising faces _____ material _____
No. rigid connections _____ Are they fastened directly to frame of sign? _____
No. through bolts _____ Size _____ Location, top or bottom _____
No. guys _____ material EXISTING BRACKET Size _____
Minimum clear height above sidewalk or street 10'
Maximum projection into street 5' Fee \$ _____
Signature of contractor [Signature]

2 SIGNS
1 ACROSS FAÇADE 10' x 1'

1 HANGING FROM BUILDING 5' x 2'6"
APPX 11' FROM PAVEMENT

RECEIVED
MAR 2 1989
DEPT. OF BUILDING INSPECTIONS
CITY OF PORTLAND

SIGNAGE APPLICATION

3/13/89

GYPSEY, INC.
424 FOREST ST

772-3300
JACK SOLEY
(871-8271)

Jack - go ahead & apply
for the sign - John H
would like to know
materials, who is making
them, & where I can
see a sample of their
work. *John*
3.20.89

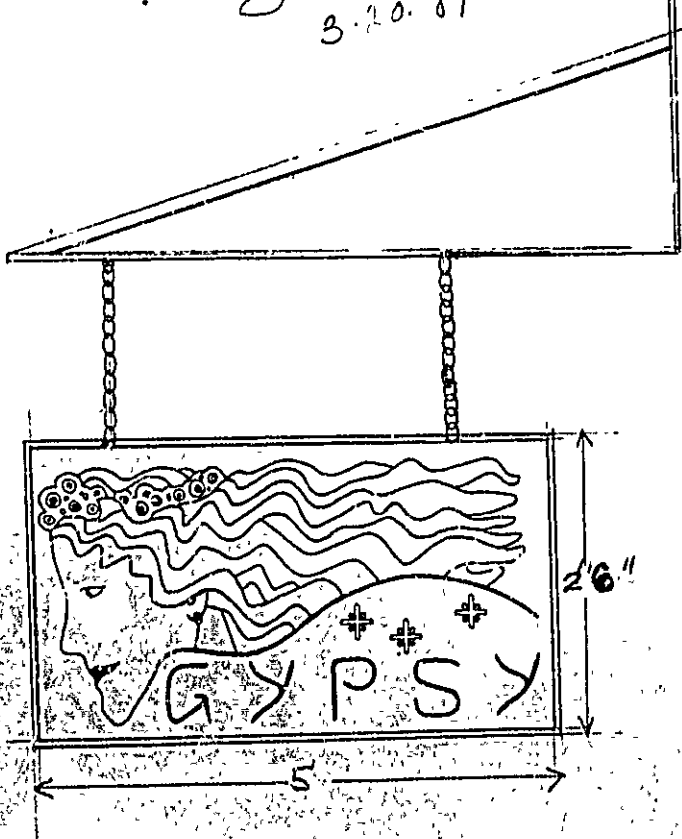

USE EXISTING
BRACKET

RECEIVED

MAR 2 6 1989

DEPT. OF BUILDING INSPECTIONS
CITY OF PORTLAND

White + Black
Front w/ be
Black + Gold
like Matthew John

GYPSEY, INC.
424 FORE ST

JACK SOLET
871-8271

BLACK SIGN WITH GOLD LETTERING
ACROSS FACADE OF STOREFRONT



*Like
Matthew John*

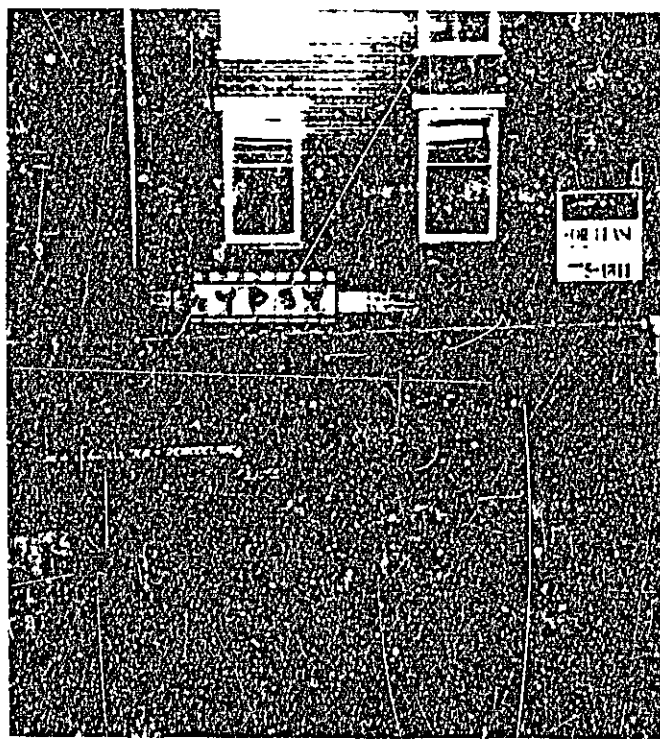

(10' x 1')

RECEIVED

MAR 2 0 1989

DEPT OF BUILDING INSPECTIONS
CITY OF PORTLAND

WRITTEN CONSENT AND AGREEMENT RELATING TO A CERTAIN SIGN OR AWING PROPOSED TO BE ERECTED ON A BUILDING AT 424 FORE ST. IN PORTLAND, MAINE Hendren Bros Assoc being the owner of the premises at 424 Fore St. in Portland, Maine hereby gives consent to the erection of a certain sign owned by Jack Saley over the side-walk or on the building from said premises as described in application to the Division of Inspection Services of Portland, Maine for a permit to cover the erection of said sign:

And in consideration of the issuance of said permit Hendren Bros Assoc. owner of said premises, in event said sign shall cease to serve the purpose for which it was erected or shall become dangerous and in event the owner of said sign shall fail to remove said sign or make it permanently safe in case the sign still serves the purpose for which it was erected, hereby agrees for himself or itself, for his heirs, its successors, and his or its assigns, to completely remove said sign in such condition and of order from him to remove it.

In Witness whereof, the ^{Property Manager} owner of said premises has signed this consent and agreement this 20th day of March 19 89.

Ernest E. Lepchick

Owner's signature

Property Mgr, Hendren & Co.
Managing Agent for
Hendren Bros Associates

[Signature]

Lessee's signature

RECEIVED

MAR 20 1989

DEPT. OF BUILDING INSPECTION
CITY OF PORTLAND

912377

Permit # 912377 City of Portland BUILDING PERMIT APPLICATION Fee \$26.20 Zone MF Map # Lot #
Please fill out any part which applies to job. Proper plans must accompany form.

Owner: Sugar Reef Phone #
 Address: 424 Fore St; Ptld, ME 04101
 LOCATION OF CONSTRUCTION 424 Fore St.
 Contractor: Sign Design Sub: 799-2000
 Address: 743 Broadway ; So Ptld Phone # MF 04106
 Est. Construction Cost: Proposed Use: retail store w sign Zoning:
 Past Use: retail store
 # of Existing Res. Units # of New Res. Units
 Building Dimensions L W Total Sq. Ft.
 # Stories: # Bedrooms Lot Stk.
 Is Proposed Use: Seasonal Condominium Conversion
 Explain Conversion Erect one sign - 2'x3'

For Official Use Only
 Subdivision: **PERMIT ISSUED**
 Date: 2/11/91 Name:
 Inside Fire Limit: LA:
 Bldg Code: Ownership:
 Time Limit: City of Portland
 Estimated Cost: B-3 Business

Street Frontage Provided: Side Side
 Provided Setbacks: Front Back Side Side

Review Required:
 Zoning Board Approval: Yes No Date:
 Planning Board Approval: Yes No Date:
 Conditional Use: Variance Site Plan Subdivision
 Shoreland Zoning Yes No Floodplain Yes No
 Special Exception
 Other (Explain): OK WPA 2-11-91

Foundations:
 1. Type of Soil:
 2. Set Backs - Front Rear Side(s)
 3. Footings Size:
 4. Foundation Size:
 5. Other

Floors:
 1. Sills Size: Sills must be anchored.
 2. Girder Size:
 3. Lally Column Spacing: Size:
 4. Joists Size: Spacing 16" O.C.
 5. Bridging Type: Size:
 6. Floor Sheathing Type: Size:
 7. Other Material:

Exterior Walls:
 1. Studding Size Spacing
 2. No. windows
 3. No. Doors
 4. Header Sizes Span(s)
 5. Bracing: Yes No
 6. Corner Posts Size
 7. Insulation Type Size
 8. Sheathing Type Size
 9. Siding Type Weather Exposure
 10. Masonry Materials
 11. Metal Materials

Interior Walls:
 1. Studding Size Spacing
 2. Header Sizes Span(s)
 3. Wall Covering Type
 4. Fire Wall if required
 5. Other Materials

Celling:
 1. Ceiling Joists Size:
 2. Ceiling Strapping Size Spacing Not in District or Landmark
 3. Type Ceiling: Size Does not require review.
 4. Insulation Type
 5. Ceiling Light: Requires Review.

Roof:
 1. Truss or Rafter Size Span Action: Approved
 2. Sheathing Type Size Approved with Conditions
 3. Roof Covering Type Denied

Chimneys:
 Type: Number of Fire Places Note:

Heating:
 Type of Heat:

Electrical:
 Service Entrance Size: Smoke Detector Required Yes No

Plumbing:
 1. Approval of soil test if required Yes No
 2. No. of Tubs or Showers
 3. No. of Flushes
 4. No. of Lavatories
 5. No. of Other Fixtures

Swimming Pools:
 1. Type:
 2. Pool Size: x Square Footage
 3. Must conform to National Electrical Code and State Law.

Permit Received By Louise E. Chase

Signature of Applicant Roger Flannery Date 2-11-91

Signature of CEO Roger Flannery Date

Inspection Dates

White-Tax Assessor Yellow-GPCOG White Tag - CEO

Copyright GPCOG 1988
Mr. Mitchell



APPLICATION FOR PERMIT
 DEPARTMENT OF BUILDING INSPECTIONS SERVICES
 ELECTRICAL INSTALLATIONS

Date: May 16, 1966
 Received and Permitted by: _____

To the CHIEF ELECTRICAL INSPECTOR: _____
 The undersigned hereby applies for a permit to make electrical installations in accordance with the provisions of the National Electrical Code and the following conditions:
 PROJECT: RENOVATION OF 26 FORG STREET

OWNER'S NAME: Michael Johnson ADDRESS: _____

CUTLERS: _____
 Receptacles _____ Switches _____ Plugmold _____ TOTAL _____
 FIXTURES: (number of)
 Incandescent _____ Fluorescent _____ (not strip) TOTAL _____
 Strip Fluorescent _____ ft. _____

SERVICES:
 Overhead _____ Underground _____ Temporary _____ TOTAL amper _____

METERS: (number of) _____
 MOTORS: (number of) _____

Fractional _____
 1 HP or over _____

RESIDENTIAL HEATING:
 Oil or Gas (number of units) _____
 Electric (number of rooms) _____

COMMERCIAL OR INDUSTRIAL HEATING:
 Oil or Gas (by a main burner) _____
 Oil or Gas (by separate units) _____
 Electric Under 20 kws _____ Over 20 kws _____

APPLIANCES: (number of)
 Ranges _____ Water Heaters _____
 Cook Tops _____ Dish Sinks _____
 Wall Ovens _____ Dishwashers _____
 Dryers _____ Comp. Mors _____
 Fans _____ Others (specify) _____

MISCELLANEOUS: (number of)
 Branch Panels _____
 Transformers _____
 Air Conditioners Central _____ 10.00
 Separate Unit (window) _____
 Signs 20 sq. ft. and under _____
 Over _____
 Swimming Pools _____
 Fire/Alarm _____ Residential _____ Commercial _____
 Health City Jule _____ Vol. (Sub _____) 30 amp and under _____
 over 30 amp _____
 Circuit Breakers _____
 Alteration Wires _____
 Repairs of _____
 Emergency Lights, battery _____
 Emergency Generators _____

FOR ADDITIONAL WORK NOT ON ORIGINAL PERMIT
 FOR REMOVAL OF A "STOP ORDER" (300-10)

INSTALLATION FEE DUE: _____
 DOUBLE FEE DUE: _____
 TOTAL AMOUNT DUE: 10.00

INSPECTION

Will be read on _____, 1966 or Will Call _____

CONTRACTOR'S NAME: Electric
 ADDRESS: 99 Capital Street
774-854

MASTER LICENSE
 LIMITED LICENSE

SIGNATURE OF CONTRACTOR
Michael Johnson

INSPECTOR: _____
 OFFICE: _____
 OPERATOR: _____



APPLICATION FOR PERMIT
 DEPARTMENT OF BUILDING INSPECTIONS SERVICES
 ELECTRICAL INSTALLATIONS

Date 05 August 1994, 19
 Receipt and Permit number 15768

To the CHIEF ELECTRICAL INSPECTOR, Portland, Maine:
 The undersigned hereby applies for a permit to make electrical installations in accordance with the laws of
 Maine, the Portland Electrical Ordinance, the National Electrical Code and the following specifications:

LOCATION OF WORK: 426 Fore St.
 OWNER'S NAME: Matthew John ADDRESS _____ FEES _____

OUTLETS: Receptacles 12 Switches _____ Plugmold _____ ft. TOTAL _____ 2.40

FIXTURES. (number of) Incandescent 10 Fluorescent _____ (not strip) TOTAL _____ 2.00
 Strip Fluorescent _____ ft _____

SERVICES: Overhead _____ Underground _____ Temporary _____ TOTAL amperes _____

METERS: (number of) _____
 MOTORS: (number of) Fractional _____
 1 HP or over _____

RESIDENTIAL HEATING: Oil or Gas (number of units) _____
 Electric (number of rooms) _____

COMMERCIAL OR INDUSTRIAL HEATING: Oil or Gas (by a main boiler) _____
 Oil or Gas (by sep rate units) _____
 Electric Under 20 kws _____ Over 20 kws _____

APPLIANCES: (number of) Ranges _____ Water Heaters _____
 Cook Tops _____ Disposals _____
 Wall Ovens _____ Dishwashers _____
 Dryers _____ Compactors _____
 Fans _____ Others (denote) _____

MISCELLANEOUS. (number of) TOTAL _____ 4.00
 Branch Panels 1 _____

Transformers _____ 10.00
 Air Conditioners Central Unit 1 _____
 Separate Units (windows) _____

Signs 20 sq. ft. and under _____
 Over 20 sq. ft. _____

Swimming Pools Above Ground _____
 In Ground _____

Fire/Purglar Alarms Residential _____
 Commercial _____

Heavy Duty Outlets, 220 Volt (such as welders) 30 amp and under _____
 over 30 amps _____

Circuit Fuses, etc. _____
 Alterations to wires _____

Repair after fire _____
 Emergency Lights, battery _____

Emergency Generators _____

FOR ADDITIONAL WORK NOT ON ORIGINAL PERMIT _____
 FOR REMOVAL OF A "STOP ORDER" (304-16 L) _____

INSTALLATION FEE DUE _____
 DOUBLE FEE DUE _____
 TOTAL AMOUNT DUE. 18.40

INSPECTION: Will be ready on _____, 19__; or Will Call _____ xx
 CONTRACTOR'S NAME: Everything Elec
 ADDRESS: P.O. Box 10927
 TEL.: 774-3967
 MASTER LICENSE NO. _____
 LIMITED LICENSE NO. _____
 SIGNATURE OF CONTRACTOR: [Signature]

INSPECTOR'S COPY -- WHITE
 OFFICE COPY -- CANARY
 CONTRACTOR'S COPY -- GREEN