

RECEIVED  
NOV 11 1979  
DEPT. OF BLDG. 'HSP.  
CITY OF PORTLAND

*just to be*



APPLICATION FOR PERMIT

B.O.C.A. USE GROUP .....

B.O.C.A. TYPE OF CONSTRUCTION ... 0010.00

ZONING LOCATION F-2B PORTLAND, MAINE, Nov. 14, 1979

PERMIT ISSUED

NOV 14 1979

CITY OF PORTLAND

To the DIRECTOR OF BUILDING & INSPECTION SERVICES, PORTLAND, MAINE

The undersigned hereby applies for a permit to erect, alter, repair, demolish, move or install the following building, structure, equipment or change use in accordance with the Laws of the State of Maine, the Portland B.O.C.A. Building Code and Zoning Ordinance of the City of Portland with plans and specifications, if any, submitted herewith and the following specifications:

LOCATION 164 Middle Street Fire District #1 [ ] #2 [ ]
1. Owner's name and address Market St., Market Partnership-80 Exchange St., Suite 22 Telephone 772-4500
2. Lessee's name and address Telephone
3. Contractor's name and address Telephone
4. Architect Specifications Plans No. of sheets
Proposed use of building mini mall No. families
Last use No. families
Material No. stories Heat Style of roof Roofing
Other buildings on same lot
Estimated contractual cost \$ 300 Fee \$ 5.50

FIELD INSPECTOR-Mr. GENERAL DESCRIPTION

This application is for: @ 73-5451
Dwelling Ext. 234 To erect non-bearing partitions for section of mall to be used for ice cream shop as per plans, 1 sheet of plans. Stamp of Special Conditions
Garage
Masonry Bldg.
Metal Bldg.
Alterations
Demolitions
Change of Use
Other
Stephen Moss
Send permit to 2 Seaview Road
Care Elizabeth, Me. 04107

NOT TO APPLICANT: Separate permits are required by the installers and subcontractors of heating, plumbing, electrical and mechanicals.

PERMIT IS TO BE ISSUED TO 1 [ ] 2 [ ] 3 [ ] 4 [ ]
Other: .....

DETAILS OF NEW WORK

Is any plumbing involved in this work? Is any electrical work involved in this work?
Is connection to be made to public sewer? If not, what is proposed for sewage?
Has septic tank notice been sent? Form notice sent?
Height average grade to top of plate Height average grade to highest point of roof
Size, front depth No. stories solid or filled land? earth or rock?
Material of foundation Thickness, top bottom cellar
Kind of roof Rise per foot Roof covering
No. of chimneys Material of chimneys of lining Kind of heat fuel
Framing Lumber-Kind Dressed or full size? Corner posts Sills
Size Girder Columns under girders Size Max. on centers
Studs (outside walls and carrying partitions) 2x4-16" O. C. Bridging in every floor and flat roof span over 8 feet.
Joists and rafters: 1st floor 2nd 3rd roof
On centers: 1st floor 2nd 3rd roof
Maximum span: 1st floor 2nd 3rd roof
If one story building with masonry walls, thickness of walls? height?

IF A GARAGE

No. cars now accommodated on same lot, to be accommodated number commercial cars to be accommodated
Will automobile repairing be done other than minor repairs to cars habitually stored in the proposed building?

APPROVALS BY: DATE MISCELLANEOUS
BUILDING INSPECTION-PLAN EXAMINER Will work require disturbing of any tree on a public street?
ZONING: DATE Will there be in charge of the above work a person competent to see that the State and City requirements pertaining thereto are observed?
BUILDING CODE:
Fire Dept.:
Health Dept.:
Others:

Signature of Applicant Stephen Moss Phone # 799-4730
Type Name of above Stephen Moss 1 [ ] 2 [ ] 3 [ ] 4 [ ]
Other and Address

FIELD INSPECTOR'S COPY

NOTES

11-20-79 Brick is up - still working  
 on plant. & healthy

11-21-79 Water got completely  
 out and

12-4-79 Issue C.O. -  
 plumbg ok per time.

Permit No 79/10.33  
 Location 164 Middle St.  
 Owner Mbl. St. Mbl. Plumbing  
 Date of permit 11-14-79  
 Approved 11-14-79 J. J. [Signature]

CITY OF PORTLAND, MAINE

MEMORANDUM

TO: Mr. Fred Taylor

DATE: 11/8/79

FROM: Fire Prevention Bureau

SUBJECT: 164 Middle St.

Approval \_\_\_\_\_ is hereby given for a building permit  
from this Department subject to the following requirements/reasons:

- 1) A flow switch or pressure switch shall be installed on the main riser and be electrically connected to horn and flashing light sounding devices. These sounding devices shall be placed at each level to assure that all persons can hear the alarm.

  
Lt. James P. Collins  
Fire Prevention Bureau

CITY OF PORTLAND, MAINE  
Department of Building Inspection



# Certificate of Occupancy

LOCATION 164 Middle Street

Date of Issue Nov. 21, 1979

Issued to Elizabeth Birchfield

This is to certify that the building, premises, or part thereof, at the above location, built--altered  
--changed as to use under Building Permit No. 79/1035, has had final inspection, has been found to conform  
substantially to requirements of Zoning Ordinance and Building Code of the City, and is hereby approved for  
occupancy or use, limited or otherwise, as indicated below.

PORTION OF BUILDING OR PREMISES

APPROVED OCCUPANCY

Section of Mall

Bag Shop

Limiting Conditions:

This certificate supersedes  
certificate issued

Approved:

11-21-79  
(Date)

*Mary Schmitt*  
Inspector

*W. Deet*  
Inspector of Buildings

Notice: This certificate identifies lawful use of building or premises, and ought to be transferred from  
owner to owner when property changes hands. Copy will be furnished to owner or lessee for one dollar

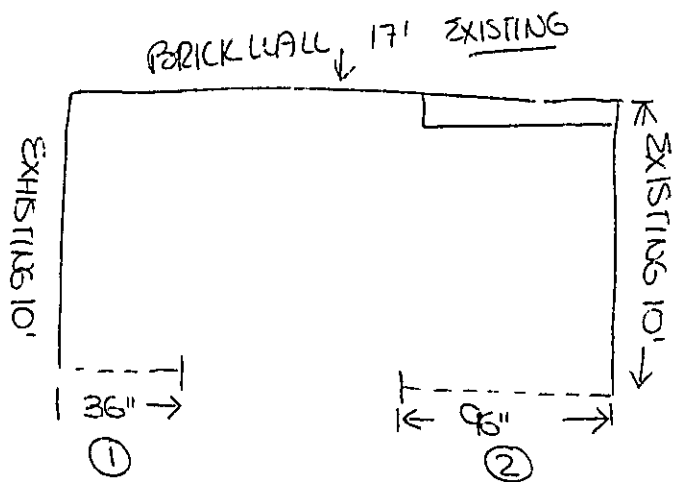

RECEIVED  
 NOV 15 1979  
 DEPT. OF BLDG. INSP.  
 CITY OF PORTLAND

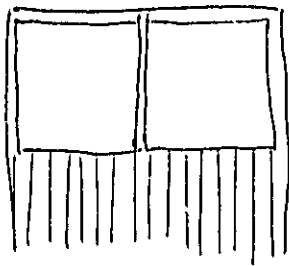

proposed walls - ① faced w/ boards 1 side  
 sheet rock second side  
 8'96" high (face)

② Faced w/ boards to  
 40" high - 2 windows  
 1/4" plate above

all exposed wood to  
 be treated w/ fire retardant



APPLICATION FOR PERMIT

PERMIT ISSUED

B.O.C.A. USE GROUP ... B.O.C.A. TYPE OF CONSTRUCTION ... 001035

NOV 15 1979

ZONING LOCATION ... PORTLAND, MAINE, NOV. 15, 1979 CITY OF PORTLAND

To the DIRECTOR OF BUILDING & INSPECTION SERVICES, PORTLAND, MAINE

The undersigned hereby applies for a permit to erect, alter, repair, demolish, move or install the following building, structure, equipment or change use in accordance with the Laws of the State of Maine, the Portland B.O.C.A. Building Code and Zoning Ordinance of the City of Portland with plans and specifications, if any, submitted herewith and the following specifications:

LOCATION ... 164 Middle Street - The Bag Lady ... Fire District #1, '2
1. Owner's name and address: Market St., Market St. Partnership ... Telephone ...
2. Lessee's name and address: Elizabeth Birchfield-Main St., Exchange St. ... Telephone .625-8421
3. Contractor's name and address ... R. & L. Builders - Gray, Me. ... Telephone ...
4. Architect ... Specifications ... Plans ... No. of sheets ...
Proposed use of building ... mini. mall ... No. families ...
Last use ... No. families ...
Material ... No. stories ... Heat ... Style of roof ... Roofing ...
Other buildings on same lot ...
Estimated contractual cost \$600. ... Fee \$5.50

FIELD INSPECTOR-Mr. GENERAL DESCRIPTION

This application is for @ 775-5451 Ext. 234

Dwelling ... Garage ... To erect 2 non-bearing walls 1 36 in. 1 96 in. as per plans 1 sheet of plans Stamp of Special Conditions
Masonry Bldg. ... Metal Bldg. ... Alterations ... Demolitions ... Change of Use ... Other ... Send permit to 18 Meadoway So. Portland, Me. 04106 c/o Bruce Bishop

NOTE TO APPLICANT: Separate permits are required by the installers and subcontractors of heating, plumbing, electrical and mechanicals.

PERMIT IS TO BE ISSUED TO 1 2 3 4 Other:

DETAILS OF NEW WORK

Is any plumbing involved in this work? ... Is any electrical work involved in this work? ...
Is connection to be made to public sewer? ... If not, what is proposed for sewage? ...
Has septic tank notice been sent? ... Form notice sent? ...
Height average grade to top of plate ... Height average grade to highest point of roof ...
Size, front ... depth ... No. stories ... solid or filled land? ... earth or rock? ...
Material of foundation ... Thickness, top ... bottom ... cellar ...
Kind of roof ... Rise per foot ... Roof covering ...
No. of chimneys ... Material of chimneys ... of lining ... Kind of heat ... fuel ...
Framing Lumber--Kind ... Dressed or full size? ... Corner posts ... Sills ...
Size Girder ... Columns under girders ... Size ... Max. on centers ...
Studs (outside walls and carrying partitions) 2x4-16" O. C. Bridging in every floor and flat roof span over 8 feet.
Joists and rafters: 1st floor ... 2nd ... 3rd ... roof ...
On centers: 1st floor ... 2nd ... 3rd ... roof ...
Maximum span: 1st floor ... 2nd ... 3rd ... roof ...
If one story building with masonry walls, thickness of walls? ... height?

IF A GARAGE

No cars now accommodated on same lot ... to be accommodated ... number commercial cars to be accommodated ...
Will automobile repairing be done other than minor repairs to cars habitually stored in the proposed building? ...

APPROVALS BY: DATE MISCELLANEOUS
BUILDING INSPECTION--PLAN EXAMINER ... Will work require disturbing of any tree on a public street? ...
ZONING: ...
BUILDING CODE ... Will there be in charge of the above work a person competent to see that the State and City requirements pertaining thereto are observed? ...
Fire Dept.: ...
Health Dept.: ...
Others: ...

Signature of Applicant Elizabeth Birchfield Phone # same
Type Name of above Elizabeth Birchfield 1 2 3 4 Other and Address

FIELD INSPECTOR'S COPY

NOTES

11-20-79 Near completion  
11-21-79 Completed -  
Issue C.O. -

Permit No. 79/1185  
Location 164 Middle Rd East  
Owner M. J. Smith  
Date of permit 11-15-79  
Approved [Signature]

Large grid area with horizontal and vertical lines, mostly blank.

NOV 21 1979





**APPLICATION FOR PERMIT**  
 DEPARTMENT OF BUILDING INSPECTIONS SERVICES  
 ELECTRICAL INSTALLATIONS

Date Sept. 19, 19 79  
 Receipt and Permit number A 34766

To the CHIEF ELECTRICAL INSPECTOR, Portland, Maine.

The undersigned hereby applies for a permit to make electrical installations in accordance with the laws of Maine, the Portland Electrical Ordinance, the National Electrical Code and the following specifications:

LOCATION OF WORK: 167 Middle Street - Ratskeller Restaurant  
 OWNER'S NAME: Market St. Market ADDRESS: 151 Maine Ave. Westbrook

		<b>FEES</b>	
<b>OUTLETS:</b>	Receptacles _____ Switches _____ Plugmold _____ ft. TOTAL <u>1-30</u> .....		<u>3.00</u>
<b>FIXTURES: (number of)</b>	Incandescent <u>xx</u> Fluorescent _____ (not strip) TOTAL <u>14</u> .....		<u>3.40</u>
	Strip Fluorescent _____ ft. ....		
<b>SERVICES:</b>	Overhead <u>xx</u> Underground <u>xx</u> Temporary _____ TOTAL amperes <u>2000</u> .....		<u>3.00</u>
<b>METERS: (number of)</b>	<u>1</u> .....		<u>.50</u>
<b>MOTORS: (number of)</b>	Fractional <u>9</u> .....		<u>4.50</u>
	1 HP or over <u>1</u> .....		<u>1.00</u>
<b>RESIDENTIAL HEATING:</b>	Oil or Gas (number of units) _____ .....		
	Electric (number of rooms) _____ .....		
<b>COMMERCIAL OR INDUSTRIAL HEATING:</b>	Oil or Gas (by a main boiler) _____ .....		
	Oil or Gas (by separate units) _____ .....		
	Electric Under 20 kws _____ Over 20 kws _____ .....		
<b>APPLIANCES: (number of)</b>	Ranges <u>1</u> .....	Water Heaters _____	
	Cook Tops <u>1</u> .....	Disposals <u>1</u> .....	
	Wall Ovens _____	Dishwashers <u>1</u> .....	
	Dryers _____	Compactors _____	
	Fans <u>3</u> .....	Others (denote) _____	
	<b>TOTAL</b> .....		<u>10.50</u>
<b>MISCELLANEOUS: (number of)</b>	Branch Panels _____ .....		
	Transformers _____ .....		
	Air Conditioners Central Unit _____ .....		
	Separate Units (windows) _____ .....		
	Signs 20 sq. ft. and under _____ .....		
	Over 20 sq. ft. _____ .....		
	Swimming Pools Above Ground _____ .....		
	In Ground _____ .....		
	Fire/Burglar Alarms Residential _____ .....		
	Commercial _____ .....		
	Heavy Duty Outlets, 220 Volt (such as welders) 30 amps and under _____ .....		
	over 30 amps _____ .....		
	Circus, Fairs, etc. _____ .....		
	Alterations to wires _____ .....		
	Repairs after fire _____ .....		
	Emergency Lights, battery _____ .....		
	Emergency Generators _____ .....		
	INSTALLATION FEE DUE: _____		
	FOR ADDITIONAL WORK NOT ON ORIGINAL PERMIT ..... DOUBLE FEE DUE: _____		
	FOR REMOVAL OF A "STOP ORDER" (304-16.b) .....		
	<b>TOTAL AMOUNT DUE:</b> .....		<u>25.90</u>

**INSPECTION:**  
 Will be ready on \_\_\_\_\_, 19 \_\_\_\_; or Will Call xx  
**CONTRACTOR'S NAME:** Falmouth Electric  
**ADDRESS:** 245 Blackstrap Rd. Falmouth  
**TEL.:** 797-6174  
**MASTER LICENSE NO.:** 420 **SIGNATURE OF CONTRACTOR:**  
**LIMITED LICENSE NO.:** \_\_\_\_\_ Edward [Signature]

INSPECTOR'S COPY — WHITE  
 OFFICE COPY — CANARY  
 CONTRACTOR'S COPY — GREEN

ELECTRICAL INSTALLATIONS -

Permit Number 37766  
Location 1647 Middle St  
Owner Market St Quarter  
Date of Permit 9-19-79  
Final Inspection 11-14-79  
By Inspector W. Kelly  
Permit Application Register Page No. 36

INSPECTIONS: Service \_\_\_\_\_ by \_\_\_\_\_  
Service called in \_\_\_\_\_  
Closing-in \_\_\_\_\_ by \_\_\_\_\_

PROGRESS INSPECTIONS: Final 11-14-79  
\_\_\_\_\_  
\_\_\_\_\_  
\_\_\_\_\_

CODE  
COMPLIANCE  
COMPLETED  
DATE 11-14-79

REMARKS:

	<u>Other inspections not listed.</u>

Catala Bell  
Costa

*[Faint handwritten notes at the bottom of the page]*



**APPLICATION FOR PERMIT**  
 DEPARTMENT OF BUILDING INSPECTIONS SERVICES  
 ELECTRICAL INSTALLATIONS

Date 8-2, 19 79  
 Receipt and Permit number A28906

To the CHIEF ELECTRICAL INSPECTOR, Portland, Maine:

The undersigned hereby applies for a permit to make electrical installations in accordance with the laws of Maine, the Portland Electrical Ordinance, the National Electrical Code and the following specifications:

LOCATION OF WORK: 164 Middle St.

OWNER'S NAME: Pritam Singh ADDRESS: 416 Fore St. (222-775-0931)

OUTLETS:		FEES
Receptacles _____	Switches _____	Plugmold _____
ft. TOTAL _____		
FIXTURES: (number of)		
Incandescent _____	Flourescent _____	(not strip) TOTAL _____
Strip Flourescent _____	ft. _____	
SERVICES:		
Overhead _____	Underground _____	Temporary _____
TOTAL amperes _____		
METERS: (number of) _____		
MOTORS: (number of)		
Fractional <u>9@.50</u> _____		
1 HP or over <u>1 1/2 - 2</u> <u>5.1.00</u> _____		<u>4.50</u>
RESIDENTIAL HEATING:		<u>2.00</u>
Oil or Gas (number of units) _____		
Electric (number of rooms) _____		
COMMERCIAL OR INDUSTRIAL HEATING:		
Oil or Gas (by a main boiler) <u>Gas by Main Boiler</u> _____		<u>5.00</u>
Oil or Gas (by separate units) _____		
Electric Under 20 kws _____	Over 20 kws _____	
APPLIANCES: (number of)		
Ranges _____	Water Heaters _____	
Cook Tops _____	Disposals _____	
Wall Ovens _____	Dishwashers _____	
Dryers _____	Compactors _____	
Fans _____	Others (denote) _____	
TOTAL _____		
MISCELLANEOUS: (number of)		
Branch Panels _____		
Transformers _____		
Air Conditioners Central Unit _____		
Separate Units (windows) _____		
Signs 20 sq. ft. and under _____		
Over 20 sq. ft. _____		
Swimming Pools Above Ground _____		
In Ground _____		
Fire/Burglar Alarms Residential _____		
Commercial _____		
Heavy Duty Outlets, 220 Volt (such as welders) 30 amps and under _____		
over 30 amps _____		
Circus, Fairs, etc. _____		
Alterations to wires _____		
Repairs after fire _____		
Emergency Lights, battery _____		
Emergency Generators _____		
FOR ADDITIONAL WORK NOT ON ORIGINAL PERMIT _____	INSTALLATION FEE DUE: _____	
FOR REMOVAL OF A "STOP ORDER" (304-16.b) _____	DOUBLE FEE DUE: _____	
	TOTAL AMOUNT DUE: <u>11.50</u>	

INSPECTION:  
 Will be ready on \_\_\_\_\_, 19\_\_; or Will Call x  
 CONTRACTOR'S NAME: Caron & Waltz  
 ADDRESS: 16 Peble St., S.P.  
 TEL.: 99-2228  
 MASTER LICENSE NO.: On Form SIGNATURE OF CONTRACTOR  
 LIMITED LICENSE NO.: \_\_\_\_\_ *[Signature]*

INSPECTOR'S COPY -- WHITE  
 OFFICE COPY -- CANARY  
 CONTRACTOR'S COPY -- GREEN





CITY OF PORTLAND, MAINE  
Department of Building Inspection

# Certificate of Occupancy

LOCATION 164 Middle Street

Issued to Clarence Blanchard

Date of Issue Nov. 19, 1979

This is to certify that the building, premises, or part thereof, at the above location, built—altered—changed as to use under Building Permit No. 79/986, has had final inspection, has been found to conform substantially to requirements of Zoning Ordinance and Building Code of the City, and is hereby approved for occupancy of use, limited or otherwise, as indicated below.

PORTION OF BUILDING OR PREMISES

APPROVED OCCUPANCY

Mezzanine

Restaurant

Limiting Conditions:

This certificate supersedes  
certificate issued

Approved.

11-19-79  
(Date)

*Inspector*  
*Inspector of Buildings*

Notice: This certificate identifies lawful use of building or premises, and should be transferred from owner to owner when property changes hands. Copy will be furnished to owner or lessee for one dollar.



APPLICATION FOR PERMIT

B.O.C.A. USE GROUP

B.O.C.A. TYPE OF CONSTRUCTION

ZONING LOCATION PORTLAND, MAINE, Nov. 2, 1979

PERMIT ISSUED

NOV 2 1979

CITY of PORTLAND

the DIRECTOR OF BUILDING & INSPECTION SERVICES, PORTLAND, MAINE

The undersigned hereby applies for a permit to erect, alter, repair, demolish, move or install the following building, structure, equipment or change use in accordance with the Law of the State of Maine, the Portland B.O.C.A. Building Code and Ordinance of the City of Portland with plans and specifications, if any, submitted herewith and the following specifications:

- 1. ZONING 164 Middle Street
2. Owner's name and address ... Fire District #1 [ ] #2 [ ] Telephone .. 854-4000
3. Contractor's name and address ... Telephone .. 688-0152
4. Architect ... Plans .04069. No of sheets ...
Proposed use of building .. restaurant ... No. families ...
Last use parking garage ... No. families ...
Material .. No. stories .. Heat .. Style of roof .. Roofing ...
Other buildings on same lot ...
Estimated contractual cost \$ 2,300 .. Fee \$ .. 14.50 ..

FIELD INSPECTOR—Mr. Marge GENERAL DESCRIPTION

- This application is for: @ 775-3451
Dwelling .. Ext 234
Garage ..
Masonry Bldg. ..
Metal Bldg. ..
Alterations ..
Demolitions ..
Change of Use ..
Other alteration ..

Alterations to mezzanine to include counters, non-bearing walls as per plans. 2 sheets of plans, Stamp of Special Conditions work to be in kitchen are only

NOTE TO APPLICANT: Separate permits are required by the installers and subcontractors of heating, plumbing, electrical and mechanicals.

PERMIT IS TO BE ISSUED TO 1 [ ] 2 [ ] 3 [x] 4 [ ]
Other: ..

DETAILS OF NEW WORK

- Is any plumbing involved in this work? .. Is any electrical work involved in this work? ..
Is connection to be made to public sewer? .. If not, what is proposed for sewage? ..
Has septic tank notice been sent? .. Form notice sent? ..
Height average grade to top of plate .. Height average grade to highest point of roof ..
Size, front .. depth .. No. stories .. solid or filled tank? .. earth or rock? ..
Material of foundation .. Thickness, top .. bottom .. cellar ..
Kind of roof .. Rise per foot .. Roof covering ..
No of chimneys .. Material of chimneys .. of lining .. Kind of heat .. fuel ..
Framing Lumber—Kind .. Dressed or full size? .. Corner posts .. Sills ..
Size Girder .. Columns under girders .. Size .. Max. centers ..
Steels (outside walls and carrying partitions) 2x4-16" O. C. Bridging in every floor and flat roof span over 8 feet.
Joists and rafters: 1st floor .., 2nd .., 3rd .., roof ..
On centers: 1st floor .., 2nd .., 3rd .., roof ..
Maximum span: 1st floor .., 2nd .., 3rd .., roof ..
If one story building with masonry walls, thickness of walls? .. height? ..

IF A GARAGE

No. cars now accommodated on same lot .., to be accommodated .. number commercial cars to be accommodated ..
Will automobile repairing be done other than minor repairs to cars habitually stored in the proposed building? ..

APPROVALS BY:

- BUILDING INSPECTION—PLAN EXAMINER .. DATE
ZONING: ..
BUILDING CODE: ..
Fire Dept: ..
Health Dept: ..
Others: ..

MISCELLANEOUS

Will work require disturbing of any tree on a public street? ..
Will there be in charge of the above work a person competent to see that the State and City requirements pertaining thereto are observed? ..

Signature of Applicant .. Phone # .. same
Type Name of above .. Clarence Blanchard .. 1 [ ] 2 [ ] 3 [x] 4 [ ]
Other .. and Address ..

FIELD INSPECTOR'S COPY

NOTES

11-6-79 Start work - to close in  
11-14-79 Work progressing in  
11-19-79 Completed subdrain &  
Issue C.O.

Permit No. 11-11-79

Location 16 1/2 Madleyville

Owner Paul Brown - Manager

Date of permit 11-2-79

Approved 11-2-79

scope 33

Large empty lined area for notes or drawings, containing a large handwritten 'X' on the left side.

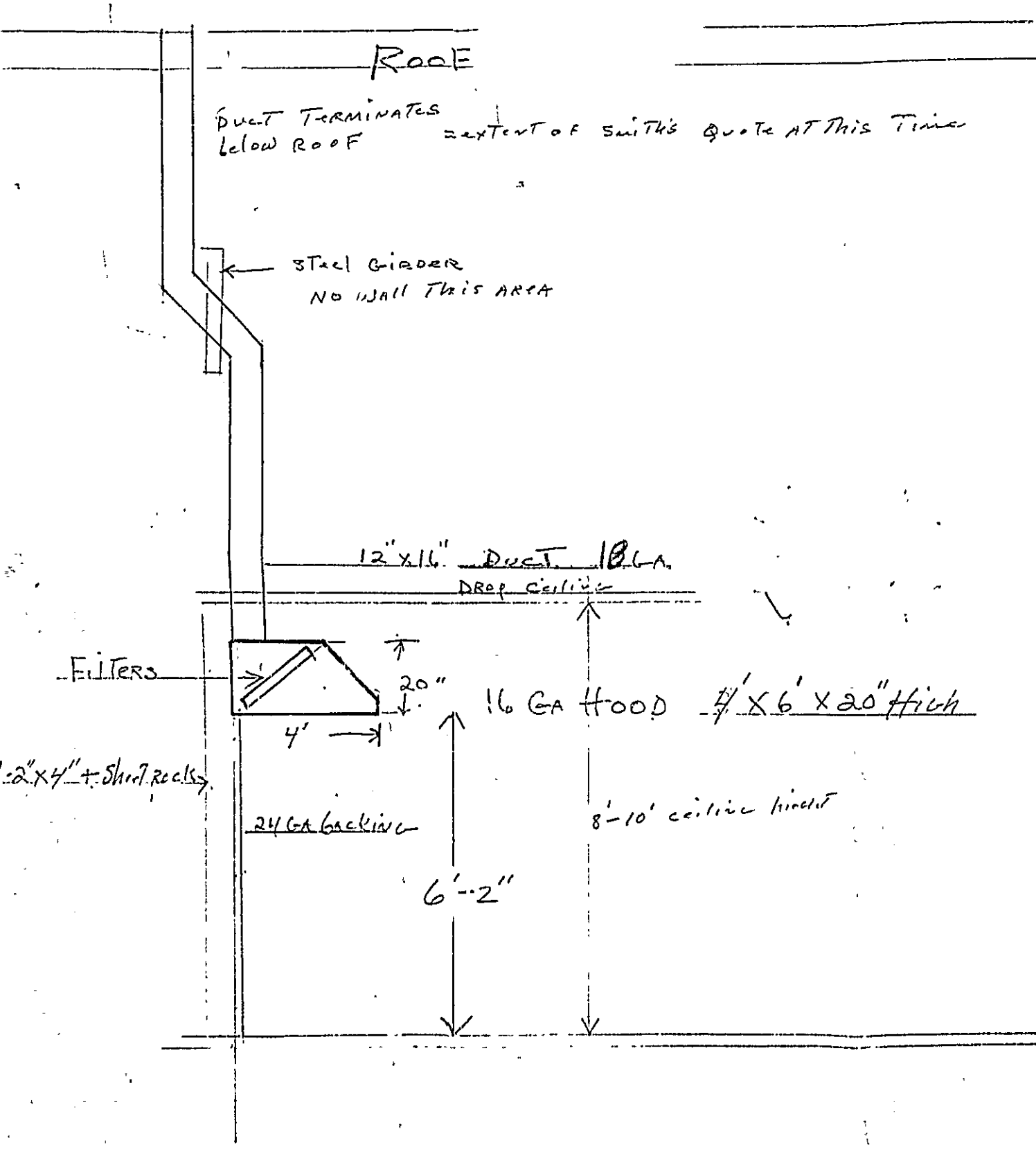

ROOF

Duct TERMINATES below ROOF extent of Smith's quote AT This Time

Steel Girder  
NO WALL THIS AREA

12" x 16" DUCT 16 GA.  
DROP ceiling

Filters

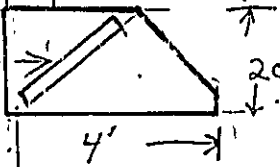

16 GA HOOD 4' x 6' x 20" High

2" x 4" + Sheet rocks

24 GA backing

8'-10" ceiling height

6'-2"

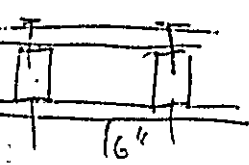

6"

RECEIVED  
OCT-5 1979  
DEPT. OF BLDG. INSP.  
CITY OF PORTLAND





APPLICATION FOR PERMIT

PERMIT ISSUED

B.O.C.A. USE GROUP ... B.O.C.A. TYPE OF CONSTRUCTION ... 000886 ... ZONING LOCATION ... PORTLAND, MAINE ... 10-5-79

OCT 9 1979 CITY OF PORTLAND

To the DIRECTOR OF BUILDING & INSPECTION SERVICES, PORTLAND, MAINE

The undersigned hereby applies for a permit to erect, alter, repair, demolish, move or install the following building, structure, equipment or change use in accordance with the Laws of the State of Maine, the Portland B.O.C.A. Building Code and Zoning Ordinance of the City of Portland with plans and specifications, if any, submitted herewith and the following specifications:

LOCATION 164 Middle Street Fire District #1 [ ] #2 [ ]
1. Owner's name and address Pritam Singh - same Telephone 227-4500
2. Lessee's name and address Michel P. Dozal-DBA Quera - same Telephone
3. Contractor's name and address Smith Metal Fabrication Co., Inc. Telephone 774-3059
4. Architect 50 Danforth St. 04101 Specifications No. of sheets 1
Proposed use of building Hood with duckwork for restaurant No. families
Last use nothing No. families
Material Heat Style of roof Roofing
Other buildings on same lot
Estimated contractual cost \$ Fee \$ 10.00

FIELD INSPECTOR-Mr. GENERAL DESCRIPTION

This application is for: @ 775-5451 Ext. 234 To install hood for stove and duckwork.
Garage
Masonry Bldg
Metal Bldg Stamp of Special Conditions
Alterations
Demolitions
Change of Use
Other

NOTE TO APPLICANT: Separate permits are required by the installers and subcontractors of heating, plumbing, electrical and mechanicals.

PERMIT IS TO BE ISSUED TO 1 [ ] 2 [x] 3 [ ] 4 [ ] Other:

DETAILS OF NEW WORK

Is any plumbing involved in this work? Is any electrical work involved in this work?
Is connection to be made to public sewer? If not, what is proposed for sewage?
Has septic tank notice been sent? Form notice sent?
Height average grade to top of plate Height average grade to highest point of roof
Size, front depth No. stories solid or filled land? earth or rock?
Material of foundation Thickness, top bottom cellar
Kind of roof Rise per foot Roof covering
No. of chimneys Material of chimney of lining Kind of heat fuel
Framing Lumber-Kind Dressed or full size? Corner posts Sills
Size Girder Columns under girders Size Max. on centers
Studs (outside walls and carrying partitions) 2x4-1 1/2" O. C. Bridging in every floor and flat roof span over 8 feet.
Joists and rafters: 1st floor 2nd 3rd roof
On centers: 1st floor 2nd 3rd roof
Maximum span: 1st floor 2nd 3rd roof
If one story building with masonry walls, thickness of walls? height?

IF A GARAGE

No. cars now accommodated on same lot to be accommodated number commercial cars to be accommodated
Will automobile repairing be done other than minor repairs to cars habitually stored in the proposed building?

APPROVALS BY: DATE

BUILDING INSPECTION-PLAN EXAMINER
ZONING:
BUILDING CODE:
Fire Dept.:
Health Dept.:
Owner:

MISCELLANEOUS

Will work require disturbing of any tree on a public street?
Will there be in charge of the above work a person competent to see that the State and City requirements pertaining thereto are observed?

Signature of Applicant Michel P. Dozal Phone #
Type Name of above Michel P. Dozal 1 [ ] 2 [x] 3 [ ] 4 [ ]
Other and Address

NOTES

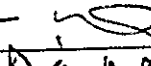
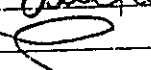
11-14-79 Hood is in -   
11-20-79 - OK per F.D & MR. Hillon  
They didn't require the ductwork  
to be enclosed - 

Permit No. 79/886

Location 14th Street

Owner G. Williams

Date of permit 10-5-79

Approved 10-9-79

Large section of lined paper with a large handwritten 'X' on the left side.



CITY OF PORTLAND, MAINE  
Department of Building Inspection

# Certificate of Occupancy

LOCATION 164 Middle Street

Issued to Douglas Guavreau

Date of Issue Nov. 19, 1979

This is to certify that the building, premises, or part thereof, at the above location, built—altered—changed as to use under Building Permit No 79/817, has had final inspection, has been found to conform substantially to requirements of Zoning Ordinance and Building Code of the City, and is hereby approved for occupancy or use, limited or otherwise, as indicated below.

PORTION OF BUILDING OR PREMISES

APPROVED OCCUPANCY

1st. Floor

Restaurant

Limiting Conditions:

This certificate supersedes  
certificate issued

Approved:

11-19-79  
(Date)

Inspector

Inspector of Buildings

Notice: This certificate identifies lawful use of building or premises, and ought to be transferred from owner to owner when property changes hands. Copy will be furnished to owner or lessee for one dollar.



APPLICATION FOR PERMIT

PERMIT ISSUED

B.O.C.A. USE GROUP
B.O.C.A. TYPE OF CONSTRUCTION 000817

SEP 19 1979

ZONING LOCATION PORTLAND, MAINE, Sept. 19, 1979

CITY of PORTLAND

the DIRECTOR OF BUILDING & INSPECTION SERVICES, PORTLAND, MAINE

The undersigned hereby applies for a permit to erect, alter, repair, demolish, move or install the following building, structure, equipment or change use in accordance with the Laws of the State of Maine, the Portland B.O.C.A. Building Code and Zoning Ordinance of the City of Portland with plans and specifications, if any, submitted herewith and the following specifications:

LOCATION 167 Middle Street
1. Owner's name and address Lessee Douglas Guavreau -151 Maine St. West 81092 Telephone 854-4000
2. Lessee's name and address Market Street Market Partners -80 Telephone
3. Contractor's name and address Exchange Sq. Telephone
4. Architect Specifications Plans No. of sheets
Proposed use of building restaurant No. families
Last use parking garage No. families
Material No. stories Heat Style of roof Roofing
Other buildings on same lot
Estimated contractual cost \$ 1,000 Fee \$ 5.50

FIELD INSPECTOR—Mr. Marge GENERAL DESCRIPTION

Cost of Use 5.00
10.50

This application is for: @ 775-5451
Dwelling Ext. 234
Garage
Masonry Bldg.
Metal Bldg.
Alterations
Demolitions
Change of Use with alterations
Other

Change of use from parking garage (section of Bldg) to be used as restaurant, with minor alterations as per plans Stamp of Special Conditions 3 sheets of plans.

NOTE TO APPLICANT: Separate permits are required by the installers and subcontractors of heating, plumbing, electrical and mechanical

PERMIT IS TO BE ISSUED TO 1 2 3 4

Other:

DETAILS OF NEW WORK

Is any plumbing involved in this work? Is any electrical work involved in this work?
Is connection to be made to public sewer? If not, what is proposed for sewage?
Has septic tank notice been sent? Form notice sent?
Height average grade to top of plate Height average grade to highest point of roof
Size, front depth No. stories solid or filled land? earth or rock?
Material of foundation Thickness, top bottom cellar
Kind of roof Rise per foot Roof covering
No. of chimneys Material of chimneys of lining Kind of heat fuel
Framing Lumber—Kind Dressed or full size? Corner posts Sills
Size Girder Columns under girders Size Max. on centers
Studs (outside walls and carrying partitions) 2x4-16" O. C. Bridging in every floor and flat roof span over 8 feet.
Joists and rafters: 1st floor, 2nd, 3rd, roof
On centers: 1st floor, 2nd, 3rd, roof
Maximum span: 1st floor, 2nd, 3rd, roof
If one story building with masonry walls, thickness of walls? height?

IF A GARAGE

No. cars now accommodated on same lot, to be accommodated number commercial cars to be accommodated
Will automobile repairing be done other than minor repairs to cars habitually stored in the proposed building?

APPROVALS BY:

DATE

MISCELLANEOUS

BUILDING INSPECTION—PLAN EXAMINER Will work require disturbing of any tree on a public street?
ZONING: Will there be in charge of the above work a person competent to see that the State and City requirements pertaining thereto are observed?
BUILDING CODE:
Fire Dept.:
Health Dept.:
Others:

Signature of Applicant Douglas Guavreau Phone # same

Type Name of above Douglas Guavreau 1 2 3 4

Other and Address

FIELD INSPECTOR'S COPY

NOTES

11-5-79 Getting Near completion - ~~smelly~~  
in Fire Dept to get copy of list - utility  
A fire retardant on wood

11-9-79 HAS plumby to The Sinks installed  
but still working on the bathrooms  
(doors laid out) I HAS emergency  
lights on - gave up to S. Dept  
because procedure but NO OK on  
opening yet

11-14-79 ~~Work~~ public bathrooms are  
in - mostly with signs  
lights are on - peak  
A wait in employee bath  
Setting up tables

11-19-79 Completed - ~~Alone~~  
working in restaurant -  
mech. unit in employee  
bath to be installed with  
The work - ~~check~~ - check  
with fire Dept on this  
see AT

Permit No. 99/817  
Location 14/1 Middle St  
Owner ~~St~~ Marshall St. Marshall  
Date of permit 9-19-79  
Approved 9-16-79  
Inspector  
Fire Station

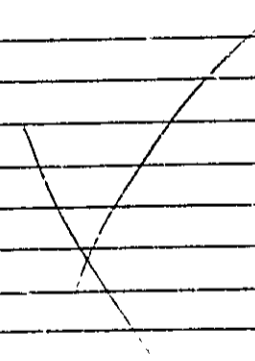



**APPLICATION FOR PERMIT**  
 DEPARTMENT OF BUILDING INSPECTIONS SERVICES  
 ELECTRICAL INSTALLATIONS

Date 8-2, 19 79  
 Receipt and Permit number A28906

To the CHIEF ELECTRICAL INSPECTOR, Portland, Maine:

The undersigned hereby applies for a permit to make electrical installations in accordance with the laws of Maine, the Portland Electrical Ordinance, the National Electrical Code and the following specifications:

LOCATION OF WORK: 164 Middle St.

OWNER'S NAME: Pritam Singh ADDRESS: 416 Fore St. (222-775-0931)

	FEES
<b>OUTLETS:</b>	
Receptacles _____ Switches _____ Plugmold _____ ft. TOTAL _____	
<b>FIXTURES:</b> (number of)	
Incandescent _____ Fluorescent _____ (not strip) TOTAL _____	
Strip Fluorescent _____ ft _____	
<b>SERVICES:</b>	
Overhead _____ Underground _____ Temporary _____ TOTAL amperes _____	
<b>TRANSFORMERS:</b> (number of) _____	
<b>COILS:</b> (number of)	
Fractional <u>90.50</u> _____	<u>4.50</u>
1 HP or over <u>1/2 - 2 @ 1.00</u> _____	<u>2.00</u>
<b>RESIDENTIAL HEATING:</b>	
Oil or Gas (number of units) _____	
Electric (number of rooms) _____	
<b>COMMERCIAL OR INDUSTRIAL HEATING:</b>	
Oil or Gas (by a main boiler) <u>Gas by Main Boiler</u> _____	<u>5.00</u>
Oil or Gas (by separate units) _____	
Electric Under 20 kws _____ Over 20 kws _____	
<b>APPLIANCES:</b> (number of)	
Ranges _____ Water Heaters _____	
Cook Tops _____ Disposals _____	
Wall Ovens _____ Dishwashers _____	
Dryers _____ Compactors _____	
Fans _____ Others (denote) _____	
TOTAL _____	
<b>MISCELLANEOUS:</b> (number of)	
Branch Panels _____	
Transformers _____	
Air Conditioners Central Unit _____	
Separate Units (windows) _____	
Signs 20 sq. ft. and under _____	
Over 20 sq. ft. _____	
Swimming Pools Above Ground _____	
In Ground _____	
Fire/Burglar Alarms Residential _____	
Commercial _____	
Heavy Duty Outlets, 220 Volt (such as welders) 30 amps and under _____	
over 30 amps _____	
Circus, Fairs, etc. _____	
Alterations to wires _____	
Repairs after fire _____	
Emergency Lights, battery _____	
Emergency Generators _____	
FOR ADDITIONAL WORK NOT ON ORIGINAL PERMIT _____	INSTALLATION FEE DUE: _____
FOR REMOVAL OF A "STOP ORDER" (304-16.b) _____	DOUBLE FEE DUE: _____
	TOTAL AMOUNT DUE: <u>11.50</u>

**INSPECTION:**

Will be ready on \_\_\_\_\_, 19\_\_ c- Will Call

CONTRACTOR'S NAME: Caron & Waltz

ADDRESS: 416 Preble St., S.P.

TEL.: 799-2228

MASTER LICENSE NO.: On Form SIGNATURE OF CONTRACTOR: \_\_\_\_\_

LIMITED LICENSE NO.: \_\_\_\_\_

INSPECTOR'S COPY — WHITE

OFFICE COPY — CANARY

CONTRACTOR'S COPY — GREEN



APPLICATION FOR PERMIT

PERMIT ISSUED

B.O.C.A. USE GROUP
B.O.C.A. TYPE OF CONSTRUCTION 000639
ZONING LOCATION PORTLAND, MAINE, 8-2-79

AUG 9 1979
CITY OF PORTLAND

To the DIRECTOR OF BUILDING & INSPECTION SERVICES, PORTLAND, MAINE

The undersigned hereby applies for a permit to erect, alter, repair, demolish, move or install the following building, structure, equipment or change use in accordance with the Laws of the State of Maine, the Portland B.O.C.A. Building Code and Zoning Ordinance of the City of Portland with plans and specifications, if any, submitted herewith and the following specifications:

LOCATION 164 Middle Street
1. Owner's name and address Pritam Singh, 416 Fore St. Fire District #1 [ ], #2 [ ] Telephone 775-0931
2. Lessee's name and address Telephone
3. Contractor's name and address Caron & Waltz, 416 Preble St., S.O. Telephone 799-2228
4. Architect Specifications Plans No. of sheets 2
Proposed use of building stores No. families
Last use garage No. families
Material No. stories Heat Style of roof Roofing
Other buildings on same lot
Estimated contractual cost \$ 3,000 Fee \$ 14.50

FIELD INSPECTOR—Mr. GENERAL DESCRIPTION

This application is for: @ 775-5451 To install piping for heating system.
Ext. 234
Dwelling
Garage
Masonry Bldg.
Metal Bldg.
Alterations
Demolitions
Change of Use
Other

Stamp of Special Conditions

NOTE TO APPLICANT: Separate permits are required by the installers and subcontractors of heating, plumbing, electrical and mechanicals.

PERMIT IS TO BE ISSUED TO 1 [ ] 2 [ ] 3 [x] 4 [ ]
Other:

DETAILS OF NEW WORK

Is any plumbing involved in this work? Is any electrical work involved in this work?
Is connection to be made to public sewer? If not, what is proposed for sewage?
Has septic tank notice been sent? Form notice sent?
Height average grade to top of plate Height average grade to highest point of roof
size, front depth No. stories solid or filled land? earth or rock?
Material of foundation Thickness, top bottom cellar
Kind of roof Rise per foot Roof covering
No. of chimneys Material of chimneys of lining Kind of heat fuel
Framing Lumber—Kind Dressed or full size? Corner posts Sills
Siz. Girder Columns under girders Size Max. on centers
Studs (outside walls and carrying partitions) 2x4-16" O. C. Bridging in every floor and flat roof span over 8 feet.
Joists and rafters: 1st floor 2nd 3rd roof
On centers: 1st floor 2nd 3rd roof
Maximum span: 1st floor 2nd 3rd roof
If one story building with masonry walls, thickness of walls? height?

IF A GARAGE

No. cars now accommodated on same lot . . . , to be accommodated . . . number commercial cars to be accommodated . . .
Will automobile repairing be done other than minor repairs to cars habitually stored in the proposed building? . . .

APPROVALS BY: DATE MISCELLANEOUS
BUILDING INSPECTION—PLAN EXAMINER Will work require disturbing of any tree on a public street?
ZONING:
BUILDING CODE: Will there be in charge of the above work a person competent
Fire Dept.: to see that the State and City requirements pertaining thereto
Health Dept.: are observed?
Others:

Signature of Applicant L. B. Jones Phone #
Type Name of above L. B. Jones 1 [ ] 2 [ ] 3 [x] 4 [ ]
Other and Address

FIELD INSPECTOR'S COPY

NOTES

11-14-79 Completed

20

Permit No. 7-1639  
 Location City Middleville  
 Owner William Strong  
 Date of permit 8-2-79  
 Approved 8-13-79

X





FILL IN AND BEGIN WITH IN

000641

PERMIT ISSUED

AUG 8 1979

APPLICATION FOR PERMIT FOR HEATING, COOKING OR POWER EQUIPMENT

CITY of PORTLAND

Portland, Maine, 8-2-79

To the INSPECTOR OF BUILDINGS, PORTLAND, ME

The undersigned hereby applies for a permit to install the following heating, cooking or power equipment in accordance with the Laws of Maine, the Building Code of the City of Portland, and the following specifications:

Location 164 Middle Street Use of Building Commercial No Stories 2 New Building Existing " X
Name and address of owner of appliance Pritam Singh - 415 Fore Street
Installer's name and address Caron & Waitz - 415 Pebie St., S. P. Telephone 799-2228

General Description of Work

To install Gas Conversion Burner

IF HEATER, OR POWER BOILER

Location of appliance Basement Any burnable material in floor surface or beneath? no
If so, how protected? Kind of fuel?
Minimum distance to burnable material, from top of appliance or casing top of furnace 3' all around
From top of smoke pipe From front of appliance From sides or back of appliance
Size of chimney flue 16"x16" Other connections to same flue NO
If gas fired, how vented? through flue Rated maximum demand per hour 1.4 Million BTU'S hr.
Will sufficient fresh air be supplied to the appliance to insure proper and safe combustion? yes

IF OIL BURNER

Name and type of burner Labelled by underwriters' laboratories?
Will operator be always in attendance? Does oil supply line feed from top or bottom of tank?
Type of floor beneath burner Size of vent pipe
Location of oil storage Number and capacity of tanks
Low water shut off Make No
With all tanks more than five feet from any flame? How many tanks enclosed?
List capacity of any existing storage tanks for furnace burners

IF COOKING APPLIANCE

Location of appliance Any burnable material in floor surface or beneath?
If so, how protected? Height of Legs, if any
Minimum distance to combustible material from top of appliance
From front of appliance From sides and back From top of smokepipe
Size of chimney flue Other connections to same flue
Is hood to be provided? If so, how vented? Forced or gravity?
If gas fired, how vented? Rated maximum demand per hour

MISCELLANEOUS EQUIPMENT OR SPECIAL INFORMATION

Amount of fee enclosed? 15.00

APPROVED.
[Signature area]

Will there be in charge of the above work a person competent to see that the State and City requirements pertaining thereto are observed? Yes

CS 300

Signature of Installer

INSPECTION COPY

Caron & Waitz Lic # 1526
[Signature]

NOTES

8-21-79 Started work on the boiler -  
 NO GAS burner on yet - NO vent ducts  
 yet.

1-20-79 Completed

Permit No. 99/641  
 Location 1617 Middle St.  
 Owner Gasman, Chicago  
 Date of permit 8-2-79  
 Approved 8-13-79 Gas Inspector

1. 1/2" FILL PIPE
2. 1/2" VENT PIPE
3. Kindling
4. Safety & Support
5. Heat exchanger
6. Burner control
7. High limit control
8. Interlock switch
9. Low water cutoff
10. High limit control
11. Safety & protection
12. Vent line
13. Co. vent line
14. Safety & Support
15. Oil
16. Instr. Card
17. Oil
18. Adequate ventilation
19. Surrounding is combustible
20. Thermal Control switch



APPLICATION FOR AMENDMENT TO PERMIT

Amendment No. 1 Permit # 79/64

Portland, Maine, July 12, 1979

PERMIT ISSUED

JUL 25 1979

CITY of PORTLAND

To the INSPECTOR OF BUILDINGS, PORTLAND, MAINE

The undersigned hereby applies for amendment to Permit No. 79/64 pertaining to the building or structure comprised in the original application in accordance with the Laws of the State of Maine, the Building Code and Zoning Ordinance of the City of Portland, plans and specifications, if any, submitted herewith, and the following specifications:

Location 164 Middle Street Within Fire Limits? Dist. No.
Owner's name and address Pritam Singh - P.O. Box 7338 DTS 04112 Telephone
Lessee's name and address Telephone
Contractor's name and address Renaissance Constr. - 38 Wharf St. Telephone 773-4271
Architect John Whipple - 386 Fore St. call if any questions on plans sheets
Proposed use of building Shopping Mall No. families
Last use Parking Garage No. families
Increased cost of work 160,000 Description of Proposed Work Additional 721.00

To make amendment to original permit to make additional work to shopping mall, as per plans, 3 sheets of plans.

Details of New Work

Is any plumbing involved in this work? Is any electrical work involved in this work?
Height average grade to top of plate Height average grade to highest point of roof
Size, front depth No. stories solid or filled land? earth or rock?
Material of foundation Thickness, top bottom cellar
Material of underpinning Height Thickness
Kind of roof Rise per foot Roof covering
No. of chimneys Material of chimneys of lining
Framing lumber—Kind Dressed or full size?
Corner posts Sills Girt or ledger board? Size
Girders Size Columns under girders Size Max. on centers
Studs (outside walls and carrying partitions) 2x4-16" O. C. Bridging in every floor and flat roof span over 8 feet.
Joists and rafters: 1st floor, 2nd, 3rd, roof
On centers: 1st floor, 2nd, 3rd, roof
Maximum span: 1st floor, 2nd, 3rd, roof

Approved:

Signature of Owner

Approved:

John Whipple
Inspector of Buildings

FILE COPY

CITY OF PORTLAND, MAINE

MEMORANDUM

TO: Mr. John Wipple

DATE: 2/5/79

FROM: Fire Prevention Bureau

SUBJECT: 164 Middle St.

(change from parking garage to shopping mall)

Approval is hereby given for a building permit  
from this Department subject to the following requirements/reasons:

- 1) An automatic alarm system shall be installed as approved through this office.
- 2) An automatic sprinkler system shall be installed through out the basement level. This system shall be installed as prescribed in NFPA #13.
- 3) Emergency lighting and self-illuminated exit signs shall be placed at all exits and paths to reach same.
- 4) The second means of egress from the mezzanine and the outdoor eating deck shall be an enclosed "Class B" stairway leading directly to the ground level and discharging to the outside.
- 5) The interior finish shall be class "A or B".

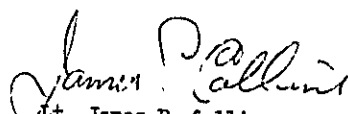
  
Lt. James P. Collins  
Fire Prevention Bureau



APPLICATION FOR PERMIT

PERMIT ISSUED

B.O.C.A. USE GROUP .....

B.O.C.A. TYPE OF CONSTRUCTION ..... 000064

FEB 6 1979

ZONING LOCATION F-2B PORTLAND, MAINE, .....

CITY of PORTLAND

To the DIRECTOR OF BUILDING & INSPECTION SERVICES, PORTLAND, MAINE

The undersigned hereby applies for a permit to erect, alter, repair, demolish, move or install the following building, structure, equipment or change use in accordance with the Laws of the State of Maine, the Portland B.O.C.A. Building Code and Zoning Ordinance of the City of Portland with plans and specifications, if any, submitted herewith and the following specifications:

LOCATION 164 Middle St. Pritam Singh P.O. Box 733 Fire District #1 [ ] #2 [ ]
1. Owner's name and address Pritam Singh Telephone
2. Lessee's name and address Same 416 Forsyth St Telephone 775-0931
3. Contractor's name and address To be determined Telephone
4. Architect John Whipple Specifications Plans No. of sheets
Proposed use of building Shopping Mall No. families
Past use Parking garage No. families
Material No. stories 2 Heat oil H.W. Style of roof Flat Roofing
Other buildings on same lot
Estimated contractual cost \$500,000.000 Fee \$ 240.00

FIELD INSPECTOR—Mr. GENERAL DESCRIPTION fee not paid
This application is for: @ 775-5451 To renovate the interior, erect interior partitions, as per plans submitted.
Dwelling Ext. 234
Garage
Masonry Bldg
Metal Bldg.
Alterations
Demolitions
Change of Use X Change from a parking garage to a shopping mall;
Other

NOTE TO APPLICANT: Separate permits are required by the installers and subcontractors of heating, plumbing, electrical and mechanicals.

PERMIT IS TO BE ISSUED TO 1 [x] 2 [ ] 3 [ ] 4 [ ]
Other: .....

DETAILS OF NEW WORK

Is any plumbing involved in this work? Is any electrical work involved in this work?
Is connection to be made to public sewer? If not, what is proposed for sewage?
Has septic tank notice been sent? Form notice sent?
Height average grade to top of plate Height average grade to highest point of roof
Size, front depth No. stories soil or filled land? earth or rock?
Material of foundation Thickness, top bottom cellar
Kind of roof Rise per foot Roof covering
No. of chimneys Material of chimneys of lining Kind of heat fuel
Framing Lumber—Kind Dressed or full size? Corner posts Sills
Size Girder Columns under girders Size Max. on centers
Studs (outside walls and carrying partitions) 2x4-16" O. C. Bridging in every floor and flat roof span over 8 feet.
Joists and rafters: 1st floor 2nd 3rd roof
On centers: 1st floor 2nd 3rd roof
Maximum span: 1st floor 2nd 3rd roof
If one story building with masonry walls, thickness of walls? height?

IF A GARAGE

No. cars now accommodated on same lot , to be accommodated ... number commercial cars to be accommodated ...
Will automobile repairing be done other than minor repairs to cars habitually stored in the proposed build'ag? .....

APPROVALS BY: DATE MISCELLANEOUS
BUILDING INSPECTION—PLAN EXAMINER Will work require disturbing of any tree on a public street? ..
ZONING: D.P. M.C. 2/1/79
BUILDING CODE: J.H. ...
Fire Dept.: J. James ...
Health Dept.:
Others: .....

Signature of Applicant John Whipple Phone # 775-2696
Type Name of above John Whipple 1 [ ] 2 [ ] 3 [ ] 4 [ ]

FIELD INSPECTOR'S COPY

Other and Address .....

227-79  
772 NOTES

227-79 Couldn't get in - doesn't open  
that work started

4-11-79 No one around - just painted  
interior on 1st floor & started  
cutting 2 holes in concrete to basement

CAPS still being parked on 1st floor  
6-28-79 poured REAR parking area  
& working on RAMP to lower level  
on Market St side - some

planning started in front section of  
bldg off Middle St - up

8-21-79 some more work on front  
stairway - met new

think of the work from  
Mooney Engineering - will  
come in with revised

plans - 10-4-79 Getting REAR  
close-in down stairs - work  
area by bathroom -

explained how slipping to  
them

2-16-79 some work on back  
using 5/8" mesh - back

metal - some  
circumstances

10-25-79 Started close  
in - called to contractor  
fire resistant sealant on  
exposed wood - started

construction of rear deck  
area - has vent line  
from boiler room - sill

11-14-79 Went thru bldg  
with R. Williams - work  
progress rapidly -

boiler room finish - work in  
in Patchell room - work on  
lights - Needs fire resist

on beams - discussed  
extension soon

11-15-79 Again went thru bldg  
more completed - exit lights

up

11-16-79 Still working - getting  
more permits taken out for  
the individual booths

Approved 8-6-79 WALL Act  
Date of permit  
Owner  
Location 147 Middle St  
Permit No. 99/64

11-19-79 Dave R. Williams  
away for fire protection

materials inside - still  
down about 1/2 finish

work - 1st floor of  
C.O.P. Robert of bldg

1012 done off before  
completion

11-20-79 GAOZ fire test from  
904.3.3 to the STRAW over

Vietnam food place - PASSED  
test except for the 30 second

glow (went to 5 sec) - will  
continue with 2 more layers  
of solution -

11-21-79 Still working - told  
owner to be sure tables  
were cleaned from the

REAR exit on top floor

11-26-79 Did new work on  
the booths by  
to get more use of

11-27-79 Tried to find  
R. Williams to

to get the Emergency  
lights - get other info

12-14-79 Still trying to knock  
down R. Williams - green use  
is getting ready to open - told them

about required use permits - need  
work in bldg with in German test

See separate permits  
by individual C.O.S

X



APPLICATION FOR AMENDMENT TO PERMIT

Amendment No. 1 Permit # 79/64

Portland, Maine, July 12, 1979

PERMIT ISSUED

JUL 25 1979

CITY of PORTLAND

To the INSPECTOR OF BUILDINGS, PORTLAND, MAINE

The undersigned hereby applies for amendment to Permit No. 79/64 pertaining to the building or structure comprised in the original application in accordance with the Laws of the State of Maine, the Building Code and Zoning Ordinance of the City of Portland, plans and specifications, if any, submitted herewith, and the following specifications:

Location 164 Middle Street Within Fire Limits? Dist. No.
Owner's name and address Pritam Singh - P. O. Box 7338 DTS 04112 Telephone
Lessee's name and address Telephone
Contractor's name and address Renaissance Constr. - 38 Wharf St. Telephone 773-1271
Architect John Whipple - 186 Fore St. - call if any questions on plans No. of sheets
Proposed use of building Shopping Mall No. families
Last use Parking Garage No. families
Increased cost of work 160,000 Additional fee 721.00

Description of Proposed Work

To make amendment to original permit to make additional work to shopping mall, as per plans, 8 sheets of plans.

Details of New Work

Is any plumbing involved in this work? Is any electrical work involved in this work?
Height average grade to top of plate Height average grade to highest point of roof
Size, front depth No. stories solid or filled land? earth or rock?
Material of foundation Thickness, top bottom cellar
Material of underpinning Height Thickness
Kind of roof Rise per foot Roof covering
No. of chimneys Material of chimneys ot lining
Framing lumber—Kind Dressed or full size?
Corner posts Sills Girt or ledger board? Size
Girders Size Columns under girders Size Max. on centers
Studs (outside walls and carrying partitions) 2x4-10" O. C. Bridging in every floor and flat roof span over 8 feet.
Joists and rafters: 1st floor, 2nd, 3rd, roof
On centers: 1st floor, 2nd, 3rd, roof
Maximum span: 1st floor, 2nd, 3rd, roof

Approved:

Signature of Owner John Whipple
Inspector of Buildings

INSPECTION COPY



**APPLICATION FOR PERMIT**  
**DEPARTMENT OF BUILDING INSPECTIONS SERVICES**  
**ELECTRICAL INSTALLATIONS**

Date 6-20, 19 79  
 Receipt and Permit number A23960

To the CHIEF ELECTRICAL INSPECTOR, Portland, Maine:

The undersigned hereby applies for a permit to make electrical installations in accordance with the laws of Maine, the Portland Electrical Ordinance, the National Electrical Code and the following specifications:

LOCATION OF WORK: 164 Middle St.  
 OWNER'S NAME: Priten Singh ADDRESS: P.O. Box 7338 DTS 04112  
(775-0931) FEES

OUTLETS:  
 Receptacles \_\_\_\_\_ Switches \_\_\_\_\_ Plugmold 200 ft. TOTAL 220 ..... 21.00

FIXTURES: (number of)  
 Incandescent 34 Fluorescent 0 (not strip) TOTAL ..... 6.20  
 Strip Fluorescent \_\_\_\_\_ ft. ....

SERVICES:  
 Overhead X Underground \_\_\_\_\_ Temporary \_\_\_\_\_ TOTAL ampercs 800 .. 6.00

METERS: (number of) 16 ..... 8.00

MOTORS: (number of)  
 Fractional \_\_\_\_\_  
 1 HP or over \_\_\_\_\_

RESIDENTIAL HEATING:  
 Oil or Gas (number of units) \_\_\_\_\_  
 Electric (number of rooms) \_\_\_\_\_

COMMERCIAL OR INDUSTRIAL HEATING:  
 Oil or Gas (by a main boiler) \_\_\_\_\_  
 Oil or Gas (by separate units) \_\_\_\_\_  
 Electric Under 20 kws \_\_\_\_\_ Over 20 kws \_\_\_\_\_

APPLIANCES: (number of)  
 Ranges \_\_\_\_\_ Water Heaters \_\_\_\_\_  
 Cook Tops \_\_\_\_\_ Disposals \_\_\_\_\_  
 Wall Ovens \_\_\_\_\_ Dishwashers \_\_\_\_\_  
 Dryers \_\_\_\_\_ Compactors \_\_\_\_\_  
 Fans 7 Others (denote) \_\_\_\_\_

TOTAL ..... 10.50

MISCELLANEOUS: (number of)  
 Branch Panels \_\_\_\_\_  
 Transformers \_\_\_\_\_  
 Air Conditioners Central Unit \_\_\_\_\_  
 Separate Units (windows) \_\_\_\_\_  
 Signs 20 sq. ft. and under \_\_\_\_\_  
 Over 20 sq. ft. \_\_\_\_\_  
 Swimming Pools Above Ground \_\_\_\_\_  
 In Ground \_\_\_\_\_  
 Fire/Burglar Alarms Residential \_\_\_\_\_  
 Commercial \_\_\_\_\_  
 Heavy Duty Outlets, 220 Volt (such as welders) 30 amps and under \_\_\_\_\_  
 over 30 amps \_\_\_\_\_  
 Circus, Fairs, etc. \_\_\_\_\_  
 Alterations to wires \_\_\_\_\_  
 Repairs after fire \_\_\_\_\_  
 Emergency Lights, battery \_\_\_\_\_  
 Emergency Generators \_\_\_\_\_

INSTALLATION FEE DUE: \_\_\_\_\_  
 FOR ADDITIONAL WORK NOT ON ORIGINAL PERMIT ..... DOUBLE FEE DUE: \_\_\_\_\_  
 FOR REMOVAL OF A "STOP ORDER" (304-16.b) .....  
 TOTAL AMOUNT DUE: 51.70

INSPECTION:  
 Will be ready on \_\_\_\_\_, 19\_\_\_\_; or Will Call X  
 CONTRACTOR'S NAME: Falmouth Elec.  
 ADDRESS: 245 Black Strap Rd., Falmouth & Me.  
 TEL.: 797-6174  
 MASTER LICENSE NO. 420 W. Milliken SIGNATURE OF CONTRACTOR: \_\_\_\_\_  
 LIMITED LICENSE NO. \_\_\_\_\_

INSPECTOR'S COPY -- WHITE  
 OFFICE COPY -- CANARY  
 CONTRACTOR'S COPY -- GREEN





CITY OF PORTLAND, MAINE  
DEPARTMENT OF BUILDING INSPECTION

COMPLAINT

Location  
164 Middle St.

INSPECTION COPY

COMPLAINT NO. 79/65

Date Received 6-19-79

Location 164 Middle St. & Myrtle St. Use of Building Garage  
Owner's name and address Pritem Singh-P.O. Box 7338 DTS 04112 Telephone 775-0931  
(Middle Street Garage- old use) Telephone 772-0383

Tenant's name and address New Use - Shopping Mall Telephone \_\_\_\_\_

Complainant's name and address Tom Parry Telephone Would not give it

Description: Concrete wall & ramp being constructed by L & L Concrete. No permit for this.

NOTES: No one checked the files - There is A  
permit on this -

Blank lined area for additional notes.

**CITY OF PORTLAND, MAINE**  
**Application for Permit to Install Wires**

Permit No. *57609*  
 Issued *3/10/69*  
 Portland, Maine *3-10-*, 19*69*

To the City Electrician, Portland, Maine:

The undersigned hereby applies for a permit to install wires for the purpose of conducting electric current, in accordance with the Laws of Maine, the Electrical Ordinance of the City of Portland, and the following specifications:

*(This form must be completely filled out - Minimum Fee, \$1.00)*

Owner's Name and Address *The Bruce (1000)* Tel.  
 Contractor's Name and Address *Eastern Out. Equip. Co.* Tel. *773-6495*  
 Location *164 Middle St* Use of Building *Garage Storage*  
 Number of Families Apartments Stores Number of Stories *2*  
 Description of Wiring: New Work Additions Alterations

Pipe Cable Metal Molding BX Cable Plug Molding (No. of feet)  
 No. Light Outlets Plugs Light Circuits Plug Circuits  
 FIXTURES: No. Fluor. or Strip Lighting (No. feet)  
 SERVICE: Pipe Cable Underground No. of Wires Size  
 METERS: Relocated Added Total No. Meters  
 MOTORS: Number Phase H. P. Amps Volts Starter  
 HEATING UNITS: Domestic (Oil) No. Motors Phase H.P.  
 Commercial (Oil) *12* No. Motors *3* Phase *1* H.P. *1/6*  
 Electric Heat (No. of Rooms)  
 APPLIANCES: No. Ranges Watts Brand Feeds (Size and No.)  
 Elec. Heaters Watts  
 Miscellaneous Watts Extra Cabinets or Panels  
 Transformers Air Conditioners (No. Units) Signs (No. Units)  
 Will commence *19* Ready to cover in *19* Inspection *19*  
 Amount of Fee \$ *7.00*

Signed *Eastern Out. Equip. Co.*  
*B.F. Talbot*

DO NOT WRITE BELOW THIS LINE

SERVICE		METER		GROUND	
VISITS: 1	2	3	4	5	6
7	8	9	10	11	12

REMARKS:

INSPECTED BY *F.W. Hattum*  
 (OVER)

LOCATION *Middle St 164*  
 INSPECTION DATE *3/19/69*  
 WORK COMPLETED *3/19/69*  
 TOTAL NO. INSPECTIONS *1*  
 REMARKS:

**FEEES FOR WIRING PERMITS EFFECTIVE JULY 31, 1963**

**WIRING**

1 to 30 Outlets . . . . . \$ 2.00  
 31 to 60 Outlets . . . . . 2.00  
 Over 60 Outlets, each Outlet . . . . . .05  
 (Each twelve feet or fraction thereof of fluorescent lighting or  
 any type of plug molding will be classed as one outlet).

**SERVICES**

Single Phase . . . . . 2.00  
 Three Phase . . . . . 4.00

**MOTORS**

Not exceeding 50 H.P. . . . . 3.00  
 Over 50 H.P. . . . . 4.00

**HEATING UNITS**

Domestic (Oil) . . . . . 2.00  
 Commercial (Oil) . . . . . 4.00  
 Electric Heat (Each Room) . . . . . .75

**APPLIANCES**

Ranges, Cooking Tops, Ovens, Water Heaters, Disposals, Built-in  
 Dishwashers, Dryers, and any permanent built-in appliance — each  
 unit . . . . . 1.50

**MISCELLANEOUS**

Temporary Service, Single Phase . . . . . 1.00  
 Temporary Service, Three Phase . . . . . 2.00  
 Circuses, Carnivals, Fairs, etc . . . . . 10.00  
 Meters, relocate . . . . . 1.00



FILL IN AND SIGN WITH INK

APPLICATION FOR PERMIT FOR HEATING, COOKING OR POWER EQUIPMENT

Portland, Maine, March 10, 1969

PERM. ... 150 MAR 10 1969 CITY OF PORTLAND

To the INSPECTOR OF BUILDINGS, PORTLAND, ME.

The undersigned hereby applies for a permit to install the following heating, cooking or power equipment in accordance with the Laws of Maine, the Building Code of the City of Portland, and the following specifications:

Location 16 1/2 Middle St. Use of Building Storage Garage No Stories 2 New Building Existing " Name and address of owner of appliance The Spruce Company, 57 Exchange St. Installer's name and address Easternoil & Equipment Company 27 Portland St Telephone

General Description of Work

To install Oil-fired steam heating system in place coal-fired steam heat.

IF HEATER, OR POWER BOILER

Location of appliance Basement Any burnable material in floor surface or beneath? none If so, how protected? Kind of fuel? oil Minimum distance to burnable material, from top of appliance or casing top of furnace 3' From top of smoke pipe 2 1/2' From front of appliance over 4' From sides or back of appliance over 3' Size of chimney flue 14x18 Other connections to same flue none If gas fired, how vented? Rated maximum demand per hour Will sufficient fresh air be supplied to the appliance to insure proper and safe combustion? yes

IF OIL BURNER

Name and type of burner National U.S. -guntype Labelled by underwriters' laboratories? yes Will operator be always in attendance? Does oil supply line feed from top or bottom of tank? bottom Type of floor beneath burner concrete Size of vent pipe 1 1/2" Location of oil storage basement Number and capacity of tanks 2-275 gals. Low water shut off yes Make McD-Miller No. 47-2 Will all tanks be more than five feet from any flame? yes How many tanks enclosed? Total capacity of any existing storage tanks for furnace burners

IF COOKING APPLIANCE

Location of appliance Any burnable material in floor surface or beneath? If so, how protected? Height of Legs, if any Skirting at bottom of appliance? Distance to combustible material from top of appliance? From front of appliance From sides and back From top of smokepipe Size of chimney flue Other connections to same flue Is hood to be provided? If so, how vented Forced or gravity? If gas fired, how vented? Rated maximum demand per hour

MISCELLANEOUS EQUIPMENT OR SPECIAL INFORMATION

Amount of fee enclosed? 2.00 (\$2.00 for one heater, etc., \$1.00 additional for each additional heater, etc., in same building at same time.)

APPROVED: D.K. 3 10 69 - JH

Will there be in charge of the above work a person competent to see that the State and City requirements pertaining thereto are observed? yes

Easternoil & Equipment Company

Signature of Installer by: Bernard F. Fillet

CS 300

INSPECTION COPY

Handwritten initials





**CITY OF PORTLAND, MAINE**  
**Application for Permit to Install Wires**

Permit No. 55669  
 Issued 3/29/67

Portland, Maine

To the City Electrician, Portland, Maine:

The undersigned hereby applies for a permit to install wires for the purpose of conducting electric current, in accordance with the laws of Maine, the Electrical Ordinance of the City of Portland, and the following specifications:

*Form must be completely filled out - Minimum Fee, \$1.00*

Owner's Name and Address Latini - Bernstein Tel. 277-5052  
 Co. Name and Address K  
 Location 11 Middle Use of Building GARAGE Storage  
 Number of Families \_\_\_\_\_ Apartments \_\_\_\_\_ Stories \_\_\_\_\_ Number of Stories \_\_\_\_\_  
 Description of Wiring: New Work \_\_\_\_\_ Additions \_\_\_\_\_ Alterations \_\_\_\_\_

Pipe \_\_\_\_\_ Cable \_\_\_\_\_ Metal Molding \_\_\_\_\_ BX Cable \_\_\_\_\_ Plug Molding (No. of feet) \_\_\_\_\_

No. Light Outlets \_\_\_\_\_ Plugs \_\_\_\_\_ Light Circuits \_\_\_\_\_ Plug Circuits \_\_\_\_\_

FIXTURES: No. \_\_\_\_\_ Light Switches \_\_\_\_\_ Fluor. or Strip Lighting (No. feet) \_\_\_\_\_

SERVICE: Pipe \_\_\_\_\_ Cable \_\_\_\_\_ Underground \_\_\_\_\_ No. of Wires 3 Size 2-2-1/4

METERS: Relocated \_\_\_\_\_ Added \_\_\_\_\_ Total No. Meters \_\_\_\_\_

MGTOPS: Number \_\_\_\_\_ Phase \_\_\_\_\_ H. P. \_\_\_\_\_ Amps \_\_\_\_\_ Volts \_\_\_\_\_ Starter \_\_\_\_\_

HEATING UNITS: Domestic (Oil) \_\_\_\_\_ No. Motors \_\_\_\_\_ Phase \_\_\_\_\_ H.P. \_\_\_\_\_

Commercial (Oil) \_\_\_\_\_ No. Motors \_\_\_\_\_ Phase \_\_\_\_\_ H.P. \_\_\_\_\_

Electric Heat (No. of Rooms) \_\_\_\_\_

APPLIANCES: No. Ranges \_\_\_\_\_ Watts \_\_\_\_\_ Brand Feeds (Size and No.) \_\_\_\_\_

Elec. Heaters \_\_\_\_\_ Watts \_\_\_\_\_

Miscellaneous \_\_\_\_\_ Watts \_\_\_\_\_

Extra Cabinets or Panels \_\_\_\_\_

Transformers \_\_\_\_\_ Air Conditioners (No. Units) \_\_\_\_\_ Signs (No. Units) \_\_\_\_\_

Will commence \_\_\_\_\_ 19 \_\_\_\_\_ Ready to cover in \_\_\_\_\_ 19 \_\_\_\_\_ Inspection \_\_\_\_\_ 19 \_\_\_\_\_

Amount of Fee \$ 2.00

Signed Peter Latini

DO NOT WRITE BELOW THIS LINE

SERVICE	<input checked="" type="checkbox"/>	METER		GROUND	<input checked="" type="checkbox"/>
VISITS: 1	2	3	4	5	6
7	8	9	10	11	12

REMARKS:

INSPECTED BY

FW [Signature]  
 (OVER)

LOCATION *Middle St. 164*  
 INSPECTION DATE *3/30/67*  
 WORK COMPLETED *3/30/67*  
 TOTAL NO. INSPECTIONS *1*

REMARKS:

**FEES FOR WIRING PERMITS EFFECTIVE JULY 31, 1963**

**WIRING**

1 to 30 Outlets . . . . . \$ 2.00 (including switches)  
 31 to 60 Outlets . . . . . 3.00 (including switches)  
 Over 60 Outlets, each Outlet . . . . . .05 (including switches)  
 (Each twelve feet or fraction thereof of fluorescent lighting or any type of plug molding will be classed as one outlet.)

**SERVICES**

Single Phase . . . . . 2.00  
 Three Phase . . . . . 4.00

**MOTORS**

Not exceeding 50 H.P. . . . . .00  
 Over 50 H.P. . . . . .4.00

**HEATING UNITS**

Domestic (Oil) . . . . . 2.90  
 Commercial (Oil) . . . . . 4.00  
 Electric Heat (Each Room) . . . . . .75

**APPLIANCES**

Ranges, Cooking Tops, Ovens, Water Heaters, Disposals, Dish Washers, etc. — Each Unit . . . . . 1.50



Work - Done -  
 by - Latini 3/30/67

CITY OF PORTLAND, MAINE

Application for Permit to Install Wires

Permit No. 55599  
 issued February 29, 1967  
 Portland, Maine 2/20/67

Void

To the City Electrician, Portland, Maine:

The undersigned hereby applies for a permit to install wires for the purpose of conducting electric current, in accordance with the laws of Maine, the Electrical Ordinance of the City of Portland, and the following specifications:

(This form must be completely filled out - Minimum Fee, \$1.00)

Owner's Name and Address *Always Obligated* Tel.  
 Contractor's Name and Address *Latini* Tel.  
 Location *114 1/2 ...* Use of Building  
 Number of Families Apartments Stores Number of Stories  
 Description of Wiring: New Work Additions Alterations  
*Refer to sheet same*  
 Pipe Cable Metal Molding BX Cable Plug Molding (No. of feet)  
 No. Light Outlets Plugs Light Circuits Plug Circuits  
 FIXTURES: No. Light Switches Fluor. or Strip Lighting (No. 1cc')  
 SERVICE: Pipe Cable Underground No. of Wires Size  
 METERS: Relocated Added Total No. Meters  
 MOTORS: Number Phase H. P. Amps Volts Starter  
 HEATING UNITS: Domestic (Oil) No. Motors Phase H.P.  
 Commercial (Oil) No. Motors Phase H.P.  
 Electric Heat (No. of Rooms)  
 APPLIANCES: No. Ranges Watts Brand Feeds (Size and No.)  
 Elec. Heaters Watts  
 Miscellaneous Watts Extra Cabinets or Panels  
 Transformers Air Conditioners (No. Units) Signs (No. Units)  
 Will commence 19 Ready to cover in 19 Inspection 19  
 Amount of Fee \$  
 Signed *[Signature]*

DO NOT WRITE BELOW THIS LINE

SERVICE	METER			GROUND		
VISITS: 1	2	3	4	5	6	
7	8	9	10	11	12	

REMARKS:

INSPECTED BY

(OVER)

LOCATION *Middle St. 164*  
 INSPECTION DATE *3/30/67*  
 WORK COMPLETED *3/30/67*  
 TOTAL NO. INSPECTIONS *1*  
 REMARKS:

FEE S FOR WIRING PERMITS EFFECTIVE JULY 31, 1963

<b>WIRING</b>	
1 to 20 Outlets	(including switches) \$ 2.00
31 to 60 Outlets	(including switches) 3.00
Over 60 Outlets, each Outlet	(including switches) .05
(Each twelve feet or fraction thereof of fluorescent lighting or any type of plug molding will be classed as one outlet)	
<b>SERVICES</b>	
Single Phase	2.00
Three Phase	4.00
<b>MOTORS</b>	
Not exceeding 50 H.P.	3.00
Over 50 H.P.	4.00
<b>PLUGGING UNITS</b>	
Domestic (OH)	2.00
Commercial (OH)	4.00
Electric Heat (Each Room)	.75
<b>APPLIANCES</b>	
Ranges, Cooking Tops, Ovens, Water Heaters, Disposals, Dishwashers, etc. — Each Unit	1.50
<b>TEMPORARY WORK (Limited to 6 months from date of permit)</b>	
Service, Single Phase	1.00
Service, Three Phase	2.00
	1.00



CITY OF PORTLAND ZONING

# APPLICATION FOR PERMIT

Class of Building or Type of Structure Second Class  
Portland, Maine, March 1, 1961

To the INSPECTOR OF BUILDINGS, PORTLAND, MAINE

The undersigned hereby applies for a permit to erect alter repair demolish install the following building structure equipment in accordance with the Laws of the State of Maine, the Building Code and Zoning Ordinance of the City of Portland, plans and specifications, if any, submitted herewith and the following specifications:

Location 161 Middle St. Within Fire Limits? \_\_\_\_\_ Dist. No. \_\_\_\_\_  
Owner's name and address Louie Bernstein (Realty Management, 510 Forest St., Portland, Me.) Telephone \_\_\_\_\_  
Lessee's name and address Dodge & Dirigo, 161 Middle St. Telephone \_\_\_\_\_  
Contractor's name and address Alton Hurd, 224 Spring St., Westbrook Telephone W-5281  
Architect \_\_\_\_\_ Specifications \_\_\_\_\_ Plans NO No. of sheets \_\_\_\_\_  
Proposed use of building Repair garage No. families \_\_\_\_\_  
Last use \_\_\_\_\_ No. families \_\_\_\_\_  
Material Masonry No. stories 2 Heat \_\_\_\_\_ Style of roof \_\_\_\_\_ Roofing \_\_\_\_\_  
Other buildings on same lot \_\_\_\_\_  
Estimated cost \$ 400.00 Fee \$ 1.00

### General Description of New Work

2.00

-spray-in basement  
To partition off paint room 25'x18' with cement board 3/8" thick - studs 2x4, 16" O.C.  
New ceiling to be cement board  
backstair

1/4/61 This work will have and will standard partition removed and paint spraying also removed.

It is understood that this permit does not include installation of heating apparatus which is to be taken out separately by and in the name of the heating contractor. PERMIT TO BE ISSUED TO Alton Hurd

### Details of New Work

Is any plumbing involved in this work? \_\_\_\_\_ Is any electrical work involved in this work? \_\_\_\_\_  
Is connection to be made to public sewer? \_\_\_\_\_ If not, what is proposed for sewage? \_\_\_\_\_  
Has septic tank notice been sent? \_\_\_\_\_ Form notice sent? \_\_\_\_\_  
Height average grade to top of plate \_\_\_\_\_ Height average grade to highest point of roof \_\_\_\_\_  
Size, front \_\_\_\_\_ depth \_\_\_\_\_ No. stories \_\_\_\_\_ solid or filled land? \_\_\_\_\_ earth or rock? \_\_\_\_\_  
Material of foundation \_\_\_\_\_ Thickness, top \_\_\_\_\_ bottom \_\_\_\_\_ cellar \_\_\_\_\_  
Material of underpinning \_\_\_\_\_ Height \_\_\_\_\_ Thickness \_\_\_\_\_  
Kind of roof \_\_\_\_\_ Rise per foot \_\_\_\_\_ Roof covering \_\_\_\_\_  
No. of chimneys \_\_\_\_\_ Material of chimneys \_\_\_\_\_ of lining \_\_\_\_\_ Kind of heat \_\_\_\_\_ fuel \_\_\_\_\_  
Framing Lumber—Kind \_\_\_\_\_ Dressed or full size? \_\_\_\_\_ Corner posts \_\_\_\_\_ Sills \_\_\_\_\_  
Size Girder \_\_\_\_\_ Columns under girders \_\_\_\_\_ Size \_\_\_\_\_ Max. on centers \_\_\_\_\_  
Kind and thickness of outside sheathing of exterior walls? \_\_\_\_\_  
Studs (outside walls and carrying partitions) 2x4-16" O. C. Bridging in every floor and flat roof span over 8 feet.  
Joists and rafters: 1st floor \_\_\_\_\_, 2nd \_\_\_\_\_, 3rd \_\_\_\_\_, roof \_\_\_\_\_  
On centers: 1st floor \_\_\_\_\_, 2nd \_\_\_\_\_, 3rd \_\_\_\_\_, roof \_\_\_\_\_  
Maximum span: 1st floor \_\_\_\_\_, 2nd \_\_\_\_\_, 3rd \_\_\_\_\_, roof \_\_\_\_\_  
If one story building with masonry walls, thickness of walls? \_\_\_\_\_ height? \_\_\_\_\_

### If a Garage

No. cars now accommodated on same lot \_\_\_\_\_, to be accommodated \_\_\_\_\_ number commercial cars to be accommodated \_\_\_\_\_  
Will automobile repairing be done other than minor repairs to cars habitually stored in the proposed building? \_\_\_\_\_

APPROVED:

\_\_\_\_\_  
\_\_\_\_\_  
\_\_\_\_\_

### Miscellaneous

Will work require disturbing of any tree on a public street? no  
Will there be in charge of the above work a person competent to see that the State and City requirements pertaining thereto are observed? yes  
Dodge & Dirigo

Signature of owner By: Alton Hurd

INSPECTION COPY

P. 7/1

1  
1  
Permit No. 601  
Location 164 Melville St  
Owner Diogo & Dodge  
Date of permit \_\_\_\_\_  
Notif. closing-in \_\_\_\_\_  
Inspn. closing-in \_\_\_\_\_  
Final Notif. \_\_\_\_\_  
Final Inspn \_\_\_\_\_  
Cert. of Occupancy issued \_\_\_\_\_  
Staking Out Notice \_\_\_\_\_  
Form Check Notice \_\_\_\_\_

NOTES

Blank lined area for notes.



INDUSTRIAL ZONE

### APPLICATION FOR PERMIT

Class of Building or Type of Structure 2nd class  
Portland, Maine, March 1, 1961

To the INSPECTOR OF BUILDINGS, PORTLAND, MAINE

The undersigned hereby applies for a permit to erect alter repair demolish install the following building structure equipment in accordance with the Laws of the State of Maine, the Building Code and Zoning Ordinance of the City of Portland, plans and specifications, if any, submitted herewith and the following specifications:

Location 164 Middle St. Within Fire Limits? \_\_\_\_\_ Dist. No. \_\_\_\_\_  
 Owner's name and address Lois Bernstein, Realty Manager - 518 Forest Ave. Telephone \_\_\_\_\_  
 Lessee's name and address Erigo & Dodge, 164 Middle St. Telephone \_\_\_\_\_  
 Contractor's name and address Alton Hurd, 334 Spring St, Westbrook Me. Telephone UL-4-5361  
 Architect \_\_\_\_\_ Specifications \_\_\_\_\_ Plans YES No. of sheets 1  
 Proposed use of building Repair Garage No. families \_\_\_\_\_  
 Last use \_\_\_\_\_ No. families \_\_\_\_\_  
 Material masonry No. stories 2 Heat \_\_\_\_\_ Style of roof \_\_\_\_\_ Roofing \_\_\_\_\_  
 Other buildings on same lot \_\_\_\_\_  
 Estimated cost \$ \_\_\_\_\_ Fee \$ 2.00

#### General Description of New Work

To install ventilation for paint-spray room as per plan.

*1/4/61 - Paint spraying in the building dis-continued so install also as it made right*

It is understood that this permit does not include installation of heating apparatus which is to be taken out separately by and in the name of the heating contractor. **PERMIT TO BE ISSUED TO** contractor

#### Details of New Work

Is any plumbing involved in this work? \_\_\_\_\_ Is any electrical work involved in this work? \_\_\_\_\_  
 Is connection to be made to public sewer? \_\_\_\_\_ If not, what is proposed for sewage? \_\_\_\_\_  
 Has septic tank notice been sent? \_\_\_\_\_ Form notice sent? \_\_\_\_\_  
 Height average grade to top of plate \_\_\_\_\_ Height average grade to highest point of roof \_\_\_\_\_  
 Size, front \_\_\_\_\_ depth \_\_\_\_\_ No. stories \_\_\_\_\_ solid or filled land? \_\_\_\_\_ earth or rock? \_\_\_\_\_  
 Material of foundation \_\_\_\_\_ thickness, top \_\_\_\_\_ bottom \_\_\_\_\_ cellar \_\_\_\_\_  
 Material of underpinning \_\_\_\_\_ Height \_\_\_\_\_ Thickness \_\_\_\_\_  
 Kind of roof \_\_\_\_\_ Rise per foot \_\_\_\_\_ Roof covering \_\_\_\_\_  
 No. of chimneys \_\_\_\_\_ Material of chimneys \_\_\_\_\_ of lining \_\_\_\_\_ Kind of heat \_\_\_\_\_ fuel \_\_\_\_\_  
 Framing Lumber--Kind \_\_\_\_\_ Dressed or full size? \_\_\_\_\_ Corner posts \_\_\_\_\_ Sills \_\_\_\_\_  
 Size Girder \_\_\_\_\_ Columns under girders \_\_\_\_\_ Size \_\_\_\_\_ Max. on centers \_\_\_\_\_  
 Kind and thickness of outside sheathing of exterior walls? \_\_\_\_\_  
 Studs (outside walls and carrying partitions) 2x4-16" O. C. Bridging in every floor and flat roof span over 8 feet.  
 Joists and rafters: 1st floor \_\_\_\_\_, 2nd \_\_\_\_\_, 3rd \_\_\_\_\_, roof \_\_\_\_\_  
 On centers: 1st floor \_\_\_\_\_, 2nd \_\_\_\_\_, 3rd \_\_\_\_\_, roof \_\_\_\_\_  
 Maximum span: 1st floor \_\_\_\_\_, 2nd \_\_\_\_\_, 3rd \_\_\_\_\_, roof \_\_\_\_\_  
 If one story building with masonry walls, thickness of walls? \_\_\_\_\_ height? \_\_\_\_\_

#### If a Garage

No. cars now accommodated on same lot \_\_\_\_\_, to be accommodated \_\_\_\_\_ number commercial cars to be accommodated \_\_\_\_\_  
 Will automobile repairing be done other than minor repairs to cars habitually stored in the proposed building? \_\_\_\_\_

APPROVED:

\_\_\_\_\_  
\_\_\_\_\_  
\_\_\_\_\_

#### Miscellaneous

Will work require disturbing of any tree on a public street? no  
 Will there be in charge of the above work a person competent to see that the State and City requirements pertaining thereto are observed? yes  
Erigo & Dodge  
Alton Hurd

Signature of owner

by: *Alton Hurd*

INSPECTION COPY

F M

Permit No. 671  
 Location W. 4th Middle St.  
 Owner Durip & Dodge  
 Date of permit \_\_\_\_\_  
 Notif. closing-in \_\_\_\_\_  
 Inspn. closing-in \_\_\_\_\_  
 Final Notif. \_\_\_\_\_  
 Final Inspn. \_\_\_\_\_  
 Cert. of Occupancy issued \_\_\_\_\_  
 Staking Out Notice \_\_\_\_\_  
 Form Check Notice \_\_\_\_\_

**NOTES**

*[Handwritten notes in the notes section, including 'MAY 11 1911']*

This permit is not to be used for any work  
 in connection with the construction of  
 a building or other structure in the  
 city of New York, unless the same  
 is in accordance with the provisions  
 of the laws of the City of New York  
 relating to the construction of  
 buildings and other structures.  
 The City Engineer is not responsible  
 for the safety of any person or  
 property in connection with the  
 work authorized by this permit.  
 The City Engineer is not responsible  
 for the safety of any person or  
 property in connection with the  
 work authorized by this permit.

RECEIVED  
 MAY 11 1911  
 CITY ENGINEER  
 OFFICE OF THE CITY ENGINEER  
 100 NASSAU ST. N.Y.

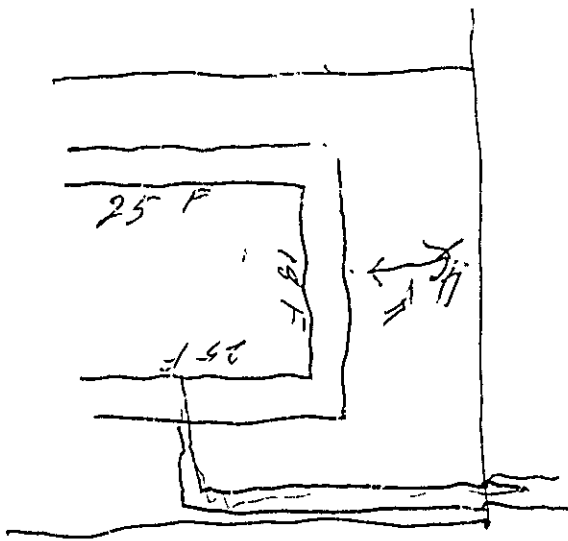

RECEIVED  
MAR 1 1961  
DEPT OF GLO'S. INSP.  
BY ...

INQUIRY BLANK

ZONE I-2b

FIRE DIST. 1

CITY OF PORTLAND, MAINE  
DEPARTMENT OF BUILDING INSPECTION

Date 11/24/58

Letter  
Verbal  
By Telephone

LOCATION 164 Middle Street OWNER Realty Management Co.

MADE BY Lewis Bernstein 518 Forest Avenue TEL. 2-5439

ADDRESS 518 Forest Avenue

PRESENT USE OF BUILDING Public Garage NO. STORIES 1 + Basement

LAST USE OF BUILDING Same CLASS OF CONSTRUCTION 2nd

REMARKS \_\_\_\_\_

INQUIRY What type of partitions would be required for partitioning off area in basement of front section of building for automobile body and fender work, including spray painting.

ANSWER See letter of 11/24/58

DATE OF REPLY \_\_\_\_\_ REPLY BY A. J. Sears