

175-181 COMMERCIAL STREET

PERMIT TO INSTALL PLUMBING

Address 179 Commercial St. PERMIT NUMBER **2341**

Installation For office

Owner of Bldg Brooks Ins.

Owner's Address same

Plumber Henry Gagne Date 6-9-81

660 E. Bridge St. NO FEE

Date Issued  
 Portland Plumbing Inspector  
 By ERNOLD R GOODWIN

App. First Insp.  
 Date  
 By

App. Final Insp.  
 Date  
 By

Type of Bldg.

- Commercial
- Residential
- Single
- Multi Family
- New Construction
- Remodeling

NEW	REPL		NO	FEE
		SINKS		
	1	LAVATORIES		
	1	TOILETS	1	3.00
		BATH TUBS	1	3.00
		SHOWERS		
		DRAINS FLOOR SURFACE		
		HOT WATER TANKS		
		TANKLESS WATER HEATERS		
		GARBAGE DISPOSALS		
		SEPTIC TANKS 1981		
		HOUSE SEWERS		
		ROOF LEADERS		
		AUTOMATIC WASHERS		
		DISHWASHERS		
		OTHER		
			TOTAL	6.00

Building and Inspection Services Dept. Plumbing Inspection

JUN 17 1981  
 ERNOLD R. GOODWIN  
 CHIEF PLUMBING INSPECTOR



**APPLICATION FOR PERMIT**  
**DEPARTMENT OF BUILDING INSPECTIONS SERVICES**  
**ELECTRICAL INSTALLATIONS**

Date June 9<sup>th</sup> 1981, 19  
 Receipt and Permit number A67247

To the CHIEF ELECTRICAL INSPECTOR, Portland, Maine:

The undersigned hereby applies for a permit to make electrical installations in accordance with the laws of Maine, the Portland Electrical Ordinance, the National Electrical Code and the following specifications:

LOCATION OF WORK: 179 Commercial St.  
 OWNER'S NAME: Brooks Ins. Co. ADDRESS: \_\_\_\_\_

	FEES
<b>OUTLETS:</b>	
Receptacles _____ Switches _____ Plugmold _____ f. TOTAL <u>30</u> ✓	3.00
<b>FIXTURES:</b> (number of)	
Incandescent _____ Flourescent _____ (not strip) TOTAL _____	
Strip Flourescent _____ ft. _____	
<b>SERVICES:</b>	
Overhead _____ Underground _____ Temporary _____ TOTAL amperes _____	
<b>METERS:</b> (number of) _____	
<b>MOTORS</b> (number of)	
Fractional _____	
1 HP or over _____	
<b>RESIDENTIAL HEATING:</b>	
Oil or Gas (number of units) _____	
Electric (number of rooms) _____	
<b>COMMERCIAL OR INDUSTRIAL HEATING:</b>	
Oil or Gas (by a main boiler) _____	
Oil or Gas (by separate units) _____	
Electric Under 20 kws _____ Over 20 kws _____	
<b>APPLIANCES:</b> (number of)	
Ranges _____	Water Heaters _____
Cook Tops _____	Disposals _____
Wall Ovens _____	Dishwashers _____
Dryers _____	Compactors _____
Fans _____	Others (denote) _____
<b>TOTAL</b> _____	
<b>MISCELLANEOUS:</b> (number of)	
Branch Panels _____	
Transformers _____	
Air Conditioners Central Unit _____	
Separate Units (windows) _____	
Signs 20 sq. ft. and under _____	
Over 20 sq. ft. _____	
Swimming Pools Above Ground _____	
In Ground _____	
Fire/Burglar Alarms Residential _____	
Commercial _____	
Heavy Duty Outlets, 220 Volt (such as welders) 30 amps and under _____	
over 30 amps _____	
Circus, Fairs, etc. _____	
Alterations to wires _____	
Repairs after fire _____	
Emergency Lights, battery _____	
Emergency Generators _____	
	INSTALLATION FEE DUE: 3.00
FOR ADDITIONAL WORK NOT ON ORIGINAL PERMIT ..... DOUBLE FEE DUE:	
FOR REMOVAL OF A "STOP ORDER" (304-16.b) ..... TOTAL AMOUNT DUE: 3.00	

**INSPECTION:**

Will be ready on \_\_\_\_\_, 19\_\_; or Will Call

CONTRACTOR'S NAME: Henry Gagne

ADDRESS: 660 E. Bridge St. Westbrook

TEL: 797-3472

MASTER LICENSE NO.: A 3013 SIGNATURE OF CONTRACTOR: \_\_\_\_\_

LIMITED LICENSE NO.: \_\_\_\_\_

INSPECTOR'S COPY — WHITE  
 OFFICE COPY — CANARY  
 CONTRACTOR'S COPY — GREEN

ELECTRICAL INSTALLATIONS—

Permit Number 67247

Location 129 Commercial St.

Owner B. Radio Assoc.

Date of Permit 6-9-81

Final Inspection 8-12-81

By Inspector Fully

Permit Application Register Page No. 26

INSPECTIONS: Service \_\_\_\_\_ by \_\_\_\_\_

Service called in \_\_\_\_\_

Closing-in 6-17-81 by Fully

PROGRESS INSPECTIONS: 7-8-81 \_\_\_\_\_

8-12-81 \_\_\_\_\_

\_\_\_\_\_

\_\_\_\_\_

\_\_\_\_\_

\_\_\_\_\_

CODE COMPLIANCE COMPLETED DATE 8-12-81

REMARKS:

Table with multiple rows for remarks, currently blank.



APPLICATION FOR PERMIT

PERMIT ISSUED

B.O.C.A. USE GROUP
B.O.C.A. TYPE OF CONSTRUCTION

ZONING LOCATION PORTLAND, MAINE, May 21, 1981

JUN 2 1981
470
CITY of PORTLAND

To the DIRECTOR OF BUILDING & INSPECTION SERVICES, PORTLAND, MAINE

The undersigned hereby applies for a permit to erect, alter, repair, demolish, move or install the following building, structure, equipment or change use in accordance with the Laws of the State of Maine, the Portland B.O.C.A. Building Code and Zoning Ordinance of the City of Portland with plans and specifications, if any, submitted herewith and the following specifications:

LOCATION 170 Commercial St. Fire District #1 [ ], #2 [ ]
1. Owner's name and address Brooks Ins. Agency Telephone
2. Lessee's name and address Telephone
3. Contractor's name and address Davis-Ryan 335 Forest Ave. Telephone 775-2294
4. Architect Specifications Plans No. of sheets
Proposed use of building offices No. families
Last use No. families
Material No. stories Heat Style of roof Roofing
Other buildings on same lot
Estimated contractual cost \$ 8,000. Fee \$ 37.00

FIELD INSPECTOR-Mr. GENERAL DESCRIPTION
This application is for: @ 775-5451 To make office renovations as per plans
Dwelling Ext. 234
Garage
Masonry Bldg.
Metal Bldg. Stamp of Special Conditions
Alterations
Demolitions
Change of Use
Other

NOTE TO APPLICANT: Separate permits are required by the installers and subcontractors of heating, plumbing, electrical and mechanicals.

PERMIT IS TO BE ISSUED TO 1 [ ] 2 [ ] 3 [x] 4 [ ]
Other:

DETAILS OF NEW WORK

Is any plumbing involved in this work? Is any electrical work involved in this work?
Is connection to be made to public sewer? If not, what is proposed for sewage?
Has septic tank notice been sent? Form notice sent?
Height average grade to top of plate Height average grade to highest point of roof
Size, front depth No. stories solid or filled land? earth or rock?
Material of foundation Thickness, top bottom cellar
Kind of roof Rise per foot Roof covering
No. of chimneys Material of chimneys of lining Kind of heat fuel
Framing Lumber-Kind Dressed or full size? Corner posts Sills
Size Girder Columns under girders Size Max. on center
Studs (outside walls and carrying partitions) 2x4-16" O. C. Bridging in every floor and flat roof span over 8 feet.
Joists and rafters: 1st floor 2nd 3rd roof
On centers: 1st floor 2nd 3rd roof
Maximum span: 1st floor 2nd 3rd roof
If one story building with masonry walls, thickness of walls? height?

IF A GARAGE

No. cars now accommodated on same lot, to be accommodated number commercial cars to be accommodated
Will automobile repairing be done other than minor repairs to cars habitually stored in the proposed building?

APPROVALS BY: DATE MISCELLANEOUS
BUILDING INSPECTION-PLAN EXAMINER Will work require disturbing of any tree on a public street?
ZONING:
BUILDING CODE: Will there be in charge of the above work a person competent
Fire Dept.: to see that the State and City requirements pertaining thereto
Health Dept.: are observed? YES.
Others:

Signature of Applicant Steven Davis Phone #

Type Name of above Steven Davis 1 [ ] 2 [ ] 3 [ ] 4 [ ]

FIELD INSPECTOR'S COPY

3

Other and Address

NOTES

6-3-81 - No change in <sup>per walter</sup> stair way -  
 only has art. to partitions on 2<sup>nd</sup> floor - checked at location - 2<sup>nd</sup> floor vacated, but no work started yet - ~~S~~  
 6-16-81 Started work - No beam walls  
 7-8-81 No one working -> Not much else done yet - ~~S~~  
 8-21-81 Still working  
 11-9-81 Completed

Permit No. 81/470  
 Location 179 Commercial St  
 Owner Brooks. Div. Agency  
 Date of permit: 6-2-81  
 Approved

A large section of the page consisting of multiple horizontal lines, likely a table or ledger. A large 'X' is drawn across the left side of this section, indicating it is unused or crossed out.



**APPLICATION FOR PERMIT**  
**DEPARTMENT OF BUILDING INSPECTIONS SERVICES**  
**ELECTRICAL INSTALLATIONS**

Date June 25, 19 79  
 Receipt and Permit number A 23984

To the CHIEF ELECTRICAL INSPECTOR, Portland, Maine:

The undersigned hereby applies for a permit to make electrical installations in accordance with the laws of Maine, the Portland Electrical Ordinance, the National Electrical Code and the following specifications:

LOCATION OF WORK: 177 Commerical St.  
 OWNER'S NAME: R. D. Brooks ADDRESS: same

<b>OUTLETS:</b>		<b>FEES</b>
Receptacles _____ Switches _____ Plugmold _____ ft. TOTAL <u>1-30</u> ✓		3.70
<b>FIXTURES:</b> (number of)		
Incandescent _____ Fluorescent <u>4 #x</u> (not strip) TOTAL <del>xxx</del> <u>1-10</u> ✓		3.00
Strip Fluorescent _____ ft. ....		
<b>SERVICES:</b>		
Overhead _____ Underground _____ Temporary _____ TOTAL amperes _____		
<b>METERS:</b> (number of) _____		
<b>MOTORS:</b> (number of)		
Fractional _____		
1 HP or over _____		
<b>RESIDENTIAL HEATING:</b>		
Oil or Gas (number of units) _____		
Electric (number of rooms) _____		
<b>COMMERCIAL OR INDUSTRIAL HEATING:</b>		
Oil or Gas (by a main boiler) _____		
Oil or Gas (by separate units) _____		
Electric Under 20 kws _____ Over 20 kws _____		
<b>APPLIANCES:</b> (number of)		
Ranges _____	Water Heaters _____	
Cook Tops _____	Disposals _____	
Wall Ovens _____	Dishwashers _____	
Dryers _____	Compactors _____	
Fans _____	Others (denote) _____	
<b>TOTAL</b> _____		
<b>MISCELLANEOUS:</b> (number of)		
Branch Panels _____		
Transformers _____		
Air Conditioners Central Unit _____		
Separate Units (windows) _____		
Signs 20 sq. ft. and under _____		
Over 20 sq. ft. _____		
Swimming Pools Above Ground _____		
In Ground _____		
Fire/Burglar Alarms Res't _____		
Co. _____		
Heavy Duty Outlets, 220 _____	30 amps and under _____	
	over 30 amps _____	
Circus, Fairs, etc. _____		
Alterations to wires _____		
Repairs after fire _____		
Emergency Lights, battery _____		
Emergency Generators _____		

FOR ADDITIONAL WORK NOT ON ORIGINAL PERMIT' ..... **INSTALLATION FEE DUE:**  
 FOR REMOVAL OF A "STOP ORDER" (304-16.b) ..... **DOUBLE FEE DUE:**  
**TOTAL AMOUNT DUE:** 6.00

**INSPECTION:**  
 Will be ready on ready, 19 79; or Will Call \_\_\_\_\_  
**CONTRACTOR'S NAME:** Frank Breggia  
**ADDRESS:** Nash Rd. So. Windham  
**TEL.:** 892-4008  
**MASTER LICENSE NO.:** 3931 **SIGNATURE OF CONTRACTOR:** [Signature]  
**LIMITED LICENSE NO.:** \_\_\_\_\_

INSPECTOR'S COPY — WHITE  
 OFFICE COPY — CANARY  
 CONTRACTOR'S COPY — GREEN

ELECTRICAL INSTALLATIONS

Permit Number 23984

Location 179 Commercial St

Owner R.D. Groves

Date of Permit 6-25-79

Final Inspection 8-21-79

By Inspector J. Libby

Permit Application Register Page No. 28

INSPECTIONS: Service \_\_\_\_\_ by \_\_\_\_\_

Service called in \_\_\_\_\_

Closing-in 6-25-79 by Libby

PROGRESS INSPECTIONS: 7-2-79 / \_\_\_\_\_

7-23-79 / \_\_\_\_\_

8-21-79 / \_\_\_\_\_

CODE  
COMPLIANCE  
COMPLETED  
DATE 8-21-79

DATE:	REMARKS:

*[Faint handwritten signature or mark]*



# CERTIFICATE OF APPROVAL

FOR INTERNAL PLUMBING FOR THE TOWN/CITY OF Portland

TOWN/CITY CODE  
05170

LPI NUMBER  
123

DATE ISSUED  
4 23 79  
Month Day Year

No 240541c

Certificate of App. Number

Inspector's Name CARRA P.I.M.I. W

Inspector Code 2

- 1. Owner
- 2. Licensed Master Plumber
- 3. Licensed Oil Burnerman
- 4. Employees of Public Utilities
- 5. Manufactured Housing Dealer
- 6. Manufactured Housing Installer

Owner George M... ..  
Address 179 Commercial St. Maine  
Location where plumbing was done and inspected.

THE INTERNAL PLUMBING INSTALLED PURSUANT TO THE ABOVE CERTIFICATE OF APPROVAL NUMBER HAS BEEN TESTED IN MY PRESENCE, FOUND TO BE FREE FROM LEAKS, AND WAS INSTALLED IN COMPLIANCE WITH THE MUNICIPAL AND STATE PLUMBING REGULATIONS.

*Arnold J. Goodwin*

Signature of LPI APR 24 1979

Date Inspected

ORIGINAL - To be sent to: Department of Human Services, Division of Health Engineering, Augusta, Maine 04322

STATE OFFICE USE ONLY

Control Number

## INTERNAL PLUMBING PERMIT FOR THE TOWN/CITY OF Portland

Town/City Code  
05170

LPI Number  
123

DATE ISSUED  
4 23 79  
Month Day Year

License Number  
1604

No 240541p

PERMIT NUMBER

Address of Where Plumbing is Done 177 Commercial St  
St., Rd., Av., Lot

Name of Owner BRACKLEY P.I.M.I. W Mailing Address Zip Code

- 1. Owner
- 2. Licensed Master Plumber
- 3. Licensed Oil Burnerman
- 4. Employees of Public Utilities
- 5. Manufactured Housing Dealer
- 6. Manufactured Housing Installer

Type of Construction	1. New	2. Remodeling	3. Addition	4. Remodeling & Addition	5. Replacement of Hot Water Heater	6. Hook-up of Mobile Home	7. Hook-up of Mobile Home	8. Other (Specify)
								<u>7</u>
Plumbing To Be Done	1. Single (Faucet)		2. Multiple (Faucet)		3. Mobile Home		4. Modular Home	
					5. Commercial		6. School	
							7. Other (Specify)	
							<u>5</u>	
Number of Fixtures or Hook-Ups	Sinks	Toilets	Tubs	Shower	Hot Water Heater	Water	Drains	Mobile Home
	<u>  </u>	<u>  </u>	<u>  </u>	<u>  </u>	<u>  </u>	<u>  </u>	<u>  </u>	<u>  </u>

This "Internal Plumbing Permit" is issued if work is not commenced within 30 days from date of issuance. Upon completion of work a "Certificate of Approval" must be obtained from the LPI.

**SCHEDULE OF FEES**  
(See section 1.12 of the Code)

1-10 Fixtures	\$2.00 each
11-20 Fixtures	\$1.50 each
21 Fixtures or up	\$1.00 each
Hook-Ups	\$2.00 each

NOTE: Water Heater (Tank or Tankless) is a Fixture!

APR 24 1979

Fixture Fee 9.00

Administrative Fee 3.70

Total Fee 12.70

If Double Fee Check ( 1 Box )

STATE OFFICE USE ONLY

Control Number

Administrative Code

Signature of LPI \_\_\_\_\_

MHE-311 Rev. 7/78



**APPLICATION FOR PERMIT**  
 DEPARTMENT OF BUILDING INSPECTIONS SERVICES  
 ELECTRICAL INSTALLATIONS

Date April 20, 19 79  
 Receipt and Permit number A 24020

To the CHIEF ELECTRICAL INSPECTOR, Portland, Maine:

The undersigned hereby applies for a permit to make electrical installations in accordance with the laws of Maine, the Portland Electrical Ordinance, the National Electrical Code and the following specifications:

LOCATION OF WORK: 179 Commerical St.  
 OWNER'S NAME: Ralph D. Brooke ADDRESS: same

	FEES
<b>OUTLETS:</b>	
Receptacles _____ Switches _____ Plugmold _____ ft. TOTAL <u>31.60</u> .....	5.00
<b>FIXTURES: (number of)</b>	
Incandescent _____ Flourescent _____ (not strip) TOTAL _____	
Strip Flourescent _____ ft. ....	
<b>SERVICES:</b>	
Overhead _____ Underground _____ Temporary _____ TOTAL amperes _____ ..	
<b>METERS: (number of)</b> _____	
<b>MOTORS: (number of)</b>	
Fractional _____	
1 HP or over _____	
<b>RESIDENTIAL HEATING:</b>	
Oil or Gas (number of units) _____	
Electric (number of rooms) _____	
<b>COMMERCIAL OR INDUSTRIAL HEATING:</b>	
Oil or Gas (by a main boiler) _____	
Oil or Gas (by separate units) _____	
Electric Under 20 kws <u>4</u> Over 20 kws _____	5.00
<b>APPLIANCES: (number of)</b>	
Ranges _____ Water Heaters _____	
Cook Tops _____ Disposals _____	
Wall Ovens _____ Dishwashers _____	
Dryers _____ Compactors _____	
Fans _____ <u>x</u> Others (denote) _____	
<b>TOTAL</b> _____	1.50
<b>MISCELLANEOUS: (number of)</b>	
Branch Panels _____	
Transformers _____	
Air Conditioners Central Unit _____	
Separate Units (windows) _____	
Signs 20 sq. ft. and under _____	
Over 20 sq. ft. _____	
Swimming Pools Above Ground _____	
In Ground _____	
Fire/Burglar Alarms Residential _____	
Commercial _____	
Heavy Duty Outlets, 220 Volt (such as welders) 30 amps and under _____	
over 30 amps _____	
Circus, Fairs, etc. _____	
Alterations to wires _____	
Repairs after fire _____	
Emergency Lights, battery _____	
Emergency Generators _____	
INSTALLATION FEE DUE: _____	
FOR ADDITIONAL WORK NOT ON ORIGINAL PERMIT ..... DOUBLE FEE DUE: _____	10.00
FOR REMOVAL OF A "STOP ORDER" (304-16.b) ..... belated fee. ....	
<b>TOTAL AMOUNT DUE:</b>	21.50

**INSPECTION:**  
 Will be ready on done, 19 79; or Will Call \_\_\_\_\_  
 CONTRACTOR'S NAME: Harry Gagne  
 ADDRESS: 660 East. Bridge St. West  
 TEL: 797-3472  
 MASTER LICENSE NO.: 3013 SIGNATURE OF CONTRACTOR: Harry Gagne  
 LIMITED LICENSE NO.: \_\_\_\_\_

INSPECTOR'S COPY — WHITE  
 OFFICE COPY — CANARY  
 CONTRACTOR'S COPY — GREEN



# CERTIFICATE OF APPROVAL

FOR INTERNAL PLUMBING FOR THE TOWN/CITY OF \_\_\_\_\_

OWNER Grand at Cove

Cont. of App. Number

**Nº 7505 1C**

ADDRESS 174 Commercial St. MAINE

Date C.O.A. Issued

**NOV 19 1977**

Location where plumbing was done and inspected

Plumbing installed by WRENNY A S.M.L.C.

Date Inspected

**NOV 9 1977**

11-1-77  
Date Permit Issued

**THE INTERNAL PLUMBING INSTALLED PURSUANT TO THE ABOVE CERTIFICATE OF APPROVAL NUMBER HAS BEEN TESTED IN MY PRESENCE, FOUND TO BE FREE FROM LEAKS, AND WAS INSTALLED IN COMPLIANCE WITH THE MUNICIPAL AND STATE PLUMBING REGULATIONS.**

Signature of LPI \_\_\_\_\_

State Office  
Use Only  
Date Received

ORIGINAL—To be sent to: Department of Human Services  
Division of Health Engineering 221 State Street Augusta, Maine 04333

## INTERNAL PLUMBING PERMIT FOR THE TOWN/CITY OF Portland

Town/City Code 06210 LPI Number 1753 License Number 1853 Date Issued 11/07/77 PERMIT NUMBER **Nº 7505 1P**

Address of where Plumbing is done

174 COMMERCIAL ST.

- 1. Owner
- 2. Licensed Master Plumber
- 3. Licensed Oil Burnerman
- 4. Employees of Public Utilities

Code  Issued

Name of Owner

WRENNY A S M L C F.I. M.I. 174 COMMERCIAL ST Zip Code

Type of Construction: 1. New  2. Remodeling  3. Addition  4. Remodeling & Addition  5. Replacement of Hot Water Heater  6. Hook-up of Mobile Home  7. Minor Change  8. Other (Specify)

Plumbing to Serve: 1. Single (Res)  2. Multi-Fam (Res)  3. Mobile Home  4. Mobile Home without Seal  5. Commercial  6. School  7. Other (Specify)

**SCHEDULE OF FEES**  
(See Sect. 1.12 of the Part I Code)

- 1-10 Fixtures \$2.00 each
- 11-20 Fixtures \$1.50 each
- 21 Fixtures or up \$1.00 each
- Hook-ups \$2.00 each

Note: Hot Water Heater (Tank or tank-less) is considered a fixture!

Fixture	0	Fixture	0	Fixture	0
Sinks	1	Shoppers		Hot Water Heaters	
Toilets		Urinals		Floor Drains	
Bathtubs		Clothes Washers		Other	
Lowboilers		Gas-Washers		Hook-ups	

Quantity Fee  
 Fixtures... 17 34.00  
 Hook-ups... 0 0.00  
 Administrative fee 3.00  
 Total or Double Fee 37.00

STATE OFFICE USE ONLY

Date Received

Receipt Number

Money Received

Administrative Code

*Wrenny A S M L C*

This "Internal Plumbing Permit" is invalid if work is not commenced within sixty (60) days from date of issuance. Upon completion of work a "Certificate of Approval" must be obtained.

Original—To be sent to: Department of Human Services, Division of Health Engineering 221 State Street Augusta, Maine 04333



APPLICATION FOR PERMIT

PERMIT ISSUED
OCT 31 1977
982
CITY OF PORTLAND

B.O.C.A. USE GROUP
B.O.C.A. TYPE OF CONSTRUCTION
ZONING LOCATION PORTLAND, MAINE, 10/31/77

To the DIRECTOR OF BUILDING & INSPECTION SERVICES, PORTLAND, MAINE

The undersigned hereby applies for a permit to erect, alter, repair, demolish, move or install the following building, structure, equipment or change use in accordance with the Laws of the State of Maine, the Portland B.O.C.A. Building Code and Zoning Ordinance of the City of Portland with plans and specifications, if any, submitted herewith and the following specifications:

LOCATION 179 Commercial St. Fire District #1 [ ] #2 [ ]
1. Owner's name and address Gerard St. Cyr Telephone
2. Lessee's name and address Ralph D. Brooks-Same Telephone
3. Contractor's name and address Clayton Ashnault, 258 Preble St., S Telephone 799-7840
4. Architect Specifications Plans No. of sheets
Proposed use of building office No. families
Last use office No. families
Material No. stories Heat Style of roof Roofing
Other buildings on same lot
Estimated contractual cost \$ 2,600 Fee \$ 12.00

FIELD INSPECTOR-Mr. GENERAL DESCRIPTION
This application is for: @ 775-5451
Dwelling Ext. 234 To remodel office building Putting up one new wall.
Garage
Masonry Bldg. Stamp of Special Conditions
Metal Bldg.
Alterations
Demolitions
Change of Use
Other

NOTE TO APPLICANT: Separate permits are required by the installers and subcontractors of heating, plumbing, electrical and mechanicals.

PERMIT IS TO BE ISSUED TO 1 [ ] 2 [ ] 3 [x] 4 [ ]
Other:

DETAILS OF NEW WORK

Is any plumbing involved in this work? Is any electrical work involved in this work?
Is connection to be made to public sewer? If not, what is proposed for sewage?
Has septic tank notice been sent? Form notice sent?
Height average grade to top of plate Height average grade to highest point of roof
Size, front depth No. stories solid or filled land? earth or rock?
Material of foundation Thickness, top bottom cellar
Kind of roof Rise per foot Roof covering
No. of chimneys Material of chimneys of lining Kind of heat fuel
Framing Lumber-Kind Dressed or full size? Corner posts Sills
Size Girder Columns under girders Size Max. on centers
Studs (outside walls and carrying partitions) 2x4-16" O. C Bridging in every floor and flat roof span over 8 feet.
Joists and rafters: 1st floor, 2nd, 3rd, roof
On centers: 1st floor, 2nd, 3rd, roof
Maximum span: 1st floor, 2nd, 3rd, roof
If one story building with masonry walls, thickness of walls? height?

IF A GARAGE

No. cars now accommodated on same lot, to be accommodated number commercial cars to be accommodated
Will automobile repairing be done other than minor repairs to cars habitually stored in the proposed building?

APPROVALS BY: DATE MISCELLANEOUS
BUILDING INSPECTION-PLAN EXAMINER Will work require disturbing of any tree on a public street?
ZONING:
BUILDING CODE: 0-4, 2, 8, 10/31/77 Will there be in charge of the above work a person competent to see that the St. and City requirements pertaining thereto are observed?
Fire Dept:
Health. Dep:
Others:

Signature of Applicant Clayton Ashnault Phone # 799-7840
Type Name of above Clayton Ashnault 1 [ ] 2 [ ] 3 [ ] 4 [ ]

FIELD INSPECTOR'S COPY

Other and Address

NOTES

3-28-78 I just received this permit the  
other day is the 1st time - partitions  
up - had no plans with permit - up

Permit No. 77/982  
Location 179 Commercial St  
Owner Leonard H. Cypa  
Date of permit 10-31-77  
Approved

Handwritten notes on a lined form, including a large 'X' mark on the left side.



**APPLICATION FOR PERMIT**  
**DEPARTMENT OF BUILDING INSPECTIONS SERVICES**  
**ELECTRICAL INSTALLATIONS**

Date May 18 19 77  
 Receipt and Permit number A09978

To the CHIEF ELECTRICAL INSPECTOR, Portland, Maine:

The undersigned hereby applies for a permit to make electrical installations in accordance with the laws of Maine, the Portland Electrical Ordinance, the National Electrical Code and the following specifications:

LOCATION OF WORK: 179 Commercial St. Ralph Brooks Ins.

OWNER'S NAME: Frank Brooks ADDRESS: same

OUTLETS: (number of)

Lights	_____	
Receptacles	_____	FEES
Switches	_____	
Plugmold	_____ (number of feet)	
TOTAL	_____	_____

FIXTURES: (number of)

Incandescent	_____	
Fluorescent	_____ (Do not include strip fluorescent)	
TOTAL	_____	_____
Strip Fluorescent, in feet	_____	_____

SERVICES:

Permanent, total amperes	_____	
Temporary	_____	

METERS: (number of) 8 ..... 4.00

MOTORS: (number of)

Fractional	_____	
1 HP or over	_____	

RESIDENTIAL HEATING:

Oil or Gas (number of units)	_____	
Electric (number of rooms)	_____	

COMMERCIAL OR INDUSTRIAL HEATING:

Oil or Gas (by a main boiler)	_____	
Oil or Gas (by separate units)	_____	
Electric (total number of kws)	_____	

APPLIANCES: (number of)

Ranges	_____	Water Heaters	_____
Cook Tops	_____	Disposals	_____
Wall Ovens	_____	Dishwashers	_____
Dryers	_____	Compactors	_____
Fans	_____	Others (denote)	_____
TOTAL	_____		_____

MISCELLANEOUS: (number of)

Branch Panels	<u>4</u>	.....	<u>4.00</u>
Transformers	_____		_____
Air Conditioners	_____		_____
Signs	_____		_____
Fire/Burglar Alarms	_____		_____
Circus, Fairs, etc.	_____		_____
Alterations to wires	_____		_____
Repairs after fire	_____		_____
Heavy Duty, 220v outlets	_____		_____
Emergency Lights, battery	_____		_____
Emergency Generators	_____		_____

INSTALLATION FEE DUE:

FOR ADDITIONAL WORK NOT ON ORIGINAL PERMIT	.....	DOUBLE FEE DUE:	_____
FOR REMOVAL OF A "STOP ORDER" (304-16.b)	.....		_____
FOR PERFORMING WORK WITHOUT A PERMIT (304-9)	.....		_____
		TOTAL AMOUNT DUE:	<u>8.00</u>

INSPECTION:

Will be ready on \_\_\_\_\_, 19\_\_\_\_; or Will Call x

CONTRACTOR'S NAME: John Perry

ADDRESS: 93 Neal St.

TEL.: 7735824

MASTER LICENSE NO.: 108

SIGNATURE OF CONTRACTOR:

LIMITED LICENSE NO.: \_\_\_\_\_

INSPECTOR'S COPY

ELECTRICAL INSTALLATIONS—

Permit Number 9978  
Location 179 Commercial St  
Owner Ralph Booth  
Date of Permit 5-18-77  
Final Inspection 5-20-77  
By Inspector R Libby  
Permit Application Register Page No. 98

INSPECTIONS: Service  by Libby  
Service called in 5-20-77  
Closing-in \_\_\_\_\_ by \_\_\_\_\_

PROGRESS INSPECTIONS: \_\_\_\_\_ / \_\_\_\_\_ / \_\_\_\_\_  
\_\_\_\_\_ / \_\_\_\_\_ / \_\_\_\_\_  
\_\_\_\_\_ / \_\_\_\_\_ / \_\_\_\_\_  
\_\_\_\_\_ / \_\_\_\_\_ / \_\_\_\_\_  
\_\_\_\_\_ / \_\_\_\_\_ / \_\_\_\_\_

CODE  
COMPLIANCE  
COMPLETED  
DATE 5-20-77

DATE:	REMARKS:
	<u>OK</u>

John Berry  
May 20 1977



Date Issued **12-14-76**  
 Portland Plumbing Inspector  
 By **ERNOLD R. GOODWIN**

Date **DEC 15 1976**  
 App. Final Insp.  
 By **ERNOLD R. GOODWIN**  
 CHIEF PLUMBING INSPECTOR

Date **DEC 15 1976**  
 App. Final Insp.  
 By **ERNOLD R. GOODWIN**  
 CHIEF PLUMBING INSPECTOR

- Commercial
- Residential
- Single
- Multi Family
- New Construction
- Remodeling

PERMIT NUMBER **0558**

Address **Commercial St. Brooks & Sons**

Owner of Bldg **Commercial**

Owner's Address **Brooks & Sons same**

Plumber **William Carr 378 Gray Rd. Falmouth, Me.** Date **12-14-76**

NEW	REPL		NO	
		SINKS		
		LAVATORIES	1	2.00
2		TOILETS	1	2.00
*		BATH TUBS		
		SHOWERS		
		DRAINS FLOOR SURFACE		
		HOT WATER TANKS		
		TANKLESS WATER HEATERS		
		GARBAGE DISPOSALS		
		SEPTIC TANKS		
		HOUSE SEWERS		
		ROOF LEADERS		
		AUTOMATIC WASHERS		
		DISHWASHERS		
		OTHER		
		<b>base fee</b>		<b>3.00</b>
		<b>TOTAL</b>		<b>7.00</b>

Building and Inspection Services Dept.: Plumbing Inspection



APPLICATION FOR AMENDMENT TO PERMIT

Amendment No. 1

Portland, Maine, Jan. 31, 1977

PERMIT ISSUED

FEB 1 1977

CITY of PORTLAND

To the INSPECTOR OF BUILDINGS, PORTLAND, MAINE

The undersigned hereby applies for amendment to Permit No. 77/31 pertaining to the building or structure comprised in the original application in accordance with the Laws of the State of Maine, the Building Code and Zoning Ordinance of the City of Portland, plans and specifications, if any, submitted herewith, and the following specifications:

Location 179 Commerical St. Within Fire Limits? Dist. No.
Owner's name and address Brooks Assoc. - same Telephone 774-4419
Lessee's name and address Telephone
Contractor's name and address John Thaxter RR 1 Box 55A No. Pownal, ME Telephone 799-6987
Architect Plans filed No. of sheets
Proposed use of building office space No. families
Last use same No. families
Increased cost of work 200.00 Additional fee 5.00

Description of Proposed Work

Alterations as revision on plans.

Details of New Work

Is any plumbing involved in this work? Is any electrical work involved in this work?
Height average grade to top of plate Height average grade to highest point of roof
Size, front depth No. stories solid or filled land? earth or rock?
Material of foundation Thickness, top bottom cellar
Material of underpinning Height Thickness
Kind of roof Rise per foot Roof covering
No. of chimneys Material of chimneys of lining
Framing lumber—Kind Dressed or full size?
Corner posts Sills Girt or ledger board? Size
Girders Size Columns under girders Size Max. on centers
Studs (outside walls and carrying partitions) 2x4-16" O. C. Bridging in every floor and flat roof span over 8 feet.
Joists and rafters: 1st floor, 2nd, 3rd, roof
On centers: 1st floor, 2nd, 3rd, roof
Maximum span: 1st floor, 2nd, 3rd, roof

Approved: O.K. E.H. 1/31/77

Signature of Owner John Thaxter

Approved: R. Smallwood Inspector of Buildings

INSPECTION COPY



APPLICATION FOR PERMIT

PERMIT ISSUED

B.O.C.A. USE GROUP .....

JAN 24 1977

B.O.C.A. TYPE OF CONSTRUCTION .....

ZONING LOCATION PORTLAND, MAINE, ... Jan. 20, 1977 CITY OF PORTLAND

To the DIRECTOR OF BUILDING & INSPECTION SERVICES, PORTLAND, MAINE

The undersigned hereby applies for a permit to erect, alter, repair, demolish, move or install the following building, structure, equipment or change use in accordance with the Laws of the State of Maine, the Portland B.O.C.A. Building Code and Zoning Ordinance of the City of Portland with plans and specifications, if any, submitted herewith and the following specifications:

LOCATION 179 Commercial St. Fire District #1 [ ] #2 [ ]
1. Owner's name and address ... Brooks Assoc. ... same Telephone 774-1429
2. Lessee's name and address ... Telephone ...
3. Contractor's name and address ... John Thaxter - RR# 1, Box 55A, Pownal, Me. Telephone 799-6987
4. Architect ... Specifications ... No. of sheets ...
Proposed use of building ... office spaces ... No. families ...
Last use ... same ... No. families ...
Material ... No. stories ... Heat ... Style of roof ... Roofing ...
Other buildings on same lot ...
Estimated contractual cost \$... 2,500 ... Fee \$... 12.00 ...

FIELD INSPECTOR—Mr. Marge GENERAL DESCRIPTION

This application is for: @ 775-5451

Dwelling ... Ext. 234 Permit to build new room and make extension to hallway, as per plans 1 sheet of plans. Walls non bearing partition. Stamp of Special Conditions
Garage ...
Masonry Bldg. ...
Metal Bldg. ...
Alterations ...
Demolitions ...
Change of Use ...
Other office ...

NOTE TO APPLICANT: Separate permits are required by the installers and subcontractors of heating, plumbing, electrical and mechanicals.

PERMIT IS TO BE ISSUED TO 1 [ ] 2 [ ] 3 [x] 4 [ ]

Other: .....

DETAILS OF NEW WORK

Is any plumbing involved in this work? ... Is any electrical work involved in this work? ...
Is connection to be made to public sewer? ... If not, what is proposed for sewage? ...
Has septic tank notice been sent? ... Form notice sent? ...
Height average grade to top of plate ... Height average grade to highest point of roof ...
Size, front ... depth ... No. stories ... solid or filled land? ... earth or rock? ...
Material of foundation ... Thickness, top ... bottom ... cellar ...
Kind of roof ... Rise per foot ... Roof covering ...
No. of chimneys ... Material of chimneys ... of lining ... Kind of heat ... fuel ...
Framing Lumber—Kind ... Dressed or full size? ... Corner posts ... Sills ...
Size Girder ... Columns under girders ... Size ... Max. on centers ...
Studs (outside walls and carrying partitions) 2x4-16" O. C. Bridging in every floor and flat roof span over 8 feet.
Joists and rafters: 1st floor ... 2nd ... 3rd ... roof ...
On centers: 1st floor ... 2nd ... 3rd ... roof ...
Maximum span: 1st floor ... 2nd ... 3rd ... roof ...
If one story building with masonry walls, thickness of walls? ... height? ...

IF A GARAGE

No. cars now accommodated on same lot ... to be accommodated ... number commercial cars to be accommodated ...
Will automobile repairing be done other than minor repairs to cars habitually stored in the proposed building? ...

APPROVALS BY: DATE

MISCELLANEOUS

BUILDING INSPECTION—PLAN EXAMINER ... Will work require disturbing of any tree on a public street? ..
ZONING: ...
BUILDING CODE: ... 0.15. E.R. 1/24/77 Will there be in charge of the above work a person competent to see that the State and City requirements pertaining thereto are observed? ..
Fire Dept.: ...
Health Dept.: ...
Others: ...

Signature of Applicant John Thaxter Phone # same ...
Type Name of above John Thaxter 1 [ ] 2 [ ] 3 [x] 4 [ ]

Other ... and Address ...

FIELD INSPECTOR'S COPY

NOTES

2-1-77 work started - WJ  
2-23-77 near completion - WJ  
5-26-77 No one called for final - work  
completed - WJ

Permit No. 97/0031  
Location 179 Greenwood St  
Owner Shirley Hoover  
Date of permit 1-20-77  
Approved 1-24-77 WJ  
WJ

Large empty lined area for notes, divided into two columns by a vertical line. The left column is crossed out with a large diagonal line.

B-3



APPLICATION FOR PERMIT TO ERECT  
SIGN OVER PUBLIC SIDEWALK OR STREET

PERMIT ISSUED

NOV 24 1976

CITY OF PORTLAND

Portland, Maine, Nov. 17, 1976

To the INSPECTOR OF BUILDINGS, PORTLAND, ME.

The undersigned hereby applies for a permit to erect the following described sign extending over a public sidewalk or street in accordance with the Building Code of the City of Portland, and the following specifications:

Location 175 Commercial St. Within File Limits? \_\_\_\_\_ Dist. No. 1092  
Owner of building to which sign is to be attached Brooks Assoc. 179 Commercial St.  
Name and address of owner of sign Albert LaBlanc 175 Commercial St.  
Contractor's name and address Scarborough Signs Rt. 1 - Scarborough Telephone \_\_\_\_\_  
When does contractor's bond expire? Dec. 31, 1976

Information Concerning Building

No. stories 3 Material of wall to which sign is to be attached brick

Details of Sign and Connections

Building owner's consent and agreement filed with application yes  
Electric? no Vertical dimension after erection 4 Horizontal 4  
Weight 60 1/2 lbs., Will there be any hollow spaces? no Any rigid frame? yes  
Material of frame steel No. advertising faces 2, material wood  
No. rigid connections 2 Are they fastened directly to frame of sign? yes  
No. through bolts 8, Size 3/8, Location, top or bottom both  
No. guys 4, material cable, Size 3/16  
Minimum clear height above sidewalk or street 10' 12"  
Maximum projection into street 4' Fee \$ 6.60

Signature of contractor

*Albert LaBlanc*

INSPECTION COPY

ZONING OK NOV. 11/19/76

O.K. E.S. 11/23/76

175 Commercial St

Albert Lablanc.

~~175~~

Sign

12-1-76 Not up yet - MG

12-14-76 Sign up & secure - MG

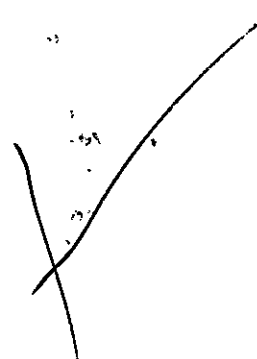



# APPLICATION FOR PERMIT

PERMIT ISSUED

NOV 8 1976

B.O.C.A. USE GROUP .....

B.O.C.A. TYPE OF CONSTRUCTION .....

ZONING LOCATION \_\_\_\_\_ PORTLAND, MAINE, Nov. 3, 1976

CITY OF PORTLAND

1017

To the DIRECTOR OF BUILDING & INSPECTION SERVICES, PORTLAND, MAINE

The undersigned hereby applies for a permit to erect, alter, repair, demolish, move or install the following building, structure, equipment or change use in accordance with the Laws of the State of Maine, the Portland B.O.C.A. Building Code and Zoning Ordinance of the City of Portland with plans and specifications, if any, submitted herewith and the following specifications:

LOCATION .. 175 Commercial St. .... Fire District #1 , #2

1. Owner's name and address .. Brooks Associates - 175 Comm. St. .... Telephone .....

2. Lessee's name and address .. ... Telephone .....

3. Contractor's name and address ... Albert Leblanc - 620 Ave. Old Orchard ... Telephone 234-9664..

4. Architect .. ... Specifications .. ... Plans ..r..... No. of sheets .....

Proposed use of building .. retail clothing .. ... No. families .....

Last use .. fire equipment co. .... No. families .....

Material .. . No. stones .. Heat .. Style of roof .. Roofing .....

Other buildings on same lot .. ...

Estimated contractual cost \$.. 500 .. Fee \$.. 5.00 ..

FIELD INSPECTOR—Mr. .... GENERAL DESCRIPTION

This application is for: @ 775-5451

Dwelling ..... Ext. 234

Garage ..... Permit to construct non-bearing partitions in two dressing rooms 24 ft. long

Masonry Bldg. .... Stamp of Special Conditions

Metal Bldg. ....

Alterations .....

Demolitions .....

Change of Use .....

Other .... retail clothing

NOTE TO APPLICANT: Separate permits are required by the installers and subcontractors of heating, plumbing, electrical and mechanicals.

PERMIT IS TO BE ISSUED TO 1  2  3  4

Other: .....

### DETAILS OF NEW WORK

Is any plumbing involved in this work? .. Is any electrical work involved in this work? .....

Is connection to be made to public sewer? .. If not, what is proposed for sewage? .....

Has septic tank notice been sent? .. Form notice sent? .....

Height average grade to top of plate .. Height average grade to highest point of roof .....

Size, front .. depth .. No. stories .. solid or filled land? .. earth or rock? .....

Material of foundation .. Thickness, top .. bottom .. cellar .....

Kind of roof .. Rise per foot .. Roof covering .....

No. of chimneys .. Material of chimneys .. of lining .. Kind of heat .. fuel .....

Framing Lumber—Kind .. Dressed or full size? .. Corner posts .. Sills .....

Size Girder .. Columns under girders .. Size .. Max. on centers .....

Studs (outside walls and carrying partitions) 2x4-16" O. C. Bridging in every floor and flat roof span over 8 feet.

Joists and rafters: 1st floor .., 2nd .., 3rd .., roof .....

On centers: 1st floor .., 2nd .., 3rd .., roof .....

Maximum span: 1st floor .., 2nd .., 3rd .., roof .....

If one story building with masonry walls, thickness of walls? .. height? .....

### IF A GARAGE

No. cars now accommodated on same lot .., to be accommodated .. number commercial cars to be accommodated ..

Will automobile repairing be done other than minor repairs to cars habitually stored in the proposed building? .....

APPROVALS BY: DATE MISCELLANEOUS

BUILDING INSPECTION—PLAN EXAMINER .. Will work require disturbing of any tree on a public street? ..no

ZONING: Nil ..

BUILDING CODE: Oct. 11/21/76 .. Will there be in charge of the above work a person competent to see that the State and City requirements pertaining thereto are observed? ..yes..

Fire Dept.: ..

Health Dept.: ..

Others: ..

Signature of Applicant .. Albert Leblanc .. Phone # .. same ..

Name of above .. Albert Leblanc .. 1  2  3  4

Other .. and Address ..

FIELD INSPECTOR'S COPY

NOTES

12-1-76 Completed - just dressing Room - ho

Handwritten notes on a set of horizontal lines.

Handwritten notes on a set of horizontal lines, with a large 'X' drawn across the top portion.

Blank horizontal lines for additional notes.

Permit No. 96/197  
 Location 175 Commercial St.  
 Owner Rayton Co. Inc.  
 Date of permit 11-3-76  
 Approved 11-3-76 NON DEPENDENT PERMITS





APPLICATION FOR PERMIT

B.O.C.A. USE GROUP
B.O.C.A. TYPE OF CONSTRUCTION
ZONING LOCATION PORTLAND, MAINE, Oct. 26, 1976

PERMIT ISSUED
OCT 29 1976
CITY OF PORTLAND

To the DIRECTOR OF BUILDING & INSPECTION SERVICES, PORTLAND, MAINE

The undersigned hereby applies for a permit to erect, alter, repair, demolish, move or install the following building, structure, equipment or change use in accordance with the Laws of the State of Maine, the Portland B.O.C.A. Building Code and Zoning Ordinance of the City of Portland with plans and specifications, if any, submitted herewith and the following specifications:

LOCATION 179 Commercial St. Fire District #1 [ ] #2 [ ]
1. Owner's name and address Ralph D. Brooks Insurance same Telephone
2. Lessee's name and address Telephone
3. Contractor's name and address John Thaxter Box 55A North Pownal Telephone 799-6987
4. Architect Specifications Plans No. of sheets
Proposed use of building clothing store No. families
Last use No. families
Material No. stories Heat Style of roof Roofing
Other buildings on same lot
Estimated contractual cost \$ 500. Fee \$ 5.

FIELD INSPECTOR—Mr. GENERAL DESCRIPTION
This application is for: @ 775-5451 To erect a non-bearing partition as per plan
Dwelling Ext. 234
Garage
Masonry Bldg.
Metal Bldg. Stamp of Special Conditions
Alterations
Demolitions
Change of Use
Other

NOTE TO APPLICANT: Separate permits are required by the installers and subcontractors of heating, plumbing, electrical and mechanicals.

PERMIT IS TO BE ISSUED TO 1 [ ] 2 [ ] 3 [x] 4 [ ]
Other:

DETAILS OF NEW WORK

Is any plumbing involved in this work? Is any electrical work involved in this work?
Is connection to be made to public sewer? If not, what is proposed for sewage?
Has septic tank notice been sent? Form notice sent?
Height average grade to top of plate Height average grade to highest point of roof
Size, front depth No. stories solid or filled land? earth or rock?
Material of foundation Thickness, top bottom cellar
Kind of roof Rise per foot Roof covering
No. of chimneys Material of chimneys of lining Kind of fuel
Framing Lumber—Kind Dressed or full size? Corner posts Sills
Size Girder Columns under girders Size Max. on centers
Studs (outside walls and carrying partitions) 2x4-16' O. C. Bridging in every floor and flat roof span over 8 feet.
Joists and rafters: 1st floor 2nd 3rd roof
On centers: 1st floor 2nd 3rd roof
Maximum span: 1st floor 2nd 3rd roof
If one story building with masonry walls, thickness of walls? height?

IF A GARAGE

No. cars now accommodated on same lot, to be accommodated number commercial cars to be accommodated
Will automobile repairing be done other than minor repairs to cars habitually stored in the proposed building?

APPROVALS BY: DATE MISCELLANEOUS
BUILDING INSPECTION—PLAN EXAMINER Will work require disturbing of any tree on a public street?
ZONING:
BUILDING CODE: 015.E.B.10127.176 Will there be in charge of the above work a person competent
Fire Dept.: to see that the State and City requirements pertaining thereto
Health Dept.: are observed? YES
Others:

Signature of Applicant John C. Thaxter Phone #
Type Name of above John Thaxter 1 [ ] 2 [ ] 3 [ ] 4 [ ]
Other
and Address

FIELD INSPECTOR'S COPY

NOTES

12-1-76 started work - H S  
1-26-77 same - needs to finish off complete work - H S  
2-23-77 same  
5-26-77 work completed - H S

Permit No. 96/998  
Location 19 Cornhill St. Cambridge MA  
Owner Ralph J. Conway  
Date of permit 10-26-76  
Approved 11-29-76 W. J. ...

~~Large diagonal scribble covering approximately 10 lines of the left column.~~

Large empty lined area on the right side of the page.



# APPLICATION FOR PERMIT

**PERMIT ISSUED**

B.O.C.A. USE GROUP .....

FEB 20 1976

B.O.C.A. TYPE OF CONSTRUCTION .....

0103

ZONING LOCATION \_\_\_\_\_ PORTLAND, MAINE, Feb. 17, 1976

CITY of PORTLAND

To the DIRECTOR OF BUILDING & INSPECTION SERVICES, PORTLAND, MAINE

The undersigned hereby applies for a permit to erect, alter, repair, demolish, move or install the following building, structure, equipment or change use in accordance with the Laws of the State of Maine, the Portland B.O.C.A. Building Code and Zoning Ordinance of the City of Portland with plans and specifications, if any, submitted herewith and the following specifications:

LOCATION ... 179 Commercial St. Fire District #1  #2

1. Owner's name and address . Ralph Brooks & Sons . same . Telephone 774-1419.

2. Lessee's name and address .....

3. Contractor's name and address . John Thaxter . Box 55 . A . North . Pownall . Telephone 781-3057.

4. Architect .....

Proposed use of building . office . No. of sheets .....

Last use .....

Material . . . . . No. stories . . . . . Heat . . . . . Style of roof . . . . . Roofing . . . . .

Other buildings on same lot .....

Estimated contractual cost \$ . 600 . . . . . Fee \$ . 5 . 00 . . . . .

FIELD INSPECTOR—Mr. Marge .....

This application is for: @ 775-5451 Erect 1 and 1/2 partitions as per plans

Dwelling . . . . . Ext. 234

Garage .....

Masonry Bldg. ....

Metal Bldg. ....

Alterations .....

Demolitions .....

Change of Use .....

Other .....

Stamp of Special Conditions

NOTE TO APPLICANT: Separate permits are required by the installers and subcontractors of heating, plumbing, electrical and mechanicals. call for pickup

PERMIT IS TO BE ISSUED TO 1  2  3  4  781-3057

### DETAILS OF NEW WORK

Is any plumbing involved in this work? .....

Is connection to be made to public sewer? .....

Has septic tank notice been sent? .....

Height average grade to top of plate .....

Size, front . . . . . depth . . . . . No. stories . . . . . solid or filled land? .....

Material of foundation .....

Kind of roof .....

No. of chimneys .....

Framing Lumber—Kind .....

Size Girder .....

Studs (outside walls and carrying partitions) 2x4-16" O. C. Bridging in every floor and flat roof span over 8 feet.

Joists and rafters: 1st floor . . . . . 2nd . . . . . 3rd . . . . . roof . . . . .

On centers: 1st floor . . . . . 2nd . . . . . 3rd . . . . . roof . . . . .

Maximum span: 1st floor . . . . . 2nd . . . . . 3rd . . . . . roof . . . . .

If one story building with masonry walls, thickness of walls? .....

### IF A GARAGE

No. cars now accommodated on same lot . . . . ., to be accommodated . . . . . number commercial cars to be accommodated . . . . .

APPROVALS BY: DATE MISCELLANEOUS

BUILDING INSPECTION—PLAN EXAMINER .....

ZONING: .....

BUILDING CODE: O.K. E.B. 6/20/76 .....

Fire Dept.: .....

Health Dept.: .....

Others: .....

Will work require disturbing of any tree on a public street? ..

Will there be in charge of the above work a person competent to see that the State and City requirements pertaining thereto are observed? Yes . . . . .

Signature of Applicant . John C. Thaxter . Phone # . . . . .

Type Name of above . John Thaxter . . . . . 1  2  3  4

Other . . . . .

and Address . . . . .

FIELD INSPECTOR'S COPY  
lak

NOTES

2-24-76 Completed 22 perha outlets

~~[Blank lined area crossed out]~~

Permit No. 76/103  
 Location 179 Commercial St  
 Owner Ralph Branta  
 Date of permit 2-20-76  
 Approved Disston

[Large blank lined area for notes]



0342

PERMIT ISSUED  
MAY 5 1976  
CITY OF PORTLAND

# APPLICATION FOR PERMIT TO ERECT SIGN OVER PUBLIC SIDEWALK OR STREET

Portland, Maine, April 29, 1976

To the INSPECTOR OF BUILDINGS, PORTLAND, ME.

The undersigned hereby applies for a permit to erect the following described sign extending over a public sidewalk or street in accordance with the Building Code of the City of Portland, and the following specifications.

Location 177 Commercial St. Within Fire Limits? yes Dist No. same

Owner of building to which sign is to be attached lessee- Anthony & Howison

Name and address of owner of sign same

Contractor's name and address Edward Cary 322 Fore St. Telephone SEA Port Coru. Co. 320 Fore

When does contractor's bond expire? insurance policy

### Information Concerning Building

No. stories 3 Material of wall to which sign is to be attached brick

### Details of Sign and Connections

Building owner's consent and agreement filed with application will send in

Electric? no Vertical dimension after erection 36" Horizontal 32"

Weight 50lbs. approx. Will there be any hollow spaces? yes Any rigid frame? no

Material of frame wood No. advertising faces 2 material wood w/metal brack

No. rigid connections 2 are they fastened directly to frame of sign? yes

No. through bolts 4 Size 3/8 by 4" Location, top or bottom both

No. guys --- material --- Size ---

Minimum clear height above sidewalk or street 10'

Maximum projection into street 3 1/2 ft. Fee \$ 5.80

Signature of contractor William H. Howison

INSPECTION COPY

G.K.E.B. 5/5/76

Permit No. 7610342  
 Location 177 Commercial  
 Owner Anthony W. K... ..  
 Date of permit 5/13/76  
 Sign Contractor \_\_\_\_\_  
 Final Inspn. \_\_\_\_\_

NOTES  
 3-11-76 No. up yet  
 5-13-76 up 25 per plans - M.S.

~~[Faint, mostly illegible text and lines, possibly a schedule or list, with a large handwritten 'X' over it.]~~



## CITY OF PORTLAND-MAINE

R. LOVELL BROWN  
BUILDING AND INSPECTION DIRECTOR

177 Commercial Street

April 30, 1976

Edward Cary  
322 Fore Street  
Portland, ME 04111

Dear Mr. Cary:

Before we will be in a position to issue permit for sign over the sidewalk at the above address, it will be necessary to tell us how "thick" the sign will be. Bear in mind it can be no less in thickness than 1½".

Very truly yours,

A handwritten signature in cursive script that reads "Earle S. Smith".

Earle S. Smith  
Plan Examiner

ESS/mt

**CITY OF PORTLAND, MAINE**

BUILDING & INSPECTION SERVICES  
ROOM 113 CITY HALL  
PORTLAND, MAINE 04111

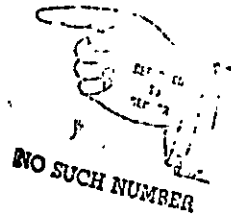
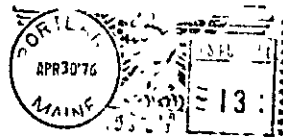

NO SUCH NUMBER

Edward Cary  
322 Fore Street  
Portland, ME 04111

320 Fore St



WRITTEN CONSENT AND AGREEMENT RELATING TO A CERTAIN SIGN PROPOSED  
TO BE ERECTED PROJECTING OVER A PUBLIC SIDEWALK FROM THE  
PREMISES AT 177 COMMERCIAL ST. IN PORTLAND, MAINE

BROOKS ASSOCIATES being the owner of the  
premises at 177 COMMERCIAL ST. in Portland, Maine hereby  
gives consent to the erection of a certain sign owned by  
ANTHONY AND HOWSON projecting over the public sidewalk  
from said premises as described in application to the Inspector  
of Buildings of Portland, Maine for a permit to cover erection  
of said sign;

And in consideration of the issuance of said permit  
BROOKS ASSOCIATES owner of said premises,  
in event said sign shall cease to serve the purpose for which  
it was erected or shall become dangerous and in event the owner  
of said sign shall fail to remove said sign or make it permanently  
safe in case the sign still serves the purpose for which it was  
erected, hereby agrees for himself or itself, for his heirs,  
its successors, and his or its assigns, to completely remove  
said sign within ten days of notice from said Inspector of  
Buildings that said sign is in such condition and of order from  
him to remove it.

In Witness whereof, the owner of said premises has signed  
this consent and agreement this 29<sup>th</sup>  
day of APRIL 1976 .

Cushman D. O'Neil  
Witness

BROOKS ASSOCIATES  
Dr. Frank J. Brooks  
Owner

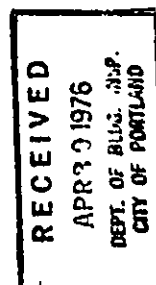

177 Commercial Street

April 30, 1976

Edward Cary  
322 Fore Street  
Portland, ME 04111

Dear Mr. Cary:

Before we will be in a position to issue permit for sign over the sidewalk at the above address, it will be necessary to tell us how "thick" the sign will be. Bear in mind it can be no less in thickness than  $1\frac{1}{2}$ ".

Very truly yours,

Earlo S. Smith  
Plan Examiner

ESS/mt

*2" thickness*

*will be using  
3/8*



ST. PAUL FIRE AND MARINE INSURANCE COMPANY  
ST. PAUL MERCURY INSURANCE COMPANY

**CERTIFICATE OF INSURANCE**

This is to certify that the following policies, subject to the terms, conditions and exclusions have been issued by this Company.

The Company will mail to the party to whom this Certificate is issued a record of any material change in or cancellation of said policy or policies but takes no responsibility for failure to do so.

NAME AND ADDRESS OF PARTY TO WHOM CERTIFICATE IS ISSUED:

• City of Portland, Maine  
• Building Inspection Department  
• 389 Congress Street  
• Portland, ME 04111

RECEIVED  
APR 23 1976  
DEPT. OF BLDG. INSP.  
CITY OF PORTLAND

NAME AND ADDRESS OF INSURED  
Cushman D. Anthony and William H. Howison  
177 Commercial Street  
Portland, ME 04111

TYPE OF INSURANCE & POLICY NO.	DATE		LIMITS OF LIABILITY				
	EFFECTIVE	EXPIRATION	BODILY INJURY			PROPERTY DAMAGE	
WORKMEN'S COMPENSATION			STATUTORY - In conformance with the Compensation Law of the State of:				
PUBLIC LIABILITY			Each Person	Each Occurrence	Aggregate	Each Occurrence	Aggregate
560JD5461	1/1/76	1/1/77	\$300,000.	\$300,000.	\$300,000.	\$300,000.	\$300,000.
AUTOMOBILE LIABILITY			Each Person	Each		Each	

REMARKS:  
Office Premises at 177 Commercial Street, Portland, Maine, including sign overhanging public sidewalk.

Dated April 26, 1976

By Edward Royce  
Noyes & Chapman, Inc.



**CARON & WALTZ INC.**

P. O. Box 2400 416 Preble Street South Portland, Maine 04106

Telephone 799-2228

October 4, 1972

Portland City Hall  
Building Inspection Department  
389 Congress Street  
Portland, Maine 04111

Gentlemen:

On October 3, 1972, one of your inspectors told one of our mechanics on the job that the combustion air louvre in the window of the boiler room was not large enough.

The building is to be occupied by Eastern Fire Equipment Company and is located at 179 Commercial Street, Portland.

The louvre is 12"x12" and opens to out of doors. According to Maine Code Paragraph 1407, Page 24, ten (10) square inches per gallon of oil per hour is the required area. This burner will fire six (6) gallons per hour, so that 60 square inches is needed. Allowing for 60% free area the 12"x12" louvre should be acceptable.

Hoping that this clarifies the matter, we remain

Sincerely yours,  
CARON & WALTZ, INC.

  
L. B. Jones,  
Engineer

LBJ/mlt

PLUMBING + HEATING + ELECTRICAL + REMODELING + REFRIGERATION + AIR CONDITIONING

179 Commercial St.

June 14, 1972

Langford & Low Company  
Box 662  
Portland

cc to: Eastern Fire & Equipment Co.  
404 Fore Street  
cc to: D. W. Christopherson  
Monument Square

Gentlemen:

A permit is issued herewith to make alterations to entire building at the above address as per plans submitted to this office subject to the following Building Code requirements:

1. All doors involved in the means of egress shall be equipped with vestibule latchesets or equivalent.
2. Exit signs shall be provided to adequately point the way to a means of egress.
3. How are toilet rooms to be vented?
4. An 1-3/4" solid wood core door with a self closing device is required in the heater room.
5. How is air for combustion to be supplied to the heater room?
6. A separate permit is required for the installation of the new heating system to be taken out by and in the name of the actual installer.

Very truly yours,

Earle S. Smith  
Plan Examiner

ESS:m



1-2 INDUSTRIAL ZONE

# APPLICATION FOR PERMIT

**PERMIT ISSUED**

JUN 16 1972

0681  
CITY OF PORTLAND

Class of Building or Type of Structure \_\_\_\_\_

Portland, Maine, June 13, 1972

To the INSPECTOR OF BUILDINGS, PORTLAND, MAINE

The undersigned hereby applies for a permit to erect alter repair demolish install the following building structure equipment in accordance with the Laws of the State of Maine, the Building Code and Zoning Ordinance of the City of Portland, plans and specifications, if any, submitted herewith and the following specifications:

Location 179 Commercial St. Within Fire Limits? \_\_\_\_\_ Dist. No. \_\_\_\_\_  
 Owner's name and address Eastern Fire & Equip. Co. - 404 Fore St. Telephone \_\_\_\_\_  
 Lessee's name and address \_\_\_\_\_ Telephone \_\_\_\_\_  
 Contractor's name and address Langford & Low Co. - Box 662 City Telephone \_\_\_\_\_  
 Architect \_\_\_\_\_ Specifications \_\_\_\_\_ Plans \_\_\_\_\_ No. of sheets A  
 Proposed use of building Eastern Fire & Equip. Sales & Service No. families \_\_\_\_\_  
 Last use Warehouse No. families \_\_\_\_\_  
 Material \_\_\_\_\_ No. stories 3 Heat \_\_\_\_\_ Style of roof \_\_\_\_\_ Roofing \_\_\_\_\_  
 Other buildings on same lot \_\_\_\_\_  
 Estimated cost \$ 58,000 Fee \$ 174.00

### General Description of New Work

To make alterations to entire building as per plans.

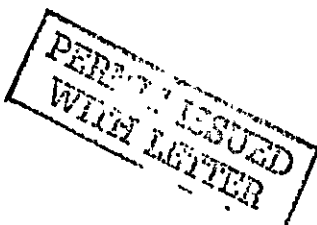

It is understood that this permit does not include installation of heating apparatus which is to be taken out separately by and in the name of the heating contractor. PERMIT TO BE ISSUED TO

### Details of New Work

Is any plumbing involved in this work? \_\_\_\_\_ Is any electrical work involved in this work? \_\_\_\_\_  
 Is connection to be made to public sewer? \_\_\_\_\_ If not, what is proposed for sewage? \_\_\_\_\_  
 Has septic tank notice been sent? \_\_\_\_\_ Form notice sent? \_\_\_\_\_  
 Height average grade to top of plate \_\_\_\_\_ Height average grade to highest point of roof \_\_\_\_\_  
 Size, front \_\_\_\_\_ depth \_\_\_\_\_ No. stories \_\_\_\_\_ solid or filled land? \_\_\_\_\_ earth or rock? \_\_\_\_\_  
 Material of foundation \_\_\_\_\_ Thickness, top \_\_\_\_\_ bottom \_\_\_\_\_ cellar \_\_\_\_\_  
 Kind of roof \_\_\_\_\_ Rise per foot \_\_\_\_\_ Roof covering \_\_\_\_\_  
 No. of chimneys \_\_\_\_\_ Material of chimneys \_\_\_\_\_ of lining \_\_\_\_\_ Kind of heat \_\_\_\_\_ fuel \_\_\_\_\_  
 Framing Lumber—Kind \_\_\_\_\_ Dressed or full size? \_\_\_\_\_ Corner posts \_\_\_\_\_ Sills \_\_\_\_\_  
 Size Girder \_\_\_\_\_ Columns under girders \_\_\_\_\_ Size \_\_\_\_\_ Max. on centers \_\_\_\_\_  
 Studs (outside walls and carrying partitions) 2x4-16" O. C. Bridging in every floor and flat roof span over 8 feet.  
 Joists and rafters: 1st floor \_\_\_\_\_, 2nd \_\_\_\_\_, 3rd \_\_\_\_\_, roof \_\_\_\_\_  
 On centers: 1st floor \_\_\_\_\_, 2nd \_\_\_\_\_, 3rd \_\_\_\_\_, roof \_\_\_\_\_  
 Maximum span: 1st floor \_\_\_\_\_, 2nd \_\_\_\_\_, 3rd \_\_\_\_\_, roof \_\_\_\_\_  
 If one story building with masonry walls, thickness of walls? \_\_\_\_\_ height? \_\_\_\_\_

### If a Garage

No. cars now accommodated on same lot \_\_\_\_\_, to be accommodated \_\_\_\_\_ number commercial cars to be accommodated \_\_\_\_\_  
 Will automobile repairing be done other than minor repairs to cars habitually stored in the proposed building? \_\_\_\_\_

APPROVED:

O. H. E. S. 6114172

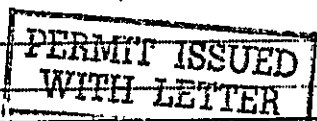

CS 301

INSPECTION COPY

Signature of owner

Langford & Low

*Edwin R. Low*

### Miscellaneous

Will work require disturbing of any tree on a public street? \_\_\_\_\_  
 Will there be in charge of the above work a person competent to see that the State and City requirements pertaining thereto are observed? YES

NOTES

10-3-72 CHECK BUILD  
ING. AIR SUPPLY FOR  
BOILER IN QUESTION ONLY  
10" - SUSPENDED CEILING  
HOLES IN OLD CEILING NOT  
FILLED TOLD FOREMAN  
OF SAME - REST OF  
BUILDING GOING AS PER  
PLAN.

*[Handwritten signature]*

7 Cof. C. No  
*[Handwritten mark]*

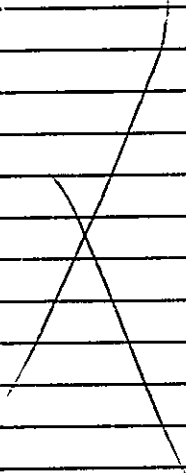

Permit No. 724 0681  
Location 179 Commercial St  
Owner Eastern Fire & Equip  
Date of permit 6/18/72  
Notif. closing-in  
Inspn. closing-in  
Final Notif.  
Final Inspn.  
Cert. of Occupancy issued  
Safety Certificate Waco  
Form Check Notice

Plans incomplete  
3rd floor done  
without permit

CITY OF PORTLAND, MAINE  
MEMORANDUM

DATE: 6/22/79

TO: Mr. Roger Willey

FROM: Fire Prevention Bureau

SUBJECT: 179 Commercial St.

(law office)

Approval is hereby given for a building permit  
from this Department subject to the following requirements/reasons:

- 1) Two separate and remote exits shall be provided.
- 2) All areas of hazard (boiler room) shall be enclosed with construction having a fire rating of at least one hour, including fire doors with self-closers.

  
Lt. James P. Collins  
Fire Prevention Bureau





APPLICATION FOR PERMIT

PERMIT ISSUED JUN 28 1979 000505 CITY of PORTLAND

B.O.C.A. USE GROUP B.O.C.A. TYPE OF CONSTRUCTION ZONING LOCATION PORTLAND, MAINE, June 6, 1979

To the DIRECTOR OF BUILDING & INSPECTION SERVICES, PORTLAND, MAINE

The undersigned hereby applies for a permit to erect, alter, repair, demolish, move or install the following building, structure, equipment or change use in accordance with the Laws of the State of Maine, the Portland B.O.C.A. Building Code and Zoning Ordinance of the City of Portland with plans and specifications, if any, submitted herewith and the following specifications:

LOCATION 179 Commerical Street Fire District #1, #2
1. Owner: name and address Ralph Brooks - same Telephone
2. Lessee's name and address Robinson & Kreiger - same Telephone 772-56 6565
3. Contractor's name and address Roger Willey - 1 Wolcott Ave. Falmouth Telephone 781-3097
4. Architect Specifications Plans No. of sheets
Proposed use of building law office No. families
Last use No. families
Material No. stories Heat Style of roof Roofing
Other buildings on same lot
Estimated contractual cost \$ 5,000... Fee \$ 23.50 fee not paid

FIELD INSPECTOR-Mr. GENERAL DESCRIPTION

This application is for: @ 775-5451
Dwelling Ext. 234 To change partitions, relocate existing partitions.
Garage
Masonry Bldg.
Metal Bldg. Stamp of Special Conditions
Alterations
Demolitions
Change of Use
Other

sent to Fire Dept. 6-7-79
per from Fire Dept 6-22-79

NOTE TO APPLICANT: Separate permits are required by the installers and subcontractors of heating, plumbing, electrical and mechanicals.

PERMIT IS TO BE ISSUED TO 1 2 3 4
Other:

DETAILS OF NEW WORK

Is any plumbing involved in this work? Is any electrical work involved in this work?
Is connection to be made to public sewer? If not, what is proposed for sewage?
Has septic tank notice been sent? Form notice sent?
Height average grade to top of plate Height average grade to highest point of roof
Size, front depth No. stories solid or filled land? earth or rock?
Material of foundation Thickness, top bottom cellar
Kind of roof Rise per foot Roof covering
No. of chimneys Material of chimneys of lining Kind of heat fuel
Framing Lumber-Kind Dressed or full size? Corner posts Sills
Size Girder Columns under girders Size Max. on centers
Studs (outside walls and carrying partitions) 2x4-16" O. C. Bridging in every floor and flat roof span over 8 feet.
Joists and rafters: 1st floor 2nd 3rd roof
On centers: 1st floor 2nd 3rd roof
Maximum span: 1st floor 2nd 3rd roof
If one story building with masonry walls, thickness of walls? height?

IF A GARAGE

No. cars now accommodated on same lot, to be accommodated number commercial cars to be accommodated
Will automobile repairing be done other than minor repairs to cars habitually stored in the proposed building?

APPROVALS BY: DATE MISCELLANEOUS
BUILDING INSPECTION-PLAN EXAMINER Will work require disturbing of any tree on a public street?
ZONING:
BUILDING CODE: Will there be in charge of the above work a person competent
Fire Dept.: to see that the State and City requirements pertaining thereto
Health Dept.: are observed?
Others:

Signature of Applicant Roger Willey Phone # same
Type Name of above Roger Willey 1 2 3 4

FIELD INSPECTOR'S COPY

Other and Address

NOTES

7-12-79 Was here before permit issued & some of work begun - ~~later~~ ~~was finishing~~ complete - not closed

8-6-79 Still work - completed

12-12-79 ~~completed~~

Approved

Date of permit

Owner

Location

Permit No.

6-26-79

Royal Brooks

179 Commercial St

199/525

Large grid area with horizontal lines, a large 'X' mark on the left side, and a signature on the right side.

PERMIT TO INSTALL PLUMBING

Address **179 Commercial St.** PERMIT NUMBER **516**

Installation For: **Eastern Fire Equipment Co.**

Owner's Address: **Ralph D. Brooks 403 Ford St.**

Plumber: **Caron & Walcz** Date: **6-30-72**

Date Issued **6-30-72**  
 Portland Plumbing Inspector  
 By **ERNOLD R. GOODWIN**

App. Final Insp. **SEP 19 1972**  
 Date **SEP 28 1972**  
 By **ERNOLD R. GOODWIN**

App. Final Insp. **SEP 28 1972**  
 Date **SEP 28 1972**  
 By **CHIEF PLUMBING INSPECTOR**  
 Type of Bldg.  
 Commercial  
 Residential  
 Single  
 Multi Family  
 New Construction  
 Remodeling

NEW	REPL	NO.	FEE
		SINKS	
	3	LAVATORIES	6.00
	3	TOILETS	4.60
		BATH TUBS	
		SHOWERS	
	2	DRAINS FLOOR * SURFACE	.60
		HOT WATER TANKS	
		TANKLESS WATER HEATERS	
		GARBAGE DISPOSALS	
		SEPTIC TANKS	
		HOUSE SEWERS	
		ROOF LEADERS	
		AUTOMATIC WASHERS	
		DISHWASHERS	
		OTHER	
TOTAL			<b>11.20</b>

Building and Inspection Services Dept; Plumbing Inspection

LIC. 276

## CITY OF PORTLAND, MAINE

### Application for Permit to Install Wires

Permit No. 142  
 Issued 1-5-73  
 Portland, Maine Jan 5, 1973

To the City Electrician, Portland, Maine:

The undersigned hereby applies for a permit to install wires for the purpose of conducting electric current, in accordance with the laws of Maine, the Electrical Ordinance of the City of Portland, and the following specifications:

(This form must be completely filled out — Minimum Fee, \$1.00)

Owner's Name and Address: EASTERN FIRE EQUIPMENT Co Tel. 274-1421  
 Contractor's Name and Address: FREEMAN G. CLAVES Jr Tel. 297-3544  
 Location: 175 Commercial St Use of Building: COMMERCIAL  
 Number of Families: \_\_\_\_\_ Apartments: \_\_\_\_\_ Stores: \_\_\_\_\_ Number of Stories: \_\_\_\_\_  
 Description of Wiring: New Work Additions Alterations ✓

Pipe Cable Metal Molding BX Cable Plug Molding (No. of feet)  
 No. Light Outlets Plugs 4 Light Circuits Plug Circuits 2  
 FIXTURES: No. Fluor. or Strip Lighting (No. feet)  
 SERVICE: Pipe Cable 208 3¢ Underground No. of Wires 4 Size 3  
 METERS: Relocated Added Total No. Meters  
 MOTORS: Number 3 Phase 3 H. P. 1 Amps Volts 208 Starter  
 HEATING UNITS: Domestic (Oil) No. Motors Phase H.P.  
 Commercial (Oil) No. Motors Phase H.P.  
 Electric Heat (No. of Rooms)

APPLIANCES: No. Ranges Watts Brand Feeds (Size and No.)  
 Elec. Heaters Watts  
 Miscellaneous Watts Extra Cabinets or Panels

Transformers Air Conditioners (No. Units) Signs (No. Units)  
 Will commence 6:00 19. Ready to cover in 19 Inspection 19  
 Amount of Fee \$ 6.00

Signed Freeman G. Claves Jr

DO NOT WRITE BELOW THIS LINE

NO.	TYPE	DATE	REMARKS
1	...	...	...
2	...	...	...
3	...	...	...
4	...	...	...
5	...	...	...
6	...	...	...
7	...	...	...
8	...	...	...
9	...	...	...
10	...	...	...
11	...	...	...
12	...	...	...

INSPECTED BY F. H. Hebert  
(over)

Eastern Fire Equip

LOCATION Commercial ST  
INSPECTION DATE 2/14/73  
WORK COMPLETED 2/14/73  
TOTAL NO. INSPECTIONS

REMARKS:

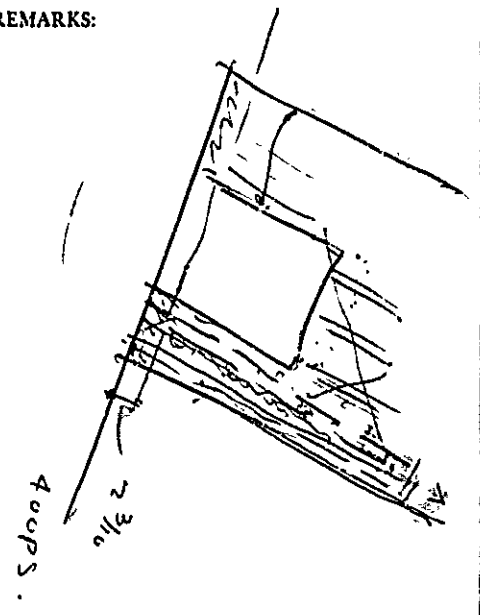

FEES FOR WIRING PERMITS EFFECTIVE JULY 31, 1963

WIRING  
1 to 30 Outlets \$ 2.00  
31 to 60 Outlets 3.00  
Over 60 Outlets, each Outlet .05  
(Each twelve feet or fraction thereof of fluorescent lighting or any type of plug molding will be classed as one outlet).

SERVICES  
Single Phase 2.00  
Three Phase 4.00

MOTORS  
Not exceeding 50 H.P. 3.00  
Over 50 H.P. 4.00

HEATING UNITS  
Domestic (Oil) 2.00  
Commercial (Oil) 4.00  
Electric Heat (Each Room) .75

APPLIANCES  
Ranges, Cooking Tops, Ovens, Water Heaters, Disposals, Built-in Dishwashers, Dryers, and any permanent built-in appliance --- each unit 1.50

MISCELLANEOUS  
Temporary Service, Single Phase 1.00  
Temporary Service, Three Phase 2.00  
Circuits, Carnivals, Fairs, etc. 10.00  
Meters, relocate 1.00  
Distribution Cabinet or Panel, per unit 1.00  
Transformers, per unit 2.00  
Air Conditioners, per unit 2.00  
Signs, per unit 2.00

ADDITIONS  
5 Outlets, or less 1.00  
Over 5 Outlets, Regular Wiring Rates

# CITY OF PORTLAND, MAINE

## Application for Permit to Install Wires

Permit No.  
 Issued 11/9/ ....., 1973  
 Portland, Maine

To the City Electrician, Portland, Maine:

The undersigned hereby applies for a permit to install wires for the purpose of conducting electric current, in accordance with the laws of Maine, the Electrical Ordinance of the City of Portland, and the following specifications:

(This form must be completely filled out - Minimum Fee, \$1.00)

Owner's Name and Address ALERS ASSOCIATES Tel. ....  
 Contractor's Name and Address CUKRAV Electric Tel. ....  
 Location 192 Commercial St. Use of Building Restaurant  
 Number of Families Apartments Stores Number of Stories 2  
 Description of Wiring: New Work Additions Alterations

Pipe Cable Metal Molding BX Cable Plug Molding (No. of feet)  
 No. Light Outlets Plugs Light Circuits Plug Circuits  
 FIXTURES: No. Fluor. or Strip Lighting (No. feet)  
 SERVICE: Pipe  Cable Undergound No. of Wires 3 Size 3/0  
 METERS: Relocated Added Total No. Meters  
 MOTORS: Number Phase H. P. Amps Volts Starter  
 HEATING UNITS: Domestic (Oil) No. Motors Phase H.P.  
 Commercial (Oil) No. Motors Phase H.P.

Electric Heat (No. of Rooms)  
 APPLIANCES: No. Ranges Watts Brand Feeds (Size and No.)  
 Elec. Heaters Watts  
 Miscellaneous Watts Extra Cabinets or Panels  
 Transformers Air Conditioners (No. Units) Signs (No. Units)  
 Will commence 19 Ready to cover in 19 Inspection 19  
 Amount of Fee \$ Signed [Signature]

DO NOT WRITE BELOW THIS LINE

SERVICE	METER	GROUND
VISITS: 1	2	3
7	8	9
		10
		11
		12

REMARKS:

INSPECTED BY [Signature]  
 (OVER)

LOCATION *Commercial ST 123*

INSPECTION DATE *1/22/73*

WORK COMPLETED *1/22/73*

TOTAL NO. INSPECTIONS *1*

REMARKS:

FEE S FOR WIRING PERMITS EFFECTIVE JULY 31, 1963

WIRING

1 to 30 Outlets \$ 2.00

31 to 60 Outlets 3.00

Over 60 Outlets, each Outlet .05  
(Each twelve feet or fraction thereof of fluorescent lighting or any type of plug molding will be classed as one outlet).

SERVICES

Single Phase 2.00

Three Phase 4.00

MOTORS

Not exceeding 50 H.P. 3.00

Over 50 H.P. 4.00

HEATING UNITS

Domestic (Oil) 2.00

Commercial (Oil) 4.00

Electric Heat (Each Room) .75

APPLIANCES

Ranges, Cooking Tops, Ovens, Water Heaters, Disposals, Built-in Dishwashers, Dryers, and any permanent built-in appliance — each unit 1.50

MISCELLANEOUS

Temporary Service, Single Phase 1.00

Temporary Service, Three Phase 2.00

Circuses, Carnivals, Fairs, etc. 10.00

Meters, relocate 1.00

Distribution, Cabinet or Panel, per unit 1.00

Transformers, per unit 2.00

Air Conditioners, per unit 2.00

Signs, per unit 1.00

ADDITIONS 1.00

WRITTEN CONSENT AND AGREEMENT RELATING TO A CERTAIN SIGN PROPOSED  
TO BE ERECTED PROJECTING OVER A PUBLIC SIDEWALK FROM THE  
PREMISES AT 175-179 Commercial St. IN PORTLAND, MAINE

Brooks Associates being the owner of the  
premises at 175-179 Commercial Street in Portland, Maine hereby gives  
consent to the erection of a certain sign owned by Eastern Fire Equipment Co. &  
Ralph D. Brooks & Sons  
projecting over the public sidewalk from said premises as described in  
application to the Inspector of Buildings of Portland, Maine for a  
permit to cover erection of said sign;

And in consideration of the issuance of said permit \_\_\_\_\_  
Brooks Associates, owner of said premises, in event said sign  
shall cease to serve the purpose for which it was erected or shall become  
dangerous and in event the owner of said sign shall fail to remove said  
sign or make it permanently safe in case the sign still serves the purpose  
for which it was erected, hereby agrees for himself or itself, for his  
heirs, its successors, and his or its assigns, to completely remove said  
sign within ten days of notice from said Inspector of Buildings that said  
sign is in such condition and of order from him to remove it.

In Witness whereof the owner of said premises has signed this  
consent and agreement this 20th day of November 1982.

JAMES KELLY  
Witness

BROOKS ASSOCIATES  
Ralph D. Brooks  
Owner





<sup>B</sup>  
1.2 INDUSTRIAL ZONE

APPLICATION FOR PERMIT TO ERECT  
SIGN OVER PUBLIC SIDEWALK OR STREET

PERMIT ISSUED

DEC 8 1972

CITY OF PORTLAND

Portland, Maine, Dec. 7, 1972

To the INSPECTOR OF BUILDINGS, PORTLAND, ME.

The undersigned hereby applies for a permit to erect the following described sign extending over a public sidewalk or street in accordance with the Building Code of the City of Portland, and the following specifications:

Location 175-179 Commercial St. Within Fire Limits?            Dist. No.             
Owner of building to which sign is to be attached Brooks Associates, same  
Name and address of contact of sign Ralph D. Brooks & Sons & Eastern Fire Equipment  
Contractor's name and address Portland Sign Co., 1832 Forest Ave. Telephone             
When does contractor's bond expire? Dec. 31, 1972

two identical sign of same dimension Information Concerning Building

No. stories 3 Material of wall to which sign is to be attached brick

Details of Sign and Connections

Building owner's consent and agreement filed with application: yes  
Electric? no Vertical dimension after erection 4' Horizontal 6'  
Weight 70# lbs. Will there be any hollow spaces? YES Any rigid frame? yes  
Material of frame Angle iron No. advertising faces two material sheet metal  
No. rigid connections four - each Are they fastened directly to frame of sign? yes  
No. through bolts none Size            Location, top or bottom             
No. guys 1 material cable Size 3/8"  
Minimum clear height above sidewalk or street 16'  
Maximum projection into street 6' Fee \$ 9.80

Signature of contractor

INSPECTION COPY

O.K. E.S. 12/7/72

Permit No. 72/1477

Location 175-179 Commercial St

Owner Brooks Assoc

Date of permit 12/8/72

Sign Contractor

Final Inspn.

NOTES

~~Jan 16/73~~  
~~[Signature]~~

\$14.75

# CITY OF PORTLAND, MAINE Application for Permit to Install Wires

Permit No. 59029  
Issued 6/30/72  
Portland, Maine 6/30, 1972

To the City Electrician, Portland, Maine:

The undersigned hereby applies for a permit to install wires for the purpose of conducting electric current, in accordance with the laws of Maine, the Electrical Ordinance of the City of Portland, and the following specifications:

(This form must be completely filled out — Minimum Fee, \$1.00)

Owner's Name and Address **EASTERN FIRE EQUIP.** Tel.  
Contractor's Name and Address **Carroll & Smith** Tel. 788 2228  
Location **179 COMMERCIAL ST** Use of Building **OFFICE**

Number of Families      Apartments      Stores      Number of Stories  
Description of Wiring: New Work      Additions      Alterations

Pipe Cable  Metal Molding      BX Cable      Plug Molding (No. of feet)  
No. Light Outlets      Plugs **27**      Light Circuits **7**      Plug Circuits **6**  
FIXTURES: No. **51**      Fluor. or Strip Lighting (No. feet) **44' (or)**

SERVICE: Pipe  Cable      Underground      No. of Wires **4**      Size **3/00, 4/0 AL**  
METERS: Relocated  Added      Total No. Meters

MOTORS: Number      Phase      H. P.      Amps      Volts      Starter  
HEATING UNITS: Domestic (Oil)      No. Motors      Phase      H.P.  
Commercial (Oil) **1**      No. Motors **6**      Phase **16**      H.P. **2 (TOTAL)**  
Electric Heat (No. of Rooms)

APPLIANCES: No. Ranges      Watts      Brand Feeds (Size and No.)  
Elec. Heaters      Watts  
Miscellaneous      Watts      Extra Cabinets or Panels

Transformers      Air Conditioners (No. Units)      Signs (No. Units)  
Will commence **7/3 1972** Ready to cover in      19      Inspection **will call 1972**  
Amount of Fee \$ **14.75**

Signed *Roger J. [Signature]* 7/15/72

DO NOT WRITE BELOW THIS LINE

SERVICE	METER						GROUND					
VISITS: 1	2	3	4	5	6							
..... 7	8	9	10	11	12							

REMARKS:

INSPECTED BY *[Signature]*  
(OVER)

CS 283

Distribution Cabinet or Panel per unit

LOCATION *Commercial ST 179*

INSPECTION DATE *8/4/72*

WORK COMPLETED *8/4/72*

TOTAL NO. INSPECTIONS *1*

REMARKS:

FEE S FOR WIRING PERMITS EFFECTIVE JULY 31, 1963

WIRING

1 to 30 Outlets \$ 2.00  
31 to 60 Outlets 3.00  
Over 60 Outlets, each Outlet .05  
(Each twelve feet or fraction thereof of fluorescent lighting or any type of plug molding will be classed as one outlet).

SERVICES

Single Phase 2.00  
Three Phase 4.00

MOTORS

Not exceeding 50 H.P. 3.00  
Over 50 H.P. 4.00

HEATING UNITS

Domestic (Oil) 2.00  
Commercial (Oil) 4.00  
Electric Heat (Each Room) .75

APPLIANCES

Ranges, Cooking Tops, Ovens, Water Heaters, Disposals, Built-in Dishwashers, Dryers, and any permanent built-in appliance — each unit 1.50

MISCELLANEOUS

Temporary Service, Single Phase 1.00  
Temporary Service, Three Phase 2.00  
Chutes, Conduits, Fairs, etc. 10.00  
Meters, relocate 1.00  
Distribution Cabinet or Panel, per unit 1.00

A. P.-101 Commercial Street

February 23, 1967

Casco Bay Trucking Company  
166 York Street  
Portland, Maine

CC to: G. H. Robinson Paper Co.  
177 Commercial Street  
Portland, Maine

CC to: Eugene Hays  
Range Road  
Cumberland, Maine

Gentlemen:

Permit to partition off office space 18' x 19' on the first floor at the above named location is not issuable at this time due to lack of information. We will need a plan of the first floor locating the proposed office in relation to the existing. With this information at hand we may further process this application.

Very truly yours,

Archie L. Seekins  
Deputy Director of Building & Inspection

ALS: kc



# APPLICATION FOR PERMIT

Class of Building or Type of Structure Second Class

Portland, Maine, February 10, 1967

To the INSPECTOR OF BUILDINGS, PORTLAND, MAINE

The undersigned hereby applies for a permit to erect alter repair demolish install the following building structure equipment in accordance with the Laws of the State of Maine, the Building Code and Zoning Ordinance of the City of Portland, plans and specifications, if any, submitted herewith and the following specifications:

Location 161 Commercial Street Within Fire Limits? \_\_\_\_\_ Dist. No. \_\_\_\_\_

Owner's name and address C.F. Robinson Pater Co., 177 Commercial St. Telephone \_\_\_\_\_

Lessee's name and address Casco Bay Trucking, 168 York St. Telephone \_\_\_\_\_

Contractor's name and address Eugene Hays, Range Rd., Cumberland, Maine Telephone \_\_\_\_\_

Architect \_\_\_\_\_ Specifications \_\_\_\_\_ Plans \_\_\_\_\_ No. of sheets \_\_\_\_\_

Proposed use of building Office, ship broker, etc. No. families \_\_\_\_\_

Last use Restaurant and storage No. families \_\_\_\_\_

Material brick No. stories 3 Heat \_\_\_\_\_ Style of roof \_\_\_\_\_ Roofing \_\_\_\_\_

Other buildings on same lot \_\_\_\_\_

Estimated cost \$ 60. Fee \$ 2.00

### General Description of New Work

Topartition off new office 18' x 19' - first floor front  
studs 2x4 - 16" O.C., panel plywood

It is understood that this permit does not include installation of heating apparatus which is to be taken out separately by and in the name of the heating contractor. **PERMIT TO BE ISSUED TO** contractor

### Details of New Work

Is any plumbing involved in this work? \_\_\_\_\_ Is any electrical work involved in this work? \_\_\_\_\_

Is connection to be made to public sewer? \_\_\_\_\_ If not, what is proposed for sewage? \_\_\_\_\_

Has septic tank notice been sent? \_\_\_\_\_ Form notice sent? \_\_\_\_\_

Height average grade to top of plate \_\_\_\_\_ Height average grade to highest point of roof \_\_\_\_\_

Size, front \_\_\_\_\_ depth \_\_\_\_\_ No. stories \_\_\_\_\_ solid or filled land? \_\_\_\_\_ earth or rock? \_\_\_\_\_

Material of foundation \_\_\_\_\_ Thickness, top \_\_\_\_\_ bottom \_\_\_\_\_ cellar \_\_\_\_\_

Kind of roof \_\_\_\_\_ Rise per foot \_\_\_\_\_ Roof covering \_\_\_\_\_

No. of chimneys \_\_\_\_\_ Material of chimneys \_\_\_\_\_ of lining \_\_\_\_\_ Kind of heat \_\_\_\_\_ fuel \_\_\_\_\_

Framing Lumber—Kind \_\_\_\_\_ Dressed or full size? \_\_\_\_\_ Corner posts \_\_\_\_\_ Sills \_\_\_\_\_

Size Girder \_\_\_\_\_ Columns under girders \_\_\_\_\_ Size \_\_\_\_\_ Max. on centers \_\_\_\_\_

Studs (outside walls and carrying partitions) 2x4-16" O. C. Bridging in every floor and flat roof span over 8 feet.

Joists and rafters: 1st floor \_\_\_\_\_, 2nd \_\_\_\_\_, 3rd \_\_\_\_\_, roof \_\_\_\_\_

On centers: 1st floor \_\_\_\_\_, 2nd \_\_\_\_\_, 3rd \_\_\_\_\_, roof \_\_\_\_\_

Maximum span: 1st floor \_\_\_\_\_, 2nd \_\_\_\_\_, 3rd \_\_\_\_\_, roof \_\_\_\_\_

If one story building with masonry walls, thickness of walls? \_\_\_\_\_ height? \_\_\_\_\_

### If a Garage

No. cars now accommodated on same lot \_\_\_\_\_, to be accommodated \_\_\_\_\_ number commercial cars to be accommodated \_\_\_\_\_

Will automobile repairing be done other than minor repairs to cars habitually stored in the proposed building? \_\_\_\_\_

APPROVED:

\_\_\_\_\_  
\_\_\_\_\_  
\_\_\_\_\_

### Miscellaneous

Will work require disturbing of any tree on a public street? no

Will there be in charge of the above work a person competent to see that the State and City requirements pertaining thereto are observed? yes

C. H. Robinson  
Casco Bay Trucking

*Eugene Hays*

CS 301

INSPECTION COPY

Signature of owner By: \_\_\_\_\_

*PH*



Permit No. 671  
Location 181 Commercial St  
Owner Dee's Bay Building  
Date of permit 7/1/67  
Notif. closing-in  
Inspn. closing-in  
Final Notif.  
Final Inspn.  
Cert. of Occupancy issued  
Staking Out Notice  
Form Check Notice

NOTES

6/19/68 - Work not  
done -

A. P.-181 Commercial Street

February 23, 1967

Casco Bay Trucking Company  
168 York Street  
Portland, Maine

CC to: C. H. Robinson Paper Co.  
177 Commercial Street  
Portland, Maine  
CC to: Eugene Hays  
Range Road  
Cumberland, Maine

Gentlemen:

Permit to partition off office space 18' x 19' on the first floor at the above named location is not issuable at this time due to lack of information. We will need a plan of the first floor locating the proposed office in relation to the existing. With this information at hand we may further process this application.

Very truly yours,

Archie L. Seekins  
Deputy Director of Building & Inspection

AIS: kc





1-26 INDUSTRIAL ZONE

# APPLICATION FOR PERMIT

Class of Building or Type of Structure Second Class

Portland, Maine, June 5, 1961

PERMIT ISSUED

JUN 8 1961

CITY of PORTLAND

To the INSPECTOR OF BUILDINGS, PORTLAND, MAINE

The undersigned hereby applies for a permit to erect alter repair demolish install the following building structure equipment in accordance with the Laws of the State of Maine, the Building Code and Zoning Ordinance of the City of Portland, plans and specifications, if any, submitted herewith and the following specifications:

Location 179 Commercial St. Within Fire Limits? \_\_\_\_\_ Dist. No. \_\_\_\_\_  
 Owner's name and address Chase Leavitt Co., 179 Commercial St. Telephone -237 51  
 Lessee's name and address \_\_\_\_\_ Telephone \_\_\_\_\_  
 Contractor's name and address owners Telephone \_\_\_\_\_  
 Architect \_\_\_\_\_ Specifications \_\_\_\_\_ Plans \_\_\_\_\_ No. of sheets \_\_\_\_\_  
 Proposed use of building Office and showroom No. families \_\_\_\_\_  
 Last use \_\_\_\_\_ No. families \_\_\_\_\_  
 Material brick \_\_\_\_\_ No. stories 3 Heat \_\_\_\_\_ Style of roof \_\_\_\_\_ Roofing \_\_\_\_\_  
 Other buildings on same lot \_\_\_\_\_  
 Estimated cost \$ 200. Fee \$ 2.00

### General Description of New Work

To lower two existing front windows approximately 2' and provide plate glass window 1ST FLOOR.

Permit Issued with Memo.

It is understood that this permit does not include installation of heating apparatus which is to be taken out separately by and in the name of the heating contractor. **PERMIT TO BE ISSUED TO**

owner

### Details of New Work

Is any plumbing involved in this work? \_\_\_\_\_ Is any electrical work involved in this work? \_\_\_\_\_  
 Is connection to be made to public sewer? \_\_\_\_\_ If not, what is proposed for sewage? \_\_\_\_\_  
 Has septic tank notice been sent? \_\_\_\_\_ Form notice sent? \_\_\_\_\_  
 Height average grade to top of plate \_\_\_\_\_ Height average grade to highest point of roof \_\_\_\_\_  
 Size, front \_\_\_\_\_ depth \_\_\_\_\_ No. stories \_\_\_\_\_ solid or filled land? \_\_\_\_\_ earth or rock? \_\_\_\_\_  
 Material of foundation \_\_\_\_\_ Thickness, top \_\_\_\_\_ bottom \_\_\_\_\_ cellar \_\_\_\_\_  
 Kind of roof \_\_\_\_\_ Rise per foot \_\_\_\_\_ Roof covering \_\_\_\_\_  
 No. of chimneys \_\_\_\_\_ Material of chimneys \_\_\_\_\_ of lining \_\_\_\_\_ Kind of heat \_\_\_\_\_ fuel \_\_\_\_\_  
 Framing Lumber—Kind \_\_\_\_\_ Dressed or full size? \_\_\_\_\_ Corner posts \_\_\_\_\_ Sills \_\_\_\_\_  
 Size Girder \_\_\_\_\_ Columns under girders \_\_\_\_\_ Size \_\_\_\_\_ Max. on centers \_\_\_\_\_  
 Studs (outside walls and carrying partitions) 2x4-16" O. C. Bridging in every floor and flat roof span over 8 feet.  
 Joists and rafters: 1st floor \_\_\_\_\_, 2nd \_\_\_\_\_, 3rd \_\_\_\_\_, roof \_\_\_\_\_  
 On centers: 1st floor \_\_\_\_\_, 2nd \_\_\_\_\_, 3rd \_\_\_\_\_, roof \_\_\_\_\_  
 Maximum span: 1st floor \_\_\_\_\_, 2nd \_\_\_\_\_, 3rd \_\_\_\_\_, roof \_\_\_\_\_  
 If one story building with masonry walls, thickness of walls? \_\_\_\_\_ height? \_\_\_\_\_

### If a Garage

No. cars now accommodated on same lot \_\_\_\_\_, to be accommodated \_\_\_\_\_ number commercial cars to be accommodated \_\_\_\_\_  
 Will automobile repairing be done other than minor repairs to cars habitually stored in the proposed building? \_\_\_\_\_

APPROVED:

*H. E. J.*

### Miscellaneous

Will work require disturbing of any tree on a public street? no  
 Will there be in charge of the above work a person competent to see that the State and City requirements pertaining thereto are observed? yes

Chase Leavitt Co.

INSPECTION COPY

Signature of owner By: *Wm Leavitt*

C-301

PH

NOTES

6/11/61 - Work not started - Allan  
 7/7/61 - Same - Allan  
 7/21/61 - Same - Allan  
 8/18/61 - Same - Allan  
 9/21/61 - Work done - Allan

~~Work not started~~  
~~Same - Allan~~  
~~Same - Allan~~  
~~Same - Allan~~  
~~Work done - Allan~~

4th  
 7th  
 8th  
 9th

Permit No.	61/600
Location	179 Commercial St.
Owner	Oliver Smith Co.
Date of permit	6/8/61
Notif. closing-in	
Inspn. closing-in	
Final Notif.	
Final Inspn.	
Cert. of Occupancy issued	
Staking Out Notice	
Form Check Notice	

Memorandum from Department of Building Inspection, Portland, Maine

AP-179 Commercial Street

June 8, 1961

Mr. William Leavitt  
Chase Leavitt Company  
179 Commercial Street

Dear Mr. Leavitt:

Permit to lower two existing front windows approximately 2' and to provide plate glass window at first floor is being issued subject to conformance with our discussion as follows:

New wood frame windows are to replace those in the existing glazed area and new windows approximately 2' high are to replace sheathing under existing window.

Very truly yours,

GEM/jg

Gerald E. Mayberry  
Deputy Building Inspection Director

CS-27

PERMIT NUMBER		PERMIT TO INSTALL PLUMBING	
9541		Address: 179 Commercial Street	
11-21-60		Installation For: C. H. Robinson	
PORTLAND PLUMBING INSPECTOR		Owner of Bldg.: C. H. Robinson	
By: J. P. Welch		Owner's Address: 165 Commercial Street	
APPROVED FIRST INSPECTION		Date: 11-21-60	
Date: 2-6-60	By: <i>J.P. Welch</i>	Plumber: Alan B. Rich	
APPROVED FINAL INSPECTION		PROPOSED INSTALLATIONS	
Date: Dec. 6, 60	By: JOSEPH P. WELCH		
TYPE OF BUILDING			
<input type="checkbox"/>	COMMERCIAL		
<input type="checkbox"/>	RESIDENTIAL		
<input type="checkbox"/>	SINGLE		
<input type="checkbox"/>	MULTI FAMILY		
<input type="checkbox"/>	NEW CONSTRUCTION		
<input type="checkbox"/>	REMODELING		
NEW		NUMBER	
1	SINKS	1	\$2.00
	LAVATORIES		
	TOILETS		
	BATH TUBS		
	SHOWERS		
	DRAINS		
1	HOT WATER TANKS	3	1 2.00
	TANKLESS WATER HEATERS		
	GARBAGE GRINDERS		
	SEPTIC TANKS		
	HOUSE SEWERS		
	ROOF LEADERS (conn. to house drain)		
PORTLAND HEALTH DEPT.		PLUMBING INSPECTION	
SM 12-53		Total	
		2	\$4.00