

ELECTRICAL INSTALLATIONS -

Permit Number 09908  
Location 1 Monument Sq  
Owner Coaco Bank  
Date of Permit 5-11-83  
Final Inspection 5-20-83  
By Inspector Libby  
Permit Application Register Page No. 146

INSPECTIONS: Service \_\_\_\_\_ by \_\_\_\_\_  
Service called in \_\_\_\_\_  
Closing-in 5-20-83 by Libby  
PROGRESS INSPECTIONS:  
\_\_\_\_\_/\_\_\_\_\_/\_\_\_\_\_  
\_\_\_\_\_/\_\_\_\_\_/\_\_\_\_\_  
\_\_\_\_\_/\_\_\_\_\_/\_\_\_\_\_  
\_\_\_\_\_/\_\_\_\_\_/\_\_\_\_\_  
\_\_\_\_\_/\_\_\_\_\_/\_\_\_\_\_

CODE  
COMPLIANCE  
COMPLETED  
DATE 5-20-83

REMARKS:  
DATE: \_\_\_\_\_

Table with multiple empty rows for recording inspection details or remarks.

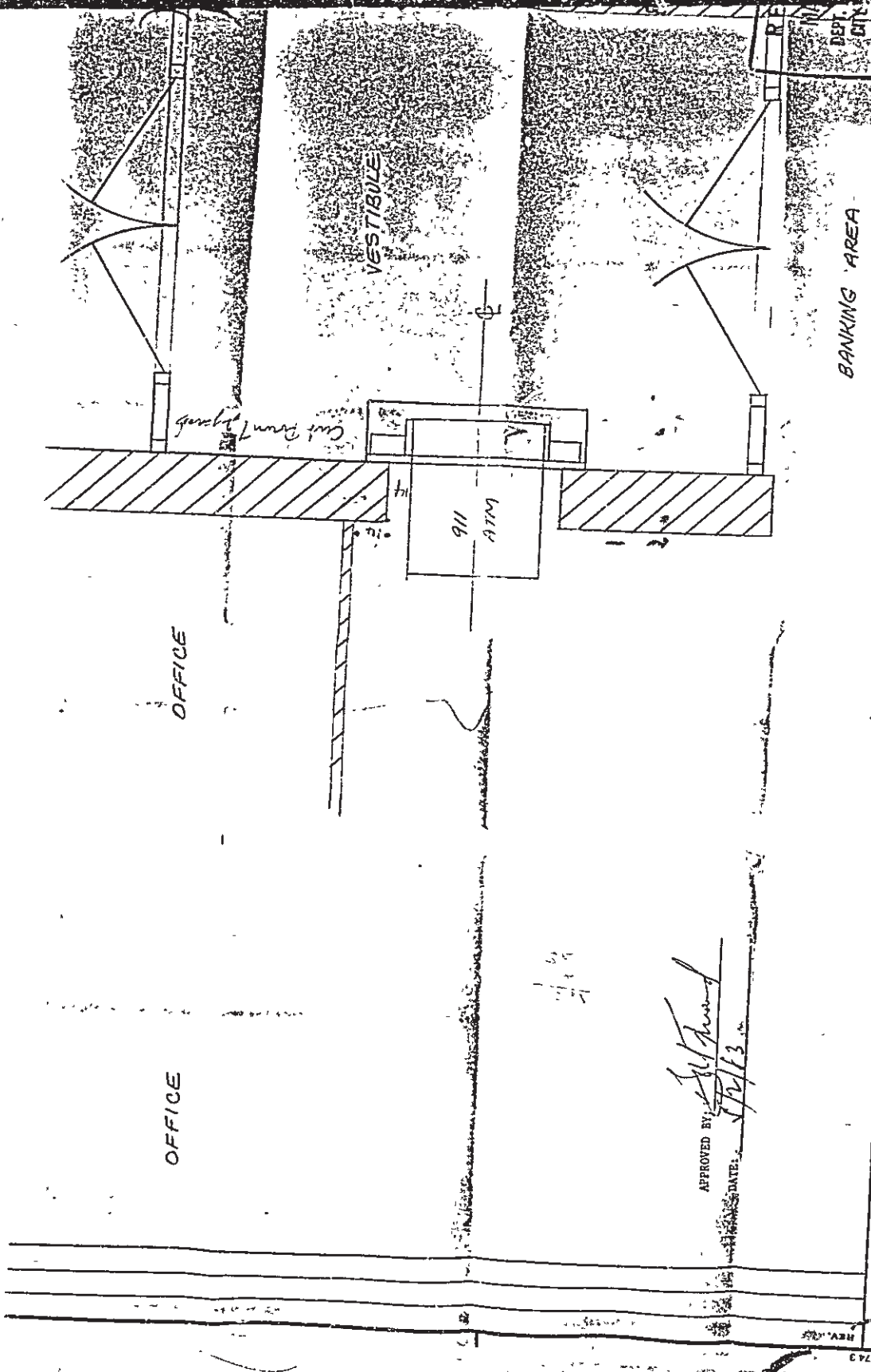

OFFICE

OFFICE

VESTIBULE

911  
ATM

BANKING AREA

*Curt. Drwn. 7 pyram.*

DEPT.  
CITY

APPROVED BY: *[Signature]*  
DATE: *5/2/13*

PROJECT	DR BY	CONTRACT NO.	<b>DEB</b>
NEXT ASSY	CH BY	DRAWING NO.	
MATERIAL	SCALE USED $1/2" = 1'0"$	CASCO BANK AND TRUST CO	
SEC'D 91122	DO NOT SCALE DRAWING	MAIN OFFICE	
	APPROVED BY	PORTLAND MAINE	

PRINTING 40-107 46574 3

APPLICATION FOR PERMIT

PERMIT ISSUED

B.O.C.A. USE GROUP ..... 00381 .....

MAY 6 1983

B.O.C.A. TYPE OF CONSTRUCTION .....

ZONING LOCATION ... PORTLAND, MAINE ... May 6, 1983

CITY of PORTLAND

To the CHIEF OF BUILDING & INSPECTION SERVICES, PORTLAND, MAINE

The undersigned hereby applies for a permit to erect, alter, repair, demolish, move or install the following building, structure, equipment or change use in accordance with the Laws of the State of Maine, the Portland B.O.C.A. Building Code and Zoning Ordinance of the City of Portland with plans and specifications, if any, submitted herewith and the following specifications:

LOCATION ... 1 Monument Square ... Fire District #1 , #2

1. Owner's name and address Pinard Realty - same ... Telephone .....

2. Lessee's name and address Casco Bank & Trust Co. same ... Telephone 774-8221

3. Contractor's name and address Pitt Construction Inc. -23 Lindale Ave., Biddeford, Me. 04005 ... Telephone 282-1169

Proposed use of building automatic system - 24 hour system ... No. of sheets .....

Last use same ... No. families .....

Material ... No. stories ... Heat ... Style of roof ... Roofing .....

Other buildings on same lot ... 3,000 ...

Estimated contractual cost \$ ... Appeal Fees \$ .....

FIELD INSPECTOR-Mr. ... Base Fee ... 25.00 .....

@ 775-5451

Late Fee .....

TOTAL \$ ... 25.00 .....

To cut hole thru brick wall for automatic teller system as per plans. 1 sheet of plans.

Stamp of Special Conditions

send permit to # 3 04005

NOTE TO APPLICANT: Separate permits are required by the installers and subcontractors of heating, plumbing, electrical and mechanicals.

DETAILS OF NEW WORK

Is any plumbing involved in this work? ... no ... Is any electrical work involved in this work? ... yes ...

Is connection to be made to public sewer? ... if not, what is proposed for sewage? .....

Has septic tank notice been sent? ... Form notice sent? .....

Height average grade to top of plate ... Height average grade to highest point of roof .....

Size, front ... depth ... No. stories ... solid or filled land? ... earth or rock? .....

Material of foundation ... Thickness, top ... bottom ... collar .....

Kind of roof ... Rise per foot ... Roof covering .....

No. of chimneys ... Material of chimneys ... of lining ... Kind of heat ... fuel .....

Framing Lumber-Kind ... Dressed or full size? ... Corner posts ... Sills .....

Size Girder ... Columns under girders ... Size ... Max. on centers .....

Studs (outside walls and carrying partitions) 2x4-16" O. C. Bridging in every floor and flat roof span over 8 feet.

Joists and rafters: 1st floor ... 2nd ... 3rd ... roof .....

On centers: 1st floor ... 2nd ... 3rd ... roof .....

Maximum span: 1st floor ... 2nd ... 3rd ... roof .....

If one story building with masonry walls, thickness of walls? ... height? .....

IF A GARAGE

No. cars now accommodated on same lot ... to be accommodated ... number commercial cars to be accommodated .....

Will automobile repairing be done other than minor repairs to cars habitually stored in the proposed building? .....

APPROVALS BY: ... DATE ... MISCELLANEOUS

BUILDING INSPECTION-PLAN EXAMINER ... Will work require disturbing of any tree on a public street? ... no

ZONING: .....

BUILDING CODE: ... Will there be in charge of the above work a person competent

Fire Dept.: ... to see that the State and City requirements pertaining thereto

Health Dept.: ... are observed? ... yes ...

Others: .....

Signature of Applicant Ralph H. Pitt ... Phone # ... same

Type Name of above Ralph Pitt for Pitt Construction Inc. / Casco Bank & Trust ... 10 20 30 40

and Address .....

FIELD INSPECTOR'S COPY

APPLICANT'S COPY

OFFICE FILE COPY

Tom August

Permit no 83/381

Location 1 Monument Square

Owner 5-6-83

Date of permit 5-6-83

Approved \_\_\_\_\_

Dwelling Cut hole thru back wall

Garage \_\_\_\_\_

Alteration \_\_\_\_\_

NOTES

6/7/83  
WORK DONE  
FOR PERMITS

9

# APPLICATION FOR PERMIT

## PERMIT ISSUED

B.O.C.A. USE GROUP .....  
 B.O.C.A. TYPE OF CONSTRUCTION ..... 00381 ..... MAY 6 1983  
 ZONING LOCATION ..... PORTLAND, MAINE ..... May 6, 1983

To the CHIEF OF BUILDING & INSPECTION SERVICES, PORTLAND, MAINE CITY OF PORTLAND

The undersigned hereby applies for a permit to erect, alter, repair, demolish, move or install the following building, structure, equipment or change use in accordance with the Laws of the State of Maine, the Portland B.O.C.A. Building Code and Zoning Ordinance of the City of Portland with plans and specifications, if any, submitted herewith and the following specifications:

LOCATION ..... 1 Monument Square ..... Fire District #1  #2

1. Owner's name and address Finard Realty Co. same ..... Telephone .....  
 2. Lessee's name and address Casco Bank & Trust Co. same ..... Telephone 774-8221 .....  
 3. Contractor's name and address Pitt Construction Inc. -23 Lindale Ave. Biddaford, Me. 04005 ..... Telephone 282-1169 .....  
 Proposed use of building automatic system - 24 hour system ..... No. of sheets .....  
 Last use same ..... No. families .....  
 Material ..... No. stories ..... Heat ..... Style o. roof ..... Roofing .....  
 Other buildings on same lot .....  
 Estimated contractual cost \$ 3,000 .....  
 FIELD INSPECTOR—Mr. .....  
 @ 775-5451

Appeal Fees \$ .....  
 Base Fee ..... 25.00 .....  
 Late Fee .....  
 TOTAL \$ ..... 25.00 .....

To cut hole thru brick wall for automation teller system as per plans. 1 sheet of plans.

Stamp of Special Conditions

send permit to # 3 04005

**NOTE TO APPLICANT:** Separate permits are required by the installers and subcontractors of heating, plumbing, electrical and mechanicals.

### DETAILS OF NEW WORK

Is any plumbing involved in this work? no ..... Is any electrical work involved in this work? yes .....  
 Is connection to be made to public sewer? ..... If not, what is proposed for sewage? .....  
 Has septic tank notice been sent? ..... Form notice sent? .....  
 Height average grade to top of plate ..... Height average grade to highest point of roof .....  
 Size, front ..... depth ..... No. stories ..... solid or filled land? ..... earth or rock? .....  
 Material of foundation ..... Thickness, top ..... bottom ..... cellar .....  
 Kind of roof ..... Rise per foot ..... Roof covering .....  
 No. of chimneys ..... Material of chimneys ..... of lining ..... Kind of heat ..... fuel .....  
 Framing Lumber—Kind ..... Dressed or full size? ..... Corner posts ..... Sills .....  
 Size Girder ..... Columns under girders ..... Size ..... Max. on centers .....  
 Studs (outside walls and carrying partitions) 2x4-16" O. C. Bridging in every floor and flat roof span over 8 feet.  
 Joists and rafters: 1st floor ..... 2nd ..... 3rd ..... roof .....  
 On centers: 1st floor ..... 2nd ..... 3rd ..... roof .....  
 Maximum span: 1st floor ..... 2nd ..... 3rd ..... roof .....  
 If one story building with masonry walls, thickness of walls? ..... height? .....

### IF A GARAGE

No. cars now accommodated on same lot ..... to be accommodated ..... number commercial cars to be accommodated .....  
 Will automobile repairing be done other than minor repairs to cars habitually stored in the proposed building? .....

APPROVALS BY: ..... DATE ..... MISCELLANEOUS no .....  
 BUILDING INSPECTION—PLAN EXAMINER ..... Will work require disturbing of any tree on a public street? .....  
 ZONING: .....  
 BUILDING CODE: ..... Will there be in charge of the above work a person competent to see that the State and City requirements pertaining thereto are observed? yes .....  
 Fire Dept: .....  
 Health Dept: .....  
 Oth. ....

Signature of Applicant Ralph Pitt ..... Phone # same .....  
 Type Name of above Ralph Pitt for Pitt Construction Inc. / Casco Bank & Trust .....  1  2  3  4  Other .....  
 and Address .....

10

FIELD INSPECTOR'S COPY      APPLICANT'S COPY      OFFICE FILE COPY



## CITY OF PORTLAND

JOSEPH E. GRAY, JR.  
DIRECTOR OF PLANNING  
AND URBAN DEVELOPMENT

October 4, 1982

Finard & Company  
2 Monument Square  
Portland, Maine 04111

Re: 1 Monument Square

Attn: William Wyte

Dear Mr. Wyte:

During a recent building inspection for work being done on the 6th floor of the 1 Monument Square building, it was noted that in the electric room firestopping is needed. It appears that new telephone trunk lines were installed in these electrical rooms that extend throughout the building. As usual in these cases, a larger area than needed was opened upon each floor level. However, after the telephone job was done, the required firestopping to close off the open areas between floors was not completed. It is necessary that this firestopping be completed at this time.

If you have any questions regarding this matter, or require a further discussion of these items, please don't hesitate to contact me.

Thank you,

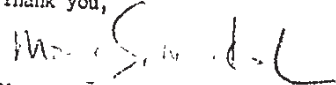
  
Marge Schmuckal  
Code Enforcement Officer

MS/jmr

APPLICATION FOR PERMIT

PERMIT ISSUED
FEB 3 1983
CITY OF PORTLAND

B.O.C.A. USE GROUP
B.O.C.A. TYPE OF CONSTRUCTION
ZONING LOCATION PORTLAND, MAINE Jan. 28, 1983

To the CHIEF OF BUILDING & INSPECTION SERVICES, PORTLAND, MAINE

The undersigned hereby applies for a permit to erect, alter, repair, demolish, move or install the following building, structure, equipment or change use in accordance with the Laws of the State of Maine, the Portland B.O.C.A. Building Code and Zoning Ordinance of the City of Portland with plans and specifications, if any, submitted herewith and the following specifications:

LOCATION Monument Square - 10th Floor - Pierce, Atwood Fire District #1 [ ] #2 [ ]

1. Owner's name and address Casco Bank - same Telephone
2. Lessee's name and address Pierce, Atwood, Scribner, Attorneys Telephone
3. Contractor's name and address F. P. & C. H. Murray - P. O. Box 2297 Telephone 799-8136 So. Portland

Proposed use of building attorney offices No. of sheets
Last use No. families
Material No. stories Heat Style of roof Roofing
Other buildings on same lot
Estimated contractual cost \$ 27,000.

FIELD INSPECTOR-Mr. @ 775-5451

Appeal Fees \$
Base Fee 145.00
Late Fee
TOTAL \$ 145.00

Alterations to already existing area of building as per plans. 6 sheets of plans.

Stamp of Special Conditions

send permit to # 3 04106

NOTE TO APPLICANT: Separate permits are required by the installers and subcontractors of heating, plumbing, electrical and mechanicals.

DETAILS OF NEW WORK

Is any plumbing involved in this work? Is any electrical work involved in this work?
Is connection to be made to public sewer? If not, what is proposed for sewage?
Has septic tank notice been sent? Form notice sent?
Height average grade to top of plate Height average grade to highest point of roof
Size, front depth No. stories solid or filled land? earth or rock?
Material of foundation Thickness, top bottom cellar
Kind of roof Rise per foot Roof covering
No. of chimneys Material of chimneys of lining Kind of heat fuel
Framing Lumber-Kind Dressed or full size? Corner posts Sills
Size Girder Columns under girders Size Max. on centers
Studs (outside walls and carrying partitions) 2x4-16" O. C. Bridging in every floor and flat roof span over 8 feet.
Joists and rafters: 1st floor 2nd 3rd roof
On centers: 1st floor 2nd 3rd roof
Maximum span: 1st floor 2nd 3rd roof
If one story building with masonry walls, thickness of walls? height?

IF A GARAGE

No. cars now accommodated on same lot, to be accommodated number commercial cars to be accommodated
Will automobile repairing be done other than minor repairs to cars habitually stored in the proposed building?

APPROVALS BY: DATE
BUILDING INSPECTION-PLAN EXAMINER
ZONING:
BUILDING CODE:
Fire Dept.:
Health Dept.:
Others:

MISCELLANEOUS
Will work require disturbing of any tree on a public street?
Will there be in charge of the above work a person competent to see that the State and City requirements pertaining thereto are observed?

Signature of Applicant Robert Murray for Phone # same
Type Name of above F. P. & C. H. Murray 1 [ ] 2 [ ] 3 [ ] 4 [ ]
Other and Address

Permit no. 83/077  
 Location Montgomery Square  
 Owner Coast Bank  
 Date of permit 1-28-82  
 Approved 2 3-83  
 Dwelling \_\_\_\_\_  
 Garage \_\_\_\_\_  
 Alteration to building

NOTES

3-17-83 started work  
 4-15-83 work complete  
 some carpentry work  
 done - Do other requirements  
 for letter -

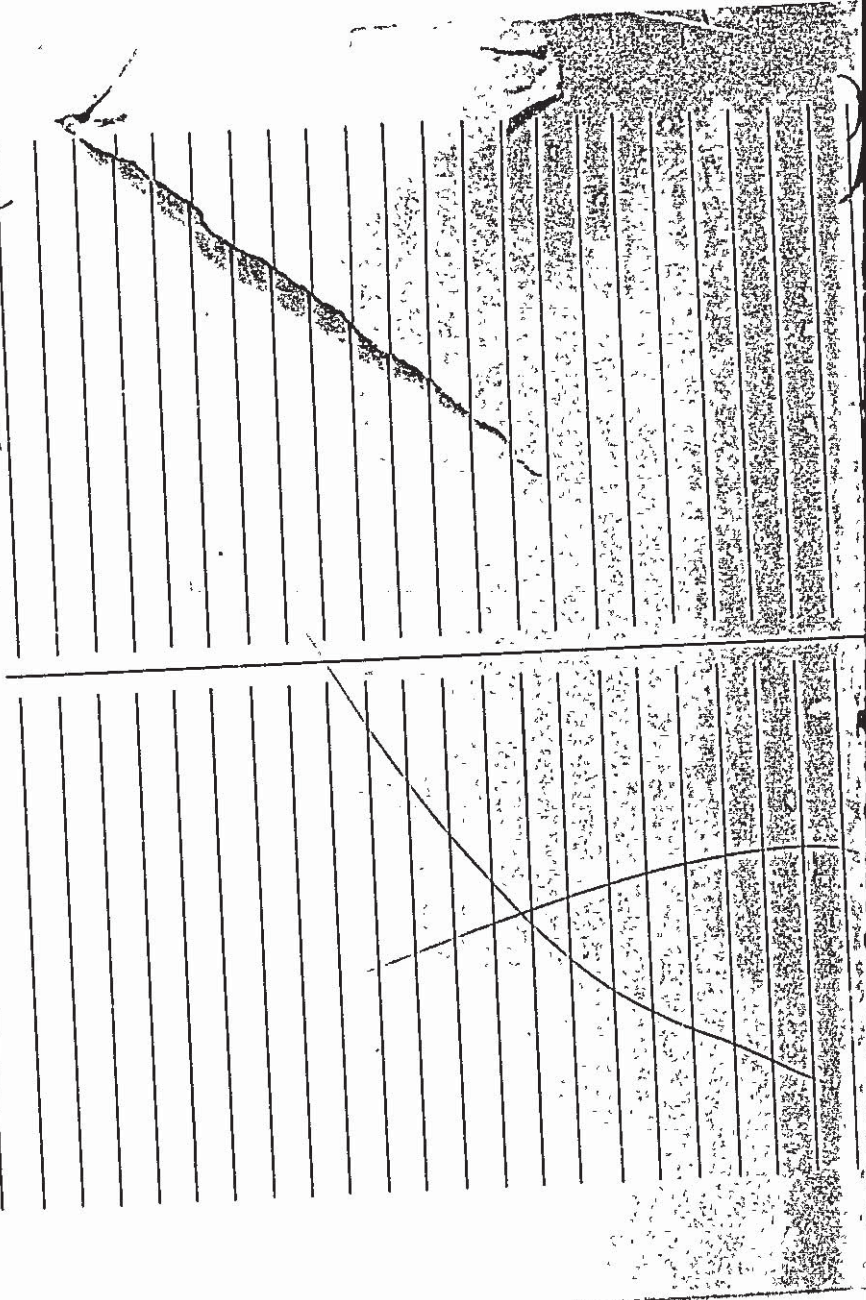



SPECIFICATION FOR  
MILLWORK

ALTERATIONS ON THE 10TH FLOOR  
PIERCE, ATWOOD, SCRIBNER, ALLEN, SMITH & LANCASTER  
ONE MONUMENT SQUARE, PORTLAND, MAINE

I. INFORMATION FOR BIDDERS

- A. Bid price shall be for a complete job, including all materials, fabrication, delivery, installation, and finishing. The successful Millwork Contractor will be assigned to the General Contractor as a sub-contractor and will be paid by the General Contractor and shall coordinate his work with the General Contractor. The bid is requested for Millwork as detailed on Sheets 2, 3, 4, and 5. Charges for materials, fabrication, delivery, and finishing shall be stated separately from charges for installation on the Form of Proposal and on the Requisitions for Payment. Maine State Sales Tax shall be separately itemized on the Form of Proposal and on the Requisition for Payment.

B. BID SUBMISSION

BID DATE.

Bids shall be submitted on stationery with the Bidder's business letterhead or on the enclosed Form of Proposal no later than the time scheduled, and addressed to:

"Pierce Atwood Scribner Allen Smith & Lancaster  
c/o WADSWORTH BOSTON MERCER & WEATHERILL  
201 Congress Building  
615 Congress Street  
Portland, ME 04101"

C. INQUIRIES

All questions concerning the work described herein shall be addressed to:

WADSWORTH BOSTON MERCER & WEATHERILL  
Telephone No. (207) 772-6554

D. TIME OF COMPLETION

The General Contractor and the Millwork Contractor shall discuss their schedules with the Owner and shall cooperate fully in order to complete the work in a timely fashion.

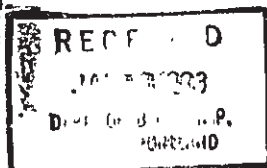

E. SCHEDULING

Work at the site which is noisy or which will interfere with the normal routine of the building shall be done at times other than 9:00 to 5:00 Monday through Friday.

F. DAMAGES

Any damage to existing work resulting from the operation of the Millwork Contractor shall be corrected as part of the work of this specification to the satisfaction of the Architect at no extra cost.

G. GUARANTEE

All work shall be guaranteed for one (1) year from the Time of Completion of the installation for faulty work or materials.

H. MEASUREMENTS

The Millwork Contractor shall be responsible for obtaining all necessary measurements at the site of the work.

I. CLEAN-UP

All tools, waste and excess materials shall be removed from the site and the premises left clean and ready for the work of other trades.

J. OWNER'S RESERVATION

The Owner reserves the right to accept or reject any or all bids, and is not necessarily bound to accept the low bidder.

K. BID OPENING

Bids will be opened in private. All bidders will be notified promptly upon selection of the successful bidder.

L. TITLE OF MATERIAL

Titles for all materials shall pass to the Owner immediately prior to installation.

M. COOPERATION WITH BUILDING

Millwork Contractor shall cooperate with the managers of the building in all regards, especially in the use of the loading dock and elevator, delivery of materials, work at odd hours and removal of debris.

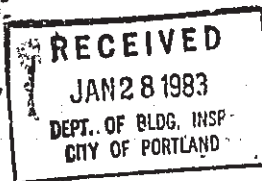

II. GENERAL

A. This specification covers fabrication, delivery, installation and finishing of new millwork.

B. NEW MILLWORK

Items of new millwork shall include but not necessarily be limited to, the following:

1. Door frame trim for opening 8A.
2. Trim at partition removals in Areas 5 and 6.
3. Work ledge and/or shelving in Areas 1, 2A, 2B, 3, 4A, 4B, and 5.
4. File top covers and ends outside offices 2A and 2B.
5. Rebuilding secretarial enclosure outside offices 4A and 4B, including new file top cover.
6. Base cupboard and shelving in Area 9A.
7. Clothes Peg Strips in various locations.
8. New adjustable shelf standards and brackets and changing length of shelves in Area 8.

C. GENERAL CONTRACT

The following items will be part of the General Construction Contract:

1. Wood doors and metal frames other than as listed above.
  2. Furnishing and installing resilient base.
- D. Quality of millwork generally shall meet the Architectural Woodwork Institute requirements for Premium Grade.
- E. Shop Drawings of all millwork items shall be submitted to and approved by the Architect before any fabrication is started.
- F. Samples as required shall be submitted to and approved by the Architect before any construction work is started.

III. MATERIALS

A. SHOW WOOD:

1. For all Areas except Mechanical Room 9A and Utility Room 8.
  - a. Solid Wood shall be mahogany to match that previously used on the 10th floor.
  - b. Plywood shall have face veneers of matching mahogany.



2. Mechanical Room 9A and Utility Room 8. Birch plywood and Birch solid wood as later specified. All wood shall have the same general depth of color. Light and dark wood together will not be acceptable.

B. TRIM shall have clearly defined contours, sharp edges, and be smooth and free of milling marks, accurately conforming to shapes as drawn and approved.

C. CONCEALED PLYWOOD shall be Baltic type multi-ply birch plywood, with interior plies of birch veneer, thickness as indicated.

D. PLASTIC LAMINATE shall be equal to Formica General Purpose Grade-10 pattern, color, pattern, and finish as indicated or as later selected.

E. SHELF HARDWARE:

1. Adjustable shelf hardware over work ledges and wall mounted in Mechanical Room 9A and Utility Room 8: Knap & Vogt #51 standards with #52 brackets, sized as indicated, bright nickel plate finish.

F. FINISHES:

1. All new millwork, except Secretarial Carrel and File Ends, shall receive 1 coat of Paste Filler (Mahogany only), 1 coat of wood stain, and 2 coats of 38 Clear Finish. Finish shall be satin on shelves and dull on other surfaces.

2. Insides of drawers shall have 2 coats 38 Clear Finish.

(38 Clear Finish is a Pratt & Lambert product)

3. Secretarial Carrel and Ends of file cabinets: natural wood shall be stained if necessary to achieve the desired color. 3 coats of transparent Hillyard "Trophy Seal" epoxy shall be applied to fill the grain followed by 2 coats of transparent Hillyard "Trophy Finish" epoxy, no-glare sheen. Application shall be in accordance with manufacturer's recommendations, including burnishing with steel wool between coats.

4. Wherever possible finishing shall be done "on-the-job" so that joints are properly made up, nail and screw holes properly filled before finishing, and the whole work presents a finished, workmanlike appearance.

5. Vinyl wall covering for file cabinet ends shall be purchased and applied as part of Millwork.

RECEIVED  
JAN 28 1983  
DEPT. OF BLDG. INSP.  
CITY OF PORTLAND

APPLICATION FOR PERMIT

PERMIT ISSUED

B.O.C.A. USE GROUP
B.O.C.A. TYPE OF CONSTRUCTION
ZONING LOCATION ... PORTLAND, MAINE

AUG 2 1984

CITY OF PORTLAND

To the CHIEF OF BUILDING & INSPECTION SERVICES, PORTLAND, MAINE

The undersigned hereby applies for a permit to erect, alter, repair, demolish, move or install the following building, structure, equipment or change use in accordance with the Laws of the State of Maine...

- 1. Owner's name and address
2. Lessee's name and address
3. Contractor's name and address

Proposed use of building
Last use
Material
Other buildings on same lot
Estimated contractual cost \$

FIELD INSPECTOR—Mr.
@ 775-5451
To make renovations, as per plans. Interior

Appeal Fees
Base Fee
Late Fee
TOTAL \$

Stamp of Special Conditions

ISSUE PERMIT TO #3

NOTE TO APPLICANT: Separate permits are required by the installers and subcontractors of heating, plumbing, electrical and mechanicals.

DETAILS OF NEW WORK

Is any plumbing involved in this work?
Is any electrical work involved in this work?
Is connection to be made to public sewer?
Has septic tank notice been sent?
Height average grade to top of plate
Size, front depth
Material of foundation
Kind of roof
No. of chimneys
Framing Lumber—Kind
Size Girder
Studs (outside walls and carrying partitions)
Joists and rafters
On centers
Maximum span

IF A GARAGE

No. cars now accommodated on same lot
Will automobile repairing be done other than minor repairs to cars habitually stored in the proposed building?

APPROVALS BY:
BUILDING INSPECTION—PLAN EXAMINER
ZONING:
BUILDING CODE:
Fire Dept.:
Health Dept.:
Others:

MISCELLANEOUS
Will work require disturbing of any tree on a public street?
Will there be in charge of the above work a person competent to see that the State and City requirements pertaining thereto are observed?

Signature of Applicant
Type Name of above

Other and Address

FIELD INSPECTOR'S COPY

APPLICANT'S COPY

OFFICE FILE COPY



# APPLICATION FOR PERMIT

**PERMIT ISSUED**  
SEP 12 1984  
**CITY OF PORTLAND**

B.O.C.A. USE GROUP .....  
B.O.C.A. TYPE OF CONSTRUCTION ..... 0112)  
ZONING LOCATION ..... PORTLAND, MAINE Sept. 7, 1984

To the CHIEF OF BUILDING & INSPECTION SERVICES, PORTLAND, MAINE

The undersigned hereby applies for a permit to erect, alter, repair, demolish, move or install the following building, structure, equipment or change use in accordance with the Laws of the State of Maine, the Portland B.O.C.A. Building Code and Zoning Ordinance of the City of Portland with plans and specifications, if any, submitted herewith and the following specifications:

LOCATION ..... Monument Sq. - 6th Floor (Casco Bank Bldg.) ..... Fire District #1 , #2

1. Owner's name and address ..... Salter Corp. - One Monument Sq., Portland, ..... Telephone 1-522-7511

2. Lessee's name and address ..... Salter Corp. - same ..... Telephone

3. Contractor's name and address ..... Salter Corp. - same ..... Telephone

Proposed use of building ..... offices ..... No. of sheets

Last use ..... same ..... No. families

Material ..... No. stories ..... Heat ..... Style of roof ..... Roofing

Other buildings on same lot ..... Appeal Fees \$

Estimated contractual cost \$ 1,500.00 ..... Base Fee

FIELD INSPECTOR—Mr. ..... @ 775-5451 ..... Late Fee

Renovations (erecting 11', non bearing, wall - goes from floor to bottom of slab) to secretary area and new door, 3' wide, 7' high for receptionist area, as per plan. TOTAL \$ 20.00

Stamp of Special Conditions

HOLD PERMIT FOR PICK-UP

**NOTE TO APPLICANT:** Separate permits are required by the installers and subcontractors of heating, plumbing, electrical and mechanicals.

**DETAILS OF NEW WORK**

Is any plumbing involved in this work?  no ..... Is any electrical work involved in this work?  yes

Is connection to be made to public sewer? ..... If not, what is proposed for sewage? .....

Has septic tank notice been sent? ..... Form notice sent? .....

Height average grade to top of plate ..... Height average grade to highest point of roof .....

Size, front ..... depth ..... No. stories ..... solid or filled land? ..... earth or rock? .....

Material of foundation ..... Thickness, top ..... bottom ..... cellar .....

Kind of roof ..... Rise per foot ..... Roof covering .....

No. of chimneys ..... Material of chimneys ..... of lining ..... Kind of heat ..... fuel .....

Framing Lumber—Kind ..... Dressed or full size? ..... Corner posts ..... Sills .....

Size Girder ..... Columns under girders ..... Size ..... Max. on centers .....

Studs (outside walls and carrying partitions) 2x4-16" O. C. Bridging in every floor and flat roof span over 8 feet.

Joists and rafters. 1st floor ..... 2nd ..... 3rd ..... roof .....

On centers: 1st floor ..... 2nd ..... 3rd ..... roof .....

Maximum span: 1st floor ..... 2nd ..... 3rd ..... roof .....

If one story building with masonry walls, thickness of walls? ..... height? .....

### IF A GARAGE

No. cars now accommodated on same lot ..... to be accommodated ..... number commercial cars to be accommodated .....

Will automobile repairing be done other than minor repairs to cars habitually stored in the proposed building? .....

**APPROVALS BY:**

BUILDING INSPECTION—PLAN EXAMINER ..... DATE

ZONING: .....

BUILDING CODE: .....

Fire Dept.: .....

Health Dept.: .....

Others: .....

**MISCELLANEOUS**

Will work require disturbing of any trees on a public street?  no

Will there be in charge of the above work a person competent to see that the State and City requirements pertaining thereto are observed?  yes

Signature of Applicant ..... Phone #

Type Name of above Gerard Bosse for for Salter Corp. 1  2  3  4

Other ..... and Address .....

FIELD INSPECTOR'S COPY

APPLICANT'S COPY

OFFICE FILE COPY

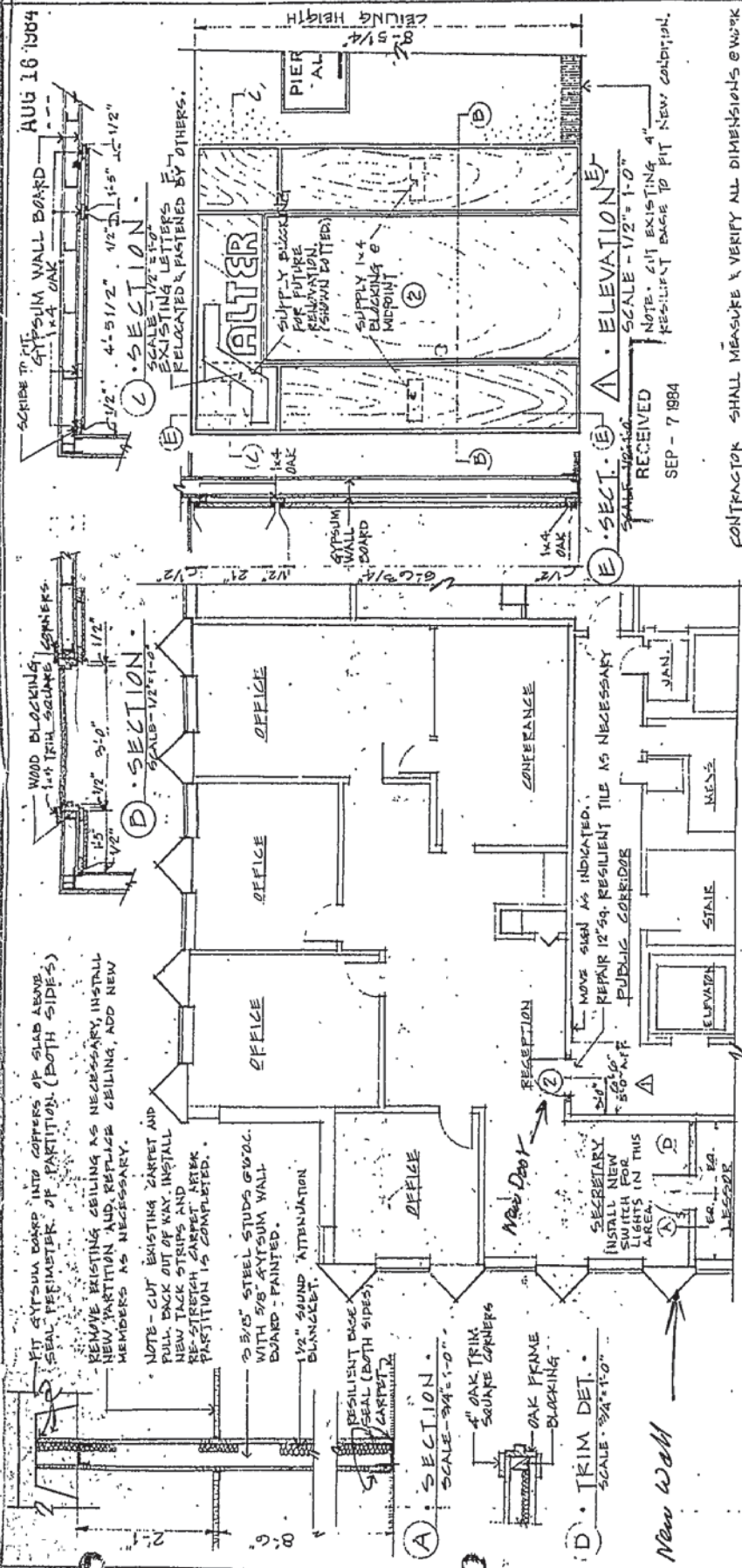

AUG 16 1984

SCHEMATIC TO FIT GYPSUM WALL BOARD 1/4" OAK

SCALE 1/2" = 1'-0"

SCALE 1/2" = 1'-0"

SCALE 1/2" = 1'-0"

SCALE 3/4" = 1'-0"

SCALE 1/2" = 1'-0"

SCALE 1/2" = 1'-0"

SCALE 1/2" = 1'-0"

SCALE 1/2" = 1'-0"

SCALE 1/2" = 1'-0"

SCALE 3/4" = 1'-0"

SCALE 1/2" = 1'-0"

SCALE 1/2" = 1'-0"

SCALE 1/2" = 1'-0"

SCALE 1/2" = 1'-0"

SCALE 1/2" = 1'-0"

SCALE 3/4" = 1'-0"

SCALE 1/2" = 1'-0"

SCALE 1/2" = 1'-0"

SCALE 1/2" = 1'-0"

SCALE 1/2" = 1'-0"

SCALE 1/2" = 1'-0"

SCALE 3/4" = 1'-0"

SCALE 1/2" = 1'-0"

SCALE 1/2" = 1'-0"

SCALE 1/2" = 1'-0"

SCALE 1/2" = 1'-0"

SCALE 1/2" = 1'-0"

SCALE 3/4" = 1'-0"

SCALE 1/2" = 1'-0"

SCALE 1/2" = 1'-0"

SCALE 1/2" = 1'-0"

SCALE 1/2" = 1'-0"

SCALE 1/2" = 1'-0"

SCALE 3/4" = 1'-0"

NOTE: CUT EXISTING CARPET AND PULL BACK OUT OF WAY. INSTALL NEW TACK STRIPS AND RE-STRIP CARPET. PARTITION IS COMPLETED.

NOTE: FIT GYPSUM BOARD INTO JOISTS OF SLAB ABOVE. SEAL PERIMETER OF PARTITION (BOTH SIDES). REMOVE EXISTING CEILING AS NECESSARY. INSTALL NEW PARTITION AND REPLACE CEILING. ADD NEW MEMBERS AS NECESSARY.

NOTE: 3/8" STEEL STUDS @ 24" ON CENTER WITH 5/8" GYPSUM WALL BOARD - PAINTED. 1/2" SOUND ATTENUATION BLANKET.

NOTE: RESILIENT BASE SEAL (BOTH SIDES). CARPET.

NOTE: 4" OAK TRIM SQUARE CORNERS. OAK FRAME BLOCKING.

NOTE: SECRETARY INSTALL NEW LIGHTS IN THIS AREA.

NOTE: MOVE SIGN AS INDICATED. REPAIR 12" SQ. RESILIENT TILE AS NECESSARY PUBLIC CORRIDOR.

NOTE: 1/2" PLYWOOD, FACE VENEERS. PLAN SLICED RED OAK. EDGE Banded WITH SOLID OAK TO MATCH.

NOTE: DOOR TO BE DETERMINED LATER.

NOTE: HARDWARE: DOOR #1 LOCKSET SARGENT 7 J150D 100 DEADLCK PRESENT 4876 40B (COUNDER ON LESSOR SIDE) 1/2 BUTTS #175 4 1/2 x 4 1/2 10A AUTOMATIC DOOR BOTTOM 60-5125-261 WEATHERSTRIP SET 10-8850

NOTE: CONTRACTOR SHALL MEASURE & VERIFY ALL DIMENSIONS @ WORK. ENTRANCE & DEMISING WALL DETAILS.

SALTER CORP.  
FLOOR OF ONE MONUMENT  
PORTLAND, MAINE  
1 WASHINGTON ST.  
HERSCHEL P. WATKINS  
ARCHITECTS - ENGINEERS  
615 "C" ST. PORTLAND  
PORTLAND, ME 04101

RECEIVED  
SEP - 7 1984

CONTRACTOR SHALL MEASURE & VERIFY ALL DIMENSIONS @ WORK.  
ENTRANCE & DEMISING WALL DETAILS.  
SALTER CORP.  
FLOOR OF ONE MONUMENT  
PORTLAND, MAINE  
1 WASHINGTON ST.  
HERSCHEL P. WATKINS  
ARCHITECTS - ENGINEERS  
615 "C" ST. PORTLAND  
PORTLAND, ME 04101

SCALE 1/2" = 1'-0"

SCALE 1/2" = 1'-0"

SCALE 1/2" = 1'-0"

SCALE 1/2" = 1'-0"

SCALE 1/2" = 1'-0"

SCALE 1/2" = 1'-0"

SCALE 1/2" = 1'-0"

SCALE 1/2" = 1'-0"

SCALE 1/2" = 1'-0"

SCALE 1/2" = 1'-0"

SCALE 3/4" = 1'-0"

SCALE 1/2" = 1'-0"

SCALE 1/2" = 1'-0"

SCALE 3/4" = 1'-0"

SCALE 1/2" = 1'-0"

SCALE 1/2" = 1'-0"

SCALE 1/2" = 1'-0"

SCALE 1/2" = 1'-0"

SCALE 1/2" = 1'-0"

SCALE 1/2" = 1'-0"

SCALE 1/2" = 1'-0"

SCALE 1/2" = 1'-0"

SCALE 1/2" = 1'-0"

SCALE 1/2" = 1'-0"

SCALE 3/4" = 1'-0"

SCALE 1/2" = 1'-0"

SCALE 1/2" = 1'-0"

SCALE 3/4" = 1'-0"

NOTES

01/14/85 WORK  
DONIE JOHNSON  
*[Signature]*

Permit No.

84/1121

Local n

1 Memorial Square

Owner

Casey Brooks

Date of permit

9-9-84

Approved

9-12-84

Discharge

Garage

Alteration

To Buildings



APPLICATION FOR PERMIT

B.O.C.A. USE GROUP .....
B.O.C.A. TYPE OF CONSTRUCTION ..... 01121
ZONING LOCATION ..... PORTLAND, MAINE Sept., 7., 1984.

PERMIT ISSUE

SEP 12 1984

CITY OF PORTLAND

To the CHIEF OF BUILDING & INSPECTION SERVICES, PORTLAND, MAINE

The undersigned hereby applies for a permit to erect, alter, repair, demolish, move or install the following building, structure, equipment or change use in accordance with the Laws of the State of Maine, the Portland B.O.C.A. Building Code and Zoning Ordinance of the City of Portland with plans and specifications, if any, submitted herewith and the following specifications:

- LOCATION ... 1. Monument Sq., 7. 6th Floor. (Casco Bank Bldg.) ... Fire District #1 [ ] #2 [ ]
1. Owner's name and address ... Telephone ...
2. Lessee's name and address Salter Corp., One Monument Sq., Portland, ... Telephone 1-622-7511.
3. Contractor's name and address Salter Corp., same ... Telephone ...

Proposed use of building ... offices ... No. families ...
Last use ... same ... No. families ...
Material ... No. stories ... Heat ... Style of roof ... Roofing ...
Other buildings on same lot ...
Estimated contractor's cost \$ 1,500.00 ...

FIELD INSPECTOR - Mr. ... @ 775-5451
Appeal Fees \$ ...
Base Fee ...
Late Fee ...

Renovations (erecting 11', non bearing, wall - goes from floor to bottom of slab) to secretary area and new door, 3' wide, 7' high for receptionist area, as per plan. TOTAL \$ 20.00

Stamp of Special Conditions

HOLD PERMIT FOR PICK-UP

NOTE TO APPLICANT: Separate permits are required by the installers and subcontractors of heating, plumbing, electrical and mechanicals.

DETAILS OF NEW WORK

Is any plumbing involved in this work? ... Is any electrical work involved in this work? ...
Is connection to be made to public sewer? ... If not, what is proposed for sewage? ...
Has septic tank notice been sent? ... Form notice sent? ...
Height average grade to top of plate ... Height average grade to highest point of roof ...
Size, front ... Depth ... No. stories ... solid or filled land? ... earth or rock? ...
Material of foundation ... Thickness, top ... bottom ... cellar ...
Kind of roof ... Rise per foot ... Roof covering ...
No. of chimneys ... Material of chimneys ... of lining ... Kind of heat ... fuel ...
Framing Lumber - Kind ... Dressed or full size? ... Corner posts ... Sills ...
Size Girder ... Columns under girders ... Size ... Max on centers ...
Studs (outside walls and carrying partitions) 2x4-16" O. C. Bridging in every floor and flat roof span over 8 feet.
Joists and rafters: 1st floor ... 2nd ... 3rd ... roof ...
On centers: 1st floor ... 2nd ... 3rd ... roof ...
Maximum span: 1st floor ... 2nd ... 3rd ... roof ...
If one story building with masonry walls, thickness of walls? ... height? ...

IF A GARAGE

No. cars now accommodated on same lot ... to be accommodated ... number commercial cars to be accommodated ...
Will automobile repairing be done other than minor repairs to cars habitually stored in the proposed building? ...

APPROVALS BY: DATE MISCELLANEOUS
BUILDING INSPECTION - PLAN EXAMINER ... Will work require disturbing of any tree on a public street? ... NO.
ZONING:
BUILDING CODE:
Fire Dept.: James J. ... Will there be in charge of the above work a person competent to see that the State and City requirements pertaining thereto are observed? yes, ...
Health Dept.:
Others:

Signature of Applicant Gerard Bosse Phone #
Type Name of: above Gerard Bosse for for Salter Corp. 1 [ ] 2 [ ] 3 [ ] 4 [ ]
Other
and Address

FIELD INSPECTOR'S COPY APPLICANT'S COPY OFFICE FILE COPY

Handwritten signature: M.A. ...



B3 BUSINESS ZONE

APPLICATION FOR PERMIT

Class of Building or Type of Structure Installation
Portland, Maine, August 21, 1969

PERMIT ISSUED 832
AUG 28 1969
CITY OF PORTLAND

To the INSPECTOR OF BUILDINGS, PORTLAND, MAINE

The undersigned hereby applies for a permit to erect alter repair demolish install the following building structure equipment in accordance with the Laws of the State of Maine, the Building Code and Zoning Ordinance of the City of Portland, plans and specifications, if any, submitted herewith and the following specifications:

Location 5 Monument Square
Owner's name and address Casco Bank & Trust Company, 475 Congress St.
Contractor's name and address The Mahaney Company, 3 High St., Biddeford St.
Proposed use of building Bank Building
Estimated cost \$ Fee \$ 5.00

General Description of New Work

To install ventilation and air-conditioning system for entire building as per plans on file.

It is understood that this permit does not include installation of heating apparatus which is to be taken out separately by and in the name of the heating contractor. PERMIT TO BE ISSUED TO contractors

Details of New Work

Is any plumbing involved in this work? Is any electrical work involved in this work?
Height average grade to top of plate Height average grade to highest point of roof
Material of foundation Thickness, top bottom cellar
Kind of roof Rise per foot Roof covering
No. of chimneys Material of chimneys of lining Kind of heat fuel
Studs (outside walls and carrying partitions) 2x4-16" O. C. Bridging in every floor and flat roof span over 8 feet.

If a Garage

No. cars now accommodated on same lot, to be accommodated number commercial cars to be accommodated.
Will automobile repairing be done other than minor repairs to cars habitually stored in the proposed building?

APPROVED:

OK - RLD - 8/28/69 w/letter

Miscellaneous

Will work require disturbing of any tree on a public street? no
Will there be in charge of the above work a person competent to see that the State and City requirements pertaining thereto are observed? yes

The Mahaney Company

INSPECTION COPY

Signature of owner by:

The Mahaney Co.
R. P. Ross

ym

NOTES

8-7-70 About all in  
Fire dampers OK  
PP

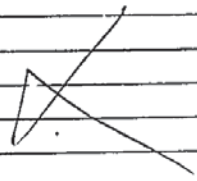

Permit No. 691837  
 Location 5th Avenue  
 Owner Quaco Building Co  
 Date of permit 8/28/69  
 Notif. closing-in  
 Inspn. closing-in  
 Final Notif.  
 Final Inspn.  
 Cert. of Occupancy Issued  
 Staking Out Notice  
 Form Check Notice



B3 BUSINESS ZONE

# APPLICATION FOR PERMIT

Class of Building or Type of Structure Second Class

Portland, Maine, April 7, 1969

PERMIT ISSUED  
295

APR 7 1969

CITY OF PORTLAND

To the INSPECTOR OF BUILDINGS, PORTLAND, MAINE

The undersigned hereby applies for a permit to erect alter repair demolish install the following building structure equipment in accordance with the Laws of the State of Maine, the Building Code and Zoning Ordinance of the City of Portland, plans and specifications, if any, submitted herewith and the following specifications:

Location 1-5 Monument Square Within Fire Limits? \_\_\_\_\_ Dist. No. \_\_\_\_\_  
 Owner's name and address Casco Bank & Trust Company, 477 Congress St. Telephone \_\_\_\_\_  
 Lessee's name and address \_\_\_\_\_ Telephone \_\_\_\_\_  
 Contractor's name and address Consolidated Constructors Inc. 616 Congress St. Telephone 774-2626  
 Architect \_\_\_\_\_ and Builders \_\_\_\_\_ Telephone \_\_\_\_\_  
 Proposed use of building Office Building Specifications yes Plans yes No. of sheets \_\_\_\_\_  
 Last use \_\_\_\_\_ No. families \_\_\_\_\_  
 Material 2nd. class No. stories 10 Heat \_\_\_\_\_ Style of roof \_\_\_\_\_ Roofing \_\_\_\_\_  
 Other buildings on same lot \_\_\_\_\_  
 Estimated cost \$ 3,100,000 Fee \$ 6200.00

### General Description of New Work

To construct 10-story reinforced concrete block office building 118'8" square as per plans and specifications.

It is understood that this permit does not include installation of heating apparatus which is to be taken out separately by and in the name of the heating contractor. **PERMIT TO BE ISSUED TO** \_\_\_\_\_ contractors

### Details of New Work

Is any plumbing involved in this work? \_\_\_\_\_ Is any electrical work involved in this work? \_\_\_\_\_  
 Is connection to be made to public sewer? \_\_\_\_\_ If not, what is proposed for sewage? \_\_\_\_\_  
 Has septic tank notice been sent? \_\_\_\_\_ Form notice sent? yes  
 Height average grade to top of plate \_\_\_\_\_ Height average grade to highest point of roof \_\_\_\_\_  
 Size, front \_\_\_\_\_ depth \_\_\_\_\_ No. stories \_\_\_\_\_ solid or filled land? \_\_\_\_\_ earth or rock? \_\_\_\_\_  
 Material of foundation \_\_\_\_\_ Thickness, top \_\_\_\_\_ bottom \_\_\_\_\_ cellar \_\_\_\_\_  
 Kind of roof \_\_\_\_\_ Rise per foot \_\_\_\_\_ Roof covering \_\_\_\_\_  
 No. of chimneys \_\_\_\_\_ Material of chimneys \_\_\_\_\_ of lining \_\_\_\_\_ Kind of heat \_\_\_\_\_ fuel \_\_\_\_\_  
 Framing Lumber—Kind \_\_\_\_\_ Dressed or full size? \_\_\_\_\_ Corner posts \_\_\_\_\_ Sills \_\_\_\_\_  
 Size Girder \_\_\_\_\_ Columns under girders \_\_\_\_\_ Size \_\_\_\_\_ Max. on centers \_\_\_\_\_  
 Studs (outside walls and carrying partitions) 2x4-16" O. C. Bridging in every floor and flat roof span over 8 feet.  
 Joists and rafters: 1st floor \_\_\_\_\_, 2nd \_\_\_\_\_, 3rd \_\_\_\_\_, roof \_\_\_\_\_  
 On centers: 1st floor \_\_\_\_\_, 2nd \_\_\_\_\_, 3rd \_\_\_\_\_, roof \_\_\_\_\_  
 Maximum span: 1st floor \_\_\_\_\_, 2nd \_\_\_\_\_, 3rd \_\_\_\_\_, roof \_\_\_\_\_  
 If one story building with masonry walls, thickness of walls? \_\_\_\_\_ height? \_\_\_\_\_

### If a Garage

No. cars now accommodated on same lot \_\_\_\_\_, to be accommodated \_\_\_\_\_ number commercial cars to be accommodated \_\_\_\_\_  
Will automobile repairing be done other than minor repairs to cars habitually stored in the proposed building? \_\_\_\_\_

APPROVED:  
\_\_\_\_\_  
\_\_\_\_\_  
\_\_\_\_\_

### Miscellaneous

Will work require disturbing of any tree on a public street? no  
Will there be in charge of the above work a person competent to see that the State and City requirements pertaining thereto are observed? yes

Casco Bank & Trust Company  
Consolidated Constructors Inc.  
and Builders

INSPECTION COPY. Signature of owner by: \_\_\_\_\_

Henry D. Fuller

J.M.

NOTES

5-19-69 ledge about  
all removed. starting  
some footings - to  
drill thru footing  
& pit into ledge PA

6-12-69 Footing about  
all in. Walls started.  
ready for grade beam PA

6-23-69 Grade beams  
completed according  
to revised founda-  
tion plans PA

8-28-69 Floors 2 & 3  
about done.

8-7-70 Bldg about  
completed. exterior PA

Working final stages  
machine room in  
penthouse PA

Exit lights:

" "

" "

Done

Owner: W. H. ...  
 Date of permit: 7/17/69  
 Notif. closing-in:  
 Inspr. closing-in:  
 Final Notif.:  
 Final Inspr.:  
 Cert. of Occupancy issued:  
 Staking, Util. Notices:  
 Form Check Notice:

8-28-69  
steel-sloppy  
concrete. extra:

8-7-70  
Bank charges 1 to 5th  
Floor not covered  
by amendment. PA

C.L.  
NEW CASCO BANK

NEW CASCO BANK

Feb. 28, 1969

The Building Code allows this building of First Class Const. to have a maximum height of 155 feet. To the very top of this building it is only 142'2". The Zoning Code allows in the B-3 Business Zone, in which this building is to be located, 125' or 10 stories which this building is for non-residential use (602.10C.6). The Building Code will allow above the maximum height also an enclosure for elevators, elevator machinery, stairways or similar construction above the main roof of the building. Sec. 701.3b of the Building Code allows a building of First Class Construction to exceed the height of 155 feet if it has an upper section whose area is not greater than  $\frac{1}{4}$  of that of the lower section measured at a height of 125 feet. Therefore, this allowance allowed under the Building Code, we also allow an interpretation under the Zoning Ordinance. The Zoning Code allows 10 stories - this building has 10 stories with allowance. Allan --



B3 BUSINESS ZONE

# APPLICATION FOR PERMIT

Class of Building or Type of Structure Second Class  
Portland, Maine, Sept. 16, 1965

PERMIT ISSUED  
SEP 17 1965

OFFICE OF THE CITY CLERK

To the INSPECTOR OF BUILDINGS, PORTLAND, MAINE

The undersigned hereby applies for a permit to erect alter repair demolish install the following building structure equipment in accordance with the Laws of the State of Maine, the Building Code and Zoning Ordinance of the City of Portland, plans and specifications, if any, submitted herewith and the following specifications:

Location 1-5 Monument Square Within Fire Limits? \_\_\_\_\_ Dist. No. \_\_\_\_\_  
 Owner's name and address Exchange Corporation, 475 Congress St. Telephone \_\_\_\_\_  
 Lessee's name and address \_\_\_\_\_ Telephone \_\_\_\_\_  
 Contractor's name and address Benjamin Wrecking Co. 99 Main St. So. Portland Telephone \_\_\_\_\_  
 Architect \_\_\_\_\_ Specifications \_\_\_\_\_ Plans \_\_\_\_\_ No. of sheets \_\_\_\_\_  
 Proposed use of building \_\_\_\_\_ No. families \_\_\_\_\_  
 Last use Wholesale Hardware Building No. families \_\_\_\_\_  
 Material brick No. stories 5 Heat \_\_\_\_\_ Style of roof \_\_\_\_\_ Roofing \_\_\_\_\_  
 Other buildings on same lot \_\_\_\_\_  
 Estimated cost \$ \_\_\_\_\_ Fee \$ 5.00

### General Description of New Work

To demolish existing 5-story brick building.

Do you agree to tightly and permanently close all dweers or drains connecting with public or private sewers from this building or structure to be demolished, under the supervision and to the approval of the Dept. of Public Works of the City of Portland? Yes.

Land to be used possibly for new construction.

It is understood that this permit does not include installation of heating apparatus which is to be taken out separately by and in the name of the heating contractor. - PERMIT TO BE ISSUED TO contractor

### Details of New Work

Is any plumbing involved in this work? \_\_\_\_\_ Is any electrical work involved in this work? \_\_\_\_\_  
 Is connection to be made to public sewer? \_\_\_\_\_ If not, what is proposed for sewage? \_\_\_\_\_  
 Has septic tank notice been sent? \_\_\_\_\_ Form notice sent? \_\_\_\_\_  
 Height average grade to top of plat \_\_\_\_\_ Height average grade to highest point of roof \_\_\_\_\_  
 Size, front \_\_\_\_\_ depth \_\_\_\_\_ No. stories \_\_\_\_\_ solid or filled land? \_\_\_\_\_ earth or rock? \_\_\_\_\_  
 Material of foundation \_\_\_\_\_ Thickness, top \_\_\_\_\_ bottom \_\_\_\_\_ cellar \_\_\_\_\_  
 Material of underpinning \_\_\_\_\_ Height \_\_\_\_\_ Thickness \_\_\_\_\_  
 Kind of roof \_\_\_\_\_ Rise per foot \_\_\_\_\_ Roof covering \_\_\_\_\_  
 No. of chimneys \_\_\_\_\_ Material of chimneys \_\_\_\_\_ of lining \_\_\_\_\_ Kind of heat \_\_\_\_\_ fuel \_\_\_\_\_  
 Framing Lumber-Kind \_\_\_\_\_ Dressed or full size? \_\_\_\_\_ Corner posts \_\_\_\_\_ Sills \_\_\_\_\_  
 Size Girder \_\_\_\_\_ Column under girders \_\_\_\_\_ Size \_\_\_\_\_ Max. on centers \_\_\_\_\_  
 Kind and thickness of outside sheathing of exterior walls? \_\_\_\_\_  
 Studs (outside walls and carrying partitions) 2x4-16" O. C. Bridging in every floor and flat roof span over 8 feet.  
 Joists and rafters: 1st floor \_\_\_\_\_, 2nd \_\_\_\_\_, 3rd \_\_\_\_\_, roof \_\_\_\_\_  
 On centers: 1st floor \_\_\_\_\_, 2nd \_\_\_\_\_, 3rd \_\_\_\_\_, roof \_\_\_\_\_  
 Maximum span: 1st floor \_\_\_\_\_, 2nd \_\_\_\_\_, 3rd \_\_\_\_\_, roof \_\_\_\_\_  
 If one story building with masonry walls, thickness of walls? \_\_\_\_\_ height? \_\_\_\_\_

### If a Garage

No. cars now accommodated on same lot \_\_\_\_\_, to be accommodated \_\_\_\_\_ number commercial cars to be accommodated \_\_\_\_\_  
Will automobile repairing be done other than minor repairs to cars habitually stored in the proposed building? \_\_\_\_\_

APPROVED:  
OK-9/17/65-ags  
 \_\_\_\_\_  
 \_\_\_\_\_

### Miscellaneous

Will work require disturbing of any tree on a public street? no  
 Will there be in charge of the above work a person competent to see that the State and City requirements pertaining thereto are observed? yes

Exchange Corporation  
Benjamin Wrecking Company

Signature of owner by: Marjorie Benjamin MB

INSPECTION COPY

NOTES

1-10-66 Insides all  
down

2-2-66 About 3/4  
down

5-4-66 Complete



Permit No. 657915  
 Location 5. Hammond, Missouri  
 Owner: Blanche DeKorsten  
 Date of permit 9/27/65  
 Notif. closing-in  
 Inspn. closing-in  
 Final Notif.  
 Final Inspn.  
 Cert. of Occupancy issued  
 Staking Out Notice  
 Form Check Notice





**APPLICATION FOR PERMIT**  
**DEPARTMENT OF BUILDING INSPECTIONS SERVICES**  
**ELECTRICAL INSTALLATIONS**

*filmed*

Date Jan. 26, 19 84  
 Receipt and Permit number B 19847

To the CHIEF ELECTRICAL INSPECTOR, Portland, Maine:

The undersigned hereby applies for a permit to make electrical installations in accordance with the laws of Maine, the Portland Electrical Ordinance, the National Electrical Code and the following specifications:

LOCATION OF WORK: 1 Monument Square - 7th Floor - Bernstein, Shur & Nelson & Sawyer

OWNER'S NAME: B & D Builders ADDRESS: 105 Winn Rd. Falmouth

OUTLETS: Receptacles \_\_\_\_\_ Switches \_\_\_\_\_ Plugmold \_\_\_\_\_ ft. TOTAL 31-60 ..... 5.00

FIXTURES: (number of) Incandescent \_\_\_\_\_ Fluorescent \_\_\_\_\_ (not strip) TOTAL \_\_\_\_\_  
 Strip Fluorescent \_\_\_\_\_ ft. ....

SERVICES: Overhead \_\_\_\_\_ Underground \_\_\_\_\_ Temporary \_\_\_\_\_ TOTAL amperes \_\_\_\_\_

METERS: (number of) \_\_\_\_\_

MOTORS: (number of) Fractional \_\_\_\_\_  
 1 HP or over \_\_\_\_\_

RESIDENTIAL HEATING: Oil or Gas (number of units) \_\_\_\_\_  
 Electric (number of rooms) \_\_\_\_\_

COMMERCIAL OR INDUSTRIAL HEATING: Oil or Gas (by a main boiler) \_\_\_\_\_  
 Oil or Gas (by separate units) \_\_\_\_\_  
 Electric Under 20 kws \_\_\_\_\_ Over 20 kws \_\_\_\_\_

APPLIANCES: (number of) Ranges \_\_\_\_\_ Water Heaters \_\_\_\_\_  
 Cook Tops \_\_\_\_\_ Disposals \_\_\_\_\_  
 Wall Ovens \_\_\_\_\_ Dishwashers \_\_\_\_\_  
 Dryers \_\_\_\_\_ Compactors \_\_\_\_\_  
 Fans \_\_\_\_\_ Others (denote) \_\_\_\_\_

TOTAL \_\_\_\_\_

MISCELLANEOUS: (number of) Branch Panels \_\_\_\_\_  
 Transformers \_\_\_\_\_  
 Air Conditioners Central Unit \_\_\_\_\_  
 Separate Units (windows) \_\_\_\_\_  
 Signs 20 sq. ft. and under \_\_\_\_\_  
 Over 20 sq. ft. \_\_\_\_\_  
 Swimming Pools Above Ground \_\_\_\_\_  
 In Ground \_\_\_\_\_  
 Fire/Burglar Alarms Residential \_\_\_\_\_  
 Commercial \_\_\_\_\_  
 Heavy Duty Outlets, 220 Volt (such as welders) 30 amps and under \_\_\_\_\_  
 over 30 amps \_\_\_\_\_  
 Circus, Fairs, etc. \_\_\_\_\_  
 Alterations to wires \_\_\_\_\_  
 Repairs after fire \_\_\_\_\_  
 Emergency Lights, battery \_\_\_\_\_  
 Emergency Generators \_\_\_\_\_

INSTALLATION FEE DUE: \_\_\_\_\_

FOR ADDITIONAL WORK NOT ON ORIGINAL PERMIT ..... DOUBLE FEE DUE: \_\_\_\_\_

FOR REMOVAL OF A "STOP ORDER" (304-16.b) ..... 5.00

TOTAL AMOUNT DUE: \_\_\_\_\_

INSPECTION: Will be ready on \_\_\_\_\_, 19 \_\_\_\_\_ or Will Call \_\_\_\_\_

CONTRACTOR'S NAME: Mancini Electy

ADDRESS: 179 Sheridan St.

TEL: \_\_\_\_\_

MASTER LICENSE NO.: on file SIGNATURE OF CONTRACTOR: Giulio Mancini

LIMITED LICENSE NO.: \_\_\_\_\_

INSPECTOR'S COPY — WHITE  
 OFFICE COPY — CANARY  
 CONTRACTOR'S COPY — GREEN



APPLICATION FOR PERMIT

PERMIT ISSUED

B.O.C.A. USE GROUP ..... B.O.C.A. TYPE OF CONSTRUCTION 0099

FEB 8 1984

ZONING LOCATION ..... PORTLAND, MAINE Jan. 16, 1984

CITY OF PORTLAND

To the CHIEF OF BUILDING & INSPECTION SERVICES, PORTLAND, MAINE

The undersigned hereby applies for a permit to erect, alter, repair, demolish, move or install the following building, structure, equipment or change use in accordance with the Laws of the State of Maine, the Portland B.O.C.A. Building Code and Zoning Ordinance of the City of Portland with plans and specifications, if any, submitted herewith and the following specifications:

LOCATION 1 Monument Square - 7th floor
1. Owner's name and address Finard Corp. - Boston, Mass.
2. Lessee's name and address Bernstein, Shur, Sawyer & Nelson
3. Contractor's name and address B. & D. Builders - 108 Winn Rd., Falmouth, Me.
Proposed use of building attorneys office
Last use same
Material No stones Heat Style of roof Roofing
Other buildings on same lot
Estimated contractual cost \$ 35,000
FIELD INSPECTOR - Mr (P) 775-5451
Appeal Fees \$
Base Fee 185.00
Late Fee
TOTAL \$ 185.00

To make alterations to existing offices as per plans, no structural changes. 2 sheets of plans. Stamp of Special Conditions removing and relocating partitions to make additional space.

send permit to # 3 04105

NOTE TO APPLICANT: Separate permits are required by the installers and subcontractors of heating, plumbing, electrical and mechanicals.

DETAILS OF NEW WORK

Is any plumbing involved in this work? Is any electrical work involved in this work? yes
Is connection to be made to public sewer? If not, what is proposed for sewage?
Has septic tank notice been sent? Form notice sent?
Height average grade to top of plate Height average grade to highest point of roof
Size, front depth No. stories solid or filled land? earth or rock?
Material of foundation Thickness, top bottom cellar
Kind of roof Rise per foot Roof covering
No. of chimneys Material of chimneys of lining Kind of heat fuel
Framing Lumber--Kind Gassed or full size? Corner posts Sills
Size Girder Columns under girders Size Max. on centers
Studs (outside walls and carrying partitions) 2x4-16" O. C. Bridging in every floor and flat roof span over 8 feet.
Joists and rafters: 1st floor 2nd 3rd roof
On centers: 1st floor 2nd 3rd roof
Maximum span: 1st floor 2nd 3rd roof
If one story building with masonry walls, thickness of walls? height?

IF A GARAGE

No. cars now accommodated on same lot to be accommodated number commercial cars to be accommodated
Will automobile repairing be done other than minor repairs to cars habitually stored in the proposed building?

APPROVALS BY: DATE
BUILDING INSPECTION-PLAN EXAMINER
ZONING:
BUILDING CODE:
Fire Dept.:
Health Dept.:
Others:

MISCELLANEOUS
Will work require disturbing of any tree on a public street? no
Will there be in charge of the above work a person competent to see that the State and City requirements pertaining thereto are observed? yes

Signature of Applicant William J. Di Biasi Phone # same
Type Name of above William Di Biasi for B. & D. Builders 1 2 3 4
Other and Address

FIELD INSPECTOR'S COPY APPLICANT'S COPY OFFICE FILE COPY

M.A. Nugent

Permit No. 84/0099  
Location 19 M...  
Owner ...  
Date of permit 1-16-84  
Approved 2-8-84  
Dwelling  
Garage  
Alteration to office

NOTES  
0000

3/6/84 NEEDS ONE  
ILLUMINATED EXIT  
5/6/84 WITH RECHECK  
3/9/84  
3/20/84  
Ward ...  
P. ...



APPLICATION FOR PERMIT

PERMIT ISSUED

B.O.C.A. USE GROUP ... B.O.C.A. TYPE OF CONSTRUCTION ... ZONING LOCATION ... PORTLAND, MAINE ... FEB 8 1984

To the CHIEF OF BUILDING & INSPECTION SERVICES, PORTLAND, MAINE
The undersigned hereby applies for a permit to erect, alter, repair, demolish, move or install the following building, structure, equipment: or change use in accordance with the Laws of the State of Maine, the Portland B O C.A. Building Code and Zoning Ordinance of the City of Portland with plans and specifications, if any, submitted herewith and the following specifications:
LOCATION ... 1. Monument Square ... 7th floor ... Fire District #1 [ ] #2 [ ]
1. Owner's name and address ... Finard Corp. - Boston, Mass. ... Telephone ...
2. Lessee's name and address ... Bernstein, Shur, Sawyer & Nelson ... Telephone ...
3. Contractor's name and address ... B. & D. Builders - 108 Winn Rd. Falmouth ... Telephone 797-3665 ...
Proposed use of building ... attorneys office ... No. of sheets ...
Last use ... same ... No. families ...
Material ... No. stories ... Heat ... Style of roof ... Roofing ...
Other buildings on same lot ...
Estimated contractual cost \$ ... 35,000 ... Appeal Fees \$ ...
FIELD INSPECTOR—Mr. ... @ 775-5451 ... Bate Fee ... 185.00 ...
Late Fee ...
TOTAL \$ ... 185.00 ...

To make alterations to existing offices as per plans, no structural changes. 2 sheets of plans. Stamp of Special Conditions removing and relocating partitions to make additional space.

and permit to # 3 04105

NOTE TO APPLICANT: Separate permits are required by the installers and subcontractors of heating, plumbing, electrical and mechanicals.

DETAILS OF NEW WORK

Is any plumbing involved in this work? ... Is any electrical work involved in this work? ... yes
Is connection to be made to public sewer? ... If not, what is proposed for sewage? ...
Has septic tank notice been sent? ... Form notice sent? ...
Height average grade to top of plate ... Height average grade to highest point of roof ...
Size, front ... depth ... No. stories ... solid or filled land? ... earth or rock? ...
Material of foundation ... Thickness, top ... bottom ... cellar ...
Kind of roof ... Rise per foot ... Roof covering ...
No. of chimneys ... Material of chimneys ... of lining ... Kind of heat ... fuel ...
Framing Lumber—Kind ... Dressed or full size? ... Corner posts ... Sills ...
Size Girder ... Columns under girders ... Size ... Max. on centers ...
Studs (outside walls and carrying partitions) 2x4-16" O. C. Bridging in every floor and flat roof of span over 8 feet.
Joists and rafters: 1st floor ... 2nd ... 3rd ... roof ...
On centers: 1st floor ... 2nd ... 3rd ... roof ...
Maximum span: 1st floor ... 2nd ... 3rd ... roof ...
If one story building with masonry walls, thickness of walls? ... height? ...

IF A GARAGE

No. cars now accommodated on same lot ... to be accommodated ... number commercial cars to be accommodated ...
Will automobile repairing be done other than minor repairs to cars habitually stored in the proposed building? ...

APPROVALS BY: DATE MISCELLANEOUS
BUILDING INSPECTION—PLAN EXAMINER ... Will work require disturbing of any tree on a public street? ... no
ZONING: ... Will there be in charge of the above work a person competent
BUILDING CODE: ... to see that the State and City requirements pertaining thereto
Fire Dept.: ... are observed? ... yes
Health Dept.: ...
Others: ...

Signature of Applicant ... Phone # ...

Type Name of above ... William Disbrow for B & D Bldrs. ... 1 [ ] 2 [ ] 3 [ ] 4 [ ]

Other ... and Address ...

10

FIELD INSPECTOR'S COPY

APPLICANT'S COPY

OFFICE FILE COPY



**APPLICATION FOR PERMIT**  
 DEPARTMENT OF BUILDING INSPECTIONS SERVICES  
 ELECTRICAL INSTALLATIONS

Date Feb. 2, 19 83  
 Receipt and Permit number A-92597

To the CHIEF ELECTRICAL INSPECTOR, Portland, Maine:  
 The undersigned hereby applies for a permit to make electrical installations in accordance with the laws of  
 Maine, the Portland Electrical Ordinance, the National Electrical Code and the following specifications:

LOCATION OF WORK: 1 Monument Square - 10th floor  
 OWNER'S NAME: Pierce, Atwood ADDRESS: same

<b>OUTLETS:</b>	Receptacles <u>10</u>	Switches _____	Plugmold _____	ft. TOTAL <u>190</u>	<b>FEE</b>
<b>FIXTURES:</b> (number of)	Incandescent _____	Flourescent _____	(not strip) TOTAL _____		<u>3.00</u>
	Strip Flourescent _____	ft. _____			
<b>SERVICES:</b>	Overhead _____	Underground _____	Temporary _____	TOTAL amperes _____	
<b>METERS:</b> (number of)	_____				
<b>MOTORS:</b> (number of)	_____				
	Fractional _____	_____			
	1 HP or over _____	_____			
<b>RESIDENTIAL HEATING:</b>	_____				
	Oil or Gas (number of units) _____	_____			
	Electric (number of rooms) _____	_____			
<b>COMMERCIAL OR INDUSTRIAL HEATING:</b>	_____				
	Oil or Gas (by a main boiler) _____	_____			
	Oil or Gas (by separate units) _____	_____			
	Electric Under 20 kws _____	Over 20 kws _____	_____		
<b>APPLIANCES:</b> (number of)	_____				
	Ranges _____	Water Heaters _____	_____		
	Cook Tops _____	Disposals _____	_____		
	Wall Ovens _____	Dishwashers _____	_____		
	Dryers _____	Compactors _____	_____		
	Fans _____	Others (denote) _____	_____		
	TOTAL _____	_____			
<b>MISCELLANEOUS:</b> (number of)	_____				
	Branch Panels _____	_____			
	Transformers _____	_____			
	Air Conditioners Central Unit _____	_____			
	Separate Units (windows) _____	_____			
	Signs 20 sq. ft. and under _____	_____			
	Over 20 sq. ft. _____	_____			
	Swimming Pools Above Ground _____	_____			
	In Ground _____	_____			
	Fire/Burglar Alarms Residential _____	_____			
	Commercial _____	_____			
	Heavy Duty Outlets, 220 Volt (such as welders) 30 amps and under _____	_____			
	over 30 amps _____	_____			
	Circus, Fairs, etc. _____	_____			
	Alterations to wires _____	_____			
	Repairs after fire _____	_____			
	Emergency Lights, battery _____	_____			
	Emergency Generators _____	_____			
	FOR ADDITIONAL WORK NOT ON ORIGINAL PERMIT _____	INSTALLATION FEE DUE: _____			
	FOR REMOVAL OF A "STOP ORDER" (304-16.b) _____	DOUBLE FEE DUE: _____			
		TOTAL AMOUNT DUE: <u>3.00</u>			

**INSPECTION:**  
 Will be ready on \_\_\_\_\_, 19\_\_\_\_; or Will Call xx  
**CONTRACTOR'S NAME:** Energy Electric  
**ADDRESS:** DessertPine, Freeport  
**TEL.:** \_\_\_\_\_  
**MASTER LICENSE NO.:** 03270 **SIGNATURE OF CONTRACTOR:** [Signature]  
**TESTED LICENSE NO.:** \_\_\_\_\_

INSPECTOR'S COPY — WHITE  
 OFFICE COPY — CANARY  
 CONTRACTOR'S COPY — GREEN





**APPLICATION FOR PERMIT**  
 DEPARTMENT OF BUILDING INSPECTIONS SERVICES  
 ELECTRICAL INSTALLATIONS

Date May 11 19 83  
 Receipt and Permit number B-09908

To the CHIEF ELECTRICAL INSPECTOR, Portland, Maine:  
 The undersigned hereby applies for a permit to make electrical installations in accordance with the laws of  
 Maine, the Portland Electrical Ordinance, the National Electrical Code and the following specifications:  
 LOCATION OF WORK: 1 Monument Square - Casco Bank & Trust  
 OWNER'S NAME: \_\_\_\_\_ ADDRESS: \_\_\_\_\_

OUTLETS: Receptacles x Switches \_\_\_\_\_ Plugmold \_\_\_\_\_ ft. TOTAL 30  
 FIXTURES: (number of) Incandescent \_\_\_\_\_ Fluorescent \_\_\_\_\_ (not strip) TOTAL \_\_\_\_\_  
 Strip Fluorescent \_\_\_\_\_ ft. \_\_\_\_\_

FEES  
 RECEIVED  
 3.00  
 3.00

SERVICES: Overhead \_\_\_\_\_ Underground \_\_\_\_\_ Temporary \_\_\_\_\_ TOTAL amperes \_\_\_\_\_  
 METERS: (number of) \_\_\_\_\_  
 MOTORS: (number of) \_\_\_\_\_  
 Fractional \_\_\_\_\_  
 1 HP or over \_\_\_\_\_

RESIDENTIAL HEATING: Oil or Gas (number of units) \_\_\_\_\_  
 Electric (number of rooms) \_\_\_\_\_

COMMERCIAL OR INDUSTRIAL HEATING: Oil or Gas (by a main boiler) \_\_\_\_\_  
 Oil or Gas (by separate units) \_\_\_\_\_  
 Electric Under 20 kws \_\_\_\_\_ Over 20 kws \_\_\_\_\_

APPLIANCES: (number of) \_\_\_\_\_  
 Ranges \_\_\_\_\_ Water Heaters \_\_\_\_\_  
 Cook Tops \_\_\_\_\_ Disposals \_\_\_\_\_  
 Wall Ovens \_\_\_\_\_ Dishwashers \_\_\_\_\_  
 Dryers \_\_\_\_\_ Compactors \_\_\_\_\_  
 Fans \_\_\_\_\_ Others (denote) \_\_\_\_\_  
 TOTAL \_\_\_\_\_

MISCELLANEOUS: (number of) \_\_\_\_\_  
 Branch Panels \_\_\_\_\_  
 Transformers \_\_\_\_\_  
 Air Conditioners Central Unit \_\_\_\_\_  
 Separate Units (windows) \_\_\_\_\_  
 Signs 20 sq. ft. and under \_\_\_\_\_  
 Over 20 sq. ft. \_\_\_\_\_  
 Swimming Pools Above Ground \_\_\_\_\_  
 In Ground \_\_\_\_\_  
 Fire/Burglar Alarms Residential \_\_\_\_\_  
 Commercial \_\_\_\_\_  
 Heavy Duty Outlets, 220 Volt (such as welders) 30 amps and under \_\_\_\_\_  
 over 30 amps \_\_\_\_\_  
 Circus, Fairs, etc. \_\_\_\_\_  
 Alterations to wires \_\_\_\_\_  
 Repairs after fire \_\_\_\_\_  
 Emergency Lights, battery \_\_\_\_\_  
 Emergency Generators \_\_\_\_\_

FOR ADDITIONAL WORK NOT ON ORIGINAL PERMIT INSTALLATION FEE DUE: \_\_\_\_\_  
 FOR REMOVAL OF A "STOP ORDER" (304-16.b) DOUBLE FEE DUE: \_\_\_\_\_  
 TOTAL AMOUNT DUE: 6.00

INSPECTION: Will be ready on \_\_\_\_\_, 19\_\_\_\_; or Will Call xx  
 CONTRACTOR'S NAME: John McFarney  
 ADDRESS: 76 Ocean House Rd., Cape Elizabeth  
 TEL.: 799-5218  
 MASTER LICENSE NO.: \_\_\_\_\_  
 LIMITED LICENSE NO.: 3910 SIGNATURE OF CONTRACTOR: John McFarney

INSPECTOR'S COPY — WHITE  
 OFFICE COPY — CANARY  
 CONTRACTOR'S COPY — GREEN





**APPLICATION FOR PERMIT**  
**DEPARTMENT OF BUILDING INSPECTIONS SERVICES**  
**ELECTRICAL INSTALLATIONS**

*filmed*

Date Jan. 26, 19 84  
 Receipt and Permit number B 19847

To the CHIEF ELECTRICAL INSPECTOR, Portland, Maine:

The undersigned hereby applies for a permit to make electrical installations in accordance with the laws of Maine, the Portland Electrical Ordinance, the National Electrical Code and the following specifications:

LOCATION OF WORK: 1 Monument Square - 7th floor - Bernstein, Snur & Nelson & Sawyer

OWNER'S NAME: B & D Builders ADDRESS: 105 Winn Rd. Falmouth

FEE\$

**OUTLETS:**

Receptacles \_\_\_\_\_ Switches \_\_\_\_\_ Plugmold \_\_\_\_\_ ft. TOTAL 31-60 ..... 5.00

**FIXTURES: (number of)**

Incandescent \_\_\_\_\_ Fluorescent \_\_\_\_\_ (not strip) TOTAL \_\_\_\_\_

Strip Fluorescent \_\_\_\_\_ ft. ....

**SERVICES:**

Overhead \_\_\_\_\_ Underground \_\_\_\_\_ Temporary \_\_\_\_\_ TOTAL amperes \_\_\_\_\_

**METERS: (number of)**

\_\_\_\_\_

**MOTORS: (number of)**

Fractional \_\_\_\_\_

1 HP or over \_\_\_\_\_

**RESIDENTIAL HEATING:**

Oil or Gas (number of units) \_\_\_\_\_

Electric (number of rooms) \_\_\_\_\_

**COMMERCIAL OR INDUSTRIAL HEATING:**

Oil or Gas (by a main boiler) \_\_\_\_\_

Oil or Gas (by separate units) \_\_\_\_\_

Electric Under 20 kws \_\_\_\_\_ Over 20 kws \_\_\_\_\_

**APPLIANCES: (number of)**

Ranges \_\_\_\_\_ Water Heaters \_\_\_\_\_

Cook Tops \_\_\_\_\_ Disposals \_\_\_\_\_

Wall Ovens \_\_\_\_\_ Dishwashers \_\_\_\_\_

Dryers \_\_\_\_\_ Compactors \_\_\_\_\_

Fans \_\_\_\_\_ Others (denote) \_\_\_\_\_

TOTAL \_\_\_\_\_

**MISCELLANEOUS: (number of)**

Branch Panels \_\_\_\_\_

Transformers \_\_\_\_\_

Air Conditioners Central Unit \_\_\_\_\_

Separate Units (windows) \_\_\_\_\_

Signs 20 sq. ft. and under \_\_\_\_\_

Over 20 sq. ft. \_\_\_\_\_

Swimming Pools Above Ground \_\_\_\_\_

In Ground \_\_\_\_\_

Fire/Burglar Alarms Residential \_\_\_\_\_

Commercial \_\_\_\_\_

Heavy Duty Outlets, 220 Volt (such as welders) 30 amps and under \_\_\_\_\_

over 30 amps \_\_\_\_\_

Circus, Fairs, etc. \_\_\_\_\_

Alterations to wires \_\_\_\_\_

Repairs after fire \_\_\_\_\_

Emergency Lights, battery \_\_\_\_\_

Emergency Generators \_\_\_\_\_

INSTALLATION FEE DUE: \_\_\_\_\_

FOR ADDITIONAL WORK NOT ON ORIGINAL PERMIT ..... DOUBLE FEE DUE: \_\_\_\_\_

FOR REMOVAL OF A "STOP ORDER" (304-16.b) ..... \_\_\_\_\_

TOTAL AMOUNT DUE: 5.00

**INSPECTION:**

Will be ready on \_\_\_\_\_, 19\_\_; or Will Call \_\_\_\_\_

CONTRACTOR'S NAME: Mancini Electric

ADDRESS: 179 Sheridan St.

TEL.: \_\_\_\_\_

MASTER LICENSE NO.: on file SIGNATURE OF CONTRACTOR:

LIMITED LICENSE NO.: \_\_\_\_\_ GIUNO MANCINI

INSPECTOR'S COPY — WHITE  
 OFFICE COPY — CANARY  
 CONTRACTOR'S COPY — GREEN





**APPLICATION FOR PERMIT**  
**DEPARTMENT OF BUILDING INSPECTIONS SERVICES**  
**ELECTRICAL INSTALLATIONS**

*filed*

Date Jan. 27, 19 84  
 Receipt and Permit number B 19851

To the CHIEF ELECTRICAL INSPECTOR, Portland, Maine:

The undersigned hereby applies for a permit to make electrical installations in accordance with the laws of Maine, the Portland Electrical Ordinance, the National Electrical Code and the following specifications:

LOCATION OF WORK: Monument Square - A. H. Beniot  
 OWNER'S NAME: Beniot Clothing ADDRESS: same

	FEES
<b>OUTLETS:</b>	
Receptacles _____ Switches _____ Plugmold _____ ft. TOTAL _____	
<b>FIXTURES: (number of)</b>	
Incandescent _____ Fluorescent _____ (not strip) TOTAL _____	
Strip Fluorescent _____ ft. _____	
<b>SERVICES:</b>	
Overhead _____ Underground _____ Temporary _____ TOTAL amperes _____	
<b>METERS: (number of)</b> _____	
<b>MOTORS: (number of)</b>	
Fractional _____	
1 HP or over _____	
<b>RESIDENTIAL HEATING:</b>	
Oil or Gas (number of units) _____	
Electric (number of rooms) _____	
<b>COMMERCIAL OR INDUSTRIAL HEATING:</b>	
Oil or Gas (by a main boiler) _____	
Oil or Gas (by separate units) _____	
Electric Under 20 kws _____ Over 20 kws _____	
<b>APPLIANCES: (number of)</b>	
Ranges _____ Water Heaters _____	
Cook Tops _____ Disposals _____	
Wall Ovens _____ Dishwashers _____	
Dryers _____ Compactors _____	
Fans _____ Others (den' ) _____	
<b>TOTAL</b> _____	
<b>MISCELLANEOUS: (number of)</b>	
Branch Panels <u>1</u> _____	1.00
Transformers _____	
Air Conditioners Central Unit _____	
Separate Units (windows) _____	
Signs 20 sq. ft. and under _____	
Over 20 sq. ft. _____	
Swimming Pools Above Ground _____	
In Ground _____	
Fire/Burglar Alarms Residential _____	
Commercial _____	
Heavy Duty Outlets, 220 Volt (such as welders) 30 amps and under _____	
over 30 amps _____	
Circus, Fairs, etc. _____	
Alterations to wires _____	
Repairs after fire _____	
Emergency Lights, battery _____	
Emergency Generators _____	
<b>FOR ADDITIONAL WORK NOT ON ORIGINAL PERMIT</b> _____	<b>INSTALLATION FEE DUE:</b>
<b>FOR REMOVAL OF A "STOP ORDER" (304-16.b)</b> _____	<b>DOUBLE FEE DUE:</b>
	<b>TOTAL AMOUNT DUE:</b>
	<u>1.00</u>
	min <u>5.00</u>

**INSPECTION:**  
 Will be ready on \_\_\_\_\_, 19\_\_\_\_; or Will Call \_\_\_\_\_  
**CONTRACTOR'S NAME:** Guy McEort Fairman Electric Inc.  
**ADDRESS:** P. O. Box 598 37 Jordan Ave. Brunswick, Me.  
**TEL.:** \_\_\_\_\_  
**MASTER LICENSE NO.:** 03511 **SIGNATURE OF CONTRACTOR:** \_\_\_\_\_  
**LIMITED LICENSE NO.:** \_\_\_\_\_

INSPECTOR'S COPY — WHITE  
 OFFICE COPY — CANARY  
 CONTRACTOR'S COPY — GREEN



APPLICATION FOR PERMIT

PERMIT ISSUED

R.O.C.A. USE GROUP .....

B.O.C.A. TYPE OF CONSTRUCTION ..... 0183

MAR 12 1965

ZONING LOCATION ..... PORTLAND, MAINE

CITY of PORTLAND

March 8, 1965

To the CHIEF OF BUILDING & INSPECTION SERVICES, PORTLAND, MAINE

The undersigned hereby applies for a permit to erect, alter, repair, demolish, move or install the following building, structure, equipment or change use in accordance with the Laws of the State of Maine, the Portland B.O.C.A. Building Code and Zoning Ordinance of the City of Portland with plans and specifications, if any, submitted herewith and the following specifications:

LOCATION ..... 1 Monument Square - main lobby ground floor Fire District #1  #2   
 1. Owner's name and address ..... Lindard Realty - 2 Monument Sq. Telephone ..... 772-2257  
 2. Lessee's name and address ..... Casco Bank - 1 Monument Sq. Telephone ..... 774-8221  
 3. Contractor's name and address ..... Pitt Construction Inc. - 23 Lindale Ave. Biddeford, Me. Telephone ..... 774-8221

Proposed use of building ..... bank No. of sheets 282-2169  
 Last use ..... same No. families .....  
 Material ..... No. stories ..... Heat ..... Style of roof ..... Roofing .....  
 Other buildings on same lot .....  
 Estimated contractual cost \$ 33,500  
 FIELD INSPECTOR—Mr. @ 775-5451  
 Appeal Fees \$ .....  
 Base Fee .....  
 Late Fee ..... 180.00  
 TOTAL \$ ..... 180.00

To make renovations to existing lobby of bank as per plans, 1 sheet of plans, no structural changes

Stamp of Special Conditions

send permit to # 3 04005

NOTE TO APPLICANT: Separate permits are required by the installers and subcontractors of heating, plumbing, electrical and mechanicals.

DETAILS OF NEW WORK

Is any plumbing involved in this work? **yes** Is any electrical work involved in this work? **yes**  
 Is connection to be made to public sewer? **existing** If not, what is proposed for sewage? **yes**  
 Has septic tank notice been sent? ..... Form notice sent? .....  
 Height average grade to top of plate ..... Height average grade to highest point of roof .....  
 Size, front ..... depth ..... No. stories ..... solid or filled land? ..... earth or rock? .....  
 Material of foundation ..... Thickness, top ..... bottom ..... cellar .....  
 Kind of roof ..... Rise per foot ..... Roof covering .....  
 No. of chimneys ..... Material of chimneys ..... of lining ..... Kind of heat ..... fuel .....  
 Framing Lumber—Kind ..... Dressed or full size? ..... Corner posts ..... Sills .....  
 Size Girder ..... Columns under girders ..... Size ..... Max. on centers .....  
 Studs (outside walls and carrying partitions) 2x4-16" O. C. Bridging in every floor and flat roof span over 8 feet.  
 Joists and rafters: 1st floor ..... 2nd ..... 3rd ..... roof .....  
 On center: 1st floor ..... 2nd ..... 3rd ..... roof .....  
 Maximum span: 1st floor ..... 2nd ..... 3rd ..... roof .....  
 If one story building with masonry walls, thickness of walls? ..... height? .....

IF A GARAGE

No. cars now accommodated on same lot ..... to be accommodated ..... number commercial cars to be accommodated .....  
 Will automobile repairing be done other than minor repairs to cars habitually stored in the proposed building? .....

APPROVALS BY: DATE  
 BUILDING INSPECTION—PLAN EXAMINER .....  
 ZONING: .....  
 BUILDING CODE: .....  
 Fire Dept.: .....  
 Health Dept.: .....  
 Others: .....

MISCELLANEOUS  
 Will work require disturbing of any tree on a public street? .....  
 Will there be in charge of the above work a person competent to see that the State and City requirements pertaining thereto are observed? .....

Signature of Applicant **Ralph H. Pitt** Phone # .....  
 Type Name of applicant **Ralph H. Pitt for Pitt Constr. Casco Bank** Other **XX**  
 and Address .....

FIELD INSPECTOR'S COPY

APPLICANT'S COPY

OFFICE FILE COPY

B

# APPLICATION FOR PERMIT

PERMIT ISSUED

B.O.C.A. USE GROUP .....  
B.O.C.A. TYPE OF CONSTRUCTION .....

NOV - 28 1984

ZONING LOCATION ..... PORTLAND, MAINE Nov. 20, 1984

CITY OF PORTLAND

To the CHIEF OF BUILDING & INSPECTION SERVICES, PORTLAND, MAINE  
The undersigned hereby applies for a permit to erect, alter, repair, demolish, move or install the following building, structure, equipment or change use in accordance with the Laws of the State of Maine, the Portland B.O.C.A. Building Code and Zoning Ordinance of the City of Portland with plans and specifications, if any, submitted herewith and the following specifications:

LOCATION ..... One Monument Square ..... Fire District #1  #2   
1. Owner's name and address ..... Casco Back ..... Telephone .....  
2. Lessee's name and address ..... Automatic Sprinkler Corp of America Telephone 767-2166  
3. Contractor's name and address ..... 78 Pleasant Ave. S.E. Portland, ME 04106  
Proposed use of building ..... Bank ..... No. of sheets .....  
Last use ..... R.F.P. ..... No. families .....  
Material ..... No. stories ..... Heat ..... Style of roof ..... No. families .....  
Other buildings on same lot ..... Roofing .....  
Estimated contractual cost \$ 6,200.00

FIELD INSPECTOR—Mr. ..... Appeal Fees \$ .....  
@ 775-5451 ..... Base Fee \$ .....  
Late Fee \$ .....  
TOTAL \$ 40.00

To install sprinkler system on 1st. floor only, as per plan.

ISSUE PERMIT TO #3

Stamp of Special Conditions

NOTE TO APPLICANT: Separate permits are required by the installers and subcontractors of heating, plumbing, electrical and mechanicals.

## DETAILS OF NEW WORK

Is any plumbing involved in this work?  No  
Is connection to be made to public sewer?  No  
Has septic tank notice been sent?  No  
Height average grade to top of plate ..... Form notice sent?  No  
Size, front ..... depth ..... No. stories ..... Height average grade to highest point of roof ..... earth or rock?  No  
Material of foundation ..... Thickness, top ..... bottom ..... cellar .....  
Kind of roof ..... Rise per foot ..... Roof covering ..... Kind of heat ..... fuel .....  
No. of chimneys ..... Material of chimneys ..... of lining ..... Sills .....  
Framing Lumber—Kind ..... Dressed or full size? ..... Corner posts ..... Max. on centers .....  
Size Girder ..... Columns under girders ..... Size .....  
Studs (outside walls and carrying partitions) 2x4-16" O.C. Bridging in every floor and flat roof span over 8 feet.  
Joists and rafters: 1st floor ..... 2nd ..... 3rd ..... roof .....  
On centers: 1st floor ..... 2nd ..... 3rd ..... roof .....  
Maximum span: 1st floor ..... 2nd ..... 3rd ..... roof .....  
If one story building with masonry walls, thickness of walls? ..... height? .....

## IF A GARAGE

No. cars now accommodated on same lot ..... to be accommodated ..... number commercial cars to be accommodated .....  
Will automobile repairing be done other than minor repairs to cars habitually stored in the proposed building? .....

APPROVALS BY: BUILDING INSPECTION—PLAN EXAMINER DATE

## MISCELLANEOUS

ZONING: Will work require disturbing of any tree on a public street?  N/A  
BUILDING CODE: Will there be in charge of the above work a person competent to see that the State and City requirements pertaining thereto are observed?  Yes  
Fire Dept.:  
Health Dept.:  
Others: .....

Signature of Applicant Ted Clark Phone # .....  
Type Name of above Ted Clark for Automatic Sprinkler 1  2  3  4

Other .....  
and Address .....

FIELD INSPECTOR'S COPY

APPLICANT'S COPY

OFFICE FILE COPY

APPLICATION FOR PERMIT

PERMIT ISSUED

AUG 2 1984

CITY of PORTLAND

B.O.C.A. USE GROUP ..... B.O.C.A. TYPE OF CONSTRUCTION ..... 924

ZONING LOCATION ..... B-3 ..... PORTLAND, MAINE July 27, 1984.

To the CHIEF OF BUILDING & INSPECTION SERVICES, PORTLAND, MAINE

The undersigned hereby applies for a permit to erect, alter, repair, demolish, move or install the following building, structure, equipment or change use in accordance with the Laws of the State of Maine, the Portland B.O.C.A. Building Code and Zoning Ordinance of the City of Portland with plans and specifications, if any, submitted herewith and the following specifications:

LOCATION ..... 1. Monument Square - 6th Floor

1. Owner's name and address ..... Pierce, Atwood, Scribner, Allen, Smith & Lancaster Fire District #1  #2

2. Lessee's name and address ..... Telephone 04108

3. Contractor's name and address ..... F. B. & C. H. Murray - P.O. Box 330, S.P. Telephone 799-8136

Proposed use of building ..... law offices No. of sheets 5

Last use ..... accounting firm offices No. families

Material ..... No. stories Heat Style of roof No. families

Other buildings on same lot ..... Roofing

Estimated contractual cost \$18,230.00

FIELD INSPECTOR - Mr. N. Nugent @ 775-5451

Appeal Fees \$

Base Fee

Late Fee

TOTAL \$100.00

To make renovations, as per plans. Interior

Stamp of Special Conditions

ISSUE PERMIT TO #3

NOTE TO APPLICANT: Separate permits are required by the installers and sub-contractors of heating, plumbing, electrical and mechanicals.

DETAILS OF NEW WORK

Is any plumbing involved in this work? yes Is any electrical work involved in this work? yes
Is connection to be made to public sewer? If not, what is proposed for sewage?
Has septic tank notice been sent? If not, what is proposed for sewage?
Height average grade to top of plate
Material of foundation Thickness, top bottom cellar
No. of chimneys Material of chimneys of lining Kind of heat fuel
Framing Lumber - Kind Dressed or full size? Corner posts Sills
Size Girder Columns under girders Size Max. on centers
Studs (outside walls and carrying partitions) 2x4-16" O. C. Bridging in every floor and flat roof span over 8 feet.
Joists and rafters: 1st floor 2nd 3rd roof
On centers: 1st floor 2nd 3rd roof
Maximum span: 1st floor 2nd 3rd roof
If one story building with masonry walls, thickness of walls? height?

IF A GARAGE

No. cars now accommodated on same lot ..... to be accommodated ..... number commercial cars to be accommodated
Will automobile repairing be done other than minor repairs to cars habitually stored in the proposed building?

APPROVALS BY: BUILDING INSPECTION - PLAN EXAMINER DATE

MISCELLANEOUS

ZONING: Will work require disturbing of any tree on a public street? DO
BUILDING CODE: Will there be in charge of the above work a person competent to see that the State and City requirements pertaining thereto are observed? yes

Fire Dept. Health Dept. Others:

Signature of Applicant Gary Sullivan for F. B. & C. H. Murray Phone #
Type Name of above and Address

FIELD INSPECTOR'S COPY APPLICANT'S COPY OFFICE FILE COPY
10 MR. NUGENT

NOTES

11/20/89  
WORK DONE  
TO PLAN  
Cura

Permit No.

81/024

Location

Shrewsbury St. - 6

Owner

Shrewsbury St. Co.

Date of permit

7-27-84

Approved

8-2-84

Dwelling

Garage

Alteration

to Law Office



rail at this point shall be sanded as necessary and refinished. Gaps left in cork covering shall be filled by the installation of a thin piece of mahogany finished to match other showwood. Existing end shall be cut down and replaced as indicated, and wing of carrel securely fastened to new file cabinets from the inside of the file cabinet. Carrel is currently secured in place by means of being set over pins in concrete floor. Care shall be taken that carrel continues to be firmly anchored, setting new pins in floor with new slots in the bottom of the carrel if this is necessary.

K. MECHANICAL ROOM 9A AND UTILITY ROOM 8

1. MECHANICAL ROOM CABINET: Counter and backsplash 3/4-inch A-B INT-APA plywood covered with plastic laminate; bottom of drawers 1/2-inch Birch plywood; sides, dividers, and rear of cabinets and shelves 3/4-inch multi-ply Birch plywood; shelf supports, showwood trim and drawer fronts 3/4-inch solid Birch; drawer sides and ends 5/8-inch Pine. All surfaces shall be for transparent finish. Hardware as scheduled on drawing. Cabinet shall be constructed so as to be easily relocated in future.
  2. SHELVING: Shelves shall be 3/4-inch multi-ply Birch plywood mounted on hardware previously specified. Blocking will be under CARPENTRY but provision of hardware and installation is part of this Section.
  3. UTILITY ROOM SHELVING: Shelf standards and brackets shall be changed as indicated to material specified herein. Shelves shall be shortened, new edge banding added if cut edges are exposed, and refinished if there is new wood exposed.
- L. PEG STRIPS shall be of mahogany as detailed. Fastenings for finished items shall be recessed and holes plugged with matching finished stock. Clothes Pegs shall be of Birch finished to match the mahogany.

IV. INSTALLATION

The Millwork Contractor shall deliver and install the millwork and shall cooperate with and coordinate his work with that of the General Contractor and electrician. Care shall be taken to protect existing work and carpet during installation of millwork as specified above.

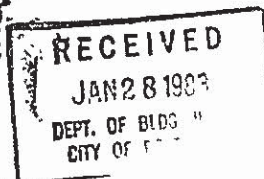

V. FORM OF PROPOSAL

Bids shall be submitted on stationery with the Bidder's business letterhead or on this Form of Proposal. If stationery is used, all information requested on this Form of Proposal shall be included. Fill in all blanks.

BID DATE:

TO: Pierce Atwood Scribner Allen Smith  
& Lancaster  
c/o WADSWORTH BOSTON MERCER  
& WEATHERILL  
615 Congress Street  
Portland, Maine 04101

A. Bidder's Name \_\_\_\_\_  
Address \_\_\_\_\_  
Telephone No. \_\_\_\_\_

B. Price for the Millwork, complete including materials, fabrication, delivery, installation, and finishing as herein specified and indicated on Sheets 2,3,4, and 5.

Materials, fabrication, delivery and finishing.....\$ \_\_\_\_\_  
Maine State Sales Tax.....\$ \_\_\_\_\_  
Installation.....\$ \_\_\_\_\_  
TOTAL.....\$ \_\_\_\_\_

C. The undersigned certifies that he has read these specifications for the installation of millwork and that he will abide by the requirements thereof, including the delivery times required.

D. Signed: \_\_\_\_\_  
Title: \_\_\_\_\_  
Firm: \_\_\_\_\_  
Date of Submission: \_\_\_\_\_

RECEIVED  
JAN 28 1988  
DEPT. OF BLDG. INSP  
CITY OF PORTLAND



## CITY OF PORTLAND

DEPARTMENT OF PLANNING & URBAN DEVELOPMENT  
INSPECTION SERVICES DIVISION

September 8, 1983

Ledgewood Inc.  
P.O. Box 8107  
Portland, ME 04104

RE: 15 Monument Square

Dear Sir:

Your application to make alterations at 15 Monument Square, Portland, Maine has been reviewed, and a building permit is hereby issued subject to the following building and fire code requirements.

1. Internally lit exit signs and emergency lighting shall be provided for all exits and paths to reach same.
2. All doors involved in the means of egress shall be equipped with latch sets which shall open from the inside without the use of keys, special knowledge, or ability, but by merely turning the usual knob or by pressure on a plate or lever.
3. The boiler room shall be enclosed with construction having a fire rating of at least one hour, including the ceiling, and fire doors with self-closers.
4. All vertical openings (stairways) shall be enclosed with construction having a fire rating of at least two hours, including fire doors with self-closers.
5. An approved manual fire alarm system shall be provided with pull stations at each exit, on each floor, connected to horn and flashing light sounding devices placed throughout as required.
6. All storage areas shall be enclosed with construction having a fire rating of at least one hour including fire door with self-closers.
7. The fire escape shall have a minimum of 9-inch tread and a maximum of 9-inch rise.

# Certificate of Flame Resistance



REGISTERED  
APPLICATION  
CONCERN No.

A-217

ISSUED BY

JOHN BOYLE & COMPANY, INC.

112-114 DUANE STREET,  
NEW YORK, N.Y. 10007

212-962-4770

Date treated or  
manufactured

6/22/81

This is to certify that the materials described on the reverse side hereof have been flame-retardant treated (or are inherently nonflammable).

FOR Johnson Camping Inc. ADDRESS 1 Marine Midland Plaza  
CITY Binghamton STATE New York

Certification is hereby made that: (Check "a" or "b")

(a) The articles described on the reverse side of this Certificate have been treated with a flame-retardant chemical approved and registered by the State Fire Marshal and that the application of said chemical was done in conformance with the laws of the State of California and the Rules and Regulations of the State Fire Marshal.

Name of chemical used \_\_\_\_\_ Chem. Reg. No. \_\_\_\_\_

Method of application.....

(b) The articles described on the reverse side hereof are made from a flame-resistant fabric or material registered and approved by the State Fire Marshal for such use.

Trade name of flame-resistant fabric or material used Wide Trailer Reg. No. F-121-6

The Flame Retardant Process Used WILL NOT Be Removed By Washing

JOHN BOYLE & COMPANY, INC.

JOHN BOYLE & CO. INC.

Name of Applicator or Production Superintendent

By

*John W. Plavers*  
Registered Signature

RECEIVED

JUN - 4 1984

DEPT. OF BLDG. INSP.  
CITY OF PORTLAND.

(over)

CONTROL NO. 9501  
CUSTOMER ORDER NO. 00119  
CUSTOMER INVOICE NO. 410186  
YARDS OR QUANTITY 2262  
COLOR Blue and white  
STYLE 788  
DATE PROCESSED 6/22/81  
LOCATION OF INSTALLATION SHIPPED TO MAINE BAY CANVAS  
977 BRIGHTON AVE PORTLAND, ME.  
TYPE OF INSTALLATION THIS MATERIAL COURSES  
2 - 20 x 40, 2 - 30 x 60 AND 2 - 40 x 100 PARRY TENDS  
BLUE AND WHITE

Cours

# APPLICATION FOR PERMIT

B.O.C.A. USE GROUP .....  
 B.O.C.A. TYPE OF CONSTRUCTION ..... **623**  
 ZONING LOCATION ..... PORTLAND, MAINE June 4, 1984

**PERMIT**  
JUN 5

To the CHIEF OF BUILDING & INSPECTION SERVICES, PORTLAND, MAINE

The undersigned hereby applies for a permit to erect, alter, repair, demolish, move or install the following *building, structural equipment or change use in accordance with the Laws of the State of Maine, the Portland B.O.C.A. Building Code and Zoning Ordinance of the City of Portland with plans and specifications, if any, submitted herewith and the following specifications:*

LOCATION ..... Monument Square ..... Fire District #1 , #2   
 1. Owner's name and address ..... A. H. Beniot - same ..... Telephone ..... 773-6421  
 2. Lessee's name and address ..... Telephone .....  
 3. Contractor's name and address ..... Maine Bay Canvas - 977 Brighton Ave ..... Telephone ..... 773-2261

Proposed use of building ..... tent for promotional sale ..... No. of sheets .....  
 Last use ..... No. families .....  
 Material ..... No stories ..... Heat ..... St. of roof ..... Roofing .....  
 Other buildings on same lot .....  
 Estimated contractual cost \$ .....

FIELD INSPECTOR—Mr. .....  
 @ 775-5451

Appeal Fees \$ .....  
 Base Fee ..... 35.00  
 Late Fee .....  
 TOTAL \$ .....

To erect 30' x 30' tent to be used July 19, 20, 21, 1984 for promotional sale as per plans. 1 sheet of plans flame proof certificate enclosed

Stamp of Special Conditions

send permit to # 1 Lucile Beniot.

**NOTE TO APPLICANT:** Separate permits are required by the installers and subcontractors of heating, plumbing, electrical and mechanicals.

### DETAILS OF NEW WORK

Is any plumbing involved in this work? ..... **no** ..... Is any electrical work involved in this work? ..... **no** .....  
 Is connection to be made to public sewer? ..... If not, what is proposed for sewage? .....  
 Has septic tank notice been sent? ..... Form notice sent? .....  
 Height average grade to top of plate ..... Height average grade to highest point of roof .....  
 Size, front ..... depth ..... No. stories ..... solid or filled land? ..... earth or rock? .....  
 Material of foundation ..... Thickness, top ..... bottom ..... cellar .....  
 Kind of roof ..... Rise per foot ..... Roof covering .....  
 No. of chimneys ..... Material of chimneys ..... of lining ..... Kind of heat ..... fuel .....  
 Framing Lumber—Kind ..... Dressed or full size? ..... Corner posts ..... Sills .....  
 Size Girder ..... Columns under girders ..... Size ..... Max. on centers .....  
 Studs (outside walls and carrying partitions) 2x4-16" C. C. Bridging in every floor and flat roof span over 8 feet.  
 Joists and rafters: 1st floor ..... 2nd ..... 3rd ..... roof .....  
 On centers: 1st floor ..... 2nd ..... 3rd ..... roof .....  
 Maximum span: 1st floor ..... 2nd ..... 3rd ..... roof .....  
 If one story building with masonry walls, thickness of wall? ..... height? .....

### IF A GARAGE.

No. cars now accommodated on same lot ..... to be accommodated ..... number commercial cars to be accommodated .....  
 Will automobile repairing be done other than minor repairs to cars habitually stored in the proposed building? .....

**APPROVALS BY:** ..... **DATE** .....  
 BUILDING INSPECTION—PLAN EXAMINER .....  
 ZONING: .....  
 BUILDING CODE: .....  
 Fire Dept.: .....  
 Health Dept.: .....  
 Others: .....

**MISCELLANEOUS**  
 Will work require disturbing of any tree on a public street? ..... **no** .....  
 Will there be in charge of the above work a person competent to see that the State and City requirements pertaining thereto are observed? ..... **yes** .....

Signature of Applicant *Oliver D. Olson* ..... Phone # ..... same .....  
 Type Name of above ..... C. F. Abrams for A. H. Beniot ..... 1  2  3  4  .....  
 Other .....  
 and Address .....

FIELD INSPECTOR'S COPY ..... APPLICANT'S COPY ..... OFFICE FILE COPY .....

*10* *Mrs. D. H. Grant*

Permit No. 84/623  
Location 1 Monument Avenue  
Owner A. D. Bennett  
Date of permit 5-4-84  
Approved J. J. - 84  
Dwelling Tank for sale  
Garage  
Alteration

NOTES

8/2/84  
Done & Done  
[Signature]



Date 11-20-84

To Inspection Services From "Automatic" Sprinkler Corporation of America  
389 Congress Street "AUTOMATIC" SPRINKLER CORP. OF AMERICA  
Portland Maine 04101 P. O. BOX 2311  
LT. Jim Collins 78 PLEASANT AVE.  
SOUTH PORTLAND, MAINE 04106

Job Name Casco Bank Our Contract No. 2-1896  
 Your Index File \_\_\_\_\_  
 Your P O No. \_\_\_\_\_

We are sending

- Enclosed  
 Separately

- Preliminary Dwg  
 Shop Drawings  
 Revised Dwg.  
 Additional Dwg.  
 Approved Dwg.  
 Literature  
 Test Certificate

- For Approval  
 Per Request  
 For Construction  
 For Your Files  
 Acceptance Inspection

RECEIVED  
 NOV 20 1984  
 DEPT. OF PERMITS  
 CITY OF PORTLAND

No. of Copies	Dwg. No.	Description
1	1 of 1	Sprinkler layout for Elevator Lobby & Bank Lobby

Remarks \_\_\_\_\_

NOTICE TO OWNERS REPRESENTATIVE: Enclosed plans show actual piping arrangement. Elevations are denoted on the plans, also locations from walls, columns, etc. Your immediate review is requested if you plan any new additions, equipment or changes in storage and building or if conflict exists with other trades, please contact the writer immediately. Plans have been submitted to the Approving Insurance Authority, and upon receipt of all approvals, plans will be released for pre fabrication.

IN ORDER TO GIVE YOU THE BEST POSSIBLE SERVICE, NO RESPONSE BY \_\_\_\_\_ WILL INDICATE YOUR ACCEPTANCE AND UPON RECEIPT OF INSURANCE APPROVALS MATERIAL WILL BE PRE FABRICATED.

Please return 1 copies to this office bearing your stamp of approval or comments.

Copies To R. B. Allen

Very truly yours,

Ted Clark  
 (Signature)





## CITY OF PORTLAND

DEPARTMENT OF PLANNING & URBAN DEVELOPMENT  
INSPECTION SERVICES DIVISION

November 26, 1984

Automatic Sprinkler Corp. of American  
78 Pleasant Ave.,  
South Portland, Maine 04106

RE: One Monument Square

Dear Sir:

Your application to install a sprinkler system has been reviewed and a permit is herewith issued subject to the following requirements.

1. This system shall comply with all the NFPA #13 requirements.
2. This system shall be electrically connected to the alarm system so that the flow of water from any one head will activate the alarm system throughout the building.

If you have any questions on these requirements please call this office.

Sincerely,

P. Samuel Hoffas  
Chief of Inspection Services

APPLICATION FOR PERMIT

B.O.C.A. USE GROUP .....  
 B.O.C.A. TYPE OF CONSTRUCTION ..... 01485

ZONING LOCATION ..... PORTLAND, MAINE Nov. 20, 1984

PERMIT ISS  
 NOV 28 1984  
 CITY of PORTLAND

To the CHIEF OF BUILDING & INSPECTION SERVICES, PORTLAND, MAINE

The undersigned hereby applies for a permit to erect, alter, repair, demolish, move or install the following building, structure, equipment or change use in accordance with the Laws of the State of Maine, the Portland B.O.C.A. Building Code and Zoning Ordinance of the City of Portland with plans and specifications, if any, submitted herewith and the following specifications:

LOCATION ..... One Monument Square ..... Fire District #1 , #2   
 1. Owner's name and address ... Casco Bank ... same ..... Telephone .....  
 2. Lessee's name and address ..... Telephone .....  
 3. Contractor's name and address Automatic Sprinkler Corp of America Telephone 767-2166  
 ..... 78 Pleasant Ave., S.P. 04106 ..... No. of sheets 1

Proposed use of building Bank ..... No. families .....  
 Last use ..... same ..... No. families .....  
 Material ..... No. stories ..... Heat ..... Style of roof ..... Roofing .....

Other buildings on same lot .....  
 Estimated contractual cost \$ 6,200.00 Appeal Fees \$ .....

FIELD INSPECTOR—Mr. .... @ 775-5451 Base Fee .....  
 Late Fee .....  
 TOTAL \$ 40.00

To install sprinkler system on 1st. floor only, as per plan.

ISSUE PERMIT TO #3

Stamp of Special Conditions  
**PERMIT ISSUED WITH LETTER**

NOTE TO APPLICANT: Separate permits are required by the installers and subcontractors of heating, plumbing, electrical and mechanicals.

DETAILS OF NEW WORK

Is any plumbing involved in this work? ... no ..... Is any electrical work involved in this work? ... no .....  
 Is connection to be made to public sewer? ..... If not, what is proposed for sewage? .....  
 Has septic tank notice been sent? ..... Form notice sent? .....  
 Height average grade to top of plate ..... Height average grade to highest point of roof .....  
 Size, front ..... depth ..... No. stories ..... solid or filled land? ..... earth or rock? .....  
 Material of foundation ..... Thickness, top ..... bottom ..... cellar .....  
 Kind of roof ..... Rise per foot ..... Roof covering .....  
 No. of chimneys ..... Material of chimneys ..... of lining ..... Kind of heat ..... fuel .....  
 Framing Lumber—Kind ..... Dressed or full size? ..... Corner posts ..... Sills .....  
 Size Girder ..... Columns under girders ..... Size ..... Max. on centers .....  
 Studs (outside walls and carrying partitions) 2x4-16" O. C. Bridging in every floor and flat roof span over 8 feet.  
 Joists and rafters: 1st floor ..... 2nd ..... 3rd ..... roof .....  
 On centers: 1st floor ..... 2nd ..... 3rd ..... roof .....  
 Maximum span: 1st floor ..... 2nd ..... 3rd ..... roof .....  
 If one story building with masonry wall, thickness of walls? ..... height? .....

IF A GARAGE

No. cars now accommodated on same lot ..... to be accommodated ..... number commercial cars to be accommodated .....  
 Will automobile repairing be done other than minor repairs to cars habitually stored in the proposed building? .....

APPROVALS BY: DATE MISCELLANEOUS  
 BUILDING INSPECTION—PLAN EXAMINER ..... Will work require disturbing of any tree on a public street? N/A  
 ZONING: .....  
 BUILDING CODE: .....  
 Fire Dept: James P. Collins ..... Will there be in charge of the above work a person competent  
 Health Dept: ..... to see that the State and City requirements pertaining thereto  
 Others: ..... are observed? ... Y/N

Signature of Applicant Ted Clark Phone # .....  
 Type Name of above Ted Clark for Automatic Sprinkler  2  3  4   
 Other .....  
 and Address .....

PERMIT ISSUED WITH LETTER FIELD INSPECTOR'S COPY

APPLICANT'S COPY OFFICE FILE COPY

TEDE

NOTES

4/26/86 Done  
 JO PLAA  
 (CN)

Permit No. 89/4485  
 Location Redmond, Oregon  
 Owner Carl Brantley  
 Date of permit 1-20-84  
 Approved 1-28-84  
 Dwelling - Grill system  
 Garage  
 Alteration



## CITY OF PORTLAND

JOSEPH E. GRAY, JR.  
DIRECTOR OF PLANNING  
AND URBAN DEVELOPMENT

April 9, 1985

Fels Co.  
390 Presumpscot Street  
Portland, Me

RE: 1 Monument Square, Portland, Maine

Dear Sir:

Your application to install an air condition and to make alterations has been reviewed and a permit is herewith issued subject to the following requirement:

Smoke dampers shall be provided at all points where rated partitions are penetrated.

If you have any questions on these requirements, please call this office.

Sincerely,

P. Samuel Hoffses  
Chief of Inspection Services

APPLICATION FOR PERMIT

PERMIT ISSUED

B.O.C.A. USE GROUP ..... 0 300
B.O.C.A. TYPE OF CONSTRUCTION .....
ZONING LOCATION ..... PORTLAND, MAINE April 8, 1985 CITY OF PORTLAND

To the CHIEF OF BUILDING & INSPECTION SERVICES, PORTLAND, MAINE
The undersigned hereby applies for a permit to erect, alter, repair, demolish, move or install the following building, structure, equipment or change use in accordance with the Laws of the State of Maine, the Portland B.O.C.A. Building Code and Zoning Ordinance of the City of Portland with plans and specifications, if any, submitted herewith and the following specifications:
LOCATION 1 Monument Square - 9th floor Fire District #1 [ ] #2 [ ]
1. Owner's name and address Finard Realty - Boston, Mass - 2 Monument Square
2. Lessee's name and address Pierce, Atwood, Scribner Law Telephone 773-6411
3. Contractor's name and address FelsCo - 390 Presumpscot St. Telephone 773-6431
Proposed use of building law offices No. of sheets
Last use same No. families
Material No. stories Heat Style of roof Roofing
Other buildings on same lot
Estimated contractual cost \$ 24,555.00 Appeal Fees \$
Base Fee 135.00
Late Fee
TOTAL \$

FIELD INSPECTOR - Mr. @ 775-5451

To make alterations to existing law offices no structural changes as per plans, 1 sheet of plans. installing air conditioning unit to serve computer room send perm. to # 3 04103

Stamp of Special Conditions PERMIT ISSUED WITH LETTER

NOTE TO APPLICANT: Separate permits are required by the installers and subcontractors of heating, plumbing, electrical and mechanicals.

DETAILS OF NEW WORK

Is any plumbing involved in this work? Yes
Is any electrical work involved in this work? Yes
Is connection to be made to public sewer? existing
Has septic tank notice been sent? Form notice sent?
Height average grade to top of plate
Size, front depth No. stories solid or filled land? earth or rock?
Material of foundation Thickness, top bottom cellar
Kind of roof Rise per foot Roof covering
No. of chimneys Material of chimneys of lining Kind of heat fuel
Framing Lumber - Kind Dressed or full size? Corner posts Sills
Size Girder Columns under girders Size Max. on centers
Studs (outside walls and carrying partitions) 2x4-16" O. C. Bridging in every floor and flat roof span over 8 feet.
Joists and rafters: 1st floor 2nd 3rd roof
On centers: 1st floor 2nd 3rd roof
Maximum span: 1st floor 2nd 3rd roof
If one story building with masonry walls, thickness of walls? height?

IF A GARAGE

No. cars now accommodated on same lot to be accommodated number commercial cars to be accommodated
Will automobile repairing be done other than minor repairs to cars habitually stored in the proposed building?

APPROVALS BY: DATE MISCELLANEOUS
BUILDING INSPECTION PLAN EXAMINER Will work require disturbing of any tree on a public street?
ZONING:
BUILDING CODE:
Fire Dept. James P. Collins, Chief Will there be in charge of the above work a person competent to see that the State and City requirements pertaining thereto are observed?
Health Dept.
Others:
Signature of Applicant Maurice Flanders Phone # same
Type Name of above Maurice Flanders for 1 [ ] 2 [ ] 3 [x] 4 [ ]
Fels Co. Other and Address

PERMIT ISSUED WITH LETTER

Handwritten signature and initials

APPLICANT'S COPY OFFICE FILE COPY

NOTES

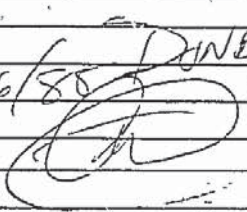
4/26/85 DONE TO PLAN  

Permit No. 85/305

Location 19th Street - Belmont

Owner Harold Griffith

Date of permit 4-8-85

Approved 4-10-85

Dwelling

Garage

Alteration to lower office

[Empty lined area for notes]

[Empty lined area for notes]

Pete Co.

RECEIVED  
 APR 28 1985  
 DEPT OF BLDG INSP.  
 CITY OF PORTLAND

CONC RT SHIP

ELECTRIC PLANS

LOCATION OF ELECTRIC CLOSET SHOWN ON SHEET #1.

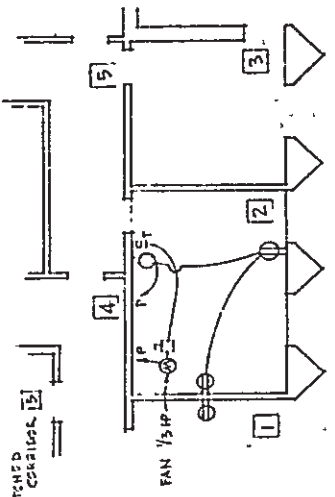

POWER & TELEPHONE PLAN

SCALE 1/8" = 1'-0"

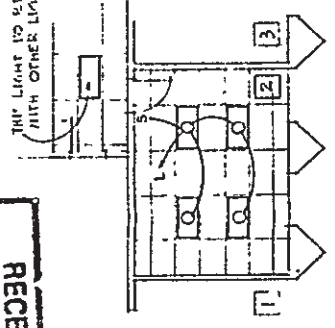

LIGHTING PLAN

SCALE 1/8" = 1'-0"

1. IN AREA #2 REMOVE ALL EXISTING WIRING AND DEVICES NOT TO BE USED IN NEW WORK.
2. REMOVE MUZZAK SPEAKER AND SWITCH.
3. REMOVE EXISTING LIGHTS AND GRILLE. CLEAN, AND RE-INSTALL. ADDITIONAL LIGHT FIXTURES AVAILABLE FROM BUILDING.

- FLUORESCENT LIGHTING FIXTURE
- WALL SWITCH, SINGLE POLE, UP 4"
- WALL MOUNTED TIMER SWITCH - 1 HOUR
- DUPLEX RECEPTACLE, UP 18" UNLESS NOTED OTHERWISE
- TELEPHONE OUTLET
- MOTOR
- DISCONNECT SWITCH
- POWER PANEL IN ELECTRIC CLOSET
- LIGHTING PANEL IN ELECTRIC CLOSET

CONTRACTOR SHALL MEASURE AND VERIFY ALL DIMENSIONS AT WORK

ALTERATIONS ON THE 6<sup>TH</sup> FLOOR OF ONE MONUMENT SQUARE

PIERCE ATWOOD SCRIBNER ALLEN ARCHITECTS - ENGINEERS 615 CONGRESS STREET PORTLAND, MAINE 04101

C-5502 MARCH 13, 1985

772-6554

RHW

2

CONTROL VALVE AT END

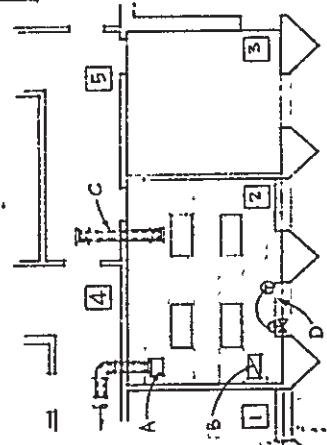

HEATING & VENTILATING PLAN

SCALE 1/8" = 1'-0"

- NEW CEILING EXHAUST FAN: PENN ZEPHYR, 365 CFM, 1/8" SP, 1050 RPM, 1/3 HP, 115V/1PH. DUCTWORK: 9" Ø GALV. STEEL WITH 1" LINING.
- RETURN CEILING GRILLE: SALVAGE, CLEAN, AND RE-INSTALL EXISTING.
- TRANSFER DUCT: 8" x 8" GALV. STEEL WITH 1" LINING AND 6" Ø CEILING DIFFUSER AT EACH END.
- NEW THERMOSTAT EQUAL TO BUILDING STANDARD CONNECTED TO CONTROL VALVE.

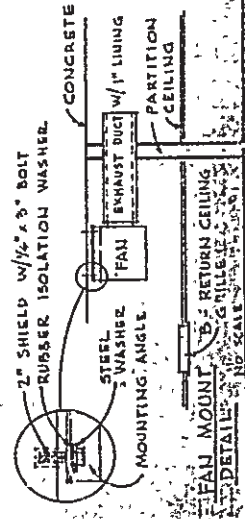

FAN MOUNTING DETAIL AT 1/4" SCALE

MAR 13 1985

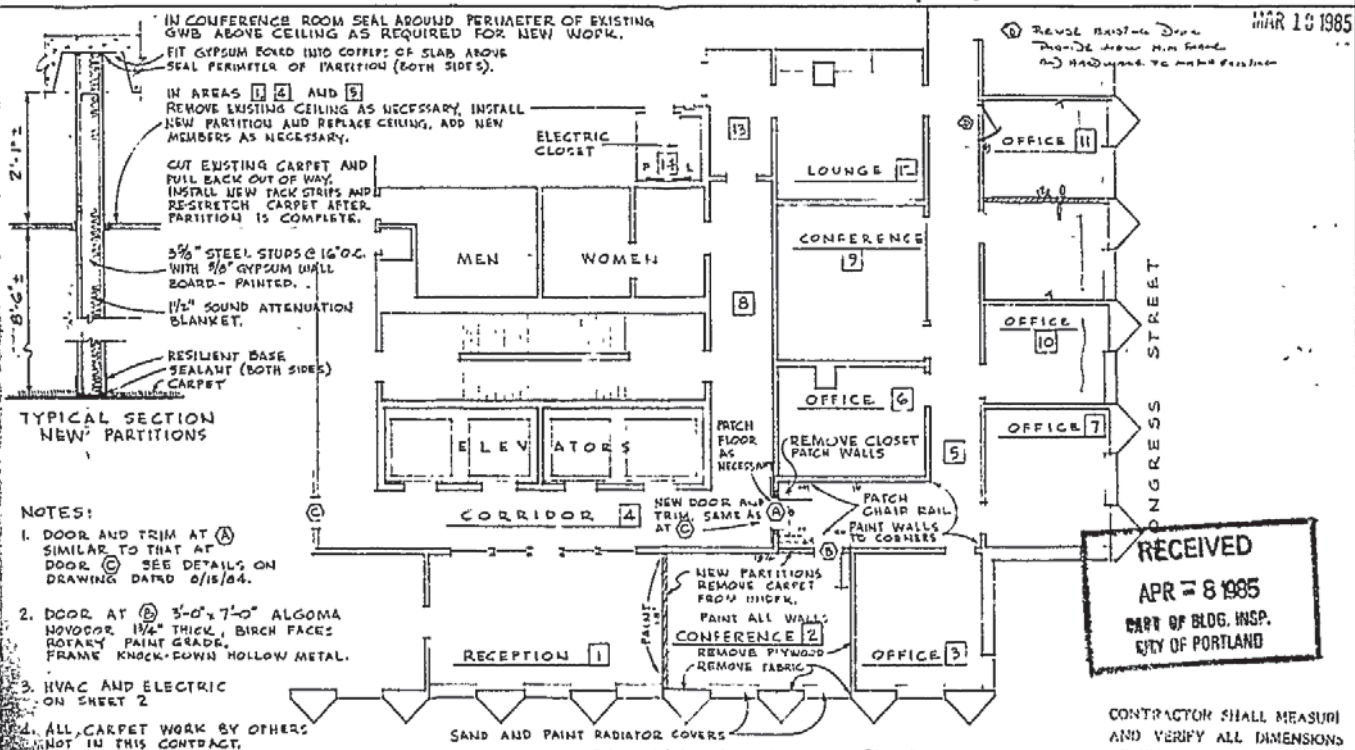



APPLICATION FOR PERMIT

PERMIT ISSUED

B.O.C.A. USE GROUP .....

APR 10 1965

B.O.C.A. TYPE OF CONSTRUCTION ..... 0 307

ZONING LOCATION ..... PORTLAND, MAINE April 8, 1965

CITY of PORTLAND

To the CHIEF OF BUILDING & INSPECTION SERVICES, PORTLAND, MAINE

The undersigned hereby applies for a permit to erect, alter, repair, demolish, move or install the following building, structure, equipment or change use in accordance with the Laws of the State of Maine, the Portland B.O.C.A. Building Code and Zoning Ordinance of the City of Portland with plans and specifications, if any, submitted herewith and the following specifications:

LOCATION ..... 1 Monument Square - 5th floor

- 1. Owner's name and address Finard Realty - Boston, Mass. Telephone #1 □, #2 □
- 2. Lessee's name and address Pierce, Atwood Scribner Law - same Telephone 773-6411
- 3. Contractor's name and address F. P. & C. H. Murray - Box 2530 SO, Portland Telephone 799-8136

Proposed use of building law firm No. of sheets .....

Last use same No. families .....

Material No. stories Heat Style of roof No. families .....

Other buildings on same lot Roofing .....

Estimated contractual cost \$ 8,600

FIELD INSPECTOR—Mr. Appeal Fees \$ .....

@ 775-5451

Base Fee . . . . . \$5.00

Late Fee .....

TOTAL \$ .....

To make alterations to existing office space, no structural changes as per plan. 2 sheets of plans.

Stamp of Special Conditions

send permit to # 3 04106

NOTE TO APPLICANT: Separate permits are required by the installers and subcontractors of heating, plumbing, electrical and mechanicals.

DETAILS OF NEW WORK

- Is any plumbing involved in this work? no
- Is any electrical work involved in this work? yes
- Is connection to be made public sewer? If not, what is proposed for sewage?
- Has septic tank notice been sent? Form notice sent?
- Height average grade to top of plate Height average grade to highest point of roof
- Size, front depth No. stories solid or filled land? earth or rock?
- Material of foundation Thickness, top bottom cellar
- Kind of roof Rise per foot Roof covering
- No. of chimneys Material of chimneys of lining Kind of heat fuel
- Framing Lumber—Kind Dressed or full size? Corner posts Sills
- Size Girder Columns under girders Size Max. on centers
- Studs (outside walls and carrying partitions) 2x4-16" O. C. Bridging in every floor and flat roof span over 8 feet.
- Joists and rafters: 1st floor, 2nd, 3rd, roof
- On centers: 1st floor, 2nd, 3rd, roof
- Maximum span: 1st floor, 2nd, 3rd, roof
- If one story building with masonry walls, thickness of walls? height?

IF A GARAGE

- No. cars now accommodated on same lot to be accommodated number commercial cars to be accommodated
- Will automobile repairing be done other than minor repairs to cars habitually stored in the proposed building?

APPROVALS BY: DATE

BUILDING INSPECTION PLAN EXAMINER

ZONING

BUILDING CODE

Fire Dept. *J. Collins*

Health Dept.

Others

MISCELLANEOUS

Will work require disturbing of any tree on a public street?

Will there be in charge of the above work a person competent to see that the State and City requirements pertaining thereto are observed?

Signature of Applicant *Dick Miller* O.A. Phone # 72118

Type Name of above Dick Miller For

F. P. & C. H. Murray Other 1 □ 2 □ 3 □ 4 □

and Address

FIELD INSPECTOR'S COPY

APPLICANT'S COPY

OFFICE FILE COPY

*10/1/65 M. Murray*

NOTES

6/19/85  
DOW TO PLAN

Permit No. 85/317

Location 1 M... ..

Owner V-8-85

Date of permit 1-10-85

Approved

Dwelling

Garage

Alteration for change

[Empty lined area for notes]

[Empty lined area for notes]