

106 EXCHANGE STREET

SHAW-WALKER

Prepared By	Initials	Date
Approved By		

Floor Plan for Deli I

Seating capacity 90
 106 Exchange
 Portland

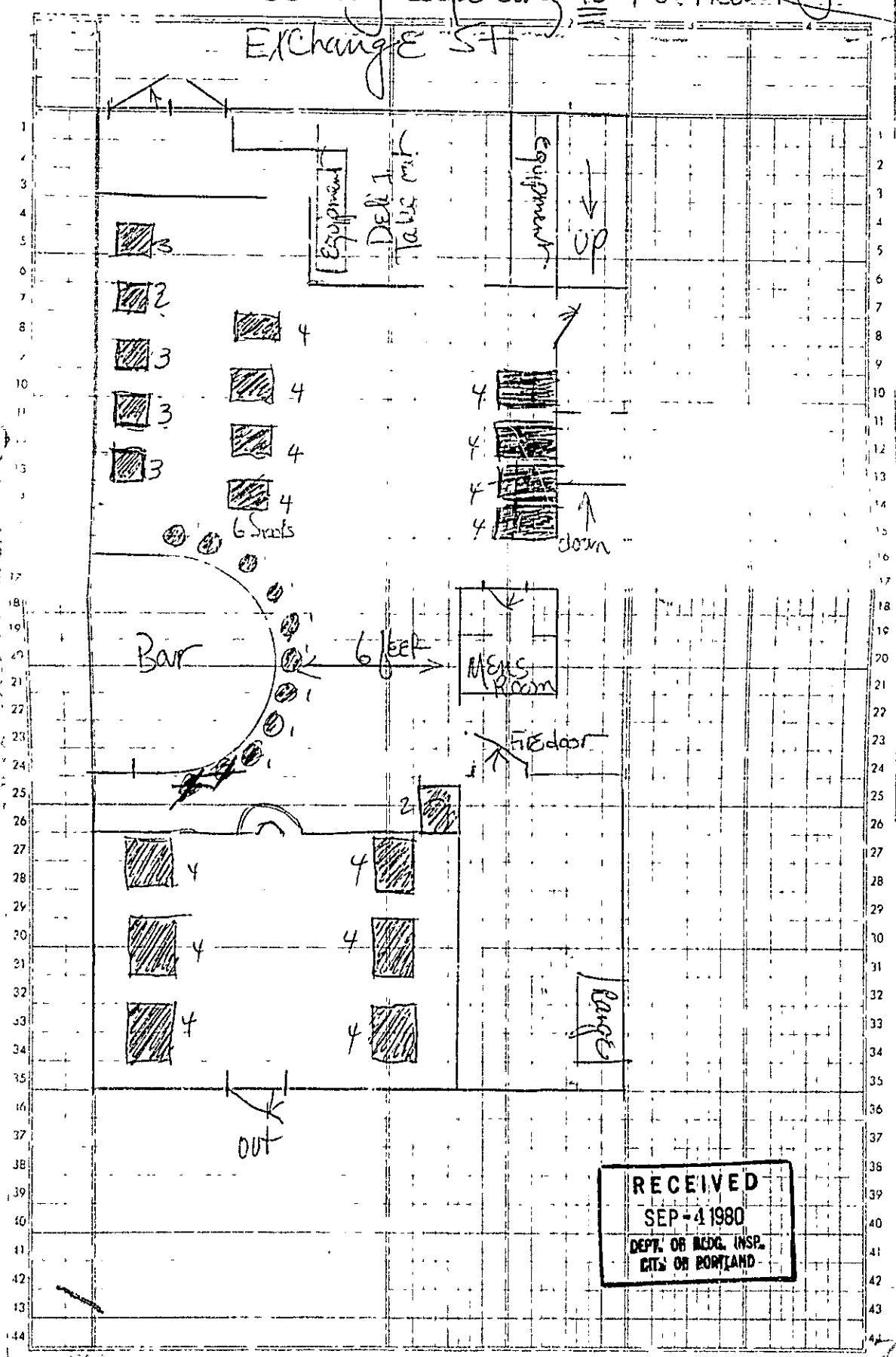

RECEIVED
 SEP-4 1980
 DEPT. OF BLDG. INSP.
 CITY OF PORTLAND



APPLICATION FOR PERMIT

PERMIT ISSUED

SEP 11 1980

00 729

CITY of PORTLAND

B.O.C.A. USE GROUP

B.O.C.A. TYPE OF CONSTRUCTION

ZONING LOCATION PORTLAND, MAINE, Sept. 4, 1980

To the DIRECTOR OF BUILDING & INSPECTION SERVICES, PORTLAND, MAINE

The undersigned hereby applies for a permit to erect, alter, repair, demolish, move or install the following building, structure, equipment or change use in accordance with the Laws of the State of Maine, the Portland B.O.C.A. Building Code and Zoning Ordinance of the City of Portland with plans and specifications, if any, submitted herewith and the following specifications:

LOCATION 106 Exchange Street Fire District #1 [] #2 []
1. Owner's name and address ... Eagles Associates ... same ... Telephone 772-9322
2. Lessee's name and address ... Telephone ...
3. Contractor's name and address ... Francis Cloutier ... 75 Gray St ... Telephone 774-5358
4. Architect ... Specifications ... Plans ... No. of sheets ...
Proposed use of building ... restaurant ... No. families ...
Last use ... same ... No. families ...
Material ... No. stories ... Heat ... Style of roof ... Roofing ...
Other buildings on same lot ...
Estimated contractual cost \$ 2,000 ... Fee \$ 10.00

FIELD INSPECTOR - Mr. GENERAL DESCRIPTION

This application is for: @ 775-5451
Dwelling ... Ext. 234
Garage ...
Masonry Bldg. ...
Metal Bldg. ...
Alterations ...
Demolitions ...
Change of Use ...
Other ...

To make alterations to already existing
restaurantas per plans. 1 sheet of
plans, no structural changes
Stamp of Special Conditions

NOTE TO APPLICANT: Separate permits are required by the installers and subcontractors of heating, plumbing, electrical and mechanicals.

PERMIT IS TO BE ISSUED TO [] 2 [] 3 [x] 4 []

Other:

DETAILS OF NEW WORK

Is any plumbing involved in this work? Is any electrical work involved in this work?
Is connection to be made to public sewer? If not, what is proposed for sewage?
Has septic tank notice been sent? Form notice sent?
Height average grade to top of plate Height average grade to highest point of roof
Size, front depth No. stories solid or filled land? earth or rock?
Material of foundation Thickness, top bottom cellar
Kind of roof Rise per foot Roof covering
No. of chimneys Material of chimneys of lining Kind of heat fuel
Framing Lumber - Kind Dressed or full size? Corner posts Sills
Size Girder Columns under girders Size Max. on centers
Studs (outside walls and carrying partitions) 2x4-16" O. C. Bridging in every floor and flat roof span over 8 feet.
Joists and rafters: 1st floor 2nd 3rd roof
On centers: 1st floor 2nd 3rd roof
Maximum span: 1st floor 2nd 3rd roof
If one story building with masonry walls, thickness of walls? height?

IF A GARAGE

No. cars now accommodated on same lot ... to be accommodated ... number commercial cars to be accommodated ...
Will automobile repairing be done other than minor repairs to cars habitually stored in the proposed building?

APPROVALS BY: DATE MISCELLANEOUS

BUILDING INSPECTION--PLAN EXAMINER Will work require disturbing of any tree on a public street? ..

ZONING:
BUILDING CODE: James P. Collins Will there be in charge of the above work a person competent
Fire Dept.: to see that the State and City requirements pertaining thereto
Health Dept.: are observed?
Others:

Signature of Applicant Francis Cloutier Phone # same
Type Name of above Francis Cloutier 1 [] 2 [] 3 [x] 4 []

Other
and Address

FIELD INSPECTOR'S COPY

NOTES

9-12-80 Completed
had someone in for permit

Permit No. 80/129
Location 106 Challenge St
Owner Eppa Carl
Date of permit 9-11-80
Approved [Signature]

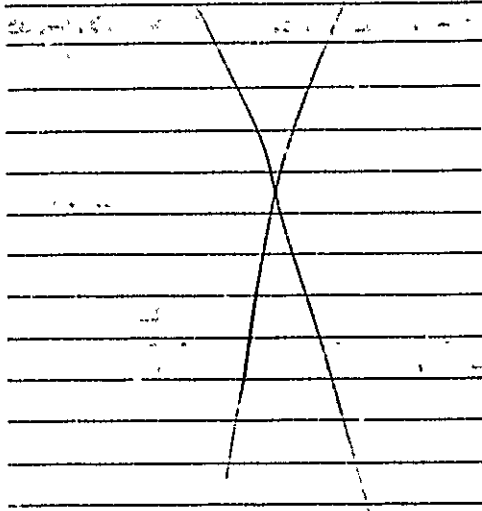



APPLICATION FOR PERMIT
DEPARTMENT OF BUILDING INSPECTIONS SERVICES
ELECTRICAL INSTALLATIONS

Date March 5, 19 79
 Receipt and Permit number A 23295

To the CHIEF ELECTRICAL INSPECTOR, Portland, Maine:

The undersigned hereby applies for a permit to make electrical installations in accordance with the laws of Maine, the Portland Electrical Ordinance, the National Electrical Code and the following specifications:

LOCATION OF WORK: 106 Exchange St.
 OWNER'S NAME: Dell I ADDRESS: same

	FEES
OUTLETS:	
Receptacles _____ Switches _____ Plugmold _____ ft. TOTAL <u>1.30</u>	<u>3.00</u>
FIXTURES: (number of)	
Incandescent _____ Fluorescent _____ (not strip) TOTAL _____	
Strip Fluorescent _____ ft. _____	
SERVICES:	
Overhead _____ Underground _____ Temporary _____ TOTAL amperes _____	
METERS: (number of) _____	
MOTORS: (number of)	
1/2 fractional _____	
1 HP or over _____	
RESIDENTIAL HEATING:	
Oil or Gas (number of units) _____	
Electric (number of rooms) _____	
COMMERCIAL OR INDUSTRIAL HEATING:	
Oil or Gas (by a main boiler) _____	
Oil or Gas (by separate units) _____	
Electric Under 20 kws _____ Over 20 kws _____	
APPLIANCES: (number of)	
Ranges _____ Water Heaters _____	
Cook Tops _____ Disposals _____	
Wall Ovens _____ Dishwashers _____	
Dryers _____ Compactors _____	
Fans _____ Others (denote) _____	
TOTAL _____	
MISCELLANEOUS: (number of)	
Branch Panels <u>1</u> _____	<u>1.00</u>
Transformers _____	
Air Conditioners Central Unit _____	
Separate Units (windows) _____	
Signs 20 sq. ft. and under _____	
Over 20 sq. ft. _____	
Swimming Pools Above Ground _____	
In Ground _____	
Fire/Burglar Alarm Residential _____	
Commercial _____	
Heavy Duty Outlets, 220 Volt (such as welders) 30 amps and under _____	
over 30 amps _____	
Circus, Fairs, etc. _____	
Alterations to wires _____	
Repairs after fire _____	
Emergency lights, battery _____	
Emergency generators _____	
FOR ADDITIONAL WORK NOT ON ORIGINAL PERMIT ... DOUBLE FEE DUE: _____	
FOR REMOVAL OF A "STOP ORDER" (304-16.b) _____	
TOTAL AMOUNT DUE:	<u>4.00</u>

INSPECTION:
 Will be ready on ready, 19 79; or Will Call _____
CONTRACTOR'S NAME: Malorano Electric
ADDRESS: 89 Murray St.
TFL.: _____
MASTER LICENSE NO.: 3065 **SIGNATURE OF CONTRACTOR:** _____
LIMITED LICENSE NO.: 2115 Thomas Malorano

INSPECTOR'S COPY — WHITE
 OFFICE COPY — CANARY
 CONTRACTOR'S COPY — GREEN

ELECTRICAL INSTALLATIONS—

Permit Number 23295

Location 106 Exchange St.

Owner Del. 1

Date of Permit 3-5-79

Final Inspection 3-5-79

By Inspector W. B. P.

Permit Application Register Page No. 18

INSPECTIONS: Service / by _____

Service called in _____

Closing-in 3-5-79 by W. B. P.

PROGRESS INSPECTIONS: _____ / _____ / _____

CODE COMPLIANCE COMPLETED DATE 3-5-79

DATE:	REMARKS:
	<u>OK</u>

W. B. P.
Inspector

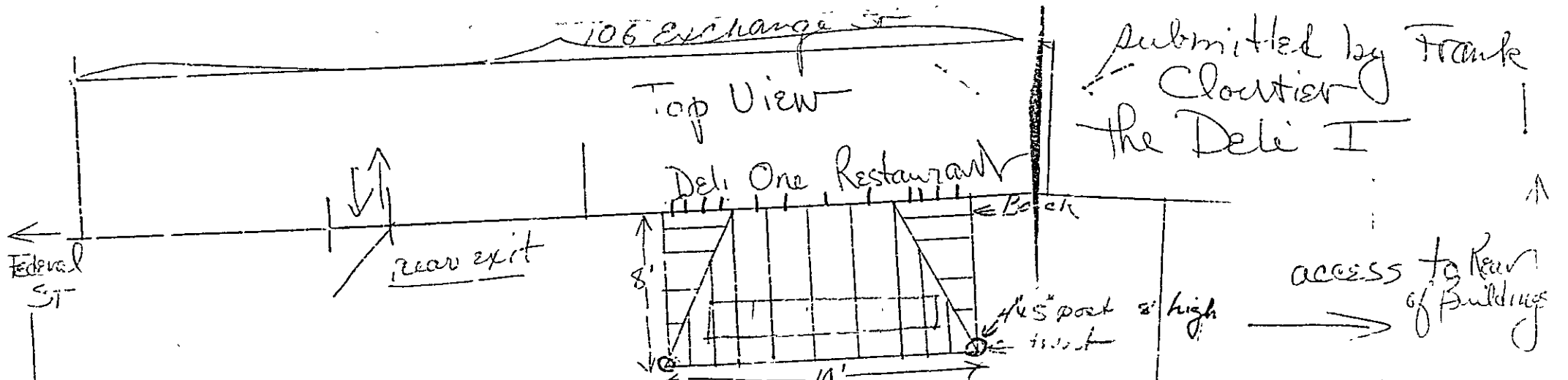

framing done in 2x4 spaced 16" off center -
 slate tile on board covering. a counter will be
 placed under reach - no ~~the~~ permanent electric
 wiring at this time.

(12) 3" lags into brick structure supporting back
 5" pitch per foot front support by 4x5 posts on concrete blocks roof is slate pieces

5' wrought iron fence with gate - fence per ored in october
 for snow removal. approved by city council

RECEIVED
 MAY - 7 1979
 DEPT. OF BLDG. INSP.
 CITY OF PORTLAND

06 Exchange

Top View

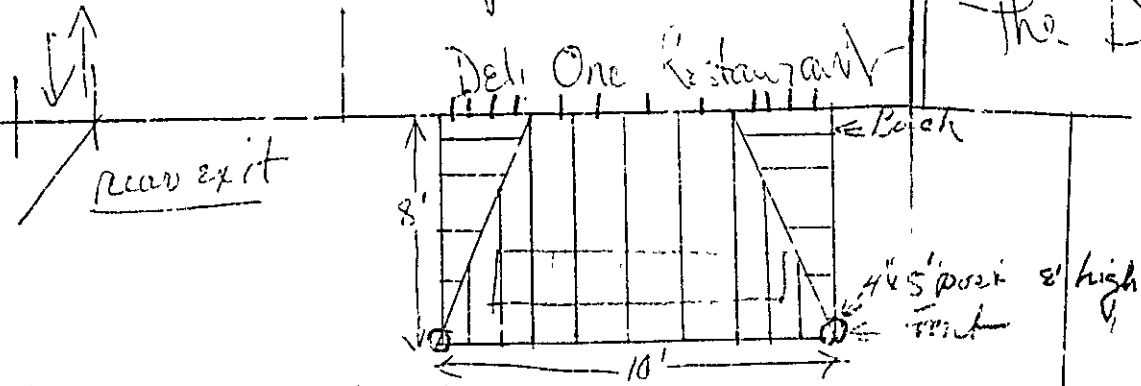

Submitted by Fran Cloutier
The Deli I

access to back of Bldg

7' fence (wood) approved by city council

Framing done in 2x1 spaced 16" off center -
slate tile on board covering. a counter will be
placed underneath - no ~~etc~~ permanent electric
wiring at this time.

2) 3" lags into brick structure supporting back -
5" pitch perfect. Front support by 4x5 posts on concrete blocks - roof is slate p.

5' wrought iron fence with gate - fence removed in october
for snow removal. approved by city council

RECEIVED
MAY - 7 1979
DEPT. OF BLDG INSP.
CITY OF PORTLAND



APPLICATION FOR PERMIT

PERMIT ISSUED

B.O.C.A. USE GROUP

B.O.C.A. TYPE OF CONSTRUCTION 000325

MAY 8 1979

ZONING LOCATION PORTLAND, MAINE, May 7, 1979

CITY of PORTLAND

To the DIRECTOR OF BUILDING & INSPECTION SERVICES, PORTLAND, MAINE

The undersigned hereby applies for a permit to erect, alter, repair, demolish, move or install the following building, structure, equipment or change use in accordance with the Laws of the State of Maine, the Portland B.O.C.A. Building Code and Zoning Ordinance of the City of Portland with plans and specifications, if any, submitted herewith and the following specifications:

LOCATION 106 Exchange St. Real. Fire District #1 #2
1. Owner's name and address Eagle Associates - same Telephone 772-9922
2. Lessee's name and address Francis Cloutier - 75 Gray St. Telephone 775-3378
3. Contractor's name and address Lessee Telephone
4. Architect Specifications Plans No. of sheets
Proposed use of building restaurant No. families
Last use same No. families
Material No. stories Heat Style of roof Roofing
Other buildings on same lot
Estimated contractual cost \$ 300 Fee \$ 5.50

FIELD INSPECTOR - Mr. GENERAL DESCRIPTION

This application is for: @ 775-5451
Dwelling Eal. 234
Garage
Masonry Bldg.
Metal Bldg.
Alterations
Demolitions
Change of Use
Other

To construct 8 x 10 covering 400
open area as per plans. 1 sheet
of plans.

Stamp of Special Conditions

Francis Cloutier C/O Deli I

NOTE TO APPLICANT: Separate permits are required by the installers and subcontractors of heating, plumbing, electrical and mechanicals.

PERMIT IS TO BE ISSUED TO 1 2 3 4

Other:

DETAILS OF NEW WORK

Is any plumbing involved in this work? Is any electrical work involved in this work?
Is connection to be made to public sewer? If not, what is proposed for sewage?
Has septic tank notice been sent? Form notice sent?
Height average grade to top of plate Height average grade to highest point of roof
Size front depth No. stories solid or filled land? earth or rock?
Material of foundation Thickness, top bottom cellar
Kind of roof Rise per foot Roof covering
No. of chimneys Material of chimneys of lining Kind of heat fuel
Framing Lumber - Kind Dressed or full size? Corner posts Sills
Size Girder Columns under girders Size Max. on centers
Studs (outside walls and carrying partitions) 2x4-16" O. C. Bridging in every floor and flat roof span over 8 feet.
Joists and rafters: 1st floor 2nd 3rd roof
On centers: 1st floor 2nd 3rd roof
Maximum span: 1st floor 2nd 3rd roof
If one story building with masonry walls, thickness of walls? height?

IF A GARAGE

No. cars now accommodated on same lot, to be accommodated number commercial cars to be accommodated
Will automobile repairing be done other than minor repairs to cars habitually stored in the proposed building?

APPROVALS BY:

DATE

MISCELLANEOUS

BUILDING INSPECTION - PLAN EXAMINER

Will work require disturbing of any tree on a public street?

ZONING:

BUILDING CODE:

Will there be in charge of the above work a person competent to see that the State and City requirements pertaining thereto are observed?

Fire Dept.:

Health Dept.:

Others:

Signature of Applicant Francis Cloutier Phone # same

Type Name of above Francis Cloutier 1 2 3 4

Other

and Address

FIELD INSPECTOR'S COPY

NOTES

5-14-79 Started banister - inside NPS double
2x4 for plate below of window. The
split 2' in from the S. side - No
work at this time - 17

5-17-79 Having them reconfigure in the
center of this 10 span - 2 3/4
of the slope on - 20

5-31-79 talked to Francis he's going to get
an amendment - to change to pay for
CIVILS - told him to get Certificate of
live proof in & submit it - 23

6-11-79 HAS sent Roof up
& deduct apply for amend
let - 24

6-2-8 HAS slid Roof
on now - 25

Permit No. 99/325
 Location 106 Exchange St - Brook
 Owner Caple Associates
 Date of permit 5-7-79
 Approved 5-8-79 E:RD
 (Signature)

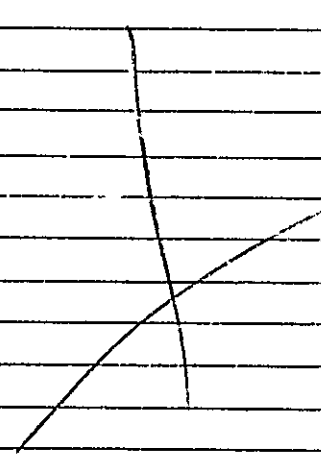

Proposed addition for Deli I
106 Exchange St

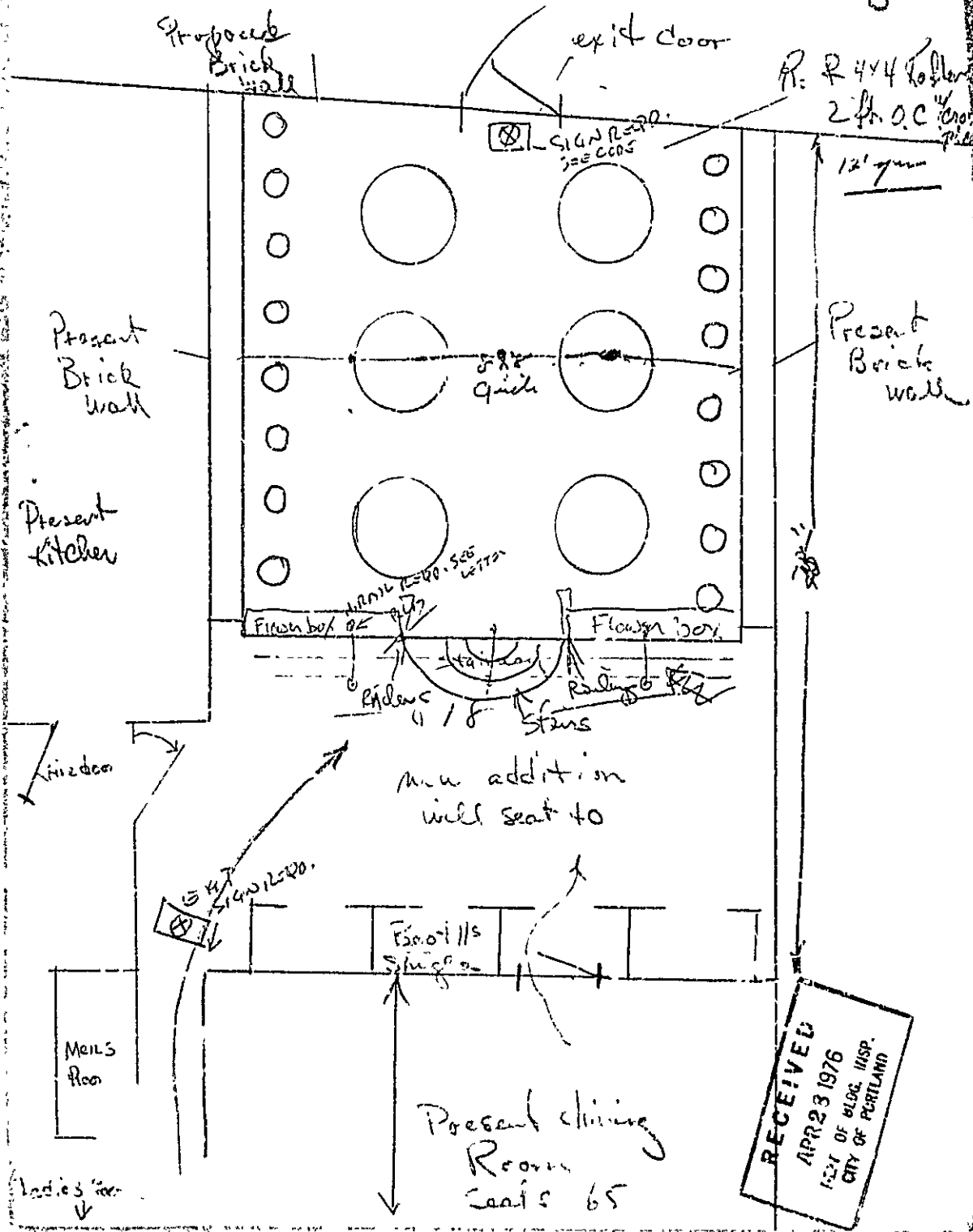

106 Exchange Street

May 10, 1976

Frank Cloutier
106 Exchange Street
Portland, ME 04111

cc: David Dulac
106 Exchange Street
Portland, ME 04111

Gentlemen:

Permit to extend an addition 18' x 25', is issued herewith, subject to the following Building Code requirements.

In order for the 8 x 8 girder to sustain the live load it will be necessary to provide 3 columns so that the effective spans will be no more than 6', instead of the full 18' as proposed.

The rear door and the door from the present dining room to the new addition are to be equipped with latch sets which will open from the inside without the use of keys, special knowledge or ability.

There appears to be 3 or 4 stairs leading from the floor to the new addition. Therefore, it will be necessary to have at least a handrail at each side, and one in the center.

ADDITIONAL EXIT SIGNS REQ - SEE FIELD INSPECTOR

Very truly yours,

Earle S. Smith
Plan Examiner

ESS/mt

Enclosure



APPLICATION FOR PERMIT

PERMIT ISSUED
MAY 11 1976
CITY OF PORTLAND

B.O.C.A. USE GROUP 0359
B.O.C.A. TYPE OF CONSTRUCTION
ZONING LOCATION B-3 PORTLAND, MAINE, April 5, 1976.

To the DIRECTOR OF BUILDING & INSPECTION SERVICES, PORTLAND, MAINE

The undersigned hereby applies for a permit to erect, alter, repair, demolish, move or install the following building, structure, equipment or change use in accordance with the Laws of the State of Maine, the Portland B.O.C.A. Building Code and Zoning Ordinance of the City of Portland with plans and specifications, if any, submitted herewith and the following specifications:

LOCATION ... 106 Exchange St. Fire District #1 #2
1. Owner's name and address .. The Deli 1 same Telephone 772-7115.
2. Lessee's name and address Telephone
3. Contractor's name and address .. David Dulac same Telephone
4. Architect Specifications Plans No. of sheets
Proposed use of building .. deli No. families
Last use No. families
Material No. stories Heat Style of roof Roofing
Other buildings on same lot
Estimated contractual cost \$... 2,000. Fee \$.. 8.00 ~~5.00~~ pd.

FIELD INSPECTOR—Mr. Marge GENERAL DESCRIPTION
This application is for: @ 775-5451 ~~XXXXXXXXXXXX~~
Dwelling Ext. 234 To extend an addition 18ft. as per plans
Garage
Masonry Bldg.
Metal Bldg.
Alterations
Demolitions
Change of Use
Other

PERMIT ISSUED WITH LETTER

Stamp of Special Conditions

NOTE TO APPLICANT. Separate permits are required by the installers and subcontractors of heating, plumbing, electrical and mechanicals.

PERMIT IS TO BE ISSUED TO 1 2 3 4

Other:

DETAILS OF NEW WORK

Is any plumbing involved in this work? Is any electrical work involved in this work? ... yes
Is connection to be made to public sewer? If not, what is proposed for sewage?
Has septic tank notice been sent? Form notice sent?
Height average grade to top of plate Height average grade to highest point of roof
Size, front depth No. stories solid or filled land? earth or rock?
Material of foundation Thickness, top bottom cellar
Kind of roof Rise per foot Roof covering
No. of chimneys Material of chimneys of lining Kind of heat fuel
Framing Lumber—Kind Dressed or full size ? Corner posts Sills
Size Girder Columns under girders Size Max. on centers
Studs (outside walls and carrying partitions) 2x4-16" O. C. Bridging in every floor and flat roof span over 8 feet.
Joists and rafters: 1st floor, 2nd, 3rd, roof
On centers: 1st floor, 2nd, 3rd, roof
Maximum span: 1st floor, 2nd, 3rd, roof
If one story building with masonry walls, thickness of walls? height?

IF A GARAGE

No. cars now accommodated on same lot ... , to be accommodated ... number commercial cars to be accommodated ...
Will automobile repairing be done other than minor repairs to cars habitually stored in the proposed building?

APPROVALS BY: DATE MISCELLANEOUS
BUILDING INSPECTION—PLAN EXAMINER Will work require disturbing of any tree on a public street? ..
ZONING:
BUILDING CODE: O.K. E.H. 5/7/76 Will there be in charge of the above work a person competent
Fire Dept. Clement O. Dold to see that the State and City requirements pertaining thereto
Health Dept.: are observed? ... Yes.
Others:

Signature of Applicant Frank Cloutier Phone #
Type Name of above ... Frank Cloutier 1 2 3 4

FIELD INSPECTOR'S COPY

Other
and Address

NOTES

7-12-76 Not started yet except for very minor work - also notified them that sign on the sidewalk must be removed

8-2-76 started work - poured foundation wall changing plans - End of char. knob with ball. Now use a 6x6 girder with side supports & 4x4 rafters, - M.S.

8-23-76 brick work already completed - ceiling completed - getting ready to install skylight - did some work in basement which needs a permit - M.S.

9-21-76 completed putting in hardware - exit signs & white lights etc - M.S.

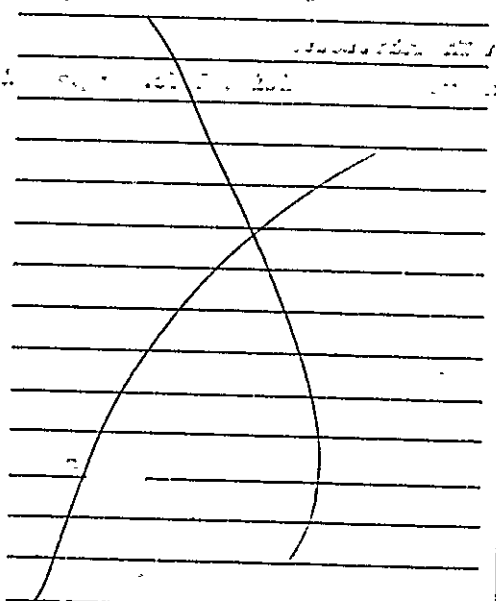

Permit No. 76/1359
Location 116 Delaware
Owner D. L. ...
Date of permit 5/11/76
Approved Addition on back

A series of horizontal lines on the right side of the page, likely serving as a table or a list of items. There are approximately 20 lines, with some lines having small vertical tick marks or marks next to them. The lines are evenly spaced and extend across the width of the page.

CITY OF PORTLAND, MAINE
MEMORANDUM

TO: R. Lovell Brown, Director of Building and Inspection Services
FROM: Michael C. Wing, Assistant City Manager
SUBJECT: Council Order #356

DATE: 6/7/77

This memorandum will formally notify you that the City Council at their afternoon meeting of June 6, 1977 agreed to Council Order #356 which permitted the erection of a banner type sign at 106 Exchange Street.

Please see that the Council Order is acted upon as soon as possible.

Michael C. Wing
Assistant City Manager

MCW/cb

Attachment

*Received
6/7/77
R. L. B.*
*Sent in C. L.
FOR BROWN SIGN
AND USE*

City of Portland, Maine

IN BOARD OF MUNICIPAL OFFICERS

#356

ORDERED, by the Municipal Officers of the City of Portland, assembled and constituted as a Board of Appeal under Municipal Code Chapter 301 (Building Code) Section 301.7,

That BOCA Section 1412 is hereby waived with regard to this appeal and the Director of Building Inspections is hereby authorized and directed to issue a permit for erection of a sign at 106 Exchange Street, as per the attached plan, upon furnishing of bond or liability insurance pursuant to BOCA Section 1407 as amended.

CITY OF PORTLAND, MAINE
MEMORANDUM

7: 53 1977
03000

TO: A.J. Wilson, City Manager- Att: Mike Wing, Asst. Mgr.

DATE: 5-26-77

FROM: R. Lovell Brown, Director of Bldg. & Insp. Services

SUBJECT: Banner Sign @ 106 Exchange St.
Building Code Appeal to Municipal Officers

Please prepare for Council agenda as per following:

A permit application with requesting letter has been made to the Building Inspection Services for the installation and use of a permanent banner sign @ 106 Exchange St. - "The Deli".

STATEMENT OF FACTS

The sign & display section on Banners, Sec. 1414.2 of the BOCA Code, only allows banners of cloth to be used as temporary for a period of not over 60 days.

The request of this applicant is for permanent use and installation.

Based on the Code, this department must deny use and applicant has requested, by letter, a building code appeal to the Municipal Officers.

Approved:

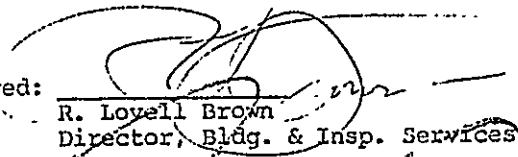
R. Lovell Brown
Director, Bldg. & Insp. Services

Approved:

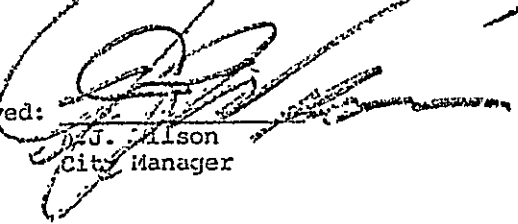
A.J. Wilson
City Manager

5-24-77

10 DEERING STREET
PORTLAND, ME 04101

RECEIVED

MAY 25 1977

DEPT. OF BLDG. INSP.
CITY OF PORTLAND

Appeal to the City Council for
Permanent canvas sign. Signs proposed
should be constructed of 3 layers of
light weight canvas sewn together with
other colored canvas pieces into design.
Such design is called an "applique".
Canvas will be treated to make it
waterproof and fireproof. Such sign to
be hung from pipe built into upper
part of sign to structure of building
on 106 Exchange St. Suspend by
medium gauge wires at 3 locations
from iron pipe.

BRADLEY L. ...

10 ... STREET
PORTLAND, OREGON 97101

Diagram of Proposed Sign:

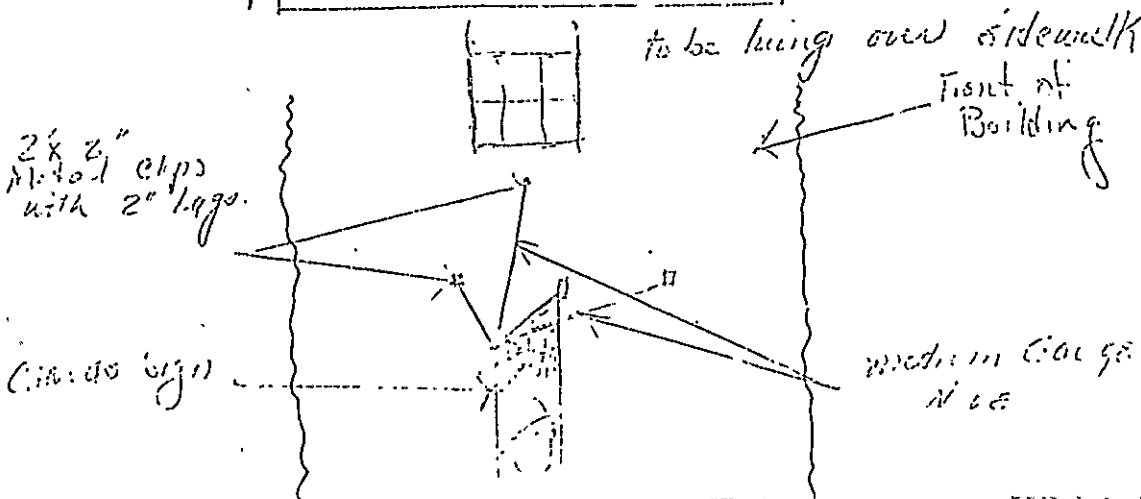
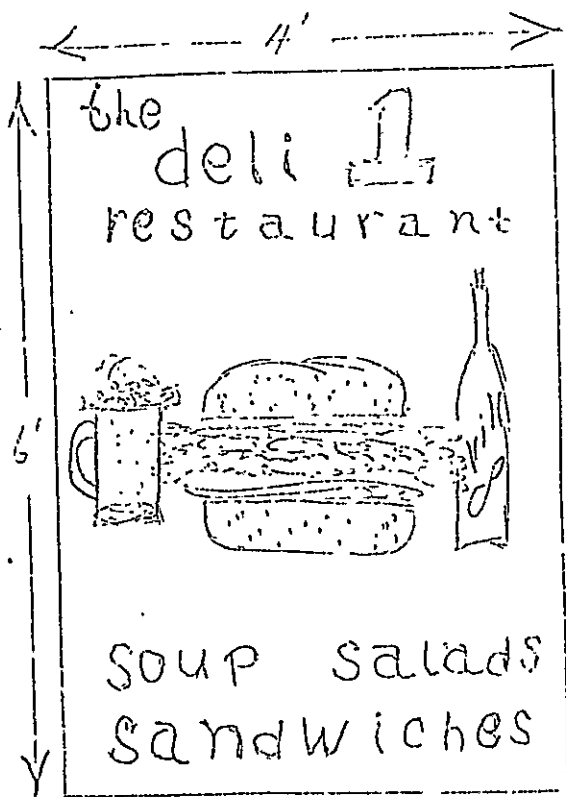

106 Exchange St.

May 19, 1977

Mr. Francis R. Cloutier
10 Dering Street
Portland ME 04101

Dear Mr. Cloutier:

This Department is prevented from issuing a permit for a permanent banner to be suspended from the present sign, under section 1217.2 of the MCA Building Code which specifically says that, "temporary signs and banners attached to or suspended from a building, constructed of cloth or other combustible material, shall be strongly constructed and shall be securely attached to their supports. They shall be removed as soon as torn or damaged, and not later than 60 days after erection, except that permits for temporary signs suspended from or attached to a canopy or awnings, etc., shall be limited to a period of 10 days".

If it is your wish to erect a temporary instead of a permanent banner, please contact this office and so state and then appropriate action will be taken to issue permit.

Very truly yours

Eric S. Smith
Plan Examiner

RCS:cm

106 Exchange St.

April 21, 1977

Mr. Frank Cloutier
Deli - I
106 Exchange Street
Portland ME

Dear Mr. Cloutier

If you wish to make application for a banner or cloth sign, then Section 414.2 of the B.O.C.A. Building Code restricts the use of such a sign to a temporary status, 60 days, after erecting such a sign it must be removed. In other words, this office is unable to issue a permit for such a banner or cloth sign on a permanent basis. Please bear in mind that even for a temporary banner it must have a certificate of flame resistance and be at least ten feet above the public sidewalk.

If you desire such a sign to be permanent, then it would be necessary to institute a Building Code appeal which would necessitate bringing the matter to the municipal officers for their consideration.

Very truly yours

Earlo S. Smith
Plan Examiner

BSS:cm

~~Schmitt~~
Tuesday Schmitt

112 Winter St
Portland
774 1222

106 X-chng

Frank Cloutier
Deli I
772 7115 -



4x6"

FRANCIS R. CLOUTIER

5-24-77

10 DEERING STREET
PORTLAND, MAINE 04101



Appeal to the City Council for
permanent canvas sign. Signs proposed
should be constructed of 3 layers of
light weight canvas sewn together with
other colored canvas pieces into design.
Such design is called an "applique".
Canvas will be treated to make it
waterproof and fireproof. Such sign to
be hung from pipe built into upper
part of sign to structure of building
on 106 Exchange St. suspended by
medium gauge wires at 3 locations
from iron pipe.

FRANCIS R. CLOUTIER

10 D'ERING STREET
PORTLAND, MAINE 04101

Diagram of Proposed sign:

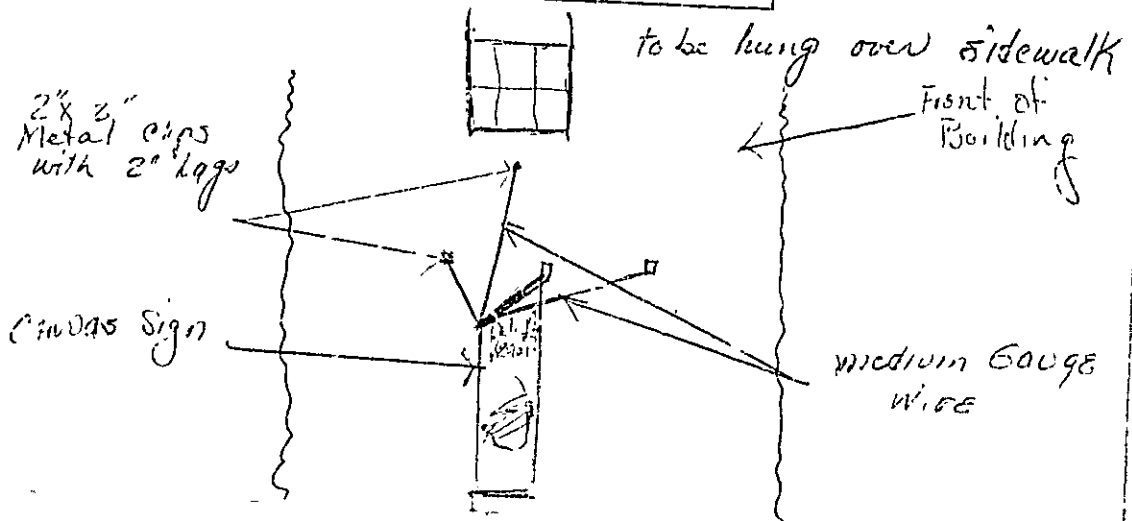
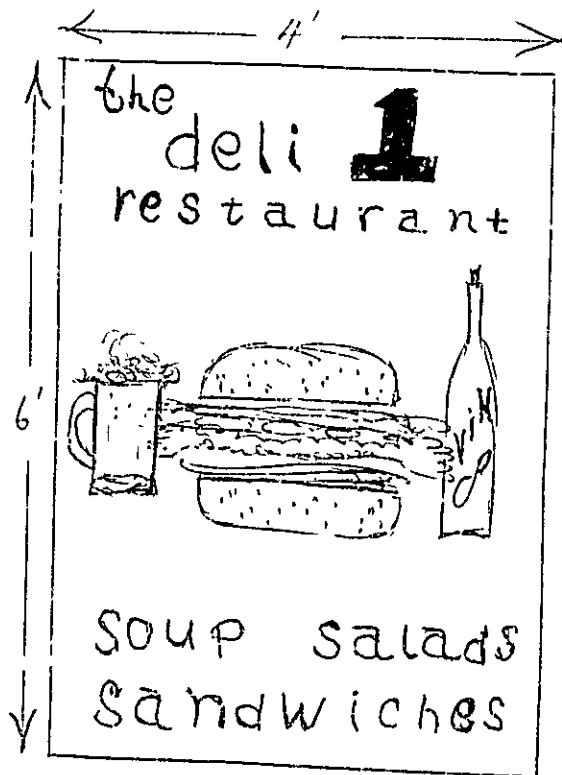

106 Exchange St.

May 19, 1977

Mr. Francis R. Cloutier
10 Deering Street
Portland ME 04101

Dear Mr. Cloutier

This Department is prevented from issuing a permit for a permanent banner to be suspended from the present sign, under Section 1414.2 of the BOCA Building Code which specifically says that, "temporary signs and banners attached to or suspended from a building, constructed of cloth or other combustible material, shall be strongly constructed and shall be securely attached to their supports. They shall be removed as soon as torn or damaged, and not later than 60 days after erection, except that permits for temporary signs suspended from or attached to a canopy or marquis, etc., shall be limited to a period of 10 days".

If it is your wish to erect a temporary instead of a permanent banner, please contact this office and so state and then appropriate action will be taken to issue permit.

Very truly yours

Earle S. Smith
Plan Examiner

BSS:cc



APPLICATION FOR PERMIT

PERMIT ISSUED

JUN 7 1977

B.O.C.A. USE GROUP

B.O.C.A. TYPE OF CONSTRUCTION 0442

ZONING LOCATION PORTLAND, MAINE, May 11, 1977

CITY of PORTLAND

To the DIRECTOR OF BUILDING & INSPECTION SERVICES, PORTLAND, MAINE

The undersigned hereby applies for a permit to erect, alter, repair, demolish, move or install the following building, structure, equipment or change use in accordance with the Laws of the State of Maine, the Portland B.O.C.A. Building Code and Zoning Ordinance of the City of Portland with plans and specifications, if any, submitted herewith and the following specifications:

LOCATION: 106 Exchange St. Fire District #1 [], #2 []
1. Owner's name and address ... Telephone ...
2. Lessee's name and address Francis Cloutier- 10 Deering St. Telephone 772-7115
3. Contractor's name and address ... Telephone ...
4. Architect ... Specifications ... Plans ... No. of sheets ...
Proposed use of building restaurant No. families ...
Last use ... No. families ...
Material ... No. stories ... Heat ... Style of roof ... Roofing 5-25-

FIELD INSPECTOR—Mr. GENERAL DESCRIPTION

This application is for: @ 775-5451 Ext. 234 Permit to erect permanent banner not attached to bldg. suspended from present sign 6 ft. x 4 ft.

Fee \$.. 7.40 pd. to be appealed no-fee paid TO MEMBERS OFFICERS BUILDING CLUB

Stamp of Special Conditions

NOTE TO APPLICANT: Separate permits are required by the installers and subcontractors of heating, plumbing, electrical and mechanicals.

PERMIT IS TO BE ISSUED TO 1 [] 2 [x] 3 [] 4 []

Other:

DETAILS OF NEW WORK

Is any plumbing involved in this work? Is any electrical work involved in this work?
Is connection to be made to public sewer? If not, what is proposed for sewage?
Has septic tank notice been sent? Form notice sent?
Height average grade to top of plate Height average grade to highest point of roof
Size, front depth No. stories solid or filled land? earth or rock?
Material of foundation Thickness, top bottom cellar
Kind of roof Rise per foot Roof covering
No. of chimneys Material of chimneys of lining Kind of heat fuel
Framing Lumber—Kind Dressed or full size? Corner posts Sills
Size Girder Columns under girders Sills Max. on centers
Studs (outside walls and carrying partitions) 2x4-16" O. C. Bridging in every floor and flat roof span over 8 feet.
Joists and rafters: 1st floor 2nd 3rd roof
On centers: 1st floor 2nd 3rd roof
Maximum span: 1st floor 2nd 3rd roof
If one story building with masonry walls, thickness of walls? height?

IF A GARAGE

No. cars now accommodated on same lot ..., to be accommodated ... number commercial cars to be accommodated ...
Will automobile repairing be done other than minor repairs to cars habitually stored in the proposed building?

APPROVALS BY: DATE

MISCELLANEOUS

BUILDING INSPECTION—PLAN EXAMINER Will work require disturbing of any tree on a public street? ..

ZONING:

BUILDING CODE: 0.15. 2.8. 6/7/77 Will there be in charge of the above work a person competent

Fire Dept.: to see that the State and City requirements pertaining thereto

Health Dept.: are observed?

Others:

Signature of Applicant: Francis R. Cloutier Phone # same

Type Name of above Francis Cloutier 1 [] 2 [x] 3 [] 4 []

Other

and Address

FIELD INSPECTOR'S COPY

1.66

NOTES

8-4-77 banner set erected - W S

9-12-77 banner up - W S

Permit No. 77/1044
Location 18th & Highland
Owner Thomas Plunkett
Date of permit 5-11-77
Approved 6-9-77 C. K. Banner

~~Notes~~

Notes



APPLICATION FOR PERMIT
 DEPARTMENT OF BUILDING INSPECTIONS SERVICES
 ELECTRICAL INSTALLATIONS

Date Aug. 24, 1976
 Receipt and Permit number A 1775

To the CHIEF ELECTRICAL INSPECTOR, Portland, Maine:

The undersigned hereby applies for a permit to make electrical installations in accordance with the laws of Maine, the Portland Electrical Ordinance, the National Electrical Code and the following specifications:

LOCATION OF WORK: 106 Exchange St.
 OWNER'S NAME: Robert Scott ADDRESS: same

OUTLETS: (number of)
 Lights _____
 Receptacles 1 to 30 FEES _____
 Switches _____
 Plugmold _____ (number of feet) _____
 TOTAL _____ 3.00

FIXTURES: (number of)
 Incandescent _____
 Fluorescent _____ (Do not include strip fluorescent)
 TOTAL _____
 Strip Fluorescent, in feet _____

SERVICES:
 Permanent, total amperes _____
 Temporary _____

METERS: (number of) _____

MOTORS: (number of)
 Fractional _____
 1 HP or over _____

RESIDENTIAL HEATING:
 Oil or Gas (number of units) _____
 Electric (number of rooms) _____

COMMERCIAL OR INDUSTRIAL HEATING:
 Oil or Gas (by a main boiler) _____
 Oil or Gas (by separate units) _____
 Electric (total number of kws) _____

APPLIANCES: (number of)
 Ranges _____ Water Heaters _____
 Cook Tops _____ Disposals _____
 Wall Ovens _____ Dish washers _____
 Dryers _____ Compactors _____
 Fans _____ Others (denote) _____
 TOTAL _____

MISCELLANEOUS: (number of)
 Branch Panels _____
 Transformers _____
 Air Conditioners _____
 Signs _____
 Fire/Burglar Alarms _____
 Circus, Fairs, etc. _____
 Alterations to wires _____
 Repairs after fire _____
 Heavy Duty, 220v outlets _____
 Emergency Lights, battery _____
 Emergency Generators _____

INSTALLATION FEE DUE: 3.00

FOR ADDITIONAL WORK NOT ON ORIGINAL PERMIT DOUBLE FEE DUE: _____

FOR REMOVAL OF A "STOP ORDER" (304-16.b) _____

FOR PERFORMING WORK WITHOUT A PERMIT (304-9) .. _____

TOTAL AMOUNT DUE: 3.00

INSPECTION:
 Will be ready on today, 19__; or Will Call _____

CONTRACTOR'S NAME: Tom Maiorano
 ADDRESS: 89 Murray St.
 TEL.: 774-3572

MASTER LICENSE NO.: 7235

SIGNATURE OF CONTRACTOR:
Thomas Maiorano

LIMITED LICENSE NO.: _____

INSPECTOR'S COPY

ELECTRICAL INSTALLATIONS —

INSPECTIONS: Service _____ by _____

Service called in _____

Closing-in _____ by _____

PROGRESS INSPECTIONS: P-24-76 / _____
_____ / _____
_____ / _____
_____ / _____

**CODE
COMPLIANCE
COMPLETED
DATE P-24-76**

Permit Number 7775
Location 106 Exchange St.
Owner Robert Seibert
Date of Permit P-24-76
Final Inspection P-24-76
By Inspector [Signature]
Permit Application Register Page No. 69

DATE:	REMARKS:

[Handwritten Signature]

RECEIVED BY
DATE
OFFICE



APPLICATION FOR PERMIT
DEPARTMENT OF BUILDING INSPECTIONS SERVICES
ELECTRICAL INSTALLATIONS

Date June 24, 1976, 19____
 Receipt and Permit number A-1704

To the CHIEF ELECTRICAL INSPECTOR, Portland, Maine

The undersigned hereby applies for a permit to make electrical installations in accordance with the laws of Maine, the Portland Electrical Ordinance, the National Electrical Code and the following specifications:

LOCATION OF WORK: 106 Exchange St.
 OWNER'S NAME: Robert Scott, ADDRESS: same

OUTLETS: (number of)

Lights	_____	
Receptacles	_____	FEES
Switches	_____	
Plug-n-hold	_____ (number of feet)	
TOTAL	_____	_____

FIXTURES: (number of)

Incandescent	_____	
Fluorescent	_____ (Do not include strip fluorescent)	
TOTAL	_____	_____
Strip Fluorescent, in feet	_____	_____

SERVICES:

Permanent, total amperes	_____	_____
Temporary	_____	_____

METERS: (number of) _____

MOTORS: (number of)

Fractional	_____	_____
1 HP or over	_____	_____

RESIDENTIAL HEATING:

Oil or Gas (number of units)	_____	_____
Electric (number of rooms)	_____	_____

COMMERCIAL OR INDUSTRIAL HEATING:

Oil or Gas (by a main boiler)	_____	_____
Oil or Gas (by separate units)	_____	_____
Electric (total number of kws)	_____	_____

APPLIANCES. (number of)

Ranges	_____	Water Heaters	_____
Cook Tops	_____	Disposals	_____
Wall Ovens	_____	Dishwashers	_____
Dryers	_____	Compactors	_____
Fans	_____	Others (denote)	_____
TOTAL	_____		_____

MISCELLANEOUS: (number of)

Branch Panels	_____	
Transformers	_____	
Air Conditioners	<u>1</u>	2.00
Signs	_____	
Fire/Burglar Alarms	_____	
Circus, Fairs, etc	_____	
Alterations to wires	_____	
Repairs after fire	_____	
Heavy Duty, 220v outlets	_____	
Emergency Lights, battery	_____	
Emergency Generators	_____	

INSTALLATION FEE DUE: _____
 FOR ADDITIONAL WORK NOT ON ORIGINAL PERMIT DOUBLE FEE DUE: _____
 FOR REMOVAL OF A "STOP ORDER" (304- 6b) _____
 FOR PERFORMING WORK WITHOUT A PERMIT (304-9) _____
 TOTAL AMOUNT DUE: 3.00

INSPECTION:
 Will be ready on ready, 19____; or Will Call _____
 CONTRACTOR'S NAME: Thomas E. Maiorano
 ADDRESS: 89 Murry St.
 TEL.: 774-3572
 MASTER LICENSE NO.: 125 SIGNATURE OF CONTRACTOR: Thomas E. Maiorano
 LIMITED LICENSE NO.: _____

ELECTRICAL INSTALLATIONS

INSPECTIONS: Service _____ by _____
Service called in _____
Closing-in _____ by _____

PROGRESS INSPECTIONS: 6-24-76 / _____
/ _____
/ _____
/ _____
/ _____

Permit Number 1709
Location 116 E. 8th St. - 5th
Owner Robert Scott
Date of Permit 6-24-76
Final Inspection 6-24-76
By Inspector R. L. G. G.
Permit Application Register Page No. 62

**CODE
COMPLIANCE
COMPLETED**
DATE 6-24-76

DATE:	REMARKS:
	OK

Robert Scott

Deli I
106 Exchange St.

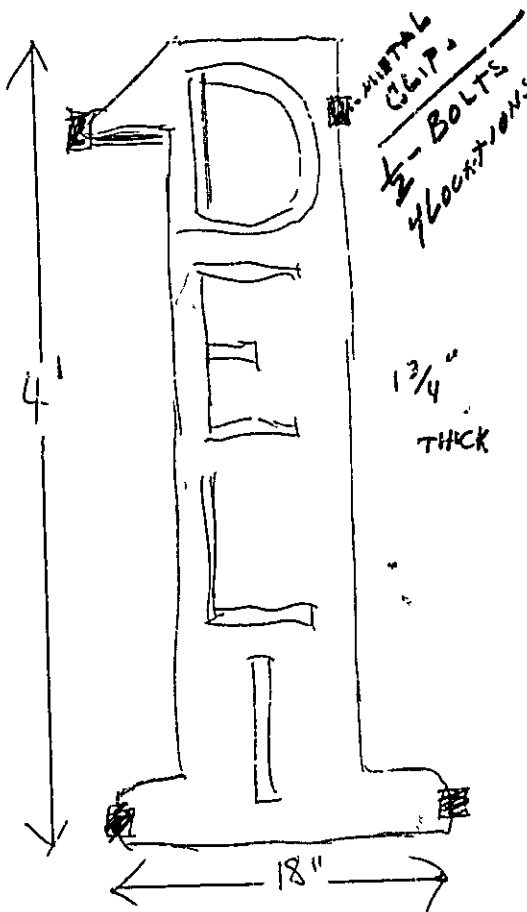

attached with
metal bars with clips
bolted into cement
wall.

RECEIVED
JAN 5 1976
DEPT. OF BLDG. INSP.
CITY OF PORTLAND



APPLICATION FOR PERMIT

PERMIT ISSUED

FEB 6 1976

B.O.C.A. USE GROUP B.O.C.A. TYPE OF CONSTRUCTION 0068

ZONING LOCATION B-3 PORTLAND, MAINE, Jan. 5, 1976

CITY of PORTLAND

To the DIRECTOR OF BUILDING & INSPECTION SERVICES, PORTLAND, MAINE

The undersigned hereby applies for a permit to erect, alter, repair, demolish, move or install the following building, structure, equipment or change use in accordance with the Laws of the State of Maine, the Portland B.O.C.A. Building Code and Zoning Ordinance of the City of Portland with plans and specifications, if any, submitted herewith and the following specifications:

LOCATION 106 Exchange Street Fire District #1 [], #2 []
1. Owner's name and address Eagles Assoc, same Telephone
2. Lessee's name and address Frank Cloutier, Box 109, Cape Porpoise Telephone 772-7116
3. Contractor's name and address Telephone
4. Architect Specifications Plans No. of sheets 1
Proposed use of building Delacatessen No families
Last use restaurant No families
Material No. stories 4 Heat Style of roof Roofing
Other buildings on same lot
Estimated contractual cost \$ Fee \$ 5.00

FIELD INSPECTOR—Mr. GENERAL DESCRIPTION
This application is for. @ 775-5451 To erect sign, 4' x 18" as per plan
to be attached to cement by 2 bars
with clips.
Dwelling Ext. 234
Garage
Masonry Bldg.
Metal Bldg. Stamp of Special Conditions
Alterations
Demolitions
Change of Use
Other

NOTE TO APPLICANT: Separate permits are required by the installers and subcontractors of heating, plumbing, electrical and mechanicals.

PERMIT IS TO BE ISSUED TO 1 [] 2 [x] 3 [] 4 []
Other:

DETAILS OF NEW WORK

Is any plumbing involved in this work? Is any electrical work involved in this work?
Is connection to be made to public sewer? If not, what is proposed for sewage?
Has septic tank notice been sent? Form notice sent?
Height average grade to top of plate Height average grade to highest point of roof
Size, front depth No. stories solid or filled land? earth or rock?
Material of foundation Thickness, top bottom cellar
Kind of roof Rise per foot Roof covering
No. of chimneys Material of chimneys of lining Kind of heat fuel
Framing Lumber—Kind Dressed or full size? Corner posts Sills
Size Girder Columns under girders Size Max. on centers
Studs (outside walls and carrying partitions) 2x4-16" O. C. Bridging in every floor and flat roof span over 8 feet.
Joists and rafters: 1st floor, 2nd, 3rd, roof
On centers: 1st floor, 2nd, 3rd, roof
Maximum span: 1st floor, 2nd, 3rd, roof
If one story building with masonry walls, thickness of walls? height?

IF A GARAGE

No. cars now accommodated on same lot, to be accommodated number commercial cars to be accommodated
Will automobile repairing be done other than minor repairs to cars habitually stored in the proposed building?

APPROVALS BY: DATE MISCELLANEOUS
BUILDING INSPECTION—PLAN EXAMINER Will work require disturbing of any tree on a public street?
ZONING: AR. M.G.D. 2/3/76
BUILDING CODE: Will there be in charge of the above work a person competent
Fire Dept.: to see that the State and City requirements pertaining thereto
Health Dept.: are observed? Yes
Others:

Signature of Applicant Frank Cloutier Phone #

Type Name of above Frank Cloutier 1 [] 2 [x] 3 [] 4 []

FIELD INSPECTOR'S COPY

Other and Address

PERMIT INFORMATION

NOTES

2-13-76 not installed - *MD*
2-23-76 installed as per plans - *MD*

Permit No. 76/1008
Location 1110 West...
Owner ...
Date of permit Feb. 11, 1976
Approved _____

Large grid area with horizontal and vertical lines, mostly blank with some faint markings.

106
SMP

WOODWORTH & CLARK

ALL FORMS OF INSURANCE

309 Cumberland Avenue Windham Branch
Portland, Maine 04104 North Windham, Me. 04062
774-6257 892-8541

Effective date 2/2/76 Days effective 60

Ins. Co. USF&G
Type of Risk: Apt. ; Off. ; Processor ;
Motel ; Merc. ; Inst.
Interested in Premises as: Lessee
Description of Business Delicatessen

INSURED'S NAME AND MAILING ADDRESS

SMP
BINDER

Bel I
106 Exchange Street
Portland, Maine 04111

Location of Risk 106 Exchange Street,
Portland, Maine
Mortgage none
Applicable Forms MLB 100, 143, 121, 123,
Applicable Loss Deductible: Cl. No. 1. (wind, 200
hail) ; Cl. No. 2. (Other Perils)
Insurance is 100 % of total insurance.

Pending the issuance of a Policy, and in consideration of the stipulation herein contained, the Company listed above is hereby bound to the insured for a maximum of 30 days, and fewer if so stipulated under "days effective," from noon (standard time) on the effective date until noon (standard time) on the date of expiration.

Section I Property Coverage Amt. of Ins.

Cov. A—Bldg(s) % Coinsurance \$ _____

Cov. B—Pers. Prop. Rptg Non-Rptg \$ 22,000

Improvements and Betterments \$ _____

Loss of Rents \$ _____

Extra Expense \$ _____

B. I. (MLB 143 - Loss of Earnings) \$ 10,000

Theft \$ _____

Burglary \$ _____

Optional Perils \$ 22,000

All Risk: Building ; Contents

Optional Coverages Amt. of Ins.

Additional Coverage Endorsement \$ _____

Vandalism, Malicious Mischief \$ 22,000

Glass \$ _____

Boiler & Machinery \$ _____

I. M. (_____) \$ _____

Signs (_____) \$ _____

Sprinkler Leakage \$ _____

Empl. Non-Own. Liab. \$ _____

Builder's Risk Limit \$ _____

Location: _____

Comprehensive Crime

Insuring Agreement I A \$ _____

Insuring Agreement I B \$ _____

Insuring Agreement II

Money & Securities \$ _____

Securities only \$ _____

Insuring Agreement III

Money & Securities \$ _____

Securities only \$ _____

Insuring Agreement IV \$ _____

Insuring Agreement V \$ _____

Section II Liability Coverage

Limits of Liability

Cov. C, Liab. (Dual Limits) B.I. \$ _____ per person \$ _____ per occurrence

P.D. \$ _____ per occurrence \$ _____ aggregate

(Single Limit) \$ 300,000 per occurrence \$ 300,000 aggregate

Prod.-Completed Op. (Dual Limits) B.I. \$ _____ per person \$ _____ per occ. \$ _____ agg.

P.D. \$ _____ per occurrence \$ _____ aggregate

(Single Limit) \$ 300,000 per occurrence \$ 300,000 aggregate

Cov. D, Medical Payments \$ 250 per person \$ 10,000 per accident

Pers. Injury-Hazards A B C

Full Coverage or % Participation \$ _____ per person agg. \$ _____ endorsement aggregate

CPL SKL CGL ELEV. COLL. OTHER _____

It is expressly stipulated that this binder is issued subject to a. the terms and conditions of the policy regularly issued by the Company in the state in which the operation or property is located, which policy is hereby made a part hereof to the same extent as if fully set forth herein; and to the payment of such premium as may be found to be due to this Company, which premium, in the event of loss before expiration of this binder, shall be fixed at the full annual premium for the sum insured.

It is a condition of this binder that whenever the Policy of this Company is issued in lieu of its undertaking under this binder, its obligations hereunder shall cease and be void; provided, however, that this binder shall not continue in force beyond the expiration date stated herein. In no event shall this binder continue in force beyond thirty (30) days from the effective date of this binder. This binder is made and accepted subject to the foregoing stipulations and conditions and shall not be valid unless countersigned by the duly authorized agent of this Company.

When more than one Company is named in this binder, the above stipulations apply separately to each Company.

Countersigned on the effective date shown above at: Portland, Maine

By: [Signature]

Policyholder—White
(Not applicable in Kansas)

Company—Blue

Bureau—Gold

Agency—Pink

October 29, 1975

Eagle Associates
106 Exchange Street
Portland, ME 04111

RE: 106 Exchange Street

Gentlemen:

Permit to remove an existing fire escape on the front of your building is being issued herewith, provided no story above the second will be used for assembly purposes.

In a conversation with Mr. Shea, on the site, he is to have the doors to the floors above the second effectively cut off from the lower two stories.

Very truly yours,

Earle Smith
Plan Examiner

ES/mj

Enclosures



APPLICATION FOR PERMIT

B.O.C.A. USE GROUP

B.O.C.A. TYPE OF CONSTRUCTION

PLACING LOCATION _____ PORTLAND, MAINE, ... Oct. 29, 1975

PERMIT ISSUED
OCT 29 1975
960
CITY of PORTLAND

By the DIRECTOR OF BUILDING & INSPECTION SERVICES, PORTLAND, MAINE.

The undersigned hereby applies for a permit to erect, alter, repair, demolish, move or install the following building, structure, equipment or change use in accordance with the Laws of the State of Maine, the Portland B.O.C.A. Building Code and any Ordinance of the City of Portland with plans and specifications, if any, submitted herewith and the following specifications:

LOCATION 106 Exchange St. Fire District #1 [], #2 []
Owner's name and address Eagle Associates same Telephone 772-9322
Lessee's name and address Telephone
Contractor's name and address To be lat Telephone
Architect Specifications Plans No. of sheets
Proposed use of building restaurant No. families
Use No. families
Civil No. stories Heat Style of roof Roofing
Other buildings on same lot
Estimated contractual cost \$ Fee \$ 5.00

FIELD INSPECTOR—Mr. Merig Schmidt GENERAL DESCRIPTION
This application is for: @ 775-5451 To remove fire escape
on 2 1/2 story bldg.
Telephone Ext. 234

- Garage
Resoary Bldg.
Metal Bldg.
Alterations
Demolitions
Change of Use
Other

Stamp of Special Conditions

NOTE TO APPLICANT: Separate permits are required by the installers and subco-tractors of heating, plumbing, electrical and mechanicals.

PERMIT ISSUED WITH LETTER

PERMIT IS TO BE ISSUED TO 1 [] 2 [] 3 [] 4 []

Other:

DETAILS OF NEW WORK

Is any plumbing involved in this work? Is any electrical work involved in this work?
Is connection to be made to public sewer? If not, what is proposed for sewage?
Has septic tank notice been sent? Form notice sent?
Height average grade to top of plate Height average grade to highest point of roof
Size, front depth No. stories solid or filled land? earth or rock?
Material of foundation Thickness, top bottom cellar
Kind of roof Rise per foot Roof covering
No. of chimneys Material of chimneys of lining Kind of heat fuel
Framing Lumber—Kind Dressed or full size Corner posts Sills
Size Girder Columns under girders Size Max. on centers
Joists and rafters: 1st floor, 2nd, 3rd, roof
On centers: 1st floor, 2nd, 3rd, roof
Maximum span: 1st floor, 2nd, 3rd, roof
One story building with masonry walls, thickness of walls? height?

IF A GARAGE

Cars now accommodated on same lot, to be accommodated number commercial cars to be accommodated
Automobile repairs done other than minor repairs to cars habitually stored in the proposed building?

APPROVALS BY: DATE MISCELLANEOUS
BUILDING INSPECTION—PLAN EXAMINER Will work require disturbing of any tree on a public street?
BUILDING CODE: 015: 2.8: 10/29/75 Will there be in charge of the above work a person competent to see that the State and City requirements pertaining thereto are observed? Y N
Health Dept.
Others:

Signature of Applicant John W. Shea Phone #
Type Name of above John Shea 1 [] 2 [] 3 [] 4 []

Other and Address:

FIELD INSPECTOR'S COPY

NOTES

11-3-75	Not removed yet	<i>[Signature]</i>
11-17-75	SAME	<i>[Signature]</i>
11-20-75	SAME	<i>[Signature]</i>
11-5-75	SAME	<i>[Signature]</i>
12-11-75	SAME	<i>[Signature]</i>
12-5-76	Removed	<i>[Signature]</i>

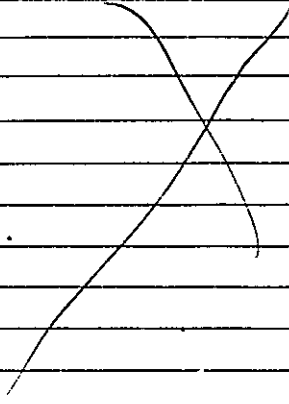

Permit No. 157960

Location 106 Challenge St.

Owner Gayle R. Rutter

Date of permit Oct. 29, 1975

Approved _____



Date Issued _____
 Portland Plumbing Inspector
 By ERNOLD R GOODWIN

App. First Insp.
 Date _____
 By ERNOLD R GOODWIN
 App. Final Insp.
 Date _____
 By _____
MAR 10 1978

- Type of Bldg.
- Commercial
 - Residential
 - Single
 - Multi Family
 - New Construction
 - Remodeling

PERMIT TO INSTALL PLUMBING

Address 106 Exchange Street PERMIT NUMBER **4454**
 Installation For restaurant
 Owner of Bldg AF of L Labor Temple
 Owner's Address _____
 Plumber Rudi Casparius Date Feb. 19 1976
 NEW REPL 52 E Commonwealth Dr. INC TZE

		SINKS		
		LAVATORIES		
		TOILETS		
		BATH TUBS		
		SHOWERS		
		DRAINS FLOOR SURFACE		
	1	HOT WATER TANKS	1	\$2.00
		TANKLESS WATER HEATERS		
		GARBAGE DISPOSALS		
		SEPTIC TANKS		
		HOUSE SEWERS		
		ROOF LEADERS		
		AUTOMATIC WASHERS		
		DISHWASHERS		
		OTHER		
	1	Elect. water booster	1	2.00
		Base fee		3.00
		TOTAL		\$7.00

Building and Inspection Services Dept.; Plumbing Inspection



APPLICATION FOR PERMIT
DEPARTMENT OF BUILDING INSPECTIONS SERVICES
ELECTRICAL INSTALLATIONS

Date Feb. 11, 19 76
 Receipt and Permit number A 11913

To the CHIEF ELECTRICAL INSPECTOR, Portland, Maine:

The undersigned hereby applies for a permit to make electrical installations in accordance with the laws of Maine, the Portland Electrical Ordinance, the National Electrical Code and the following specifications:

LOCATION OF WORK: 106 Exchange St.

OWNER'S NAME: Robert Scott ADDRESS: same

OUTLETS: (number of)

Lights	_____	
Receptacles	_____	FEES
Switches	_____	
Plugmold	_____ (number of feet)	
TOTAL	_____	_____

FIXTURES. (number of)

Incandescent	_____	
Fluorescent	_____ (Do not include strip fluorescent)	
TOTAL	_____	_____
Strip Fluorescent, in feet	_____	_____

SERVICES:

Permanent, total amperes	<u>150</u>	3.00
Temporary	_____	_____

METERS: (number of) 150

MOTORS: (number of)

Fractional	_____	
1 HP or over	_____	

RESIDENTIAL HEATING:

Oil or Gas (number of units)	_____	
Electric (number of rooms)	_____	

COMMERCIAL OR INDUSTRIAL HEATING:

Oil or Gas (by a main boiler)	_____	
Oil or Gas (by separate units)	_____	
Electric (total number of kws)	_____	

APPLIANCES: (number of)

Ranges	_____	Water Heaters	_____
Cook Tops	_____	Disposals	_____
Wall Ovens	_____	Dishwashers	_____
Dryers	_____	Compactors	_____
Fans	_____	Others (denote)	_____
TOTAL	_____		_____

MISCELLANEOUS: (number of)

Branch Panels	_____	
Transformers	_____	
Air Conditioners	_____	
Signs	_____	
Fire/Burglar Alarms	_____	
Circus, Fairs, etc.	_____	
Alterations to wires	_____	
Repairs after fire	_____	
Heavy Duty, 220v outlets	_____	
Emergency Lights, battery	_____	
Emergency Generators	_____	

INSTALLATION FEE DUE: 3.50

FOR ADDITIONAL WORK NOT ON ORIGINAL PERMIT DOUBLE FEE DUE: _____

FOR REMOVAL OF A "STOP ORDER" (304-16.b) _____

FOR PERFORMING WORK WITHOUT A PERMIT (304-9) _____

TOTAL AMOUNT DUE: 3.50

INSPECTION:
 Will be ready on late 2=11, 1976; or Will Call _____

CONTRACTOR'S NAME: Tom Maiorano
 ADDRESS: 89 Murray St.
 TEL.: 774-3572

MASTER LICENSE NO: 145 SIGNATURE OF CONTRACTOR: Thomas E. Maiorano
 LIMITED LICENSE NO: _____



APPLICATION FOR PERMIT
DEPARTMENT OF BUILDING INSPECTIONS SERVICES
ELECTRICAL INSTALLATIONS

Date Feb. 12, 1976, 19
 Receipt and Permit number A 11920

To the CHIEF ELECTRICAL INSPECTOR, Portland, Maine:

The undersigned hereby applies for a permit to make electrical installations in accordance with the laws of Maine, the Portland Electrical Ordinance, the National Electrical Code and the following specifications:

LOCATION OF WORK: 106 Exchange St.
 OWNER'S NAME: Robert Scott ADDRESS: _____

OUTLETS: (number of)
 Lights _____
 Receptacles _____ FEES
 Switches _____
 Plugmold _____ (number of feet)
 TOTAL 1-30 3.00

FIXTURES: (number of)
 Incandescent _____
 Fluorescent _____ (Do not include strip fluorescent)
 TOTAL _____
 Strip Fluorescent, in feet _____

SERVICES:
 Permanent, total amperes _____
 Temporary _____

METERS: (number of) _____

MOTORS: (number of)
 Fractional _____
 1 HP or over _____

RESIDENTIAL HEATING:
 Oil or Gas (number of units) _____
 Electric (number of rooms) _____

COMMERCIAL OR INDUSTRIAL HEATING:
 Oil or Gas (by a main boiler) _____
 Oil or Gas (by separate units) _____
 Electric (total number of kws) _____

APPLIANCES: (number of)
 Ranges _____ pre Water Heaters 1
 Cook Tops _____ Disposals _____
 Wall Ovens _____ Dishwashers 1
 Dryers _____ Compactors _____
 Fans _____ Others (denote) 2 compressors
 TOTAL 6.00

MISCELLANEOUS: (number of) 1.00
 Branch Panels 1
 Transformers
 Air Conditioners
 Signs
 Fire/Burglar Alarms
 Circus, Fairs, etc.
 Alterations to wires
 Repairs after fire
 Heavy Duty, 220v outlets
 Emergency Lights, battery
 Emergency Generators

INSTALLATION FEE DUE: _____

FOR ADDITIONAL WORK NOT ON ORIGINAL PERMIT DOUBLE FEE DUE: _____

FOR REMOVAL OF A "STOP ORDER" (304-16.b) _____

FOR PERFORMING WORK WITHOUT A PERMIT (304-9) _____

TOTAL AMOUNT DUE: 10.00

INSPECTION:
 Will be ready on _____, 19____, or Will Call X _____

CONTRACTOR'S NAME: Thomas Majorano

ADDRESS: 89 Murray

TEL.: _____

MASTER LICENSE NO.: 145

SIGNATURE OF CONTRACTOR:
Thomas E. Majorano

LIMITED LICENSE NO.: _____

INSPECTOR'S COPY

(COPY)

CITY OF PORTLAND, MAINE
Department of Building Inspection



Certificate of Occupancy

LOCATION **106 Exchange Street**

Issued to **Frank Cloutier**

Date of Issue **Feb. 13, 1976**

This is to certify that the building, premises, or part thereof, at the above location, built—altered
—changed as to use under Building Permit No. **75/1034**, has had final inspection, has been found to conform
substantially to requirements of Zoning Ordinance and Building Code of the City, and is hereby approved for
occupancy or use, limited or otherwise, as indicated below.

PORTION OF BUILDING OR PREMISES
1st Floor

APPROVED OCCUPANCY
restaurant

Limiting Conditions **none**

This certificate supersedes
certificate issued

Approved:

(Date)

Margaret Schmitt
Inspector

[Signature]
Inspector of Buildings

Notice: This certificate identifies lawful use of building or premises, and ought to be transferred from
owner to owner when property changes hands. Copy will be furnished to owner or lessee for one dollar.

106 Exchange Street

January 20, 1976

Frank Cloutier
Harrisacket Road
Wells, ME 04090

cc: David Dulac
Route 302
Bridgton, ME 04009

As discussed with you on 1/16/76, the hood over the gas stove needs some updating. Section M-1007.1 of the B.O.C.A. Mechanical Code states, "CO₂ or dry chemical systems shall be installed in range hoods and connecting duct systems where used in conjunction with frying and cooking operations in all food preparation centers within any occupancy." Section M-1007.4.5 states that duct systems from range hood shall not be equipped with fire dampers.

Existing System
doesn't apply
per ESS.

Both egresses will have to open outward with the flow of exit travel, and must be equipped with only such locks or latches at all times whether persons are using the place of assembly or not. All fastenings which would keep the door from opening must be instantly released from the inside without special knowledge or ability, merely by turning the customary knob or pressure on the customary thumb latch (Section 311.3a.2 of the Municipal Code).

OK

If you have any questions, don't hesitate to call this office.

Very truly yours,

Marge Schmuckal
Building Inspector

MS/mj

CITY OF PORTLAND, MAINE
FIRE DEPARTMENT



Clement O. Dodd

XXXXXXXXXXXX
CHIEF

FIRE PREVENTION BUREAU
380 CONGRESS STREET
PORTLAND, MAINE

25 November 1975

To: Office of Building Inspection
Subj: Alterations at 106 Exchange St.

Permit approved providing: 1 hour fire door with automatic self closer at kitchen and dining area. Illuminated exits signs and or paths of travel to reach same. Portable extinguishers as deemed necessary by the Fire Department.

A handwritten signature in dark ink, appearing to read "H. Blaney", is written over the bottom right portion of the document.

106 Exchange St.

November 25, 1975

David Dulac
Rt. 302
Bridgeton, Maine

c.c. Frank Cloutier
Harrisdoeket Rd.
Wells, Maine

Dear Mr. Dulac:

Permit is issued herewith to establish a restaurant at the above location subject to the following Building Code and Fire Department regulations.

An 1 3/4" solid wood core door equipped with a self-closing device is to be provided between the kitchen and the dining area. *OK*

Illuminated exit signs are to be provided over the exits along with white lights on the outside. *OK*

The Fire Department requires that portable extinguishers are to be placed in strategic positions throughout the restaurant area. *Fire Dept OK*

Please have the actual installer of the hood and fan apply for a separate permit at this office. *Existing - no permit*

Very truly yours,

Earle S. Smith, Plan Examiner
Building Inspection Services

ESS/sk

DEPT. OF BLDG. INSP.
CITY OF PORTLAND,

Exchange Street

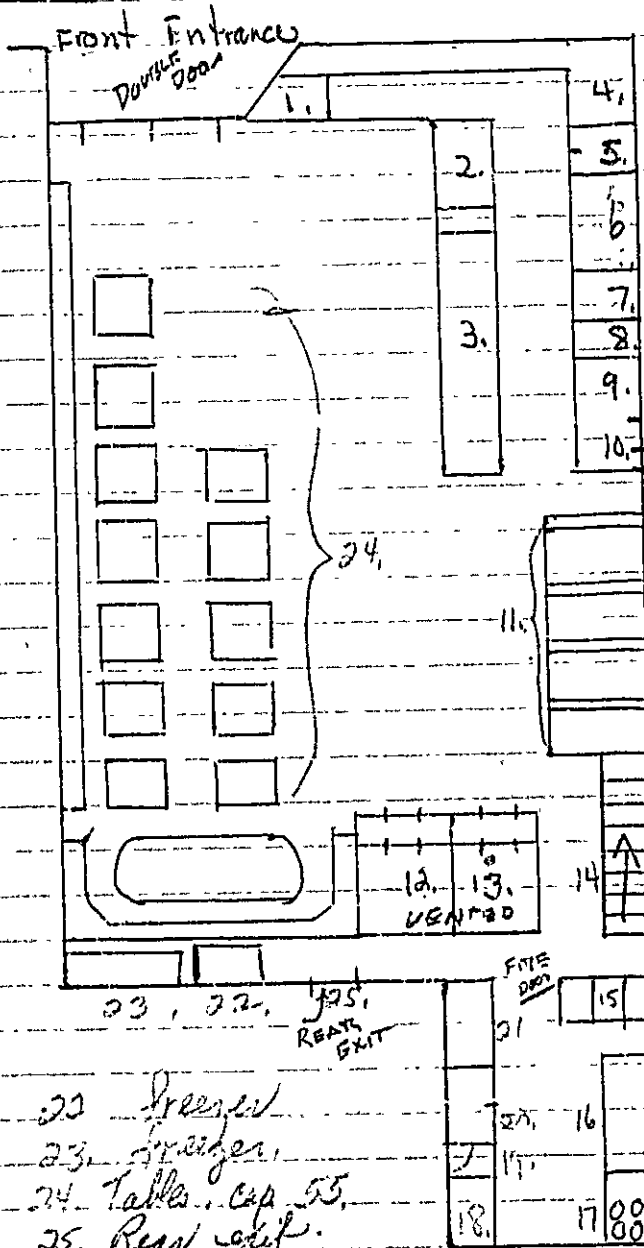

- 1. each
- 2. pastry display
- 3. Sebd bar
- 4. Table
- 5. Sink 3 comp
- 6. Work Bench
- 7. Slicer
- 8. coffee machine
- 9. bench
- 10. Taps (Beer)
- 11. Baths (cap. 24)
- 12. Mens Room
- 13. Ladies Room
- 14. Stairs
- 15. 3 comp sink
- 16. Work Table
- 17. Stove
- 18. Table
- 19. office
- 20. Refrigerator
- 21. Table

22. Freezer
23. Freezer
24. Table cap 55
25. Rear exit

FRONT DOOR	15
21	
22	16
23	17
18	17'00"



APPLICATION FOR PERMIT

PERMIT ISSUED

NOV 25 1975
1034

CITY of PORTLAND

B.O.C.A. USE GROUP

B.O.C.A. TYPE OF CONSTRUCTION

ZONING LOCATION _____ PORTLAND, MAINE, 11/21/75.....

To the DIRECTOR OF BUILDING & INSPECTION SERVICES, PORTLAND, MAINE

The undersigned hereby applies for a permit to erect, alter, repair, demolish, move or install the following building, structure, equipment or change use in accordance with the Laws of the State of Maine, the Portland B.O.C.A. Building Code and Zoning Ordinance of the City of Portland with plans and specifications, if any, submitted herewith and the following specifications:

LOCATION 106 Exchange St. Fire District #1 #2
1. Owner's name and address Frank Cloutier, Herringdocket Rd., Wells, Me. Telephone
2. Lessee's name and address Telephone
3. Contractor's name and address David Dulac Rt., 302, Bridgeton Me. Telephone
4. Architect Specifications Plans No. of sheets
Proposed use of building Restaurant No. families
Last use No. families
Material No. stories Heat Style of roof Roofing
Other buildings on same lot
Estimated contractual cost \$ 1,500 Fee \$ 6.00

FIELD INSPECTOR—Mr. Karge GENERAL DESCRIPTION
This application is for: @ 775-5451 Alterations as shown
Dwelling Ext. 234
Garage
Masonry Bldg.
Metal Bldg.
Alterations
Demolitions
Change of Use
Other

PERMIT ISSUED WITH LETTER

Stamp of Special Conditions

sent to Fire Dept. 11/21/75
Fire Dept.

NOTE TO APPLICANT: Separate permits are required by the installers and subcontractors of heating, plumbing, electrical and mechanicals. Frank Cloutier

PERMIT IS TO BE ISSUED TO 1 2 3 4 106 Exchange
Other:

DETAILS OF NEW WORK

Is any plumbing involved in this work? Is any electrical work involved in this work?
Is connection to be made to public sewer? If not, what is proposed for sewage?
Has septic tank notice been sent? Form notice sent?
Height average grade to top of plate Height average grade to highest point of roof
Size, front depth No. stories solid or filled land? earth or rock?
Material of foundation Thickness, top bottom cellar
Kind of roof Rise per foot Roof covering
No. of chimneys Material of chimneys of lining Kind of heat fuel
Framing Lumber—Kind Dressed or full size? Corner posts Sills
Size Girder Columns under girders Size Max. on centers
Studs (outside walls and carrying partitions) 2x4-16" O. C. Bridging in every floor and flat roof span over 8 feet.
Joists and rafters: 1st floor 2nd 3rd roof
On centers: 1st floor 2nd 3rd roof
Maximum span: 1st floor 2nd 3rd roof
If one story building with masonry walls, thickness of walls? height?

IF A GARAGE

No. cars now accommodated on same lot to be accommodated ... number commercial cars to be accommodated ...
Will automobile repairing be done other than minor repairs to cars habitually stored in the proposed building?

APPROVALS BY: DATE
BUILDING INSPECTION—PLAN EXAMINER
ZONING:
BUILDING CODE:
Fire Dept.:
Health Dept.:
Other:

MISCELLANEOUS
Will work require disturbing of any tree on a public street? ..
Will there be in charge of the above work a person competent to see that the State and City requirements pertaining thereto are observed? ... yes

Signature of Applicant: Frank Cloutier Phone # 985-7761
Type Name of above: Frank Cloutier 1 2 3 4

FIELD INSPECTOR'S COPY
lak

Other
and Address

Front Counter 772-7115

NOTES

11-20-75 Told worker that they needed a permit

12-5-75 No one working - M.S.

12-11-75 Putting in new door way - Stucco - Chiming
+ painting up - a wave of permits needed for new
hood or cooling appliances - M.S.

12-19-75 Work progressing - M.S.

1-16-76 Working on kitchen & back porch - Needs Anti-
panic hardware on front & rear exits - hood needs
some up dating - M.S.

1-20-76 See letter - M.S.

1-30-76 Still working - M.S.

2-6-76 Still working - M.S.

2-13-76 Putting in anti panic hardware -

Everything else as per letter - M.S.

Issue C.O. - M.S.

Fire Dept quote - M.S.

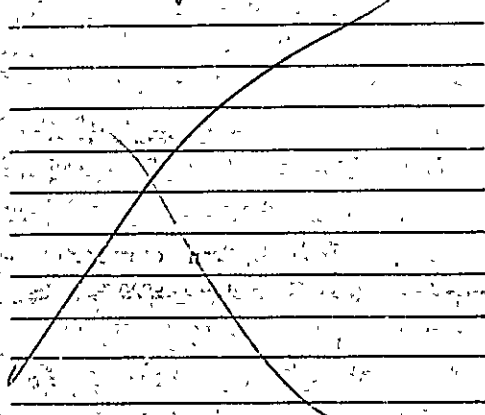

Permit No. 75/1034
Location: 116 (College) St.
Owner: Frank & Anita
Date of permit: Nov 25 1975
Approved: [Signature]

RECEIPT FOR CERTIFIED MAIL—30¢ (plus postage)

No. 902296

SENT TO VI-PATS		POSTMARK OR DATE	CLOCK(S) ONLY 5500
STREET AND NO. 106 EXCHANGE ST.			
P. O., STATE AND ZIP CODE PORTLAND, ME.			
OPTIONAL SERVICES FOR ADDITIONAL FEES			
RETURN	1. Shows to whom and date delivered	15¢	
RECEIPT	With delivery to addressee only	35¢	
SERVICES	2. Shows to whom, date and where delivered	85¢	
	With delivery to addressee only	50¢	
DELIVER TO ADDRESSEE ONLY			
SPECIAL DELIVERY (extra fee required)			
PS Form 3800	NO INSURANCE COVERAGE PROVIDED	(See other side)	<i>L. Smith</i>
Apr. 1971	NOT FOR INTERNATIONAL MAIL	GPO 1972 O-460-743	Use ZIP Code

Vi-Pats
106 Exchange St.
Portland, Maine

Gentlemen:

An inspector from this office reports that the top guy has been disconnected from the sign which overhangs the public sidewalk. Please have this sign repaired and notify this office so that our inspector may reinspect it.

Earle S. Smith
Plan Examiner

ESS:sk

CITY OF PORTLAND, MAINE
Building & Inspection Services

March 3, 1975

106 Exchange St.

C
O
P
Y
Vi-Pats
106 Exchange St.
Portland, Maine

Gentlemen:

An inspector from this office reports that the top guy has been disconnected from the sign which overhangs the public sidewalk.

Please have this sign repaired and notify this office so that our inspector may reinspect it.

Earle S. Smith
Plan Examiner

ESS:sk



FILL IN AND SIGN WITH INK

APPLICATION FOR PERMIT FOR HEATING, COOKING OR POWER EQUIPMENT

1118

PERMIT ISSUED

Portland, Maine, Nov. 18, 1954

CITY OF PORTLAND

To the INSPECTOR OF BUILDINGS, PORTLAND, ME.

The undersigned hereby applies for a permit to install the following heating, cooking or power equipment in accordance with the Laws of Maine, the Building Code of the City of Portland, and the following specifications:

Location 106 Exchange St. Use of Building Com. No Stories 4 New Building Existing
Name and address of owner of appliance Eagles Associates
Installer's name and address Ballard Oil & Equipment Co. Telephone 772-1991

General Description of Work

To install Replacement oil burner- KFS Waltham in existing boiler (American Rad.)

IF HEATER, OR POWER BOILER

Location of appliance basement Any burnable material in floor surface or beneath? No
It so, how protected? Kind of fuel? # 2
Minimum distance to burnable material, from top of appliance or casing top of furnace 4'
From top of smoke pipe 2' From front of appliance 3' From sides or back of appliance 4'
Size of chimney flue 8 x 12 Other connections to same flue none
If gas fired, how vented? Rated maximum demand per hour
Will sufficient fresh air be supplied to the appliance to insure proper and safe combustion? yes

IF OIL BURNER

Name and type of burner Waltham Labelled by underwriters' laboratories? yes
Will operator be always in attendance? no Does oil supply line feed from top or bottom of tank? bottom
Type of floor beneath burner concrete Size of vent pipe 1 1/4"
Location of oil storage basement Number and capacity of tanks 1-275
Low water shut off Make No.
Will all tanks be more than five feet from any flame? yes How many tanks enclosed?
Total capacity of any existing storage tanks for furnace burners 1-275

IF COOKING APPLIANCE

Location of appliance Any burnable material in floor surface or beneath?
If so, how protected? Height of Legs, if any
Skirting at bottom of appliance? Distance to combustible material from top of appliance?
From front of appliance From sides and back From top of smokepipe
Size of chimney flue Other connections to same flue
Is hood to be provided? If so, how vented? Forced or gravity?
If gas fired, how vented? Rated maximum demand per hour

MISCELLANEOUS EQUIPMENT OR SPECIAL INFORMATION

Amount of fee enclosed? 5.00

APPROVED:

OK 11-18-54-NFC

Will there be in charge of the above work a person competent to see that the State and City requirements pertaining thereto are observed? yes

CS 300

INSPECTION COPY

Signature of Installer

NOTES

11-25-74 Closed *AL*

Inertion on clearance of
stack + method of recording
oil lines.

Return to Nelson, 12/7/74
Libby

2-12-75 Completed *AL*

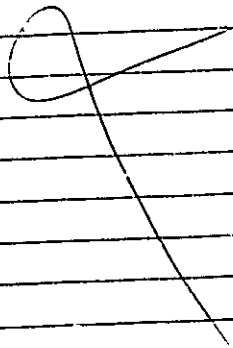

Permit No. 74/1118
Location De E. Thompson St
Owner Anglo Pac.
Date of permit 11/18/74
Approved

Nelson

CITY OF PORTLAND, MAINE
Application for Permit to Install Wires

Permit No. **2354**
 Issued **11/18/74**
 Portland, Maine Nov. 18, 1974, 19

To the City Electrician, Portland, Maine:

The undersigned hereby applies for a permit to install wires for the purpose of conducting electric current, in accordance with the laws of Maine, the Electrical Ordinance of the City of Portland, and the following specifications:

(This form must be completely filled out — Minimum Fee, \$1.00)

Owner's Name and Address **Eagles Associates** Tel. **772-1991**
 Contractor's Name and Address **Ballard Oil & Equip. Co.** Tel. **772-1991**
 Location **106 Exchange St.** Use of Building **Com.**
 Number of Families **Apartment** Stores **4** Number of Stories **4**
 Description of Wiring: **New Work** Additions Alterations **X**

.....
 Pipe . . . Cable Metal Molding BX Cable Plug Molding (No. of feet)
 No. Light Outlets . . . Plugs Light Circuits Plug Circuits
FIXTURES: No. Fluor. or Strip Lighting (No. feet)
SERVICE: Pipe Cable Underground No. of Wires Size
METERS: Relocated Added Total No. Meters
MOTORS: Number **1** Phase **1** H. P. **1/8 Amps 3.0** Volts **115** Starter
HEATING UNITS: Domestic (Oil) No. Motors Phase H.P.
 Commercial (Oil) No. Motors Phase H.P.
 Electric Heat (No. of Rooms)
APPLIANCES: No. Ranges Watts Brand Feeds (Size and No.)
 Elec. Heaters Watts
 Miscellaneous Watts Extra Cabinets or Panels
 Transformers Air Conditioners (No Units) Signs (No. Units)
 Will commence **19** Ready to cover in Will Call Inspection **19**
 Amount of Fee \$ **.2.00** Signed **Ballard Oil & Equipment Co.**

DO NOT WRITE BELOW THIS LINE

SERVICE	METER	GROUND
VISITS: 1/2-6-74₂	12-17-74₃	4 5 6
..... 7	8 9	10 11 12

REMARKS: *no one in* 

INSPECTED BY 

(OVER)



CITY OF PORTLAND, MAINE
DEPARTMENT OF BUILDING INSPECTION
COMPLAINT

Location

106A Exchange St.

FILE COPY

COMPLAINT NO. 67/14 Date Received April 18, 1967

Location 106A Exchange Street Use of Building _____

Owner's name and address Eagles Associates, 106 Exchange St. Telephone _____

Tenant's name and address _____ Telephone _____

Complainant's name and address _____ Telephone _____

Description: Dangerous fire escape over sidewalk.

NOTES: See letter. GEM

Handwritten 'X' mark on the lined notes section.

Re: Fire Escape 106A Exchange Street

Feb. 27, 1967

Eagles Associates
106 Exchange Street

Gentlemen:

It has been reported to this department that the fire escape over the Exchange Street sidewalk on February 23, 1967 suddenly and with force dropped to the sidewalk due to the weight of accumulated snow on the counterbalanced portion.

It is understood that this counterbalanced portion was secured by a string to prevent this part of the fire escape from swinging down from the weight of the accumulated snow. As the snow built up, the weight was enough to break this string and to send this portion to the sidewalk with considerable force. The securing of this lower portion of the fire escape in the above manner is both contrary to the City of Portland Building Code and a very dangerous practice.

In view of the above it is necessary that you as owners take corrective action to prevent this from recurring and perhaps causing a serious accident.

It is understandable that a counterbalanced stairway would lower due to excessive snow weight in a severe storm such as was just experienced. However, these fire escapes should not lower during minor storms as this escape is reported to have done previously. It is suggested that you contact a reliable steel fire escape fabricator to determine the proper balancing of this fire escape.

Please notify this office without delay as to what action is being taken.

Very truly yours,

Gerald E. Mayberry
Director Building & Inspection Services Dept.

GEH:m

EL
m

Re: Fire Escape 106A Exchange Street

Feb. 27, 1967

Eagles Associates
106 Exchange Street

Gentlemen:

It has been reported to this department that the fire escape over the Exchange Street sidewalk on February 23, 1967 suddenly and with force dropped to the sidewalk due to the weight of accumulated snow on the counterbalanced portion.

It is understood that this counterbalanced portion was secured by a string to prevent this part of the fire escape from swinging down from the weight of the accumulated snow. As the snow built up the weight was enough to break this string and to send this portion to the sidewalk with considerable force. The securing of this lower portion of the fire escape in the above manner is both contrary to the City of Portland Building Code and a very dangerous practice.

In view of the above it is necessary that you as owners take corrective action to prevent this from recurring and perhaps causing a serious accident.

It is understandable that a counterbalanced stairway would lower due to excessive snow weight in a severe storm such as was just experienced. However, these fire escapes should not lower during minor storms as this escape is reported to have done previously. It is suggested that you contact a reliable steel fire escape fabricator to determine the proper balancing of this fire escape.

Please notify this office without delay as to what action is being taken.

Very truly yours,

Gerald E. Mayberry
Director Building & Inspection Services Dept.

GE:tm

PERMIT TO INSTALL PLUMBING

Permit Number 16075

Issued 1/23/66
 Portland Plumbing Inspector
 By E. R. Goodwin
 App. First Insp. 1/29/66
 Date
 By E. R. Goodwin
 App. Final Insp. 1/29/66
 Date
 By E. R. Goodwin
 Type of Bldg.
 Commercial
 Residential
 Single
 Multi Family
 New Construction
 Remodeling

Address _____

Installation For _____

Owner of Bldg. _____

Owner's Address: _____

Plumber: W. Cunningham Co. Date: 1/29/66

New/Rep: _____

1	SINK	1	2.00
	LAVATORIES		
	TOILETS		
	BATH TUBS		
	SHOWERS		
	DRAINS FLOOR SURFACE		
	HOT WATER TANKS		
	TANKLESS WATER HEATERS		
	GARBAGE DISPOSALS		
	SEPTIC TANKS		
	HOUSE SEWERS		
	ROOF LEADERS		
	AUTOMATIC WASHERS		
	DISHWASHERS		
	OTHER		
		TOTAL	2.00

BLDG. SERVICES & INSP. DEPT. PLUMBING INSPECTION

SINGLE
 MULTI FAMILY
 NEW CONSTRUCTION
 REMODELING

PORTLAND HEALTH DEPT. PLUMBING INSPECTION

TOTAL > \$ 2.00

REMODELING
 5M 12 53 PORTLAND HEALTH DEPT. PLUMBING INSPECTION Total 2.00

REMODELING
 5M 12 53 PORTLAND HEALTH DEPT. PLUMBING INSPECTION Total 2.00

Special Inspection Basement

PERMIT TO INSTALL PLUMBING

Oct. 7-13-64

14097

PERMIT NUMBER

Date Issued 6-9-64
PORTLAND PLUMBING INSPECTOR

Address 106A Exchange Street

Installation For: Eagle Associates

Owner of Bldg. Eagle Associates

Owner's Address Sams

Plumber: Portland Gas Light Company Date: 6-9-64

By J. P. Volci

APPROVED FIRST INSPECTION

Date 7-13-64

By J. P. Welch

APPROVED FINAL INSPECTION

Date 7-13-64
JOSEPH P. WELCH

CHIEF PLUMBING INSPECTOR

By

- TYPE OF BUILDING
 COMMERCIAL
 RESIDENTIAL
 SINGLE
 MULTI FAMILY
 NEW CONSTRUCTION
 REMODELING

NEW	REPL	PROPOSED INSTALLATIONS	NUMBER	FEE
		SINKS		
		LAVATORIES		
		TOILETS		
		BATH TUBS		
		SHOWERS		
		DRAINS		
		HOT WATER TANKS	1	\$ 2.00
		TANKLESS WATER HEATERS		
		GARBAGE GRINDERS		
		SEPTIC TANKS		
		HOUSE SEWERS		
		ROOF LEADERS (Conn. to house drain)		

PORTLAND HEALTH DEPT. PLUMBING INSPECTION

TOTAL ► \$ 2.00

REMODELING PORTLAND HEALTH DEPT. PLUMBING INSPECTION Total 1.10
 SM 12-53 PORTLAND HEALTH DEPT. PLUMBING INSPECTION
 REMODELING PORTLAND HEALTH DEPT. PLUMBING INSPECTION Special Service Agreement To \$ 2.00
 SM 12-53 PORTLAND HEALTH DEPT. PLUMBING INSPECTION