

Night Watch 24 Hour Emergency Property Repair and Maintenance

774-2154 P.O. Box 7634 Portland, Maine 04112
Voice Pagers: Douglas M. Hansen 761-7009 Kenneth J. Prantice 761-7000

August 18, 1983

Mr. P. Samuel Hoffses
City of Portland, Maine
Chief of Inspection Services
City Hall
389 Congress Street
Portland, ME 04101

Dear Mr. Hoffses:

This letter seeks to receive written confirmation from the building inspection office that the application of stucco over the existing wood frame building known as the Longfellow Ticket Booth on Long Wharf will bring it into compliance with your wishes. Submitted as:

1. A diagram of existing wall section.
2. A diagram of proposed wall section.
Application of 3/4" thick stucco over metal lath on all vertical wall surfaces of the ticket booth.

(Page 11 of Fire Resistance Rating of assemblies of construction materials as recognized in the BOCA Basic Building Code

3/4" 1:2 - 1:3 Gypsum - Sand Plaster on Metal Lath (L.B.) 1 Hour Fire Rating

Thanking you for your consideration in this matter.

Regards,

Douglas M. Hansen

Douglas M. Hansen

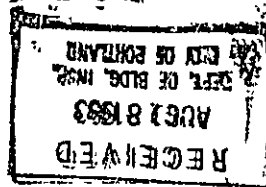

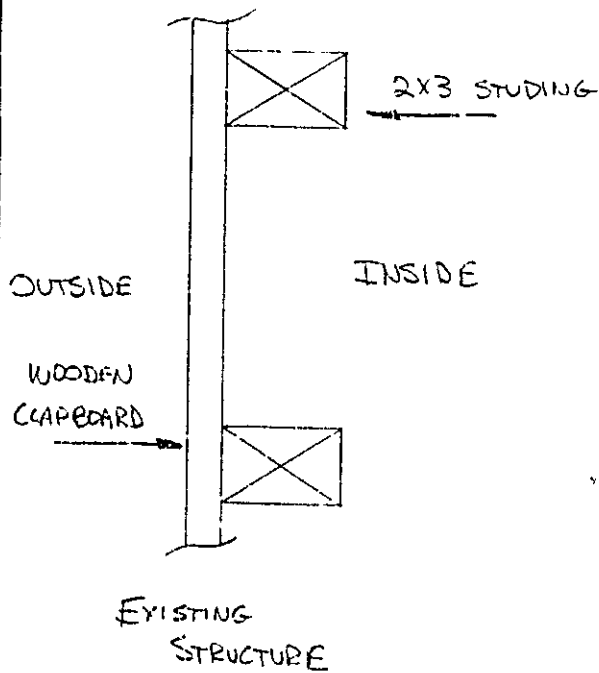

1 1/2 - 1 1/3 GYPSUM
 SAND PLASTER ON
 METAL LATH (L.B.)
 1 HR FIRE RATING
 AS PER BOCA BASIC
 BUILDING CODE

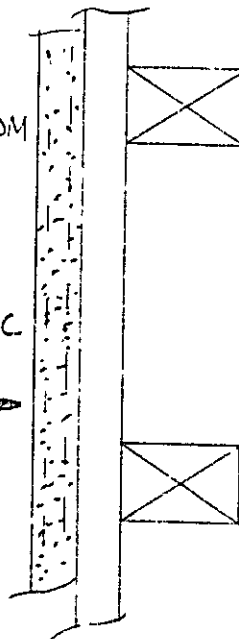

PROPOSED MODIFICATION TO BRING INTO
 INTO COMPLIANCE FOR A-1 FIRE ZONE

RECEIVED
 AUG 22 1983
 DEPT. OF BLDG. INSP
 CITY OF PORTLAND

LONGFELLOW CRUISE LINES TICKET BOOTH		
SCALE NONE	APPROVED BY	DRAWN BY
DATE 8-19-83		REVISED
		DRAWING NUMBER

COMMERCIAL STREET SIDEWALK

8x14 FT
TICKET
BOOTH

OLDE FOLK
MARINER
FLECT

*Place
with
your
file*

LONGFLOW CRUISE LINES
TICKET BOOTH SITE PLAN (RETURN TO ORIGINAL
POSITION ON WHARF)

SCALE 3/32	APPROVED BY	DRAWN BY
DATE 1/6/83		REVISED
		DRAWING NUMBER

inside Chimney

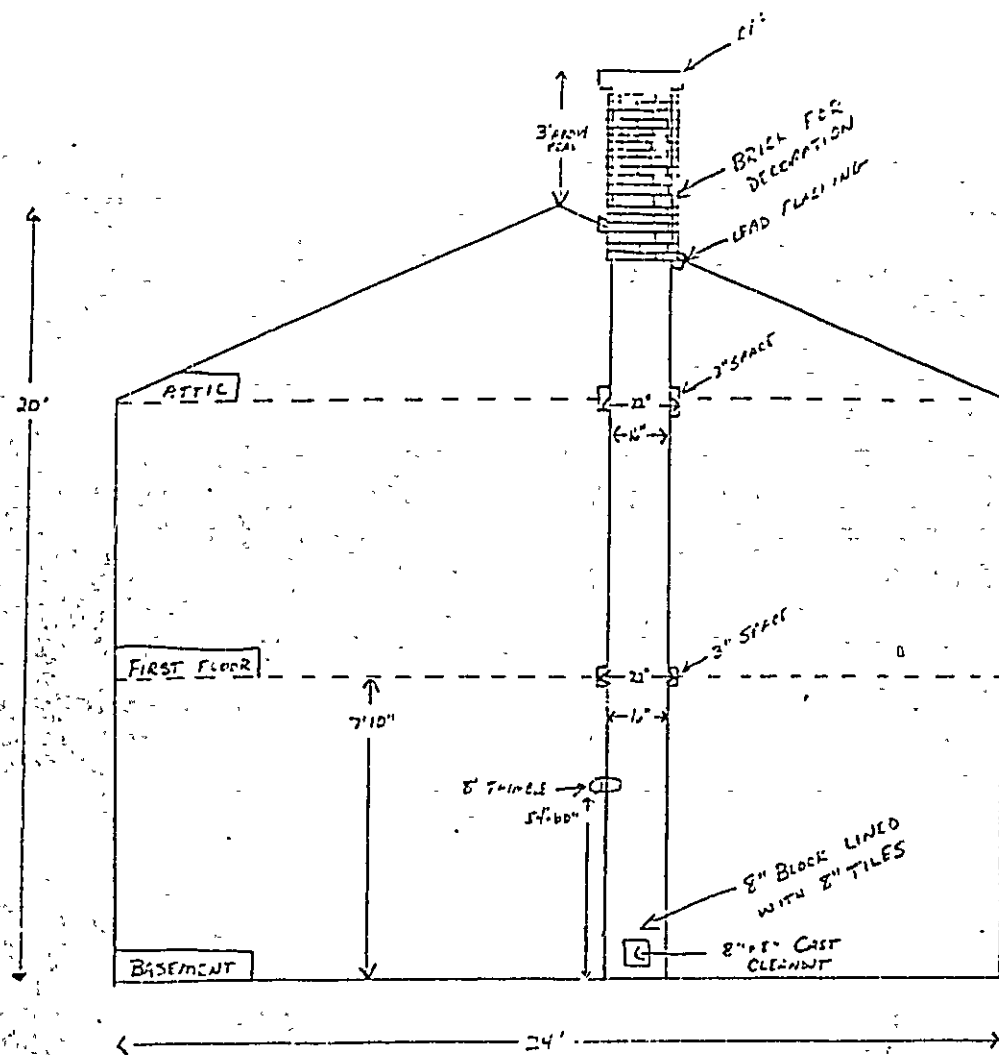

SIDE VIEW OF HOUSE

RECEIVED
DEC 10 1982
SEPT. OF BLDG INSP.
CITY OF PORTLAND

1/4" = 1'



Phil's Portable Welding
 RFD #2, Route 35
 Sebago Lake Village, Maine 04075

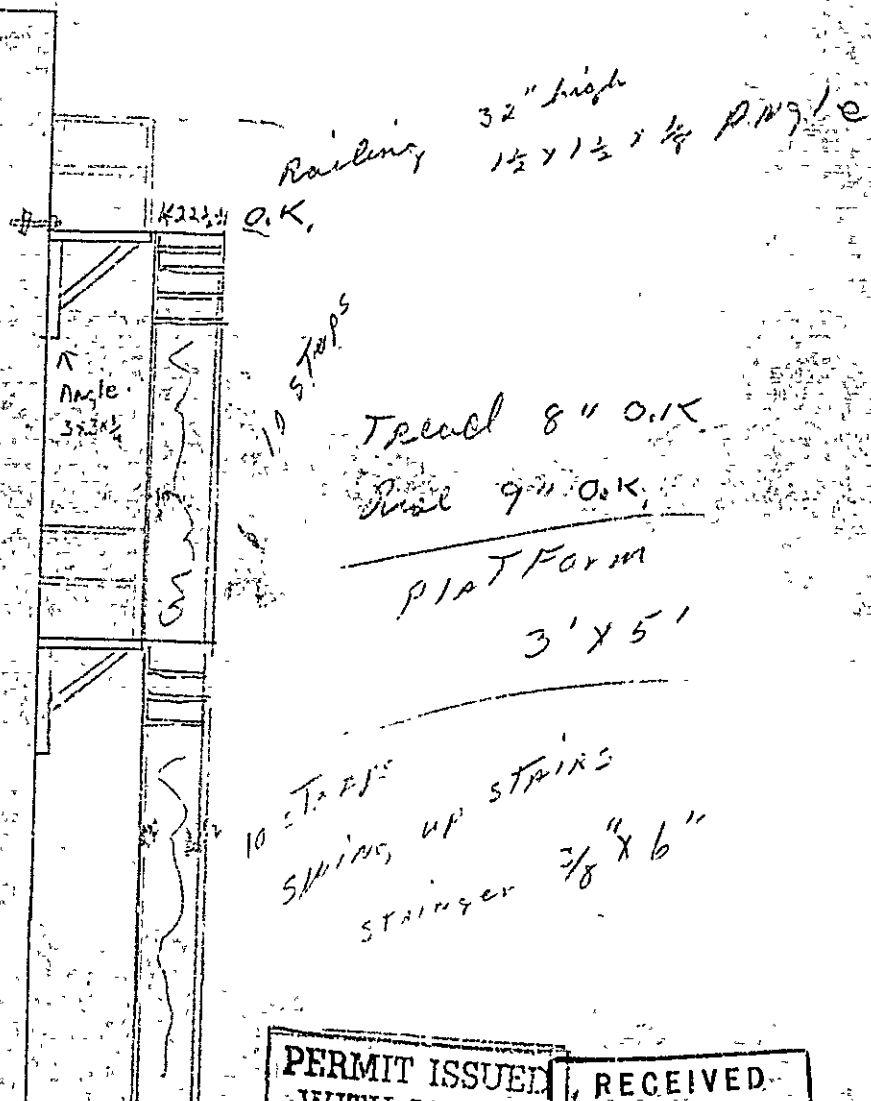

PERMIT ISSUED
 WITH LETTER

RECEIVED
 JUL - 8 1983
 DEPT. OF BLDG. INSP.
 CITY OF PORTLAND