



941284

PERMIT ISSUED
DEC - 9 1994
CITY OF PORTLAND

FILL IN AND SIGN WITH INK

APPLICATION FOR PERMIT FOR HEATING, COOKING OR POWER EQUIPMENT

Portland, Maine,

12/6/94

To the INSPECTOR OF BUILDINGS, PORTLAND, ME.

The undersigned hereby applies for a permit to install the following heating, cooking or power equipment in accordance with the Laws of Maine, the Building Code of this City of Portland, and the following specifications:

Location 72 Commercial St Use of Building manufacturing No. Stories New Bldg. Existing
Name and address of owner of appliance Resource Trading Co
Installer's name and address Hyland Co 799-7870 Telephone
Box 2880 - South Portland, ME 04106

General Description of Work

To install furnace & 2 heaters

IF HEATER, OR POWER BOILER

Location of appliance overhead Any burnable material in floor surface or beneath? no
If so, how protected? Kind of fire protection natural
Minimum distance to burnable material, from top of appliance or casing top of... 3 ft
From top of smoke pipe... 3 ft From front of appliance 10 ft From sides or back of appliance 6 ft
Size of chimney flue 2 inch Other connections to same flue 3 inch
If gas fired, how vented? outside
Will sufficient fresh air be supplied to the appliance to insure proper combustion? YES

IF OIL BURNER

Name and type of burner
Will operator be always in attendance?
Type of floor vented burner
Location of oil storage
Low water shut off
Will all tanks be more than five feet from...
Total capacity of any existing storage for burners

IF COOKING APPLIANCE

Location of appliance Any burnable material in floor surface or beneath?
If so, how protected? Height of Legs, if any
Skirting at bottom of... Distance to combustible material from top of appliance?
From front of appliance From sides and back From top of smokepipe
Size of chimney Other connections to same flue
Is hood to be used? If so, how vented? Forced or gravity?
If gas fired, how vented? Rated maximum demand per hour

MISCELLANEOUS EQUIPMENT OR SPECIAL INFORMATION

cost of work: \$ 2000

Amount of fee enclosed? \$ 30

APPROVED:

Installed Jan 95

CS 307

Signature of Installer

INSPECTION FILE APPLICANT'S ASSESSOR'S COPY

W. E. MANSON

Will there be in charge of the... see that the State and City requirements are observed? YES

John Hyland
master plumber
144...
1. Name & Label
2. Remote control
3. High limit control
4. Main cutoff switch
5. Low water cutoff
6. Piping support & bracing
7. Valves in supply line
8. Capacity of tanks
9. Oil tank rigging & support
10. Oil tank
11. Oil tank
12. Oil tank
13. Oil tank
14. Oil tank
15. Oil tank
16. Oil tank
17. Oil tank
18. Oil tank
19. Oil tank
20. Oil tank



FILL IN AND SIGN WITH INK

950924

APPLICATION FOR PERMIT FOR HEATING, COOKING OR POWER EQUIPMENT

Portland, Maine,

030-D-001

05 September 1995

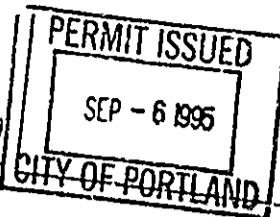

To the INSPECTOR OF BUILDINGS, PORTLAND, ME. The undersigned hereby applies for a permit to install the following heating, cooking or power equipment in accordance with the Laws of Maine, the Building Code of the City of Portland, and the following specifications:

Location 72 Commercial St Use of Building Comm
Name and address of owner of appliance Main Wharf Associates
Installer's name and address Hyland Company P & H 200 Spurwink Ave C.E. 04107

No. Stories 1 New Building Existing
Telephone 799-7870

To install Install Oil Fired Steam Boiler
General Description of Work

IF HEATER OR POWER BOILER
Location of appliance Atop Oil Storage Building (right side of Building)
If so, how protected? Any burnable material in floor surface or beneath? No
Minimum distance to burnable material, from top of appliance or casing top of furnace 4'
Kind of fuel? #2 oil
From top of smoke pipe 0' From front of appliance 3' From sides or back of appliance 3' x 3'
Size of chimney flue 7" Other connections to same flue no
If gas fired, how vented?
Will sufficient fresh air be supplied to the appliance to insure proper and safe combustion? yes
Rated maximum demand per hour 315,000 BTU's

IF OIL BURNER
Name and type of burner Carlan
Will operator be always in attendance? no
Does oil supply line feed from top or bottom of tank? Bottom
Type of floor beneath burner HANCOCK steel
Size of vent pipe 7"
Location of oil storage Beneath (8' below)
Number and capacity of tanks 28-275 (2 feeding this boiler)
Low water shut off. McDonald Miller Make 407
How many tanks enclosed? 8-275
Total capacity of any existing storage tanks for furnace burners 2-27

IF COOKING APPLIANCE
Location of appliance
Any burnable material in floor surface or beneath?
If so, how protected?
Height of Legs if any
Skirting at bottom of appliance?
Distance to combustible material from top of appliance?
From front of appliance From sides and back
From top of smokepipe
Size of chimney flue
Other connections to same flue
Is hood to be provided?
If so, how vented?
If gas fired, how vented?
Forced or gravity?
Rated maximum demand per hour

MISCELLANEOUS EQUIPMENT OR SPECIAL INFORMATION

Hyland Co.
John Theroux - Industrial Burner Services
Eastbrook, ME 874-1441 Master Oil Burner #5240
Cost of Work: 8,000.00 Permit Fee 60.00

Amount of fee enclosed

APPROVED: [Signature]

Will there be in charge of the above work a person competent to see that the State and City requirements pertaining thereto are observed?

Signature of Installer: [Signature]
BY JOHN HYLAND I.E.

MR. L...

FILE COPY

City of Portland
Parks/Plant Works
55 Portland Street
Portland, Maine 04101

SEWER USER CHARGE
SEWER METER
DATE OF READING

FOR SEWER ~~SUB~~METER

FOR SEWER USER CHARGE ADJUSTMENTS

The undersigned hereby requests permission to install additional water meter(s) in accordance with Section 322.60 of the "Municipal Code of the City of Portland, Maine"
It is understood that all expenses related to the purchase, installation and maintenance of the meter(s) is to be borne by the applicant.

TO BE COMPLETED BY APPLICANTS

✓ Address where sub-meter is requested 72 Commercial St. Port. Me.
✓ Property owner's name MAINE WHF. ASSOC.
✓ Tax Map Reference (On Real Estate Tax Bill) 30-D-1
✓ Property owner's address 400 Commercial St. Port. Me 773176 / 773126
✓ Person to be contacted to schedule inspections Tim Rumpf 7743141
(Name and Telephone Number)
✓ Portland Water District Account No. (On bill) P-94-2970B
✓ Billing Name & Address (On bill) MAINE WHF. ASSOC.
400 Commercial St. Port. Me

Location and size existing Portland Water District Service Meter 2" BILTON BLDG

Proposed location and size of sub-meter 1" VANTAGE METER

Will a remote reading register be utilized? NO YES (If yes, state location _____)

Description of work in plumbing required for sub-metering: OUT INTO
1" supply and to several fixtures

✓ The volume of water to be submetered can be shown not to enter the sewerage system by virtue of its use for: _____

I certify the above information is true and correct:

Tim Rumpf
Signature

12/10/86
Date

Revised 12-30-85

Jan. 12, 1988

SEWER USER CHARGE
SEWER METER

proposed repairs, shall enter back meter submeter to non-ferrous equipment or location (use additional sheet of paper if necessary).

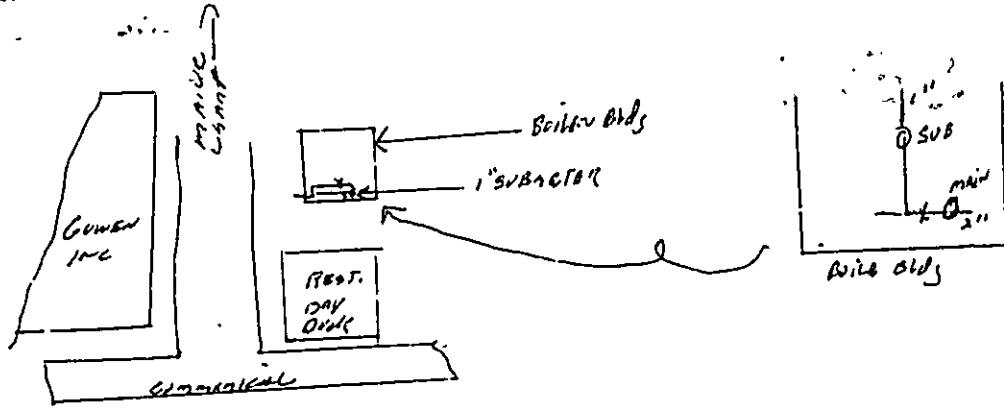

TO BE COMPLETED BY PUBLIC WORKS

Pre-installation inspection by D. G. PATRICKSON
 on 12-11-86

Automatic reading system requested YES NO

A _____ Back Flow Preventer or equal shall be installed _____

Application Approved Denied

Comments
1" meter to be vented

TO BE COMPLETED BY THE PLUMBING INSPECTOR

An inspection of the completed installation of the sub-metering system approved on this application was conducted on 1/11/88 by Ernold R. Goodwin, Chief Plumbing Inspector of the City of Portland.

The sub-metering system was installed as approved

No cross connections were found

The installation is approved dis-approved

E. Goodwin

TO BE COMPLETED BY THE WATER DISTRICT

Date submeter sold 12/12/86
 Submeter account number P. 94. 2970B
 Submeter make and number 1" R #36645346
 Submeter installation readings 0000013
 Submeter account entered into computer 1/12/88
 Submeter account entered into meter box 1/12/88
 Special instructions _____

931.026

Permit # _____ City of Portland BUILDING PERMIT APPLICATION Fee \$65 Zone _____ Map # _____ Lot# _____
Please fill out any part which applies to job. Proper plans must accompany form.

Owner: Resource Trading CO Phone # 772-2299
Address: Box 1698 - Ptld, ME 04104
LOCATION OF CONSTRUCTION 72 Commercial St. (Maine Wharf)
Contractor: lessee Sub: _____
Address: _____ Phone # _____
Est. Construction Cost: 9000 Proposed Use: seafood processing facility w support tank Zoning: _____
Past Use: _____
of Existing Rca. Units _____ # of New Rca. Units _____
Building Dimensions L _____ W _____ Total Sq. Ft. _____
Stories: _____ # Bedrooms _____ Lot Size: _____
Is Proposed Use: Seasonal _____ Condominium _____ Conversion _____
Explain Conversion const base for nitrogen tank

For Official Use Only
Date 10/29/93 Subdivision _____
Inside Fire Limits _____
Bldg Code _____
Time Limit _____
Estimated Cost 9000
Zoning WC2
Street Frontage Provided: _____
Provided Setbacks: Front _____ Back _____ Side _____
Review Required:
Zoning Board Approval: Yes _____ No _____ Date _____
Planning Board Approval: Yes _____ No _____ Date _____
Conditional Use: _____ Variance _____ Site Plan _____ Subdivision _____
Shoreland Zoning Yes _____ No _____ Floodplain Yes _____ No _____
Special Exception _____
Other _____ (Explain) _____

Foundations:
1. Type of Soil: _____
2. Set Backs - Front _____ Rear _____ Side(s) _____
3. Footings Size: _____
4. Foundation Size: _____
5. Other _____
- 10'x10' - appx
Floor: prop owner: Maine Wharf Assoc.
1. Sills Size _____ Sills must be anchored.
2. Girder Size: _____
3. Lally Column Spacing: _____ Size: _____
4. Joists Size: _____ Spacing 16" O.C.
5. Bridging Type: _____ Size: _____
6. Floor Sheathing Type: _____ Size: _____
7. Other Material: _____
Exterior Walls:
1. Studding Size _____ Spacing _____
2. No. windows _____
3. No. Doors _____
4. Header Sizes _____ Span(s) _____
5. Bracing: Yes _____ No _____
6. Corner Posts Size _____
7. Insulation Type _____ Size _____
8. Sheathing Type _____ Size _____
9. Siding Type _____ Weather Exposure _____
10. Masonry Materials _____
11. Metal Materials _____
Interior Walls:
1. Studding Size _____ Spacing _____
2. Header Sizes _____ Span(s) _____
3. Wall Covering Type _____
4. Fire Wal. if required _____
5. Other Materials _____

Ceiling: **HISTORIC PRESERVATION**
1. Ceiling Joists Size _____
2. Ceiling Strapping Size _____ Spacing _____
3. Type Ceiling: _____
4. Insulation Type _____ Size _____
5. Ceiling Height: _____
Roof: _____
1. Truss or Rafter Size _____ Span _____
2. Sheathing Type _____ Size _____
3. Roof Covering Type _____
Chimneys: _____
Type: _____ Number of Fire Places _____
Heating: _____
Type of Heat: _____
Electrical: _____
Service Entrance Size: _____ Smoke Detector Required Yes _____ No _____
Plumbing: _____
1. Approval of soil test if required Yes _____ No _____
2. No. of Tubs or Showers _____
3. No. of Flushes _____
4. No. of Lavatories _____
5. No. of Other Fixtures _____
Swimming Pools: _____
1. Type: _____
2. Pool Size: _____ x _____ Square Footage _____
3. Must conform to National Electrical Code and State Law.

Permit Received By Louise E. Chase
Signature of Applicant Barry Wright Date 10/29/93
Signature of CEO _____ Date _____
Inspection Dates _____

931007

Permit # _____ City of Portland BUILDING PERMIT APPLICATION Fee \$530.00 Zone _____ Map # _____ Lot# _____
Please fill out any part which applies to job. Proper plans must accompany form.

Owner Maine Wharf Assoc. Phone # _____
Address 72 Commercial St. Portland 04101
LOCATION OF CONSTRUCTION 72 Commercial Bldg. #5
Contractor Sheridan Corp. Sub. 453 9311
Address P.O. Box 689 West 04078 Phone # 774-6138
Est. Construction Cost \$101,720.00 Proposed Use Fish processing
Past Use Fish processing
of Existing Res. Units _____ # of New Res. Units _____
Building Dimensions L _____ W _____ Total Sq Ft _____
Stories _____ # Bedrooms _____ Lot Size _____
Is Proposed Use Seasonal _____ Condominium _____ Conversion _____
Explain Conversion repairs after fire Per Sam Hoffes (no plans needed)

For Official Use Only
Date Oct. 20, 1993 Subdivision _____
Inside Fire Limits _____ Name ACT 2-7-1986
Bldg Code _____ Lot _____
Time Limit _____ Ownership _____
Estimated Cost 101,720.00
Zoning: Street Frontage Provided _____
Provided Setbacks: Front _____ Side _____
Review Required: Zoning Board Approval Yes _____ No _____ Date: _____
Planning Board Approval Yes _____ No _____ Date: _____
Conditional Use _____ Variance _____ Site Plan _____ Subdivision _____
Shoreland Zoning Yes _____ No _____ Floodplain Yes _____ No _____
Special Exception _____ (Explain) _____
WACO - 10-25-93

Foundations: 32-D-192
1. Type of Soil: _____
2. Set Backs - Front _____ Rear _____ Side(s) _____
3. Footings Size: _____
4. Foundation Size: _____
5. Other: _____

Floor: 1. Sills Size: _____ Sills must be anchored.
2. Girder Size: _____
3. Lally Column Spacing: _____ Size _____
4. Joists Size: _____ Spacing 16" O C
5. Bridging Type: _____ Size _____
6. Floor Sheathing Type _____ Size _____
7. Other Material: _____

Exterior Walls: 1. Studding Size _____ Spacing _____
2. No. of windows _____
3. No. of doors _____
4. Header Sizes _____ Spacing _____
5. Bracing: Yes _____ No _____
6. Corner Posts Size _____
7. Insulation Type _____ Size _____
8. Sheathing Type _____ Size _____
9. Siding Type _____ Weather Exposure _____
10. Masonry Materials _____
11. Metal Materials _____

Interior Walls: 1. Studding Size _____ Spacing _____
2. Header Sizes _____ Spacing _____
3. Wall Covering Type _____
4. Fire Wall if required _____
5. Other Materials _____

Ceiling: 1. Ceiling Joists Size _____
2. Ceiling Strapping Size _____ Spacing _____ **HISTORIC PRESERVATION**
3. Type Ceiling: _____ **Not in District or Landmark**
4. Insulation Type _____ Size _____ **Does not require review.**
5. Ceiling Height: _____ **Requires Review.**
Roof: 1. Truss or Rafter Size _____ Spacing _____
2. Sheathing Type _____ Size _____ **Approved with Conditions**
3. Roof Covering Type _____
Chimneys: Type _____ Number of Fire Places _____ Date 10/20/93
Heating: Type of Heat _____
Electrical: Service Entrance Size _____ Smoke Detector Required Yes _____ No _____
Plumbing: 1. Approval of soil test if required Yes _____ No _____
2. No. of Tubs or Showers _____
3. No. of Flushes _____
4. No. of Lavatories _____
5. No. of Other Fixtures _____
Swimming Pools: 1. Type: _____
2. Pool Size: _____ Square Footage _____
3. Must conform to National Electrical Code and State Law

Permit Received By Latini
Signature of Applicant Ken Lamoreaux Date 10/20/93
Signature of CEO _____ Date _____
Inspection Dates _____

MAIL PERMIT TO RESOURCE TRADING P.O. BOX 1698 Portland 04104



APPLICATION FOR AMENDMENT TO PERMIT

Amendment No. 1

Portland, Maine, December 9, 1993

PERMIT ISSUED
DEC 13 1993
PORTLAND

To the INSPECTOR OF BUILDINGS, PORTLAND, MAINE

The undersigned hereby applies for amendment to Permit No. 931025 pertaining to the building or structure comprised in the original application in accordance with the Laws of the State of Maine, the Building Code and Zoning Ordinance of the City of Portland, plans and specifications, if any, submitted herewith, and the following specifications:

Location 72 Commercial St. (Maine Wharf) Within Fire Limits? _____ Dist. No. _____
Owner's name and address Resource Trading Co. Maine Wharf Assoc. Telephone _____
Lessee's name and address Resource Trading Co. 72 Commercial St. Telephone 772-2297
Contractor's name and address H. P. Fleming 89 Pleasant Ave. Sp. Portland Telephone 799-8514
Architect Cannon Engineering, Inc. Plans filed No. of sheets 2
Proposed use of building/a _____ No. families _____
Last use _____ No. families _____
Increased cost of work none Additional fee \$25.00

Description of Proposed Work HISTORIC PRESERVATION

Driving files

- Not in District nor Landmark
- Does not require review.
- Requires Review.

Action: Approved
 Approved with Conditions
 Denied

Details of New Work

Is any plumbing involved in this work? No Is any electrical work involved in this work? No
Height average grade to top of plate _____ Height average grade to highest point of roof _____
Size, front _____ depth _____ No. stories _____ solid or filled land? _____ earth or rock? _____
Material of foundation _____ Thickness, top _____ bottom _____ cellar _____
Material of underpinning _____ Height _____ Thickness _____
Kind of roof _____ Rise per foot _____ Roof covering _____
No. of chimneys _____ Material of chimneys _____ of lining _____
Framing lumber -- Kind _____ Dressed or full size? _____
Corner posts _____ Sills _____ Girt or ledger board? _____ Size _____
Girders _____ Size _____ Columns under girders _____ Size _____ Max. on centers _____
Studs (outside walls and carrying partitions) 2x4-16" O.C. Bridging in every floor and flat roof span over 8 feet.
Joints and rafters: 1st floor _____, 2nd _____, 3rd _____, roof _____
On centers: 1st floor _____, 2nd _____, 3rd _____, roof _____
Maximum span: 1st floor _____, 2nd _____, 3rd _____, roof _____

Approved: [Signature] 12-13-93

Signature of Owner: Barry H. Vakey

Approved: [Signature] Inspector of Buildings

INSPECTION COPY - WHITE
APPLICANT'S COPY - YELLOW

FILE COPY - PINK
ASSESSOR'S COPY - GOLDEN

[Signature]



APPLICATION FOR PERMIT
DEPARTMENT OF BUILDING INSPECTIONS SERVICES
ELECTRICAL INSTALLATIONS

Date 8/18/93, 19
 Receipt and Permit number 3088

To the CHIEF ELECTRICAL INSPECTOR, Portland, Maine:
 The undersigned hereby applies for a permit to make electrical installations in accordance with the laws of
 Maine, the Portland Electrical Ordinance, the National Electrical Code and the following specifications:
 LOCATION OF WORK: 72 Commercial St.
 OWNER'S NAME: Resource Trading Co ADDRESS: _____ FEES

OUTLETS:	Receptacles <u>15</u>	Switches <u>10</u>	Plugmold _____	ft. TOTAL <u>25</u>	5.00
FIXTURES: (number of)	Incandescent _____	Flourescent _____	(not strip) TOTAL _____		
	Strip Flourescent _____	ft. _____			
SERVICES:	Overhead _____	Underground _____	Temporary _____	TOTAL amperes _____	
METERS: (number of)	_____				
MOTORS: (number of)	_____				
	Fractional _____	_____			
	1 HP or over _____	_____			
RESIDENTIAL HEATING:	_____				
	Oil or Gas (number of units) _____	_____			
	Electric (number of rooms) _____	_____			
COMMERCIAL OR INDUSTRIAL HEATING:	_____				
	Oil or Gas (by a main boiler) _____	_____			
	Oil or Gas (by separate units) _____	_____			
	Electric Under 20 kws _____	Over 20 kws _____	_____		
APPLIANCES: (number of)	Ranges _____	Water Heaters _____	_____		
	Cook Tops _____	Disposals _____	_____		
	Wall Ovens _____	Dishwashers _____	_____		
	Dryers _____	Compoactors _____	_____		
	Fans _____	Others (denote) _____	_____		
	TOTAL _____	_____			
MISCELLANEOUS: (number of)	_____				4.00
	Branch Panels _____	_____			
	Transformers _____	_____			
	Air Conditioners Central Unit _____	_____			
	Separate Units (windows) _____	_____			
	Signs 20 sq. ft. and under _____	_____			
	Over 20 sq. ft. _____	_____			
	Swimming Pools Above Ground _____	_____			
	In. Ground _____	_____			
	Fire/Burglar Alarms Residential _____	_____			
	Commercial _____	4			8.00
	Heavy Duty Outlets, 220 Volt (such as welders) 30 amps and under _____	_____			
	over 30 amps _____	_____			
	Circus, Fairs, etc. _____	_____			5.00
	Alterations to wires <u>X</u> _____	_____			
	Repairs after fire _____	_____			
	Emergency Lights, Battery _____	_____			
	Emergency Generator _____	_____			
	INSTALLATION FEE DUE _____	_____			
	DOUBLE FEE DUE _____	_____			
FOR ADDITIONAL WORK NOT ON ORIGINAL PERMIT	_____				
FOR REMOVAL OF A "STOP ORDER" (304-16.b)	_____				
	TOTAL AMOUNT DUE:				22.00

INSPECTION:
 Will be ready on _____, 19____; or Will Call X
 CONTRACTOR'S NAME: Seacoast Elect Co
 ADDRESS: 74 Greenwood - Ptd
 TEL: 797-4452
 MASTER LICENSE NO. #03088 - Parckee SIGNATURE OF CONTRACTOR Harry C. Parckee
 LIMITED LICENSE NO: _____

INSPECTOR'S COPY -- WHITE
 OFFICE COPY -- CANARY
 CONTRACTOR'S COPY -- GREEN



APPLICATION FOR PERMIT
DEPARTMENT OF BUILDING INSPECTIONS SERVICES
ELECTRICAL INSTALLATIONS

Date November 24, 1993
 Receipt and Permit number 3089

To the CHIEF ELECTRICAL INSPECTOR, Portland, Maine:

The undersigned hereby applies for a permit to make electrical installations in accordance with the laws of Maine, the Portland Electrical Ordinance, the National Electrical Code and the following specifications:

LOCATION OF WORK: 72 Commercial St.
 OWNER'S NAME: Resource Trading ADDRESS: same FEES

OUTLETS:	Receptacles <u>10</u> Switches <u>6</u> Plugmold _____ ft TOTAL <u>16</u>	<u>3.20</u>
FIXTURES: (number of)	Incandescent _____ Fluorescent <u>26</u> (not strip) TOTAL <u>26</u>	<u>5.20</u>
	Strip Fluorescent <u>64</u> ft	<u>4.00</u>
SERVICES:	Overhead _____ Underground _____ Temporary _____ TOTAL amperes _____ ..	_____
METERS: (number of)	_____	_____
MOTORS: (number of)	Fractional _____	_____
	1 HP or over _____	_____
RESIDENTIAL HEATING:	Oil or Gas (number of units) _____	_____
	Electric (number of rooms) _____	_____
COMMERCIAL OR INDUSTRIAL HEATING:	Oil or Gas (by a main boiler) <u>1 Oil unit</u>	<u>5.00</u>
	Oil or Gas (by separate units) _____	_____
	Electric Under 20 kws _____ Over 20 kws _____	_____
APPLIANCES: (number of)	Ranges _____ Water Heaters <u>1</u> _____	_____
	Cook Tops _____ Disposals _____	_____
	Wall Ovens _____ Dishwashers _____	_____
	Dryers _____ Compactors _____	_____
	Fans _____ Others (denote) _____	_____
	TOTAL <u>1</u>	<u>2.00</u>
MISCELLANEOUS: (number of)	Branch Panels _____	_____
	Transformers _____	_____
	Air Conditioners Central Unit _____	_____
	Separate Units (windows) _____	_____
	Signs 20 sq. ft. and under _____	_____
	Over 20 sq. ft. _____	_____
	Swimming Pools Above Ground _____	_____
	In Ground _____	_____
	Fire/Burglar Alarms Residential _____	_____
	Commercial _____	_____
	Heavy Duty Outlets, 220 Volt (such as welders) 30 amps and under _____	_____
	over 30 amps _____	_____
	Circus, Fairs, etc. _____	_____
	Alterations to wires _____	_____
	Repairs after fire _____	<u>4.00</u>
	Emergency Lights, battery <u>4</u>	_____
	Emergency Generators _____	_____
	INSTALLATION FEE DUE: _____	_____
	FOR ADDITIONAL WORK NOT ON ORIGINAL PERMIT DOUBLE FEE DUE: _____	_____
	FOR REMOVAL OF A "STOP ORDER" (304-16.b)	<u>23.40</u>
	TOTAL AMOUNT DUE: _____	_____

INSPECTION:
 Will be ready on _____, 19__; or Will Call X
CONTRACTOR'S NAME: Seacoast Elect. Co.
ADDRESS: 74 Greenwood Portland 04103
TEL: 797-4452
MASTER LICENSE NO.: 03088 **SIGNATURE OF CONTRACTOR:** [Signature]
LIMITED LICENSE NO.: _____

INSPECTOR'S COPY — WHITE
 OFFICE COPY — CANARY
 CONTRACTOR'S COPY — GREEN

941284

FILL IN AND SIGN WITH INK



APPLICATION FOR PERMIT FOR HEATING, COOKING OR POWER EQUIPMENT

12/6/94

Portland, Maine

PERMIT ISSUED DEC - 9 1994 CITY OF PORTLAND

To the INSPECTOR OF BUILDINGS, PORTLAND, ME.

The undersigned hereby applies for a permit to install the following heating, cooking or power equipment in accordance with the Laws of Maine, the Building Code of the City of Portland, and the following specifications:

Location 72 Commercial St Use of Building manufacturing No. Stories New Building Existing Name and address of owner of appliance Resource Trading Co Installer's name and address Myland Co 199-1370 Telephone

General Description of Work

To install furnace & 2 heaters

IF HEATER, OR POWER BOILER

Location of appliance overhead Any burnable material in floor surface or beneath? no If so, how protected? Kind of fuel? natural gas Minimum distance to burnable material, from top of appliance or casing top of furnace 3 ft From top of smoke pipe 3 ft From front of appliance 10 ft From sides or back of appliance 6 ft Size of chimney flue 2 inch Other connections to same flue no If gas fired, how vented? outside Rated maximum demand per hour 125,000 BTU Will sufficient fresh air be supplied to the appliance to insure proper and safe combustion? yes

IF OIL BURNER

Name and type of burner Labelled by underwriters' laboratories? Will operator be always in attendance? Does oil supply line feed from top or bottom of tank? Type of floor beneath burner Size of vent pipe Location of oil storage Number and capacity of tanks Low water shut off Make No Will all tanks be more than five feet from any flame? How many tanks enclosed? Total capacity of any existing storage tanks for furnace burners

IF COOKING APPLIANCE

Location of appliance Any burnable material in floor surface or beneath? If so, how protected? Height of Legs, if any Skirting at bottom of appliance? Distance to combustible material from top of appliance? From front of appliance From sides and back From top of smokepipe Size of chimney flue Other connections to same flue Is hood to be provided? If so, how vented? Forced or gravity? If gas fired, how vented? Rated maximum demand per hour

MISCELLANEOUS EQUIPMENT OR SPECIAL INFORMATION

cost of work: \$ 2000 John Myland master plumber : # 1789

Amount of fee enclosed: \$30

APPROVED:

[Signature]

Will there be in charge of the above work a person competent to see that the State and City requirements pertaining thereto are observed? yes

[Signature]

INSPECTION FILE APPLICANT'S ASSESSOR'S COPY

1115 11/17/94

ELECTRICAL PERMIT

City of Portland, Me.



To the Chief Electrical Inspector, Portland Maine:
 The undersigned hereby applies for a permit to make electrical installations
 in accordance with the laws of Maine, the City of Portland Electrical Ordinance,
 National Electrical code and the following specification:

Date 05 May 1995

LOCATION: 72 Commercial St

Permit # 3507

OWNER Urchin Merchant ADDRESS _____

				TOTAL EACH FEE		
OUTLETS						
	Receptacles	Switches		15	.20	3.00
FIXTURES	(number of)					
	Incandescent	Fluorescent	9		.20	1.80
	Fluorescent strip				.20	
SERVICES						
	Overhead		TPL AMPS TO	800	15.00	
	Underground			800	15.00	
TEMPORARY SERV.						
	Overhead		AMPS OVER	800	25.00	
	Underground			800	25.00	
METERS	(number of)					
MOTORS	(number of)	1			2.00	1.00
RESID/COM	Electric units				1.00	
HEATING	oil/gas units				5.00	
APPLIANCES	Ranges	Cook Tops	Wall Ovens		2.00	
	Water heaters	Fence	Dryers		2.00	
Disposals	Dishwasher	Compactors	Others (denote)		2.00	
MISC. (number of)	Air Cond/win				3.00	
	Air Cond/cent				10.00	
	Signs				5.00	
	Pools				10.00	
	Alarms/res				5.00	
	Alarms/com				15.00	
	Heavy Duty				2.00	
	Outlets					
	Circus/Carnv				25.00	
	Alterations	xx			5.00	5.00
	Fire Repairs				15.00	
	E Lights	2			1.00	2.00
	E Generators	xxx			20.00	
	Panels	1			4.00	4.00
TRANSFER	0-25 Kva				5.00	
	25-200 Kva				8.00	
	Over 200 Kva				10.00	
				TOTAL AMOUNT DUE		
				MINIMUM FEE		25.00
				25.00		

INSPECTION: Will be ready 5/8 1:00 or will call _____

CONTRACTORS NAME Lighting Electric & Refrigeration Mark Levine

ADDRESS P.O. Box 875 Gray, ME

TELEPHONE 998-7835 774-3116

MASTER LICENSE No. 3507

SIGNATURE OF CONTRACTOR

LIMITED LICENSE No. _____

Mark Levine

PERMIT NO 3507

INSPECTIONS:

SERVICE _____ BY _____

SERVICE CALLED _____ BY _____

CLOSING 5-8-95 BY SRB

LOCATION: 72 Commercial

OWNER URchin Merchant

REMARKS: 5-23-95 Final

FINAL INSPECTION 5-23-95 BY See Below

PLUMBING APPLICATION

Department of Human Services
Division of Health Engineering
(207) 269-2826

MUNSON

PROPERTY ADDRESS

Town Or Plantation: Portland

Street Subdivision Lot #: 72 Commercial St.

PROPERTY OWNERS NAME

Meine Wharf Assoc
Last: Meine First: Wharf

Applicant Name: Hyland Company

Mailing Address of Owner/Applicant (if different): P.O. Box 2880, So. Portland, ME 04106

Date Permit Issued: 11/6/94

Local Plumbing Inspector Signature: _____

L.P.I. #: 01124

FEE: \$ _____ Double Fee Charged:

Owner/Applicant Statement

I certify that the information submitted is correct to the best of my knowledge and understanding that my profession is recognized by the Local Plumbing Inspector to carry a permit.

Signature of Owner/Applicant: [Signature] Date: 12/94

Caution: Inspection Required

I have inspected the installation authorized above and found it to be in compliance with the Maine Plumbing Rules.

Local Plumbing Inspector Signature: [Signature] Date Approved: 10-95

PERMIT INFORMATION

This Application is for	Type Of Structure To Be Served:	Plumbing To Be Installed By:
1. <input type="checkbox"/> NEW PLUMBING 2. <input type="checkbox"/> RELOCATED PLUMBING	1. <input type="checkbox"/> SINGLE FAMILY DWELLING 2. <input type="checkbox"/> MODULAR OR MOBILE HOME 3. <input type="checkbox"/> MULTIPLE FAMILY DWELLING 4. <input type="checkbox"/> OTHER — SPECIFY <u>COMMERCIAL</u>	1. <input checked="" type="checkbox"/> MASTER PLUMBER 2. <input type="checkbox"/> OIL BURNERMAN 3. <input type="checkbox"/> MFG'D HOUSING DEALER / MECHANIC 4. <input type="checkbox"/> PUBLIC UTILITY EMPLOYEE 5. <input type="checkbox"/> PROPERTY OWNER LICENSE # _____

Hook-Up & Piping Relocation Maximum of 1 Hook-Up	Column 2		Column 1	
	Number	Type of Fixture	Number	Type of Fixture
HOOK-UP to public sewer in those cases where the connection is not regulated and inspected by the local Sanitary District. OR HOOK-UP to an existing subsurface wastewater disposal system PIPING RELOCATION of sanitary lines, drains, and piping without new fixtures. Number of Hook-Ups & Relocations Hook-Up & Relocation Fee OR TRANSFER FEE (\$6.00)		Hosebib / Sillcock		Bathtub (and Shower)
		Floor Drain		Shower (Separate)
		Urinal		Sink
		Drinking Fountain		Wash Basin
		Indirect Waste		Water Closet (Toilet)
		Water Treatment Softener, Filter, etc.		Clothes Washer
		Grease / Oil Separator		Dish Washer
		Dental Cuspidor		Garage Disposal
		Bidet		Laundry Tub
		Other: _____	0.1	Water Heater
	Fixtures (Subtotal) Column 2		Fixtures (Subtotal) Column 1	
SEE PERMIT FEE SCHEDULE FOR CALCULATING FEES				
				Fixtures (Subtotal) Column 2
				Fixtures (Subtotal) Column 1
				Total Fixtures
				Fixture Fee
				Transfer Fee
				Hook-Up & Relocation Fee
				Permit Fee (Total)

City of Portland, Maine - Building or Use Permit Application 389 Congress Street, 04101, Tel: (207) 874-8763, FAX: 874-8716

Location of Construction: 12 Commercial St		Owner: Maine Wharf Assoc.	Phone:	Permit No: 950812
Owner Address:	Lease/Buyer's Name: Urchin Mercantile 72 Commercial St Portland, ME 04101	Phone:	Business Name:	PERMIT ISSUED Permit Issued: AUG - 4 1995 CITY OF PORTLAND
Contractor Name:	Address:	Phone: 772-7277 Lloyd		
Past Use: Seafood Sales	Proposed Use: Same	COST OF WORK: \$	PERMIT FEE: \$ 63.60	Zone: CBL: 030-D-001 WCTZ Zoning Approval: This limits any other future sign erected Special Zones or Reviews: <input type="checkbox"/> Shoreland <input type="checkbox"/> Wetland <input type="checkbox"/> Flood Zone <input type="checkbox"/> Subdivision <input type="checkbox"/> Site Plan Zoning Appr: <input type="checkbox"/> Variance <input type="checkbox"/> Miscellaneous <input type="checkbox"/> Conditional Use <input type="checkbox"/> Interpretation <input type="checkbox"/> Approved <input type="checkbox"/> Denied Historic Preservation <input type="checkbox"/> Not in District or Landmark <input checked="" type="checkbox"/> Does Not Require Review <input type="checkbox"/> Requires Review Action: <input type="checkbox"/> Approved <input type="checkbox"/> Approved with Conditions <input type="checkbox"/> Denied Date: 7/17/95 [Signature]
		FIRE DEPT. <input type="checkbox"/> Approved <input type="checkbox"/> Denied	INSPECTION: U Use Group: Type: Signature: [Signature]	
Proposed Project Description: Erect Signage 2 Banners each (6' x 12')		PEDESTRIAN ACTIVITIES DISTRICT (P.A.D.) Action: <input type="checkbox"/> Approved <input type="checkbox"/> Approved with Conditions <input type="checkbox"/> Denied Signature: Date:		
Permit Taken By: Mary Gresik	Date Applied For: 13 July 1995			
<p>1. This permit application doesn't preclude the Applicant from meeting applicable State and Federal rules.</p> <p>2. Building permits do not include plumbing, septic or electrical work.</p> <p>3. Building permits are void if work is not started within six (6) months of the date of issuance. False information may invalidate a building permit and stop all work.</p>				
PERMIT ISSUED WITH LETTER		Call Lloyd 772-7277 or 780-1530		
CERTIFICATION				
I hereby certify that I am the owner of record of the named property, or that the proposed work is authorized by the owner of record and that I have been authorized by the owner to make this application as his authorized agent and I agree to conform to all applicable laws of this jurisdiction. In addition, if a permit for work described in the application is issued, I certify that the code official's authorized representative shall have the authority to enter all areas covered by such permit at any reasonable hour to enforce the provisions of the code(s) applicable to such permit.				
SIGNATURE OF APPLICANT: [Signature] Lloyd Covens		ADDRESS:	DATE: 13 July 1995	PHONE:
RESPONSIBLE PERSON IN CHARGE OF WORK, TITLE:			PHONE:	
White-Permit Desk Green-Assessor's Canary-D.P.W. Pink-Public File Ivory Card-Inspector				CEO DISTRICT 2 T. M...

924387

Permit # _____ City of Portland BUILDING PERMIT APPLICATION Fee 95.00 Zone _____ Map # _____ Lot# _____

Please fill out any part which applies to job. Proper plans must accompany form.

Owner: Resource Trading Co. Phone # 772-2299
 Address: 22 87 Commercial St Main Wharf
 LOCATION OF CONSTRUCTION 72 Commercial St
 Contractor: No. Atlantic Custom Builders
 P.O. Box 1973 Portland, ME 04104 Phone # 811-7142
 Address: _____
 Est. Construction Cost: 15,000.00 Proposed Use: Comm w/storage shed
 Past Use: Comm
 # of Existing Res. Units _____ # of New Res. Units _____
 Building Dimensions L _____ W _____ Total Sq. Ft. _____
 # Stories: _____ # Bedrooms _____ Lot Size: _____
 Is Proposed Use: Seasonal _____ Condominium _____ Conversion _____
 Explain Conversion Const storage shed (31'x24') inside warehouse.

For Official Use Only

Date: November 24, 1992 Subdivision: _____
 Inside Fire Limits _____ Name: _____
 Blg Code _____ Location: _____
 Time Limit _____ Ownership: _____
 Estimated Cost _____

PERMIT ISSUED
 NOV 30 1992
 CITY OF PORTLAND

Zoning: Street Frontage Provided: 126
 Provided Setbacks: Front _____ Back _____ Side _____ Side _____

Review Required:
 Zoning Board Approval: Yes _____ No _____ Date: _____
 Planning Board Approval: Yes _____ No _____ Date: _____
 Conditional Use: _____ Variance _____ Site Plan _____ Subdivision _____
 Shoreland Zoning Yes _____ No _____ Floodplain Yes _____ No _____
 Special Exception _____
 Other (Explain) _____

HISTORIC PRESERVATION

Ceiling:
 1. Ceiling Joists Size: _____ Not in District nor Landmark
 2. Ceiling Strapping Size _____ Spacing _____ Does not require review.
 3. Type Ceilings: _____
 4. Insulation Type _____ Size _____ Requires Review.
 5. Ceiling Height: _____

Roof:
 1. Truss or Rafter Size _____ Span _____ Action: Approved.
 2. Sheathing Type _____ Size _____ Approved with conditions.
 3. Roof Covering Type _____ Date: _____
 Signature: _____

Chimneys:
 Type: _____ Number of Fire Places _____

Heating:
 Type of Heat: _____

Electrical:
 Service Entrance Size: _____ Smoke Detector Required Yes _____ No _____

Plumbing:
 1. Approval of soil test if required Yes _____ No _____
 2. No. of Tubs or Showers _____
 3. No. of Flushes _____
 4. No. of Lavatories _____
 5. No. of Other Fixtures _____

Swimming Pools:
 1. Type: _____
 2. Pool Size: _____
 3. Must conform to National Electrical Code and G.M.P.T.

Foundations:
 1. Type of Soil: _____
 2. Set Backs - Front _____ Rear _____ Side(s) _____
 3. Footings Size: _____
 4. Foundation Size: _____
 5. Other _____

Floor:
 1. Sills Size: _____ Sills must be anchored.
 2. Girder Size: _____
 3. Lally Column Spacing: _____ Size: _____
 4. Joists Size: _____ Spacing 16" O.C.
 5. Bridging Type: _____ Size: _____
 6. Floor Sheathing Type: _____ Size: _____
 7. Other Material: _____

Exterior Walls:
 1. Studding Size _____ Spacing _____
 2. No. windows _____
 3. No. Doors _____
 4. Header Sizes _____ Span(s) _____
 5. Bracing: Yes _____ No _____
 6. Corner Posts Size _____
 7. Insulation Type _____ Size _____
 8. Sheathing Type _____ Size _____
 9. Siding Type _____ Weather Exposure _____
 10. Masonry Materials _____
 11. Metal Materials _____

Interior Walls:
 1. Studding Size _____ Spacing _____
 2. Header Sizes _____ Span(s) _____
 3. Wall Covering Type _____
 4. Fire Wall if required _____
 5. Other Materials _____

PERMIT ISSUED WITH LETTER

PERMIT ISSUED WITH LETTER
 Date: Nov 24, 1992

CONTINUED TO REVERSE SIDE
 Ivory Tag - CEO

White - Tax Assessor

MM. Leary

930857

Permit # 930857 City of Portland BUILDING PERMIT APPLICATION Fee \$35. Zone _____ Map # _____ Lot # _____
Please fill out any part which applies to job. Proper plans must accompany form.

Owner: Resource Trading Co. Phone # 772-2299
Address: Box 1698 - Ptld, ME 04104
LOCATION OF CONSTRUCTION 72 Commercial St. (Haine Wharf)
Contractor: RiCo Portsmouth Sub: _____
Address: _____ Phone # 435-6646
Est. Construction Cost: _____ Proposed Use: seafood processing tank
Past Use: seafood processing
of Existing Res. Units _____ # of New Res. Units _____
Building Dimensions L _____ W _____ Total Sq. Ft. _____
Stories: _____ # Bedrooms _____ Lot Size: _____
Is Proposed Use: Seasonal _____ Condominium _____ Conversion _____
Explain Conversion Install a/g liquid nitrogen tank - 6000 gal
(for freezing purposes)

For Official Use Only
Date 9/10/93
Trade Fire Limits _____
Bldg Code _____
Time Limit _____
Estimated Cost _____
Subdivision _____
Name 930857
City of Portland
Zoning: _____
Street Frontage Provided: _____
Provided Setbacks: Front _____ Back _____ Side _____
Review Required:
Zoning Board Approval: Yes _____ No _____ Date: _____
Planning Board Approval: Yes _____ No _____ Date: _____
Conditional Use _____ Variance _____ Site Plan _____ Subdivision _____
Shoreland Zoning Yes _____ No _____ Floodplain Yes _____ No _____
Special Exception _____
Other W.D.M. - 9-14-93

- Foundation:
1. Type of Soil: _____
2. Set Backs - Front _____ Rear _____ Side(s) _____
3. Footings Size: _____
4. Foundation Size: _____
5. Other _____
- Floors:
1. Sills Size: _____ Sills must be anchored.
2. Girder Size: _____
3. Lally Column Spacing: _____ Size: _____
4. Joists Size: _____ Spacing 16" O.C.
5. Bridging Type: _____ Size: _____
6. Floor Sheathing Type: _____ Size: _____
7. Other Material: _____
- Exterior Walls:
1. Studding Size _____ Spacing _____
2. No. windows _____
3. No. Doors _____
4. Header Sizes _____ Span(s) _____
5. Bracing: Yes _____ No _____
6. Corner Posts Size _____
7. Insulation Type _____ Size: _____
8. Sheathing Type _____ Size: _____
9. Siding Type _____ Weather Exposure _____
10. Masonry Materials _____
11. Metal Materials _____
- Interior Walls:
1. Studding Size _____ Spacing _____
2. Header Sizes _____ Span(s) _____
3. Wall Covering Type _____
4. Fire Wall If required _____
5. Other Materials _____

- Ceiling:
1. Ceiling Joists Size: _____
2. Ceiling Strapping Size _____ Spacing _____ Not in District nor Landmark.
3. Type Ceiling: _____ Does not require review.
4. Insulation Type _____ Size _____ Requires Review.
5. Ceiling Height: _____
- Roof:
1. Truss or Rafter Size _____ Span _____ Action _____ Approved
2. Sheathing Type _____ Size _____ Approved with Conditions.
3. Roof Covering Type _____
- Chimneys:
Type: _____ Number of Fire Places _____ Date: _____
- Heating:
Type of Heat: _____
- Electrical:
Service Entrance Size: _____ Smoke Detector Required Yes _____ No _____
- Plumbing:
1. Approval of soil test if required Yes _____ No _____
2. No. of Tubs or Showers _____
3. No. of Flushes _____
4. No. of Lavatories _____
5. No. of Other Fixtures _____
- Swimming Pools:
1. Type: _____
2. Pool Size: _____ x _____ Square Footage _____
3. Must conform to National Electrical Code and State Law.

PERMIT ISSUED WITH REQUIREMENTS

Permit Received By Louise E. Chase
Signature of Applicant Barry Wight Date _____
CEO's District 2

CONTINUED TO REVERSE SIDE
Ivory Tag - CEO

#2

White - Tax Assessor

INSTRUCTIONS

First - The applicant is to complete front of this form. The Tax Map Reference can be found on your Real Estate Tax Bill directly following owners name and address in the center of your Property Tax Bill. Billing name and address should be copied from your Water & Sewer Bill as well as the Portland Water District Account Number which is in the lower left corner of the Water and Sewer Bill.

Second - Fill completed application form to:

City of Portland
Dept. of Public Works
404 City Hall
Portland, Maine 04201

ATTN: MR. WILLIAM GOODWIN

Third - The Public Works Department will call the person indicated on front side to schedule pre-installation inspection. During this inspection the Public Works section of this form (below) will be completed. Following this inspection Public Works will make copies of the application form. If the application is approved 3 copies will be made, one will be mailed to the Portland Water District, one will be forwarded to the City Plumbing Inspector and one will be mailed back to the Applicant. If the application is denied, one copy will be made and mailed to the applicant showing reason for denial.

Fourth - Upon receipt of a copy of the approved application, the applicant can purchase and install the sub-meter as approved. Following installation the applicant or his plumber must call the Chief Plumbing Inspector at 773-5451 Ext. 601 for an inspection of the completed installation. Following inspection by the Chief Plumbing Inspector, the Water District will be requested to send the sub-meter and arrange to have an automatic reading system (if applicable - see General Information) installed where by the volume shown by the sub-meter will be credited on the Sewer User Charge of the Bill.

353

GENERAL INFORMATION

Section 22.6C of the "Municipal Code of the City of Portland, Maine" reads as follows:

"Submetering of Water Volume. Any person who feels that reported water records are not a reliable index of his discharge volume may install an additional water meter of a type approved by the Director to measure the volume of water which can be shown not to enter the sewerage system. The person installing such a meter shall immediately notify the Director for reporting meter readings and shall be responsible to the Director for reporting meter readings not less often than every three months. Such person shall be credited with the volume charged for the volume shown by such meter, which meter shall be accessible for reading by the City or its agents at all reasonable times."

The City and the District have arranged to relieve the customer from the reporting responsibility required above if both meters can be read simultaneously by the District meter readers during their regularly scheduled visits to read the pre-existing service meter. This can be accomplished by locating the sub-meter directly adjacent to the pre-existing service meter or by equipping the sub-meter located elsewhere with a remote reading register located so both readings can be made at the same time.

Approved meters are: Neptune and Rockwell meters, conforming to the following specifications:

1. shall meet or exceed AMA accuracy test requirements and be accompanied by a certificate of test accuracy.
2. the meters will have straight reading, cubic foot registers.
3. the meters will have the meter number stamped into the main case.
4. the meters shall be magnetic drive.
5. shall have either a rotating disc or oscillating piston.
6. shall have a bronze case.

Approved meters are available from the Water District, which sells them for the price the District buys them from the manufacturers. If you wish to purchase a sub-meter from the District you must bring your copy of an approved application with you at time of purchase.

TO BE COMPLETED BY PUBLIC WORKS

Pre-installation inspection by Bill Goodwin Norm Twaddel

on September 22, 1980

Automatic reading system requested YES NO

A _____ Back Flow Preventer or equal shall be installed

Application Approved Denied

Comments Joe Schmaier indicated that they had Watts SA Backflow Preventers for use when hoses were in use but due to theft and vandalism they were not left on sillcocks when not in use. At inspection time they were not on the sillcocks, but no hoses were in use at the time

TO BE COMPLETED BY THE PLUMBING INSPECTOR

An inspection of the completed installation of the submetering system approved on this application was conducted on 4-21-83 by Ernie R. Goodwin, Chief Plumbing Inspector of the City of Portland

The submetering system was installed as approved.

No cross connections were found.

The installation is approved dis-approved

TO BE COMPLETED BY THE WATER DISTRICT

Date submeter sold 9-25-80
Submeter account number P-94-2970 C
Submeter make and number 5/8 P
Submeter installation readings #
Submeter account entered into computer _____
Submeter account entered into meter book 9-25-80
Special Instructions _____

NOTE - CHECK NUMBER ON METER IN BUILDING

APPLICATION FOR SUBMETER



RECEIVED

SEP 22 1980

PUBLIC WORKS ENGINEERING

For Sewer User Charge Adjustments

The undersigned hereby requests permission to install additional water meter(s) in accordance with Section 322.6C of the "Municipal Code of the City of Portland, Maine".

It is understood that all expenses related to the purchase installation and maintenance of the meter(s) is to be borne by the applicant.

To be Completed by Applicant

Address where sub-meter is requested 70 Commercial Street

Property owner name Schmader Realty Corp.

Tax Map Reference (on Real Estate Tax Bill) 30-D-1

Property owner address P.O. Box 3542 Portland, Maine 04104

Person to be contacted to schedule inspections Joseph Schmader 773-1761
(Name and Telephone Number)

Portland Water District Acct. No. (on bill) P-94-2970 C

Billing Name & Address (on bill) Gowen Marine Inc.
70 Commercial St.

Location and size existing Portland Water District Service Meter 1" Ø meter in boiler room of building # 1

Proposed location and size of sub-meter 2 submeters 5/8" Ø in building # 3
one in main room on far wall - one in the bathroom

Will a remote reading register be utilized? NO YES (if yes, state location
owner to send cards with City taking periodical check readings)

Description of proposed changes in plumbing required for submetering:

① main room - cut in submeter with yoke in line to outside sillcock

② bathroom - cut in submeter in line to outside sillcock

The volume of water to be submetered can be shown not to enter the sewerage system by virtue of its use for:

water for ships

Building # 4

Sketch plan showing proposed changes in plumbing and the location of existing and proposed meters. Show water flow through submeter to non-discharge equipment or location (use additional sheet of paper if necessary)

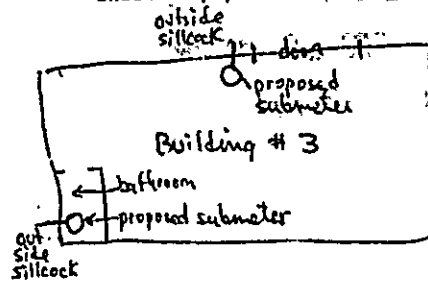

I certify the above information is true and correct:

Joseph Schmader
Signature

no date

9/22/80
Date

INSTRUCTIONS

First - The applicant is to complete front of this form. The Tax Map Reference can be found on your Real Estate Tax Bill directly following owners name and address in the center of your Property Tax Bill. Billing Map and address should be copied from your Water & Sewer Bill as well as the Portland Water District Account Number which is in the lower left corner of the Water and Sewer Bill.

Second - Full completed application form to:

City of Portland
Dept. of Public Works
204 City Hall
Portland, Maine 04103

ATTN: MR. WILLIAM GOODWIN

Third - The Public Works Department will call the person indicated on front side to schedule pre-installation inspection. During this inspection the Public Works section of this form (below) will be completed. Following this inspection Public Works will make copies of the application form. If the application is approved 3 copies will be made, one will be mailed to the Portland Water District; one will be forwarded to the City Plumbing Inspector and one will be mailed back to the Applicant. If the application is denied, one copy will be made and mailed to the applicant (copy reason for denial).

Fourth - Upon receipt of a copy of the approved application, the applicant can purchase and install the sub-meter as approved. Following installation the applicant or his plumber must call the Chief Plumbing Inspector at 775-8433 Ext. 809 for an inspection of the completed installation. Following inspection by the Chief Plumbing Inspector, the Water District will be requested to seal the sub-meter and arrange to have an automatic reading system (if applicable - See General Information) installed where by the volume shown by the submeter will be credited on the Sewer User Charge of the Bill.

353

GENERAL INFORMATION

Section 222.02 of the "Municipal Code of the City of Portland, Maine" reads as follows:

"Submetering of Water Volume. Any person who feels that reported water records are not a reliable index of his discharge volume may install an additional water meter of a type approved by the Director to measure the volume of water which can be shown not to enter the sewerage system. The person installing such a meter shall immediately notify the Director of such installation and shall be responsible to the Director for reporting meter readings not less often than every three months. Such person shall be credited with the volume charges for the volume shown by such meter, which meter shall be accessible for reading by the City or its agents at all reasonable times."

The City and the District have arranged to relieve the customer from the reporting responsibility required above if both meters can be read simultaneously by the District Meter Readers during their regularly scheduled visits to read the pre-existing service meter. This can be accomplished by locating the sub-meter directly adjacent to the pre-existing service meter or by enclosing the sub-meter located elsewhere with a remote reading register located so both readings can be made at the same time.

Approved meters are: Neptune and Beckwith meters, conforming to the following specifications:

1. shall meet or exceed ANSI accuracy test requirements and be accompanied by a certificate of test accuracy.
2. the meters will have straight reading, cubic foot registers.
3. the meters will have the meter number stamped into the metal case.
4. the meters shall be magnetic drive.
5. shall have either a rotating disc or oscillating piston.
6. shall have a bronze case.

Approved meters are available from the Water District, which sells them for the price the District buys them from the manufacturers. If you wish to purchase a sub-meter from the District you must bring your copy of an approved application with you at time of purchase.

TO BE COMPLETED BY PUBLIC WORKS

Pre-installation inspection by: Bill Goodwin Norm Twaddel

on Sept - 27, 1980

Automatic reading system requested YES NO

A _____ Back Flow Preventer or equal shall be installed

Application Approved Denied

Comments Joe Schmader indicated that they had Watts 8A backflow preventers for use when hoses were hooked up but due to theft and vandalism they were not left on sillcocks when not in use. At inspection time they were not on the sillcocks, but there were no hoses in use at the time

TO BE COMPLETED BY THE PLUMBING INSPECTOR

An inspection of the completed installation of the submetering system approved on this application was conducted on 4-21-83
By Ernold R. Goodwin, Chief Plumbing Inspector of the City of Portland.

- The submetering system was installed as approved
 No cross connections were found.

The installation is approved dis-approved Ernold Goodwin

TO BE COMPLETED BY THE WATER DISTRICT

Date submeter sold 9-25-80
Submeter account number P-94-2970C
Submeter make and number 5/8"R
Submeter installation readings 00
Submeter account entered into computer 00
Submeter account entered into meter book 9-25-80
Special Instructions _____

NOTE - CHECK NUMBER ON METER IN BUILDING

APPLICATION FOR SUBMETER



RECEIVED
SEP 22 1980
PUBLIC WORKS ENGINEERING

For Sewer User Charge Adjustments

The undersigned hereby requests permission to install additional water meter(s) in accordance with Section 322.60 of the "Municipal Code of the City of Portland, Maine".

It is understood that all expenses related to the purchase, installation and maintenance of the meter(s) is to be borne by the applicant.

To be Completed by Applicant

Address where sub-meter is requested 70 Commercial Street

Property owner name Schmader Realty Corp

Tax Map Reference (on Real Estate Tax Bill) 30-D-1

Property owner address P.O. Box 3542 Portland Maine 04104

Person to be contacted to schedule inspections Joseph Schmader 773-1761
(Name and Telephone Number)

Portland Water District Acct. No. (on bill) P-94-2970C

Billing Name & Address (on bill) Gowen Marine Inc
70 Commercial St.

Location and size existing Portland Water District Service Meter 1" Ø meter in
boiler room of building #1

Proposed location and size of sub-meter 5/8" Ø inside garage door of
building #4

Will a remote reading register be utilized? YES (If yes, state location _____)
Cards will be sent by owner with City taking periodic check readings

Description of proposed changes in plumbing required for submetering:

cut in submeter with yoke
in line to outside sillcock

The volume of water to be submetered can be shown not to enter the sewerage system by virtue of its use for:

water for ships

Sketch plan showing proposed changes in plumbing and the location of existing and proposed meters. Show water flow through submeter to non-discharge equipment or location (use additional sheet of paper if necessary)

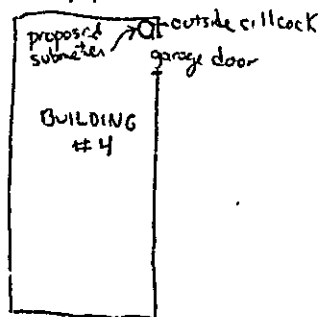

I certify the above information is true and correct:

Joseph Schmader
Signature

no date

9/22/80
Date