



APPLICATION FOR PERMIT
DEPARTMENT OF BUILDING INSPECTIONS SERVICES
ELECTRICAL INSTALLATIONS

Date 3/7/85, 19
 Receipt and Permit number 00433

To the CHIEF ELECTRICAL INSPECTOR, Portland, Maine:

The undersigned hereby applies for a permit to make electrical installations in accordance with the laws of Maine, the Portland Electrical Ordinance, the National Electrical Code and the following specifications:

LOCATION OF WORK: 46 Custom House Wharf
 OWNER'S NAME: R&S Seafood Co. ADDRESS: same

	FEES
OUTLETS:	
Receptacles _____ Switches _____ Plugmold _____ ft. TOTAL <u>1-30</u>	3.00
FIXTURES: (number of)	
Incandescent _____ Fluorescent _____ (not strip) TOTAL <u>1-10</u>	3.00
Strip Fluorescent <u>160</u> ft.	14.20
SERVICES:	
Overhead <u>x</u> Underground _____ Temporary _____ TOTAL amperes <u>200 + 200</u> 400	6.00
METERS: (number of) <u>2</u>	1.00
MOTORS: (number of)	
Fractional _____	
1 HP or over <u>6</u>	5.00
RESIDENTIAL HEATING:	
Oil or Gas (number of units) _____	
Electric (number of rooms) _____	
COMMERCIAL OR INDUSTRIAL HEATING:	
Oil or Gas (by a main boiler) _____	
Oil or Gas (by separate units) _____	
Electric Under 20 kws <u>x</u> Over 20 kws _____	5.00
APPLIANCES: (number of)	
Ranges _____ Water Heaters _____	
Cook Tops _____ Disposals _____	
Wall Ovens _____ Dishwashers _____	
Dryers _____ Compactors _____	
Fans _____ Others (denote) _____	
TOTAL _____	
MISCELLANEOUS: (number of)	
Branch Panels <u>1</u>	1.00
Transformers _____	
Air Conditioners Central Unit _____	
Separate Units (windows) _____	
Signs 20 sq. ft. and under _____	
Over 20 sq. ft. _____	
Swimming Pools Above Ground _____	
In Ground _____	
Fire/Burglar Alarms Residential _____	
Commercial _____	
Heavy Duty Outlets, 220 Volt (such as welders) 30 amps and under _____	
over 30 amps _____	
Circus, Fairs, etc. _____	
Alterations to wires _____	
Repairs after fire _____	
Emergency Lights, battery _____	
Emergency Generators _____	
FOR ADDITIONAL WORK NOT ON ORIGINAL PERMIT INSTALLATION FEE DUE.	
FOR REMOVAL OF A "STOP ORDER" (304-16.b) DOUBLE FEE DUE.	
TOTAL AMOUNT DUE:	39.20

INSPECTION:

Will be ready on _____, 19____; or Will Call x

CONTRACTOR'S NAME: Seacoast Electric Co.

ADDRESS: Leavitt St., Long Island

TEL: _____

MASTER LICENSE NO. X 03088 SIGNATURE OF CONTRACTOR: _____

LIMITED LICENSE NO.: _____

INSPECTOR'S COPY — WHITE
 OFFICE COPY — CANARY
 CONTRACTOR'S COPY — GREEN



APPLICATION FOR PERMIT
DEPARTMENT OF BUILDING INSPECTIONS SERVICES
ELECTRICAL INSTALLATIONS

Date April 10, 19 86
 Receipt and Permit number D-26440

To the CHIEF ELECTRICAL INSPECTOR, Portland, Maine:
 The undersigned hereby applies for a permit to make electrical installations in accordance with the laws of
 Maine, the Portland Electrical Ordinance, the National Electrical Code and the following specifications:

LOCATION OF WORK: 46 Custom House Wharf
 OWNER'S NAME: R & S Seafood Co. ADDRESS: same

	FEES
OUTLETS:	
Receptacles _____ Switches _____ Plugmold _____ ft. TOTAL <u>1-30</u>	3.00
FIXTURES: (number of)	
Incandescent <u>x</u> Fluorescent _____ (not strip) TOTAL <u>1-10</u>	3.00
Strip Fluorescent _____ ft.	
SERVICES:	
Overhead _____ Underground _____ Temporary _____ TOTAL amperes _____ ..	
METERS: (number of)	
MOTORS: (number of)	
Fractional	3.00
1 HP or over <u>3</u>	
RESIDENTIAL HEATING:	
Oil or Gas (number of units)	
Electric (number of rooms)	
COMMERCIAL OR INDUSTRIAL HEATING:	
Oil or Gas (by a main boiler)	
Oil or Gas (by separate units)	
Electric Under 20 kws <u>x</u> Over 20 kws	5.00
APPLIANCES: (number of)	
Ranges _____ Water Heaters _____	
Cook Tops _____ Disposals _____	
Wall Ovens _____ Dishwashers _____	
Dryers _____ Compactors _____	
Fans _____ Others (denote) _____	
TOTAL	
MISCELLANEOUS: (number of)	
Branch Panels	
Transformers	
Air Conditioners Central Unit _____	
Separate Units (windows)	
Signs 20 sq. ft. and under	
Over 20 sq. ft.	
Swimming Pools Above Ground	
In Ground	
Fire/Burglar Alarms Residential	
Commercial	
Heavy Duty Outlets, 220 Volt (such as welders) 30 amps and under	
over 30 amps	
Circus, Fairs, etc.	
Alterations to wires	
Repairs after fire	
Emergency Lights, battery	
Emergency Generators	
FOR ADDITIONAL WORK NOT ON ORIGINAL PERMIT	INSTALLATION FEE DUE:
FOR REMOVAL OF A "STOP ORDER" (304-16.b)	DOUBLE FEE DUE:
	TOTAL AMOUNT DUE: 14.00

INSPECTION:
 Will be ready on _____, 19____; or Will Call _____
CONTRACTOR'S NAME: Harry Papkee
ADDRESS: 3400 Long Island
TEL: 3372
MASTER LICENSE NO.: X 088 **SIGNATURE OF CONTRACTOR:** Harry Papkee
LIMITED LICENSE NO.: _____

ELECTRICAL INSTALLATIONS

Permit Number 216440

Location 46 Canton Street Westford

Owner R & S Sea Food

Date of Permit 4-19-86

Final Inspection 4-24-86

By Inspector *[Signature]*

Permit Application Register Page No. 109

Commercial SA

INSPECTIONS: Serviced by _____
 Service called in _____
 Closing-in 4-24-86 by *[Signature]*

PROGRESS INSPECTIONS: _____ / _____ / _____ / _____ / _____

CODE
COMPLIANCE
COMPLETED
DATE

4-24-86

DATE:	REMARKS:

[Handwritten signature]

X

06 9064.70

steven Keith

APPLICATION



FOR SUBMETER

RECEIVED
MAY 6 1980
PUBLIC WORKS ENGINEERING

For Sewer User Charge Adjustments

The undersigned hereby requests permission to install additional water meter(s) in accordance with Section 322.6C of the "Municipal Code of the City of Portland, Maine"

It is understood that all expenses related to the purchase, installation and maintenance of the meter(s) is to be borne by the applicant.

To be Completed by Applicant

Address where sub-meter is requested 46 Custom House Wharf

Property owner name Proprietors of Custom House Wharf

Tax Map Reference (on Real Estate Tax Bill) 30-A-1,2

Property owner address George E. Macgowan 5 Eastern Prom.

Person to be contacted to schedule inspections Ronald Lamb 773-7171
(Name and Telephone Number)

Portland Water District Acct. No. (on bill) P-90-4376

Billing Name & address (on bill) R.E. Sears Co
46 Custom House Wharf

Location and size existing Portland Water District Service Meter

ground meter box outside building about 10' from CMP Pole #6

Proposed location and size of sub-meter 1" Ø with bypass on 1" line supplying cooling water and water to ice machine 2nd floor center

Will a remote reading register be utilized? NO YES (If yes, state location outside on wall of building near meter box)

Description of proposed changes in plumbing required for submetering:

install submeter with proper by-pass in existing 1" supply line to second floor ice machine

The volume of water to be submetered can be shown not to enter the sewerage system by virtue of its use for:

non-contact cooling water and ice

Sketch plan showing proposed changes in plumbing and the location of existing and proposed meters. Show water flow through submeter to non-discharge equipment or location (use additional sheet of paper if necessary)

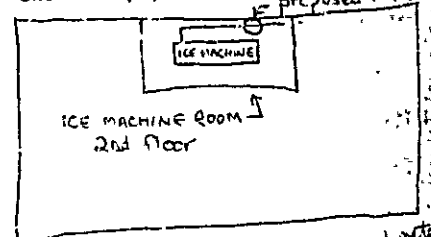

existing ground meter box
CUSTOM HOUSE WHARF

← TO COMMERCIAL ST

I certify the above information is true and correct:

Ronald Lamb
Signature

5/6/80
Date

INSTRUCTIONS

- First - The applicant is to complete front of this form. The Tax Map Reference can be found on your Real Estate Tax Bill directly following owners name and address in the center of your Property Tax Bill. Billing name and address should be copied from your Water & Sewer Bill at well as the Portland Water District Account Number which is in the lower left corner of the Water and Sewer Bill.
- Second - Fill completed application form to.
City of Portland
Dept. of Public Works
424 City Hall
Portland, Maine 04101
ATTN: MR. WILLIAM GOODWIN
- Third - The Public Works Department will call the person indicated on front side to schedule pre-installation inspection. During this inspection the Public Works section of this form (bottom) will be completed. Following inspection Public Works will make copies of the application form. If the application is approved 3 copies will be made, one will be mailed to the Portland Water District, one will be forwarded to the City Planning Inspector and one will be mailed back to the Applicant. If the application is denied, one copy will be made and mailed to the applicant showing reason for denial.
- Fourth - Upon receipt of a copy of the approved application, the applicant can purchase and install the sub-meter as approved. Following installation the applicant or his plumber must call the Chief Plumbing Inspector at 273-5551 Ext. 231 for an inspection of the completed installation. Following inspection by the Chief Plumbing Inspector, the Water District will be requested to seal the sub-meter and arrange to have an automatic reading system (if applicable - See General Information) installed where by the volume shown by the sub-meter will be credited on the Sewer User Charge of the Bill.

GENERAL INFORMATION

Section 22.6C of the Municipal Code of the City of Portland, Maine, reads as follows:

"Submetering of Water Meters. Any person who feels that recorded water records are not a reliable index of his discharge volume may install an additional water meter of a type approved by the Director to measure the volume of water which can be shown not to enter the storage system. The person installing such a meter shall immediately notify the Director of such installation and shall be responsible to the Director for reporting meter readings not less often than every three months. Such person shall be credited with the volume charged for the volume shown by such meter, which meter shall be accessible for reading by the City or its agents at all reasonable times."

The City and the District have arranged to relieve the customer from the reporting responsibility required above if both meters can be read simultaneously by the District Meter Readers during their regularly scheduled visits to read the pre-existing service meter. This can be accomplished by locating the sub-meter directly adjacent to the pre-existing service meter or by equipping the sub-meter location elsewhere with a remote reading register located so both readings can be made at the same time.

Approved meters are: Neptune and Packwell meters, conforming to the following specifications:

1. shall meet or exceed ANSI accuracy test requirements and be accompanied by a certificate of test accuracy.
2. the meters will have straight reading, cubic foot registers.
3. the meters will have the meter number stamped into the main case.
4. the meters shall be magnetic drive.
5. shall have either a rotating disc or oscillating piston.
6. shall have a bronze case.

Approved meters are available from the Water District, which sells them for the price the District buys them from the manufacturer. If you wish to purchase a sub-meter from the District you must bring your copy of an approved application with you at time of purchase.

TO BE COMPLETED BY PUBLIC WORKS

Pre-installation inspection by Bill Goodwin, Norm Twaddell
on May 6, 1980

Automatic reading system requested YES NO

A _____ Back Flow Preventer or equal shall be installed

Application Approved Denied

Comments A number of changes to take place in near future
Public Works Dept. to be kept informed

TO BE COMPLETED BY THE PLUMBING INSPECTOR

An inspection of the completed installation of the submetering system approved on this application was conducted on 5/14/80 by Ernold R. Goodwin, Chief Plumbing Inspector of the City of Portland.

- The submetering system was installed as approved.
- No cross connections were found.

The installation is approved dis-approved

TO BE COMPLETED BY THE WATER DISTRICT

① Speaking w/ Jeanne Morse (Portland Wtn. Dist.) 2/10/89

② found this entry incorrect

Date Submeter sold 3-25-80

Submeter account number P-90-1336

Submeter make and number ET #25186922

Submeter installation readings -0-

Submeter account entered into computer -0-

Submeter account entered into meter book 3-25-80

Special Instructions _____

REPLACED 1" R #2468078T (damaged through frost) with 1" R #2468078T 2/10/89

INCORRECT THE ABOVE INFO IS FOR #24 CUSTOM HOUSE WHARF

Should have been 6/18/1980 P-90-4376 1" R #2468078T -0- FJB 2/10/89

CORRECT to 2/10/89