

10 WILLIS STREET

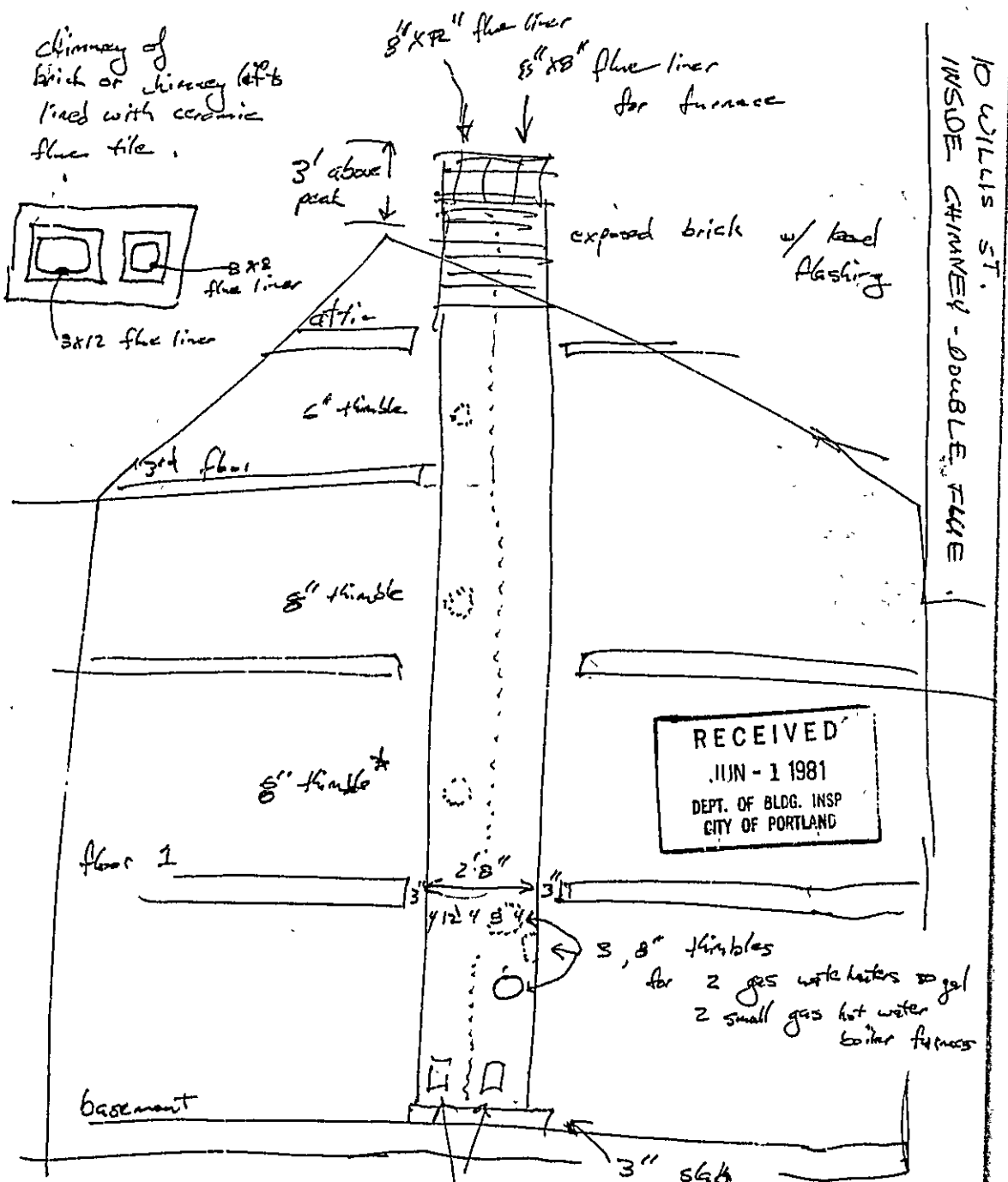

* extended thimble through flammable well shall be of insulated piping materials.

All framing shall be adequately spaced from the chimney.

APPLICATION FOR PERMIT

PERMIT ISSUED

B.O.C.A. USE GROUP

B.O.C.A. TYPE OF CONSTRUCTION

JUN 8 1981

473

CITY OF PORTLAND

ZONING LOCATION PORTLAND, MAINE, June 1, 1981

To the DIRECTOR OF BUILDING & INSPECTION SERVICES, PORTLAND, MAINE

The undersigned hereby applies for a permit to erect, alter, repair, demolish, move or install the following building, structure, equipment or change use in accordance with the Laws of the State of Maine, the Portland B.O.C.A. Building Code and Zoning Ordinance of the City of Portland with plans and specifications, if any, submitted herewith and the following specifications:

- LOCATION 10 Willis St. Fire District #1 [], #2 []
1. Owner's name and address James A. Bill 104 Winter St. Telephone 772-7911
2. Lessee's name and address Telephone
3. Contractor's name and address OWNER Telephone
4. Architect Specifications Plans No. of sheets
Proposed use of building No. families
Last use No. families
Material No. stories Heat Style of roof Roofing
Other buildings on same lot
Estimated contractual cost \$ 700 Fee \$ 5.50

FIELD INSPECTOR-Mr. GENERAL DESCRIPTION

This application is for: @ 775-5451 Ext. 234 To construct interior chimney as per plan
Dwelling
Garage
Masonry Bldg.
Metal Bldg.
Alterations
Demolition:
Change of Use
Other

Stamp of Special Conditions

NOTE TO APPLICANT: Separate permits are required by the installers and subcontractors of heating, plumbing, electrical and mechanicals.

PERMIT IS TO BE ISSUED TO 1 [x] 2 [] 3 [] 4 []

Other:

DETAILS OF NEW WORK

- Is any plumbing involved in this work? Is any electrical work involved in this work?
Is connection to be made to public sewer? if not, what is proposed for sewage?
Has septic tank notice been sent? Form notice sent?
Height average grade to top of plate Height average grade to highest point of roof
Size, front depth No. stories solid or filled land? earth or rock?
Material of foundation Thickness, top bottom cellar
Kind of roof Rise per foot Roof covering
No. of chimneys Material of chimneys of lining Kind of heat fuel
Framing Lumber-Kind Dressed or full size? Corner posts Sills
Size Girder Columns under girders Size Max. on centers
Studs (outside walls and carrying partitions) 2x4-16" O. C. Bridging in every floor and flat roof span over 8 feet.
Joists and rafters: 1st floor 2nd 3rd roof
On centers: 1st floor 2nd 3rd roof
Maximum span: 1st floor 2nd 3rd roof
If one story building with masonry walls, thickness of walls? height?

IF A GARAGE

No. cars now accommodated on same lot ..., to be accommodated ... number commercial cars to be accommodated ...
Will automobile repairing be done other than minor repair, to cars habitually stored in the proposed building?

APPROVALS BY:

DATE

MISCELLANEOUS

BUILDING INSPECTION-PLAN EXAMINER Will work require disturbing of any tree on a public street?

ZONING:

BUILDING CODE:

Will there be in charge of the above work a person competent to see that the State and City requirements pertaining thereto are observed? ... YES

Fire Dept.:

Health Dept.:

Others:

Signature of Applicant Phone #

Type Name of above James A. Bill 1 [] 2 [] 3 [] 4 []

Other and Address

FIELD INSPECTOR'S COPY



NOTES

6/8/81 - Stopped job because of conflict
between ^{ISO} fire code and BOA code
regarding # of wood shaves flued into one
line. OK

6/9/81 - Discussed with Mr. Collins - he
referred to W. Hulston. Discussed w/
W.H. and he approved design as
submitted. OK

10-28-81 Re/ chimney is nearly
complete but not
above roof peak
yet. OK

2-2-82 Chimney has
been completed, checked
chimney on roof
OK

Approved

Date of permit 6-3-81

Owner James A. B. B.

Location 10 W. Hill St.

Permit No. 81/473



APPLICATION FOR PERMIT

PERMIT ISSUED

NOV 28 1977

CITY of PORTLAND

B.O.C.A. USE GROUP
 B.O.C.A. TYPE OF CONSTRUCTION 1074
 ZONING LOCATION PORTLAND, MAINE, 11-28-77

To the DIRECTOR OF BUILDING & INSPECTION SERVICES, PORTLAND, MAINE
 The undersigned hereby applies for a permit to erect, alter, repair, demolish, move or install the following building, structure, equipment or change use in accordance with the Laws of the State of Maine, the Portland B.O.C.A. Building Code and Zoning Ordinance of the City of Portland with plans and specifications, if any, submitted herewith and the following specifications:

LOCATION 10 Willis Street
 1. Owner's name and address Robert Kaukey Fire District #1 , #2
 2. Lessee's name and address Telephone 774 3843
 3. Contractor's name and address Shawnee Step Co., Telephone
 4. Architect Specifications Plans Telephone
 Proposed use of building No. of sheets
 Last use No. families
 Material No. stories 2 1/2 Heat Style of roof No. families
 Other buildings on same lot Roofing
 Estimated contractual cost \$... 226.00
 Fee \$.. 23.60.....

FIELD INSPECTOR—Mr. GENERAL DESCRIPTION
 This application is for: Side Shawnee Step 4'-3riser- 42" plat
 Dwelling @ 775-5451 Ext. 234 ht 22 1/2" proj. 61"

Stamp of Special Conditions

NOTE TO APPLICANT: Separate permits are required by the installers and subcontractors of heating, plumbing, electrical and mechanicals.

PERMIT IS TO BE ISSUED TO 1 2 3 4
 Other:

DETAILS OF NEW WORK

Is any plumbing involved in this work? Is any electrical work involved in this work?
 Is connection to be made to public sewer? If not, what is proposed for sewage?
 Has septic tank notice been sent? Form notice sent?
 Height average grade to top of plate Height average grade to highest point of roof
 Size, front depth No. stories solid or filled land? earth or rock?
 Material of foundation Thickness, top bottom cellar
 Kind of roof Rise per foot Roof covering Kind of heat fuel
 No. of chimneys Material of chimneys of lining Sills
 Framing Lumber—Kind Dressed or full size? Corner posts
 Size Girder Columns under girders Size Max. on centers
 Studs (outside walls and carrying partitions) 2x4-16" O. C. Bridging in every floor and flat roof span over 8 feet.
 Joists and rafters: 1st floor 2nd 3rd roof
 On centers: 1st floor 2nd 3rd roof
 Maximum span: 1st floor 2nd 3rd roof
 If one story building with masonry walls, thickness of walls? height?

IF A GARAGE

No. cars now accommodated on same lot to be accommodated ... number commercial cars to be accommodated ...
 Will automobile repairing be done other than minor repairs to cars habitually stored in the proposed building?

APPROVALS BY: DATE
 BUILDING INSPECTION—PLAN EXAMINER
 ZONING:
 BUILDING CODE:

MISCELLANEOUS
 Will work require disturbing of any tree on a public street? ..
 Will there be in charge of the above work a person competent to see that the State and City requirements pertaining thereto are observed?

Fire Dept.:
 Health Dept.:
 Others:
 Signature of Applicant Richard B. Snow Phone #
 Type Name of above Richard B. Snow.....

FIELD INSPECTOR'S COPY

1 2 3 4
 Other ..
 and Address

off Walnut.

Permit No. 97 / 1074
Location 10 Mulligan St
Owner Robert Drury
Date of permit 11-28-77
Approved 11-28-77

NOTES

Nov 29/77 Making cert.

Jan 78

Feb 16/78

Installed.



APPLICATION FOR PERMIT
DEPARTMENT OF BUILDING INSPECTIONS SERVICES
ELECTRICAL INSTALLATIONS

Date June 8, 1976, 19
 Receipt and Permit number A 1899

To the CHIEF ELECTRICAL INSPECTOR, Portland, Maine:

The undersigned hereby applies for a permit to make electrical installations in accordance with the laws of Maine, the Portland Electrical Ordinance, the National Electrical Code and the following specifications:

LOCATION OF WORK: 10 Willis St.

OWNER'S NAME: Dorothy Loring ADDRESS: _____

OUTLETS: (number of)

Lights	_____	
Receptacles	_____	FEES
Switches	_____	
Plugmold	_____ (number of feet)	
TOTAL	<u>2</u>	<u>3.00</u>

FIXTURES: (number of)

Incandescent	_____	
Fluorescent	_____ (Do not include strip fluorescent)	
TOTAL	_____	_____
Strip Fluorescent, in feet	_____	_____

SERVICES:

Permanent, total amperes	_____	_____
Temporary	_____	_____

METERS: (number of) _____

MOTORS: (number of)

Fractional	_____	_____
1 HP or over	_____	_____

RESIDENTIAL HEATING:

Oil or Gas (number of units)	_____	_____
Electric (number of rooms)	_____	_____

COMMERCIAL OR INDUSTRIAL HEATING:

Oil or Gas (by a main boiler)	_____	_____
Oil or Gas (by separate units)	_____	_____
Electric (total number of kws)	_____	_____

APPLIANCES: (number of)

Ranges	<u>1</u>	Water Heaters	_____
Cook Tops	_____	Disposals	_____
Wall Ovens	_____	Dishwashers	_____
Dryers	_____	Compactors	_____
Fans	_____	Others (denote)	_____
TOTAL	_____		<u>1.50</u>

MISCELLANEOUS: (number of)

Branch Panels	<u>1</u>	_____	<u>1.00</u>
Transformers	_____	_____	_____
Air Conditioners	_____	_____	_____
Signs	_____	_____	_____
Fire/Burglar Alarms	_____	_____	_____
Circus, Fairs, etc.	_____	_____	_____
Alterations to wires	_____	_____	_____
Repairs after fire	_____	_____	_____
Heavy Duty, 220v outlets	_____	_____	_____
Emergency Lights, battery	_____	_____	_____
Emergency Generators	_____	_____	_____

INSTALLATION FEE DUE: _____

FOR ADDITIONAL WORK NOT ON ORIGINAL PERMIT DOUBLE FEE DUE: _____

FOR REMOVAL OF A "STOP ORDER" (304-16.b) _____

FOR PERFORMING WORK WITHOUT A PERMIT (304-9) _____

TOTAL AMOUNT DUE: 5.50 ~~5.50~~

INSPECTION:

Will be ready on _____, 19____; or Will Call xx

CONTRACTOR'S NAME: Larry McMahon

ADDRESS: 12 Clifton St.

TEL.. _____

MASTER LICENSE NO.: will call

SIGNATURE OF CONTRACTOR:

LIMITED LICENSE NO.: _____

Larry McMahon (Paul Darling)

INSPECTOR'S COPY

Date Issued

5/7/68

Portland Plumbing Inspector
By ERNOLD R. GOODWIN

Date

App. First Insp.
MAY 8 - 1968

By ERNOLD R. GOODWIN
CHIEF PLUMBING INSPECTOR

Date

App. Final Insp.
MAY 8 - 1968

By ERNOLD R. GOODWIN
CHIEF PLUMBING INSPECTOR

- Commercial
- Residential
- Single
- Multi Family
- New Construction
- Remodeling

PERMIT TO INSTALL PLUMBING

182830000

PERMIT NUMBER

Address 10 Hillis Street, 1st. &

Installation For A Dwelling

Owner of Bldg.: Louis Loring

Owner's Address: 10 Hillis Street

Plumber: Portland Gas Light Company

Date: 5/7/68

NEW REPL

NEW	REPL		NO.	FEE
		SINKS		
		LAVATORIES		
		TOILETS		
		BATH TUBS		
		SHOWERS		
		DRAINS FLOOR SURFACE		
10350		HOT WATER TANKS	1.2	4.00
10350		TANKLESS WATER HEATERS		
		GARBAGE DISPOSALS		
		SEPTIC TANKS		
		HOUSE SEWERS		
		ROOF LEADERS		
		AUTOMATIC WASHERS		
		DISHWASHERS		
		OTHER		
		TOTAL	2	4.00

Building and Inspection Services Dept.: Plumbing Inspection

CITY OF PORTLAND, MAINE

Application for Permit to Install Wires

Permit No. 54965
 Issued 6/23/66

Portland, Maine, 19 66

To the City Electrician, Portland, Maine:

The undersigned hereby applies for a permit to install wires for the purpose of conducting electric current, in accordance with the laws of Maine, the Electrical Ordinance of the City of Portland, and the following specifications:

(This form must be completely filled out — Minimum Fee, \$1.00)

Owner's Name and Address James Ferguson Tel. 43129
 Contractor's Name and Address William E. Egan Tel. 43129
 Location 10 Wallis St Use of Building _____
 Number of Families 2 Apartments _____ Stores 2 Number of Stories _____
 Description of Wiring: New Work _____ Additions _____ Alterations _____
Aluminum Sub
 Pipe _____ Cable _____ Metal Molding _____ BX Cable _____ Plug Molding (No. of feet) _____
 No. Light Outlets _____ Plugs _____ Light Circuits _____ Plug Circuits _____
 FIXTURES: No. _____ Light Switches _____ Fluor. or Strip Lighting (No. feet) _____
 SERVICE: Pipe _____ Cable _____ Underground _____ No. of Wires _____ Size _____
 METERS: Relocated _____ Added _____ Total No. Meters _____
 MOTORS: Number _____ Phase _____ H. P. _____ Amps _____ Volts _____ Starter _____
 HEATING UNITS: Domestic (Oil) _____ No. Motors _____ Phase _____ H.P. _____
 Commercial (Oil) _____ No. Motors _____ Phase _____ H.P. _____
 Electric Heat (No. of Rooms) _____
 APPLIANCES: No. Ranges _____ Watts _____ Brand Feeds (Size and No.) _____
 Elec. Heaters _____ Watts _____
 Miscellaneous _____ Watts _____ Extra Cabinets or Panels _____
 Transformers _____ Air Conditioners (No. Units) _____ Signs (No. Units) _____
 Will commence _____ 19 _____ Ready to cover in _____ 19 _____ Inspection _____ 19 _____
 Amount of Fee \$ 1.00

Signed _____

DO NOT WRITE BELOW THIS LINE

SERVICE METER _____ GROUND
 VISITS: 1 _____ 2 _____ 3 _____ 4 _____ 5 _____ 6 _____
 7 _____ 8 _____ 9 _____ 10 _____ 11 _____ 12 _____
 REMARKS:

INSPECTED BY J. Healy
 (OVER)

LOCATION *Willis St. 10.*
 INSPECTION DATE *6/23/66*
 WORK COMPLETED *6/23/66*
 TOTAL NO. INSPECTIONS *()*
 REMARKS:

FEES FOR WIRING PERMITS EFFECTIVE JULY 31, 1963

WIRING
 1 to 30 Outlets (including switches) \$ 2.00
 31 to 60 Outlets (including switches) 3 00
 Over 60 Outlets, each Outlet (including switches) .05
 (Each twelve feet or fraction thereof of fluorescent lighting or any type of plug molding will be classed as one outlet).

SERVICES

Single Phase 2.00
 Three Phase 4.00

MOTORS

Not exceeding 50 H.P. 3.00
 Over 50 H.P. 4.00

HEATING UNITS

Domestic (Oil) 2.00
 Commercial (Oil) 4.00
 Electric Heat (Each Room) .75

APPLIANCES

Ranges, Cooking Tops, Ovens, Water Heaters, Disposals, Dishwashers, etc. — Each Unit 1.50

TEMPORARY WORK (limited to 6 months from date of permit)

Service, Single Phase 1.00
 Service, Three Phase 2.00
 Wiring, 1-50 Outlets 1.00
 Wiring, each additional outlet over 50 .02
 Circuses, Carnivals, Fairs, etc 10.00

MISCELLANEOUS

Distribution Cabinet or Panel, per unit 3.100
 Transformers, per unit 2.00
 Air Conditioners, per unit 2.00
 Signs, per unit 2.00

ADDITIONS

2.00



APPLICATION FOR PERMIT

Class of Building or Type of Structure Third Class

Portland, Maine, June 26, 1948

PERMIT TO BE ISSUED

JUN 26 1948

CITY OF PORTLAND

To the INSPECTOR OF BUILDINGS, PORTLAND, MAINE

The undersigned hereby applies for a permit to ~~erect~~ alter ~~repair~~ ~~demolish~~ ~~rebuild~~ the following building structure ~~equipment~~ in accordance with the Laws of the State of Maine, the Building Code and Zoning Ordinance of the City of Portland, plans and specifications, if any, submitted herewith and the following specifications:

Location 10 Willis Street Within Fire Limits? _____ Dist. No. _____
 Owner's name and address Kenneth Stokes, 10 Willis Street Telephone _____
 Lessee's name and address _____ Telephone _____
 Contractor's name and address Owner Telephone _____
 Architect _____ Specifications _____ Plans _____ No. of sheets _____
 Proposed use of building Dwelling house No. families 2
 Last use _____ " _____ No. families 2
 Material wood No. stories 2 1/2 Heat _____ Style of roof _____ Roofing _____
 Other buildings on same lot none
 Estimated cost \$ 50 Fee \$ 2.50

General Description of New Work

To demolish 2-story ^{rear} frame shed 10' x 20'. To close up door leading w shed on second floor Rear wall of house to be clapboarded.

It is understood that this permit does not include installation of heating apparatus which is to be taken out separately by and in the name of the heating contractor. **PERMIT TO BE ISSUED TO** owner

Details of New Work

Is any plumbing involved in this work? _____ Is any electrical work involved in this work? _____
 Height average grade to top of plate _____ Height average grade to highest point of roof _____
 Size, front _____ depth _____ No. stories _____ solid or filled land? _____ earth or rock? _____
 Material of foundation _____ Thickness, top _____ bottom _____ cellar _____
 Material of underpinning _____ Height _____ Thickness _____
 Kind of roof _____ Rise per foot _____ Roof covering _____
 No. of chimneys _____ Material of chimneys _____ of lining _____ Kind of heat _____ fuel _____
 Framing lumber—Kind _____ Dressed or full size? _____
 Corner posts _____ Sills _____ Girt or edger board? _____ Size _____
 Girders _____ Size _____ Columns under girders _____ Size _____ Max. on centers _____
 Studs (outside walls and carrying partitions) 2x4-16" O. C. Bridging in every floor and flat roof span over 8 feet.
 Joists and rafters: 1st floor _____, 2nd _____, 3rd _____, roof _____
 On centers: 1st floor _____, 2nd _____, 3rd _____, roof _____
 Maximum span: 1st floor _____, 2nd _____, 3rd _____, roof _____
 If one story building with masonry walls, thickness of walls? _____ height? _____

If a Garage

How many cars now accommodated on same lot _____, to be accommodated _____ number commercial cars to be accommodated _____
Will automobile repairing be done other than minor repairs to cars habitually stored in the proposed building? _____

REMARKS:

Miscellaneous

Will work require disturbing of any tree on a public street? no
Will there be in charge of the above work a person competent to see that the State and City requirements pertaining thereto are observed? YES

NON COPY

Signature of owner

Kenneth a Stokes

Permit No. 48/1075

Location 10 Willis St.

Owner Kenneth Stokes

Date of permit 6/26/48

Notif. closing-in _____

Inspn. closing-in _____

Final Notif. _____

Final Inspn. _____

Cert. of Occupancy issued none

NOTES

6/17/48 - No equipment
used

~~Vertical lines and a diagonal line crossing the page, likely representing a redaction or a placeholder for a drawing.~~

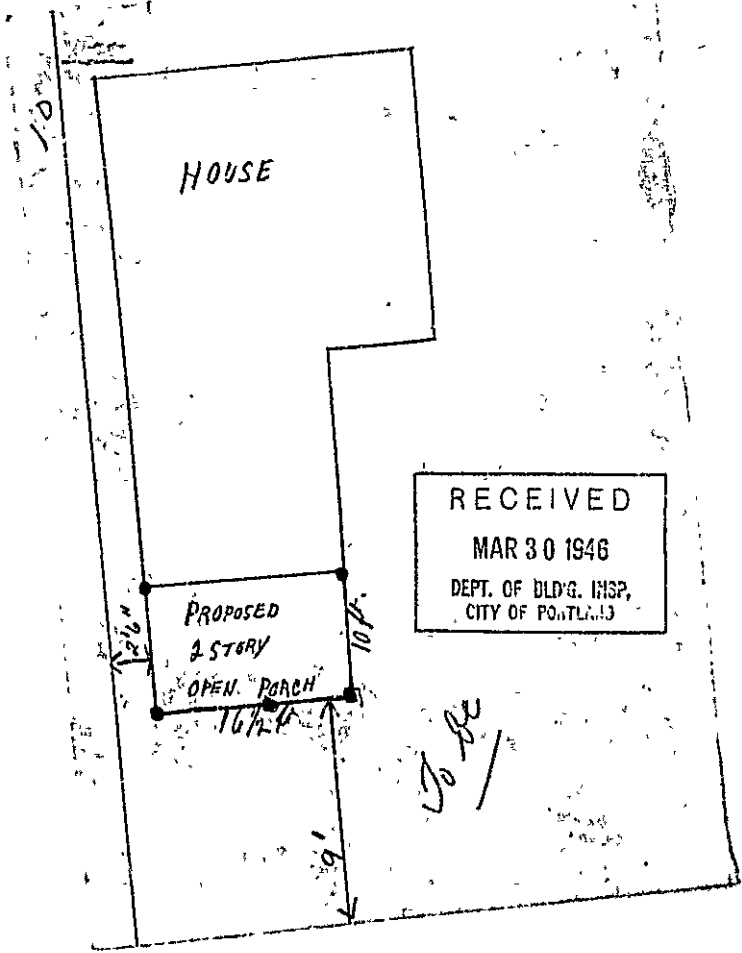

HOUSE

RECEIVED

MAR 30 1946

DEPT. OF BLD'G. INSP,
CITY OF PORTLAND

PROPOSED
2 STORY

OPEN PORCH

16 1/2'

10'

9'

Jo Be

63 1/2 Miller St.

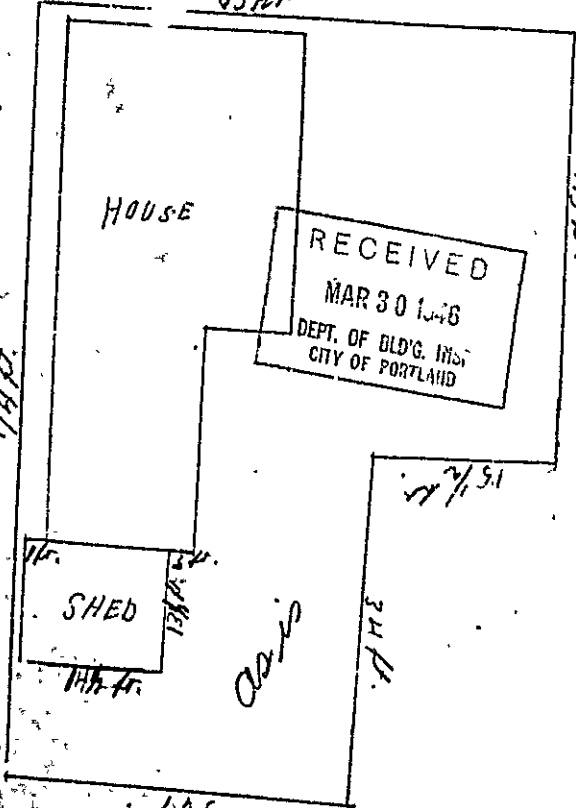

HOUSE

RECEIVED
MAR 30 1948
DEPT. OF BLD'G. INS.
CITY OF PORTLAND

SHED

Garage

74 ft

45 ft

1 1/2 ft

34 ft

3 1/2 ft

AP 10 Willis Street-I

April 2, 1946

Mr. Earlon Parker
10 Willis Street
Portland, Maine

Subject: Building permit for demolition of 2-story rear shed at the rear of dwelling at 10 Willis Street and construction in its place of a 2-story open rear piazza

Dear Sir:

Since you furnished no framing plan showing sizes, spacing and spans of all structural members and location of foundation piers etc., I am compelled to take a great deal for granted in trying to determine whether or not the proposed work will comply with Building Code requirements. This is not to doubt your judgment or experience but by way of warning that we have no way of adjusting the requirements of the Building Code to any details that you may build into the piazza, and without a plan which shows compliance with the requirements of the Building Code as to details we are unable to check in advance of doing the work.

For instance, I presume that the 4x6 sills and the 4x6 beams evidently to be used under second floor joists and under roof joists will be set with the 6-inches upright, that they will be suitably supported upon the posts to act as both braces and ties and at the same time not weaken the posts materially, that you are aware of the requirements for splicing the solid corner and intermediate posts if all one length cannot be procured, that you will anchor the sills or posts, as the case may be to the masonry piers with metal dowels or equivalent, that the concrete piers will extend at least six inches above the surface of the ground, that you are aware of some of the prohibitions of the Building Code as to supporting floor joists on the members which support them and supporting the floor and roof joists against the existing building.

We want to be of service and the natural thing to do in case of doubt is to come down here and ask about the details. We are so completely overcome with incoming business, however, that there is little time to talk over details with the many people who want to us has often been done in the past.

If you are in doubt about these details, it is necessary that you make a framing plan showing them and leave it down here so that we can check as time affords.

I am only able to issue the permit under the Zoning Ordinance with the proposed structure so close to the side and rear property lines because of the fact that you are evidently from your location sketch increasing these distances over those which now exist to the shed to be removed. Please be careful about this and if you should have some change of mind about the location of the piazza or the size of it, file application for amendment to the permit now issued before making the change so that you may not get into difficulties with the Zoning Ordinance. It is true that we only try to interpret the ordinance aright and every property owner has the right to challenge our interpretation of it and the basis on which we issue permits--thus any neighboring property owner who is concerned about your building close to lines can raise questions which might be difficult for you to answer.

Very truly yours,

Inspector of Buildings

WMC/S

ATH
VES.
RMT
PH
JS
HL
RS



(A) APARTMENT HOUSE ZONE
APPLICATION FOR PERMIT

Class of Building or Type of Structure Third Class

Portland, Maine, March 30, 1946

PERMIT ISSUED
00505
APR 2 1946

To the INSPECTOR OF BUILDINGS, PORTLAND, ME.

The undersigned hereby applies for a permit to ~~erect~~ ~~alter~~ ~~repair~~ ~~demolish~~ ~~all~~ the following building structure equipment in accordance with the Laws of the State of Maine, the Building Code and Zoning Ordinance of the City of Portland, plans and specifications, if any, submitted herewith and the following specifications:

Location 10 Willis Street Within Fire Limits? yes Dist. No. 3
 Owner's name and address Earlton Parker, 10 Willis Street Telephone no
 Lessee's name and address _____ Telephone _____
 Contractor's name and address owner Telephone _____
 Architect _____ Specifications _____ Plans yes No. of sheets 2
 Proposed use of building Dwelling No. families 2
 Last use _____ No. families 2
 Material frame No. stories 2 Heat _____ Style of roof _____ Roofing _____
 Other buildings on same lot none
 Estimated cost \$ 250. Fee \$ 1.00

General Description of New Work

To demolish existing 2 story ~~shed~~ ^{13 x 14'6"} on rear of building and
 To construct 2 story open rear piazza 10' x 16'6".

*14 x 2 on 8' span = 4752
 8 x 5 x 45 = 1800*

Permit Issued with Letter

CERTIFICATE OF OCCUPANCY
 REQUIREMENT IS WAIVED

4x6 plate @ 8' span

It is understood that this permit does not include installation of heating apparatus which is to be taken out separately by and in the name of the heating contractor.

Details of New Work

any plumbing work involved in this work? _____ Is any electrical work involved in this work? _____
 Height average grade to top of plate _____ Height average grade to highest point of roof _____
 Size, front _____ depth _____ No. stories 2 solid or filled land? solid earth or rock? earth
 Material of foundation concrete piers at least 4' below grade ^{5"} Thickness, top 12" bottom 10" cellar no
 Material of underpinning " to sill Height _____ Thickness _____
 Kind of roof shed Rise per foot 2" Roof covering asphalt roofing Class C-2nd Lab. _____
 No. of chimneys _____ Material of chimneys _____ of lining _____ Kind of heat _____ fuel _____
 Framing lumber--Kind hemlock ^{6"} upright Dressed or full size? dressed
 Corner posts 4x6 Sills 4x6 Girt or ledger board? _____ Size _____
 Girders _____ Size _____ Columns under girders _____ Size _____ Mat. on centers _____
 Studs (outside walls and carrying partitions) 2x4-16" O. C. Bridging in every floor and flat roof span over 8 feet.
 Joists and rafters: 1st floor 2x6, 2nd 2x6, 3rd _____, roof 2x6
 On centers: 1st floor 16", 2nd 16", 3rd _____, roof 16"
 Maximum span: 1st floor 10', 2nd 10', 3rd _____, roof 10'
 If one story building with masonry walls, thickness of walls? _____ height? _____

If a Garage

No. cars now accommodated on same lot _____, to be accommodated _____ number commercial cars to be accommodated _____
 Will automobile repairing be done other than minor repairs to cars habitually stored in the proposed building? _____

Miscellaneous

Will work require disturbing of any tree on a public street? no
 Will there be in charge of the above work a person competent to see that the State and City requirements pertaining thereto are observed? yes

APPROVED:

Signature of owner Earlton P. Parker

Permit No 46/505

Location 10 Mullis St.

Owner Earlon Parker

Date of permit 4/2/46

Notif. closing-in

Inspn. closing-in

Final Notif

Final Inspn 7/2/46

Cert. of Occupancy issued 1/10/46

NOTES

4/30/46

Mr. Michaels Land
Contractor

5/21/46 - Same - E.H.

6/20/46 - Same - E.H.

7/24/46

Permit approved
E.H.

February 21, 1936

File: C-56-1
R-5/11/36

Mr. E. H. Thomas,
80 Wilson St.,
Portland, Me.

Dear Sir:

With relation to the building which you are reported to own or control at 10 Willis St., an inspector from this office reports certain conditions pertaining to smokepipes in the cellar that are considered dangerous from the standpoint of fire hazard.

As authorized and directed by Sections 28, 29, 30 and 52 of Chapter 25, Revised Statutes of Maine, copy attached hereto, it is necessary for me to require that you have these conditions corrected on or before March 10, 1936, essentially as indicated below.

Replace both smokepipes serving the two heaters connected to the front chimney in the cellar, - both are badly rusted and one so badly corroded that it has a hole in it about 1" in diameter. When the pipe nearer Willis St. is replaced lower it as high as possible (perhaps it may be lowered as much as 3 inches) so that the top of it may be as far as possible from the woodwork above. When both pipes have been replaced and proper connection made tightly to the chimney, provide a shield of so-called "asbestos lumber" over each, to be at least three times the diameter of each smokepipe in width and to be suspended approximately half way between the tops of the pipes and the woodwork above on non-burnable hangers such as wire.

When the work is completed, please notify this office so that another inspection may be made.

Very truly yours,

Warren T. Drank
Inspector of Buildings

McD/r

LCC RPA No. 1-2-72-3



APPLICATION FOR PERMIT
DEPARTMENT OF BUILDING INSPECTIONS SERVICES
ELECTRICAL INSTALLATIONS

Date 7/15/93, 1993
 Receipt and Permit number 4488

To the CHIEF ELECTRICAL INSPECTOR, Portland, Maine:

The undersigned hereby applies for a permit to make electrical installations in accordance with the laws of Maine, the Portland Electrical Ordinance, the National Electrical Code and the following specifications:

LOCATION OF WORK: 10 Willis St.
 OWNER'S NAME: Jane McManery ADDRESS: _____

	FEES	
OUTLETS:		
Receptacles _____ Switches _____ Plug/mold _____ ft. TOTAL _____		
FIXTURES: (number of)		
Incaidescant _____ Fluorescent _____ (not strip) TOTAL _____		
Strip Fluorescent _____ ft. _____		
SERVICES:		
Overhead <input checked="" type="checkbox"/> _____ Underground _____ Temporary _____ TOTAL amperes <u>100</u> ..		<u>15.00</u>
METERS: (number of) <u>2</u> ..		<u>2.00</u>
MOTORS: (number of)		
Fractional _____		
1 HP or over _____		
RESIDENTIAL HEATING:		
Oil or Gas (number of units) _____		
Electric (number of rooms) _____		
COMMERCIAL OR INDUSTRIAL HEATING:		
Oil or Gas (by a main boiler) _____		
Oil or Gas (by separate units) _____		
Electric Under 20 kws _____ Over 20 kws _____		
APPLIANCES: (number of)		
Ranges _____ Water Heaters _____		
Cook Tops _____ Disposals _____		
Wall Ovens _____ Dishwashers _____		
Dryers _____ Compactors _____		
Fans _____ Others (denote) _____		
TOTAL _____		
MISCELLANEOUS: (number of)		
Branch Panels _____		
Transformers _____		
Air Conditioners Central Unit _____		
Separate Units (windows) _____		
Signs 20 sq. ft. and under _____		
Over 20 sq. ft. _____		
Sw'ming Pools Above Ground _____		
In Ground _____		
Fire/Burglar Alarms Residential _____		
Commercial _____		
Heavy Duty Outlets, 220 Vol. (such as welders) 30 amps and under _____		
over 30 amps _____		
Circus, Fairs, etc. _____		
Alterations to wires _____		
Repairs after fire _____		
Emergency Lights, battery _____		
Emergency Generators _____		

INSTALLATION FEE DUE: _____

FOR ADDITIONAL WORK NOT ON ORIGINAL PERMIT DOUBLE FEE DUE: _____

FOR REMOVAL OF A "STOP ORDER" (304-16.b) _____

TOTAL AMOUNT DUE: 17.00

INSPECTION:
 Will be ready on _____, 19__; or Will Call _____

CONTRACTOR'S NAME: Mike Menario Elct. Cont.

ADDRESS: Ptld

TEL: 878-0277

MASTER LICENSE NO: #4488 SIGNATURE OF CONTRACTOR: _____

LIMITED LICENSE NO: _____

INSPECTOR'S COPY — WHITE
 OFFICE COPY — CANARY
 CONTRACTOR'S COPY — GREEN

ELECTRICAL INSTALLATIONS

Permit Number 4488

Location 10601 115 S

Owner SHARIE M. McMANIS

Date of Permit 7-15-93

Final Inspection 7-26-93

By Inspector Steve Berg

Permit Application Register Page No. 100

INSPECTIONS: Service 7-26-93 by SB
Service called in 11:10 AM
Closing-in _____ by _____

PROGRESS INSPECTIONS:
_____/_____/_____
_____/_____/_____
_____/_____/_____
_____/_____/_____
_____/_____/_____
_____/_____/_____

DATE:	REMARKS:
7-26-93	Final inspection