

May 6, 1987

RE: 200 Anderson Street

Ms. Deana Cyr
200 Anderson St.
Portland, Maine 04101

Dear Ms. Cyr:

This is in reference to your application for a permit for a sign at 200 Anderson Street. The application states a blue sign with gold lettering made of wood.

Details as to the text of the sign and what is being publicized appear to be lacking although it appears to be located on the side of the building and is said to be four feet by six feet in size.

What business is promoted by or the subject of the sign, for what use or firm is it being offered? Please advise this office.

Sincerely,

Warren J. Turner

Warren J. Turner
Zoning Enforcement Inspector

/el

cc: P. Samuel Hoffses, Chief of Inspection Services
Arthur Addato, Code Enforcement Officer

Portland
Flooring &
Design

4' x 6' sign

offering floor & wall covering

389 CONGRESS STREET • PORTLAND, MAINE 04101 • TELEPHONE (207) 775-5451

I. GENERAL INFORMATION 200 Anderson Street
 Location/address of construction
 Owner or lessee's name Deana Cyr Tel 761-5882
 Address same

Contractor's name Scarborough Signs Tel
 Address Scarborough

Subcontractors: _____
PERMIT ISSUED

MAY 14 1987

City Of Portland

II. NEW SUBDIVISION OR EXISTING LOT REFERENCE
 Name _____
 Lot _____
 Block _____
 Bk. & pg. Reg./deeds _____
 Date recorded _____

III. PROPOSED USE CODE 327 If other, explain retail Seasonal _____ Condominium _____ Apartment _____
IV. PAST USE _____
V. OWNERSHIP PUBLIC (Federal/State/local government) PRIVATE (Incl. Mch. corp./nonprofit)

VI. DESCRIPTION OF WORK: Blue with gold lettering 4X6 sign - wooden
 A
 send permit to #1 - #27 Bonny Bank Rd.
 So. Portland 04101

VII. BUILDING DIMENSIONS: length _____ width _____ square footage _____ height _____ #stories _____
VIII. EST. CONSTRUCTION COST: _____ **IX. GR. SQ. FT. OF LAND:** _____ **X. BUILDING:** _____

X. RESIDENTIAL BUILDINGS ONLY: #BEDROOMS: 1 BDRM 2 BDRMS 3 BDRMS
 *NEW DWELLING UNITS WITH: _____
 *EXISTING DWELLING UNITS WITH: _____
XI. RESIDENTIAL UNITS:
 *NEW DWELLINGS _____
 *EXISTING DWELLINGS _____
 NET RESIDENTIAL UNITS _____

XII. SIGNATURE OF APPLICANT: _____ **DATE:** _____

DO NOT WRITE BELOW THIS LINE

XIII. ZONING:
 DISTRICT I-2 STREET FRONTAGE _____
 SETBACKS: front _____ back _____ side _____ side _____
 ZONING BOARD APPROVAL: no yes (date) _____
 PLANNING BOARD APPROVAL: no yes (date) _____

XIV. OFFICE USE:
 TAX MAP _____
 LOT # _____
 VALUE/STRUCTURE _____
 PERMIT EXPIRATION _____

XV. CONDITIONAL USE: variance _____ site plan _____ subdivision _____ shore and floodplain mgmt _____
 special exception _____ other _____ (explain) _____

XVI. SIGNATURE OF FIELD INSPECTOR (CEO): _____ **DATE:** _____

XVII. FEES:
 base fee _____
 subdivision fee _____
 site plan review fee _____
 other fees _____
 late fee _____
 TOTAL 29.80 BYXRB

XVIII. SPACE FOR FIGURING /ADDITIONAL COMMENTS:
 O.K. M. Turner May 4, 1987

| | |
|--|--|
| 1. WATER SUPPLY <input type="checkbox"/> public <input type="checkbox"/> private | 8. CHIMNEY * flues * fireplaces material |
| 2. SEWER <input type="checkbox"/> public <input type="checkbox"/> private, type | 9. FRAMING: floor joists |
| 3. HEAT type fuel | size max. on centers |
| 4. FOUNDATION type thickness footing | ceiling joists |
| 5. ROOF type pitch covering load | rafters |
| 6. PLUMBING * tubs * showers * lavatories * laundry tubs * flushes * other | studs |
| SPRINKLER SYSTEM? <input type="checkbox"/> yes <input type="checkbox"/> no | wall studs |
| 7. ELECTRICAL service entrance size * smoke detectors | 10. If 1-story building w/ masonry walls: wall thickness height |
| NUMBER OF OFF-STREET PARKING SPACES: enclosed outdoors | 11. BEDROOM WINDOWS height width sill height egress window? <input type="checkbox"/> yes <input type="checkbox"/> no |

PLOT PLAN/DETAILS OF WORK ON REVERSE
 White - Municipal Office
 Yellow - CEO
 Pink - Tax Assessor
 Gold - GPCOG

[7] Mr. Oddis

Local No. _____
 Order of the Board _____
 Address _____
 Contractor's Name _____
 Address _____
 Subject _____

CITY OF PORTLAND
 CODE _____
 DISTRICT _____

DESCRIPTION OF WORK _____
 (Use with gold lettering for work on _____)

Send permit to #1 - #27 Bonny Circle Rd
 So Portland 04131

CONSTRUCTION PERMITS BOARD
 (This space is reserved for the use of the Board)

DO NOT WRITE IN THIS SPACE

STREET FRONTAGE _____
 SIDE _____
 BOARD APPROVAL: no yes (date) _____
 CITY BOARD APPROVAL: no yes (date) _____

EQUALIZATION VARIANCE _____
 SPECIAL CONDITION _____

DESIGNATION OF FIELD INSPECTOR (CEG) _____
 FEES:
 Submission Fee _____
 Plan Review Fee _____
 Other Fees _____
 TOTAL \$5.00

| 1. WATER SUPPLY | 2. SEWER | 3. HEAT | 4. FUNDATION | 5. ROOF | 6. PLUMBING | 7. ELECTRICAL | 8. MECHANICAL | 9. OTHER | 10. TOTAL |
|--|--|---|---|---|--|--|---|---|-----------|
| <input type="checkbox"/> public <input type="checkbox"/> private | <input type="checkbox"/> public <input type="checkbox"/> private | <input type="checkbox"/> gas <input type="checkbox"/> oil <input type="checkbox"/> electric | <input type="checkbox"/> concrete <input type="checkbox"/> masonry <input type="checkbox"/> other | <input type="checkbox"/> gable <input type="checkbox"/> flat <input type="checkbox"/> other | <input type="checkbox"/> hot water <input type="checkbox"/> steam <input type="checkbox"/> other | <input type="checkbox"/> 120V <input type="checkbox"/> 240V <input type="checkbox"/> other | <input type="checkbox"/> furnace <input type="checkbox"/> boiler <input type="checkbox"/> other | <input type="checkbox"/> elevator <input type="checkbox"/> escalator <input type="checkbox"/> other | |

Time allowed

200 Anderson St.

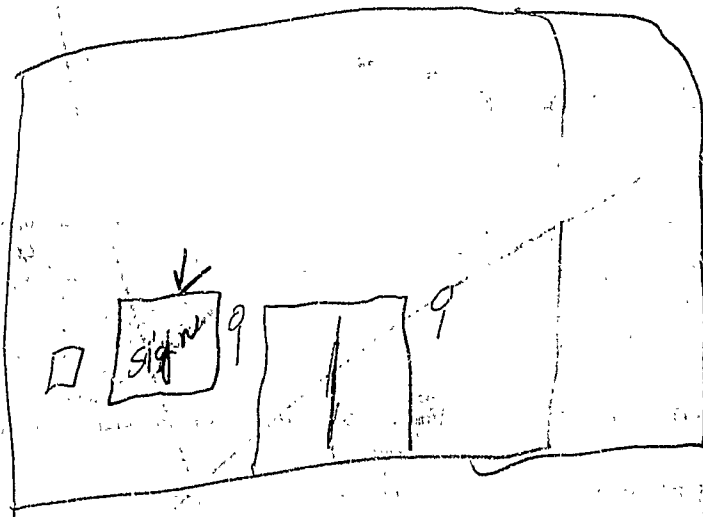

RECEIVED

MAY - 1 1987

DEPT. OF BUILDING INSPECTION
CITY OF PORTLAND

3'

7'

SEAGER ELECTRIC

7744860

RECEIVED

OCT - 7 1987

DEPT. OF BUILDING INSPECTIONS
CITY OF PORTLAND

700 ANDERSON ST.

APPLICATION FOR PERMIT

PERMIT ISSUED

B.O.C.A. USE GROUP

B.O.C.A. TYPE OF CONSTRUCTION

OCT 8 1987

ZONING LOCATION ... F-2 ... PORTLAND, MAINE ... Oct. 7, 1987

City Of Portland

To the CHIEF OF BUILDING & INSPECTION SERVICES, PORTLAND, MAINE

The undersigned hereby applies for a permit to erect, alter, repair, demolish, move or install the following building, structure, equipment or change use in accordance with the Laws of the State of Maine, the Portland B.O.C.A. Building Code and Zoning Ordinance of the City of Portland with plans and specifications, if any, submitted herewith and the following specifications:

LOCATION ... 200 Anderson Street ... Fire District #1 , #2 Telephone ... 767-5707

1. Owner's name and address .. Bill Gagne - 274 Mitchell Rd. Cape Elizabeth Telephone ..
2. Lessee's name and address ..
3. Contractor's name and address .. Seabee Elec. Telephone ..

Proposed use of building .. No. of sheets ..

Last use .. No. families ..

Material .. No. stories .. Heat .. Style of roof .. Roofing ..

Other buildings on same lot ..

Estimated contractual cost \$..

FIELD INSPECTOR—Mr. @ 775-5451

to construct 3' x 7' sign

Appeal Fees \$
Base Fee
Late Fee
TOTAL \$ 29.20

Stamp of Special Conditions

NOTE TO APPLICANT: Separate permits are required by the installers and subcontractors of heating, plumbing, electrical and mechanicals.

DETAILS OF NEW WORK

Is any plumbing involved in this work? Is any electrical work involved in this work?
Is connection to be made to public sewer? If not, what is proposed for sewage?
Has septic tank notice been sent? Form notice sent?
Height average grade to top of plate Height average grade to highest point of roof
Size, front depth No. stories solid or filled land? earth or rock?
Material of foundation Thickness, top bottom cellar
Kind of roof Rise per foot Roof covering
No. of chimneys Material of chimneys of lining Kind of heat fuel
Framing Lumber—Kind Dressed or full size? Corner posts Sills
Size Girder Columns under girders Size Max. on centers
Studs (outside walls and carrying partitions) 2x4-16" O. C. Bridging in every floor and flat roof span over 8 feet.
Joists and rafters: 1st floor, 2nd, 3rd, roof
On centers: 1st floor, 2nd, 3rd, roof
Maximum span: 1st floor, 2nd, 3rd, roof
If one story building with masonry walls, thickness of walls? height?

IF A GARAGE

No. cars now accommodated on same lot .., to be accommodated .. number commercial cars to be accommodated ..
Will automobile repairing be done other than minor repairs to cars habitually stored in the proposed building? ..

APPROVALS BY: DATE

BUILDING INSPECTION—PLAN EXAMINER ..
ZONING: O.K. M.J. Turner Oct 7, 1987

MISCELLANEOUS

Will work require disturbing of any tree on a public street? ..
Will there be in charge of the above work a person competent to see that the State and City requirements pertaining thereto are observed? ..
Fire Dept.:
Health Dept.:
Others:

Signature of Applicant .. [Signature] Phone # ..

Type Name of above .. Bill Gagne .. 1 2 3 4

Other ..
and Address ..

FIELD INSPECTOR'S COPY APPLICANT'S COPY

OFFICE FILE COPY

173 M.A. Addato



APPLICATION FOR PERMIT
 DEPARTMENT OF BUILDING INSPECTIONS SERVICES
 ELECTRICAL INSTALLATIONS

Date April 29, 19 87
 Receipt and Permit number D09344

To the CHIEF ELECTRICAL INSPECTOR, Portland, Maine:

The undersigned hereby applies for a permit to make electrical installations in accordance with the laws of Maine, the Portland Electrical Ordinance, the National Electrical Code and the following specifications:

LOCATION OF WORK: 200 Anderson Street
 OWNER'S NAME: Anderson Realty Assoc. ADDRESS: c/o Boulos Co., 2 City Center, Port.

FEES

OUTLETS: Receptacles _____ Switches _____ Plugmold _____ ft. TOTAL _____

FIXTURES: (number of)
 Incandescent _____ Fluorescent _____ (not strip) TOTAL _____
 Strip Fluorescent _____ ft. _____

SERVICES: Overhead Underground _____ Temporary _____ TOTAL amperes 100 .. 3.00
 3 phase
 .50

METERS: (number of) 1

MOTORS: (number of)
 Fractional _____
 1 HP or over _____

RESIDENTIAL HEATING:
 Oil or Gas (number of units) _____
 Electric (number of rooms) _____

COMMERCIAL OR INDUSTRIAL HEATING:
 Oil or Gas (by a main boiler) _____
 Oil or Gas (by separate units) _____
 Electric Under 20 kws _____ Over 20 kws _____

APPLIANCES: (number of)
 Ranges _____ Water Heaters _____
 Cook Tops _____ Disposals _____
 Wall Ovens _____ Dishwashers _____
 Dryers _____ Compactors _____
 Fans _____ Others (denote) _____
 TOTAL _____

MISCELLANEOUS: (number of)
 Branch Panels _____
 Transformers _____
 Air Conditioners Central Unit _____
 Separate Units (windows) _____
 Signs 20 sq. ft. and under _____
 Over 20 sq. ft. _____
 Swimming Pools Above Ground _____
 In Ground _____
 Fire/Burglar Alarms Residential _____
 Commercial _____
 Heavy Duty Outlets, 220 Volt (such as welders) 30 amps and under _____
 over 30 amps _____
 Circus, Fairs, etc. _____
 Alterations to wires _____
 Repairs after fire _____
 Emergency Lights, battery _____
 Emergency Generators _____

FOR ADDITIONAL WORK NOT ON ORIGINAL PERMIT INSTALLATION FEE DUE:
 FOR REMOVAL OF A "STOP ORDER" (304-16.b) DOUBLE FEE DUE:
 TOTAL AMOUNT DUE: 5.00 Min.

INSPECTION: READY IN THE AFTERNOON
 Will be ready on April 30, 1987; or Will Call _____
 CONTRACTOR'S NAME: Richard P. Romano
 ADDRESS: 18 Meadow Way, Cape. Eliz., ME 04107
 TEL.: 767-3866 SIGNATURE OF CONTRACTOR:
 MASTER LICENSE NO.: 04615 Richard P. Romano
 LIMITED LICENSE NO.: _____

INSPECTOR'S COPY — WHITE
 OFFICE COPY — CANARY
 CONTRACTOR'S COPY — GREEN

ELECTRICAL INSTALLATIONS

Permit Number 09344

Location 260 W. Williams St

Owner Amerson Property

Date of Permit 4/25/87

Final Inspection 4/30/87

By Inspector D. Williams

Permit Application Register Page No. 147

INSPECTIONS: Service 100 amp by Russ
Service called in 4/30/87
Closing-in _____ by _____

PROGRESS INSPECTIONS: 4/30/87

| DATE: | REMARKS: |
|----------------|----------|
| <u>4/30/87</u> | |
| | |
| | |
| | |
| | |
| | |
| | |
| | |

4/30/87 DR.

APPLICATION FOR PERMIT

B.O.C.A. USE GROUP B.O.C.A. TYPE OF CONSTRUCTION 802

ZONING LOCATION PORTLAND, MAINE June 29, 1984

PERMIT ISSUED

JUL 9 1984

CITY OF PORTLAND

To the CHIEF OF BUILDING & INSPECTION SERVICES, PORTLAND, MAINE

The undersigned hereby applies for a permit to erect, alter, repair, demolish, move or install the following building, structure, equipment or change use in accordance with the Laws of the State of Maine, the Portland B.O.C.A. Building Code and Zoning Ordinance of the City of Portland with plans and specifications, if any, submitted herewith and the following specifications:

- 1. Owner's name and address Anderson Trust - same Fire District #1 [] #2 []
2. Lessee's name and address Telephone
3. Contractor's name and address Michael D. Davis 27 Minott St., S. P. 04106 Telephone 767-4598

Proposed use of building storage No. of sheets
Last use same No. families
Material No. stories Heat Style of roof Roofing
Other buildings on same lot
Estimated contractual cost \$ 3,000.00

FIELD INSPECTOR - Mr. @ 775-5451
Appeal Fees \$
Base Fee
Late Fee
TOTAL \$ 25.00

Renovations, as per plan. Errecting non-bearing partitions. (10') Storage of Household furnishings and filing cabinets, etc.

Stamp of Special Conditions

NOTE TO APPLICANT: Separate permits are required by the installers and subcontractors of heating, plumbing, electrical and mechanicals.

DETAILS OF NEW WORK

Is any plumbing involved in this work? no
Is any electrical work involved in this work? no
Is connection to be made to public sewer? If not, what is proposed for sewage?
Has septic tank notice been sent? Form notice sent?
Height average grade to top of plate Height average grade to highest point of roof
Size, front depth No. stories solid or filled land? earth or rock?
Material of foundation Thickness, top bottom cellar
Kind of roof Rise per foot Roof covering
No. of chimneys Material of chimneys of lining Kind of heat fuel
Framing Lumber - Kind Dressed or full size? Corner posts Sills
Size Girder Columns under girders Size Max. on centers
Studs (outside walls and carrying partitions) 2x4-16" O. C. bridging in every floor and flat-roof span over 8 feet.
Joists and rafters: 1st floor 2nd 3rd roof
On centers: 1st floor 2nd 3rd roof
Maximum span: 1st floor 2nd 3rd roof
If one story building with masonry walls, thickness of walls? height?

IF A GARAGE

No. cars now accommodated on same lot to be accommodated number commercial cars to be accommodated
Will automobile repairing be done other than minor repairs to cars habitually stored in the proposed building?

APPROVALS BY: DATE MISCELLANEOUS
BUILDING INSPECTION - PLAN EXAMINER Will work require disturbing of any tree on a public street? no
ZONING:
BUILDING CODE: James V. Collins, Chief Will there be in charge of the above work a person competent to see that the State and City requirements pertaining thereto are observed? yes
Health Dept:
Others:

Signature of Applicant Michael Davis Phone # 767-4598
Type Name of above Michael Davis 1 [] 2 [] 3 [x] 4 []

Other and Address

FIELD INSPECTOR'S COPY APPLICANT'S COPY OFFICE FILE COPY

[7] MA. Addate

NOTES

7-13-84. Partition work
 in progress. OK *aa*
 7-22-84 - w/p OK *aa*
 8-24-84 OK *aa*

Permit No. *81/802*
 Location *211 W. ...*
 Owner *Cooper ...*
 Date of permit *6-29-84*
 Approved *7-9-84*
 Dwelling
 Garage
 Alteration *for stairs, steps*

Two large rectangular areas with horizontal lines, both of which are crossed out with a large diagonal slash from the top-left to the bottom-right.

PLUMBING APPLICATION

PROPERTY ADDRESS

Town or Plantation: Portland

Street: 500 Anderson St

Subdivision/Lot #: _____

PROPERTY OWNERS NAME

FizGIS Realty

Applicant Name: Askov Plumbing & Heating

Mailing Address of Owner/Applicant (if different): 900 Riverside St, Portland, ME 04101

PORTLAND 4236 TOWN COPY

Date Permitted: 8/30/19 Fee: \$110 Excludes Fee Charge

Local Plumbing Inspector Signature: [Signature] License # 0124

Chief Plumbing Inspector

Owner/Applicant Statement

I certify that the information submitted is correct to the best of my knowledge and understand that any falsification is reason for the Local Plumbing Inspector to deny a Permit.

Signature of Owner/Applicant: [Signature] Date: 8/27/19

Caution: Inspection Required

I have inspected the installation authorized above and found it to be in compliance with the Maine Plumbing Rules.

Local Plumbing Inspector Signature: [Signature] Date Approved: 3/20/19

PERMIT INFORMATION

This Application is for:

- NEW PLUMBING
- RELOCATED PLUMBING

Type Of Structure To Be Served:

- SINGLE FAMILY DWELLING
- MODULAR OR MOBILE HOME
- MULTIPLE FAMILY DWELLING
- OTHER - SPECIFY: Commercial

Plumbing To Be Installed By:

- MASTER PLUMBER
- OIL BURNERMAN
- MFG'D. HOUSING DEALER/MECHANIC
- PUBLIC UTILITY EMPLOYEE
- PROPERTY OWNER

LICENSE # 7660

| Number | Hook-Ups And Piping Relocation | Column 2 | | Column 1 | |
|--------|---|----------|--|----------|------------------------------|
| | | Number | Type of Fixture | Number | Type Of Fixture |
| | HOOK-UP: to public sewer in those cases where the connection is not regulated and inspected by the Local Sanitary District. | | Hosebibb / Silcock | | Bathtub (and Shower) |
| | | 1 | Floor Drain | | Shower (Separate) |
| | | | Urinal | 2 | Sink |
| | HOOK-UP: to an existing subsurface wastewater disposal system. | | Drinking Fountain | 1 | Wash Basin |
| | | | Indirect Waste | 1 | Water Closet (Toilet) |
| | | | Water Treatment Softener, Filter, etc. | | Clothes Washer |
| | | | Grease/Oil Separator | | Dish Washer |
| | PIPING RELOCATION: of sanitary lines, drains, and piping without new fixtures. | | Dental Copridor | | Garbage Disposal |
| | | | Bidet | | Laundry Tub |
| | | | Other: <u>Dante cooler</u> | | Water Heater |
| | Hook-Ups (Subtotal) | 1 | Fixtures (Subtotal) Column 2 | 4 | Fixtures (Subtotal) Column 1 |
| \$ | Hook-Up Fee | | | 2 | Fixtures (Subtotal) Column 2 |
| | | | | 6 | Total Fixtures |
| | | | | \$18.00 | Permit Fee |
| | | | | \$18.00 | Permit Fee (Total) |

SEE PERMIT FEE SCHEDULE FOR CALCULATING FEE

913012

Permit # 913012 City of Portland BUILDING PERMIT APPLICATION Fee \$25 Zone _____ Map # _____ Lot# _____

Please fill out any part which applies to job. Proper plans must accompany form.

Owner: Cascavia Caviars Inc Phone # 773-2313
 Address: 200 Anderson St; Ptd. #E 04101
 LOCATION OF CONSTRUCTION 200 Anderson St.
 Contractor: Reis Rest. Equip. Sub. 783-0326
 Address: 12 Stewart St; Leviston Phone # 4E 04240
 Est. Construction Cost: \$250 Proposed Use: wholesale/retail
 Past Use: wholesale/retail
 # of Existing Res. Units _____ # of New Res. Units _____
 Building Dimensions L _____ W _____ Total Sq. Ft. _____
 # Stories: _____ # Bedrooms _____ Lot Size _____
 Is Proposed Use: Seasonal _____ Condominium _____ Conversion _____
 Explain Conversion install a refrigeration system

PERMIT ISSUED
SEP 11 1991
CITY OF PORTLAND

For Official Use Only
 Date 9/5/91 Subdivisor: _____
 Inside Fire Limits _____
 Bldg Code _____ Ownership: _____
 Time Limit _____
 Estimated Cost _____

Zoning: W refary sust.
 Street Frontage Provided: _____
 Provided Setbacks: Front _____ Back _____ Side _____
 Review Required:
 Zoning Board Approval: Yes _____ No _____ Date: _____
 Planning Board Approval: Yes _____ No _____ Date: _____
 Conditional Use: _____ Variance _____ Site Plan _____ Subdivision _____
 Shoreland Zoning Yes _____ No _____ Floodplain Yes _____ No _____
 Special Exception _____
 Other (Explain) W/OH 9-11-91

Foundation:
 1. Type of Soil: _____
 2. Set Backs - Front _____ Rear _____ Side(s) _____
 3. Footings Size: _____
 4. Foundation Size: _____
 5. Other _____

Floor:
 1. Sills Size: _____ Sills must be anchored.
 2. Girder Size: _____
 3. Lally Column Spacing: _____ Size: _____
 4. Joists Size: _____ Spacing 16" O.C.
 5. Bridging Type: _____ Size: _____
 6. Floor Sheathing Type: _____ Size: _____
 7. Other Material: _____

Exterior Walls:
 1. Studding Size _____ Spacing _____
 2. No. windows _____
 3. No. Doors _____
 4. Header Sizes _____ Span(s) _____
 5. Bracing: Yes _____ No _____
 6. Corner Posts Size _____
 7. Insulation Type _____ Size _____
 8. Sheathing Type _____ Size _____
 9. Siding Type _____ Weather Exposure _____
 10. Masonry Materials _____
 11. Metal Materials _____

Interior Walls:
 1. Studding Size 1 1/2" x 6" Spacing 16"
 2. Header Sizes 2x4 Span(s) ANALOG
 3. Wall Covering Type _____
 4. Fire Wall if required _____
 5. Other Materials _____

Ceiling:
 1. Ceiling Joists Size: _____
 2. Ceiling Strapping Size _____ Spacing _____
 3. Type Ceilings: _____
 4. Insulation Type _____ Size _____
 5. Ceiling Height: _____

Roof:
 1. Truss or Rafter Size _____ Span _____
 2. Sheathing Type _____ Size _____
 3. Roof Covering Type _____

Chimneys:
 Type: _____ Number of Fire Places _____

Heating:
 Type of Heat: W/OH

Electrical:
 Service Entrance Size: _____ Smoke Detector Required Yes _____ No _____

Plumbing:
 1. Approval of soil test if required Yes _____ No _____
 2. No. of Tubs or Showers _____
 3. No. of Flushes _____
 4. No. of Lavatories _____
 5. No. of Other Fixtures _____

Swimming Pools:
 1. Type: _____
 2. Pool Size: _____ x _____ Square Footage _____
 3. Must conform to National Electrical Code and State Law.

Permit Received By Louise E. Chase
 Signature of Applicant Richard J. Carter Date 9-5-91
 CEO's District W/OH

CONTINUED TO REVERSE SIDE
 Ivory Tag - CEO

White - Tax Assessor

PLOT PLAN



FEES (Breakdown From Front)

Base Fee \$ 25

Subdivision Fee \$ _____

Site Plan Review Fee \$ _____

Other Fees \$ _____

(Explain) _____

Late Fee \$ _____

| Type | Inspection Record | Date |
|-------|-------------------|----------------|
| _____ | _____ | ____/____/____ |
| _____ | _____ | ____/____/____ |
| _____ | _____ | ____/____/____ |
| _____ | _____ | ____/____/____ |

COMMENTS *9.11 System has all been installed*

CERTIFICATION

I hereby certify that I am the owner of record of the named property, or that the proposed work is authorized by the owner of record and that I have been authorized by the owner to make this application as has authorized agent and I agree to conform to all applicable laws of this jurisdiction. In addition, if a permit for work described in this application is issued, I certify that the code official or the code official's authorized representative shall have the authority to enter areas covered by such permit at any reasonable hour to enforce the provisions of the code(s) applicable to such permit.

SIGNATURE OF APPLICANT *Rimmell, Curt*

ADDRESS

CASCADIA 773-2134

PHONE NO.

RESPONSIBLE PERSON IN CHARGE OF WORK, TITLE

PHONE NO.

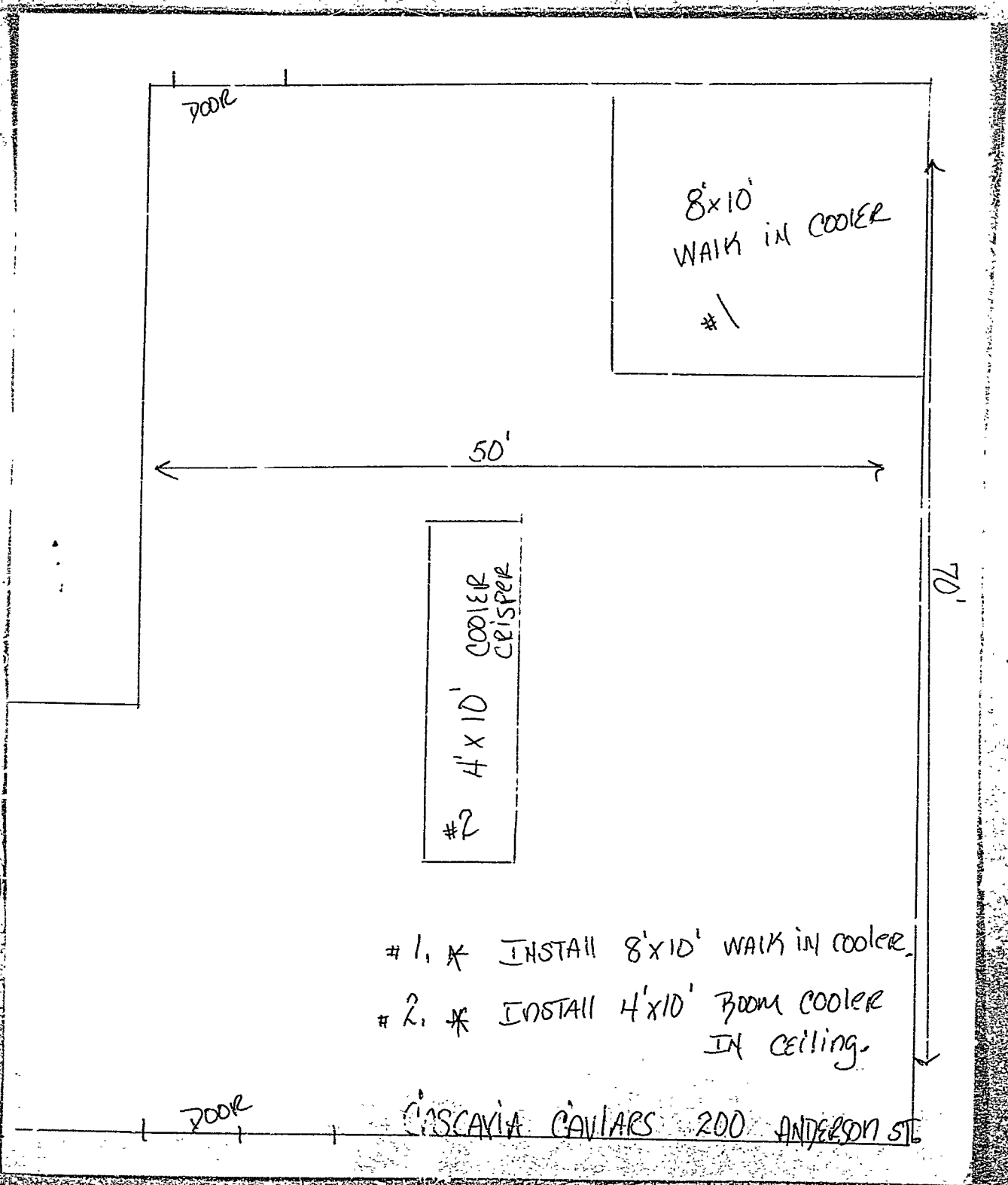

8'x10'
WALK IN COOLER
#1

50'

4'x10'
BOOM COOLER
#2

70'

DOOR

DOOR

- #1. * INSTALL 8'x10' WALK IN COOLER.
- #2. * INSTALL 4'x10' BOOM COOLER IN CEILING.

CASCAVIA CAVALARS ZOO ANDERSON ST

023344

Permit # _____ City of Portland BUILDING PERMIT APPLICATION Fee 35.00 Zone _____ Map # _____ Lot# _____

Owner: Joe Wojick Phone # _____
Address: 200 Anderson St

LOCATION OF CONSTRUCTION 200 Anderson St Ptd

Contractor: Lewiston Bottled Gas Sub.
Address: POB 559 Lewiston, ME 04243 Phone # 786-0671 Dave Marcotte

Est. Construction Cost: _____ Proposed Use: _____

of Existing Res. Units _____ # of New Res. Units _____

Building Dimensions L _____ W _____ Total Sq. Ft. _____

Stories: _____ # Bedrooms _____ Lot Size: _____

Is Proposed Use: Seasonal _____ Condominium _____ Conversion _____

Explain Conversion Install (4) 120 Gallon Above Crnd Propane Tanks

For Official Use Only

Date January 7, 1992 Subdivision: _____
 Inside Fire Limits _____ Name: _____
 Bldg Code _____ I.D. _____
 Time Limit _____ Ownership: _____
 Estimated Cost _____

Zoning: F-2
 Street Frontage Provided: _____
 Provided Setbacks: Front _____ Back _____ Side _____ Side _____

Review Required:
 Zoning Board Approval: Yes _____ No _____ Date: _____
 Planning Board Approval: Yes _____ No _____ Date: _____
 Conditional Use: _____ Variance _____ Site Plan _____ Subdivision _____
 Shoreland Zoning Yes _____ No _____ Floodplain Yes _____ No _____
 Special Exception _____
 Other WPA 786-0671-8-92 (Explain) _____

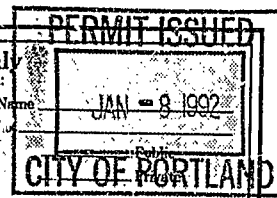

Foundation:
 1. Type of Soil: _____
 2. Set Backs - Front _____ Rear _____ Side(s) _____
 3. Footings Size: _____
 4. Foundation Size: _____
 5. Other _____

Floor:
 1. Sills Size: _____ Sills must be anchored.
 2. Girder Size: _____
 3. Lally Column Spacing: _____ Size: _____
 4. Joists Size: _____ Spacing 16" O.C.
 5. Bridging Type: _____ Size: _____
 6. Floor Sheathing Type: _____ Size: _____
 7. Other Material: _____

Exterior Walls:
 1. Studding Size _____ Spacing _____
 2. No. windows _____
 3. No. Doors _____
 4. Header Sizes _____ Span(s) _____
 5. Bracing: Yes _____ No _____
 6. Corner Posts Size _____
 7. Insulation Type _____ Size _____
 8. Sheathing Type _____ Size _____
 9. Siding Type _____ Weather Exposure _____
 10. Masonry Materials _____
 11. Metal Materials _____

Interior Walls:
 1. Studding Size _____ Spacing _____
 2. Header Sizes _____ Span(s) _____
 3. Wall Covering Type _____
 4. Fire Wall if required _____
 5. Other Materials _____

Ceiling:
 1. Ceiling Joists Size: _____
 2. Ceiling Strapping Size _____ Spacing _____ Not in District nor Landmark.
 3. Type Ceilings: _____ Does not require review.
 4. Insulation Type _____ Size _____
 5. Ceiling Height: _____ Requires Review.

Roof:
 1. Truss or Rafter Size _____ Span _____ Action: Approved
 2. Sheathing Type _____ Size _____ Approved with Conditions
 3. Roof Covering Type _____
 Date: 1/7/92

Chimneys:
 Type: _____ Number of Fire Places _____
 Date: 1/7/92
 Signature: [Signature]

Heating:
 Type of Heat: _____

Electrical:
 Service Entrance Size: _____ Smoke Detector Required Yes _____ No _____

Plumbing:
 1. Approval of soil test if required Yes _____ No _____
 2. No. of Tubs or Showers _____
 3. No. of Flushes _____
 4. No. of Lavatories _____
 5. No. of Other Fixtures _____

Swimming Pools:
 1. Type: _____
 2. Pool Size: _____ x _____ Square Footage _____
 3. Must conform to National Electrical Code and State Law.

Permit Received By Mary Greisd
 Signature of Applicant [Signature] Date Jan 7, 1992
 Signature of Contractor [Signature] Date _____
 Signature of City Engineer [Signature] Date _____
 CEO's District _____

CONTINUED TO REVERSE SIDE FAB AVE
 Ivory Tag - CEO [Signature]

White - Tax Assessor

PLOT PLAN



FEEES (Breakdown From Front)

Base Fee \$ _____

Subdivision Fee \$ _____

Site Plan Review Fee \$ _____

Other Fees \$ _____

(Explain) _____

Late Fee \$ _____

| Type | Inspection Record | Date |
|-------|-------------------|----------------|
| _____ | _____ | ____/____/____ |
| _____ | _____ | ____/____/____ |
| _____ | _____ | ____/____/____ |
| _____ | _____ | ____/____/____ |

COMMENTS

Everything is OK

CERTIFICATION

I hereby certify that I am the owner of record of the named property, or that the proposed work is authorized by the owner of record and that I have been authorized by the owner to make this application as has authorized agent and I agree to conform to all applicable laws of this jurisdiction. In addition, if a permit for work described in this application is issued, I certify that the code official or the code official's authorized representative shall have the authority to enter areas covered by such permit at any reasonable hour to enforce the provisions of the code(s) applicable to such permit.

[Signature] SIGNATURE OF APPLICANT *PO Box 559 Lewiston, Me. 04243* ADDRESS *786-0671* PHONE NO.

RESPONSIBLE PERSON IN CHARGE OF WORK, TITLE _____ PHONE NO. _____

BUILDING PERMIT REPORT

DATE: 1-8-92

ADDRESS: 200 Anderson St.

REASON FOR PERMIT: Install (4) 120 gal^l ABOVE GROUND L/P TANKS

BUILDING OWNER: Joe Wojcik

CONTRACTOR: Lewiston Bolted Shs

PERMIT APPLICANT Don Marcotte

APPROVED: N/A DENIED

CONDITION OF APPROVAL OR DENIAL:

- ✓ 1.) All above ground L/P storage tanks shall be located in accordance with NFPA #58 standards.
- ✓ 2.) Any tank located near the path of vehicle movement shall be protected with appropriate permanent barricades.
- ✓ 3.) All piping shall be protected from possible mechanical damage and vandalism.

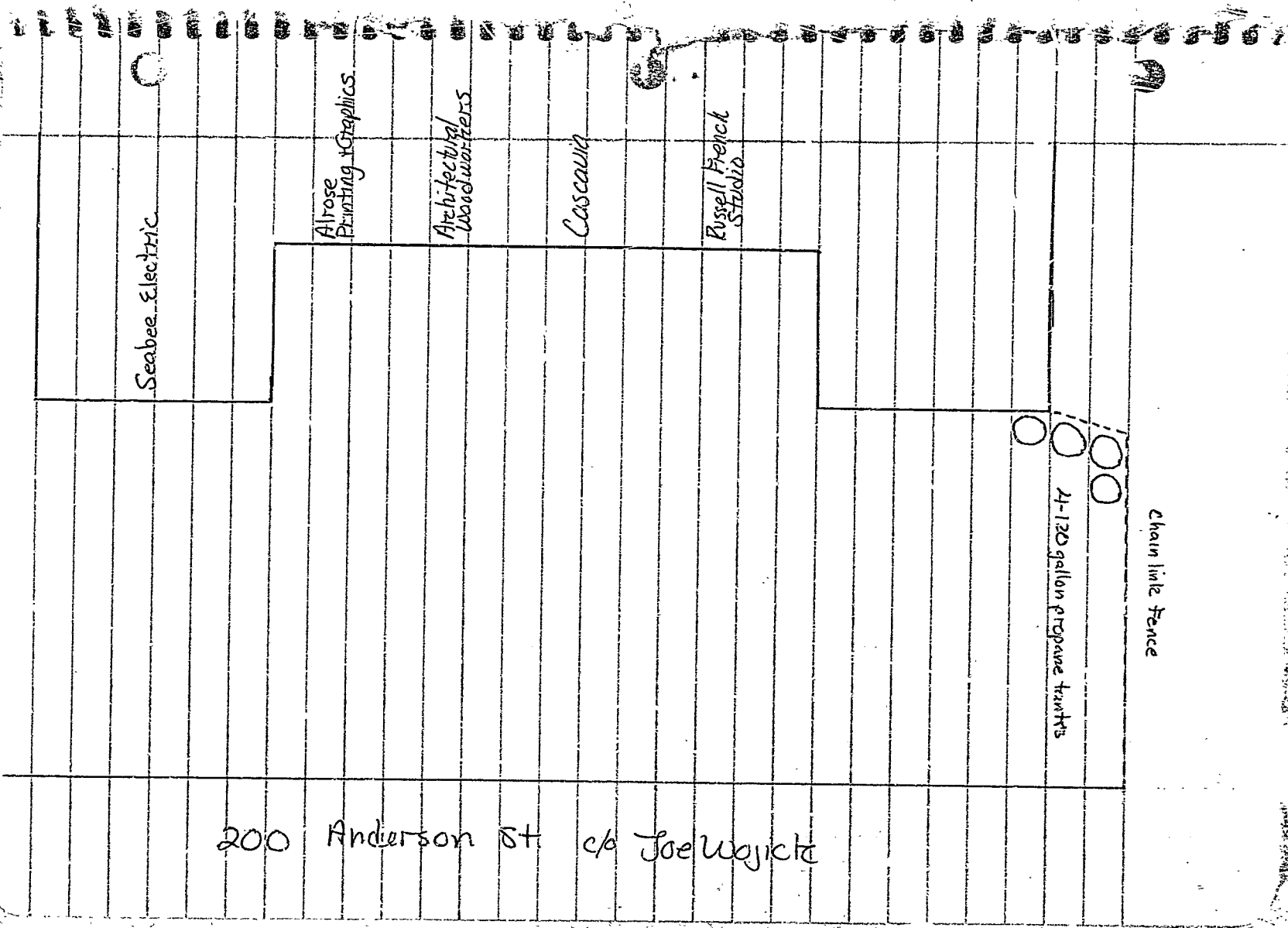

Seabee Electric

Alrose
Printing & Graphics

Architectural
Woodworkers

Cascaida

Russell French
Studio

24-120 gallon propane tanks

Chain link fence

200 Anderson St cp Joe Wojcik

APPLICATION FOR PERMIT

B.O.C.A. USE GROUP
 B.O.C.A. TYPE OF CONSTRUCTION **802**
 ZONING LOCATION PORTLAND, MAINE June 29, 1984.

PERMIT ISSUED

JUL 9 1984

CITY OF PORTLAND

To the CHIEF OF BUILDING & INSPECTION SERVICES, PORTLAND, MAINE

The undersigned hereby applies for a permit to erect, alter, repair, demolish, move or install the following building, structure, equipment or change use in accordance with the Laws of the State of Maine, the Portland B.O.C.A. Building Code and Zoning Ordinance of the City of Portland with plans and specifications, if any, submitted herewith and the following specifications:

LOCATION ... **200 Anderson Street - Middle Section of Building** Fire District #1 , #2
 1. Owner's name and address **Anderson Trust - same** Telephone
 2. Lessee's name and address Telephone
 3. Contractor's name and address **Michael Davis - 27 Minott St., S. P., 04106** Telephone **767-4598**
 Proposed use of building **storage** No. of sheets
 Last use **same** No. families
 Material No. stories Heat Style of roof Roofing
 Other buildings on same lot
 Estimated contractual cost \$ **3,000.00**

FIELD INSPECTOR—Mr. @ 775-5451
 Appeal Fees \$
 Base Fee
 Late Fee
 TOTAL \$ **25.00**

Renovations, as per plan. ~~xxxxxxx~~ Erecting non-bearing partitions. (10') Storage of Household furnishings and filing cabinets, etc.

Stamp of Special Conditions

NOTE TO APPLICANT: Separate permits are required by the installers and subcontractors of heating, plumbing, electrical and mechanicals.

DETAILS OF NEW WORK

Is any plumbing involved in this work? ... **no** Is any electrical work involved in this work? ... **no**
 Is connection to be made to public sewer? If not, what is proposed for sewage?
 Has septic tank notice been sent? Form notice sent?
 Height average grade to top of plate Height average grade to highest point of roof
 Size, front depth No. stories solid or filled land? earth or rock?
 Material of foundation Thickness, top bottom cellar
 Kind of roof Rise per foot Roof covering
 No. of chimneys Material of chimneys of lining Kind of heat fuel
 Framing Lumber—Kind Dressed or full size? Corner posts Sills
 Size Girder Columns under girders Size Max. on centers
 Studs (outside walls and carrying partitions) 2x4-16" O. C. Bridging in every floor and flat roof span over 8 feet.
 Joists and rafters: 1st floor , 2nd , 3rd , roof
 On centers: 1st floor , 2nd , 3rd , roof
 Maximum span: 1st floor , 2nd , 3rd , roof
 If one story building with masonry walls, thickness of walls? height?

IF A GARAGE

No. cars now accommodated on same lot to be accommodated number commercial cars to be accommodated
 Will automobile repairing be done other than minor repairs to cars habitually stored in the proposed building?

APPROVALS BY: DATE MISCELLANEOUS
 BUILDING INSPECTION—PLAN EXAMINER Will work require disturbing of any tree on a public street? **no**
 ZONING:
 BUILDING CODE: Will there be in charge of the above work a person competent to see that the State and City requirements pertaining thereto are observed? **yes**
 Fire Dept.: *James J. Tallon, Chief*
 Health Dept.:
 Others:

Signature of Applicant *Michael Davis* Phone # **767-4598**

Type Name of above **Michael Davis** 1 2 3 4
 Other
 and Address

FIELD INSPECTOR'S COPY APPLICANT'S COPY OFFICE FILE COPY

17 MR. Addato

NOTES

7-13-84 - Partition work
 in progress. OK *aa*
 7-29-84 - w/p OK *aa*
 8-24-84 OK *aa*

Permit No. *847502*
 Location *211 Vandenberg St.*
 Owner *Coastal Home Fund*
 Date of permit *6-29-84*
 Approved *7-9-84*
 Dwelling _____
 Garage _____
 Alteration *to Storage Room*

Large section of the form is crossed out with a large 'X'.

APPLICATION FOR PERMIT

HERMIT ISSUED

B.O.C.A. USE GROUP
B.O.C.A. TYPE OF CONSTRUCTION 802
ZONING LOCATION PORTLAND, MAINE June 29, 1984

JUL 9 1984

CITY of PORTLAND

To the CHIEF OF BUILDING & INSPECTION SERVICES, PORTLAND, MAINE

The undersigned hereby applies for a permit to erect, alter, repair, demolish, move or install the following building, structure, equipment or change use in accordance with the Laws of the State of Maine, the Portland B.O.C.A. Building Code and Zoning Ordinance of the City of Portland with plans and specifications, if any, submitted herewith and the following specifications:

LOCATION 206 Anderson Street - Middle Section of Building
1. Owner's name and address Anderson Trust - same Fire District #1 , #2
2. Lessee's name and address Telephone
3. Contractor's name and address Michael Davis - 27 Mirot St., S. P. 04106 Telephone 767-4598
Proposed use of building storage No. of sheets
Last use same No. families
Material No. stories Heat Style of roof Roofing
Other buildings on same lot
Estimated contractual cost \$ 3,000.00

FIELD INSPECTOR—Mr. @ 775-5451
Renovations, as per plan, including erecting non-bearing partitions, (10') Storage of household furnishings and living cabinets, etc.
Appeal Fees \$
Base Fee
Late Fee
TOTAL \$ 25.00

Stamp of Special Conditions

NOTE TO APPLICANT: Separate permits are required by the installers and subcontractors of heating, plumbing, electrical and mechanicals.

DETAILS OF NEW WORK

Is any plumbing involved in this work? no Is any electrical work involved in this work? no
Is connection to be made to public sewer? If not, what is proposed for sewage?
Has septic tank notice been sent? Forr notice sent?
Height average grade to top of plate Height average grade to highest point of roof
Size, front depth No. stories solid or filled land? earth or rock?
Material of foundation Thickness, top bottom cellar
Kind of roof Rise per foot Roof covering
No. of chimneys Material of chimneys of lining Kind of heat fuel
Framing Lumber—Kind Dressed or full size? Corner posts Sills
Size Girder Columns under girders Size Max. on centers
Studs (outside walls and carrying partitions) 2x4-16" O. C. Bridging in every floor and flat roof span over 8 feet.
Joists and rafters: 1st floor 2nd 3rd roof
On centers: 1st floor 2nd 3rd roof
Maximum span: 1st floor 2nd 3rd roof
If one story building with masonry walls, thickness of walls height?

IF A GARAGE

No. cars now accommodated on same lot, to be accommodated number commercial cars to be accommodated
Will automobile repairing be done other than minor repairs to cars habitually stored in the proposed building?

APPROVALS BY: DATE
BUILDING INSPECTION—PLAN EXAMINER
ZONING:
BUILDING CODE:
Fire Dept.:
Health Dept.:
Others:

MISCELLANEOUS
Will work require disturbing of any tree on a public street? no
Will there be in charge of the above work a person competent to see that the State and City requirements pertaining thereto are observed? no

Signature of Applicant Michael Davis Phone # 767-4598
Type Name of above Michael Davis

Other and Address

FIELD INSPECTOR'S COPY

APPLICANT'S COPY

OFFICE FILE COPY



APPLICATION FOR PERMIT

PERMIT ISSUED

B.O.C.A. USE GROUP

B.O.C.A. TYPE OF CONSTRUCTION 699

JUN 20 1984

ZONING LOCATION PORTLAND, MAINE June 13, 1984

CITY of PORTLAND

To the CHIEF OF BUILDING & INSPECTION SERVICES, PORTLAND, MAINE

The undersigned hereby applies for a permit to erect, alter, repair, demolish, move or install the following building, structure, equipment or change use in accordance with the Laws of the State of Maine, the Portland B.O.C.A. Building Code and Zoning Ordinance of the City of Portland with plans and specifications, if any, submitted herewith and the following specifications:

LOCATION 200 Anderson St. Fire District #1 #2

1. Owner's name and address The Anderson Trust C/O Nelson & Small -212 Telephone 775-5661

2. Lessee's name and address New Life Faith Center - Box 2789 - So. Canco Rd. Telephone 883-6644

3. Contractor's name and address Sofort Telephone Ucan MacAlaster

..... No. of sheets

Proposed use of building Church No. families

Last use distribution center No. families

Material No. stories Heat Style of roof Roofing

Other buildings on same lot

Estimated contractual cost \$..... Appeal Fees \$.....

FIELD INSPECTOR—Mr. Base Fee 25.00

@ 775-5451

Late Fee

TOTAL \$ 25.00

Change of use from distribution center to church, no alterations or structural changes

Stamp of Special Conditions

send permit to # 2 04106 04106

NOTE TO APPLICANT: Separate permits are required by the installers and subcontractors of heating, plumbing, electrical and mechanicals.

DETAILS OF NEW WORK

Is any plumbing involved in this work? ... no Is any electrical work involved in this work? ... no
Is connection to be made to public sewer? ... If not, what is proposed for sewage? ...
Has septic tank notice been sent? ... Form notice sent? ...
Height average grade to top of plate ... Height average grade to highest point of roof ...
Size, front ... depth ... No. stories ... solid or filled land? ... earth or rock? ...
Material of foundation ... Thickness, top ... bottom ... cellar ...
Kind of roof ... Rise per foot ... Roof covering ...
No. of chimneys ... Material of chimneys ... of lining ... Kind of heat ... fuel ...
Framing Lumber—Kind ... Dressed or full size? ... Corner posts ... Sills ...
Size Girder ... Columns under girders ... Size ... Max. on centers ...
Studs (outside walls and carrying partitions) 2x4-16" O. C. Bridging in every floor and flat roof span over 8 feet.
Joists and rafters: 1st floor ... 2nd ... 3rd ... roof ...
On centers: 1st floor ... 2nd ... 3rd ... roof ...
Maximum span: 1st floor ... 2nd ... 3rd ... roof ...
If one story building with masonry walls, thickness of walls? ... height? ...

IF A GARAGE

No. cars now accommodated on same lot ... to be accommodated ... number commercial cars to be accommodated ...
Will automobile repairing be done other than minor repairs to cars habitually stored in the proposed building? ...

APPROVALS BY: DATE BUILDING INSPECTION—PLAN EXAMINER ... ZONING: ... BUILDING CODE: ... Fire Dept.: ... Health Dept.: ... Others: ...

MISCELLANEOUS Will work require disturbing of any tree on a public street? ... Will there be in charge of the above work a person competent to see that the State and City requirements, pertaining thereto are observed? ...

883-9047

EPK:MK

Signature of Applicant John Walsh for New Life Faith Phone # ...

Type Name of above Center 1 2 3 4

Other and Address

FIELD INSPECTOR'S COPY

APPLICANT'S COPY

OFFICE FILE COPY



APPLICATION FOR PERMIT
DEPARTMENT OF BUILDING INSPECTIONS SERVICES
ELECTRICAL INSTALLATIONS

Date Jan. 22, 19 86
 Receipt and Permit number D 23067

To the CHIEF ELECTRICAL INSPECTOR, Portland, Maine:

The undersigned hereby applies for a permit to make electrical installations in accordance with the laws of Maine, the Portland Electrical Ordinance, the National Electrical Code and the following specifications:

LOCATION OF WORK: 200 Anderson Street
 OWNER'S NAME: XXXXX NCSco ADDRESS: same

| | | | | | | | |
|-----------------------------------|--|-------------|-----------------|-----------|-------------|-------------|-------------|
| OUTLETS: | Receptacles | Switches | Plugmold | ft. TOTAL | <u>1-30</u> | FEE'S | <u>3.00</u> |
| FIXTURES: (number of) | Incandescent | Flourescent | (not strip) | TOTAL | | | |
| | Strip Flourescent | | | ft. | | | |
| SERVICES: | Overhead | Underground | Temporary | TOTAL | amperes | | |
| METERS: (number of) | | | | | | | |
| MOTORS: (number of) | Fractional | | | | | | |
| | 1 HP or over | | | | | | |
| RESIDENTIAL HEATING: | Oil or Gas (number of units) | | | | | | |
| | Electric (number of rooms) | | | | | | |
| COMMERCIAL OR INDUSTRIAL HEATING: | Oil or Gas (by a main boiler) | | | | | | |
| | Oil or Gas (by separate units) | | | | | | |
| | Electric Under 20 kws | Over 20 kws | | | | | |
| APPLIANCES: (number of) | Ranges | | Water heaters | | | | |
| | Cook Tops | | Disp | | | | |
| | Wall Ovens | | Dishwash | | | | |
| | Dryers | | Compactors | | | | |
| | Fans | | Others (denote) | | | | |
| | TOTAL | | | | | | |
| MISCELLANEOUS: (number of) | Branch Panels | | | | | | |
| | Transformers | | | | | | |
| | Air Conditioners Central Unit | | | | | | |
| | Separate Units (windows) | | | | | | |
| | Signs 20 sq. ft. and under | | | | | | |
| | Over 20 sq. ft. | | | | | | |
| | Swimming Pools Above Ground | | | | | | |
| | In Ground | | | | | | |
| | Fire/Burglar Alarms Residential | | | | | | |
| | Commercial | | | | | | |
| | Heavy Duty Outlets, 220 Volt (such as welders) 30 amps and under | | | | | | |
| | over 30 amps | | | | | | |
| | Circus, Fairs, etc. | | | | | | |
| | Alterations to wires | | | | | | |
| | Repairs after fire | | | | | | |
| | Emergency Lights, battery | | | | | | |
| | Emergency Generators | | | | | | |
| | INSTALLATION FEE DUE: | | | | | | |
| | FOR ADDITIONAL WORK NOT ON ORIGINAL PERMIT | | | | | | |
| | DOUBLE FEE DUE: | | | | | | |
| | FOR REMOVAL OF A "STOP ORDER" (304-16.b) | | | | | | |
| | TOTAL AMOUNT DUE: | | | | | <u>3.00</u> | |
| | | | | | | min | <u>5.00</u> |

INSPECTION:
 Will be ready on ready, 19 86; or Will Call
 CONTRACTOR'S NAME: James E Cairns III - Cairns Elec
 ADDRESS: 160 W Pleasant St, Westbrook
 TEL.: 854-20487
 MASTER LICENSE NO.: 4227
 LIMITED LICENSE NO.: _____
 SIGNATURE OF CONTRACTOR: [Signature]

INSPECTOR'S COPY — WHITE
 OFFICE COPY — CANARY
 CONTRACTOR'S COPY — GREEN



APPLICATION FOR PERMIT
DEPARTMENT OF BUILDING INSPECTIONS SERVICES
ELECTRICAL INSTALLATIONS

Date April 11, 19 85
 Receipt and Permit number D-01698

To the CHIEF ELECTRICAL INSPECTOR, Portland, Maine:

The undersigned hereby applies for a permit to make electrical installations in accordance with the laws of Maine, the Portland Electrical Ordinance, the National Electrical Code and the following specifications:

LOCATION OF WORK: 200 Anderson St. - Brian Haddock - Architectural Woodworker
 OWNER'S NAME: Nelson & Small ADDRESS: 212 Cancó Road

| | | | | | |
|-----------------------------------|--|------------------------|-----------------------------|-----------------------------|-------------|
| OUTLETS: | Receptacles _____ | Switches _____ | Plugmold _____ | ft. TOTAL <u>21462 1-30</u> | FEE |
| | | | | | <u>5x22</u> |
| FIXTURES: (number of) | | | | | <u>3.00</u> |
| | Incandescent <u>2</u> | Flourescent <u>20</u> | (not strip) TOTAL <u>25</u> | | <u>4.50</u> |
| | Strip Flourescent _____ | ft. _____ | | | |
| SERVICES: | Overhead _____ | Underground _____ | Temporary _____ | TOTAL amperes _____ | |
| METERS: (number of) | | | | | |
| MOTORS: (number of) | | | | | |
| | Fractional _____ | | | | |
| | 1 HP or over <u>6</u> | | | | <u>6.00</u> |
| RESIDENTIAL HEATING: | Oil or Gas (number of units) _____ | | | | |
| | Electric (number of rooms) _____ | | | | |
| COMMERCIAL OR INDUSTRIAL HEATING: | Oil or Gas (by a main boiler) _____ | | | | |
| | Oil or Gas (by separate units) _____ | | | | |
| | Electric Under 20 kws _____ | Over 20 kws _____ | | | |
| APPLIANCES: (number of) | Ranges _____ | Water Heaters <u>1</u> | | | |
| | Cook Tops _____ | Disposals _____ | | | |
| | Wall Ovens _____ | Dishwashers _____ | | | |
| | Dryers _____ | Compactors _____ | | | |
| | Fans _____ | Others (denote) _____ | | | <u>1.50</u> |
| | TOTAL _____ | | | | |
| MISCELLANEOUS: (number of) | Branch Panels _____ | | | | |
| | Transformers _____ | | | | |
| | Air Conditioners Central Unit _____ | | | | |
| | Separate Units (windows) _____ | | | | |
| | Signs 20 sq. ft. and under _____ | | | | |
| | Over 20 sq. ft. _____ | | | | |
| | Swimming Pools Above Ground _____ | | | | |
| | In Ground _____ | | | | |
| | Fire/Burglar Alarms Residential _____ | | | | |
| | Commercial _____ | | | | |
| | Heavy Duty Outlets, 220 Volt (such as welders) 30 amps and under _____ | | | | |
| | over 30 amps _____ | | | | |
| | Circus, Fairs, etc. _____ | | | | |
| | Alterations to wires _____ | | | | |
| | Repairs after fire _____ | | | | |
| | Emergency Lights, battery _____ | | | | |
| | Emergency Generators _____ | | | | |

INSTALLATION FEE DUE: _____
 FOR ADDITIONAL WORK NOT ON ORIGINAL PERMIT DOUBLE FEE DUE: _____
 FOR REMOVAL OF A "STOP ORDER" (304-16.b)
 TOTAL AMOUNT DUE: 15.00

INSPECTION:
 Will be ready on _____, 19__ ; or Will Call xx
 CONTRACTOR'S NAME: John Schuettinger
 ADDRESS: RFD # 1 Box 831 Bridgton
 TEL: 647-2246
 MASTER LICENSE NO.: 3698 SIGNATURE OF CONTRACTOR: _____
 LIMITED LICENSE NO.: _____

INSPECTOR'S COPY — WHITE
 OFFICE COPY — CANARY
 CONTRACTOR'S COPY — GREEN

DATE: 3-22-82
COMPLETED
COMPLIANCE
CODE

DATE: _____
REMARKS: _____

INSPECTIONS: Service _____
Service called in _____
Closing-in _____
PROGRESS INSPECTIONS: _____

Permit Application Register Page No. 9
By Inspector: [Signature]
Final Inspection: 3-22-82
Date of Permit: 3-21-82
Owner: Stephen & Dorell
Location: 300 Cambridge St.
Permit Number: 01035
ELECTRICAL INSTALLATIONS —



APPLICATION FOR PERMIT
 DEPARTMENT OF BUILDING INSPECTIONS SERVICES
 ELECTRICAL INSTALLATIONS

Date March 21, 19 85
 Receipt and Permit number D 01632

To the CHIEF ELECTRICAL INSPECTOR, Portland, Maine:

The undersigned hereby applies for a permit to make electrical installations in accordance with the laws of Maine, the Portland Electrical Ordinance, the National Electrical Code and the following specifications:

LOCATION OF WORK: 200 Anderson St.
 OWNER'S NAME: Nelson & Small Inc. ADDRESS: 212 Canco Road

OUTLETS: Receptacles _____ Switches _____ Plugmold _____ ft. TOTAL _____

FIXTURES: (number of) Incandescent _____ Fluorescent _____ (not strip) TOTAL _____
 Strip Fluorescent _____ ft. _____

SERVICES: 2 - services 200 - ~~XXXXXXXXXXXXXXXXXXXX~~ TOTAL amperes 400 6.00

METERS: (number of) 4 _____ Temporary _____ TOTAL amperes 400 6.00

MOTORS: (number of) _____ 2.00

RESIDENTIAL HEATING: Oil or Gas (number of units) _____
 Electric (number of rooms) _____

COMMERCIAL OR INDUSTRIAL HEATING: Oil or Gas (by a main boiler) _____
 Oil or Gas (by separate units) _____
 Electric Under 20 kws _____ Over 20 kws _____

APPLIANCES: (number of) Ranges _____ Water Heaters _____
 Cook Tops _____ Disposals _____
 Wall Ovens _____ Dishwashers _____
 Dryers _____ Compactors _____
 Fans _____ Others (denote) _____

MISCELLANEOUS: (number of) Branch Panels _____
 Transformers _____
 Air Conditioners Central Unit _____
 Separate Units (windows) _____
 Signs 20 sq. ft. and under _____
 Over 20 sq. ft. _____
 Swimming Pools Above Ground _____
 In Ground _____
 Fire/Burglar Alarms Residential _____
 Commercial _____
 Heavy Duty Outlets, 220 Volt (such as welders) 30 amps and under _____
 over 30 amps _____
 Circus, Fairs, etc. _____
 Alterations to wires _____
 Repairs after fire _____
 Emergency Lights, battery _____
 Emergency Generators _____

FOR ADDITIONAL WORK NOT ON ORIGINAL PERMIT INSTALLATION FEE DUE: _____
 FOR REMOVAL OF A "STOP ORDER" (304-16.b) DOUBLE FEE DUE: _____
 TOTAL AMOUNT DUE: 8.00

INSPECTION: Will be ready on _____, 19__; or Will Call xx
 CONTRACTOR'S NAME: John Schuettinger
 ADDRESS: RFD # 1 Box 831 Bridgton, Me.
 TEL.: 647-2246
 MASTER LICENSE NO.: 3698 SIGNATURE OF CONTRACTOR: John Schuettinger
 LIMITED LICENSE NO.: _____

INSPECTOR'S COPY — WHITE
 OFFICE COPY — CANARY
 CONTRACTOR'S COPY — GREEN