

BUILDING PERMIT REPORT

DATE: 16 MAY 2000 ADDRESS: 39 Allison Ave CBL: 353-A-018

REASON FOR PERMIT: To Construct a 8'x12' storage shed

BUILDING OWNER: Richard Petrie

PERMIT APPLICANT: CONTRACTOR David Dardano

USE GROUP: U CONSTRUCTION TYPE: 5B CONSTRUCTION COST: \$2400.00 PERMIT FEES: \$42.00

The City's Adopted Building Code (The BOCA National Building code/1999 with City Amendments)
The City's Adopted Mechanical Code (The BOCA National Mechanical Code/1993)

CONDITION(S) OF APPROVAL

This permit is being issued with the understanding that the following conditions are met: #1, #2, #29, #36, #37

- 1. This permit does not excuse the applicant from meeting applicable State and Federal rules and laws.
2. Before concrete for foundation is placed, approvals from the Development Review Coordinator and Inspection Services must be obtained. (A 24 hour notice is required prior to inspection) "ALL LOT LINES SHALL BE CLEARLY MARKED BEFORE CALLING."
3. Foundation drain shall be placed around the perimeter of a foundation that consists of gravel or crushed stone containing not more than 10 percent material that passes through a No. 4 sieve.
4. Foundations anchors shall be a minimum of 1/2" in diameter, 7" into the foundation wall, minimum of 12" from corners of foundation and a maximum 6' O.C. between bolts.
5. Waterproofing and dampproofing shall be done in accordance with Section 1813.0 of the building code.
6. Precaution must be taken to protect concrete from freezing, Section 1908.0
7. It is strongly recommended that a registered land surveyor check all foundation forms before concrete is placed.
8. Private garages located beneath habitable rooms in occupancies in Use Group R-1, R-2, R-3 or I-1 shall be separated from adjacent interior spaces by fire partitions and floor/ceiling assembly which are constructed with not less than 1-hour fire resisting rating.
9. All chimneys and vents shall be installed and maintained as per Chapter 12 of the City's Mechanical Code.
10. Sound transmission control in residential building shall be done in accordance with Chapter 12, Section 1214.0 of the City's Building Code.
11. Guardrails & Handrails: A guardrail system is a system of building components located near the open sides of elevated walking surfaces for the purpose of minimizing the possibility of an accidental fall from the walking surface to the lower level.
12. Headroom in habitable space is a minimum of 7'6".
13. Stair construction in Use Group R-3 & R-4 is a minimum of 10" tread and 7 1/4" maximum rise.
14. The minimum headroom in all parts of a stairway shall not be less than 80 inches.
15. Every sleeping room below the fourth story in buildings of Use Groups R and I-1 shall have at least one operable window or exterior door approved for emergency egress or rescue.
16. Each apartment shall have access to two (2) separate, remote and approved means of egress.
17. All vertical openings shall be enclosed with construction having a fire rating of at least one (1) hour, including fire doors with self closer's.
18. The boiler shall be protected by enclosing with (1) hour fire rated construction including fire doors and ceiling, or by providing automatic extinguishment.

City of Portland, Maine - Building or Use Permit Application 389 Congress Street, 04101, Tel: (207) 874-8703, FAX: 874-8716

Permit No: **000486**

Location of Construction: _____
 Owner: _____ Phone: _____
 Lessee/Buyer's Name: _____ Phone: _____
 Business Name: _____
 Address: _____ Phone: _____
 Proposed Use: _____
 COST OF WORK: \$ _____
 PERMIT FEE: \$ _____
 FIRE DEPT. Approved Denied
 INSPECTION: Use Group: **U** Type: **59**
 Signature: **[Signature]**
 Signature: **[Signature]**
 PEDESTRIAN ACTIVITIES DISTRICT (P.F.D.) Approved Denied
 Action: Approved with Conditions: Approved Denied
 Signature: _____ Date: _____
 Date Applied For: **NOV 5/15/00**

Contractor Name: **David Dardano**
 Past Use: **Single Family Dwelling**
 Proposed Project Description: **Build on 8' x 12' Storage Shed.**
 Permit Taken By: **MD**
 Date Applied For: **NOV 5/15/00**

Zone: **R-2** CBL: _____
 Zoning Approval: **96A**
 Sec. 14-80 - **Side Yard 5 min.**
 Special Zone or Reviews: **[Signature]**
 Shoreland
 Wetland
 Flood Zone
 Subdivision
 Site Plan maj Minor Imm

Zoning Appeal
 Variance
 Miscellaneous
 Conditional Use
 Interpretation
 Approved
 Denied

Historic Preservation
 Not in District or Landmark
 Does Not Require Review
 Requires Review

Action:
 Approved
 Approved with Conditions
 Denied

Date: _____

CERTIFICATION
 I hereby certify that I am the owner of record of the named property, or that the proposed work is authorized by the owner of record and that I have been authorized by the owner to make this application as his authorized agent and I agree to conform to all applicable laws of this jurisdiction. In addition, if a permit for work described in the application is issued, I certify that the code official's authorized representative shall have the authority to enter all areas covered by such permit at any reasonable hour to enforce the provisions of the code(s) applicable to such permit

PERMIT ISSUED WITH REQUIREMENTS

David Dardano
 38 West Lynde Avenue
 Portland, ME 04103

SIGNATURE OF APPLICANT: _____
 ADDRESS: _____
 PHONE: _____
 DATE: **5/15/00**

RESPONSIBLE PERSON IN CHARGE OF WORK, TITLE: _____
 ADDRESS: _____
 PHONE: _____
 DATE: _____

THIS IS NOT A PERMIT/CONSTRUCTION CANNOT COMMENCE UNTIL THE PERMIT IS ISSUED

**Building or Use Permit Pre-Application
Additions/Alterations/Accessory Structures
To Detached Single Family Dwelling**

Use Permit.

NOTEIf you or the property owner owes real estate or personal property taxes or user charges on any property within the City, payment arrangements must be made before permits of any kind are accepted.**

In the interest of processing your application in the quickest possible manner, please complete the information below for a Building or Use Permit.

*SEND PERMIT TO CONTRACTOR
FOR REVIEW*

Location/Address of Construction: 39 Allison Ave

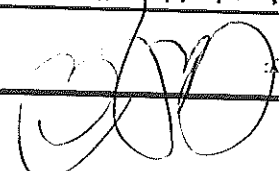
Tax Assessor's Chart, Block & Lot Number		Chart# <u>353</u> Block# <u>A</u> Lot# <u>018</u>	
Owner:		Richard Perez	
Telephone#:		898-9013	
Owner's Address:		39 Allison Ave.	
Lessee/Buyer's Name (If Applicable)			
Cost Of Work:		\$ 2400 -	
Fee		\$ 420.00	
Proposed Project Description: (Please be as specific as possible)			
<u>Build an 8' x 10' Storage Shed.</u>			
Contractors Name, Address & Telephone			
<u>David D'Amico Portland 878-3917</u>			
Reed By: 			

Separate permits are required for Internal & External Plumbing, HVAC and Electrical installation.

- All construction must be conducted in compliance with the 1996 B.O.C.A. Building Code as amended by Section 6-Art II.
- All plumbing must be conducted in compliance with the State of Maine Plumbing Code.
- All Electrical Installation must comply with the 1996 National Electrical Code as amended by Section 6-Art III.
- HVAC(Heating, Ventilation and Air Conditioning) installation must comply with the 1993 BOCA Mechanical Code.

You must include the following with you application:

- 1) A Copy of Your Deed or Purchase and Sale Agreement
- 2) A Copy of your Construction Contract, if available
- 3) A Plot Plan (Sample Attached)

If there is expansion to the structure, a complete plot plan (Site Plan) must include:

- The shape and dimension of the lot, all existing buildings (if any), the proposed structure and the distance from the actual property lines. Structures include decks porches, a bow windows cantilever sections and roof overhangs, as well as, sheds, pools, garages and any other accessory structures.
- Scale and required zoning district setbacks

4) Building Plans (Sample Attached)

- A complete set of construction drawings showing all of the following elements of construction:
 - Cross Sections w/Framing details (including porches, decks w/railings, and accessory structures)
 - Floor Plans & Elevations
 - Window and door schedules
 - Foundation plans with required drainage and dampproofing
 - Electrical and plumbing layout. Mechanical drawings for any specialized equipment such as furnaces, chimneys, gas equipment, HVAC equipment (air handling) or other types of work that may require special review must be included.

Certification

I hereby certify that I am the Owner of record of the named property, or that the proposed work is authorized by the owner of record and that I have been authorized by the owner to make this application as his/her authorized agent. I agree to conform to all applicable laws of this jurisdiction. In addition, if a permit for work described in this application is issued, I certify that the Code Official's authorized representative shall have the authority to enter all areas covered by this permit at any reasonable hour to enforce the provisions of the codes applicable to this permit.

Signature of applicant: D. D'Amico Date: 5/15/00

Building Permit Fee: \$30.00 for the 1st \$1000.00 cost plus \$6.00 per \$1,000.00 construction cost thereafter.

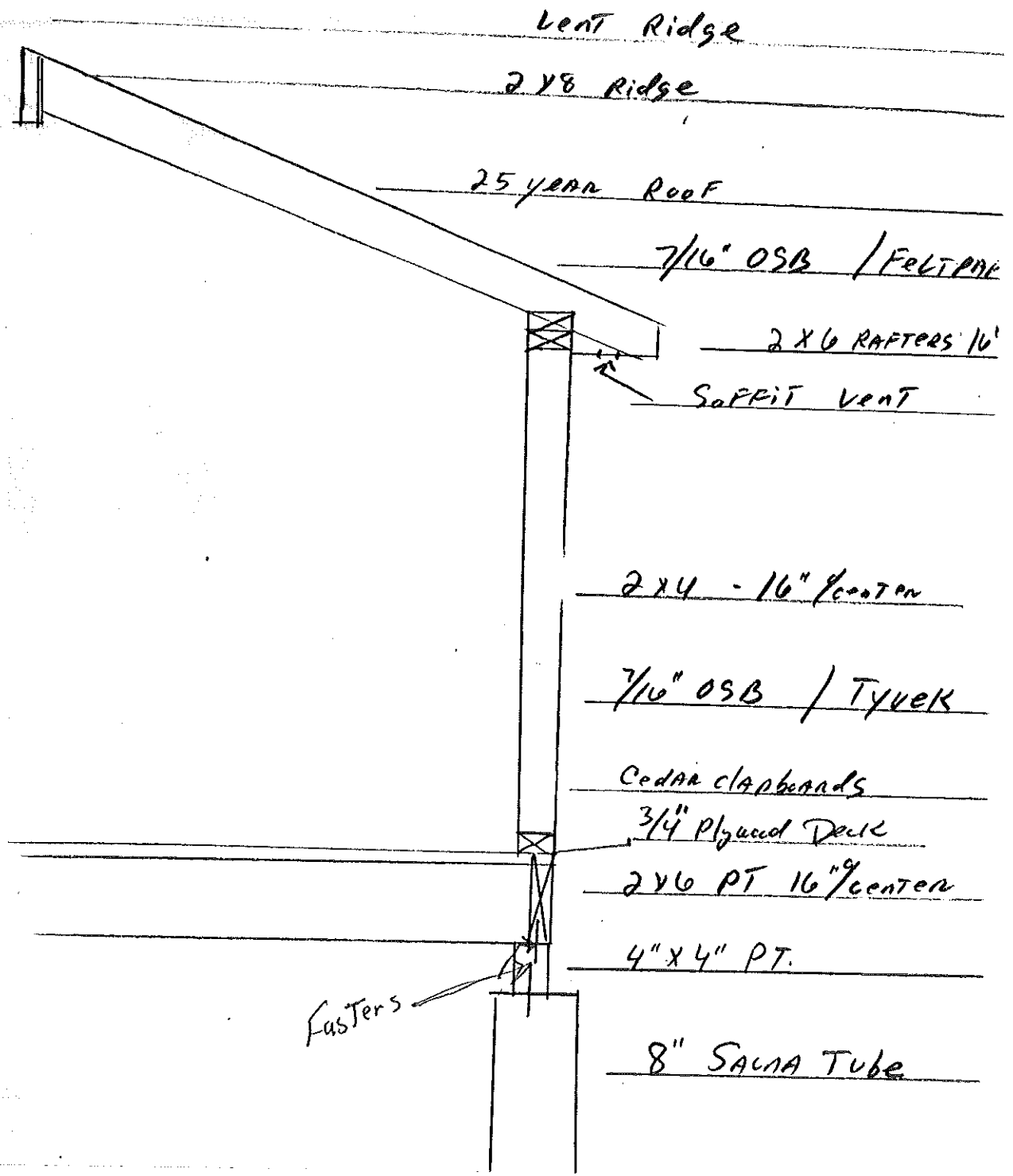

Vent Ridge

2x8 Ridge

25 year Roof

7/16" OSB / FELT PAPE

2x6 RAFTERS 16"

Soffit Vent

2x4 - 16" / center

7/16" OSB / TYVEK

Cedar clabeards

3/4" Plywood Deck

2x6 PT 16" / center

4" x 4" PT.

Fasteners

8" SAWN Tube

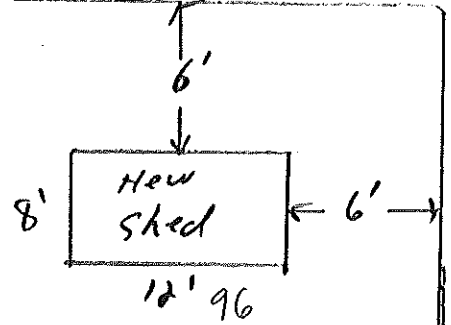

Richard Poire
39 Allison Ave.
Portland, ME
878-9013

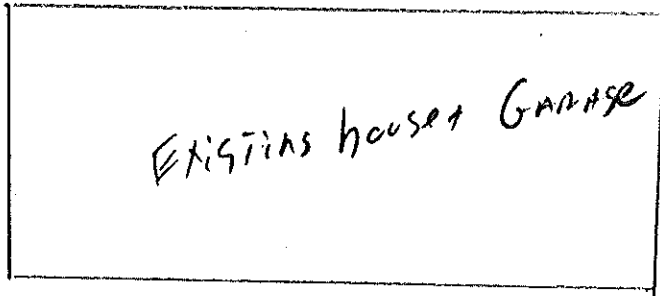

DAVID DARDANO
38 WEST LYNNE AVENUE
PORTLAND, MAINE 04103
878-3922
CONTRACTOR,

SEND TO

39 Allison Ave

FRONT

19. All single and multiple station smoke detectors shall be of an approved type and shall be installed in accordance with the provisions of the City's Building Code Chapter 9, Section 920.3.2 (BOCA National Building Code/1999), and NFPA 101 Chapter 18 & 19. (Smoke detectors shall be installed and maintained at the following locations):
 - In the immediate vicinity of bedrooms
 - In all bedrooms
 - In each story within a dwelling unit, including basements
20. A portable fire extinguisher shall be located as per NFPA #10. They shall bear the label of an approved agency and be of an approved type. (Section 921.0)
21. The Fire Alarm System shall be installed and maintained to NFPA #72 Standard.
22. The Sprinkler System shall be installed and maintained to NFPA #13 Standard.
23. All exit signs, lights and means of egress lighting shall be done in accordance with Chapter 10 Section & Subsections 1023.0 & 1024.0 of the City's Building Code. (The BOCA National Building Code/1999)
24. Section 25 - 135 of the Municipal Code for the City of Portland states, "No person or utility shall be granted a permit to excavate or open any street or sidewalk from the time of November 15 of each year to April 15 of the following year".
25. The builder of a facility to which Section 4594-C of the Maine State Human Rights Act Title 5 MRSA refers, shall obtain a certification from a design professional that the plans commencing construction of the facility, the builder shall submit the certification the Division of Inspection Services.
26. Ventilation and access shall meet the requirements of Chapter 12 Sections 1210.0 and 1211.0 of the City's Building Code. (Crawl spaces & attics)
27. All electrical, plumbing and HVAC permits must be obtained by a Master Licensed holders of their trade. No closing in of walls until all electrical (min. 72 hours notice) and plumbing inspections have been done.
28. All requirements must be met before a final Certificate of Occupancy is issued.
- * 29. All building elements shall meet the fastening schedule as per Table 2305.2 of the City's Building Code (The BOCA National Building Code/1996).
30. Ventilation of spaces within a building shall be done in accordance with the City's Mechanical code (The BOCA National Mechanical Code/1993). (Chapter M-16)
31. Please read and implement the attached Land Use Zoning report requirements.
32. Boring, cutting and notching shall be done in accordance with Sections 2305.3, 2305.3.1, 2305.4.4 and 2305.5.1 of the City's Building Code.
33. Bridging shall comply with Section 2305.16.
34. Glass and glazing shall meet the requirements of Chapter 24 of the building code. (Safety Glazing Section 2406.0)
35. All signage, shall be done in accordance with Section 3102.0 signs of the City's Building Code, (The BOCA National Building Code/1999).
- * 36. 96' Land Use code Rear and side Lot Line set backs 5' min, min. of 25' Front yard - Section 14-86
- * 37. Fasteners shall be used between piers and columns, and columns and primary

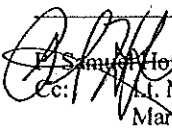
 Marge Schmuckal, Building Inspector
 cc: M. McDougall, PFD
 Marge Schmuckal, Zoning Administrator

PSH 1/2600

****On the basis of plans submitted and conditions placed on these plans any deviations shall require a separate approval.**

*****THIS PERMIT HAS BEEN ISSUED WITH THE UNDERSTANDING THAT ALL THE CONDITIONS OF THE APPROVAL SHALL BE COMPLETED. THEREFORE, BEFORE THE WORK IS COMPLETED A REVISED PLAN OR STATEMENT FROM THE PERMIT HOLDER SHALL BE SUBMITTED TO THIS OFFICE SHOWING OR EXPLAINING THAT THE CONDITIONS HAVE BEEN MET. IF THIS REQUIREMENT IS NOT RECEIVED YOUR CERTIFICATE OF OCCUPANCY SHALL BE WITHHELD.**

******CERTIFICATE OF OCCUPANCY FEE \$50.00**

****** ALL PLANS THAT REQUIRE A PROFESSIONAL DESIGNER'S SEAL, (AS PER SECTION 114.0 OF THE BUILDING CODE) SHALL ALSO BE PRESENTED TO THIS DIVISION ON AUTO CAD LT.2000, OR EQUIVALENT.**