

City of Portland, Maine - Building or Use Permit Application

389 Congress Street, 04101 Tel: (207) 874-8703, Fax: (207) 874-8716

Permit No: 06-1167	Issue Date: PERMIT ISSUED	CBL: 007 D001001
-----------------------	-------------------------------------	---------------------

Location of Construction: 181 RAY ST	Owner Name: SQUIRE CABOT R	Owner Address: 181 RAY ST	Phone: AUG 15 2006
Business Name:	Contractor Name: Down East Energy	Contractor Address: 172 Main Street South Portland	Phone: 2077995585
Lessee/Buyer's Name	Phone:	Permit Type: Tanks - Dwellings	Zone: CITY OF PORTLAND

Past Use: Single Family	Proposed Use: Single Family install a 57 gal tank	Permit Fee:	Cost of Work: \$0.00	CEO District: 4
Proposed Project Description: Install a 57 gal tank		FIRE DEPT: <input type="checkbox"/> Approved <input type="checkbox"/> Denied	INSPECTION: Use Group: <i>[Signature]</i> Type: <i>[Signature]</i>	
		Signature:	Signature: <i>[Signature]</i>	
PEDESTRIAN ACTIVITIES DISTRICT (P.A.D.)				
Action: <input type="checkbox"/> Approved <input type="checkbox"/> Approved w/Conditions <input type="checkbox"/> Denied				
		Signature:	Date:	

Permit Taken By: dmartin	Date Applied For: 08/04/2006	Zoning Approval		
-----------------------------	---------------------------------	------------------------	--	--

<p>1. This permit application does not preclude the Applicant(s) from meeting applicable State and Federal Rules.</p> <p>2. Building permits do not include plumbing, septic or electrical work.</p> <p>3. Building permits are void if work is not started within six (6) months of the date of issuance. False information may invalidate a building permit and stop all work..</p>	<p align="center">Special Zone or Reviews</p> <input type="checkbox"/> Shoreland <input type="checkbox"/> Wetland <input type="checkbox"/> Flood Zone <input type="checkbox"/> Subdivision <input type="checkbox"/> Site Plan Maj <input type="checkbox"/> Minor <input type="checkbox"/> MM <input type="checkbox"/> Date:	<p align="center">Zoning Appeal</p> <input type="checkbox"/> Variance <input type="checkbox"/> Miscellaneous <input type="checkbox"/> Conditional Use <input type="checkbox"/> Interpretation <input type="checkbox"/> Approved <input type="checkbox"/> Denied Date:	<p align="center">Historic Preservation</p> <input type="checkbox"/> Not in District or Landmark <input type="checkbox"/> Does Not Require Review <input type="checkbox"/> Requires Review <input type="checkbox"/> Approved <input type="checkbox"/> Approved w/Conditions <input type="checkbox"/> Denied Date:
---	--	--	--

CERTIFICATION

I hereby certify that I am the owner of record of the named property, or that the proposed work is authorized by the owner of record and that I have been authorized by the owner to make this application as his authorized agent and I agree to conform to all applicable laws of this jurisdiction. In addition, if a permit for work described in the application is issued, I certify that the code official's authorized representative shall have the authority to enter all areas covered by such permit at any reasonable hour to enforce the provision of the code(s) applicable to such permit.

SIGNATURE OF APPLICANT _____ ADDRESS _____ DATE _____ PHONE _____

RESPONSIBLE PERSON IN CHARGE OF WORK, TITLE _____ DATE _____ PHONE _____

City of Portland, Maine - Building or Use Permit

389 Congress Street, 04101 Tel: (207) 874-8703, Fax: (207) 874-8716

Permit No: 06-1167	Date Applied For: 08/04/2006	CBL: 407 D001001
-----------------------	---------------------------------	---------------------

Location of Construction: 181 RAY ST	Owner Name: SQUIRE CABOT R	Owner Address: 181 RAY ST	Phone:
Business Name:	Contractor Name: Down East Energy	Contractor Address: 172 Main Street South Portland	Phone (207) 799-5585
Lessee/Buyer's Name	Phone:	Permit Type: Tanks - Dwellings	

Proposed Use: Single Family install a 57 gal tank	Proposed Project Description: Install a 57 gal tank
--	--

Dept: Building	Status: Approved with Conditions	Reviewer: Mike Nugent	Approval Date: 08/14/2006
Note:	Ok to Issue: <input checked="" type="checkbox"/>		
1) Must comply with NFPA regs.			

Ray Street
111'

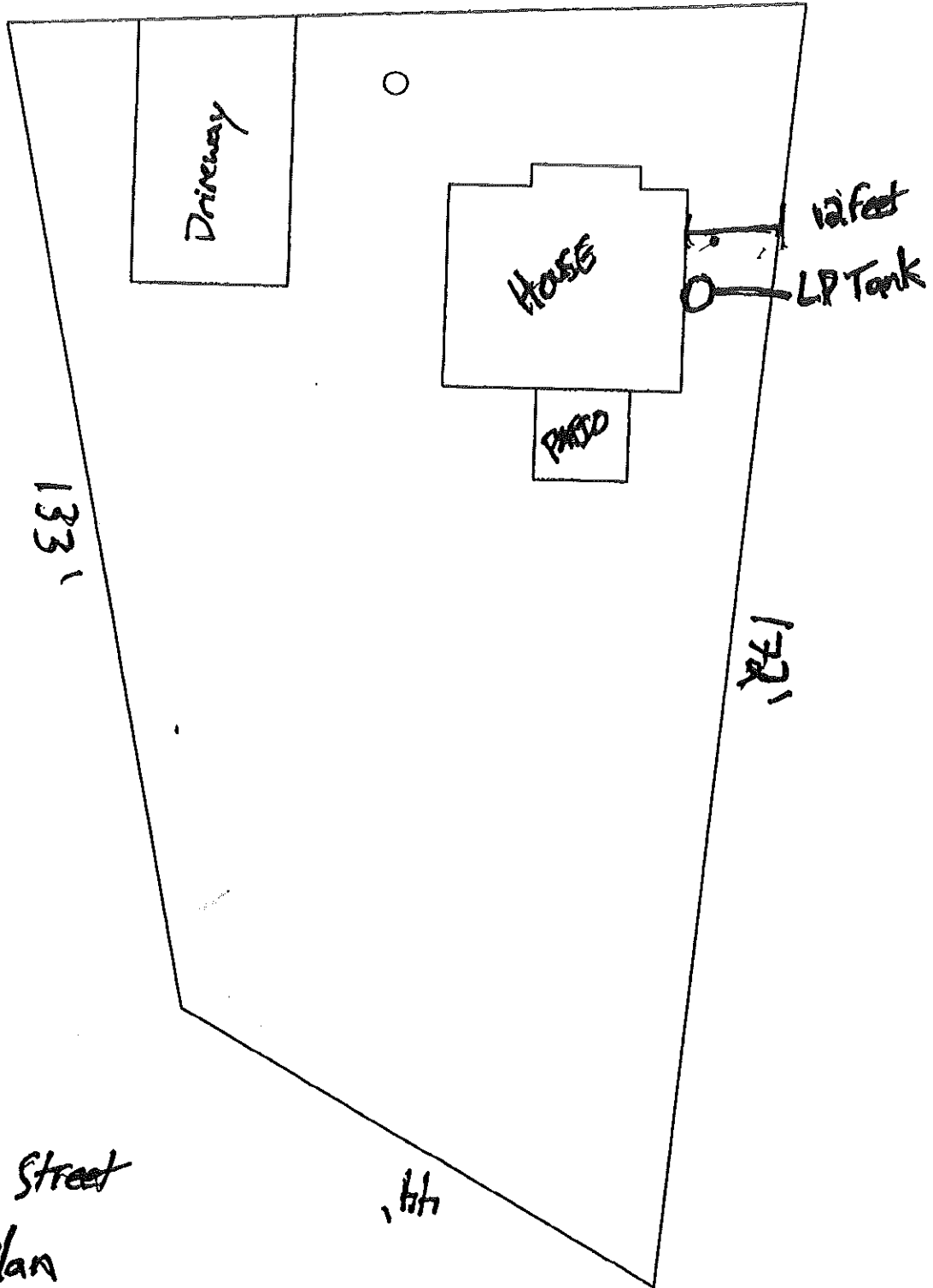

181 Ray Street
Plot Plan

Steve, Here is 181 Ray Plot Plan
w/ LP Tank Location
-Cabot Squire