

36" Min Guard -
w/ balusters less than 4"

- Elevation of the deck will be app 4' from ground
- There will be a hand railing all the way around with balusters 5' apart
- Bolts and nuts will attach the post for the railing. They will be 3' on center

- Deck will be connected to the house with 1/2" throughbolts 2' o.c
- The support beam will be a beam made up of 2-2x10 supported by 3-4x6
- The stairs will be taken from the house and used in the designated location
- Flashing will be used where deck meets the house
- 4x6 post will be supported on cement filled sona tubes
- Sona tubes will be 8" diameter by 4' deep and will be attached with 4 metal Post base
- Joist will be 2x8 connected with joist hangers and toenailed into the support beam (16" o.c)
- Decking will be composite, screwed down.

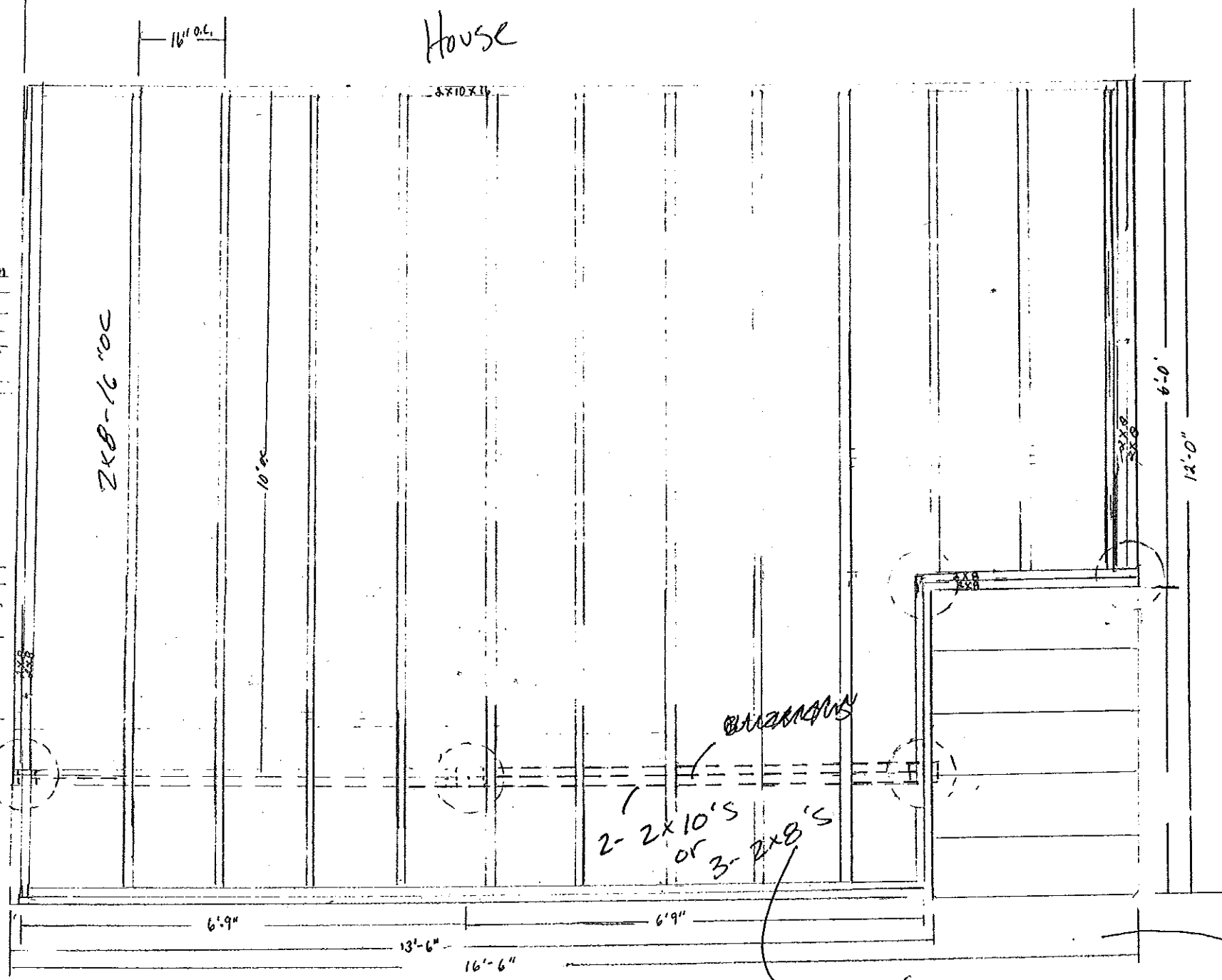

2-2x10's
or
3-2x8's

Spans 8'-6" OK

existing stairs from house being reused in this location.

1/2" = 1'