

PERMIT ISSUED

City of Portland, Maine - Building or Use Permit Application

389 Congress Street, 04101 Tel: (207) 874-8703, Fax: (207) 874-8716

Permit No: 03-0582	Issue Date: JUN 26 2003	CBL: 429 H016001
-----------------------	----------------------------	---------------------

Location of Construction: 81 Jordan St	Owner Name: Bugden Stephen &	Owner Address: 79 Jordan St	Phone: 207-761-8125
Business Name:	Contractor Name: Maine Window & Sunroom	Contractor Address: 71 Portland Rd. Kennebunk	Phone: 2079852300
Lessee/Buyer's Name	Phone:	Permit Type: Additions - Dwellings	Zone:

Past Use: single family	Proposed Use: single family - add 16' x 22' sunroom	Permit Fee: \$114.00	Cost of Work: \$13,000.00	CEO District: 2
		FIRE DEPT: <input checked="" type="checkbox"/> Approved <input type="checkbox"/> Denied	INSPECTION: Use Group: R-3 Type: SB BOIA 99	

Proposed Project Description: add 16'x22' sunroom	Signature:	Signature:
PEDESTRIAN ACTIVITIES DISTRICT (P.A.D.)		
Action: <input type="checkbox"/> Approved <input type="checkbox"/> Approved w/Conditions <input type="checkbox"/> Denied		
Signature:	Date:	

Permit Taken By: tmn	Date Applied For: 05/29/2003	Zoning Approval	
-------------------------	---------------------------------	------------------------	--

- This permit application does not preclude the Applicant(s) from meeting applicable State and Federal Rules.
- Building permits do not include plumbing, septic or electrical work.
- Building permits are void if work is not started within six (6) months of the date of issuance. False information may invalidate a building permit and stop all work..

Special Zone or Reviews <input type="checkbox"/> Shoreland <input type="checkbox"/> Wetland <input type="checkbox"/> Flood Zone <input type="checkbox"/> Subdivision <input type="checkbox"/> Site Plan Maj <input type="checkbox"/> Minor <input type="checkbox"/> MM <input type="checkbox"/> Date: 6/25/03	Zoning Appeal <input type="checkbox"/> Variance <input type="checkbox"/> Miscellaneous <input type="checkbox"/> Conditional Use <input type="checkbox"/> Interpretation <input type="checkbox"/> Approved <input type="checkbox"/> Denied Date:	Historic Preservation <input checked="" type="checkbox"/> Not in District or Landmark <input type="checkbox"/> Does Not Require Review <input type="checkbox"/> Requires Review <input type="checkbox"/> Approved <input type="checkbox"/> Approved w/Conditions <input type="checkbox"/> Denied Date: 6/25/03
---	---	--

CERTIFICATION

I hereby certify that I am the owner of record of the named property, or that the proposed work is authorized by the owner of record and that I have been authorized by the owner to make this application as his authorized agent and I agree to conform to all applicable laws of this jurisdiction. In addition, if a permit for work described in the application is issued, I certify that the code official's authorized representative shall have the authority to enter all areas covered by such permit at any reasonable hour to enforce the provision of the code(s) applicable to such permit.

SIGNATURE OF APPLICANT	ADDRESS	DATE	PHONE
RESPONSIBLE PERSON IN CHARGE OF WORK, TITLE		DATE	PHONE

DISPLAY THIS CARD ON PRINCIPAL FRONTAGE OF WORK CITY OF PORTLAND

Please Read
Application And
Notes, If Any,
Attached

BUILDING INSPECTION PERMIT

Permit Number: 030582

This is to certify that Bugden Stephen &/Maine Window & S
has permission to add 16'x22' sunroom
AT 81 Jordan St 429 H016001

provided that the person or persons, firm or corporation accepting this permit shall comply with all of the provisions of the Statutes of Maine and of the Ordinances of the City of Portland regulating the construction, maintenance and use of buildings and structures, and of the application on file in this department.

Apply to Public Works for street line and grade if nature of work requires such information.

Notification inspection must given and when permission procured before this building or part thereof is occupied or closed-in.
24 HOUR NOTICE IS REQUIRED.

A certificate of occupancy must be procured by owner before this building or part thereof is occupied.

OTHER REQUIRED APPROVALS

Fire Dept. PERMIT ISSUED
Health Dept. _____
Appeal Board JUN 26 2003
Other _____

Department Name

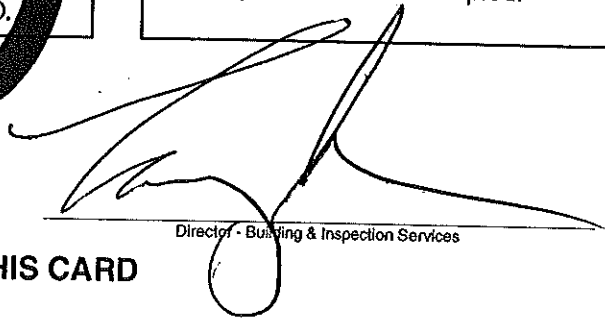

Director - Building & Inspection Services

CITY OF PORTLAND PENALTY FOR REMOVING THIS CARD

Portland

All Purpose Building Permit Application

If you or the property owner owes real estate or personal property taxes or user charges on any property within the City, payment arrangements must be made before permits of any kind are accepted.

Location/Address of Construction: <u>81 Jordan St. Portland</u>		
Total Square Footage of Proposed Structure <u>352</u>	Square Footage of Lot <u>11,660</u>	
Tax Assessor's Chart, Block & Lot Chart# <u>429</u> Block# <u>H</u> Lot# <u>016</u>	Owner: <u>Stephen & Anchina Budgen</u>	Telephone: <u>761-8125</u>
Lessee/Buyer's Name (If Applicable)	Applicant name, address & telephone: <u>MWS Inc (Tammy)</u> <u>71 Portland Rd Kennebunk</u> <u>ME 04043</u>	Cost Of Work: \$ <u>13,000</u> Fee: \$ <u>114.00</u>
Current use: <u>Screened in Deck with open porch</u>		
If the location is currently vacant, what was prior use: _____		
Approximately how long has it been vacant: _____		
Proposed use: <u>Sunroom</u>		
Project description: <u>To enclose 22x16 Deck with sunroom</u>		
Contractor's name, address & telephone: <u>MWS Inc. (Tammy) 71 Portland Rd</u> <u>Kennebunk ME 04043</u>		
Who should we contact when the permit is ready: <u>Tammy or Bruce</u>		
Mailing address: <u>71 Portland Rd Kennebunk, ME 04043</u>		
We will contact you by phone when the permit is ready. You must come in and pick up the permit and review the requirements before starting any work, with a Plan Reviewer. A stop work order will be issued and a \$100.00 fee if any work starts before the permit is picked up. PHONE: <u>985-2300</u> <i>AL</i>		

IF THE REQUIRED INFORMATION IS NOT INCLUDED IN THE SUBMISSIONS THE PERMIT WILL BE AUTOMATICALLY DENIED AT THE DISCRETION OF THE BUILDING/PLANNING DEPARTMENT, WE MAY REQUIRE ADDITIONAL INFORMATION IN ORDER TO APPROVE THIS PERMIT.

I hereby certify that I am the Owner of record of the named property, or that the owner of record authorizes the proposed work and that I have been authorized by the owner to make this application as his/her authorized agent. I agree to conform to all applicable laws of this jurisdiction. In addition, if a permit for work described in this application is issued, I certify that the Code Official's authorized representative shall have the authority to enter all areas covered by this permit at any reasonable hour to enforce the provisions of the codes applicable to this permit.

Signature of applicant: <u>Tammy Patch</u>	Date: <u>5-21-03</u>
--	----------------------

This is NOT a permit, you may not commence ANY work until the permit is issued. If you are in a Historic District you may be subject to additional permitting and fees with the Planning Department on the 4th floor of City Hall

TABLE 1: LOAD/SPAN TABLE FOR HONEYCOMB CORE PANELS

PANEL SPAN (ft)	PANEL CONFIG.	ALLOWABLE LIVE ROOF LOADS FOR HONEYCOMB (H/C) PANELS								
		20 psf	25 psf	30 psf	35 psf	40 psf	45 psf	50 psf	55 psf	60 psf
8	3" HC	*	*	*	*	*	*	*	*	*
8	3" HC + H	*	*	*	*	*	*	*	*	*
8	4.5" HC	*	*	*	*	*	*	*	*	*
8	4.5" HC + H	*	*	*	*	*	*	*	*	*
8	6" HC	*	*	*	*	*	*	*	*	*
8	6" HC + H	*	*	*	*	*	*	*	*	*
9	3" HC	*	*	*	*	*	*	*	*	*
9	3" HC + H	*	*	*	*	*	*	*	*	*
9	4.5" HC	*	*	*	*	*	*	*	*	*
9	4.5" HC + H	*	*	*	*	*	*	*	*	*
9	6" HC	*	*	*	*	*	*	*	*	*
9	6" HC + H	*	*	*	*	*	*	*	*	*
10	3" HC	*	*	*	*	*	*	*	*	*
10	3" HC + H + SKY	*	*	*	*	*	*	*	*	*
10	3" HC + H	*	*	*	*	*	*	*	*	*
10	4.5" HC	*	*	*	*	*	*	*	*	*
10	4.5" HC + H	*	*	*	*	*	*	*	*	*
10	6" HC	*	*	*	*	*	*	*	*	*
10	6" HC + H	*	*	*	*	*	*	*	*	*
11	3" HC	*	*	*	*	*	*	*	*	*
11	3" HC + H + SKY	*	*	*	*	*	*	*	*	*
11	3" HC + H	*	*	*	*	*	*	*	*	*
11	4.5" HC	*	*	*	*	*	*	*	*	*
11	4.5" HC + H	*	*	*	*	*	*	*	*	*
11	6" HC	*	*	*	*	*	*	*	*	*
11	6" HC + H	*	*	*	*	*	*	*	*	*
12	3" HC	*	*	*	*	*	*	*	*	*
12	3" HC + H + SKY	*	*	*	*	*	*	*	*	*
12	3" HC + H	*	*	*	*	*	*	*	*	*
12	4.5" HC	*	*	*	*	*	*	*	*	*
12	4.5" HC + H + SKY	*	*	*	*	*	*	*	*	*
12	4.5" HC + H	*	*	*	*	*	*	*	*	*
12	6" HC	*	*	*	*	*	*	*	*	*
12	6" HC + H	*	*	*	*	*	*	*	*	*
13	3" HC	*	*	*	*	*	*	*	*	*
13	3" HC + H + SKY	*	*	*	*	*	*	*	*	*
13	3" HC + H	*	*	*	*	*	*	*	*	*
13	4.5" HC	*	*	*	*	*	*	*	*	*
13	4.5" HC + H + SKY	*	*	*	*	*	*	*	*	*
13	4.5" HC + H	*	*	*	*	*	*	*	*	*
13	6" HC	*	*	*	*	*	*	*	*	*
13	6" HC + H	*	*	*	*	*	*	*	*	*

(Continued next page)

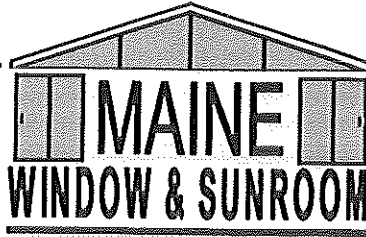

"We Treat Your Home Like Our Own."

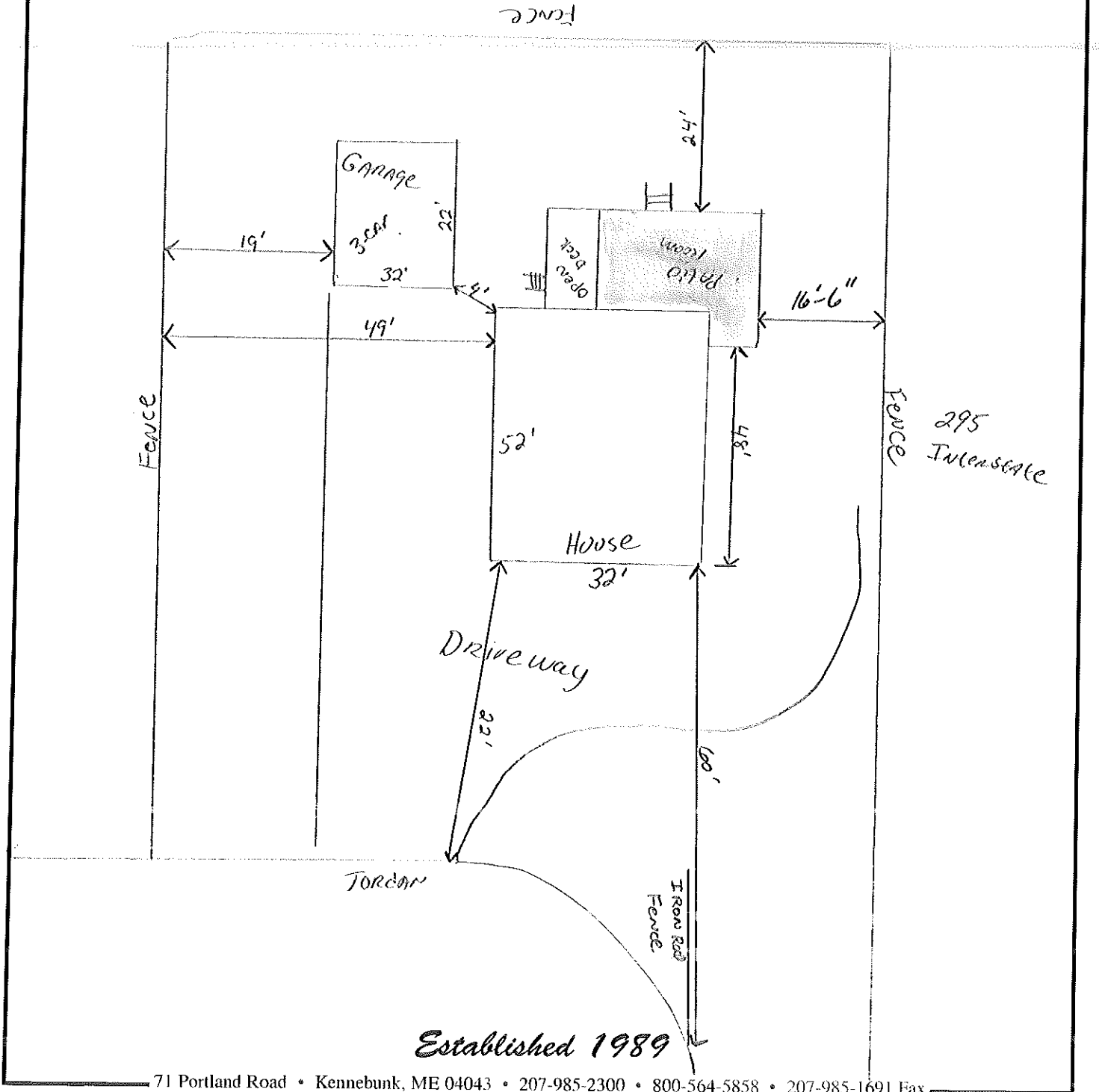

5/29/03-Permit # 030582

4294016001

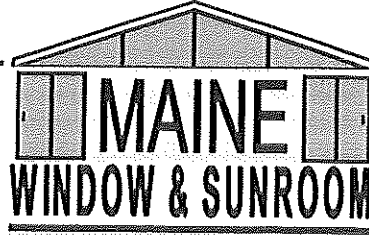

"We Treat Your Home Like Our Own."

Bugden, Stephen

81 Jordan, St

Portland, Me.

04103

Under the deck

2 - 2"x8"

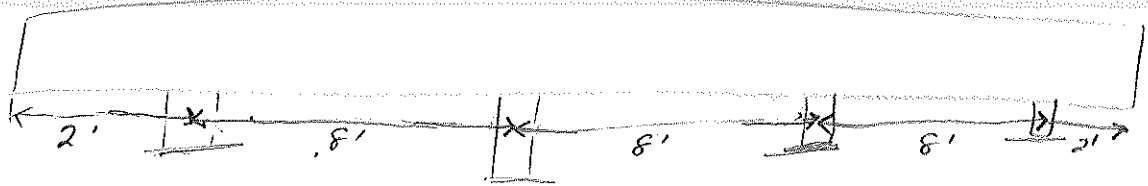

Established 1989

FIGURE 50-2

STUDIO ROOM CROSS SECTION

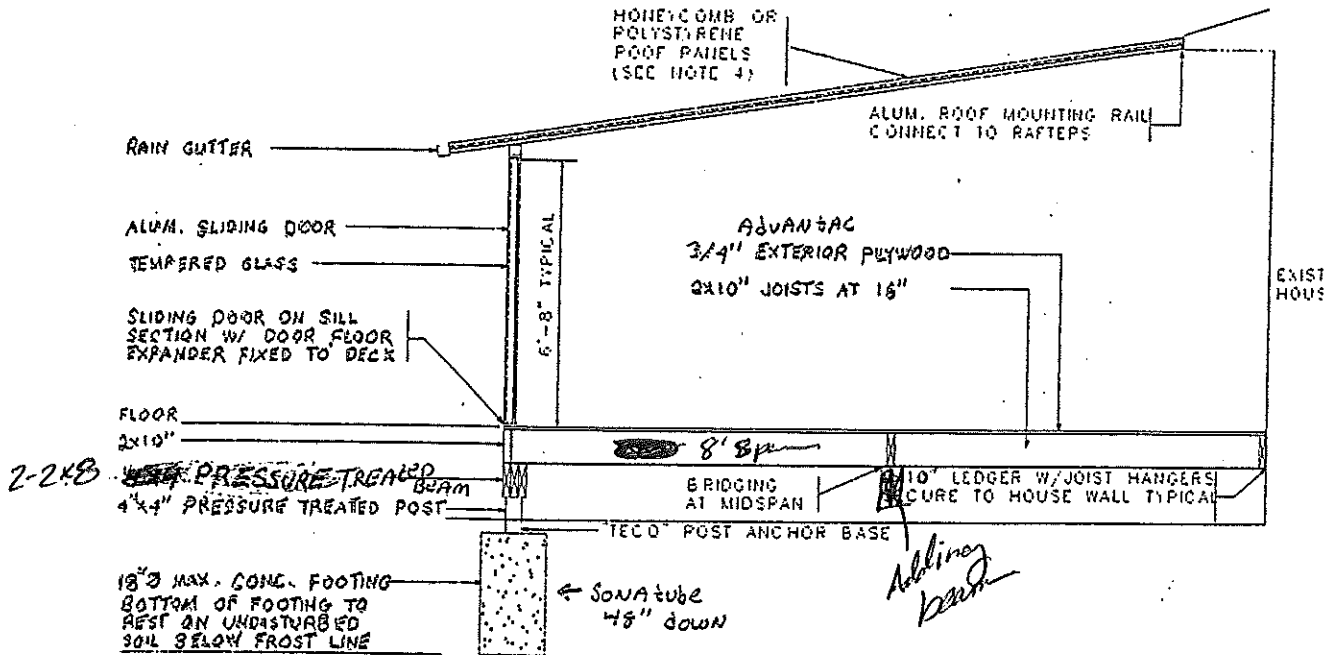

STUDIO ROOM CROSS SECTION (WOODEN DECK)

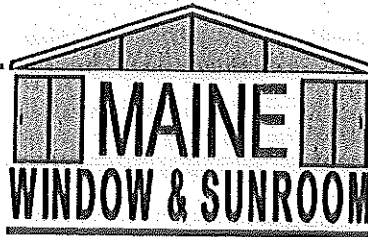

"We Treat Your Home Like Our Own."

DATE: 5/10/03

JOB NAME & ADDRESS:

Stephen & Anchina Bugden
81 Jordan St.
Portland, ME 04103

I, Stephen F. Bugden, hereby authorize Maine Window & Sunroom to act as my agent to acquire a building permit for my home improvement project.

Stephen F. Bugden
Signature

Established 1989

PLUMBING APPLICATION

2004-8415

Department of Human Sciences
Division of Health Engineering

PROPERTY ADDRESS

Town or Plantation: 71-21 SABLE ST. PORTLAND, ME
Street Subdivision Lot #:

PROPERTY OWNERS NAME

Last: BUDGEN First: STEVEN

Applicant Name: ALL ASPECTS TRADING LLC

Mailing Address of Owner/Applicant (If Different): PO BOX 11462 PORTLAND, ME 04104

Owner/Applicant Statement

I certify that the information submitted is correct to the best of my knowledge and understand that any falsification is reason for the Local Plumbing Inspectors to deny a Permit.

Signature of Owner/Applicant

9/31/04
Date

PORTLAND 9113 TOWN COPY
Date Permit Issued: 10/1/04 \$ 1214.00 If Double Fee Charged
Local Plumbing Inspector Signature: [Signature] L.P.I. # 06180
429 H C 100

Caution: Inspection Required

I have inspected the installation authorized above and found it to be in compliance with the Maine Plumbing Rules.

Local Plumbing Inspector Signature

Date Approved

PERMIT INFORMATION

This Application Is for

- 1. NEW PLUMBING
- 2. RELOCATED PLUMBING

Type of Structure To Be Served:

- 1. SINGLE FAMILY DWELLING
- 2. MODULAR OR MOBILE HOME
- 3. MULTIPLE FAMILY DWELLING
- 4. OTHER - SPECIFY IND-HOME BUSINESS

Plumbing To Be Installed By:

- 1. MASTER PLUMBER
- 2. OIL BURNERMAN
- 3. MFG'D. HOUSING DEALER/MECHANIC
- 4. PUBLIC UTILITY EMPLOYEE
- 5. PROPERTY OWNER

LICENSE # 07143

Hook-Up & Piping Relocation Maximum of 1 Hook-Up

HOOK-UP: to public sewer in those cases where the connection is not regulated and inspected by the local Sanitary District.

OR

HOOK-UP: to an existing subsurface wastewater disposal system.

PIPING RELOCATION: of sanitary lines, drains, and piping without new fixtures.

OR

TRANSFER FEE
[\$6.00]

Number	Column 2	Number	Column 1
	Type of Fixture		Type of Fixture
	Hosebibb / Sillcock		Bathtub (and Shower)
	Floor Drain		Shower (Separate)
	Urinal	0, 1	Sink
	Drinking Fountain		Wash Basin
	Indirect Waste		Water Closet (Toilet)
	Water Treatment Softener, Filter, etc.		Clothes Washer
	Grease / Oil Separator		Dish Washer
	Dental Cuspidor		Garbage Disposal
	Bidet		Laundry Tub
	Other: _____		Water Heater
	Fixtures (Subtotal) Column 2	0, 1	Fixtures (Subtotal) Column 1
		0, 0	Fixtures (Subtotal) Column 2
		0, 1	Total Fixtures
			Fixture Fee
			Transfer Fee
			Hook-Up & Relocation Fee
			Permit Fee (Total)

SEE PERMIT FEE SCHEDULE
FOR CALCULATING FEE

06105

TOWN COPY