

Nancy and Terry McGovern  
 174 Sherwood St.  
 Portland, ME 04103

Sec. 14-385  
 allows front steps  
 to be replaced  
 in the exact footprint

RS Zone  
 Front 20' Req 16' scaled  
 Sec. 14-120(d) 1 A Front yard  
 Need not exceed the avg.  
 depth of adjacent lots  
 14.125' Required min.

7/26/05  
 Per Don Nichols  
 Checked setbacks of  
 adjacent lots  
 Inspector check  
 these dimensions

$19'6'' + 8'9'' = 28.25'$   
 $\div 2 = 14.125'$

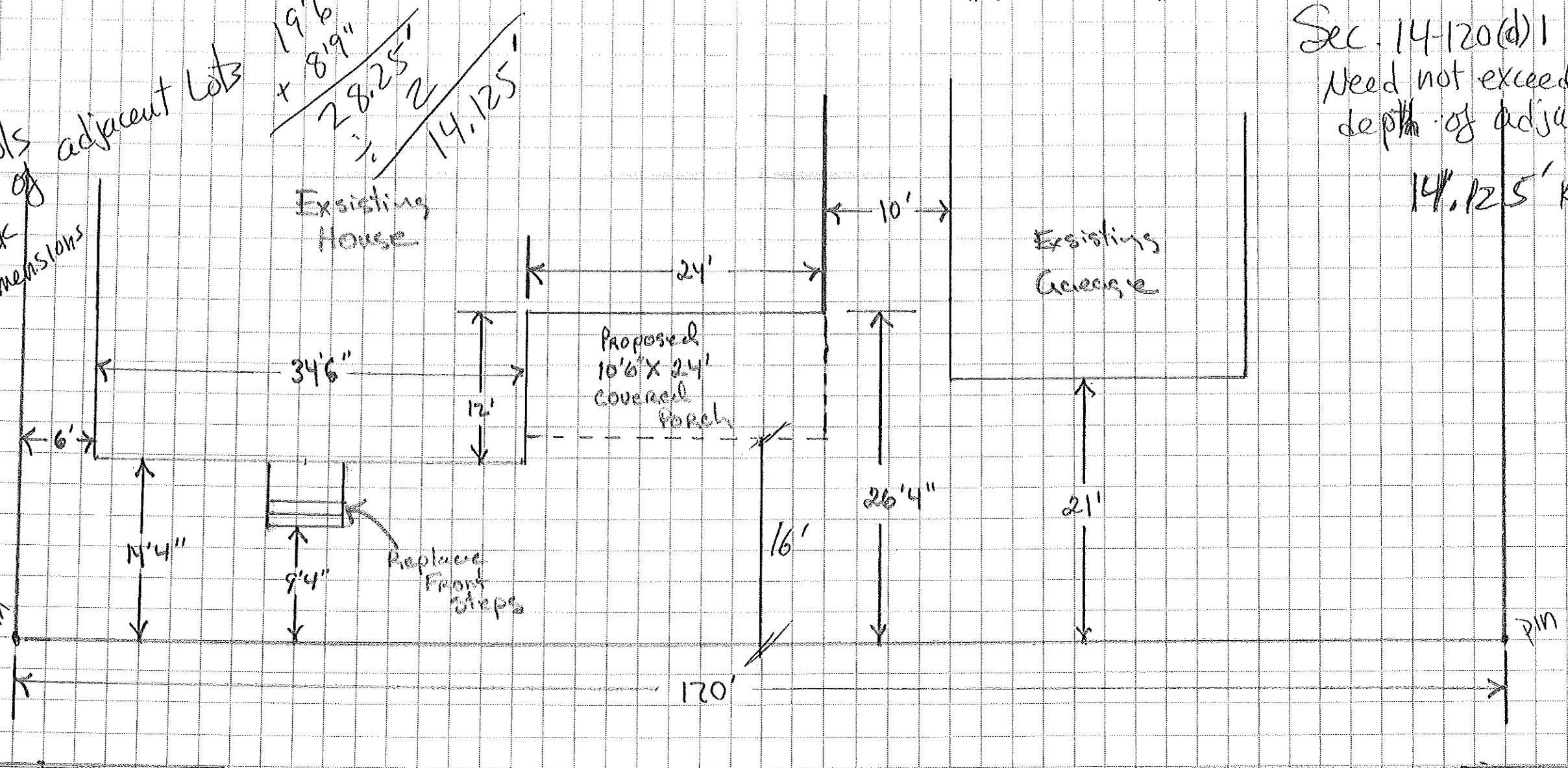

8'9" to steps  
 ↑

19'6"  
 ↑

Front Steps

Sherwood Street

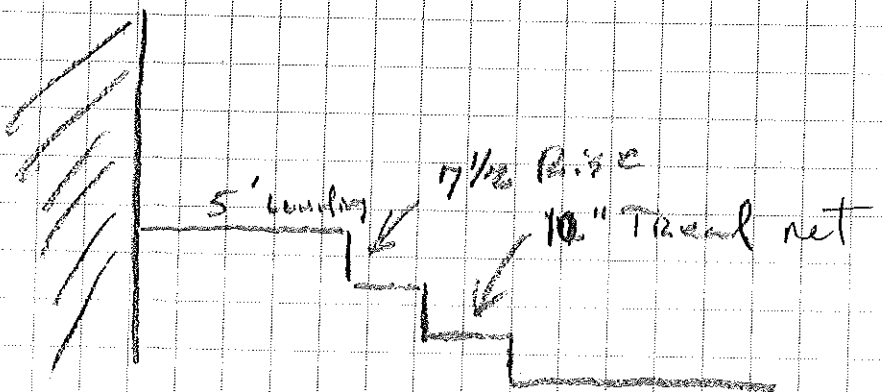

**Don Nichols**  
 Building Contractor, Inc.  
 16 Allagash Way  
 Windham, ME 04062

**DON NICHOLS**  
 BUILDING CONTRACTOR

JOB McGovern  
 SHEET NO. \_\_\_\_\_ OF \_\_\_\_\_  
 CALCULATED BY \_\_\_\_\_ DATE \_\_\_\_\_  
 CHECKED BY \_\_\_\_\_ DATE \_\_\_\_\_  
 SCALE 1" = 10'