

City of Portland, Maine - Building or Use Permit Application

389 Congress Street, 04101 Tel: (207) 874-8703; Fax: (207) 874-8716

Permit No:	06-0125	Issue Date:	JAN 30 2006
352 A001001			

Location of Construction:	1756 WASHINGTON AVE	Owner Name:	ESPOSITO NEIL W & KATHLEE	Owner Address:	1756 WASHINGTON AVE	Phone:	
Business Name:		Contractor Name:		Contractor Address:		Phone:	
Lessee/Buyer's Name		Phone:		Permit Type:	Sheds	Zone:	

Part Use:	Single Family Home	Proposed Use:	Single Family Home/ Put a 8' x 12' shed on cinder-blocks	Permit Fee:	\$30.00	Cost of Work:	\$1,000.00	GEO District:	5
Proposed Project Description:	Put a 8' x 12' shed on cinder-blocks			FIRE DEPT:	<input checked="" type="checkbox"/> Approved <input type="checkbox"/> Denied	INSPECTION:	Use Group: <i>V</i> Type: <i>5B</i>		

Permit Taken By:	Idobson	Date Applied For:	01/26/2006	Signature:	<i>N/A</i>	Signature:	<i>City Zoning Administrator</i>
				Signature:		Signature:	

Zoning Approval

<p>1. This permit application does not preclude the Applicant(s) from meeting applicable State and Federal Rules.</p> <p>2. Building permits do not include plumbing, septic or electrical work.</p> <p>3. Building permits are void if work is not started within six (6) months of the date of issuance. False information may invalidate a building permit and stop all work.</p>	<p>Special Zone or Reviews</p> <p><input type="checkbox"/> Shoreland</p> <p><input checked="" type="checkbox"/> Wetland</p> <p><input type="checkbox"/> Flood Zone</p> <p><input checked="" type="checkbox"/> Subdivision</p> <p><input type="checkbox"/> Site Plan</p> <p>Maj <input type="checkbox"/> Minor <input type="checkbox"/> MM <input type="checkbox"/></p> <p>Date: <i>1/27/06</i></p>	<p>Zoning Appeal</p> <p><input type="checkbox"/> Variance</p> <p><input type="checkbox"/> Miscellaneous</p> <p><input type="checkbox"/> Conditional Use</p> <p><input type="checkbox"/> Interpretation</p> <p><input type="checkbox"/> Approved</p> <p><input type="checkbox"/> Denied</p> <p>Date:</p>	<p>Historic Preservation</p> <p><input checked="" type="checkbox"/> Not in District or Landmark</p> <p><input type="checkbox"/> Does Not Require Review</p> <p><input type="checkbox"/> Requires Review</p> <p><input type="checkbox"/> Approved</p> <p><input type="checkbox"/> Approved w/Conditions</p> <p><input type="checkbox"/> Denied</p> <p>Date: <i>1/27/06</i></p>
--	--	---	---

CERTIFICATION

I hereby certify that I am the owner of record of the named property, or that the proposed work is authorized by the owner of record and that I have been authorized by the owner to make this application as his authorized agent and I agree to conform to all applicable laws of this jurisdiction. In addition, if a permit for work described in the application is issued, I certify that the code official's authorized representative shall have the authority to enter all areas covered by such permit at any reasonable hour to enforce the provision of the code(s) applicable to such permit.

SIGNATURE OF APPLICANT	ADDRESS	DATE	PHONE
RESPONSIBLE PERSON IN CHARGE OF WORK, TITLE		DATE	PHONE

City of Portland, Maine - Building or Use Permit

389 Congress Street, 04101 Tel: (207) 874-8703, Fax: (207) 874-8716

Permit No:	Date Applied For:	CBL:
06-0125	01/26/2006	352 A001001

Location of Construction: 1756 WASHINGTON AVE	Owner Name: ESPOSITO NEIL W & KATHLEE	Owner Address: 1756 WASHINGTON AVE	Phone:
Business Name:	Contractor Name:	Contractor Address:	Phone
Lessee/Buyer's Name	Phone:	Permit Type: Sheds	

Proposed Use: Single Family Home/ Put a 8' x 12' shed on cinder-blocks	Proposed Project Description: Put a 8' x 12' shed on cinder-blocks
---	---

Dept: Zoning	Status: Approved	Reviewer: Tammy Munson	Approval Date: 01/27/2006
Note:			Ok to Issue: <input checked="" type="checkbox"/>

Dept: Building	Status: Approved	Reviewer: Tammy Munson	Approval Date: 01/27/2006
Note:			Ok to Issue: <input checked="" type="checkbox"/>



General Building Permit Application

If you or the property owner owes real estate or personal property taxes or user charges on any property within the City, payment arrangements must be made before permits of any kind are accepted.

Location/Address of Construction: <u>1756 Washington Ave.</u>		Total Square Footage of Proposed Structure: <u>96'</u>		Square Footage of Lot	
Tax Assessor's Chart, Block & Lot Chart# <u>352</u> Block# <u>A</u> Lot# <u>1</u>	Owner <u>Kathleen + Vern</u>	Applicant name, address & telephone: <u>Ramleen + Vern Espinoza</u> <u>1756 Washington Ave</u> <u>Portland ME 04103</u>		Telephone: <u>878-5150</u>	
Lessee/Buyer's Name (If Applicable)		Current Specific use: <u>Storage shed</u>		Cost Of Work: \$ <u>1,000.00</u>	
If vacant, what was the previous use?		Proposed Specific use:		Fee: \$ _____	
Project description: <u>Storage shed 8 x 12 set on Cinder blocks.</u>		Contractor's name, address & telephone:		C of O Fee: \$ <u>30.00/100</u>	
Who should we contact when the permit is ready?		Mailing address:		Phone: <u>878-5150</u>	

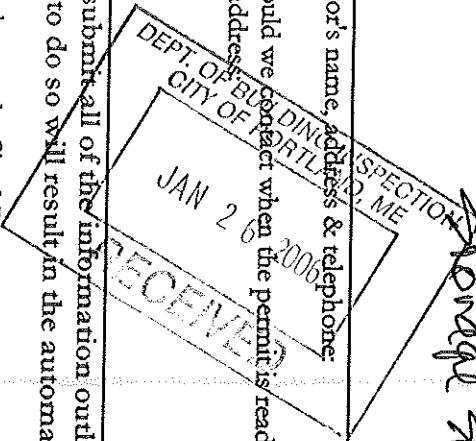

Please submit all of the information outlined in the Commercial Application Checklist. Failure to do so will result in the automatic denial of your permit.

In order to be sure the City fully understands the full scope of the project, the Planning and Development Department may request additional information prior to the issuance of a permit. For further information visit us on-line at www.portlandmaine.gov, stop by the Building Inspections office, room 315 City Hall or call 874-8703.

I hereby certify that I am the Owner of record of the named property, or that the owner of record authorizes the proposed work and that I have been authorized by the owner to make this application as his/her authorized agent. I agree to conform to all applicable laws of this jurisdiction. In addition, if a permit for work described in this application is issued, I certify that the Code Official's authorized representative shall have the authority to enter all areas covered by this permit at any reasonable hour to enforce the provisions of the codes applicable to this permit.

Signature of applicant: [Signature] Date: 1-26-08

This is not a permit; you may not commence ANY work until the permit is issued.

FROM : HARBORCITY REALTY

FAX NO. : 207 775-6451

May 27 2004 04:22PM P1

MORTGAGEN PLAN

I HEREBY CERTIFY TO
THAT THE TITLE STRIPLES
ON THIS MORTGAGE CORP OF PA.
AND ITS TITLE INSURER

THE BUILDING SETBACKS ARE
IN CONFORMITY WITH THE
TOWN ZONING REQUIREMENTS
THE DWELLING DOES NOT FALL
WITHIN THE SPECIAL FLOOD
HAZARD AREA AS DELIMITED BY
F.E.M.A.
THE LAND DOES NOT FALL
WITHIN THE SPECIAL FLOOD
HAZARD AREA AS DELIMITATED
BY F.E.M.A. ON COMMUNITY/
PANEL # 230051 00020

LOCUS ADDRESS

1756 WASHINGTON AVENUE
PORTLAND, MAINE

BUYERS: EDWARD H. TIBBETTS
AND
MARY SUE CRONIN

SELLER: STEPHEN E. CROCKETT

NORTHEASTERN LAND
SURVEYING
134 SCHOOL STREET
GORHAM, MAINE 04038
PHONE (207) 839-2090
FAX (207) 839-6361

JOB NUMBER 135-36
INSPECTION DATE 6-1-99

SCALE: 1"=40'

WASHINGTON AVENUE (BIT)

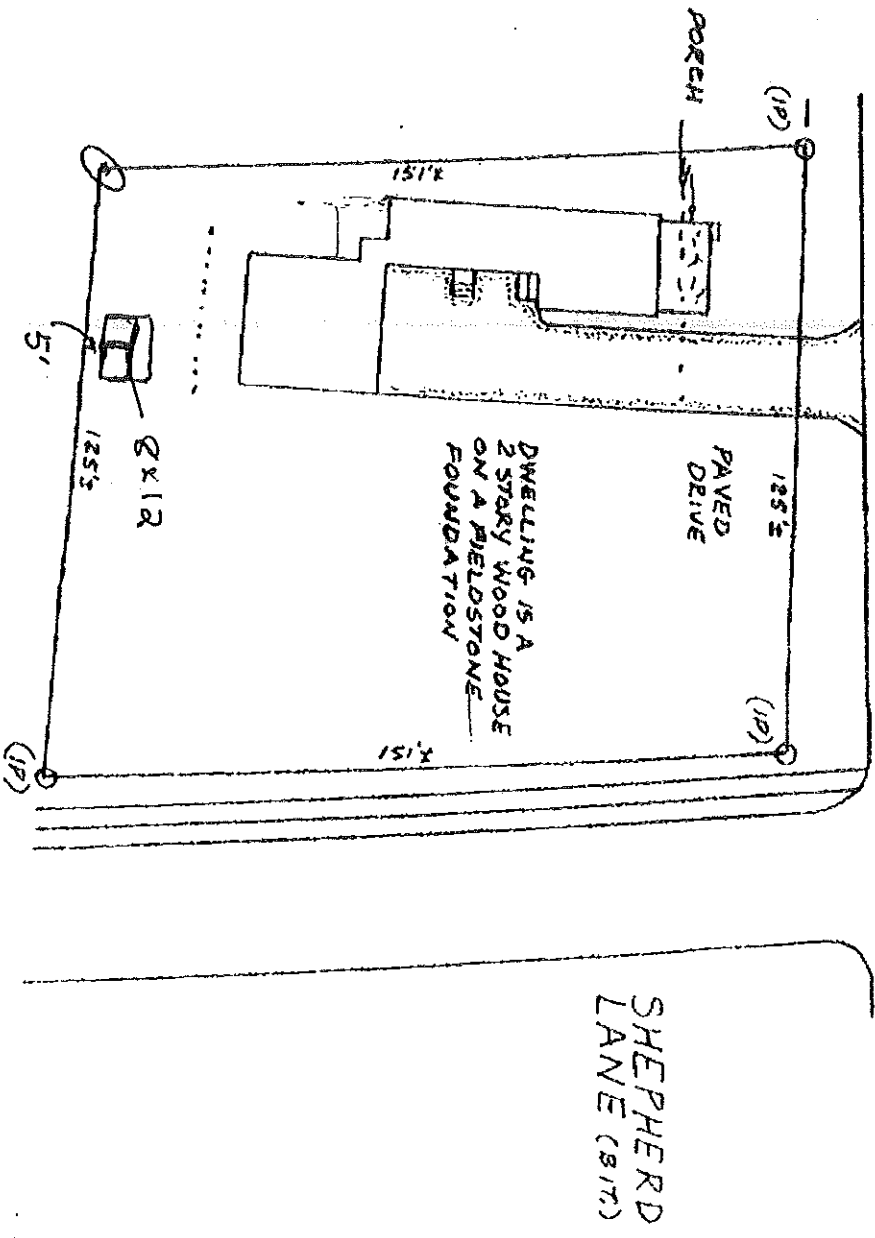

THIS IS NOT A BOUNDARY SURVEY
AND IS NOT FOR RECORDING
PURPOSES. THIS PLAN MAY NOT
REVEAL CONFLICTS WITH ADJUTING
DEEDS. THE PROPERTY IS SUBJECT TO
ALL RIGHTS, COVENANTS, RESTRICTIONS,
AND EASEMENTS OF RECORD.

REFERENCES

PLAN BOOK _____ PAGE _____ LOT _____
DEED BOOK 6836 PAGE 266
COUNTY CUMBERLAND

DRAWN BY 111

DISPLAY THIS CARD ON PRINCIPAL FRONTAGE OF WORK

CITY OF PORTLAND

Please Read Application And Notes, if Any, Attached

This is to certify that ESPOSITO NEIL W & KAT has permission to Put a 8' x 12' shed on cinder- AT 1756 WASHINGTON AVE

BEN J ROBERTS JTS

352 A001001

PERMIT INSPECTION

PERMIT ISSUED

Permit Number: 060125
 JAN 30 2006

CITY OF PORTLAND

provided that the person or persons of the provisions of the Statutes of the construction, maintenance and u this department.

Apply to Public Works for street line and grade if nature of work requires such information.

OTHER REQUIRED APPROVALS

Fire Dept. _____
Health Dept. _____
Appeal Board _____
Other _____

Notification of inspection must be given in writing to the permittee at least 48 hours before the inspection. If the permittee fails to appear for inspection, a notice is required.

A certificate of occupancy must be procured by owner before this building or part thereof is occupied.

Department Name _____

[Signature]
01/27/06

Director - Building & Inspection Services

PENALTY FOR REMOVING THIS CARD