

City of Portland, Maine - Building or Use Permit Application
 389 Congress Street, 04101 Tel: (207) 874-8703, Fax: (207) 874-8716

Permit No:	04-0972	Issue Date:	JUL 14 2004	CBL:	347 0016001
------------	---------	-------------	-------------	------	-------------

Location of Construction:	161 Hennessy Dr	Owner Name:	Orlando Sharon T	Owner Address:	161 Hennessy Dr	CITY OF PORTLAND	Phone:	799-4977
Business Name:		Contractor Name:	Sheds, U.S.A.	Contractor Address:	P.O. Box 6622	Portland	Phone:	6038681300
Lessee/Buyer's Name:		Phone:		Permit Type:	Sheds		Zone:	R-3

Part Use:	single family	Proposed Use:	single family - build 8' x 12' shed	Permit Fee:	\$39.00	Cost of Work:	\$1,800.00	CEO District:	5
Proposed Project Description:	build 8' x 12' shed			FIRE DEPT:	<input type="checkbox"/> Approved <input checked="" type="checkbox"/> Denied	INSPECTION:	Use Group: U	Type:	SB

Signature: *[Signature]* Signature: *[Signature]*
 PEDESTRIAN ACTIVITIES DISTRICT (P.A.D.)
 Action: Approved Approved w/Conditions Denied
 Signature: _____ Date: _____

Permit Taken By:	mm	Date Applied For:	07/14/2004	Zoning Approval		
------------------	----	-------------------	------------	------------------------	--	--

- This permit application does not preclude the Applicant(s) from meeting applicable State and Federal Rules.
- Building permits do not include plumbing, septic or electrical work.
- Building permits are void if work is not started within six (6) months of the date of issuance. False information may invalidate a building permit and stop all work.

Special Zone or Reviews	Zoning Appeal	Historic Preservation
<input type="checkbox"/> Shoreland <input type="checkbox"/> Wetland <input checked="" type="checkbox"/> Flood Zone <input type="checkbox"/> Subdivision <input type="checkbox"/> Site Plan Maj: <input type="checkbox"/> Minor <input type="checkbox"/> MM <input type="checkbox"/> Date: 7/14/04	<input type="checkbox"/> Variance <input type="checkbox"/> Miscellaneous <input type="checkbox"/> Conditional Use <input type="checkbox"/> Interpretation <input type="checkbox"/> Approved <input type="checkbox"/> Denied Date:	<input checked="" type="checkbox"/> Not in District or Landmark <input type="checkbox"/> Does Not Require Review <input type="checkbox"/> Requires Review <input type="checkbox"/> Approved <input type="checkbox"/> Approved w/Conditions <input type="checkbox"/> Denied Date: 7/14/04



CERTIFICATION

I hereby certify that I am the owner of record of the named property, or that the proposed work is authorized by the owner of record and that I have been authorized by the owner to make this application as his authorized agent and I agree to conform to all applicable laws of this jurisdiction. In addition, if a permit for work described in the application is issued, I certify that the code official's authorized representative shall have the authority to enter all areas covered by such permit at any reasonable hour to enforce the provision of the code(s) applicable to such permit.

SIGNATURE OF APPLICANT	ADDRESS	DATE	PHONE
RESPONSIBLE PERSON IN CHARGE OF WORK, TITLE		DATE	PHONE

All Purpose Building Permit Application

If you or the property owner owes real estate or personal property taxes or user charges on any property within the City, payment arrangements must be made before permits of any kind are accepted.

Location/Address of Construction: <u>161 Hennessy Drive</u>		Square Footage of Lot <u>15,088.6 sq. ft.</u>	
Total Square Footage of Proposed Structure <u>96 sq. ft.</u>			
Tax Assessor's Chart, Block & Lot Chart#	Block#	Lot#	Owner: <u>Sharon T Orlando</u>
Lessee/Buyer's Name (If Applicable)			Telephone: <u>797-4977</u>
Current use: <u>Private Residence - Single</u>		Applicant name, address & telephone: <u>Sharon T Orlando 161 Hennessy Drive 797-4977</u>	
If the location is currently vacant, what was prior use: _____		Cost Of Work: \$ <u>1800</u>	
Approximately how long has it been vacant: _____		Fee: \$ _____	
Proposed use: <u>Construct/deliver a shed</u>			
Project description: <u>8'x12' Shed</u>			
Contractor's name, address & telephone:		<u>Sheds USA - PO Box 1623 Portsmouth, NH 1-800-441-8489 www.shedsusa.com 03802</u>	
Who should we contact when the permit is ready: <u>Sharon T. Orlando</u>			
Mailing address: <u>161 Hennessy Drive 797-4977</u>			
We will contact you by phone when the permit is ready. You must come in and pick up the permit and review the requirements before starting any work. With a Plan Reviewer. A stop work order will be issued and a \$100.00 fee if any work starts before the permit is picked up. PHONE: <u>797-4977</u>			

IF THE REQUIRED INFORMATION IS NOT INCLUDED IN THE SUBMISSIONS THE PERMIT WILL BE AUTOMATICALLY DENIED AT THE DISCRETION OF THE BUILDING/PLANNING DEPARTMENT, WE MAY REQUIRE ADDITIONAL INFORMATION IN ORDER TO APPROVE THIS PERMIT.

I hereby certify that I am the Owner of record of the named property, or that the owner of record authorizes the proposed work and that I have been authorized by the owner to make this application as his/her authorized agent. I agree to conform to all applicable laws of this jurisdiction. In addition, if a permit for work described in this application is issued, I certify that the Code Official's authorized representative shall have the authority to enter all areas covered by this permit at any reasonable hour to enforce the provisions of the codes applicable to this permit.

Signature of applicant: Sharon T. Orlando Date: 7.14.04

This is NOT a permit, you may not commence ANY work until the permit is issued. If you are in a Historic District you may be subject to additional permitting and fees with the Planning Department on the 4th floor of City Hall

DISPLAY THIS CARD ON PRINCIPAL FRONTAGE OF WORK CITY OF PORTLAND

Please Read
Application And
Notes, if Any,
Attached

BUILDING INSPECTION PERMIT

Permit Number: 040972

This is to certify that Orlando Sharon T/Sheds, U.S.
has permission to build 8' x 12' shed

At 161 Hennessy Dr

040972 347 C016001

provided that the person or persons, Orlando Sharon T/Sheds, U.S.
of the provisions of the Statutes of the State of Oregon
the construction, maintenance and use of buildings and structures, and of the application on file in
this department.

Apply to Public Works for street line
and grade if nature of work requires
such information.

Notification of inspection must be given to the owner of the building or structure before this permit is issued or closed-in. A NOTICE IS REQUIRED.

A certificate of occupancy must be
procured by owner before this build-
ing or part thereof is occupied.

~~OTHER REQUIRED APPROVALS~~

Fire Dept. _____

Health Dept. _____

Appeal Board _____

Other _____

Department Name: PORTLAND

JUL 14 2004

PENALTY FOR REMOVING THIS CARD

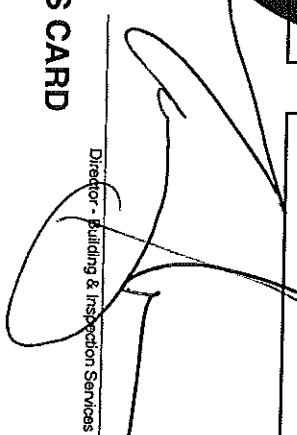

Director - Building & Inspection Services

This page contains a detailed description of the Parcel ID you selected. Press the **New Search** button at the bottom of the screen to submit a new query.

Current Owner Information

Card Number	1 of 1
Parcel ID	347 C016001
Location	161 HENNESSY DR
Land Use	SINGLE FAMILY

Owner Address
 ORLANDO SHARON T
 161 HENNESSY DR
 PORTLAND ME 04103

Book/Page
 Legal
 15034/242
 347-C-16
 HENNESSY DR 155-155
 SKYLARK RD
 15090 SF

Valuation Information

Land	\$35,700	Building	\$57,620	Total	\$103,320
------	----------	----------	----------	-------	-----------

Property Information

Year Built	1963	Style	Ranch	Story Height	1	Sq. Ft.	1000	Total Acres	0.346
------------	------	-------	-------	--------------	---	---------	------	-------------	-------

Bedrooms	3	Full Baths	1	Half Baths	1	Total Rooms	5	Attic	None	Basement	Full
----------	---	------------	---	------------	---	-------------	---	-------	------	----------	------

Outbuildings

Type	SHED-FRAME	Quantity	1	Year Built	1979	Size	5X8	Grade	D	Condition	F
------	------------	----------	---	------------	------	------	-----	-------	---	-----------	---

Sales Information

Date	09/09/1999	Type	LAND + BLDING	Price	\$107,000	Book/Page	15034-242
------	------------	------	---------------	-------	-----------	-----------	-----------

[Picture](#) [Sketch](#)
Picture and Sketch

Any information concerning tax payments should be directed to the Treasury office at 874-8490 or e-mailed.

New Search!

Descriptor/Area

A: 1F,r/B
1000 sqft

B: W/D
164 sqft

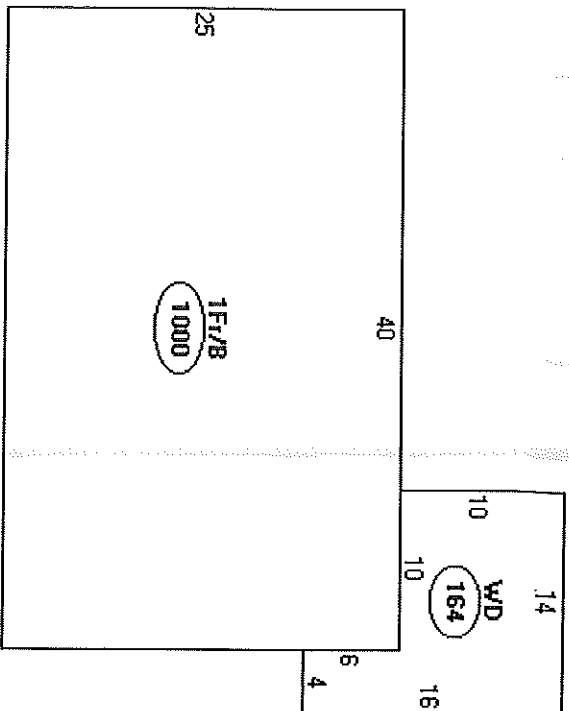

Baldie
1682.58

60 1.925.98 TOTAL cents

8.00 check
285.00 Deposite

Options & Upgrades

Note: Options and upgrades are an additional cost to the standard pricing.

Floor Upgrades

Pressure treated 5/8" plywood floor	\$1.20/sq ft
6' & 8' wide sheds: 2" x 6" (16" on center) PT floor joist upgrade	\$.92/sq ft
6' & 8' wide sheds: 2" x 6" (12" on center) PT floor joist upgrade (12" on center floor joist upgrade increases floor strength by 200%)	\$1.27/sq ft
10' & 12' wide sheds: 2" x 6" (12" on center) floor joist upgrade	\$.35/sq ft
12" on center floor joist upgrade increases floor strength by more than 30%	
Pressure treated floor joist options for all Sheds	see chart below

PRESSURE TREATED FLOOR JOIST UPGRADE

6 x 6	\$ 25.00	10x14	\$ 70.00
6 x 8	\$ 30.00	10x16	\$ 75.00
8 x 8	\$ 30.00	10x18	\$ 100.00
8 x 10	\$ 30.00	12x12	\$ 76.00
8 x 12	\$ 40.00	12x14	\$ 88.00
8 x 14	\$ 40.00	12x16	\$ 100.00
8 x 16	\$ 50.00	12x18	\$ 125.00
10x10	\$ 55.00	12x20	\$ 150.00
10x12	\$ 60.00		

Door Upgrades Note: 6x6 size sheds come standard with 26" single door.

Size	Price
Exchange standard 26" single door for 40" double door (6x6 shed only)	\$ 50.00
Exchange standard 40" double door for 54"	\$ 60.00
Exchange standard 40" double door for 66"	\$ 90.00
Exchange standard 40" double door for 78"	\$ 120.00

Other Options

Item	Price
Pressure treated 4" ramp (Ramp will fit to door opening - one free ramp per order, additional ramps \$50)	FREE
Additional 26" single door	\$ 85.00
Additional 40" double door	\$ 130.00
Additional 54" double door	\$ 150.00
Additional 66" double door	\$ 175.00
Additional 78" double door	\$ 195.00
WOOD SHED ONLY - Additional window (includes flower box and shutters)	\$ 69.00
VINYL SHED ONLY - Functional window upgrade* (arch) (standard vinyl shed window does not open - functional window opens)	\$ 49.00
*Note: Functional window upgrade must be purchased on all windows purchased with shed. Standard # of windows: 1 window - 6x6, 6x8, 8x8, 8x10, 10x10; 2 windows - all other sizes.	
Window screen (each)	\$ 15.00
Aluminum gable vents (pair)	\$ 30.00
Work bench (2"x4" construction with plywood top - approx. 7.5')	\$ 60.00
Shelf (12" wide x 7' long)	\$ 45.00
4' storage loft for 8' wide sheds	\$ 65.00
4' storage loft for 10' wide sheds	\$ 80.00
4' storage loft for 12' wide sheds	\$ 95.00
*Note: Storage loft not available for 6' wide sheds. Loft storage space will vary with roof style. Loft not recommended on Front Extended Peak roof style sheds due to space limitations.	
Anchor Kit" (Anchors and hurricane clips)	\$ 120.00

Site Requirements

- Clearance around the shed site must be at least 3' from any fences, trees, etc. Please remove tree branches, brush or other obstacles 3' around perimeter of shed and 12' above ground.
- Land grade must be less than a 6" slope from the highest to lowest point, with no protruding rocks or stumps in the area.
- Access to the site must be clear; sheds are delivered in prefab panels—stairs, narrow walkways, fences, gates, shrubs, carports, awnings, arbors, etc. may present difficulties and should be brought to Sheds USA's attention prior to delivery.
- Land quality is important. When choosing your site consider all factors, including: proper drainage, firmness of earth, etc.
- Permits are the responsibility of the homeowner. Please contact your local town office prior to purchasing/ordering your shed to determine town/county restrictions, if any.
- Shed site must be 150' or less from where large tractor trailer can park. Sheds sites located further than 150' from truck parking area will incur a minimum \$50.00 fee, payable to Sheds USA at time of scheduling. Please inform/contact our office if this applies to your site (toll free 866.616.2687).

If any of the above SITE REQUIREMENTS are not fulfilled, your shed may not be built and a fee of \$150.00 will be charged for our crews to return and construct your shed once conditions are met. If this occurs, delivery of your shed materials must be accepted and placed on your property in a location accessible to the final shed site to avoid a \$300 re-delivery fee. It is the customer's responsibility to cover the materials with a non-transparent, waterproof material to prevent any unnecessary weathering and/or discoloration. All fees are assessed by Sheds USA at time of notification.

"Please note: Some town/county building codes may require customers to purchase an Anchor kit and/or 2"x 6" (12" or 16" o/c) Floor Joist option/upgrade in order to meet town/county specific requirements/codes. Although Sheds USA builds one of the highest quality shed products available, some towns have very stringent building codes and Sheds USA cannot guarantee that all of our sheds will meet these codes. Any additional cost necessary to meet code requirements will be the customer's responsibility.

**Cedar sheds may be built with Cedar or Cypress depending on availability. Cypress and Cedar have very similar appearance & characteristics, all bulleted items under the Cedar header apply to both wood types. Sheds USA reserves the right to substitute materials with the understanding that any substitutions will be of comparable quality and appearance to that being specified.*

Visit www.ShedsUSA.com/millstores for more detailed information.

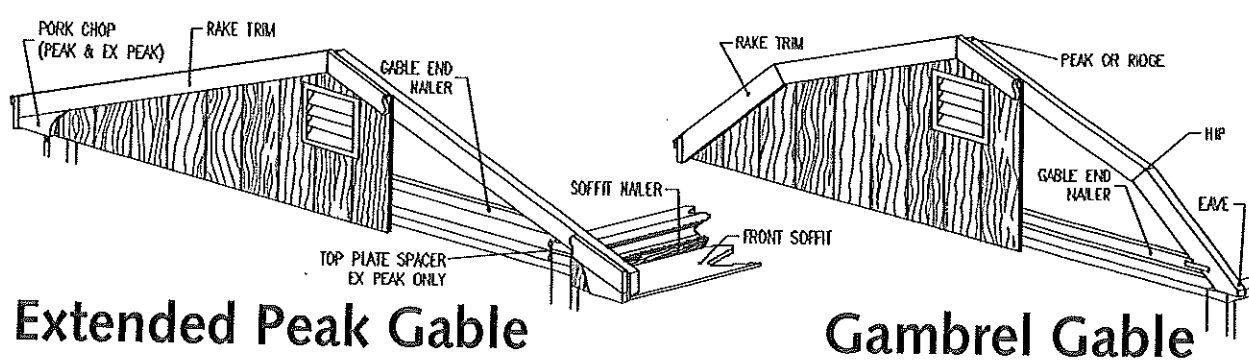
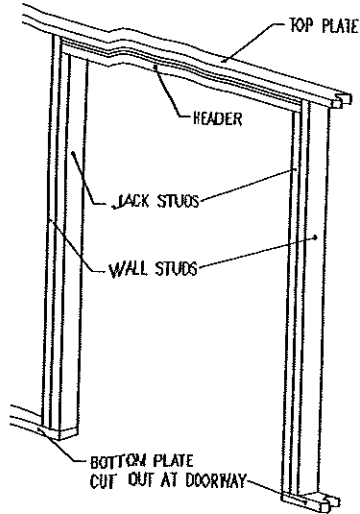

Typical Door Framing

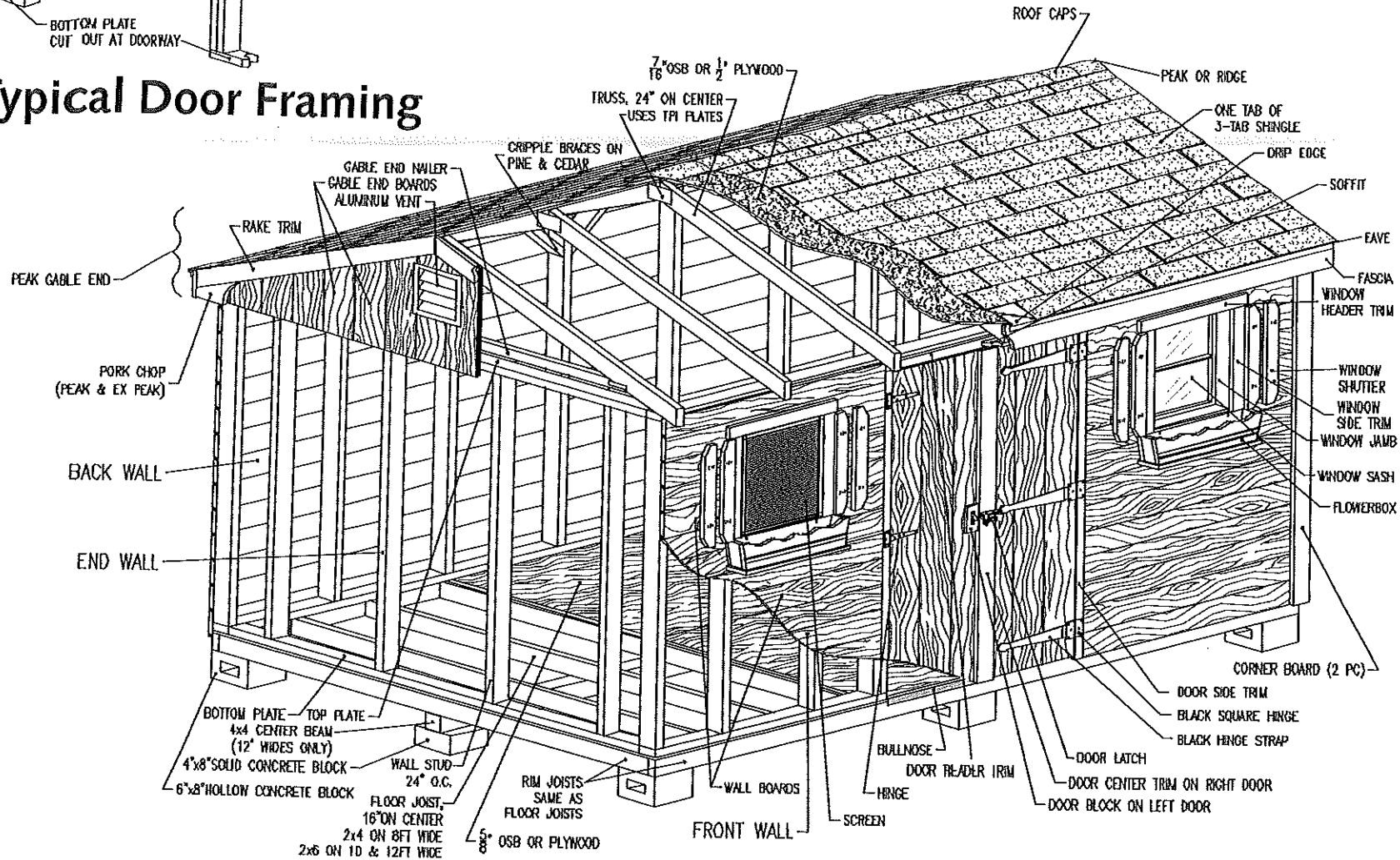

Cutaway of Pine Shed with Peak Roof

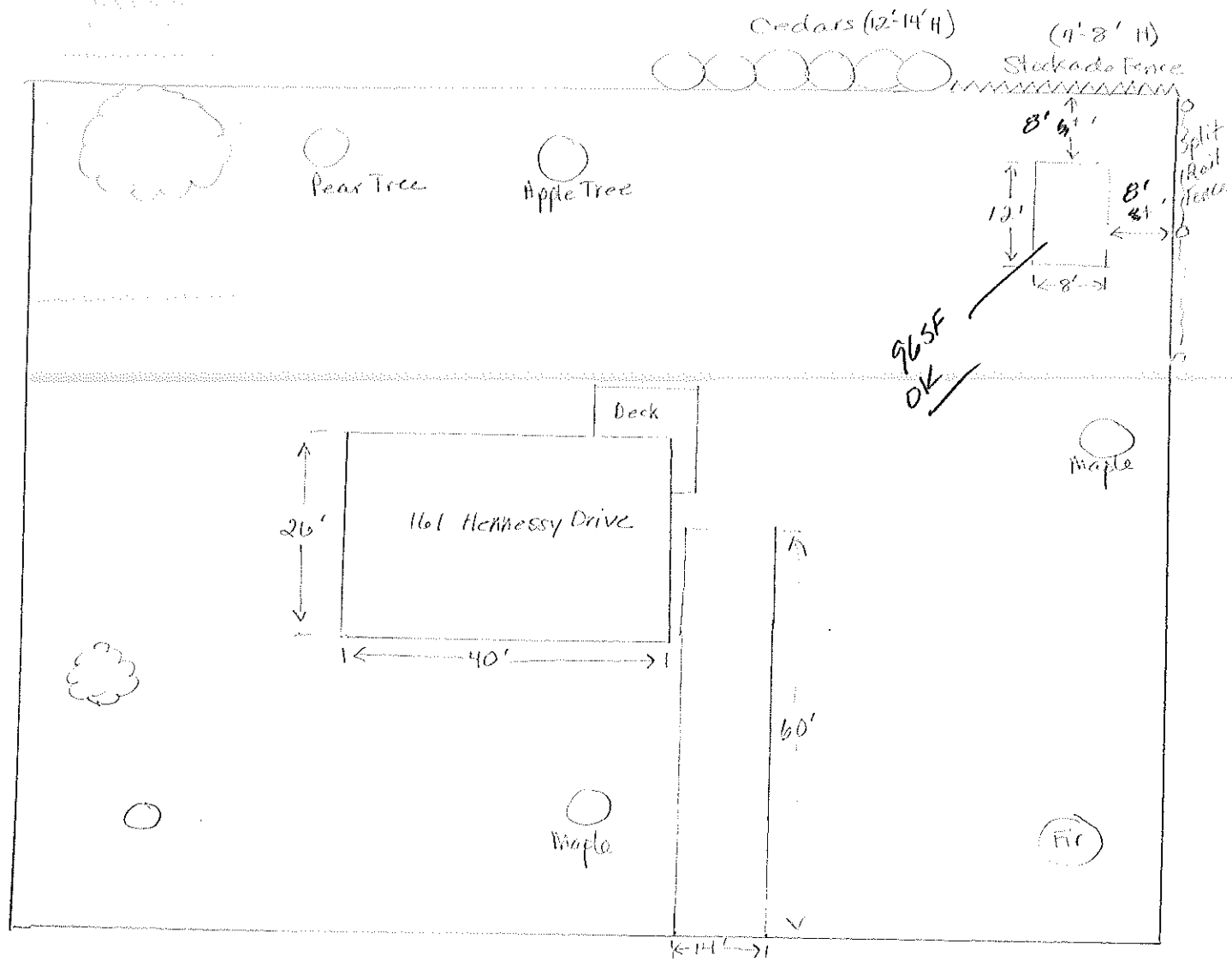

←
 Move to 8'
 R-3 OK
 Lot cov- OK
 Side + rear- 5' Reg.

BUILDING PERMIT INSPECTION PROCEDURES

Please call 874-8703 or 874-8693 to schedule your inspections as agreed upon

Permits expire in 6 months, if the project is not started or ceases for 6 months.

The Owner or their designee is required to notify the inspections office for the following inspections and provide adequate notice. Notice must be called in 48-72 hours in advance in order to schedule an inspection:

By initializing at each inspection time, you are agreeing that you understand the inspection procedure and additional fees from a "Stop Work Order" and "Stop Work Order Release" will be incurred if the procedure is not followed as stated below.

 Pre-construction Meeting: Must be scheduled with your inspection team upon receipt of this permit. Jay Reynolds, Development Review Coordinator at 874-8632 must also be contacted at this time, before any site work begins on any project other than single family additions or alterations.

Footing/Building Location Inspection: Prior to pouring concrete

 Re-Bar Schedule Inspection: Prior to pouring concrete

 Foundation Inspection: Prior to placing ANY backfill

Framing/Rough Plumbing/Electrical: Prior to any insulating or drywalling

Final/Certificate of Occupancy: Prior to any occupancy of the structure or use. NOTE: There is a \$75.00 fee per inspection at this point.

Certificate of Occupancy is not required for certain projects. Your inspector can advise you if your project requires a Certificate of Occupancy. All projects DO require a final inspection

 If any of the inspections do not occur, the project cannot go on to the next phase, REGARDLESS OF THE NOTICE OR CIRCUMSTANCES.

CERTIFICATE OF OCCUPANCIES MUST BE ISSUED AND PAID FOR, BEFORE THE SPACE MAY BE OCCUPIED

Thomas J. Owens
Signature of Applicant/Designee

Date 7/14/04

Signature of Inspections Official

Date 7/14/04

CBI: 3471-C-16

Building Permit #: 04-0972



CITY OF PORTLAND, MAINE

Department of Building Inspections

7/14/04 20

Received from Stann Orlando

Location of Work 101 Hennessy

Cost of Construction \$ 1800

Permit Fee \$ 39

CBL: 347-C-16 Plumbing (15) Electrical (12) Site Plan (12)

Check #: 1608

Total Collected \$ 39

THIS IS NOT A PERMIT

No work is to be started until PERMIT CARD is actually posted on the premises. Acceptance of fee is no guarantee that permit will be granted. PRESERVE THIS RECEIPT. In case permit cannot be obtained the amount of the fee will be refunded upon return of the permit less \$10.00 or 10% whichever is greater.

Applicant's Copy
 - Office Copy
 - Permit Copy