

City of Portland, Maine - Building or Use Permit Application
 389 Congress Street, 04101 Tel: (207) 874-8703, Fax: (207) 874-8716

Permit No:	06-1204	Issue Date:	CBL:	344 H007001
------------	---------	-------------	------	-------------

Location of Construction:	Owner Name:	Owner Address:	Phone:
1438 WASHINGTON AVE	COFFIN RALPH J	1438 WASHINGTON AVE	
Business Name:	Contractor Name:	Contractor Address:	Phone:
	The Signery	299 Forest Avenue Portland	2078797700
Lessee/Buyer's Name	Phone:	Permit Type:	Zone:
		Signs - Permanent	

Past Use:	Proposed Use:	Permit Fee:	Cost of Work:	CEO District:
Commercial	Commercial install 5.5' x 2.5' sign freestanding sign & 7' x 7.5 wall sign		\$0.00	5

WITHDRAW

FIRE DEPT:	INSPECTION:	Signature:	Type:
<input type="checkbox"/> Approved <input type="checkbox"/> Denied	Use Group:		
Signature:		Signature:	
PEDESTRIAN ACTIVITIES DISTRICT (P.A.D.)		Date:	
Action: <input type="checkbox"/> Approved <input type="checkbox"/> Approved w/Conditions <input type="checkbox"/> Denied			
Signature:	Date:		

Permit Taken By:	Date Applied For:	Zoning Approval	
dmartin	04/14/2006		

Proposed Project Description:	Special Zone or Reviews	Zoning Appeal	Historic Preservation
Install 5.5' x 2.5' sign freestanding sign & 7' x 7.5 wall sign	<input type="checkbox"/> Shoreland <input type="checkbox"/> Wetland <input type="checkbox"/> Flood Zone <input type="checkbox"/> Subdivision <input type="checkbox"/> Site Plan Maj <input type="checkbox"/> Minor <input type="checkbox"/> MM <input type="checkbox"/>	<input type="checkbox"/> Variance <input type="checkbox"/> Miscellaneous <input type="checkbox"/> Conditional Use <input type="checkbox"/> Interpretation <input type="checkbox"/> Approved <input type="checkbox"/> Denied	<input type="checkbox"/> Not in District or Landmark <input type="checkbox"/> Does Not Require Review <input type="checkbox"/> Requires Review <input type="checkbox"/> Approved <input type="checkbox"/> Approved w/Conditions <input type="checkbox"/> Denied
	Date:	Date:	Date:

- This permit application does not preclude the Applicant(s) from meeting applicable State and Federal Rules.
- Building permits do not include plumbing, septic or electrical work.
- Building permits are void if work is not started within six (6) months of the date of issuance. False information may invalidate a building permit and stop all work.

WITHDRAW

CERTIFICATION

I hereby certify that I am the owner of record of the named property, or that the proposed work is authorized by the owner of record and that I have been authorized by the owner to make this application as his authorized agent and I agree to conform to all applicable laws of this jurisdiction. In addition, if a permit for work described in the application is issued, I certify that the code official's authorized representative shall have the authority to enter all areas covered by such permit at any reasonable hour to enforce the provision of the code(s) applicable to such permit.

SIGNATURE OF APPLICANT	ADDRESS	DATE	PHONE

RESPONSIBLE PERSON IN CHARGE OF WORK, TITLE	DATE	PHONE



Signage/Awning Permit Application

If you or the property owner owes real estate or personal property taxes or user charges on any property within the City, payment arrangements must be made before permits of any kind are accepted.

Location/Address of Construction: 1438 Washington Avenue Portland ME 04108	
Tax Assessor's Chart, Block & Lot Chart# 344-H - Lot# 7+8 TAX ACCOUNT 31088	Owner: Ralph J. Coffin Jr. & Julie Armstrong
Telephone: (207) 747-8595	
Lessee/Buyer's Name (if Applicable) Cornerstone Title & Settlement Company Julie Armstrong = Annex	Contractor name, address & telephone: The Signery Cove St. Portland 879-7700
	Total s.f. of signage x \$2.00 Per s.f. plus \$50.00/\$65.00 52 ^M x 42 ^M For H.D. signage= Total Fee: \$ Awning Fee= cost of work Total Fee: \$ 56
Height: Single Tenant or Multi Tenant Lot 29 SINGE	phone: 747 8595
pany - real estate closing services	
No <input type="checkbox"/> Dimensions proposed: 5 1/2 x 2 1/2 ft	Height from grade: 3 1/2 ft
No <input type="checkbox"/> Dimensions proposed: 7 ft x 1 1/2 ft, over door	
Awning backlit? Yes <input type="checkbox"/> No <input type="checkbox"/>	Depth: _____
Awning mark or symbol on it? Yes <input type="checkbox"/> No <input type="checkbox"/>	_____
message, trademark or symbol: _____	s.f. _____
Information on existing and previously permitted sign(s): old owner	
Freestanding (e.g. pole) sign? Yes <input checked="" type="checkbox"/> No <input type="checkbox"/>	Dimensions: 4 ft x 4 ft
Bldg. wall sign? (attached to bldg) Yes <input type="checkbox"/> No <input type="checkbox"/>	Dimensions: 8 ft x 2 ft
Awning? Yes <input type="checkbox"/> No <input type="checkbox"/>	Sq. ft. area of awning w/communication: _____

left message on
4-H-06 for
Applicant to Call
More info required

A site sketch and building sketch showing exactly where existing and new signage is located must be provided. Sketches and/or pictures of proposed signage and existing building are also required.

Please submit all of the information outlined in the Sign/Awning Application Checklist. Failure to do so may result in the automatic denial of your permit.

In order to be sure the City fully understands the full scope of the project, the Planning and Development Department may request additional information prior to the issuance of a permit. For further information visit us on-line at www.portlandmaine.gov, stop by the Building Inspections office, room 315 City Hall or call 874-8703.

I hereby certify that I am the Owner of record of the named property, or that the owner of record authorizes the proposed work and that I have been authorized by the owner to make this application as his/her authorized agent. I agree to conform to all applicable laws of this jurisdiction. In addition, if a permit for work described in this application is issued, I certify that the Code Official's authorized representative shall have the authority to enter all areas covered by this permit at any reasonable hour to enforce the provisions of the codes applicable to this permit.

Signature of applicant:  Date: 4/1/06

This is not a permit; you may not commence ANY work until the permit is issued.

CORNERSTONE

Title and Settlement

April 1, 2006

To Whom It May Concern:

My name is Julie Armstrong and I am the owner of both 1438 Washington Avenue and Cornerstone Title & Settlement Co., Inc., the subject(s) of this application and request for permission for signage.

I not only permit this signage to be placed on this property, but request your approval for same.

I am attaching for your reference and review, the Permit Application, a sketch of the signs, and a sketch plan of the lot.

Please let me know if you require further documentation or assistance. I may be contacted as indicated below.

Best Regards,

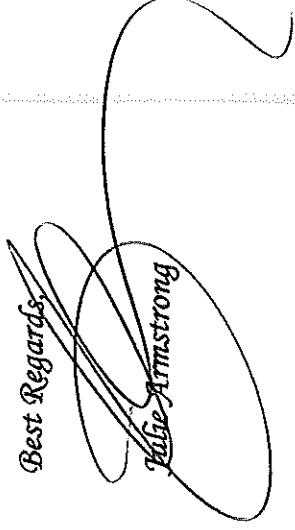

Julie Armstrong

PS> You will also find enclosed herewith, my check for \$43.00 representing the fee for the application (\$30.00) plus \$9.00 per additional \$1,000.00 of work (\$18.00) for the estimated \$2,000.00 of signage and labor.

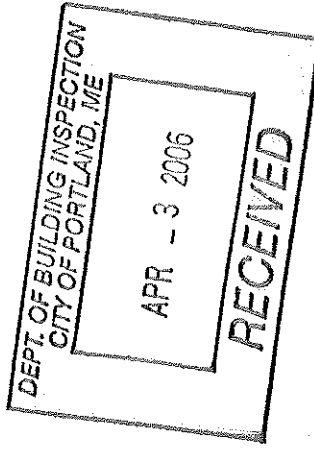



Signage/Awning Permit Application Checklist

All of the following information is required and must be submitted. Checking off each item as you prepare your application package will ensure your package is complete and will help to expedite the permitting process.

- NA Certificate of Liability listing the City as additional insured if any portion of the sign abuts or encroaches on any public right of way, or can fall into any public right of way.
- Letter of permission from the owner indicating the permissions granted and the tenant/space building frontage.
- A sketch plan of lot indicating location of buildings, driveways and any abutting streets or rights of way, lengths of building frontages, street frontages and all existing setbacks. Please indicate on the plan all existing and proposed signs with their dimensions and specific locations. Be sure to include distance from the ground and building façade dimensions for any signage attached to the building.
- A sketch or photo of any proposed sign(s) indicating content, dimensions, materials, source of illumination, construction method as well as specifics of installation/attachment.
- NA Certificate of flammability required for awning or canopy.
- NA A UL# is required for lighted signs at the time of final inspection.
- NA Pre-application questionnaire completed and attached.
- Photos of existing signage
- Details for sign fastening, attachment or mounting in the ground.

Permit fee for signage or awning-with-signage: \$30.00 plus \$2.00 per square foot of sign.

Permit fee for awning-without-signage is based on cost of work: \$30.00 for the first \$1,000.00, \$9.00 per additional \$1,000.00 of cost.

Base application fee for any Historic District signage is \$65.00.

SIGN #1

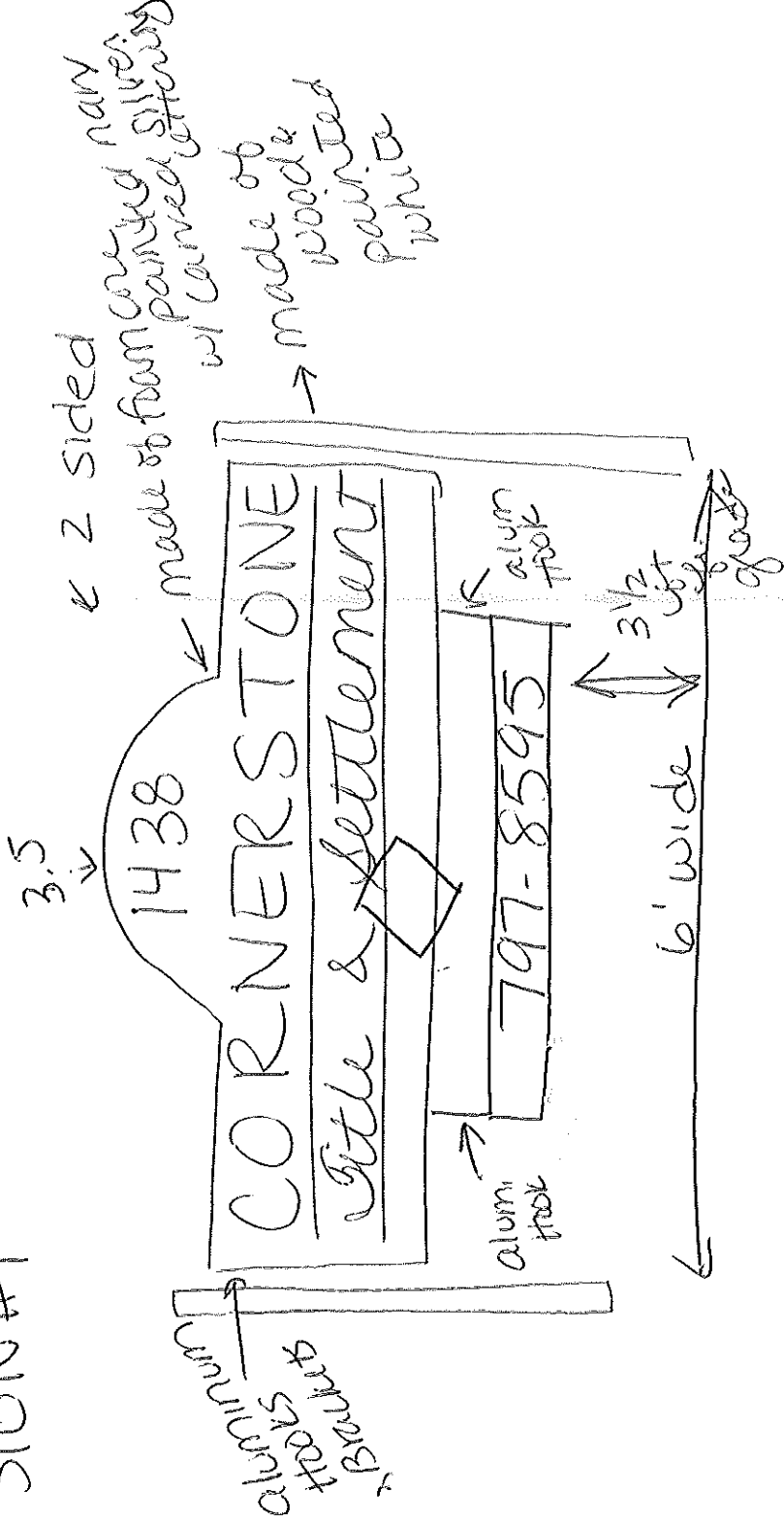

SIGN #2

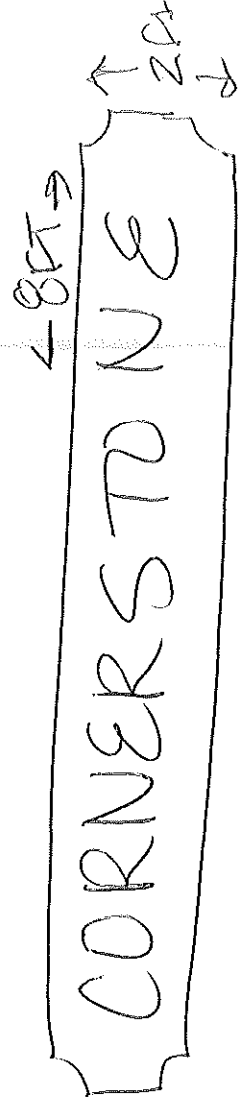

Made of foam painted + carved letters

To be attached directly to Bldg over front door.

Att: Andy

- * Posts mounted in cement underground w/ head shields
 - * House sign connected w/ fasteners: L Brackets 2 3/4" long.
- 77 that screw together & to the house & fit into 2 1/2" hole over door.

Descriptor/Area

A: A/1SFR/B
1008 sqft

B: EFP
60 sqft

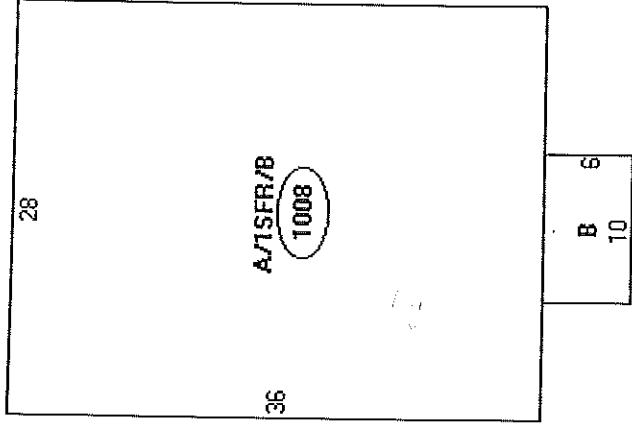

Building