

City of Portland, Maine - Building or Use Permit Application

389 Congress Street, 04101 Tel: (207) 874-8703, Fax: (207) 874-8716

Permit No	05-0256
Case No	344 D008001

Location of Construction:	40 Pennell Ave	Owner Name:	Prentiss Lisa	Owner Address:	40 Pennell Ave	City of Portland Address:	CITY OF PORTLAND
Business Name:		Contractor Name:	self	Contractor Address:	Portland		

Lessee/Buyer's Name	Phone:	Permit Type:	Additions - Dwellings	Zone:	RS
---------------------	--------	--------------	-----------------------	-------	----

Past Use:	Single Family	Proposed Use:	Single Family w/12' x 17' one story addition, 5' x 12' covered porch & 12' x 20' deck	Permit Fee:	\$201.00	Cost of Work:	\$20,000.00	CEO District:	5
Proposed Project Description:	Build a 12' x 17' one story addition, 5' x 12' covered porch & 12' x 20' deck			FIRE DEPT:	<input type="checkbox"/> Approved <input type="checkbox"/> Denied	INSPECTION:	Use Group: R3 Type: SB		

Signature:	<i>[Signature]</i>	Date:	3/16/05
Action:	<input type="checkbox"/> Approved <input type="checkbox"/> Approved w/Conditions <input type="checkbox"/> Denied	Signature:	<i>[Signature]</i>

Permit Taken By:	jmb	Date Applied for:	03/16/2005
------------------	-----	-------------------	------------

- This permit application does not preclude the Applicant(s) from meeting applicable State and Federal Rules.
- Building permits do not include plumbing, septic or electrical work.
- Building permits are void if work is not started within six (6) months of the date of issuance. False information may invalidate a building permit and stop all work..

Special Zone or Reviews		Zoning Appeal		Historic Preservation	
<input type="checkbox"/> Shoreland	<input type="checkbox"/> Wetland	<input type="checkbox"/> Flood Zone	<input type="checkbox"/> Subdivision	<input type="checkbox"/> Variance	<input type="checkbox"/> Miscellaneous
<input type="checkbox"/> Site Plan	<input type="checkbox"/> Mai <input type="checkbox"/> Minor <input type="checkbox"/> MM	<input type="checkbox"/> Conditional Use	<input type="checkbox"/> Interpretation	<input checked="" type="checkbox"/> Not in District or Landmark	<input type="checkbox"/> Does Not Require Review
<input type="checkbox"/> Denied	<input type="checkbox"/> Approved	<input type="checkbox"/> Approved	<input type="checkbox"/> Denied	<input type="checkbox"/> Requires Review	<input type="checkbox"/> Approved
<input type="checkbox"/> Denied	<input type="checkbox"/> Approved w/Conditions	<input type="checkbox"/> Approved	<input type="checkbox"/> Denied	<input type="checkbox"/> Approved w/Conditions	<input type="checkbox"/> Approved

CERTIFICATION

I hereby certify that I am the owner of record of the named property, or that the proposed work is authorized by the owner of record and that I have been authorized by the owner to make this application as his authorized agent and I agree to conform to all applicable laws of this jurisdiction. In addition, if a permit for work described in the application is issued, I certify that the code official's authorized representative shall have the authority to enter all areas covered by such permit at any reasonable hour to enforce the provision of the code(s) applicable to such permit.

SIGNATURE OF APPLICANT	ADDRESS	DATE	PHONE
------------------------	---------	------	-------

RESPONSIBLE PERSON IN CHARGE OF WORK, TITLE	DATE	PHONE
---	------	-------

DISPLAY THIS CARD ON PRINCIPAL FRONTAGE PERMITS

CITY OF PORTLAND

BUILDING INSPECTION

PERMIT

MAR 19 2005
 Permit Number: 050256
CITY OF PORTLAND

Please Read Application And Notes, if Any, Attached

This is to certify that Prenhiss Lisa/self

has permission to Build a 12' x 17' one story addition, 5' x 12' covered porch & 12' x 20' deck

AT 40 Pennell Ave

CBL 344 D008001

provided that the person or persons, firm or corporation accepting this permit shall comply with all of the provisions of the Statutes of Maine and of the Ordinances of the City of Portland regulating the construction, maintenance and use of buildings and structures, and of the application on file in this department.

Apply to Public Works for street line and grade if nature of work requires such information.

Notification of inspection must be given and written permission procured before this building or part thereof is lained or otherwise closed-in. 24 HOUR NOTICE IS REQUIRED.

A certificate of occupancy must be procured by owner before this building or part thereof is occupied.

OTHER REQUIRED APPROVALS

Fire Dept _____

Health Dept _____

Appeal Board _____

Other _____

Department Name

PENALTY FOR REMOVING THIS CARD

David Banker
 Director - Building & Inspection Services
 3/16/05

City of Portland, Maine - Building or Use Permit

389 Congress Street, 04101 Tel: (207) 874-8703, Fax: (207) 874-8716

Permit No:	05-0256	Date Applied For:	03/16/2005	CBL:	344 D008001
------------	---------	-------------------	------------	------	-------------

Location of Construction: 40 Pennell Ave	Owner Name: Prentiss Lisa	Owner Address: 40 Pennell Ave	Phone: () 653-2311
Business Name:	Contractor Name: self	Contractor Address: Portland	Phone
Lessee/Buyer's Name	Phone:	Permit Type: Additions - Dwellings	

Proposed Use: Single Family w/12' x 17' one story addition, 5' x 12' covered porch & 12' x 20' deck	Proposed Project Description: Build a 12' x 17' one story addition, 5' x 12' covered porch & 12' x 20' deck
--	--

Dept: Zoning Status: Approved Reviewer: Jeanine Bourke Approval Date: 03/16/2005
 Note: Ok to Issue:

Dept: Building Status: Approved with Conditions Reviewer: Jeanine Bourke Approval Date: 03/16/2005
 Note: Ok to Issue:

- 1) Permit approved based on the plans submitted and reviewed w/owner/contractor, with additional information as agreed on and as noted on plans.
- 2) Separate permits are required for any electrical, plumbing, or heating.

All Purpose Building Permit Application

If you or the property owner owes real estate or personal property taxes or user charges on any property within the City, payment arrangements must be made before permits of any kind are accepted.

Location/Address of Construction: <u>40 PENNELL AVE, PORTLAND ME</u>	
Total Square Footage of Proposed Structure <u>264 SQ. FT. ADDITIONAL \$250 SQ. FT. DECK</u>	Square Footage of Lot <u>15,000</u>
Tax Assessor's Chart, Block & Lot Chart# <u>344</u> Block# <u>D</u> Lot# <u>8-9-10</u>	Owner: <u>JAMESO PARENTS</u> <u>LISA PARENTS</u>
Lessee/Buyer's Name (if Applicable)	Applicant name, address & telephone: <u>JAMESO PARENTS</u> <u>40 PENNELL AVE</u> <u>PORTLAND ME 04103</u>
Current use: <u>EMPTY / CELLAR</u>	Cost Of Work: \$ <u>29,000</u> Fee: \$ <u>201.00</u>
If the location is currently vacant, what was prior use: _____	
Approximately how long has it been vacant: _____	
Proposed use: <u>BATH, ENTRY, PANTRY, 3/4 BATH AND STAIR</u>	
Project description: <u>1 STAIR ADDITIONAL WITH 12x20' DECK</u>	
Contractor's name, address & telephone: <u>DWYER G.C.</u>	
Who should we contact when the permit is ready: <u>JAMESO PARENTS</u>	
Mailing address: <u>40 PENNELL AVE. PORTLAND, ME 04103</u>	
We will contact you by phone when the permit is ready. You must come in and pick up the permit and review the requirements before starting any work, with a Plan Reviewer. A stop work order will be issued and a \$100.00 fee if any work starts before the permit is picked up. PHONE: <u>653-2311</u>	

IF THE REQUIRED INFORMATION IS NOT INCLUDED IN THE SUBMISSIONS THE PERMIT WILL BE AUTOMATICALLY DENIED AT THE DISCRETION OF THE BUILDING/PLANNING DEPARTMENT, WE MAY REQUIRE ADDITIONAL INFORMATION IN ORDER TO APPROVE THIS PERMIT.

I hereby certify that I am the Owner of record of the named property, or that the owner of record authorizes the proposed work and that I have been authorized by the owner to make this application as his/her authorized agent. I agree to conform to all applicable laws of this jurisdiction. In addition, if a permit for work described in this application is issued, I certify that the Code Official's authorized representative shall have the authority to enter all areas covered by this permit at any reasonable hour to enforce the provisions of the codes applicable to this permit.

Signature of applicant:  Date: MARCH 16, 05

This is NOT a permit, you may not commence ANY work until the permit is issued.
If you are in a Historic District you may be subject to additional permitting and fees with the Planning Department on the 4th floor of City Hall

This page contains a detailed description of the Parcel ID you selected. Press the **New Search** button at the bottom of the screen to submit a new query.

Current Owner Information

Card Number
Parcel ID
Location
Land Use

1 of 1
344 D008001
40 PENNELL AVE
SINGLE FAMILY

RS

Owner Address

PRENTISS LISA
40 PENNELL AVE
PORTLAND ME 04103

315 Gerald

Book/Page
Legal

NCFY04/
344-D-6-5-10
PENNELL AVE 34-46

Valuation Information

Land
\$38,330

Building
\$74,020

Total
\$112,350

05-0256

Property Information

Year Built
1910

Style
Gambrel

Story Height
2

Sq. Ft.
1248

Total Acres
0.344

Bedrooms
3

Full Baths
1

Half Baths

Total Rooms
7

Attic
None

Basement
Full

Outbuildings

Type
GARAGE-WD/CB

Quantity
1

Year Built
1915

Size
19X20

Grade
C

Condition
G

Sales Information

Date
02/08/1999
02/03/1999
08/19/1993

Type
LAND + BLDING
LAND + BLDING
LAND + BLDING

Price
\$120,000
\$101,000

Book/Page
14525-141
14523-047
109103-273

Picture and Sketch

[Picture](#)

[Sketch](#)

[Tax Map](#)

[Click here to view Tax Roll Information.](#)
Any information concerning tax payments should be directed to the Treasury office at 874-8490 or e-
[mailed.](#)

New Search!

PLUMBING APPLICATION

PROPERTY ADDRESS

Town or Plantation: PORTLAND
 Street: 40 PENNELL AVE.
 Subdivision Lot #: _____
PROPERTY OWNERS NAME
 Last: PRENTISS First: LISA JAMES
 Applicant Name: JAMES PRENTISS
 Mailing Address of Owner/Applicant (If Different): 40 PENNELL AVE.

Owner/Applicant Statement

I certify that the information submitted is correct to the best of my knowledge and understanding that any falsification is reason for the Local Plumbing Inspectors to deny a Request.

Signature of Owner/Applicant: [Signature] Date: 4/1/05

Local Plumbing Inspector Signature

Date Approved

PORTLAND 2005-08/26
 Date Permit Issued: 4/1/05 PERMIT # 9343 TOWN COPY
 Local Plumbing Inspector Signature: [Signature] L.P.I. # 022144
 \$ 1214.00 FEE Double Fee
 \$ 344 D 008

Caution: Inspection Required

I have inspected the installation authorized above and found it to be in compliance with the Maine Plumbing Rules.

PERMIT INFORMATION

This Application is for:

- 1. NEW PLUMBING
- 2. RELOCATED PLUMBING

Type of Structure To Be Served:

- 1. SINGLE FAMILY DWELLING
- 2. MODULAR OR MOBILE HOME
- 3. MULTIPLE FAMILY DWELLING
- 4. OTHER - SPECIFY RELOCATION

Plumbing To Be Installed By:

- 1. MASTER PLUMBER
- 2. OIL BURNERMAN
- 3. MFG/D. HOUSING DEALER/MECHANIC
- 4. PUBLIC UTILITY EMPLOYEE
- 5. PROPERTY OWNER

LICENSE # _____

Hook-Up & Piping Relocation Maximum of 1 Hook-Up		Number	Column 2 Type of Fixture	Number	Column 1 Type of Fixture
HOOK-UP: to public sewer in those cases where the connection is not regulated and inspected by the local Sanitary District.					
OR					
HOOK-UP: to an existing subsurface wastewater disposal system.					
PIPING RELOCATION: of sanitary lines, drains, and piping without new fixtures.					
OR					
TRANSFER FEE (\$6.00)					
OR					
SEE PERMIT FEE SCHEDULE FOR CALCULATING FEE					
			Hosebibb / Sillcock		Bathub (and Shower)
			Floor Drain	0	Shower (Separate)
			Urinal		Sink
			Drinking Fountain	0	Wash Basin
			Indirect Waste	0	Water Closet (Toilet)
			Water Treatment Softener, Filter, etc.		Clothes Washer
			Grease / Oil Separator		Dish Washer
			Dental Cuspidor		Garbage Disposal
			Bidet		Laundry Tub
			Other: _____		Water Heater
			Fixtures (Subtotal) Column 2	3	Fixtures (Subtotal) Column 1
			Fixtures (Subtotal) Column 2		Fixtures (Subtotal) Column 1
			Total Fixtures	3	
			Fixture Fee		Fixture Fee
			Transfer Fee		Transfer Fee
			Hook Up & Relocation Fee		Hook Up & Relocation Fee
			Permit Fee		Permit Fee
			(Total)		(Total)

OFF TOWN COPY 34



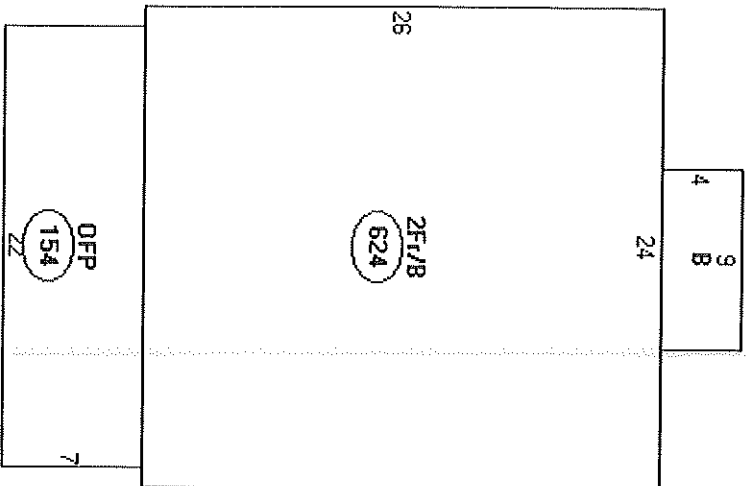

Descriptor/Area
 A: 2F1/B
 624 sqft
 B: EP
 36 sqft
 C: OFF
 154 sqft

814
 1104 Area
 12x17 = 204
 5x12 = 66
 12x20 = 240
 1104
 1918 SF
 350 Garage
 2298

OK

15000
 44010
 61000 SF

BUILDING PERMIT INSPECTION PROCEDURES

Please call 874-8703 or 874-8693 to schedule your **inspections as agreed upon**

Permits expire in 6 months, if the project is not started or ceases for 6 months.

The Owner or their designee is required to notify the inspections office for the following inspections and provide adequate notice. Notice must be called in 48-72 hours in advance in order to schedule an inspection:

By initializing at each inspection time, you are agreeing that you understand the inspection procedure and additional fees from a "Stop Work Order" and "Stop Work Order Release" will be incurred if the procedure is not followed as stated below.

A Pre-construction Meeting will take place upon receipt of your building permit.

Footing/Building Location Inspection: Prior to pouring concrete

Re-Bar Schedule Inspection: Prior to pouring concrete

Foundation Inspection: Prior to placing ANY backfill

Framing/Rough Plumbing/Electrical: Prior to any insulating or drywalling

Final Certificate of Occupancy: Prior to any occupancy of the structure or use. NOTE: There is a \$75.00 fee per inspection at this point.

Certificate of Occupancy is not required for certain projects. Your inspector can advise you if your project requires a Certificate of Occupancy. All projects DO require a final inspection

If any of the inspections do not occur, the project cannot go on to the next phase, REGARDLESS OF THE NOTICE OR CIRCUMSTANCES.

CERTIFICATE OF OCCUPANCIES MUST BE ISSUED AND PAID FOR, BEFORE THE SPACE MAY BE OCCUPIED

T. Brown
Signature of Applicant/Designee 3/16/05
Date 3/16/05

Seville Smith
Signature of Inspections Official 05-0256
Date 3/16/05

CBL: 344-D-8 Building Permit #: 05-0256