

**PERMIT ISSUED**

**City of Portland, Maine - Building or Use Permit Application**

389 Congress Street, 04101 Tel: (207) 874-8703, Fax: (207) 874-8716

|                       |                            |                     |
|-----------------------|----------------------------|---------------------|
| Permit No:<br>03-0394 | Issue Date:<br>MAY 02 2003 | CBL:<br>397 B003001 |
|-----------------------|----------------------------|---------------------|

Location of Construction: 737 Allen Ave  
 Business Name: Curdis Diane S &  
 Lessee/Buyer's Name: Applicant  
 Contractor Name: Applicant  
 Phone:

Owner Address: 737 Allen Ave Ext  
 Contractor Address: Portland  
 Permit Type: Additions - Dwellings  
 Zone: R3  
 Phone: 797-9782

Past Use: Single Family  
 Proposed Use: Single Family

Permit Fee: \$30.00  
 Cost of Work: \$1,000.00  
 CEO District: 2  
 FIRE DEPT:  Approved  Denied  
 INSPECTION: Use Group: B-3 Type: SB  
 Signature: [Signature] Date: [Date]

Proposed Project Description:  
 Constructed 10' x 20' Deck

Signature: [Signature] Date: [Date]  
 PEDESTRIAN ACTIVITIES DISTRICT (P.A.D.)  
 Action:  Approved  Approved w/Conditions  Denied  
 Signature: [Signature] Date: [Date]

Permit Taken By: gad Date Applied For: 04/23/2003  
**Zoning Approval**

- This permit application does not preclude the Applicant(s) from meeting applicable State and Federal Rules.
- Building permits do not include plumbing, septic or electrical work.
- Building permits are void if work is not started within six (6) months of the date of issuance. False information may invalidate a building permit and stop all work..

**PERMIT ISSUED**  
 MAY 02 2003  
 CITY OF PORTLAND

| Special Zone or Reviews   | Zoning Appeal  | Historic Preservation   |
|---|--|---|
| <input type="checkbox"/> Shoreland<br><input type="checkbox"/> Wetland<br><input type="checkbox"/> Flood Zone<br><input type="checkbox"/> Subdivision<br><input type="checkbox"/> Site Plan<br>Maj <input type="checkbox"/> Minor <input type="checkbox"/> MM <input type="checkbox"/><br>Date: | <input type="checkbox"/> Variance<br><input type="checkbox"/> Miscellaneous<br><input type="checkbox"/> Conditional Use<br><input type="checkbox"/> Interpenation<br><input type="checkbox"/> Approved<br><input type="checkbox"/> Denied<br>Date: | <input type="checkbox"/> Not in District or Landmark<br><input type="checkbox"/> Does Not Require Review<br><input type="checkbox"/> Requires Review<br><input type="checkbox"/> Approved<br><input type="checkbox"/> Approved w/Conditions<br><input type="checkbox"/> Denied<br>Date: |

**CERTIFICATION**

I hereby certify that I am the owner of record of the named property, or that the proposed work is authorized by the owner of record and that I have been authorized by the owner to make this application as his authorized agent and I agree to conform to all applicable laws of this jurisdiction. In addition, if a permit for work described in the application is issued, I certify that the code official's authorized representative shall have the authority to enter all areas covered by such permit at any reasonable hour to enforce the provision of the code(s) applicable to such permit.

SIGNATURE OF APPLICANT \_\_\_\_\_ ADDRESS \_\_\_\_\_ DATE \_\_\_\_\_ PHONE \_\_\_\_\_

RESPONSIBLE PERSON IN CHARGE OF WORK TITLE \_\_\_\_\_ DATE \_\_\_\_\_ PHONE \_\_\_\_\_

# BUILDING PERMIT INSPECTION PROCEDURES

Please call 874-8703 or 874-8693 to schedule your inspections as agreed upon

Permits expire in 6 months, if the project is not started or ceases for 6 months.

The Owner or their designee is required to notify the inspections office for the following inspections and provide adequate notice. Notice must be called in 48-72 hours in advance in order to schedule an inspection.

By initializing at each inspection time, you are agreeing that you understand the inspection procedure and additional fees from a "Stop Work Order" and "Stop Work Order Release" will be incurred if the procedure is not followed as stated below.

Pre-construction Meeting: Must be scheduled with your inspection team upon receipt of this permit. Jay Reynolds, Development Review Coordinator at 874-8632 must also be contacted at this time, before any site work begins on any project other than single family additions or alterations.

Footing/Building Location Inspection: Prior to pouring concrete

Re-Bar Schedule Inspection: Prior to pouring concrete

Foundation Inspection: Prior to placing ANY backfill

Framing/Rough Plumbing/Electrical: Prior to any insulating or drywalling

Final/Certificate of Occupancy: Prior to any occupancy of the structure or use. NOTE: There is a \$75.00 fee per inspection at this point.

Certificate of Occupancy is not required for certain projects. Your inspector can advise you if your project requires a Certificate of Occupancy. All projects DO require a final inspection

If any of the inspections do not occur, the project cannot go on to the next phase, REGARDLESS OF THE NOTICE OR CIRCUMSTANCES.

**CERTIFICATE OF OCCUPANCIES MUST BE ISSUED AND PAID FOR, BEFORE THE SPACE MAY BE OCCUPIED**

Signature of applicant/designee

Date

Signature of Inspections Official

Date

CBL: 397-B-3

Building Permit #:

030394

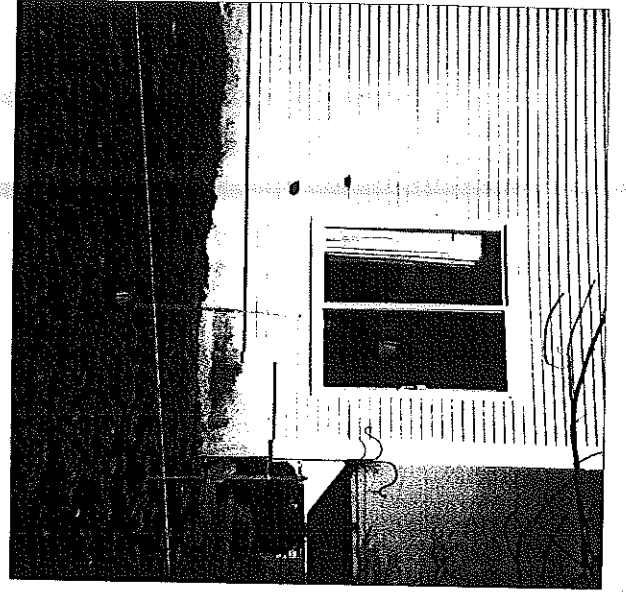

# DISPLAY THIS CARD ON PRINCIPAL FRONTAGE OF WORK

## CITY OF PORTLAND

### BUILDING INSPECTION

# PERMIT

Permit Number: 030394

Please Read Application And Notes, if Any, Attached

This is to certify that Curtis Diane S & Applicant has permission to Constructed 10' x 20' Deck

At 737 Allen Ave

397 B003001

provided that the person or persons, of the provisions of the Statutes of the construction, maintenance and use of this department.

Information or operation. Accepting this permit shall comply with all the provisions of the City of Portland regulating buildings and structures, and of the application on file in

Apply to Public Works for street line and grade if nature of work requires such information.

Inspection must be made and when this permit is closed-in, NOTICE IS REQUIRED.

A certificate of occupancy must be procured by owner before this building or part thereof is occupied.

#### OTHER REQUIRED APPROVALS

Fire Dept. PERMIT ISSUED

Health Dept. \_\_\_\_\_

Appeal Board MAY 02 2003

Department Name

**CITY OF PORTLAND**

**PENALTY FOR REMOVING THIS CARD**

Director, Building & Inspection Services

68-0294

# All Purpose Building Permit Application

If you or the property owner owes real estate or personal property taxes or user charges on any property within the City, payment arrangements must be made before permits of any kind are accepted.

|  |   |  |                      |
|--|---|--|----------------------|
| Location/Address of Construction: <u>737 Allen Ave</u>   |   | Square Footage of Lot: <u>8016</u>                       |                      |
| Total Square Footage of Proposed Structure: <u>200sq.</u>  |   | Square Footage of Lot: <u>8016</u>                       |                      |
| Tax Assessor's Chart, Block & Lot<br>Chart# <u>397-B-003-001</u> Block# <u>      </u> Lot# <u>      </u> | Owner:<br><u>Cecil K. Curtis</u>  | Diane E. Shimko-Curtis<br>Telephone: <u>907-797-9782</u> |                      |
| Lessee/Buyer's Name (if Applicable)  | Applicant's name, address & telephone:<br><u>Diane E. Shimko-Curtis</u><br><u>737 Allen Ave.</u><br><u>Portland, Me 04103</u>   | Cost of Work: \$ <u>1000</u>                             | Fee: \$ <u>30.00</u> |
| Current use: _____   | DEPT. OF BUILDING INSPECTION<br>CITY OF PORTLAND, ME<br>APR 23 2008   |  |                      |
| If the location is currently vacant, what was prior use: _____   | APPROXIMATELY HOW LONG HAS IT BEEN VACANT: _____  |  |                      |
| Proposed use: _____  | PROJECT DESCRIPTION:<br><u>Press. Treated Used/Partially assembled deck (2x4s)</u>  |  |                      |
| Contractor's name, address & telephone:  | Who should we contact when the permit is ready: <u>Cecil K. Curtis</u>  |  |                      |
|  | Mailing address: <u>737 Allen Ave.</u><br><u>Portland, Me.</u>  |  |                      |
|  | We will contact you by phone when the permit is ready. You must come in and pick up the permit and review the requirements before starting any work. With a Plan Reviewer. A stop work order will be issued and a \$100.00 fee if any work starts before the permit is picked up. PHONE: <u>797-9782009</u> |  |                      |

IF THE REQUIRED INFORMATION IS NOT INCLUDED IN THE SUBMISSIONS THE PERMIT WILL BE AUTOMATICALLY DENIED AT THE DISCRETION OF THE BUILDING/PLANNING DEPARTMENT, WE MAY REQUIRE ADDITIONAL INFORMATION IN ORDER TO APPROVE THIS PERMIT.

I hereby certify that I am the Owner of record of the named property, or that the owner of record authorizes the proposed work and that I have been authorized by the owner to make this application as his/her authorized agent. I agree to conform to all applicable laws of this jurisdiction. In addition, if a permit for work described in this application is issued, I certify that the Code Official's authorized representative shall have the authority to enter all areas covered by this permit at any reasonable hour to enforce the provisions of the codes applicable to this permit.

Signature of applicant: Cecil K. Curtis Date: 4/23/03

This is NOT a permit, you may not commence ANY work until the permit is issued. If you are in a Historic District you may be subject to additional permitting and fees with the Planning Department on the 4th floor of City Hall

## EXHIBIT A

A certain lot or parcel of land, with the buildings thereon, containing approximately eight thousand sixteen square feet (8,016 sq. ft.) situated in the City of Portland, County of Cumberland and State of Maine, located on the southeasterly side of Allen Avenue near the Falmouth town line and being more particularly bounded and described as follows:

Beginning at an iron pipe set in the ground set at the southeasterly sideline of Allen Avenue at the westerly corner of the lot herein conveyed; thence running North 55° 44' 30" East along said Allen Avenue one hundred forty-eight and seventy-seven hundredths (148.77') to a stone bound by the Falmouth town line; thence turning and running South 15° 42' 49" West by the Falmouth town line one hundred sixty-seven and fifty-eight hundredths feet (167.58') to an iron pipe set in the ground; thence turning and running North 45° 00' West by Lot #2, so-called, one hundred nine and seventy hundredths feet (109.70') to the iron pipe which is the point of beginning. Courses cited in this description are magnetic as observed in March of 1984.

Meaning and intending to convey Lot #3 as described in "Plan of Land in Portland, Maine owned by Philip J. Daniels, et al" dated December 4, 1984 as surveyed by Davis P. Wurts.

RECEIVED  
RECORDED REGISTRY OF DEEDS

1989 AUG 20 PM 2:02

CUMBERLAND COUNTY

*John B. O'Brien*

## EXHIBIT A

A certain lot or parcel of land, with the buildings thereon, containing approximately eight thousand sixteen square feet (8,016 sq. ft.) situated in the City of Portland, County of Cumberland and State of Maine, located on the southeasterly side of Allen Avenue near the Falmouth town line and being more particularly bounded and described as follows:

Beginning at an iron pipe set in the ground set at the southeasterly sideline of Allen Avenue at the westerly corner of the lot herein conveyed; thence running North 55° 44' 30" East along said Allen Avenue one hundred forty-eight and seventy-seven hundredths (148.77') to a stone bound by the Falmouth town line; thence turning and running South 15° 42' 49" West by the Falmouth town line one hundred sixty-seven and fifty-eight hundredths feet (167.58') to an iron pipe set in the ground; thence turning and running North 45° 00' West by Lot #2, so-called, one hundred nine and seventy hundredths feet (109.70') to the iron pipe which is the point of beginning. Courses cited in this description are magnetic as observed in March of 1984.

Meaning and intending to convey Lot #3 as described in "Plan of Land in Portland, Maine owned by Philip J. Daniels, et al" dated December 4, 1984 as surveyed by Davis P. Wurts.

RECEIVED  
RECORDER REGISTRY OF DEEDS

1998 AUG 20 PM 2: 02

CUMBERLAND COUNTY

*John B. O'Brien*

E  
FALMOUTH

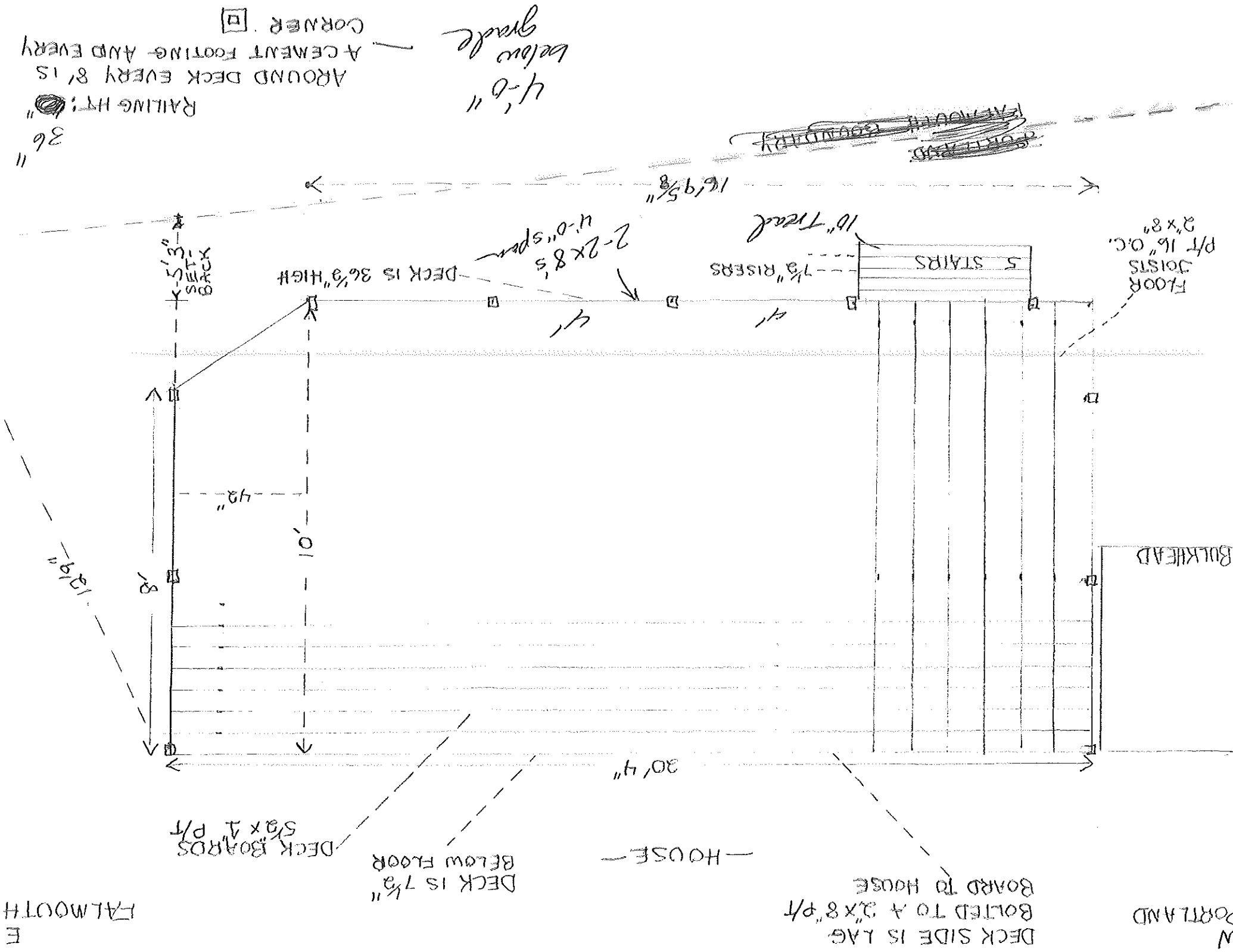

W  
PORTLAND

DECK SIDE IS LAG  
BOLTED TO A 2"x8" PT  
BOARD TO HOUSE

HOUSE

DECK IS 7 1/2"  
BELOW FLOOR

DECK BOARDS  
5"x1" PT

BULKHEAD

FLOOR  
JOISTS  
2"x8" O.C.

5 STAIRS

10" Tread  
7 1/2" RISERS

2-2x8's  
4" spc

DECK IS 36 3/4" HIGH

RAILING  
36" HT

16x5/8"

4'-0" below grade

AROUND DECK EVERY 8' IS  
CEMENT FOOTING AND EVERY  
CORNER

~~PORTLAND~~  
~~FALMOUTH~~  
~~BOUNDARY~~



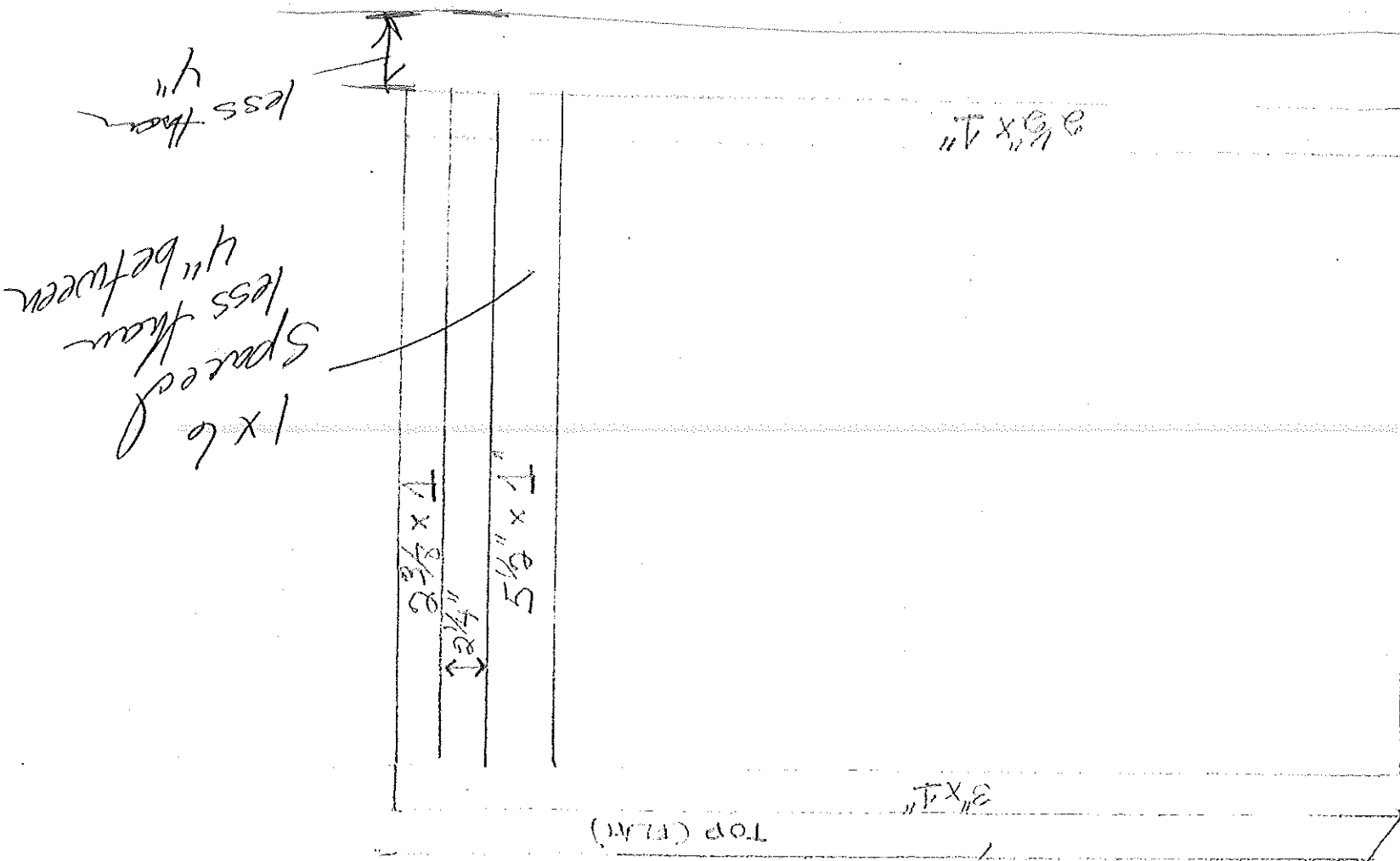

Railing HEIGHT: ~~36"~~  
 36"

2 3/4\" x 1"