

All dimensions, size designations given are subject to verification on job site and adjustment to fit job conditions.

This is an original design and must not be released or copied unless applicable fee has been paid or job order placed.

Designed: 2/2/2007
Printed: 2/2/2007

Danbury, CT 06810



Fp 1

Drawing #:

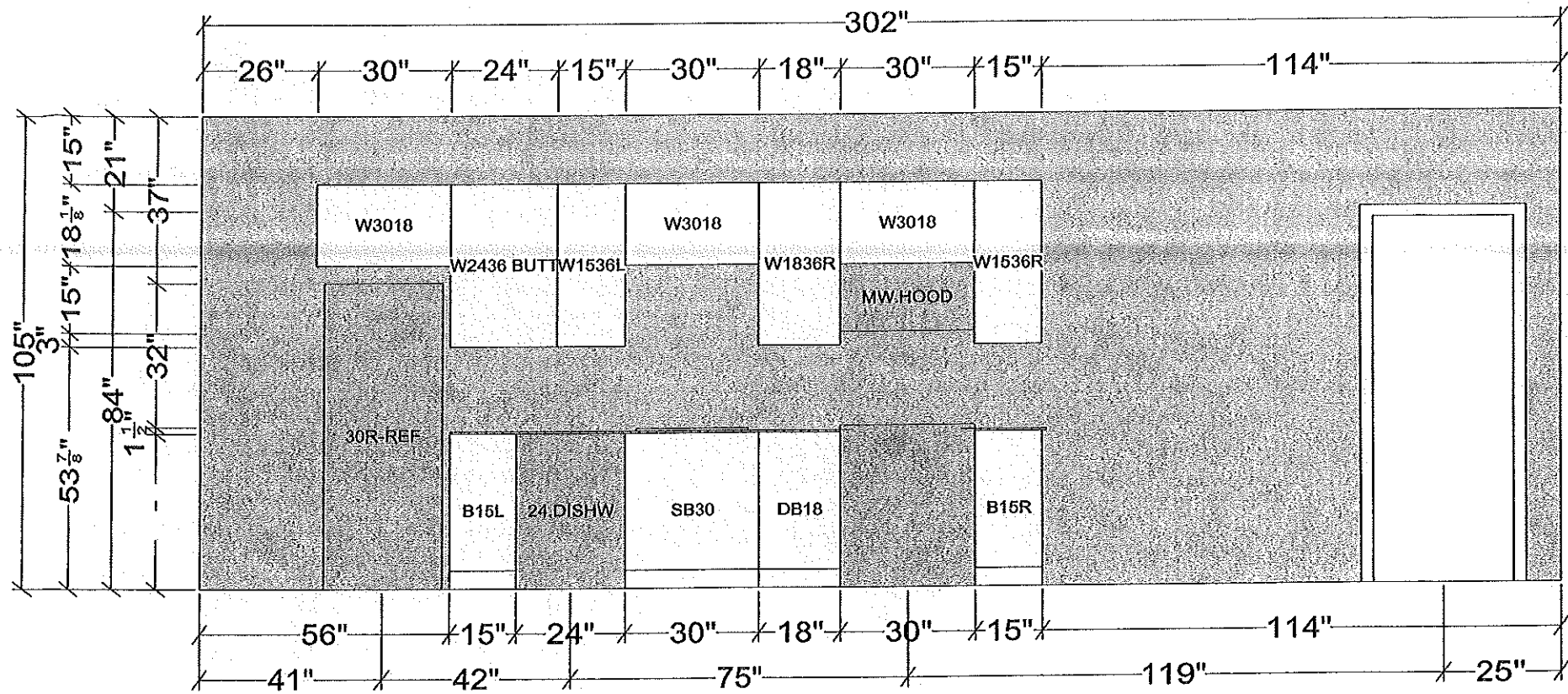

All dimensions size designations given are subject to verification on job site and adjustment to fit job conditions.



This is an original design and must not be released or copied unless applicable fee has been paid or job order placed.

Designed: 2/2/2007
Printed: 2/2/2007

Designed: 2/2/2007
Printed: 2/2/2007



Note: This drawing is an artistic interpretation of the general appearance of the design. It is not meant to be an exact rendition.

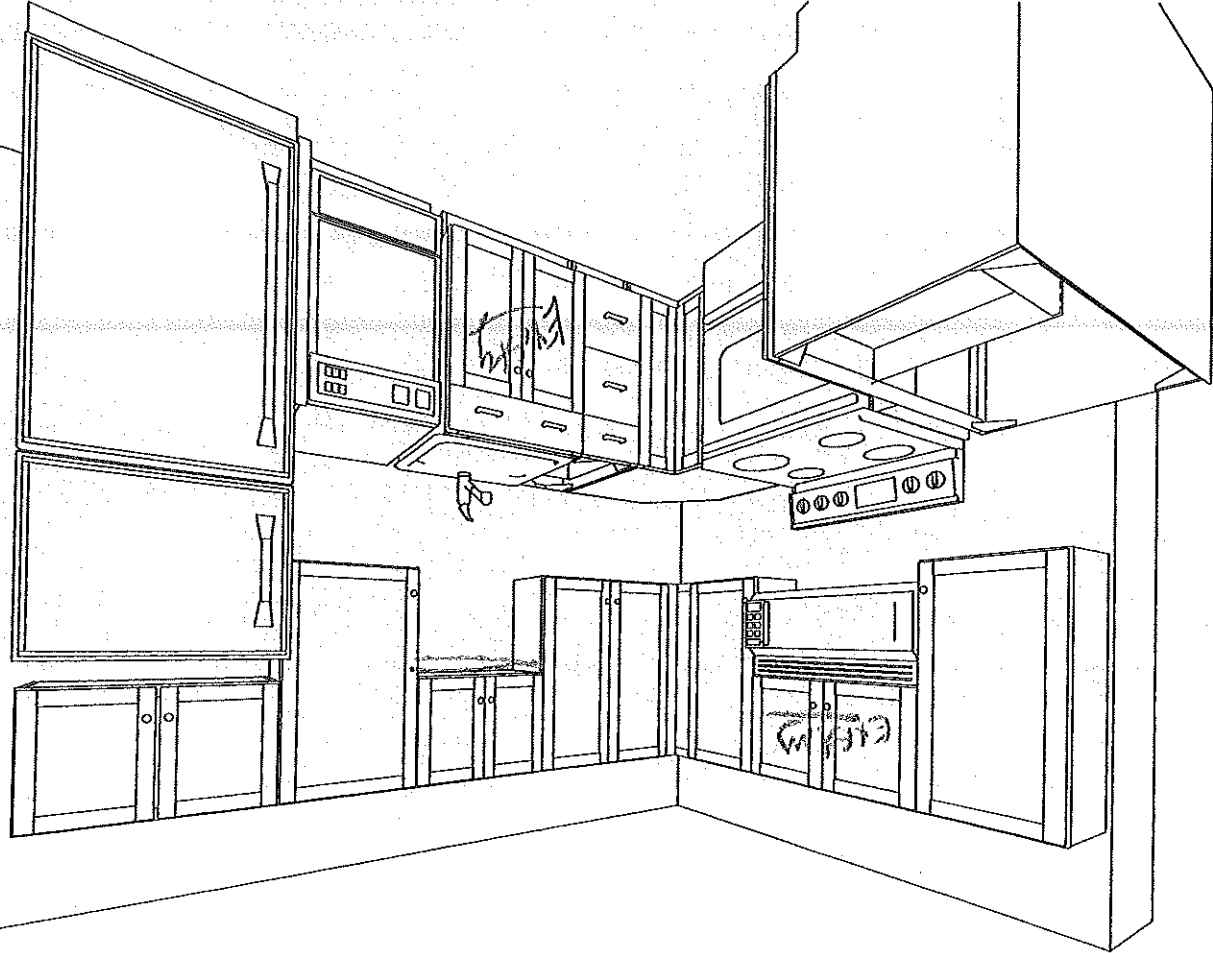

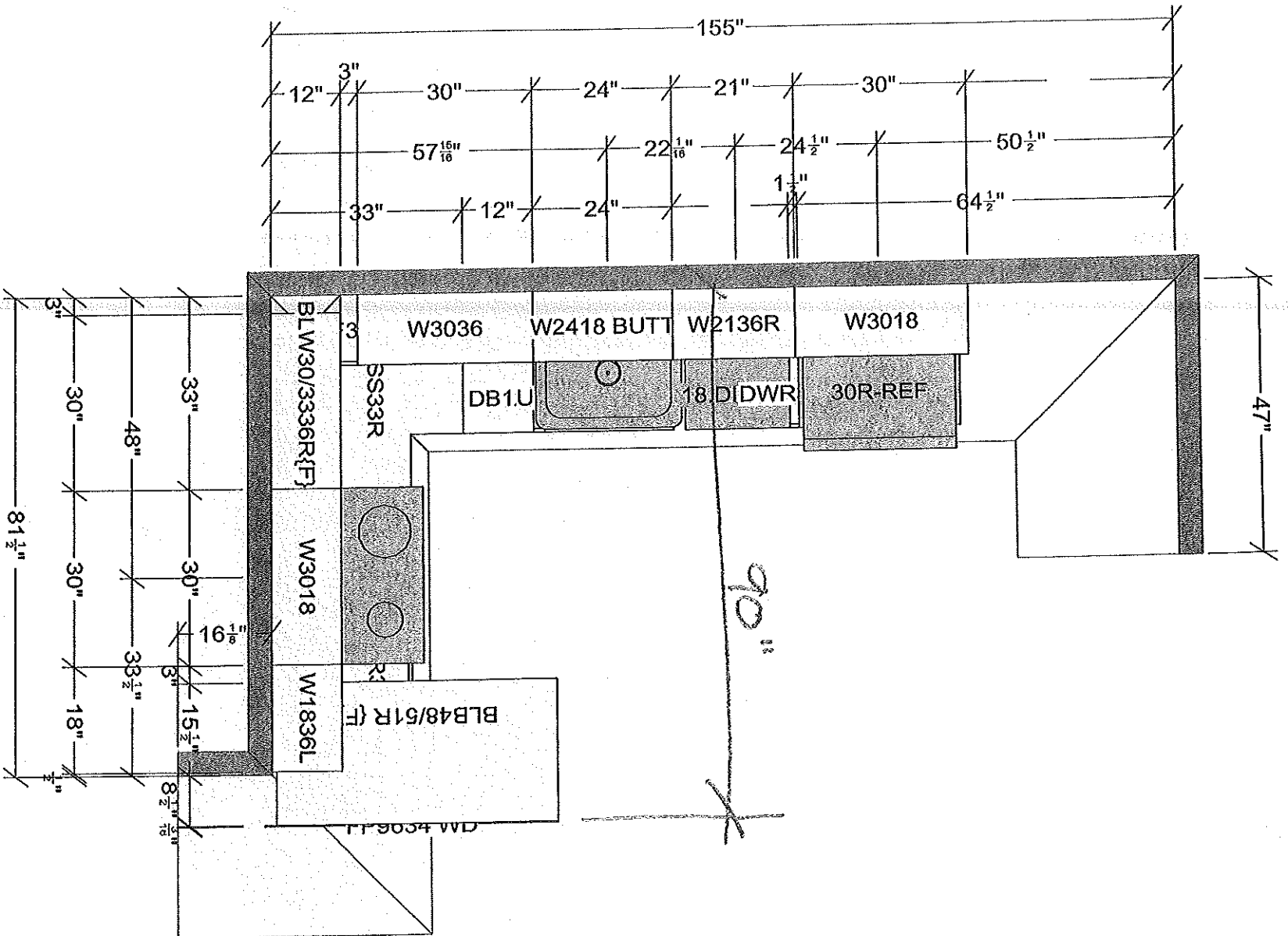

All dimensions, size designations given are subject to verification on job site and adjustment to fit job conditions.



This is an original design and must not be released or copied unless applicable fee has been paid or job order placed.

Designed: 2/2/2007
Printed: 2/2/2007

Danielle Reed-unit 4A-402161

ALL

Drawing #:

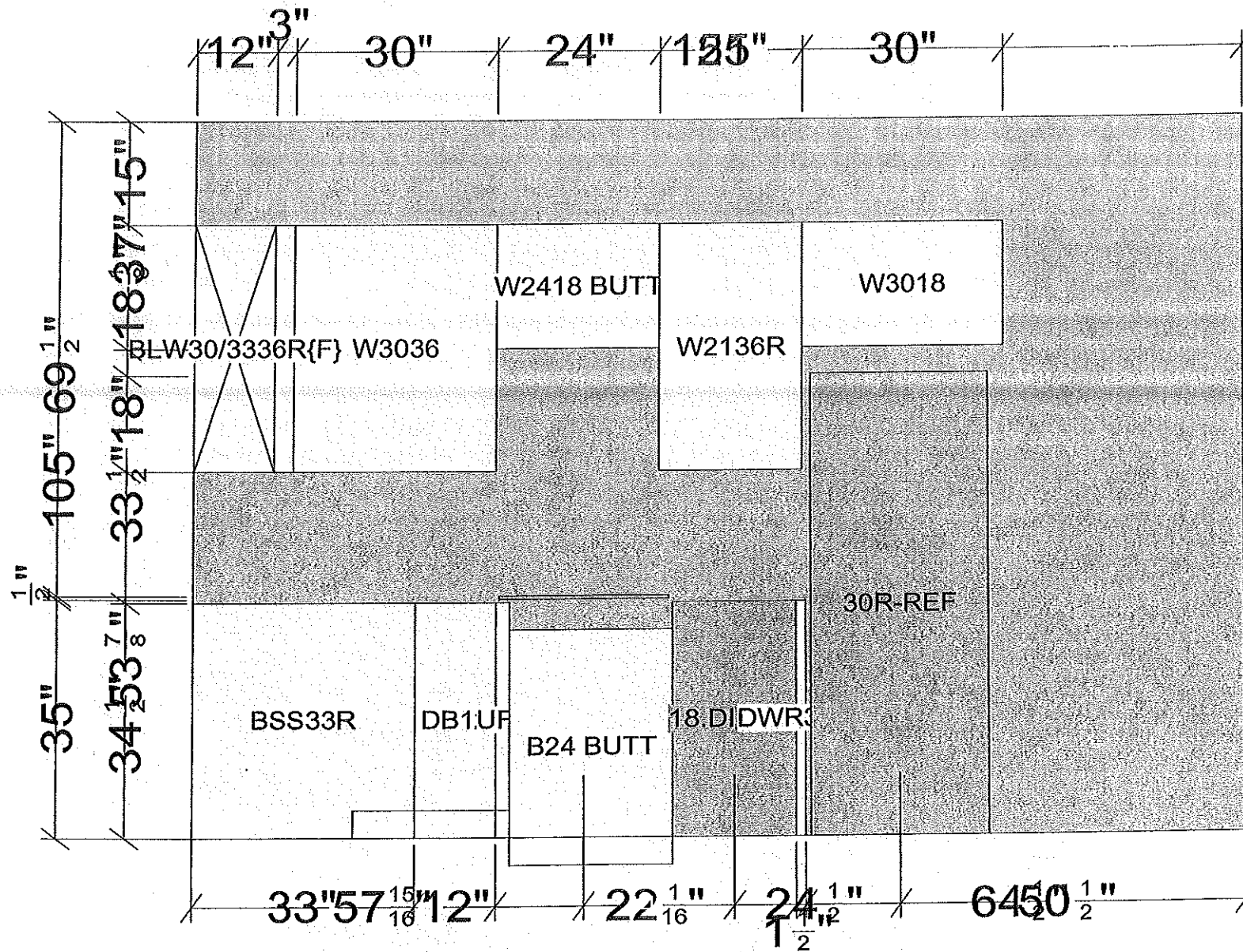

All dimensions - size designations given are subject to verification on job site and adjustment to fit job conditions.

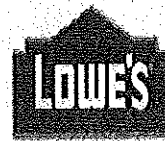

This is an original design and must not be released or copied unless applicable fee has been paid or job order placed.

Designed: 2/2/2007
Printed: 2/2/2007

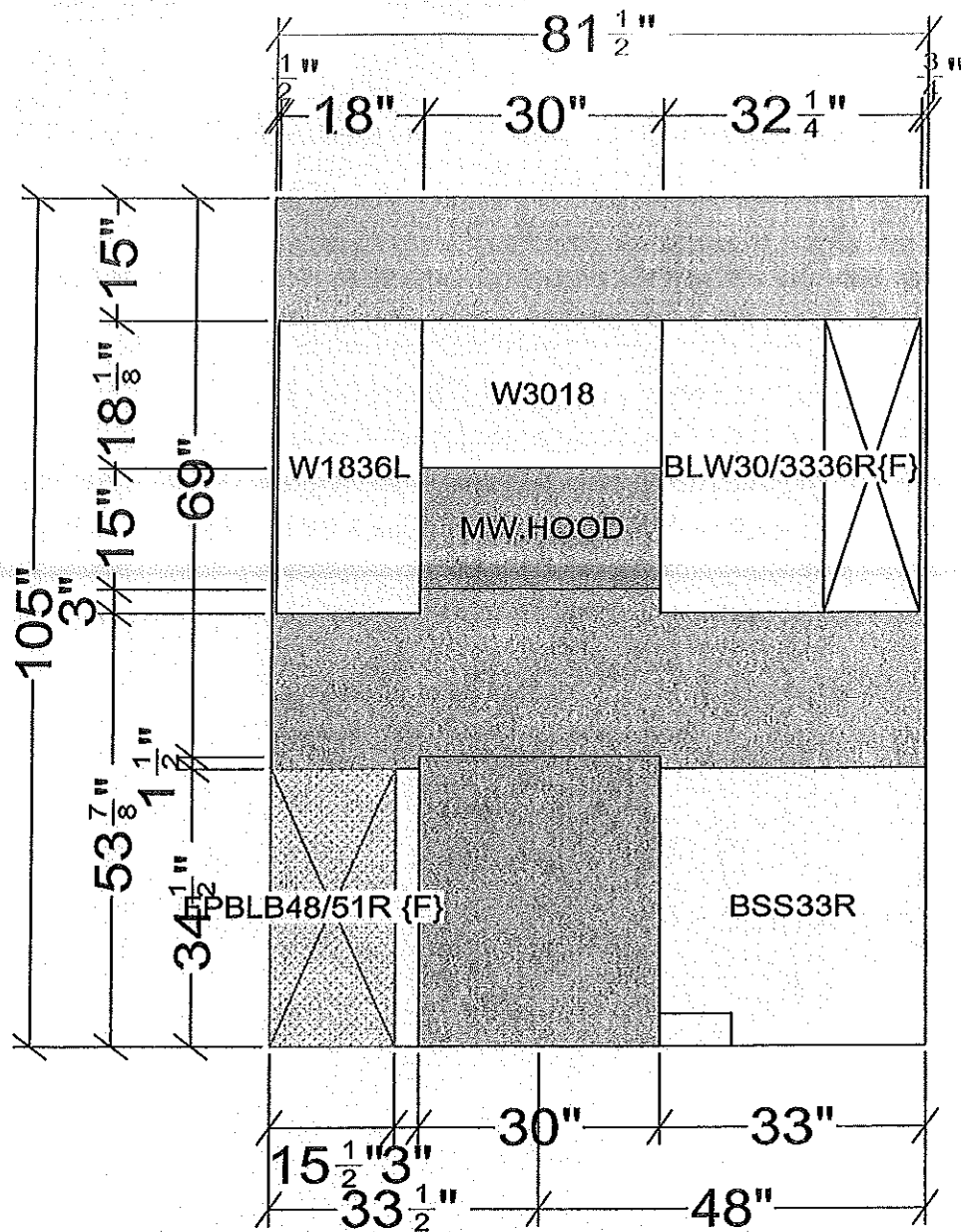

All dimensions size designations given are subject to verification on job site and adjustment to fit job conditions.



This is an original design and must not be released or copied unless applicable fee has been paid or job order placed.

Designed: 2/2/2007
Printed: 2/2/2007



Designed: 2/28/2007
Printed: 2/28/2007

Note: This drawing is an artistic interpretation of the general appearance of the design. It is not meant to be an exact rendition.

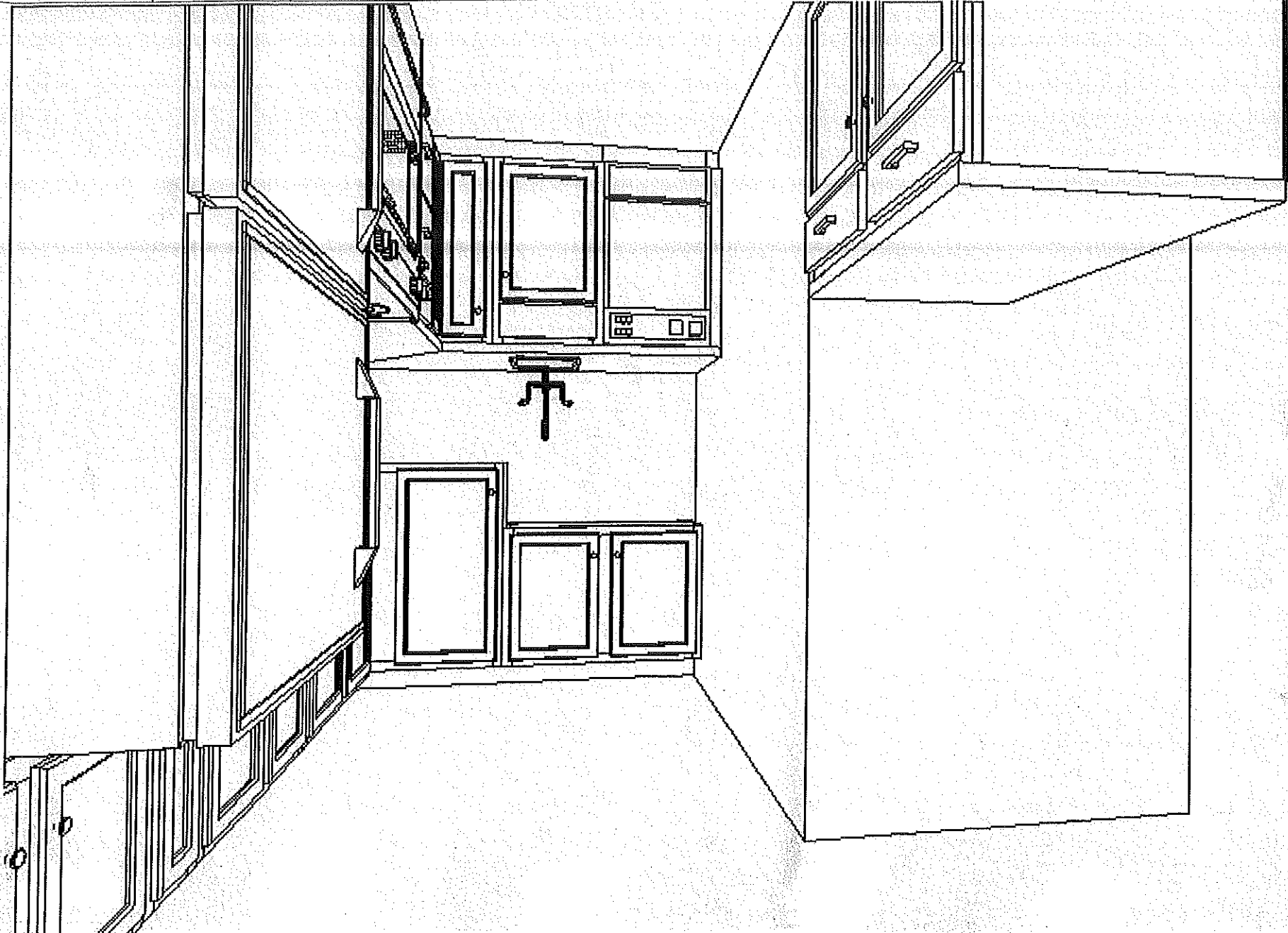



Designed: 2/28/2007
Printed: 2/28/2007

Note: This drawing is an artistic interpretation of the general appearance of the design. It is not meant to be an exact rendition.

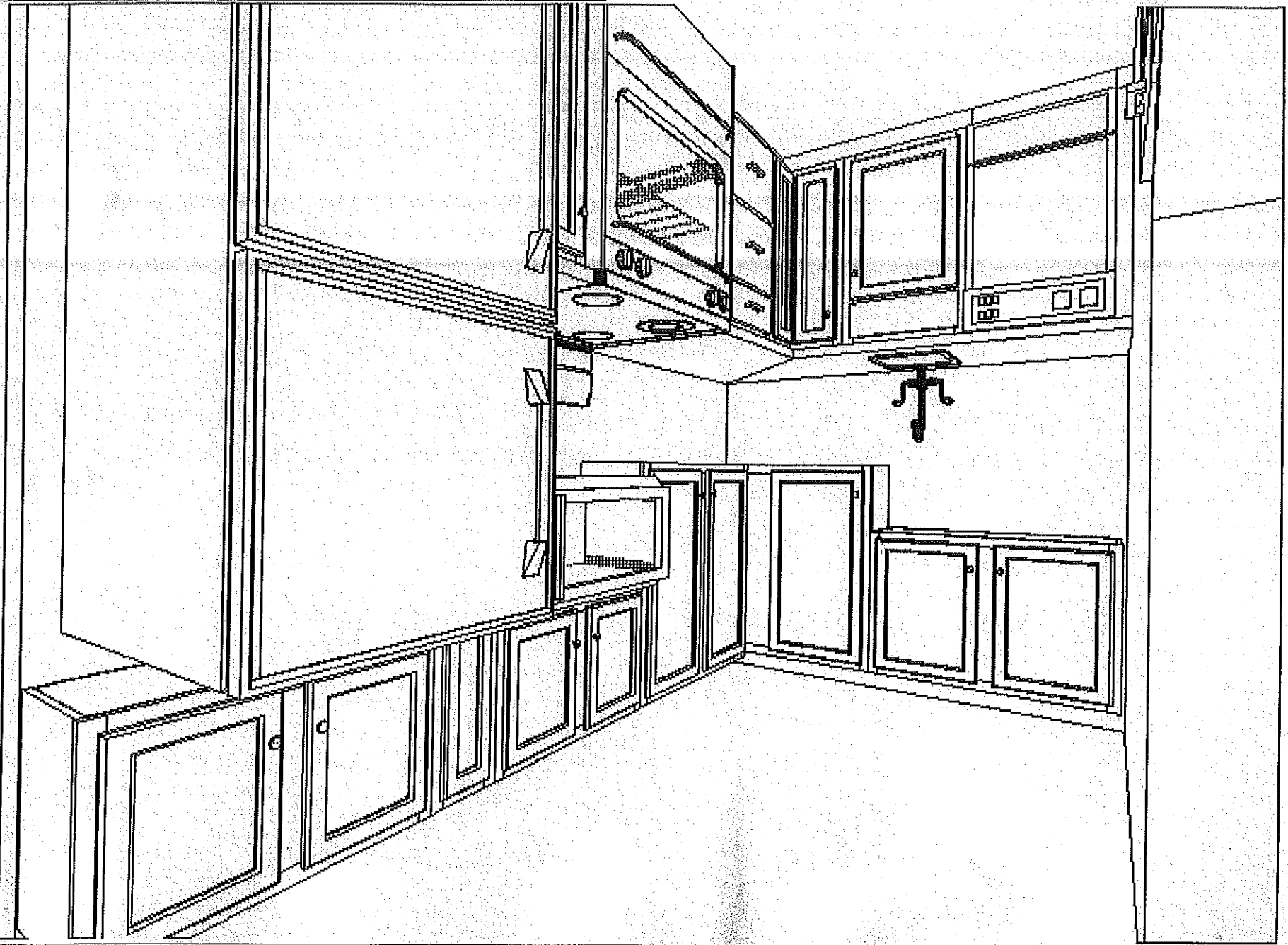

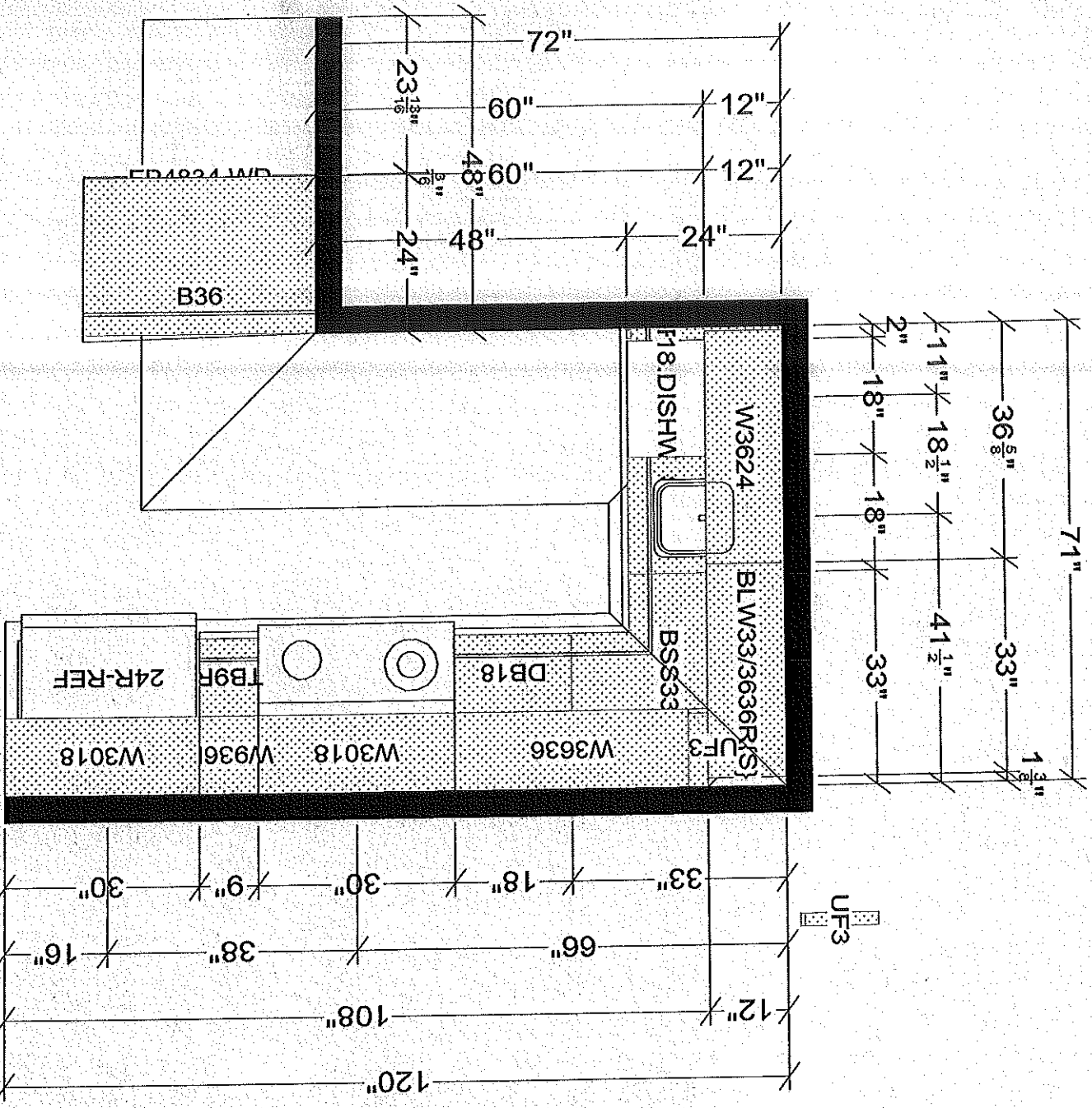

All dimensions, size designations given are subject to verification on job site and adjustment to fit job conditions.



This is an original design and must not be released or copied unless applicable fee has been paid or job order placed.

Designed: 1/10/2007
Printed: 2/28/2007



Designed: 2/28/2007
Printed: 2/28/2007

Note: This drawing is an artistic interpretation of the general appearance of the design. It is not meant to be an exact rendition.

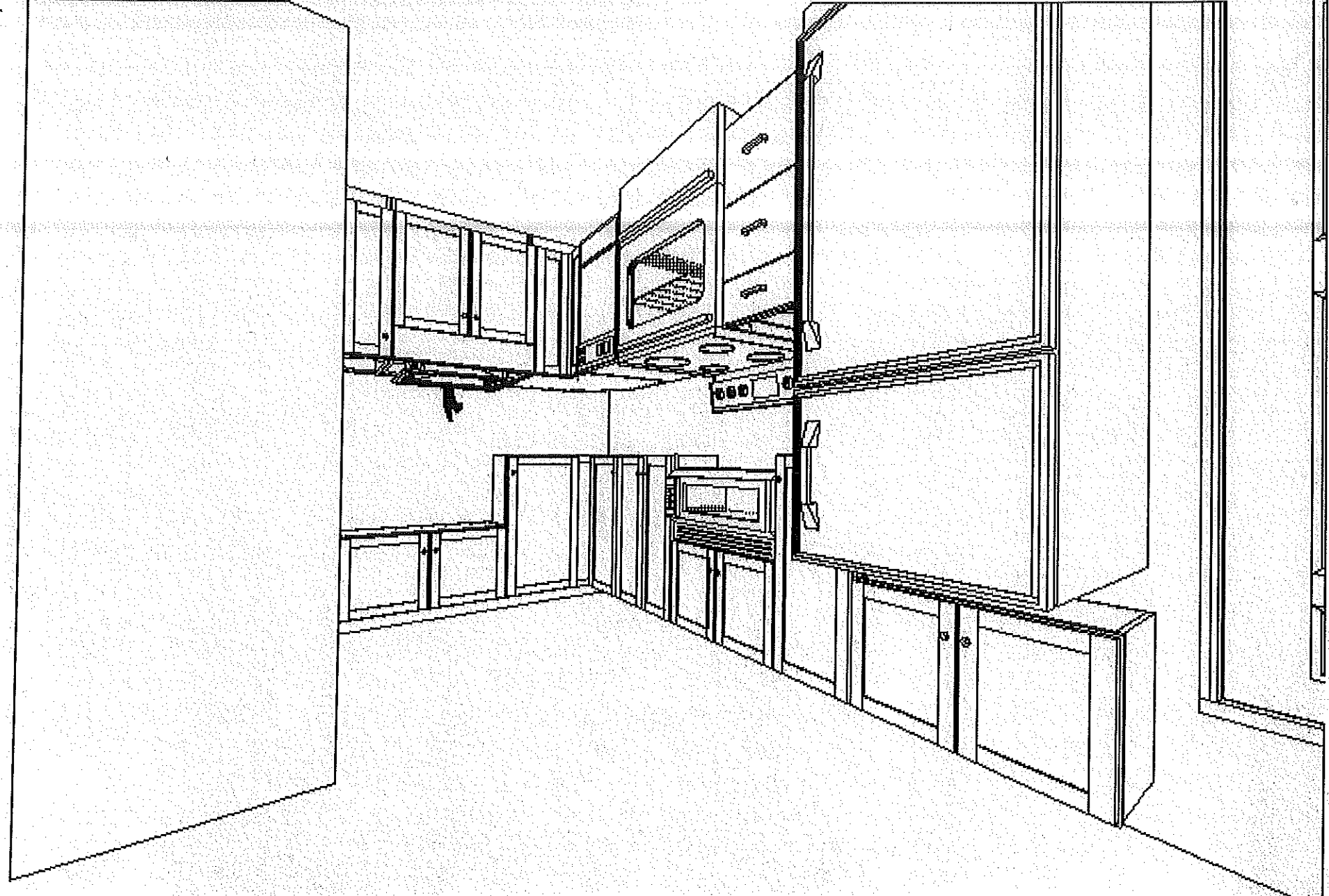

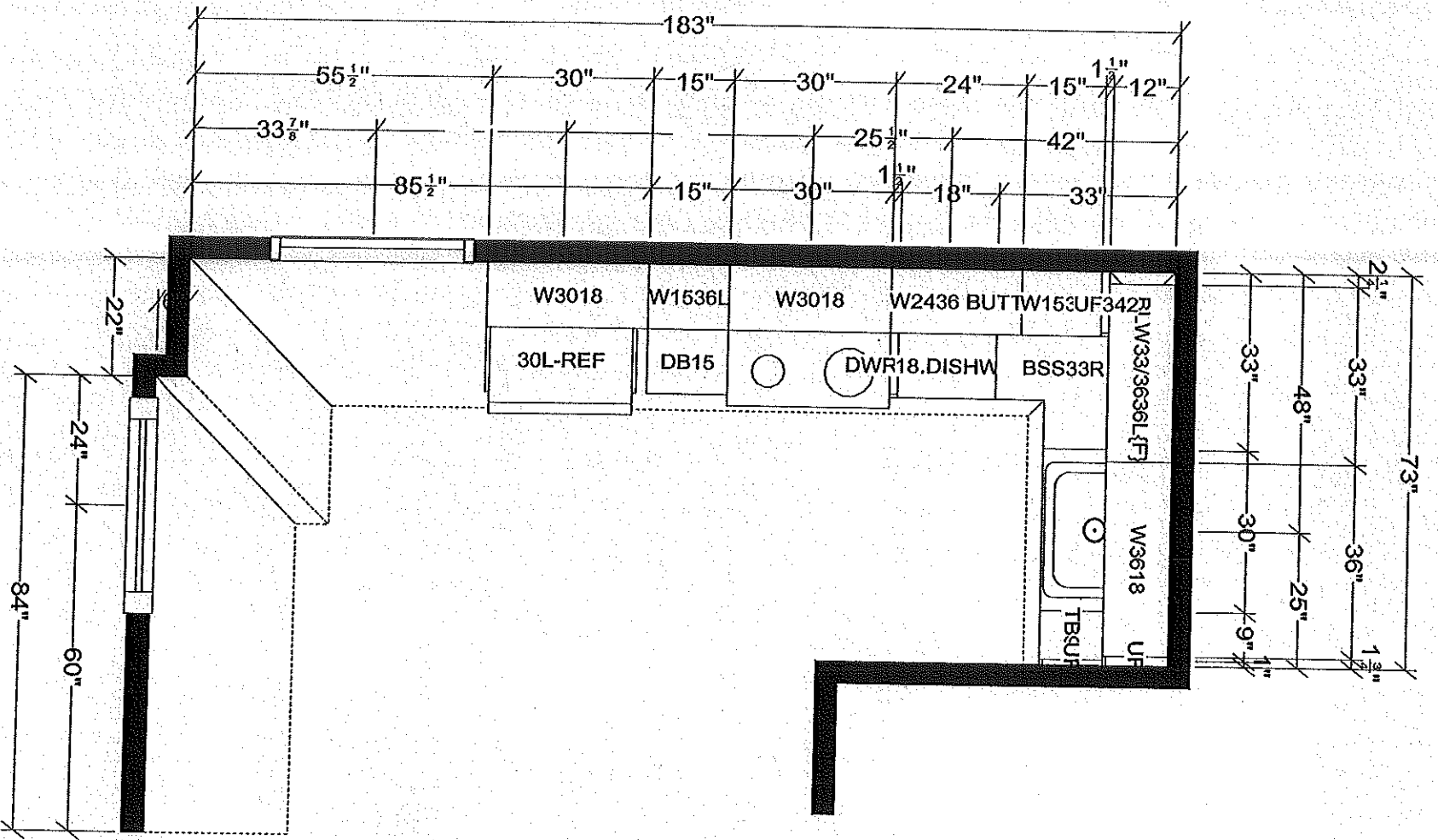

All dimensions, size designations given are subject to verification on job site and adjustment to fit job conditions.



This is an original design and must not be released or copied unless applicable fee has been paid or job order placed.

Designed: 2/28/2007
Printed: 2/28/2007

Dambrie-Unit7-dd2.kit

Dambrie-Unit7-dd2.kit

Drawing # 1

Note: This drawing is an artistic interpretation of the general appearance of the design. It is not meant to be an exact rendition.



Designed: 2/2/2007
Printed: 2/2/2007

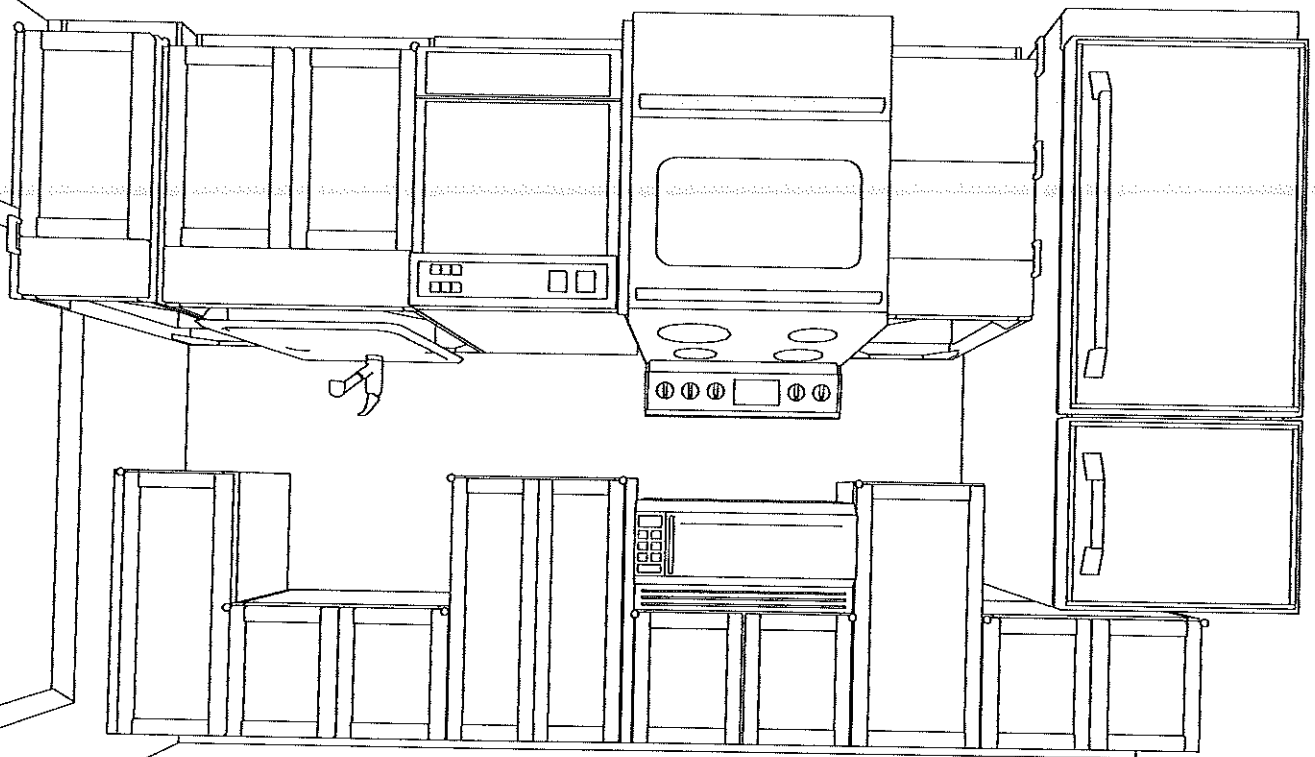

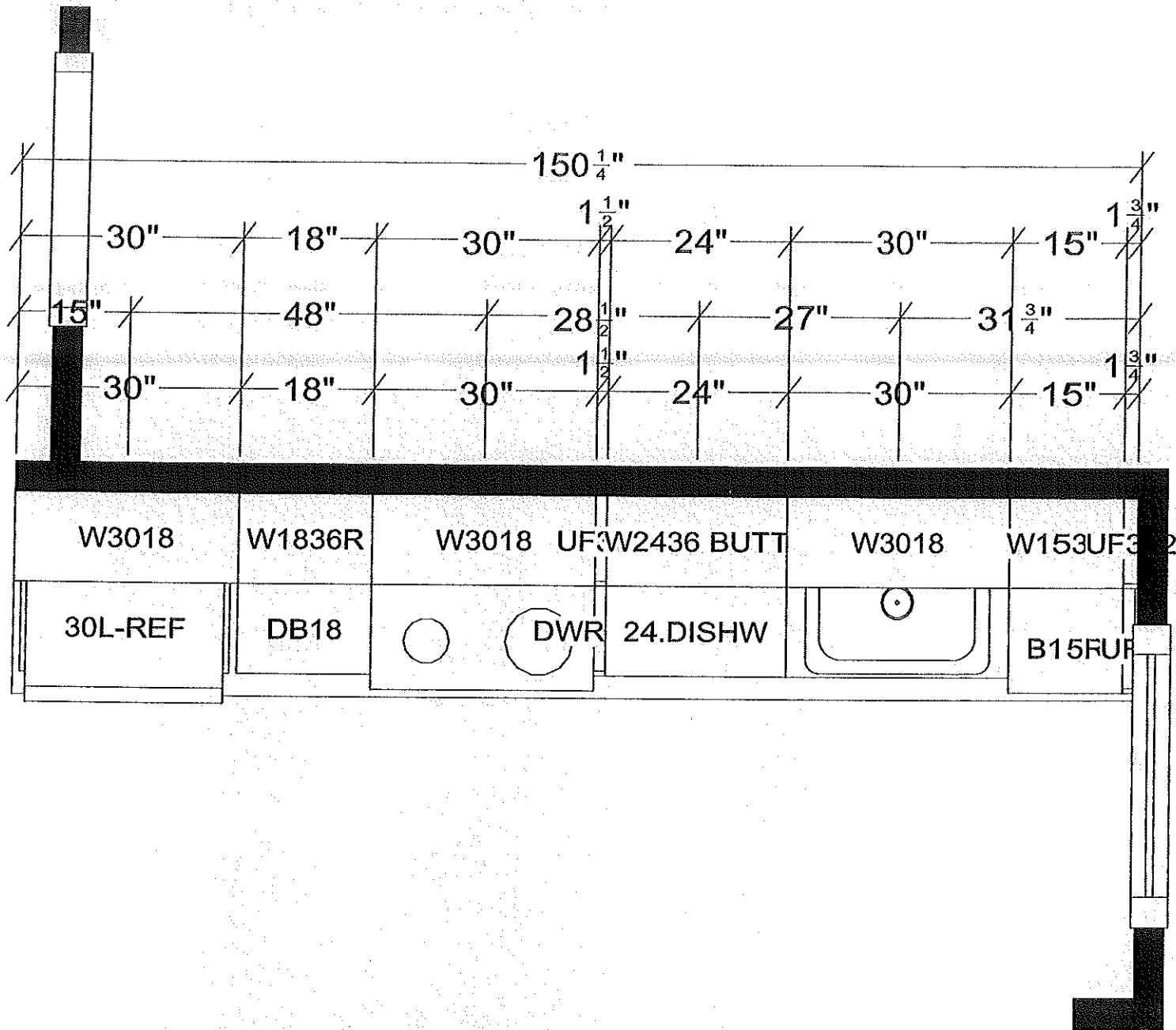

All dimensions, size designations given are subject to verification on job site and adjustment to fit job conditions.



This is an original design and must not be released or copied unless applicable fee has been paid or job order placed.

Designed: 2/1/2007
Printed: 2/2/2007

Dimension Unit: ddd'xxx"

Fp 1

Drawing #: 1

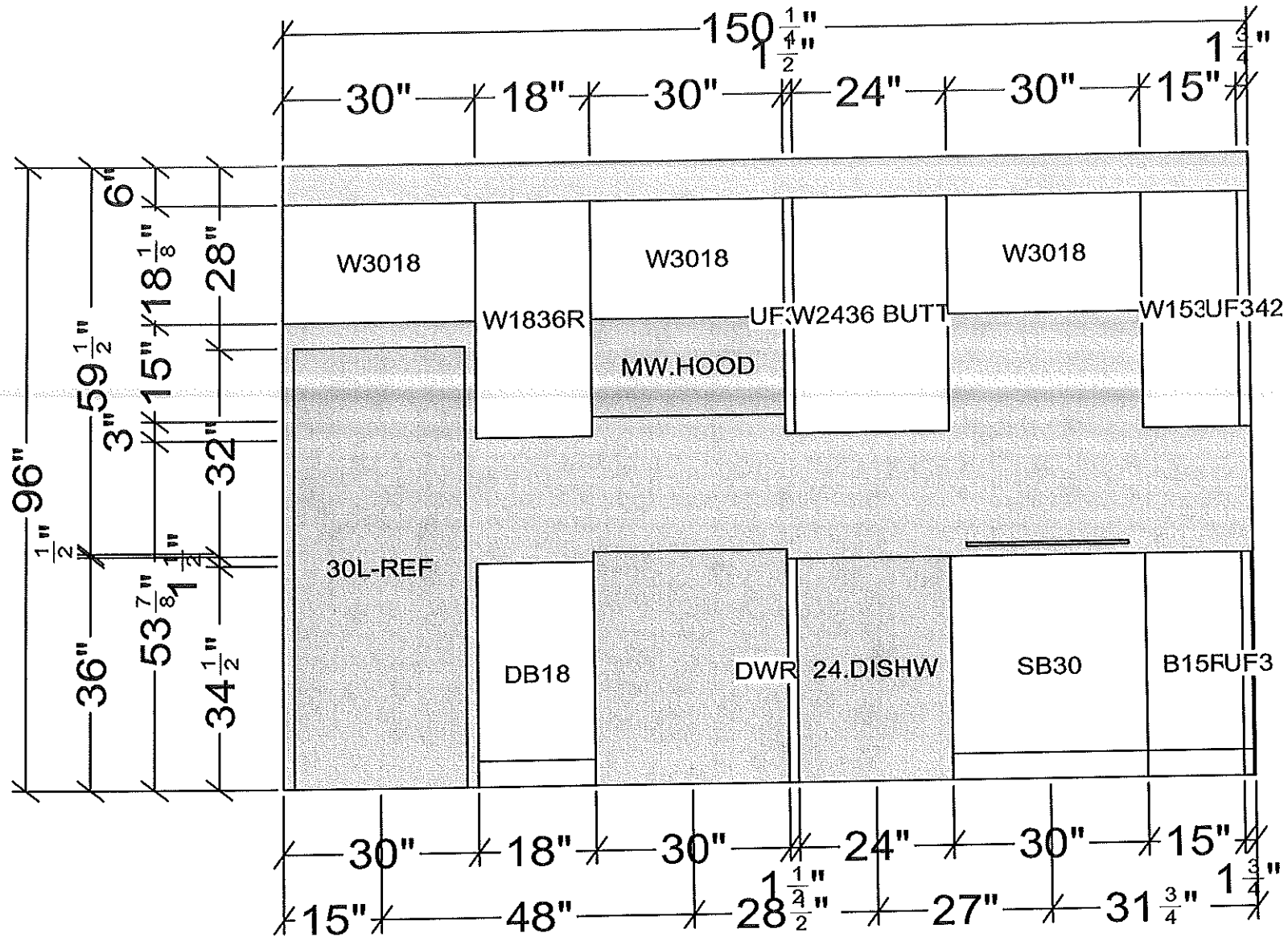

All dimensions .size designations given are subject to verification on job site and adjustment to fit job conditions.



This is an original design and must not be released or copied unless applicable fee has been paid or job order placed.

Designed: 2/2/2007
Printed: 2/2/2007

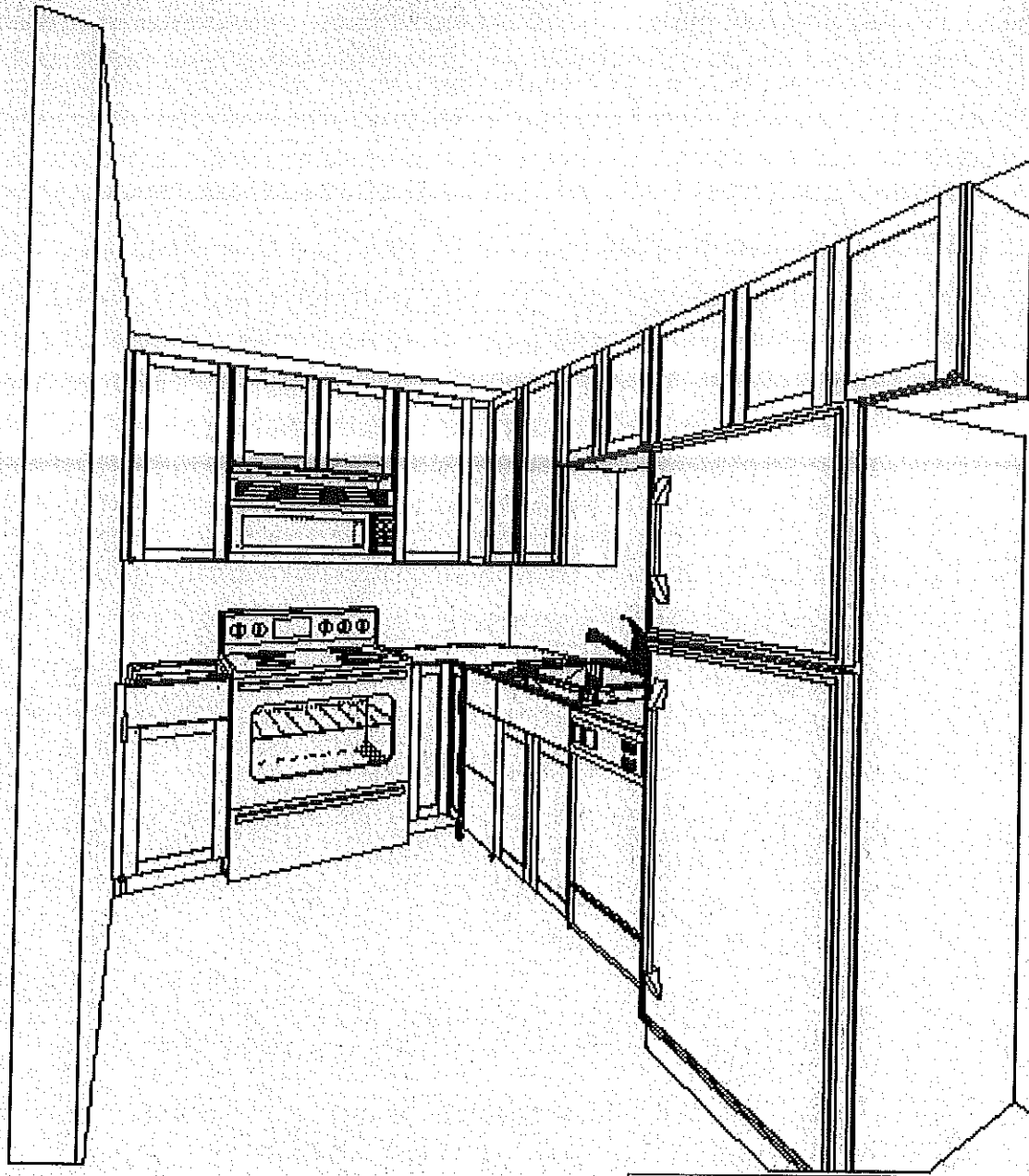

Note: This drawing is an artistic interpretation of the general appearance of the design. It is not meant to be an exact rendition.

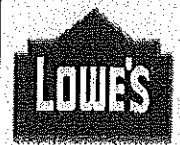

Designed: 2/13/2007
Printed: 2/28/2007

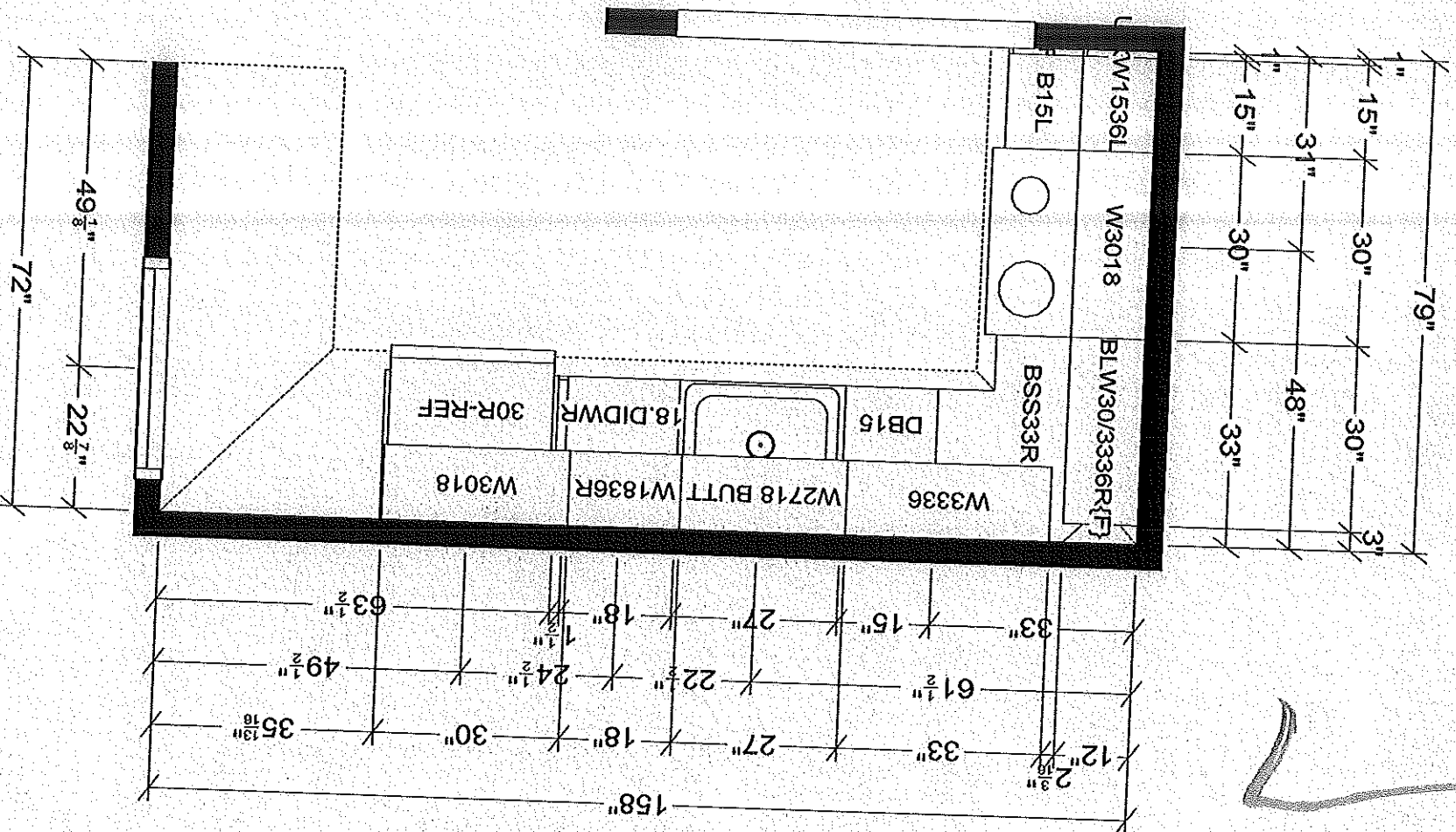

All dimensions, size designations given are subject to verification on job site and adjustment to fit job conditions.



This is an original design and must not be released or copied unless applicable fee has been paid or job order placed.

Designed: 2/13/2007
Printed: 2/28/2007

Part No: Umr8-442.kit

Fp 1

Drawing # 1

SEI SHELLEY ENGINEERING, INC.
STRUCTURAL CONSULTANTS

Fax Memorandum

To: Lannie Dobson From: Tim Shelley

874-8716 Pages: 2

Company: City of Portland Date: 9/8/07

Re: CC:

- Urgent
- For Review
- Please Comment
- Please Reply
- For Your Use

Comments:

Lannie:

Attached is my letter regarding the stone veneer anchor attachments for Fred Dambrle's project at 929 Congress St. If you have any questions, please do not hesitate to contact me.

Regards:

Tim Shelley

ESDH

SEI **SHELLEY ENGINEERING, INC.**
STRUCTURAL CONSULTANTS

City of Portland
City Hall Rm. 315
389 Congress Street
Portland, Maine 04101

September 6, 2007
Job No. 2006-184

Pg. 1 of 1

Subject: Structural attachment of the stone veneer panels at 931 Congress St.,
by Fred Dambric.

Attention: Lannie Dobson
Lannie:

I contacted the Halfen Co., the supplier of the stone veneer anchors, and spoke with their technical department. As indicated in my earlier letter to you, I am now supplying you with the technical data and anchoring system that I have selected for supporting the stone panels.

For gravity support, (1) HRM Model 500 anchor at each bottom corner of all panels (two required, one at each corner).

For horizontal loads, (1) Type DH - Model 1006 tie-back at each top corner of all panels, (two required, one at each corner), and on the tall panels, spaced at two ft. maximum on center, at each vertical side of the panel.

These selected anchors are adequate to resist the weight of the panels and lateral wind and seismic loads.

I will inspect the installation after it is complete, and follow up with letter to you regarding the work performed.

Please let me know if you have any questions.

Sincerely:

Timothy G. Shelley
Timothy G. Shelley, P.E.

cc: Fred Dambric

