

RADIUS SHAPE WINDOWS



25 Series
Unit Sections



Scale 6" = 1'-0"

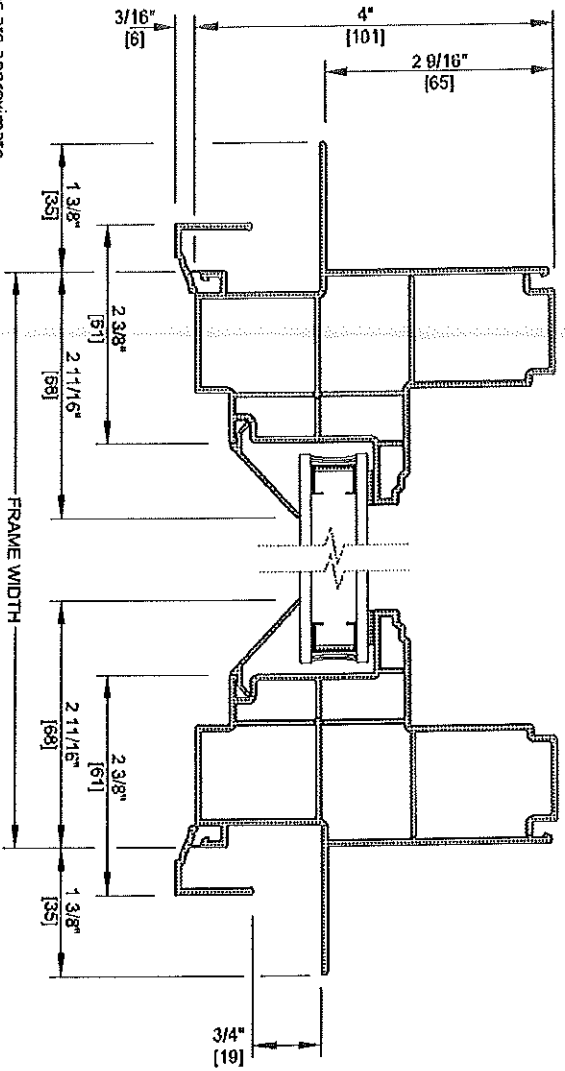
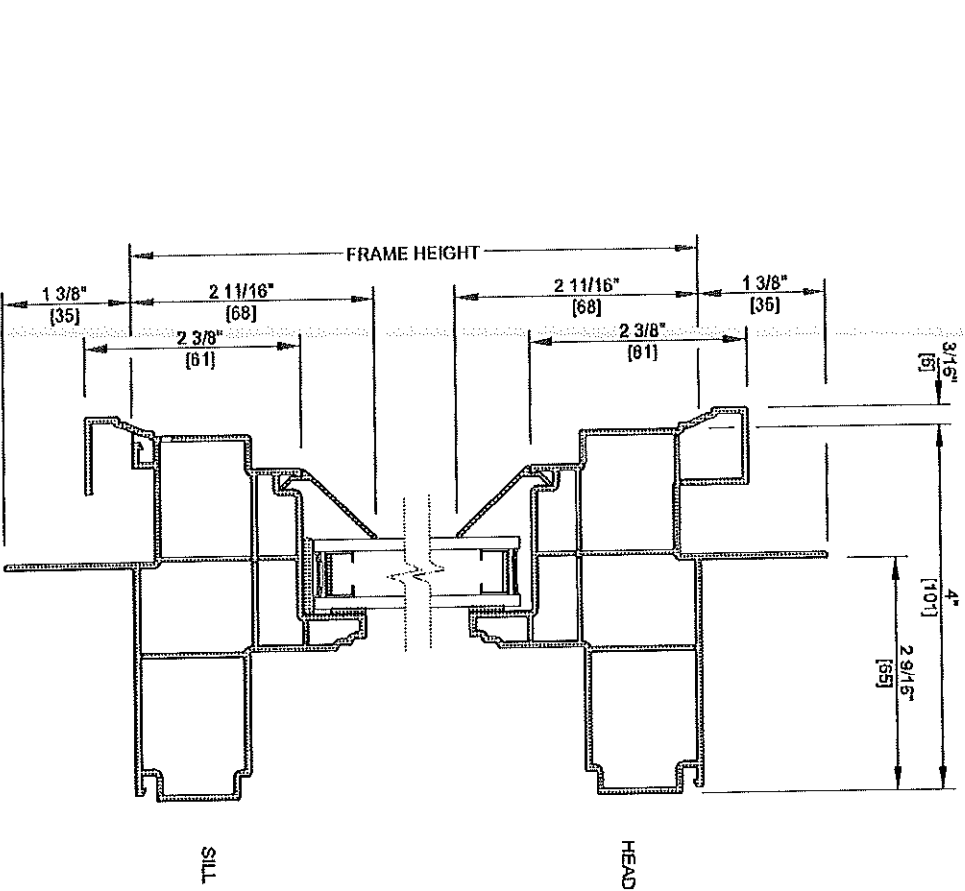

All dimensions are approximate.

RADIUS SHAPE WINDOWS



25 Series
Unit Sections



Scale 3" = 1'-0"

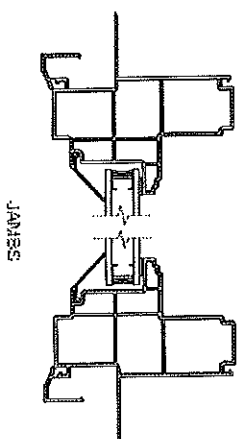
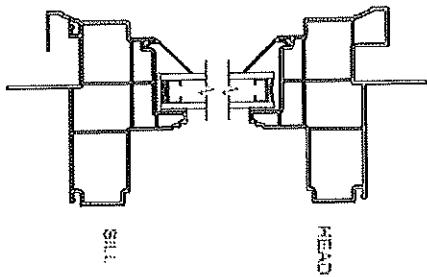

Units with Optional Factory Applied Wood Jamb Extensions

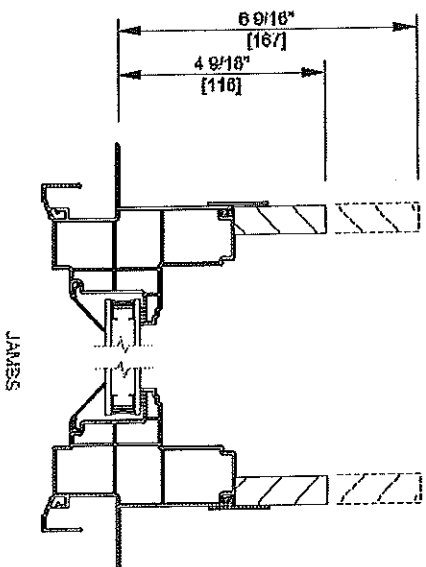
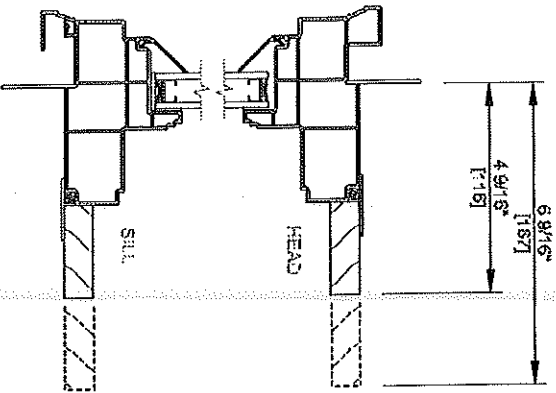

[Back to Quote](#)

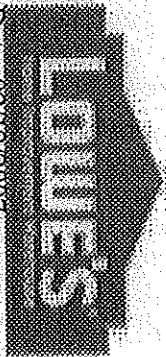

LOWE'S HOME CENTERS, INC.
#1946
1058 BRIGHTON AVENUE
PORTLAND, ME 4102
(207) 482-2800

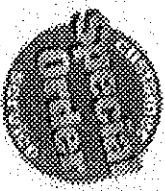

Date: 02/12/2007

Project #: 188186224
Customer Name: WILDCAT LLC
WILDCAT LLC
Customer Phone: (207) 632-4128
Customer Address: 929&931 CONGRESS
CURRENT JOB SITE
PORTLAND ME 04103

Description: *Joel Bar arch's*

Line Item
Frame Size

Product Code
Description

Unit Price Quantity Total Price

0001	Manufacturer: ThermaStar by Pella (R) 37" x 18 1/4"		
RO Size = 37 1/2" W x 18 3/4" H	Product: Windows		
Frame Size = 37" W x 18 1/4" H	Type: Fixed Frames / Special Shapes		
	Manufacturer: ThernaStar by Pella (R)		
	Room Location: OTHER 1		
	Product Category: Radius Window (Circlehead)		
	Material: Vinyl		
	Frame Type (Overall Width): Nail Fin (2 11/16" OAW)		
	Series: 10 Basic New Construction		
	Shape: Half Circle		
	Configuration: One Wide (Fixed used w/ SW-SH)		
	Frame Size Width: 37"		
	Frame Size Height: 18 1/4"		
	Frame Radius: 18 1/4"		
	Exterior Finish: White		
	Interior Finish: White		
	Glazing: Obscure		
	Tempered Glass: Yes		
	Grilles Between Glass Type: None		
	Lead Time: 14 Days		
		\$267.37	3 \$802.11

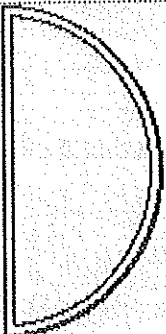

Salesperson: MARK MORISSETTE (S1946MM3)

Project Total: \$802.11

Accepted by: _____

Date: 02/12/2007

[Print this Page](#)

This Millwork Quote is valid until 2/18/2007. This is an estimate only. This estimate does not include tax or delivery charges. Delivery of all materials contained in this estimate are subject to availability from the manufacturer or supplier. All the above quantities, dimensions, specifications and accessories have been verified and accepted.

DOORCRAFT[®]

Part of the JELD-WEN[®] family

www.doorcraftdoors.com

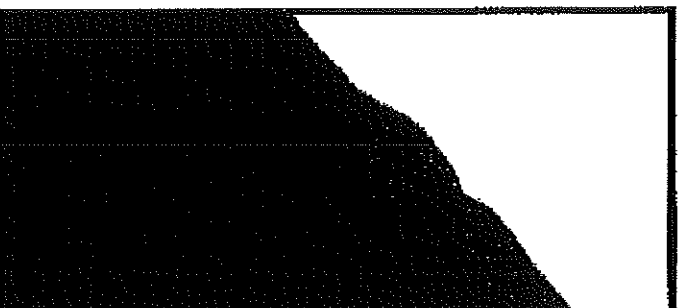

DoorCraft 90 minute flush fire doors		45, 60, 90 minute Door 1 Process	
Maximum Size	Single 4'0" x 10'0" Pails 8'0" x 8'0"		
Thickness	1 3/4"		
Care	Homogenous mineral non asbestos. Meets or exceeds all industry requirements.		
Stiles	1 1/2" wood, matching or compatible to faces. Before trim.		
Top and bottom Rails	1" top and 2" bottom wood. Before trim.		
Face	Cross-banded hardwood veneer in all commercially available species. 1/2" Primed or raw hardwood. 1/2" Prefinished smooth or grained hardwood. 5-ply plastic laminate also available.		
Adhesives	WDMA I.S. 1-A-97 Type 1 or 2 PVA Glue		
Construction	7-ply when using 3-ply hardwood faces; 9-ply when using 4-ply hardwood faces.		
Standards	Warnock Hersey International approved to fire endurance tests. WHI is an approved ICBO quality control agency.		
Other Detail Work	Factory fitting and machining to specification. Contact factory for details.		
Warranty	5-year limited warranty		

DoorCraft of Vermont

Industrial Park, 146 Pleasant Street Extension, Ludlow, VT 05149

(802) 228-2020

Fax: (802) 228-2048

JELD-WEN[®]

WINDOWS & DOORS

Interior Door Division

146 Pleasant St. Extension
P.O. Box 465
Ludlow, VT
05149 USA

802 228-2020 Tel
802 228-2048 Fax

www.jeld-wen.com

FAX TRANSMISSION

Date:

2/28

To:

Mark

Tel.

From:

M. Owen

Tel:

Fax:

207-482-2803

Fax:

Pages (+ cover):

and spec sheet - 90 min doors -

* Please note Stair Ped
at end of doors

THERMA TRU[®]
DOORS

**Expandable Steel Frame
Installation Instructions**

Installation
Instructions

Steel

Installation Instructions for Expandable Steel Frame

Read all instructions before starting.

THERMA TRU[®]
DOORS

The Most Preferred Brand in the Business[™]

Product Manual

August 2005

SITE 1

1.65

Installation
Instructions

THERMA-TRU[®]
DOORS

**Split-Jamb Fire Frame Site Installation
Instructions**

Installation
Instructions

100-204182

**Site
Installation
Instructions**

**for
Split Jamb
Fire Frame**

Read all directions carefully before installing your new Thermo-Tru Steel Frame Door System.

Please note that there are separate "Prehanging Instructions" to be reviewed and followed prior to completing the installation.

CODES
Building codes vary from area to area. If a fire rating is required of the door and opening being framed, the installer must use installation materials and methods to satisfy the authority having jurisdiction. Thermo-Tru provides labeled products, but bears no responsibility for installation.

THERMA-TRU[®]
DOORS

The Most Preferred Brand in the Business™

**Thermo-Tru Positive Pressure
(UBC 7-2-97/UL 10C/NFPA 252)
Labeled Systems**

This Thermo-Tru door has been labeled in compliance with UL10C & UBC 7-2 1997 (Positive Pressure) and does not require the application of an additional edge sealing system. To maintain the validity of this certification, the door installer must follow these instructions. They should be kept on file on the building premises for verification by the authority having jurisdiction.

- Verify that the frame is compatible with the door and properly installed.
- Install hardware per the hardware manufacturer's instructions.
- For smoke rating, a listed and labeled category "H" Smoke and Draft control gasket shall be installed to the opening. Category "H" Smoke and Draft control gaskets shall be "listed" for compliance with test procedure UBC Standard 7-2-1997, Parts I and II.
- Installation must comply with requirements of NFPA 80 "Standard for Fire Doors and Fire Windows."
- A maximum of 1/8" clearance between frame and door is allowed.
- Surface mounted hardware must be attached with through bolts unless interior blocking is provided.
- Doors shall be installed in minimum 18-gauge standard or adjustable steel frames with kerfs.
- Thermo-Tru Virginia (General Products) Compression weather-strip shall be installed in the header and jambs of the frame.
- If closure block reinforcement is not provided, use through bolts or sex bolts to install closure.

THERMA-TRU[®]
DOORS

The Most Preferred Brand in the Business™

1750 Indian Wood Circle, Maumee, Ohio 43537
1-800-Thermo-Tru (843-7628)
www.thermatru.com

© Copyright 2002 Thermo-Tru Corp. 12005 3704# 5294231

Product Manual

August 2005

SITE 1

1.61

Installation
Instructions

4822803

Split-Jamb Fire Frame Site Installation Instructions

THERMA TRU
DOORS

TOOLS REQUIRED

- Drill with Phillips Driver Bit
- Shims
- Caulk Gun and Caulk

OPTIONAL COMPONENTS (Supplied Separately)

LOCK PLATES

Passage Locks:



T-Snake
Adapter Plate

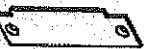

Blank for
RIM Hardware

Deadbolt Locks:



5 1/2"
Center to Center
Insert



4" or 7"
Center to Center
Insert

PAINTING FRAME AND DOOR

- **DOOR PREP:** Brush or sponge off dirt. Wipe dry.
- **FRAME PREP:** Wet-clean with mild abrasive cleaner. Rinse completely and wipe dry.
- Paint the door in an open position.
- Use a high quality exterior house paint to finish the frame and door when the temperature is above 50°F and humidity is below 90%.
- **DO NOT** paint weatherstrip. (It can be temporarily removed for painting.)
- **DO NOT** close door until the paint is completely dry.

For information on where to purchase
Therma-Tru entry door systems,
call 1-800-537-8827

Therma-Tru Fire Frame Parts List and Description

(Note: Not all items are included with every option.)

JOB SITE COMPONENTS

TRIM (3 Pieces)

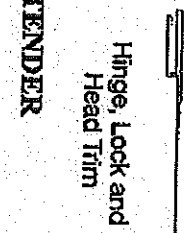

Hinge, Lock and
Head Trim

SILL EXTENDER



HARDWARE

Installation Instructions

Passage Lock Plate

An adapter plate for a full lipped strike plate is included as a standard item in the frame package hardware kit. Other options are available separately.



Deadbolt Lock Plate

The standard frame comes with a deadbolt blank for no deadbolt. Deadbolt adapter plates are available separately.

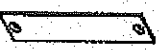

(2) Jamb seal pads

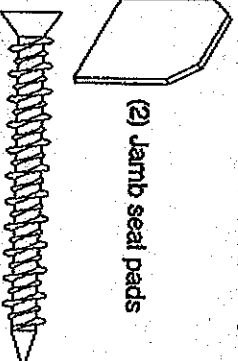

(10) #10 x 2" Phillips flathead screws,



(4) #12-24 x 1 / 2" Self tapping Screw

THERMATRU[®]
DOORS

Split-Jamb Fire Frame Site Installation Instructions

Installation
Instructions

1 CHECK ROUGH OPENING SIZE.

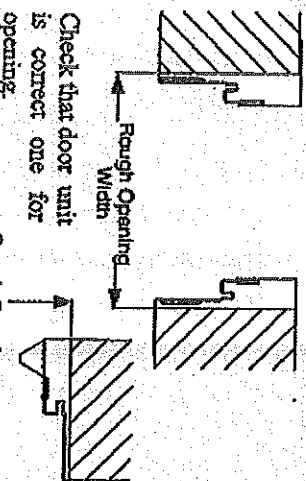

Check that door unit is correct one for opening.

Check rough opening width and height for the appropriate sill type. See table below.

If additional carpet clearance is required, the necessary full shim under the sill will change the rough opening height accordingly.

Sill Type	Rough Opening Height		Rough Opening Width	
	6/8	7/0	Door	Opening
Inswing/Outswing	81-3/8"	85-3/8"	2/6	31"
Public Access	80-3/4"	84-3/4"	2/8	33"
No Sill	80-3/8"	84-3/8"	3/0	37"

2 CHECK ROUGH OPENING FOR ACCURACY.

WARNING: It is critical for proper fit and operation that the rough opening is correct

Is subfloor level?
Are walls plumb with jambs?
Are studs or door bucks plumb?
If problems exist, fix the problem.

3 UNITS WITH PUBLIC ACCESS SILLS, CAULK BOTTOM OF SILL.

For public access sills, apply caulk along entire length of sill as shown.



4 CENTER UNIT IN OPENING AND FASTEN FLANGES TO WALL.

Place unit on correct side of opening. Do not remove "L" bracket until door is in place, plumb and shimmed. Center unit in rough opening and set flanges flush and plumb against wall. Nail or screw flanges to wall through punched holes at perimeter.

For jambs exposed to weather caulk entire perimeter on underneath side of nailing flange. If problems exist, fix the problems.

5 LOCATE AND SECURE SHIMS BETWEEN WALL AND FRAME.

Keeping door closed, carefully shim between wall and frame. Shim hinge jamb behind hinges and the lock jamb as indicated in the figure below to plumb and level the door. Remove "L" bracket from door.

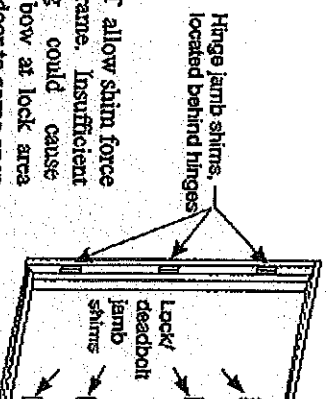

DO NOT allow shim force to twist frame. Insufficient shimming could cause jamb to bow at lock area allowing door to come open during a fire.

6 DRIVE SECURITY SCREWS INTO TOP HINGE LEAF.

With door open, at hinges where indicated, drill 7/64" diameter pilot holes and fasten #10 x 2" screws (provided) through holes in each hinge leaf.



Product Manual

August 2005

SITE 1

1.63

Installation
Instructions

Split-Jamb Fire Frame Site Installation Instructions

THERMA TRU
DOORS

7 FASTEN LOCK JAMB TO WALL

Secure lock jamb to stud through countersunk holes and shims using the provided #10 x 2" wood screws.

Close the door and finish securing the face of the frame in the remaining countersunk holes.

8 FASTEN LOCK PLATES TO LOCK JAMB

Fasten passage and deadbolt lock plates to lock jamb with (4) #12 - 24 x 1/2" self tapping screws provided.

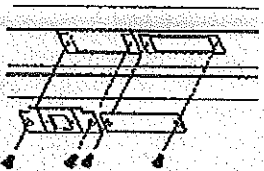

9 CAULK ALONG FRONT OF SILL BASE.

Prior to installing extender, apply a bead of caulk along front leg of riser.

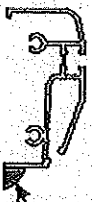

Caulk here

10 INSERT EXTENDER INTO RISER.

Slip proper width extender into sill base and adjust for wall depth ($\pm 1/2"$).

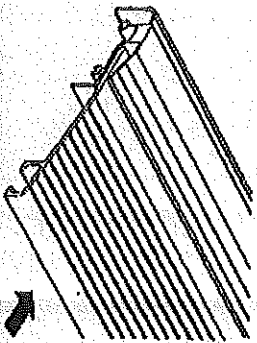

11 SLIDE TRIM ONTO JAMBS.

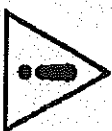

CAUTION

If insulation is required between the frame and rough opening, insulate before sliding trim onto jamb.

Slide hinge and lock trim on first. Be sure that trim ends are resting on the sill or floor. Next apply head trim. Fasten to wall with nails or screws at punched hole locations.

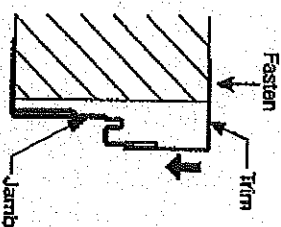

For trim exposed to weather, caulk entire perimeter on underneath side of mating flange.

12 CAULK UNITS EXPOSED TO WEATHER.

Apply a bead of caulk at jamb-sill and trim-sill joints. Also, caulk sill-floor joints. Apply corner seal pads with a bead of caulk at pad - sill joints.

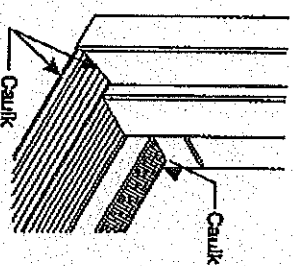

Screw aluminum sill extender to subfloor using #8 x 1 1/4" screws, provided.

THERMA TRU
DOORS

The Most Preferred Brand in the Business™

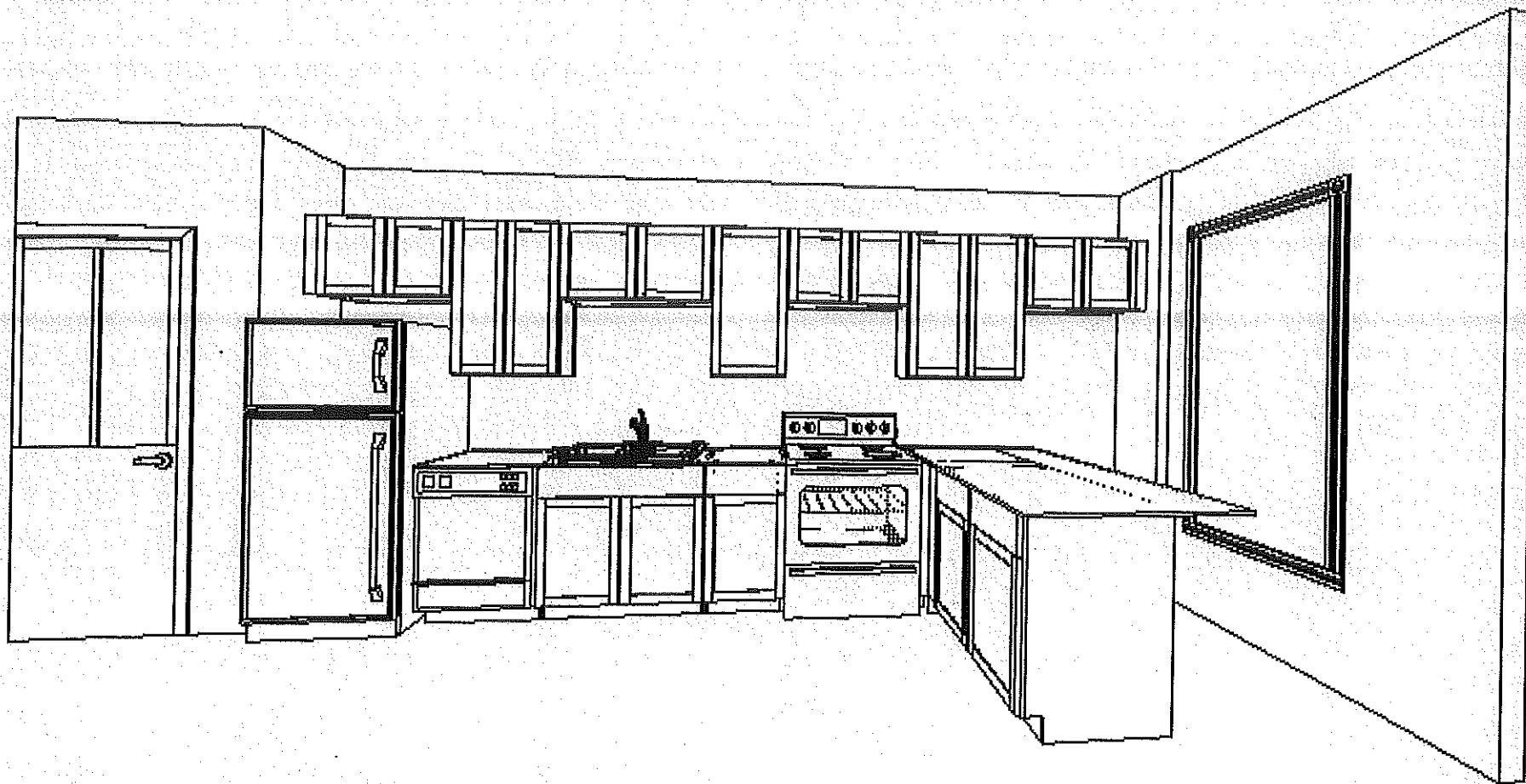

Note: This drawing is an artistic interpretation of the general appearance of the design. It is not meant to be an exact rendition.



Designed: 2/13/2007
Printed: 2/28/2007

All dimensions, size designations given are subject to verification on job site and adjustment to fit job conditions.



This is an original design and must not be released or copied unless applicable fee has been paid or job order placed.

Designed: 2/13/2007
Printed: 2/28/2007

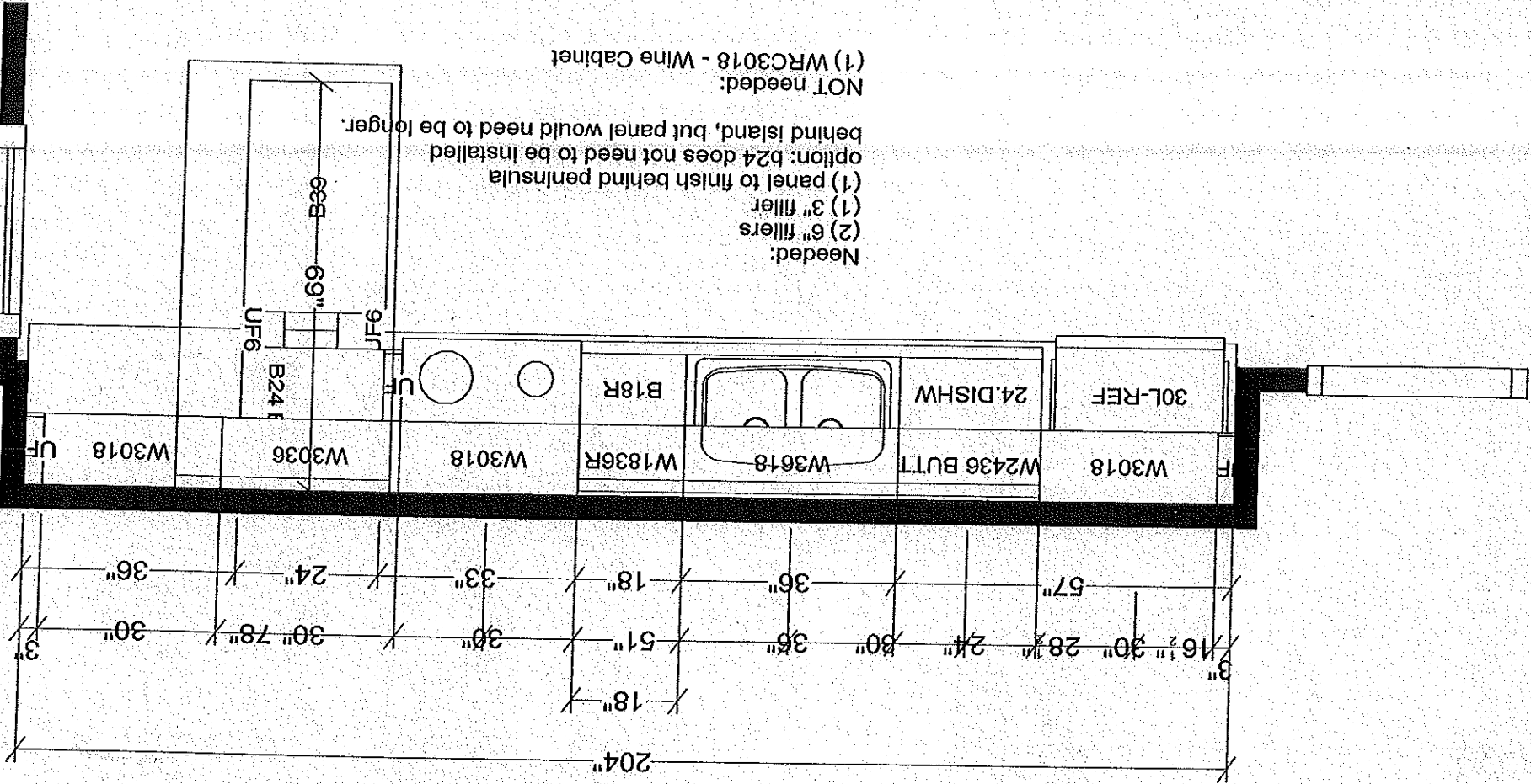

Needed:
 (2) 6" fillers
 (1) 3" filler
 (1) panel to finish behind peninsula
 option: b24 does not need to be installed
 behind island, but panel would need to be longer.
 NOT needed:
 (1) WRC3018 - Wine Cabinet

This is an original design and must not be released or copied unless applicable fee has been paid or job order placed.



All dimensions, size designations given are subject to verification on job site and adjustment to fit job conditions.

Designed: 2/13/2007
Printed: 2/28/2007

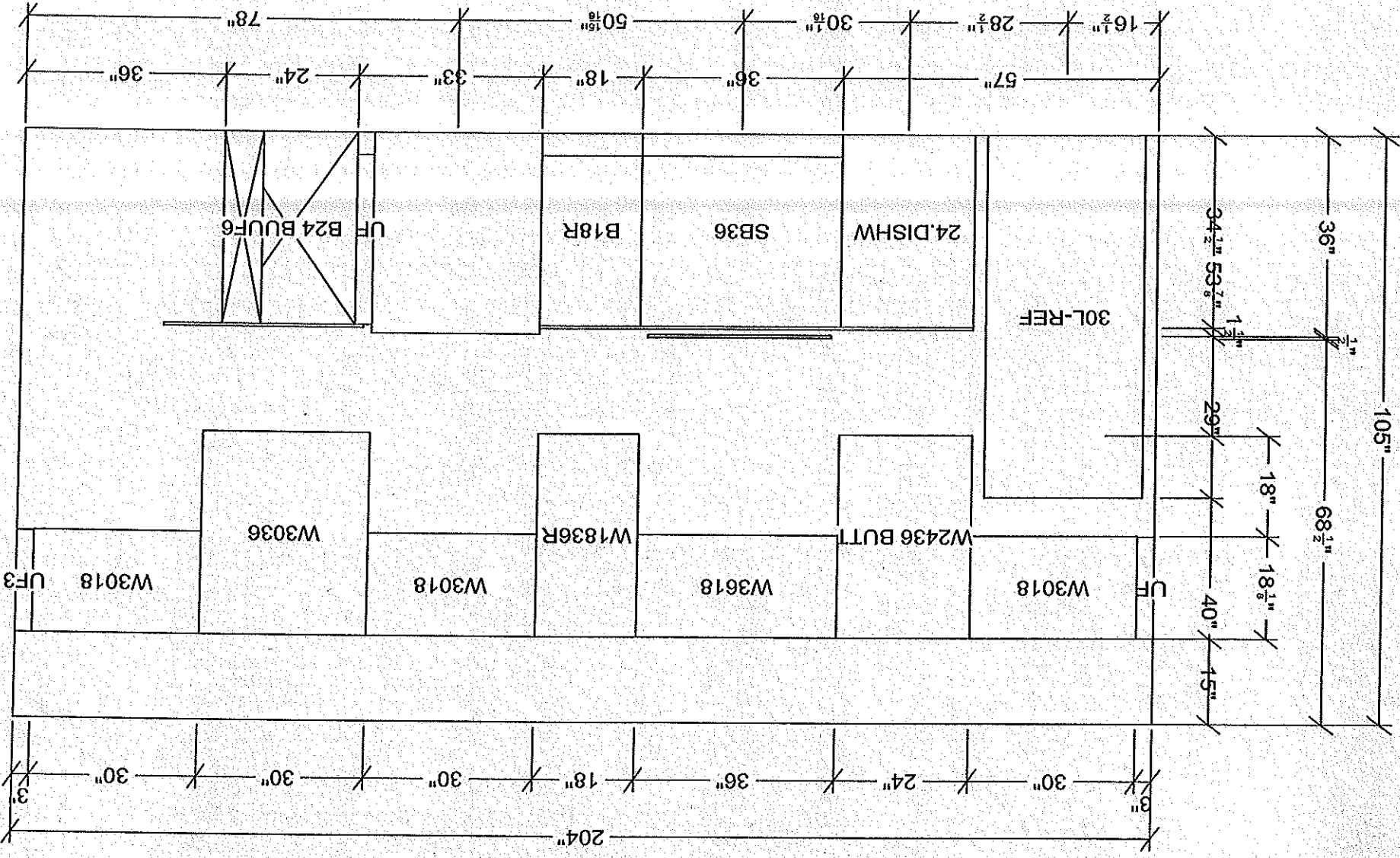

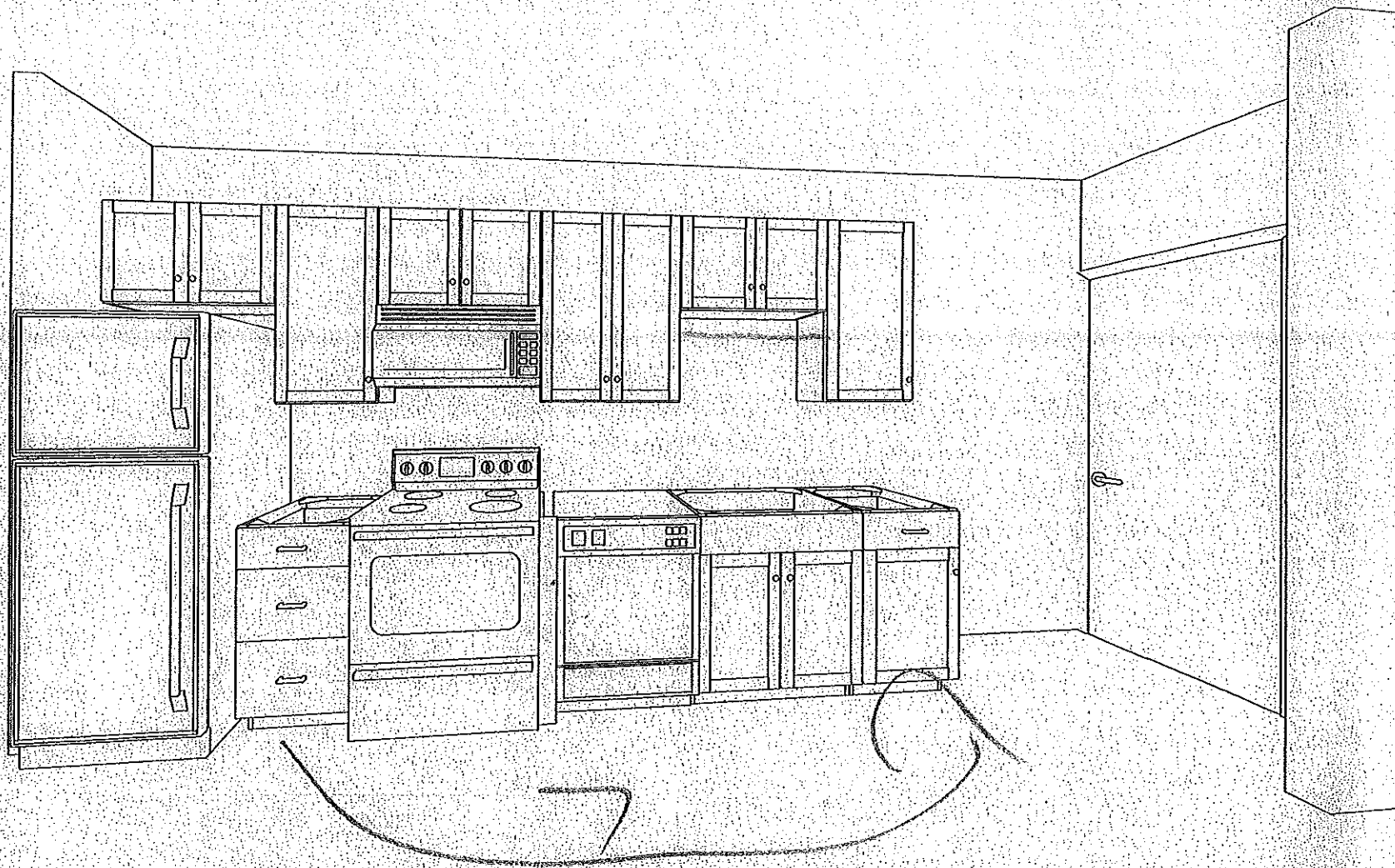

4

Note: This drawing is an artistic interpretation of the general appearance of the design. It is not meant to be an exact rendition.



Designed: 2/1/2007
Printed: 2/2/2007

Dambrie-Unit2-dd2.kit

Dambrie-Unit2-dd2.kit Drawing #: 1

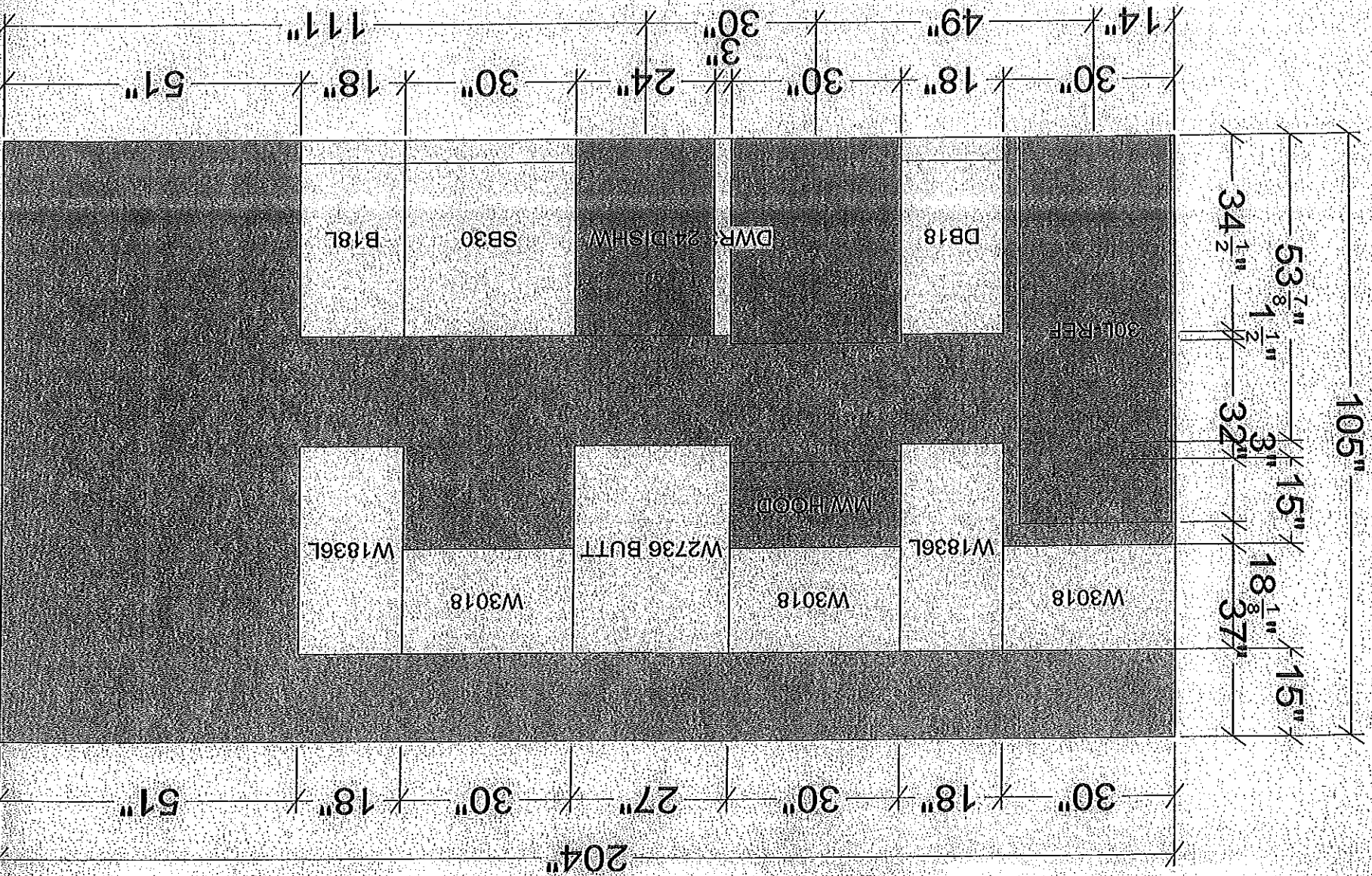

All dimensions, size designations given are subject to verification on job site and adjustment to fit job conditions.



This is an original design and must not be released or copied unless applicable fee has been paid or job order placed.

Designed: 2/2/2007
 Printed: 2/2/2007

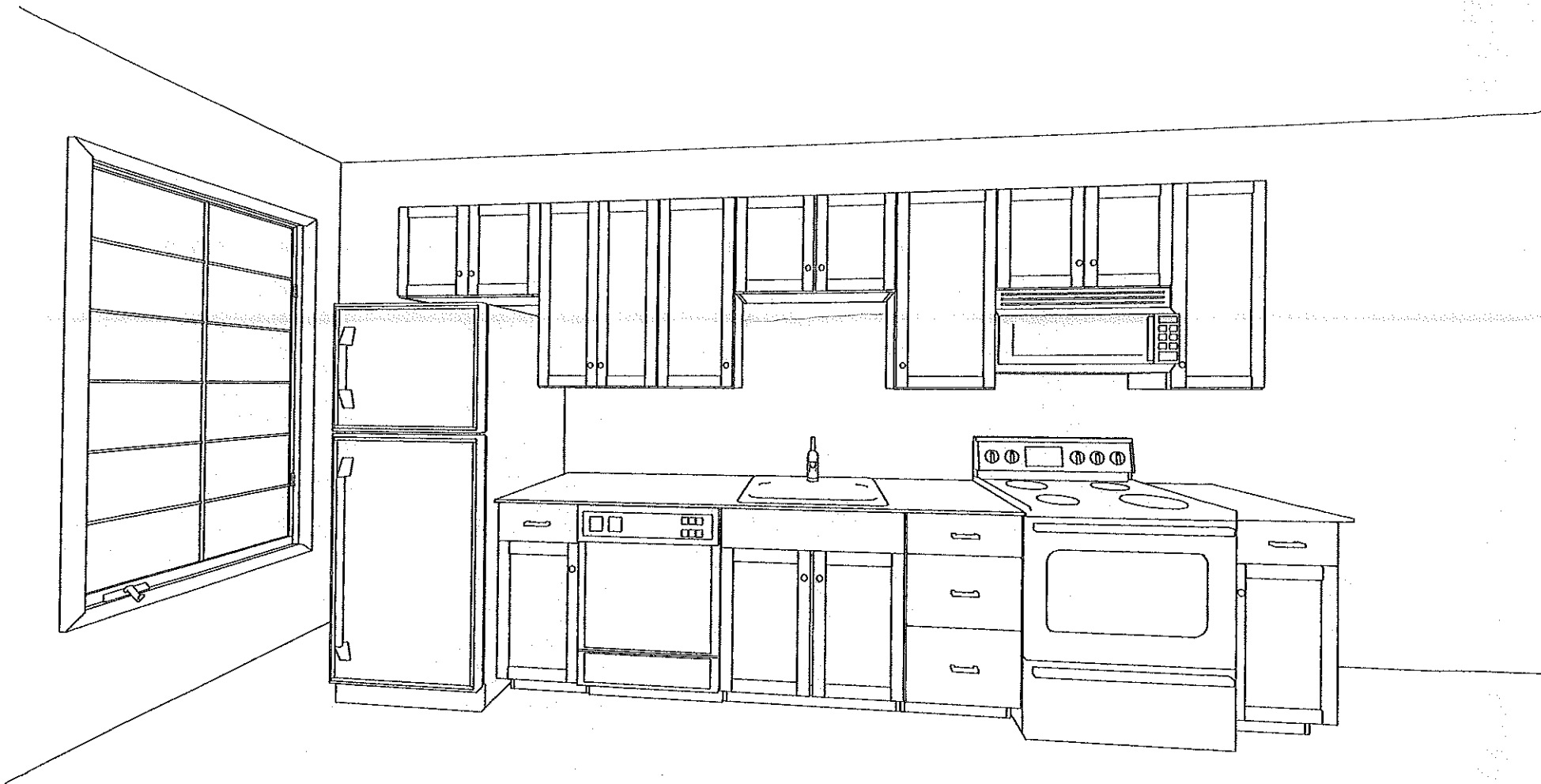

Note: This drawing is an artistic interpretation of the general appearance of the design. It is not meant to be an exact rendition.



Designed: 2/2/2007
Printed: 2/2/2007