

Filename: C:\03-005A\10-06-04\20343802-E101-E102-E103-E104.dwg, Oct. 08, 2004 - 2:38pm

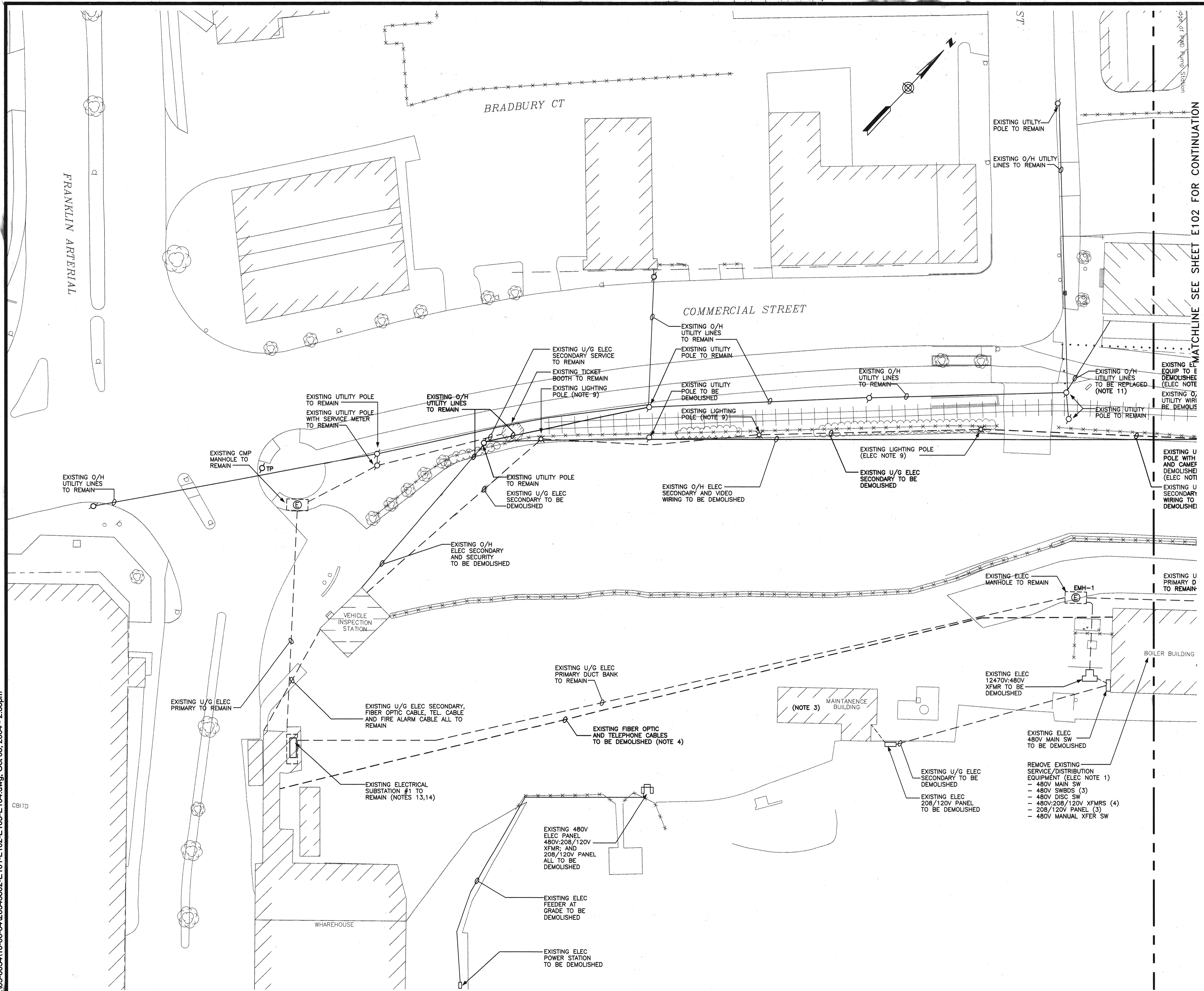

MATCHLINE SEE SHEET E102 FOR CONTINUATION

ELEC DEMOLITION NOTES: (SHEETS E101, E102, E103 & E104)

1. ALL ELECTRICAL ITEMS INDICATED ON PLANS TO BE DEMOLISHED SHALL BE DISCONNECTED, REMOVED AND DISPOSED OFF-SITE BY CONTRACTOR (EXCEPT WHERE SPECIFICALLY NOTED OTHERWISE).
2. WHERE EXISTING UNDERGROUND ELECTRICAL FEEDERS ARE INDICATED TO BE DEMOLISHED, REMOVE WIRING, CUT CONDUIT BELOW GRADE, AND ABANDON EMPTY CONDUIT IN PLACE.
3. WHERE BUILDINGS ARE INDICATED TO BE DEMOLISHED, ALL EXISTING ELECTRICAL SERVICE EQUIPMENT AND WIRING SHALL BE REMOVED AND DISPOSED OFF-SITE BY CONTRACTOR.
4. DISCONNECT AND REMOVE EXISTING FIBER OPTIC CABLE AND TELEPHONE CABLE FROM UNDERGROUND PIPE TUNNEL.
5. ARRANGE WITH CMP TO REMOVE EXISTING FLOODLIGHT AND ASSOCIATED OVERHEAD WIRING.
6. ARRANGE WITH CMP TO REMOVE EXISTING SERVICE METER FOR SERVICE TO METAL BUILDING.
7. ARRANGE WITH CMP TO REMOVE EXISTING SERVICE METER FOR SERVICE TO RAILROAD MISC POWER. ALSO REMOVE EXISTING OVERHEAD SERVICE RISER, TWO SERVICE BOXES, AND RECEPTACLE OUTLETS. SHALL BE RELOCATED PER SHEET E201.
8. REMOVE EXISTING SURVEILLANCE CAMERA AND RELOCATE TO PAINT STORAGE BUILDING.
9. WHERE INDICATED ON PLANS, REMOVE EXISTING AREA LIGHT AND RETURN TO CITY. WHERE LIGHT IS INSTALLED ON A METAL LIGHTING POLE, RETURN ENTIRE POLE AND LIGHT ASSEMBLY TO THE CITY.
10. REMOVE EXISTING SURVEILLANCE CAMERA AND RELOCATE TO NEW LIGHTING POLE.
11. ARRANGE WITH CMP TO REMOVE THE EXISTING OVERHEAD SECONDARY SERVICE TO THE BUILDING AT THE COMMERCIAL/INDIA STREET INTERSECTION. ALSO ARRANGE WITH VERIZON TO REMOVE THE O/H TELEPHONE SERVICE AND WITH TIME WARNER TO REMOVE THE O/H CABLE TV SERVICE.
12. ARRANGE WITH CMP TO REMOVE AND RELOCATE THE EXISTING UTILITY POLE AT THE INTERSECTION OF FORE ST. AND THE NEW HANCOCK ST. EXTENSION.
13. DISCONNECT AND REMOVE EXISTING PRIMARY FEEDER THAT SERVES EXISTING SUBSTATION #2 (OUTSIDE TRANSFORMER) AT THE BOILER HOUSE. LABEL EXISTING PRIMARY SWITCH: 'SPARE-NOT USED'.
14. UNDER THE BASE BID, DISCONNECT THE EXISTING PRIMARY FEEDER COILED AT BOTTOM OF SWITCH. LABEL SWITCH: 'SPARE-NOT USED'. UNDER ALT BID #1, LEAVE THE EXISTING PRIMARY FEEDER THAT SERVES SUBSTATION #3 CONNECTED. LABEL SWITCH: 'PIER 2 DOLPHIN SUBSTATION'.

Bartlett Design
 LIGHTING & ELECTRICAL ENGINEERING
 942 WASHINGTON STREET BATH, ME 04630
 TEL (207) 443-5447 FAX (207) 443-5580

STATE OF MAINE
 DEPARTMENT OF TRANSPORTATION
 PROJECT NUMBER 009215.00

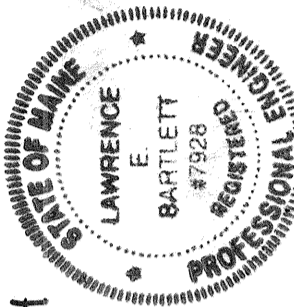

Lawrence J. Bartlett
 SIGNATURE
 P.E. NUMBER 7928
 DATE 10/27/04

PROJ. MANAGER	DATE	BY	DESIGN-DETAILED	CHECKED-REVISED	DESIGN2-DETAILED2	DESIGN3-DETAILED3	REVISIONS 1	REVISIONS 2	REVISIONS 3	REVISIONS 4	FIELD CHANGES
PAUL POTLIE	10/27/04	JLC LEB	LEB	LEB							

KEY PLAN

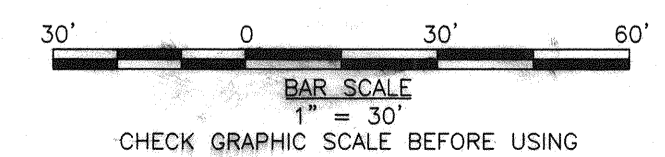
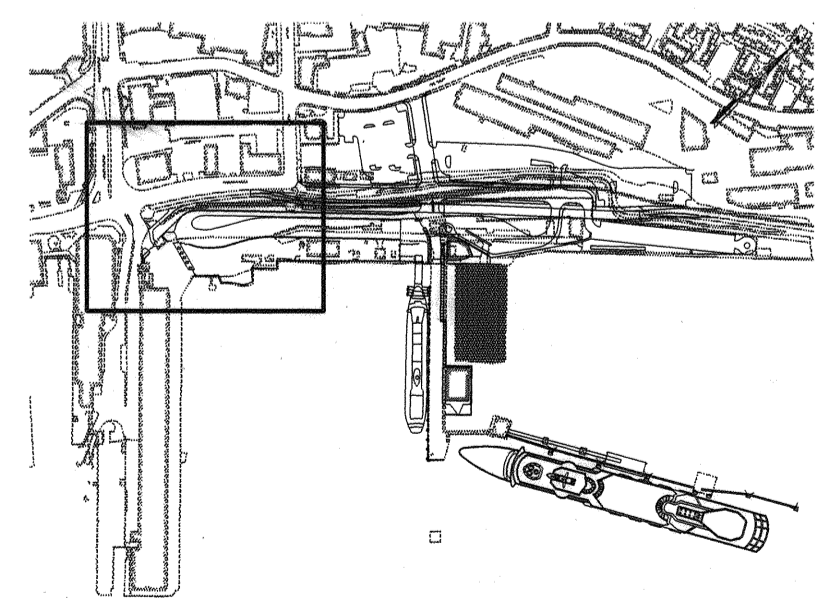

CITY OF PORTLAND
 OCEAN GATEWAY PHASE 1

ELECTRICAL SITE
 DEMOLITION - 1