

Filename: \\server1\projects\02-0818 Maine Int. Ferry Terminal\PHASE 1\Architecture\FINAL CONSTRUCTION DOCUMENTS\RECEIVING STATION\20343802-R-A102.dwg, Oct 07, 2004 - 6:28pm

**LEGEND:**

- ⊙ OCCUPANT LOAD / AREA
- Ⓜ TRAVEL DISTANCE
- Ⓟ GROSS SQUARE FOOT AREA
- STAIR OR DOOR EXIT CAPACITY
- Ⓐ ASSEMBLY (WAITING, CONCENTRATED) W/NOT FIXED CHAIRS) USE @ 1 SF/PERSON
- Ⓐ ASSEMBLY (WAITING, CONCENTRATED) USE @3 SF/PERSON
- Ⓐ ASSEMBLY (WAITING, UNCONCENTRATED) USE @15 SF/PERSON
- Ⓐ ACCESSORY USE ('NO OCCUPANCY')
- Ⓜ MECHANICAL @300 SF/PERSON
- Ⓞ OFFICE USE @100 SF/PERSON
- Ⓢ STORAGE USE @300 SF/PERSON
- Ⓢ FIRE-RATED DOOR AND FRAME "B" LABEL 1 1/2" HRS.
- FIRE RATED WALL / PARTITION (HRS. AS NOTED)
- FE-1 SURFACE MOUNTED FIRE EXTINGUISHER 4 CABINET ABC TYPE 2-A RATED
- FE-2 SEMI-RECESSED FIRE EXTINGUISHER 4 CABINET ABC TYPE 2-A RATED
- Ⓢ INTERNALLY ILLUMINATED EXIT SIGN
- CLEAR WIDTH OF DOOR, RAMP OR STAIR IN INCHES
- Ⓢ TOTAL, MAX. EXIT CAPACITY ALLOWABLE

**NOTE:**

ALL LOAD FACTORS ARE TAKEN FROM THE 2003 BOCA NATIONAL BUILDING CODE (UNLESS NOTED OTHERWISE)

**NOTE:**

ONE FIRE EXTINGUISHER SHALL BE PROVIDED FOR EVERY 3000 SQ. FT. WITH A MAXIMUM DISTANCE OF TRAVEL NOT EXCEEDING 15'-0". TOP OF EXTINGUISHER NOT TO EXCEED 5'-0" ABOVE FLOOR FINISH.

ALL FIRE EXTINGUISHERS PROVIDED WILL BE A MIN 2A 10BC AND SHALL BE RECESSED IN WALL CABINETS.

**CODE SUMMARY**

**BOCA BUILDING CODE 2003 AND NFPA**

**OCCUPANCY GROUP** GROUP A3 - ASSEMBLY, TERMINALS.

**BUILDING TYPE:**  
LOWER LEVEL TYPE 3B

- EXTERIOR WALLS LOADBEARING: 2 HRS. FIRE RATED (F.R.)
- NON LOADBEARING: 0 HRS. F.R.
- FIRE & PARTY WALLS: 2 HRS. F.R.
- FIRE ENCLOSURE OF EXITS: 2 HRS. F.R.
- SHAFTS (INCLUDE ELEVATOR): 2 HRS. F.R.
- INTERIOR LOADBEARING WALLS, LOADBEARING PARTITION, COLUMNS, GIRDERS, TRUSSES (OTHER THAN ROOF TRUSSES) AND FRAMING SUPPORTING MORE THAN ONE FLOOR: 0 HRS. F.R.
- SUPPORTING ONE ROOF ONLY OR A ROOF: 0 HR. F.R.
- STRUCTURAL MEMBER SUPPORTING WALL: 0 HR. F.R.
- FLOOR CONSTRUCTION INCLUD. BEAMS: 0 HR. F.R.
- ROOF CONSTRUCTION INC. BEAMS, TRUSSES, FRAMING AND ROOF DECK: 15' OR LESS HEIGHT OF LOWER MEMBER: 0 HR. F.R.
- MORE THAN 15' BUT LESS THAN 20': 0 HR. F.R.
- MORE THAN 20': 0 HR.

**EGRESS WIDTHS:** NFPA (MOST RESTRICTIVE)

- DOORS:** 120 PERSONS P/EGRESS UNIT (SIMPLE DOOR) 2 INCH/PERSON
- 360 PERSONS P/EGRESS UNIT (DOUBLE DOOR) 2 INCH/PERSON
- STAIRS:** 3 INCH/PERSON
- RAMP:** 2 INCH/PERSON

- ALLOWABLE AREAS:** AREAS OF BUILDINGS OVER ONE STORY, 8,400 sq.ft. x 200% (506.3 BOCA) = 16,800 sq.ft.
- ALLOWABLE HEIGHT:** 30' + 20' (504.2 BOCA) = 50'  
2 LEVELS + 1 (504.2 BOCA) = 3 FLOORS.
- MAX. TRAVEL DIST.:** 250'-0" SPRINKLERED
- MAX. DEAD END:** 20 FEET
- No. OF EXITS REQD:** 3 EXITS (OCCUPANT LOAD: 501-1000)
- DISTANCE BETWEEN EXITS REQD:** D2 > D1 / 3 (140 2/3' / 3 < 10 2/3')  
W/AUTOMATIC SPRINKLER SYSTEM

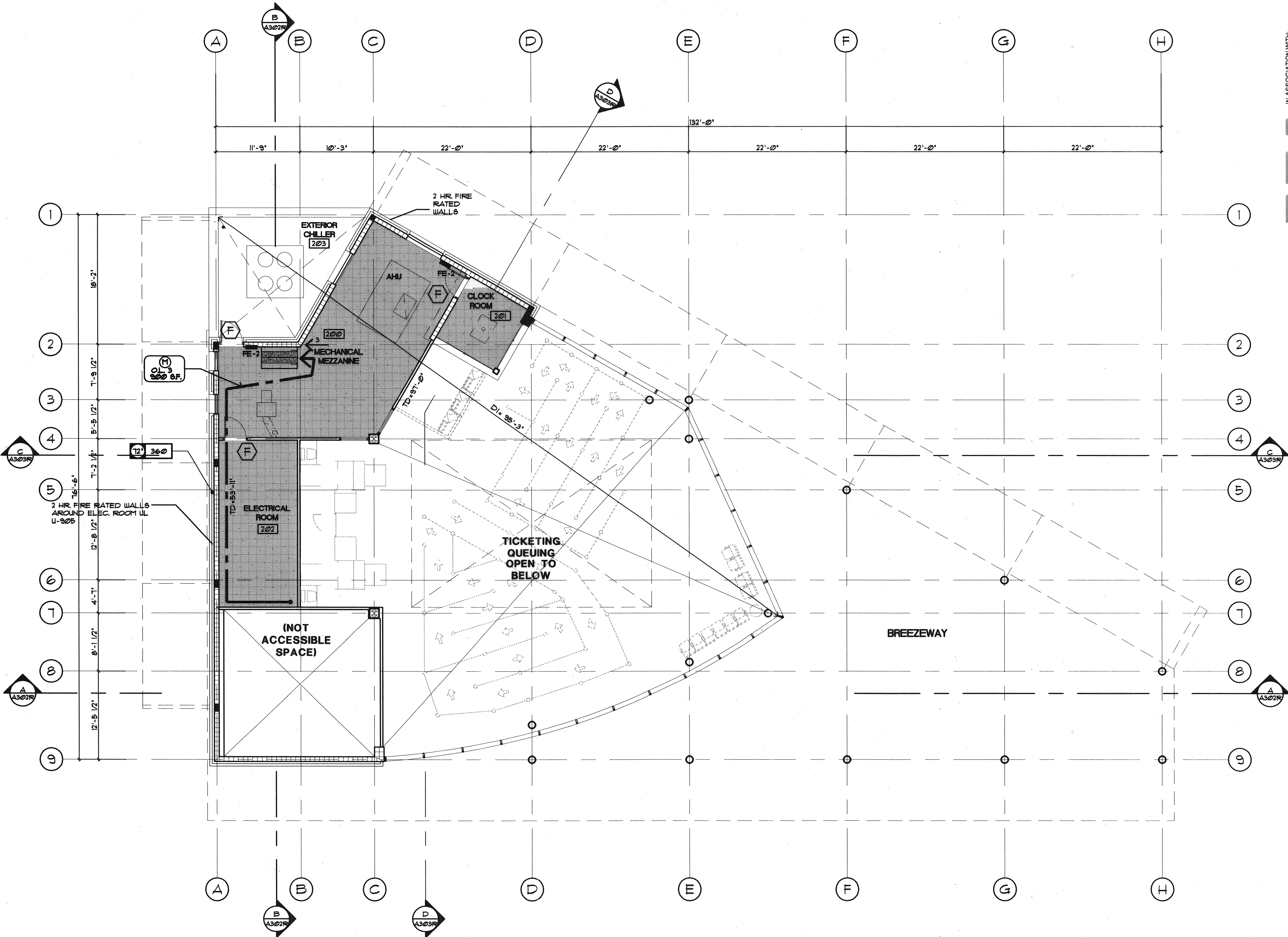

**LIFE SAFETY PLAN**  
SCALE: 1/8" = 1'-0"

IN ASSOCIATION WITH:  
CORRILL-PALMER CONSULTING ENGINEERS  
WINSTON SCOTT ARCHITECTS  
HALEY & ALDRICH

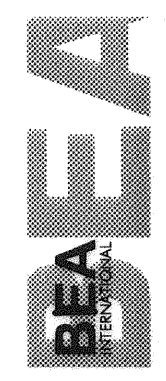

STATE OF MAINE  
DEPARTMENT OF TRANSPORTATION  
PROJECT NUMBER 009215.00  
PIN 009215.00

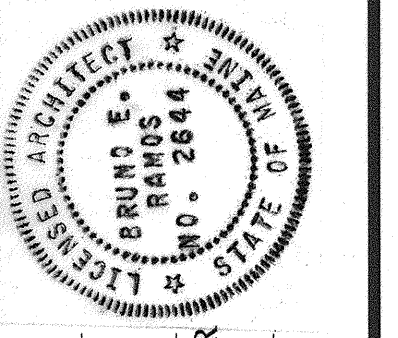

PROJ. MANAGER	PAUL POTTLE	DATE
DESIGN-DETAILED		
CHECKED-REVIEWED		
DESIGN-DETAILED		
REVISIONS 1		
REVISIONS 2		
REVISIONS 3		
REVISIONS 4		
FIELD CHANGES		

CITY OF PORTLAND  
OCEAN GATEWAY PHASE 1  
LIFE SAFETY PLAN  
MEZZANINE FLOOR

A-102-R