

Filename: \\server1\projects\02-0818 Maine Int Ferry Terminal\PHASE 1\Architecture\FINAL CONSTRUCTION DOCUMENTS\TERMINAL BUILDING\020343802-T-A602.dwg, Oct 07, 2004 - 5:54pm

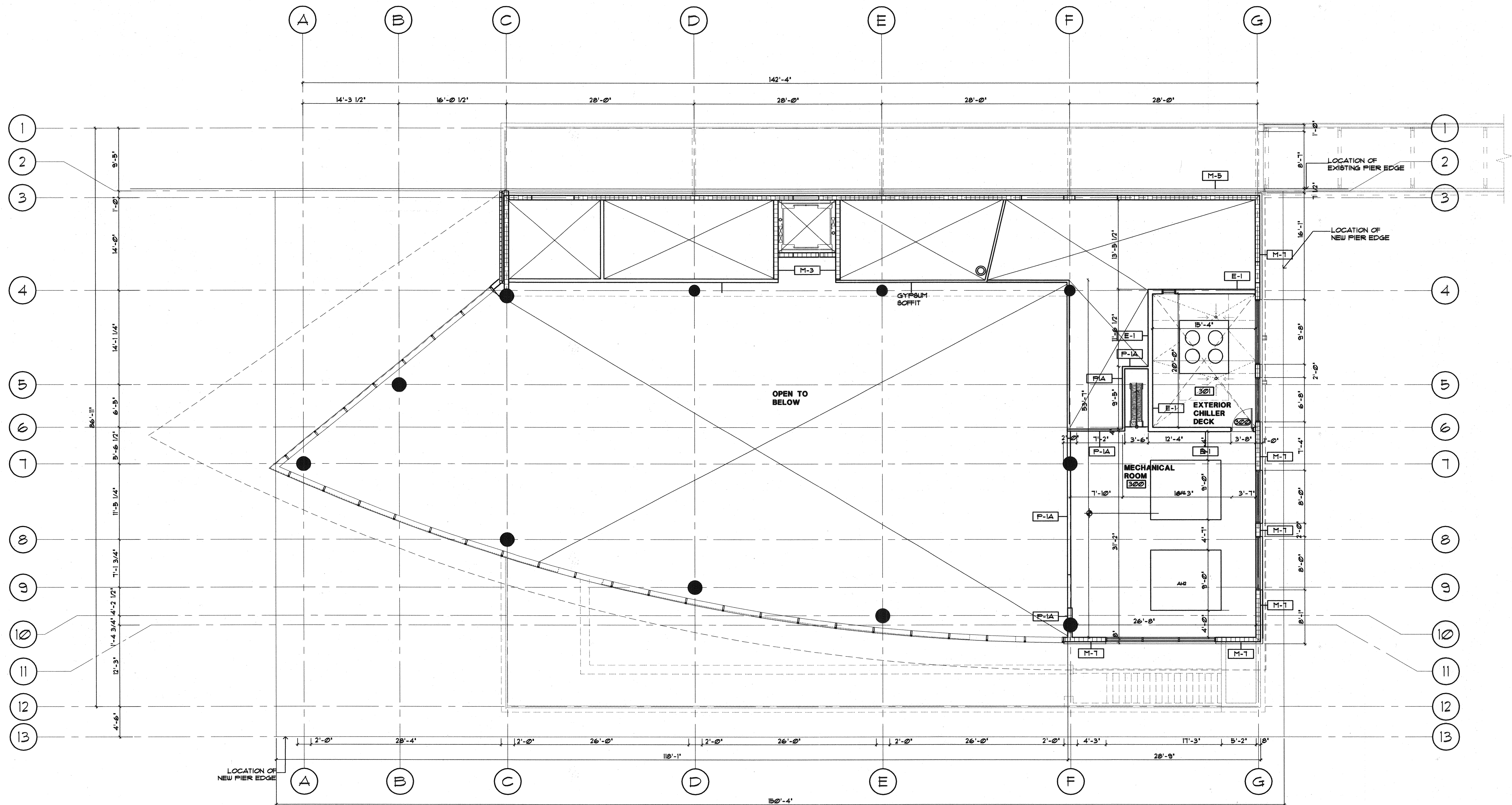

MEZZANINE FLOOR PLAN WALL TYPE
SCALE: 1/8"=1'-0"

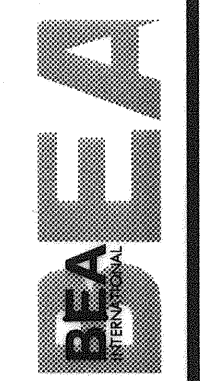
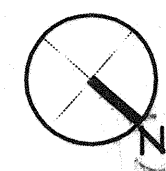

IN ASSOCIATION WITH:
GORRILL-PALMER CONSULTING ENGINEERS
PERRATOVICH, NOTTINGHAM, & DRAGE
WINTOW SCOTT ARCHITECTS
HALET & SCHROCK

STATE OF MAINE
DEPARTMENT OF TRANSPORTATION
PROJECT NUMBER 009215.00
PIN
009215.00

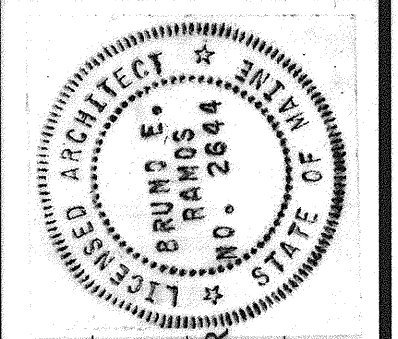

PROJ. MANAGER	PAUL POTTLE	BY	DATE
DESIGN-DETAILED			
CHECKED-REVIEWED			
DESIGN-DETAILED2			
DESIGN-DETAILED3			
REVISIONS 1			
REVISIONS 2			
REVISIONS 3			
REVISIONS 4			
FIELD CHANGES			

CITY OF PORTLAND
OCEAN GATEWAY PHASE 1
MEZZANINE PLAN WALL TYPE

A602-T