

Filename: \\Server1\projects\02-0818 Maine Int Ferry Terminal\PHASE 1\Architecture\FINAL CONSTRUCTION DOCUMENTS\TERMINAL BUILDING\20343802-T-A601.dwg, Oct 07, 2004 - 12:00pm

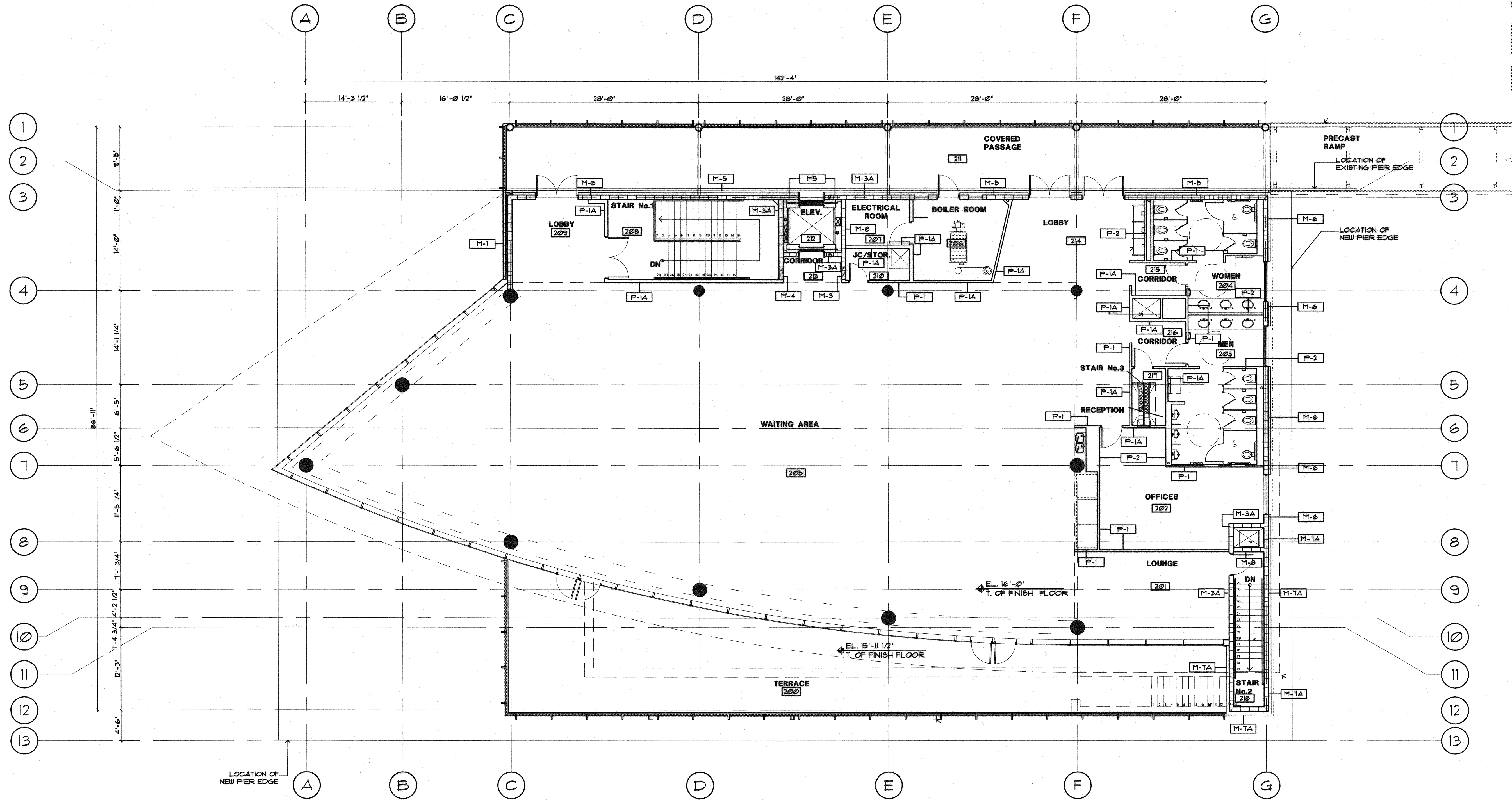

SECOND FLOOR WALL TYPE PLAN
SCALE: 1/8" = 1'-0"

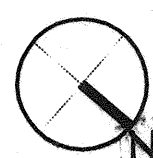

IN ASSOCIATION WITH:
GORRILL-PALMER CONSULTING ENGINEERS
ARCHITECTS
WINSTON SCOTT ARCHITECTS
HALEY & ALDRICH



STATE OF MAINE
DEPARTMENT OF TRANSPORTATION
PROJECT NUMBER 009215.00
PIN
009215.00

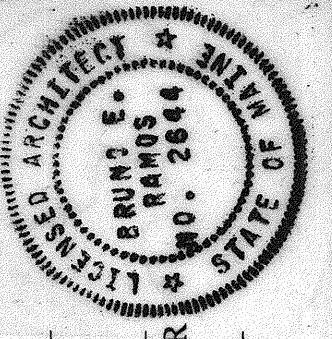

SIGNATURE		P. LICENCE NUMBER	
DATE		ARC 2644	
BY		DATE	
PROJ. MANAGER: PAUL POTTLE		10/8/2004	
DESIGN-DETAILED	CHECKED-REVIEWED	REVISIONS 1	FIELD CHANGES
DESIGN-2-DETAILED2	DESIGN-3-DETAILED3	REVISIONS 2	
		REVISIONS 3	
		REVISIONS 4	

CITY OF PORTLAND
OCEAN GATEWAY PHASE 1
SECOND FLOOR PLAN WALL TYPE

A601-T