

PERSPECTIVE VIEW

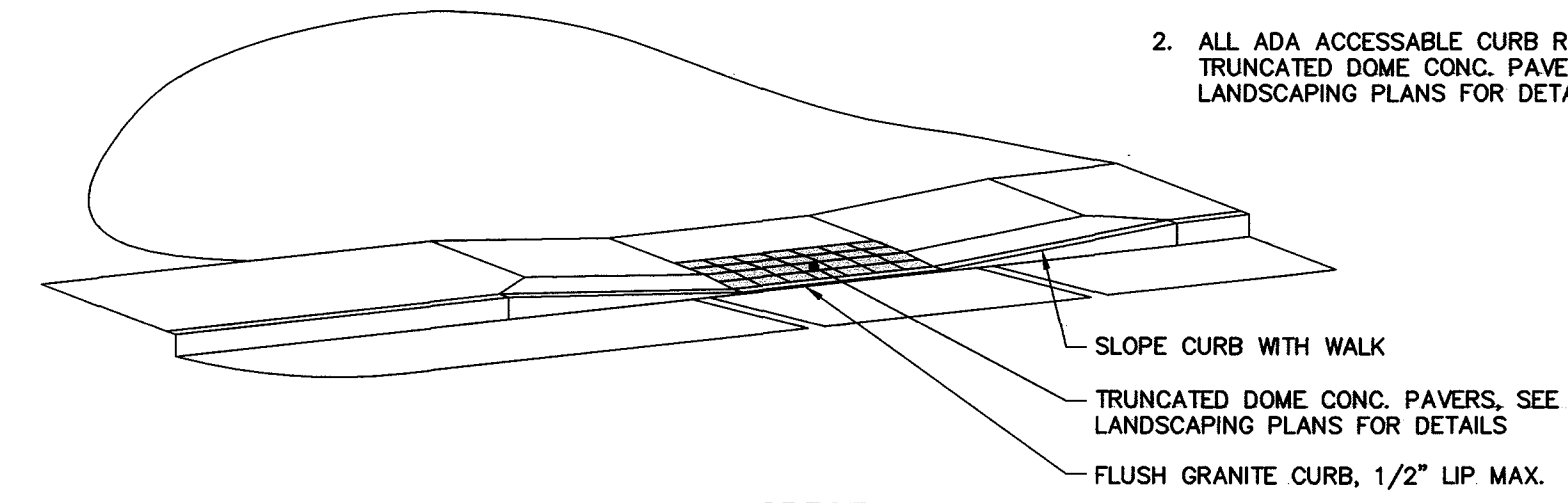

PERSPECTIVE VIEW

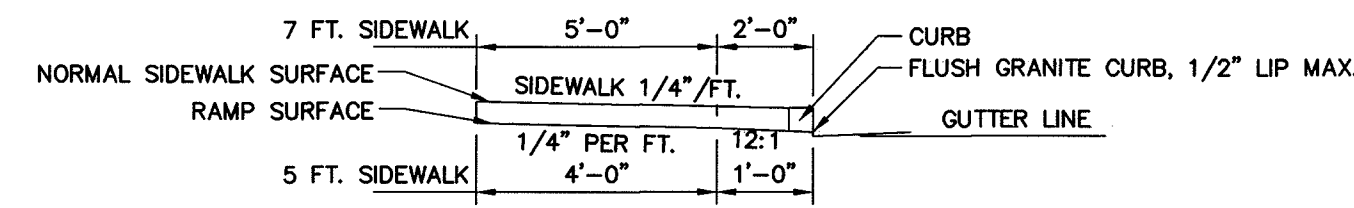

SECTION A-A

NOTE -- RADIUS CURB

1. NO VEHICULAR ACCESS SHALL BE PERMITTED THROUGH THE RADIUS CURB.

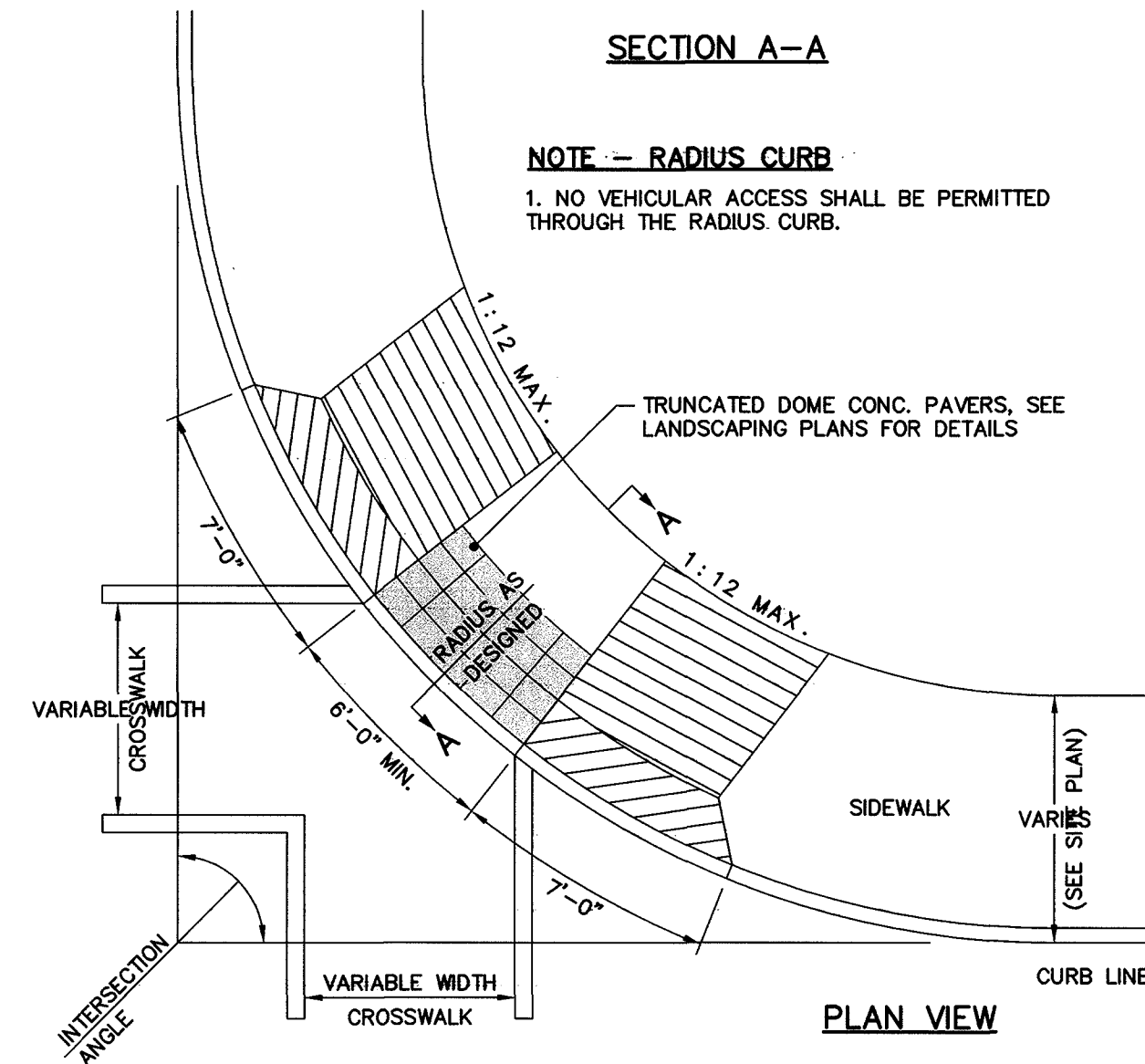

PLAN VIEW

RADIUS CURB

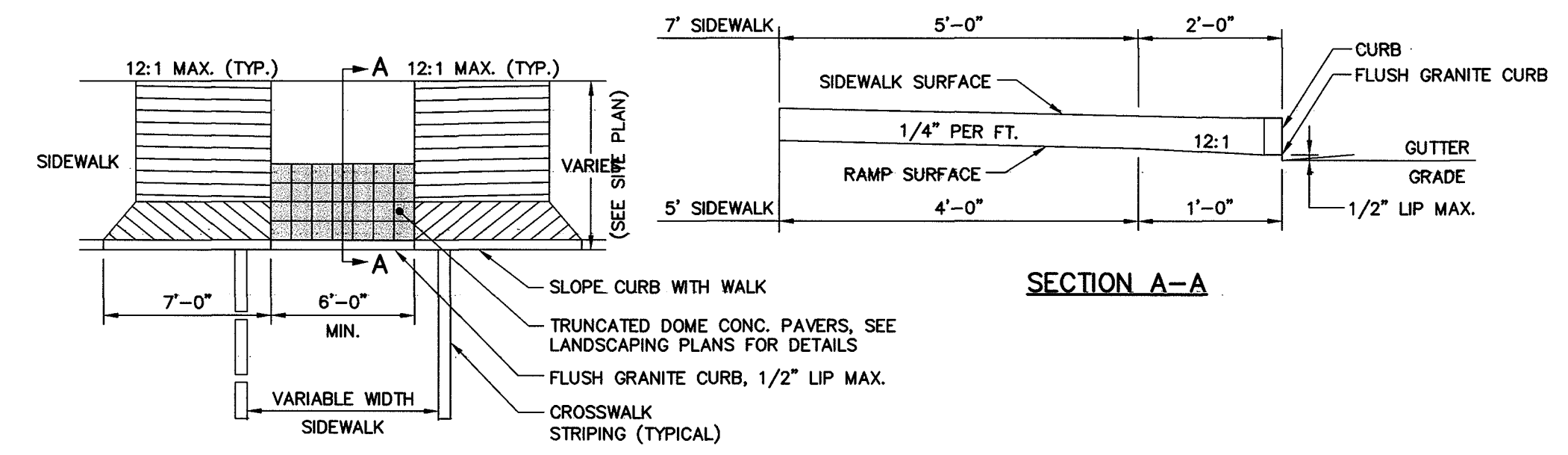

SECTION A-A

WALK THROUGH

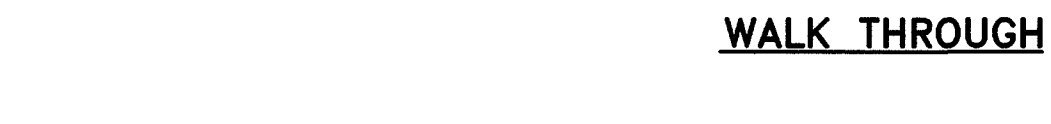

PLAN VIEW

SIDEWALK MOUNT

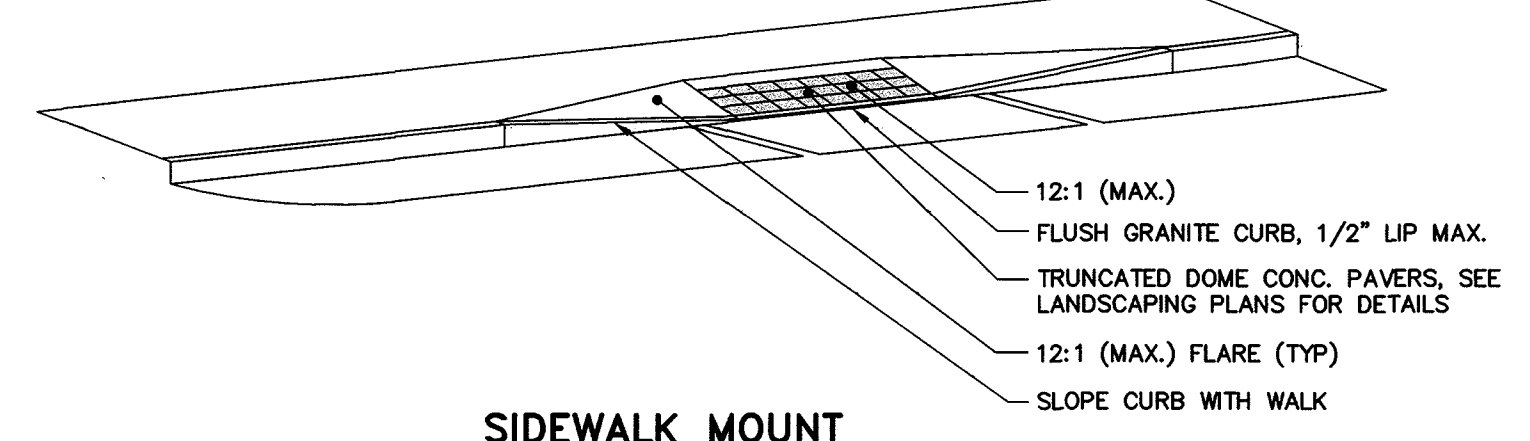

SIDEWALK MOUNT

ADA ACCESSIBLE CURB RAMP GENERAL NOTE:

- CURB OPENINGS FOR PEDESTRIAN RAMPS SHALL BE 6' MINIMUM.
- ALL ADA ACCESSIBLE CURB RAMPS SHALL HAVE TRUNCATED DOME CONC. PAVERS. SEE LANDSCAPING PLANS FOR DETAILS.

WOODARD & CURRAN
 Engineering - Science - Operations
 41 Hutchins Drive - Portland, Maine 04102

STATE OF MAINE
DEPARTMENT OF TRANSPORTATION
PROJECT NUMBER 009215.00

PROJ. MANAGER PAUL POTTLE
 DESIGN-DETAILED JBC
 CHECKED-REVIEWED DAS
 DESIGN-DETAILED DAS
 DESIGN-DETAILED DAS
 REVISIONS 1
 REVISIONS 2
 REVISIONS 3
 FIELD CHANGES 4

DATE 07/10/05
 DATE 07/10/05

SIGNATURE BARRY S. SHEFF
 P.E. NUMBER 9708
 DATE 1/24/05

CITY OF PORTLAND
OCEAN GATEWAY PHASE 1
CIVIL DETAILS - 6

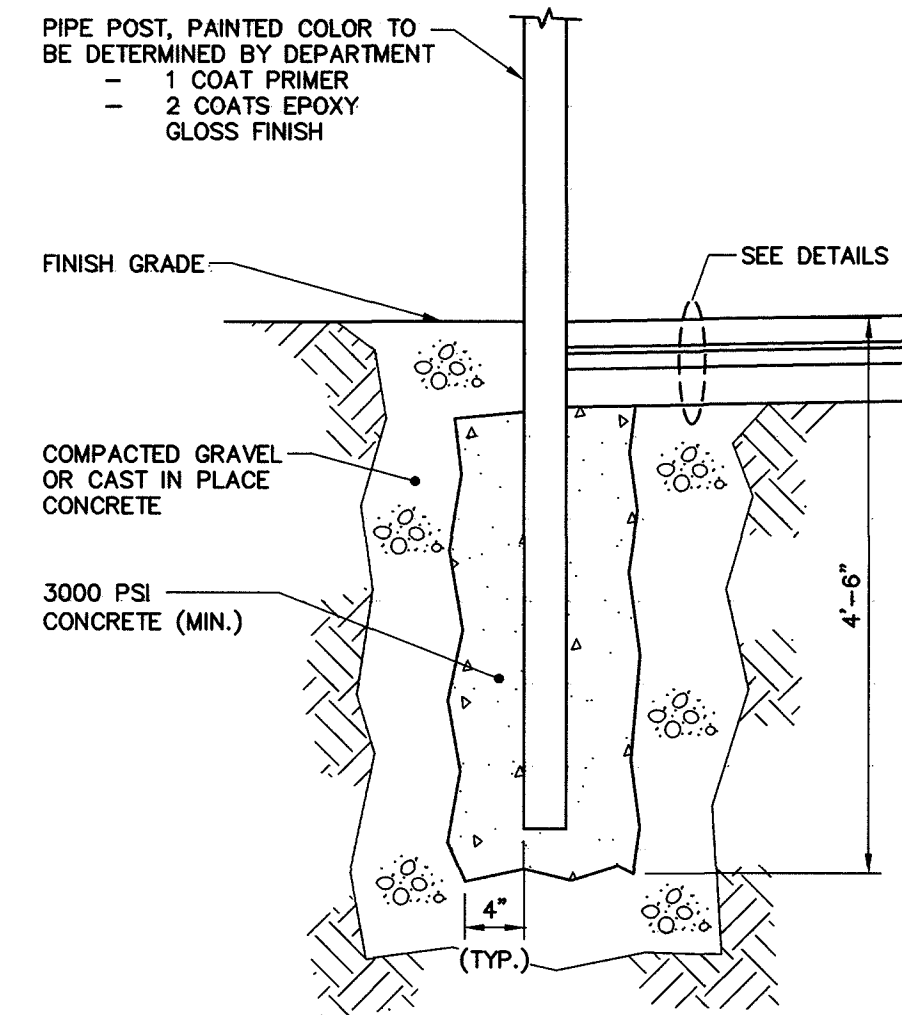

NOTES:

- POST DETAIL FOR USE IN INSTALLING PARKING METERS, STREET SIGNS, AND FACILITY SIGNAGE NOT MOUNTED ON POLES/MAST ARMS.
- ANNULAR SPACE BETWEEN FOOTING AND SURROUNDING MATERIAL SHALL BE FILLED TO ELIMINATE VOIDS.
- PARKING METER POST EMBEDMENT SHALL BE BETWEEN 30" AND 36". DRIVEN POST IS ALLOWABLE IN LIEU OF CONCRETE FOUNDATION; PARKING METER POST (PROVIDED BY CITY) SHALL BE DRIVEN WITH 18" LONG STEEL STRAND GUY WIRE THREADED THROUGH POST AT 6" FROM BOTTOM.

POST SCHEDULE			
TYPE	HEIGHT ABOVE FIN. GRADE	POST DIAMETER	POST MATERIAL
SNOW BAN SIGN	7'-0"	2 3/8" (I.D.)	GALV. STEEL
STREET SIGNAGE	7'-0"	2 3/8" (I.D.)	GALV. STEEL
STREET NAME	7'-0"	3 1/2" (I.D.)	GALV. STEEL
FACILITY SIGNAGE	13'-0"	4 1/2" (O.D.)	ALUMINUM SCH. 40
FACILITY SIGNAGE (DIRECTIONAL)	13'-0"	10 3/4" (O.D.)	ALUMINUM SCH. 40

TYPICAL POST DETAIL
N.T.S.

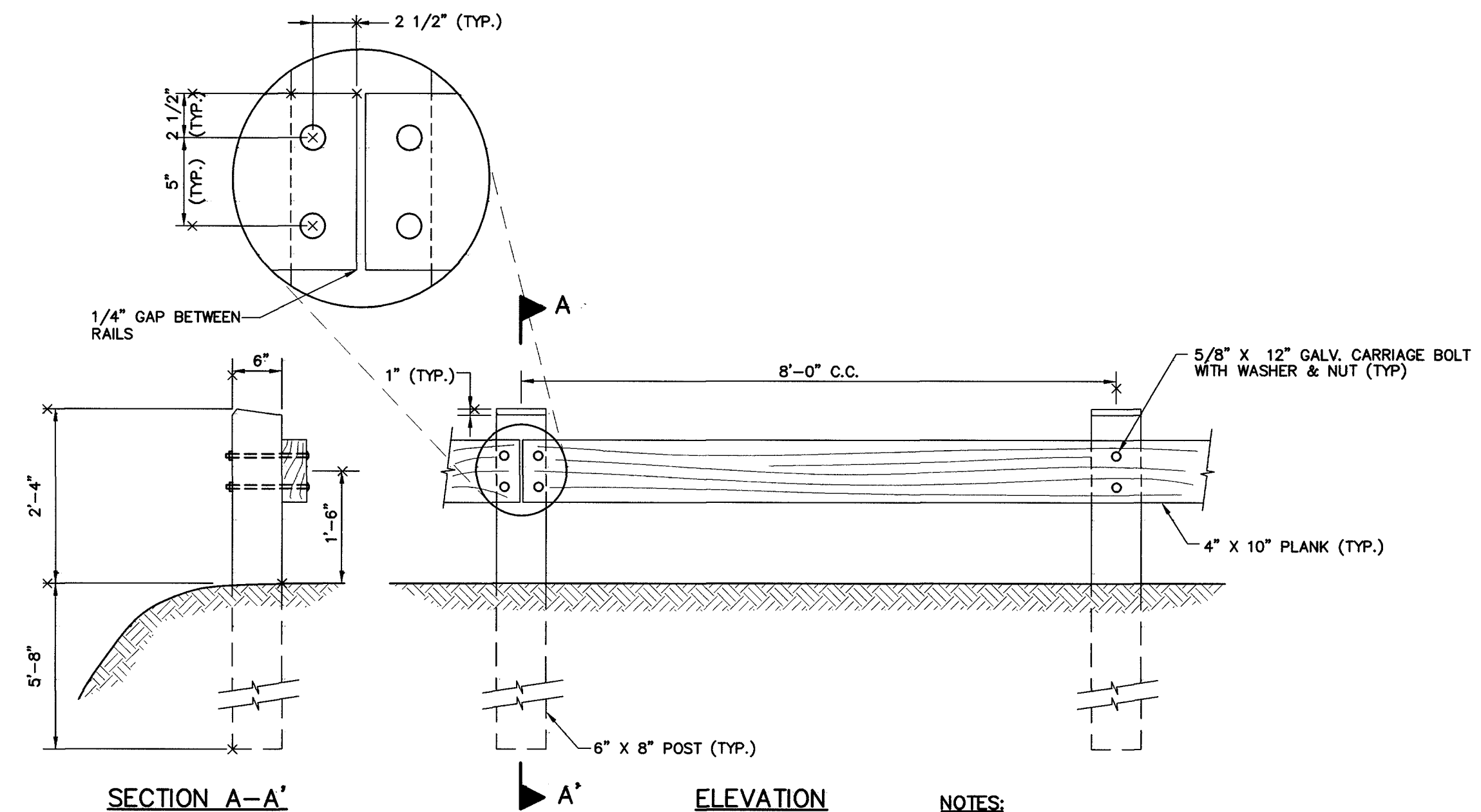

SECTION A-A'

ELEVATION

NOTES:

- ALL WOOD SHALL BE PRESSURE TREATED.
- ALL HARDWARE SHALL BE GALVANIZED.

WOOD GUARDRAIL
N.T.S.

C405