

Filename: O:\203438 Ocean Gateway - Phase 1 Engineering\Project Deliverables\2005-01-XX - BID Submittal\CAD Drawings\Civil\20343802-C219.dwg, Jan 14, 2005 - 2:57pm

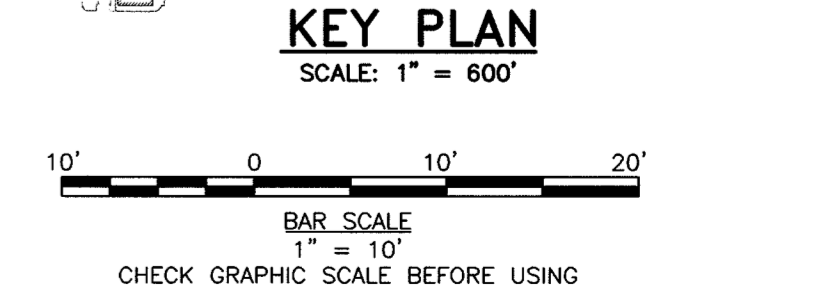
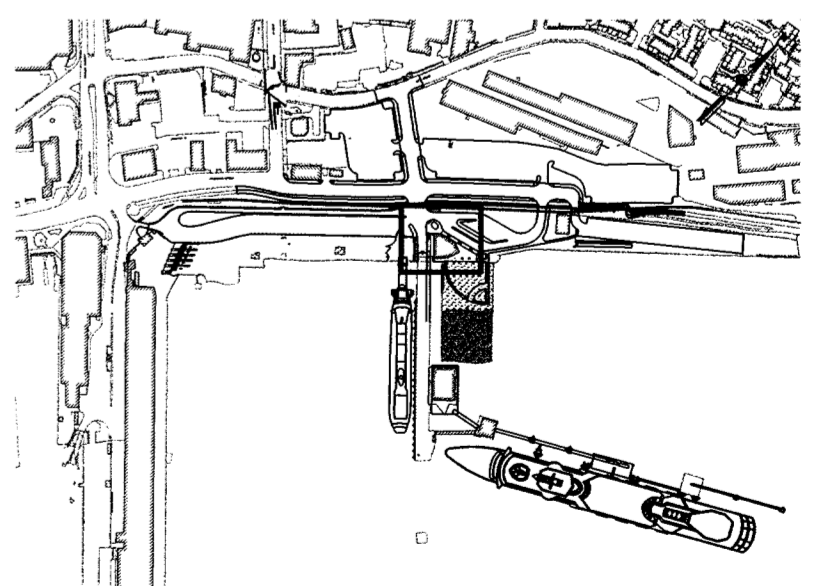
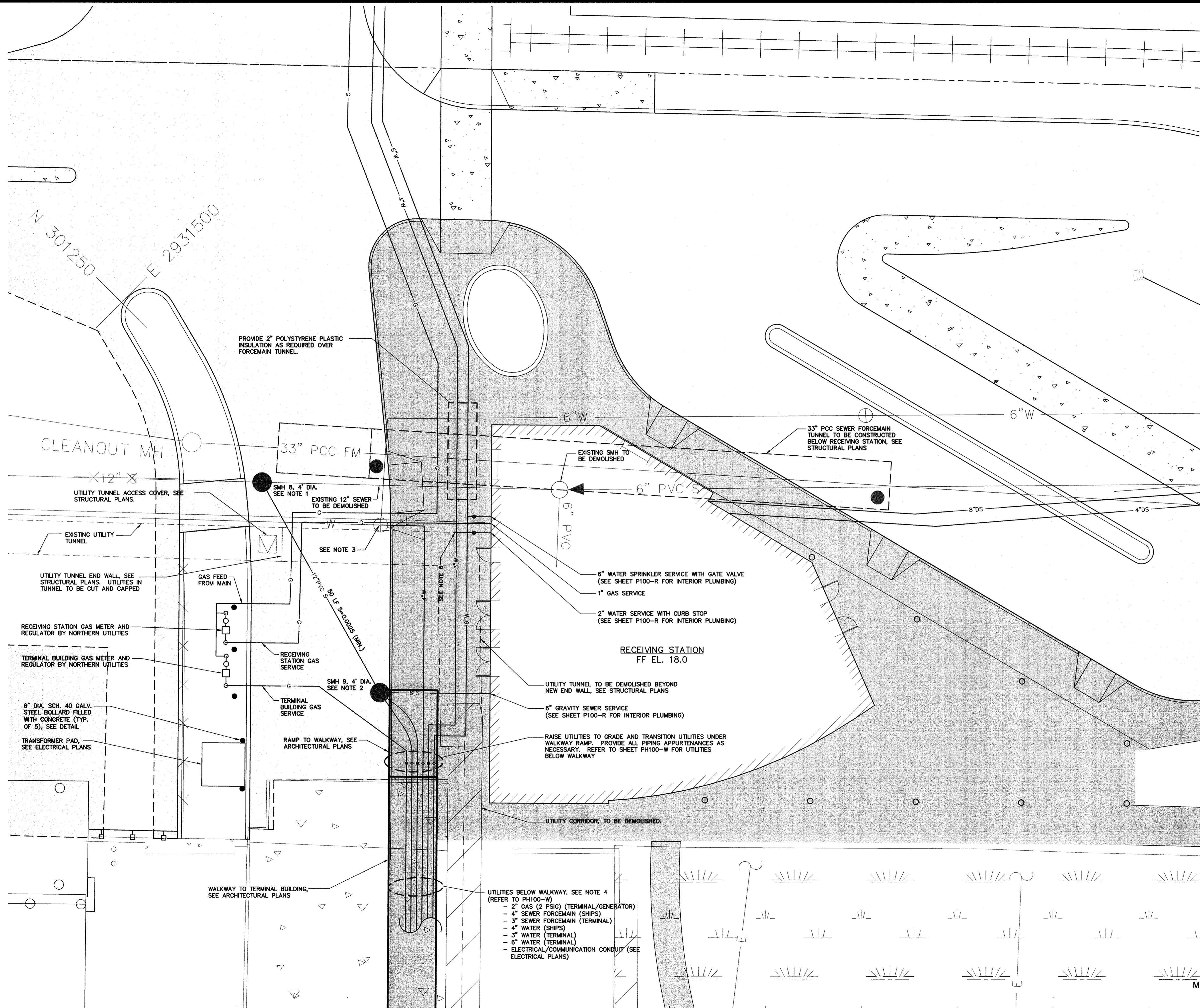

MLLW = 0.00 FT = -4.57 FT NGVD 1929 (CITY DATUM)

- NOTES:**
- TEST PIT REQUIRED TO DETERMINE INVERT OF EXISTING 12" SEWER. MANHOLE DEPTH AND INVERTS AS DETERMINED BY TEST PIT RESULTS.
  - SEWER MANHOLE DEPTH AS DETERMINED BY TEST PIT RESULTS AND SLOPE OF 12" PVC SEWER BETWEEN SMH 8 AND SMH 9.
  - REDUCE EXISTING 10" W TO 4" D.I. WATER BEYOND GATE VALVE FOR VESSEL SERVICE. EXISTING 6" SERVICE TO PAINT STORAGE BUILDING TO BE DEMOLISHED.
  - UTILITIES BENEATH WALKWAY LISTED LEFT TO RIGHT IN PLAN VIEW FOR CLARITY PURPOSES.
  - REMOVE AND DISPOSE EXISTING UTILITY SERVICES TO PAINT STORAGE BUILDING BELOW RECEIVING STATION. EVACUATE AND PROVIDE MECHANICAL JOINT CAPS AND RETAINER GLANDS ON ABANDONED WATER AND SEWER SERVICES EAST OF RECEIVING STATION. RECORD LOCATION OF ALL ABANDONED PIPE.
  - REDUCE 4" W TO 3" WATER BEYOND RECEIVING STATION SERVICE.

**WOODARD & CURRAN**  
Engineering · Science · Operations  
41 Hutchinson Drive · Portland, Maine 04102

STATE OF MAINE  
DEPARTMENT OF TRANSPORTATION  
PROJECT NUMBER 009215.00  
PIN  
009215.00

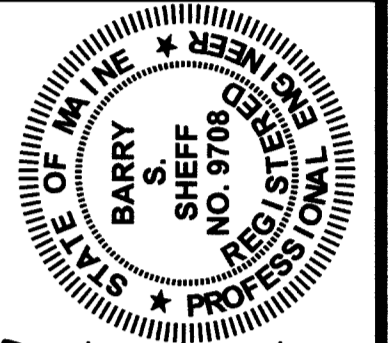

*Barry Suiff*  
SIGNATURE  
9708  
P.E. NUMBER  
1/14/05  
DATE

PROJ. MGR	PAUL POTTE	DATE	BY
DESIGN-DETAILED	DAS	01/14/05	JBC
CHECKED-REVIEWED	DAS	01/14/05	BSS
DESIGN-DETAILED	DAS		
DESIGN-DETAILED			
REVISIONS 1			
REVISIONS 2			
REVISIONS 3			
REVISIONS 4			
FIELD CHANGES			

CITY OF PORTLAND  
OCEAN GATEWAY PHASE 1  
RECEIVING STATION UTILITY PLAN

C219