

STRUCTURE DESIGNATION	RIM	NORTHING	EASTING
DMH 7	18.14	301367.55	2931417.41
DMH 8	19.97	301483.25	2931259.39

STRUCTURE DESIGNATION	RIM	NORTHING	EASTING
CB 10	18.23	301359.49	2931387.79
CB 11	18.10	301383.57	2931415.83
CB 15	18.50	301310.60	2931350.71
CB 19	19.76	301480.23	2931173.16
CB 20	19.90	301467.81	2931190.48

STRUCTURE DESIGNATION	RIM	NORTHING	EASTING
SMH 6	19.90	301440.32	2931297.70
SMH 7	20.35	301532.48	2931171.83

LINE	LENGTH	BEARING	START NORTHING & EASTING	END NORTHING & EASTING
L6	316.46	N53°47'21"W	N 301345.33 E 2931437.60	N 301532.28 E 2931182.27

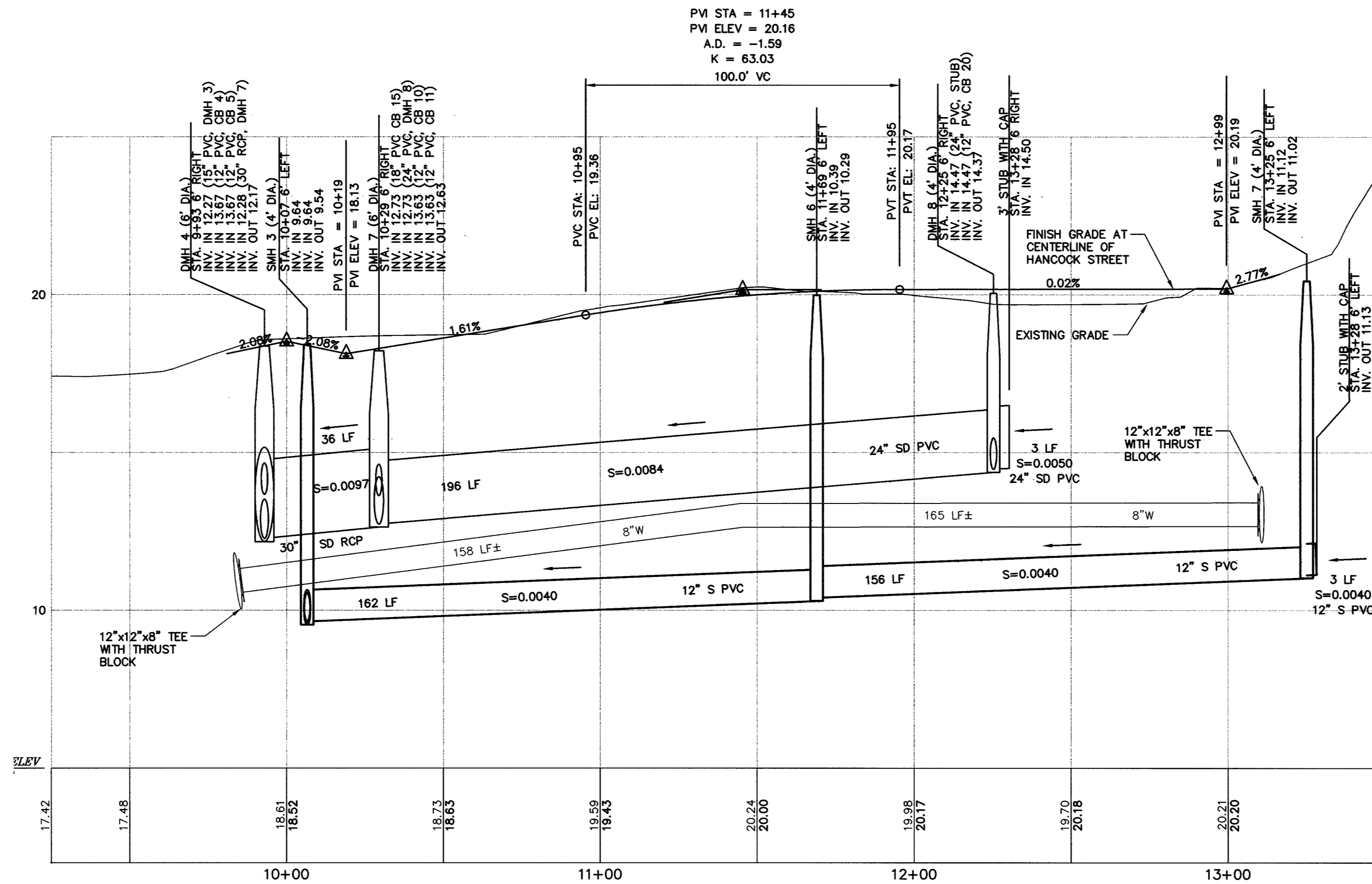

- NOTE:**
- FOR INFORMATION ON HORIZONTAL DATUM, VERTICAL DATUM AND CONTROL POINTS, SEE SHEET C001 AND C101.
  - INSTALLATION OF GAS MAIN AND APPURTENANCES BY NORTHERN UTILITIES. TRENCHING, BEDDING AND BACKFILL BY CONTRACTOR.
  - ALL STORM DRAIN LINES FROM CATCH BASINS TO DMH'S ARE 12" PVC, S=0.005, UNLESS OTHERWISE NOTED.
  - RIM ELEVATIONS PROVIDED FOR INFORMATIONAL PURPOSES. CONTRACTOR SHALL BE RESPONSIBLE FOR SETTING RIM ELEVATIONS IN ACCORDANCE WITH FINISH GRADES.
  - IN THE CASE THAT ALTERNATE 14 "SURFACE COURSE PAVEMENT ON CITY STREETS" IS ACCEPTED, ADJUST RIM ELEVATIONS OF STRUCTURES ACCORDINGLY.

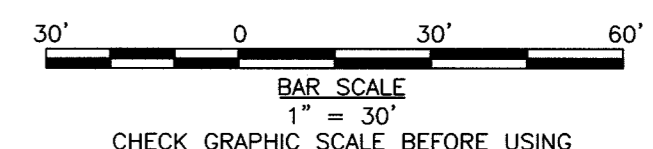
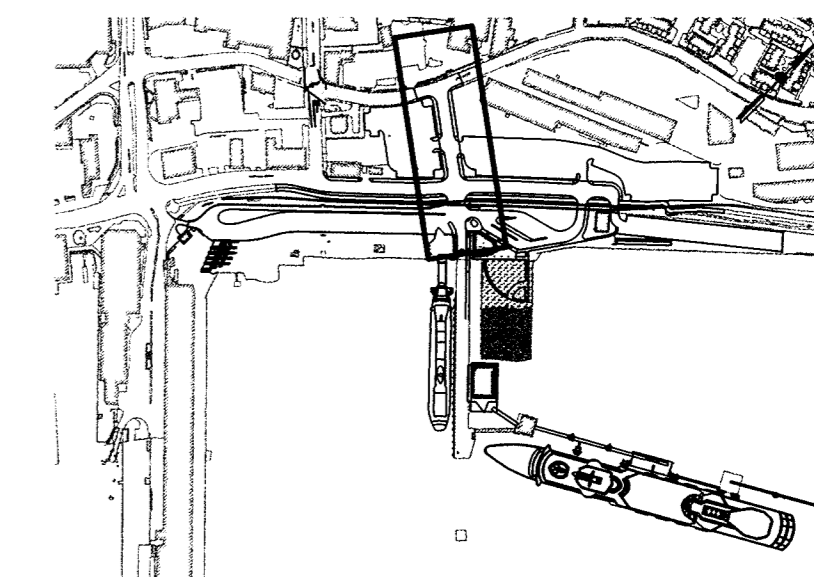

MLLW = 0.00 FT = -4.57 FT NGVD 1929 (CITY DATUM)

**WOODARD & CURRAN**  
Engineering • Science • Operations  
41 Hutchins Drive • Portland, Maine 04102

STATE OF MAINE  
DEPARTMENT OF TRANSPORTATION  
PROJECT NUMBER 009215.00  
PIN 009215.00



DATE: 01/14/05  
BY: Barry Suiff  
SIGNATURE: [Signature]  
P.E. NUMBER: 9708  
DATE: 1/14/05

PROJ. MANAGER	PAUL FORTLE	BY	DATE
DESIGN-DETAILED	DAS	BAR	01/14/05
CHECKED-REVIEWED	DAS	BSS	01/14/05
DESIGN-DETAILED	DAS		
DESIGN-DETAILED			
REVISIONS 1			
REVISIONS 2			
REVISIONS 3			
REVISIONS 4			
FIELD CHANGES			

CITY OF PORTLAND  
OCEAN GATEWAY PHASE 1  
HANCOCK STREET PLAN & PROFILE  
STA. 10+00 TO STA. 13+16

C215