

PLAN
SCALE: 1" = 30'

LINE	LENGTH	BEARING	START NORTING & EASTING	END NORTING & EASTING
L4	108.11	N46°24'59"E	N 301403.66 E 2931494.12	N 301478.20 E 2931572.43
L5	767.91	N47°28'43"E	N 301478.20 E 2931572.43	N 301987.20 E 2932158.40

STRUCTURE DESIGNATION	RIM	NORTING	EASTING
CB 6	17.49	301504.18	2931627.39
CB 7	17.52	301523.84	2931595.57
CB 8	17.05	301644.47	2931780.38
CB 9	17.00	301686.82	2931773.30
CB 16	17.30	301678.65	2931668.89

STRUCTURE DESIGNATION	RIM	NORTING	EASTING
DMH 5	17.72	301519.67	2931626.53
DMH 6	17.32	301648.82	2931767.36

STRUCTURE DESIGNATION	RIM	NORTING	EASTING
SMH 4	17.77	301515.58	2931604.32
SMH 5	17.24	301681.24	2931784.97

PVI STA = 18+87
PVI ELEV = 17.84
A.D. = 0.02
K = 4918.05
100.0' VC

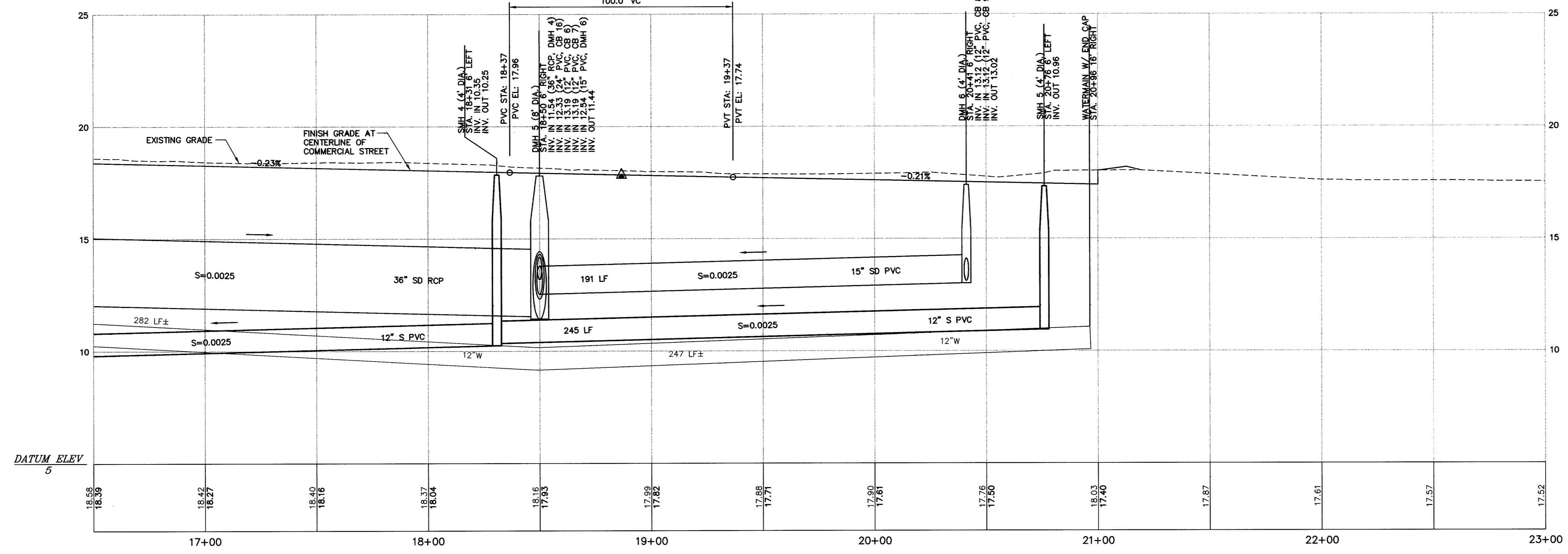

PROFILE
HORIZONTAL SCALE: 1" = 30'
VERTICAL SCALE: 1" = 3'

- NOTE:**
- FOR INFORMATION ON HORIZONTAL DATUM, VERTICAL DATUM AND CONTROL POINTS, SEE SHEET C001 AND C101.
 - INSTALLATION OF GAS MAIN AND APPURTENANCES BY NORTHERN UTILITIES. TRENCHING, BEDDING AND BACKFILL BY CONTRACTOR.
 - ALL STORM DRAIN LINES FROM CATCH BASINS TO DMH'S ARE 12" PVC, S=0.005, UNLESS OTHERWISE NOTED.
 - RIM ELEVATIONS PROVIDED FOR INFORMATIONAL PURPOSES. CONTRACTOR SHALL BE RESPONSIBLE FOR SETTING RIM ELEVATIONS IN ACCORDANCE WITH FINISH GRADES.
 - IN THE CASE THAT ALTERNATE 14 "SURFACE COURSE PAVEMENT ON CITY STREETS" IS ACCEPTED, ADJUST RIM ELEVATIONS OF STRUCTURES ACCORDINGLY.

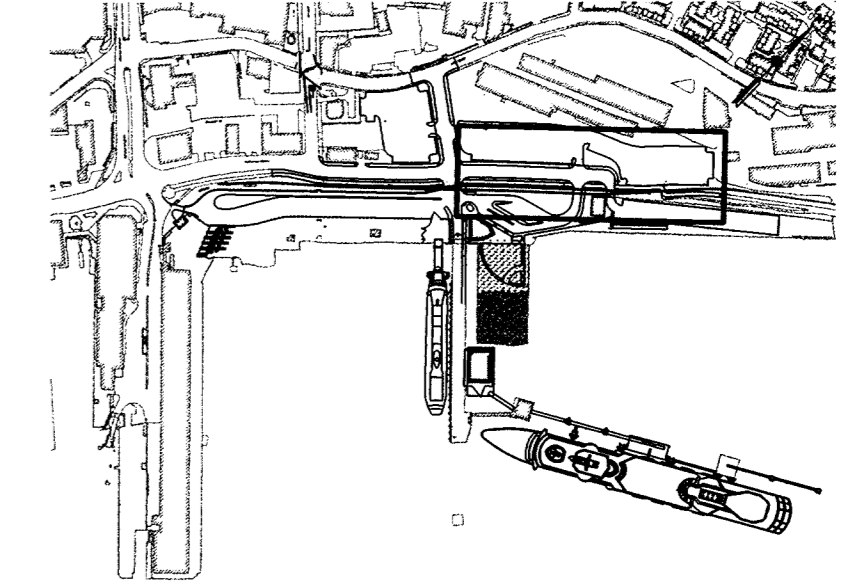

KEY PLAN
SCALE: 1" = 600'

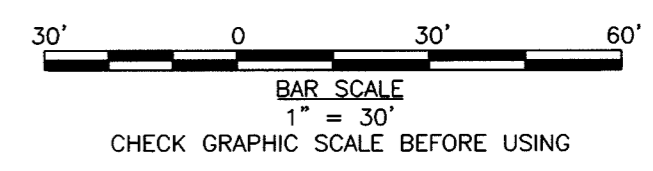

MLLW = 0.00 FT = -4.57 FT NGVD 1929 (CITY DATUM)

WOODARD & CURRAN
Engineering • Science • Operations
41 Hutchins Drive • Portland, Maine 04102

STATE OF MAINE
DEPARTMENT OF TRANSPORTATION
PROJECT NUMBER 009215.00
PIN 009215.00

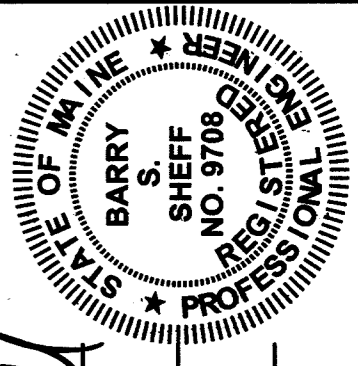

PROJ. MANAGER: PAUL POTTE
BY: [Signature]
DATE: 01/14/05
CHECKED: [Signature] DAS
DESIGN: [Signature] DAS
DESIGN: [Signature] DAS
REVISIONS: 1
REVISIONS: 2
REVISIONS: 3
REVISIONS: 4
FIELD CHANGES

CITY OF PORTLAND
OCEAN GATEWAY PHASE 1
COMMERCIAL STREET PLAN & PROFILE
STA. 16+50 TO STA. 23+00