

DEMOLITION PLAN LEGEND

- 01 NOT USED
- 02 REMOVE STAIR HANDRAILS & BALUSTERS.
- 03 REMOVE WALL AS REQUIRED FOR NEW CONSTRUCTION.
- 04 REMOVE MILLWORK - PROVIDE SMOOTH LEVEL SURFACE FOR APPLICATION OF SCHEDULED FLOORING
- 05 REMOVE DOOR, DOOR FRAME & ALL ASSOCIATED HARDWARE AS REQUIRED FOR NEW CONSTRUCTION.
- 06 REMOVE EXISTING INSH1 & RESTORE EXISTING OPENING - PREPARE ALL AFFECTED SURFACE SMOOTH & LEVEL FOR APPLICATION OF SCHEDULED FINISHES.

EXISTING EMERGENCY LIGHTING LEGEND

- ☐ FE Existing Fire Extinguisher
- ☐ Existing Emergency Light
- ☐ Existing Exit Sign

NOTE: EXISTING TENANT SPACES EQUIPPED w/ SPRINKLER FIRE SUPPRESSION

J1 EXISTING CONDITIONS PLAN & PROPOSED DEMOLITION PLAN

J16 LEGEND

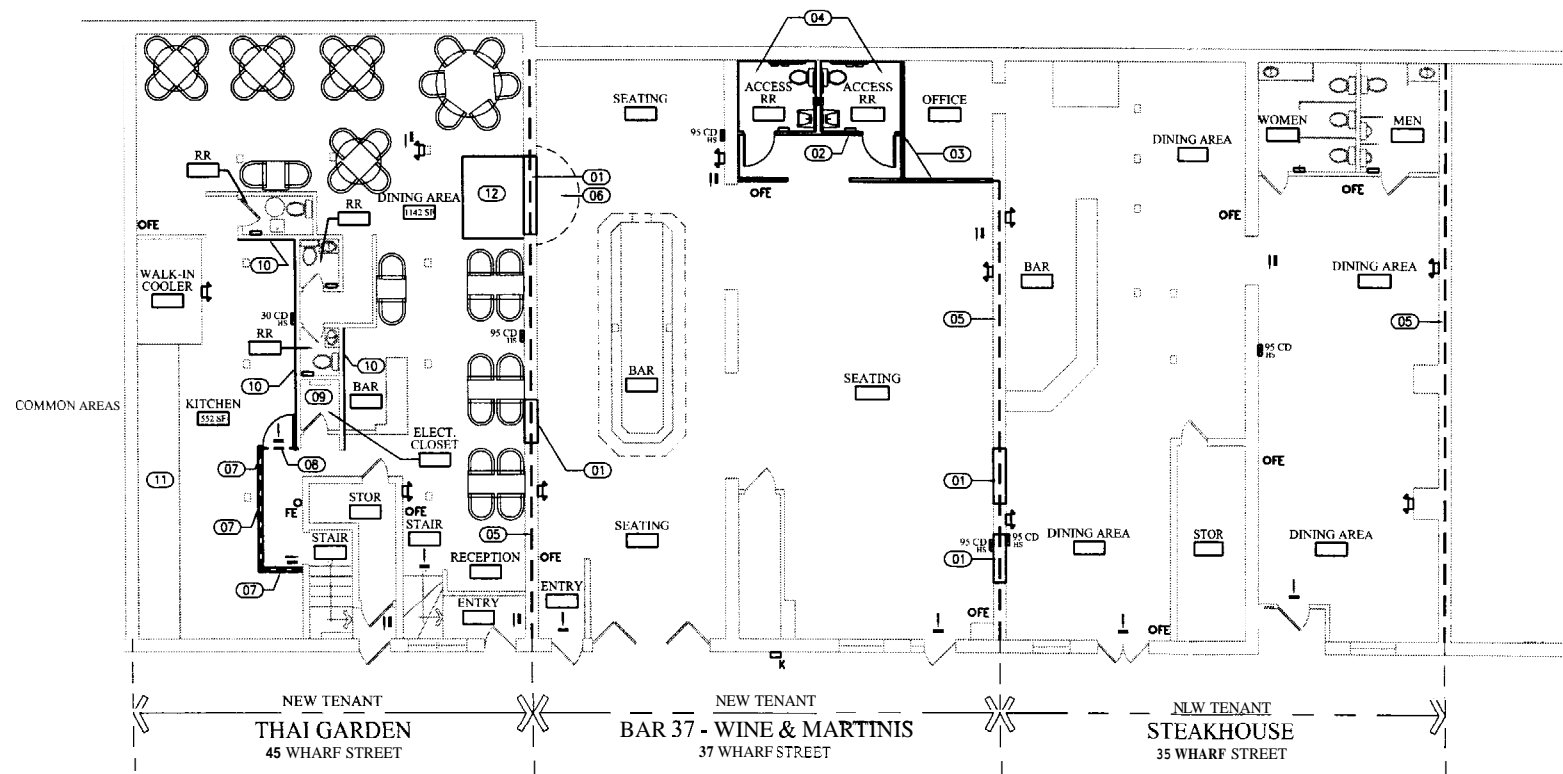

FLOOR PLAN LEGEND

- 01 INFILL EXISTING WALL w/ BRICK - MATCH EXISTING BRICK SIZE, COURSE & BONDING - PROVIDE 2 HOUR FIRE RATING TO MATCH EXISTING FIRE RATING.
- 02 WALL PARTITION - 5/8" TYPE 'X' GWB OF EACH SIDE OF 1.5" MTL STUDS @ 16" o.c. FROM TOP FLOOR TO UNDERSIDE OF FLOOR DECK ABOVE - PROVIDE MOISTURE RESISTANCE GWB IN ALL WET AREAS EXCEPT @ RATED WALL ASSEMBLIES.
- 03 2 HOUR FIRE RATED WALL ASSEMBLY (UL NO. 475) - 2 LAYERS 5/8" TYPE 'X' GWB OF EACH SIDE OF 3 5/8" MTL STUDS @ 16" o.c. FROM TOP OF FLOOR DECK TO UNDERSIDE OF FLOOR DECK ABOVE.
- 04 ACCESSIBLE RESTROOM - ALL FIXTURES AND CLEARANCE PER ADAG GUIDELINES.
- 05 EXISTING 2 HOUR RATED BRICK FIRE ASSEMBLY.
- 06 INFILL EXISTING STAIR OPENING - SMOOTH & FLUSH AS REQUIRED FOR SMOOTH LEVEL APPLICATION OF SCHEDULED FLOORING.
- 07 1 HOUR FIRE RATED WALL ASSEMBLY (UL NO. 465) - 5/8" TYPE 'X' GWB OF EACH SIDE OF 3 5/8" MTL STUDS @ 16" o.c. FROM TOP FLOOR TO UNDERSIDE OF FLOOR DECK ABOVE.
- 08 PROVIDE 1 HOUR RATED DOOR & FRAME.
- 09 REVISE AND REWORK ELECTRICAL CLOSET TO PROVIDE SMOKE PROOF ENCLOSURE - PROVIDE SMOKE PROOF GASKET FOR EXISTING ELECTRICAL CLOSET DOOR. PROVIDE SIGN READING "NO STORAGE ALLOWED".
- 10 EXISTING WALL TO BE MODIFIED - ADD 5/8" 1 TYPE 'X' GWB TO KITCHEN SIDE AND BAR SIDE OF WALL FROM TOP FLOOR TO UNDERSIDE OF FLOOR DECK ABOVE.
- 11 EXISTING FIRE SUPPRESSION/EXHAUST SYSTEM - A LETTER ON EXHAUST HOOD MAINTENANCE WILL BE PROVIDED BY OWNER AND PLANS FOR THE SYSTEM BY OWNER.
- 12 NEW FOUNTAIN PLATFORM BY OWNER.

EMERGENCY LIGHTING LEGEND

- ☐ Fire Extinguisher
- ☐ Emergency Light
- ☐ Exit Sign
- ☐ Horn Strobe
- ☐ Strobe
- ☐ Knox Box w/ Keys To All Three Tenants

NOTES:
 1. EXISTING SPRINKLER FIRE SUPPRESSION SYSTEM SHALL BE MODIFIED TO BE NFPA 13 CERTIFIED IN NEW TENANT SPACES.
 2. PROVIDE NFPA 72 COMPLIANT FIRE ALARM SYSTEM.

A1 PROPOSED REVISED FLOOR PLAN

A16 LEGEND



GAWRON TURGEON ARCHITECTS
 29 Black Point Road
 Scarborough, ME 04074
 www.gawronturgeon.com
 Tel 202.883.6307
 Fax 202.883.0361

45-37-35 WHARF STREET
 Proposed Renovations
 Portland, Maine

REVISIONS		
#	DATE	DESCRIPTION

DATE:	11.07.05
PROJECT #:	100305
DRAWN BY:	DMR
CHECKED BY:	DMR
DRAWING SCALE:	1/8" = 1'-0"

SHEET TITLE
PLANS

A100

© COPYRIGHT 1985-2005
 BY DESIGN OR BY DESIGN OF
 DESIGN & ARCHITECTURE
 ARCHITECTS & INTERIORS
 GAWRON ARCHITECTS IS PROHIBITED

883-630

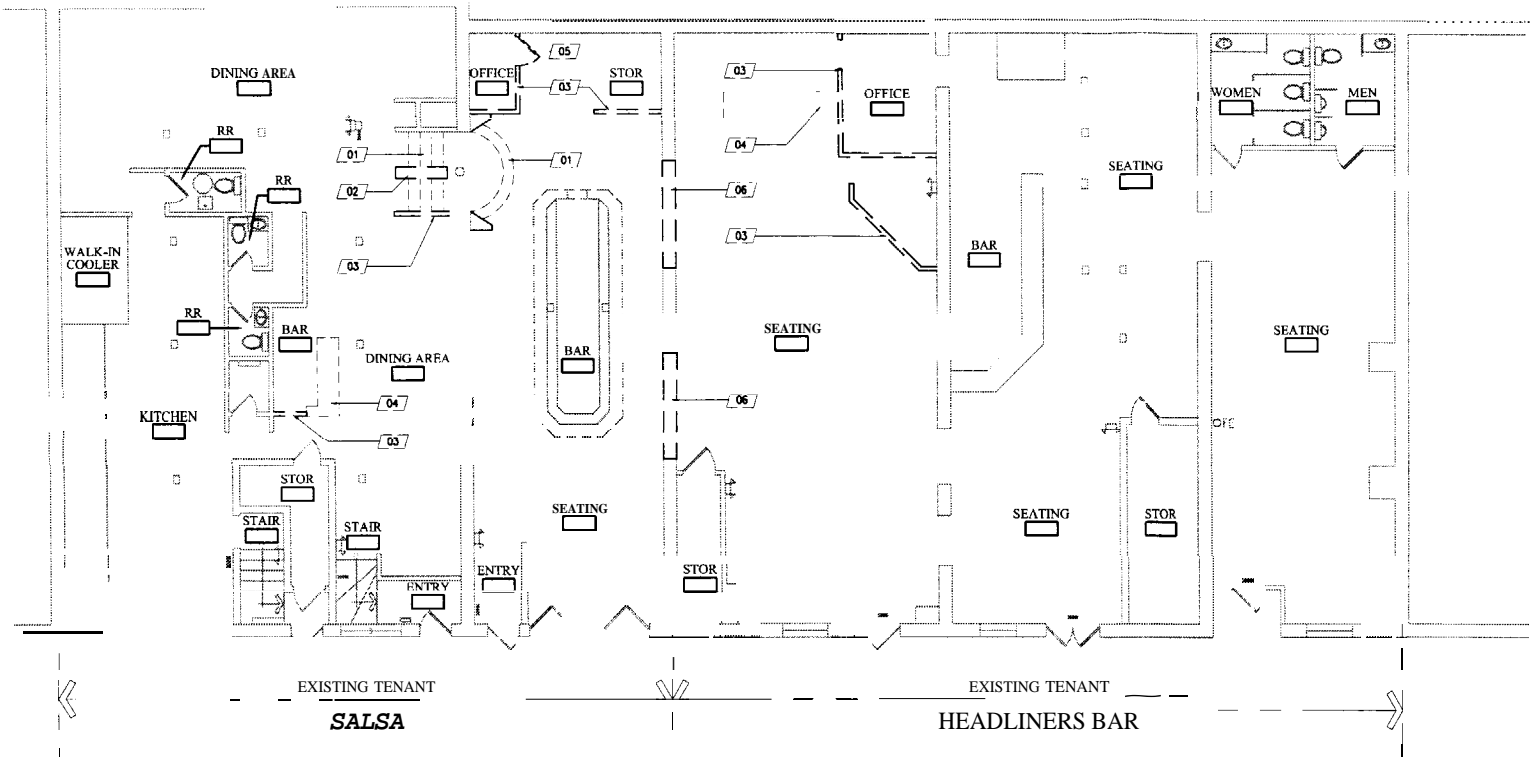

DEMOLITION PLAN LEGEND

- 01 REMOVE STAIRS - PROVIDE SMOOTH LEVEL SURFACE FOR APPLICATION OF SCHEDULED FLOORING.
- 02 REMOVE STAIR HANDRAILS & BALUSTERS.
- 03 REMOVE WALL AS REQUIRED FOR NEW CONSTRUCTION.
- 04 REMOVE MILLWORK - PROVIDE SMOOTH LEVEL SURFACE FOR APPLICATION OF SCHEDULED FLOORING.
- 05 REMOVE DOOR, DOOR FRAME & ALL ASSOCIATED HARDWARE AS REQUIRED FOR NEW CONSTRUCTION.
- 06 REMOVE EXISTING INFILL & RESTORE EXISTING OPENING - PREPARE ALL AFFECTED SURFACE SMOOTH & LEVEL FOR APPLICATION OF SCHEDULED FINISHES.

EXISTING EMERGENCY LIGHTING LEGEND

- OFE Existing Fire Extinguisher
- Existing Emergency Light
- Existing Exit Sign

NOTE: EXISTING TENANT SPACES EQUIPPED w/ SPRINKLER FIRE SUPPRESSION

**GAWRON
TURGEON
ARCHITECTS**
29 Black Point Road
Scarborough, ME 04074
www.gawronturgen.com
Tel. 207.883.6307
Fax: 207.883.6361

45-37-35 WHARF STREET
Proposed Renovations
Portland, Maine

J1 EXISTING CONDITIONS PLAN & PROPOSED DEMOLITION PLAN

J16 LEGEND

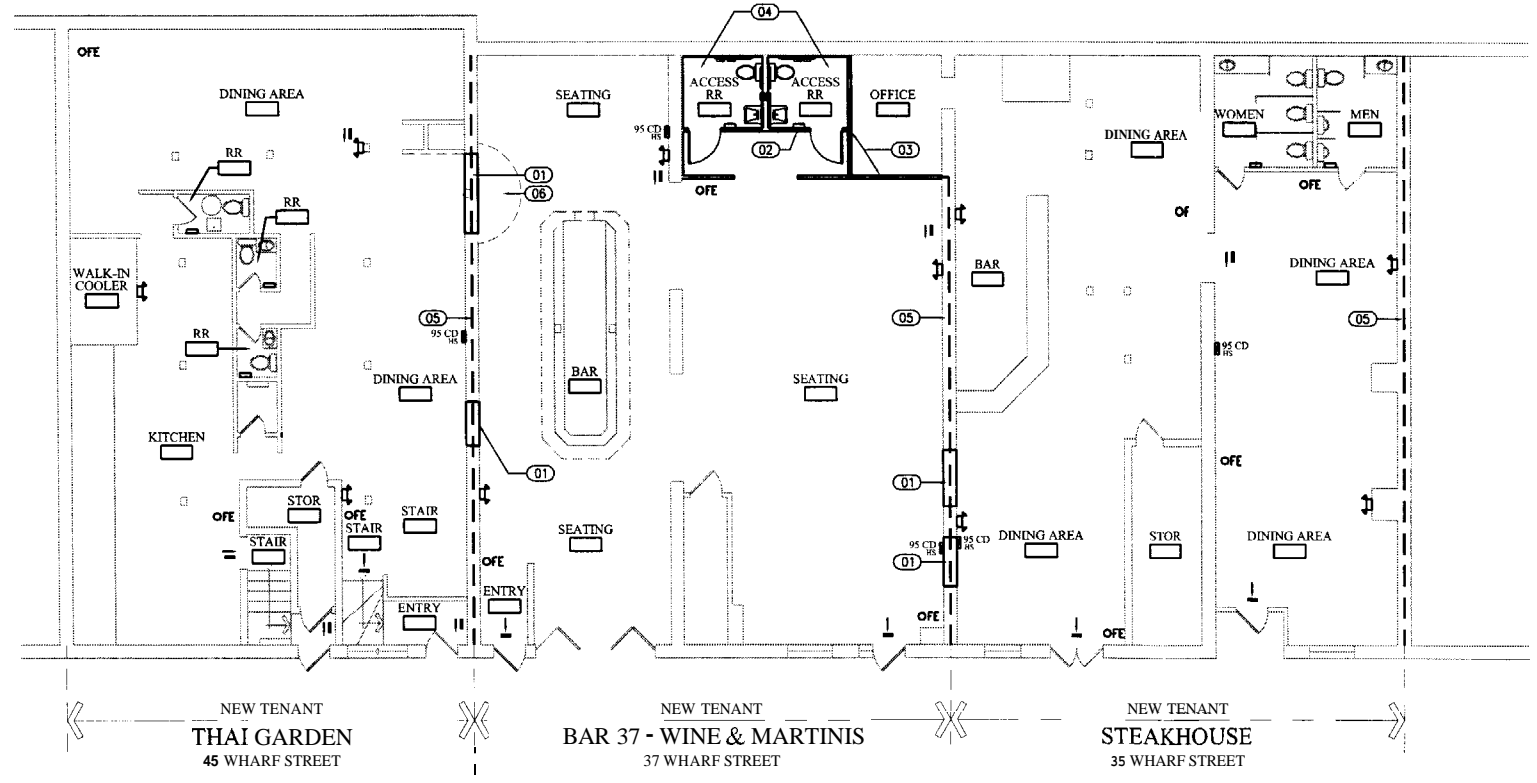

FLOOR PLAN LEGEND

- 01 INFILL EXISTING WALL w/ BRICK - MATCH EXISTING BRICK SIZE, COURSE & BONDING - PROVIDE 2 HOUR FIRE RATING TO MATCH EXISTING FIRE RATING.
- 02 WALL PARTITION - 5/8" TYPE 'X' GWB @ EACH SIDE OF 3/8" MTL STUDS @ 16" o.c. FROM TOP FLOOR TO UNDERSIDE OF FLOOR DECK ABOVE - PROVIDE MOISTURE RESISTANCE GWB IN ALL WET AREAS EXCEPT @ RATED WALL ASSEMBLIES.
- 03 2 HOUR FIRE RATED WALL ASSEMBLY (UL NO 425) - 2 LAYERS 5/8" TYPE 'X' GWB @ EACH SIDE OF 3/8" MTL STUDS @ 16" o.c. FROM TOP OF FLOOR DECK TO UNDERSIDE OF FLOOR DECK ABOVE.
- 04 ACCESSIBLE RESTROOM - ALL FIXTURES AND CLEARANCE PER ADA/GUIDELINES.
- 05 EXISTING 2 HOUR RATED BRICK FIRE ASSEMBLY.
- 06 INFILL EXISTING STAIR OPENING - SMOOTH & FLUSH AS REQUIRED FOR SMOOTH LEVEL APPLICATION OF SCHEDULED FLOORING.

--- 2 HOUR FIRE RATE ASSEMBLY - TENANT DEMISING WALL

EMERGENCY LIGHTING LEGEND

- OFE Fire Extinguisher
- Emergency Light
- Exit Sign
- HORN STROBE
- STROBE

NOTE: EXISTING SPRINKLER FIRE SUPPRESSION SYSTEM SHALL BE MODIFIED TO MATCH NEW

REVISIONS	
DATE	DESCRIPTION

DATE:	10.25.05
DIRECT #:	100305
AWN BY:	DMR
CHECKED BY:	DMR
AWNING SCALE:	1/8" = 1'-0"

SHEET TITLE
PLANS

A100

© COPYRIGHT 1985-2005
REPRODUCTION OR REUSE OF
THIS DOCUMENT IS PROHIBITED
UNLESS AUTHORIZED BY THE
ARCHITECT, IN WRITING