

**GENERAL NOTES**

1. THE RECORD OWNER OF THE PARCEL IS THE CITY OF PORTLAND, 388 CONGRESS STREET, PORTLAND, ME 04101. THE PROPERTY ADDRESS IS 6 COMMERCIAL STREET, PORTLAND, ME 04101 AND IS LOCATED IN THE EASTERN WATERFRONT PORT ZONE (EWPZ). THE SUBJECT PARCEL IS SHOWN AS CHART 444, BLOCK 029, LOT 001 IN THE CITY ACCESSORS'S DATABASE.
2. PROPERTY, SITE AND TOPOGRAPHIC DATA SHOWN HEREON IS FROM A COMBINATION OF AVAILABLE CITY GIS INFORMATION AND DATA FROM PLAN REFERENCE B. ENTITIES DEPICTED HEREON WERE NOT FIELD VERIFIED FOR ACCURACY OR OMISSIONS.
3. VERTICAL AND HORIZONTAL DATUMS REFERENCED IN PLAN REFERENCE A.
4. PLAN REFERENCES:
  - A. SHEET C001, CIVIL GENERAL NOTES, LEGEND, ABBREVIATIONS AND BORING LOGS, OCEAN GATEWAY PHASE I FOR CITY OF PORTLAND BY WOODARD & CURRAN, LATEST REVISION 10/11/24.
  - B. SHEET C100, EXISTING CONDITIONS PLANS, OCEAN GATEWAY PHASE I FOR CITY OF PORTLAND BY WOODARD & CURRAN, LATEST REVISION 10/11/24.
5. THE UTILITY LOCATIONS DEPICTED HEREON ARE APPROXIMATE AND COMPILED USING AVAILABLE CITY GIS DATA. REQUIRE FIELD VERIFICATION BY THE CONTRACTOR PRIOR TO CONSTRUCTION ACTIVITY. UTILITIES DEPICTED HEREON MAY NOT NECESSARILY REPRESENT ALL EXISTING UTILITIES. CONTRACTORS AND/OR DESIGNERS NEED TO CONTACT DIG-SAFE SYSTEMS, INC. (1-888-DIG-SAFE) AND FIELD VERIFY EXISTING UTILITIES PRIOR TO CONSTRUCTION AND/OR EXCAVATION.
6. ALL SEDIMENT AND EROSION CONTROL MEASURES SHALL BE INSTALLED IN ACCORDANCE WITH "MAINE EROSION AND SEDIMENT CONTROL BEST PRACTICES" MANUAL PUBLISHED BY BUREAU OF LAND AND WATER QUALITY MAINE DEPARTMENT OF ENVIRONMENTAL PROTECTION MARCH 2009 OR LATEST EDITION. IT SHALL BE THE RESPONSIBILITY OF THE CONTRACTOR TO POSSESS A COPY OF THE EROSION CONTROL PLAN AT ALL TIMES.

**LEGEND**

EXISTING	DESCRIPTION	PROPOSED
---	BOUNDARY LINE/ROW	---
---	ABUTTER LINE/ROW	---
---	EASEMENT	---
---	ZONE LINE	---
○	BENCHMARK	○
▭	BUILDING	▭
+	SIGN	+
---	EDGE PAVEMENT	---
---	EDGE CONCRETE	---
---	PAVEMENT PAINT	---
---	GRAVEL ROAD	---
---	CURBLINE	---
---	EDGE WATER	---
---	TREELINE	---
○	TREE	○
---	FENCE	---
---	RETAINING WALL	---
---	GUARDRAIL	---
○	BOLLARD	○
---	RAILROAD	---

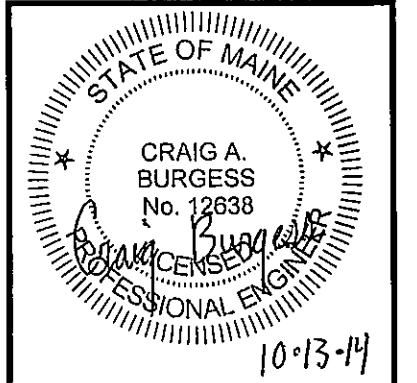
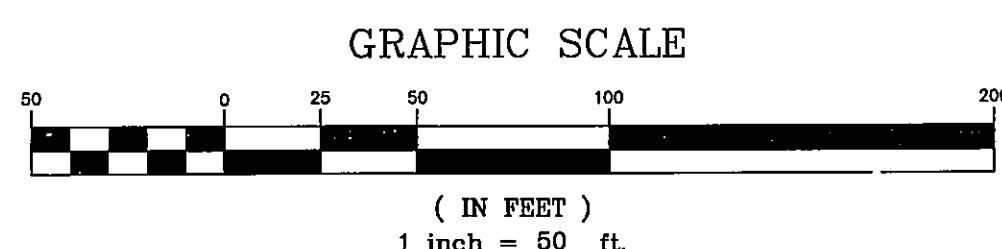

REV.	BY:	DATE:	STATUS:
A	OAM	03-18-14	REMOVED LOADING DOCK RAMP & RETAINING WALL
B	OAM	10-13-14	CONCEPT, SUBMITTED FOR REVIEW

THIS PLAN SHALL NOT BE MODIFIED WITHOUT PERMISSION FROM SEBAGO TECHNICS, INC. ANY ALTERATIONS, AUTHORIZED OR OTHERWISE, SHALL BE AT THE USER'S SOLE RISK AND WITHOUT LIABILITY TO SEBAGO TECHNICS, INC.

PROJECT NO.	FIELD BOOK	DESIGN	CHKD	DRAWN
13430		DAM/CAB	OAM	CAB

**SEBAGO**  
TECHNICS  
WWW.SEBAGOTECHNICS.COM  
76 John Roberts Rd., Suite 1A  
South Portland, ME 04106  
Tel: 207-265-5100

OVERALL SITE PLAN  
OF:  
**MAINE STATE PIER PROCESSING FACILITY**  
COMMERCIAL STREET  
PORTLAND, MAINE 04101  
FOR:  
**SHUCKS MAINE LOBSTER**  
150 MAIN STREET  
RICHMOND, ME 04357

DATE	SCALE
03-20-14	1"=50'

CASCO BAY

TUG BOAT AREA

CONCRETE

MAINE STATE PIER

OPTION SPACE

OPTION SPACE

OPTION SPACE

APPROXIMATE BUILDING DIVIDE

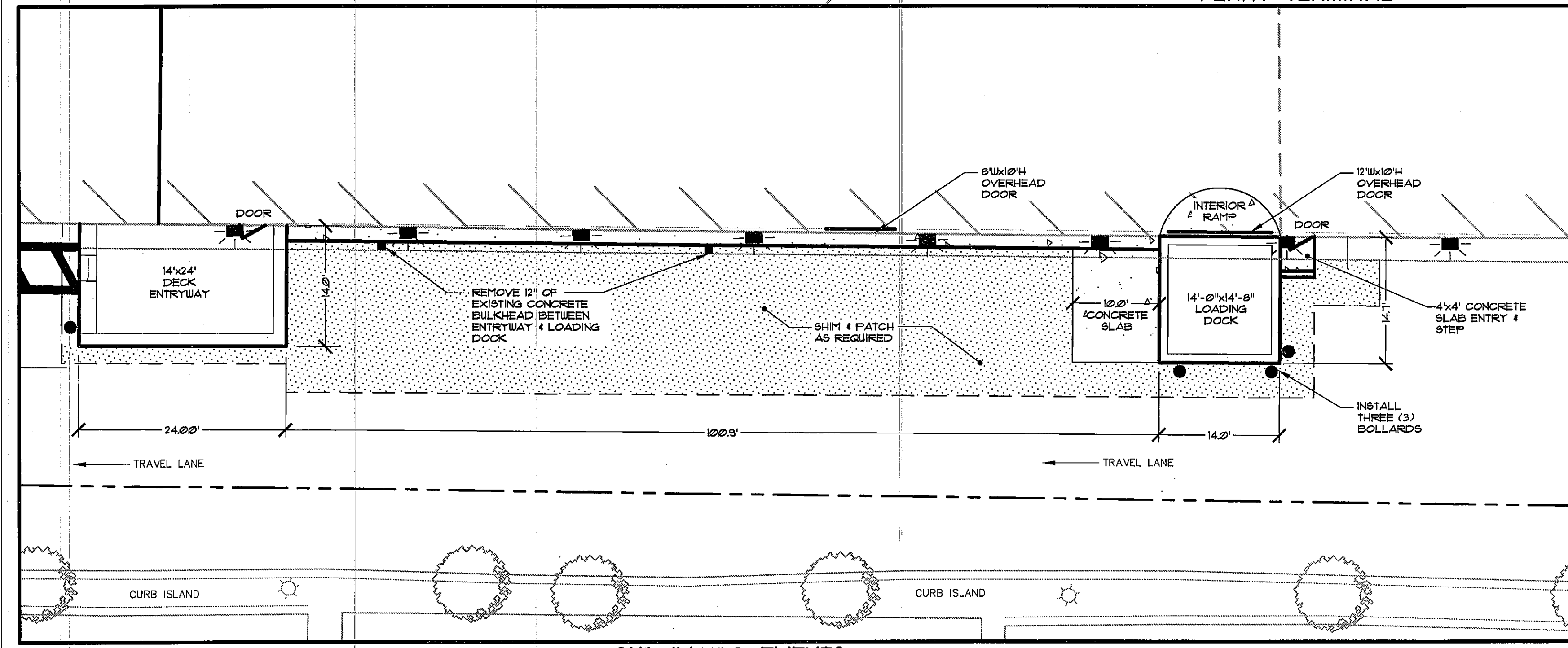
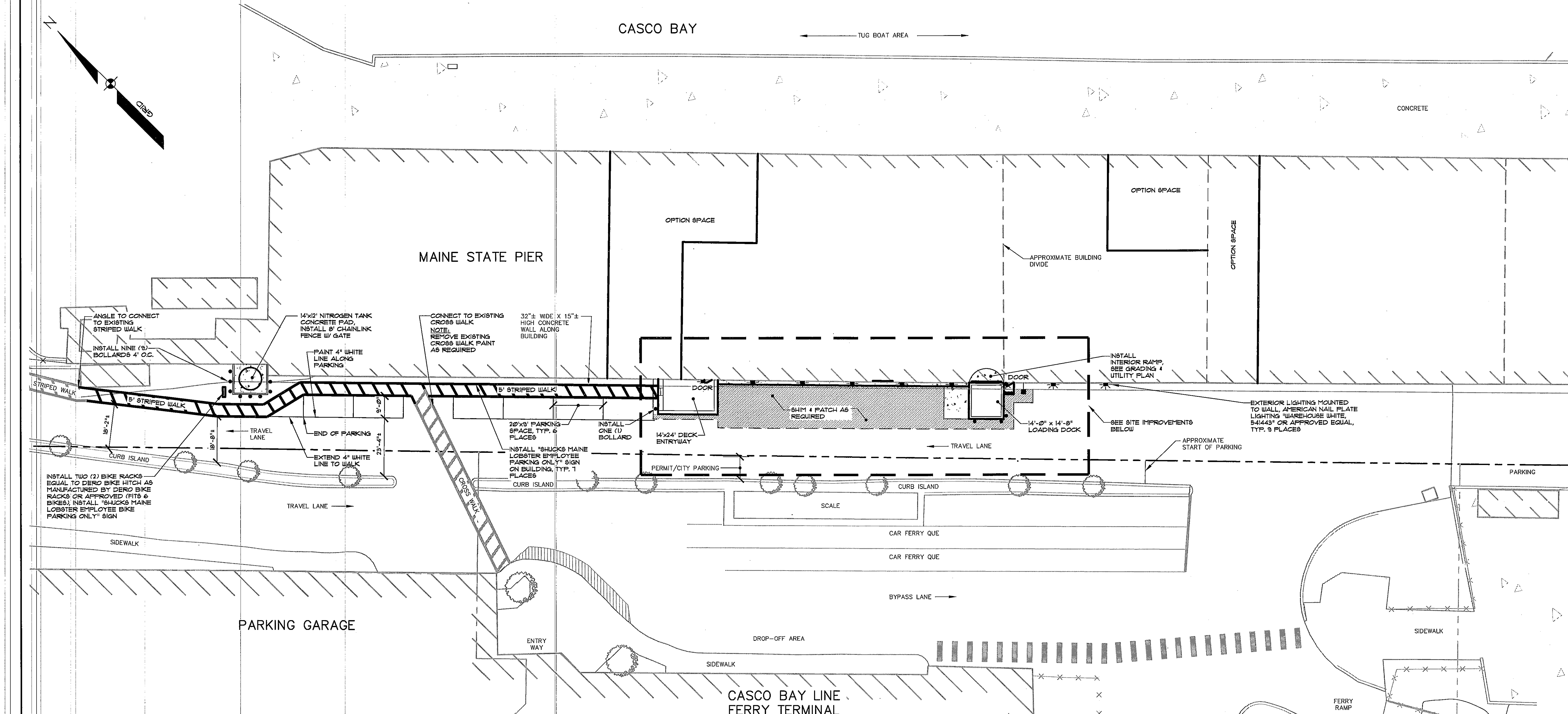

SITE IMPROVEMENTS  
SCALE: 1"=10'

LEGEND

EXISTING	DESCRIPTION	PROPOSED
---	BOUNDARY LINE/ROW	---
---	ABUTTER LINE/ROW	---
---	EASEMENT	---
---	ZONE LINE	---
---	BENCHMARK	---
---	BUILDING	---
---	SIGN	---
---	EDGE PAVEMENT	---
---	EDGE CONCRETE PAVEMENT PAINT	---
---	GRAVEL ROAD	---
---	CURBLINE	---
---	EDGE WATER	---
---	TREELINE	---
---	TREE	---
---	FENCE	---
---	RETAINING WALL	---
---	GUARDRAIL	---
---	BOLLARD	---

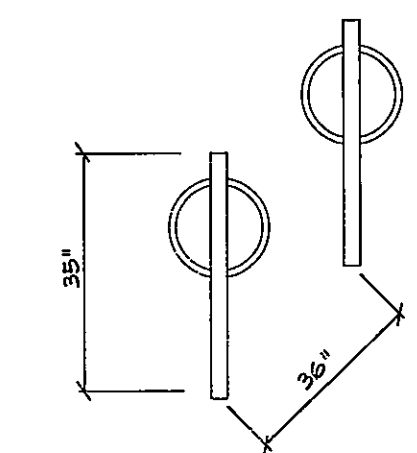

NOTES:  
 1. BIKE RACK SHALL EQUAL DERO BIKE HITCH AS MANUFACTURED BY DERO BIKE RACKS. INSTALL BIKE RACKS AS RECOMMENDED BY THE MANUFACTURER AND AS PROVIDED IN I-33A AND I-33B, SECTION I OF THE CITY OF PORTLAND'S TECHNICAL DESIGN MANUAL.  
 2. INSTALL BIKE RACKS MINIMUM 36" FROM DECK ENTRYWAY AND 24" FROM SIDE OF MAINE STATE PIER BUILDING.  
 3. DISTANCE BETWEEN RACKS SHALL BE 36" AS SHOWN IN THE DETAIL.

BICYCLE RACK  
NOT TO SCALE

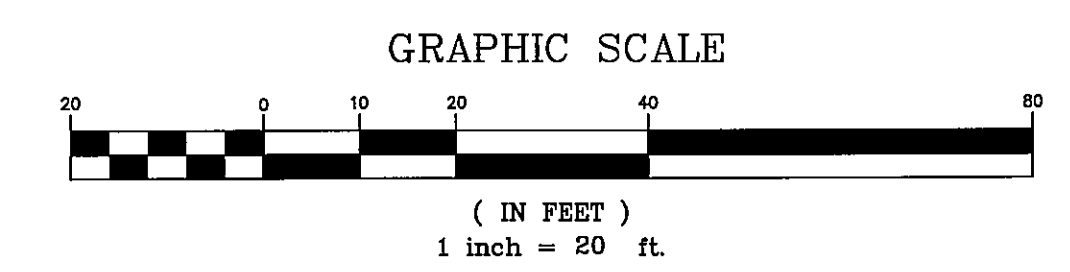

STATE OF MAINE  
 CRAIG A. BURGESS  
 No. 12838  
 PROFESSIONAL ENGINEER  
 10-13-14

REV.	BY:	DATE:	STATUS:
E	OAM	10-13-14	REMOVED LOADING DOCK RAMP & RETAINING WALL
D	OAM	05-16-14	ADJUSTED STRIPED WALK & PARKING AREAS ALONG BUILDING
C	OAM	05-08-14	ADDED PARKING SPACES, ADJUSTED STRIPED WALK & REVISED TANK LOCATION
B	OAM	05-08-14	ADDED CROSSWALK, BOLLARDS AT NITROGEN TANK PAD AREA & BICYCLE RACK
A	OAM	03-20-14	SUBMITTED FOR CITY SITE PLAN APPROVAL

THIS PLAN SHALL NOT BE MODIFIED WITHOUT WRITTEN PERMISSION FROM SEBAGO TECHNICALS, INC. ANY ALTERATIONS, AUTHORIZED OR OTHERWISE, SHALL BEAT THE USER'S SOLE RISK AND WITHOUT LIABILITY TO SEBAGO TECHNICALS, INC.

SEBAGO TECHNICALS, INC.  
 WWW.SEBAGO-TECHNICALS.COM  
 75 John B. Roberts Rd., Suite B  
 South Portland, ME 04106  
 Tel: 207-883-6555

PROJECT NO. 13430  
 FIELD BOOK DESIGN CHKD DRAWN  
 JOAMICAB OAM CAB

SITE PLAN  
 OF:  
 MAINE STATE PIER PROCESSING FACILITY  
 COMMERCIAL STREET  
 PORTLAND, MAINE 04101  
 FOR:  
 SHUCKS MAINE LOBSTER  
 65 MAIN STREET  
 RICHMOND, ME 04357

DATE	SCALE
03-20-14	1"=20'

SHEET 2 OF 5

13430S.dwg, TAB: S2

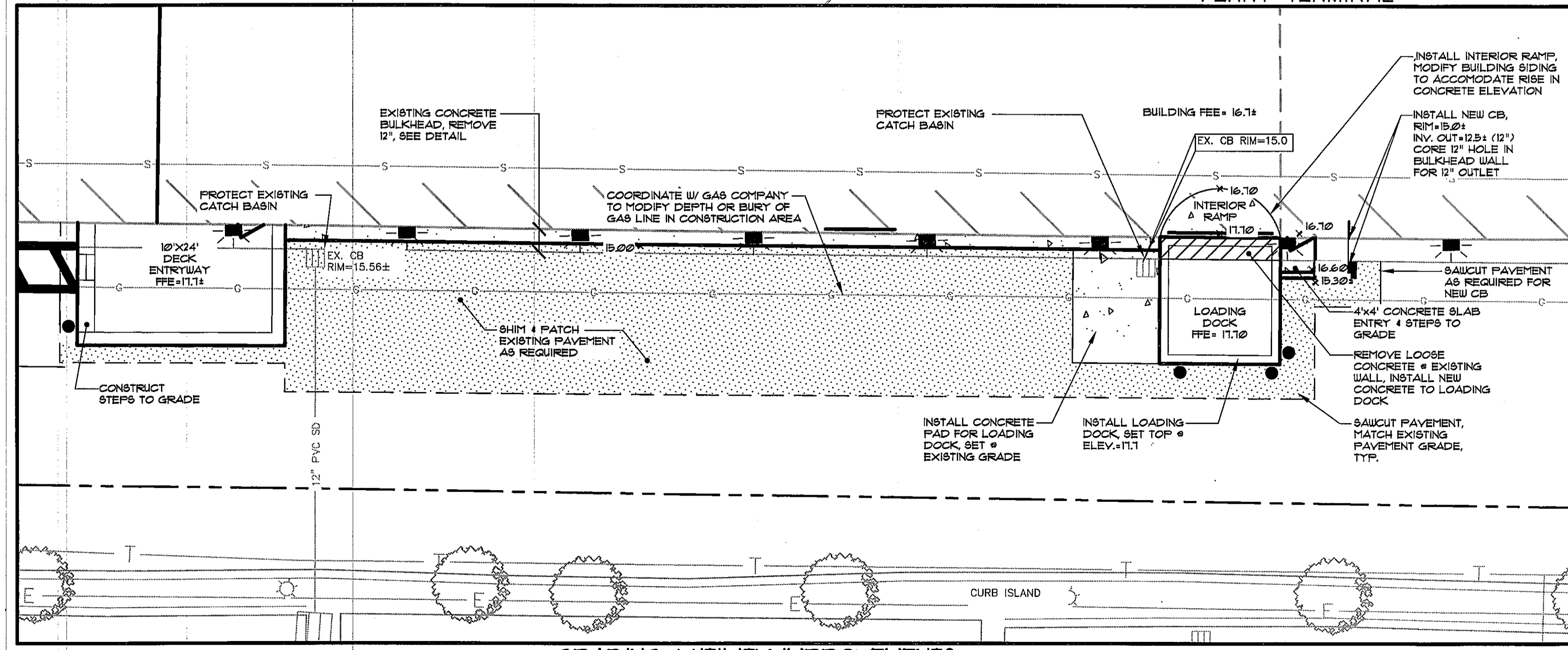
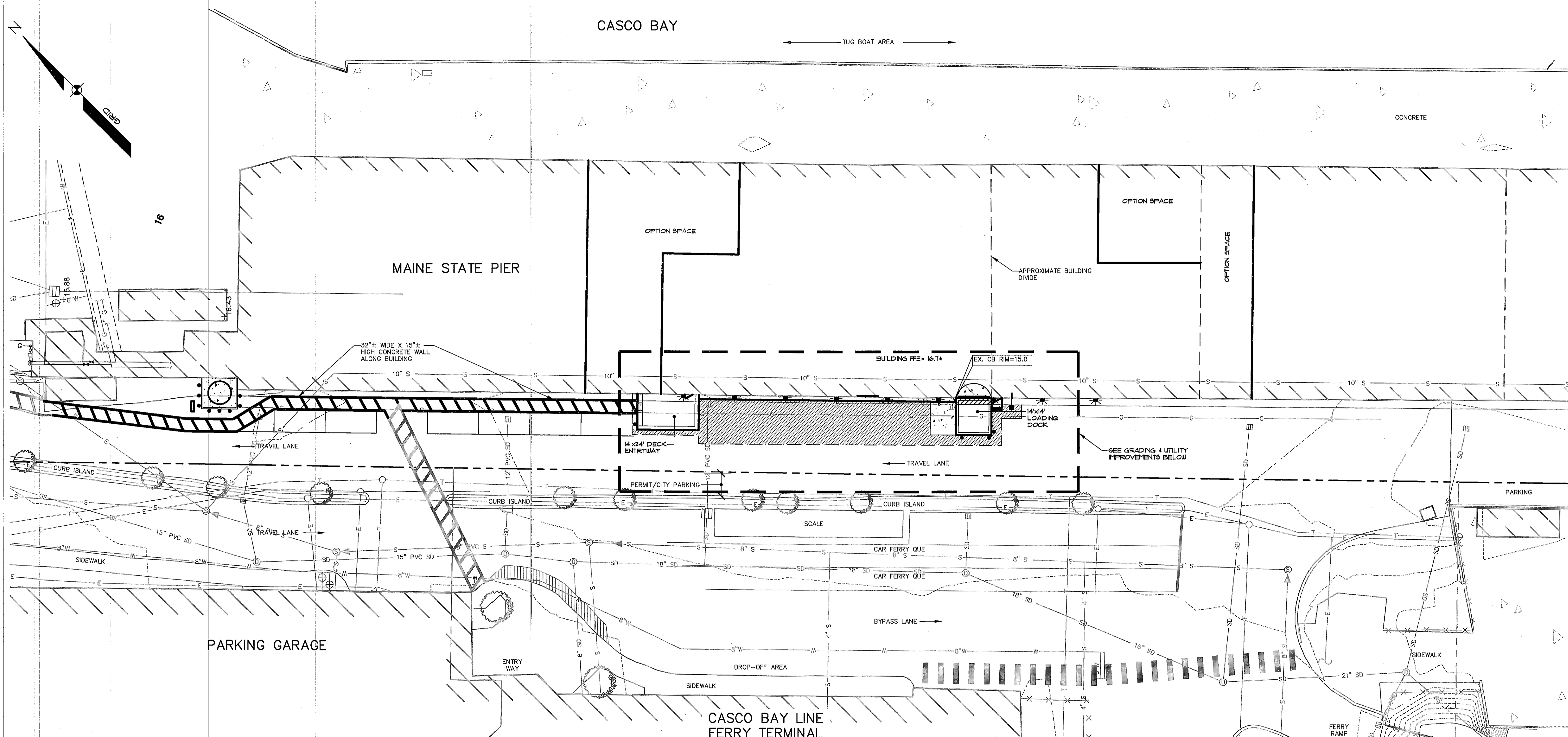

**LEGEND**

EXISTING	DESCRIPTION	PROPOSED	EXISTING	DESCRIPTION	PROPOSED
---	BOUNDARY LINE/ROW	---	W	WATER	W
---	ABUTTER LINE/ROW	---	WV	WATER GATE VALVE	WV
---	SETBACK	---	WS	WATER SHUT OFF	WS
---	EASEMENT	---	HY	HYDRANT	HY
---	ZONE LINE	---	PW	POTABLE WELL	PW
---	BENCH-MARK	---	S	SEWER	S
---	BUILDING	---	FM	FORCE MAIN	FM
---	SIGN	---	SM	SEWER MH	SM
---	EDGE PAVEMENT	---	SD	STORM DRAIN	SD
---	EDGE CONCRETE	---	UD	UNDERDRAIN	UD
---	PAVEMENT PAINT	---	CB	CATCH BASIN	CB
---	GRAVEL ROAD	---	DM	DRAINAGE MH	DM
---	CURBLINE	---	CU	CULVERT	CU
---	EDGE WATER	---	CHU	OVERHEAD UTILITY	CHU
---	TREELINE	---	T	UNDERGROUND TELEPHONE	T
---	CONTOURS	---	E	UNDERGROUND ELECTRIC	E
---	SPOT GRADE	---	TF	TRANSFORMER PAD	TF
---	FENCE	---	EM	ELECTRICAL MANHOLE	EM
---	RETAINING WALL	---	TM	TELEPHONE MANHOLE	TM
---	GUARDRAIL	---	LP	LIGHT POLE/WALL	LP
---	BOLLARD	---	U	UTILITY POLE	U
---	GAS	---			
---	GAS GATE VALVE	---			

**NOTES**

- PROPERTY, SITE AND TOPOGRAPHIC DATA SHOWN HEREON IS FROM A COMBINATION OF AVAILABLE CITY GIS INFORMATION AND DATA FROM PLAN REFERENCE B. ENTITIES DEPICTED WERE NOT FIELD VERIFIED FOR ACCURACY OR OMISSIONS.
- VERTICAL AND HORIZONTAL DATUMS REFERENCED IN PLAN REFERENCE A. SEE SHEET 1 OF 5.
- THE UTILITY LOCATIONS DEPICTED HEREON ARE APPROXIMATE AND COMPILED USING AVAILABLE CITY GIS DATA. FIELD VERIFICATION IS REQUIRED BY THE CONTRACTOR PRIOR TO CONSTRUCTION ACTIVITY. UTILITIES DEPICTED HEREON MAY NOT NECESSARILY REPRESENT ALL EXISTING UTILITIES. CONTRACTORS AND/OR DESIGNERS NEED TO CONTACT DIG-SAFE SYSTEMS, INC. (1-888-DIG-SAFE) AND FIELD VERIFY EXISTING UTILITIES PRIOR TO CONSTRUCTION AND/OR EXCAVATION.
- ALL SEDIMENT AND EROSION CONTROL MEASURES SHALL BE INSTALLED IN ACCORDANCE WITH "MAINE EROSION AND SEDIMENT CONTROL BEST PRACTICES" MANUAL PUBLISHED BY BUREAU OF LAND AND WATER QUALITY MAINE DEPARTMENT OF ENVIRONMENTAL PROTECTION, MARCH 2003 OR LATEST EDITION. IT SHALL BE THE RESPONSIBILITY OF THE CONTRACTOR TO POSSESS A COPY OF THE EROSION CONTROL PLAN AT ALL TIMES.

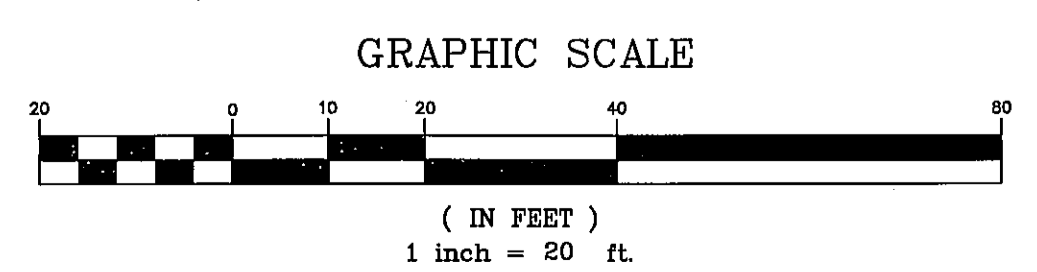

STATE OF MAINE  
 CRAIG A. BURGESS  
 No. 12658  
 PROFESSIONAL ENGINEER  
 10-13-14

B	OAM	10-13-14	REMOVED LOADING DOCK RAMP & RETAINING WALL
A	OAM	03-20-14	SUBMITTED FOR CITY SITE PLAN APPROVAL
REV.	BY:	DATE:	STATUS:

THIS PLAN SHALL NOT BE MODIFIED WITHOUT WRITTEN PERMISSION FROM SEBAGO TECHNICS, INC. ANY ALTERATIONS, AUTHORIZED OR OTHERWISE, SHALL BE AT THE USER'S SOLE RISK AND WITHOUT LIABILITY TO SEBAGO TECHNICS, INC.

**SEBAGO**  
 TECHNICS  
 WWW.SEBOGOTECHNICS.COM  
 76 John Paul Road, Suite B  
 South Portland, ME 04106  
 Tel. 207-200-2100  
 PROJECT NO. 13430

DESIGN	CHKD	DRAWN	CAB
OAM/CAB	OAM	OAM	CAB

**GRADING & UTILITY PLAN**  
 OF:  
**MAINE STATE PIER PROCESSING FACILITY**  
 COMMERCIAL STREET  
 PORTLAND, MAINE 04101  
 FOR:  
**SHUCKS MAINE LOBSTER**  
 50 MAIN STREET  
 RICHMOND, ME 04357  
 TAB: GJ1

DATE	SCALE
03-20-14	1"=20'

SHEET 3 OF 5

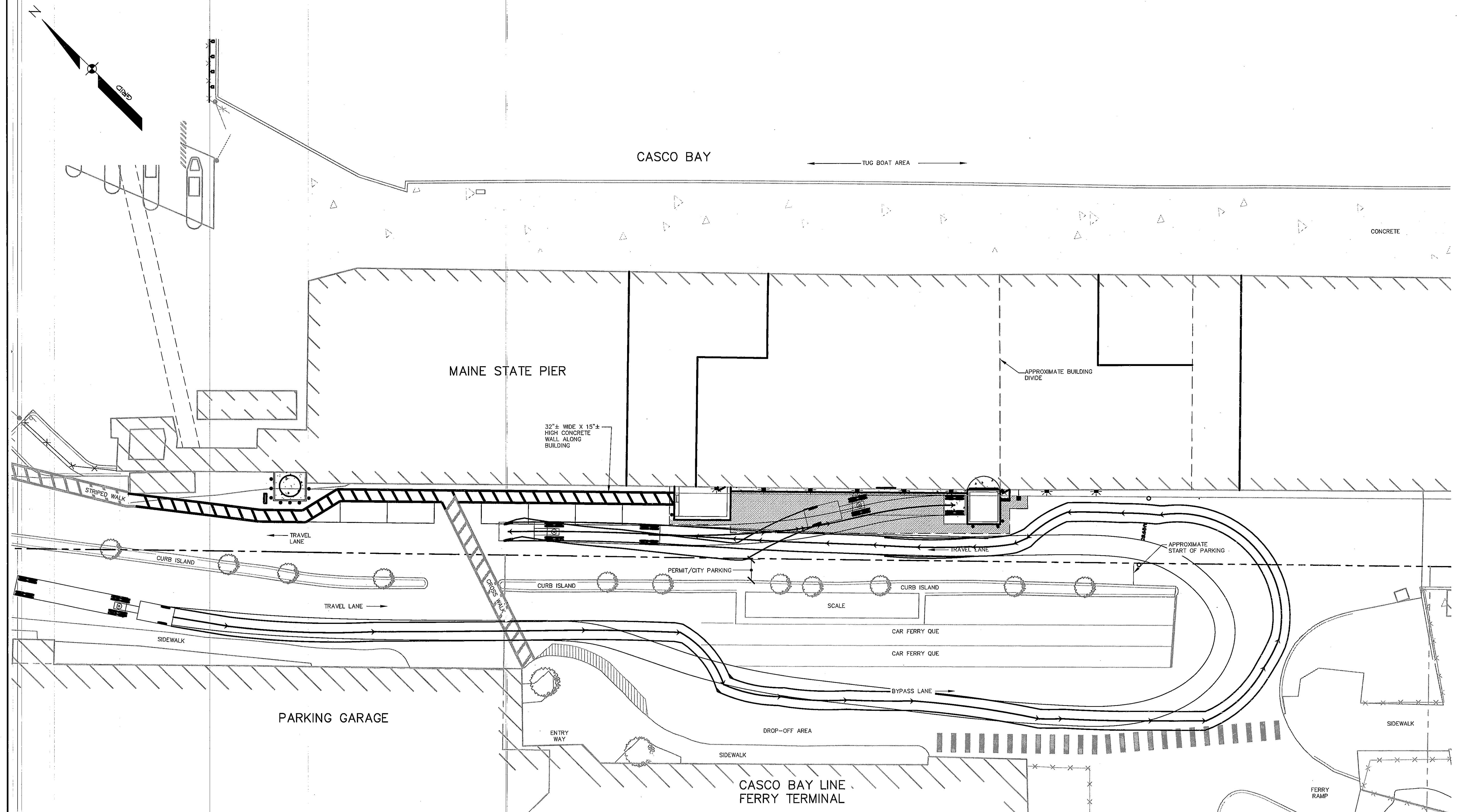

CASCO BAY

TUG BOAT AREA

CONCRETE

MAINE STATE PIER

32"± WIDE X 15"± HIGH CONCRETE WALL ALONG BUILDING

APPROXIMATE BUILDING DIVIDE

STRIPED WALK

TRAVEL LANE

CURB ISLAND

TRAVEL LANE

SIDEWALK

PERMIT/CITY PARKING

CURB ISLAND

SCALE

CURB ISLAND

CAR FERRY QUE

CAR FERRY QUE

APPROXIMATE START OF PARKING

PARKING GARAGE

ENTRY WAY

DROP-OFF AREA

CASCO BAY LINE FERRY TERMINAL

SIDEWALK

SIDEWALK

FERRY RAMP

**NOTES**  
1. TRAFFIC MOVEMENT WAS PERFORMED IN AUTOTURN USING WB-62 (TRACTOR TRAILER) VEHICLE PER AASHTO 2001.

**LEGEND**

EXISTING	DESCRIPTION	PROPOSED
---	BOUNDARY LINE/ROW	---
---	ABUTTER LINE/ROW	---
---	SETBACK	---
---	EASEMENT	---
---	ZONE LINE	---
---	BENCHMARK	---
---	BUILDING	---
---	SIGN	---
---	EDGE PAVEMENT	---
---	EDGE CONCRETE	---
---	PAVEMENT PAINT	---
---	GRAVEL ROAD	---
---	CURBLINE	---
---	EDGE WATER	---
---	TREELINE	---
---	TREE	---
---	FENCE	---
---	RETAINING WALL	---
---	GUARDRAIL	---
---	BOLLARD	---

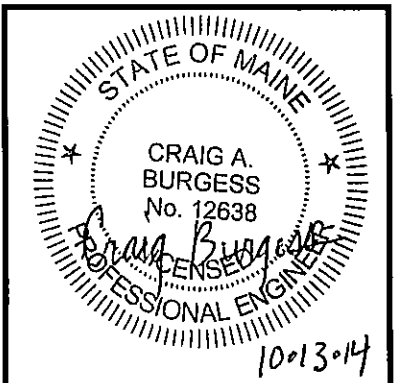
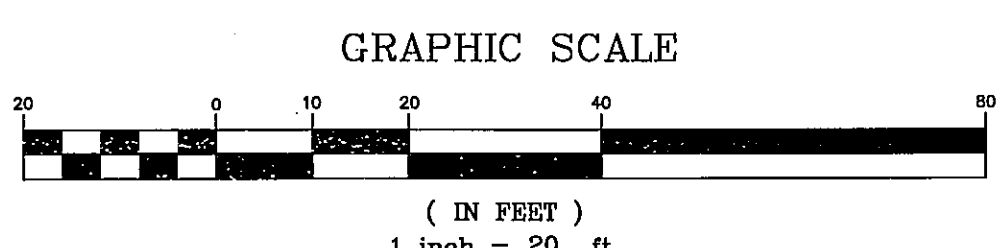

REV.	BY:	DATE:	STATUS:
B	OAM	10-13-14	REMOVED LOADING DOCK RAMP & RETAINING WALL
A	OAM	03-20-14	SUBMITTED FOR CITY SITE PLAN APPROVAL

THIS PLAN SHALL NOT BE MODIFIED WITHOUT WRITTEN PERMISSION FROM SEBAGO TECHNICS, INC. ANY ALTERATIONS, AUTHORIZED OR OTHERWISE, SHALL BE AT THE USER'S SOLE RISK AND WITHOUT LIABILITY TO SEBAGO TECHNICS, INC.

**SEBAGO TECHNICS**  
 WWW.SEBAGOTECHNICS.COM  
 75 John Roberts Rd., Suite 1A  
 South Portland, ME 04106  
 Tel: 207-286-9200

PROJECT NO. 19430

DESIGN	CHKD	DRAWN
OAM/CAB	OAM	CAB

**TRAFFIC MOVEMENT PLAN**  
 OF:  
**MAINE STATE PIER PROCESSING FACILITY**  
 COMMERCIAL STREET  
 PORTLAND, MAINE 04101  
 FOR:  
**SHUCKS MAINE LOBSTER**  
 150 MAIN STREET  
 RICHMOND, ME 04357

DATE	SCALE
03-20-14	1"=20'

**SHEET 4 OF 5**

13430S.dwg, TAB:53

**CONSTRUCTION NOTES**

- ALL WORK SHALL CONFORM TO THE APPLICABLE CODES AND ORDINANCES.
- CONTRACTOR SHALL VISIT THE SITE AND FAMILIARIZE HIM OR HERSELF WITH ALL CONDITIONS AFFECTING THE PROPOSED WORK AND SHALL MAKE PROVISIONS AS TO THE COST THEREOF. CONTRACTOR SHALL BE RESPONSIBLE FOR FAMILIARIZING HIM OR HERSELF WITH ALL CONTRACT DOCUMENTS, FIELD CONDITIONS AND DIMENSIONS AND CONFIRMING THAT THE WORK MAY BE ACCOMPLISHED AS SHOWN PRIOR TO PROCEEDING WITH CONSTRUCTION. ANY DISCREPANCIES SHALL BE BROUGHT TO THE ATTENTION OF THE ENGINEER PRIOR TO THE COMMENCEMENT OF WORK.
- CONTRACTOR SHALL NOTIFY ENGINEER OF ALL PRODUCTS OR ITEMS NOTED AS "EXISTING" WHICH ARE NOT FOUND IN THE FIELD.
- INSTALL ALL EQUIPMENT AND MATERIALS IN ACCORDANCE WITH MANUFACTURER'S RECOMMENDATIONS AND OWNER'S REQUIREMENTS UNLESS SPECIFICALLY OTHERWISE INDICATED OR WHERE LOCAL CODES OR REGULATIONS TAKE PRECEDENCE.
- CONTRACTOR SHALL VERIFY ALL DIMENSIONS AND CONDITIONS IN THE FIELD PRIOR TO FABRICATION AND ERECTION OF ANY MATERIAL. ANY UNUSUAL CONDITIONS SHALL BE REPORTED TO THE ATTENTION OF THE ENGINEER.
- CONTRACTOR SHALL CLEAN AND REMOVE DEBRIS AND SEDIMENT DEPOSITED ON PUBLIC STREETS, SIDEWALKS, ADJACENT AREAS, OR OTHER PUBLIC WAYS DUE TO CONSTRUCTION.
- CONTRACTOR SHALL INCORPORATE PROVISIONS AS NECESSARY IN CONSTRUCTION TO PROTECT EXISTING STRUCTURES, PHYSICAL FEATURES, AND MAINTAIN SITE STABILITY DURING CONSTRUCTION. CONTRACTOR SHALL RESTORE ALL AREAS TO ORIGINAL CONDITION AND AS DIRECTED BY DESIGN DRAWINGS.
- SITE CONTRACTOR SHALL OBTAIN ALL REQUIRED PERMITS PRIOR TO CONSTRUCTION.
- ALL EROSION AND SEDIMENT CONTROL MEASURES SHALL BE INSTALLED IN ACCORDANCE WITH "MAINE EROSION AND SEDIMENTATION CONTROL HANDBOOK FOR CONSTRUCTION: BEST MANAGEMENT PRACTICES" PUBLISHED BY THE CUMBERLAND COUNTY SOIL AND WATER CONSERVATION DISTRICT AND MAINE DEPARTMENT OF ENVIRONMENTAL PROTECTION, MARCH 1991 OR LATEST EDITION. IT SHALL BE THE RESPONSIBILITY OF THE CONTRACTOR TO POSSESS A COPY OF THE EROSION CONTROL PLAN AT ALL TIMES.
- THE CONTRACTOR IS HEREBY CAUTIONED THAT ALL SITE FEATURES SHOWN HEREON ARE BASED ON FIELD OBSERVATIONS BY THE SURVEYOR AND BY INFORMATION PROVIDED BY UTILITY COMPANIES. THE INFORMATION IS NOT TO BE RELIED ON AS BEING EXACT OR COMPLETE. THE CONTRACTOR SHALL CONTACT DIG SAFE (811) AT LEAST THREE (3) BUT NOT MORE THAN THIRTY (30) DAYS PRIOR TO COMMENCEMENT OF EXCAVATION OR DEMOLITION TO VERIFY HORIZONTAL AND VERTICAL LOCATION OF ALL UTILITIES.
- CONTRACTOR SHALL BE AWARE THAT DIG SAFE ONLY NOTIFIES ITS "MEMBER" UTILITIES ABOUT THE DIG. WHEN NOTIFIED, DIG SAFE WILL ADVISE CONTRACTOR OF MEMBER UTILITIES IN THE AREA. CONTRACTOR IS RESPONSIBLE FOR IDENTIFYING AND CONTACTING NON-MEMBER UTILITIES DIRECTLY. NON-MEMBER UTILITIES MAY INCLUDE TOWN OR CITY WATER AND SEWER DISTRICTS AND SMALL LOCAL UTILITIES, AS WELL AS USGS PUBLIC WORKS SYSTEMS.
- CONTRACTORS SHALL BE RESPONSIBLE FOR COMPLIANCE WITH THE REQUIREMENTS OF 23 MRS.A 336-D-A. IT SHALL BE THE RESPONSIBILITY OF THE CONTRACTOR TO COORDINATE WITH THE APPROPRIATE UTILITIES TO OBTAIN AUTHORIZATION PRIOR TO RELOCATION OF ANY EXISTING UTILITIES WHICH CONFLICT WITH THE PROPOSED IMPROVEMENTS SHOWN ON THESE PLANS. IF A UTILITY CONFLICT ARISES, THE CONTRACTOR SHALL IMMEDIATELY NOTIFY THE OWNER, THE MUNICIPALITY AND APPROPRIATE UTILITY COMPANY PRIOR TO PROCEEDING WITH ANY RELOCATION.
- ALL PAVEMENT MARKINGS AND DIRECTIONAL SIGNAGE SHOWN ON THE PLAN SHALL CONFORM TO THE MANUAL OF UNIFORM TRAFFIC CONTROL DEVICES (MUTCD) STANDARDS.
- ALL PAVEMENT JOINTS SHALL BE SAWCUT PRIOR TO PAVING TO PROVIDE A DURABLE AND UNIFORM JOINT.
- NO HOLES, TRENCHES OR STRUCTURES SHALL BE LEFT OPEN OVERNIGHT IN ANY EXCAVATION ACCESSIBLE TO THE PUBLIC OR IN PUBLIC RIGHTS-OF-WAY.
- ALL WORK WITHIN THE PUBLIC RIGHT-OF-WAY SHALL REQUIRE PERMIT FROM THE TOWN OF NAPLES.
- IMMEDIATELY UPON COMPLETION OF CUTS/FILLS, THE CONTRACTOR SHALL STABILIZE DISTURBED AREAS IN ACCORDANCE WITH EROSION CONTROL NOTES AND AS SPECIFIED ON PLANS.
- THE CONTRACTOR SHALL BE FULLY AND SOLELY RESPONSIBLE FOR THE REMOVAL, REPLACEMENT AND RECTIFICATION OF ALL DAMAGED AND DEFECTIVE MATERIAL AND WORKSMANSHIP IN CONNECTION WITH THE CONTRACT WORK. THE CONTRACTOR SHALL REPLACE OR REPAIR AS DIRECTED BY THE OWNER ALL SUCH DAMAGED OR DEFECTIVE MATERIALS WHICH APPEAR WITHIN A PERIOD OF ONE YEAR FROM THE DATE OF SUBSTANTIAL COMPLETION.
- ALL WORK PERFORMED BY THE GENERAL CONTRACTOR AND/OR TRADE SUBCONTRACTOR SHALL CONFORM TO THE REQUIREMENTS OF LOCAL, STATE OR FEDERAL LAWS, AS WELL AS ANY OTHER GOVERNING REQUIREMENTS, WHETHER OR NOT SPECIFIED ON THE DRAWINGS.
- WHERE THE TERMS "APPROVED EQUAL", "OTHER APPROVED", "EQUAL TO", "ACCEPTABLE" OR OTHER GENERAL QUALIFYING TERMS ARE USED IN THESE NOTES, IT SHALL BE UNDERSTOOD THAT REFERENCE IS MADE TO THE RULING AND JUDGMENT OF SEBAGO TECHNICS, INC.
- THE GENERAL CONTRACTOR SHALL PROVIDE ALL NECESSARY PROTECTION FOR THE WORK UNTIL TURNED OVER TO THE OWNER.
- THE GENERAL CONTRACTOR SHALL MAINTAIN A CURRENT AND COMPLETE SET OF CONSTRUCTION DRAWINGS ON SITE DURING ALL PHASES OF CONSTRUCTION FOR USE OF ALL TRADES.
- THE CONTRACTOR SHALL TAKE FULL RESPONSIBILITY FOR ANY CHANGES AND DEVIATION OF APPROVED PLANS NOT AUTHORIZED BY THE ARCHITECT/ENGINEER AND/OR CLIENT/OWNER.
- DETAILS ARE INTENDED TO SHOW END RESULT OF DESIGN. ANY MODIFICATION TO SUIT FIELD DIMENSION AND CONDITION SHALL BE SUBMITTED TO THE ENGINEER FOR REVIEW AND APPROVAL PRIOR TO ANY WORK.
- BEFORE THE FINAL ACCEPTANCE OF THE PROJECT, THE CONTRACTOR SHALL REMOVE ALL EQUIPMENT AND MATERIALS, REPAIR OR REPLACE PRIVATE OR PUBLIC PROPERTY WHICH MAY HAVE BEEN DAMAGED OR DESTROYED DURING CONSTRUCTION, CLEAN THE AREAS WITHIN AND ADJACENT TO THE PROJECT WHICH HAVE BEEN OBSTRUCTED BY HIS/HER OPERATIONS, AND LEAVE THE PROJECT AREA NEAT AND PRESENTABLE.
- ALL SUBSURFACE UTILITY LINES SHOWN HEREON ARE BASED SOLELY ON THE FIELD LOCATION OF VISIBLE STRUCTURES, SPH'S, CB'S, HYDRANTS, ETC. IN CONJUNCTION WITH DESIGN AND OR AS-BUILT PLANS SUPPLIED TO SEBAGO TECHNICS, INC. BY OTHERS PRIOR TO ANY CONSTRUCTION. EXCAVATION, TEST BORINGS, DRILLING, ETC. DIG SAFE MUST BE NOTIFIED AND A SITE IDENTIFICATION NUMBER ALONG WITH A SAFE TO DIG DATE OBTAINED. THE SITE CONTRACTOR SHALL BE RESPONSIBLE FOR FIELD VERIFYING THE LOCATION, DEPTH AND MATERIAL OF ALL SUBSURFACE UTILITY LINES SHOWN HEREON AND ANY AND ALL OTHERS LOCATED ON SITE WITHIN THE CONSTRUCTION AREA.

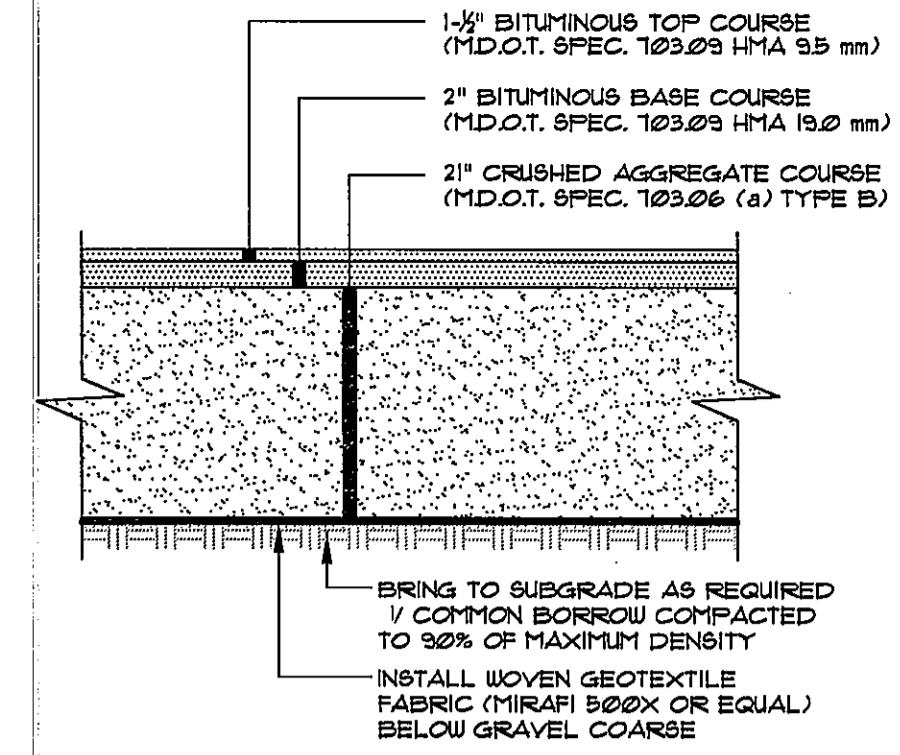

- NOTES:**
- COMPACT GRAVEL COURSE TO 95% OF MAXIMUM DENSITY USING HEAVY ROLLER COMPACTION.
  - CONTRACTOR SHALL SET GRADE STAKES MARKING SUBBASE AND FINISH GRADE ELEVATIONS FOR CONSTRUCTION REFERENCE.

**TYP. PAVED SECTION**  
NOT TO SCALE

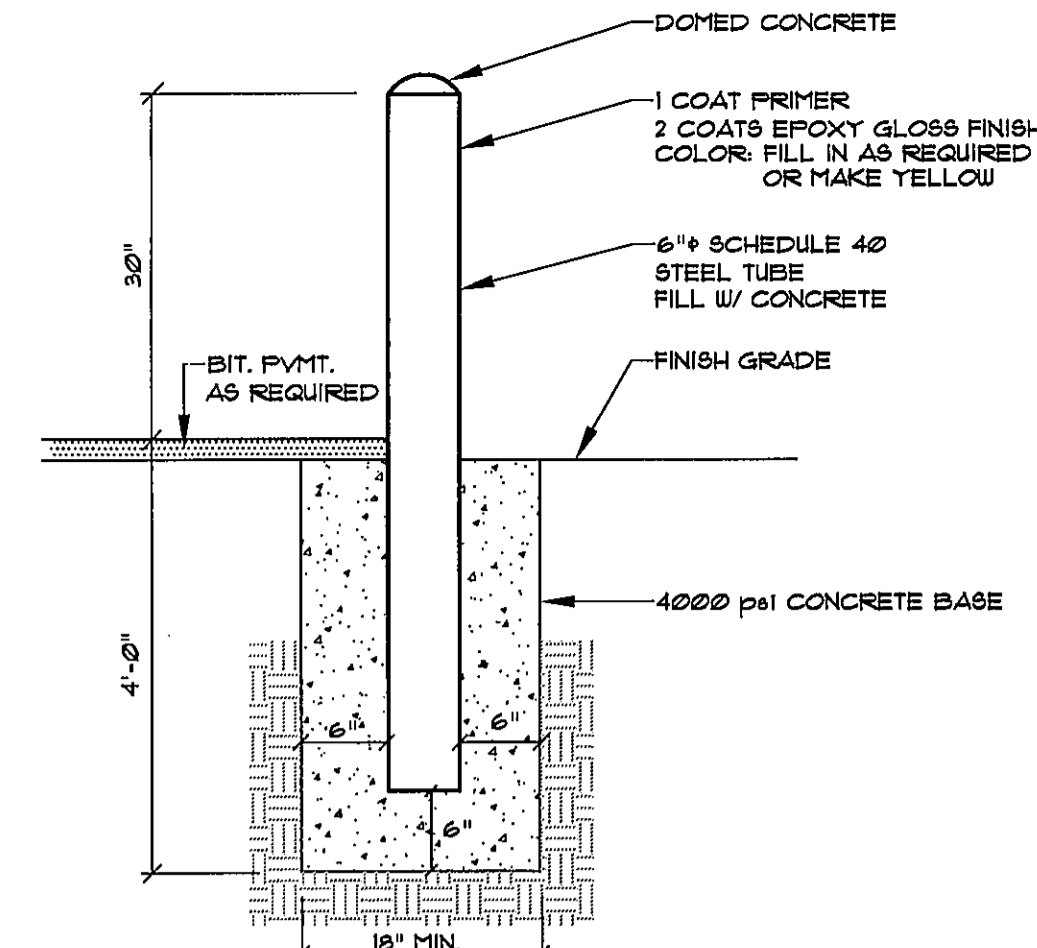

**METAL BOLLARD**  
NOT TO SCALE

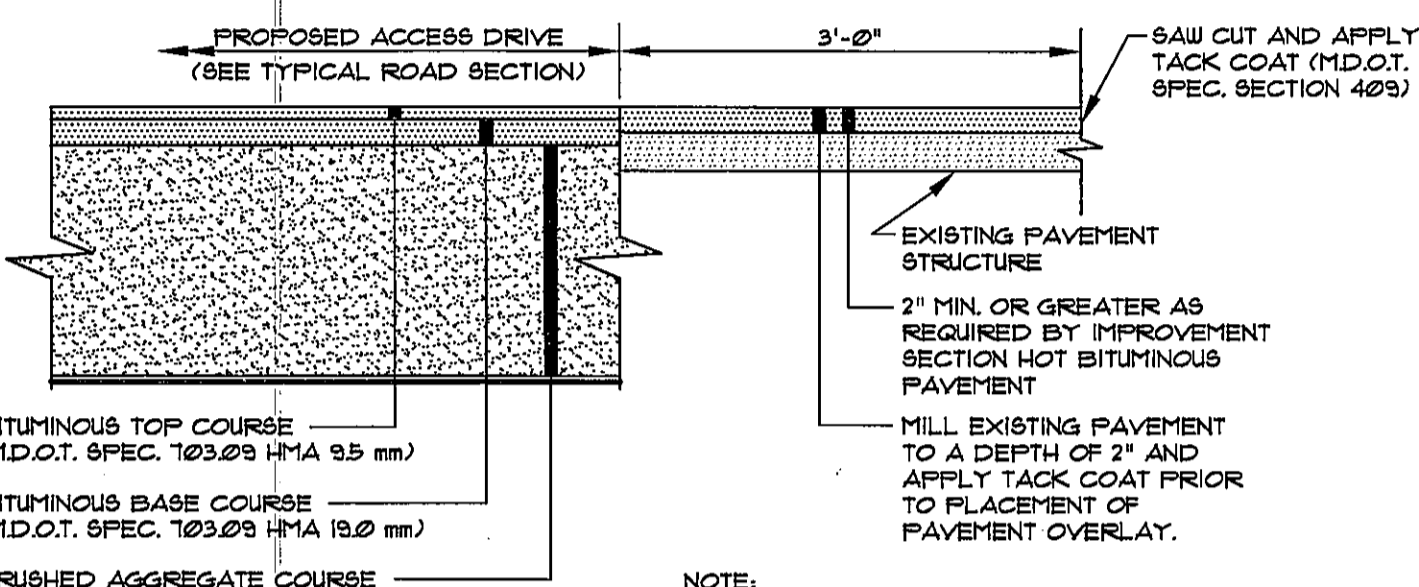

- NOTE:** SEE PAVED SECTION DETAIL FOR PAVEMENT AND GRAVEL DEPTHS.

**TYPICAL PAVEMENT JOINT**  
NOT TO SCALE

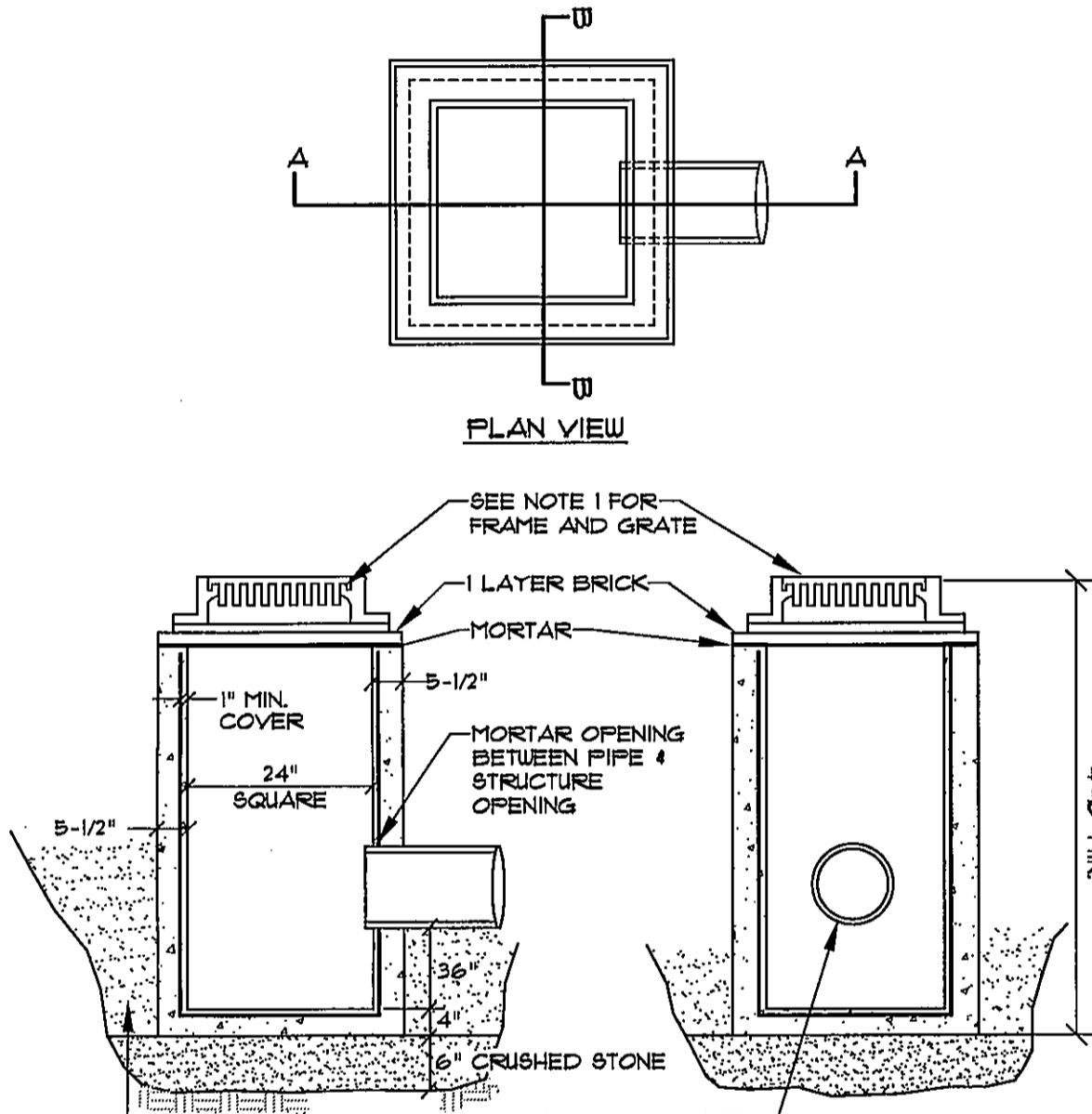

- NOTES:**
- FRAME SHALL BE FOR 24\"/>
  - ENTIRE CATCH BASIN WITH EXCEPTION OF LEVELING BRICK FRAME AND GRATE TO BE PRECAST AS SINGLE PORTLAND CEMENT CONCRETE UNIT.

**TYP. TYPE 'F' CATCH BASIN**  
NOT TO SCALE

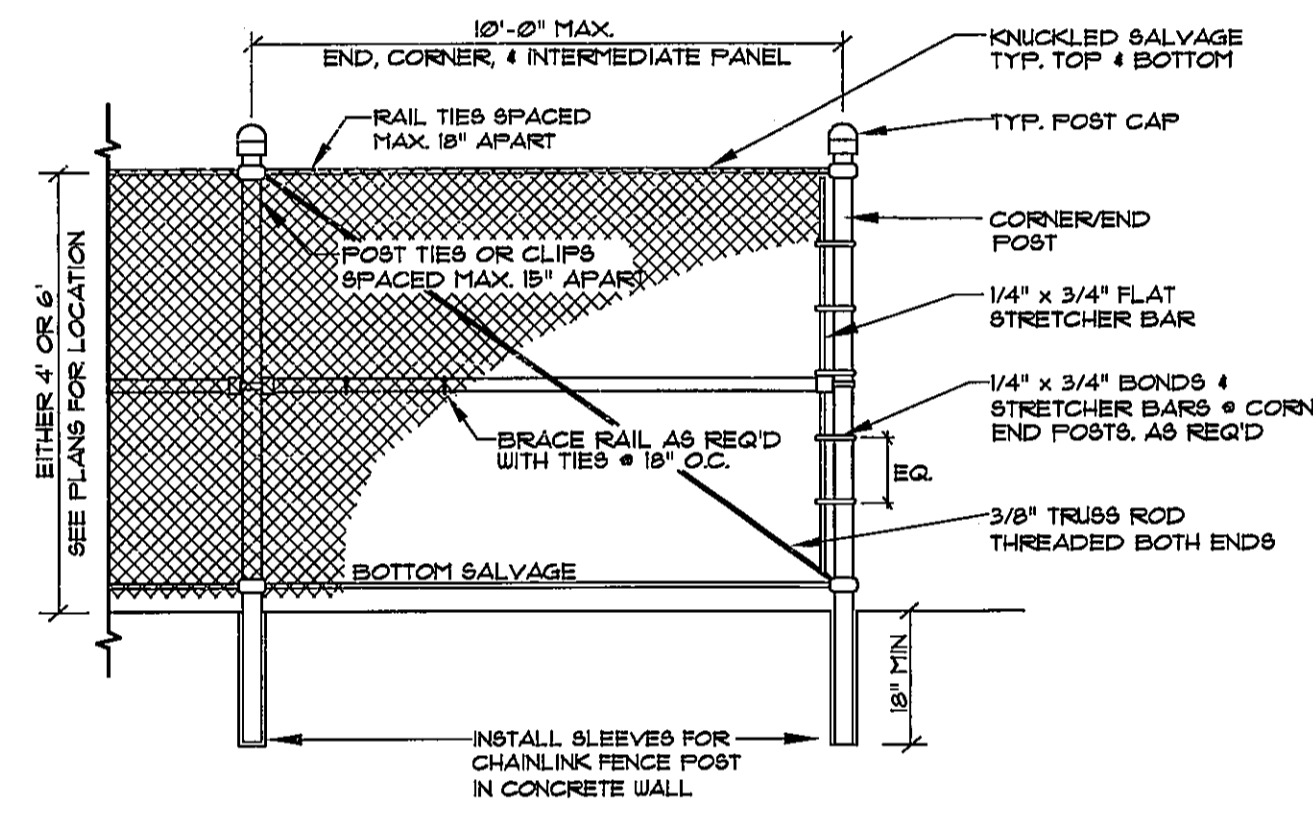

- NOTES:**
- CORNER OR END POST: NOMINAL 3\"/>
  - INTERMEDIATE POST: NOMINAL 2-1/2\"/>
  - BRACE (TOP & BOTTOM): NOMINAL 1-5/8\"/>
  - THE OUTSIDE OF THE FENCE FABRIC SHALL BE 3\"/>
  - BRACE RAIL AND DIAGONAL BRACE ROD SHALL BE INSTALLED AT EACH 10\"/>
  - CONCRETE SHALL HAVE MINIMUM COMPRESSIVE STRENGTH (f'c) OF 3000 psi WITH 6% AIR ENTRAINMENT.
  - SUBMIT SHOP DRAWINGS FOR OWNER'S/ENGINEER'S APPROVAL.
  - FENCE FABRIC, POST, RAILS AND APPURTENANCES SHALL BE VINYL CLAD COLOR: BLACK.

**TYPICAL CHAIN LINK FENCE**  
NOT TO SCALE

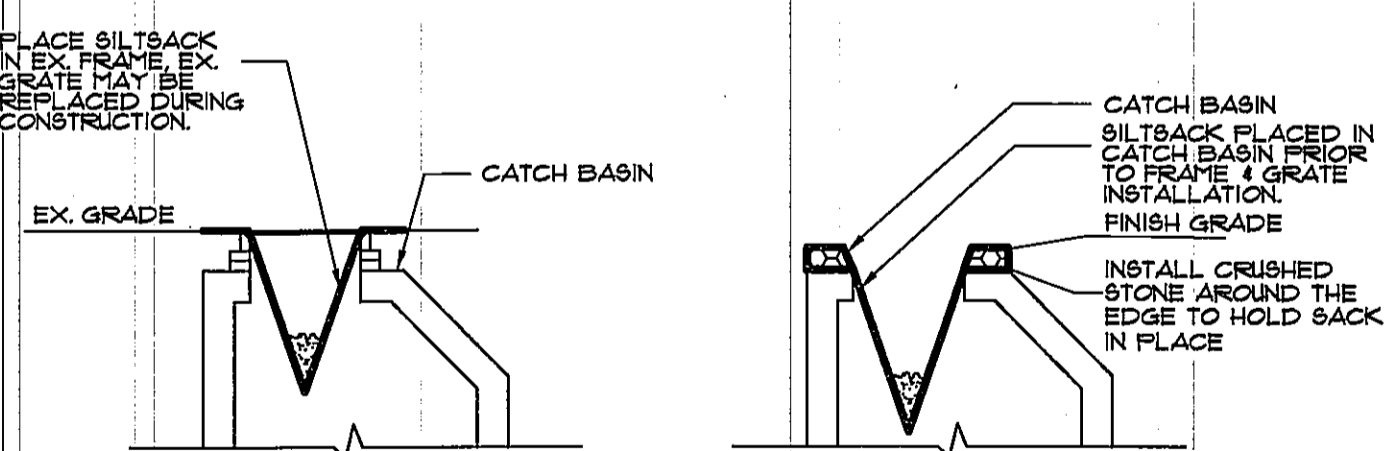

**CATCH BASIN PROTECTION DETAIL (FOR PAVED AREAS)**  
NOT TO SCALE

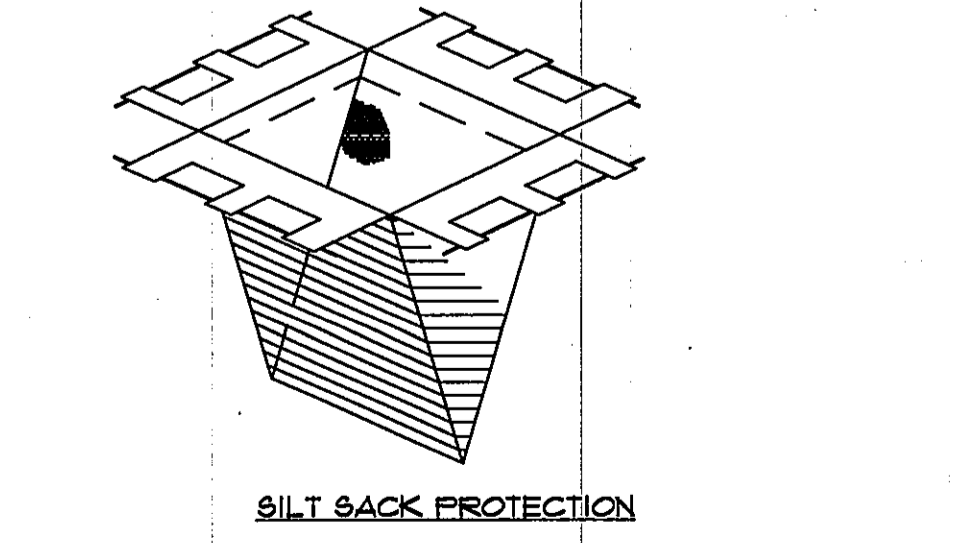

- NOTES:**
- PRIOR TO FINAL GRADING AND PAVING OPERATIONS BEGIN A CATCH BASIN INSERT (SUCH AS A SILT BACK OR A SANDY BACK) MUST BE INSTALLED IN EACH BASIN PER MANUFACTURER'S INSTRUCTIONS. HAY BALES SHOULD BE REMOVED ONCE INSERTS ARE INSTALLED.

**CATCH BASIN PROTECTION DETAIL (FOR PAVED AREAS)**  
NOT TO SCALE

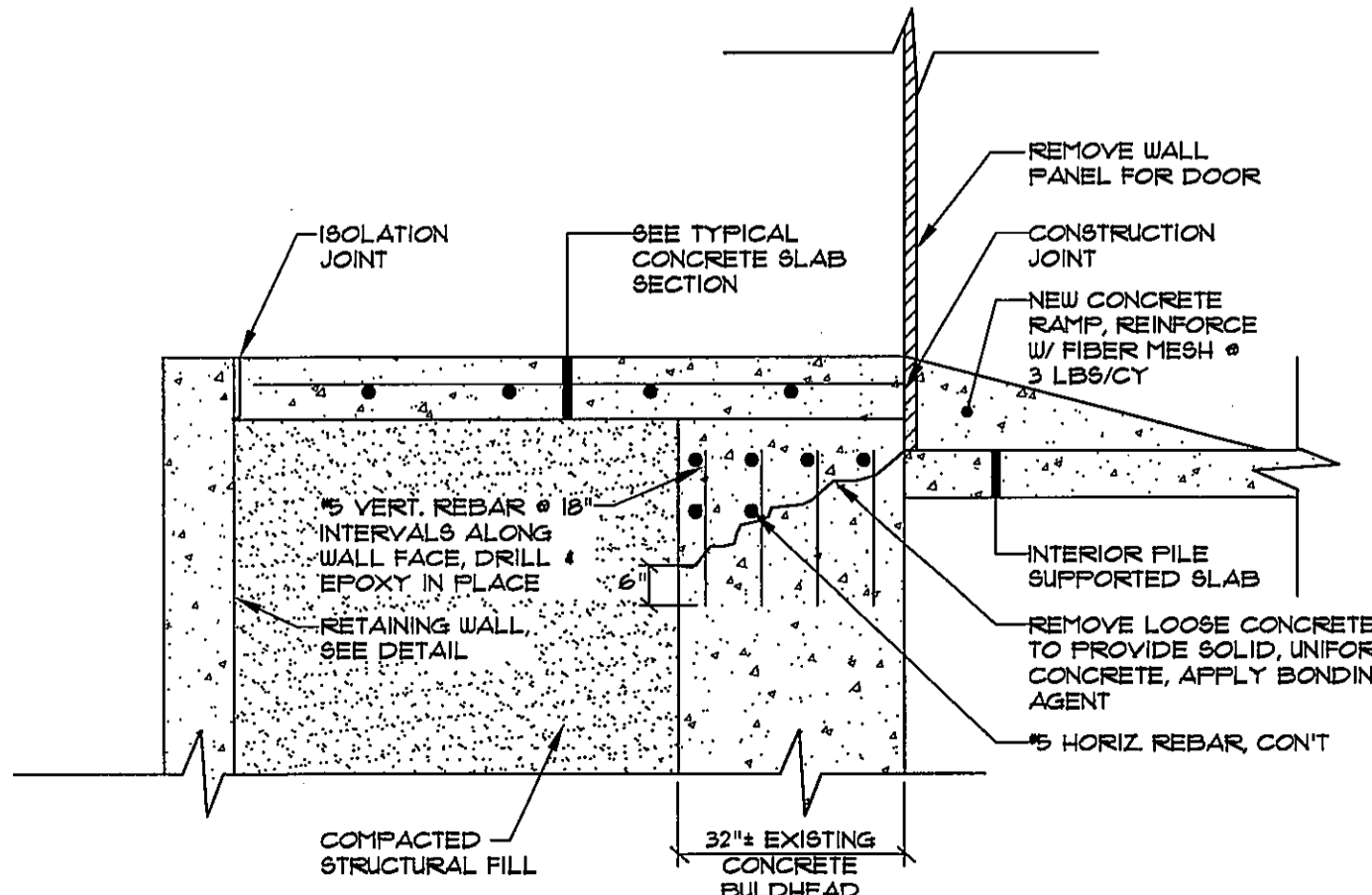

**LOADING DOCK WALL IMPROVEMENT**  
NOT TO SCALE

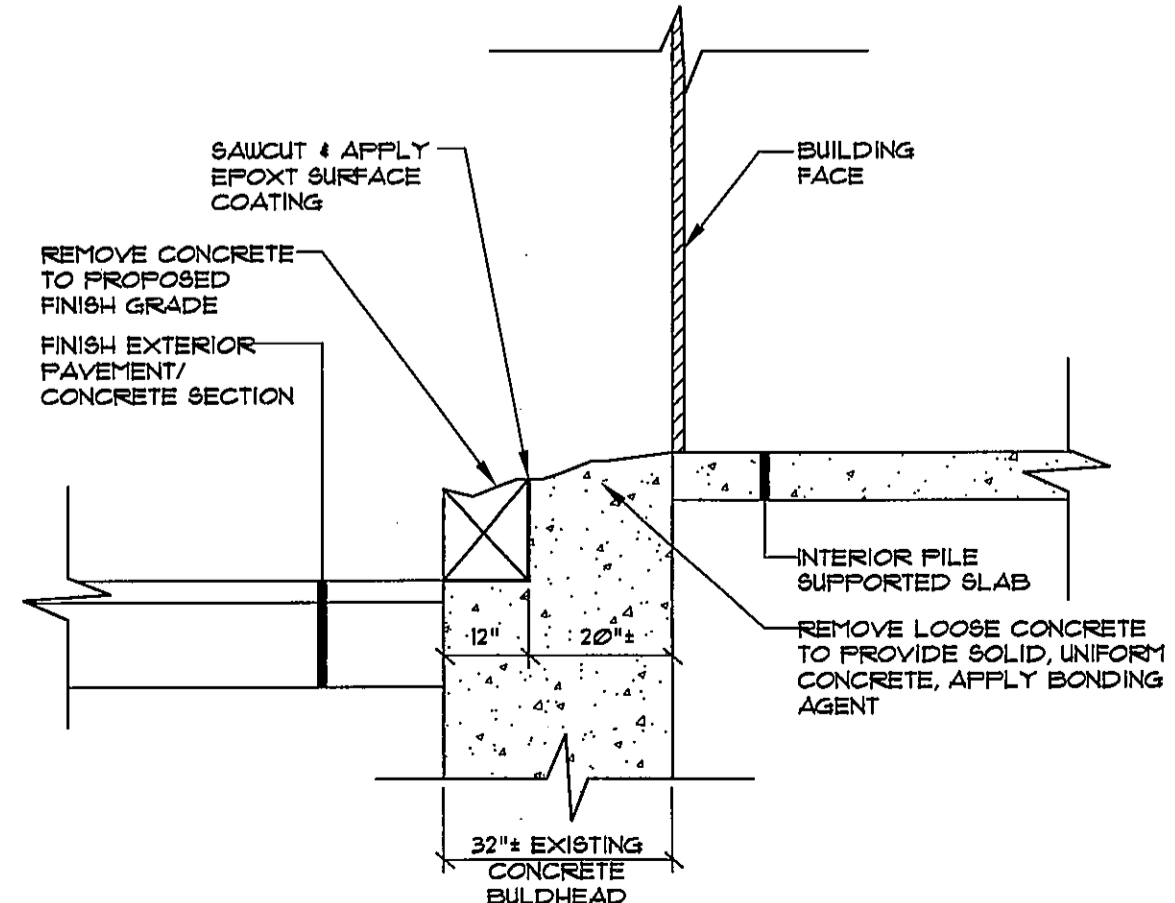

**LONGITUDINAL WALL SAW CUT**  
NOT TO SCALE

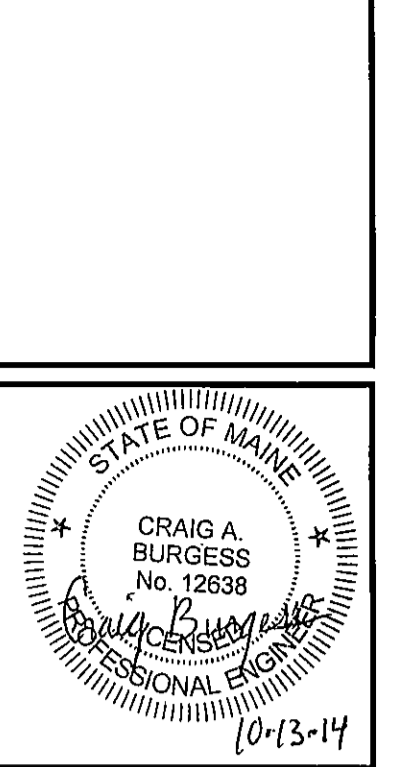

DATE	10-13-14	REMOVED LOADING DOCK RAMP & RETAINING WALL
BY	CA	SUBMITTED FOR CITY SITE PLAN APPROVAL
REV.	A	DATE: 03-20-14
STATUS:	BY:	DATE:

**SEBAGO TECHNICS**

WWW.SEBAGOTECHNICS.COM  
 75 Ash Rd., Suite 3  
 South Portland, ME 04106  
 Tel. 207-783-9556

PROJECT NO. FIELD BOOK DESIGN CHKD DRAWN  
 13430 OAM CAB

**SITE DETAILS & NOTES**

OF: **MAINE STATE PIER PROCESSING FACILITY**  
 COMMERCIAL STREET  
 PORTLAND, MAINE 04101

FOR: **SHUCKS MAINE LOBSTER**  
 150 MAIN STREET  
 RICHMOND, ME 04357

DATE	SCALE
03-20-14	1"=20'