

FLOOR PLAN

LEGEND:
—— DEMISING WALLS
—— FLOOR TO FLOOR OR FLOOR TO ROOF

DEMISING WALL NOTE:
 Demising walls depicted on the plan require a 1 hour fire rating due to the adjacent mixed occupancy being categorized as "Storage". These stud partition walls are to extend to the full width of the exterior wall line and to the roof or existing rated ceiling and carry a UL 414 / GA/WP 1072 rating. All penetrations are to be covered and taped with 5/8" type X gypsum on each side of the wall. Remaining cavities are to be sealed with 1 hour fire rated caulking. The final interior wall finish on the Shucks Maine Lobster (SML) side is to be determined at a later date, but shall sustain a 1 hour rated assembly.

STAIR NOTE:
 A set of temporary wood stairs and 4' x 4' landings with wood rails shall be constructed at the two main doors to accommodate direct access to the leased space until such time as a permit is issued to complete the site work and loading dock and deck. These stairs, as shown on the enclosed plans, shall be constructed per IBC "Temporary Structures" standards using structural grade SPF material.

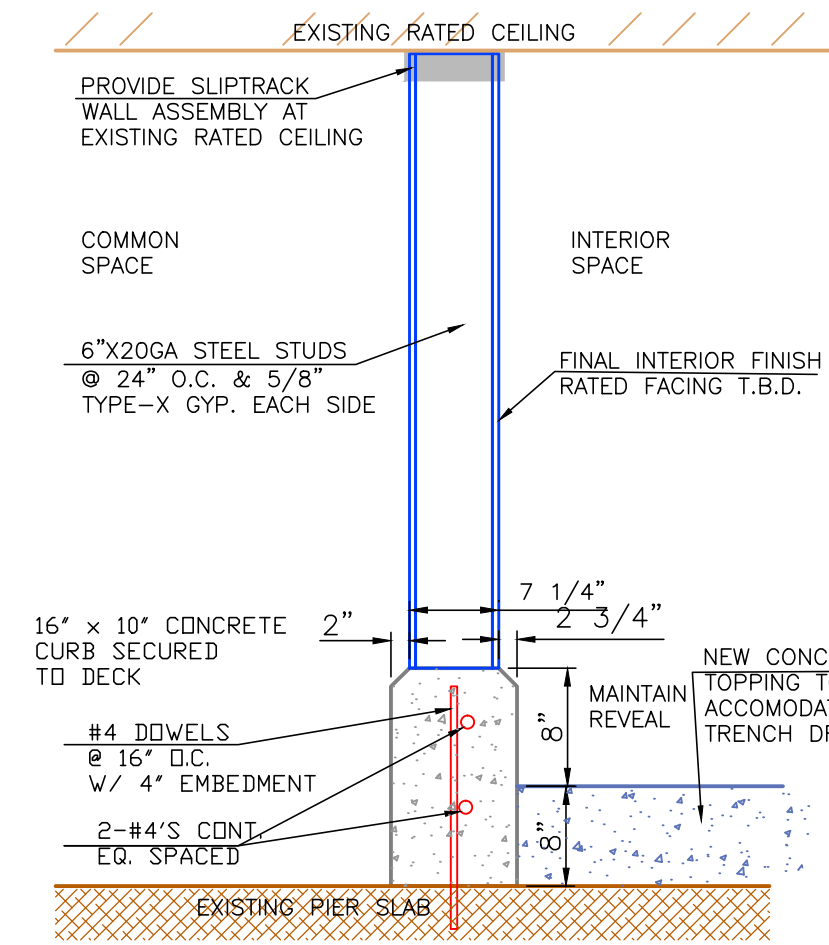
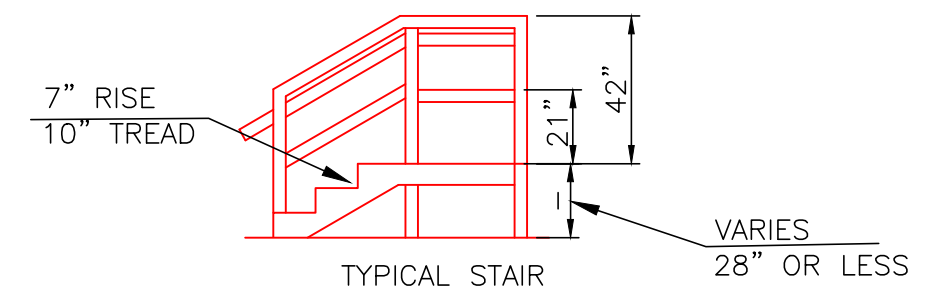

DEMISING WALL SECTION A-A

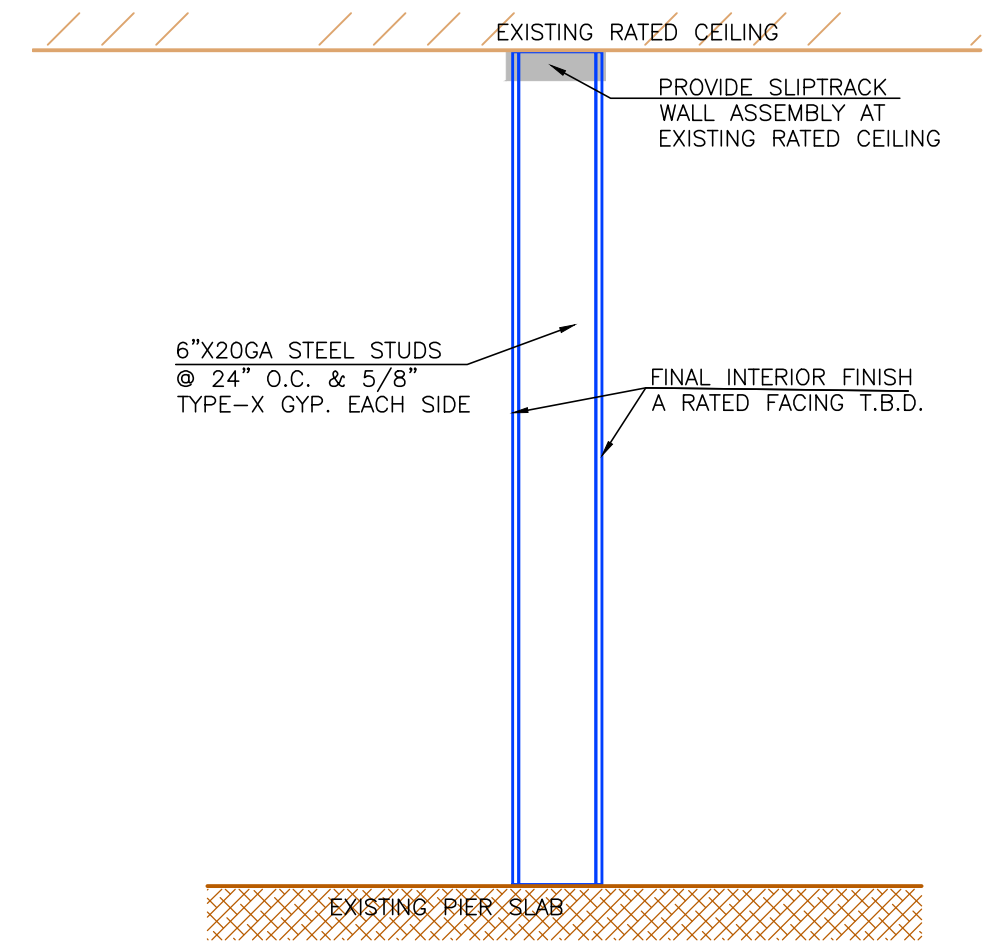

DEMISING WALL SECTION B-B

| DOOR SCHEDULE | | | | | | |
|---------------|----------|---------|--------|------------|-------|------------------|
| NO. | LOCATION | SIZE | RATING | MATERIAL | FRAME | HARDWARE |
| D1 | INTERIOR | 6x7 | 1 HR | INS. METAL | STEEL | LOCKSET & CLOSER |
| D2 | EXTERIOR | 3x7 | | INS. METAL | STEEL | LOCKSET & CLOSER |
| D3 | EXTERIOR | 12'x10' | | INS. METAL | STEEL | STEEL |

| | | | | | | | | | |
|------|--|----------|--|----------------|--|--|--|------------------------------|--|
| DATE | | REVISION | | DRAWING STATUS | | ENGINEERING DESIGNS FOR SHUCKS MAINE LOBSTER Portland, Maine | | JOB NO. 14-0003 | |
| | | | | | | EST. NO. | | ENGINEERING DWG. NO. CAN-01 | |
| | | | | | | SIZE | | DESIGNED | |
| | | | | | | TYPE | | DRAWN BY RAJP | |
| | | | | | | DRAWN BY RAJP | | REVIEWED BY DS | |
| | | | | | | REVIEWED BY DS | | TITLE Demising Walls & Doors | |
| | | | | | | SCALE NOT TO SCALE | | DESIGN BUILDER | |
| | | | | | | DATE 07-01-2014 | | | |
| | | | | | | | | | |