

# KS SERIES - VERTICAL INSTALLATION

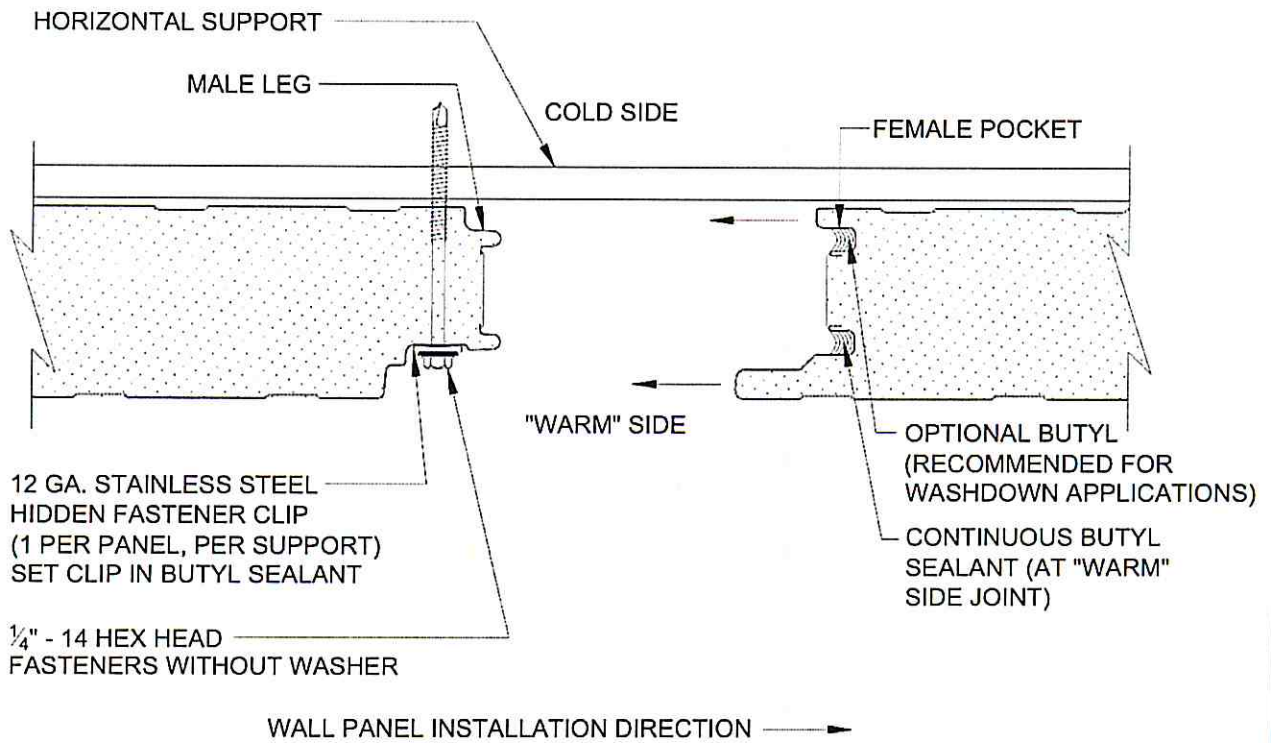
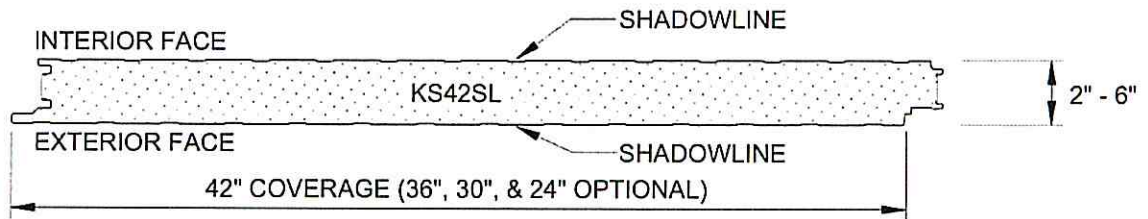

NOTE: FILL FEMALE POCKET(S) 3/4 FULL WITH SEALANT TO PROVIDE PROPER AIR/WATER SEAL

**KS42SL**  
**EXPANDED JOINT**

DETAIL #: CS-PJ-01-KSV

DATE: 7/26/11

**Kingspan.**  
Insulated Panels

[www.kingspanpanels.us](http://www.kingspanpanels.us)  
[www.kingspanpanels.ca](http://www.kingspanpanels.ca)