

DEMOLITION KEYED NOTES:
 1 REMOVE (E)EXHAUST ROOF JACK.

E1 MECHANICAL DEMOLITION PLAN ~ ROOF
 1/8" = 1'-0"

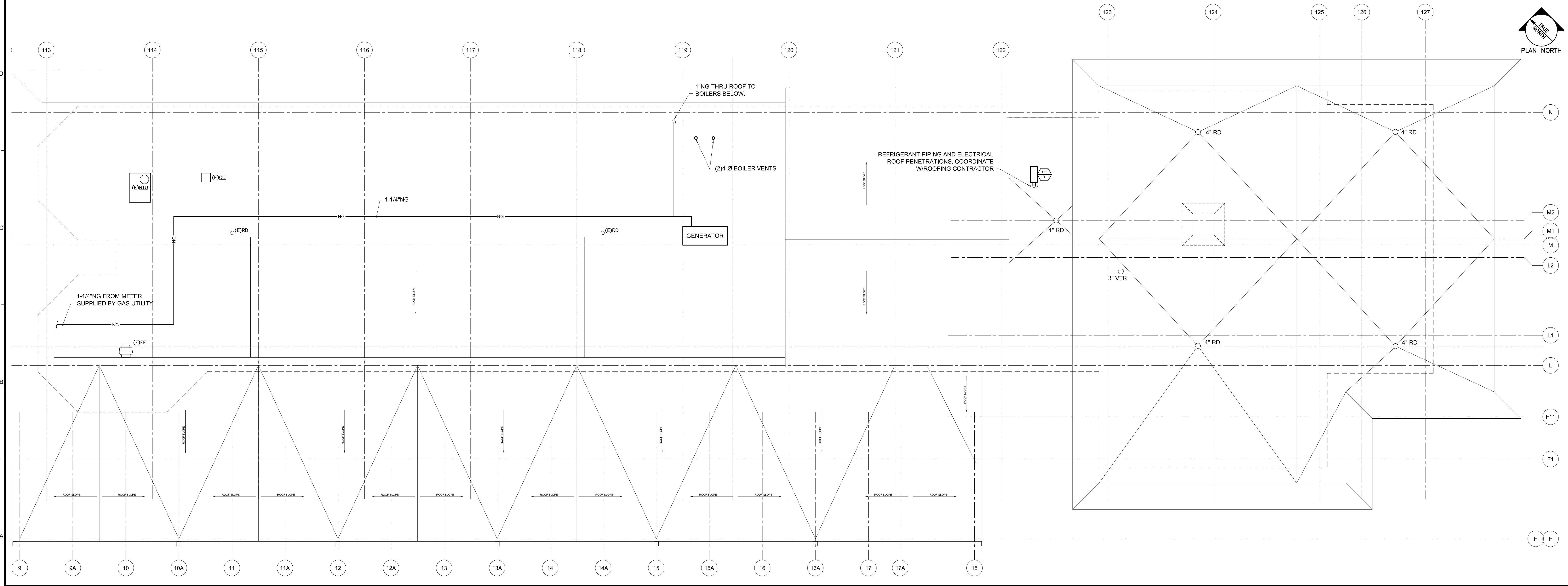

A1 MECHANICAL PLAN ~ ROOF
 1/8" = 1'-0"

Allied Engineering
 Structural Mechanical
 Electrical Commissioning

**160 Veranda Street
 Portland, Maine 04103**
 T: 207.221.2260
 F: 207.221.2266
 Web: www.allied-eng.com

Allied Project No: 12008
 Cad File: 12008M.dwg
 Checked By: IAM

SSA

Scott Simons Architects
 75 York Street, Portland, Maine 04101
 www.simonsarchitects.com
 207.772.4656

PROJECT NAME:
CASCO BAY FERRY TERMINAL
 RENOVATIONS & ADDITIONS
 56 COMMERCIAL STREET
 PORTLAND, MAINE 04101

SEAL:

THIS DRAWING IS THE PROPERTY OF SCOTT SIMONS ARCHITECTS (SSA) AND IS NOT TO BE COPIED OR REPRODUCED IN PART OR WHOLE. ©2012 SCOTT SIMONS ARCHITECTS, LLC

REVISION:	DATE
1	DATE
2	DATE
3	DATE
4	DATE
5	DATE
6	DATE

DATE OF ISSUE: MAY 14, 2013
 PROJECT NUMBER: 2011-0270
 STATUS: ISSUED FOR BIDDING

MECHANICAL PLANS ~ ROOF

MH-102
 2008 © Scott Simons Architects LLC

N:\Projects\2012\12008 - Casco Bay Ferry Terminal\01 Drawing Files\12008M.dwg May 13, 2013 8:17am