

1 LAYER 1
SCALE: 1/8" = 1'-0"

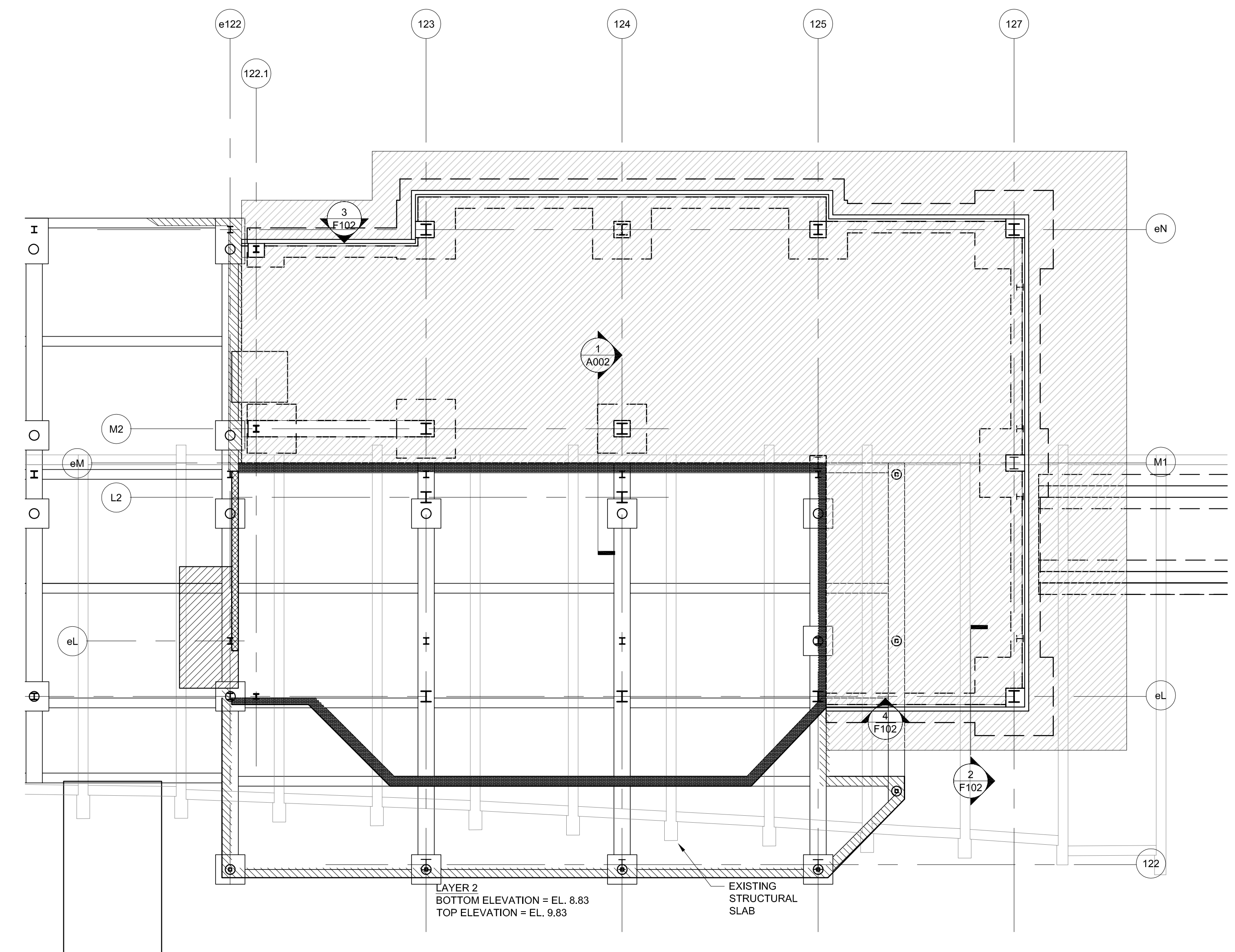

2 LAYER 2
SCALE: 1/8" = 1'-0"

NOTES:
1. REFER TO SPECIFICATION SECTION 312323.43 - GEOFOAM LIGHTWEIGHT FILL FOR ADDITIONAL INFORMATION
2. REFER TO SHEET A002 FOR GEOFOAM DETAILS
3. COORDINATE LOCATION OF GEOFOAM WITH EXISTING FOUNDATIONS, EXISTING/PROPOSED UTILITIES, AND THE EXISTING SEAWALL, SUBJECT TO REVIEW AND APPROVAL BY THE OWNER.

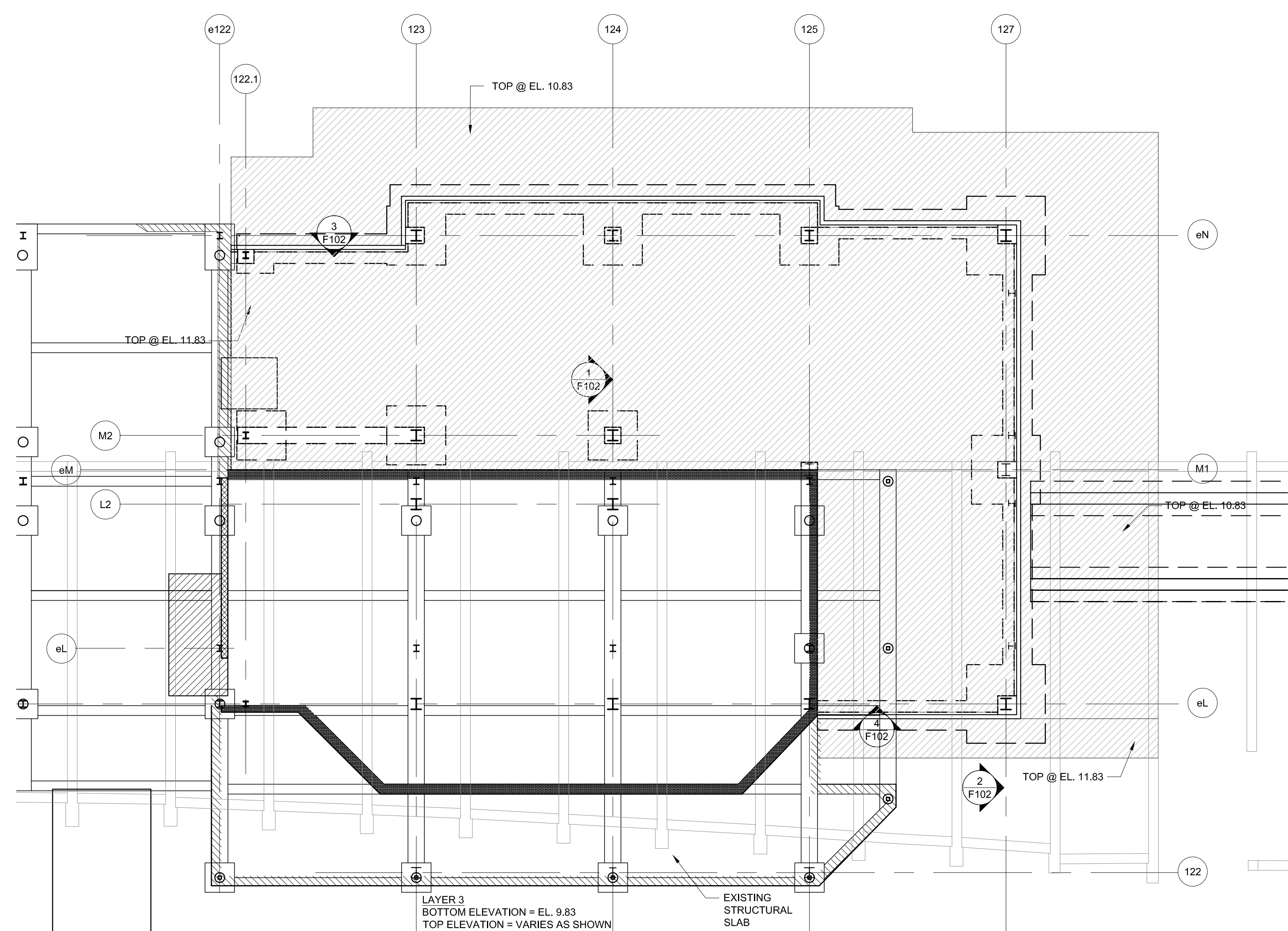

3 LAYER 3
SCALE: 1/8" = 1'-0"



Scott Simons Architects
75 York Street, Portland, Maine 04101
www.simonsarchitects.com
207.772.4656

PROJECT NAME:
CASCO BAY FERRY TERMINAL
RENOVATIONS & ADDITIONS
56 COMMERCIAL STREET
PORTLAND, MAINE 04101
FEDERAL PROJECT NO. FBD-1836 (300) X
STATE WIN NO. 18363.10

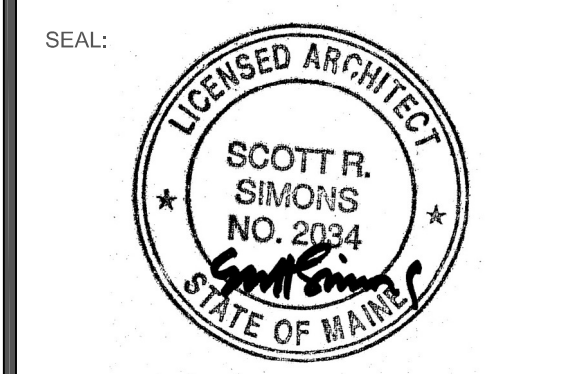

THIS DRAWING IS THE PROPERTY OF SCOTT SIMONS ARCHITECTS, L.L.C. AND IS NOT TO BE COPIED OR REPRODUCED IN PART OR WHOLE.
2013 © SCOTT SIMONS ARCHITECTS, L.L.C.

REVISIONS:

DATE OF ISSUE: MAY 14, 2013
PROJECT NUMBER: 2011-0270
STATUS: ISSUED FOR BIDDING

PLAN SHEET

F101